

**SUPPLEMENTAL INFORMATION
No. 1**

For Planning Commission Agenda of:
June 06, 2019

Re:	Applicant	Empress Farms, LLC	Item No.: E-3
	Record Number	PLN-CUP-12694	
	Assessor Parcel Numbers	104-311-019, 104-281-005, and 104-281-004	

The following items are included in this supplemental:

1. Parking Plan Map
2. Revised Site Map (Revision limited to location of parking spaces)

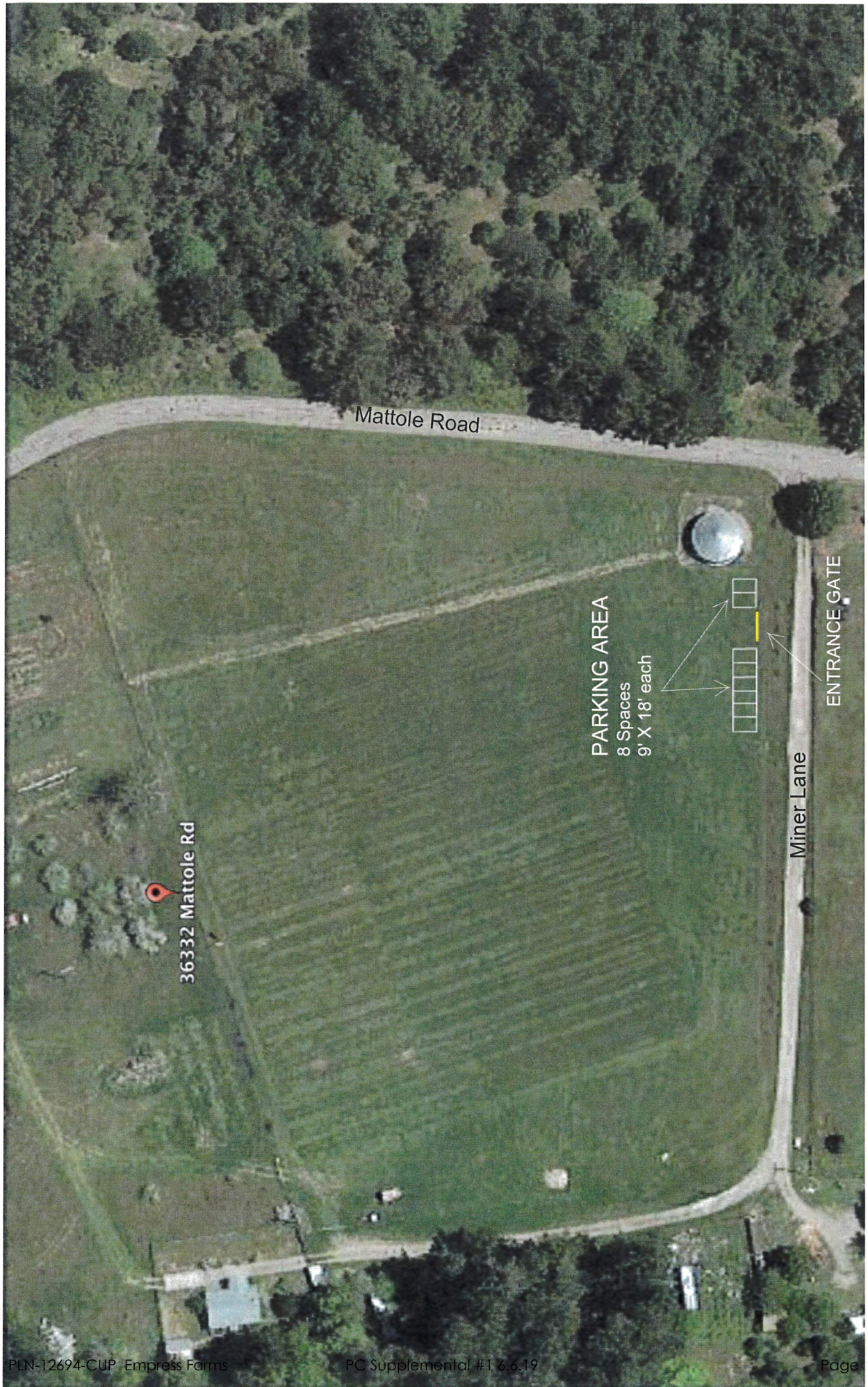

Access to the cultivation site is through 2 gates: one on Miner Lane near Mattole Road and one 0.05 miles down Miner Lane at the perimeter of the cultivation field, as shown on the above map. Parking is just inside the gate, in perpendicular fashion, along the fence-line.

- NOTES
1. SPACING BETWEEN EACH CULTIVATION SECTION/PREMISE 10' TYPICALLY
 2. BEDS 8' WIDE, AISLES 6' WIDE
 3. FENCES OR OTHER DELINEATOR TO BE ERECTED AROUND EACH IDENTIFIED 10,000 SQFT SECTION/PREMISE
 4. APPS# 12699 IS RELOATED RRR AREA FROM 104-143-015
 5. APPS# 12694 IS RELOCATED & CONSOLIATED PRE-EXISTING CULTIVATION
 6. TOTAL CULTIVATION ON PROPERTY/LOT
63,560 SQFT
1.46 ACRES
 7. OFFSITE ACTIVITIES: DRYING/PROCESSING/PACKAGING
 8. NO WATER CROSSINGS ON PARCEL
 9. NO DOMESTIC WATER STORAGE ON PARCEL
 10. NO EXISTING (<E>) STRUCTURES WILL BE ASSOCIATED WITH CANNABIS CULTIVATION, EXCEPT WATER TANK
 11. ALL PROPOSED (<P>) STRUCTURES/FACILITIES SHOWN ARE FOR CANNABIS CULTIVATION

LEGEND
<E> EXISTING
<P> PROPOSED

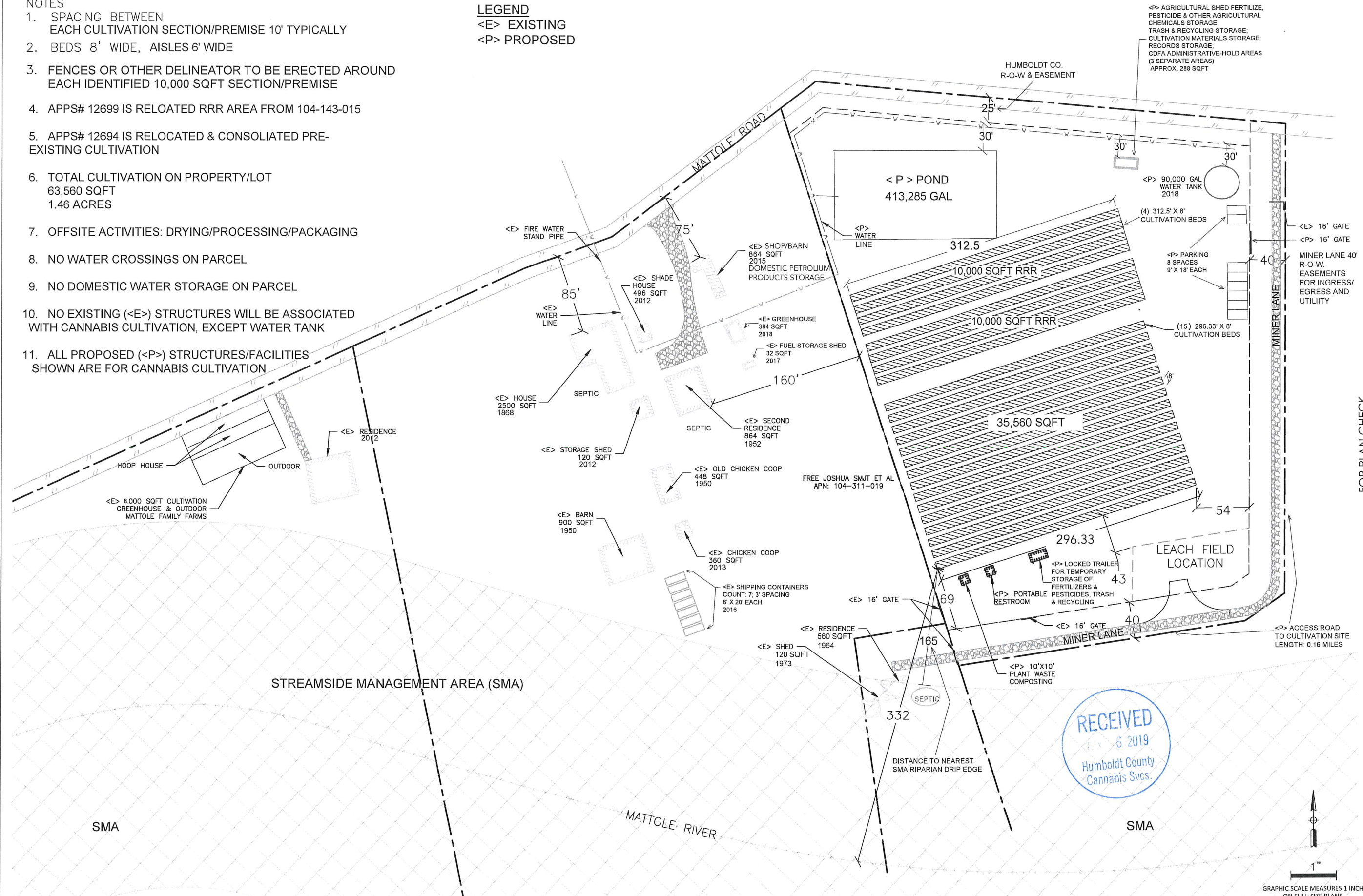

FOR PLAN CHECK

EMPRESS FARMS
WATERFALL RANCH
104-311-019

NO.	HISTORY / REVISION	BY	CHK.	DATE

EMPRESS FARMS - WATERFALL RANCH
104-311-019
SITE PLAN
EMPRESS FARMS
P.O. BOX 7, PETROLIA, CA 95558

DRAWN	ATW
CHECK	JF
APPROVED	KC
DATE	5-24-2018
JOB	EMPR-WR
FIGURE	