

COUNTY OF HUMBOLDT
DEPARTMENT OF PUBLIC WORKS
PROJECT PLANS FOR CONSTRUCTION OF
PEDESTRIAN SAFETY CROSSING PROJECT
PROJECT NUMBER: HSIPL 5904(150)
CONTRACT NO. 216100

PROJECT SITES

MYRTLE AVENUE & PENNSYLVANIA AVENUE (HEALTHSPORT)
HARRISON AVENUE & ROANE AVENUE (RAMONE'S)
HARRIS STREET (REDWOOD ACRES FAIRGROUNDS)

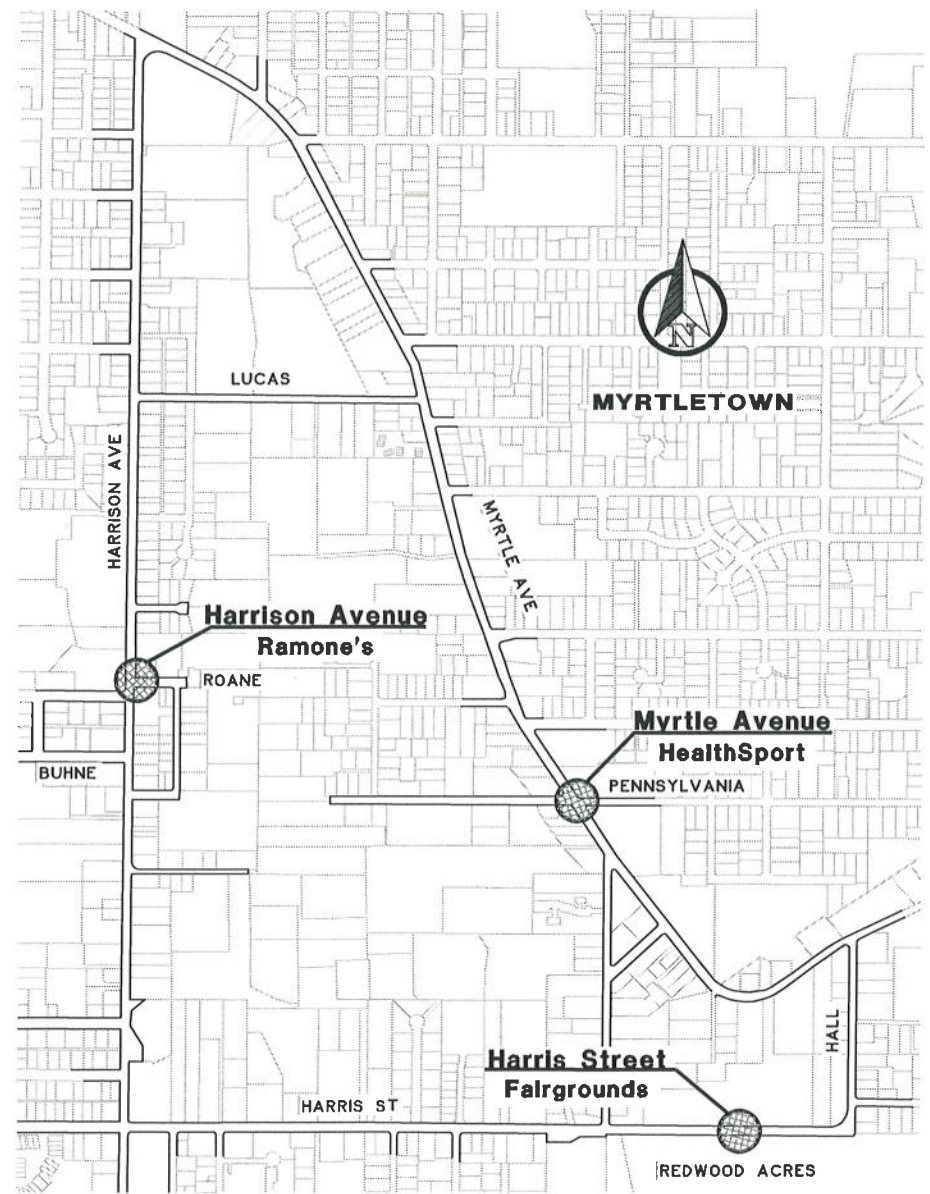

PROJECT VICINITY MAP
NOT TO SCALE



INDEX OF SHEETS

1. COVER SHEET
2. QUANTITIES & TRAFFIC CONTROL
3. TEMPORARY PEDESTRIAN ACCESS ROUTES
4. DETAILS PEDESTRIAN SIGNS
5. MISC. DETAILS: STEEL DRAIN, GUTTER PLATE, MODIFIED CURB & MARKINGS
6. HARRIS STREET LAYOUT SHEET
7. HARRIS STREET CURB RAMP PLAN & ELEVATIONS
8. HARRISON STREET LAYOUT SHEET
9. HARRISON STREET CURB RAMP PLANS & ELEVATIONS
10. MYRTLE AVENUE LAYOUT SHEET
11. MYRTLE AVENUE CURB RAMP PLAN & ELEVATIONS

APPLICABLE REFERENCES

UNIFIED BUILDING CODE
HUMBOLDT COUNTY CODE - TITLE VI CHAPTER 1 SECTION 611-6
HUMBOLDT COUNTY CODE - TITLE VI CHAPTER 2 SECTION 612-2
CAC REFERENCE MANUAL
REFERENCE TO MUTCD 2014 EDITION
REFERENCE TO ASHTO STANDARDS
US ACCESS BOARD MANUAL
PROWAG

NOTES

THE CONTRACTOR SHALL HAVE A CLASS "A" LICENSE
FOR THIS PROJECT.

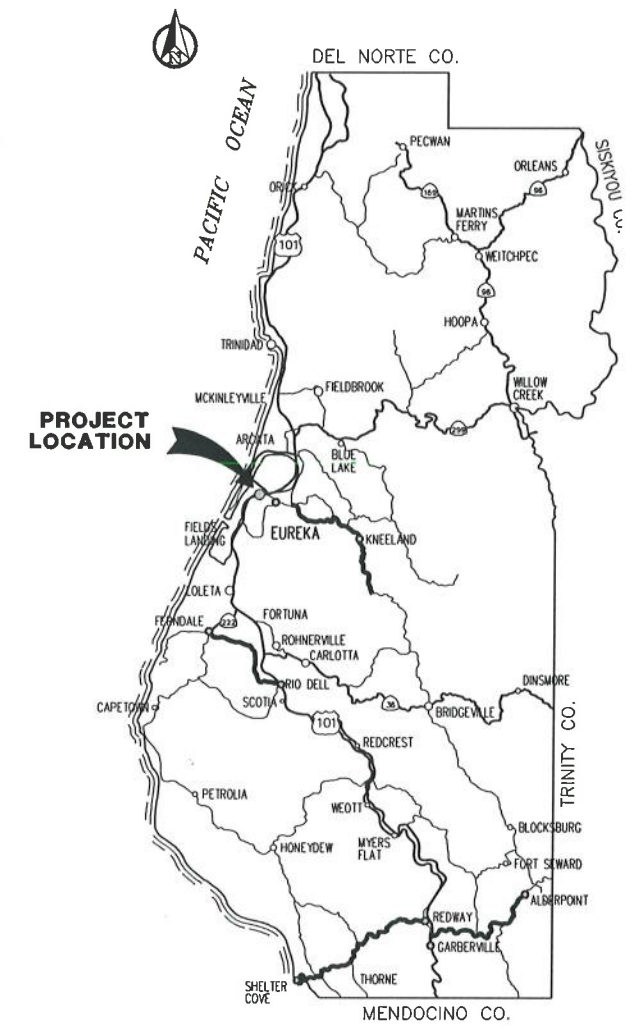

RECOMMENDED

Robert L. Burnett
ROBERT L. BURNETT
RCE 36210, EXP. 6/30/2020
2/6/19
DATE



APPROVED

Tony R. Seghetti
TONY R. SEGHETTI
RCE 63174, EXP. 9/30/2020
2/6/19
DATE



TRAFFIC CONTROL PLAN - TWO LANES

NOT TO SCALE

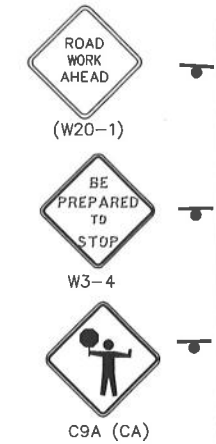

- NOTE:
- TEMPORARY TRAFFIC CONTROL - ONE TRAFFIC LANE OPEN FOR CONSTRUCTION AND TO KEEP TRAFFIC DELAYS TO A MINIMUM.
 - IF THERE ARE SIDE STREETS, TEMPORARY TRAFFIC CONTROL WILL NEED TO APPLY TO THOSE.
 - FOR ADDITIONAL TRAFFIC CONTROL SYSTEM REQUIREMENTS, SEE CALTRANS STD PLANS T9 & T13.

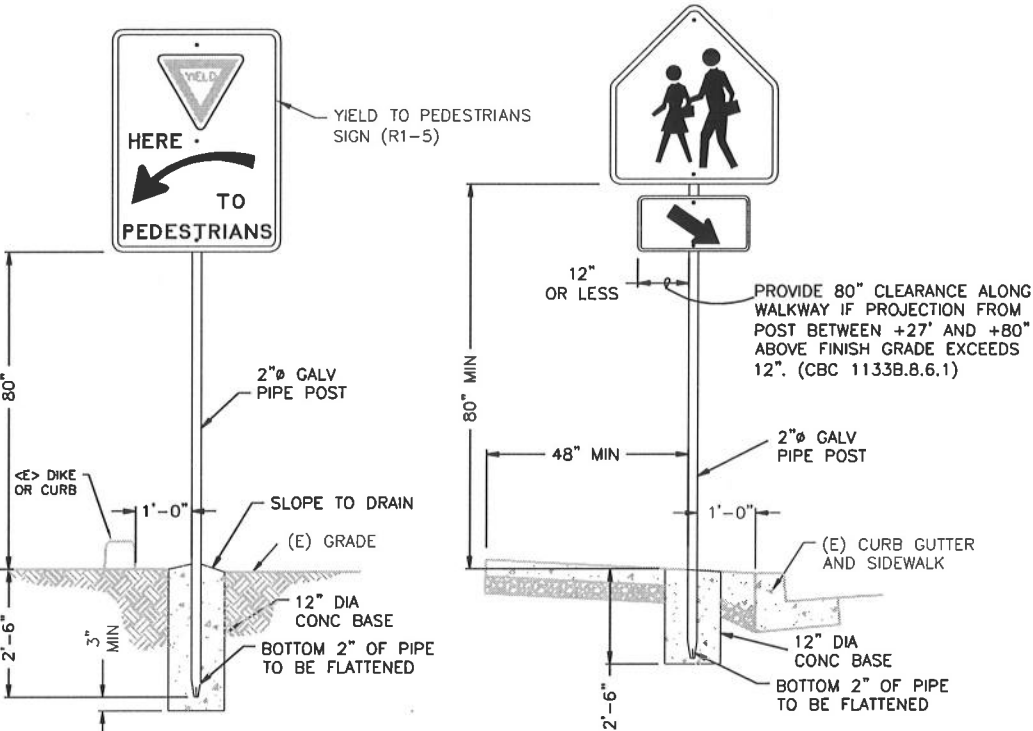
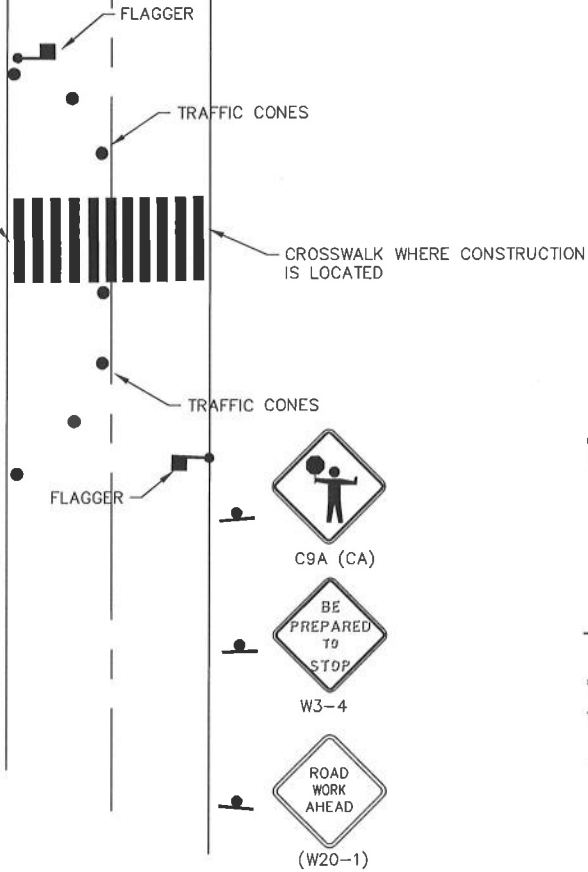

RELOCATE, RESET, OR NEW SIGN DETAIL

N.T.S.

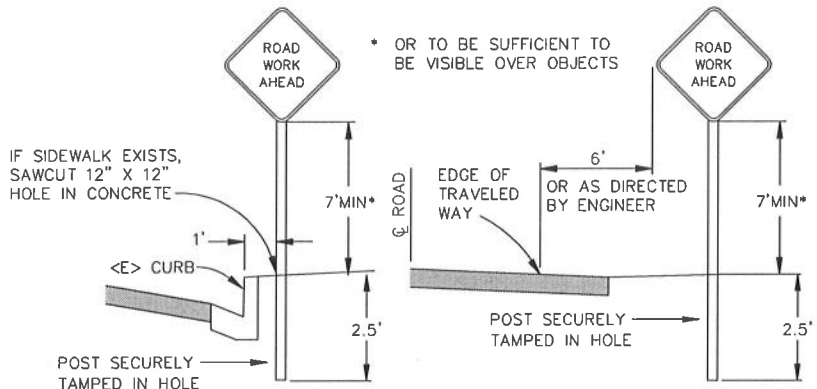

CURB CONDITION UNPAVED SHOULDER

1) PLACE SIGNS BEHIND SIDEWALK, IF POSSIBLE.

URBAN CONSTRUCTION AREA SIGN

- NOT TO SCALE -



ROAD NAME: HARRIS & HARRISON STREET, MYRTLE AVE.	DESIGN SECTION: ROBERT L. BURNETT	COUNTY OF HUMBOLDT	SHEET 2 OF 11
ROAD NO: VARIES	MILE POST: VARIES	DEPARTMENT OF PUBLIC WORKS	
PROJECT NO: HSPL 5904(150)	EA NO: 0118000124	PEDSTRIAN SAFETY PROJECT	
CONTRACT NO: 216100	PPND:	CONSTRUCTION QUANTITIES & TRAFFIC CONTROL	
DRAWING FILE NAME: L:\projects\216100 Ped Crosswalk Improvements\DWG\CD5902 DITS TC.dwg	DESIGNED BY: RLB		
PLOT DATE: 2/5/2019	REVIEWED BY: JAB		
	APPROVED BY: TRS		

QUANTITY SUMMARY

ITEM NO.	ITEM CODE	ITEM DESCRIPTION	UNIT	QUANTITY
1	035740	16" X 5" STEEL CHANNEL (0.375" THICK)	LF	26
2	46259	F BAR REINFORCING STEEL	LB	180
3	120100	TRAFFIC CONTROL SYSTEM	LS	1
4	124000	TEMPORARY PEDESTRIAN ACCESS ROUTE	LS	1
5	130100	JOB SITE MANAGEMENT	LS	1
6	130200	PREPARE WATER POLLUTION CONTROL PROGRAM	LS	1
7	130620	TEMPORARY DRAINAGE INLET PROTECTION	EA	1
8	190137	ROADWAY EXCAVATION (CITY STREET)	CY	25
9	260203	CLASS 2 AGGREGATE BASE	CY	25
10	390132	HOT MIX ASPHALT (TYPE A)	TON	9
11	394090	PLACE HOT MIX ASPHALT (MISCELLANEOUS AREA)	SY	52
12	562001	ROADSIDE SIGN (PED SIGN W11-2 & W16-9P W/ METAL POST)	EA	2
13	562001	ROADSIDE SIGN (SOLAR POWERED, S1-1 W/ LED LIGHTS, RRFB, W16-7P & PED PUSH BUTTON W/ ADA PLAQUE) - MYRTLE AVE	EA	2
14	562001	ROADSIDE SIGN (SOLAR POWERED, W11-2 W/ LED LIGHTS, RRFB, W16-7P & PED PUSH BUTTON W/ ADA PLAQUE)	EA	4
15	730070	DETECTABLE WARNING SURFACE	SF	60
16	731511	MINOR CONCRETE (ISLAND PAVING)	CY	6
17	731519	MINOR CONCRETE (STAMPED CONCRETE)	SF	120
18	731627	MINOR CONCRETE (CURB, SIDEWALK AND CURB RAMP)	CY	13
19	731760	REMOVE CONCRETE CURB AND SIDEWALK	SY	70
20	750001	F MISCELLANEOUS IRON AND STEEL (MYRTLE AVE. CROSS DRAIN)	LB	160
21	810230	PAVEMENT MARKER (RETROREFLECTIVE)	EA	14
22	820250	REMOVE ROADSIDE SIGN	EA	3
23	820610	RELOCATE ROADSIDE SIGN	EA	1
24	840502	THERMOPLASTIC TRAFFIC STRIPE, 4" (ENHANCED WET NIGHT VISIBILITY)	LF	50
25	840516	THERMOPLASTIC PAVEMENT MARKING (ENHANCED WET NIGHT VISIBILITY)	SF	500
26	846030	REMOVE THERMOPLASTIC TRAFFIC STRIPE	LF	15
27	846035	REMOVE THERMOPLASTIC PAVEMENT MARKING	SF	620
28	999990	MOBILIZATION	LS	1

CONSTRUCTION AREA SIGN SUMMARY

SIGN TYPE	QTY	DESCRIPTION	SIZE	REMARKS	POST SIZE
W20-1	2	ROAD WORK AHEAD	36" x 36"	COVERED WHEN NOT IN USE	4" x 4"
C9A (CA)	2	FLAGMAN SYMBOL	36" x 36"	COVERED WHEN NOT IN USE	4" x 4"
W3-4	2	BE PREPARED TO STOP	36" x 36"	COVERED WHEN NOT IN USE	4" x 4"
G20-2	2	END ROAD WORK	36" x 18"	COVERED WHEN NOT IN USE	4" x 4"

27/2/2019



BAR IS ONE INCH ON ORIGINAL DRAWING IF NOT ONE INCH ON THIS SHEET, ADJUST SCALES ACCORDINGLY	ROAD NAME: HARRIS & HARRISON STREET, MYRTLE AVE.		DESIGN SECTION	COUNTY OF HUMBOLDT DEPARTMENT OF PUBLIC WORKS		SHEET 3 OF 11
	ROAD NO: VARIES	MILE POST: VARIES	ROBERT L. BURNETT			
	PROJECT NO.: HSPL 5904(150)	EA NO.: 01161000124	DESIGNED BY: RLB			
	CONTRACT NO.: 215100	PPND:	DRAWN BY: RLB			
	DRAWING FILE NAME: L:\projects\215100 Ped Crosswalk Improvements\DWG\CSM02 01YS.TC.dwg		REVIEWED BY: JAB	TEMPORARY PEDESTRIAN ACCESS ROUTES		
	PLOT DATE: 2/5/2019	REVISION DATE:	APPROVED BY: TRS			

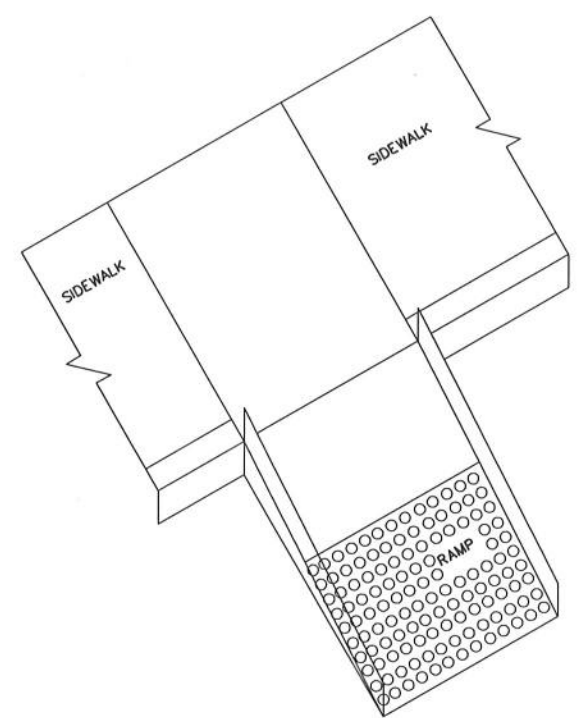

TEMP. PED. ACCESS ROUTE CURB RAMP
(OPTION A: REVISED STD PLAN RSP T34)
NOT TO SCALE

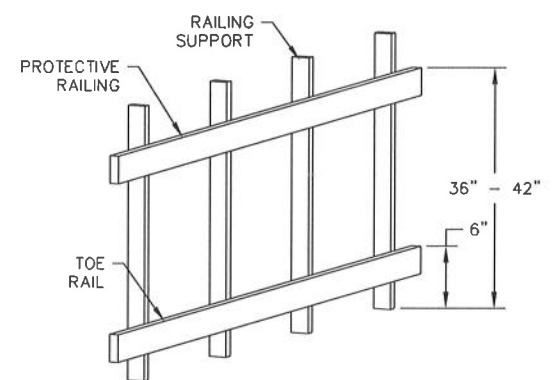

TEMP. PED. ACCESS ROUTE BARRIER
(ISOMETRIC VIEW SHOWING TOE & PROTECTIVE HEIGHTS)
NOT TO SCALE

NOTES FROM CALTRANS REVISED STD PLAN RSP T31

- ONLY SIGNS RELATED TO PEDESTRIANS ARE SHOWN. FOR ALL OTHER SIGNS SEE APPROPRIATE T-SHEETS.
- SEPARATE PEDESTRIAN WALKWAY FROM TRAFFIC AND WORK ZONE ACTIVITIES, WHEN TEMPORARY WALKWAY IS ADJACENT TO TRAFFIC.
- THE TEMPORARY PEDESTRIAN ACCESS ROUTE MUST NOT LEAD INTO CONFLICT WITH VEHICLES OR WORK.
- ADVANCE WARNING SIGN IS NOT REQUIRED IF THE WORK AREA IS WITHIN THE LIMITS OF A LARGER WORK ZONE. SIGN SHALL BE EQUIPPED WITH AT LEAST TWO FLAGS FOR DAYTIME CLOSURE. EACH FLAG SHALL BE ORANGE OR FLUORESCENT RED-ORANGE IN COLOR.
- ALL DEVICES USED TO CHANNELIZE PEDESTRIAN FLOW MUST CONNECT SUCH THAT GAPS DO NOT ALLOW PEDESTRIANS TO STRAY FROM THE CHANNELIZED PATH.
- BARRICADES CLOSING SIDEWALK SHALL COVER THE FULL WIDTH OF THE SIDEWALK.
- SEPARATE THE TEMPORARY PEDESTRIAN ACCESS ROUTE FROM TRAFFIC USING A TEMPORARY BARRIER AND A CRASH CUSHION IF NECESSARY.
- WHEN IT IS NOT POSSIBLE TO MAINTAIN A MINIMUM OF 60 INCHES THROUGHOUT THE LENGTH OF THE PEDESTRIAN ROUTE, MAINTAIN A MINIMUM WIDTH OF 48 INCHES AND PROVIDE A 60 X 60-INCH PASSING SPACE AT LEAST EVERY 200 FEET.
- SEE REVISED STANDARD PLAN RSP A88A FOR DETECTABLE WARNING SURFACE FOR CURB RAMPS TO APPLY TO TEMPORARY CURB RAMPS.
- SEE REVISED STANDARD PLAN RSP T34 FOR TEMPORARY CURB RAMP OPTIONS.

BARRICADE SPECIFICATIONS (US ACCESS BOARD):

- THE CONSTRUCTION BARRICADE AT THE ALTERNATE CIRCULATION PATH SHALL BE CONTINUOUS, STABLE AND NON-FLEXIBLE.
- IT SHALL HAVE A SOLID TOE RAIL WITH ITS TOP EDGE AT 6" MINIMUM IN HEIGHT AND ITS BOTTOM EDGE NO HIGHER THAN 1-1/2" ABOVE THE ADJACENT SURFACE.
- IT SHALL HAVE A CONTINUOUS RAILING MOUNTED AT A TOP HEIGHT OF 36" TO 42" WITH DIAGONAL STRIPES HAVING AT LEAST 70 PERCENT CONTRAST.
- THE TOP RAIL SHALL BE PARALLEL TO THE TOE RAIL AND BE SITUATED TO ALLOW PEDESTRIANS TO USE THE RAIL AS A GUIDE FOR THEIR HAND(S) FOR WAYFINDING PURPOSES.
- NO BARRICADE SUPPORT MEMBER SHALL PROTRUDE MORE THAN 4" BEYOND THE TOE RAIL INTO THE ALTERNATE CIRCULATION PATH.

NOTE:

- THE CONTRACTOR SHALL COORDINATE WITH THE ENGINEER FOR PEDESTRIAN TRAFFIC AROUND WORK AREAS IN SIDEWALKS.
- PER MUTCD 2014, CHAPTER 6D. PEDESTRIAN AND WORKER SAFETY:

ADEQUATE PEDESTRIAN ACCESS AND WALKWAYS SHALL BE PROVIDED. IF THE TEMPORARY TRAFFIC CONTROL (TTC) ZONE AFFECTS AN ACCESSIBLE AND DETECTABLE PEDESTRIAN FACILITY, THE ACCESSIBILITY AND DETECTABILITY SHALL BE MAINTAINED ALONG THE ALTERNATE PEDESTRIAN ROUTE.

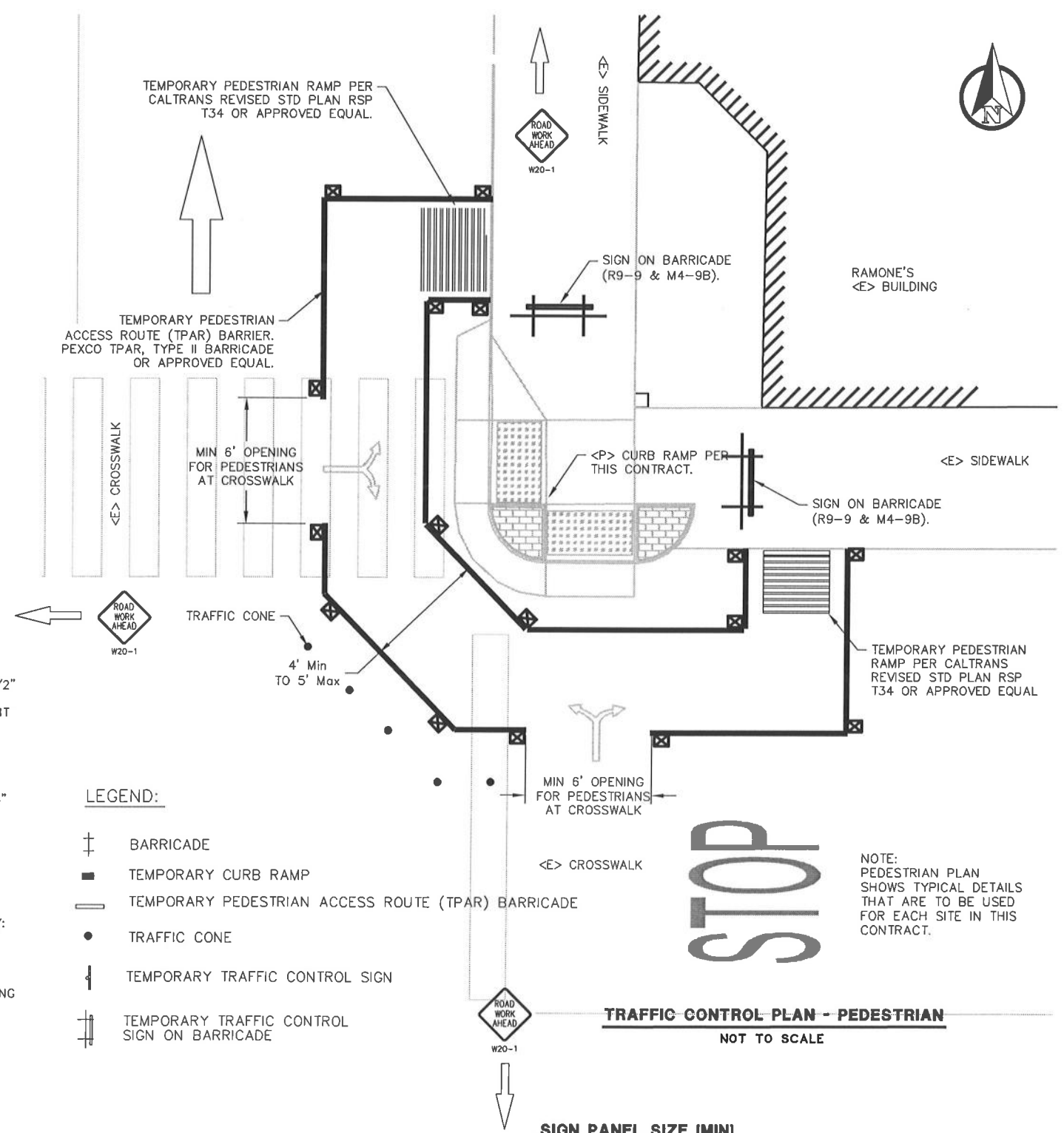
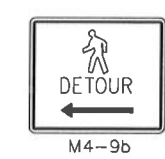

LEGEND:

- BARRICADE
- TEMPORARY CURB RAMP
- TEMPORARY PEDESTRIAN ACCESS ROUTE (TPAR) BARRICADE
- TRAFFIC CONE
- TEMPORARY TRAFFIC CONTROL SIGN
- TEMPORARY TRAFFIC CONTROL SIGN ON BARRICADE

TRAFFIC CONTROL PLAN - PEDESTRIAN
NOT TO SCALE

SIGN PANEL SIZE (MIN)

SIGN TYPE	QTY	DESCRIPTION	SIGN SIZE	REMARKS
M4-9b	2	PEDESTRIAN DETOUR	30" x 24"	MOUNTED ON PED BARRICADE
R9-9	2	SIDEWALK CLOSED	24" x 12"	MOUNTED ON PED BARRICADE
W20-1	3	ROAD WORK AHEAD	36" x 36"	SEE NOTE #4 THIS SHEET



<div>BAR IS ONE INCH ON ORIGINAL DRAWING</div> <div>IT NOT ONE INCH ON THIS SHEET, ADJUST SCALES ACCORDINGLY</div>	ROAD NAME: HARRIS & HARRISON STREET, MYRTLE AVE.		DESIGN SECTION		<div>COUNTY OF HUMBOLDT</div> <div>DEPARTMENT OF PUBLIC WORKS</div> <div>PEDSTRIAN SAFETY PROJECT</div> <div>DETAILS LED SIGNS</div>	<div>SHEET</div> <div>4</div> <div>OF</div> <div>11</div>
	ROAD NO: VARIES	MILE POST: VARIES	ROBERT L. BURNETT			
	PROJECT NO: HSIPL 5904(150)	EA NO: 0116000124	DESIGNED BY: RLB			
	CONTRACT NO: 216100	PPNO:	DRAWN BY: RLB			
	DRAWING FILE NAME:		REVIEWED BY: JAB			
	PLOT DATE: 2/5/2019	REVISION DATE:	APPROVED BY: TRS			

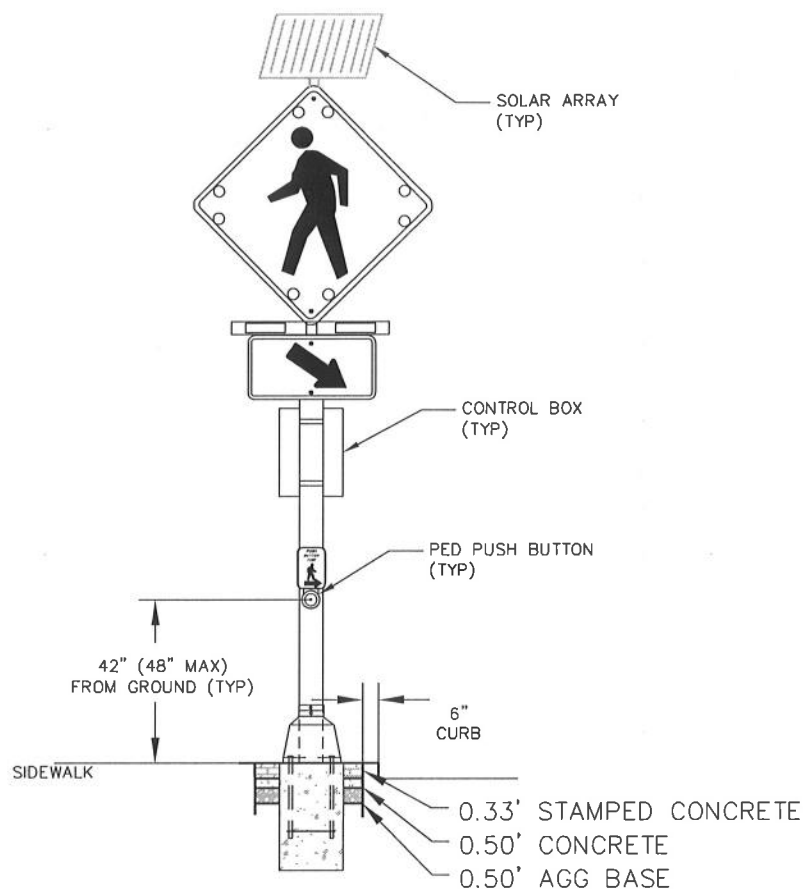

SIGN IN STAMPED CONCRETE

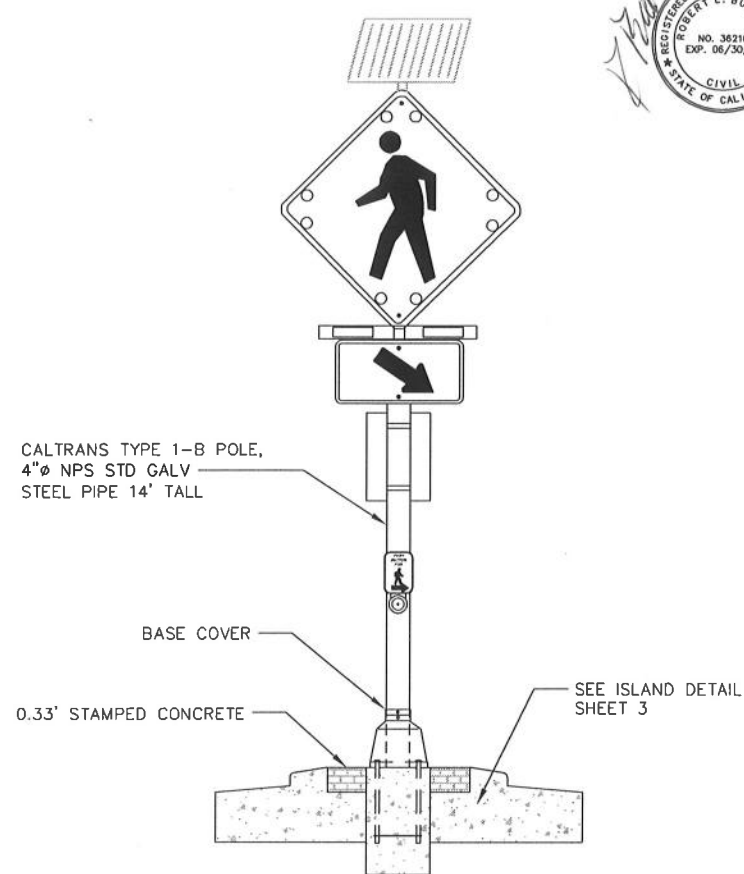

SIGN IN ISLAND

*NOTE:
FLASHING LED SIGN SYSTEM WILL PROVIDE SOLAR POWER FOR TEN (10) DAYS OF AUTONOMY AT 300 ACTUATIONS PER DAY. SYSTEM SHALL INCLUDE ADA COMPLIANT, WIRELESS, PUSHBUTTON ACTIVATION. FLASHING LED PEDESTRIAN SIGNS TO COMPLY WITH ALL APPLICABLE FHWA, MUTCD STANDARDS AND GUIDELINES. BID ITEM COST FOR FLASHING LED SIGNS INCLUDES STRUCTURE EXCAVATION AND CONCRETE FOR SIGN FOUNDATION.

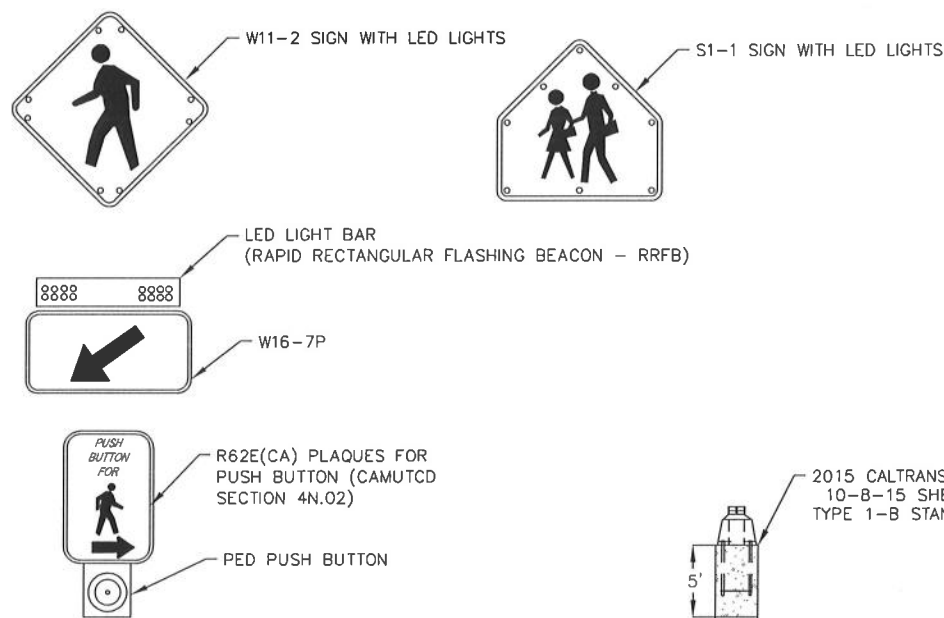

TYPICAL PED CROSSING SIGNAGE

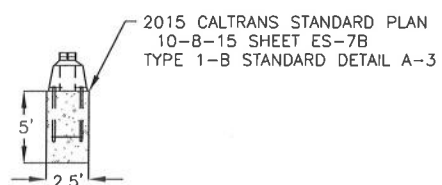

POST BASE (TYP)

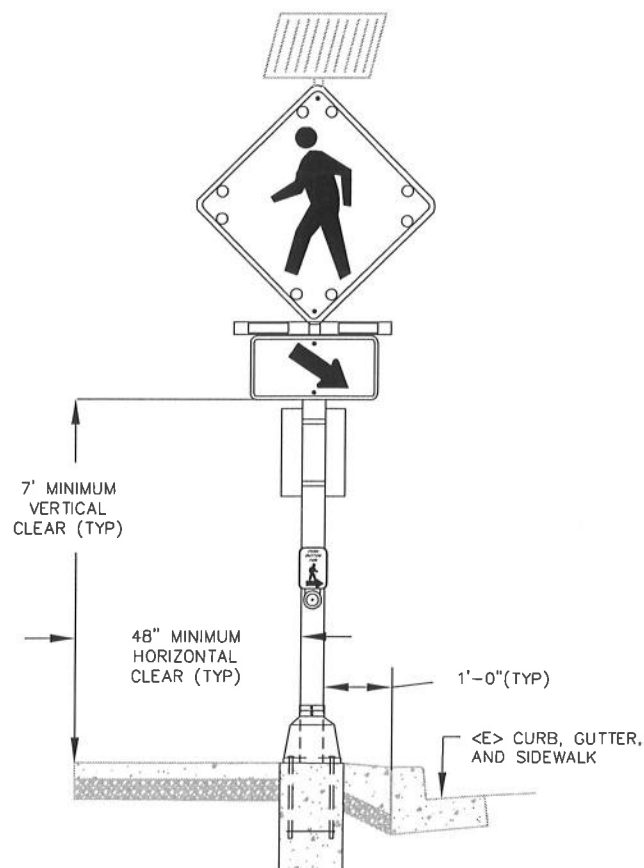

SIGN IN SIDEWALK

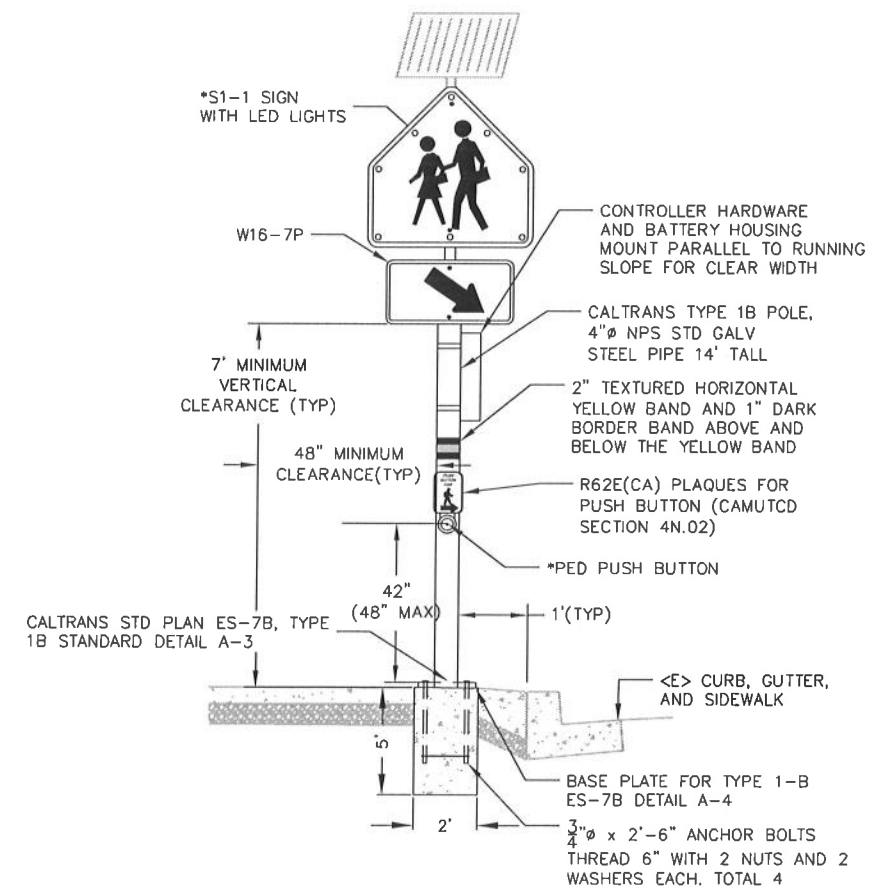

FLASHING LED SIGN DETAIL

NOT TO SCALE



**FAIRGROUND
PARKING**

- NOTE:
- 1) ELEVATION AND GRADES SHOWN ARE FOR DESIGN PURPOSES ONLY. ACTUAL ELEVATIONS AND GRADES TO BE FIELD VERIFIED AND SHALL MEET CURRENT ADA REQUIREMENTS.
 - 2) DESIGN BASED ON CROSS SLOPE OF 1.25% (WHERE 1.5% REQUIRED).
 - 3) CONTRACTOR SHALL MAINTAIN ACCESS TO ADJACENT BUSINESS (REDWOOD ACRES) AS APPROVED BY ENGINEER.
 - 4) TEMPORARY PEDESTRIAN ACCESS THROUGH SITE SHALL BE PROVIDED AND SHALL MEET ADA REQUIREMENTS.



BAR IS ONE INCH ON
ORIGINAL DRAWING

IF NOT ONE INCH ON
THIS SHEET, ADJUST
SCALES ACCORDINGLY

ROAD NAME: HARRIS & HARRISON STREET, MYRTLE AVE.	DESIGN SECTION: ROBERT L. BURNETT
ROAD NO: VARIES	MILE POST: VARIES
PROJECT NO: HSPL 5904(150)	EA NO: 0116000124
CONTRACT NO: 218100	PPNO:
DRAWING FILE NAME:	REVIEWED BY: JAB
PLOT DATE: 2/5/2019	APPROVED BY: TRS
REVISION DATE:	

**COUNTY OF HUMBOLDT
DEPARTMENT OF PUBLIC WORKS**

PEDSTRIAN SAFETY PROJECT

**HARRIS STREET (REDWOOD ACRES)
CURB RAMP LAYOUT**

SHEET
6
OF
11

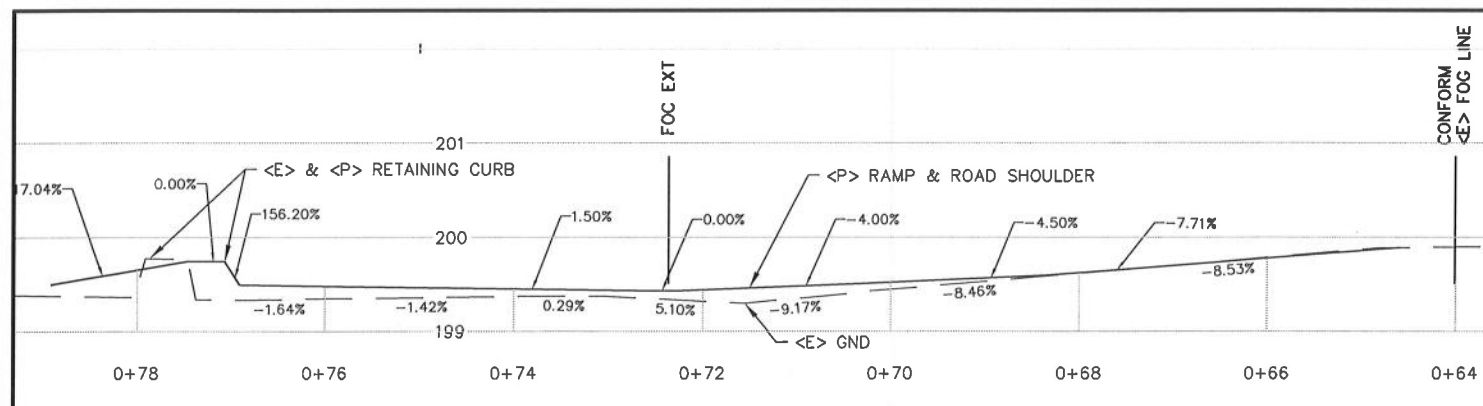
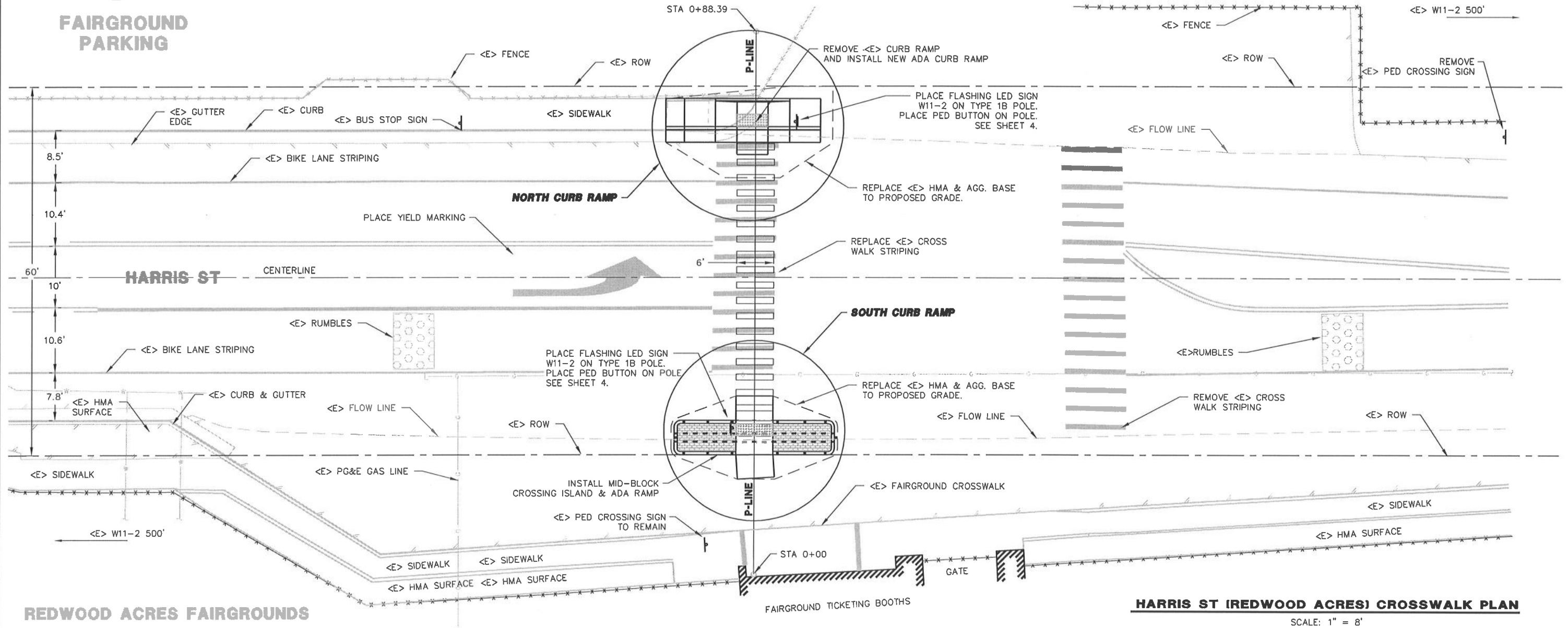

NORTH CURB RAMP PROFILE

SCALE: 1" = 1' HOR & VERT

NOTE: FOC (FACE OF CURB)

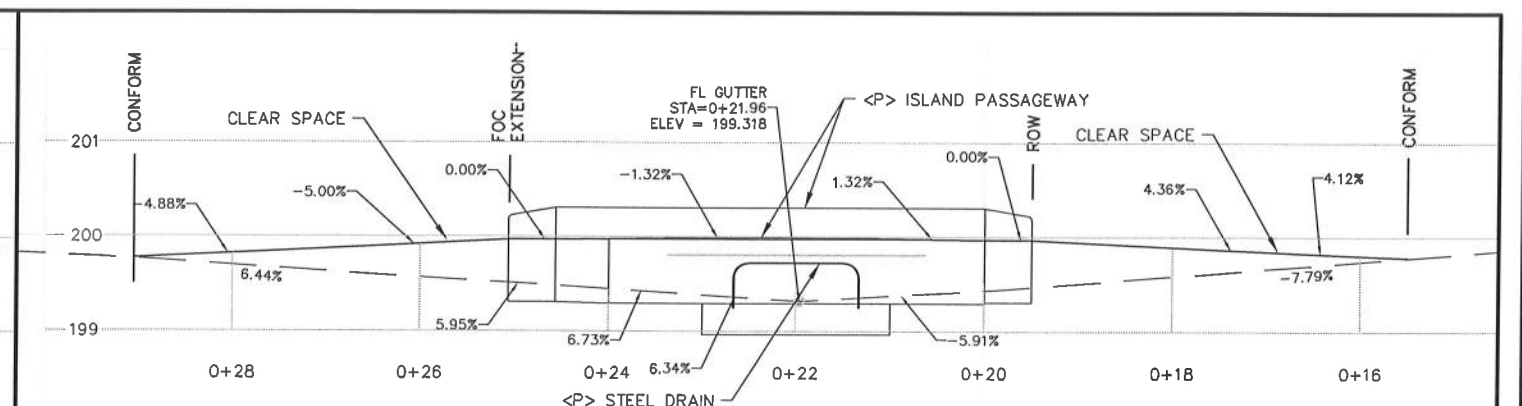

SOUTH CURB RAMP PROFILE

SCALE: 1" = 1' HOR & VERT

BAR IS ONE INCH ON
ORIGINAL DRAWING

IF NOT ONE INCH ON
THIS SHEET, ADJUST
SCALES ACCORDINGLY

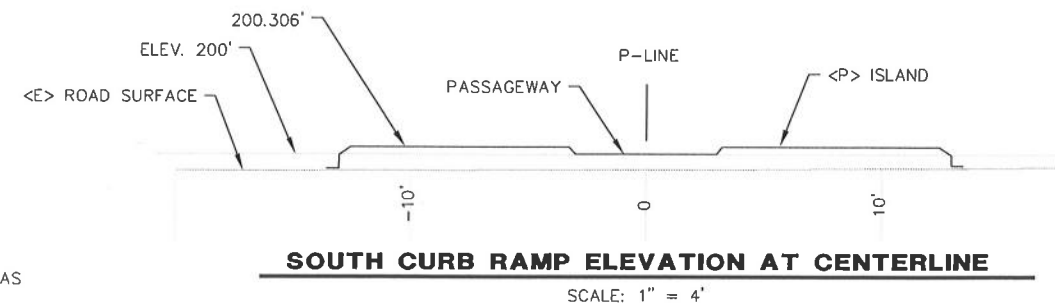

- NOTE:
- 1) ELEVATION AND GRADES SHOWN ARE FOR DESIGN PURPOSES ONLY. ACTUAL ELEVATIONS AND GRADES TO BE FIELD VERIFIED AND SHALL MEET CURRENT ADA REQUIREMENTS.
 - 2) DESIGN BASED ON CROSS SLOPE OF 1.25% (WHERE 1.5% REQUIRED).
 - 3) CONTRACTOR SHALL MAINTAIN ACCESS TO ADJACENT BUSINESS (REDWOOD ACRES) AS APPROVED BY ENGINEER.
 - 4) TEMPORARY PEDESTRIAN ACCESS THROUGH SITE SHALL BE PROVIDED AND SHALL MEET ADA REQUIREMENTS.

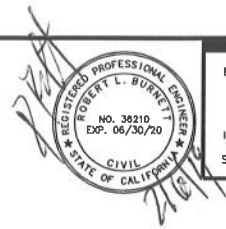

BAR IS ONE INCH ON
ORIGINAL DRAWING

IF NOT ONE INCH ON
THIS SHEET, ADJUST
SCALES ACCORDINGLY

ROAD NAME: HARRIS & HARRISON STREET, MYRTLE AVE.	DESIGN SECTION ROBERT L. BURNETT
ROAD NO: VARIES	MILE POST: VARIES
PROJECT NO.: HSIPL 5904(150)	EA NO.: 0116000124
CONTRACT NO.: 216100	PPNO:
DRAWING FILE NAME:	DRAWN BY: RLB
PLOT DATE: 2/5/2019	REVIEWED BY: JAB
REVISION DATE:	APPROVED BY: TRS

COUNTY OF HUMBOLDT
DEPARTMENT OF PUBLIC WORKS
PEDSTRIAN SAFETY PROJECT
**HARRISON AVENUE (RAMONE'S)
CURB RAMP LAYOUT**

SHEET
8
OF
11

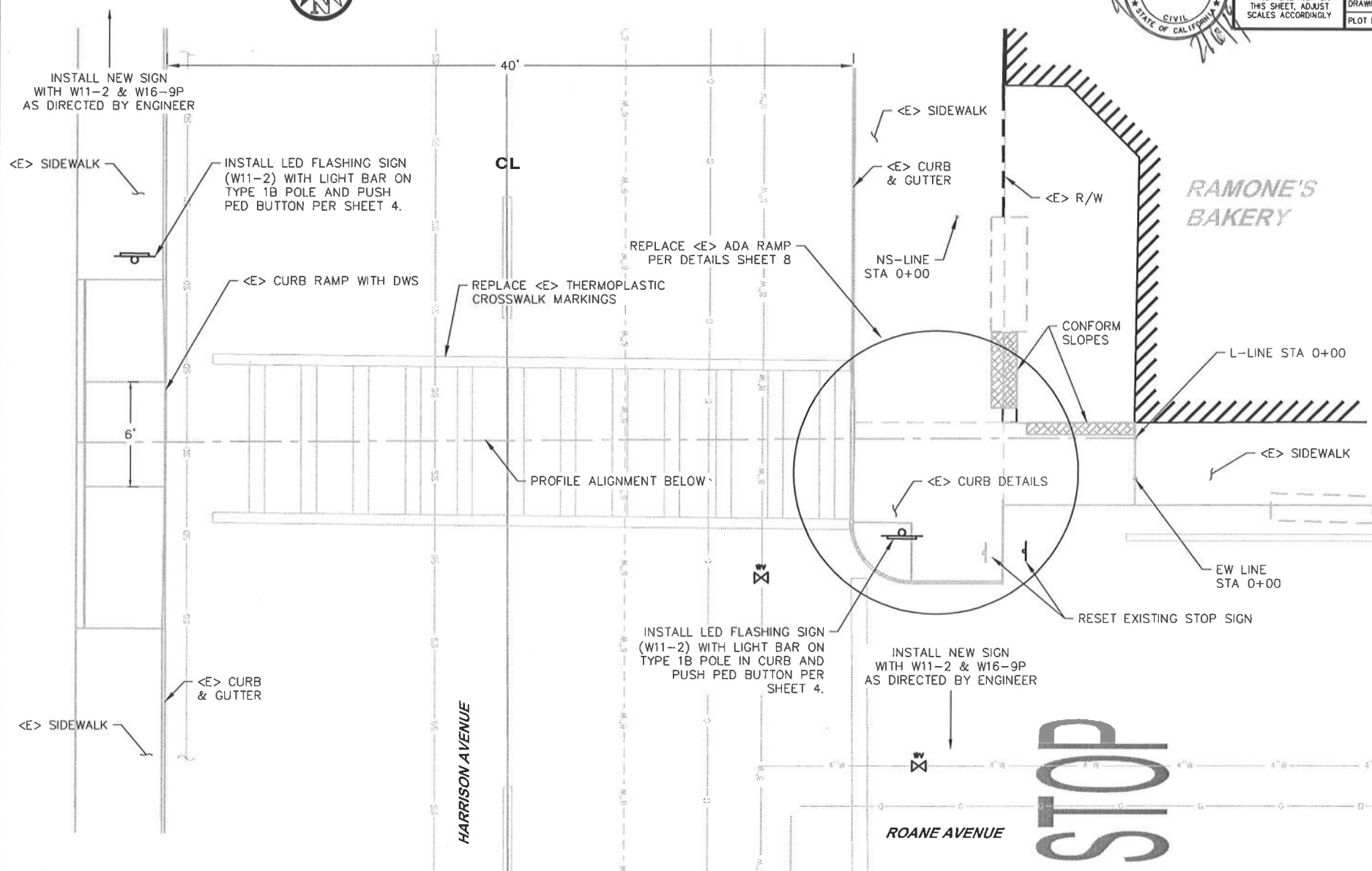

HARRISON AND ROANE AVE. CROSSING

SCALE: 1" = 4'

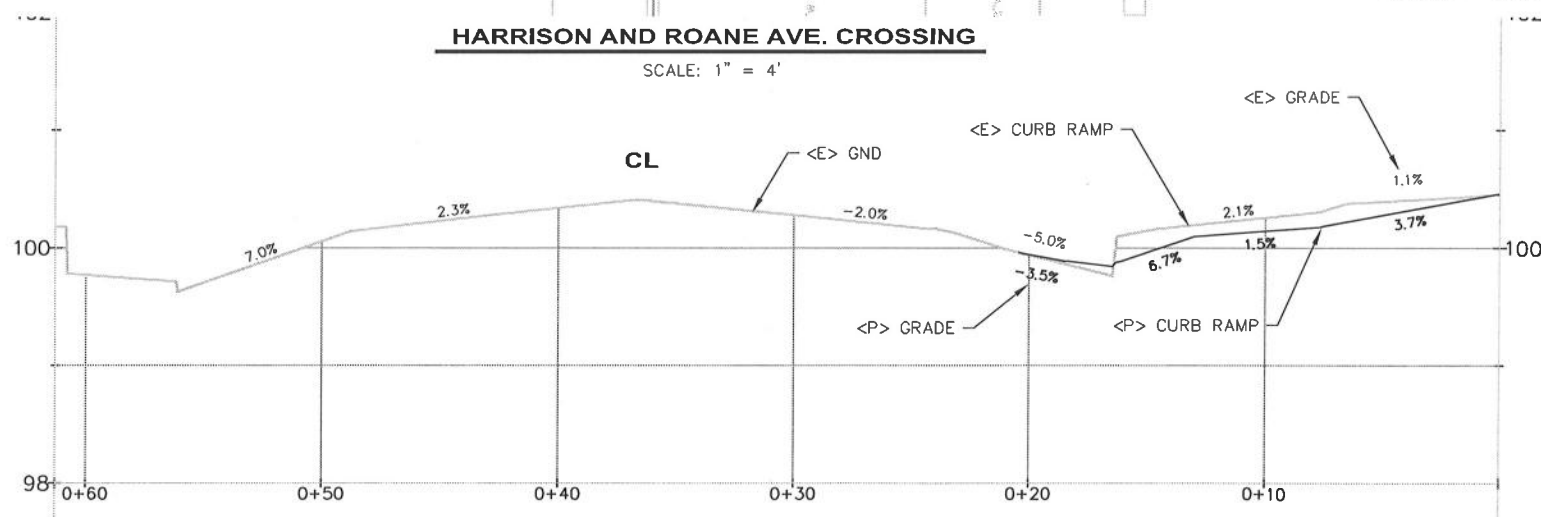

HARRISON AVE. L-LINE PROFILE

SCALE: 1" = 4' HORIZONTAL; 1" = 20' VERTICAL

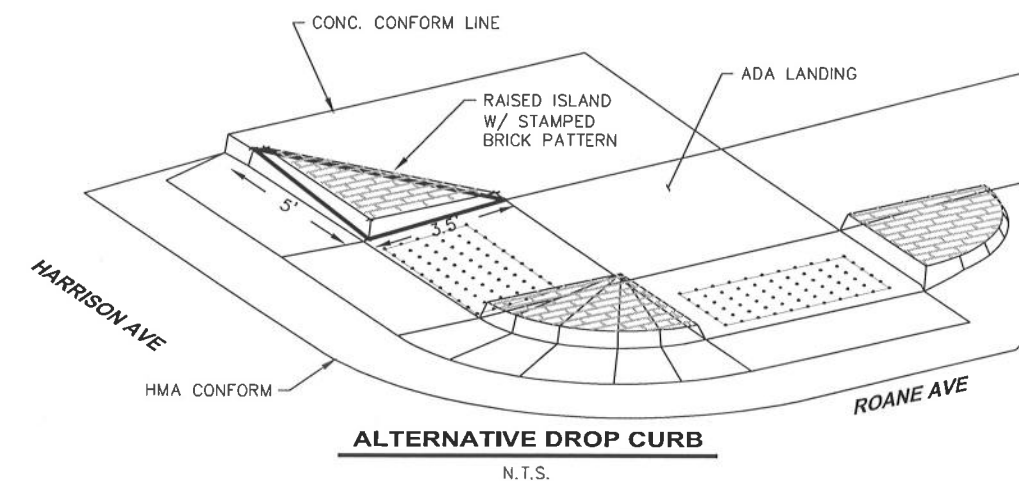

ALTERNATIVE DROP CURB

N.T.S.

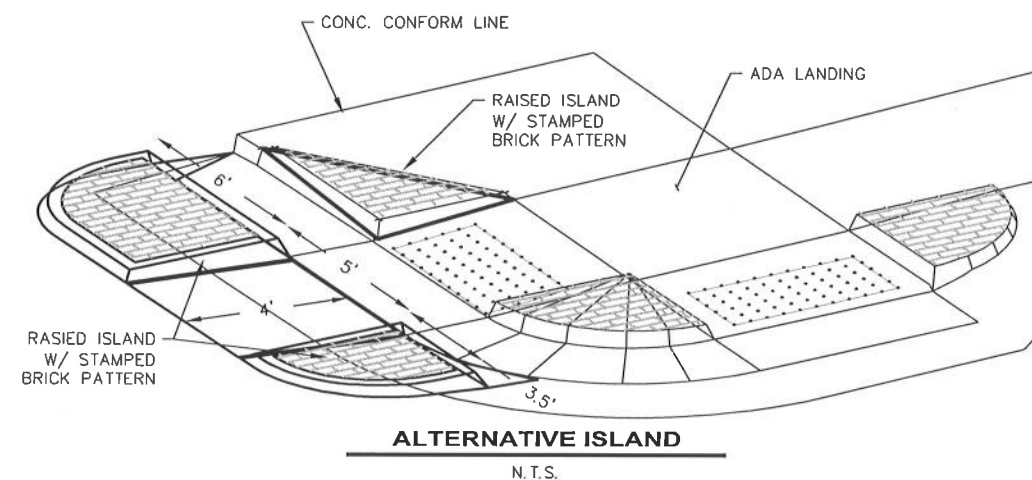

ALTERNATIVE ISLAND

N.T.S.

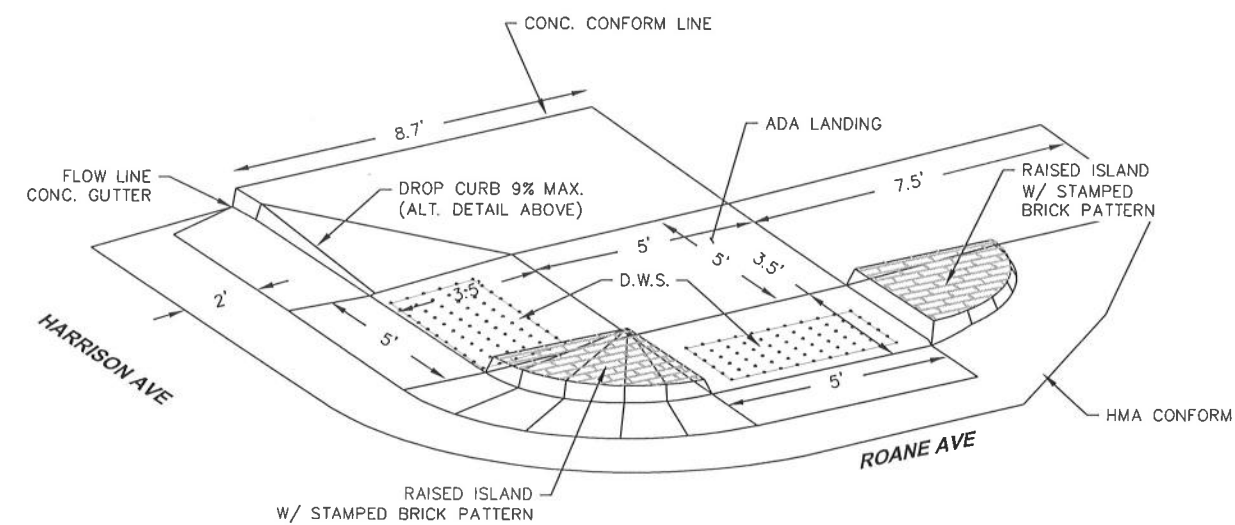

PERSPECTIVE VIEW: PROPOSE CURB RAMP

N.T.S.



BAR IS ONE INCH ON ORIGINAL DRAWING IF NOT ONE INCH ON THIS SHEET, ADJUST SCALES ACCORDINGLY	ROAD NAME: HARRIS & HARRISON STREET, MYRTLE AVE.		DESIGN SECTION	COUNTY OF HUMBOLDT DEPARTMENT OF PUBLIC WORKS PEDSTRIAN SAFETY PROJECT HARRISON AVENUE (RAMONE'S) CURB RAMP PLAN & ELEVATIONS	SHEET 9 OF 11
	ROAD NO: VARIES	MILE POST: VARIES	ROBERT L. BURNETT		
	PROJECT NO.: HSP1 5904(150)	EA NO.: 01150000124	DESIGNED BY: RLB		
	CONTRACT NO.: 216100	PPNO:	DRAWN BY: RLB		
	DRAWING FILE NAME:		REVIEWED BY: JAB		
PLOT DATE: 2/5/2019		REVISION DATE:	APPROVED BY: TRS		

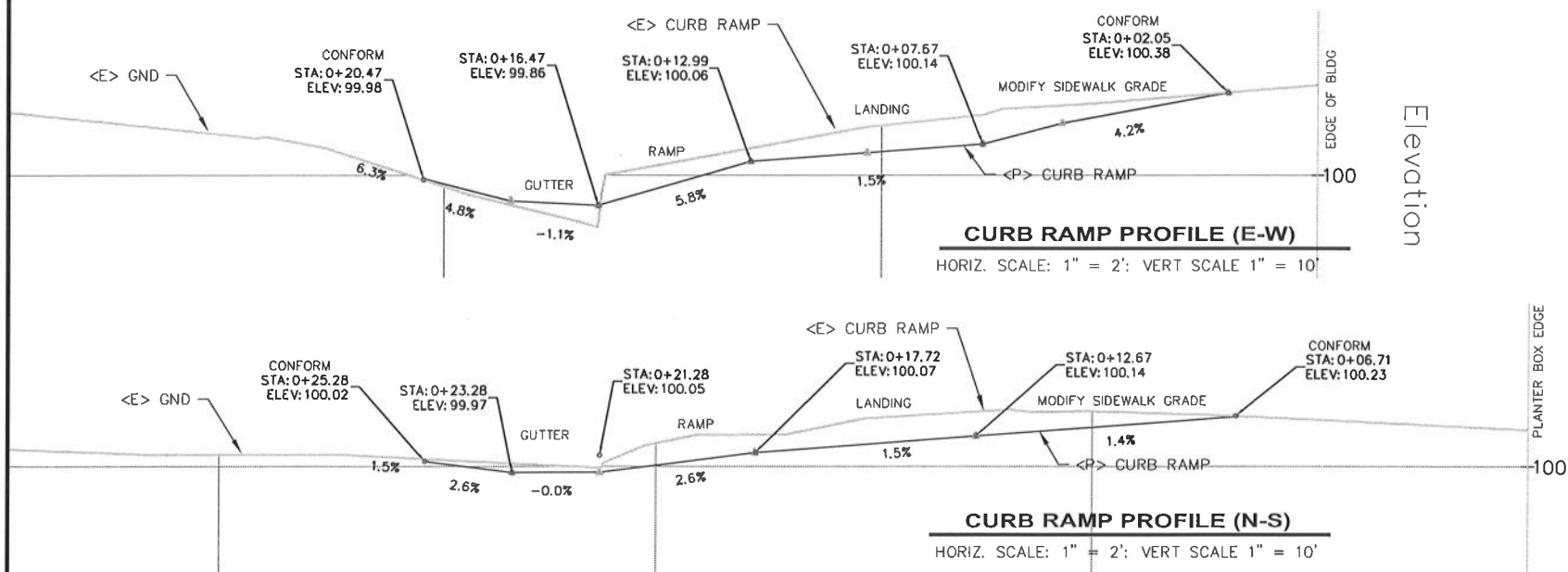
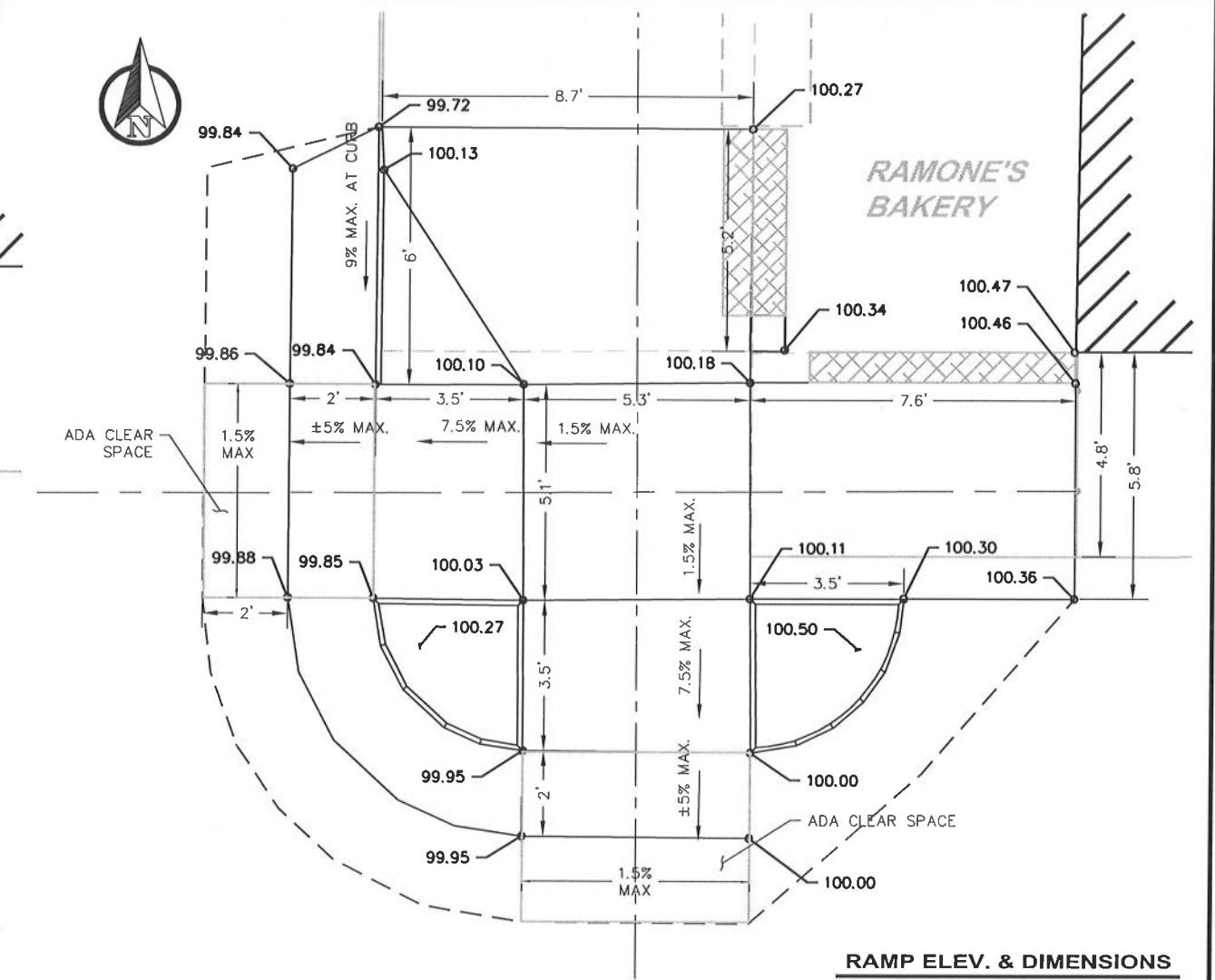

NOTE:

- 1) ELEVATION AND GRADES SHOWN ARE FOR DESIGN PURPOSES ONLY. ACTUAL ELEVATIONS AND GRADES TO BE FIELD VERIFIED AND SHALL MEET CURRENT ADA REQUIREMENTS.
- 2) CONTRACTOR SHALL MAINTAIN ACCESS TO ADJACENT BUSINESS (RAMONE'S BAKERY) AS APPROVED BY ENGINEER.
- 3) TEMPORARY PEDESTRIAN ACCESS THROUGH SITE SHALL BE PROVIDED AND SHALL MEET ADA REQUIREMENTS.



BAR IS ONE INCH ON ORIGINAL DRAWING
IF NOT ONE INCH ON THIS SHEET, ADJUST SCALES ACCORDINGLY

ROAD NAME: HARRIS & HARRISON STREET, MYRTLE AVE.	DESIGN SECTION: ROBERT L. BURNETT
ROAD NO: VARIES	MILE POST: VARIES
PROJECT NO.: HSIPL 5904(150)	EA NO.: 0116000124
CONTRACT NO.: 216100	PPNO:
DRAWING FILE NAME:	DESIGNED BY: RLB
PLOT DATE: 2/5/2019	REVIEWED BY: JAB
REVISION DATE:	APPROVED BY: TRS

COUNTY OF HUMBOLDT DEPARTMENT OF PUBLIC WORKS
PEDSTRIAN SAFETY PROJECT
MYRTLE AVENUE (HEALTHSPORT) CURB RAMP LAYOUT

SHEET
10
OF
11

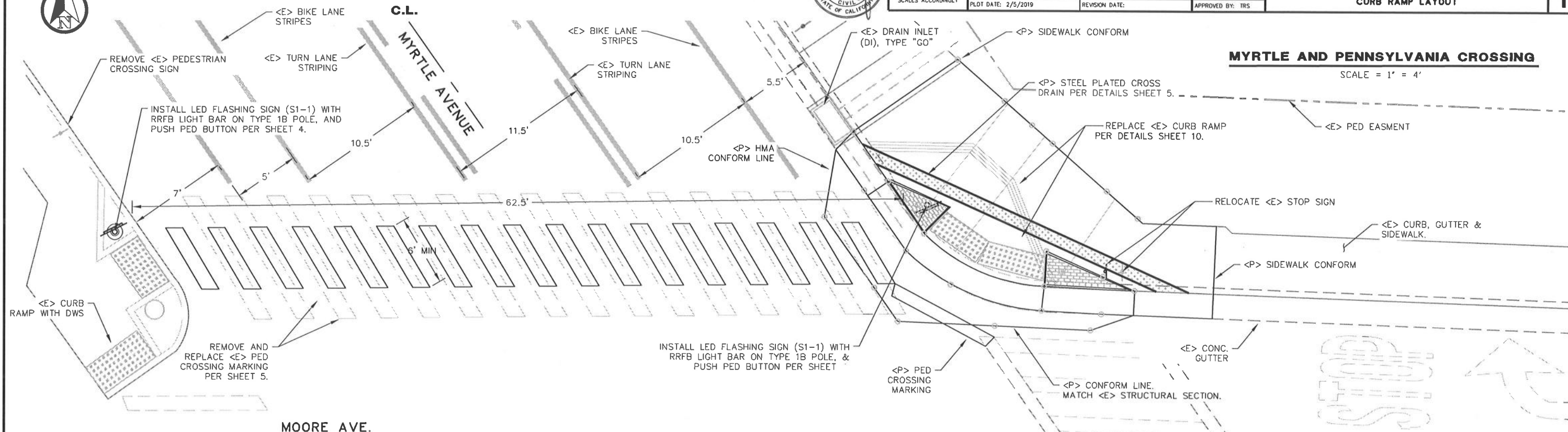

MYRTLE AND PENNSYLVANIA CROSSING

SCALE = 1" = 4'

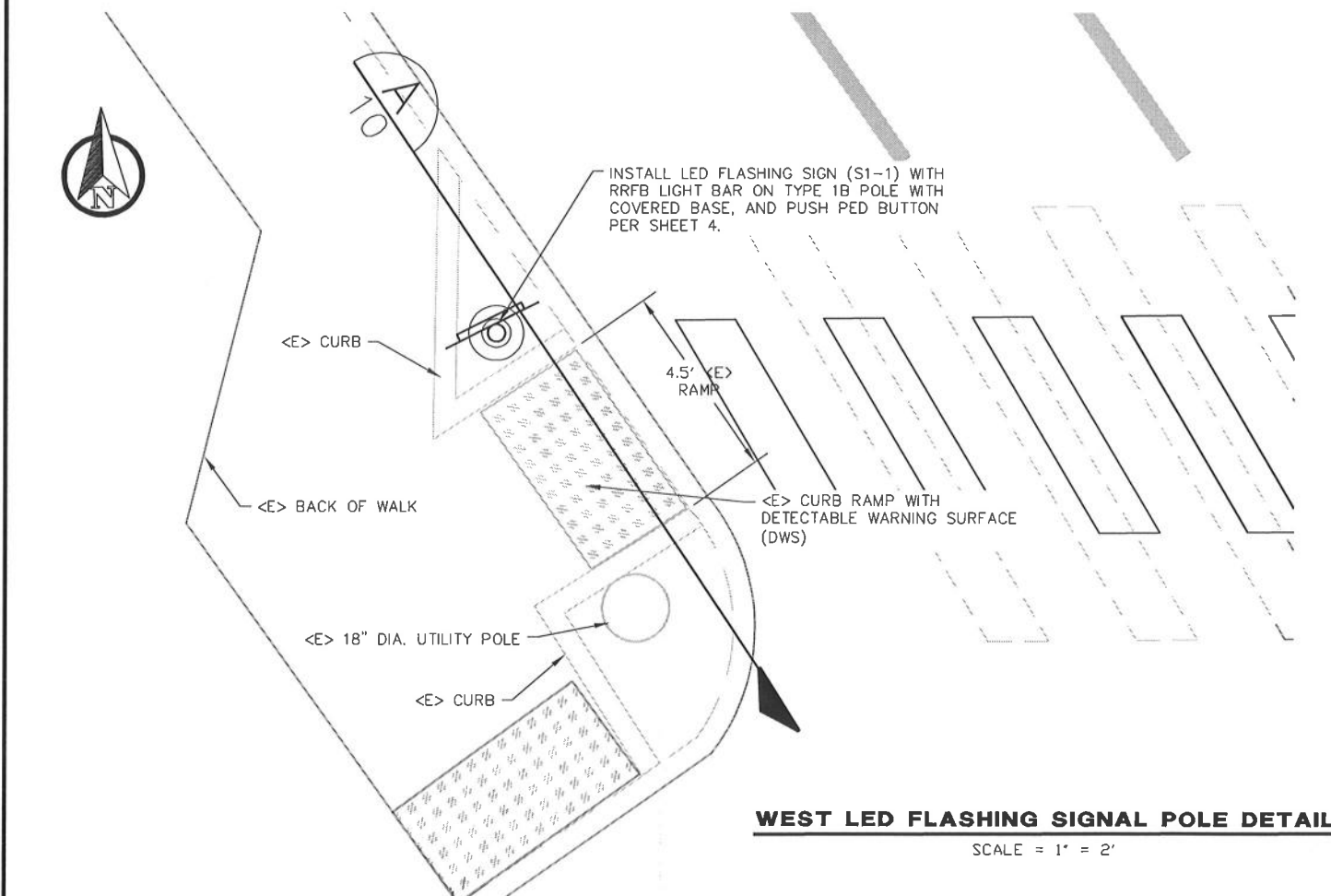

WEST LED FLASHING SIGNAL POLE DETAIL

SCALE = 1" = 2'

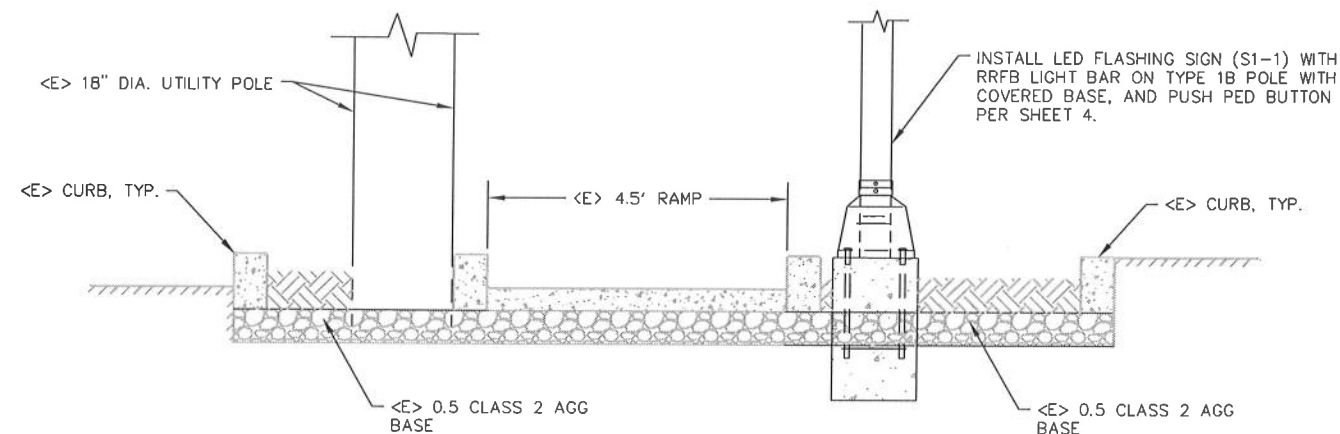

SECTION A

NOT TO SCALE

- NOTE:
- 1) ELEVATION AND GRADES SHOWN ARE FOR DESIGN PURPOSES ONLY. ACTUAL ELEVATIONS AND GRADES TO BE FIELD VERIFIED AND SHALL MEET CURRENT ADA REQUIREMENTS.
 - 2) DESIGN BASED ON CROSS SLOPE OF 1.25% (WHERE 1.5% REQUIRED).
 - 3) CONTRACTOR SHALL MAINTAIN ACCESS TO ADJACENT BUSINESS (HEALTHSPORT) AS APPROVED BY ENGINEER.
 - 4) TEMPORARY PEDESTRIAN ACCESS THROUGH SITE SHALL BE PROVIDED AND SHALL MEET ADA REQUIREMENTS.

