

**BOARD OF SUPERVISORS, COUNTY OF HUMBOLDT, STATE OF CALIFORNIA**

Certified copy of portion of proceedings, Meeting of November 6, 2018

**AMENDING SECTION 311 -7 OF THE HUMBOLDT COUNTY CODE BY REZONING  
PROPERTY IN THE CARLOTTA AREA [ZR-17-002 (VILTRAKIS)]**

**ORDINANCE NO. 2614**

The Board of Supervisors of the County of Humboldt ordains as follows:

SECTION 1, ZONE AMENDMENT. Section 311-7 of the Humboldt County Code is hereby amended by rezoning lands in the Carlotta area, known as a portion of APN 206-081-001, through immediate rezone, out of Timberland Production Zone (TPZ) to Agriculture General with a combining zone specifying a five acre minimum parcel size (AG-B-5(5)).

The area described is also shown on the Humboldt County Zoning Maps [chcpz2] and on the map attached as Exhibit A.

SECTION 2. EFFECTIVE DATE. This ordinance shall become effective thirty (30) days after the date of its passage.

**PASSED, APPROVED AND ADOPTED** this 6<sup>th</sup> day of November, 2018 on the following vote, to wit:

AYES:	Supervisors	Fennell, Bass, Sundberg, Bohn, Wilson
NOES:	Supervisors	--
ABSENT:	Supervisors	--



Ryan Sundberg, Chair  
Board of Supervisors of the County of Humboldt,  
State of California

(SEAL)

ATTEST:

Kathy Hayes, Clerk of the Board of Supervisors  
of the County of Humboldt, State of California

By: 

Ryan Sharp, Deputy

ATTACHMENT B, EXHIBIT A

Map

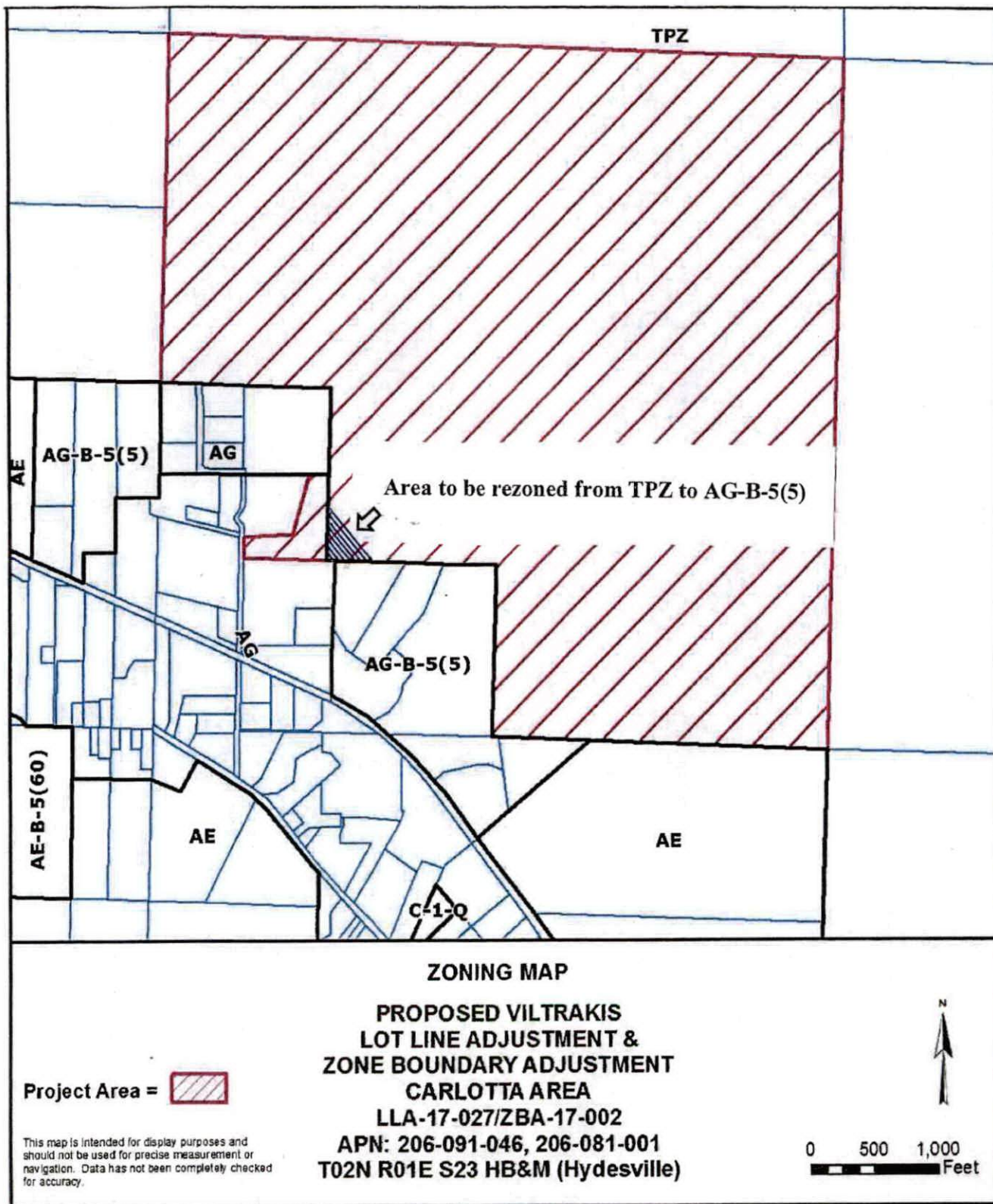

## **ATTACHMENT B, EXHIBIT B**

### **Legal Description**

All that real property situated in the County of Humboldt, State of California, described as follows:

**BEGINNING** at the Southeast corner of Parcel 2 as shown on Book 25 of Parcel Maps, Pages 104-105 Humboldt County Records, said point being monumented by a 1/2" Galvanized Iron Pipe;

**THENCE** North 0 degrees 3 minutes 36 seconds East along the East line of Parcel 2 of said Parcel Map 328.12 feet to a 5/8" Rebar with plastic cap stamped "JOHNSTON PLS 9194";

**THENCE** South 41 degrees 53 minutes 39 seconds East 442.13 feet more or less to a point on the North line of Book 6 of Parcel Maps, Pages 51-52 Humboldt County Records, said point monumented with a 5/8" Rebar with plastic cap stamped "JOHNSTON PLS 9194";

**THENCE** North 89 degrees 48 minutes 29 seconds West along the North line of Book 6 of Parcel Maps, Pages 51-52, Humboldt County Records, 295.58 feet to the **Point of Beginning**.

Basis of Bearings is Book 25 of Parcel Maps, Pages 104-105 Humboldt County Records.

---