



COUNTY OF HUMBOLDT

AGENDA ITEM NO.

C-15

For the meeting of: March 14, 2017

Date: February 17, 2017

To: Board of Supervisors

From:  Thomas K. Mattson, Director of Public Works

Subject: EARTHQUAKE DAMAGE REPAIRS TO MATTOLE ROAD (3C010) AT POST MILE 43.17; PROJECT NO. ER 4820(004); CONTRACT NO. 210207

RECOMMENDATION(S):

That the Board of Supervisors:

- 1) Approve the plans and specifications,
- 2) Direct the Clerk of the Board to advertise the above-mentioned project as required by Section 22037 of the California Public Contract Code, with bids to be opened on Tuesday, April 25, 2017, at 2:00 p.m.

SOURCE OF FUNDING:

Road Fund; Federal Highway Administration (FHWA) Emergency Relief (ER) Program

DISCUSSION:

This project consists of the permanent repair of Mattole Road (3C010) at post mile 43.17. This portion of the road sustained moderate damage during the magnitude six point five (6.5) earthquake on January 9, 2010.

Prepared by A. Sorensen, Associate Civil Engineer

CAO Approval



REVIEW:

Auditor

County Counsel



Human Resources

Other

TYPE OF ITEM:

- ☒ Consent
☐ Departmental
☐ Public Hearing
☐ Other

PREVIOUS ACTION/REFERRAL:

Board Order No. _____

Meeting of: _____

BOARD OF SUPERVISORS, COUNTY OF HUMBOLDT

Upon motion of Supervisor  Seconded by Supervisor 

Ayes  Fennell, Bass, Bohn, Wilson

Nays

Abstain

Absent

and carried by those members present, the Board hereby approves the recommended action contained in this Board report.

Dated: 

By:

Kathy Hayes, Clerk of the Board

The earthquake created a slip-out at this location that removed the shoulder and approximately four and half (4½) feet of the existing northbound lane for a distance of twenty-five (25) feet. The county placed barricades, signs, traffic control devices and limited traffic to a single lane to divert traffic away from hazardous conditions until permanent repairs could be made. The proposed permanent repair consists of cutting into the hillside to create a roadway with the same width as existed prior to the earthquake. The work includes temporary detours, clearing and grubbing, excavation, erosion control measures, installing guardrail along the length of the slip-out and restoring the roadway with aggregate base and hot mix asphalt.

The Department of Public Works recommends that the Board of Supervisors approves the attached plans and specifications, advertise the project, and proceed to construction.

FINANCIAL IMPACT:

The requested action has no significant financial impact because no funds are committed until the project is awarded. This project is being funded through the Federal Highway Administration, Emergency Relief Program, which will provide eighty-eight point fifty-three percent (88.53%) of the funds for the project. The Road Fund will cover the remaining eleven point forty-seven percent (11.47%) of project costs. The engineer's estimate for the construction contract is \$522,650. Construction costs are included in the Fiscal Year 2016-17 Road Fund Budget.

This project conforms to the Board of Supervisors' Core Role of providing for and maintaining infrastructure as identified in the Board's Strategic Framework.

OTHER AGENCY INVOLVEMENT:

California Department of Transportation (Caltrans)
Federal Highway Administration (FHWA)

ALTERNATIVES TO STAFF RECOMMENDATIONS:

The Board of Supervisors may choose not to approve the project. However, staff does not recommend this alternative because the project will reconstruct a damaged portion of roadway using funds that would not otherwise be available to the county.

ATTACHMENT:

Plans and Specifications for the project, Earthquake Damage Repairs to Mattole Road (3C010) at post mile 43.17; Project No. ER 4820(004); Contract No. 210207

County of Humboldt • Department of Public Works
1106 Second Street • Eureka • CA • 95501 • (707) 445-7652



SPECIAL PROVISIONS

NOTICE TO CONTRACTORS,
PROPOSAL AND CONTRACT

FOR

**EARTHQUAKE DAMAGE REPAIRS TO MATTOLE
ROAD (3C010) AT P.M. 43.17**

**PROJECT NO.: ER 4820 (004)
CONTRACT NO.: 210207**

40 WORKING DAYS

FOR USE WITH Standard Specifications dated 2015,
Standard Specifications dated 2010 (In Part),
Standard Plans dated 2015, Prevailing Wage Rates,
Labor Surcharge and Equipment Rental Rates

BIDS OPEN: April 25, 2017 AT 2:00 PM

Clerk of the Board's Office
Humboldt County Courthouse
825 Fifth Street, Suite 111
Eureka, CA 95501

SPECIAL PROVISIONS

NOTICE TO CONTRACTORS,
PROPOSAL AND CONTRACT

FOR

EARTHQUAKE DAMAGE REPAIRS TO MATTOLE
ROAD (3C010) AT P.M. 43.17

PROJECT NO.: ER 4820 (004)
CONTRACT NO.: 210207

Prepared by

County of Humboldt
Department of Public Works
1106 Second Street
Eureka, CA 95501

Recommended:

Jeffrey A. Ball
Jeffrey A. Ball
RCE 70631, Expires 6/30/2017

2-17-2017
Date

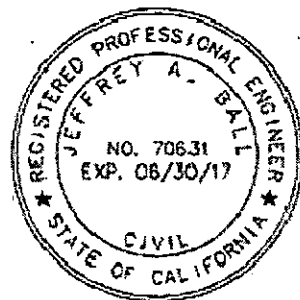

Approved:

Tony R. Seghetti
Tony R. Seghetti
RCE 63714, Expires 09/30/2018

2/17/17
Date

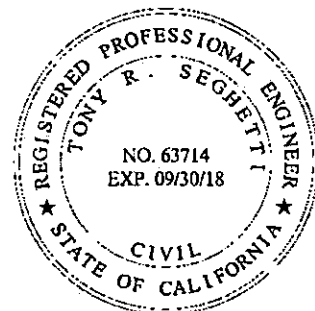

TABLE OF CONTENTS

NOTICE TO BIDDERS	3
SPECIAL PROVISIONS	5
DIVISION I GENERAL PROVISIONS.....	5
1 GENERAL	5
2 BIDDING.....	6
3 CONTRACT AWARD AND EXECUTION	6
5 CONTROL OF WORK	9
6 CONTROL OF MATERIALS	9
7 LEGAL RELATIONS AND RESPONSIBILITY TO THE PUBLIC	10
<i>Federal Wage Rates</i>	<i>10</i>
<i>Use of United States-Flag Vessel</i>	<i>11</i>
<i>FHWA Form 1273.....</i>	<i>12</i>
<i>Female and Minority Goals</i>	<i>25</i>
<i>Federal Trainee Program</i>	<i>26</i>
<i>Title VI Assurances</i>	<i>28</i>
8 PROSECUTION AND PROGRESS.....	29
9 PAYMENT	29
<i>Prompt Payment of Funds Withheld from Subcontractors.....</i>	<i>29</i>
DIVISION II GENERAL CONSTRUCTION	30
12 TEMPORARY TRAFFIC CONTROL	30
13 WATER POLLUTION CONTROL.....	31
DIVISION III GRADING.....	32
16 CLEARING AND GRUBBING.....	32
19 EARTHWORK	32
21 EROSION CONTROL	32
DIVISION IV SUBBASES AND BASES.....	33
26 AGGREGATE BASES	33
DIVISION V SURFACINGS AND PAVEMENTS	33
39 ASPHALT CONCRETE.....	33
DIVISION IX TRAFFIC CONTROL DEVICES.....	34
83 RAILINGS AND BARRIERS.....	34
PROPOSAL	36
PROPOSAL SIGNATURE PAGE.....	40
BIDDER'S BOND	41
CONTRACTOR'S CERTIFICATE REGARDING WORKER'S COMPENSATION	42
PUBLIC CONTRACT CODE SECTION 10285.1 STATEMENT	42
PUBLIC CONTRACT CODE SECTION 10162 QUESTIONNAIRE	43
PUBLIC CONTRACT CODE SECTION 10232 STATEMENT	43
DEBARMENT AND SUSPENSION CERTIFICATION.....	44
EQUAL EMPLOYMENT OPPORTUNITY CERTIFICATION	45
NONCOLLUSION AFFIDAVIT.....	45
NONLOBBYING CERTIFICATION FOR FEDERAL-AID CONTRACTS.....	46
DISCLOSURE OF LOBBYING ACTIVITIES	47
EXHIBIT 12-B BIDDER'S LIST OF SUBCONTRACTORS (DBE AND NON-DBE) - PART I	49
EXHIBIT 12-B BIDDER'S LIST OF SUBCONTRACTORS (DBE AND NON-DBE) - PART II	50
EXHIBIT 15-G CONSTRUCTION CONTRACT DBE COMMITMENT	51
EXHIBIT 15-H DBE INFORMATION —GOOD FAITH EFFORTS.....	53
EXHIBIT 17-F FINAL REPORT-UTILIZATION OF DBE AND FIRST-TIER SUBCONTRACTORS	56
EXHIBIT 17-O: DBE CERTIFICATION STATUS CHANGE	58
AGREEMENT	60
PAYMENT BOND	64
PERFORMANCE BOND	65

STANDARD PLANS LIST

The standard plan sheets applicable to this Contract include those listed below. The applicable revised standard plans (RSPs) listed below are included in the project plans.

ABBREVIATIONS, LINES, SYMBOLS, AND LEGEND

A3A	Abbreviations (Sheet 1 of 3)
A3B	Abbreviations (Sheet 2 of 3)
A3C	Abbreviations (Sheet 3 of 3)
A10A	Legend - Lines and Symbols (Sheet 1 of 5)
A10B	Legend - Lines and Symbols (Sheet 2 of 5)
A10C	Legend - Lines and Symbols (Sheet 3 of 5)
A10D	Legend - Lines and Symbols (Sheet 4 of 5)
A10E	Legend - Lines and Symbols (Sheet 5 of 5)

PAVEMENT MARKERS, TRAFFIC LINES, AND PAVEMENT MARKINGS

A20A	Pavement Markers and Traffic Lines - Typical Details
A20B	Pavement Markers and Traffic Lines - Typical Details

EXCAVATION AND BACKFILL

A62A	Excavation and Backfill - Miscellaneous Details
-------------	---

OBJECT MARKERS, DELINEATORS, CHANNELIZERS, AND BARRICADES

A73A	Object Markers
A73B	Markers
A73C	Delineators, Channelizers and Barricades

SURVEY MONUMENTS

A74	Survey Monuments
------------	------------------

MIDWEST GUARDRAIL SYSTEM - STANDARD RAILING SECTIONS

A77L2	Midwest Guardrail System - Standard Railing Section (Steel Post with Notched Wood or Notched Recycled Plastic Block)
A77N3	Midwest Guardrail System - Typical Line Post Embedment and Hinge Point Offset Details

MIDWEST GUARDRAIL SYSTEM - TYPICAL LAYOUTS FOR EMBANKMENTS

A77P2	Midwest Guardrail System - Typical Layouts for Embankments
--------------	--

CURBS, DRIVEWAYS, DIKES, CURB RAMPS, AND ACCESSIBLE PARKING

A87B	Hot Mix Asphalt Dikes
-------------	-----------------------

LANDSCAPE AND EROSION CONTROL

H51	Erosion Control Details - Fiber Roll and Compost Sock
------------	---

**TEMPORARY CRASH CUSHIONS, RAILING AND TRAFFIC
SCREEN**

T3A Temporary Railing (Type K)
T3B Temporary Railing (Type K)

TEMPORARY TRAFFIC CONTROL SYSTEMS

T13 Traffic Control System for Lane Closure on Two Lane Conventional
Highways

TEMPORARY WATER POLLUTION CONTROL

T51 Temporary Water Pollution Control Details (Temporary Silt Fence)
T57 Temporary Water Pollution Control Details (Temporary Check Dam)

ROADSIDE SIGNS

RS1 Roadside Signs - Typical Installation Details No. 1
RS2 Roadside Signs - Wood Post - Typical Installation Details No. 2
RS4 Roadside Signs - Typical Installation Details No. 4



COUNTY OF HUMBOLDT
DEPARTMENT OF PUBLIC WORKS

NOTICE TO BIDDERS

Sealed proposals will be received by (and all bids should be mailed or delivered to) the

Clerk of the Board Office
SEALED BID for (Project Name)
Humboldt County Courthouse
825 Fifth Street, Suite 111
Eureka, California, 95501

until 2:00 PM, **TUESDAY, April 25, 2017**, at which time they will be publicly opened by the Clerk of the Board of the County of Humboldt at a public meeting in the Office of the Clerk of the Board of Supervisors, Humboldt County Courthouse, Eureka, California, for performing work as follows:

EARTHQUAKE DAMAGE REPAIRS TO MATTOLE ROAD (3C010)

AT P.M. 43.17

PROJECT NO.: ER 4820 (004)

CONTRACT NO.: 210207

Bids are required for the entire work as described herein:

The roadwork to be done consists, in general, of, traffic control, clearing and grubbing, earthwork to construct a retreat roadway section, and surfacing of the roadway with aggregate base, hot mix asphalt, hot mix asphalt dike, placing guardrail, roadside delineators, and thermoplastic striping. This work also consists of temporary water pollution control, as needed and installation of erosion control for permanent soil stabilization. Bidders are advised that the work must be completed within **40 working days**. The Engineer's Estimate for this work is: **\$400,000**.

Plans, Special Provisions (not including documents included by reference) and Proposal Forms may be obtained by prospective Bidders upon **ADVANCE** payment of a non-refundable printing and service charge in the amount of **\$15.00**. All checks shall be made payable to COUNTY OF HUMBOLDT and should be mailed along with the request for Plans to the Humboldt County Department of Public Works, 1106 Second Street, Eureka, California, 95501.

Telephone: (707) 445-7652 Requests for plans, planholder list or project estimate
(707) 445-7377 Engineering division, questions regarding plans or specs
(707) 445-7409 Fax transmissions

Plans and Special Provisions reference the Caltrans Standard Specifications and Standard Plans dated 2015. Provisions that reference federal-aid contracts are applicable.

The successful Bidder shall furnish a Payment Bond and a Performance Bond.

The Contractor shall possess a **CLASS "A"** Contractors License at the time this contract is awarded.

No pre-bid meeting is scheduled for this project.

This contract is subject to state contract nondiscrimination and compliance requirements pursuant to Government Code, Section 12990. The County of Humboldt affirms that in any contract entered into pursuant to this advertisement, Disadvantaged Business Enterprises, as defined in 49 CFR Part 26, will be afforded full opportunity to submit bids in response to this invitation.

For this contract, the County has included a Disadvantaged Business Enterprises (DBE) goal of **3.0 Percent**. Bidders need not achieve the percentage stated as a condition of award.

Inquiries or questions based on alleged patent ambiguity of the plans, specifications or estimate must be communicated as a bidder inquiry prior to bid opening. Any such inquiries or questions, submitted after bid opening, will not be treated as a bid protest.

Pursuant to Section 1773 of the Labor Code, the general prevailing wage rates in the county, or counties, in which the work is to be done have been determined by the Director of the California Department of Industrial Relations. These wages are set forth in the General Prevailing Wage Rates for this project, available at County of Humboldt, 1106 2nd Street, Eureka, CA. 95501 and available from the California Department of Industrial Relations' Internet web site at <http://www.dir.ca.gov/DLSR/PWD>. The Federal minimum wage rates for this project as predetermined by the United States Secretary of Labor are available on the web home page of the Department of Labor at <http://www.gpo.gov/davisbacon/> and copies may be examined at the offices described above where project plans, special provisions, and proposal forms may be seen. Addenda to modify the Federal minimum wage rates, if necessary, will be issued to planholders that have purchased bid documents from the Department of Public Works at 1106 Second Street, Eureka, California, 95501. Future effective general prevailing wage rates which have been predetermined and are on file with the California Department of Industrial Relations are referenced but not printed in the general prevailing wage rates.

Attention is directed to the Federal minimum wage rate requirements of the Department of Labor. If there is a difference between the minimum wage rates predetermined by the Secretary of Labor and the general prevailing wage rates determined by the Director of the California Department of Industrial Relations for similar classifications of labor, the Contractor and subcontractors shall pay not less than the higher wage rate. The Department will not accept lower State wage rates not specifically included in the Federal minimum wage determinations. This includes "helper" (or other classifications based on hours of experience) or any other classification not appearing in the Federal wage determinations. Where Federal wage determinations do not contain the State wage rate determination otherwise available for use by the Contractor and subcontractors, the Contractor and subcontractors shall pay not less than the Federal minimum wage rate which most closely approximates the duties of the employees in question.

This project is subject to the "Buy America" provisions of the Surface Transportation Act of 1982, as amended by the Intermodal Surface Transportation Efficiency Act of 1991 (ISTEA) Sections 1041(a) and 1048(a), and the regulations adopted pursuant thereto.

The U.S. Department of Transportation (DOT) provides a toll-free "hotline" service to report bid rigging activities. Bid rigging activities can be reported Mondays through Fridays, between 8:00 a.m. and 5:00 p.m., Eastern Time, Telephone No. 1-800-424-9071. Anyone with knowledge of possible bid rigging, bidder collusion, or other fraudulent activities should use the "hotline" to report these activities. The "hotline" is part of the DOT's continuing effort to identify and investigate highway construction contract fraud and abuse and is operated under the direction of the DOT Inspector General. All information will be treated confidentially and caller anonymity will be respected.

KATHY HAYES

Clerk of the Board of Supervisors

County of Humboldt, State of California

DATED: _____

2 BIDDING

Add to section 2-1.06A:

Plans, Special Provisions (not including documents included by reference) and Proposal Forms may be viewed by prospective Bidders at the Humboldt County Department of Public Works, 1106 Second Street, Eureka, California.

Plans, Special Provisions and Supplemental Project Information may be viewed on the County of Humboldt web site: www.co.humboldt.ca.us. Current Revised Standard Specifications are available for review at the Department of Public Works, 1106 Second Street, Eureka, California or on Caltrans web page of the Office Engineer/ Engineering. (<http://www.dot.ca.gov/hq/esc/oe/standards.php>)

Note that Plans, Special Provisions, and Proposal Forms posted on the County's web site are for **informational purposes only and may not be substituted for any bid document**. Only those bid documents purchased from the Department of Public Works at 1106 Second Street, Eureka, California, 95501 may be used to submit a bid.

Add to section 2-1.33A:

The forms:

"Subcontractor List",
 "DBE Commitment",
 "DBE Confirmation", and
 "DBE Good Faith Efforts Documentation"

are included in the Proposal Section of these special provisions.

Add to section 2-1.34:

The form "Bidder's Security" will be found following the signature page of the Proposal.

^^^

3 CONTRACT AWARD AND EXECUTION

Add to section 3-1.04:

Bid Protest. Any bid protest must be in writing and must be received by the Department Director at 1106 Second Street, Eureka, CA, 95501 (Fax: (707) 445-7409), before 5:00 p.m. no later than three (3) working days following bid opening (the "Bid Protest Deadline") and must comply with the following requirements:

1. Only a bidder who has actually submitted a Bid Proposal is eligible to submit a bid protest against another bidder. Subcontractors are not eligible to submit bid protests. A bidder may not rely on the bid protest submitted by another bidder, but must timely pursue its own protest.

2. The bid protest must contain a complete statement of the basis for the protest and all supporting documentation. Material submitted after the Bid Protest Deadline will not be considered. The protest must refer to the specific portion or portions of the Contract Documents upon which the protest is based. The protest must include the name, address and telephone number of the person representing the protesting bidder if different from the protesting bidder.

3. A copy of the protest and all supporting documents must also be transmitted by fax or by e-mail, by or before the Bid Protest Deadline, to the protested bidder and any other bidder who has a reasonable prospect of receiving an award depending upon the outcome of the protest.

4. The protested bidder may submit a written response to the protest, provided the response is received by the Department Director before 5:00 p.m., within two (2) working days after the Bid Protest Deadline or after receipt of the bid protest, whichever is sooner (the "Response Deadline"). The response must include all supporting documentation. Material submitted after the Response Deadline will not be considered. The response must include the name, address and telephone number of the person representing the protested bidder if different from the protested bidder.

5. The procedure and time limits set forth in this section are mandatory and are the bidder's sole and exclusive remedy in the event of bid protest. The bidder's failure to comply with these procedures shall constitute a waiver of any right to further pursue a bid protest, including filing a Government Code Claim or initiation of legal proceedings. Any addenda or bulletins issued during the time of bidding, or forming a part of the documents issued to the Bidder for the preparation of his bid, shall be covered in the bid, and shall become a part of the Agreement.

Any addenda or bulletins issued during the time of bidding, or forming a part of the documents issued to the Bidder for the preparation of his bid, shall be covered in the bid, and shall become a part of the Agreement.

No person, firm or corporation shall be allowed to make or file, or be interested in, more than one bid for the same work, unless alternate bids are called for. A person, firm, or corporation who has submitted a subproposal to a Bidder, or who has quoted prices on materials to a Bidder, is not thereby disqualified from submitting a subproposal or quoting prices to other Bidders.

Replace section 3-1.05:

The successful Bidder, simultaneously with the execution of the Agreement, will be required to furnish a **Payment Bond** in an amount equal to **one hundred (100%) percent** of the contract price, and a faithful **Performance Bond** in an amount equal to **one hundred (100%)** of the contract price; said Bonds shall be secured from a surety company satisfactory to the Humboldt County Board of Supervisors. The Payment Bond shall comply with Section 3248 of the Civil Code of the State of California. The Payment Bond and the faithful Performance Bond shall each be in a form which is satisfactory to the County Counsel of the County of Humboldt. A copy of an acceptable format is attached to the Agreement forms included in the proposal section of these specifications.

Replace section 3-1.07:

I. THIS CONTRACT/AGREEMENT SHALL NOT BE EXECUTED BY COUNTY and the CONTRACTOR is not entitled to any rights, unless certificates of insurance, or other sufficient proof that the following provisions have been complied with, and such certificate(s) are filed with the Clerk of the Humboldt County Board of Supervisors.

II. Without limiting Contractor's indemnification provided herein, Contractor shall and shall require any of its subcontractors to take out and maintain, throughout the period of this Agreement, the following policies of insurance placed with insurers with a current A.M. Bests rating of no less than A:VII or its equivalent against injury/death to persons or damage to property which may arise from or in connection with the activities hereunder of Contractor, its agents, employees or subcontractors:

A. Comprehensive or Commercial General Liability Insurance at least as broad as Insurance Services Office Commercial General Liability coverage (occurrence from CG 0001), in an amount of \$1,000,000 per occurrence. If work involves explosive, underground or collapse risks, XCU must be included. If a general aggregate limit is used, either the general aggregate limit shall apply separately to this project or the general aggregate shall be twice the required occurrence limit. Said policy shall contain, or be endorsed with, the following provisions:

(1) The County, its officers, employees and agents, are covered as additional insured for liability arising out of the operations performed by or on behalf of Contractor. The coverage shall contain no special limitations on the scope of protection afforded to the County, its officers, agents, and employees.

(2) The policy shall not be canceled or materially reduced in coverage without thirty (30) days prior written notice (10 days for non-payment of the premium) to County by certified mail.

(3) The inclusion of more than one insured shall not operate to impair the rights of one insured against another insured, and the coverage afforded shall apply as though separate policies had been issued to each insured, but the inclusion of more than one insured shall not operate to increase the limits of the insurer's liability.

(4) For claims related to this project, the Contractor's insurance is primary coverage to the County, and any insurance or self-insurance programs maintained by the County are excess to Contractor's insurance and will not be called upon to contribute with it.

(5) Any failure to comply with reporting or other provisions of the parties, including breach of warranties, shall not affect coverage provided to County, its officers, employees, and agents.

B. Automobile liability insurance with coverage at least as broad as Insurance Services Office form CA 0001 06092, Code 1 (any auto), for vehicles used in the performance of this Agreement with minimum coverage of not less than \$1,000,000 per accident combined single limit (CSL). Such policy shall contain or be endorsed with the provision that coverage shall not be canceled or materially reduced in coverage without thirty(30) days prior written notice (10 days for non-payment of premium) to County by certified mail.

C. Workers' Compensation insurance meeting statutory limits of the California Labor Code which policy shall contain or be endorsed to contain a waiver of subrogation against County, its officers, agents, and employees and provide for thirty (30) days prior written notice in the event of cancellation.

D. Contractor shall furnish County with certificates and original endorsements effecting the required coverage prior to execution of this Agreement by County. The endorsements shall be on forms as approved by the County's Risk Manager or County Counsel. Any deductible or self-insured retention over \$100,000 shall be disclosed to and approved by County. If Contractor does not keep all required policies in full force and effect, County may, in addition to other remedies under this Agreement, take out the necessary insurance, and Contractor agrees to pay the cost of said insurance.

The County may elect to treat a failure to maintain the requisite insurances as a breach of contract/agreement and terminate the contract/agreement as provided herein.

III. Contractor shall indemnify and hold harmless County and its Board, officers, officials, employees, and volunteers from and against all claims, damages, losses, and expenses including attorney fees arising out of the performance of the work described herein, caused in whole or in part by any negligent act or omission by the contractor, any subcontractor, anyone directly or indirectly employed by any of them or anyone for whose acts any of them may be liable, except where caused by the active negligence, sole negligence, or willful misconduct of the County.

Replace paragraph 3, section 3-1.18:

The form of Agreement which the successful Bidder, as Contractor, will be required to execute, is included in the contract documents and should be carefully examined by the bidder. The agreement and bonds will be executed in duplicate. The signed agreements and bonds together with the required insurance certificates are to be returned by the successful bidder within 7 days, not including Sundays and legal holidays, after the bidder has received the contract for execution.

^^

5 CONTROL OF WORK

Add to section 5-1.13A:

The subcontractors listed on the "Subcontractor List," shall perform the work and supply the materials for which they are listed, unless the Contractor has received prior written authorization to perform the work with other forces or to obtain the materials from other sources.

The Contractor should notify the Engineer in writing of any changes to its anticipated subcontractor participation. This notice should be provided prior to the commencement of that portion of the work.

Replace paragraph 3, section 5-1.36D:

The Contractor's attention is directed to the existence of certain underground facilities that may require special precautions be taken by the Contractor to protect the health, safety and welfare of workmen and of the public. Facilities requiring special precautions include, but are not limited to: conductors of petroleum products, oxygen, chlorine, and toxic or flammable gases; natural gas in pipelines greater than 150 mm (6 inches) in diameter or pipelines operating at pressures greater than 415 kPa (60 psi) gauge; underground electric supply system conductors or cables, with potential to ground of more than 300 volts, either directly buried or in duct or conduit which do not have concentric grounded conductors or other effectively grounded metal shields or sheaths.

Per Govt Code § 4216 et seq., the Contractor shall notify the Engineer and the appropriate regional notification center for operators of subsurface installations at least 3 working days, but not more than 14 calendar days, prior to performing any excavation or other work close to any underground pipeline, conduit, duct, wire or other structure. Regional notification centers include but are not limited to the following:

Notification Center	Telephone Number
Underground Service Alert-Northern California (USA)	1-800-642-2444 1-800-227-2600
Underground Service Alert-Southern California (USA)	1-800-422-4133 1-800-227-2600

^^

6 CONTROL OF MATERIALS

Add to section 6-1.02:

The Contractor shall notify the Engineer not less than 48 hours before County-furnished material is to be picked up by the Contractor. A full description of the material and the time the material will be picked up shall be provided.

^^

7 LEGAL RELATIONS AND RESPONSIBILITY TO THE PUBLIC

Add to section 7-1.02K(2) paragraph 2:

The general prevailing wage rates determined by the Director of Industrial Relations, for the county or counties in which the work is to be done, are available at the Humboldt County Department of Public Works, 1106 Second Street, Eureka CA 95501. These wage rates are not included in the Special Provision, Notice to Bidder's, Proposal and Contract Book for the project. Changes, if any, to the general prevailing wage rates will be available at the same location.

Add to section 7-1.02L:

7-1.02L(3) Noncollusion

In conformance with Public Contract Code Section 7106, a Noncollusion Affidavit is included in the Proposal. Signing the Proposal shall also constitute signature of the Noncollusion Affidavit.

Add to section 7-1.02M(3):

Material from mining operations furnished for this project shall only come from sites in compliance with the Surface Mining and Reclamation Act of 1975 (SMARA) or sites not subject to SMARA. Contractor shall provide County with documentation establishing compliance with SMARA or exemption from SMARA.

The requirements of this section shall apply to materials furnished for the project, except for acquisition of materials in conformance with the provisions in section 4-1.04, "Use of Materials Found on the Job Site," of the Standard Specifications.

Add to section 7-1.11A:

Federal Wage Rates

The predetermined federal wages are derived from the Davis-Bacon Act of 1931 and are prescribed by 23 USC 113. The Federal Wage Rates are available directly from the Department of Labor at: <http://www.wdol.gov/dba.aspx#0>. The user is given a choice between entering in the determination number example: "CA2008004" or selecting the criteria State/County/Construction Type/WD number (WD num not needed). Select California/Humboldt/Highway, respectively. Copies of the Federal Wage Rates will also be available at:

Information Office
County of Humboldt, Department of Public Works
1106 Second Street
Eureka, CA 95501

Federal Wage Rates are not required to be physically included in this Bid Package. However, the federal wage rates as revised by addendums, if such addendums are issued, are included in the Agreement signed by the County of Humboldt and the Contractor.

Add to section 7-1.11A:

Federal lobbying restrictions imposed by Section 1352, Title 31, United States Code, is included in section 7-1.11B(XI).

A certification for Federal-aid contracts regarding payment of funds to lobby Congress or a Federal agency is included in the Proposal. Standard Form - LLL, "Disclosure of Lobbying Activities," with instructions for completion of the Standard Form is also included in the Proposal. Signing the Proposal shall constitute signature of the Certification.

The Contractor, subcontractors and any lower-tier contractors shall file a disclosure form at the end of each calendar quarter in which there occurs any event that requires disclosure or that materially affects the accuracy of the information contained in any disclosure form previously filed by the Contractor, subcontractors and any lower-tier contractors. An event that materially affects the accuracy of the information reported includes:

- (1) A cumulative increase of \$25,000 or more in the amount paid or expected to be paid for influencing or attempting to influence a covered Federal action; or
- (2) A change in the person(s) or individual(s) influencing or attempting to influence a covered Federal action; or
- (3) A change in the officer(s), employee(s), or Member(s) contacted to influence or attempt to influence a covered Federal Action.

Add to section 7-1.11A:
Use of United States-Flag Vessel

The contractor agrees -

- (1) To utilize privately owned United State flag commercial vessels to ship at least 50 percent of the gross tonnage (computed separately for dry bulk carriers, dry cargo liners, and tankers) involved, whenever shipping any equipment, material, or commodities pursuant to this contract, to the extent such vessels are available at fair and reasonable rates for United States-flag commercial vessels.
- (2) To furnish within 20 days following the date of loading for shipments originating within the United States or within 30 working days following the date, of loading for shipments originating outside the United States, a legible copy of a rated, 'on-board' commercial ocean bill-of-lading in English for each shipment of cargo described in paragraph (1) of this section to both the Contracting Officer (through the prime contractor in the case of subcontractor bills-of lading) and to the Division of National Cargo, Office of Market Development, Maritime Administration, Washington, DC 20590.
- (3) To insert the substance of the provisions of this clause in all subcontracts issued pursuant to this contract.

FEDERAL REQUIREMENTS FOR FEDERAL-AID CONSTRUCTION PROJECTS
FHWA Form 1273

GENERAL.—The work herein proposed will be financed in whole or in part with Federal funds, and therefore all of the statutes, rules and regulations promulgated by the Federal Government and applicable to work financed in whole or in part with Federal funds will apply to such work. The "Required Contract Provisions, Federal-Aid Construction Contracts, "Form FHWA 1273, are included in this Section 14. Whenever in said required contract provisions references are made to "SHA contracting officer", "SHA resident engineer", or "authorized representative of the SHA", such references shall be construed to mean "Engineer" as defined in Section 1-1.18 of the Standard Specifications.

PERFORMANCE OF PREVIOUS CONTRACT.—In addition to the provisions in Section II, "Nondiscrimination," and Section VII, "Subletting or Assigning the Contract," of the required contract provisions, the Contractor shall comply with the following:

The bidder shall execute the CERTIFICATION WITH REGARD TO THE PERFORMANCE OF PREVIOUS CONTRACTS OR SUBCONTRACTS SUBJECT TO THE EQUAL OPPORTUNITY CLAUSE AND THE FILING OF REQUIRED REPORTS located in the proposal. No request for subletting or assigning any portion of the contract in excess of \$10,000 will be considered under the provisions of Section VII of the required contract provisions unless such request is accompanied by the CERTIFICATION referred to above, executed by the proposed subcontractor.

NON-COLLUSION PROVISION.—The provisions in this section are applicable to all contracts except contracts for Federal Aid Secondary projects.

Title 23, United States Code, Section 112, requires as a condition precedent to approval by the Federal Highway Administrator of the contract for this work that each bidder file a sworn statement executed by, or on behalf of, the person, firm, association, or corporation to whom such contract is to be awarded, certifying that such person, firm, association, or corporation has not, either directly or indirectly, entered into any agreement, participated in any collusion, or otherwise taken any action in restraint of free competitive bidding in connection with the submitted bid. A form to make the non-collusion affidavit statement required by Section 112 as a certification under penalty of perjury rather than as a sworn statement as permitted by 28, USC, Sec. 1746, is included in the proposal.

PARTICIPATION BY DISADVANTAGED BUSINESS ENTERPRISES IN SUBCONTRACTING.—Part 26, Title 49, Code of Federal Regulations applies to this Federal-aid project. Pertinent sections of said Code are incorporated in part or in its entirety within other sections of these special provisions.

Schedule B—Information for Determining Joint Venture Eligibility (This form need not be filled in if all joint venture firms are DBE owned.)

1. Name of joint venture _____
2. Address of joint venture _____
3. Phone number of joint venture _____
4. Identify the firms which comprise the joint venture. (The DBE partner must complete Schedule A.) _____
- a. Describe the role of the DBE firm in the joint venture. _____
- b. Describe very briefly the experience and business qualifications of each non-DBE joint venturer: _____
5. Nature of the joint venture's business _____
6. Provide a copy of the joint venture agreement.
7. What is the claimed percentage of DBE ownership? _____
8. Ownership of joint venture: (This need not be filled in if described in the joint venture agreement, provided by question 6.).
 - a. Profit and loss sharing.
 - b. Capital contributions, including equipment.
 - c. Other applicable ownership interests.

Revised 3-95
08-07-95

FR-1

9. Control of and participation in this contract. Identify by name, race, sex, and "firm" those individuals (and their titles) who are responsible for day-to-day management and policy decision making, including, but not limited to, those with prime responsibility for:

a. Financial decisions _____

b. Management decisions, such as:

1. Estimating _____

2. Marketing and sales _____

3. Hiring and firing of management personnel _____

4. Purchasing of major items or supplies _____

c. Supervision of field operations _____

Note.—If, after filing this Schedule B and before the completion of the joint venture's work on the contract covered by this regulation, there is any significant change in the information submitted, the joint venture must inform the grantee, either directly or through the prime contractor if the joint venture is a subcontractor.

Affidavit

"The undersigned swear that the foregoing statements are correct and include all material information necessary to identify and explain the terms and operation of our joint venture and the intended participation by each joint venturer in the undertaking. Further, the undersigned covenant and agree to provide to grantee current, complete and accurate information regarding actual joint venture work and the payment therefor and any proposed changes in any of the joint venture arrangements and to permit the audit and examination of the books, records and files of the joint venture, or those of each joint venturer relevant to the joint venture, by authorized representatives of the grantee or the Federal funding agency. Any material misrepresentation will be grounds for terminating any contract which may be awarded and for initiating action under Federal or State laws concerning false statements."

Revised 3-95
08-07-95

FR-2

Name of Firm	Name of Firm
Signature	Signature
Name	Name
Title	Title
Date	Date

Date _____

State of _____

County of _____

On this ____ day of _____, 19 __, before me appeared (Name) _____, to me personally known, who, being duly sworn, did execute the foregoing affidavit, and did state that he or she was properly authorized by (Name of firm) _____ to execute the affidavit and did so as his or her free act and deed.

Notary Public _____

Commission expires _____

[Seal]

Date _____

State of _____

County of _____

On this ____ day of _____, 19 __, before me appeared (Name) _____ to me personally known, who, being duly sworn, did execute the foregoing affidavit, and did state that he or she was properly authorized by (Name of firm) _____ to execute the affidavit and did so as his or her free act and deed.

Notary Public _____

Commission expires _____

[Seal]

Replace section 7-1.11B with:

FHWA-1273 -- Revised May 1, 2012

REQUIRED CONTRACT PROVISIONS FEDERAL-AID CONSTRUCTION CONTRACTS

- I. General
- II. Nondiscrimination
- III. Nonsegregated Facilities
- IV. Davis-Bacon and Related Act Provisions
- V. Contract Work Hours and Safety Standards Act Provisions
- VI. Subletting or Assigning the Contract
- VII. Safety: Accident Prevention
- VIII. False Statements Concerning Highway Projects
- IX. Implementation of Clean Air Act and Federal Water Pollution Control Act
- X. Compliance with Government wide Suspension and Debarment Requirements
- XI. Certification Regarding Use of Contract Funds for Lobbying

ATTACHMENTS

A. Employment and Materials Preference for Appalachian Development Highway System or Appalachian Local Access Road Contracts (included in Appalachian contracts only)

I. GENERAL

1. Form FHWA-1273 must be physically incorporated in each construction contract funded under Title 23 (excluding emergency contracts solely intended for debris removal). The contractor (or subcontractor) must insert this form in each subcontract and further require its inclusion in all lower tier subcontracts (excluding purchase orders, rental agreements and other agreements for supplies or services).

The applicable requirements of Form FHWA-1273 are incorporated by reference for work done under any purchase order, rental agreement or agreement for other services. The prime contractor shall be responsible for compliance by any subcontractor, lower-tier subcontractor or service provider.

Form FHWA-1273 must be included in all Federal-aid design-build contracts, in all subcontracts and in lower tier subcontracts (excluding subcontracts for design services, purchase orders, rental agreements and other agreements for supplies or services). The design-builder shall be responsible for compliance by any subcontractor, lower-tier subcontractor or service provider.

Contracting agencies may reference Form FHWA-1273 in bid proposal or request for proposal documents, however, the Form FHWA-1273 must be physically incorporated (not referenced) in all contracts, subcontracts and lower-tier subcontracts (excluding purchase orders, rental agreements and other agreements for supplies or services related to a construction contract).

2. Subject to the applicability criteria noted in the following sections, these contract provisions shall apply to all work performed on the contract by the contractor's own organization and with the assistance of workers under the contractor's immediate superintendence and to all work performed on the contract by piecework, station work, or by subcontract.

3 A breach of any of the stipulations contained in these Required Contract Provisions may be sufficient grounds for withholding of progress payments, withholding of final payment, termination of the contract, suspension / debarment or any other action determined to be appropriate by the contracting agency and FHWA

4 Selection of Labor During the performance of this contract, the contractor shall not use convict labor for any purpose within the limits of a construction project on a Federal-aid highway unless it is labor performed by convicts who are on parole, supervised release, or probation. The term Federal-aid highway does not include roadways functionally classified as local roads or rural minor collectors

II. NONDISCRIMINATION

The provisions of this section related to 23 CFR Part 230 are applicable to all Federal-aid construction contracts and to all related construction subcontracts of \$10,000 or more. The provisions of 23 CFR Part 230 are not applicable to material supply, engineering, or architectural service contracts

In addition, the contractor and all subcontractors must comply with the following policies: Executive Order 11246, 41 CFR 60, 29 CFR 1625-1627, Title 23 USC Section 140, the Rehabilitation Act of 1973, as amended (29 USC 794), Title VI of the Civil Rights Act of 1964, as amended, and related regulations including 49 CFR Parts 21, 26 and 27, and 23 CFR Parts 200, 230, and 633

The contractor and all subcontractors must comply with: the requirements of the Equal Opportunity Clause in 41 CFR 60-1.4(b) and, for all construction contracts exceeding \$10,000, the Standard Federal Equal Employment Opportunity Construction Contract Specifications in 41 CFR 60-4.3.

Note The U S Department of Labor has exclusive authority to determine compliance with Executive Order 11246 and the policies of the Secretary of Labor including 41 CFR 60, and 29 CFR 1625-1627. The contracting agency and the FHWA have the authority and the responsibility to ensure compliance with Title 23 USC Section 140, the Rehabilitation Act of 1973, as amended (29 USC 794), and Title VI of the Civil Rights Act of

1964, as amended, and related regulations including 49 CFR Parts 21, 26 and 27, and 23 CFR Parts 200, 230, and 633

The following provision is adopted from 23 CFR 230, Appendix

A, with appropriate revisions to conform to the U S

Department of Labor (US DOL) and FHWA requirements.

1. Equal Employment Opportunity: Equal employment

opportunity (EEO) requirements not to discriminate and to take affirmative action to assure equal opportunity as set forth under laws, executive orders, rules, regulations (28 CFR 35, 29 CFR 1630, 29 CFR 1625-1627, 41 CFR 60 and 49 CFR 27) and orders of the Secretary of Labor as modified by the provisions prescribed herein, and imposed pursuant to 23 U.S.C. 140 shall constitute the EEO and specific affirmative action standards for the contractor's project activities under this contract. The provisions of the Americans with Disabilities Act of 1990 (42 U.S.C. 12101 et seq.) set forth under 28 CFR 35 and 29 CFR 1630 are incorporated by reference in this contract. In the execution of this contract, the contractor agrees to comply with the following minimum specific requirement activities of EEO:

a. The contractor will work with the contracting agency and the Federal Government to ensure that it has made every good faith effort to provide equal opportunity with respect to all of its terms and conditions of employment and in their review of activities under the contract.

b. The contractor will accept as its operating policy the following statement:

"It is the policy of this Company to assure that applicants are employed, and that employees are treated during employment, without regard to their race, religion, sex, color, national origin, age or disability. Such action shall include: employment, upgrading, demotion, or transfer; recruitment or recruitment advertising; layoff or termination; rates of pay or other forms of compensation; and selection for training, including apprenticeship, pre-apprenticeship, and/or on-the-job training.

2. EEO Officer: The contractor will designate and make known to the contracting officers an EEO Officer who will have the responsibility for and must be capable of effectively administering and promoting an active EEO program and who must be assigned adequate authority and responsibility to do so.

3. Dissemination of Policy: All members of the contractor's staff who are authorized to hire, supervise, promote, and discharge employees, or who recommend such action, or who are substantially involved in such action, will be made fully cognizant of, and will implement, the contractor's EEO policy and contractual responsibilities to provide EEO in each grade and classification of employment. To ensure that the above agreement will be met, the following actions will be taken as a minimum:

a. Periodic meetings of supervisory and personnel office employees will be conducted before the start of work and then not less often than once every six months, at which time the contractor's EEO policy and its implementation will be reviewed and explained. The meetings will be conducted by the EEO Officer.

b. All new supervisory or personnel office employees will be given a thorough indoctrination by the EEO Officer, covering all

major aspects of the contractor's EEO obligations within thirty days following their reporting for duty with the contractor.

c. All personnel who are engaged in direct recruitment for the project will be instructed by the EEO Officer in the contractor's procedures for locating and hiring minorities and women.

d. Notices and posters setting forth the contractor's EEO policy will be placed in areas readily accessible to employees, applicants for employment and potential employees.

e. The contractor's EEO policy and the procedures to implement such policy will be brought to the attention of employees by means of meetings, employee handbooks, or other appropriate means.

4. Recruitment: When advertising for employees, the contractor will include in all advertisements for employees the notation: "An Equal Opportunity Employer." All such advertisements will be placed in publications having a large circulation among minorities and women in the area from which the project work force would normally be derived.

a. The contractor will, unless precluded by a valid bargaining agreement, conduct systematic and direct recruitment through public and private employee referral sources likely to yield qualified minorities and women. To meet this requirement, the contractor will identify sources of potential minority group employees, and establish with such identified sources procedures whereby minority and women applicants may be referred to the contractor for employment consideration.

b. In the event the contractor has a valid bargaining agreement providing for exclusive hiring hall referrals, the contractor is expected to observe the provisions of that agreement to the extent that the system meets the contractor's compliance with EEO contract provisions. Where implementation of such an agreement has the effect of discriminating against minorities or women, or obligates the contractor to do the same, such implementation violates Federal nondiscrimination provisions.

c. The contractor will encourage its present employees to refer minorities and women as applicants for employment. Information and procedures with regard to referring such applicants will be discussed with employees.

5. Personnel Actions: Wages, working conditions, and employee benefits shall be established and administered, and personnel actions of every type, including hiring, upgrading, promotion, transfer, demotion, layoff, and termination, shall be taken without regard to race, color, religion, sex, national origin, age or disability. The following procedures shall be followed:

a. The contractor will conduct periodic inspections of project sites to insure that working conditions and employee facilities do not indicate discriminatory treatment of project site personnel.

b. The contractor will periodically evaluate the spread of wages paid within each classification to determine any evidence of discriminatory wage practices.

c. The contractor will periodically review selected personnel actions in depth to determine whether there is evidence of discrimination. Where evidence is found, the contractor will promptly take corrective action. If the review indicates that the

discrimination may extend beyond the actions reviewed, such corrective action shall include all affected persons.

d. The contractor will promptly investigate all complaints of alleged discrimination made to the contractor in connection with its obligations under this contract, will attempt to resolve such complaints, and will take appropriate corrective action within a reasonable time. If the investigation indicates that the discrimination may affect persons other than the complainant, such corrective action shall include such other persons. Upon completion of each investigation, the contractor will inform every complainant of all of their avenues of appeal.

6. Training and Promotion:

a. The contractor will assist in locating, qualifying, and increasing the skills of minorities and women who are should be aimed at developing full journey level status employees in the type of trade or job classification involved.

b. Consistent with the contractor's work force requirements and as permissible under Federal and State regulations, the contractor shall make full use of training programs, i.e., apprenticeship, and on-the-job training programs for the geographical area of contract performance. In the event a special provision for training is provided under this contract, this subparagraph will be superseded as indicated in the special provision. The contracting agency may reserve training positions for persons who receive welfare assistance in accordance with 23 U.S.C. 140(a).

c. The contractor will advise employees and applicants for employment of available training programs and entrance requirements for each.

d. The contractor will periodically review the training and promotion potential of employees who are minorities and women and will encourage eligible employees to apply for such training and promotion.

7. Unions: If the contractor relies in whole or in part upon unions as a source of employees, the contractor will use good faith efforts to obtain the cooperation of such unions to increase opportunities for minorities and women. Actions by the contractor, either directly or through a contractor's association acting as agent, will include the procedures set forth below:

a. The contractor will use good faith efforts to develop, in cooperation with the unions, joint training programs aimed toward qualifying more minorities and women for membership in the unions and increasing the skills of minorities and women so that they may qualify for higher paying employment.

b. The contractor will use good faith efforts to incorporate an EEO clause into each union agreement to the end that such union will be contractually bound to refer applicants without regard to their race, color, religion, sex, national origin, age or disability.

c. The contractor is to obtain information as to the referral practices and policies of the labor union except that to the extent such information is within the exclusive possession of the labor union and such labor union refuses to furnish such information to the contractor, the contractor shall so certify to the contracting agency and shall set forth what efforts have been made to obtain such information.

d. In the event the union is unable to provide the contractor with a reasonable flow of referrals within the time limit set forth in the collective bargaining agreement, the contractor will, through independent recruitment efforts, fill the employment vacancies without regard to race, color, religion, sex, national origin, age or disability; making full efforts to obtain qualified and/or qualifiable minorities and women. The failure of a union to provide sufficient referrals (even though it is obligated to provide exclusive referrals under the terms of a collective bargaining agreement) does not relieve the contractor from the requirements of this paragraph. In the event the union referral practice prevents the contractor from meeting the obligations pursuant to Executive Order 11246, as amended, and these special provisions, such contractor shall immediately notify the contracting agency.

8. Reasonable Accommodation for Applicants / Employees with Disabilities: The contractor must be familiar with the requirements for and comply with the Americans with Disabilities Act and all rules and regulations established there under. Employers must provide reasonable accommodation in all employment activities unless to do so would cause an undue hardship.

9. Selection of Subcontractors, Procurement of Materials and Leasing of Equipment: The contractor shall not discriminate on the grounds of race, color, religion, sex, national origin, age or disability in the selection and retention of subcontractors, including procurement of materials and leases of equipment. The contractor shall take all necessary and reasonable steps to ensure nondiscrimination in the administration of this contract.

a. The contractor shall notify all potential subcontractors and suppliers and lessors of their EEO obligations under this contract.

b. The contractor will use good faith efforts to ensure subcontractor compliance with their EEO obligations.

10. Assurance Required by 49 CFR 26.13(b):

a. The requirements of 49 CFR Part 26 and the State DOT's U.S. DOT-approved DBE program are incorporated by reference.

b. The contractor or subcontractor shall not discriminate on the basis of race, color, national origin, or sex in the performance of this contract. The contractor shall carry out applicable requirements of 49 CFR Part 26 in the award and administration of DOT-assisted contracts. Failure by the contractor to carry out these requirements is a material breach of this contract, which may result in the termination of this contract or such other remedy as the contracting agency deems appropriate.

11. Records and Reports: The contractor shall keep such records as necessary to document compliance with the EEO requirements. Such records shall be retained for a period of three years following the date of the final payment to the contractor for all contract work and shall be available at reasonable times and places for inspection by authorized representatives of the contracting agency and the FHWA.

a. The records kept by the contractor shall document the following:

(1) The number and work hours of minority and non-minority group members and women employed in each work classification on the project;

(2) The progress and efforts made in cooperation with unions, when applicable, to increase employment opportunities for minorities and women; and

(3) The progress and efforts being made in locating, hiring, training, qualifying, and upgrading minorities and women;

b. The contractors and subcontractors will submit an annual report to the contracting agency each July for the duration of the project, indicating the number of minority, women, and non-minority group employees currently engaged in each work classification required by the contract work. This information is to be reported on Form FHWA-1391. The staffing data should represent the project work force on board in all or any part of the last payroll period preceding the end of July. If on-the-job training is being required by special provision, the contractor will be required to collect and report training data. The employment data should reflect the work force on board during all or any part of the last payroll period preceding the end of July.

III. NONSEGREGATED FACILITIES

This provision is applicable to all Federal-aid construction contracts and to all related construction subcontracts of \$10,000 or more.

The contractor must ensure that facilities provided for employees are provided in such a manner that segregation on the basis of race, color, religion, sex, or national origin cannot result. The contractor may neither require such segregated use by written or oral policies nor tolerate such use by employee custom. The contractor's obligation extends further to ensure that its employees are not assigned to perform their services at any location, under the contractor's control, where the facilities are segregated. The term "facilities" includes waiting rooms, work areas, restaurants and other eating areas, time clocks, restrooms, washrooms, locker rooms, and other storage or dressing areas, parking lots, drinking fountains, recreation or entertainment areas, transportation, and housing provided for employees. The contractor shall provide separate or single-user restrooms and necessary dressing or sleeping areas to assure privacy between sexes.

IV. DAVIS-BACON AND RELATED ACT PROVISIONS

This section is applicable to all Federal-aid construction projects exceeding \$2,000 and to all related subcontracts and lower-tier subcontracts (regardless of subcontract size). The requirements apply to all projects located within the right-of-way of a roadway that is functionally classified as Federal-aid highway. This excludes roadways functionally classified as local roads or rural minor collectors, which are exempt. Contracting agencies may elect to apply these requirements to other projects.

The following provisions are from the U.S. Department of Labor regulations in 29 CFR 5.5 "Contract provisions and related matters" with minor revisions to conform to the FHWA-1273 format and FHWA program requirements.

1. Minimum wages

a. All laborers and mechanics employed or working upon the site of the work, will be paid unconditionally and not less often than

once a week, and without subsequent deduction or rebate on any account (except such payroll deductions as are permitted by regulations issued by the Secretary of Labor under the Copeland Act (29 CFR part 3)), the full amount of wages and bona fide fringe benefits (or cash equivalents thereof) due at time of payment computed at rates not less than those contained in the wage determination of the Secretary of Labor which is attached hereto and made a part hereof, regardless of any contractual relationship which may be alleged to exist between the contractor and such laborers and mechanics.

Contributions made or costs reasonably anticipated for bona fide fringe benefits under section 1(b)(2) of the Davis-Bacon Act on behalf of laborers or mechanics are considered wages paid to such laborers or mechanics, subject to the provisions of paragraph 1.d. of this section; also, regular contributions made or costs incurred for more than a weekly period (but not less often than quarterly) under plans, funds, or programs which cover the particular weekly period, are deemed to be constructively made or incurred during such weekly period. Such laborers and mechanics shall be paid the appropriate wage rate and fringe benefits on the wage determination for the classification of work actually performed, without regard to skill, except as provided in 29 CFR 5.5(a)(4). Laborers or mechanics performing work in more than one classification may be compensated at the rate specified for each classification for the time actually worked therein: Provided, That the employer's payroll records accurately set forth the time spent in each classification in which work is performed. The wage determination (including any additional classification and wage rates conformed under paragraph 1.b. of this section) and the Davis-Bacon poster (WH-1321) shall be posted at all times by the contractor and its subcontractors at the site of the work in a prominent and accessible place where it can be easily seen by the workers.

b.(1) The contracting officer shall require that any class of laborers or mechanics, including helpers, which is not listed in the wage determination and which is to be employed under the contract shall be classified in conformance with the wage determination. The contracting officer shall approve an additional classification and wage rate and fringe benefits therefore only when the following criteria have been met:

(i) The work to be performed by the classification requested is not performed by a classification in the wage determination; and

(ii) The classification is utilized in the area by the construction industry; and

(iii) The proposed wage rate, including any bona fide fringe benefits, bears a reasonable relationship to the wage rates contained in the wage determination.

(2) If the contractor and the laborers and mechanics to be employed in the classification (if known), or their representatives, and the contracting officer agree on the classification and wage rate (including the amount designated for fringe benefits where appropriate), a report of the action taken shall be sent by the contracting officer to the Administrator of the Wage and Hour Division, Employment Standards Administration, U.S. Department of Labor, Washington, DC 20210. The Administrator, or an authorized representative, will approve, modify, or disapprove every additional classification action within 30 days of receipt and so advise the contracting officer or will notify the contracting officer within the 30-day period that additional time is necessary.

(3) In the event the contractor, the laborers or mechanics to be employed in the classification or their representatives, and the contracting officer do not agree on the proposed classification and wage rate (including the amount designated for fringe benefits, where appropriate), the contracting officer shall refer the questions, including the views of all interested parties and the recommendation of the contracting officer, to the Wage and Hour Administrator for determination. The Wage and Hour Administrator, or an authorized representative, will issue a determination within 30 days of receipt and so advise the contracting officer or will notify the contracting officer within the 30-day period that additional time is necessary.

(4) The wage rate (including fringe benefits where appropriate) determined pursuant to paragraphs 1.b.(2) or 1.b.(3) of this section, shall be paid to all workers performing work in the classification under this contract from the first day on which work is performed in the classification.

c. Whenever the minimum wage rate prescribed in the contract for a class of laborers or mechanics includes a fringe benefit which is not expressed as an hourly rate, the contractor shall either pay the benefit as stated in the wage determination or shall pay another bona fide fringe benefit or an hourly cash equivalent thereof.

d. If the contractor does not make payments to a trustee or other third person, the contractor may consider as part of the wages of any laborer or mechanic the amount of any costs reasonably anticipated in providing bona fide fringe benefits under a plan or program. Provided, That the Secretary of Labor has found, upon the written request of the contractor, that the applicable standards of the Davis-Bacon Act have been met. The Secretary of Labor may require the contractor to set aside in a separate account assets for the meeting of obligations under the plan or program.

2. Withholding

The contracting agency shall upon its own action or upon written request of an authorized representative of the Department of Labor, withhold or cause to be withheld from the contractor under this contract, or any other Federal contract with the same prime contractor, or any other federally-assisted contract subject to Davis-Bacon prevailing wage requirements, which is held by the same prime contractor, so much of the accrued payments or advances as may be considered necessary to pay laborers and mechanics, including apprentices, trainees, and helpers, employed by the contractor or any subcontractor the full amount of wages required by the contract. In the event of failure to pay any laborer or mechanic, including any apprentice, trainee, or helper, employed or working on the site of the work, all or part of the wages required by the contract, the contracting agency may, after written notice to the contractor, take such action as may be necessary to cause the suspension of any further payment, advance, or guarantee of funds until such violations have ceased.

3. Payrolls and basic records

a. Payrolls and basic records relating thereto shall be maintained by the contractor during the course of the work and preserved for a period of three years thereafter for all laborers and mechanics working at the site of the work. Such records shall contain the name, address, and social security number of each such worker, his or her correct classification, hourly rates of wages paid (including rates of contributions or costs anticipated for bona fide fringe benefits or cash equivalents thereof of the types described in section 1(b)(2)(B) of the Davis-Bacon Act), daily and weekly number of hours worked, deductions made and actual wages paid.

Whenever the Secretary of Labor has found under 29 CFR 5.5(a)(1)(iv) that the wages of any laborer or mechanic include the amount of any costs reasonably anticipated in providing benefits under a plan or program described in section 1(b)(2)(B) of the Davis-Bacon Act, the contractor shall maintain records which show that the commitment to provide such benefits is enforceable, that the plan or program is financially responsible, and that the plan or program has been communicated in writing to the laborers or mechanics affected, and records which show the costs anticipated or the actual cost incurred in providing such benefits. Contractors employing apprentices or trainees under approved programs shall maintain written evidence of the registration of apprenticeship programs and certification of trainee programs, the registration of the apprentices and trainees, and the ratios and wage rates prescribed in the applicable programs.

b.(1) The contractor shall submit weekly for each week in which any contract work is performed a copy of all payrolls to the contracting agency. The payrolls submitted shall set out accurately and completely all of the information required to be maintained under 29 CFR 5.5(a)(3)(i), except that full social security numbers and home addresses shall not be included on weekly transmittals. Instead the payrolls shall only need to include an individually identifying number for each employee (e.g., the last four digits of the employee's social security number). The required weekly payroll information may be submitted in any form desired. Optional Form WH-347 is available for this purpose from the Wage and Hour Division Web site at <http://www.dol.gov/esa/whd/forms/wh347instr.htm> or its successor site. The prime contractor is responsible for the submission of copies of payrolls by all subcontractors. Contractors and subcontractors shall maintain the full social security number and current address of each covered worker, and shall provide them upon request to the contracting agency for transmission to the State DOT, the FHWA or the Wage and Hour Division of the Department of Labor for purposes of an investigation or audit of compliance with prevailing wage requirements. It is not a violation of this section for a prime contractor to require a subcontractor to provide addresses and social security numbers to the prime contractor for its own records, without weekly submission to the contracting agency..

(2) Each payroll submitted shall be accompanied by a "Statement of Compliance," signed by the contractor or subcontractor or his or her agent who pays or supervises the payment of the persons employed under the contract and shall certify the following:

(i) That the payroll for the payroll period contains the information required to be provided under §5.5 (a)(3)(ii) of Regulations, 29 CFR part 5, the appropriate information is being maintained under §5.5 (a)(3)(i) of Regulations, 29 CFR part 5, and that such information is correct and complete;

(ii) That each laborer or mechanic (including each helper, apprentice, and trainee) employed on the contract during the payroll period has been paid the full weekly wages earned, without rebate, either directly or indirectly, and that no deductions have been made either directly or indirectly from the full wages earned, other than permissible deductions as set forth in Regulations, 29 CFR part 3;

(iii) That each laborer or mechanic has been paid not less than the applicable wage rates and fringe benefits or cash equivalents for the classification of work performed, as specified in the applicable wage determination incorporated into the contract.

(3) The weekly submission of a properly executed certification set forth on the reverse side of Optional Form WH-347 shall satisfy the requirement for submission of the "Statement of Compliance" required by paragraph 3.b.(2) of this section.

(4) The falsification of any of the above certifications may subject the contractor or subcontractor to civil or criminal prosecution under section 1001 of title 18 and section 231 of title 31 of the United States Code.

c. The contractor or subcontractor shall make the records required under paragraph 3.a. of this section available for inspection, copying, or transcription by authorized representatives of the contracting agency, the State DOT, the FHWA, or the Department of Labor, and shall permit such representatives to interview employees during working hours on the job. If the contractor or subcontractor fails to submit the required records or to make them available, the FHWA may, after written notice to the contractor, the contracting agency or the State DOT, take such action as may be necessary to cause the suspension of any further payment, advance, or guarantee of funds. Furthermore, failure to submit the required records upon request or to make such records available may be grounds for debarment action pursuant to 29 CFR 5.12.

4. Apprentices and trainees

a. Apprentices (programs of the USDOL).

Apprentices will be permitted to work at less than the predetermined rate for the work they performed when they are employed pursuant to and individually registered in a bona fide apprenticeship program registered with the U.S. Department of Labor, Employment and Training Administration, Office of Apprenticeship Training, Employer and Labor Services, or with a State Apprenticeship Agency recognized by the Office, or if a person is employed in his or her first 90 days of probationary employment as an apprentice in such an apprenticeship program, who is not individually registered in the program, but who has been certified by the Office of Apprenticeship Training, Employer and Labor Services or a State Apprenticeship Agency (where appropriate) to be eligible for probationary employment as an apprentice.

The allowable ratio of apprentices to journeymen on the job site in any craft classification shall not be greater than the ratio permitted to the contractor as to the entire work force under the registered program. Any worker listed on a payroll at an apprentice wage rate, who is not registered or otherwise employed as stated above, shall be paid not less than the applicable wage rate on the wage determination for the classification of work actually performed. In addition, any apprentice performing work on the job site in excess of the ratio permitted under the registered program shall be paid not less than the applicable wage rate on the wage determination for the work actually performed. Where a contractor is performing construction on a project in a locality other than that in which its program is registered, the ratios and wage rates (expressed in percentages of the journeyman's hourly rate) specified in the contractor's or subcontractor's registered program shall be observed.

Every apprentice must be paid at not less than the rate specified in the registered program for the apprentice's level of progress, expressed as a percentage of the journeymen hourly rate specified in the applicable wage determination. Apprentices shall be paid fringe benefits in accordance with the provisions of the

apprenticeship program. If the apprenticeship program does not specify fringe benefits, apprentices must be paid the full amount of fringe benefits listed on the wage determination for the applicable classification. If the Administrator determines that a different practice prevails for the applicable apprentice classification, fringes shall be paid in accordance with that determination.

In the event the Office of Apprenticeship Training, Employer and Labor Services, or a State Apprenticeship Agency recognized by the Office, withdraws approval of an apprenticeship program, the contractor will no longer be permitted to utilize apprentices at less than the applicable predetermined rate for the work performed until an acceptable program is approved.

b. Trainees (programs of the USDOL).

Except as provided in 29 CFR 5.16, trainees will not be permitted to work at less than the predetermined rate for the work performed unless they are employed pursuant to and individually registered in a program which has received prior approval, evidenced by formal certification by the U.S. Department of Labor, Employment and Training Administration.

The ratio of trainees to journeymen on the job site shall not be greater than permitted under the plan approved by the Employment and Training Administration.

Every trainee must be paid at not less than the rate specified in the approved program for the trainee's level of progress, expressed as a percentage of the journeyman hourly rate specified in the applicable wage determination. Trainees shall be paid fringe benefits in accordance with the provisions of the trainee program. If the trainee program does not mention fringe benefits, trainees shall be paid the full amount of fringe benefits listed on the wage determination unless the Administrator of the Wage and Hour Division determines that there is an apprenticeship program associated with the corresponding journeyman wage rate on the wage determination which provides for less than full fringe benefits for apprentices. Any employee listed on the payroll at a trainee rate who is not registered and participating in a training plan approved by the Employment and Training Administration shall be paid not less than the applicable wage rate on the wage determination for the classification of work actually performed. In addition, any trainee performing work on the job site in excess of the ratio permitted under the registered program shall be paid not less than the applicable wage rate on the wage determination for the work actually performed.

In the event the Employment and Training Administration withdraws approval of a training program, the contractor will no longer be permitted to utilize trainees at less than the applicable predetermined rate for the work performed until an acceptable program is approved.

c. Equal employment opportunity. The utilization of apprentices, trainees and journeymen under this part shall be in conformity with the equal employment opportunity requirements of Executive Order 11246, as amended, and 29 CFR part 30.

d. Apprentices and Trainees (programs of the U.S. DOT).

Apprentices and trainees working under apprenticeship and skill training programs which have been certified by the Secretary of Transportation as promoting EEO in connection with Federal-aid highway construction programs are not subject to the requirements of paragraph 4 of this Section IV. The straight time hourly wage

rates for apprentices and trainees under such programs will be established by the particular programs. The ratio of apprentices and trainees to journeymen shall not be greater than permitted by the terms of the particular program.

5. Compliance with Copeland Act requirements. The contractor shall comply with the requirements of 29 CFR part 3, which are incorporated by reference in this contract.

6. Subcontracts. The contractor or subcontractor shall insert Form FHWA-1273 in any subcontracts and also require the subcontractors to include Form FHWA-1273 in any lower tier subcontracts. The prime contractor shall be responsible for the compliance by any subcontractor or lower tier subcontractor with all the contract clauses in 29 CFR 5.5.

7. Contract termination: debarment. A breach of the contract clauses in 29 CFR 5.5 may be grounds for termination of the contract, and for debarment as a contractor and a subcontractor as provided in 29 CFR 5.12.

8. Compliance with Davis-Bacon and Related Act requirements. All rulings and interpretations of the Davis-Bacon and Related Acts contained in 29 CFR parts 1, 3, and 5 are herein incorporated by reference in this contract.

9. Disputes concerning labor standards. Disputes arising out of the labor standards provisions of this contract shall not be subject to the general disputes clause of this contract. Such disputes shall be resolved in accordance with the procedures of the Department of Labor set forth in 29 CFR parts 5, 6, and 7. Disputes within the meaning of this clause include disputes between the contractor (or any of its subcontractors) and the contracting agency, the U.S. Department of Labor, or the employees or their representatives.

10. Certification of eligibility.

a. By entering into this contract, the contractor certifies that neither it (nor he or she) nor any person or firm who has an interest in the contractor's firm is a person or firm ineligible to be awarded Government contracts by virtue of section 3(a) of the Davis-Bacon Act or 29 CFR 5.12(a)(1).

b. No part of this contract shall be subcontracted to any person or firm ineligible for award of a Government contract by virtue of section 3(a) of the Davis-Bacon Act or 29 CFR 5.12(a)(1).

c. The penalty for making false statements is prescribed in the U.S. Criminal Code, 18 U.S.C. 1001.

V. CONTRACT WORK HOURS AND SAFETY STANDARDS ACT

The following clauses apply to any Federal-aid construction contract in an amount in excess of \$100,000 and subject to the overtime provisions of the Contract Work Hours and Safety Standards Act. These clauses shall be inserted in addition to the clauses required by 29 CFR 5.5(a) or 29 CFR 4.6. As used in this paragraph, the terms laborers and mechanics include watchmen and guards.

1. Overtime requirements. No contractor or subcontractor contracting for any part of the contract work which may require or involve the employment of laborers or mechanics shall require or permit any such laborer or mechanic in any workweek in which he or she is employed on such work to work in excess of forty hours in such workweek unless such laborer or mechanic receives compensation at a rate not less than one and one-half times the basic rate of pay for all hours worked in excess of forty hours in such workweek.

2. Violation; liability for unpaid wages; liquidated damages. In the event of any violation of the clause set forth in paragraph (1.) of this section, the contractor and any subcontractor responsible therefor shall be liable for the unpaid wages. In addition, such contractor and subcontractor shall be liable to the United States (in the case of work done under contract for the District of Columbia or a territory, to such District or to such territory), for liquidated damages. Such liquidated damages shall be computed with respect to each individual laborer or mechanic, including watchmen and guards, employed in violation of the clause set forth in paragraph (1.) of this section, in the sum of \$10 for each calendar day on which such individual was required or permitted to work in excess of the standard workweek of forty hours without payment of the overtime wages required by the clause set forth in paragraph (1.) of this section.

3. Withholding for unpaid wages and liquidated damages. The FHWA or the contracting agency shall upon its own action or upon written request of an authorized representative of the Department of Labor withhold or cause to be withheld, from any moneys payable on account of work performed by the contractor or subcontractor under any such contract or any other Federal contract with the same prime contractor, or any other federally-assisted contract subject to the Contract Work Hours and Safety Standards Act, which is held by the same prime contractor, such sums as may be determined to be necessary to satisfy any liabilities of such contractor or subcontractor for unpaid wages and liquidated damages as provided in the clause set forth in paragraph (2.) of this section.

4. Subcontracts. The contractor or subcontractor shall insert in any subcontracts the clauses set forth in paragraph (1.) through (4.) of this section and also a clause requiring the subcontractors to include these clauses in any lower tier subcontracts. The prime contractor shall be responsible for compliance by any subcontractor or lower tier subcontractor with the clauses set forth in paragraphs (1.) through (4.) of this section.

VI. SUBLETTING OR ASSIGNING THE CONTRACT

This provision is applicable to all Federal-aid construction contracts on the National Highway System.

1. The contractor shall perform with its own organization contract work amounting to not less than 30 percent (or a greater percentage if specified elsewhere in the contract) of the total original contract price, excluding any specialty items designated by the contracting agency. Specialty items may be performed by subcontract and the amount of any such specialty items performed may be deducted from the total original contract price before computing the amount of work required to be performed by the contractor's own organization (23 CFR 635.116).

a. The term "perform work with its own organization" refers to workers employed or leased by the prime contractor, and equipment owned or rented by the prime contractor, with or without operators. Such term does not include employees or equipment of a subcontractor or lower tier subcontractor, agents of the prime contractor, or any other assignees. The term may include payments for the costs of hiring leased employees from an employee leasing firm meeting all relevant Federal and State regulatory requirements. Leased employees may only be included in this term if the prime contractor meets all of the following conditions:

(1) The prime contractor maintains control over the supervision of the day-to-day activities of the leased employees;

(2) The prime contractor remains responsible for the quality of the work of the leased employees;

(3) The prime contractor retains all power to accept or exclude individual employees from work on the project; and

(4) The prime contractor remains ultimately responsible for the payment of predetermined minimum wages, the submission of payrolls, statements of compliance and all other Federal regulatory requirements.

b. "Specialty Items" shall be construed to be limited to work that requires highly specialized knowledge, abilities, or equipment not ordinarily available in the type of contracting organizations qualified and expected to bid or propose on the contract as a whole and in general are to be limited to minor components of the overall contract.

2. The contract amount upon which the requirements set forth in paragraph (1) of Section VI is computed includes the cost of material and manufactured products which are to be purchased or produced by the contractor under the contract provisions.

3. The contractor shall furnish (a) a competent superintendent or supervisor who is employed by the firm, has full authority to direct performance of the work in accordance with the contract requirements, and is in charge of all construction operations (regardless of who performs the work) and (b) such other of its own organizational resources (supervision, management, and engineering services) as the contracting officer determines is necessary to assure the performance of the contract.

4. No portion of the contract shall be sublet, assigned or otherwise disposed of except with the written consent of the contracting officer, or authorized representative, and such consent when given shall not be construed to relieve the contractor of any responsibility for the fulfillment of the contract. Written consent will be given only after the contracting agency has assured that each subcontract is evidenced in writing and that it contains all pertinent provisions and requirements of the prime contract.

5. The 30% self-performance requirement of paragraph (1) is not applicable to design-build contracts; however, contracting agencies may establish their own self-performance requirements.

VII. SAFETY: ACCIDENT PREVENTION

This provision is applicable to all Federal-aid construction contracts and to all related subcontracts.

1. In the performance of this contract the contractor shall comply with all applicable Federal, State, and local laws governing safety, health, and sanitation (23 CFR 635). The contractor shall provide all safeguards, safety devices and protective equipment and take any other needed actions as it determines, or as the contracting officer may determine, to be reasonably necessary to protect the life and health of employees on the job and the safety of the public and to protect property in connection with the performance of the work covered by the contract.

2. It is a condition of this contract, and shall be made a condition of each subcontract, which the contractor enters into pursuant to this contract, that the contractor and any subcontractor shall not permit any employee, in performance of the contract, to work in surroundings or under conditions which are unsanitary, hazardous or dangerous to his/her health or safety, as determined under construction safety and health standards (29 CFR 1926) promulgated by the Secretary of Labor, in accordance with Section 107 of the Contract Work Hours and Safety Standards Act (40 U.S.C. 3704).

3. Pursuant to 29 CFR 1926.3, it is a condition of this contract that the Secretary of Labor or authorized representative thereof, shall have right of entry to any site of contract performance to inspect or investigate the matter of compliance with the construction safety and health standards and to carry out the duties of the Secretary under Section 107 of the Contract Work Hours and Safety Standards Act (40 U.S.C. 3704).

VIII. FALSE STATEMENTS CONCERNING HIGHWAY PROJECTS

This provision is applicable to all Federal-aid construction contracts and to all related subcontracts.

In order to assure high quality and durable construction in conformity with approved plans and specifications and a high degree of reliability on statements and representations made by engineers, contractors, suppliers, and workers on Federal-aid highway projects, it is essential that all persons concerned with the project perform their functions as carefully, thoroughly, and honestly as possible. Willful falsification, distortion, or misrepresentation with respect to any facts related to the project is a violation of Federal law. To prevent any misunderstanding regarding the seriousness of these and similar acts, Form FHWA-1022 shall be posted on each Federal-aid highway project (23 CFR 635) in one or more places where it is readily available to all persons concerned with the project:

18 U.S.C. 1020 reads as follows:

"Whoever, being an officer, agent, or employee of the United States, or of any State or Territory, or whoever, whether a person, association, firm, or corporation, knowingly makes any false statement, false representation, or false report as to the character, quality, quantity, or cost of the material used or to be used, or the quantity or quality of the work performed or to be performed, or the cost thereof in connection with the submission of plans, maps, specifications, contracts, or costs of construction on any highway or related project submitted for approval to the Secretary of Transportation; or

Whoever knowingly makes any false statement, false representation, false report or false claim with respect to the character, quality, quantity, or cost of any work performed or to be performed, or materials furnished or to be furnished, in connection

with the construction of any highway or related project approved by the Secretary of Transportation; or

Whoever knowingly makes any false statement or false representation as to material fact in any statement, certificate, or report submitted pursuant to provisions of the Federal-aid Roads Act approved July 1, 1916, (39 Stat. 355), as amended and supplemented;

Shall be fined under this title or imprisoned not more than 5 years or both."

IX. IMPLEMENTATION OF CLEAN AIR ACT AND FEDERAL WATER POLLUTION CONTROL ACT

This provision is applicable to all Federal-aid construction contracts and to all related subcontracts.

By submission of this bid/proposal or the execution of this contract, or subcontract, as appropriate, the bidder, proposer, Federal-aid construction contractor, or subcontractor, as appropriate, will be deemed to have stipulated as follows:

1. That any person who is or will be utilized in the performance of this contract is not prohibited from receiving an award due to a violation of Section 508 of the Clean Water Act or Section 306 of the Clean Air Act.

2. That the contractor agrees to include or cause to be included the requirements of paragraph (1) of this Section X in every subcontract, and further agrees to take such action as the contracting agency may direct as a means of enforcing such requirements.

X. CERTIFICATION REGARDING DEBARMENT, SUSPENSION, INELIGIBILITY AND VOLUNTARY EXCLUSION

This provision is applicable to all Federal-aid construction contracts, design-build contracts, subcontracts, lower-tier subcontracts, purchase orders, lease agreements, consultant contracts or any other covered transaction requiring FHWA approval or that is estimated to cost \$25,000 or more – as defined in 2 CFR Parts 180 and 1200.

1. Instructions for Certification – First Tier Participants:

a. By signing and submitting this proposal, the prospective first tier participant is providing the certification set out below.

b. The inability of a person to provide the certification set out below will not necessarily result in denial of participation in this covered transaction. The prospective first tier participant shall submit an explanation of why it cannot provide the certification set out below. The certification or explanation will be considered in connection with the department or agency's determination whether to enter into this transaction. However, failure of the prospective first tier participant to furnish a certification or an explanation shall disqualify such a person from participation in this transaction.

c. The certification in this clause is a material representation of fact upon which reliance was placed when the contracting agency

determined to enter into this transaction. If it is later determined that the prospective participant knowingly rendered an erroneous certification, in addition to other remedies available to the Federal Government, the contracting agency may terminate this transaction for cause of default.

d. The prospective first tier participant shall provide immediate written notice to the contracting agency to whom this proposal is submitted if any time the prospective first tier participant learns that its certification was erroneous when submitted or has become erroneous by reason of changed circumstances.

e. The terms "covered transaction," "debarred," "suspended," "ineligible," "participant," "person," "principal," and "voluntarily excluded," as used in this clause, are defined in 2 CFR Parts 180 and 1200. "First Tier Covered Transactions" refers to any covered transaction between a grantee or subgrantee of Federal funds and a participant (such as the prime or general contract). "Lower Tier Covered Transactions" refers to any covered transaction under a First Tier Covered Transaction (such as subcontracts). "First Tier Participant" refers to the participant who has entered into a covered transaction with a grantee or subgrantee of Federal funds (such as the prime or general contractor). "Lower Tier Participant" refers any participant who has entered into a covered transaction with a First Tier Participant or other Lower Tier Participants (such as subcontractors and suppliers).

f. The prospective first tier participant agrees by submitting this proposal that, should the proposed covered transaction be entered into, it shall not knowingly enter into any lower tier covered transaction with a person who is debarred, suspended, declared ineligible, or voluntarily excluded from participation in this covered transaction, unless authorized by the department or agency entering into this transaction.

g. The prospective first tier participant further agrees by submitting this proposal that it will include the clause titled "Certification Regarding Debarment, Suspension, Ineligibility and Voluntary Exclusion-Lower Tier Covered Transactions," provided by the department or contracting agency, entering into this covered transaction, without modification, in all lower tier covered transactions and in all solicitations for lower tier covered transactions exceeding the \$25,000 threshold.

h. A participant in a covered transaction may rely upon a certification of a prospective participant in a lower tier covered transaction that is not debarred, suspended, ineligible, or voluntarily excluded from the covered transaction, unless it knows that the certification is erroneous. A participant is responsible for ensuring that its principals are not suspended, debarred, or otherwise ineligible to participate in covered transactions. To verify the eligibility of its principals, as well as the eligibility of any lower tier prospective participants, each participant may, but is not required to, check the Excluded Parties List System website (<https://www.epls.gov/>), which is compiled by the General Services Administration.

i. Nothing contained in the foregoing shall be construed to require the establishment of a system of records in order to render in good faith the certification required by this clause. The knowledge and information of the prospective participant is not required to exceed that which is normally possessed by a prudent person in the ordinary course of business dealings.

j. Except for transactions authorized under paragraph (f) of these instructions, if a participant in a covered transaction knowingly enters into a lower tier covered transaction with a person who is suspended, debarred, ineligible, or voluntarily excluded from participation in this transaction, in addition to other remedies available to the Federal Government, the department or agency may terminate this transaction for cause or default.

* * * * *

2. Certification Regarding Debarment, Suspension, Ineligibility and Voluntary Exclusion – First Tier Participants:

a. The prospective first tier participant certifies to the best of its knowledge and belief, that it and its principals:

(1) Are not presently debarred, suspended, proposed for debarment, declared ineligible, or voluntarily excluded from participating in covered transactions by any Federal department or agency;

(2) Have not within a three-year period preceding this proposal been convicted of or had a civil judgment rendered against them for commission of fraud or a criminal offense in connection with obtaining, attempting to obtain, or performing a public (Federal, State or local) transaction or contract under a public transaction; violation of Federal or State antitrust statutes or commission of embezzlement, theft, forgery, bribery, falsification or destruction of records, making false statements, or receiving stolen property;

(3) Are not presently indicted for or otherwise criminally or civilly charged by a governmental entity (Federal, State or local) with commission of any of the offenses enumerated in paragraph (a)(2) of this certification; and

(4) Have not within a three-year period preceding this application/proposal had one or more public transactions (Federal, State or local) terminated for cause or default.

b. Where the prospective participant is unable to certify to any of the statements in this certification, such prospective participant shall attach an explanation to this proposal.

2. Instructions for Certification - Lower Tier Participants:

(Applicable to all subcontracts, purchase orders and other lower tier transactions requiring prior FHWA approval or estimated to cost \$25,000 or more - 2 CFR Parts 180 and 1200)

a. By signing and submitting this proposal, the prospective lower tier is providing the certification set out below.

b. The certification in this clause is a material representation of fact upon which reliance was placed when this transaction was entered into. If it is later determined that the prospective lower tier participant knowingly rendered an erroneous certification, in addition to other remedies available to the Federal Government, the department, or agency with which this transaction originated may pursue available remedies, including suspension and/or debarment.

c. The prospective lower tier participant shall provide immediate written notice to the person to which this proposal is submitted if at any time the prospective lower tier participant learns

that its certification was erroneous by reason of changed circumstances.

d. The terms "covered transaction," "debarred," "suspended," "ineligible," "participant," "person," "principal," and "voluntarily excluded," as used in this clause, are defined in 2 CFR Parts 180 and 1200. You may contact the person to which this proposal is submitted for assistance in obtaining a copy of those regulations. "First Tier Covered Transactions" refers to any covered transaction between a grantee or subgrantee of Federal funds and a participant (such as the prime or general contract). "Lower Tier Covered Transactions" refers to any covered transaction under a First Tier Covered Transaction (such as subcontracts). "First Tier Participant" refers to the participant who has entered into a covered transaction with a grantee or subgrantee of Federal funds (such as the prime or general contractor). "Lower Tier Participant" refers any participant who has entered into a covered transaction with a First Tier Participant or other Lower Tier Participants (such as subcontractors and suppliers).

e. The prospective lower tier participant agrees by submitting this proposal that, should the proposed covered transaction be entered into, it shall not knowingly enter into any lower tier covered transaction with a person who is debarred, suspended, declared ineligible, or voluntarily excluded from participation in this covered transaction, unless authorized by the department or agency with which this transaction originated.

f. The prospective lower tier participant further agrees by submitting this proposal that it will include this clause titled "Certification Regarding Debarment, Suspension, Ineligibility and Voluntary Exclusion-Lower Tier Covered Transaction," without modification, in all lower tier covered transactions and in all solicitations for lower tier covered transactions exceeding the \$25,000 threshold.

g. A participant in a covered transaction may rely upon a certification of a prospective participant in a lower tier covered transaction that is not debarred, suspended, ineligible, or voluntarily excluded from the covered transaction, unless it knows that the certification is erroneous. A participant is responsible for ensuring that its principals are not suspended, debarred, or otherwise ineligible to participate in covered transactions. To verify the eligibility of its principals, as well as the eligibility of any lower tier prospective participants, each participant may, but is not required to, check the Excluded Parties List System website (<https://www.epls.gov/>), which is compiled by the General Services Administration.

h. Nothing contained in the foregoing shall be construed to require establishment of a system of records in order to render in good faith the certification required by this clause. The knowledge and information of participant is not required to exceed that which is normally possessed by a prudent person in the ordinary course of business dealings.

i. Except for transactions authorized under paragraph e of these instructions, if a participant in a covered transaction knowingly enters into a lower tier covered transaction with a person who is suspended, debarred, ineligible, or voluntarily excluded from participation in this transaction, in addition to other remedies available to the Federal Government, the department or agency with which this transaction originated may pursue available remedies, including suspension and/or debarment.

* * * * *

Certification Regarding Debarment, Suspension, Ineligibility and Voluntary Exclusion--Lower Tier Participants:

1. The prospective lower tier participant certifies, by submission of this proposal, that neither it nor its principals is presently debarred, suspended, proposed for debarment, declared ineligible, or voluntarily excluded from participating in covered transactions by any Federal department or agency.

2. Where the prospective lower tier participant is unable to certify to any of the statements in this certification, such prospective participant shall attach an explanation to this proposal.

* * * * *

XI. CERTIFICATION REGARDING USE OF CONTRACT FUNDS FOR LOBBYING

This provision is applicable to all Federal-aid construction contracts and to all related subcontracts which exceed \$100,000 (49 CFR 20).

1. The prospective participant certifies, by signing and submitting this bid or proposal, to the best of his or her knowledge and belief, that:

a. No Federal appropriated funds have been paid or will be paid, by or on behalf of the undersigned, to any person for influencing or attempting to influence an officer or employee of any Federal agency, a Member of Congress, an officer or employee of Congress, or an employee of a Member of Congress in connection with the awarding of any Federal contract, the making of any Federal grant, the making of any Federal loan, the entering into of any cooperative agreement, and the extension, continuation, renewal, amendment, or modification of any Federal contract, grant, loan, or cooperative agreement.

b. If any funds other than Federal appropriated funds have been paid or will be paid to any person for influencing or attempting to influence an officer or employee of any Federal agency, a Member of Congress, an officer or employee of Congress, or an employee of a Member of Congress in connection with this Federal contract, grant, loan, or cooperative agreement, the undersigned shall complete and submit Standard Form-LLL, "Disclosure Form to Report Lobbying," in accordance with its instructions.

2. This certification is a material representation of fact upon which reliance was placed when this transaction was made or entered into. Submission of this certification is a prerequisite for making or entering into this transaction imposed by 31 U.S.C. 1352. Any person who fails to file the required certification shall be subject to a civil penalty of not less than \$10,000 and not more than \$100,000 for each such failure.

3. The prospective participant also agrees by submitting its bid or proposal that the participant shall require that the language of this certification be included in all lower tier subcontracts, which exceed \$100,000 and that all such recipients shall certify and disclose accordingly.

Female and Minority Goals

To comply with Section II, "Nondiscrimination," of "Required Contract Provisions Federal-Aid Construction Contracts," the following female and minority utilization goals for Federal-aid construction contracts and subcontracts that exceed \$10,000.

The nationwide goal for female utilization is 6.9 percent.

The goals for minority utilization [45 Fed Reg 65984 (10/3/1980)] are as follows:

Minority Utilization Goals

	Economic Area	Goal (Percent)
174	Redding CA: Non-SMSA Counties: CA Lassen; CA Modoc; CA Plumas; CA Shasta; CA Siskiyou; CA Tehama	6.8
175	Eureka, CA Non-SMSA Counties: CA Del Norte; CA Humboldt; CA Trinity	6.6
176	San Francisco-Oakland-San Jose, CA: SMSA Counties: 7120 Salinas-Seaside-Monterey, CA CA Monterey 7360 San Francisco-Oakland CA Alameda; CA Contra Costa; CA Marin; CA San Francisco; CA San Mateo 7400 San Jose, CA CA Santa Clara, CA 7485 Santa Cruz, CA CA Santa Cruz 7500 Santa Rosa CA Sonoma 8720 Vallejo-Fairfield-Napa, CA CA Napa; CA Solano Non-SMSA Counties: CA Lake; CA Mendocino; CA San Benito	28.9 25.6 19.6 14.9 9.1 17.1 23.2
177	Sacramento, CA: SMSA Counties: 6920 Sacramento, CA CA Placer; CA Sacramento; CA Yolo Non-SMSA Counties CA Butte; CA Colusa; CA El Dorado; CA Glenn; CA Nevada; CA Sierra; CA Sutter; CA Yuba	16.1 14.3
178	Stockton-Modesto, CA: SMSA Counties: 5170 Modesto, CA CA Stanislaus 8120 Stockton, CA CA San Joaquin Non-SMSA Counties CA Alpine; CA Amador; CA Calaveras; CA Mariposa; CA Merced; CA Toulumne	12.3 24.3 19.8
179	Fresno-Bakersfield, CA SMSA Counties: 0680 Bakersfield, CA CA Kern 2840 Fresno, CA CA Fresno Non-SMSA Counties:	19.1 26.1 23.6
14	CA Kings; CA Madera; CA Tulare	

180	Los Angeles, CA: SMSA Counties: 0360 Anaheim-Santa Ana-Garden Grove, CA CA Orange 4480 Los Angeles-Long Beach, CA CA Los Angeles 6000 Oxnard-Simi Valley-Ventura, CA CA Ventura 6780 Riverside-San Bernardino-Ontario, CA CA Riverside; CA San Bernardino 7480 Santa Barbara-Santa Maria-Lompoc, CA CA Santa Barbara Non-SMSA Counties CA Inyo; CA Mono; CA San Luis Obispo	11.9 28.3 21.5 19.0 19.7 24.6
181	San Diego, CA: SMSA Counties 7320 San Diego, CA CA San Diego Non-SMSA Counties CA Imperial	16.9 18.2

For each July during which work is performed under the contract, you and each non-material-supplier subcontractor with a subcontract of \$10,000 or more must complete Form FHWA PR-1391 (Appendix C to 23 CFR 230). Submit the forms by August 15.

Federal Trainee Program

For the Federal training program, the number of trainees or apprentices is _____.

This section applies if a number of trainees or apprentices is specified in the special provisions.

As part of your equal opportunity affirmative action program, provide on-the-job training to develop full journeymen in the types of trades or job classifications involved.

You have primary responsibility for meeting this training requirement.

If you subcontract a contract part, determine how many trainees or apprentices are to be trained by the subcontractor.

Include these training requirements in your subcontract.

Where feasible, 25 percent of apprentices or trainees in each occupation must be in their 1st year of apprenticeship or training.

Distribute the number of apprentices or trainees among the work classifications on the basis of your needs and the availability of journeymen in the various classifications within a reasonable recruitment area.

Before starting work, submit to the City/County of _____:

1. Number of apprentices or trainees to be trained for each classification
2. Training program to be used
3. Training starting date for each classification

Obtain the City/County's of _____ approval for this submitted information before you start work. The City/County of _____ credits you for each apprentice or trainee you employ on the work who is currently enrolled or becomes enrolled in an approved program.

The primary objective of this section is to train and upgrade minorities and women toward journeymen status. Make every effort to enroll minority and women apprentices or trainees, such as conducting systematic and direct recruitment through public and private sources likely to yield minority and women apprentices or

trainees, to the extent they are available within a reasonable recruitment area. Show that you have made the efforts. In making these efforts, do not discriminate against any applicant for training.

Do not employ as an apprentice or trainee an employee:

1. In any classification in which the employee has successfully completed a training course leading to journeyman status or in which the employee has been employed as a journeyman
2. Who is not registered in a program approved by the US Department of Labor, Bureau of Apprenticeship and Training

Ask the employee if the employee has successfully completed a training course leading to journeyman status or has been employed as a journeyman. Your records must show the employee's answers to the questions.

In your training program, establish the minimum length and training type for each classification. The City/County of _____ and FHWA approves a program if one of the following is met:

1. It is calculated to:
 - Meet the your equal employment opportunity responsibilities
 - Qualify the average apprentice or trainee for journeyman status in the classification involved by the end of the training period
2. It is registered with the U.S. Department of Labor, Bureau of Apprenticeship and Training, and it is administered in a way consistent with the equal employment responsibilities of Federal-aid highway construction contracts

Obtain the State's approval for your training program before you start work involving the classification covered by the program.

Provide training in the construction crafts, not in clerk-typist or secretarial-type positions. Training is allowed in lower level management positions such as office engineers, estimators, and timekeepers if the training is oriented toward construction applications. Training is allowed in the laborer classification if significant and meaningful training is provided and approved by the division office. Off-site training is allowed if the training is an integral part of an approved training program and does not make up a significant part of the overall training.

The City/County of _____ reimburses you 80 cents per hour of training given an employee on this contract under an approved training program:

1. For on-site training
2. For off-site training if the apprentice or trainee is currently employed on a Federal-aid project and you do at least one of the following:
 - Contribute to the cost of the training
 - Provide the instruction to the apprentice or trainee
 - Pay the apprentice's or trainee's wages during the off-site training period
3. If you comply this section.

Each apprentice or trainee must:

1. Begin training on the project as soon as feasible after the start of work involving the apprentice's or trainee's skill
2. Remain on the project as long as training opportunities exist in the apprentice's or trainee's work classification or until the apprentice or trainee has completed the training program

Furnish the apprentice or trainee:

1. Copy of the program you will comply with in providing the training
2. Certification showing the type and length of training satisfactorily completed

Title VI Assurances

During the performance of this Agreement, the contractor, for itself, its assignees and successors in interest (hereinafter collectively referred to as CONTRACTOR) agrees as follows:

- (1) Compliance with Regulations: CONTRACTOR shall comply with the regulations relative to nondiscrimination in federally assisted programs of the Department of Transportation, Title 49, Code of Federal Regulations, Part 21, as they may be amended from time to time, (hereinafter referred to as the REGULATIONS), which are herein incorporated by reference and made a part of this agreement.
- (2) Nondiscrimination: CONTRACTOR, with regard to the work performed by it during the AGREEMENT, shall not discriminate on the grounds of race, color, sex, national origin, religion, age, or disability in the selection and retention of sub-applicants, including procurements of materials and leases of equipment. CONTRACTOR shall not participate either directly or indirectly in the discrimination prohibited by Section 21.5 of the Regulations, including employment practices when the agreement covers a program set forth in Appendix B of the Regulations.
- (3) Solicitations for Sub-agreements, Including Procurements of Materials and Equipment: In all solicitations either by competitive bidding or negotiation made by CONTRACTOR for work to be performed under a Sub-agreement, including procurements of materials or leases of equipment, each potential sub-applicant or supplier shall be notified by CONTRACTOR of the CONTRACTOR'S obligations under this Agreement and the Regulations relative to nondiscrimination on the grounds of race, color, or national origin.
- (4) Information and Reports: CONTRACTOR shall provide all information and reports required by the Regulations, or directives issued pursuant thereto, and shall permit access to its books, records, accounts, other sources of information, and its facilities as may be determined by the California Department of Transportation or FHWA to be pertinent to ascertain compliance with such Regulations or directives. Where any information required of CONTRACTOR is in the exclusive possession of another who fails or refuses to furnish this information, CONTRACTOR shall so certify to the California Department of Transportation or the FHWA as appropriate, and shall set forth what efforts CONTRACTOR has made to obtain the information.
- (5) Sanctions for Noncompliance: In the event of CONTRACTOR'S noncompliance with the nondiscrimination provisions of this agreement, the California Department of Transportation shall impose such agreement sanctions as it or the FHWA may determine to be appropriate, including, but not limited to:
 - (a) withholding of payments to CONTRACTOR under the Agreement within a reasonable period of time, not to exceed 90 days; and/or
 - (b) cancellation, termination or suspension of the Agreement, in whole or in part.
- (6) Incorporation of Provisions: CONTRACTOR shall include the provisions of paragraphs (1) through (6) in every sub-agreement, including procurements of materials and leases of equipment, unless exempt by the Regulations, or directives issued pursuant thereto.

CONTRACTOR shall take such action with respect to any sub-agreement or procurement as the California Department of Transportation or FHWA may direct as a means of enforcing such provisions including sanctions for noncompliance, provided, however, that, in the event CONTRACTOR becomes involved in, or is threatened with, litigation with a sub-applicant or supplier as a result of such direction, CONTRACTOR may request the California Department of Transportation enter into such litigation to protect the interests of the State, and, in addition, CONTRACTOR may request the United States to enter into such litigation to protect the interests of the United States.

MAINTAIN RECORDS AND SUBMIT REPORTS DOCUMENTING YOUR PERFORMANCE UNDER THIS SECTION

8 PROSECUTION AND PROGRESS

Replace section 8-1.04B, paragraph 1&2:

The Contractor shall begin work within fifteen calendar days after the contract has been executed by the Board of Supervisors of the County of Humboldt, provided he has received a written "Notice to Proceed" from the Engineer in accordance with Section 4 of the contract Agreement.

Replace section 8-1.05, paragraph 2:

Said work shall be diligently prosecuted to completion before the expiration of:

40 WORKING DAYS

Tabulation of working days shall begin on the fifteenth calendar day after execution of the contract by the Board of Supervisors of the County of Humboldt. If said fifteenth calendar day falls on a Saturday, Sunday, or legal Holiday, then the first working day for beginning tabulation will be the first working day prior to said Saturday, Sunday or Holiday.

Replace section 8-1.10A, paragraph 1:

The County of Humboldt specifies liquidated damages (Pub Cont Code § 10226). Liquidated damages, if any, accrue starting on the 1st day after the expiration of the working days through the day of Contract acceptance except as specified in sections 8-1.08B and 8-1.08C.

See the table in Section 8-1.10A of the Standard Specifications for liquidated damages pertaining to this project.

Neither the Contract, nor any moneys due or to become due under the Contract, may be assigned by the Contractor without the prior consent of the Contractor's surety or sureties, unless such surety or sureties have waived their right to notice of assignment. The performance of the Contract may not be assigned without prior written consent of the County of Humboldt.

^^

9 PAYMENT

Add to section 9-1.03:

Prompt Payment of Funds Withheld from Subcontractors

A prime contractor or subcontractor shall pay to any subcontractor not later 10 days of receipt of each progress payment in accordance with the provision in Section 7108.5 of the California Business and Professions Code concerning prompt payment to subcontractors. The 10-days is applicable unless a longer period is agreed to in writing. Any delay or postponement of payment over 30 days may take place only for good cause and with the agency's prior written approval. Any violation of Section 7108.5 shall subject the violating contractor or subcontractor to the penalties, sanctions, and other remedies of that Section. This requirement shall not be construed to limit or impair any contractual, administrative, or judicial remedies, otherwise available to the contractor or subcontractor in the event of a dispute involving late payment or nonpayment by the contractor, deficient subcontractor performance, and/or noncompliance by a subcontractor. This clause applies to both DBE and non-DBE subcontractors.

Replace section 9-1.16F:

No retainage will be held by the agency from progress payments due to the prime contractor. Prime contractors and subcontractors are prohibited from holding retainage from subcontractors. Any delay or postponement of payment may take place only for good cause and with the agency's prior written approval. Any violation of these provisions shall subject the violating contractor or subcontractor to the penalties, sanctions, and other remedies specified in Section 7108.5 of the California Business and Professions Code. This requirement shall not be construed to limit or impair any contractual, administrative, or judicial remedies, otherwise available to the contractor or subcontractor in the event of a dispute involving late payment or nonpayment by the contractor, deficient subcontractor performance, and/or noncompliance by a subcontractor. This clause applies to both DBE and non-DBE subcontractors

Replace section 9-1.17B:

After Contract acceptance by the Board of Supervisors of the County of Humboldt, the Department pays you based on the Engineer-prepared estimate that includes withholds and the balance due after deduction of previous payments.

[illegible]

DIVISION II GENERAL CONSTRUCTION

12 TEMPORARY TRAFFIC CONTROL

Replace section 12-5:

12-5 TRAFFIC CONTROL SYSTEM FOR LANE CLOSURE

12-5.01 GENERAL

Section 12-5 includes specifications for closing traffic lanes with stationary lane closures on 2-lane, 2-way highways. The traffic control system for a lane closure must comply with the details shown.

Traffic control system includes signs.

12-5.03 CONSTRUCTION

12-5.03A General

During traffic striping and pavement marker placement using bituminous adhesive, control traffic with a stationary or a moving lane closure. During other activities, control traffic with stationary lane closures.

Whenever components of the traffic control system are displaced or cease to operate or function as specified from any cause, immediately repair the components to the original condition or replace the components and restore the components to the original location.

The Contractor shall notify the appropriate regional notification center for operators of subsurface installations at least 2 business days, but not more than 14 days, prior to commencing excavation for

construction area sign posts. The regional notification centers include, but are not limited to, the following:

Notification Center	Telephone Number
Underground Service Alert	811 1-800-227-2600

12-5.03B Stationary Lane Closures

For a stationary lane closure made only for the work period, remove the components of the traffic control system from the traveled way and shoulder, except for portable delineators placed along open trenches or excavation adjacent to the traveled way at the end of each work period. You may store the components at selected central locations designated by the Engineer within the limits of the highway.

Flagging shall conform to the provisions in Section 12-1, "General," of the Standard Specifications, except that the provision in Section 12-1.04, "Payment," providing for flagging costs to be borne equally by the State and the Contractor will not apply. All flagging costs will be borne totally by the Contractor. If it is determined by the Engineer that the amount of flagging is insufficient for the traffic conditions, all work involving public traffic shall be halted until the Contractor provides the necessary flagging.

12-5.04 PAYMENT

The contract lump sum price paid for Traffic Control System includes full compensation for furnishing all labor (including all flagging costs), materials, tools, equipment and incidentals, and for doing all the work involved in placing, removing, storing, maintaining, moving to new locations, replacing, and disposing of the components of the traffic control system, as specified in the Standard Specifications and these special provisions, and as directed by the Engineer.

The adjustment provisions in Section 4-1.05, "Changes and Extra Work," of the Standard Specifications, shall not apply to the item of traffic control system. Adjustments in compensation for traffic control system will be made only for increased or decreased traffic control system required by changes ordered by the Engineer and will be made on the basis of the cost of the increased or decreased traffic control necessary. Such adjustment will be made on a force account basis as provided in Section 9-1.04, "Force Account," of the Standard Specifications for increased work, and estimated on the same basis in the case of decreased work.

Traffic control system required by work classified as extra work, as provided in Section 4-1.05 of the Standard Specifications, will be paid for as Extra Work.

AA

13 WATER POLLUTION CONTROL

Insert into section 13-1.01:

Preliminary calculations by the Engineer indicate that the project's disturbed soil area is 0.6 acres not including stockpile or Contractor's staging area.

on and embankment
existing vegetation
by the Engineer.

areas that are
damage resulting
limits are not to be

ay. Comply with

disposed of outside
Standard

gineer:

Replace Section 39 Asphalt Concrete with Section 39 Hot Mix Asphalt, Standard Specifications 2010

Add to section 39-1.01 (2010 Std. Specs):

Produce and place HMA Type A under the METHOD construction process.

Add to section 39-1.02C (2010 Std. Specs):

Asphalt binder used in HMA Type A must be PG 64-16.

Add to section 39-1.02E (2010 Std. Specs):

Aggregate used in HMA Type A must comply with the 1/2-inch HMA Types A and B gradation.

^^

DIVISION IX TRAFFIC CONTROL DEVICES

83 RAILINGS AND BARRIERS

Replace section 83-2.04C with:

83-2.04C Alternative Flared Terminal System

Alternative flared terminal system must be furnished and installed as shown on the plans and under these special provisions.

The allowable alternatives for a flared terminal system must consist of one of the following or a Department-authorized equal.

1. **TYPE FLEAT TERMINAL SYSTEM** - Type FLEAT terminal system must be a Flared Energy Absorbing Terminal 350 manufactured by Road Systems, Inc., located in Big Spring, Texas, and must include items detailed for Type FLEAT terminal system shown on the plans. The Flared Energy Absorbing Terminal 350 can be obtained from the distributor, Universal Industrial Sales, P.O. Box 699, Pleasant Grove, UT 84062, telephone (801) 785-0505 or from the distributor, Gregory Industries, Inc., 4100 13th Street, S.W., Canton, OH 44708, telephone (330) 477-4800.
2. **TYPE SRT TERMINAL SYSTEM** - Type SRT terminal system must be an SRT-350 Slotted Rail Terminal (8-post system) as manufactured by Trinity Highway Products, LLC, and must include items detailed for Type SRT terminal system shown on the plans. The SRT-350 Slotted Rail Terminal (8-post system) can be obtained from the manufacturer, Trinity Highway Products, LLC, P.O. Box 99, Centerville, UT 84012, telephone (800) 772-7976.

Submit a certificate of compliance for terminal systems.

Terminal systems must be installed under the manufacturer's installation instructions and these specifications. Each terminal system installed must be identified by painting the type of terminal system

in neat black letters and figures 2 inches high on the backside of the rail element between system posts numbers 4 and 5.

For Type SRT terminal system, the steel foundation tubes with soil plates attached must be, at the Contractor's option, either driven, with or without pilot holes, or placed in drilled holes. Space around the steel foundation tubes must be backfilled with selected earth, free of rock, placed in layers approximately 4 inches thick and each layer must be moistened and thoroughly compacted. The wood terminal posts must be inserted into the steel foundation tubes by hand and must not be driven. Before the wood terminal posts are inserted, the inside surfaces of the steel foundation tubes to receive the wood posts must be coated with a grease that will not melt or run at a temperature of 149 degrees F or less. The edges of the wood terminal posts may be slightly rounded to facilitate insertion of the post into the steel foundation tubes.

For Type FLEAT terminal system, the soil tubes must be, at the Contractor's option, driven with or without pilot holes, or placed in drilled holes. Space around the steel foundation tubes must be backfilled with selected earth, free of rock, placed in layers approximately 4 inches thick and each layer must be moistened and thoroughly compacted. Wood posts must be inserted into the steel foundation tubes by hand. Before the wood terminal posts are inserted, the inside surfaces of the steel foundation tubes to receive the wood posts must be coated with a grease that will not melt or run at a temperature of 149 degrees F or less. The edges of the wood posts may be slightly rounded to facilitate insertion of the post into the steel foundation tubes.

After installing the terminal system, dispose of surplus excavated material in a uniform manner along the adjacent roadway where designated by the Engineer.

~~~~~



**PROPOSAL**  
**TO**  
**THE COUNTY OF HUMBOLDT**  
**FOR**

**EARTHQUAKE DAMAGE REPAIRS TO MATTOLE**  
**ROAD (3C010) AT P.M. 43.17**  
**PROJECT NO.: ER 4820 (004)**  
**CONTRACT NO.: 210207**

Name of Bidder: \_\_\_\_\_  
(Name must be exactly as it appears [or will appear] on Contractor's license)

Business Address: \_\_\_\_\_  
\_\_\_\_\_

Telephone No.: \_\_\_\_\_

Place of Residence: \_\_\_\_\_

The work for which this proposal is submitted is for construction in accordance with the special provisions (including the payment of not less than the State general prevailing wage rates or Federal minimum wage rates), the project plans described above, including any addenda thereto, the contract annexed hereto and also in accordance with the California Department of Transportation Standard Plans dated 2015, the Standard Specifications dated 2015, and the Labor Surcharge and Equipment Rental Rates in effect at the time the work is performed.

Bids are to be submitted for the entire work. The amount of the bid for comparison purposes will be the total of all items.

The bidder shall set forth for each unit basis item of work a unit price and a total for the item, and for each lump sum item a total for the item, all in clearly legible figures in the respective spaces provided for that purpose. In the case of unit basis items, the amount set forth under the "Item Total" column shall be the product of the unit price bid and the estimated quantity for the item.

In case of discrepancy between the unit price and the total set forth for a unit basis item, the unit price shall prevail, except as provided in (a) or (b), as follows:

- (a) If the amount set forth as a unit price is unreadable or otherwise unclear, or is omitted, or is the same as the amount as the entry in the item total column, then the amount set forth in the item total column for the item shall prevail and shall be divided by the estimated quantity for the item and the price thus obtained shall be the unit price;
- (b) (Decimal Errors) If the product of the entered unit price and the estimated quantity is exactly off by a factor of ten, one hundred, etc., or one-tenth, or one-hundredth, etc. from the entered total, the discrepancy will be resolved by using the entered unit price or item total, whichever most closely approximates percentagewise the unit price or item total in the County of Humboldt's Final Estimate of cost.

If both the unit price and the item total are unreadable or otherwise unclear, or are omitted, the bid may be deemed irregular. Likewise if the item total for a lump sum item is unreadable or otherwise unclear, or is omitted, the bid may be deemed irregular unless the project being bid has only a single item and a clear, readable total bid is provided.

Symbols such as commas and dollar signs will be ignored and have no mathematical significance in establishing any unit price or item total or lump sums. Written unit prices, item totals and lump sums will be interpreted according to the number of digits and, if applicable, decimal placement. Cents symbols also have no significance in establishing any unit price or item total since all figures are assumed to be expressed in dollars and/or decimal fractions of a dollar. Bids on lump sum items shall be item totals only; if any unit price for a lump sum item is included in a bid and it differs from the item total, the items total shall prevail.

The foregoing provisions for the resolution of specific irregularities cannot be so comprehensive as to cover every omission, inconsistency, error or other irregularity which may occur in a bid. Any situation not specifically provided for will be determined in the discretion of the County of Humboldt, and that discretion will be exercised in the manner deemed by the County of Humboldt to best protect the public interest in the prompt and economical completion of the work. The decision of the County of Humboldt respecting the amount of a bid, or the existence or treatment of an irregularity in a bid, shall be final.

If this proposal shall be accepted and the undersigned shall fail to enter into the contract and furnish the 2 bonds in the sums required by the State Contract Act, with surety satisfactory to the County of Humboldt, within 8 days, not including Saturdays, Sundays and legal holidays, after the bidder has received notice from the County of Humboldt that the contract has been awarded, the County of Humboldt may, at its option, determine that the bidder has abandoned the contract, and thereupon this proposal and the acceptance thereof shall be null and void and the forfeiture of the security accompanying this proposal shall operate and the same shall be the property of the County of Humboldt.

The undersigned, as bidder, declares that the only persons or parties interested in this proposal as principals are those named herein; that this proposal is made without collusion with any other person, firm, or corporation; that he has carefully examined the location of the proposed work, the annexed proposed form of contract, and the plans therein referred to; and he proposes, and agrees if this proposal is accepted, that he will contract with the County of Humboldt, in the form of the copy of the contract annexed hereto, to provide all necessary machinery, tools, apparatus and other means of construction, and to do all the work and furnish all the materials specified in the contract, in the manner and time therein prescribed, and according to the requirements of the Engineer as therein set forth, and that he will take in full payment therefor the following prices, to wit:

**BID FORM (EXHIBIT A)**  
**EARTHQUAKE DAMAGE REPAIRS TO MATTOLE ROAD**  
**(3C010) AT P.M. 43.17**  
**PROJECT NO.: ER 4820 (004)**  
**CONTRACT NO.: 210207**

| ITEM NO.                                                 | ITEM CODE | ITEM DESCRIPTION                                             | UNIT             | QUANTITY | UNIT PRICE | TOTAL  |
|----------------------------------------------------------|-----------|--------------------------------------------------------------|------------------|----------|------------|--------|
| 1                                                        | 120090    | Construction Area Signs                                      | EA               | 8        |            |        |
| 2                                                        | 120100    | Traffic Control System                                       | LS               | 1        |            |        |
| 3                                                        | 129000    | Temporary Railing (Type K)                                   | LF               | 240      |            |        |
| 4                                                        | 130100    | Construction Area Signs                                      | LS               | 1        | EA         | 8      |
| 5                                                        | 130200    | Prepare Water Pollution Control Program                      | LS               | 1        | LS         | 1      |
| 6                                                        | 130680    | Temporary Silt Fence                                         | LF               | 525      | LF         | 240    |
| 7                                                        | 160102    | Clearing and Grubbing (LS)                                   | LS               | 1        |            |        |
| 8                                                        | 190101    | Roadway Excavation                                           | CY               | 5,485    | LS         | 1      |
| 9                                                        | 198050    | Embankment                                                   | CY               | 850      | LS         | 1      |
| 10                                                       | 210350    | Fiber Roll                                                   | LF               | 400      | LF         | 525    |
| 11                                                       | 210430    | Hydroseed                                                    | SF               | 17,500   | LS         | 1      |
| 12                                                       | 260203    | Class 2 Aggregate Base (CY)                                  | CY               | 325      | CY         | 5,485  |
| 13                                                       | 390132    | Hot Mix Asphalt (Type A)                                     | TON              | 260      | CY         | 850    |
| 14                                                       | 394070    | Place HMA Dike (Type C & F)                                  | LF               | 260      |            |        |
| 15                                                       | 820108    | Delineator (Class 2)                                         | EA               | 7        | LF         | 400    |
| 16                                                       | 832001    | Metal Beam Guard Railing                                     | LF               | 100      | SF         | 17,500 |
| 17                                                       | 839585    | Alternative Flared Terminal System                           | EA               | 2        | CY         | 325    |
| 18                                                       | 840502    | Thermoplastic Traffic Stripe (Enhanced Wet Night Visibility) | LF               | 1,600    |            |        |
| 19                                                       | 999990    | Mobilization                                                 | LS               | 1        | TON        | 260    |
| NOTE: ITEM CODE LETTER DESIGNATION: F=FINAL PAY QUANTITY |           |                                                              |                  |          |            |        |
| 14                                                       | 394070    | Place HMA Dike (Type C & F)                                  |                  |          | LF         | 260    |
| 15                                                       | 820108    | Delineator (Class 2)                                         | <b>BID TOTAL</b> |          | EA         | 7      |
| 16                                                       | 832001    | Metal Beam Guard Railing                                     |                  |          | LF         | 100    |
| 17                                                       | 839585    | Alternative Flared Terminal System                           |                  |          | EA         | 2      |
| 18                                                       | 840502    | Thermoplastic Traffic Stripe (Enhanced Wet Night Visibility) |                  |          | LF         | 1,600  |
| 19                                                       | 999990    | Mobilization                                                 |                  |          | LS         | 1      |

**BID TOTAL**

ACKNOWLEDGEMENT OF ADDENDA

ADDENDUM NO.

INITIAL

\_\_\_\_\_  
\_\_\_\_\_  
\_\_\_\_\_

\_\_\_\_\_  
\_\_\_\_\_  
\_\_\_\_\_

\_\_\_\_\_  
*(Bidder's Signature)*

\_\_\_\_\_  
*(Title)*

## PROPOSAL SIGNATURE PAGE

Accompanying this proposal is \_\_\_\_\_

*(NOTICE: INSERT THE WORDS "CASH (\$\_\_\_)", "CASHIER'S CHECK",  
"CERTIFIED CHECK", OR "BIDDERS'S BOND", AS THE CASE MAY BE.)*

in the amount of at least **TEN PERCENT (10%)** of the total bid.

The names of all persons interested in the foregoing proposal as Principals are as follows:

\_\_\_\_\_

*(NOTE: If a Bidder or other interested person is a Corporation, state the legal name of the corporation, also names of the president, secretary, treasurer, and manager thereof; if a Co-partnership, state the true name of the firm, also state the names of all individual copartners composing the firm; if the Bidder or other interested person is an Individual, state the first and last names in full.)*

Licensed in accordance with an act providing for the registration of Contractors,

**LICENSE NO.** \_\_\_\_\_ **Classification(s)** \_\_\_\_\_

Note: It is optional to provide your contractors license number at this time. You are not required to provide your contractors license number until the time that the contract is to be awarded.

By my signature on this proposal I certify, under penalty of perjury under the laws of the State of California, that the foregoing questionnaire and statements of Public Contract Code Sections 10162, 10232 and 10285.1 are true and correct and that the bidder has complied with the requirements of Section 8103 of the Fair Employment and Housing Commission Regulations (Chapter 5, Title 2 of the California Administrative Code). By my signature on this proposal I further certify, under penalty of perjury under the laws of the State of California and the United States of America, that the Noncollusion Affidavit required by Title 23 United States Code, Section 112 and Public Contract Code Section 7106; and the Title 49 Code of Federal Regulations, Part 29 Debarment and Suspension Certification are true and correct.

Date: \_\_\_\_\_



\_\_\_\_\_  
\_\_\_\_\_  
\_\_\_\_\_

*Signature and Title of Bidder*

Bidder's Business Address \_\_\_\_\_

\_\_\_\_\_

Place of Residence \_\_\_\_\_

**BIDDER'S BOND**  
**COUNTY OF HUMBOLDT, DEPARTMENT OF PUBLIC WORKS**  
**EARTHQUAKE DAMAGE REPAIRS TO MATTOLE ROAD**  
**(3C010) AT P.M. 43.17**  
**PROJECT NO.: ER 4820 (004)**  
**CONTRACT NO.: 210207**

for which bids are to be opened on **TUESDAY**, April 25, 2017, at 2:00 PM, in the Office of the Clerk of the Board, Humboldt County Courthouse, in Eureka, California.

Know all men by these presents: That we \_\_\_\_\_

\_\_\_\_\_, as

**PRINCIPAL**, and \_\_\_\_\_,

as **SURETY**, are held and firmly bound unto the County of Humboldt in the penal sum of **TEN PERCENT (10%) OF THE TOTAL AMOUNT OF THE BID** of the **PRINCIPAL** named above, submitted by said **PRINCIPAL** to the County of Humboldt for the work described above, for the payment of which sum is lawful money of the United States, well and truly to be made, to the Director of the Department to which said bid was submitted, we bind ourselves, our heirs, executors, administrators and successors, jointly and severally, firmly by these presents. In no case shall the liability of the **SURETY** hereunder exceed the sum of:  
\$ \_\_\_\_\_

**THE CONDITION OF THIS OBLIGATION IS SUCH**, that whereas the **PRINCIPAL** has submitted the above mentioned bid to the County of Humboldt, as aforesaid, for the construction as specifically described above,

**NOW, THEREFORE**, if the aforesaid **PRINCIPAL** is awarded the contract, and within the time and manner required under the Specifications, after the prescribed forms are presented to him for signature, enters into a written contract, in the prescribed form, in accordance with the bid, and files two bonds with the Department, one to guarantee faithful performance and the other to guarantee payment for labor and materials, as required by law, then this obligation shall be null and void; otherwise, it shall be and remain in full force and virtue.

**IN WITNESS WHEREOF**, we have hereunto set our hands and seals on this

\_\_\_\_\_ day of \_\_\_\_\_, 20\_\_\_\_.

\_\_\_\_\_ (seal)

\_\_\_\_\_ (seal)

**PRINCIPAL**

\_\_\_\_\_ (seal)

\_\_\_\_\_ (seal)

**SURETY**

Address: \_\_\_\_\_

Note: Signatures of those executing for **SURETY** must be properly acknowledged.

## CONTRACTOR'S CERTIFICATE REGARDING WORKER'S COMPENSATION

### Labor Code Section 3700.

"Every employer except the State and all political subdivisions or institutions thereof, shall secure the payment of compensation in one or more of the foregoing ways:

- A. By being insured against liability to pay compensation by one or more insurers duly authorized to write compensation insurance in this State.
- B. By securing from the Director of Industrial Relations a certificate of consent of self-insure, which may be given upon furnishing proof satisfactory to the Director of Industrial Relations of ability to self-insure and to pay any compensation that may become due to his employees."

I am aware of the provisions of Section 3700 of the Labor Code which requires every employer to be insured against liability for worker's compensation or to undertake self-insurance in accordance with the provisions of that code, and that I will comply with such provisions before commencing the performance of the work of this contract.

**Sign**  
  
**Here**

---

---

---

(In accordance with Article 5 [commencing at Section 1860 ], Chapter 1 , Part 7 , Division 2 , of the Labor Code, the above certificate must be signed and filed with the awarding body prior to commencing any work under this contract. )

### PUBLIC CONTRACT CODE SECTION 10285.1 STATEMENT

In conformance with Public Contract Code Section 10285.1 (Chapter 376, Stats. 1985), the bidder hereby declares under penalty of perjury under the laws of the State of California that the bidder has \_\_\_\_, has not \_\_\_\_ been convicted within the preceding three years of any offenses referred to in that section, including any charge of fraud, bribery, collusion, conspiracy, or any other act in violation of any state or Federal antitrust law in connection with the bidding upon, award of, or performance of, any public works contract, as defined in Public Contract Code Section 1101, with any public entity, as defined in Public Contract Code Section 1100, including the Regents of the University of California or the Trustees of the California State University. The term "bidder" is understood to include any partner, member, officer, director, responsible managing officer, or responsible managing employee thereof, as referred to in Section 10285.1.

Note: The bidder must place a check mark after "has" or "has not" in one of the blank spaces provided. The above Statement is part of the Proposal. Signing this Proposal on the signature portion thereof shall also constitute signature of this Statement. Bidders are cautioned that making a false certification may subject the certifier to criminal prosecution.

## **PUBLIC CONTRACT CODE SECTION 10162 QUESTIONNAIRE**

In conformance with Public Contract Code Section 10162, the Bidder shall complete, under penalty of perjury, the following questionnaire:

Has the bidder, any officer of the bidder, or any employee of the bidder who has a proprietary interest in the bidder, ever been disqualified, removed, or otherwise prevented from bidding on, or completing a federal, state, or local government project because of a violation of law or a safety regulation?

YES ☐ NO ☐

If the answer is yes, explain the circumstances in the following space.

## **PUBLIC CONTRACT CODE SECTION 10232 STATEMENT**

In conformance with Public Contract Code Section 10232, the Contractor, hereby states under penalty of perjury, that no more than one final unappealable finding of contempt of court by a federal court has been issued against the Contractor within the immediately preceding two-year period because of the Contractor's failure to comply with an order of a federal court which orders the Contractor to comply with an order of the National Labor Relations Board.

**Note:** The above Statement and Questionnaire are part of the Proposal. Signing this Proposal on the signature portion thereof shall also constitute signature of this Statement and Questionnaire. Bidders are cautioned that making a false certification may subject the certifier to criminal prosecution.



## **DEBARMENT AND SUSPENSION CERTIFICATION**

### **TITLE 49, CODE OF FEDERAL REGULATIONS, PART 29**

The bidder, under penalty of perjury, certifies that, except as noted below, he/she or any other person associated therewith in the capacity of owner, partner, director, officer, manager:

- is not currently under suspension, debarment, voluntary exclusion, or determination of ineligibility by any Federal agency;
- has not been suspended, debarred, voluntarily excluded or determined ineligible by any Federal agency within the past 3 years;
- does not have a proposed debarment pending; and
- has not been indicted, convicted, or had a civil judgement rendered against it by a court of competent jurisdiction in any matter involving fraud or official misconduct within the past 3 years.

If there are any exceptions to this certification, insert the exceptions in the following space.

Exceptions will not necessarily result in denial of award, but will be considered in determining bidder responsibility. For any exception noted above, indicate below to whom it applies, initiating agency, and dates of action.

Notes: Providing false information may result in criminal prosecution or administrative sanctions. The above certification is part of the Proposal. Signing this Proposal on the signature portion thereof shall also constitute signature of this Certification.

*(THE BIDDER'S EXECUTION ON THE SIGNATURE PORTION OF THIS PROPOSAL SHALL ALSO CONSTITUTE AN ENDORSEMENT AND EXECUTION OF THOSE CERTIFICATIONS WHICH ARE A PART OF THIS PROPOSAL)*

## **EQUAL EMPLOYMENT OPPORTUNITY CERTIFICATION**

The bidder \_\_\_\_\_, proposed subcontractor \_\_\_\_\_, hereby certifies that he has \_\_\_\_\_, has not \_\_\_\_\_, participated in a previous contract or subcontract subject to the equal opportunity clauses, as required by Executive Orders 10925, 11114, or 11246, and that, where required, he has filed with the Joint Reporting Committee, the Director of the Office of Federal Contract Compliance, a Federal Government contracting or administering agency, or the former President's Committee on Equal Employment Opportunity, all reports due under the applicable filing requirements.

**Note:** The above certification is required by the Equal Employment Opportunity Regulations of the Secretary of Labor (41 CFR 60-1.7(b) (1)), and must be submitted by bidders and proposed subcontractors only in connection with contracts and subcontracts which are subject to the equal opportunity clause. Contracts and subcontracts which are exempt from the equal opportunity clause are set forth in 41 CFR 60-1.5. (Generally only contracts or subcontracts of \$10,000 or under are exempt.)

Currently, Standard Form 100 (EEO-1) is the only report required by the Executive Orders or their implementing regulations.

Proposed prime contractors and subcontractors who have participated in a previous contract or subcontract subject to the Executive Orders and have not filed the required reports should note that 41 CFR 60-1.7(b) (1) prevents the award of contracts and subcontracts unless such contractor submits a report covering the delinquent period or such other period specified by the Federal Highway Administration or by the Director, Office of Federal Contract Compliance, U.S. Department of Labor.

## **NONCOLLUSION AFFIDAVIT**

(Title 23 United States Code Section 112 and  
Public Contract Code Section 7106)

To the COUNTY OF HUMBOLDT, DEPARTMENT OF PUBLIC WORKS:

In conformance with Title 23 United States Code Section 112 and Public Contract Code 7106 the bidder declares that the bid is not made in the interest of, or on behalf of, any undisclosed person, partnership, company, association, organization, or corporation; that the bid is genuine and not collusive or sham; that the bidder has not directly or indirectly induced or solicited any other bidder to put in a false or sham bid, and has not directly or indirectly colluded, conspired, connived, or agreed with any bidder or anyone else to put in a sham bid, or that anyone shall refrain from bidding; that the bidder has not in any manner, directly or

indirectly, sought by agreement, communication, or conference with anyone to fix the bid price of the bidder or any other bidder, or to fix any overhead, profit, or cost element of the bid price, or of that of any other bidder, or to secure any advantage against the public body awarding the contract of anyone interested in the proposed contract; that all statements contained in the bid are true; and, further, that the bidder has not, directly or indirectly, submitted his or her bid price or any breakdown thereof, or the contents thereof, or divulged information or data relative thereto, or paid, and will not pay, any fee to any corporation, partnership, company association, organization, bid depository, or to any member or agent thereof to effectuate a collusive or sham bid.

Note: The above Noncollusion Affidavit is part of the Proposal. Signing this Proposal on the signature portion thereof shall also constitute signature of this Noncollusion Affidavit:

Bidders are cautioned that making a false certification may subject the certifier to criminal prosecution.

### **NONLOBBYING CERTIFICATION FOR FEDERAL-AID CONTRACTS**

The prospective participant certifies, by signing and submitting this bid or proposal, to the best of his or her knowledge and belief, that:

- (1) No Federal appropriated funds have been paid or will be paid, by or on behalf of the undersigned, to any person for influencing or attempting to influence an officer or employee of any Federal agency, a Member of Congress, an officer or employee of Congress, or an employee of a Member of Congress in connection with the awarding of any Federal contract, the making of any Federal grant, the making of any Federal loan, the entering into of any cooperative agreement, and the extension, continuation, renewal, amendment, or modification of any Federal contract, grant, loan, or cooperative agreement.
- (2) If any funds other than Federal appropriated funds have been paid or will be paid to any person for influencing or attempting to influence an officer or employee of any Federal agency, a Member of Congress, an officer or employee of Congress, or an employee of a Member of Congress in connection with this Federal contract, grant, loan, or cooperative agreement, the undersigned shall complete and submit Standard Form-LLL, "Disclosure of Lobbying Activities," in conformance with its instructions.

This certification is a material representation of fact upon which reliance was placed when this transaction was made or entered into. Submission of this certification is a prerequisite for making or entering into this transaction imposed by Section 1352, Title 31, U.S. Code. Any person who fails to file the required certification shall be subject to a civil penalty of not less than \$10,000 and not more than \$100,000 for each such failure.

The prospective participant also agrees by submitting his or her bid or proposal that he or she shall require that the language of this certification be included in all lower tier subcontracts, which exceed \$100,000 and that all such subrecipients shall certify and disclose accordingly.

## DISCLOSURE OF LOBBYING ACTIVITIES

Complete this form to disclose lobbying activities pursuant to 31 U.S.C. 1352

|                                                                                                                                                                                                                                                                                                                                                                                                                                                                                                                                                          |                                                                                                                                                                                                                                                                                                                           |                                                                                                                                                                                                               |
|----------------------------------------------------------------------------------------------------------------------------------------------------------------------------------------------------------------------------------------------------------------------------------------------------------------------------------------------------------------------------------------------------------------------------------------------------------------------------------------------------------------------------------------------------------|---------------------------------------------------------------------------------------------------------------------------------------------------------------------------------------------------------------------------------------------------------------------------------------------------------------------------|---------------------------------------------------------------------------------------------------------------------------------------------------------------------------------------------------------------|
| <b>1. Type of Federal Action:</b><br><input type="checkbox"/> a. contract<br><input type="checkbox"/> b. grant<br><input type="checkbox"/> c. cooperative agreement<br><input type="checkbox"/> d. loan<br><input type="checkbox"/> e. loan guarantee<br><input type="checkbox"/> f. loan insurance                                                                                                                                                                                                                                                      | <b>2. Status of Federal Action:</b><br><input type="checkbox"/> a. bid/offer/application<br><input type="checkbox"/> b. initial award<br><input type="checkbox"/> c. post-award                                                                                                                                           | <b>3. Report Type:</b><br><input type="checkbox"/> a. initial<br><input type="checkbox"/> b. material change<br><br><b>For Material Change Only:</b><br>year _____ quarter _____<br>date of last report _____ |
| <b>4. Name and Address of Reporting Entity</b><br><br><input type="checkbox"/> Prime <input type="checkbox"/> Subawardee<br>Tier _____, if known<br><br>Congressional District, if known _____                                                                                                                                                                                                                                                                                                                                                           |                                                                                                                                                                                                                                                                                                                           | <b>5. If Reporting Entity in No. 4 is Subawardee, Enter Name and Address of Prime:</b><br><br>Congressional District, if known _____                                                                          |
| <b>6. Federal Department/Agency:</b><br><br>Congressional District, if known _____                                                                                                                                                                                                                                                                                                                                                                                                                                                                       |                                                                                                                                                                                                                                                                                                                           | <b>7. Federal Program Name/Description:</b><br><br>CFDA Number, if applicable _____                                                                                                                           |
| <b>8. Federal Action Number, if known:</b>                                                                                                                                                                                                                                                                                                                                                                                                                                                                                                               |                                                                                                                                                                                                                                                                                                                           | <b>9. Award Amount, if known:</b>                                                                                                                                                                             |
| <b>10. a. Name and Address of Lobby Entity</b><br>(If individual, last name, first name, MI)                                                                                                                                                                                                                                                                                                                                                                                                                                                             |                                                                                                                                                                                                                                                                                                                           | <b>b. Individuals Performing Services</b> (including address if different from No. 10a)<br>(last name, first name, MI)                                                                                        |
| (attach Continuation Sheet(s) if necessary)                                                                                                                                                                                                                                                                                                                                                                                                                                                                                                              |                                                                                                                                                                                                                                                                                                                           |                                                                                                                                                                                                               |
| <b>11. Amount of Payment (check all that apply)</b><br>\$ _____ <input type="checkbox"/> actual <input type="checkbox"/> planned                                                                                                                                                                                                                                                                                                                                                                                                                         | <b>13. Type of Payment (check all that apply)</b><br><input type="checkbox"/> a. retainer<br><input type="checkbox"/> b. one-time fee<br><input type="checkbox"/> c. commission<br><input type="checkbox"/> d. contingent fee<br><input type="checkbox"/> e. deferred<br><input type="checkbox"/> f. other, specify _____ |                                                                                                                                                                                                               |
| <b>12. Form of Payment (check all that apply):</b><br><input type="checkbox"/> a. cash<br><input type="checkbox"/> b. in-kind; specify: nature _____<br>value _____                                                                                                                                                                                                                                                                                                                                                                                      |                                                                                                                                                                                                                                                                                                                           |                                                                                                                                                                                                               |
| <b>14. Brief Description of Services Performed or to be performed and Date(s) of Service, including officer(s), employee(s), or member(s) contacted, for Payment Indicated in Item 11:</b><br><br>(attach Continuation Sheet(s) if necessary)                                                                                                                                                                                                                                                                                                            |                                                                                                                                                                                                                                                                                                                           |                                                                                                                                                                                                               |
| <b>15. Continuation Sheet(s) attached:</b> Yes <input type="checkbox"/> No <input type="checkbox"/>                                                                                                                                                                                                                                                                                                                                                                                                                                                      |                                                                                                                                                                                                                                                                                                                           |                                                                                                                                                                                                               |
| <b>16. Information requested through this form is authorized by Title 31 U.S.C. Section 1352. This disclosure of lobbying reliance was placed by the tier above when his transaction was made or entered into. This disclosure is required pursuant to 31 U.S.C. 1352. This information will be reported to Congress semiannually and will be available for public inspection. Any person who fails to file the required disclosure shall be subject to a civil penalty of not less than \$10,000 and not more than \$100,000 for each such failure.</b> |                                                                                                                                                                                                                                                                                                                           | Signature: _____<br>Print Name: _____<br>Title: _____<br>Telephone No.: _____ Date: _____                                                                                                                     |
| <b>Federal Use Only:</b>                                                                                                                                                                                                                                                                                                                                                                                                                                                                                                                                 |                                                                                                                                                                                                                                                                                                                           | Authorized for Local Reproduction<br>Standard Form - LLL                                                                                                                                                      |

## INSTRUCTIONS FOR COMPLETION OF SF-LLL, DISCLOSURE OF LOBBYING ACTIVITIES

This disclosure form shall be completed by the reporting entity, whether subawardee or prime Federal recipient, at the initiation or receipt of covered Federal action or a material change to previous filing pursuant to title 31 U.S.C. section 1352. The filing of a form is required for such payment or agreement to make payment to lobbying entity for influencing or attempting to influence an officer or employee of any agency, a Member of Congress an officer or employee of Congress or an employee of a Member of Congress in connection with a covered Federal action. Attach a continuation sheet for additional information if the space on the form is inadequate. Complete all items that apply for both the initial filing and material change report. Refer to the implementing guidance published by the Office of Management and Budget for additional information.

1. Identify the type of covered Federal action for which lobbying activity is and/or has been secured to influence, the outcome of a covered Federal action.
2. Identify the status of the covered Federal action.
3. Identify the appropriate classification of this report. If this is a follow-up report caused by a material change to the information previously reported, enter the year and quarter in which the change occurred. Enter the date of the last, previously submitted report by this reporting entity for this covered Federal action.
4. Enter the full name, address, city, state and zip code of the reporting entity. Include Congressional District if known. Check the appropriate classification of the reporting entity that designates if it is or expects to be a prime or subaward recipient. Identify the tier of the subawardee, e.g., the first subawardee of the prime is the first tier. Subawards include but are not limited to subcontracts, subgrants and contract awards under grants.
5. If the organization filing the report in Item 4 checks "Subawardee" then enter the full name, address, city, state and zip code of the prime Federal recipient. Include Congressional District, if known.
6. Enter the name of the Federal agency making the award or loan commitment. Include at least one organization level below agency name, if known. For example, Department of Transportation, United States Coast Guard.
7. Enter the Federal program name or description for the covered Federal action (item 1). If known, enter the full Catalog of Federal Domestic Assistance (CFDA) number for grants, cooperative agreements, loans, and loan commitments.
8. Enter the most appropriate Federal identifying number available for the Federal action identification in item 1 (e.g., Request for Proposal (RFP) number, Invitation for Bid (IFB) number, grant announcement number, the contract grant or loan award number, the application/proposal control number assigned by the Federal agency). Include prefixes, e.g., "RFP-DE-90-001."
9. For a covered Federal action where there has been an award or loan commitment by the Federal agency, enter the Federal amount of the award/loan commitments for the prime entity identified in item 4 or 5.
10. (a) Enter the full name, address, city, state and zip code of the lobbying entity engaged by the reporting entity identified in item 4 to influenced the covered Federal action.  
(b) Enter the full names of the individual(s) performing services and include full address if different from 10 (a). Enter Last Name, First Name and Middle Initial (MI).
11. Enter the amount of compensation paid or reasonably expected to be paid by the reporting entity (item 4) to the lobbying entity (item 10). Indicate whether the payment has been made (actual) or will be made (planned). Check all boxes that apply. If this is a material change report, enter the cumulative amount of payment made or planned to be made.
12. Check the appropriate box(es). Check all boxes that apply. If payment is made through an in-kind contribution, specify the nature and value of the in-kind payment.
13. Check the appropriate box(es). Check all boxes that apply. If other, specify nature.
14. Provide a specific and detailed description of the services that the lobbyist has performed or will be expected to perform and the date(s) of any services rendered. Include all preparatory and related activity not just time spent in actual contact with Federal officials. Identify the Federal officer(s) or employee(s) contacted or the officer(s) employee(s) or Member(s) of Congress that were contacted.
15. Check whether or not a continuation sheet(s) is attached.
16. The certifying official shall sign and date the form, print his/her name title and telephone number.

Public reporting burden for this collection of information is estimated to average 30 minutes per response, including time for reviewing instruction, searching existing data sources, gathering and maintaining the data needed, and completing and reviewing the collection of information. Send comments regarding the burden estimate or any other aspect of this collection of information, including suggestions for reducing this burden, to the Office of Management and Budget, Paperwork Reduction Project (0348-0046), Washington, D.C. 20503.

# EXHIBIT 12-B BIDDER'S LIST OF SUBCONTRACTORS (DBE AND NON-DBE) - PART I

PROJECT NO.: ER 4820 (004)

CONTRACT NO.: 210207

As of March 1, 2015 Contractors (and sub-contractors) wishing to bid on public works contracts shall be registered with the State Division of Industrial Relations and certified to bid on Public Works contracts. Please register at: <https://efiling.dir.ca.gov/PWCR/ActionServlet?action=displayPWCRegistrationForm>

In accordance with Title 49, Section 26.11 of the Code of Federal Regulations, and Section 4104 of the Public Contract Code of the State of California, as amended, the following information is required for each sub-contractor who will perform work amounting to more than one half of one percent (0.5%) of the Total Base Bid or \$10,000 (whichever is greater). Photocopy this form for additional firms.

| Subcontractor Name and Location | Line Item & Description | Subcontract Amount | Percentage of Bid Item Sub- contracted | Contractor License Number | DBE (Y/N) | DBE Cert Number | Annual Gross Receipts                  |
|---------------------------------|-------------------------|--------------------|----------------------------------------|---------------------------|-----------|-----------------|----------------------------------------|
|                                 |                         |                    |                                        | DIR Reg Number            |           |                 |                                        |
| Name:                           |                         |                    |                                        |                           |           |                 | <input type="checkbox"/> <\$1 million  |
| City, State:                    |                         |                    |                                        |                           |           |                 | <input type="checkbox"/> <\$5 million  |
|                                 |                         |                    |                                        |                           |           |                 | <input type="checkbox"/> <\$10 million |
|                                 |                         |                    |                                        |                           |           |                 | <input type="checkbox"/> <\$15 million |
|                                 |                         |                    |                                        |                           |           |                 | Age of Firm: ____yrs.                  |
| Name:                           |                         |                    |                                        |                           |           |                 | <input type="checkbox"/> <\$1 million  |
| City, State:                    |                         |                    |                                        |                           |           |                 | <input type="checkbox"/> <\$5 million  |
|                                 |                         |                    |                                        |                           |           |                 | <input type="checkbox"/> <\$10 million |
|                                 |                         |                    |                                        |                           |           |                 | <input type="checkbox"/> <\$15 million |
|                                 |                         |                    |                                        |                           |           |                 | Age of Firm: ____yrs.                  |
| Name:                           |                         |                    |                                        |                           |           |                 | <input type="checkbox"/> <\$1 million  |
| City, State:                    |                         |                    |                                        |                           |           |                 | <input type="checkbox"/> <\$5 million  |
|                                 |                         |                    |                                        |                           |           |                 | <input type="checkbox"/> <\$10 million |
|                                 |                         |                    |                                        |                           |           |                 | <input type="checkbox"/> <\$15 million |
|                                 |                         |                    |                                        |                           |           |                 | Age of Firm: ____yrs.                  |
| Name:                           |                         |                    |                                        |                           |           |                 | <input type="checkbox"/> <\$1 million  |
| City, State:                    |                         |                    |                                        |                           |           |                 | <input type="checkbox"/> <\$5 million  |
|                                 |                         |                    |                                        |                           |           |                 | <input type="checkbox"/> <\$10 million |
|                                 |                         |                    |                                        |                           |           |                 | <input type="checkbox"/> <\$15 million |
|                                 |                         |                    |                                        |                           |           |                 | Age of Firm: ____yrs.                  |
| Name:                           |                         |                    |                                        |                           |           |                 | <input type="checkbox"/> <\$1 million  |
| City, State:                    |                         |                    |                                        |                           |           |                 | <input type="checkbox"/> <\$5 million  |
|                                 |                         |                    |                                        |                           |           |                 | <input type="checkbox"/> <\$10 million |
|                                 |                         |                    |                                        |                           |           |                 | <input type="checkbox"/> <\$15 million |
|                                 |                         |                    |                                        |                           |           |                 | Age of Firm: ____yrs.                  |
| Name:                           |                         |                    |                                        |                           |           |                 | <input type="checkbox"/> <\$1 million  |
| City, State:                    |                         |                    |                                        |                           |           |                 | <input type="checkbox"/> <\$5 million  |
|                                 |                         |                    |                                        |                           |           |                 | <input type="checkbox"/> <\$10 million |
|                                 |                         |                    |                                        |                           |           |                 | <input type="checkbox"/> <\$15 million |
|                                 |                         |                    |                                        |                           |           |                 | Age of Firm: ____yrs.                  |

Distribution: 1) Original-Local Agency File 2 ) Copy-DLAE w/ Award Package

## EXHIBIT 12-B BIDDER'S LIST OF SUBCONTRACTORS (DBE AND NON-DBE) - PART II

PROJECT NO.: ER 4820 (004) CONTRACT NO.: 210207

The bidder shall list all subcontractors who provided a quote or bid but were not selected to participate as a subcontractor on this project. This is required for compliance with Title 49, Section 26 of the Code of Federal Regulations. Photocopy this form for additional firms.

| Subcontractor Name and Location | Line Item & Description | Subcontract Amount | Percentage of Bid Item Sub- contracted | Contractor License Number<br>DIR Reg Number | DBE (Y/N) | DBE Cert Number | Annual Gross Receipts                  |
|---------------------------------|-------------------------|--------------------|----------------------------------------|---------------------------------------------|-----------|-----------------|----------------------------------------|
| Name:                           |                         |                    |                                        |                                             |           |                 | <input type="checkbox"/> <\$1 million  |
| City, State:                    |                         |                    |                                        |                                             |           |                 | <input type="checkbox"/> <\$5 million  |
|                                 |                         |                    |                                        |                                             |           |                 | <input type="checkbox"/> <\$10 million |
|                                 |                         |                    |                                        |                                             |           |                 | <input type="checkbox"/> <\$15 million |
| Age of Firm: ____yrs.           |                         |                    |                                        |                                             |           |                 |                                        |
| Name:                           |                         |                    |                                        |                                             |           |                 | <input type="checkbox"/> <\$1 million  |
| City, State:                    |                         |                    |                                        |                                             |           |                 | <input type="checkbox"/> <\$5 million  |
|                                 |                         |                    |                                        |                                             |           |                 | <input type="checkbox"/> <\$10 million |
|                                 |                         |                    |                                        |                                             |           |                 | <input type="checkbox"/> <\$15 million |
| Age of Firm: ____yrs.           |                         |                    |                                        |                                             |           |                 |                                        |
| Name:                           |                         |                    |                                        |                                             |           |                 | <input type="checkbox"/> <\$1 million  |
| City, State:                    |                         |                    |                                        |                                             |           |                 | <input type="checkbox"/> <\$5 million  |
|                                 |                         |                    |                                        |                                             |           |                 | <input type="checkbox"/> <\$10 million |
|                                 |                         |                    |                                        |                                             |           |                 | <input type="checkbox"/> <\$15 million |
| Age of Firm: ____yrs.           |                         |                    |                                        |                                             |           |                 |                                        |
| Name:                           |                         |                    |                                        |                                             |           |                 | <input type="checkbox"/> <\$1 million  |
| City, State:                    |                         |                    |                                        |                                             |           |                 | <input type="checkbox"/> <\$5 million  |
|                                 |                         |                    |                                        |                                             |           |                 | <input type="checkbox"/> <\$10 million |
|                                 |                         |                    |                                        |                                             |           |                 | <input type="checkbox"/> <\$15 million |
| Age of Firm: ____yrs.           |                         |                    |                                        |                                             |           |                 |                                        |
| Name:                           |                         |                    |                                        |                                             |           |                 | <input type="checkbox"/> <\$1 million  |
| City, State:                    |                         |                    |                                        |                                             |           |                 | <input type="checkbox"/> <\$5 million  |
|                                 |                         |                    |                                        |                                             |           |                 | <input type="checkbox"/> <\$10 million |
|                                 |                         |                    |                                        |                                             |           |                 | <input type="checkbox"/> <\$15 million |
| Age of Firm: ____yrs.           |                         |                    |                                        |                                             |           |                 |                                        |

Distribution: 1) Original - Local Agency File

## Exhibit 15-G CONSTRUCTION CONTRACT DBE COMMITMENT

1. Local Agency: HUMBOLDT COUNTY 2. Contract DBE Goal: 3.0 Percent  
 3. Project Description: EARTHQUAKE DAMAGE REPAIRS TO MATTOLE ROAD (3C010) AT P.M. 43.17  
 4. Project Location: \_\_\_\_\_  
 5. Bidder's Name: \_\_\_\_\_ 6. Prime Certified DBE: ☐ 7. Bid Amount: \_\_\_\_\_  
 8. Total Dollar Amount for ALL Subcontractors: \_\_\_\_\_ 9. Total Number of ALL Subcontractors: \_\_\_\_\_

| 10. Bid Item Number                                                                                                                                                                                                 | 11. Description of Work, Service, or Materials Supplied | 12. DBE Certification Number | 13. DBE Contact Information<br>(Must be certified on the date bids are opened)                                                                                                                                                                                                                                                                                   | 14. DBE Dollar Amount |
|---------------------------------------------------------------------------------------------------------------------------------------------------------------------------------------------------------------------|---------------------------------------------------------|------------------------------|------------------------------------------------------------------------------------------------------------------------------------------------------------------------------------------------------------------------------------------------------------------------------------------------------------------------------------------------------------------|-----------------------|
|                                                                                                                                                                                                                     |                                                         |                              |                                                                                                                                                                                                                                                                                                                                                                  |                       |
|                                                                                                                                                                                                                     |                                                         |                              |                                                                                                                                                                                                                                                                                                                                                                  |                       |
|                                                                                                                                                                                                                     |                                                         |                              |                                                                                                                                                                                                                                                                                                                                                                  |                       |
|                                                                                                                                                                                                                     |                                                         |                              |                                                                                                                                                                                                                                                                                                                                                                  |                       |
|                                                                                                                                                                                                                     |                                                         |                              |                                                                                                                                                                                                                                                                                                                                                                  |                       |
|                                                                                                                                                                                                                     |                                                         |                              |                                                                                                                                                                                                                                                                                                                                                                  |                       |
|                                                                                                                                                                                                                     |                                                         |                              |                                                                                                                                                                                                                                                                                                                                                                  |                       |
| <b>Local Agency to Complete this Section</b>                                                                                                                                                                        |                                                         |                              | <b>15. TOTAL CLAIMED DBE PARTICIPATION</b>                                                                                                                                                                                                                                                                                                                       | \$                    |
| 21. Local Agency Contract Number: <u>CONTRACT NO.: 210207</u><br>22. Federal-Aid Project Number: <u>PROJECT NO.: ER 4820 (004)</u><br>23. Bid Opening Date: <u>April 25, 2017</u><br>24. Contract Award Date: _____ |                                                         |                              |                                                                                                                                                                                                                                                                                                                                                                  | %                     |
| Local Agency certifies that all DBE certifications are valid and information on this form is complete and accurate.                                                                                                 |                                                         |                              | IMPORTANT: Identify all DBE firms being claimed for credit, regardless of tier. Names of the First Tier DBE Subcontractors and their respective item(s) of work listed above must be consistent, where applicable with the names and items of the work in the "Subcontractor List" submitted with your bid. Written confirmation of each listed DBE is required. |                       |
| 25. Local Agency Representative's Signature                                                                                                                                                                         |                                                         | 26. Date                     | 16. Preparer's Signature                                                                                                                                                                                                                                                                                                                                         |                       |
| 27. Local Agency Representative's Name                                                                                                                                                                              |                                                         | 28. Phone                    | 17. Date                                                                                                                                                                                                                                                                                                                                                         |                       |
| 29. Local Agency Representative's Title                                                                                                                                                                             |                                                         |                              | 18. Preparer's Name                                                                                                                                                                                                                                                                                                                                              |                       |
|                                                                                                                                                                                                                     |                                                         |                              | 19. Phone                                                                                                                                                                                                                                                                                                                                                        |                       |
|                                                                                                                                                                                                                     |                                                         |                              | 20. Preparer's Title                                                                                                                                                                                                                                                                                                                                             |                       |

**DISTRIBUTION:** 1. Original – Local Agency  
 2. Copy – Caltrans District Local Assistance Engineer (DLAE). Failure to submit to DLAE within 30 days of contract execution may result in de-obligation of federal funds on contract. Include additional copy with award package.

**ADA Notice:** For individuals with sensory disabilities, this document is available in alternate formats. For information call (916) 654-6410 or TDD (916) 654-3880 or write Records and Forms Management, 1120 N Street, MS-89, Sacramento, CA 95814.



## INSTRUCTIONS – CONSTRUCTION CONTRACT DBE COMMITMENT

### CONTRACTOR SECTION

1. **Local Agency** - Enter the name of the local or regional agency that is funding the contract.
2. **Contract DBE Goal** - Enter the contract DBE goal percentage as it appears on the project advertisement.
3. **Project Location** - Enter the project location as it appears on the project advertisement.
4. **Project Description** - Enter the project description as it appears on the project advertisement (Bridge Rehab, Seismic Rehab, Overlay, Widening, etc).
5. **Bidder's Name** - Enter the contractor's firm name.
6. **Prime Certified DBE** - Check box if prime contractor is a certified DBE.
7. **Bid Amount** - Enter the total contract bid dollar amount for the prime contractor.
8. **Total Dollar Amount for ALL Subcontractors** - Enter the total dollar amount for all subcontracted contractors. SUM = (DBEs + all Non-DBEs). Do not include the prime contractor information in this count.
9. **Total number of ALL subcontractors** - Enter the total number of all subcontracted contractors. SUM = (DBEs + all Non-DBEs). Do not include the prime contractor information in this count.
10. **Bid Item Number** - Enter bid item number for work, services, or materials supplied to be provided.
11. **Description of Work, Services, or Materials Supplied** - Enter description of work, services, or materials to be provided. Indicate all work to be performed by DBEs including work performed by the prime contractor's own forces, if the prime is a DBE. If 100% of the item is not to be performed or furnished by the DBE, describe the exact portion to be performed or furnished by the DBE. See LAPM Chapter 9 to determine how to count the participation of DBE firms.
12. **DBE Certification Number** - Enter the DBE's Certification Identification Number. All DBEs must be certified on the date bids are opened.
13. **DBE Contact Information** - Enter the name, address, and phone number of all DBE subcontracted contractors. Also, enter the prime contractor's name and phone number, if the prime is a DBE.
14. **DBE Dollar Amount** - Enter the subcontracted dollar amount of the work to be performed or service to be provided. Include the prime contractor if the prime is a DBE. See LAPM Chapter 9 for how to count full/partial participation.
15. **Total Claimed DBE Participation - \$:** Enter the total dollar amounts entered in the "DBE Dollar Amount" column. **%:** Enter the total DBE participation claimed ("Total Claimed DBE Participation Dollars" divided by item "Bid Amount"). If the total % claimed is less than item "Contract DBE Goal," an adequately documented Good Faith Effort (GFE) is required (see Exhibit 15-H DBE Information - Good Faith Efforts of the LAPM).
16. **Preparer's Signature** - The person completing the DBE commitment form on behalf of the contractor's firm must sign their name.
17. **Date** - Enter the date the DBE commitment form is signed by the contractor's preparer.
18. **Preparer's Name** - Enter the name of the person preparing and signing the contractor's DBE commitment form.
19. **Phone** - Enter the area code and phone number of the person signing the contractor's DBE commitment form.
20. **Preparer's Title** - Enter the position/title of the person signing the contractor's DBE commitment form.

### LOCAL AGENCY SECTION

21. **Local Agency Contract Number** - Enter the Local Agency contract number or identifier.
22. **Federal-Aid Project Number** - Enter the Federal-Aid Project Number.
23. **Bid Opening Date** - Enter the date contract bids were opened.
24. **Contract Award Date** - Enter the date the contract was executed.
25. **Local Agency Representative's Signature** - The person completing this section of the form for the Local Agency must sign their name to certify that the information in this and the Contractor Section of this form is complete and accurate.
26. **Date** - Enter the date the DBE commitment form is signed by the Local Agency Representative.
27. **Local Agency Representative's Name** - Enter the name of the Local Agency Representative certifying the contractor's DBE commitment form.
28. **Phone** - Enter the area code and phone number of the person signing the contractor's DBE commitment form.
29. **Local Agency Representative Title** - Enter the position/title of the Local Agency Representative certifying the contractor's DBE commitment form.

## EXHIBIT 15-H DBE INFORMATION —GOOD FAITH EFFORTS

### DBE INFORMATION - GOOD FAITH EFFORTS

Federal-aid Project No. PROJECT NO.: ER 4820 (004) Bid Opening Date April 25, 2017

The County of Humboldt established a Disadvantaged Business Enterprise (DBE) goal of 3.0 % for this project. The information provided herein shows that a good faith effort was made.

Lowest, second lowest and third lowest bidders shall submit the following information to document adequate good faith efforts. Bidders should submit the following information even if the "Local Agency Bidder DBE Commitment" form indicates that the bidder has met the DBE goal. This will protect the bidder's eligibility for award of the contract if the administering agency determines that the bidder failed to meet the goal for various reasons, e.g., a DBE firm was not certified at bid opening, or the bidder made a mathematical error.

Submittal of only the "Local Agency Bidder DBE Commitment" form may not provide sufficient documentation to demonstrate that adequate good faith efforts were made.

The following items are listed in the Section entitled "Submission of DBE Commitment" of the Special Provisions:

- A. The names and dates of each publication in which a request for DBE participation for this project was placed by the bidder (please attach copies of advertisements or proofs of publication):

| <u>Publications</u> | <u>Dates of Advertisement</u> |
|---------------------|-------------------------------|
|                     |                               |
|                     |                               |
|                     |                               |

- B. The names and dates of written notices sent to certified DBEs soliciting bids for this project and the dates and methods used for following up initial solicitations to determine with certainty whether the DBEs were interested (please attach copies of solicitations, telephone records, fax confirmations, etc.):

| <u>Names of DBEs Solicited</u> | <u>Date of Initial Solicitation</u> | <u>Follow Up Methods and Dates</u> |
|--------------------------------|-------------------------------------|------------------------------------|
|                                |                                     |                                    |
|                                |                                     |                                    |
|                                |                                     |                                    |
|                                |                                     |                                    |
|                                |                                     |                                    |
|                                |                                     |                                    |

- C. The items of work which the bidder made available to DBE firms including, where appropriate, any breaking down of the contract work items (including those items normally performed by the bidder with its own forces) into economically feasible units to facilitate DBE participation. It is the bidder's responsibility to demonstrate that sufficient work to facilitate DBE participation was made available to DBE firms.

| Items of Work | Bidder Normally<br>Performs Item<br>(Y/N) | Breakdown of<br>Items | Amount<br>(\$) | Percentage<br>Of<br>Contract |
|---------------|-------------------------------------------|-----------------------|----------------|------------------------------|
|               |                                           |                       |                |                              |
|               |                                           |                       |                |                              |
|               |                                           |                       |                |                              |

- D. The names, addresses and phone numbers of rejected DBE firms, the reasons for the bidder's rejection of the DBEs, the firms selected for that work (please attach copies of quotes from the firms involved), and the price difference for each DBE if the selected firm is not a DBE:

Names, addresses and phone numbers of rejected DBEs and the reasons for the bidder's rejection of the DBEs:

---

---

---

---

Names, addresses and phone numbers of firms selected for the work above:

---

---

---

---

- E. Efforts made to assist interested DBEs in obtaining bonding, lines of credit or insurance, and any technical assistance or information related to the plans, specifications and requirements for the work which was provided to DBEs:

---

---

---

---

- F. Efforts made to assist interested DBEs in obtaining necessary equipment, supplies, materials or related assistance or services, excluding supplies and equipment the DBE subcontractor purchases or leases from the prime contractor or its affiliate:

---

---

---

---

- G. The names of agencies, organizations or groups contacted to provide assistance in contacting, recruiting and using DBE firms (please attach copies of requests to agencies and any responses received, i.e., lists, Internet page download, etc.):

| Name of Agency/Organization | Method/Date of Contact | Results |
|-----------------------------|------------------------|---------|
|                             |                        |         |
|                             |                        |         |

- H. Any additional data to support a demonstration of good faith efforts (use additional sheets if necessary):

---

---

**NOTE: USE ADDITIONAL SHEETS OF PAPER IF NECESSARY.**

### EXHIBIT 17-F FINAL REPORT-UTILIZATION OF DBE AND FIRST-TIER SUBCONTRACTORS

| 1. Local Agency Contract Number<br><b>CONTRACT NO.: 210207</b> |                                                        | 2. Federal-Aid Project Number<br><b>PROJECT NO.: ER 4820 (004)</b> |                              | 3. Local Agency<br><b>HUMBOLDT COUNTY</b> |     | 4. Contract Completion Date |                           |
|----------------------------------------------------------------|--------------------------------------------------------|--------------------------------------------------------------------|------------------------------|-------------------------------------------|-----|-----------------------------|---------------------------|
| 5. Contractor/Consultant                                       |                                                        |                                                                    | 6. Business Address          |                                           |     | 7. Final Contract Amount    |                           |
| 8. Contract Item Number                                        | 9. Description of Work, Service, or Materials Supplied | 10. Company Name and Business Address                              | 11. DBE Certification Number | 12. Contract Payments                     |     | 13. Date Work Completed     | 14. Date of Final Payment |
|                                                                |                                                        |                                                                    |                              | Non-DBE                                   | DBE |                             |                           |
|                                                                |                                                        |                                                                    |                              |                                           |     |                             |                           |
|                                                                |                                                        |                                                                    |                              |                                           |     |                             |                           |
|                                                                |                                                        |                                                                    |                              |                                           |     |                             |                           |
|                                                                |                                                        |                                                                    |                              |                                           |     |                             |                           |
|                                                                |                                                        |                                                                    |                              |                                           |     |                             |                           |
|                                                                |                                                        |                                                                    |                              |                                           |     |                             |                           |
|                                                                |                                                        |                                                                    |                              |                                           |     |                             |                           |
|                                                                |                                                        |                                                                    |                              |                                           |     |                             |                           |
|                                                                |                                                        |                                                                    |                              |                                           |     |                             |                           |
| 15. ORIGINAL DBE COMMITMENT AMOUNT      \$ _____               |                                                        |                                                                    |                              | 16. TOTAL                                 |     |                             |                           |

List all first-tier subcontractors/subconsultants and DBEs regardless of tier whether or not the firms were originally listed for goal credit. If actual DBE utilization (or item of work) was different than that approved at the time of award, provide comments on an additional page. List actual amount paid to each entity. If no subcontractors/subconsultants were used on the contract, indicate on the form.

**I CERTIFY THAT THE ABOVE INFORMATION IS COMPLETE AND CORRECT**

|                                                                                                        |                                                 |           |          |
|--------------------------------------------------------------------------------------------------------|-------------------------------------------------|-----------|----------|
| 17. Contractor/Consultant Representative's Signature                                                   | 18. Contractor/Consultant Representative's Name | 19. Phone | 20. Date |
| <b>I CERTIFY THAT THE CONTRACTING RECORDS AND ON-SITE PERFORMANCE OF THE DBE(S) HAS BEEN MONITORED</b> |                                                 |           |          |
| 21. Local Agency Representative's Signature                                                            | 22. Local Agency Representative's Name          | 23. Phone | 24. Date |

**DISTRIBUTION:** Original – Local Agency, Copy – Caltrans District Local Assistance Engineer. Include with Final Report of Expenditures

**ADA NOTICE:** For individuals with sensory disabilities, this document is available in alternate formats. For information, call (916) 445-1233, Local Assistance Procedures Manual TTY 711, or write to Records and Forms Management, 1120 N Street, MS-89, Sacramento, CA 95814.

## INSTRUCTIONS – FINAL REPORT-UTILIZATION OF DISADVANTAGED BUSINESS ENTERPRISES (DBE) AND FIRST-TIER SUBCONTRACTORS

1. **Local Agency Contract Number** - Enter the Local Agency contract number or identifier.
2. **Federal-Aid Project Number** - Enter the Federal-Aid Project Number.
3. **Local Agency** - Enter the name of the local or regional agency that is funding the contract.
4. **Contract Completion Date** - Enter the date the contract was completed.
5. **Contractor/Consultant** - Enter the contractor/consultant's firm name.
6. **Business Address** - Enter the contractor/consultant's business address.
7. **Final Contract Amount** - Enter the total final amount for the contract.
8. **Contract Item Number** - Enter contract item for work, services, or materials supplied provided. Not applicable for consultant contracts.
9. **Description of Work, Services, or Materials Supplied** - Enter description of work, services, or materials provided. Indicate all work to be performed by DBEs including work performed by the prime contractor/consultant's own forces, if the prime is a DBE. If 100% of the item is not to be performed or furnished by the DBE, describe the exact portion to be performed or furnished by the DBE. See LAPM Chapter 9 to determine how to count the participation of DBE firms.
10. **Company Name and Business Address** - Enter the name, address, and phone number of all subcontracted contractors/consultants. Also, enter the prime contractor/consultant's name and phone number, if the prime is a DBE.
11. **DBE Certification Number** - Enter the DBE's Certification Identification Number. Leave blank if subcontractor is not a DBE.
12. **Contract Payments** - Enter the subcontracted dollar amount of the work performed or service provided. Include the prime contractor/consultant if the prime is a DBE. The Non-DBE column is used to enter the dollar value of work performed by firms that are not certified DBE or for work after a DBE becomes decertified.
13. **Date Work Completed** - Enter the date the subcontractor/subconsultant's item work was completed.
14. **Date of Final Payment** - Enter the date when the prime contractor/consultant made the final payment to the subcontractor/subconsultant for the portion of work listed as being completed.
15. **Original DBE Commitment Amount** - Enter the "Total Claimed DBE Participation Dollars" from Exhibits 15-G or 10-O2 for the contract.
16. **Total** - Enter the sum of the "Contract Payments" Non-DBE and DBE columns.
17. **Contractor/Consultant Representative's Signature** - The person completing the form on behalf of the contractor/consultant's firm must sign their name.
18. **Contractor/Consultant Representative's Name** - Enter the name of the person preparing and signing the form.
19. **Phone** - Enter the area code and telephone number of the person signing the form.
20. **Date** - Enter the date the form is signed by the contractor's preparer.
21. **Local Agency Representative's Signature** - A Local Agency Representative must sign their name to certify that the contracting records and on-site performance of the DBE(s) has been monitored.
22. **Local Agency Representative's Name** - Enter the name of the Local Agency Representative signing the form.
23. **Phone** - Enter the area code and telephone number of the person signing the form.
24. **Date** - Enter the date the form is signed by the Local Agency Representative.

### EXHIBIT 17-O: DBE CERTIFICATION STATUS CHANGE

|                                                                |                            |                                                                    |                                       |                                                                           |              |                                |  |
|----------------------------------------------------------------|----------------------------|--------------------------------------------------------------------|---------------------------------------|---------------------------------------------------------------------------|--------------|--------------------------------|--|
| 1. Local Agency Contract Number<br><b>CONTRACT NO.: 210207</b> |                            | 2. Federal-Aid Project Number<br><b>PROJECT NO.: ER 4820 (004)</b> |                                       | 3. Local Agency<br><b>HUMBOLDT COUNTY</b>                                 |              | 4. Contract Completion<br>Date |  |
| 5. Contractor/Consultant                                       |                            |                                                                    | 6. Business Address                   |                                                                           |              | 7. Final Contract Amount       |  |
| 8.<br>Contract<br>Item<br>Number                               | 9. DBE Contact Information | 10. DBE<br>Certification<br>Number                                 | 11. Amount<br>Paid<br>While Certified | 12.<br>Certification/<br>Decertificati<br>on Date<br>(Letter<br>Attached) | 13. Comments |                                |  |
|                                                                |                            |                                                                    |                                       |                                                                           |              |                                |  |
|                                                                |                            |                                                                    |                                       |                                                                           |              |                                |  |
|                                                                |                            |                                                                    |                                       |                                                                           |              |                                |  |
|                                                                |                            |                                                                    |                                       |                                                                           |              |                                |  |
|                                                                |                            |                                                                    |                                       |                                                                           |              |                                |  |
|                                                                |                            |                                                                    |                                       |                                                                           |              |                                |  |
|                                                                |                            |                                                                    |                                       |                                                                           |              |                                |  |
|                                                                |                            |                                                                    |                                       |                                                                           |              |                                |  |
|                                                                |                            |                                                                    |                                       |                                                                           |              |                                |  |
|                                                                |                            |                                                                    |                                       |                                                                           |              |                                |  |
|                                                                |                            |                                                                    |                                       |                                                                           |              |                                |  |
|                                                                |                            |                                                                    |                                       |                                                                           |              |                                |  |
|                                                                |                            |                                                                    |                                       |                                                                           |              |                                |  |

If there were no changes in the DBE certification of subcontractors/subconsultants, indicate on the form.

**I CERTIFY THAT THE ABOVE INFORMATION IS COMPLETE AND CORRECT**

|                                                                                                        |                                                   |           |          |
|--------------------------------------------------------------------------------------------------------|---------------------------------------------------|-----------|----------|
| 14. Contractor/Consultant Representative's Signature                                                   | 15. Contractor/Consultant Representative's Name - | 16. Phone | 17. Date |
| <b>I CERTIFY THAT THE CONTRACTING RECORDS AND ON-SITE PERFORMANCE OF THE DBE(S) HAS BEEN MONITORED</b> |                                                   |           |          |
| 18. Local Agency Representative's Signature                                                            | 19. Local Agency Representative's Name            | 20. Phone | 21. Date |

DISTRIBUTION: Original – Local Agency, Copy – Caltrans District Local Assistance Engineer. Include with Final Report of Expenditures

ADA NOTICE: For individuals with sensory disabilities, this document is available in alternate formats. For information, call (916) 445-1233, Local Assistance Procedures Manual TTY 711, or write to Records and Forms Management, 1120 N Street, MS-89, Sacramento, CA 95814.

**INSTRUCTIONS –DISADVANTAGED BUSINESS ENTERPRISES (DBE)  
CERTIFICATION STATUS CHANGE**

1. **Local Agency Contract Number** - Enter the Local Agency contract number or identifier.
2. **Federal-Aid Project Number** - Enter the Federal-Aid Project Number.
3. **Local Agency** - Enter the name of the local or regional agency that is funding the contract.
4. **Contract Completion Date** - Enter the date the contract was completed.
5. **Contractor/Consultant** - Enter the contractor/consultant's firm name.
6. **Business Address** - Enter the contractor/consultant's business address.
7. **Final Contract Amount** - Enter the total final amount for the contract.
8. **Contract Item Number** - Enter contract item for work, services, or materials supplied provided. Not applicable for consultant contracts.
9. **DBE Contact Information** - Enter the name, address, and phone number of all DBE subcontracted contractors/consultants.
10. **DBE Certification Number** - Enter the DBE's Certification Identification Number.
11. **Amount Paid While Certified** - Enter the actual dollar value of the work performed by those subcontractors/subconsultants during the time period they are certified as a DBE.
12. **Certification/Decertification Date (Letter Attached)** - Enter either the date of the Decertification Letter sent out by the Office of Business and Economic Opportunity (OBE) or the date of the Certification Certificate mailed out by OBE.
13. **Comments** - If needed, provide any additional information in this section regarding any of the above certification status changes.
14. **Contractor/Consultant Representative's Signature** - The person completing the form on behalf of the contractor/consultant's firm must sign their name.
15. **Contractor/Consultant Representative's Name** - Enter the name of the person preparing and signing the form.
16. **Phone** - Enter the area code and telephone number of the person signing the form.
17. **Date** - Enter the date the form is signed by the contractor's preparer.
18. **Local Agency Representative's Signature** - A Local Agency Representative must sign their name to certify that the contracting records and on-site performance of the DBE(s) has been monitored.
19. **Local Agency Representative's Name** - Enter the name of the Local Agency Representative signing the form.
20. **Phone** - Enter the area code and telephone number of the person signing the form.
21. **Date** - Enter the date the form is signed by the Local Agency Representative.



## **AGREEMENT**

This is an AGREEMENT made and entered into this \_\_\_\_\_ day  
of \_\_\_\_\_, 20\_\_, by and between the County of Humboldt, a  
political subdivision of the State of California (hereinafter referred to as COUNTY)  
and \_\_\_\_\_,

a corporation organized and existing under the laws of the State of California;  
hereinafter referred to as "CONTRACTOR".

County and Contractor for the consideration hereinafter named agree as follows:

### **Section 1 - SCOPE OF WORK**

Contractor shall furnish all Labor, Tools and Materials and perform all the work for the:

**EARTHQUAKE DAMAGE REPAIRS TO MATTOLE ROAD  
(3C010) AT P.M. 43.17  
PROJECT NO.: ER 4820 (004)  
CONTRACT NO.: 210207**

in accordance with the contract documents referred to in Section 3 of this Agreement.

### **Section 2 - CONTRACT PRICE**

County shall pay, and Contractor shall accept Contractor's Bid Prices, as shown on EXHIBIT "A" attached hereto and made a part hereof, as full compensation for furnishing all materials and for doing all the work contemplated and embraced in this Agreement; also for all loss or damage, arising out of the work aforesaid, or from the actions of the elements, or from any unforeseen difficulties or obstructions which may arise or be encountered in the prosecution of the work until its acceptance by County, and for all risks of every description connected with the work; also for all expenses incurred by or in consequence of the suspension or discontinuance of the work and for well and faithfully completing the work, and the whole thereof, in the manner and according to the Plans and Specifications, and the requirements of the Engineer.

### **Section 3 - CONTRACT DOCUMENTS**

The complete contract between the parties hereto shall consist of the following, hereinafter referred to as the CONTRACT DOCUMENTS:

- Notice to Contractors
- Plans and Drawings
- Bid Form
- Bidder's Bond
- Performance Bond
- Payment Bond
- This Agreement
- Special Provisions

And, as published by the Department of Transportation, State of California, except as modified by the Special Provisions:

- Standard Plans - dated 2015
- Standard Specifications - dated 2015
- Equipment Rental Rates in effect at the time the work is performed

And, as published by the California Department of Industrial Relations, and the California Business, Transportation and Housing Agency,

- General Prevailing Wage Rates
- Labor and Surcharge Rates

And any addenda to any of the above documents, all of which are on file in the office of the Director of Public Works of the County of Humboldt. Each of said CONTRACT DOCUMENTS is incorporated and made a part of this Agreement by the reference contained in this Section.

All rights and obligations of the County and the Contractor are fully set forth and described in the Contract Documents. All of the above named documents are intended to be complementary, so that any work called for in one, and mentioned in the other is to be performed and executed the same as if mentioned in all said documents.

### **Section 4 - BEGINNING OF WORK**

Following receipt and full execution and approval of the Contract Documents, and posting of the requisite Bonds as called for therein, the COUNTY will issue a "Notice to Proceed". Under no circumstances shall the CONTRACTOR enter upon the site of work until receipt of the "Notice to Proceed", or unless so authorized in writing by the COUNTY.

### **Section 5 - TIME OF COMPLETION**

The work called for in this Agreement shall be commenced within fifteen (15) days of the date of execution of the contract by COUNTY and shall be fully completed within a period of 40 working days beginning on the fifteenth calendar day after the date of said approval of contract.

## **Section 6 - PREVAILING WAGE**

Copies of the prevailing wage rates of per diem wages are on file in the Humboldt County Public Works office at 1106 Second Street, Eureka, California and are available to any interested person on request.

## **Section 7 - WORKERS' COMPENSATION**

By my signature hereunder, as CONTRACTOR, I certify that I am aware of the provisions of Section 3700 of the Labor Code which requires every employer to be insured against liability for Workers' Compensation or to undertake self insurance in accordance with the provisions of that code, and I will comply with such provisions before commencing the performance of the work of this contract.

## **Section 8 - COMPLIANCE WITH LAWS**

The Contractor agrees to comply with all local, state, and federal laws and regulations, including but not limited to the Americans With Disabilities Act. The Contractor further agrees to comply with any applicable federal, state or local licensing standards, any applicable accrediting standards, and any other applicable standards or criteria established locally or by the state or federal governments.

This agreement shall be governed by and construed in accordance with the laws of the State of California.

## **Section 9 - NOTICES**

All notices shall be in writing and delivered in person or transmitted by mail. Notices required to be given to the COUNTY shall be addressed as follows:

Humboldt County Department of Public Works  
1106 Second Street, Eureka, California, 95501

Notices required to be given to CONTRACTOR shall be addressed as follows:

---

---

---

---

IN WITNESS WHEREOF, The parties hereto have entered into this Agreement as of the date first above set forth.

COUNTY OF HUMBOLDT

(SEAL) BY \_\_\_\_\_  
Chairman, Board of Supervisors  
of the County of Humboldt,  
State of California

ATTEST:

KATHY HAYES  
Clerk of the Board of Supervisors  
of the County of Humboldt,  
State of California

BY \_\_\_\_\_  
Clerk of the Board

CONTRACTOR

BY \_\_\_\_\_

TITLE \_\_\_\_\_

BY \_\_\_\_\_

TITLE \_\_\_\_\_

(Two Signatures Required For Corporation)

APPROVED AS TO FORM:

BY \_\_\_\_\_  
Deputy County Counsel

INSURANCE CERTIFICATES REVIEWED  
AND APPROVED:

BY \_\_\_\_\_  
Risk Manager

## PAYMENT BOND

KNOW ALL MEN BY THESE PRESENTS:

THAT WHEREAS, the County of Humboldt, by its order made \_\_\_\_\_, 20\_\_\_\_, has awarded to \_\_\_\_\_ hereinafter designated as the "Principal," a contract for the work described as follows:

\_\_\_\_\_  
\_\_\_\_\_  
\_\_\_\_\_

NOW, THEREFORE, we the Principal and \_\_\_\_\_, Surety, are held and firmly bound unto the County of Humboldt in the penal sum of \_\_\_\_\_ Dollars (\$ \_\_\_\_\_), lawful money of the United States of America for the payment of which sum well and truly to be made, we bind ourselves, our heirs, executors, administrators, successors and assigns, jointly and severally, firmly by these presents.

THE CONDITION OF THIS OBLIGATION IS SUCH that if said Principal, his or its subcontractors, heirs, executors, administrators, successors, or assigns, shall fail to pay any of the persons named in Section 3181 of the Civil Code, or amounts due under the Unemployment Insurance Code, with respect to work or labor performed by claimant, or for any amounts required to be deducted, withheld, and paid over to the Franchise Tax Board from the wages of employees of the Contractor and his subcontractors pursuant to Section 18806 of the Revenue and Taxation Code with respect to such work and labor as required by Sections 3247 et seq. of the Civil Code of California, then said Surety will pay for the same, in or to an amount not exceeding the amount hereinafter set forth, and also will pay in case suit is brought upon this bond, such reasonable attorney's fees, as shall be fixed by the court, awarded and taxed as in the above-mentioned statutes provided.

AND, the said Surety, for value received, hereby stipulates and agrees that no change, extension of time, alteration or addition to the terms of the contract or to the work to be performed thereunder or the specifications accompanying the same shall in any way affect its obligations on this bond, and it does hereby waive notice of any such change, extension of time, alteration or addition to the terms of the contract, or to the work, or to the specifications.

IN WITNESS WHEREOF, this instrument has been duly executed by Principal and Surety above named, on the \_\_\_\_\_ day of \_\_\_\_\_, 20\_\_\_\_.

\_\_\_\_\_  
PRINCIPAL  
BY \_\_\_\_\_

\_\_\_\_\_  
SURETY  
BY \_\_\_\_\_

Attorney-in-fact

## PERFORMANCE BOND

KNOW ALL MEN BY THESE PRESENTS: that

\_\_\_\_\_  
(Name of Contractor)  
\_\_\_\_\_  
(Address of Contractor)  
a \_\_\_\_\_, hereinafter called Principal, and  
( Corporation , Partnership , or Individual )  
\_\_\_\_\_  
Name of Surety)  
\_\_\_\_\_  
( Address of Surety )  
hereinafter called Surety, are held and firmly bound unto \_\_\_\_\_  
\_\_\_\_\_  
( Name of Owner )  
\_\_\_\_\_  
( Address of Owner )  
hereinafter called Owner , in the penal sum of \_\_\_\_\_  
\_\_\_\_\_ Dollars , \$ \_\_\_\_\_

in lawful money of the United States, for the Payment of which sum well and truly to be made, we bind ourselves, successors, and assigns, jointly and severally, by these presents.

THE CONDITION OF THIS OBLIGATION is such that whereas, the Principal entered into a certain contract with the OWNER, dated the \_\_\_\_\_ day of \_\_\_\_\_, 20\_\_\_\_, a copy of which is hereto attached and made a part hereof for the construction of :

\_\_\_\_\_  
\_\_\_\_\_  
\_\_\_\_\_

NOW , THEREFORE , if the Principal shall well , truly and faithfully perform its duties; all of the undertakings, covenants, terms, conditions, and agreements of said contract during the original term thereof, and any extensions thereof which may be granted by the OWNER, with or without notice to the Surety and during the one year guaranty period, and if he shall satisfy all claims and demands incurred under such contract, and shall fully indemnify and save harmless the OWNER from all costs and damages which it may suffer by reason of failure to do so, and shall reimburse and repay the OWNER all outlay and expense which the OWNER may incur in making good any default, then this obligation shall be void; otherwise to remain in full force and effect.

PROVIDED , FURTHER , that the said surety, for value received hereby stipulate and agrees that no change, extension of time, alteration or addition to the specifications accompanying the same shall in any way affect its obligation on this BOND , and it does hereby waive notice of any such change, extension of time, alteration or addition to the terms of the contract or to the WORK or to the SPECIFICATIONS.

PROVIDED. , FURTHER , that no final settlement between the OWNER and the CONTRACTOR shall abridge the right of any beneficiary hereunder, whose claim may be unsatisfied.

IN WITNESS WHEREOF, this instrument is executed in \_\_\_\_ counterparts, one of which shall  
(number)  
be deemed an original, this the \_\_\_\_\_ day of \_\_\_\_\_, 20\_\_\_\_.

ATTEST :

\_\_\_\_\_  
(Principal) Secretary  
(SEAL)

\_\_\_\_\_  
Principal  
BY \_\_\_\_\_ (s)

\_\_\_\_\_  
(Witness as to Principal)  
\_\_\_\_\_  
Address

\_\_\_\_\_  
Address

\_\_\_\_\_  
Surety

ATTEST :

\_\_\_\_\_  
(SEAL)

\_\_\_\_\_  
(Witness as to Surety)  
\_\_\_\_\_  
Address

BY \_\_\_\_\_  
Attorney - in - Fact  
\_\_\_\_\_  
Address

NOTE : Date of BOND must not be prior to date of contract. If CONTRACTOR is Partnership, all partners should execute BOND.

IMPORTANT : Surety companies executing BONDS must appear on the Treasury Department's most current list (Circular 570 as amended) and be authorized to transact business in the state where the PROJECT is located.

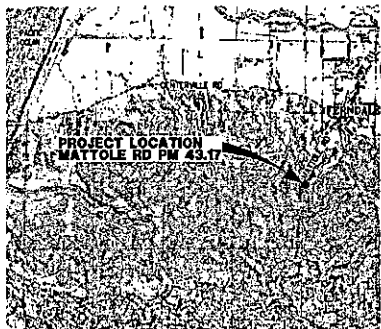

**VICINITY MAP**  
NOT TO SCALE

# COUNTY OF HUMBOLDT DEPARTMENT OF PUBLIC WORKS

## PROJECT PLANS FOR CONSTRUCTION OF EARTHQUAKE DAMAGE REPAIRS TO MATTOLE ROAD [3C010] PM 43.17 PROJECT NO. ER 4820 [004] CONTRACT NO. 210207

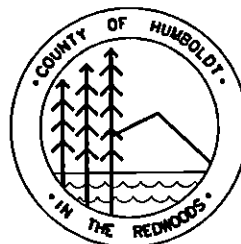

### INDEX OF SHEETS

- 1 COVER SHEET
- 2 CONSTRUCTION AREA SIGNS, QUANTITIES, AND DETAILS
- 3 TYPICAL SECTIONS AND DETAILS
- 4 PLAN AND PROFILE
- 5-6 CROSS SECTIONS

### APPLICABLE STANDARD PLANS

REFERENCE TO CALTRANS STANDARD PLANS DATED MAY 2015  
SEE APPLICABLE STANDARDS LIST IN SPECIAL PROVISIONS.

### NOTES

THE CONTRACTOR SHALL HAVE A CLASS "A" LICENSE  
FOR THIS PROJECT.

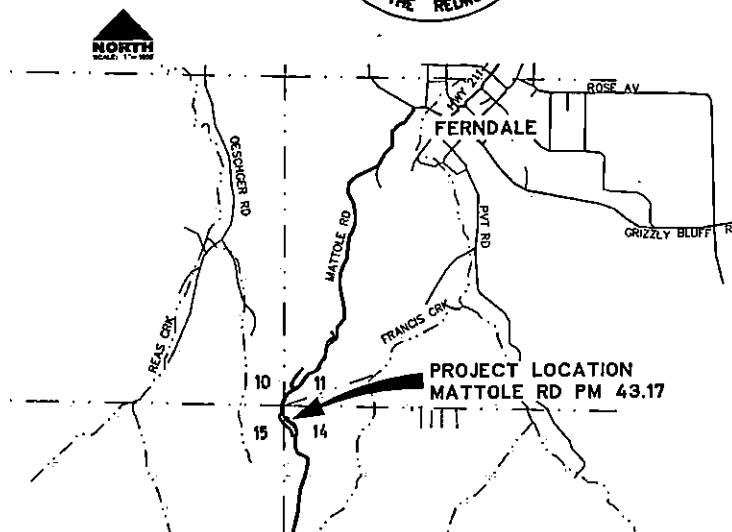

**SITE MAP**  
NOT TO SCALE

|                                                          |                           |                  |                                   |
|----------------------------------------------------------|---------------------------|------------------|-----------------------------------|
| ROAD NAME: MATTOLE ROAD                                  | ROAD NO: 3C010            | MALE POST: 43.17 | DESIGN SECTION: ROBERT L. BARNETT |
| PROJECT NO: ER 4820 [004]                                | EA NO: 01-324171          | DESIGNED BY: JMB | PROJECT NO: ER 4820 [004]         |
| CONTRACT NO: 210207                                      | CONTRACT NO: 210207       | DESIGNED BY: JMB | PROJECT NO: ER 4820 [004]         |
| DRAWING FILE NAME: L:\PROJECTS\110071\110071\004\004.DWG | PROJECT NO: ER 4820 [004] | DESIGNED BY: JMB | PROJECT NO: ER 4820 [004]         |
| PLOT DATE: 2/16/2017                                     | PROJECT NO: ER 4820 [004] | DESIGNED BY: JMB | PROJECT NO: ER 4820 [004]         |

|                                                                                                                              |
|------------------------------------------------------------------------------------------------------------------------------|
| COUNTY OF HUMBOLDT<br>DEPARTMENT OF PUBLIC WORKS<br>MATTOLE ROAD [3C010] PM 43.17<br>COVER SHEET,<br>SHEET INDEX AND DETAILS |
|------------------------------------------------------------------------------------------------------------------------------|

SHEET  
1  
OF  
6

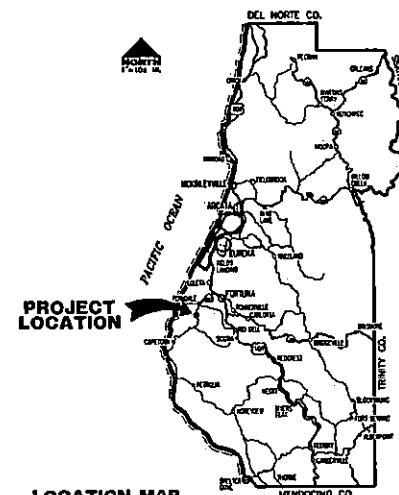

**LOCATION MAP**  
NOT TO SCALE

### RECOMMENDED

*Jeffrey A. Ball* 2-17-17  
JEFFREY A. BALL  
RCE 70631, EXP. 6/30/2017  
DATE



### APPROVED

*Tony R. Segretti* 2/17/17  
TONY R. SEGRETTI  
RCE 63714, EXP. 9/30/2018  
DATE



|                        |                   |                      |
|------------------------|-------------------|----------------------|
| ORIGINAL LOW BID PRICE | CONSTRUCTED BY    | RESIDENT ENGINEER    |
|                        | PROJECT COMPLETED | CONSTRUCTION COST \$ |





THIS IS ONE WORK ON  
ORIGINAL DRAWING  
IF NOT ONE WORK ON  
THIS SHEET ADJUST  
SCALES ACCORDINGLY  
PLOT DATE: 3/15/2017

ROAD NO. 32012  
PROJECT NO. EA 4320250  
CONTRACT NO. 740207  
DRAWING FILE NAME: L:\PROJECTS\110517\_VMS\CONC2.DWG  
PLOT DATE: 3/15/2017  
RLE POST: 4317  
EA NO: 01-824771  
DESIGNED BY: JMS  
DRAWN BY: JMS  
CHECKED BY: JMS  
APPROVED BY: JMS

DEPARTMENT OF PUBLIC WORKS

MATTOL ROAD (32010) PM 43.17

CONSTRUCTION AREA SIGNS,  
QUANTITIES, AND DETAILS

2  
of  
6

### QUANTITY SUMMARY TABLE

| ITEM NO. | ITEM CODE | ITEM DESCRIPTION                                  | UNIT | QUANTITY |
|----------|-----------|---------------------------------------------------|------|----------|
| 1        | 120050    | Construction Area Signs                           | EA   | 8        |
| 2        | 120100    | Traffic Control System                            | LS   | 1        |
| 3        | 129000    | Temporary Railing (Type K)                        | LF   | 240      |
| 4        | 130100    | Construction Site Management                      | LS   | 1        |
| 5        | 130200    | Prepare Water Pollution Control Program           | LS   | 1        |
| 6        | 130680    | Temporary Silt Fence                              | LF   | 525      |
| 7        | 160102    | Clearing and Grubbing (LS)                        | LS   | 1        |
| 8        | 190101    | Roadway Excavation                                | CY   | 5,485    |
| 9        | 198050    | Embankment                                        | CY   | 850      |
| 10       | 210350    | Fiber Roll                                        | LF   | 400      |
| 11       | 210430    | Hydroseed                                         | SF   | 17,500   |
| 12       | 260203    | Class 2 Aggregate Base (CY)                       | CY   | 325      |
| 13       | 390132    | Hot Mix Asphalt (Type A)                          | TON  | 260      |
| 14       | 394070    | Place HMA Dike (Type C & F)                       | LF   | 260      |
| 15       | 820108    | delineator (Class 2)                              | EA   | 7        |
| 16       | 832001    | Metal Beam Guard Railing                          | LF   | 100      |
| 17       | 839585    | Alternative Flared Terminal System                | EA   | 2        |
| 18       | 840502    | Thermoplastic Traffic Stripe (Enhanced Wet Night) | LF   | 1,600    |
| 19       | 999990    | Mobilization                                      | LS   | 1        |

### SURVEY CONTROL & MONUMENT COORDINATES

| Pnt.# | Northing | Eastings | Elev.   | Description            |
|-------|----------|----------|---------|------------------------|
| 1     | 9376.01  | 19889.97 | 5061.63 | fdbrscapp-2            |
| 2     | 10001.71 | 19889.82 | 5000.00 | setmagnoldpmbrosstogac |
| 3     | 10108.51 | 19780.03 | 4973.27 | set180dspikeornflag    |
| 4     | 10451.73 | 19803.03 | 4938.07 | set180dspikeornflag    |
| 5     | 10716.40 | 19549.71 | 4899.11 | set180dspikeornflag    |
| 6     | 10619.57 | 19615.62 | 4911.55 | setmagnol+shw          |
| 7     | 8856.59  | 19787.48 | 5081.19 | set180dspikeornflag    |
| 8     | 8558.36  | 19743.58 | 5123.65 | fd2inbcip-plwz         |
| 9     | 10699.69 | 19559.48 | 4902.19 | fdrrspikeoldp-6        |
| 10    | 10472.33 | 19775.40 | 4934.35 | fdrrspikeoldpuncholdp5 |
| 11    | 10268.19 | 19785.98 | 4955.71 | set180dspikeornflag    |
| 12    | 10401.92 | 19738.07 | 4994.54 | set180dspikeornflag    |
| 13    | 10470.20 | 19636.06 | 4975.88 | set180dspikeornflag    |
| 2000  | 10968.74 | 19595.99 | 0.00    | calc P-7               |
| 2001  | 10829.31 | 19595.37 | 0.00    | calcsec10              |

VERTICAL DATUM: ASSUMED ELEVATION 5000.00 ON CONTROL POINT CP#2  
HORIZONTAL DATUM: FROM FOUND BRASS CAPS P-2 HUM. CO. AND P-1 HUM. CO. ON 41 OF SURVEYS, PAGE 63. IN NW 1/4 SECTION 14, T2N, R2W, N.M.

RIGHT OF WAY: 25' EITHER SIDE OF BEST FIT OF TRAVERSED CENTERLINE PER ROAD REGISTER #7, PAGE 160

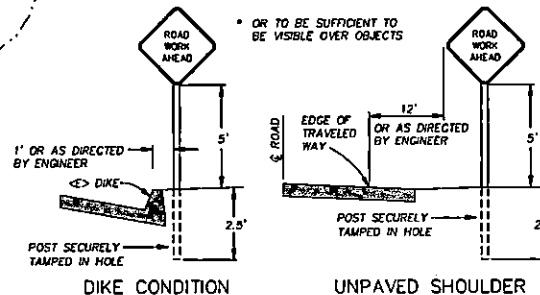
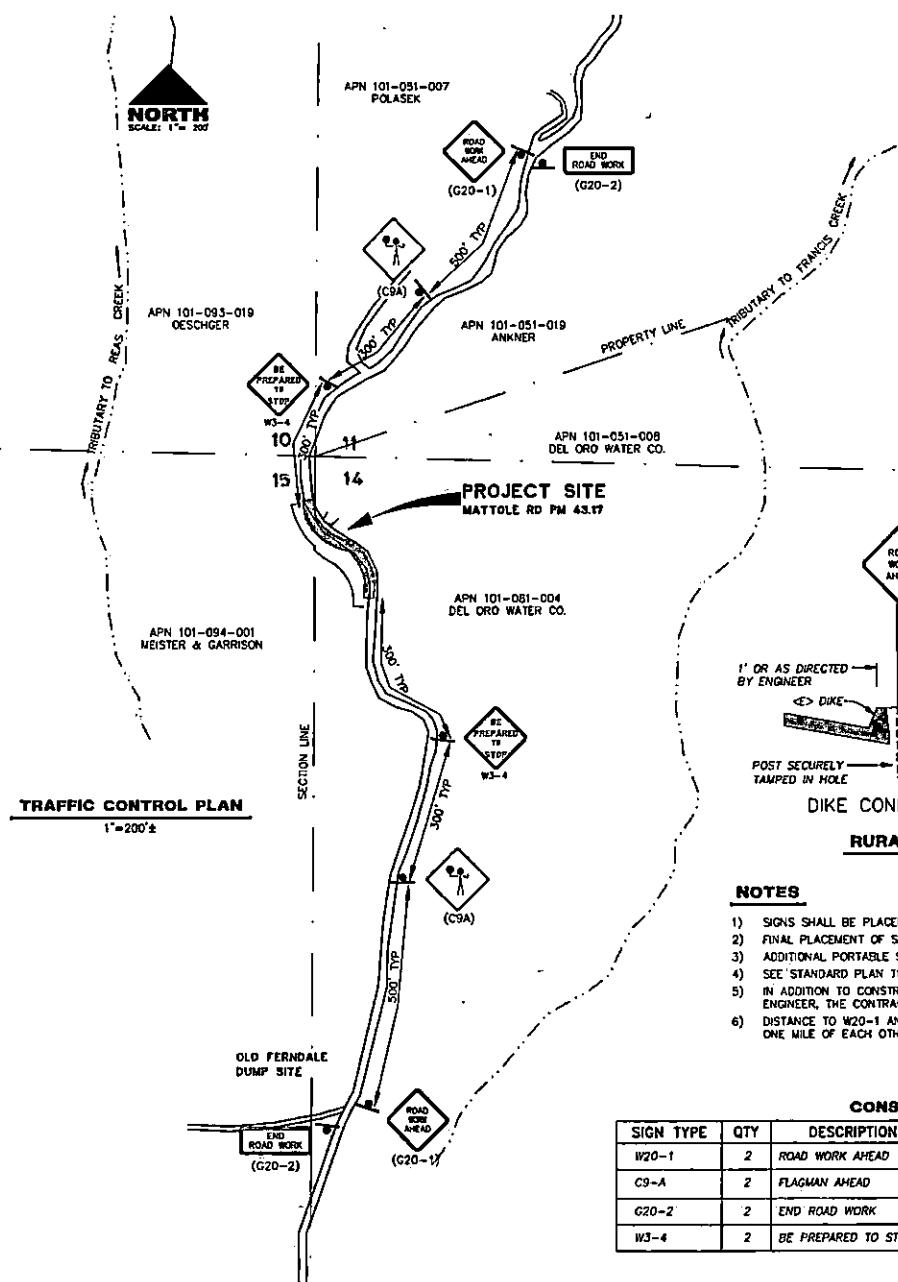

### RURAL CONSTRUCTION AREA SIGN

- NOT TO SCALE -

### NOTES

- 1) SIGNS SHALL BE PLACED AS SHOWN ON PLAN OR AS DIRECTED BY THE ENGINEER.
- 2) FINAL PLACEMENT OF SIGNS SHALL BE APPROVED BY RESIDENT ENGINEER.
- 3) ADDITIONAL PORTABLE SIGNS SHALL BE USED AS REQUIRED FOR OTHER ROADSIDE WORK.
- 4) SEE STANDARD PLAN 113 FOR TRAFFIC CONTROL SYSTEM.
- 5) IN ADDITION TO CONSTRUCTION AREA SIGNS AND WHEN DIRECTED BY THE RESIDENT ENGINEER, THE CONTRACTOR SHALL UTILIZE FLAGMEN AS NECESSARY TO DIRECT TRAFFIC.
- 6) DISTANCE TO W20-1 AND G20-2 MAY BE EXTENDED TO ENCOMPASS SITES WITHIN ONE MILE OF EACH OTHER.

### CONSTRUCTION AREA SIGN SUMMARY

| SIGN TYPE | QTY | DESCRIPTION         | SIZE      | REMARKS                 | POST SIZE | NUMBER |
|-----------|-----|---------------------|-----------|-------------------------|-----------|--------|
| W20-1     | 2   | ROAD WORK AHEAD     | 36" x 36" | VISIBLE AT ALL TIMES    | 4" x 4"   | 1      |
| C9-A      | 2   | FLAGMAN AHEAD       | 36" x 36" | COVERED WHEN NOT IN USE | 4" x 4"   | 1      |
| G20-2     | 2   | END ROAD WORK       | 36" x 18" | VISIBLE AT ALL TIMES    | 4" x 4"   | 1      |
| W3-4      | 2   | BE PREPARED TO STOP | 36" x 36" | COVERED WHEN NOT IN USE | 4" x 4"   | 1      |



|                                                                 |                           |                  |                  |                  |                  |
|-----------------------------------------------------------------|---------------------------|------------------|------------------|------------------|------------------|
| DATE IS ONE INCH ON ORIGINAL DRAWING                            | PROJECT NO. 2017-00000000 | CA NO. 01-000000 | DESIGNED BY: JES | REVIEWED BY: JES | APPROVED BY: JES |
| IF NOT ONE INCH ON THIS SHEET, ALL DIMENSIONS SHALL BE AS SHOWN | PROJECT NO. 2017-00000000 | CA NO. 01-000000 | DESIGNED BY: JES | REVIEWED BY: JES | APPROVED BY: JES |
| DATE: 2/18/2017                                                 | PROJECT NO. 2017-00000000 | CA NO. 01-000000 | DESIGNED BY: JES | REVIEWED BY: JES | APPROVED BY: JES |

3  
of  
6

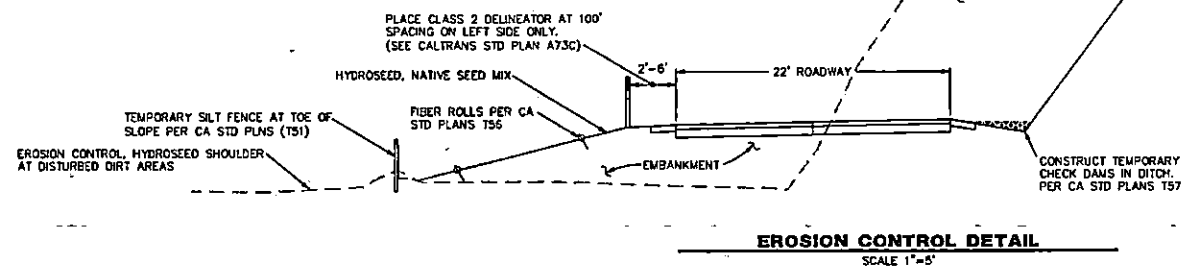
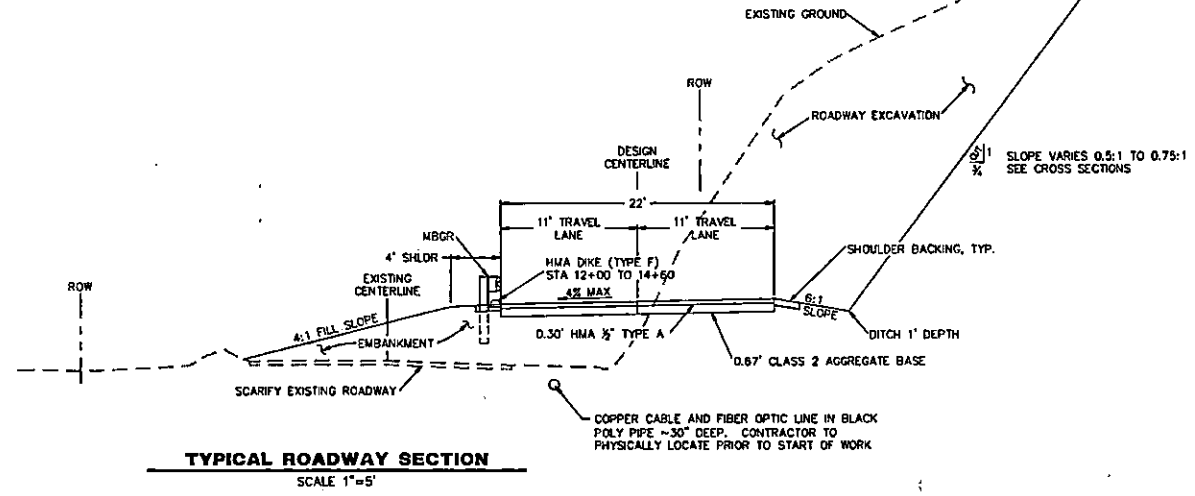
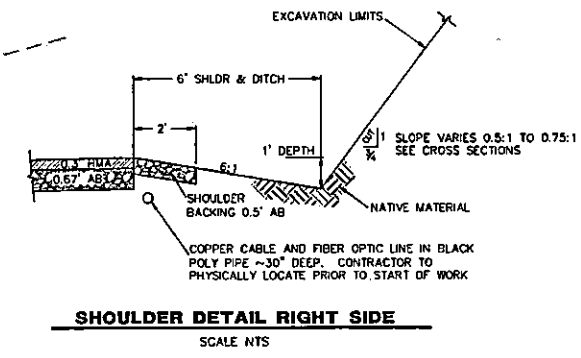
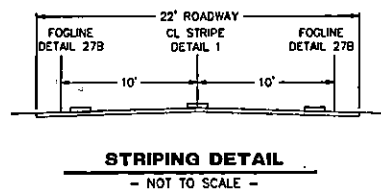
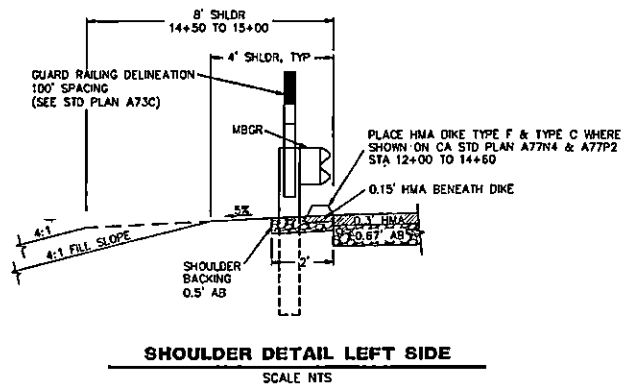



DATE OF ONE COPY ON ORIGINAL DRAWING: 01-25-2017  
IF NOT ONE COPY ON ORIGINAL DRAWING, SCALE ACCORDINGLY  
ROAD NAME: MATTIOL ROAD  
ROAD NO.: 3000  
PROJECT NO.: DA 4020004  
CONTRACT NO.: F1020  
DRAWING FILE NAME: L:\PROJECTS\4020004\3000\3000.DWG  
PLOT DATE: 2/16/2017  
DESIGN SECTION: NORTH L. BLUMETT  
MILE POST: 4.17  
SHEET NO.: 01-25-2017  
DESIGNED BY: JMS  
DRAWN BY: JMS  
CHECKED BY: BJS  
APPROVED BY: BJS

COUNTY OF HUMBOLDT  
DEPARTMENT OF PUBLIC WORKS  
MATTIOL ROAD (3000) PM 43.17  
TYPICAL SECTIONS AND DETAILS

SHEET  
4  
OF  
6

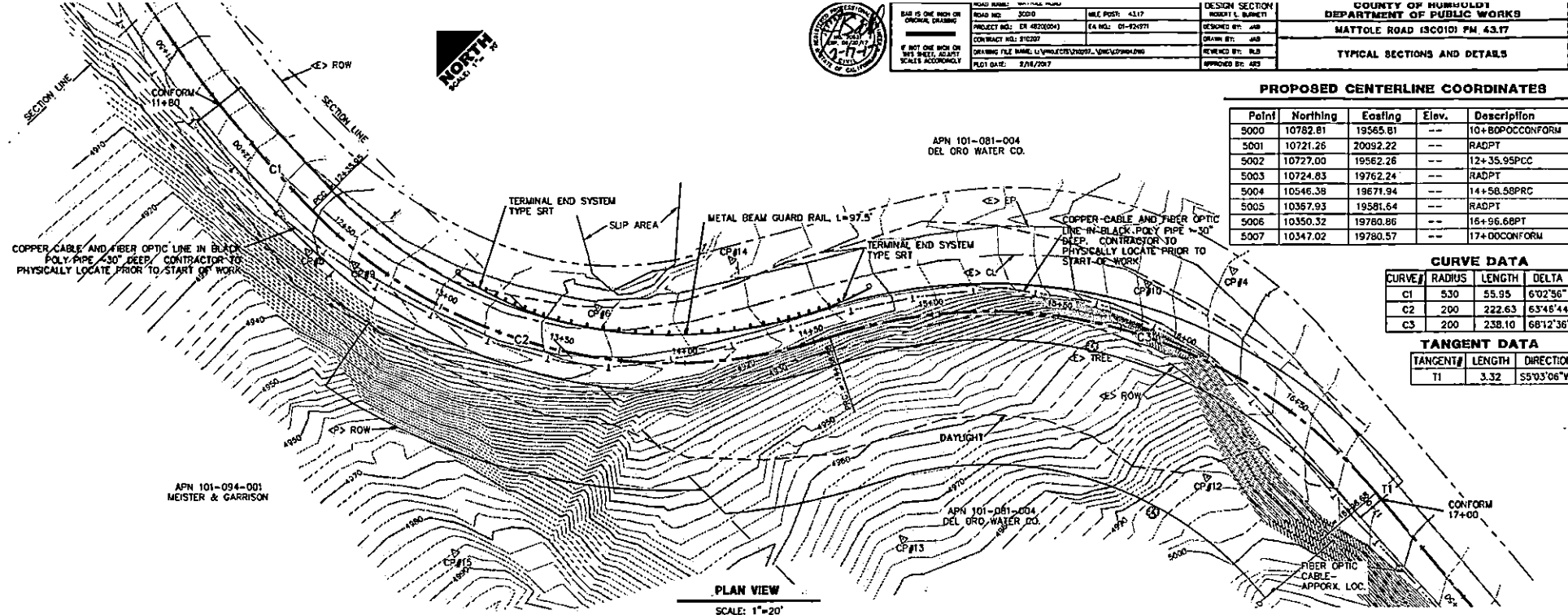

| PROPOSED CENTERLINE COORDINATES |          |          |       |                  |
|---------------------------------|----------|----------|-------|------------------|
| Point                           | Northing | Easting  | Elev. | Description      |
| 5000                            | 10782.81 | 19565.61 | ---   | 10+80.00 CONFORM |
| 5001                            | 10721.26 | 20092.22 | ---   | RADPT            |
| 5002                            | 10727.00 | 19562.26 | ---   | 12+35.95 PCC     |
| 5003                            | 10724.83 | 19762.24 | ---   | RADPT            |
| 5004                            | 10546.38 | 19671.94 | ---   | 14+58.58 PRC     |
| 5005                            | 10367.93 | 19581.64 | ---   | RADPT            |
| 5006                            | 10350.32 | 19780.86 | ---   | 16+96.68 PT      |
| 5007                            | 10347.02 | 19780.57 | ---   | 17+00.00 CONFORM |

| CURVE DATA |        |        |           |
|------------|--------|--------|-----------|
| CURVE#     | RADIUS | LENGTH | DELTA     |
| C1         | 530    | 55.95  | 6°02'56"  |
| C2         | 200    | 222.63 | 63°46'44" |
| C3         | 200    | 238.10 | 68°12'36" |

| TANGENT DATA |        |            |
|--------------|--------|------------|
| TANGENT#     | LENGTH | DIRECTION  |
| T1           | 3.32   | S5°03'06"W |

PLAN VIEW  
SCALE: 1"=20'

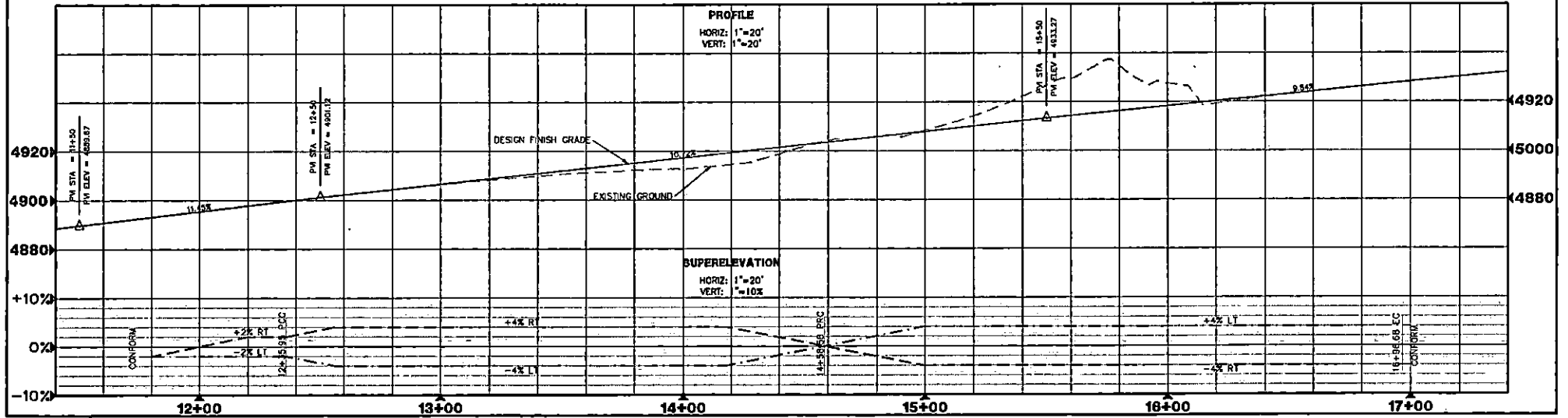



|                     |  |                     |                     |
|---------------------|--|---------------------|---------------------|
| DATE OF THIS REPORT |  | DATE OF THIS REPORT | DATE OF THIS REPORT |
| PROJECT NO.         |  | PROJECT NO.         | PROJECT NO.         |
| SHEET NO.           |  | SHEET NO.           | SHEET NO.           |
| DRAWN BY            |  | CHECKED BY          | CHECKED BY          |
| DESIGNED BY         |  | APPROVED BY         | APPROVED BY         |
| FIELD DATE          |  | FIELD DATE          | FIELD DATE          |

|                                 |  |                                 |
|---------------------------------|--|---------------------------------|
| COUNTY OF PRINCE GEORGE         |  | DEPARTMENT OF PUBLIC WORKS      |
| HAZLEWOOD ROAD SECTION PM 43.17 |  | HAZLEWOOD ROAD SECTION PM 43.17 |
| CROSS SECTIONS                  |  | CROSS SECTIONS                  |

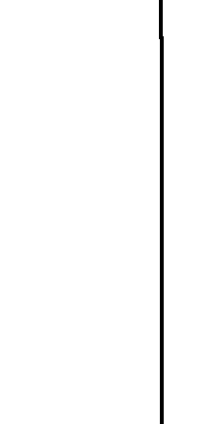
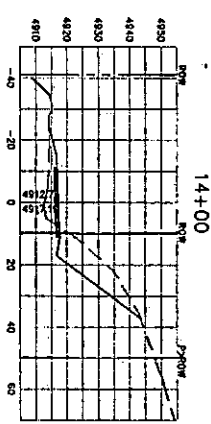
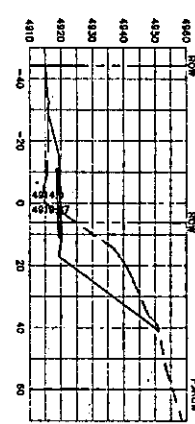
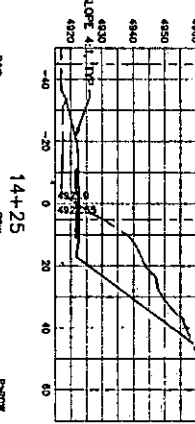
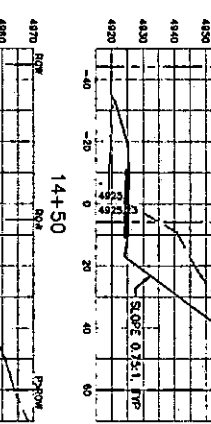
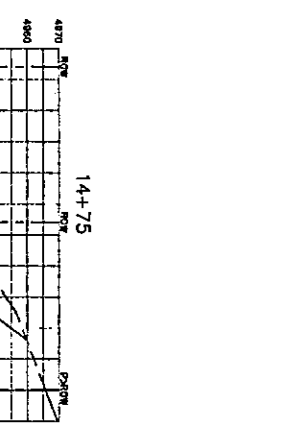
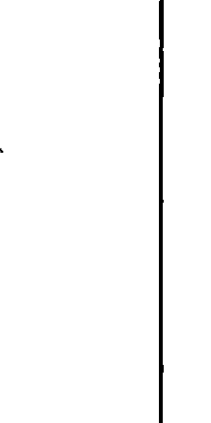
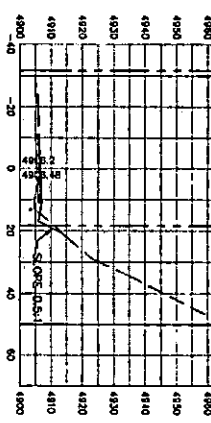
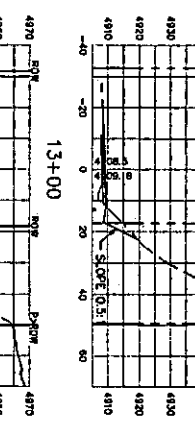
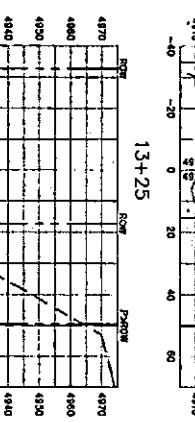
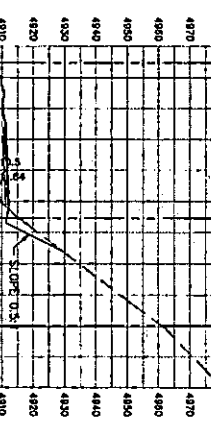
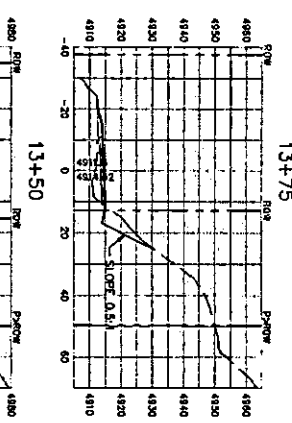
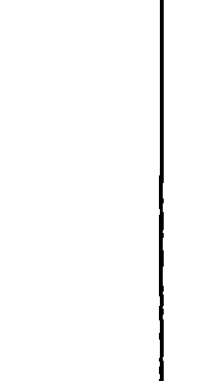
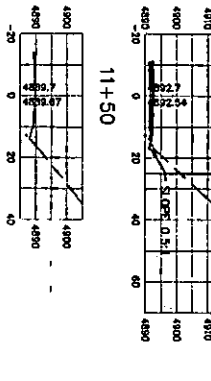
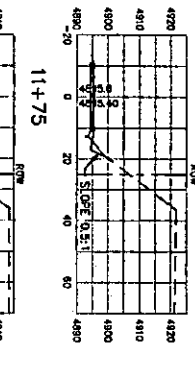
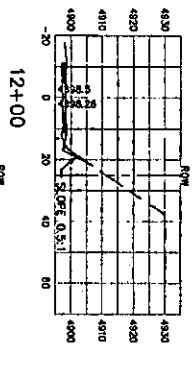
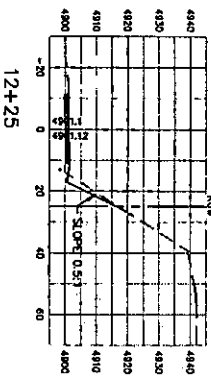
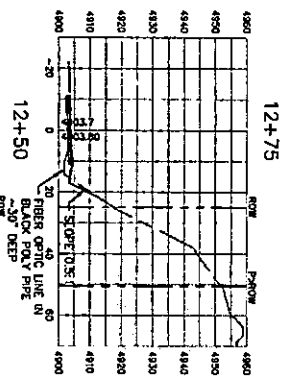

CUT SLOPES ARE 0.75:1 UNLESS SHOWN OTHERWISE  
SCALE 1"=20' H.V



|                                 |                  |                  |                  |
|---------------------------------|------------------|------------------|------------------|
| DATE OF THIS MAP OR<br>REVISION | DATE MADE        | MAP NO.          | SECTION          |
| 10/1/77                         | 10/1/77          | 137              | SECTION          |
| PROJECT NO. 137                 | PROJECT NO. 137  | PROJECT NO. 137  | PROJECT NO. 137  |
| CONTRACT NO. 137                | CONTRACT NO. 137 | CONTRACT NO. 137 | CONTRACT NO. 137 |
| DESIGNED BY                     | DESIGNED BY      | DESIGNED BY      | DESIGNED BY      |
| CHECKED BY                      | CHECKED BY       | CHECKED BY       | CHECKED BY       |
| APPROVED BY                     | APPROVED BY      | APPROVED BY      | APPROVED BY      |

|                             |         |
|-----------------------------|---------|
| COUNTY OF HUMBOLDT          | SECTION |
| DEPARTMENT OF PUBLIC WORKS  | SECTION |
| MATTOLE ROAD (SC01) PM 4.17 | SECTION |
| CROSS SECTIONS              | SECTION |

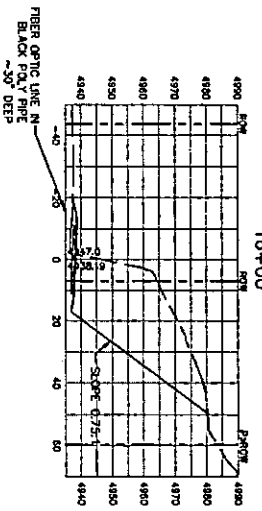
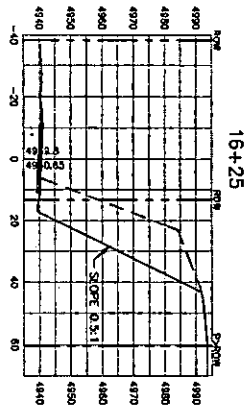
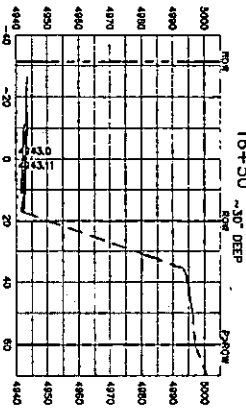
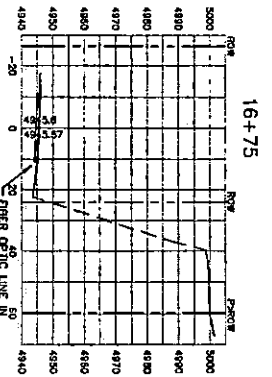

17+50

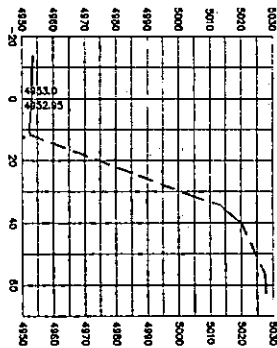

17+25

