

ATTACHMENT 5

**CERTIFICATION OF REZONING
(Notice of Timberland Production Zone Status)**

Recording Requested By:
PLANNING DEPARTMENT
COUNTY OF HUMBOLDT

Exempt from fees per Government Code Section 27383

Return To:
Planning and Building Department – Planning Division
3015 H Street
Eureka, CA 95501-4484

Clerk: MM Total: \$0.00
Oct 5, 2015 at 11:15:24
CONFORMED COPY

CERTIFICATION OF REZONING
(NOTICE OF TIMBERLAND PRODUCTION ZONE STATUS)

Pursuant to Government Code Sections 51117, 51140 and 51141, I hereby certify that on September 1, 2015, the Humboldt County Board of Supervisors, by Ordinance No. 2535, rezoned lands in the Blocksburg area, an approximate 206 acres to Timberland Production Zone (TPZ), more fully described in said Ordinance and the map for the rezoned land (Exhibit A and B to Ordinance), a copy of which is attached to this Certification.

The ordinance shall take effect and be in full force thirty (30) days from the date of its passage.

DATED: September 1, 2015



Chair, Board of Supervisors *Estelle Fennell*
County of Humboldt, State of California.

CERTIFICATE OF ACKNOWLEDGMENT

A notary public or other officer completing this certificate verifies only the identity of the individual who signed the document, to which this certificate is attached, and not the truthfulness, accuracy, or validity of that document.

STATE OF CALIFORNIA }
COUNTY OF HUMBOLDT }

On this 5 day of October 20 15, before me, Catherine Whitman Munsee
Public Notary, personally appeared Estelle Fennell who proved to me on the basis of
satisfactory evidence to be the person whose name is subscribed to the within instrument and acknowledged
to me that he executed the same in his authorized capacity, and that by his signature on behalf of which the
person acted, executed the instrument.

I certify under PENALTY OF PERJURY under the laws of the State of California that the foregoing is true and
correct.

Witness my hand and official seal.

Catherine Whitman Munsee (seal)
Signature

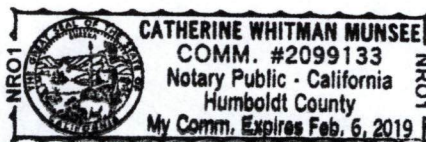

**BOARD OF SUPERVISORS, COUNTY OF HUMBOLDT
STATE OF CALIFORNIA**

Certified copy of portion of proceedings, Meeting on September 1, 2015

ORDINANCE NO. 2535

**AMENDING SECTION 311-7 OF THE HUMBOLDT COUNTY CODE BY REZONING PROPERTY IN THE
BLOCKSBURG AREA [ZR-14-003 (Childs)]**

The Board of Supervisors of the County of Humboldt ordains as follows:

SECTION 1. ZONE AMENDMENT. Section 311-7 of the Humboldt County Code is hereby amended by reclassifying the property described in the Attached Exhibit A as follows: approximately 206 acres of Agriculture Exclusive with a combining zone specifying a minimum parcel size of 160 acres [AE-B5(160)] into Timberland Production Zone (TPZ).

The area described is also shown on the Humboldt County Zoning Map [V-39] and on the map attached as Exhibit A.

SECTION 2. EFFECTIVE DATE. This ordinance shall become effective thirty (30) days after the date of its passage.

PASSED, APPROVED, AND ADOPTED this 1 day of September 2015 on the following vote, to wit:

AYES: Supervisors: Sundberg, Lovelace, Fennell, Bohn

NOES: Supervisors:

ABSENT: Supervisors: Bass



Estelle Fennell, Chair
Board of Supervisors
County of Humboldt, State of California

(SEAL)

ATTEST:

Kathy Hayes
Clerk, Board of Supervisors
County of Humboldt, State of California

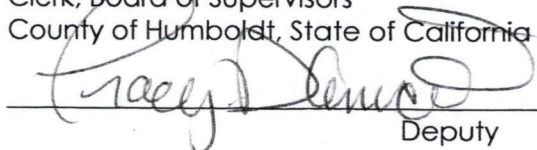

Deputy

PROPERTY DESCRIPTION

All that real property situated in the County of Humboldt, State of California described as follows:

The Southwest Quarter of the Northeast Quarter, the North Half of the Southeast Quarter and the Southeast Quarter of the Southeast Quarter of Section 28, Township 1 South, Range 5 East, Humboldt Meridian.

The Northeast Quarter of the Northeast Quarter of Section 33, Township 1 South, Range 5 East, Humboldt Meridian.

The Southwest Quarter of the Southeast Quarter of Section 28 and the Northwest Quarter of the Northeast Quarter, and the South Half of the Northeast Quarter of Section 33, Township 1 South, Range 5 East, Humboldt Meridian.

The East Half of the Northwest Quarter of Section 33, Township 1 South, Range 5 East, Humboldt Meridian.

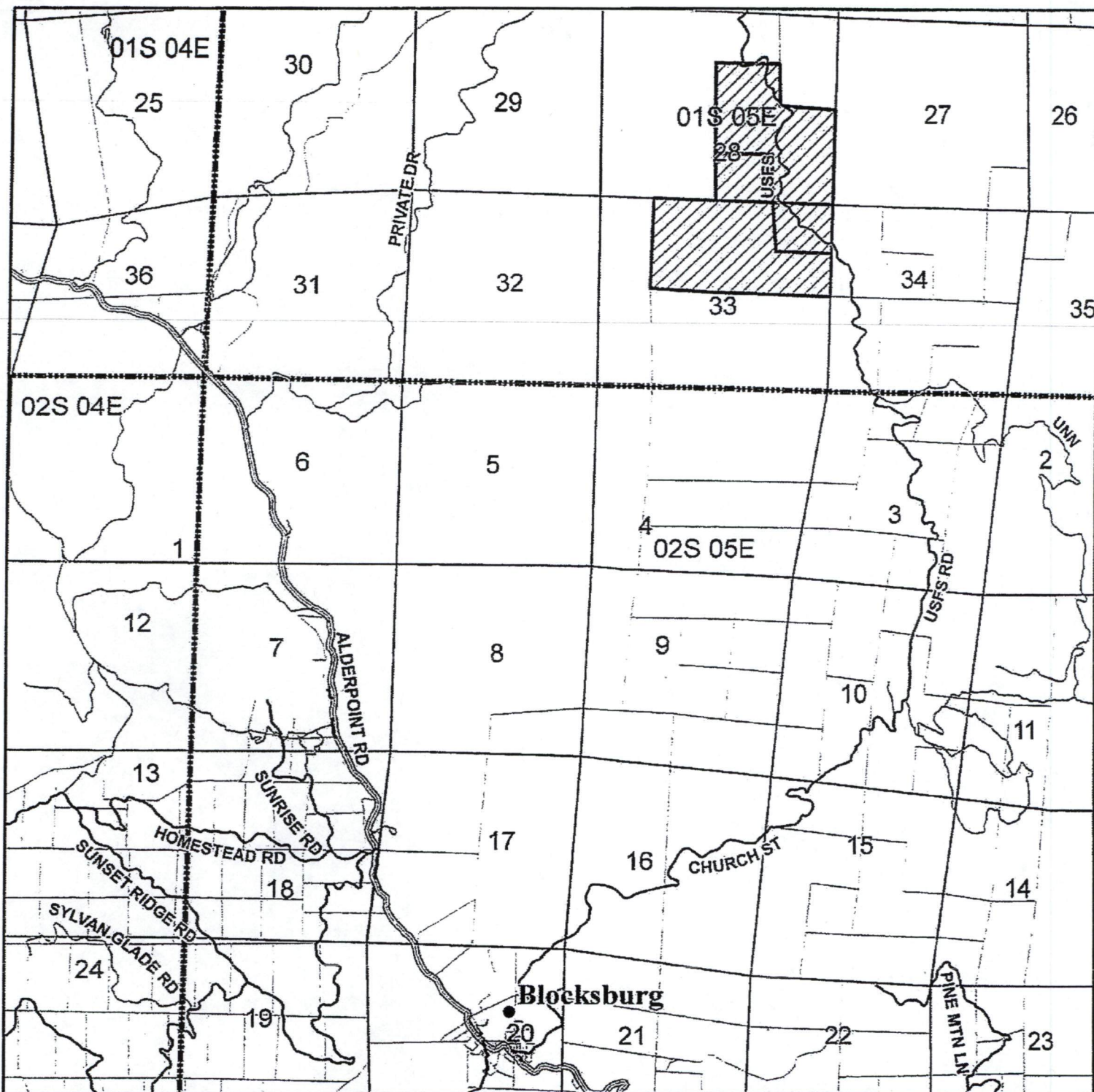

LOCATION MAP
PROPOSED CHILDS

Project Area = 

ZONE RECLASSIFICATION
BLOCKSBURG AREA
AGPN-14-007/ZR-14-003
APN: 210-174-004 et seq
T01S R05E S28,33 HB&M (Black Lassic)

This map is intended for display purposes and should not be used for precise measurement or navigation. Data has not been completely checked for accuracy.

0 0.25 0.5 0.75 1 Miles

RECEIPT



Transaction #: 58438
 Receipt #: 2015010179
 Cashier Date: 10/5/15 11:15
 Cashier By: MM
 Print Date: 10/5/2015 11:15:27

Kelly E. Sanders, Recorder
 Humboldt County, California
 825 5th Street
 Eureka, CA 95501
 (707) 445-7382

11:15:27
 10/5/2015

CUSTOMER INFORMATION		TRANSACTION INFORMATION		PAYMENT SUMMARY	
HUMBOLDT CNTY		Date Received:	October 5, 2015 11:13	Total Fees:	\$0.00
		Source Code:	10 a.m. Reservation	Total Payments:	\$0.00
		Return Code:	MAIL	Balance Due:	\$0.00
		Trans Type:	Recording		
		Bin Number:			
		Agent Ref Number:	X		

TRANSACTION PROBLEMS

1	Payment	
	EXEMPT	\$0.00
1	Official Record	
MISC	Document #: 2015-018989 Pages: 4 Date: 10/5/2015 11:15:24 From: HUMBOLDT CNTY To:	