

Proposed Alignment for Beach Access Mat Clam Beach North Lot



Beach Mat

Sand Path

Photo date: March 7, 2022

Proposed Alignment for Beach Access Mat Clam Beach North Lot



Beach Mat

Sand Path

The proposed beach mat alignment avoids conflicts with the bollard on the existing path and would help prevent unauthorized vehicles trying to access the beach.

The proposed beach mat alignment avoids an area that often has ponded water during the wet season, which could create an access barrier.

Photo date: March 7, 2022

Proposed Alignment for Beach Access Mat Clam Beach North Lot



Root mass provides physical separation to avoid user conflicts at entry point

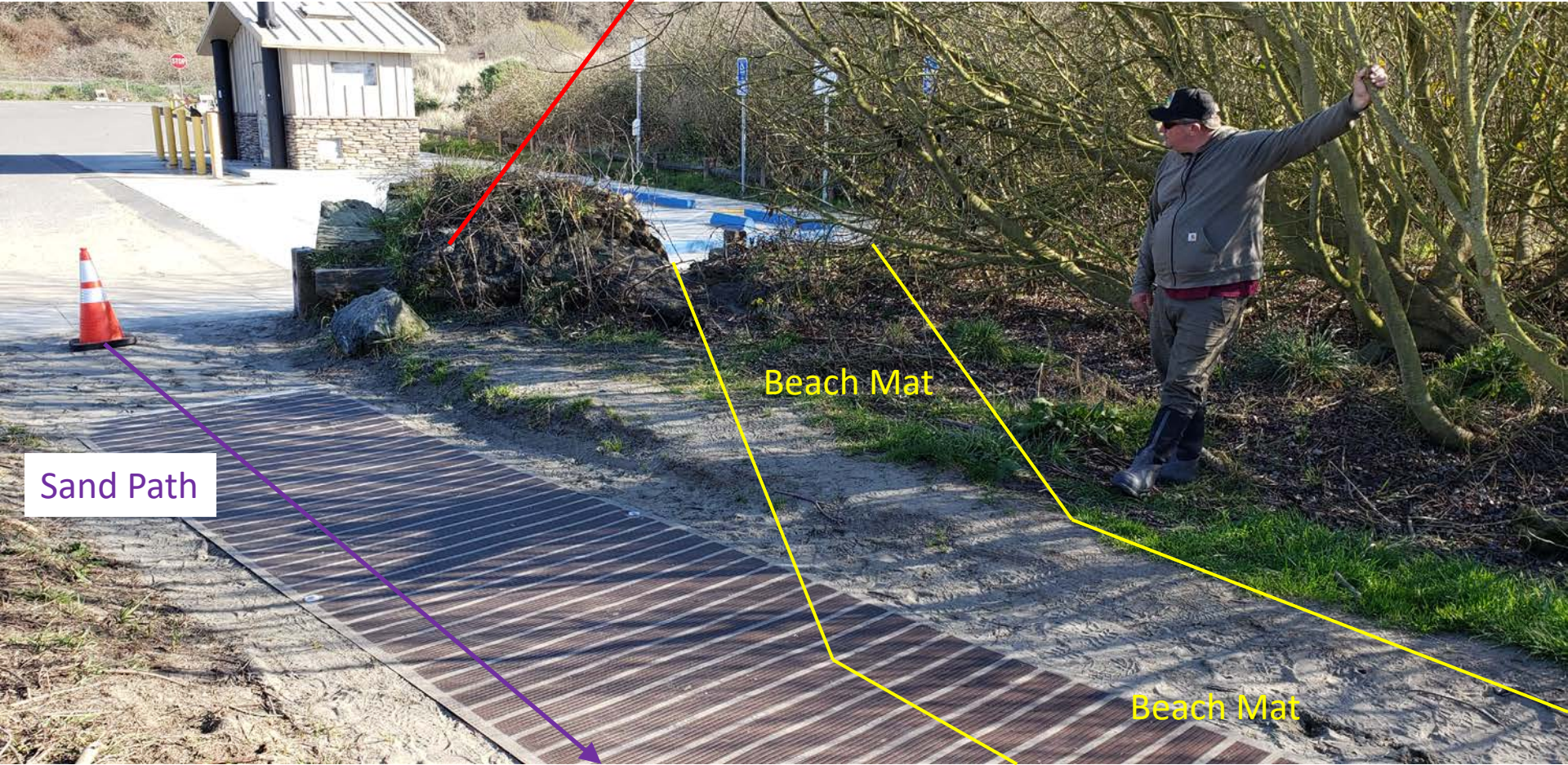

Sand Path

Beach Mat

Beach Mat

Sand Path

Proposed Alignment for Beach Access Mat Clam Beach North Lot



Site preparation work would include trimming overhanging tree limbs, removing a fence segment, clearing ground cover, and placing approximately 5 cubic yards of aggregate base.

Photo date: April 29, 2022

Proposed Alignment for Beach Access Mat Clam Beach North Lot



Photo date: April 29, 2022



PRELIMINARY
NOT FOR CONSTRUCTION

BAR IS ONE INCH ON ORIGINAL DRAWING IF NOT ONE INCH ON THIS SHEET, ADJUST SCALES ACCORDINGLY	ROAD NAME: CLAM BEACH	DESIGN SECTION: ENGINEERING	COUNTY OF HUMBOLDT DEPARTMENT OF PUBLIC WORKS CLAM BEACH WHEELCHAIR MAT ROUTE ROUTE OPTION #1 (ROTATE STUMP)	SHEET 1 OF 1
	ROAD NO.: N/A FED PROJECT NO.: N/A CONTRACT NO.: 163049 DRAWING FILE NAME: 163049 Design PLOT DATE: 4/25/2022	MILE POST: N/A DESIGNED BY: HUMCO DRAWN BY: MMS REVIEWED BY: APPROVED BY:		

PRELIMINARY QUANTITIES		
ITEM	UNIT	QUANTITY
CLEARING/WIDENING	SQFT	1020
WHEELCHAIR MATS	EA	20

LINE LEGEND

- HIGH TIDE LINE
- EXISTING BEACH ACCESS TRAIL
- LOGS AND WOOD DEBRIS
- EDGE OF VEGETATION

BASIS OF BEARINGS NOTE

BEARINGS SHOWN HEREON ARE BASED ON THE CALIFORNIA STATE PLANE COORDINATE SYSTEM (CCS83), ZONE 1, EPOCH 2010.00, HAVING A CONVERGENCE ANGLE OF -01'22"52" AT CONTROL POINT NUMBER 2 BEING A SET GIN SPIKE WITH TAG STAMPED "HUMCO SURVEY". THE BEARINGS FOR THIS PROJECT ARE IN GRID, HOWEVER THE DISTANCES HAVE BEEN SCALED TO GROUND DISTANCES; ROTATE GRID BEARINGS HEREON COUNTERCLOCKWISE 01'22"52" TO OBTAIN GEODETIC (TRUE) BEARINGS. MULTIPLY GROUND DISTANCES HEREIN BY THE COMBINED SCALE FACTOR OF 0.99990277 TO OBTAIN "GRID" DISTANCES.

ELEVATION NOTE

VERTICAL DATUM: NAVD 88 (COMPUTED USING GEOID18) BASED UPON GPS STATIC OBSERVATION AT CONTROL POINT NUMBER 2 AND PROCESSED USING NGS OPUS; ELEVATION BEING 21.73'.

SURVEY NOTE

- THE PURPOSE OF THIS SURVEY IS TO DETERMINE TOPOGRAPHY TO PLAN THE BEACH ACCESS ROUTE FOR A VINYL WHEELCHAIR MAT.
- UNDERGROUND UTILITIES RESEARCH WAS NOT PERFORMED. ONLY VISIBLE UTILITIES WERE TIED AT THE TIME OF THIS SURVEY.
- THERE MAY BE SYMBOLS SHOWN IN THE LEGEND THAT ARE NOT USED IN THIS SURVEY.

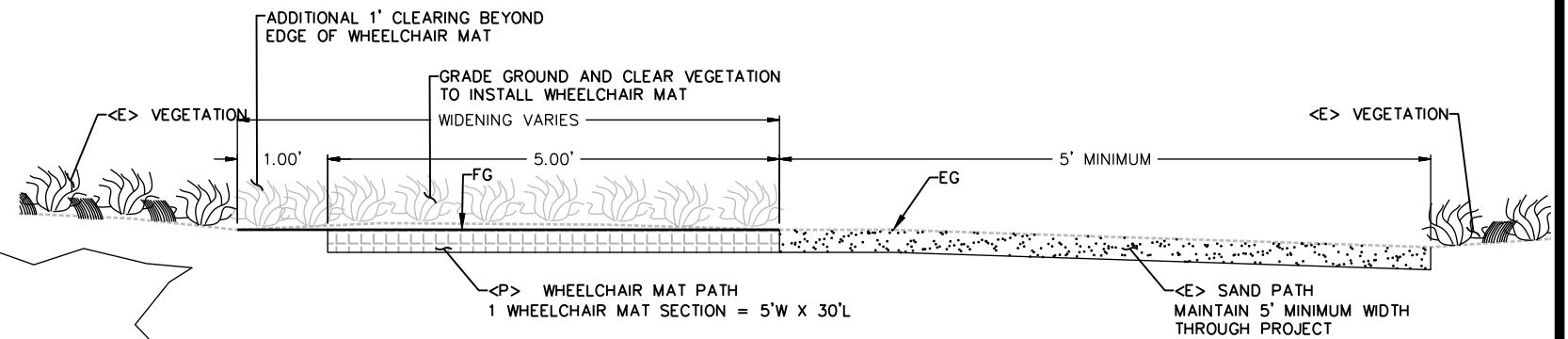
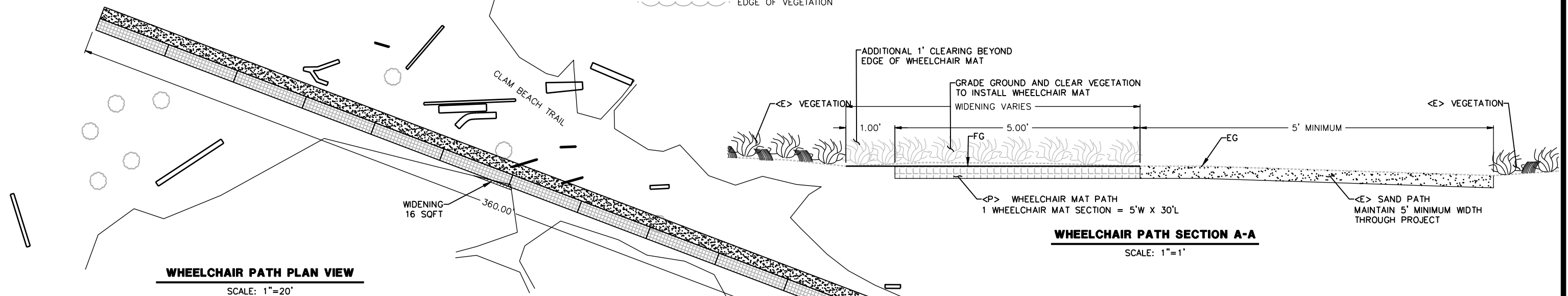

WHEELCHAIR PATH SECTION A-A

SCALE: 1"=1'

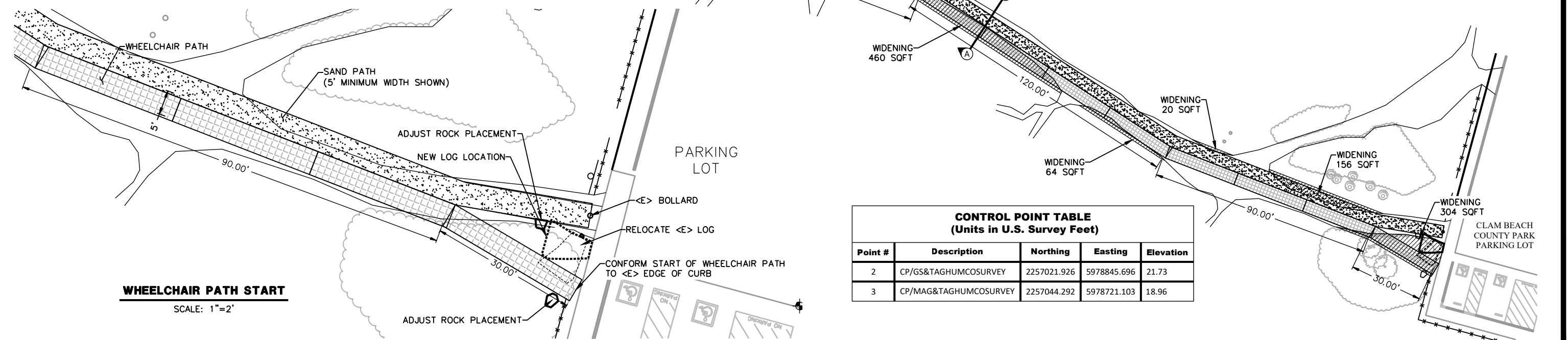

WHEELCHAIR PATH START

SCALE: 1"=2'

CONTROL POINT TABLE (Units in U.S. Survey Feet)				
Point #	Description	Northing	Easting	Elevation
2	CP/GS&TAGHUMCOSURVEY	2257021.926	5978845.696	21.73
3	CP/MAG&TAGHUMCOSURVEY	2257044.292	5978721.103	18.96