



COUNTY OF HUMBOLDT

AGENDA ITEM NO.
H-2

For the meeting of: February 10, 2015

Date: January 21, 2015

To: Board of Supervisors

From: *(M)* Thomas K. Mattson, Director of Public Works

Subject: INTRODUCTION OF ORDINANCE: AMENDING SECTIONS 431-48, 431-85, 431-96.6, AND 431-109 RELATING TO PARKING ON HARRIS STREET, PARK STREET, SCENIC DRIVE, AND WALNUT STREET, AND AMENDING SECTION 435-3 REGARDING ESTABLISHMENT OF CLASS II BICYCLE LANES IN MCKINLEYVILLE AND EUREKA TO TITLE IV OF THE HUMBOLDT COUNTY CODE

RECOMMENDATION(S): That the Board of Supervisors:

1. Introduce the attached Ordinance by title and waive the first reading;
2. Set the Ordinance for adoption on February 24, 2015 or at least one week from that date;
3. Direct the Clerk of the Board to publish the pre-adoption summary of the Ordinance and to post a certified copy of the full text of the proposed Ordinance in the office of the Clerk of the Board, both the publication and posting to be done at least five (5) days prior to the Board meeting at which the Ordinance will be adopted. [Government Code Section 25124 (b)(1)];
4. Direct the Clerk of the Board, within 15 days after adoption of the Ordinance, to publish a post-adoption summary of the ordinance with the names of the Supervisors voting for and against the Ordinance, and to post in the office of the Clerk of the Board a certified copy of the full text of the adopted Ordinance and amendments along with the names of those

Prepared by Art Reeve CAO Approval Cheryl Willingham

REVIEW:

Auditor _____ County Counsel Sm Personnel _____ Risk Manager _____ Other _____

TYPE OF ITEM:

- Consent
- Departmental
- Public Hearing
- Other _____

PREVIOUS ACTION/REFERRAL:

Board Order No. _____

Meeting of: _____

BOARD OF SUPERVISORS, COUNTY OF HUMBOLDT

Upon motion of Supervisor Sundberg Seconded by Supervisor Bass

Ayes Sundberg, Lovelace, Fennell, Bohn, Bass
Nays _____
Abstain _____
Absent _____

and carried by those members present, the Board hereby approves the recommended action contained in this Board report.

Dated: Feb. 10, 2015
By: [Signature]
Kathy Hayes, Clerk of the Board

Supervisors voting for and against the Ordinance [Government Code Section 25124 (b)(1)];
and

5. Direct Public Works to file the attached Notice of Exemption with the County Clerk in accordance with the California Environmental Quality Act.

SOURCE OF FUNDING: Road Fund (1200325)

DISCUSSION:

The proposed ordinance prohibits parking along a portion of Harris Street, Park Street, and Walnut Street in Eureka, restricts parking on a portion of Scenic Drive in Trinidad, and includes additional bicycle lanes in McKinleyville and Eureka. (See Attachment 1)

The proposed no-parking zone on the south side of Harris Street (between Post Mile 0.871 to Post Mile 0.887) was requested by Humboldt County Department of Public Works Engineering Division to comply with the Humboldt Transit Authority Bus Shelter Project. (See Attachment 2)

The proposed no-parking zone on the south side of Park Street (between Post Mile 0.000 to Post Mile 0.048) was requested by Humboldt County Department of Public Works Engineering Division to comply with the Humboldt Transit Authority Bus Shelter Project and because the roadway narrows in this area, to comply with the new class II bicycle lane. (See Attachment 2)

The proposed no-parking zone on the northwest side of Walnut Street (between Post Mile 0.871 to Post Mile 0.887) was requested by the Cutten School and the Safe Routes to School Committed Taskforce to comply to the recommendations of the "Walkability Audit and Workshop Outcomes Winship Middle School and Cutten Elementary School," April 16, 2013. (See Attachment 3)

The proposed limited parking from 10:00 p.m. to 5:00 a.m. on Scenic Drive (between Post Mile 2.313 to Post Mile 2.343) was requested by the Trinidad Rancheria, to prohibit overnight parking. (See Attachment 4)

The additional established Class II Bicycle Lanes on School Road in McKinleyville, and Park Street in Eureka are recently completed projects and need only to be codified.

The proposed ordinance revision is considered a project under the California Environmental Quality Act (CEQA). This project is categorically exempt from environmental review pursuant to Section 15301 (Existing Facilities) and Section 15305 (Minor Alterations in Land Use Limitations) of the CEQA Guidelines, and the application of this categorical exemption is not barred by one of the exceptions set forth in Section 15300.2 of the CEQA Guidelines. A Notice of Exemption is included in Attachment 5.

FINANCIAL IMPACT:

The cost for the manufacturing and installation of the regulatory signs are estimated at \$130.00 per sign and is covered in the Road Fund budget. There will be no impact to the General Fund.

The requested action conforms to the Board of Supervisors core roles of providing for and maintaining infrastructure and creating opportunities for improved safety.

OTHER AGENCY INVOLVEMENT:

California Highway Patrol, which enforces traffic laws on County roads

ALTERNATIVES TO STAFF RECOMMENDATIONS:

Not adopt the ordinance; however, this action would not improve traffic safety in these locations.

ATTACHMENTS:

1. Proposed Ordinance
2. Email and Construction Plans from Humboldt County Department of Public Works Engineering Division
3. Portions of the 'Walkability Audit and Workshop Outcomes Winship Middle School and Cutten Elementary School'
4. Letter from Trinidad Rancheria
5. Notice of Exemption under California Environmental Quality Act

ORDINANCE NO. _____

AN ORDINANCE OF THE BOARD OF SUPERVISORS OF THE COUNTY OF HUMBOLDT AMENDING SECTIONS 431-48, 431-85, 431-96.6, 431-109 AND 435-3 RELATING TO PARKING ON SCENIC DRIVE, HARRIS, PARK, AND WALNUT STREETS IN EUREKA AND TRINIDAD, AND ADDING BICYCLE LANES ON SCHOOL ROAD AND PARK STREET IN EUREKA AND MCKINLEYVILLE TO TITLE IV OF THE HUMBOLDT COUNTY CODE

The Board of Supervisors of the County of Humboldt ordains as follows:

SECTION 1. Sections 431-48, 431-85, 431-96.6, and 431-109 of Chapter 1 of Division 3 of Title IV of the Humboldt County Code are amended as shown on the attached pages.

SECTION 2. Section 435-3 of Chapter 5 of Division 3 of Title IV of the Humboldt County Code are amended as shown on the attached pages.

SECTION 3. This ordinance shall take effect and be in force thirty (30) days from the date of its passage. A summary shall be published at least five (5) days before the date set for adoption and again fifteen (15) days after passage of this ordinance. It shall be published once with the names of the Board of Supervisors voting for and against the ordinance in a newspaper of general circulation published in the County of Humboldt, State of California.

PASSED, APPROVED AND ADOPTED this _____ day of _____, 2015.

AYES: Supervisors--
NOES: Supervisors--
ABSENT: Supervisors--

Chair of the Board of Supervisors of the
County of Humboldt, State of California

(SEAL)

ATTEST:

Kathy Hayes, Clerk of the Board of Supervisors
County of Humboldt

431-44. PARKING ON GRIZZLY BLUFF ROAD.

The parking of vehicles is hereby prohibited at all times on the east side of Grizzly Bluff Road (County Road No. F2G100) between Post Mile 4.30 and Post Mile 4.65 (P.K. 6.92 to P.K. 7.48). (Ord. 999, § 1, 10/08/74)

431-46. PARKING ON HALIBUT AVENUE.

The parking of vehicles is hereby prohibited at all times on both sides of Halibut Avenue (County Road 3J830) from its intersection with Buhne Drive (County Road 3J811) to the end of Halibut Avenue (the entire length thereof). (Ord. 2303, § 1, 07/01/2003)

431-48. PARKING ON HARRIS STREET.

(a) The parking of vehicles is hereby prohibited at all times on the north side of Harris Street (County Road No. A3K320) between Post Mile 0.000 and Post Mile 0.522 (P.K. 0.000 to P.K. 0.840), between Post Mile 0.617 and Post Mile 0.623 (P.K. 0.993 to P.K. 1.003), between Post Mile 0.641 and Post Mile 0.648 (P.K. 1.032 to P.K. 1.043). (Ord. 1155, § 2, 08/16/77; Ord. 2147a, § 3, 05/27/97; Ord. 2430, § 1, 04/27/2010)

(b) The parking of vehicles is hereby prohibited at all times on the south side of Harris Street (County Road No. A3K320) between Post Mile 0.036 and Post Mile 0.044 (P.K. 0.058 to P.K. 0.071), between Post Mile 0.050 and Post Mile 0.058 (P.K. 0.080 to P.K. 0.093), between Post Mile 0.083 and Post Mile 0.091 (P.K. 0.134 to P.K. 0.146), between Post Mile 0.098 and Post Mile 0.106 (P.K. 0.158 to P.K. 0.171), between Post Mile 0.183 and Post Mile 0.193 (P.K. 0.295 to P.K. 0.311), between Post Mile 0.200 and Post Mile 0.207 (P.K. 0.322 to P.K. 0.333), between Post Mile 0.230 and Post Mile 0.250 (P.K. 0.370 to P.K. 0.402), between Post Mile 0.274 and Post Mile 0.303 (P.K. 0.441 to P.K. 0.488), between Post Mile 0.339 and Post Mile 0.346 (P.K. 0.546 to P.K. 0.557), between Post Mile 0.354 and Post Mile 0.362 (P.K. 0.570 to P.K. 0.583), between Post Mile 0.434 and Post Mile 0.440 (P.K. 0.698 to P.K. 0.708), between Post Mile 0.447 and Post Mile 0.454 (P.K. 0.719 to P.K. 0.731), between Post Mile 0.515 and Post Mile 0.547 (P.K. 0.829 to P.K. 0.880). (Ord. 1639, § 1, 04/24/84; Ord. 1747, § 1, 08/05/86; Ord. 2430, § 1, 04/27/2010)

(c) The parking of vehicles is hereby prohibited at all times on the south side of Harris Street (County Road No. A3K320) between Post Mile 0.0 and Post Mile 0.036 (P.K. 0.0 to P.K. 0.058). (Ord. 2454, § 1, 05/24/2011)

(d) The parking of vehicles is hereby prohibited at all times on the south side of Harris Street (County Road No. A3K320) from Post Mile 0.541 to Post Mile 0.551 (P.K. 0.871 to P.K. 0.887). (Ord. _____, § __, __/__/2015)

431-51. PARKING ON HARRISON AVENUE EXTENSION.

The parking of vehicles is hereby prohibited at all times on the east side of Harrison Avenue Extension (#F3K305) between Post Mile 0.00 and Post Mile 0.029 (P.K. 0.00 to P.K. 0.07). (Ord. 2340, § 1, 10/04/2011)

431-52. PARKING ON HARRISON AVENUE.

(a) The parking of vehicles is hereby prohibited at all times on the east side of Harrison Avenue (County Road No. F3K305) between Post Mile 1.007 to Post Mile 1.100 (P.K. 1.620 to P.K. 1.770), between Post Mile 0.932 to Post Mile 0.933 (P.K. 1.500 to P.K. 1.501), between Post Mile 0.914 to Post Mile 0.927 (P.K. 1.471 to P.K. 1.492), between Post Mile 0.892 to Post Mile 0.899 (P.K. 1.436 to P.K. 1.447), between Post Mile 0.834 to Post Mile 0.869 (P.K. 1.342 to P.K. 1.399), between Post Mile 0.655 to Post Mile 0.789 (P.K. 1.054 to P.K. 1.270), between Post Mile 0.565 to Post Mile 0.600 (P.K. 0.909 to P.K. 0.966), between Post Mile 0.540 to Post Mile 0.555 (P.K. 0.869 to P.K. 0.893), between Post Mile 0.514 to Post Mile 0.520 (P.K. 0.827 to 0.837), between Post Mile 0.471 to Post Mile 0.510 (P.K. 0.758 to P.K. 0.821), between Post Mile 0.340 to Post Mile 0.384 (P.K. 0.547 to P.K. 0.618), between Post Mile 0.000 to Post Mile 0.042 (P.K. 0.000 to P.K. 0.068). (Ord. 1384, § 1, 3/4/80; Ord. 1605, § 1, 7/26/83; Ord. 2147a, § 3, 5/27/97; Ord. 2292, 01/07/2003; Ord. 2489, § 3, 10/02/2012; Ord. 2518, § 1, 09/23/2014)

(b) The parking of vehicles is hereby limited to 15 minutes on the east side of Harrison Avenue (#F3K305) from Post Mile 0.635 to Post Mile 0.643 (P.K. 1.022 to P.K. 1.035). (Ord. 2460, § 2, 10/04/2011; Ord. 2489, § 3, 10/02/2012; Ord. 2518, § 1, 09/23/2014)

(c) The parking of vehicles is hereby limited to 15 minutes on the east side of Harrison Avenue (County Road No. F3K305) from its intersection with Roane Avenue (County Road No. 3K440) Post Mile 0.60 to Post Mile 0.50 (P.K. 0.97 to P.K. 0.80). (Ord. 2489, § 3, 10/02/2012)

(d) The parking of vehicles is hereby prohibited at all times on the east side of Harrison Avenue (County Road No. F3K305) from Post Mile 0.592 to Post Mile 0.599 (P.K. 0.953 to P.K. 0.964). (Ord. 2513, § 1, 02/04/2014)

431-53. PARKING ON HATCHERY ROAD.

(a) Parking is hereby prohibited from 10:00 p.m. to 5:00 a.m. along either side of Hatchery Road (County Road No. 5L015) from Post Mile 0.00 (Blue Lake City Limit) to Post Mile 0.61 (West End Road). (Ord. 2386, § 4, 05/01/2007; Ord. 2489, § 3, 10/02/2012)

(b) The Parking of vehicles is hereby prohibited at all times on the west side of Hatchery Road (County Road No. 5L015) from Post Mile 1.335 to Post Mile 1.410 (P.K. 2.148 to P.K. 2.269). (Ord. 2489, § 3, 10/02/2012)

431-54. PARKING ON HEMLOCK STREET.

The parking of vehicles is hereby prohibited at all times on the south side of Hemlock Street (County Road No. 3K261) between Post Mile 0.043 and Post Mile 0.076 (P.K. 0.069 and P.K. 0.122). (Ord. 2354, § 1, 12/06/2005)

431-56. PARKING ON HERRICK AVENUE.

The parking of vehicles is hereby prohibited at all times on the north side of Herrick Avenue (County Road No. A3J410) between Post Mile 0.77 and Post Mile 0.87 (P.K. 1.24 to P.K. 1.40) and on the south side of Herrick Avenue (County Road No. A3J410) between Post Mile 0.79 and Post Mile 0.87 (P.K. 1.28 to P.K. 1.40). The parking of vehicles is hereby prohibited between the hours of 10:00 p.m. and 5:00 a.m. on the south side of Herrick Avenue (County Road No. A3J410) from Post Mile 0.0 to Post Mile 0.02 (P.K. 0.0 to P.K. 0.03). (Ord. 1011 § 1, 1/14/75; Ord. 2337, § 2, 01/18/2005)

431-60. PARKING ON HUBBARD LANE.

(a) The parking of vehicles is hereby prohibited from the area located within 10 feet (3.048 meters) on each side of every driveway along both sides of Hubbard Lane (County Road No. 3K370) from its intersection with Harris Street to a point located 800 feet (243.84 meters) northerly. (Ord. 726, § 1, 6/23/70)

(b) Parking is prohibited at all times on Hubbard Lane (County Road No. 3K370) on the west side between Post Mile 0.00 to Post Mile 0.02 (P.K. 0.00 to P.K. 0.03) and Post Mile 0.06 to Post Mile 0.11 (P.K. 0.10 to P.K. 0.18). (Ord. 1140, § 1, 6/7/77; Ord. 1530, § 2, 5/18/82)

(c) The parking of vehicles is hereby prohibited at all times on the east side of Hubbard Lane (County Road No. 3K370) from Post Mile 0.062 for a distance of 75 feet south to Post Mile 0.048 (P.K. 0.1 to P.K. 0.077). (Ord. 2454, § 1, 05/24/2011)

(d) The parking of vehicles is hereby prohibited at all times on the south side of Hubbard Lane (County Road No. 3K370) from the intersection of Myrtle Avenue, Post Mile 0.23 to the existing no parking zone at Post Mile 0.17 (P.K. 0.37 to P.K. 0.27). (Ord. 2454, § 1, 05/24/2011)

(e) The parking lane of vehicles is hereby prohibited at all times on the north side of Hubbard Lane (County Road No. 3K370) from the intersection of Myrtle Avenue, Post Mile 0.23 to intersection of Hubbard Lane (County Road No. 3K375), Post Mile 0.165 (P.K. 0.37 to P.K. 0.27). (Ord. 2454, § 1, 05/24/2011)

431-61. PARKING ON HUMBOLDT AVENUE.

The parking of vehicles is hereby prohibited at all times on the west side of Humboldt Avenue (County Road No. 6B070) between Post Mile 0.00 and 0.04 (P.K. 0.00 to P.K. 0.067). (Ord. 2259, 12/04/2001)

431-61.5. PARKING ON KIMTU ROAD.

The parking of vehicles is hereby prohibited at all times on the north side of Kimtu Road (County Road No. 8M125) from Post Mile 0.40 to Post Mile 0.44 (P.K. 0.64 to P.K. 0.71). (Ord. 2497, § 3, 03/19/2013)

431-62. PARKING ON KING SALMON AVENUE.

The parking of vehicles is hereby prohibited between the hours of 10:00 p.m. and 5:00 a.m. on King Salmon Avenue (County Road No. 3J810) from Post Mile 0.0 to Post Mile 0.01 (P.K. 0.00 to P.K. 0.02) and on the south side of King Salmon Avenue (County Road No. 3J810) from Post Mile 0.28 to Post Mile 0.33 (P.K. 0.45 to P.K. 0.53). (Ord. 2337, § , 01/18/2005)

431-63. PARKING ON LOLETA DRIVE.

The parking of vehicles is hereby limited to 15 minutes between 8:00 a.m. and 5:00 p.m. daily, excepting Sundays and holidays, on the south side of Loleta Drive (County Road A3H200) from Post Mile 0.048 (P.K. 0.077) to Post Mile 0.049 (P.K. 0.079). (Ord. 2337, § 2, 01/18/2005)

431-64. PERMITTING ANGLE PARKING ON MAIN STREET IN LOLETA.

(a) Pursuant to § 22503 of the Vehicle Code, angle parking is hereby permitted on the west side of Main Street (County Road No. C3H180) between the north line of Church Street (County Road No. 3H190) and the south line of Loleta Drive (County Road No. A3H200). As used herein, "angle parking" shall mean that any vehicle so parked must be placed parallel to and between the delineation lines painted on the roadway. Any vehicle parallel parked, or parked so as to occupy portions of two (2) or more delineated parking areas, shall be deemed to be parked in violation of this section. (Ord. 1041, § 1, 8/12/75; Ord. 2478, § 1, 05/08/2012)

(b) The parking of vehicles is hereby limited to 15 minutes between 8:00 a.m. and 5:00 p.m. daily, excepting Sundays and holidays, on the west side of Main Street (County Road No. C3H180) from its intersection with Loleta Drive (County Road No. A3H200) Post Mile 0.18 to Post Mile 0.24 (P.K. 0.29 to P.K. 0.39). (Ord. 2478, § 1, 05/08/2012)

431-84. PARKING ON OAK STREET.

(a) The parking of vehicles is hereby prohibited from the hour of 7:00 a.m. to the hour of 4:00 p.m. on the south side of Oak Street (County Road No. C3K190) between Post Mile 0.03 and Post Mile 0.04 (P.K. 0.05 to P.K. 0.06). The restriction provided herein shall not be applicable on Saturdays, Sundays or legal holidays and shall be applicable only from the 1st day of September until the 15th day of June of any year. (Ord. 921, § 1, 5/1/73; Ord. 2473, § 1, 02/28/2012; Ord. 2478, § 1, 05/08/2012)

(b) The parking of vehicles is hereby prohibited at all times on the north side of Oak Street (County Road C3K190) between Post Mile 0.03 and Post Mile 0.04 (P.K. 0.05 to P.K. 0.06). (Ord. 2304, § 1, 07/22/2003; Ord. 2473, § 1, 02/28/2012)

(c) The parking of vehicles is hereby prohibited at all times on the north side of Oak Street (#C3K190) between Post Mile 0.11 and Post Mile 0.10 (P.K. 0.18 to P.K. 0.16) and on the south side of Oak Street (#C3K190) between Post Mile 0.11 and Post Mile 0.106 P.K. 0.18 to P.K. 0.17. (Ord. 2473, § 1, 02/28/2012)

431-85. PARKING ON PARK STREET.

(a) The parking of vehicles is hereby prohibited at all times on the south side of Park Street (#C3K750) between Post Mile 0.18 and Post Mile 0.25 (P.K. 0.29 to P.K. 0.40) (Ord. 2560, § 1, 10/04/2011; Ord. _____, § __, __/__/2015)

(b) The parking of vehicles is hereby prohibited at all times on the south side of Park Street (County Road No. C3K750) from Post Mile 0.000 to Post Mile 0.048 (P.K. 0.000 to P.K. 0.077). (Ord. _____, § __, __/__/2015)

431-86. PARKING ON PATRICK'S POINT DRIVE.

(a) The parking of vehicles is hereby prohibited at all times on the west side of Patrick's Point Drive (County Road No. 3N010) between P.M. 5.25 and P.M. 5.59 (P.K. 8.32 and P.K. 8.83). (Ord. 1182, § 1, 11/22/77; Ord. 2145, § 1, 04/29/97)

(b) The parking of vehicles is hereby prohibited between the hours of 10:00 p.m. and 5:00 a.m., daily, including Sundays and holidays, along both sides of Patrick's Point Drive (County Road No. 3N010) from Post Mile 0.00 to Post Mile 5.51 (P.K. 0.00 to P.K. 8.87). (Ord. 2146, § 1, 4/29/97)

431-86.5. PARKING ON PENINSULA DRIVE.

The parking of vehicles is hereby prohibited at all times on the east side of Peninsula Drive (#3K905) between Post Mile 1.69 and Post Mile 1.86 (P.K. 2.72 to P.K. 2.99) and on the west side of Peninsula Drive (#3K905) between Post Mile 1.69 and Post Mile 1.79 (P.K. 2.72 to P.K. 2.88). (Ord. 2478, § 3, 05/08/2012)

431-87. PARKING ON PENNSYLVANIA AVENUE.

The parking of vehicles is hereby prohibited at all times on Pennsylvania Avenue (County Road No. 3K480) on the south side between Post Mile 0.00 and Post Mile 0.02 (P.K. 0.00 to 0.03) and on the north side between Post Mile 0.00 and Post Mile 0.04 (P.K. 0.00 to P.K. 0.64). (Ord. 2454, § 2, 05/24/2011)

431-88. PARKING ON PERCH STREET.

The parking of vehicles is hereby prohibited at all times on the south side of Perch Street (County Road No. 3J840) between Post Mile 0.09 and Post Mile 0.14 (P.K. 0.14 to P.K. 0.23). (Ord. 864, § 1, 7/18/72)

431-89. PARKING ON WILLOW ROAD.

The parking of vehicles is hereby prohibited at all times on the west side of Willow Road (County Road No. 8M110) between Post Mile 0.00 and Post Mile 0.06 (P.K. 0.00 to P.K. 0.10). (Ord. 2016, § 3, 12/07/93)

431-92. PARKING ON RAILROAD AVENUE.

(a) The parking of vehicles is hereby prohibited at all times on the following portions of Railroad Avenue (County Road No. C3J740):

(1) The north side thereof from the Northwestern Pacific Railroad tracks to Humboldt Bay.

(2) The south side thereof from the east end of the boat ramp to a point 200 feet (60.96 meters) easterly thereof. (Ord. 432, § 1, 5/8/62)

(b) Angle parking shall be permitted on the south side of Railroad Avenue (County Road No. C3J740) from a point 200 feet (60.96 meters) west of the Northwestern Pacific Railroad tracks to a point 200 feet (60.96 meters) east end of the boat ramp. No parking of any other type shall be allowed at any time in the area specified in this section and within which angle parking is permitted. (Ord. 432, § 2, 5/8/62)

(c) The parking of vehicles on the south side of Railroad Avenue (County Road No. C3J740) from the intersection with Fields Landing Drive (County Road No. C3J700) to a point 50 feet (15.24 meters) westerly, Post Mile 0.00 to Post Mile 0.01 (P.K. 0.00 to P.K. 0.02), shall be restricted to ten (10) minutes between the hours of 8:00 a.m. and 5:00 p.m., Monday through Saturday with Sundays and holidays excluded. (Ord. 1601, § 1, 7/12/83)

431-93. PARKING ON RAILROAD AVENUE (LOLETA)

The parking of vehicles on the west side of Railroad Avenue (County Road 3H210) from the intersection with Loleta Drive (County Road 3H200) to the intersection with Church Street (County Road 3H190) is hereby prohibited at all times.) (Ord. No. 2223, § 1, 8/29/2000)

431-96. PARKING ON REDWOOD AVENUE.

The parking of vehicles is hereby prohibited at all times on both sides of Redwood Avenue (County Road No. 4L580) in the Arcata area from its intersection with the east line of Frontage Road (County Road No. 4L560) to a point 300 feet (91.44 meters) easterly of said intersection with Frontage Road. (Ord. 473, § 1, 2/25/64)

431-96.5. PARKING ON REDWOOD DRIVE (REDWAY).

Angle parking on Redwood Drive (County Road No. 6B105) from Post Mile 2.72 to Post Mile 2.83 (P.K. 4.30 to P.K. 4.48) shall be permitted on the west side of Redwood Drive in the areas marked and signed for such purpose. (Ord. 1888, § 1, 2/27/90)

Angle parking on Redwood Drive (County Road No. 6B105) from Post Mile 2.83 to Post Mile 3.06 (P.K. 4.48 to P.K. 4.84) is hereby restricted to two (2) hours between the hours of 8:00 a.m. and 5:00 p.m., Monday through Saturday, with Sundays and holidays excluded. (Ord. 1888, § 1, 2/27/90; Ord. 2176, §1, 8/25/98)

Parking is prohibited at all times along the east side of Redwood Drive (County Road No. 6B105) from Post Mile 3.00 to Post Mile 3.06 (P.K. 4.752 to P.K. 4.84). (Ord. 1597, § 1, 5/31/83; Ord. 1699, § 1, 7/16/85)

Parallel parking on Redwood Drive (County Road No. 6B105) from P.M. 2.70 to P.M. 2.83 (P.K. 4.30 to P.K. 4.48) on the west side is hereby restricted to two (2) hours between the hours of 8:00 a.m. and 5:00 p.m., Monday through Saturday, with Sundays and holidays excluded. (Ord. 2227, § 1, 11/07/00)

Parallel parking on Redwood Drive (County Road No. 6B105) from P.M. 2.70 to P.M. 3.05 (P.K. 4.30 to P.K. 4.84) on the east side is hereby restricted to two (2) hours between the hours of 8:00 a.m. and 5:00 p.m. Monday through Saturday, with Sundays and holidays excluded. (Ord. 2227, § 1, 11/07/00)

431-96.5.5. PARKING ON SANTA CLARA STREET.

The parking of vehicles six (6) feet and greater in height is hereby prohibited at all times on Santa Clara Street (3K790) for a distance of 100 feet north and south of Tremont Street. (Ord. 2444, § 3, 02/15/2011)

431-96.6. PARKING ON SCENIC DRIVE.

(a) The parking of vehicles is hereby prohibited between the hours of 10:00 p.m. and 5:00 a.m. daily, including Sundays and holidays, along both sides of Scenic Drive (County Road No. 4M310) from Post Mile 0.00 to Post Mile 2.39 (P.K. 0.00 to P.K. 3.85). (Ord. 1897, § 1, 04/24/90; Ord. 2074, § 1, 5/23/95; Ord. ____, § __, __/__/2015)

(b) The parking of vehicles is hereby prohibited between the hours of 10:00 p.m. and 5:00 a.m. daily, including Sundays and holidays, on the east side of Scenic Drive (County Road No. 4M310) from Post Mile 2.313 to Post Mile 2.343 (P.K. 3.722 to P.K. 3.771). (Ord. ____, § __, __/__/2015)

431-97. PARKING ON SCHOOL ROAD.

(a) The parking of vehicles is hereby prohibited Monday through Friday, 8:00 a.m. to 4:00 p.m. on both sides of School Road (County Road No. 6C060) from Post Mile 0.00 to Post Mile 0.14 (P.K. 0.00 to P.K. 0.22). (Ord. 1282, § 1, 10/24/78; Ord. 2510, § 2, 01/14/2014)

(b) The parking of vehicles is hereby prohibited at all times on the north side of School Road (County Road No. C3L070) from Post Mile 0.27 to Post Mile 0.68 (P.K. 0.076 to P.K. 0.230). (Ord. 2510, § 2, 01/14/2014)

431-98. PARKING ON SEA AVENUE.

The parking of vehicles is hereby prohibited at all times on the south side of Sea Avenue (County Road No. C3K100) from Post Mile 0.16 to Post Mile 0.24 (P.K. 0.25 to P.K. 0.38). (Ord. 1250, § 1, 08/15/78)

431-98.5. PARKING IN SHELTER COVE.

(a) The parking of vehicles is hereby prohibited at all times on the north side of Beach Road (County Road No. 4A120) from Humboldt Loop Road (County Road No. 4A060) to the intersection with Redcrest Court (County Road No. 4A121). (Ord. 2173, § 1, 07/21/98)

(b) Parking is prohibited at all times on the eastern side of Redcrest Court (County Road No. 4A121) from the intersection with Beach Road (County Road No. 4A120) to the beginning of the cul-de-sac. (Ord. 2173, § 1, 07/21/98)

(c) Parking is prohibited at all times on the eastern side of Humboldt Loop Road (County Road No. 4A060) from the intersection with Beach Road (County Road No. 4A120) to the intersection with Ridgeview Circle (County Road No. 4A059) (Ord. 2173, § 1, 07/21/98)

(d) Pursuant to § 22503 of the Vehicle Code, diagonal parking is hereby required on the west side of Machi Road (County Road No. 4A032) from Post Mile 0.00 to Post Mile 0.03 (P.K. 0.00 to P.K. 0.05). (Ord. 2497, § 4, 03/19/2013)

431-99. SINGLEY BAR ROAD.

The parking of vehicles is hereby prohibited at all times on the north side of Singley Bar Road (County Road No. 3H023) from Post Mile 0.00 to Post Mile 0.08 (P.K. 0.00 to P.K. 0.13). (Ord. 1543, § 1, 08/17/82)

431-100. PARKING ON SOUTH BROADWAY.

The parking of vehicles is hereby prohibited at all times on the west side of U.S. Highway 101 (South Broadway) between 1,200 feet (365.76 meters) south of Hilfiker Avenue, Post Mile 75.57 and 500 feet (152.40 meters) south of Hilfiker Avenue, Post Mile 75.71 (P.K. 121.61 to P.K. 121.84). (Ord. 618, § 1, 01/03/68)

431-102. PARKING ON SUNNY HEIGHTS DRIVE.

The parking of vehicles is hereby prohibited at all times on both sides of Sunny Heights Drive (County Road No. 3H105) in the Fortuna area between Post Mile 0.08 to Post Mile 0.14 (P.K. 0.12 to P.K. 0.22). (Ord. 1325, § 1, 04/17/79)

431-102.5. PARKING ON SUTTER ROAD.

a. The parking of vehicles is hereby prohibited at all times on the north side of Sutter Road (County Road No. C4L810) between Post Mile 0.17 and Post Mile 1.22 (P.K. 0.28 and P.K. 1.96). (Ord. 2389, § 1, 02/28/2007)

b. The parking of vehicles is hereby prohibited at all times on the south side of Sutter Road (County Road No. C4L810) between Post Mile 0.17 and Post Mile 0.76 (P.K. 0.28 and P.K. 1.22). (Ord. 2389, § 1, 02/28/2007)

431-103. PARKING ON HIGHWAY 36.

The parking of vehicles is hereby prohibited at all times on both sides of State Highway 36 (01-Hum-36) in the vicinity of Van Duzen County Park from Post Mile 12.29 to Post Mile 12.47 (P.K. 19.78 to P.K. 20.07). (Ord. 1945, § 1, 10/22/91)

431-104. PARKING ON HIGHWAY 36 IN CARLOTTA.

The parking of vehicles is hereby restricted to loading and unloading of passengers and mail during the hours of 8:00 a.m. to 6:00 p.m., Monday through Saturday, on the north side of the State Highway 36, Post Mile 5.09 (P.K. 8.19), along the sidewalk in front of the Carlotta Post Office. (Ord. 659, § 1, 2/4/69)

431-105. PARKING ON TOMPKINS HILL ROAD.

The parking of vehicles is hereby prohibited at all times on both sides of Tompkins Hill Road (County Road No. A3H050) in the Fortuna area from Post Mile 1.65 to Post Mile 2.45 (P.K. 2.61 to P.K. 3.88). (Ord. 1551, § 1, 9/21/82)

431-106. PARKING ON TREMONT STREET.

The parking of vehicles six (6) feet and greater in height is hereby prohibited at all times on Tremont Street (3K770) for a distance of 100 feet east and west of Santa Clara Street. (Ord. 2444, § 3, 02/15/2011)

431-108. PARKING ON UPPER BAY ROAD.

There shall be no parking on either side of the Upper Bay Road (County Road No. 3L060) between the west side of Hund Ranch and the bridge over the Mad River Slough. (Ord. 318, § 1, 9/13/54)

431-108.5. PARKING ON WALFORD AVENUE.

(a) The parking of vehicles is hereby prohibited at all times on both the east and west sides of Walford Avenue between Post Mile 0.0 and Post Mile 0.033 (P.K. 0.0 to P.K. 0.053). (Ord. 2454, § 2, 05/24/2011; Ord. 2473, § 1, 02/28/2012)

(b) The parking of vehicles is hereby prohibited at all times on the east side of Walford Avenue (#3K295) between Post Mile 0.077 and Post Mile 0.072 (P.K. 0.124 to P.K. 0.116). (Ord. 2473, § 1, 02/28/2012)

431-109. PARKING ON WALNUT STREET.

(a) The parking of vehicles is hereby prohibited at all times on the west side of Walnut Street (County Road No. F3J300) between Post Mile 5.88 and Post Mile 5.92 (P.K. 9.46 and P.K. 9.53). (Ord. 2354, § 1, 12/06/2005; Ord. 2473, § 1, 02/28/2012)

(b) The parking of vehicles is hereby prohibited at all times on the east side of Walnut Street (#F3J300) between Post Mile 5.655 and Post Mile 5.88 (P.K. 9.101 and P.K. 9.46). (Ord. 2473, § 1, 02/28/2012)

(c) The parking of vehicles is hereby prohibited at all times on the northwest side of Walnut Street (County Road No. F3J300) from Post Mile 5.380 to Post Mile 5.383 (P.K. 8.658 to P.K. 8.663). (Ord. ____, § __, __/ /2015)

CHAPTER 5

BICYCLE LANES**435-1. AUTHORITY.**

Section 21207 et seq. of the Vehicle Code of the State of California authorizes the establishment of bicycle lanes upon highways, provided that such bicycle lanes be constructed to conform to the provisions of § 891 et seq. ("Bikeways") of the Streets and Highways Code of the State of California. (Ord. 1363 § 1, 10/23/79; Ord. 2351, § 16, 12/06/2005)

435-3. ESTABLISHMENT OF CLASS II BICYCLE LANES.

The following Class II bicycle lanes are hereby established:

(a) Along both the east and west sides of Central Avenue in McKinleyville (County Road No. A4L800) from Post Mile 0.58 to Post Mile 1.80 (P.K. 0.92 to P.K. 2.85). (Ord. 1363, § 1, 10/23/79)

(b) Along McKinleyville Avenue (County Road No. C4C925) from Post Mile 0.65 to Post Mile 1.70 (P.K. 1.03 to P.K. 2.30). (Ord. 2003, § 2, 6/15/93)

(c) Along both the north and south sides of Bates Road in McKinleyville (County Road No. 4M106) from Post Mile 0.28 to Post Mile 0.52 (P.K. 0.45 to P.K. 0.84). (Ord. 2510, § 3, 01/14/2014)

(d) Along both the north and south sides of Murray Road in McKinleyville (County Road No. C3M020) from Post Mile 0.05 to Post Mile 0.22 (P.K. 0.08 to P.K. 0.84). (Ord. 2510, § 3, 01/14/2014)

(e) Along both the sides of Nursery Way in McKinleyville (County Road No. 4L937) from Post Mile 0.00 to Post Mile 0.35 (P.K. 0.00 to P.K. 0.56). (Ord. 2510, § 3, 01/14/2014)

(f) Along both the north and south sides of Sutter Road in McKinleyville (County Road No. C4L810) from Post Mile 0.00 to Post Mile 1.07 (P.K. 0.00 to P.K. 1.72). (Ord. 2510, § 3, 01/14/2014)

(g) Along both the northwest and southeast sides of Chartin Road in Blue Lake (County Road No. 5L020) from Post Mile 0.00 to Post 0.20 (P.K. 0.00 to P.K. 0.32). (Ord. 2510, § 3, 01/14/2014)

(h) Along both the northeast and southwest sides of Myrtle Avenue in Eureka (County Road No. F3K300) from Post Mile 0.00 to Post Mile 1.34 (P.K. 0.00 to P.K. 2.16). (Ord. 2510, § 3, 01/14/2014)

(i) Along both the east and west sides of Hall Avenue in Eureka (County Road No. A3K321) from Post Mile 0.00 to Post Mile 0.18 (P.K. 0.00 to P.K. 0.13). (Ord. 2510, § 3, 01/14/2014)

(j) Along both the north and south sides of Harris Street in Eureka (County Road No. A3K320) from Post Mile 0.00 to Post Mile 0.74 (P.K. 0.00 to P.K. 1.19). (Ord. 2510, § 3, 01/14/2014)

(k) Along both the east and west sides of Walnut Drive in Eureka (County Road No. F3J300) from Post 3.27 to Post Mile 5.30 (P.K. 5.26 to P.K. 8.53). (Ord. 2510, § 3, 01/14/2014)

(l) Along both the east and west sides of Walnut Street in Eureka (County Road No. F3J300) from Post Mile 5.68 to Post Mile 5.90 (P.K. 9.14 to P.K. 9.50). (Ord. 2510, § 3, 01/14/2014)

(m) Along both the north and south sides of School Road in McKinleyville (County Road No. C3L070) from Post Mile 0.00 to Post Mile 0.69 (P.K. 0.00 to P.K. 1.11). (Ord. ____, § __, __/__/2015)

(n) Along both the north and south sides of Park Street in Eureka (County Road No. C3K750) from Post Mile 0.00 to Post Mile 0.54 (P.K. 0.00 to P.K. 0.87). (Ord. ____, § __, __/__/2015)

SUMMARY FOR PUBLICATION PRIOR TO ADOPTION OF ORDINANCE

(The summary shall be published and a certified copy of the full text of the proposed ordinance shall be posted in the office of the Clerk of the Board of Supervisors at least five (5) days prior to the Board of Supervisors meeting at which the proposed ordinance is to be adopted.)

SUMMARY

On _____, 2015, at its regularly scheduled Board meeting, the Humboldt County Board of Supervisors will consider for adoption a proposed ordinance amending 431-48, 431-85, 431-96.6, 431-109 and 435-3 relating to parking on Scenic Drive, Harris, Park and Walnut Streets, in Eureka and Trinidad, and adding Bicycle Lanes on School Road and Park Street in Eureka and McKinleyville to Title IV of the Humboldt County Code

The text of the proposed ordinance is available from the Clerk of the Board, Room 111, 825 Fifth Street, Eureka, CA.

Reeve, Arthur

From: Ball, Jeff
Sent: Monday, January 12, 2015 12:11 PM
To: Reeve, Arthur
Subject: RE: HTA Bus Stops - Harris Street
Attachments: CDSN03-Site17_revised3.pdf; CDSN04-Site18_revised1.pdf; HTA Bus Stops.pdf

Art,

Attached is the two plan view sheets for the bus stops on Park Ave and Harris Street. Also attached is the entire plan set.

From: Reeve, Arthur
Sent: Thursday, January 08, 2015 9:34 AM
To: Ball, Jeff; 'Greg Pratt'
Cc: Whitworth, Chris; Burnett, Rob
Subject: RE: HTA Bus Stops - Harris Street

Jeff,

It takes three months for red curbs to go through the public hearing process before they can be painted.

Art

From: Ball, Jeff
Sent: Wednesday, January 07, 2015 4:34 PM
To: 'Greg Pratt'; Reeve, Arthur
Cc: Whitworth, Chris; Burnett, Rob
Subject: RE: HTA Bus Stops - Harris Street

Greg,

Yes, I can get county maintenance to place red curb from the cross walk to the bus loading zone.

Jeff

From: Greg Pratt [<mailto:greg@hta.org>]
Sent: Wednesday, January 07, 2015 3:53 PM
To: Ball, Jeff
Cc: Whitworth, Chris; Burnett, Rob
Subject: RE: HTA Bus Stops - Harris Street

Hi Jeff

The bus stop drawing looks great and the location of the stop being west of the crosswalk will be much safer. Can we get a 40' red curb starting from the crosswalk?

*Greg Pratt
General Manager
Humboldt Transit Authority*

133 V Street Eureka, CA 95501

(707) 443-0826 ext. 101

greg@hta.org

From: Ball, Jeff [<mailto:JBall@co.humboldt.ca.us>]

Sent: Wednesday, January 07, 2015 3:19 PM

To: Greg Pratt

Cc: Whitworth, Chris; Burnett, Rob

Subject: HTA Bus Stops - Harris Street

Greg,

The attached drawing shows the proposed bus stop on Harris Street west of the parking lot entrance for Redwood Acres. This design uses the existing sidewalk that was recently constructed (summer 2014) and adds 3' behind it per ADA requirements and provides room for a bus shelter. Please review the attached drawing and let me or Chris Whitworth know if you want make changes to the plan.

Thank you,

Jeff

Jeffrey A. Ball

Associate Engineer

County of Humboldt

Department of Public Works

Engineering Division

Ph#707.445.7377

Fax#707.445.7409

jball@co.humboldt.ca.us

ROAD NAME: HARRIS, HARRIS, REDWOOD, & CENTRAL PROJECT NO. 321610 CONTRACT NO. 321610 DRAWING FILE NAME: I:\PROJECTS\321610\321610.DWG PLOT DATE: 12/17/2014 EXPIRES DATE:	DESIGN SECTION ROBERT L. BURNETT PROJECT NO. 321610 CONTRACT NO. 321610 DRAWING FILE NAME: I:\PROJECTS\321610\321610.DWG PLOT DATE: 12/17/2014 EXPIRES DATE:	COUNTY OF HUMBOLDT DEPARTMENT OF PUBLIC WORKS HUMBOLDT TRANSIT AUTHORITY BUS STOP UPGRADES COVER SHEET, SHEET INDEX AND DETAILS	SHEET 1 OF 6
--	--	---	-------------------------------------

COUNTY OF HUMBOLDT
DEPARTMENT OF PUBLIC WORKS
PROJECT PLANS FOR CONSTRUCTION OF
HUMBOLDT TRANSIT AUTHORITY BUS STOP UPGRADES
4 LOCATIONS IN HUMBOLDT COUNTY
CONTRACT NO. 321610

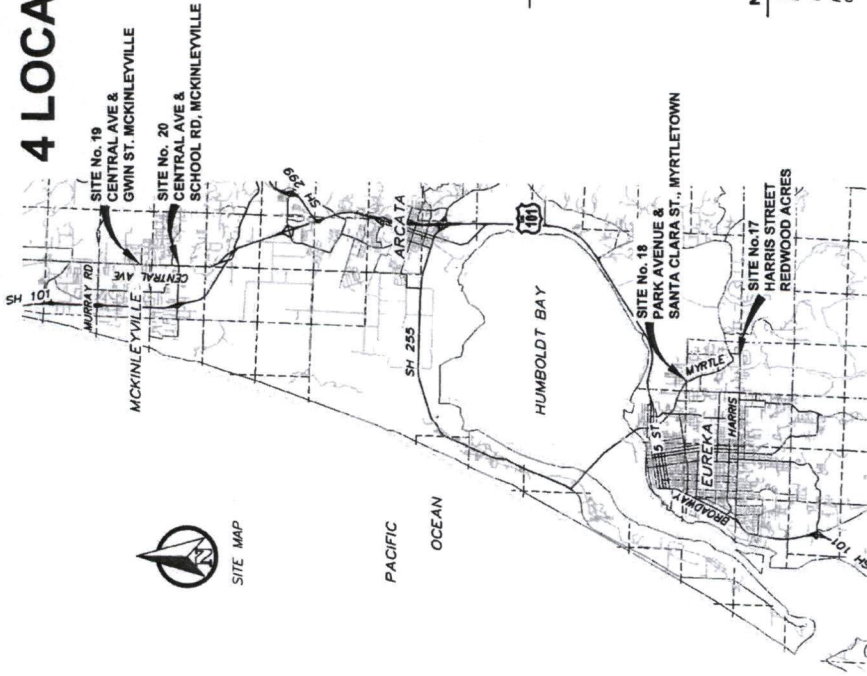
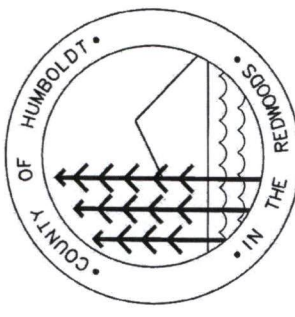

INDEX OF SHEETS

- 1 COVER SHEET
- 2 QUANTITIES AND DETAILS
- 3 SITE No. 17 HARRIS STREET, REDWOOD ACRES
- 4 SITE No. 18 PARK STREET, MYRTLETOWN
- 5 SITE No. 19 CENTRAL AVENUE MCKINLEYVILLE
- 6 SITE No. 20 CENTRAL AVENUE MCKINLEYVILLE

NOTES

THE CONTRACTOR SHALL HAVE A CLASS "A" LICENSE FOR THIS PROJECT.
 REFERENCE TO CALTRANS STANDARD PLANS DATED 2010
 REFERENCE TO TITLE 2: UNIFORM FEDERAL ACCESSIBILITY STANDARDS (UFAS)
 OR AIA STANDARDS FOR ACCESSIBLE DESIGN (APPENDIX A OF 28 CFR PART 36)



RECOMMENDED

ROBERT L. BURNETT
 RCE 36210, EXP. 6/30/2014

APPROVED

CHRISTOPHER J. WHITWORTH
 RCE 51931, EXP. 6/30/2014

COUNTY OF HUMBOLDT DEPARTMENT OF PUBLIC WORKS HUMBOLDT TRANSIT AUTHORITY BUS STOP UPGRADES SITE 17 HARRIS STREET, REDWOOD ACRES	
DESIGN SECTION DATE: 12/17/2014 DRAWN BY: J. DORR CHECKED BY: J. DORR APPROVED BY: J. DORR	SHEET 3 OF 6

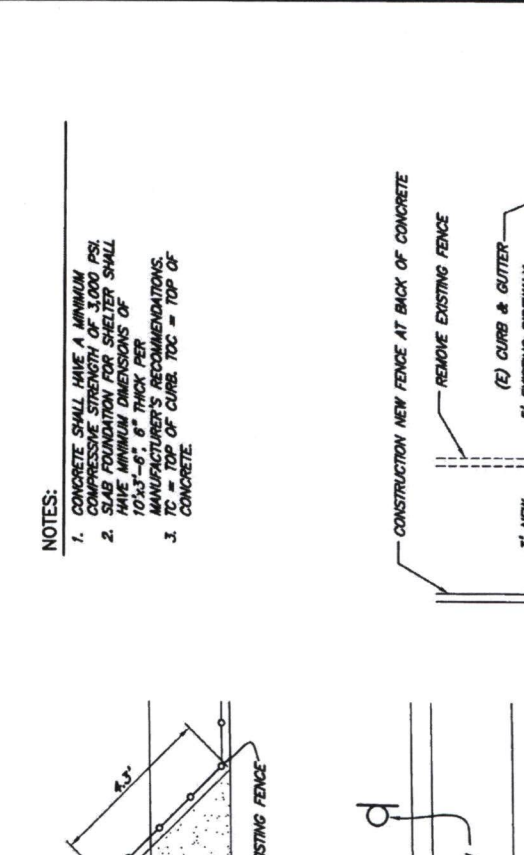
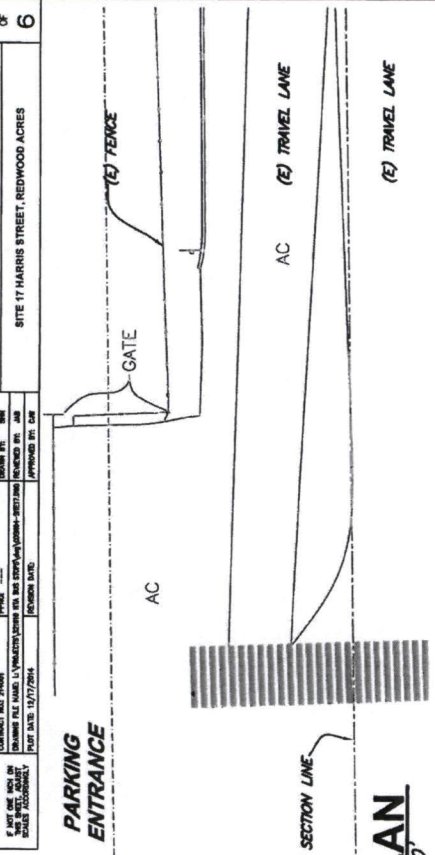

- NOTES:
1. CONCRETE SHALL HAVE A MINIMUM COMPRESSIVE STRENGTH OF 3,000 PSI. SLAB FOUNDATION FOR SHELTER SHALL HAVE MINIMUM DIMENSIONS OF 10'x3'-0" 6" THICK PER MANUFACTURER'S RECOMMENDATIONS. TC = TOP OF CURB. TOC = TOP OF CONCRETE.
 - 2.
 - 3.

DETAIL 1
2/3"=1'

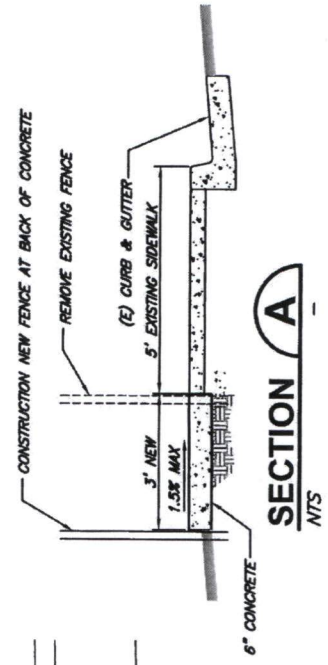

COUNTY OF HUMBOLDT DEPARTMENT OF PUBLIC WORKS		DESIGN SECTION HUBBOLDT TRANSIT AUTHORITY BUS STOP UPGRADES	
SHEET 4		OF 6	
SITE 18 PARK STREET AND SANTA CLARA STREET		HUBBOLDT TRANSIT AUTHORITY BUS STOP UPGRADES	
ROAD NAME: HUMBOLDT, PARK, HUMBOLDT, & CENTRAL	DATE: 12/17/2014	DESIGNER: JAM	APPROVED: JAM
PROJECT NO.: 214001	DATE: 12/17/2014	DESIGNER: JAM	APPROVED: JAM
CONTRACT NO.: 214001	DATE: 12/17/2014	DESIGNER: JAM	APPROVED: JAM
DRAWING FILE NAME: L:\PROJECTS\214001\214001-01\214001-01.dwg	DATE: 12/17/2014	DESIGNER: JAM	APPROVED: JAM
DATE: 12/17/2014	DATE: 12/17/2014	DESIGNER: JAM	APPROVED: JAM

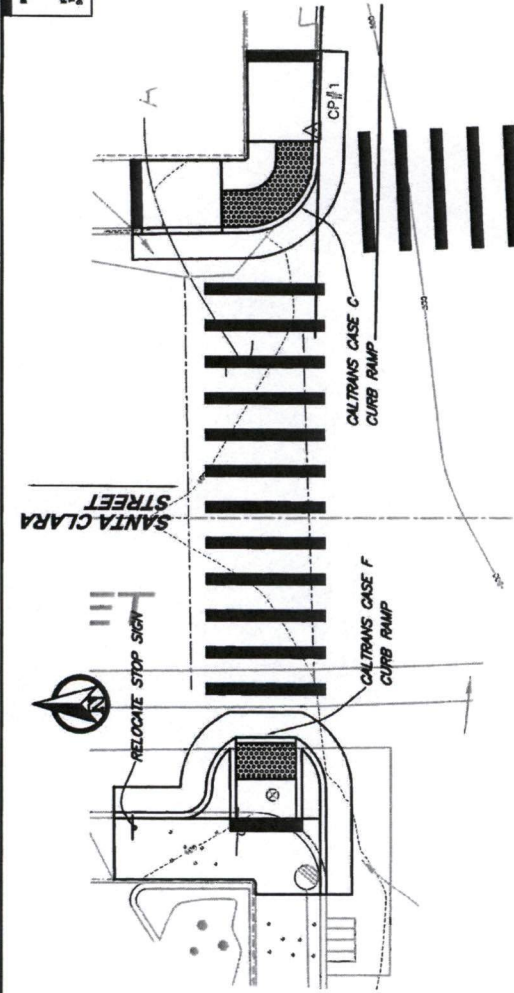

NOTES:

1. SLOPE OF ADA LANDING NOT TO EXCEED 2% IN ANY DIRECTION.
2. LONGITUDINAL SLOPE OF SIDEWALK TO MATCH LONGITUDINAL SLOPE OF (E) ROAD.
3. CONCRETE SHALL HAVE A MINIMUM COMPRESSIVE STRENGTH OF 3,000 PSI.
4. SLAB FOUNDATION FOR TOLAR BUS SHELTER SHALL HAVE MINIMUM DIMENSIONS OF 10' x 3'-6" x 6" THICK PER MANUFACTURER'S RECOMMENDATIONS.

SURVEY NOTES:

ELEVATIONS ARE BASED ON CONTROL POINTS #1 & #2. A MINI MAG NAIL IN THE TOP OF AN AC CURB AT THE NORTHEAST CORNER OF PARK STREET AND SANTA CLARA STREET, AND A 2 1/2 INCH BRASS DISK WITH PUNCH MARK, STAMPED RE 28124, IN A WELL AT THE INTERSECTION OF PARK STREET AND JOHN HILL STREET.

POINT	NORTHING	EASTING	ELEVATION
#1	4984.19'	10000.08'	500.00'
#2	4974.77'	10570.32'	517.88'

DETAIL 1
NTS

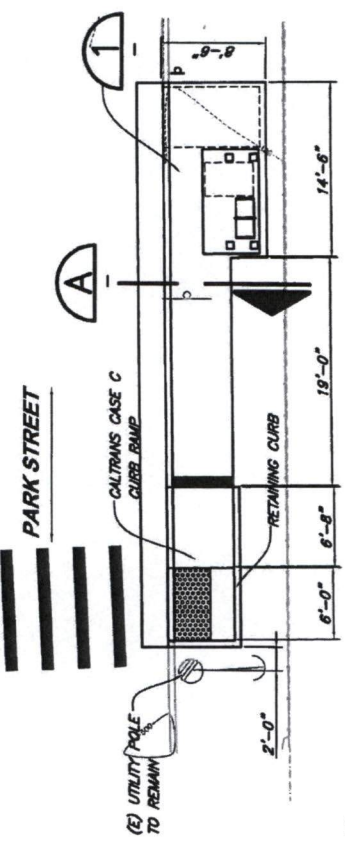

PLAN
1-5

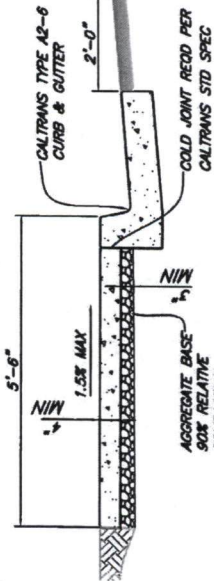

SECTION A
NTS

**Walkability Audit and Workshop Outcomes
Winship Middle School and Cutten Elementary School
Cutten, California
April 16, 2013**

**Humboldt County Department of Health and Human Services & Natural Resources Services
Division of Redwood Community Action Agency**



Overview: A Walkability Audit and Workshop was held in Cutten on April 16, 2013 to observe and identify concerns and solutions to safety issues around kids who walk or bike to Cutten Elementary School and for those who will be walking or bicycling to Winship Middle School when it re-opens in fall of 2013. Parents, neighbors, the school principals, the California Highway Patrol, the Eureka Police Department's School Resource Officer, Humboldt County Public Works Department, Humboldt County Office of Education's (HCOE) California Joint Powers Authority Risk Manager, HCOE's bus transportation manager, NRS/RCAA staff, and County Public Health were all on hand to witness firsthand the challenges and opportunities around safe walking and bicycling in Cutten. The Audit was supported by the County-wide Safe Routes to Schools (SR2S) Task Force and funded through the Redwood Crossing Guard Program, a Safe Routes to Schools non-infrastructure grant received by Humboldt County Public Works and administered by the Humboldt County Department of Health and Human Services.



Painting red curbs for no parking on either side of Walnut and Primrose crosswalk will improve visibility.



Cutten Elementary Engineering/Infrastructure Recommendations:

- Install 3-way stop at Walnut and Cypress
- Shorten crossing distance at Walnut and Cypress by installing bulbouts
- Install LED lights in pavement at crosswalks
- Move flashing School Zone Light closer to the school
- Install clear directional signage in drop-off and pick-up zone
- Consider re-routing cars on track to exit through parking lot vs. Foxwood Drive
- Trim foliage at Primrose and Walnut to improve visibility
- Consider installing raised crosswalk with bulbouts on Walnut across from Cutten Elementary
- Paint red curb on both ends of Walnut crosswalk (at Primrose) to improve visibility
- Paint red curb next to fire hydrant at end of Primrose crosswalk
- Create No Parking Zone by painting red curb on Walnut across from Cutten Elementary

Cutten Elementary Parent/Staff Education Needs:

- Train teachers to hold kids at gate until safe to move towards cars
- Spearhead effort for PTA to partner with Winship PTA/PTO
- Include pick-up and drop-off guidelines in school newsletter
- Create hand painted signs to encourage drivers to slow and/or for directional signs
- Educate/remind parents to yield to drivers on Foxwood Drive
- Purchase lighted stop paddles for crossing guard
- Educate parents to not U-Turn on Primrose

MEMO

HUMBOLDT COUNTY DEPARTMENT OF PUBLIC WORKS

DATE: January 12, 2015
TO: Scott Miles, Deputy County Counsel
FROM: Art Reeve, Deputy Director of Public Works, Roads
SUBJECT: Ordinance Preparation Requests

.....
Scott,

Below are proposed ordinances for parking and Class II Bicycle Lanes on various County Roads.
Please prepare the ordinances for approval by the Board:

(431-48) PARKING ON HARRIS STREET.

(d) The parking of vehicles is hereby prohibited at all times on the south side of Harris Street (County Road No. A3K320) from Post Mile 0.541 to Post Mile 0.551 (P.K. 0.871 to P.K. 0.887).

(431-85) PARKING ON PARK STREET.

Add (a) to first paragraph

(b) The parking of vehicles is hereby prohibited at all times on the south side of Park Street (County Road No. C3K750) from Post Mile 0.000 to Post Mile 0.048 (P.K. 0.000 to P.K. 0.077).

(431-96.6) PARKING ON SCENIC DRIVE.

Add (a) to first paragraph

(b) The parking of vehicles is hereby prohibited between the hours of 10:00 p.m. and 5:00 a.m. daily, including Sundays and holidays, on the east side of Scenic Drive (County Road No. 4M310) from Post Mile 2.313 to Post Mile 2.343 (P.K. 3.722 to P.K.3.771).

(431-109) PARKING ON WALNUT STREET.

(c) The parking of vehicles is hereby prohibited at all times on the northwest side of Walnut Street (County Road No. F3J300) from Post Mile 5.380 to Post Mile 5.383 (P.K. 8.658 to P.K. 8.663).

(435-3) ESTABLISHMENT OF CLASS II BICYCLE LANES.

(m) Along both the north and south sides of School Road in McKinleyville (County Road No. C3L070) from Post Mile 0.00 to Post Mile 0.69 (P.K. 0.00 to P.K. 1.11).

(n) Along both the north and south sides of Park Street in Eureka (County Road No. C3K750) from Post Mile 0.00 to Post Mile 0.54 (P.K. 0.00 to P.K. 0.87).

Please process in your normal priority. I would like to get this to the Board at the February 24th meeting. If you have any questions, please call me at 707-498-7294 or email me at areeve@co.humboldt.ca.us.

Thank you.



DEPARTMENT OF PUBLIC WORKS
C O U N T Y O F H U M B O L D T

MAILING ADDRESS: 1106 SECOND STREET, EUREKA, CA 95501-0579
AREA CODE 707

ARCATA-EUREKA AIRPORT TERMINAL
McKINLEYVILLE
FAX 839-3596

PUBLIC WORKS BUILDING
SECOND & L ST., EUREKA
FAX 445-7409

CLARK COMPLEX
HARRIS & H ST., EUREKA
FAX 445-7388

AVIATION 839-5401

ADMINISTRATION	445-7491	NATURAL RESOURCES	445-7741
BUSINESS	445-7652	NATURAL RESOURCES PLANNING	267-9540
ENGINEERING	445-7377	PARKS	445-7651
FACILITY MAINTENANCE	445-7493	ROADS & EQUIPMENT MAINTENANCE	445-7421

LAND USE 445-7205

MEMORANDUM

Date: January 12, 2015

To: Humboldt County Recorder's Office
c/o Louise Holman
825 5th Street, Fifth Floor
Eureka, CA 95501
445-7593

From: Doug Dinsmore
Public Works Department
1106 Second Street
Eureka, CA 95501
445-7741

Project: An Ordinance of the Board of Supervisors of the County of Humboldt amending Sections 431-48, 431-85, 431.96.6, and 431-109 regarding parking on Harris Street (Eureka), Park Street (Eureka), Scenic Drive (Trinidad), Walnut Street (Eureka), and amending Section 435-3 regarding establishment of Class II Bicycle Lanes on School Road (McKinleyville) and Park Street (Eureka), to Title IV of the Humboldt County Code.

Contents: CEQA Notice of Exemption Form

Notes: Two copies of this Notice of Exemption (NOE) are enclosed. When the notice is filed, please return one copy stamped with the date it was filed. After the notice is posted for 30 days, please return a copy stamped with the "posted through" date.

Thank you,



Cher-Ae Heights Indian Community of the Trinidad Rancheria



January 23, 2015

Tom Mattson, Director
Humboldt County Public Works
1106 Second Street
Eureka, CA 95501

Via email to: TMattson@co.humboldt.ca.us

Dear Mr. Mattson:

The Cher-Ae Heights Indian Community of the Trinidad Rancheria is formally requesting closure of the turnout on Scenic Drive between the Casino Entrance (Cher-Ae Lane) and the Casino Exit during the hours of 10pm and 5am daily.

This turnout is frequently used for overnight parking and nuisance parking. The turnout is on Trinidad Rancheria Trust Property and we frequently have public parking that creates health and safety issues for our Tribal Community, Tribal Government and the Cher-Ae Heights Casino.

We appreciate your assistance in resolving this matter as soon as possible. Please contact CEO Jacque Hostler-Carmesin with any questions or concerns.

Thank You,

Garth Sundberg, Sr.
Tribal Chairman
Trinidad Rancheria

CC: Arthur Reeve, P.E., Deputy Public Works Director, areeve@co.humboldt.ca.us



www.trinidadrancheria.com

1 Cher-Ae Lane • PO Box 630 • Trinidad, California • 95570 • 707.677.0211 • 707.677.3921 (fax)

HUMBOLDT COUNTY
NOTICE OF EXEMPTION

TO: _____ **Secretary for Resource**
1416 Ninth Street, Room 1311
Sacramento, CA 95814

APPLICANT: Humboldt County Public Works
1106 Second St.
Eureka, CA 95501
707-445-7741

 X **County Clerk**
County of Humboldt

Project Title: An Ordinance of the Board of Supervisors of the County of Humboldt amending Sections 431-48, 431-85, 431.96.6, and 431-109 regarding parking on Harris Street (Eureka), Park Street (Eureka), Scenic Drive (Trinidad), and Walnut Street (Eureka), and amending Section 435-3 regarding establishment of Class II Bicycle Lanes along both the north and south sides of School Road (McKinleyville) and along the north and south sides of Park Street (Eureka), to Title IV of the Humboldt County Code.

Project Location-Specific:

Harris Street – Vehicle parking shall be prohibited at all times on the south side of Harris Street (County Road No. A3K320) from Post Mile (P.M.) 0.541 to P.M. 0.551 (P.K. 0.871 to P.K. 0.887).

Park Street – Vehicle parking shall be prohibited at all times on the south side of Park Street (County Road No. C3K750) from P.M. 0.000 to P.M. 0.048 (P.K. 0.000 to P.K. 0.077).

Scenic Drive – Vehicle parking shall be prohibited between the hours of 10:00 p.m. and 5:00 a.m. daily, including Sundays and holidays, on the east side of Scenic Drive (County Road No. 4M310) from P.M. 2.313 to P.M. 2.343 (P.K. 3.722 to P.K.3.771).

Walnut Street – Vehicle parking shall be prohibited at all times on the northwest side of Walnut Street (County Road No. F3J300) from P.M. 5.380 to P.M. 5.383 (P.K. 8.658 to P.K. 8.663).

School Road – The establishment of Class II bicycle lanes along both the north and south sides of School Road (County Road No. C3L070) from P.M. 0.00 to P.M. 0.69 (P.K. 0.00 to P.K. 1.11).

Park Street – The establishment of Class II bicycle lanes along both the north and south sides of Park Street (County Road No. C3K750) from P.M. 0.00 to P.M. 0.54 (P.K. 0.00 to P.K. 0.87).

Project Location-County: Humboldt County

Description of Nature, Purpose, and Beneficiaries of Project: The project is a revision to the Humboldt County Code establishing parking prohibitions and bicycle lanes along designated portions of public roads, as a means of improving public safety.

Name of Public Agency Approving Project: Humboldt County Board of Supervisors

Name of Person or Agency Carrying Out Project: Humboldt County Department of Public Works

Exempt Status: (Check One)

_____ **Ministerial (Sec. 15268)**

_____ **Declared Emergency (Sec. 15269[a])**

_____ **Emergency Project (Sec. 15269[b] and [c])**

 X **Categorical Exemption. State type and section number:** Section 15301 (Existing Facilities) and Section 15305 (Minor Alterations in Land Use Limitations)

Reason why project is exempt: The projects will not result in direct effects on the environment. Road segments proposed for prohibited parking will not prompt development of new parking areas. The

proposed speed restrictions and bicycle lanes will not affect traffic flow or otherwise alter usage of the subject roadways.

Contact Person: Art Reeve, Deputy-Director (Road Maintenance)

Telephone: 707-445-7205



Signature of Receiving Party

Signature of Humboldt Co. Rep.

Title

Environmental Analyst

Title

Date received for filing

January 12, 2015

Date Signed