

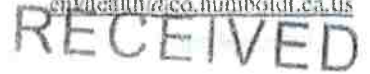

17/18-1912



MAY 23 2018

WATER WELL APPLICATION

CONSTRUCTION – REPAIR – DESTRUCTION

The Well Permit will be returned to the property owner when approved by
Humboldt County Division of Environmental Health (DEH)

HUMBOLDT CO. DIVISION
OF ENVIRONMENTAL HEALTH

Instructions:

1. Complete both sides and submit the Water Well Application with required fee. Include Well Driller's signature and property owner's signature.
2. Work on a well shall not be started prior to approval of the Water Well Application by DEH.
3. Any changes made to the location of a new well shall be approved by DEH prior to commencement of drilling.
4. Well Driller shall notify DEH a minimum of 24 hours prior to sealing the annular space.

Site Address	9320 Wilder Ridge Rd.	APN	108-023-008
City/State/Zip	Garberville, CA 95542	CA	
Directions to Site	Southbound on US-101 (approx. 63 mi.), take exit 642 Redwood Dr., continue on Redwood Dr. (approx. 1.8 mi.), turn right onto Briceland Thorn Rd. (approx. 10 mi.), straight onto Ettensburg Rd. (approx. 5.9 mi.), straight onto Wilder Ridge Rd., site on left		
Applicant	Yordans Peshunov	Contact	
Mailing Address	5145 Black Oak Rd.	Work Phone	
City/State/Zip	Concord, CA 94521	Cell Phone	415-656-6601
Property Owner	Wilder Ridge, LLC	Home Phone	
Mailing Address	403 Rifle Camp Rd.	Work Phone	
City/State/Zip	Woodland Park, NJ 07424	Cell Phone	973-247-1015, 973-454-1455
I hereby grant 'right-of-entry' for inspection purposes			
Drilling		C-57	
Contractor	Watson Well Drilling Inc.	License #	1014048
I hereby agree to comply with all laws and regulations of the County of Humboldt and the State of California Department of Water Resources Bulletin 74 pertaining to water well construction. I will contact Humboldt County Division of Environmental Health (DEH) when I commence work. Within 30 days after completion of work, I will furnish DEH a report of the work performed.			
Well Driller Signature:			
Would driller like a copy of approved application?	<input checked="" type="checkbox"/> Yes <input type="checkbox"/> No		
<input type="checkbox"/> U.S. Mail address:			
<input checked="" type="checkbox"/> Email address:	Admin@watsonwelldrillinginc.com		
Type of Application:	Construction:	Intended Use:	
<input checked="" type="checkbox"/> Construction	Estimated Depth (ft.) _____	<input type="checkbox"/> Domestic - private	
<input type="checkbox"/> Destruction	Diameter (in.) _____	<input type="checkbox"/> Community Supply	
<input checked="" type="checkbox"/> Repair/Modification	Depth of Seal (ft.) _____	<input type="checkbox"/> Irrigation	
	Sealing Material _____	<input checked="" type="checkbox"/> Other <u>50' seal</u> <u>20' seal</u>	



BIG RIVER FARM, LLC.

CONDITIONAL USE PERMIT APPLICATION

APN: 108-023-008



VICINITY MAP
NOT TO SCALE

PROJECT DESCRIPTION:

DR. JIMMY FARM, LLC IS PROPOSING TO PERMIT EXERCISING MEDICAL CLINIC (GENERAL PRACTICE) IN THE COUNTY OF HUMBOLDT COUNTY, CALIFORNIA. THE PROJECT INCLUDES THE CONSTRUCTION OF A MEDICAL CLINIC, OFFICE BUILDING, AND 2000 SQUAR FEET OF MEDICAL OFFICE. THE PROJECT INCLUDES THE DEVELOPMENT OF 2000 SQUAR FEET OF MEDICAL OFFICE. THE PROJECT INCLUDES THE DEVELOPMENT OF 2000 SQUAR FEET OF MEDICAL OFFICE. THE PROJECT INCLUDES THE DEVELOPMENT OF 2000 SQUAR FEET OF MEDICAL OFFICE. THE PROJECT INCLUDES THE DEVELOPMENT OF 2000 SQUAR FEET OF MEDICAL OFFICE.

GENERAL NOTES:

1. DRAWING SCALE AS NOTED. WRITTEN DIMENSIONS SHALL TAKE PRECEDENCE OVER SCALED DIMENSIONS.
2. THIS IS NOT A HIGHLIGHT SURVEY. BOUNDARY INFORMATION IS BASED ON THE RECORD SURVEY FROM HUMBOLDT COUNTY RECORDS DATE 08/20/1998 TO 10/10/1998. THE BOUNDARY INFORMATION IS NOT TO BE USED FOR ANY OTHER PURPOSE.
3. THERE ARE NO MEASUREMENTS SHOWN. THE STATION PLACES OF VERTICAL CURVES ARE SHOWN WITHIN 100 FEET OF THE PROPOSED CENTERLINE AND A 200 FEET OF THE PROPOSED CENTERLINE.
4. THERE ARE NO RECORDS OR ADJOINING PARCELS KNOWN TO THE PROJECT DEVELOPER.
5. ANY EXISTING DEVELOPMENT CONSTRUCTED WITHIN THE BOUNDARY OF THE PROJECT SHALL BE SUBJECT TO THE HUMBOLDT COUNTY BUILDING DEPARTMENT PRIOR APPROVAL OF THE CONDITIONAL USE PERMIT.

- DIRECTIONS TO SITE:**
- FROM EUREKA, CA
 - SOUTHBOUND ON US-101 (APPROX. 6.5 MILES)
 - TAKE EXIT 642 FOR REDWOOD DR
 - LEFT ON REDWOOD DR
 - APPROX. 0.5 MILES
 - TURN RIGHT ONTO BRIGELAND THORN RD
 - STAY STRAIGHT ONTO ETTERSBURG RD (APPROX. 5.5 MILES)
 - ETTERSBURG RD TURN INTO WILDER RIDGE RD (APPROX. 3.8 MILES)
 - PROJECT SITE ON LEFT

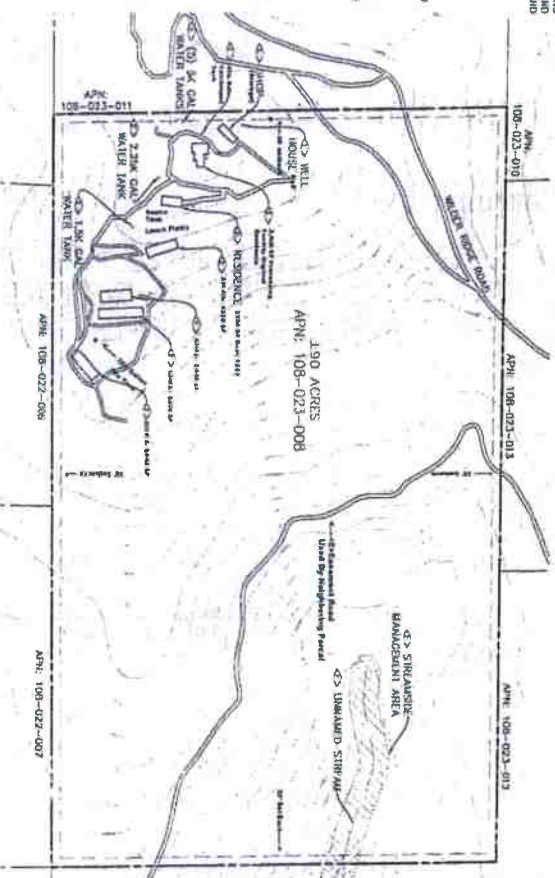

PROJECT INFORMATION:

PROJECT NAME: BIG RIVER FARM, LLC
 PROJECT ADDRESS: 403 891E CAMP RD, WOODLAND, CA 95692
 PROJECT CONTACT: [Name], [Phone], [Email]
 PROJECT DATE: [Date]

EXISTING CONDITIONS:

EXISTING ZONE: [Zone]
 EXISTING USE: [Use]
 EXISTING RIGHTS: [Rights]

PROPOSED CONDITIONS:

PROPOSED ZONE: [Zone]
 PROPOSED USE: [Use]
 PROPOSED RIGHTS: [Rights]

COMMENTS:

[Comments]

PLANNING DEPARTMENT:

DATE: [Date]
 BY: [Name]

PLANNING COMMISSION:

DATE: [Date]
 BY: [Name]

APPROVALS:

[Signatures]

NCRWGCB ORDER NUMBER R1-2015-0023
 THE SUBJECT MATTER HAS BEEN ENROLLED IN THE HUMBOLDT COUNTY RECORDS SYSTEM. THE RECORDS WILL BE MADE AVAILABLE TO THE PUBLIC UPON REQUEST.



SHEET INDEX:

01 - ZONING PLAN, VICINITY MAP, & PROJECT NOTES

BIG RIVER FARM, LLC / APN: 108-023-008
 9320 WILDER RIDGE RD, ETTERSBURG, CA
 CUP PLOT PLAN, VICINITY MAP AND PROJECT NOTES

NO.	DATE	REVISION

<u>Estimated Work Dates:</u>	<u>Casing:</u>	<u>Type of Sewage System:</u>
Start _____	Diameter (in.) _____	<input type="checkbox"/> Community Sewer
Completion _____	Material _____	<input type="checkbox"/> OWTS (Septic)
		Distance from well site to OWTS _____
Special Requirements/Comments:		

PLOT PLAN		
17/18-1912		

FOR OFFICE USE ONLY

Fee: <u>373</u> *	Site Approved by: <u>J. Whittaker</u>
Date: <u>5/23/18</u> *	Site Approved Date: <u>6/5/18</u>
Receipt: <u>2134</u> *	Sealed to Depth of: _____
Project #: _____	Seal observed: <input type="checkbox"/> Yes <input type="checkbox"/> No
Paid by: <u>Watson Well Drilling</u> *	Final Approved Date: _____

RECEIVED

MAY 23 2018