



FEMA



Cal OES
GOVERNOR'S OFFICE
OF EMERGENCY SERVICES

BAR IS ONE INCH ON ORIGINAL DRAWING IF NOT ONE INCH ON THIS SHEET, ADJUST SCALES ACCORDINGLY	ROAD NAME: HIDDEN COURT & EAST BRANCH ROAD	DESIGN SECTION	COUNTY OF HUMBOLDT DEPARTMENT OF PUBLIC WORKS STORM DAMAGE REPAIR TO HIDDEN CT PM 0.20, PM 0.04, AND EAST BRANCH RD PM 0.36	SHEET 1 OF 9
	ROAD NO.: 6B181 & 6B175	MILE POST: 0.20, 0.04, 0.36		
	AGREEMENT NO.: FEMA PW#4301-0297, PW#4699-0303, PW#4683-0623	DESIGNED BY: MMS	TITLE SHEET	
	CONTRACT NO.: 217340, 222165, 222107	DRAWN BY: MMS		
	DRAWING FILE NAME: Hidden Court PM 0.20 Design	REVIEWED BY: JAB		
	PLOT DATE: 4/15/2026	APPROVED BY: TRS		

COUNTY OF HUMBOLDT
DEPARTMENT OF PUBLIC WORKS
PROJECT PLANS FOR CONSTRUCTION OF
STORM DAMAGE REPAIR TO
HIDDEN COURT (6B181) AT PM 0.20, PM 0.04
& EAST BRANCH ROAD (6B175) AT PM 0.36,
PW4301-0297, PW4699-0303, PW4683-0623
CONTRACT NO. 217340, 222165, 222107

NOTES

THE CONTRACTOR SHALL HAVE A CLASS "A" LICENSE FOR THIS PROJECT.
 REFERENCE TO CALTRANS STANDARD PLANS DATED 2025.
 (SEE APPLICABLE STANDARD PLAN LIST IN SPECIAL PROVISIONS,
 STANDARD SPECIFICATIONS, AND LATEST 2025 STANDARD SPECIFICATIONS)

DESIGN DESIGNATION

EAST BRANCH ROAD ADT = 113
 V = 25MPH

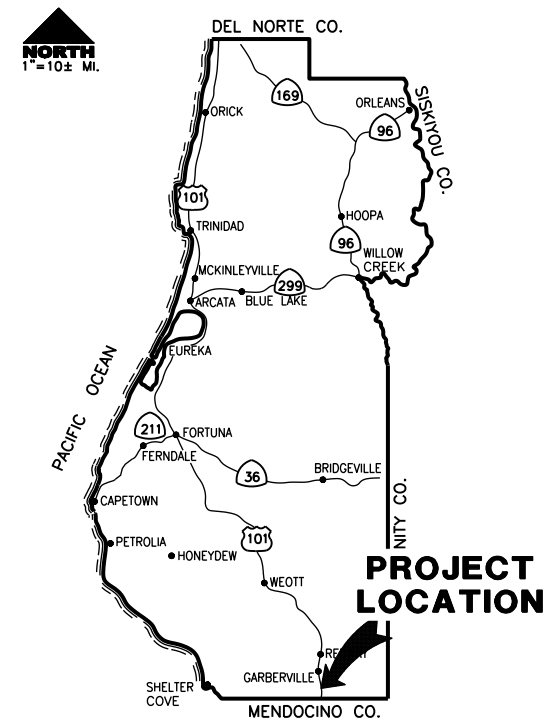

LOCATION MAP
 SCALE: 1"=10± MILE

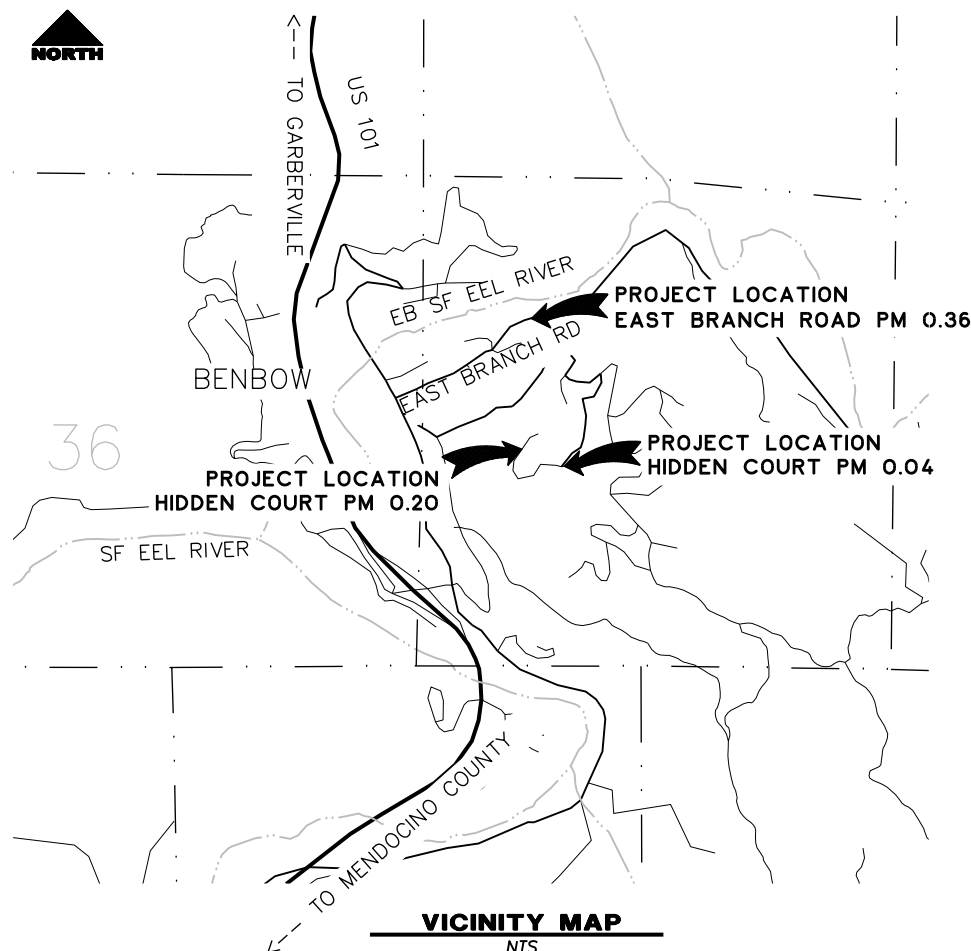

VICINITY MAP
 NTS

SITE	CONTRACT No.	LAT & LONG	FEMA PW#
HIDDEN COURT PM 0.20	217340	40.069786, -123.781744	CA-4301-PW-297
HIDDEN COURT PM 0.04	222165	40.069200, -123.780700	CA-4699-PW-303
EAST BRANCH ROAD PM 0.36	222107	40.073910, -123.781040	CA-4683-PW-623

INDEX OF SHEETS

- 1 COVER SHEET, SHEET INDEX, AND MAPS
- 2 TRAFFIC CONTROL, STAGING AND STOCKPILE AREAS, AND QUANTITIES
- 3 HIDDEN COURT PM 0.20 SURVEY AND CONTROL
- 4 HIDDEN COURT PM 0.20 TYPICAL SECTIONS
- 5 HIDDEN COURT PM 0.20 PLAN VIEW
- 6-7 HIDDEN COURT PM 0.20 SECTION VIEWS
- 8 HIDDEN COURT PM 0.04
- 9 EAST BRANCH ROAD PM 0.36

RECOMMENDED

Jeffrey A. Ball
 JEFFREY A. BALL
 RCE 70631, EXP. 6/30/2027
 4-20-2026
 DATE



APPROVED

Tony R. Seghetti
 TONY R. SEGHETTI
 RCE 63714, EXP. 9/30/2026
 4-20-2026
 DATE



ORIGINAL LOW BID PRICE	CONSTRUCTED BY	RESIDENT ENGINEER
	PROJECT COMPLETED	CONSTRUCTION COST \$



ROAD NAME: HIDDEN COURT & EAST BRANCH ROAD	DESIGN SECTION: ENGINEERING	COUNTY OF HUMBOLDT DEPARTMENT OF PUBLIC WORKS	SHEET 2 OF 9
ROAD NO.: 6B181 & 6B175	MILE POST: 0.20, 0.04, 0.36		
AGREEMENT NO.: FEMA PW#4301-0297, PW#4699-0303, PW#4683-0623	DESIGNED BY: MMS	STORM DAMAGE REPAIR TO HIDDEN CT PM 0.20, PM 0.04, AND EAST BRANCH RD PM 0.36	
CONTRACT NO.: 217340, 222165, 222107	DRAWN BY: MMS	SIGNS, STAGING AND STOCKPILE, AND QUANTITIES	
DRAWING FILE NAME: Hidden Court PM 0.20 Design	REVIEWED BY: JAB		
PLOT DATE: 4/15/2026	APPROVED BY: TRS		

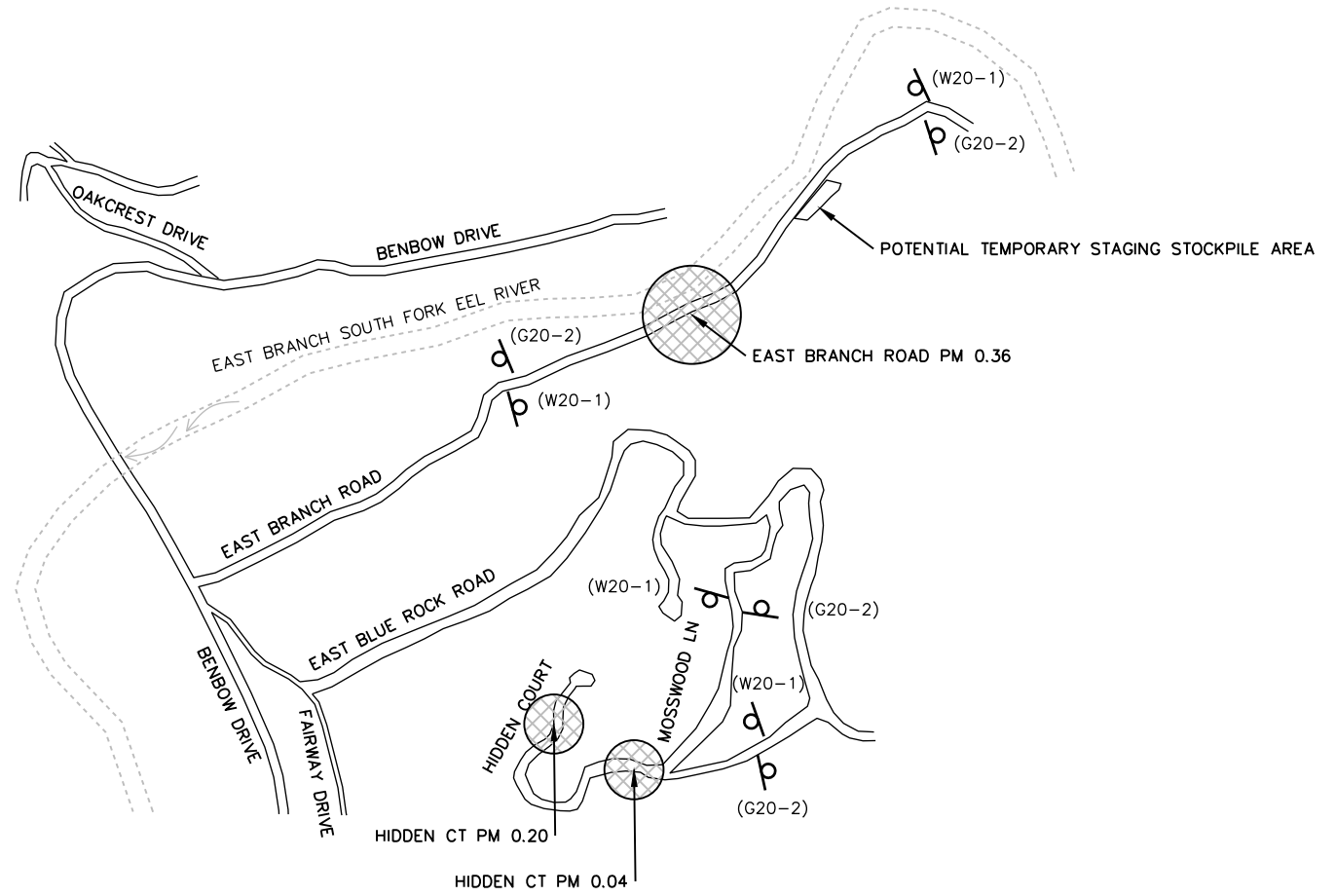

QUANTITIES

ITEM NO.	ITEM CODE	ITEM DESCRIPTION	UNIT	HC 0.20	HC 0.04	EBR 0.36	TOTAL
1	120090	Construction Area Signs	EA	2	2	4	8
2	120100	Traffic Control System	LS	0.2	0.1	0.7	1
3	130100	Job Site Management	LS	0.4	0.1	0.5	1
4	130200	Prepare Water Pollution Control Program	LS	0.4	0.1	0.5	1
5	170103	Clearing and Grubbing (LS)	LS	1.0	0.0	0.0	1
6	190101	F Roadway Excavation	CY	625	0	1,117	1,742
7	198050	F Embankment	CY	375	0	782	1,157
8	198232	Geosynthetic Reinforcement, PR2000	SQYD	0	0	2,999	2,999
9	198424	Secondary Geosynthetic Reinforcement, SR1600	SQYD	1,003	0	389	1,392
10	210212	Dry Seed (SQFT)	SQFT	1,900	0	2,275	4,175
11	210280	Rolled Erosion Control Product (Blanket)	SQFT	1,900	0	0	1,900
12	210350	Fiber Rolls	LF	173	0	350	523
13	260203	F Class 2 Aggregate Base (CY)	CY	108	0	230	338
14	390132	Hot Mix Asphalt (Type A)	TON	69	41	158	268
15	394037	Place Hot Mix Asphalt Dike (Type A)	LF	180	0	0	180
16	665018	18" Corrugated Steel Pipe (.109" Thick)	LF	25	0	0	25
17	680902A	6" Perforated Plastic Pipe	LF	180	0	0	180
18	680903A	6" Non-Perforated Plastic Pipe	LF	25	0	0	25
19	682022	F Class 1 Permeable Material (Blanket)	CY	88	0	0	88
20	710130	Remove Culvert	EA	1	0	0	1
21	723055	Rock Slope Protection (1/4 T, Class V, Method B) (CY)	CY	12	0	0	12
22	780260	Remove and Replace Monument	EA	1	0	0	1
23	999990	Mobilization	LS	0.4	0.1	0.5	1

NOTES

- 1) SIGNS SHALL BE PLACED AS SHOWN ON PLAN OR AS DIRECTED BY THE ENGINEER.
- 2) FINAL PLACEMENT OF SIGNS SHALL BE APPROVED BY RESIDENT ENGINEER.
- 3) ADDITIONAL PORTABLE SIGNS SHALL BE USED AS REQUIRED FOR OTHER ROADSIDE WORK.
- 4) SEE STANDARD PLAN T13 FOR TRAFFIC CONTROL SYSTEM.
- 5) IN ADDITION TO CONSTRUCTION AREA SIGNS AND WHEN DIRECTED BY THE RESIDENT ENGINEER, THE CONTRACTOR SHALL UTILIZE FLAGMEN AS NECESSARY TO DIRECT TRAFFIC.
- 6) KEEP A MINIMUM OF 1 TRAFFIC LANE AT LEAST 10' WIDE OPEN FOR TRAFFIC, EXCEPT THE FULL WIDTH OF THE TRAVELED WAY MUST BE OPEN WHEN CONSTRUCTION OPERATIONS ARE NOT ACTIVE OR AN APPROVED TRAFFIC CONTROL PLAN IS IN PLACE

CONSTRUCTION AREA SIGN SUMMARY

SIGN TYPE	QTY	DESCRIPTION	SIZE	REMARKS	POST SIZE	NUMBER
W20-1	4	ROAD WORK AHEAD	30" x 30"	VISIBLE AT ALL TIMES	4" x 4"	1
G20-2	4	END ROAD WORK	36" x 18"	VISIBLE AT ALL TIMES	4 x 4	1

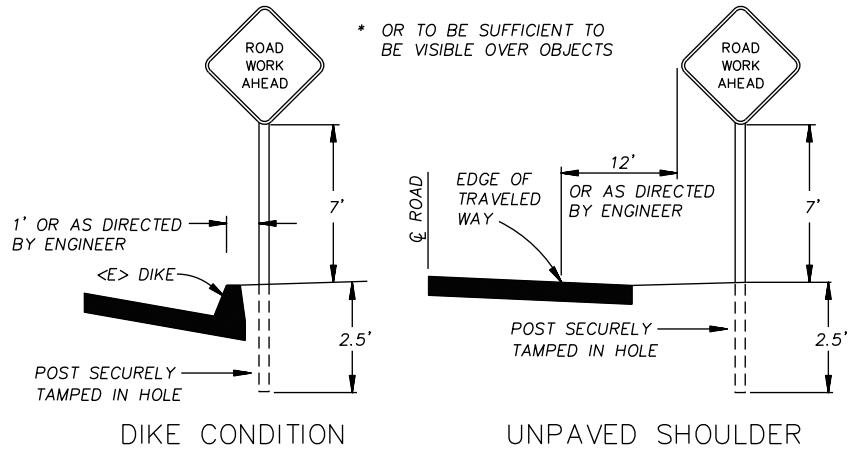

RURAL CONSTRUCTION AREA SIGN

- NOT TO SCALE -

STOCKPILE NOTES

- 1) MANAGE MATERIAL PER SECTION 13-4.03C OF THE 2018 CALTRANS STANDARD SPECIFICATIONS
- 2) IF STOCKPILE AREA IS IN A TURNOUT, THE TURNOUT SHALL BE REESTABLISHED TO PRE-CONSTRUCTION CONDITIONS
- 3) STOCKPILE LOCATIONS HAVE BEEN APPROVED BY PUBLIC WORKS AS DETAILED IN THE ENVIRONMENTAL REPORT.



ROAD NAME: HIDDEN COURT	DESIGN SECTION: ENGINEERING
ROAD NO: 68181	MILE POST: 0.20
AGREEMENT NO.: FEMA PW#PA-09-CA-4301-0297	DESIGNED BY: MMS
CONTRACT NO.: 217340	DRAWN BY: RMD
DRAWING FILE NAME: Hidden Court PM 0.20 Design	REVIEWED BY: JAB
PLOT DATE: 4/15/2026	APPROVED BY: TRS

COUNTY OF HUMBOLDT DEPARTMENT OF PUBLIC WORKS	SHEET 3 OF 9
STORM DAMAGE REPAIR TO HIDDEN COURT PM 0.20	
RIGHT OF WAY AND SURVEY CONTROL	

SURVEY NOTES:

- The purpose of this survey is to determine topography for a storm damage repair site at PM 0.20 of Hidden Court, Benbow, CA. This survey reflects conditions on the site at time of survey; field work completed 2/8, 2/12, and 2/23/18.
- Underground utilities research was not performed. We located PG&E overhead lines, a 3" waterline that has been laid atop road as a temporary measure to protect water main, and storm drains that we encountered in survey limits. Overhead telephone lines were observed along ground in slide area and were not located- it is assumed they are no longer in service. The existence of other utilities including on-site septic systems is unknown. See Underground Utility Note below.
- Coordinates for this survey are based on a County of Humboldt survey for Hidden Creek PM 0.0, Project No. 211246, dated February 2014. We held Points 3 and 5 thereon for the basis of coordinates and bearings on this survey. Per said County survey control is California Coordinate System of 1983 (CCS83) Zone 1 (Epoch 2010.0) in US Survey Feet based on NGS Opus post processing. The mapping angle per said survey is 1 degree 09 minutes 54 seconds- rotate bearings counterclockwise by this angle to obtain "True" or Geodetic bearings. Grid distances shown should be divided by the Combined Scale factor of 0.99995170 to obtain ground distances. Elevations are also from said County survey, based on GPS Opus solution, and are purportedly on NAVD88 Datum.
- Tract Map No. 68, Benbow Estates Unit No. 3, recorded in Book 15 of Maps pages 39-46 was scaled to grid based on Combined Scale factor noted above. Bearings on said Benbow Estates Unit 3 were rotated clockwise 1 degree 24 minutes 08 seconds between the found street monuments No.'s 57 and 60, holding No. 57. Record distance and bearing between these monuments per Tract Map No. 68 is N 24° 30' E 171.78'; we measured N 25° 54' 08" E 171.87' (grid) based on control noted in Note 3 above.
- Only trees greater than 12 inches in diameter were located- other trees exist in surveyed area and are not shown.

Point #	Elevation	Northing	Easting	Description
58	696.90	1913840.14	6063055.73	CP_SPK
50	749.71	1913413.96	6062942.08	CP_MAG
61	676.55	1913938.83	6063073.76	CP_SPK
53	718.82	1913591.90	6062878.17	CP_R&C
54	691.51	1913735.06	6062920.65	CP_SPK
55	706.25	1913688.42	6062989.67	CP_SPK
59	691.65	1913885.26	6063091.88	CP_SPK

Point #	Elevation	Northing	Easting	Description
51	737.85	1913419.84	6062909.38	FD_75"IP_RCE_23681
3	777.16	1913415.58	6063103.60	fdspike
60	688.20	1913906.00	6063117.91	FD_2" BC_IN_MW_RCE_13184
52	740.83	1913452.35	6062915.49	FD_SPK
4	791.37	1913477.97	6063181.01	fdbrokenspike
5	794.01	1913497.71	6063183.94	fdspike
105	794.02	1913497.68	6063183.91	FD_SPK
57	701.08	1913751.40	6063042.83	FD_2" BC_IN_MW_RCE_13184
103	777.16	1913415.58	6063103.60	FD_SPK

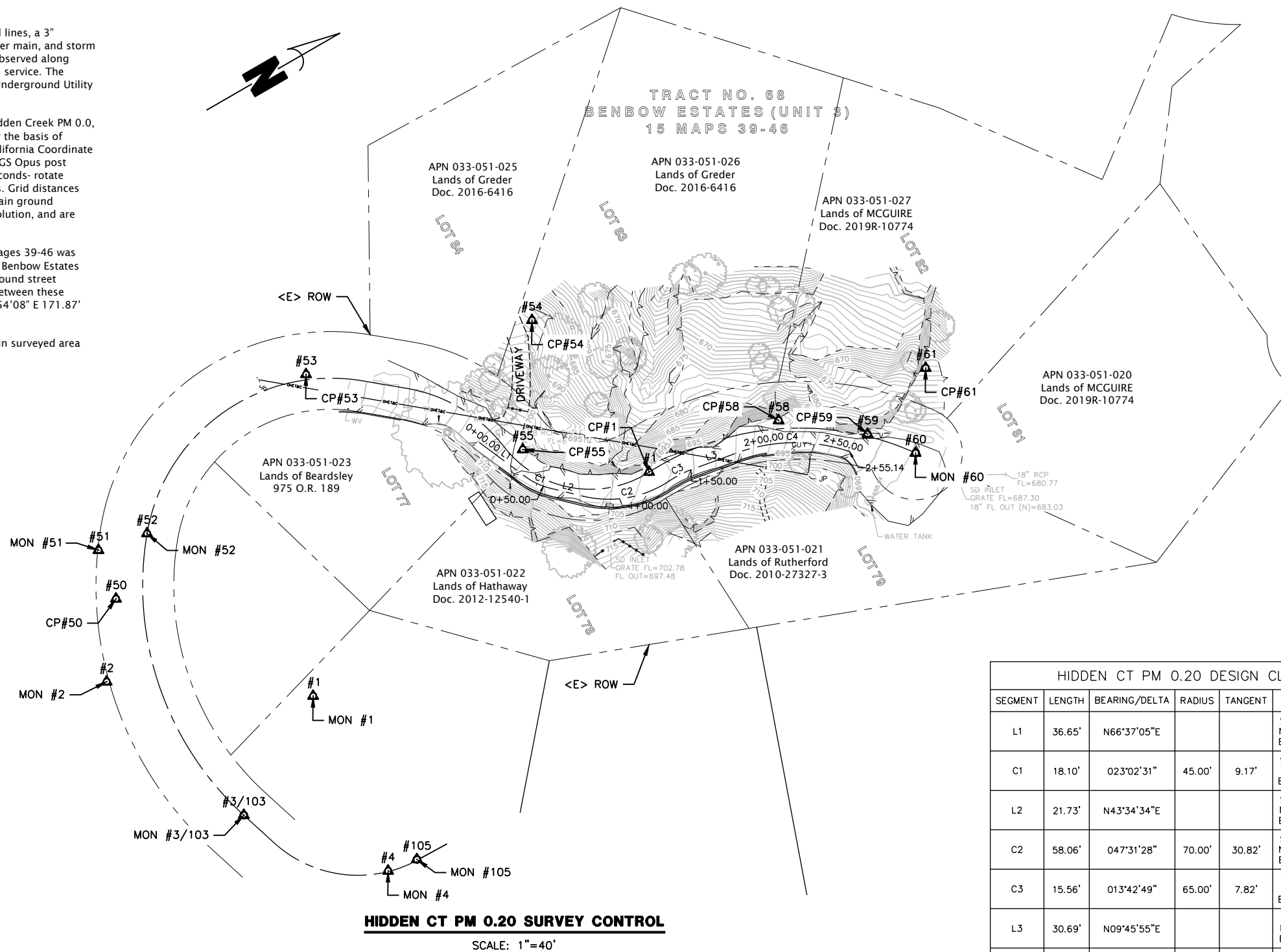

SEGMENT	LENGTH	BEARING/DELTA	RADIUS	TANGENT	START	END
L1	36.65'	N66°37'05"E			STA: 0+00.00 N: 1913666.46 E: 6062971.74	STA: 0+36.65 N: 1913681.01 E: 6063005.38
C1	18.10'	023°02'31"	45.00'	9.17'	STA: 0+36.65 N: 1913681.01 E: 6063005.38	STA: 0+54.75 N: 1913691.29 E: 6063020.12
L2	21.73'	N43°34'34"E			STA: 0+54.75 N: 1913691.29 E: 6063020.12	STA: 0+76.48 N: 1913707.04 E: 6063035.10
C2	58.06'	047°31'28"	70.00'	30.82'	STA: 0+76.48 N: 1913707.04 E: 6063035.10	STA: 1+34.54 N: 1913760.11 E: 6063054.22
C3	15.56'	013°42'49"	65.00'	7.82'	STA: 1+34.54 N: 1913760.11 E: 6063054.22	STA: 1+50.10 N: 1913775.61 E: 6063055.01
L3	30.69'	N09°45'55"E			STA: 1+50.10 N: 1913775.61 E: 6063055.01	STA: 1+80.79 N: 1913805.86 E: 6063060.22
C4	74.35'	038°43'31"	110.00'	38.66'	STA: 1+80.79 N: 1913805.86 E: 6063060.22	STA: 2+55.14 N: 1913869.57 E: 6063095.72



ROAD NAME: HIDDEN COURT	DESIGN SECTION
ROAD NO: 6B181	ENGINEERING
MILE POST: 0.20	DESIGNED BY: MMS
AGREEMENT NO.: FEMA PW#PA-09-CA-4301-0297	DRAWN BY: RMD
CONTRACT NO.: 217340	REVIEWED BY: JAB
DRAWING FILE NAME: Hidden Court PM 0.20 Design	APPROVED BY: TRS
PLOT DATE: 4/15/2026	

COUNTY OF HUMBOLDT DEPARTMENT OF PUBLIC WORKS STORM DAMAGE REPAIR TO HIDDEN COURT PM 0.20 HIDDEN COURT PM 0.20 TYPICAL SECTIONS	SHEET 4 OF 9
--	-------------------------------------

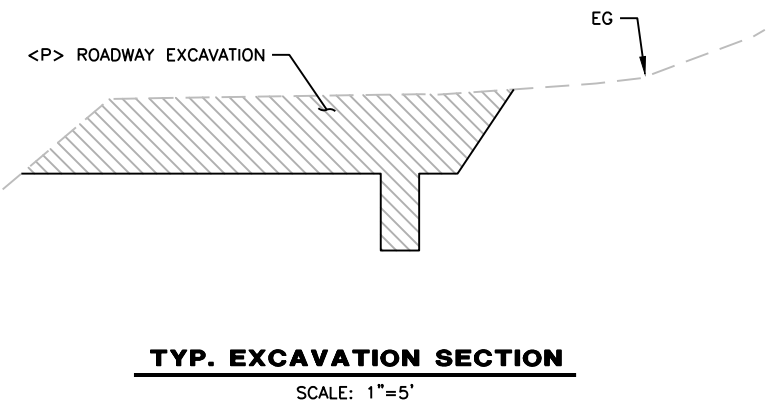
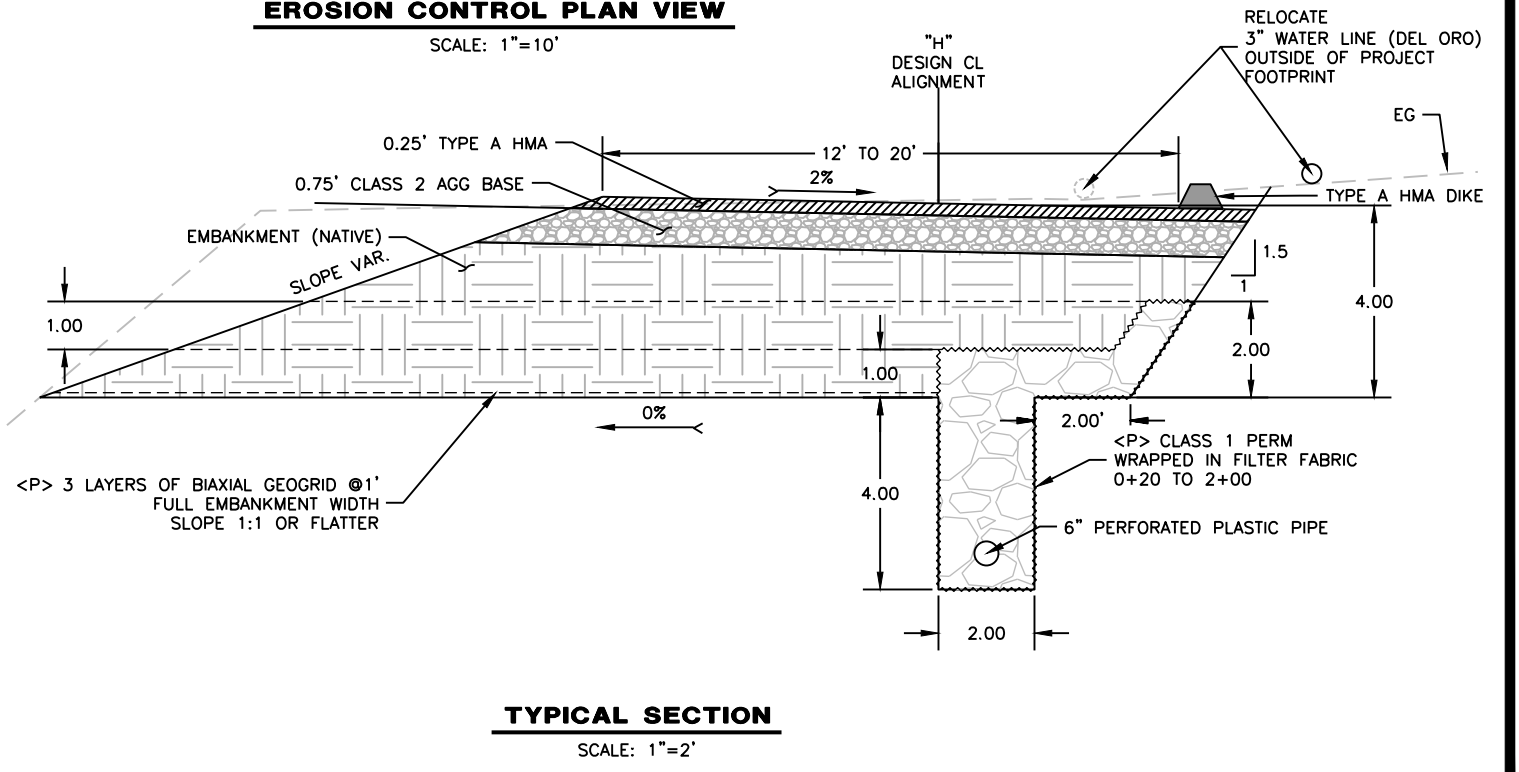
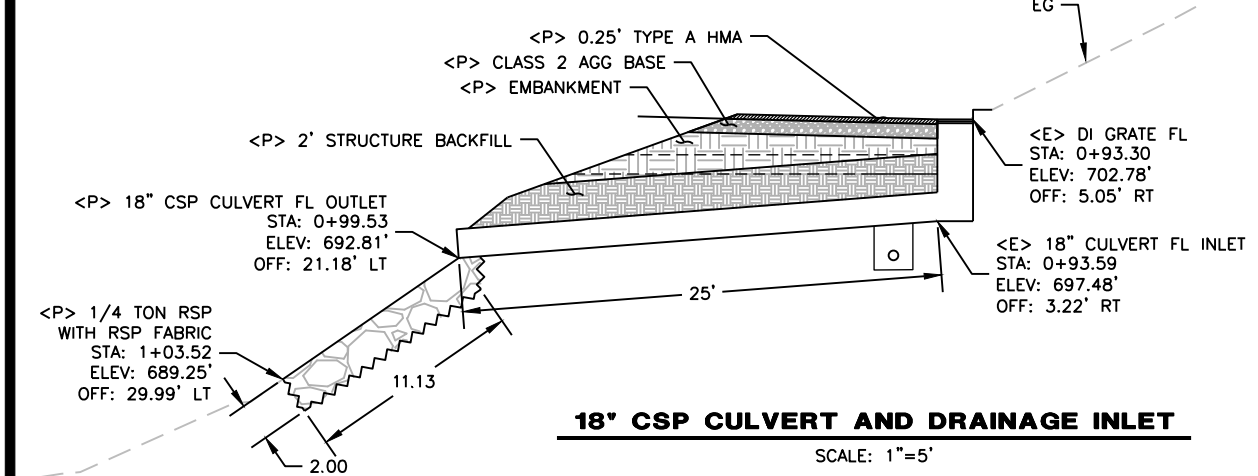
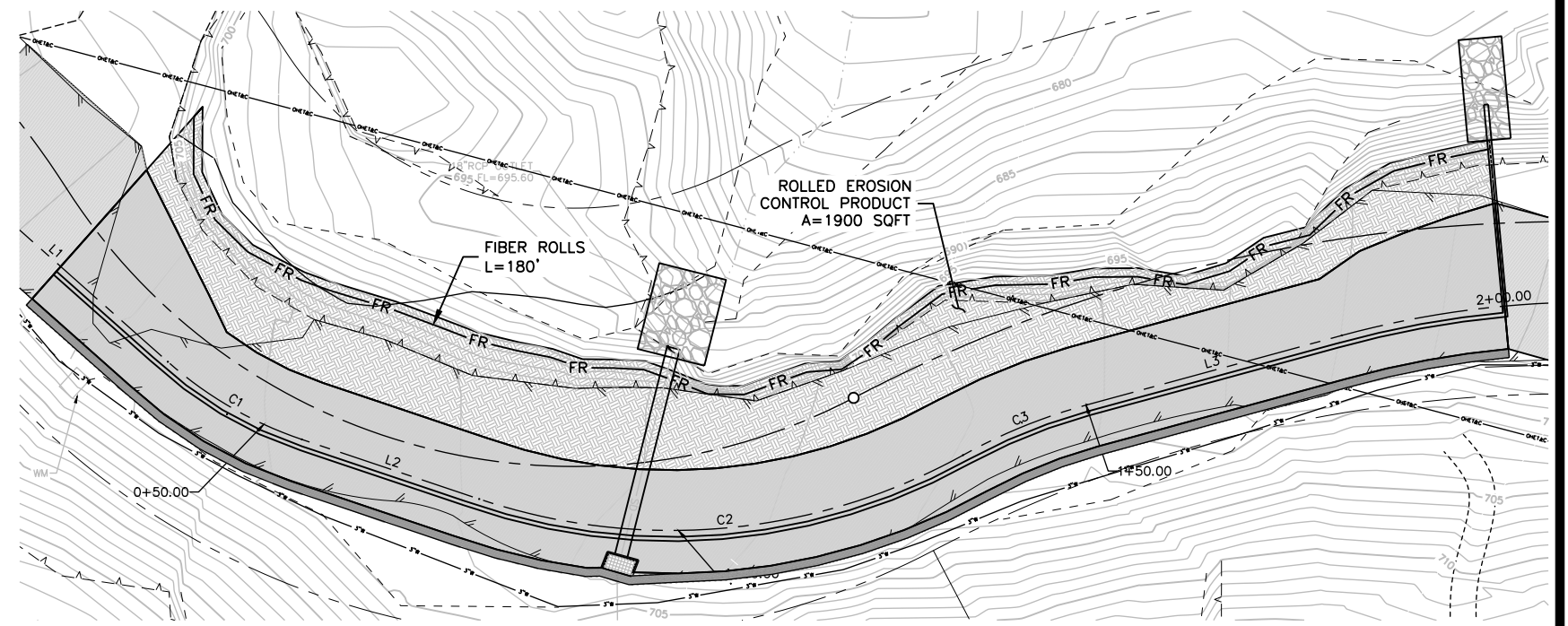
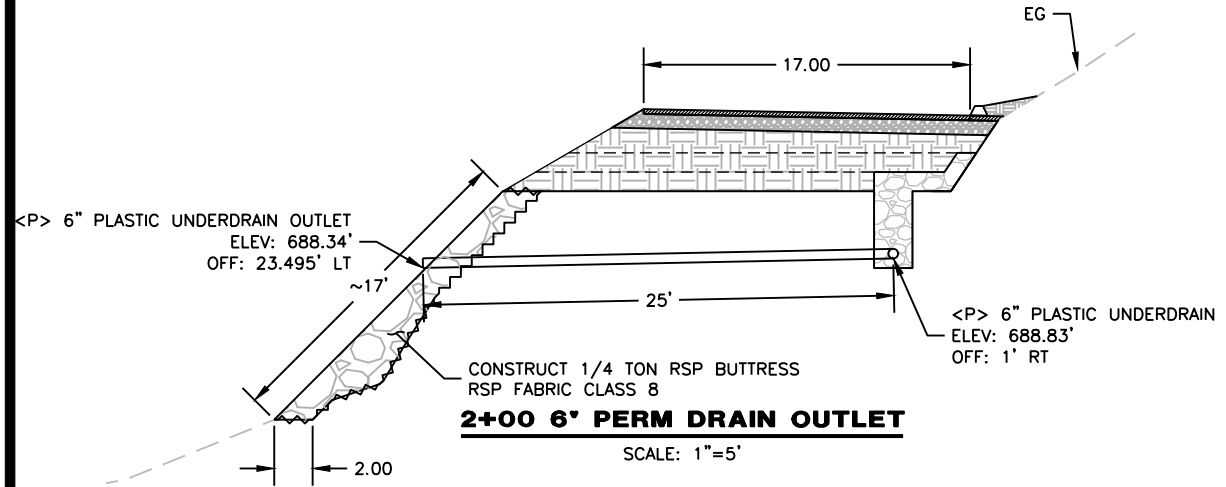
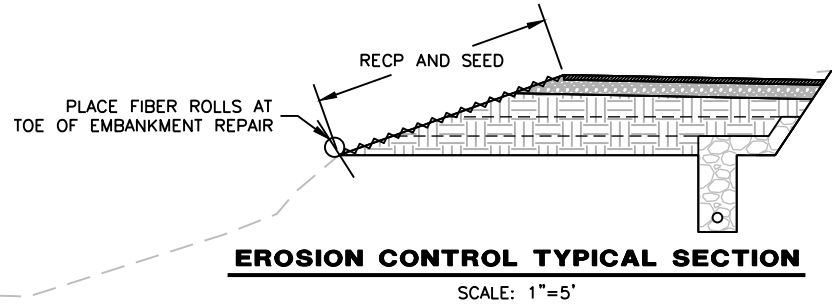
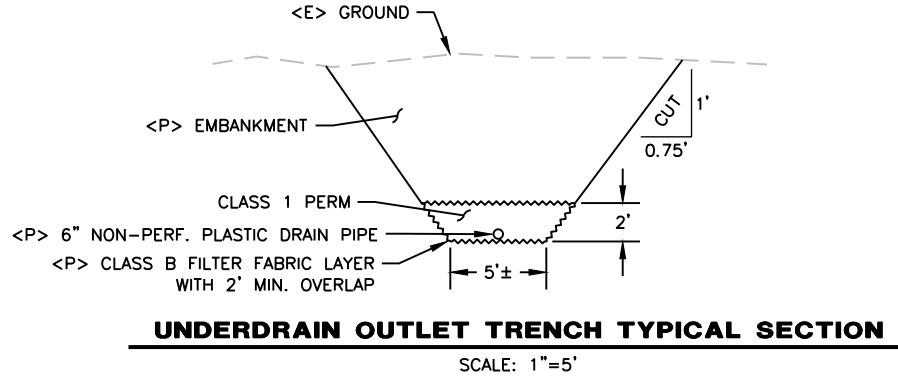

TYPICAL SECTION
SCALE: 1"=2'



ROAD NAME: HIDDEN COURT	DESIGN SECTION
ROAD NO.: 6B181	ENGINEERING
AGREEMENT NO.: FEMA PW#PA-09-CA-4301-0297	DESIGNED BY: MMS
CONTRACT NO.: 217340	DRAWN BY: RMD
DRAWING FILE NAME: Hidden Court PM 0.20 Design	REVIEWED BY: JAB
PLOT DATE: 4/15/2026	APPROVED BY: TRS

COUNTY OF HUMBOLDT DEPARTMENT OF PUBLIC WORKS
STORM DAMAGE REPAIR TO HIDDEN COURT PM 0.20
HIDDEN COURT PM 0.20 PLAN AND PROFILE

SHEET
5
OF
9

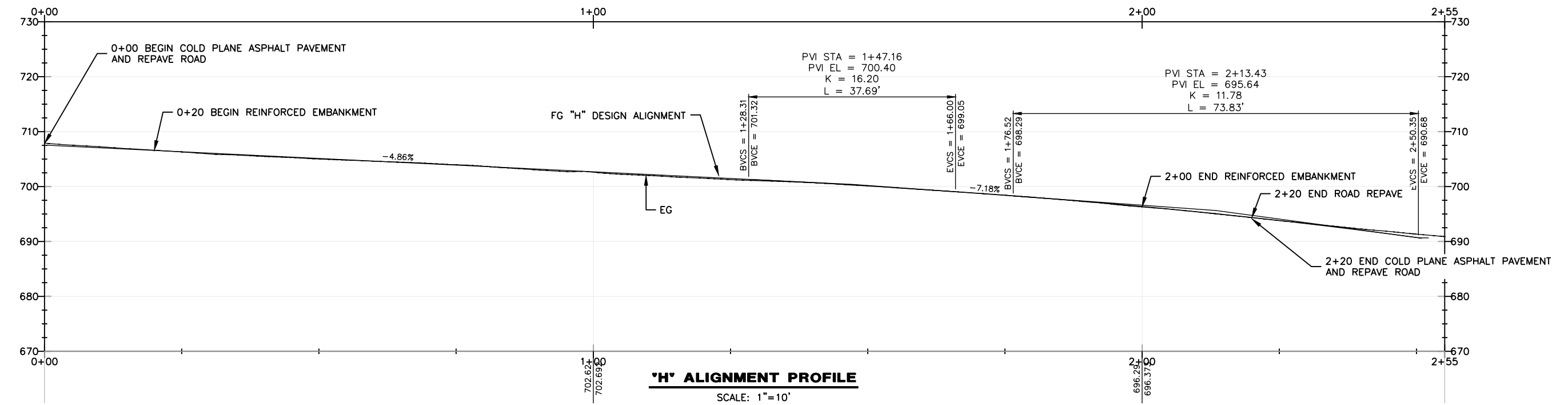
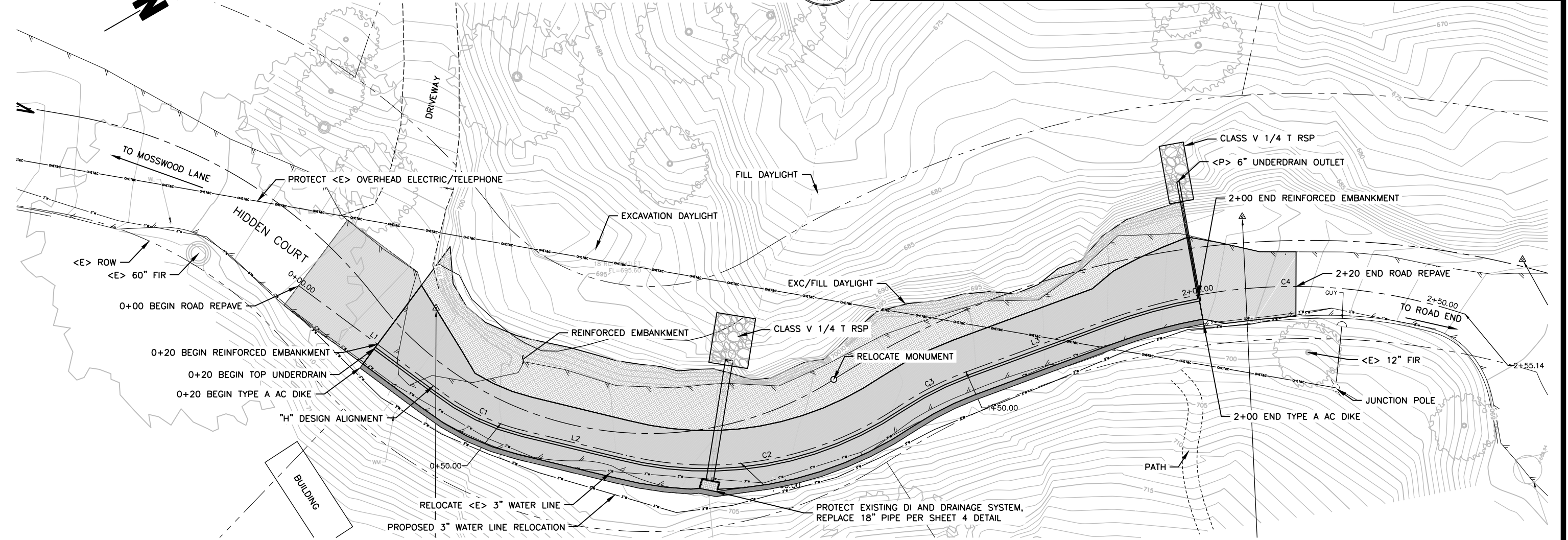



BAR IS ONE INCH ON ORIGINAL DRAWING IF NOT ONE INCH ON THIS SHEET, ADJUST SCALES ACCORDINGLY	ROAD NAME: HIDDEN COURT	DESIGN SECTION	
	ROAD NO.: 6B181	MILE POST: 0.20	ENGINEERING
	AGREEMENT NO.: FEMA PW#PA-09-CA-4301-0297	DESIGNED BY: MMS	
	CONTRACT NO.: 217340	DRAWN BY: RMD	
	DRAWING FILE NAME: Hidden Court PM 0.20 Design	REVIEWED BY: JAB	
	PLOT DATE: 4/15/2026	APPROVED BY: TRS	

COUNTY OF HUMBOLDT DEPARTMENT OF PUBLIC WORKS STORM DAMAGE REPAIR TO HIDDEN COURT PM 0.20
SECTION VIEWS (0.20 TO 1+20)

SHEET
6
OF
9

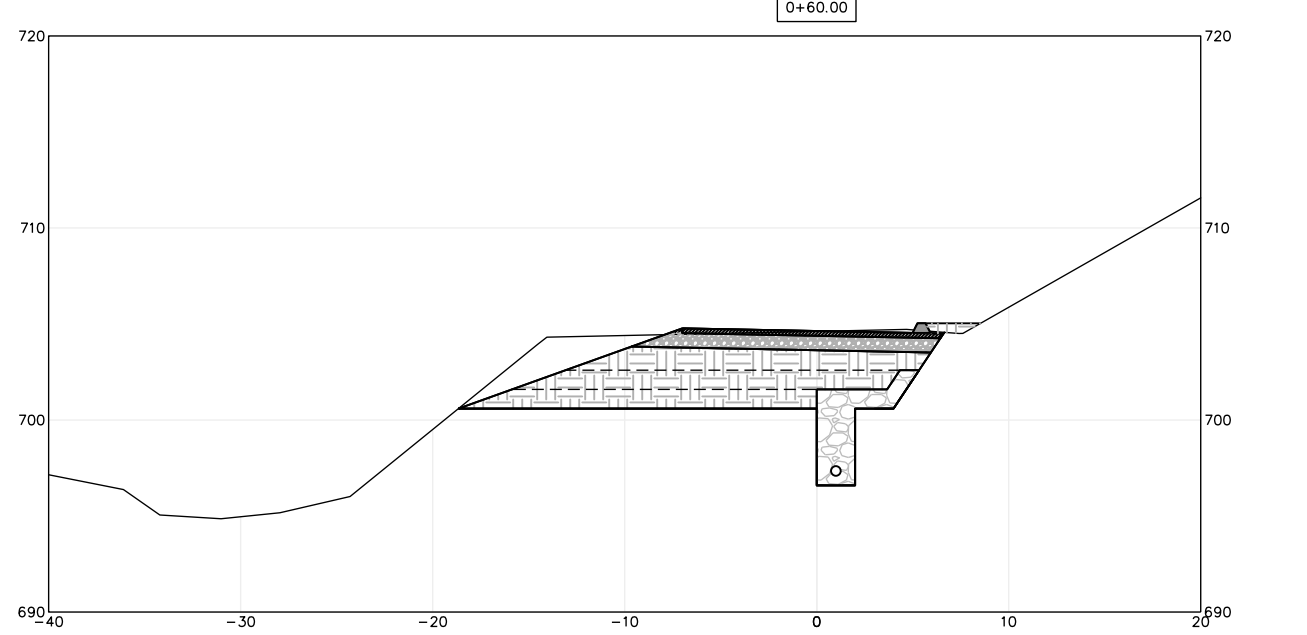
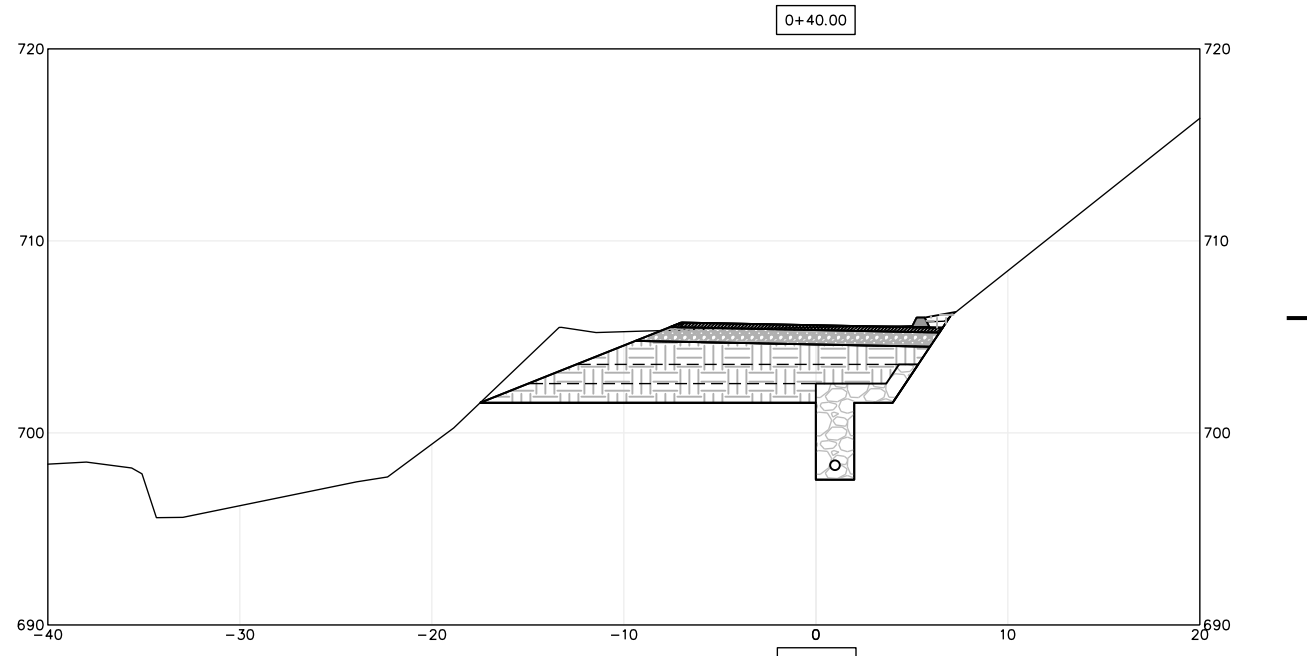
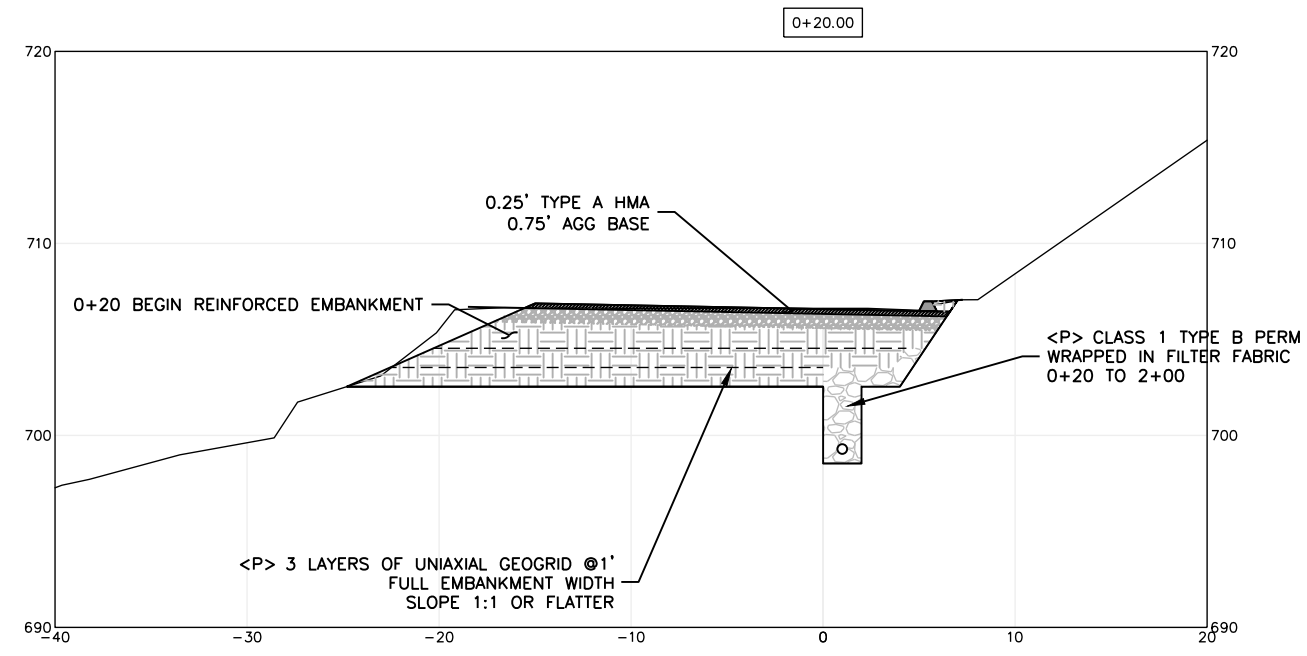

SECTION VIEWS
SCALE: 1"=10'

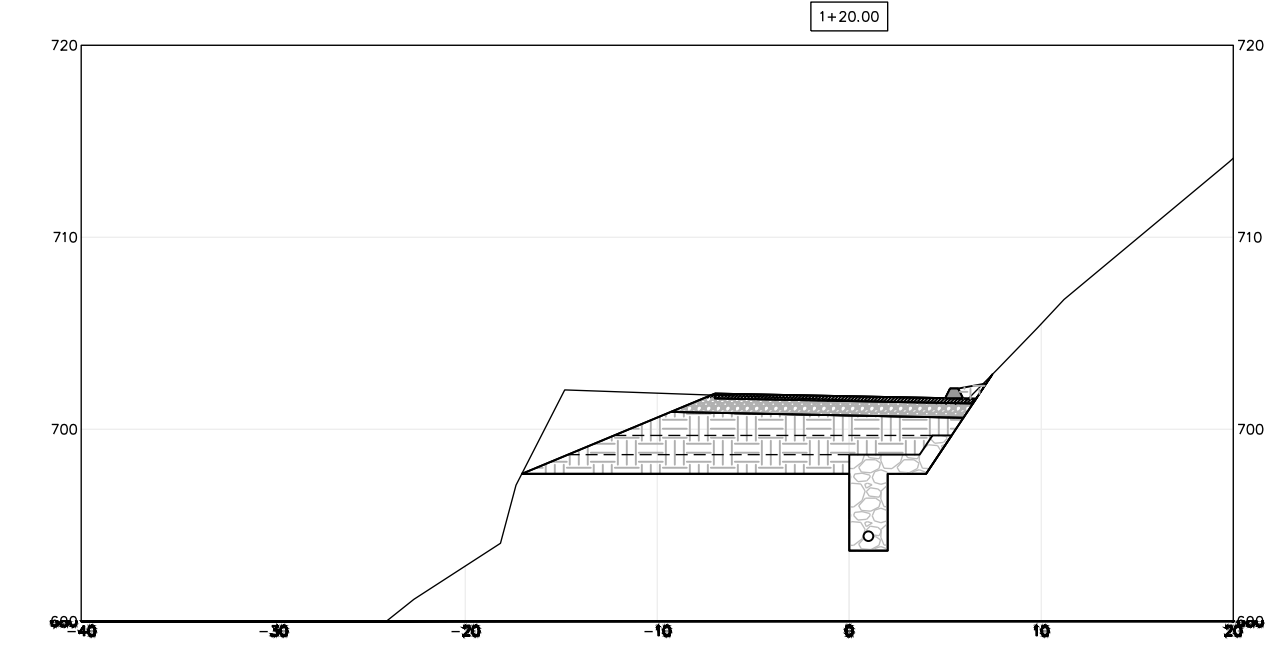
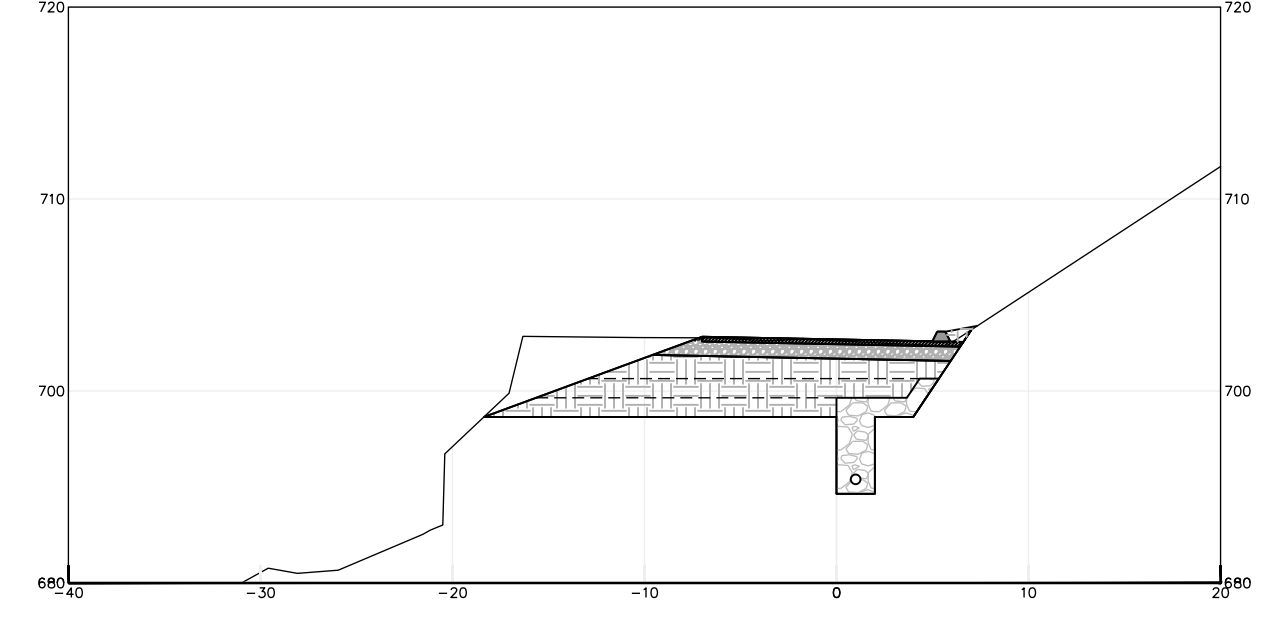
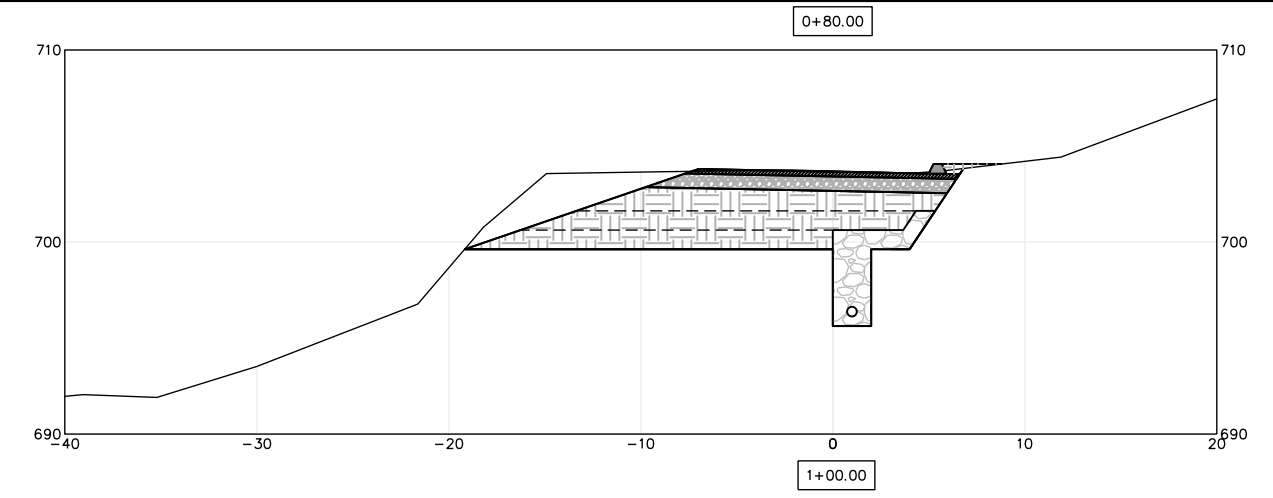



ROAD NAME: HIDDEN COURT		DESIGN SECTION
ROAD NO.: 6B181	MILE POST: 0.20	ENGINEERING
AGREEMENT NO.: FEMA PW#PA-09-CA-4301-0297		DESIGNED BY: MMS
CONTRACT NO.: 217340		DRAWN BY: RMD
DRAWING FILE NAME: Hidden Court PM 0.20 Design		REVIEWED BY: JAB
PLOT DATE: 4/15/2026		APPROVED BY: TRS

COUNTY OF HUMBOLDT DEPARTMENT OF PUBLIC WORKS	
STORM DAMAGE REPAIR TO HIDDEN COURT PM 0.20	
SECTION VIEWS (1+40 TO 2+00)	

SHEET
7
OF
9

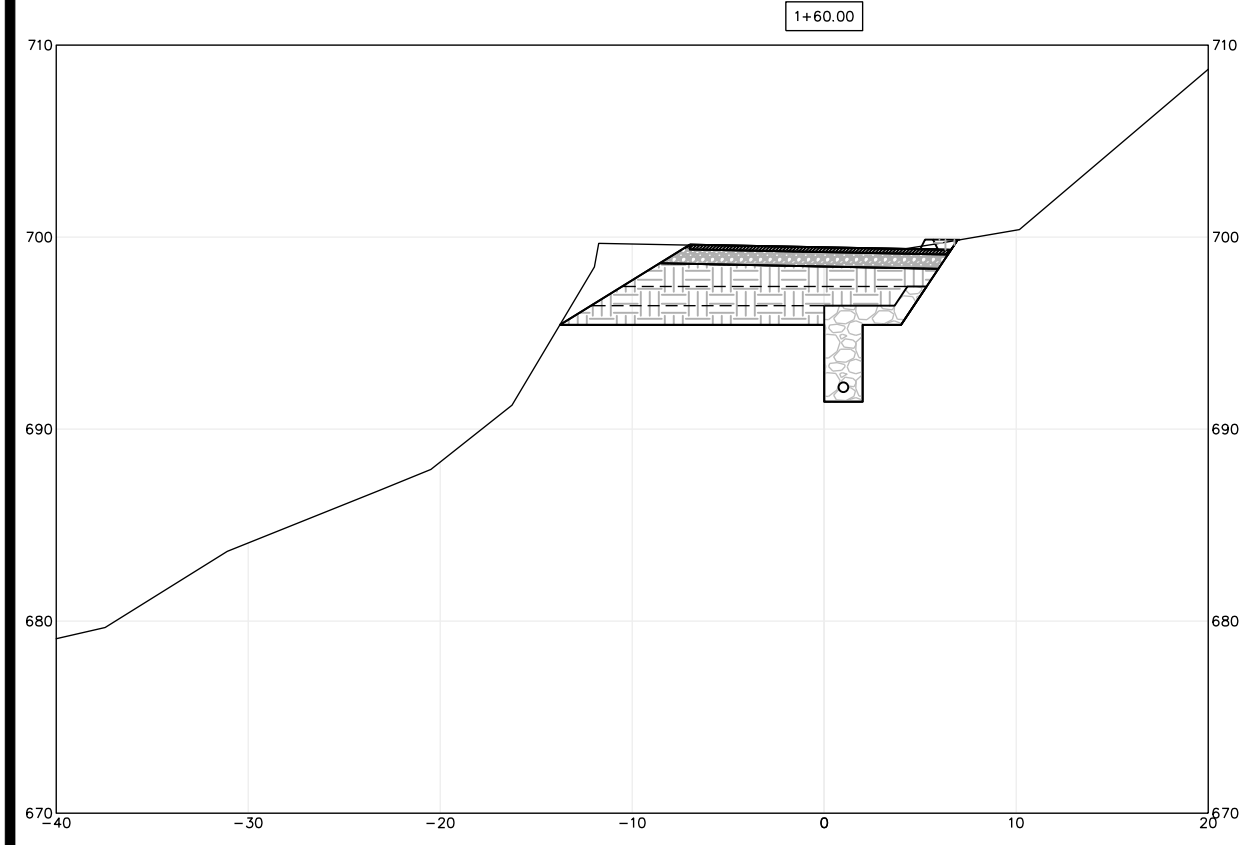
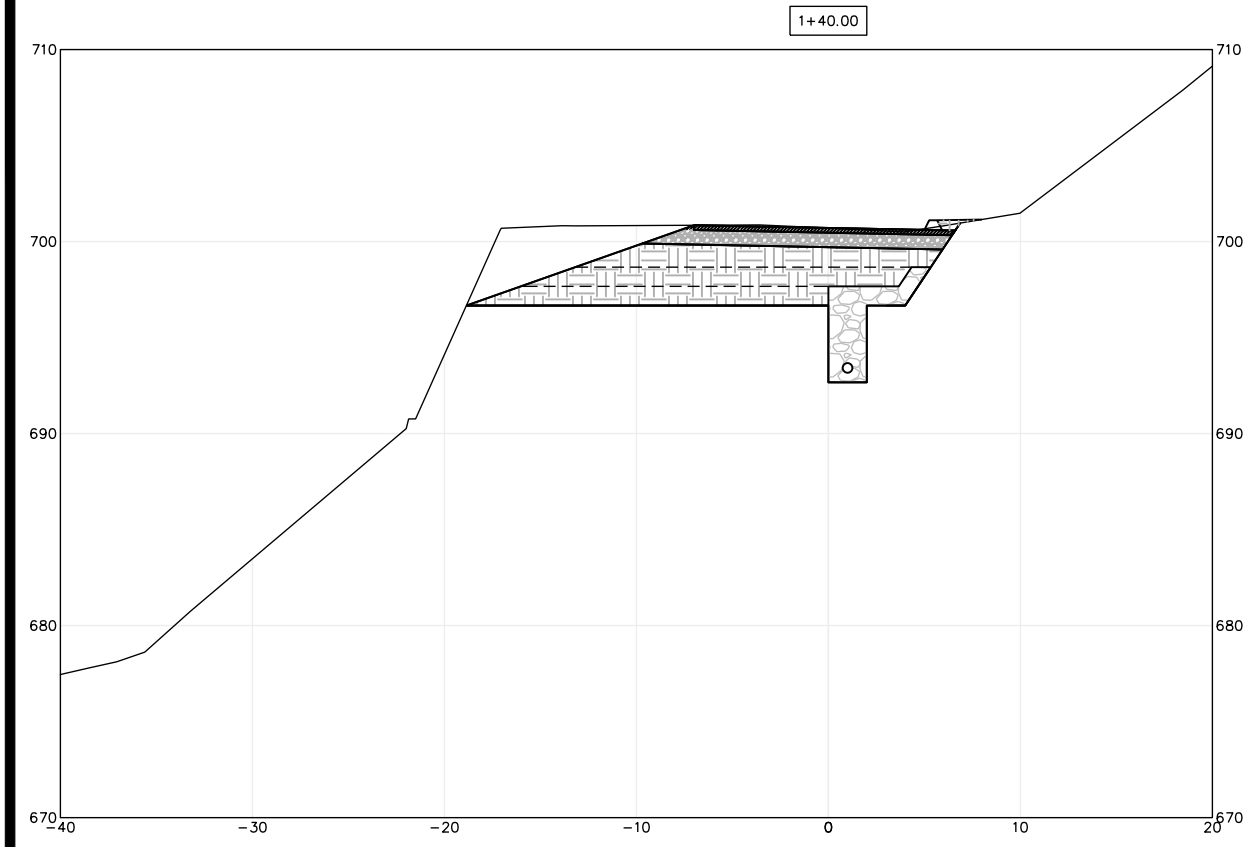

SECTION VIEWS
SCALE: 1"=10'

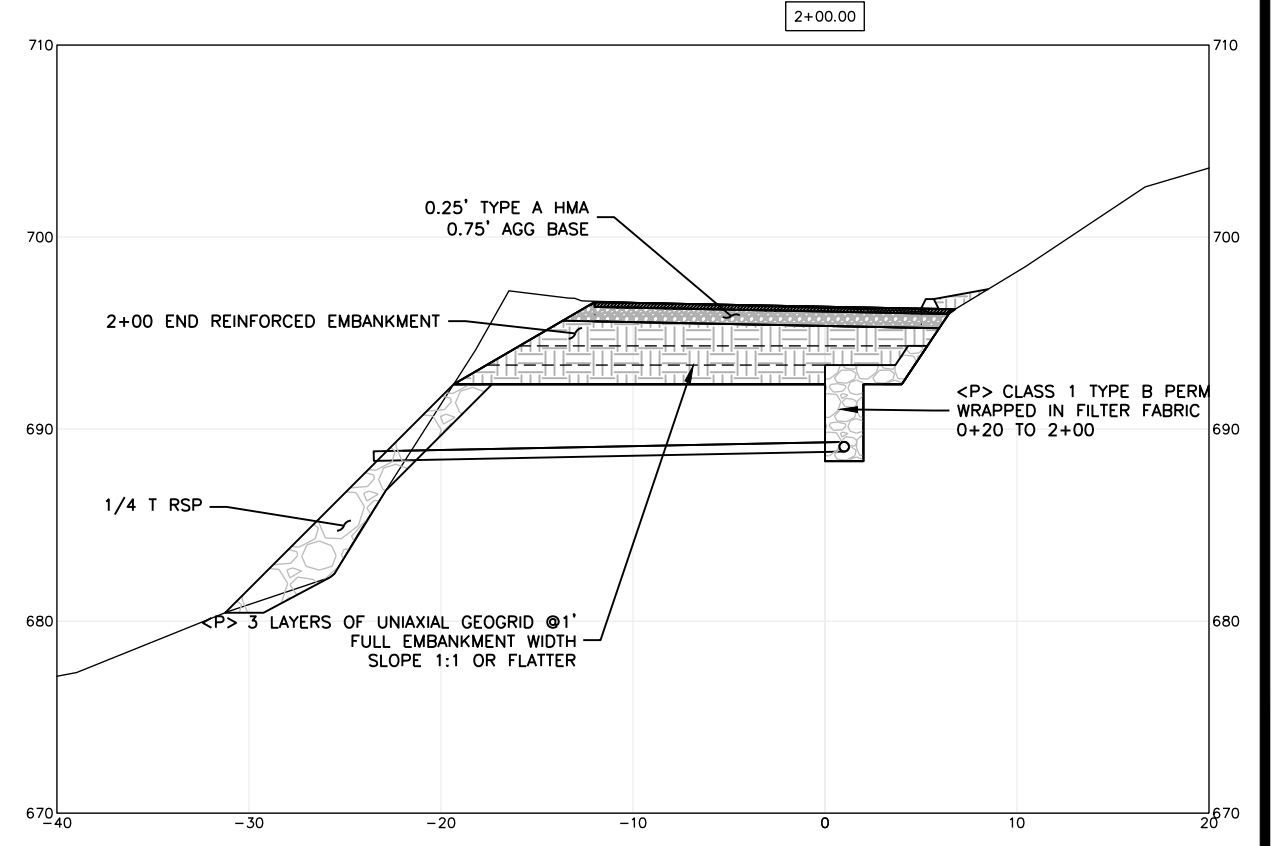
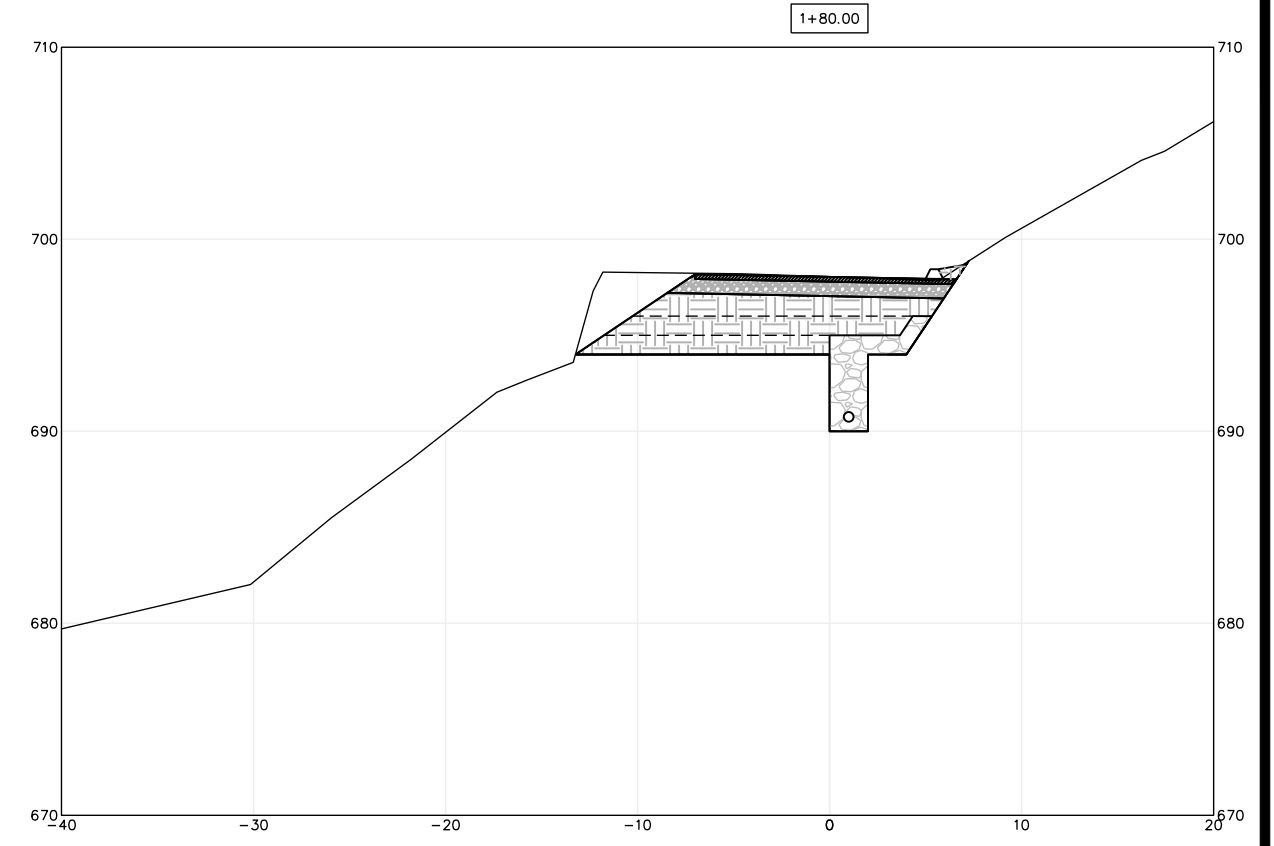



BAR IS ONE INCH ON ORIGINAL DRAWING	ROAD NAME: HIDDEN COURT & EAST BRANCH ROAD	DESIGN SECTION
IF NOT ONE INCH ON THIS SHEET, ADJUST SCALES ACCORDINGLY	ROAD NO.: 6B181	ENGINEERING
	MILE POST: 0.04	DESIGNED BY: MMS
	AGREEMENT NO.: PW#4699-0303	DRAWN BY: MMS
	CONTRACT NO.: 222165	REVIEWED BY: JAB
	DRAWING FILE NAME: Hidden Court PM 0.04 Design	APPROVED BY: TRS
	PLOT DATE: 4/15/2026	

COUNTY OF HUMBOLDT DEPARTMENT OF PUBLIC WORKS	
STORM DAMAGE REPAIR TO HIDDEN COURT PM 0.04	
PLAN VIEW AND TYPICAL SECTIONS	

SHEET
8
OF
9

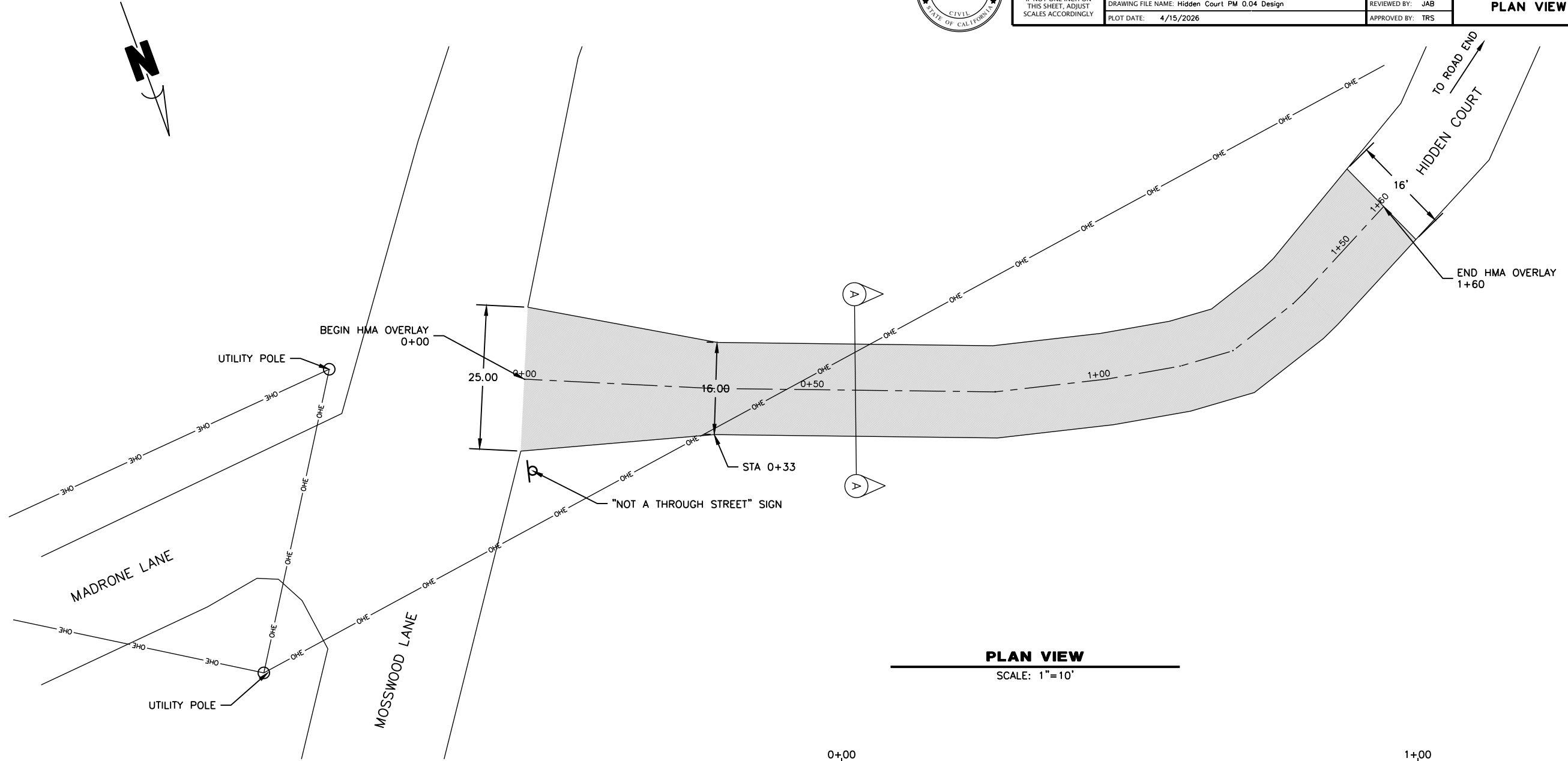

PLAN VIEW
SCALE: 1"=10'

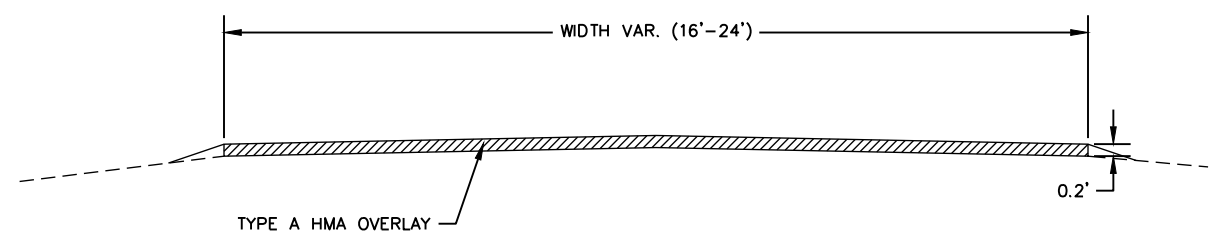

TYPICAL SECTION A-A
SCALE: 1"=2'

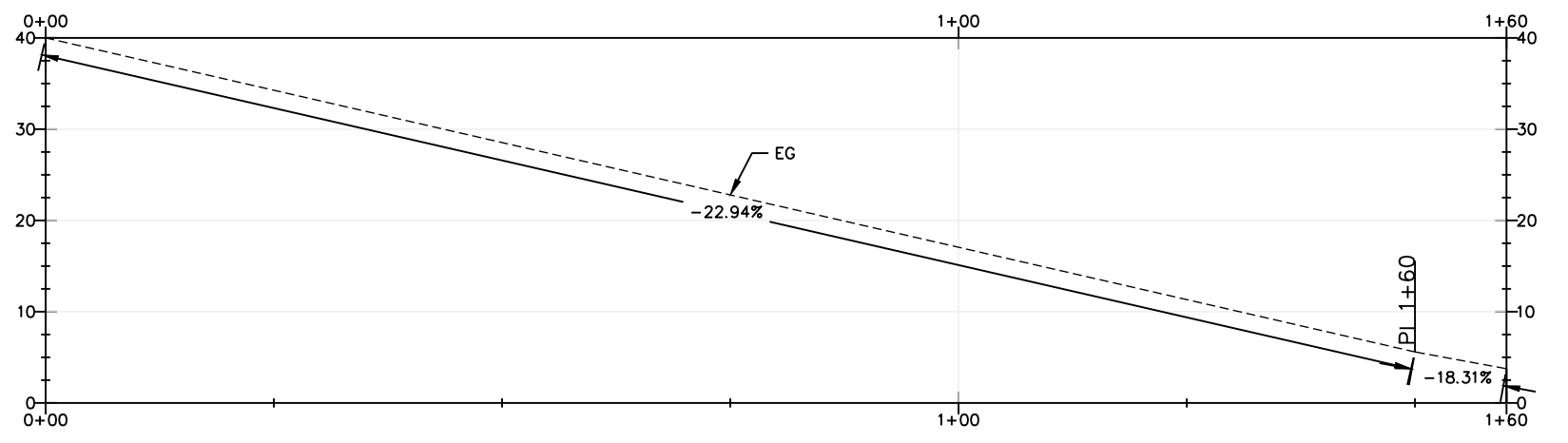

EXISTING ROAD PROFILE
SCALE: 1"=2'



BAR IS ONE INCH ON ORIGINAL DRAWING	ROAD NAME: EAST BRANCH ROAD	DESIGN SECTION
IF NOT ONE INCH ON THIS SHEET, ADJUST SCALES ACCORDINGLY	ROAD NO.: 6B175	ENGINEERING
	AGREEMENT NO.: PW#4683-0623	DESIGNED BY: MMS
	CONTRACT NO.: 222107	DRAWN BY: MMS
	DRAWING FILE NAME: EAST BRANCH ROAD PM 0.36 Design	REVIEWED BY: JAB
	PLOT DATE: 4/15/2026	APPROVED BY: TRS

COUNTY OF HUMBOLDT DEPARTMENT OF PUBLIC WORKS	SHEET
STORM DAMAGE REPAIR TO EAST BRANCH RD PM 0.36	9
PLAN VIEW AND TYPICAL SECTIONS	OF
	9

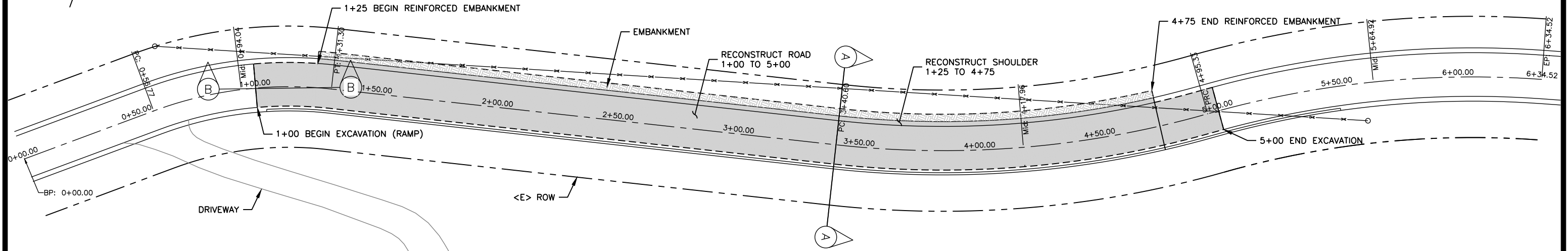

PLAN VIEW
SCALE: 1"=20'

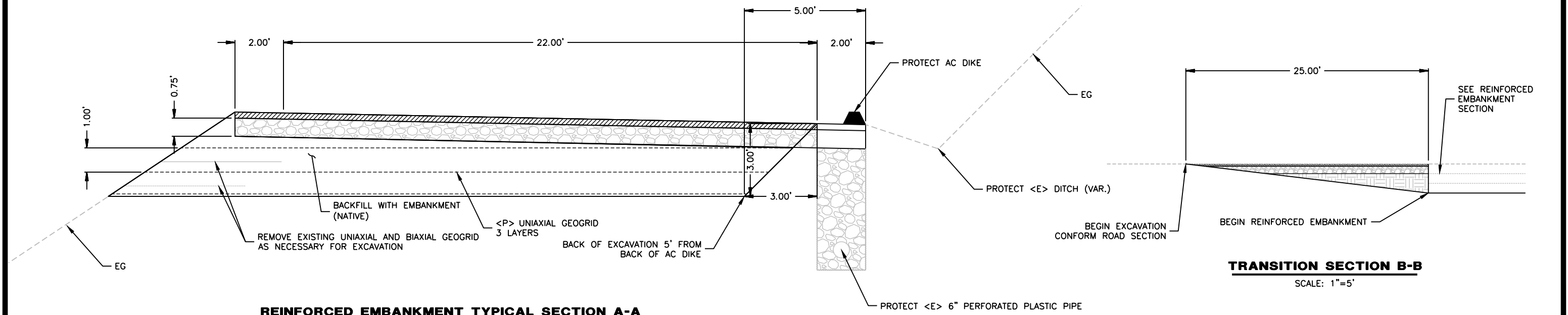

REINFORCED EMBANKMENT TYPICAL SECTION A-A
SCALE: 1"=2'

TRANSITION SECTION B-B
SCALE: 1"=5'