



LOCATION MAP
SCALE: 1" = 3,000'

PROJECT INFORMATION:

PROJECT DESCRIPTION: A ZONING CLEARANCE CERTIFICATE FOR A PROPOSED 10,000 SQUARE FOOT ~~INDOOR~~ CANNABIS CULTIVATION OPERATION.

APPLICANT: ROC SQUATCH FARMS
ATTN: ROCCI COSTA
638 W. SONOMA STREET
EUREKA, CA 95501
(707) 614-7832

PROPERTY OWNER: RODNEY COSTA
P.O. BOX 206
ALDERPOINT, CA 95571

ACRES: 5.01

PLAN: RA5-20

ZONE: AG

NOTES:

- FOR PLANNING PURPOSES ONLY. NOT FOR CONSTRUCTION.
- DATA IS APPROXIMATE.
- SOURCES: CONTOURS FROM NATIONAL ELEVATION DATASET, STREAMS FROM NATIONAL HYDROGRAPHY DATASET, PARCELS FROM HUMBOLDT COUNTY SHAPE FILE, IMAGE FROM BING
- THERE ARE NO OFF SITE RESIDENCES WITHIN 300 FEET OF CULTIVATION AREA.
- THERE ARE NO SCHOOLS, SCHOOL BUS STOPS, CHURCHES OR OTHER PLACES OF RELIGIOUS WORSHIP, PUBLIC PARKS OR TRIBAL CULTURAL RESOURCES WITHIN 600 FEET OF THE CULTIVATION AREA.
- GREENHOUSE SIZES ARE APPROXIMATE.
- APPLICANT TO HAVE PARCEL BOUNDARY AND CONSTRUCTION STAKING DONE PRIOR TO CONCRETE PLACEMENT FOR SETBACK VERIFICATION.
- PROPOSED WATER STORAGE INCLUDES 2500 GALLONS FOR SRA WATER STORAGE REQUIREMENTS.

LEGEND:

— OHE — OVERHEAD ELECTRIC

PLN: 217876-01-Rocci Costa

ROC SQUATCH FARMS

PLOT PLAN

APN 516-211-025

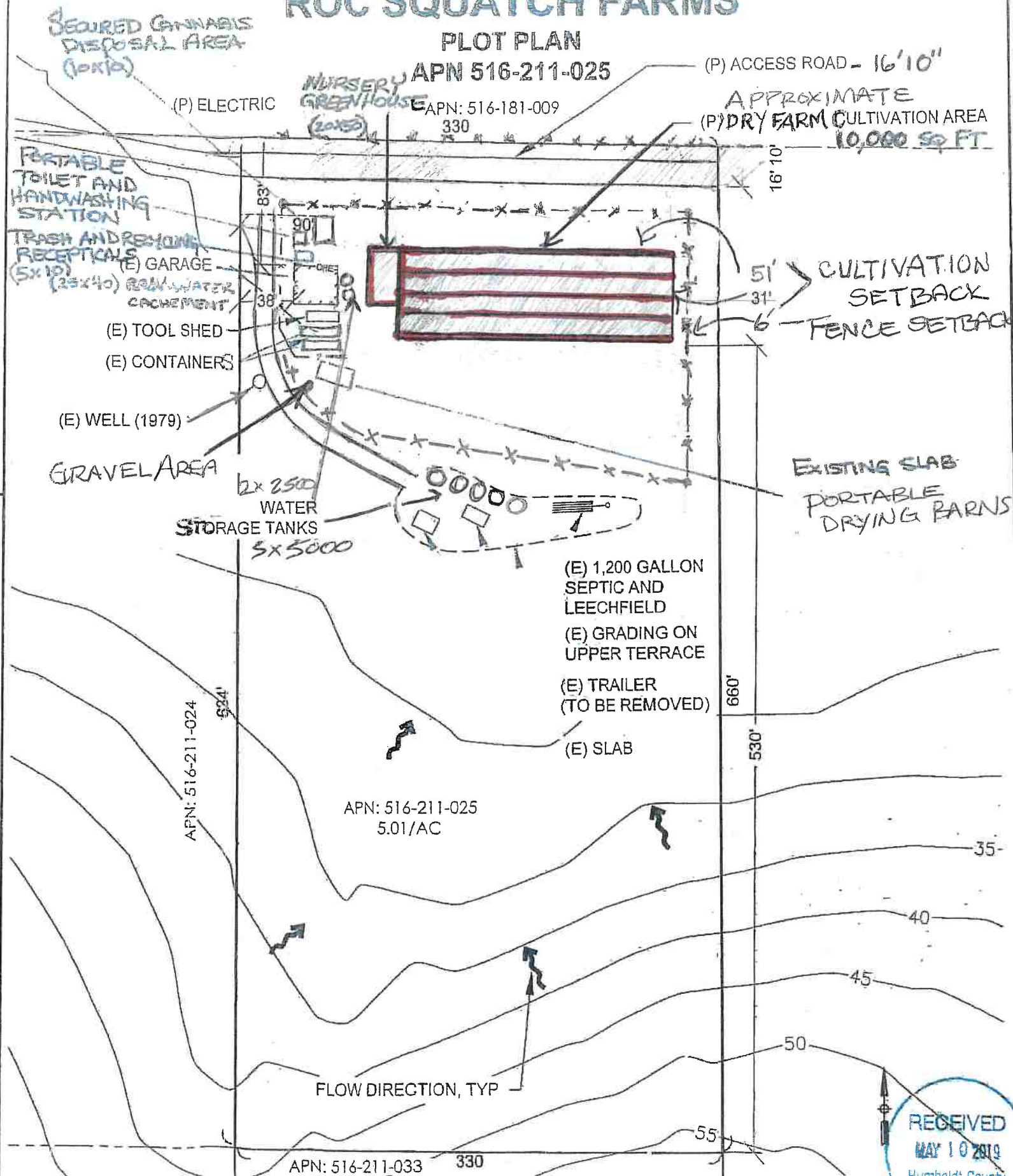

SITE MAP
SCALE: 1" = 100'

March 5, 2019
September 5, 2019

RECEIVED
JAN 24 2020
Humboldt County
Planning Division

RECEIVED
SEP 15 2021
Humboldt County
Planning Division

BY: CHG:1 DATE:
HISTORY / REVISION
NO:

ROC SQUATCH FARMS
PLOT PLAN

1734 WARREN CREEK RD. BLUE LAKE, CA 95521
APN: 516-211-025

RECEIVED
MAY 10 2019
Humboldt County
Planning Division

DRAWN	JDB
CHECK	MR
APPROVED	MR
DATE	3/31/17
JOB NUMBER	3.31.2017
PGURE	Page 13
	Page 10