

SOLAR SHADOW LENGTHS

	RIDGE HT.			
	1"	2'	18'	22'
(A)	41.1'	73.1'	92.6'	61'
(B)	35.4'	64.1'	39.6'	45.8'
(C)	41.1'	73.1'	92.6'	61'

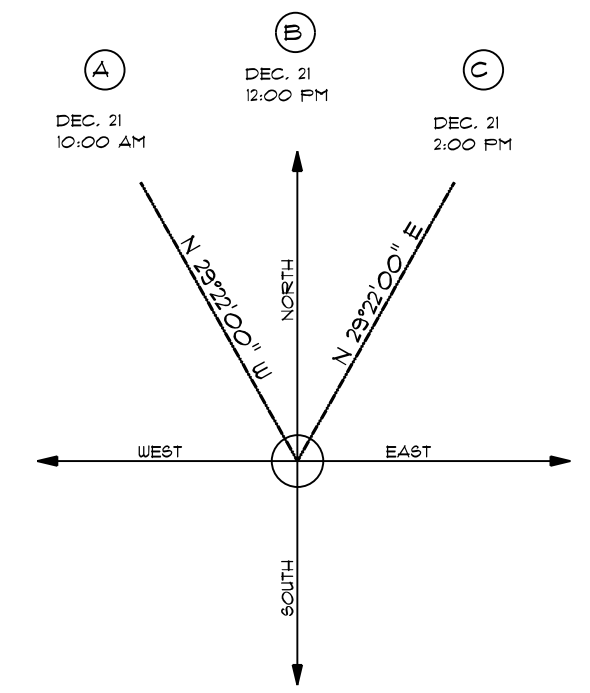

NORTH
SOLAR SHADING PLAN
 SCALE: 1" = 30'-0"

JOB No.

22-015

DRAFTING:



Brian Reilly
 4949 West End Road
 Arcata, CA 95521
 (707) 826-9800
 brian@millyard1.com

JOB TITLE:

SOLAR SHADE

for:
Dane Valadao
 1904 Pickett
 McKinleyville, CA 95519

PROJECT:

APN: 510-381-021
 1904 Pickett Road
 McKinleyville, CA 95519

ENGINEERING:

REVISIONS

ALL WORK SHALL BE IN CONFORMANCE WITH THE 2016 EDITIONS OF THE CALIFORNIA BUILDING CODE, CALIFORNIA 2016 RESIDENTIAL CODE, CALIFORNIA 2016 ELECTRICAL CODE, CALIFORNIA 2016 MECHANICAL CODE, CALIFORNIA 2016 PLUMBING CODE, CALIFORNIA ENERGY CODE, CALIFORNIA FIRE CODE, CALIFORNIA GREEN BUILDING CODE, & LOCAL ORDINANCES. THE CALIFORNIA BUILDING STANDARDS CODE IS BASED ON THE 2015-IBC.

6/16/2023

ENGR. JOB No.

DRAWN BY: **BAR**

SHEET No.

1

CONTRACTOR SHALL VERIFY ALL NOTATIONS AND DIMENSIONS OF EXISTING CONDITIONS OR NEW WORK. CONTRACTOR SHALL BE RESPONSIBLE FOR OBTAINING ALL NECESSARY PERMITS AND APPROVALS. CONTRACTOR SHALL BE RESPONSIBLE FOR ALL CONDITIONS OF THE PROJECT. CONTRACTOR SHALL BE RESPONSIBLE FOR OBTAINING ALL NECESSARY PERMITS AND APPROVALS FOR THIS PROJECT.