

FUNDING SOURCES



FEMA



Cal OES
GOVERNOR'S OFFICE
OF EMERGENCY SERVICES

**COUNTY OF HUMBOLDT
DEPARTMENT OF PUBLIC WORKS
PROJECT PLANS FOR CONSTRUCTION OF
STORM DAMAGE REPAIRS ON
ETTERSBERG ROAD (5B010)**

**at P.M. 5.0-5.6, 5.25
FEMA-4434-DR-CA PW-71; 4308-DR-CA PW-1031
CONTRACT NO. 219305, 217337**

BAR IS ONE INCH ON ORIGINAL DRAWING IF NOT ONE INCH ON THIS SHEET, ADJUST SCALES ACCORDINGLY	ROAD NAME: ETTERSBERG ROAD	DESIGN SECTION: ENGINEERING	COUNTY OF HUMBOLDT DEPARTMENT OF PUBLIC WORKS STORM DAMAGE ON ETTERSBERG ROAD PM 5.0-5.6, 5.25 COVER SHEET, SHEET INDEX AND MAPS	SHEET 1 OF 10
	ROAD NO.: 5B010	MILE POST: 5.0-5.6, 5.25		
	FEMA PROJECT NO.: FEMA 4434 PW#71; 4308 PW#1031	DESIGNED BY: JAB		
	CONTRACT NO.: 219305 & 217337	DRAWN BY: JAB		
	DRAWING FILE NAME: L:/PROJECT/2019 STORM DAMAGE/219305/Design/	REVIEWED BY: JAB		
	PLOT DATE: 05/02/2022	APPROVED BY: TRS		

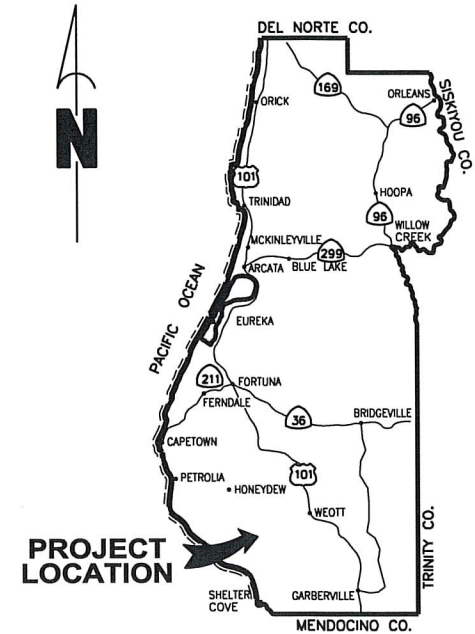

LOCATION MAP
SCALE: 1"=10± MILE

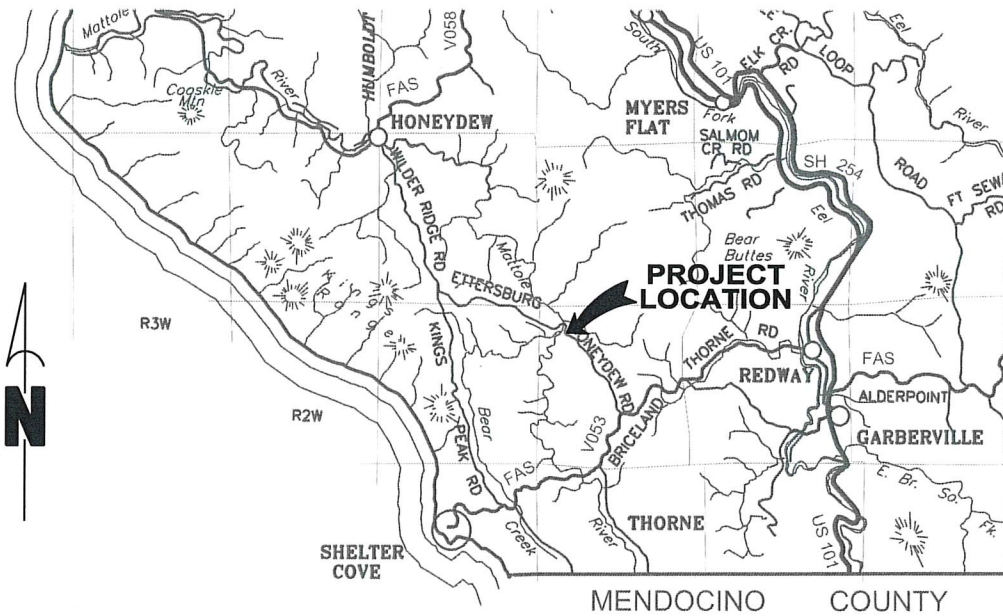

VICINITY MAP
N.T.S.



INDEX OF SHEETS

- 1 COVER SHEET, SHEET INDEX, AND MAPS
- 2 CONSTRUCTION SIGNS & QUANTITIES
- 3 SURVEY & CONTROL
- 4 TYPICAL SECTION AND DETAILS
- 5 TRAFFIC PHASING - CULVERT SITE
- 6 PM 5.0 CULVERT PLAN AND PROFILE
- 7 PM 5.25 ROAD PLAN AND PROFILE
- 8 EROSION CONTROL
- 9-10 CROSS SECTIONS

NOTES

THE CONTRACTOR SHALL HAVE A CLASS "A" LICENSE FOR THIS PROJECT.
PROJECT PLANS AND SPECIAL PROVISIONS TO BE SUPPLEMENTED BY THE STATE OF CALIFORNIA DEPARTMENT OF TRANSPORTATION STANDARD PLANS, STANDARD SPECIFICATIONS, AND THE LATEST REVISED 2018 STANDARD PLANS AND SPECIFICATIONS. (SEE APPLICABLE STANDARD PLAN LIST IN SPECIAL PROVISIONS)

RECOMMENDED

Jeffrey A. Ball 5/2/2022
JEFFREY A. BALL DATE
RCE 70631, EXP. 6/30/2023



APPROVED

Tony R. Seghetti 5/2/2022
TONY R. SEGHETTI DATE
RCE 63714, EXP. 9/30/2022



ORIGINAL LOW BID PRICE	CONSTRUCTED BY	RESIDENT ENGINEER
	PROJECT COMPLETED	CONSTRUCTION COST \$

STAGING & STOCKPILE NOTES

- 1) MANAGE MATERIAL PER SECTION 13-4.03C OF THE 2018 CALTRANS STANDARD SPECIFICATIONS
- 2) IF STAGING AND/OR STOCKPILE AREA IS IN A TURNOUT - THE TURNOUT SHALL BE REESTABLISHED TO PRE-CONSTRUCTION CONDITIONS
- 3) STAGING AND/OR STOCKPILE LOCATIONS SHOWN IN THE PLANS HAVE BEEN APPROVED BY PUBLIC WORKS AS DETAILED IN THE ENVIRONMENTAL REPORT.



ROAD NAME: ETTERSBERG ROAD	DESIGN SECTION: ENGINEERING
ROAD NO: 5B010	MILE POST: 5.0-5.6, 5.25
FEMA PROJECT NO: FEMA 4434 PW#71; 4308 PW#1031	DESIGNED BY: JAB
CONTRACT NO: 219305 & 217337	DRAWN BY: JAB
DRAWING FILE NAME: L:/PROJECT/2019 STORM DAMAGE/219305/Design/	REVIEWED BY: JAB
PLOT DATE: 05/02/2022	APPROVED BY: TRS

COUNTY OF HUMBOLDT DEPARTMENT OF PUBLIC WORKS STORM DAMAGE ON ETTERSBERG ROAD PM 5.0-5.6, 5.25 CONSTRUCTION AREA SIGNS AND BID QUANTITIES	SHEET 2 OF 10
--	--------------------------------------

PROJECT QUANTITIES

ITEM NO.	ITEM CODE	ITEM DESCRIPTION	UNIT	PM 5.0-5.6	PM 5.25	TOTAL QUANTITY
1	120090	Construction Area Signs	EA	6	6	12
2	120100	Traffic Control System	LS	0.5	0.5	1
3	129000	Temporary Railing (Type K)	LF	280	220	500
4	129100	Temporary Crash Cushion Module	EA	12	12	24
5	130100	Job Site Management	LS	0.5	0.5	1
6	130200	Prepare Water Pollution Control Program	LS	0.5	0.5	1
7	130680	Temporary Silt Fence	LF	50	0	50
8	160102	Clearing and Grubbing	LS	0.5	0.5	1
9	190101	Roadway Excavation	CY	47	722	769
10	190136A	Construct Detour	LS	1	0	1
11	192025 F	Structure Excavation (Culvert)	CY	1,080	0	1,080
12	193004A	Structure Backfill (Culvert)	CY	469	0	469
13	198050	Embankment	CY	414	667	1,081
14	198250A	Geosynthetic Reinforcement (Uniaxial Geogrid)	SY	0	678	678
15	210212	Dry Seed	SF	2,890	1,560	4,450
16	210350	Fiber Roll	LF	212	83	295
17	210420	Straw	SF	2,890	1,560	4,450
18	260301	Class 2 Aggregate Base	CY	99	52	151
19	390132	Hot Mix Asphalt (Type A)	TON	54	28	82
20	665067A P	72" Corrugated Aluminized Steel Pipe (0.168" Thick)	LF	200	0	200
21	710100	Abandon Culvert	EA	1	0	1
22	723030	Rock Slope Protection (1/2 Ton, Class VII, Method A)	CY	50	0	50
23	800052A	Reset Fence (Type WM, Wooden Post)	LF	200	0	200
24	999990	Mobilization	LS	0.5	0.5	1

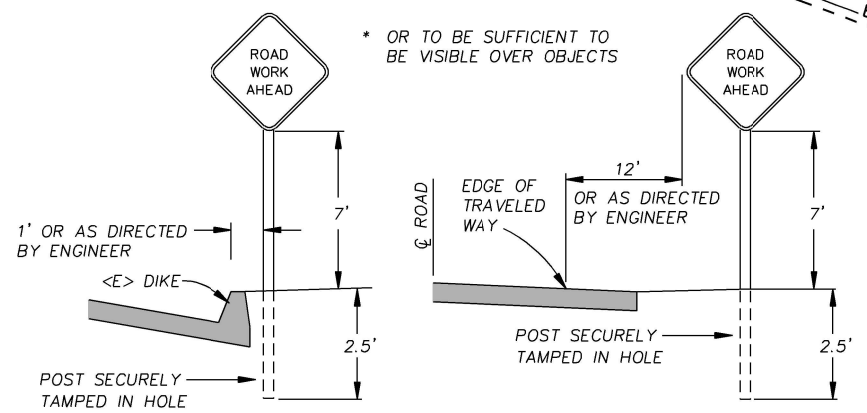
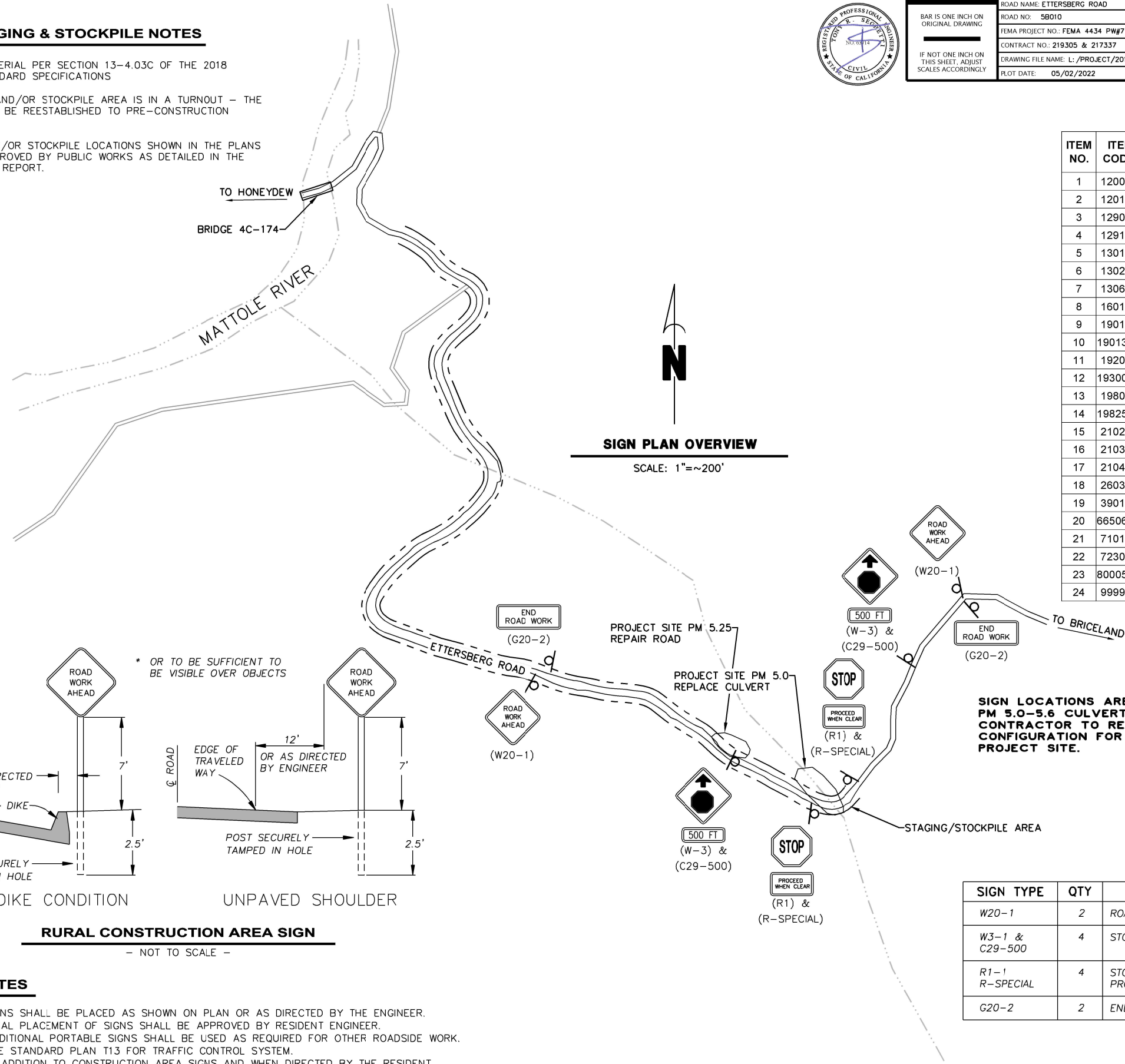

RURAL CONSTRUCTION AREA SIGN

- NOT TO SCALE -

NOTES

- 1) SIGNS SHALL BE PLACED AS SHOWN ON PLAN OR AS DIRECTED BY THE ENGINEER.
- 2) FINAL PLACEMENT OF SIGNS SHALL BE APPROVED BY RESIDENT ENGINEER.
- 3) ADDITIONAL PORTABLE SIGNS SHALL BE USED AS REQUIRED FOR OTHER ROADSIDE WORK.
- 4) SEE STANDARD PLAN T13 FOR TRAFFIC CONTROL SYSTEM.
- 5) IN ADDITION TO CONSTRUCTION AREA SIGNS AND WHEN DIRECTED BY THE RESIDENT ENGINEER, THE CONTRACTOR SHALL UTILIZE FLAGMEN AS NECESSARY TO DIRECT TRAFFIC.
- 6) KEEP A MINIMUM OF 1 TRAFFIC LANE AT LEAST 10' WIDE OPEN FOR TRAFFIC, EXCEPT THE FULL WIDTH OF THE TRAVELED WAY MUST BE OPEN WHEN CONSTRUCTION OPERATIONS ARE NOT ACTIVE OR AN APPROVED TRAFFIC CONTROL PLAN IS IN PLACE.

CONSTRUCTION AREA SIGN SUMMARY

SIGN TYPE	QTY	DESCRIPTION	SIZE	REMARKS	POST SIZE	NUMBER
W20-1	2	ROAD WORK AHEAD	30" x 30"	VISIBLE AT ALL TIMES	4" x 4"	1
W3-1 & C29-500	4	STOP AHEAD	30" x 30" 20" X 7"	VISIBLE AT ALL TIMES	4 x 4	1
R1-1 R-SPECIAL	4	STOP PROCEED WHEN CLEAR	30" x 30" 30" x 15"	VISIBLE AT ALL TIMES LINE OF SIGHT	4 x 4	1
G20-2	2	END ROAD WORK	36" x 18"	VISIBLE AT ALL TIMES	4 x 4	1



BAR IS ONE INCH ON ORIGINAL DRAWING
IF NOT ONE INCH ON THIS SHEET, ADJUST SCALES ACCORDINGLY

ROAD NAME: ETTERSBERG ROAD	DESIGN SECTION: ENGINEERING
ROAD NO.: 5B010	MILE POST: 5.0-5.6, 5.25
FEMA PROJECT NO.: FEMA 4434 PW#71; 4308 PW#1031	DESIGNED BY: JAB
CONTRACT NO.: 219305 & 217337	DRAWN BY: JAB
DRAWING FILE NAME: L:/PROJECT/2019 STORM DAMAGE/219305/Design/	REVIEWED BY: JAB
PLOT DATE: 05/02/2022	APPROVED BY: TRS

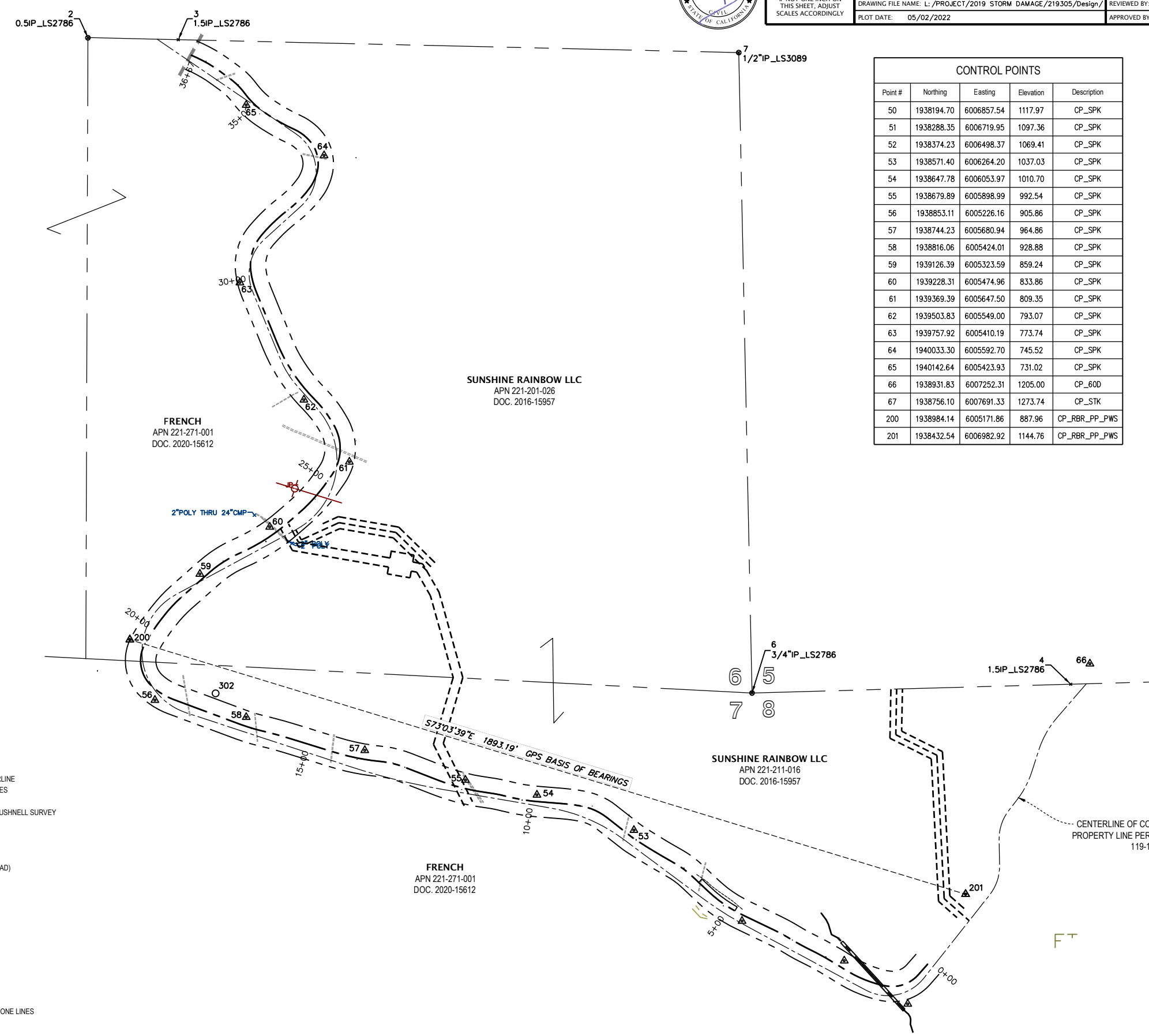

CONTROL POINTS				
Point #	Northing	Easting	Elevation	Description
50	1938194.70	6006857.54	1117.97	CP_SPK
51	1938288.35	6006719.95	1097.36	CP_SPK
52	1938374.23	6006498.37	1069.41	CP_SPK
53	1938571.40	6006264.20	1037.03	CP_SPK
54	1938647.78	6006053.97	1010.70	CP_SPK
55	1938679.89	6005898.99	992.54	CP_SPK
56	1938853.11	6005226.16	905.86	CP_SPK
57	1938744.23	6005680.94	964.86	CP_SPK
58	1938816.06	6005424.01	928.88	CP_SPK
59	1939126.39	6005323.59	859.24	CP_SPK
60	1939228.31	6005474.96	833.86	CP_SPK
61	1939369.39	6005647.50	809.35	CP_SPK
62	1939503.83	6005549.00	793.07	CP_SPK
63	1939757.92	6005410.19	773.74	CP_SPK
64	1940033.30	6005592.70	745.52	CP_SPK
65	1940142.64	6005423.93	731.02	CP_SPK
66	1938931.83	6007252.31	1205.00	CP_60D
67	1938756.10	6007691.33	1273.74	CP_STK
200	1938984.14	6005171.86	887.96	CP_RBR_PP_PWS
201	1938432.54	6006982.92	1144.76	CP_RBR_PP_PWS

- SURVEY NOTES:**
- The purpose of this survey is to determine topography for storm damage between PM 5.00 to 5.60 of Ettersburg Road. This survey includes a repaired storm damage site at PM 5.25. This survey reflects conditions at the time of survey; field work was performed from November 2020 to February 2021.
 - Underground utilities research was not performed. The only evidence of underground utilities found onsite are the various storm drain culverts shown hereon. No underground telephone or communication paddles or markers were found in the project area. Power, telephone and communications are on overhead pole lines in the project area.
 - Coordinates for this survey are California Coordinate System of 1983 (CCS83) Zone 1. NAD83 (2011), Epoch 2010.0 based on a static GPS Control Survey using the NGS OPUS Post-Processing software. The control point shown hereon as Point 201 was held for horizontal position; Point 200 was used for the grid bearing. The mapping angle is 1°18' 06"; rotate bearings hereon counterclockwise by this angle to obtain "True" or Geodetic bearings. Grid distances shown should be divided by the Combined Scale Factor of 0.99993096 to obtain ground distances. Mapping angle and grid scale factor are taken at Point 201, a 5/8" rebar with plastic cap stamped "PWS CONTROL" at the easterly end of the project site. Elevations are NAVD88 datum based the found NGS vertical benchmark with designation "H 1464", PID "LU2324", located within the project site and shown hereon as Point 302, holding the published elevation of 918.13 feet.
 - Only trees greater than 12 inches in diameter were located; numerous other smaller trees exist and are not shown. Trees are generally measured at breast height. Tree locations should be considered approximate as not all trees are growing vertically.
 - No successful boundary survey was performed as part of this project. Monuments at the easterly and westerly ends of the project shown on Book 7 of Parcel Maps, Pages 119-120, Humboldt County Records (HCR) on the road right of way were searched for and not found. No record was found for the found Bushnell rebar and cap shown on Point 305 hereon. Subdivisional section lines shown hereon are approximate, as is the relationship of the centerline per 7 PM 119-120 with the existing roadway. 7 PM 119-120 dedicates easements for public roadway 25 feet on each side of centerline as Parcels 'A' & 'B' on the map, as well as "a maintenance easement to extend 10 feet beyond catch points of all cuts and fills." The right of way shown hereon is 66 feet wide, 33 feet on each side of centerline based on Road Register Page 104 No. 98.
 - Ownerships shown hereon are taken from the Humboldt County GIS; document information is per the Humboldt County Assessors website. The centerline of the road per 7 PM 119-120 is the dividing line between the French & Sunshine Rainbow LLC parcels shown hereon.

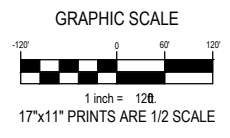

- LEGEND**
- SURVEY CONTROL POINT
 - SURVEYED RIGHT OF WAY CENTERLINE
 - RIGHT OF WAY EASEMENT SIDELINES
 - RIGHT OF WAY CENTERLINE PER BUSHNELL SURVEY RECORDED AT 7 PM 119-120
 - EDGES OF PAVEMENT
 - EDGE OF TRAVELED WAY (DIRT ROAD)
 - EXISTING GROUND CONTOURS (TWO FOOT INTERVALS)
 - TOP OF SLOPE
 - TOE OF SLOPE / GRADE BREAK
 - DRAINAGE FLOW LINE
 - FENCE LINE
 - STORM DRAIN CULVERT
 - OVERHEAD ELECTRIC AND TELEPHONE LINES
 - JOINT UTILITY POLE

TOPOGRAPHIC SURVEY
for
Ettersburg Road
PM 5.00-5.60 & 5.25
Humboldt County Project Nos.
217337 & 219305
Task Order No. DPW2017-005-T55
PORTIONS OF SECTIONS 6, 7, 8, T4S, R2E,
HUMBOLDT MERIDIAN
IN THE UNINCORPORATED AREA OF
HUMBOLDT COUNTY, STATE OF CALIFORNIA
Date: April 2021

SCALE: 1" = 120' SHEET 1 OF 7



BAR IS ONE INCH ON ORIGINAL DRAWING IF NOT ONE INCH ON THIS SHEET, ADJUST SCALES ACCORDINGLY	ROAD NAME: ETTERSBERG ROAD	DESIGN SECTION: ENGINEERING	COUNTY OF HUMBOLDT DEPARTMENT OF PUBLIC WORKS STORM DAMAGE ON ETTERSBERG ROAD PM 5.0-5.6, 5.25 TYPICAL SECTIONS
	ROAD NO.: 5B010	MILE POST: 5.0-5.6, 5.25	
	FEMA PROJECT NO.: FEMA 4434 PW#71: 4308 PW#1031	DESIGNED BY: JAB	
	CONTRACT NO.: 219305 & 217337	DRAWN BY: JAB	
	DRAWING FILE NAME: L:/PROJECT/2019 STORM DAMAGE/219305/Design/	REVIEWED BY: JAB	
	PLOT DATE: 05/02/2022	APPROVED BY:	

SHEET
4
OF
10

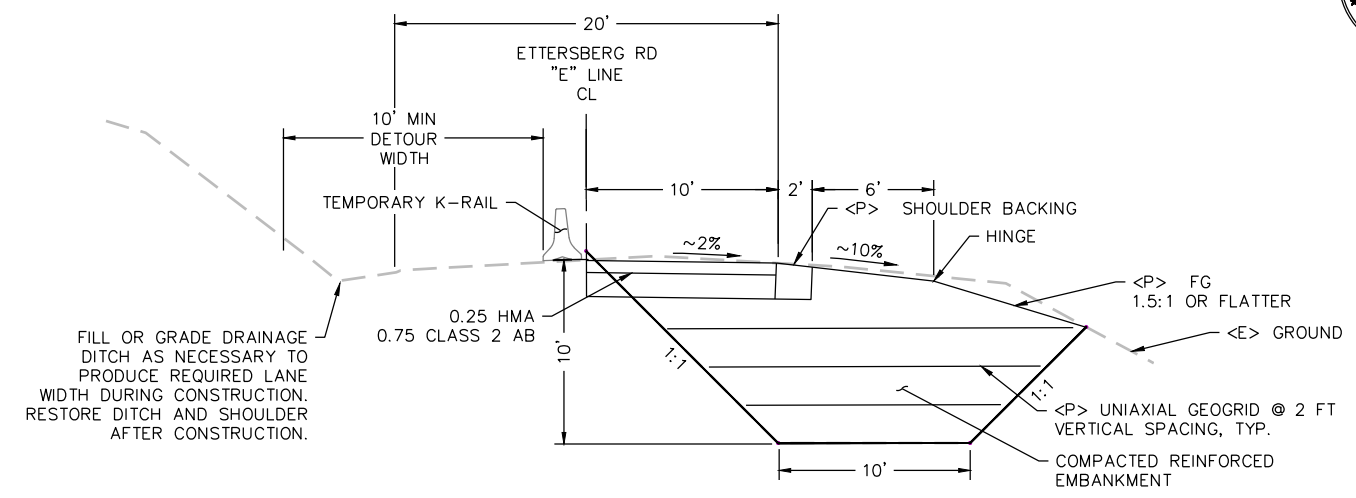

TYPICAL SECTION AT PM 5.25
SCALE: 1"=5'

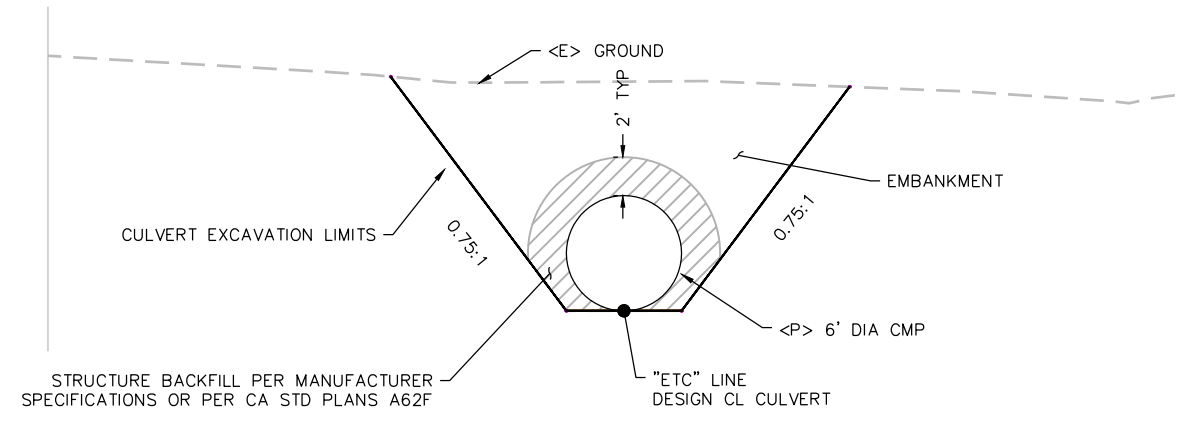

TYPICAL CULVERT SECTION
SCALE: 1"=5'

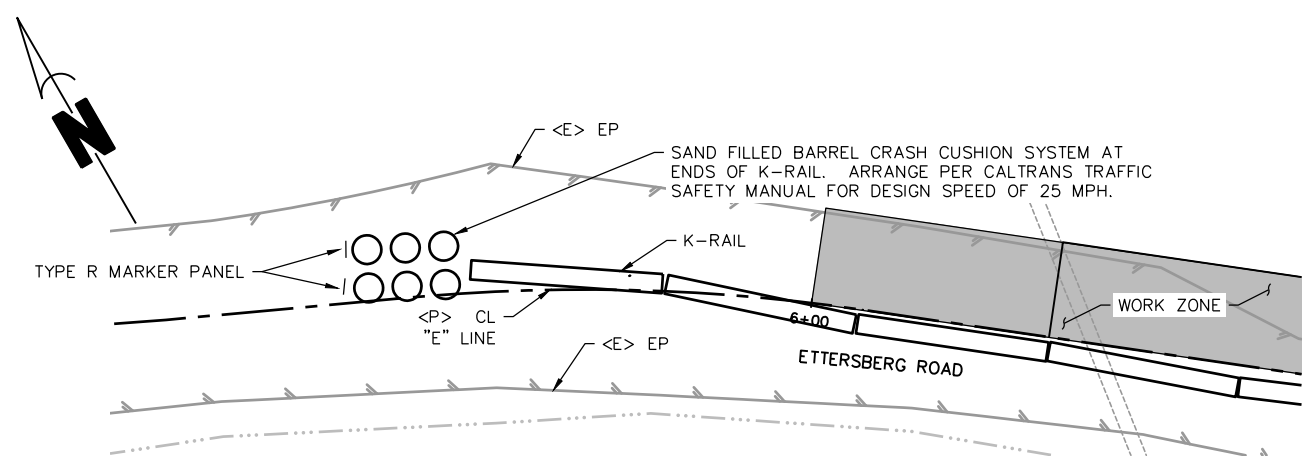

SAND BARREL CRASH CUSHION AND K-RAIL DETAIL
SCALE: 1"=10'

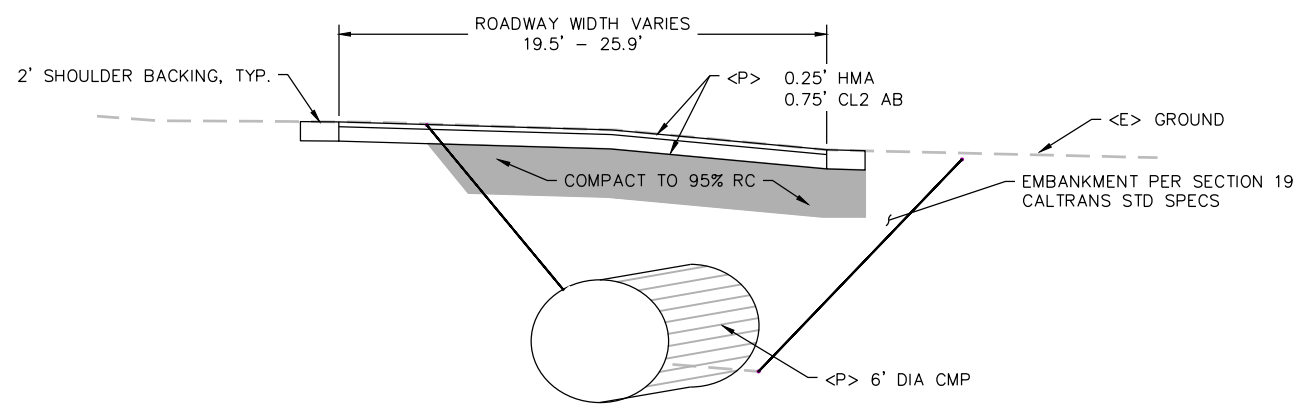

TYPICAL ROADWAY SECTION AT CULVERT
SCALE: 1"=5'

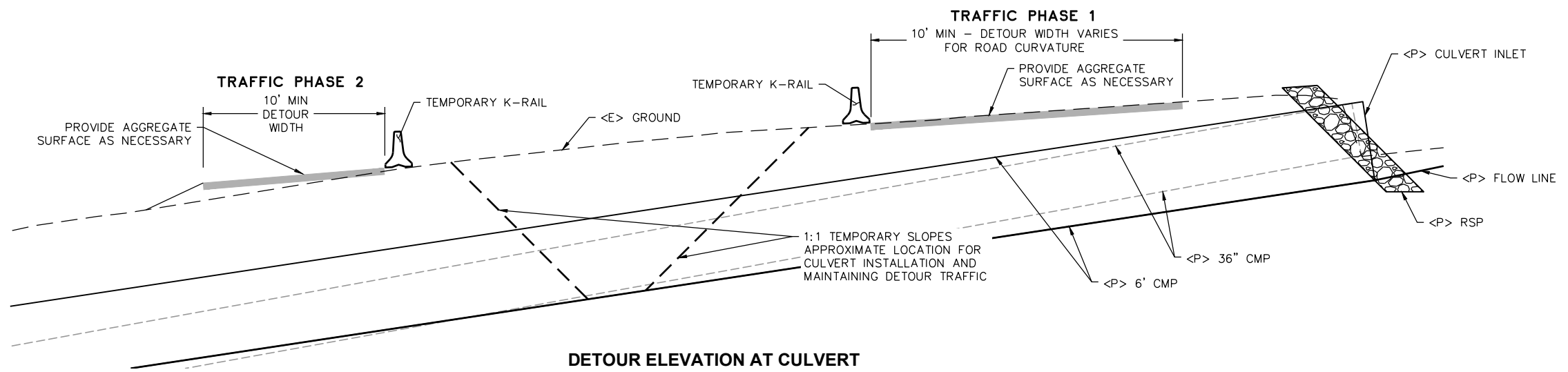

DETOUR ELEVATION AT CULVERT
SCALE: 1"=5'



ROAD NAME: ETTERSBERG ROAD	DESIGN SECTION: ENGINEERING
ROAD NO.: 5B010	MILE POST: 5.0-5.6, 5.25
FEMA PROJECT NO.: FEMA 4434 PW#71: 4308 PW#1031	DESIGNED BY: JAB
CONTRACT NO.: 219305 & 217337	DRAWN BY: JAB
DRAWING FILE NAME: L:/PROJECT/2019 STORM DAMAGE/219305/Design/	REVIEWED BY: JAB
PLOT DATE: 05/02/2022	APPROVED BY:

COUNTY OF HUMBOLDT DEPARTMENT OF PUBLIC WORKS
STORM DAMAGE ON ETTERSBERG ROAD PM 5.0-5.6, 5.25
TRAFFIC PHASING - PM 5.0 CULVERT SITE

SHEET
5
OF
10

TRAFFIC PHASING NOTES

- 1) CONTRACTOR MAY PROPOSE ALTERNATE METHODS OF TRAFFIC PHASING THAT ARE SUBJECT TO COUNTY APPROVAL PRIOR TO IMPLEMENTATION
- 2) CONTRACTOR SHALL PROVIDE AND MAINTAIN A MINIMUM OF ONE OPEN TRAFFIC LANE THROUGH THE WORK AREA AT ALL TIMES. TRAFFIC LANE SHALL BE AT LEAST 10 FEET WIDE.
- 3) TEMPORARY ROAD CLOSURE MAY BE PERMITTED UPON APPROVAL OF THE CONSTRUCTION ENGINEER. CLOSURES LONGER THAN 30 MINUTES REQUIRE APPROVAL AND PUBLIC NOTICE OF 14 DAYS MINIMUM.

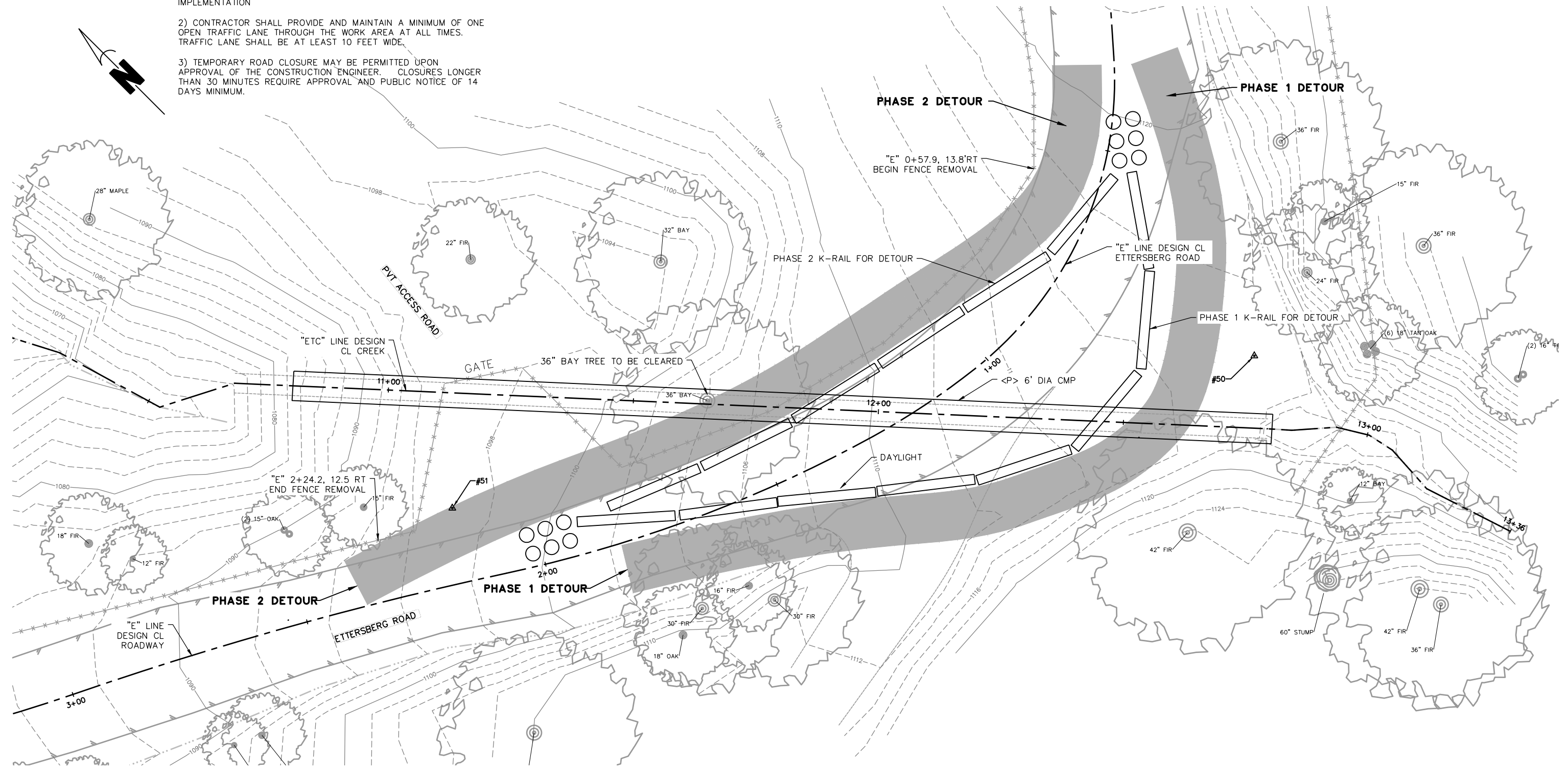
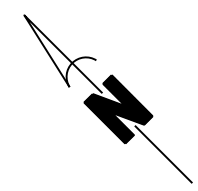

DETOUR PLAN VIEW

SCALE: 1"=10'



ROAD NAME: ETTERSBERG ROAD	DESIGN SECTION: ENGINEERING
ROAD NO.: 5B010	MILE POST: 5.0-5.6, 5.25
FEMA PROJECT NO.: FEMA 4434 PW#71: 4308 PW#1031	DESIGNED BY: JAB
CONTRACT NO.: 219305 & 217337	DRAWN BY: JAB
DRAWING FILE NAME: L:/PROJECT/2019 STORM DAMAGE/219305/Design/	REVIEWED BY: JAB
PLOT DATE: 05/02/2022	APPROVED BY:

COUNTY OF HUMBOLDT DEPARTMENT OF PUBLIC WORKS
STORM DAMAGE ON ETTERSBERG ROAD PM 5.0-5.6, 5.25
PM 5.0 CULVERT PLAN AND PROFILE

SHEET
6
OF
10

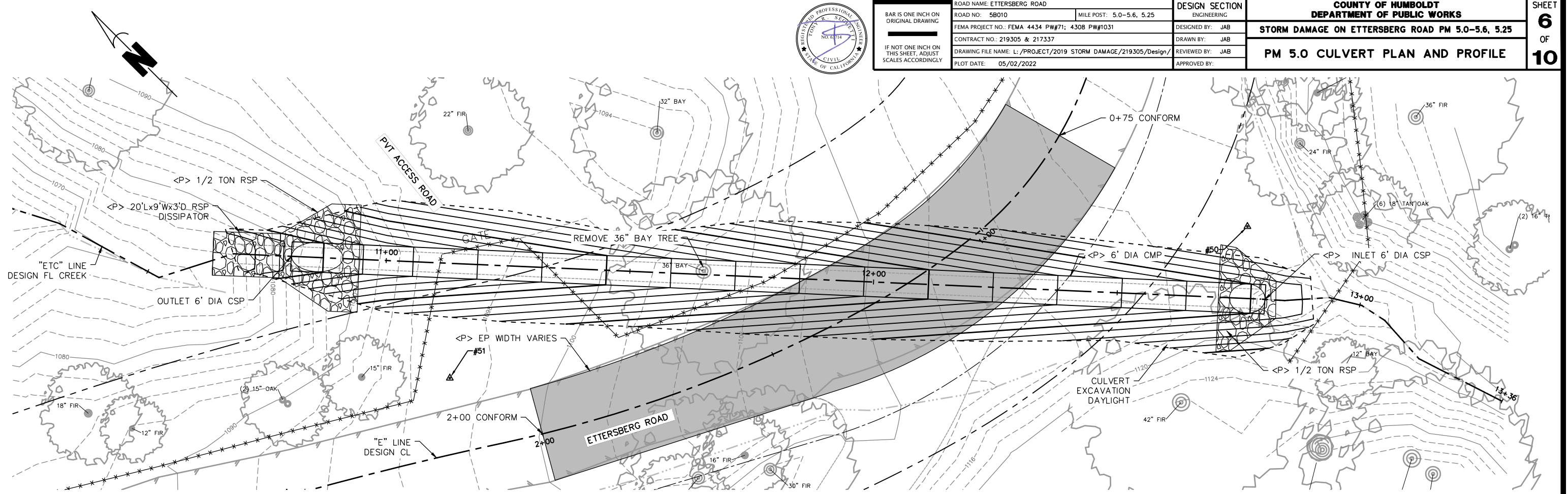

PLAN VIEW

SCALE: 1"=10'

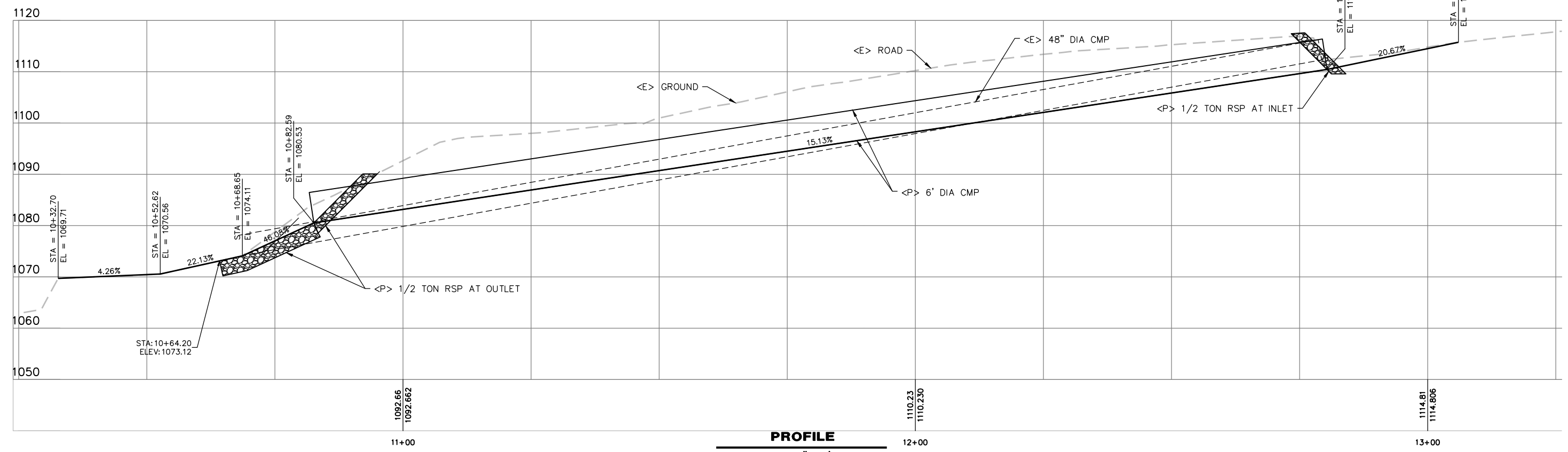

PROFILE

SCALE: 1"=10' H,V



ROAD NAME: ETTERSBERG ROAD	MILE POST: 5.0-5.6, 5.25	DESIGN SECTION
ROAD NO.: 5B010		ENGINEERING
FEMA PROJECT NO.: FEMA 4434 PW#71: 4308 PW#1031		DESIGNED BY: JAB
CONTRACT NO.: 219305 & 217337		DRAWN BY: JAB
DRAWING FILE NAME: L:/PROJECT/2019 STORM DAMAGE/219305/Design/		REVIEWED BY: JAB
PLOT DATE: 05/02/2022		APPROVED BY:

COUNTY OF HUMBOLDT DEPARTMENT OF PUBLIC WORKS STORM DAMAGE ON ETTERSBERG ROAD PM 5.0-5.6, 5.25
PM 5.25 PLAN AND PROFILE

SHEET
7
OF
10

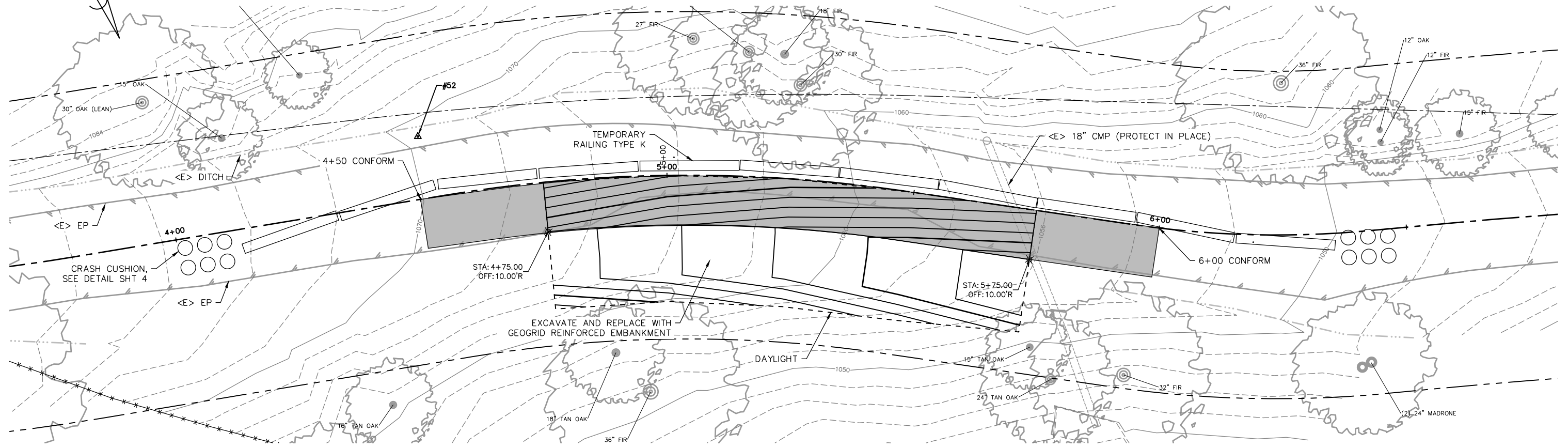

PLAN VIEW
SCALE: 1"=10'

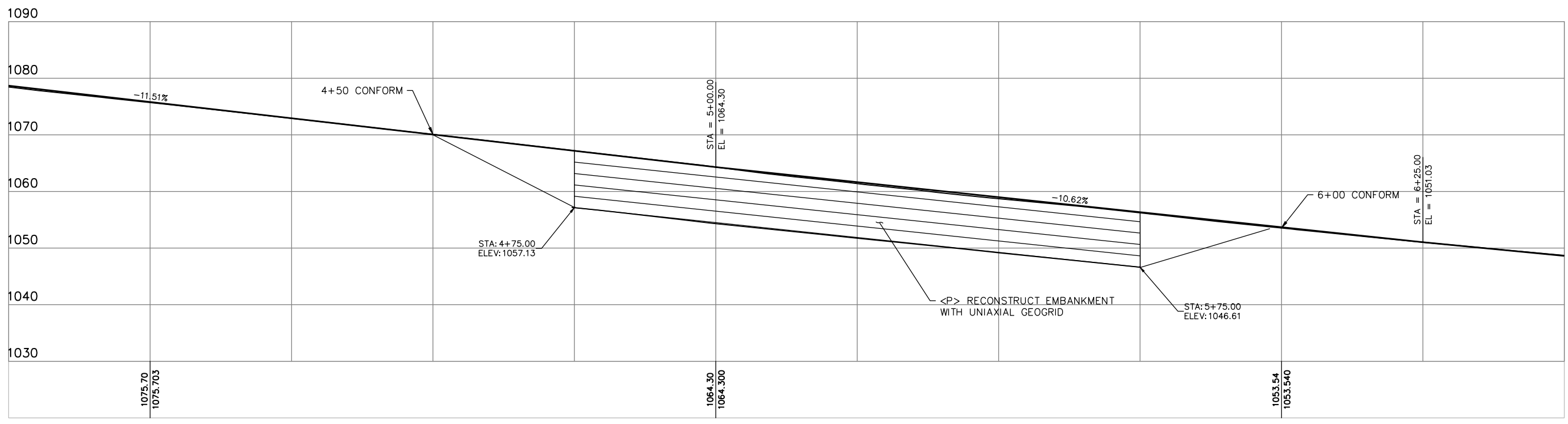

PROFILE
SCALE: 1"=10' H,V



ROAD NAME: ETTERSBERG ROAD	DESIGN SECTION: ENGINEERING
ROAD NO.: 5B010	MILE POST: 5.0-5.6, 5.25
FEMA PROJECT NO.: FEMA 4434 PW#71; 4308 PW#1031	DESIGNED BY: JAB
CONTRACT NO.: 219305 & 217337	DRAWN BY: JAB
DRAWING FILE NAME: L:/PROJECT/2019 STORM DAMAGE/219305/Design/	REVIEWED BY: JAB
PLOT DATE: 05/02/2022	APPROVED BY:

COUNTY OF HUMBOLDT DEPARTMENT OF PUBLIC WORKS
STORM DAMAGE ON ETTERSBERG ROAD PM 5.0-5.6, 5.25
EROSION CONTROL PLAN

SHEET
8
OF
10

LEGEND

	ROCK SLOPE PROTECTION
	STRAW & DRY SEED
	FIBER ROLL
	CHECK DAM
	SILT FENCE

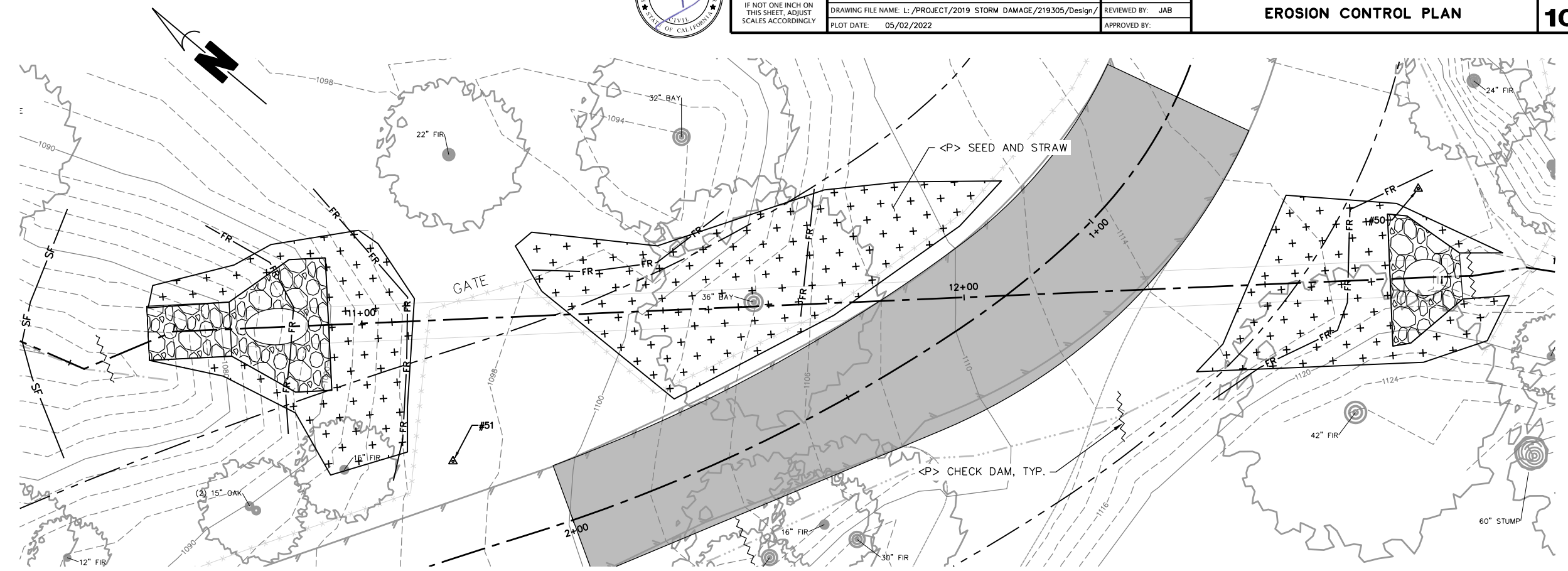

PLAN VIEW- PM 5.0 CULVERT
SCALE: 1"=10'

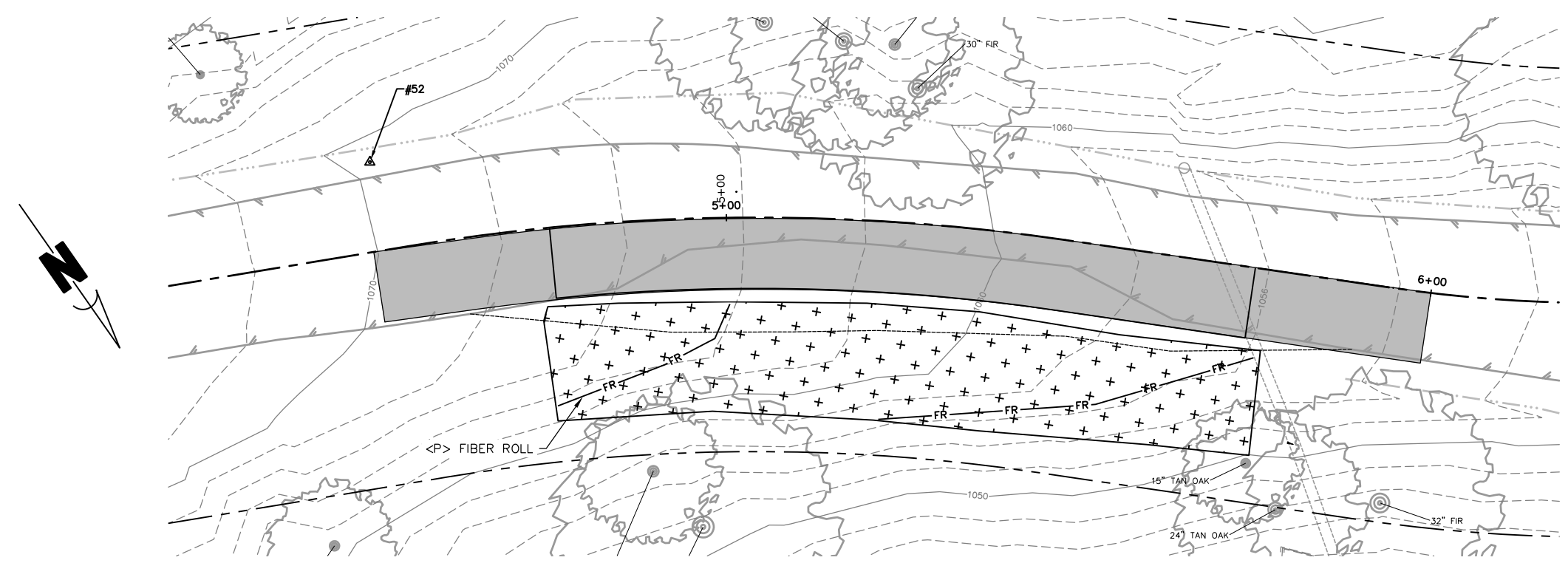

PLAN VIEW- PM 5.25
SCALE: 1"=10'



BAR IS ONE INCH ON ORIGINAL DRAWING IF NOT ONE INCH ON THIS SHEET, ADJUST SCALES ACCORDINGLY	ROAD NAME: ETTERSBERG ROAD	DESIGN SECTION	COUNTY OF HUMBOLDT DEPARTMENT OF PUBLIC WORKS STORM DAMAGE ON ETTERSBERG ROAD PM 5.0-5.6, 5.25 CULVERT CROSS SECTIONS	SHEET 9 OF 10	
	ROAD NO.: 5B010	MILE POST: 5.0-5.6, 5.25			ENGINEERING
	FEMA PROJECT NO.: FEMA 4434 PW#71: 4308 PW#1031				DESIGNED BY: JAB
	CONTRACT NO.: 219305 & 217337				DRAWN BY: JAB
	DRAWING FILE NAME: L:/PROJECT/2019 STORM DAMAGE/219305/Design/		REVIEWED BY: JAB		
	PLOT DATE: 05/02/2022		APPROVED BY:		

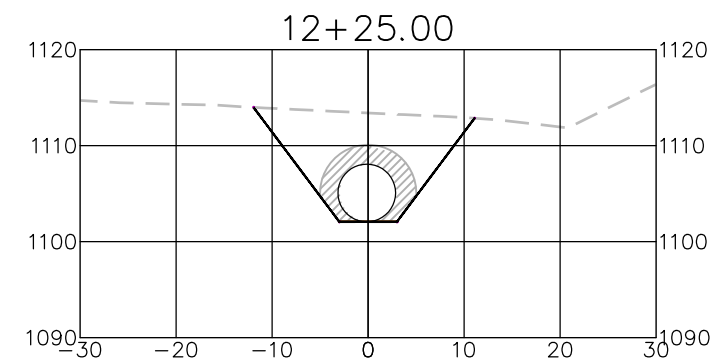
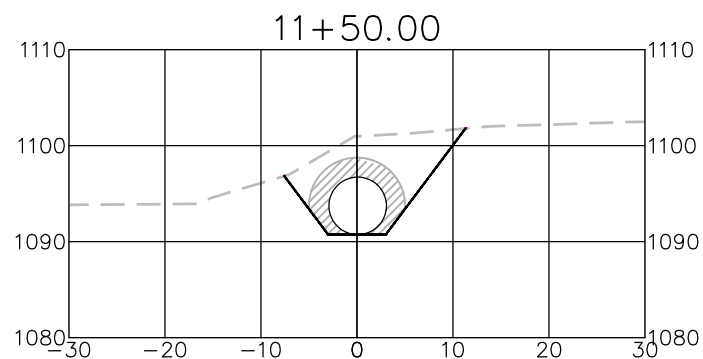
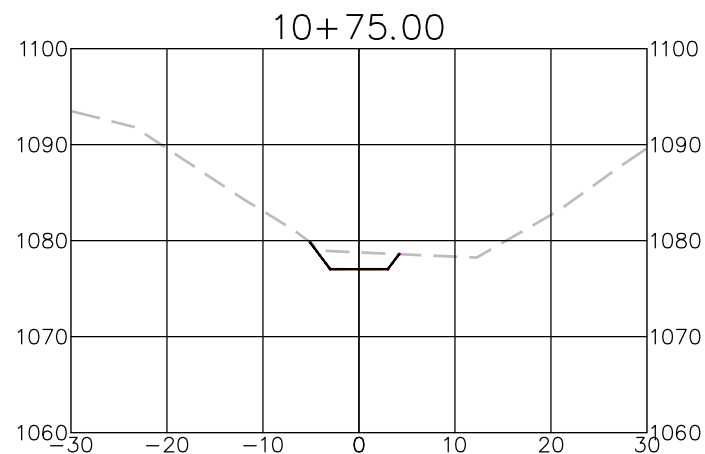
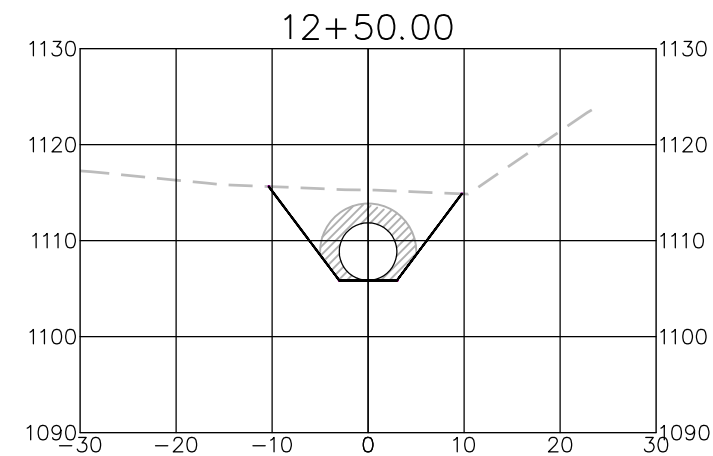
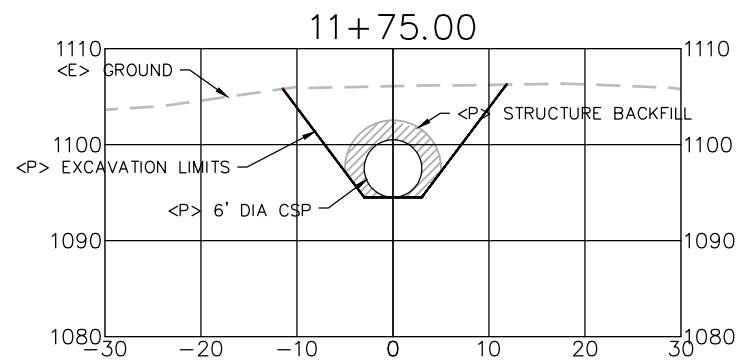
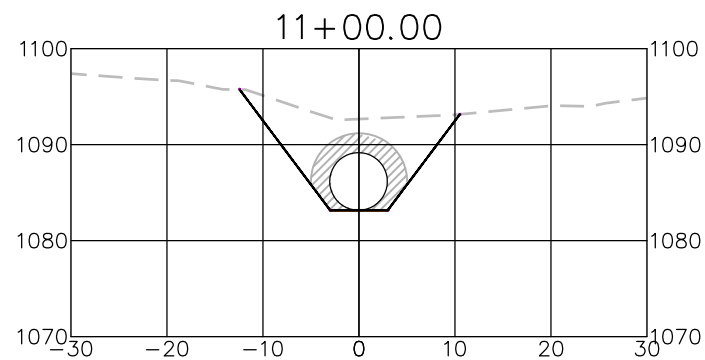
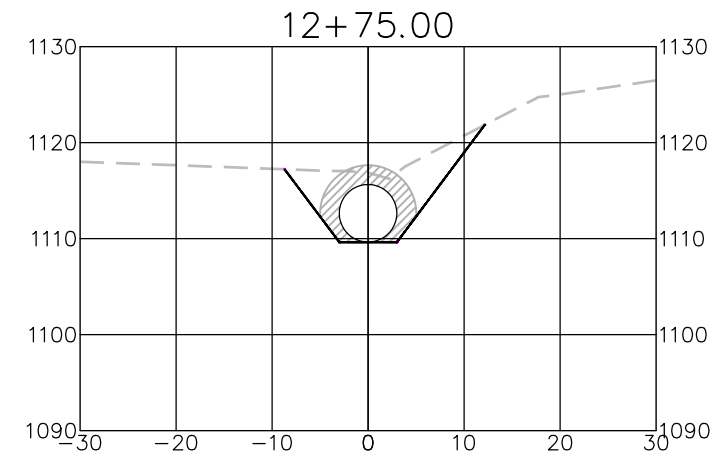
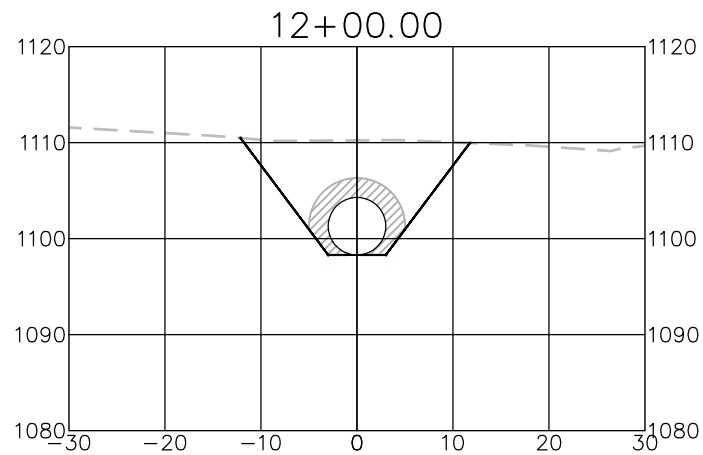
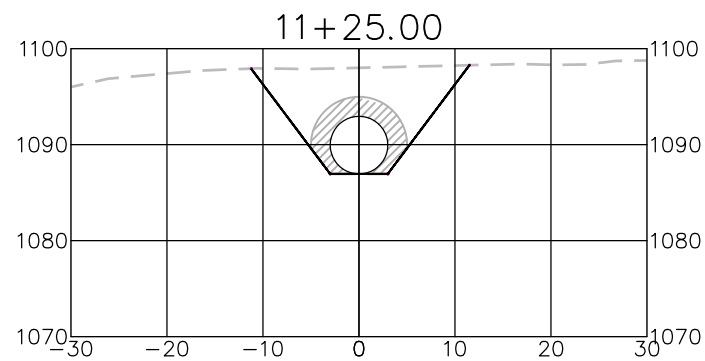

PLAN VIEW- PM 5.25

SCALE: 1"=10' (H,V)



BAR IS ONE INCH ON ORIGINAL DRAWING

IF NOT ONE INCH ON THIS SHEET, ADJUST SCALES ACCORDINGLY

ROAD NAME: ETTERSBERG ROAD		DESIGN SECTION
ROAD NO: 5B010	MILE POST: 5.0-5.6, 5.25	ENGINEERING
FEMA PROJECT NO.: FEMA 4434 PW#71: 4308 PW#1031		DESIGNED BY: JAB
CONTRACT NO.: 219305 & 217337		DRAWN BY: JAB
DRAWING FILE NAME: L:/PROJECT/2019 STORM DAMAGE/219305/Design/		REVIEWED BY: JAB
PLOT DATE: 05/02/2022		APPROVED BY:

COUNTY OF HUMBOLDT DEPARTMENT OF PUBLIC WORKS
STORM DAMAGE ON ETTERSBERG ROAD PM 5.0-5.6, 5.25
PM 5.25 ROAD CROSS SECTIONS

SHEET
10
OF
10

