

10930

RECEIVED
JUN 21 2021
Humboldt County
Cannabis Svcs.

Plot Plan (Pg 2/2)

APP 10930 Cultivation: 18,492' Outdoor DEP



Owner: Contadino Properties LLC
APN: 216-392-006 Zoning: FR-B-5(10)
3355 Rancho Sequoia Drive in Alderpoint
Applicant: MHG, LLC Contact: Maureen Hope
PO Box 3395 - La Jolla CA, 92038
(858)230-1404 gstarconsulting@protonmail.com

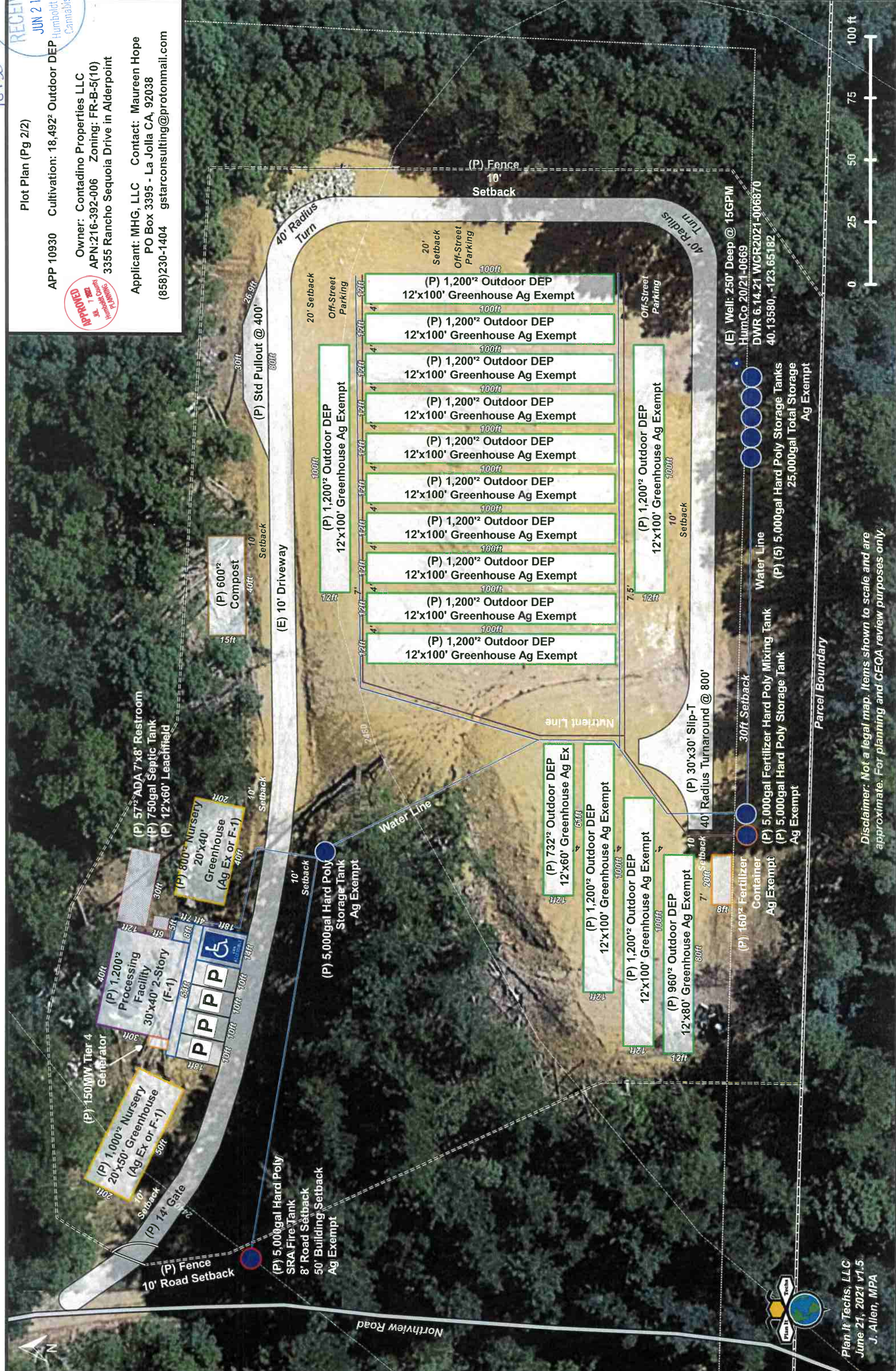

(E) Well: 250' Deep @ 15GPM
HumCo 20/21-0669
DWR 6.14.21 WCR2021-096870
40.13580, -123.65182

(P) 5,000gal Hard Poly Storage Tanks
(P) 5,000gal Hard Poly Storage Tanks
25,000gal Total Storage
Ag Exempt

(P) 5,000gal Fertilizer Hard Poly Mixing Tank
(P) 5,000gal Hard Poly Storage Tank
Ag Exempt

(P) 160' Fertilizer Container
Ag Exempt

(P) 30'x30' Slip-T
40' Radius Turnaround @ 800'

Parcel Boundary

Plan It Techs, LLC
June 21, 2021 v1.5
J. Allen, MPA

Disclaimer: Not a legal map. Items shown to scale and are approximate. For planning and CEQA review purposes only.



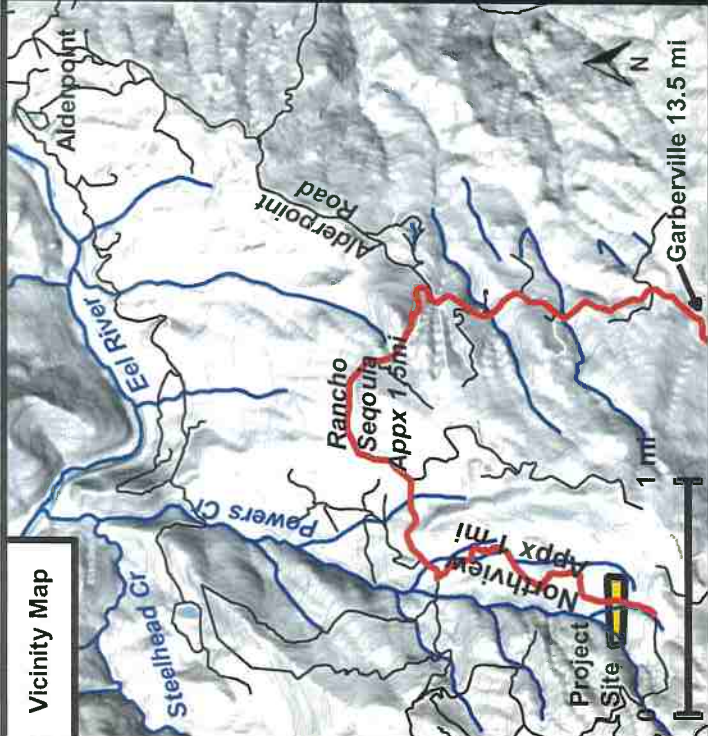

PERMITS: CalFire 1-16EX-081 HUM, DWR H504515, DFW 1600-2018-0352-R1, NCRWQB 1B170623CHUM, & SWB 1_12CC427907

SPECIES OF CONCERN: Marbled Murrelet Northern Spotted Owl (*Strix occidentalis caurina*), Marbled Murrelet (*Brachyramphus marmoratus*), Humboldt Marten (*Martes caurina humboldtensis*), Mountain Beaver (*Aplodontia rufa nigra*), Fisher (*Pekania pennanti*)

NOTE THIS PROJECT:

1. SWB 401 WQC and USACE 404 CWA on 01/05/2021 by Timberland Resource Consultants.
2. Proposes a well contracted with Fisch Well Drilling to replace diversion.
3. Qualified Engineer shall undertake perk test, construction plans, and all required permits.
4. Remediation Plan shall be submitted by Timberland Resource Consultants.
5. Ephemeral Class III Streams within 400' of the cultivation area.
6. No known archaeological or paleontological resources within 600' of the cultivation.
7. No schools, school bus stops, public lands, or places of worship within 600' of the cultivation.
8. No residences within 300' of the cultivation.
9. No known areas subject to flooding, steep or unstable slopes, expansive clays, faults, or hazardous waste.

Plot Plan (Pg 1/2)
 APP 10930 Cultivation: 18,492² Outdoor DEP
 Owner: Contadino Properties LLC
 APN: 216-392-006 Zoning: FR-B-5(10)
 3355 Rancho Sequoia Drive in Alderpoint
 Applicant: MHG, LLC Contact: Maureen Hope
 PO Box 3395 - La Jolla CA, 92038
 (858)230-1404 gstarconsulting@protonmail.com

