



THE CLARKIES JOINT IS APPLYING FOR A CANNABIS RETAIL LICENSE IN ACCORDANCE WITH THE CALIFORNIA BUREAU OF CANNABIS CONTROL (BCC). THE OPERATION IS LOCATED AT 3525 REDWOOD DR, REDWAY CA. THE RETAIL PREMISES IS LOCATED ON THE FIRST FLOOR AND IS APPROXIMATELY 715 SQUARE FEET. THE PROPERTY ALSO INCLUDES A PREMISES FOR ONE (1) PROPOSED CANNABIS DISTRIBUTOR LICENSE ON THE FIRST AND SECOND FLOOR AND ONE (1) PREMISES FOR AN EXISTING RESIDENCE ON THE SECOND FLOOR.

APPLICANT:
CLARKIES JOINT
RACHEL AND CLARK WORSWICK
7260 BENBOW DRIVE
GARBERVILLE, CA 95542

PROPERTY OWNER:
WEST RIVER LANE, LLC
P.O. BOX 1020
GARBERVILLE, CA 95542

SITE ADDRESS:
APN: 077-331-032-000
3525 REDWOOD DR
REDWAY, CA 95560

PROPERTY SIZE = ±0.31 ACRES

GENERAL PLAN DESIGNATION = COMMERCIAL SERVICES

1. DRAWING SCALE AS NOTED. WRITTEN DIMENSIONS SHALL TAKE PRECEDENCE OVER SCALED DIMENSIONS.
2. THIS IS NOT A BOUNDARY SURVEY. BOUNDARY INFORMATION DEPICTED HAS BEEN OBTAINED FROM HUMBOLDT COUNTY 2015 GIS DATA. NORTHPOINT CONSULTING GROUP, INC. HAS NOT VERIFIED THIS PROPERTY BOUNDARY.
3. ALL AREAS OUTSIDE OF THE CANNABIS ACTIVITIES ARE USED IN ACCORDANCE TO THE HUMBOLDT COUNTY LAND USE DESIGNATION.

22x34 SHEET: 1"=10'
11x17 SHEET: 1"=20'



C0 - PREMISES DIAGRAM, VICINITY MAP,
& PROJECT NOTES
C1 - DETAILED FLOOR PLANS

APN: 077-331-032-000

SEE SHEET C1 FOR FLOOR PLANS
AND DETAILS OF PROPOSED
PREMISES

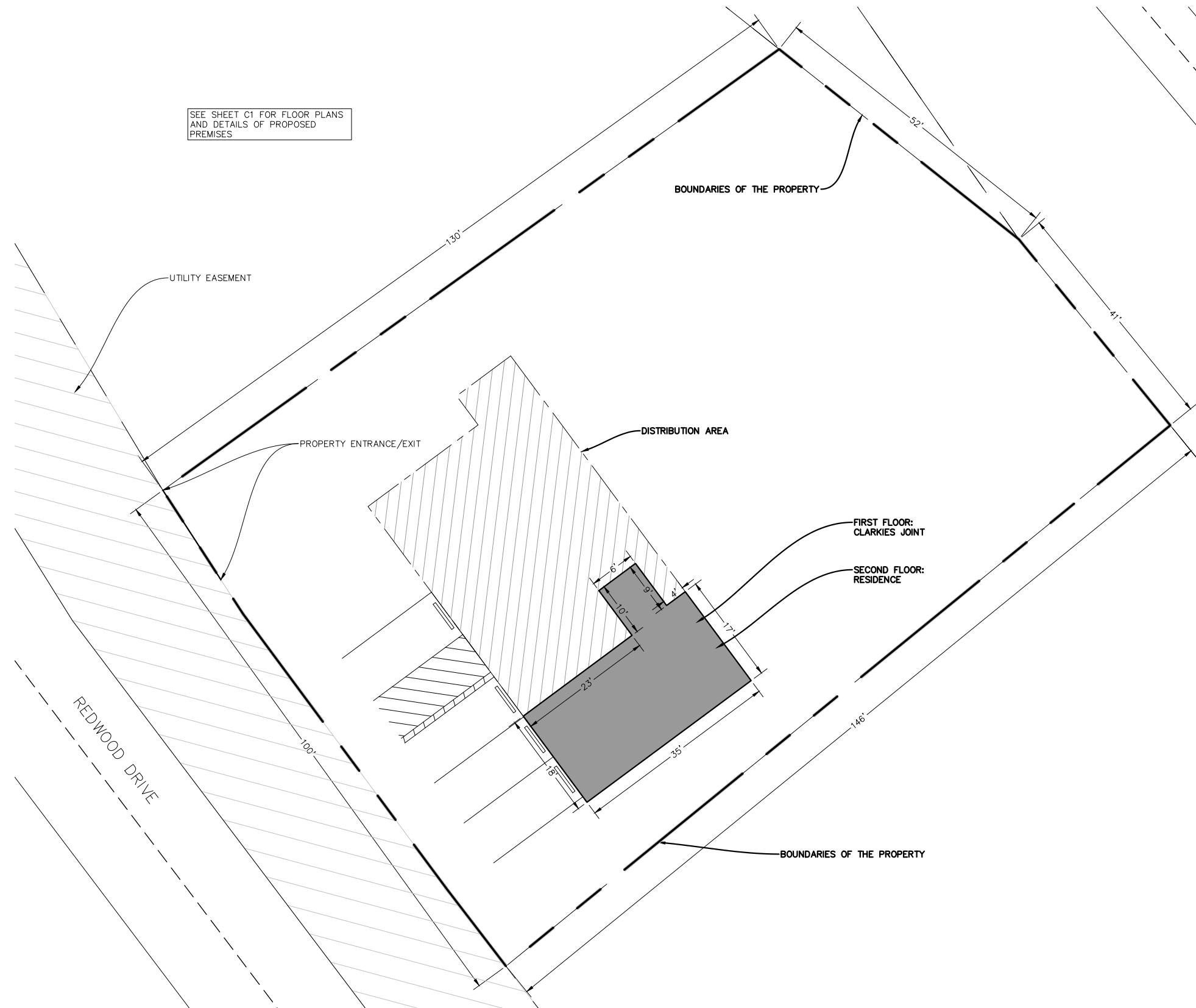
[illegible]

NORTHPOINT
CONSULTING GROUP, INC.
1117 Samoa Blvd., Arcata, CA 95521

CLARKIES JOINT
REDWAY, CA
PROPERTY DIAGRAM

PROJ. MGR.: PBS
DRAWN BY: PRH
DATE: 06/07/202
SCALE: AS SHOWN

SHEET
C0
18-119

APN: 077-331-032-000



22x34 SHEET: 1"=5'
11x17 SHEET: 1"=10'



A horizontal graphic scale bar with a black and white alternating pattern. It is marked with '0' at the left end, '5' at the midpoint, and '10' at the right end.



22x34 SHEET: 1"=5'
11x17 SHEET: 1"=10'



A horizontal scale bar with a black outline. It is divided into two main sections: the left section is white with a black outline, and the right section is solid black. The white section is labeled '5' at its right end, and the black section is labeled '10' at its right end. The bar represents a total length of 10 feet.

[illegible]

NORTHPOINT
CONSULTING GROUP, INC.
1117 Samoa Blvd., Arcata, CA 95521

THE COUNTRY CLUB, LLC
REDWAY, CA
DETAILED FLOOR PLAN

PROJ. MGR.: PBS
DRAWN BY: PRH
DATE: 06/07/2024
SCALE: AS SHOWN

SHEET
C1
18-119