



DEPARTMENT OF FORESTRY AND FIRE PROTECTION

135 Ridgway Ave.
Santa Rosa, CA 95401
Website: www.fire.ca.gov
(707) 576-2959



Date: April 21, 2016
Ref.: 1-16EX-110-HUM

DONALD SCHOENHOFER
3440 NEWBURG RD
FORTUNA, CA 95540

Dear Mr. Schoenhofer

This is to acknowledge that your **Less Than 3 Acre Conversion Exemption** was accepted on **April 20, 2016**. It has been assigned the above listed Exemption number. All timber operations must be complete within one year. All conversion activities must be complete within two years, unless under permit by local jurisdiction.

*****Please read the enclosed notice regarding Listed Anadromous Salmonids, Slash Clean-up, Sudden Oak Death, Pitch Canker, and Operations between October 15 – May 1.*****

In addition, please note the requirement for submittal of the Timber Operations Work Completion and/or Stocking Report (blue form) upon completion of the project.

Compliance with all provisions of the Forest Practice Act, rules pursuant to Section 1104.1(a)--Title 14 of the California Code of Regulations, will be determined by future inspection(s).

If you have any questions you may contact your local CAL FIRE Forest Practice Inspector or me at (707) 576-2959.

Sincerely,

Topher Henderson
Forestry Assistant II

Enclosure

cc: Unit
Board of Equalization
RPF – Brian Griesbach
LTO – Zerlang Construction
File
<ftp://thp.fire.ca.gov/THPLibrary/North Coast Region/>

LESS THAN 3 ACRE CONVERSION EXEMPTION

STATE OF CALIFORNIA
 DEPARTMENT OF FORESTRY AND FIRE PROTECTION
 NOTICE OF TIMBER OPERATIONS THAT ARE EXEMPT FROM
 CONVERSION AND TIMBER HARVESTING PLAN REQUIREMENTS
 RM-73 (1104.1a) (11/12)

FOR ADMIN. USE ONLY

Ex. # 1-16EX-110 HLM
 Date of Receipt APR 20 2016 *JZA*
 Date Accepted 4/20/16
 Date Expires _____

VALID FOR ONE YEAR FROM DATE OF RECEIPT BY CAL FIRE
 TIMBER OPERATIONS CANNOT START UNTIL VALID COPY
 OF A NOTICE OF ACCEPTANCE IS RECEIVED FROM CAL FIRE

The Director of the Department of Forestry and Fire Protection (CAL FIRE) is hereby notified of timber operations under the requirements of 14 CCR § 1104.1(a); Harvesting of trees that is a single conversion to a non-timber growing use of timberland of less than three acres. (See 14 CCR § 1104.1(a) for a description of the conditions on the conduct of this type of timber operation and additional information that is **required** to be submitted.) Complete Items 1 through 8 on both pages of this notice.

1. TIMBER OWNER(S) OF RECORD: Don Schoenhofer

Address: 3440 Newburg Road

City: Fortuna State: CA Zip: 95540 Phone: 707-498-8701

TIMBER TAX EXEMPTION: Timber owners owe timber yield tax when they harvest trees unless the harvest is exempt (Revenue and Taxation Code sec. 38116). Some small or low value harvests may be exempt from timber yield tax: Timber removed from an operation whose value does not exceed \$3,000 within a quarter, according to BOE Harvest Value Schedules, Rule 1024. If you believe your harvest may qualify for this exemption, please complete Items A and B below. For timber yield tax information or for further assistance with these questions call the State Board of Equalization, 1-800-400-7115, or write: Timber Tax Section, MIC: 60, State Board of Equalization, P.O. Box 942879, Sacramento, California 94279-0060; or contact the BOE Web Page on the Internet at <http://www.boe.ca.gov>.

A. Circle the option that most closely estimates the total volume for this harvest, in thousands of board feet (mbf - Net Scribner short log):

Under 8 mbf 8-15 mbf 16-25 mbf Over 25 mbf

B. Estimate the species composition of the timber that will be removed during this harvest (numbers should sum to 100%):

Redwood 60%; Ponderosa/Sugar pine; _____% Douglas-fir 20%; Fir _____%;

Port-Orford Cedar _____%; Cedar (IC, WRC) _____%; Other conifer _____%; Other hardwood 20%.

RECEIVED

APR 20 2016

COAST AREA OFFICE
 RESOURCE MANAGEMENT

2. TIMBERLAND OWNER(S) OF RECORD: Don Schoenhofer

Address: 3440 Newburg Road

City: Fortuna State: CA Zip: 95540 Phone: 707-498-8701

I certify, under penalty of perjury, that this is a one-time conversion to a non-timberland use and that there is a "bona fide intent" [14 CCR § 1100(b)] to convert to residential home site and new road construction. I also certify that as the timberland owner, I have not obtained an exemption pursuant to this section in the last five years.

SIGNATURE [Signature]

Date 4/18/16

3. LICENSED TIMBER OPERATOR(S): Zerlang Construction

License Number: A-10423
C-10423

Address 3627 Tami Drive

City: Fortuna State: CA Zip: 95540 Phone: 707-725-1249

SIGNATURE [Signature]

Date 4/18/16

4. Designate the legal land description of the location of timberland conversion. A map showing the location of the timberland conversion MUST be attached. The map must show the ownership boundaries, the location of the timber operation, boundaries of the conversion, location and classification of all watercourses, and landing locations.

Section	Township	Range	Base & Meridian	County	Acreage to be Converted	Assessors Parcel Number
35	1S	2E	Humboldt	Humboldt	2.9	095-201-005

5. **The following are limitations or requirements for timber operations conducted under a Less Than Three Acre Conversion Exemption (Notice, Notice of Conversion Exemption, Conversion Exemption):**
- A. Timber operations shall comply with all other applicable provisions of the Forest Practice Act and regulations, county general plans, zoning ordinances, and any implementing ordinances; copies of the state rules and regulations may be found on CAL FIRE's Web Page on the Internet at <http://www.fire.ca.gov>.
 - B. All timber operations shall be complete within one year from the date of acceptance by CAL FIRE.
 - C. All conversion activities shall be complete within two years from the date of acceptance by CAL FIRE unless under permit by local jurisdiction. Failure to complete the conversion requires compliance with stocking standards and stocking report requirements of the Forest Practice Act and Board of Forestry and Fire Protection regulations.
 - D. The timber operator shall remove or dispose of all slash or woody debris in accordance with 14 CCR § 1104.1(a)(2)(D)(1)-(9). The timberland owner may assume responsibility for the slash treatment, provided the landowner acknowledges in writing to CAL FIRE such responsibility at the time of submission of this notice. The specific requirements shall be included with the acknowledgement.
 - E. Timber operations may be conducted during the winter period. Tractor operations in the winter period are allowed under any of the conditions described in 14 CCR § 1104.1(a)(2)(E)1.-3.
 - F. No timber operations are allowed within a watercourse and lake protection zone unless specifically approved by local permit (e.g., county, city).
 - G. No timber operations shall be conducted until CAL FIRE's notice of acceptance is received and a valid copy of this notice and CAL FIRE's acceptance shall be kept on site during timber operations.
 - H. No sites of rare, threatened or endangered plants or animals or species of special concern shall be disturbed, threatened, or damaged.
 - I. No timber operations are allowed on significant historical or archeological sites.
 - J. Within one month of the completion of timber operations, including slash disposal, the timberland owner shall submit a work completion report to CAL FIRE.
 - K. A violation of the conversion exemption, including a conversion applied for in the name of someone other than the person or entity implementing the conversion in bona fide good faith, are violations of the Forest Practice Act and penalties may accrue up to ten thousand dollars (\$10,000) for each violation pursuant to Article 8 (commencing with Section 4601).
6. See following page declare as the authorized designee of the County Board of Supervisors that this conversion exemption is in conformance with all county regulatory requirements, including public notice. **(If the county has authorized a designee this item MUST be completed. If it has not, see item 7.)**

SIGNATURE _____ Date _____

7. Registered Professional Forester preparing Notice: Brian Griesbach Number 2738

RECEIVED

Address Timberland Resource Consultants, 165 South Fortuna Blvd, Suite 4

APR 20 2016

City Fortuna State CA Zip 95540 Phone 707-725-1897

**COAST AREA OFFICE
RESOURCE MANAGEMENT**

I have, or my supervised designee has, (1) prepared this Notice of Conversion Exemption Timber Operations; (2) visited the site and flagged the boundaries of the conversion exemption, applicable WLPZs and equipment limitation zones; (3) prepared a Neighborhood Notice of Conversion Exemption according to 14 CCR § 1104.1(a)(3) to be mailed by the landowner to adjacent landowners; and (4) posted and dated a copy of the Neighborhood Notice of Conversion Exemption on the ownership, visible to the public, at least 5 days prior to the postmark date of submission of the Notice of Conversion Exemption. I certify that if the County Board of Supervisors has not designated a representative authorized to sign in Item 6 that I, or my supervised designee, contacted the county and the Notice is in conformance with county regulations.

SIGNATURE of RPF Brian Griesbach Date 4/19/16

8. NOTICE SUBMITTER(S): Don Schoenhofer

Address: 3440 Newburg Road

City: Fortuna State: CA Zip: 95540 Phone: 707-498-8701

Submitter must be 1, 2, or 3 above, and must sign.

SIGNATURE [Signature] Date 4/18/16

FILE THIS NOTICE WITH THE CAL FIRE OFFICE BELOW FOR THE COUNTY IN WHICH THE OPERATION WILL OCCUR:

Forest Practice, CAL FIRE 135 Ridgway Avenue Santa Rosa, CA 95401	Forest Practice, CAL FIRE 6105 Airport Road Redding, CA 96002	Forest Practice, CAL FIRE 1234 East Shaw Avenue Fresno, CA 93710
Alameda, Colusa, Contra Costa, Del Norte, Humboldt, Lake, Marin, Mendocino, Napa, San Mateo, Santa Clara, Santa Cruz, Solano, Sonoma, western Trinity and Yolo Counties	Butte, Glenn, Lassen, Modoc, Nevada, Placer, Plumas, Shasta, Sierra, Siskiyou, Sutter, Tehama, eastern Trinity and Yuba Counties	Alpine, Amador, Calaveras, El Dorado, Fresno, Imperial, Inyo, Kern, Los Angeles, Madera, Mariposa, Merced, Mono, Monterey, Orange, Riverside, San Benito, San Bernardino, San Diego, San Luis Obispo, Santa Barbara, Stanislaus, Tuolumne, Tulare, and Ventura Counties

5. The following are limitations or requirements for timber operations conducted under a Less Than Three Acre Conversion Exemption (Notice, Notice of Conversion Exemption, Conversion Exemption):
 - A. Timber operations shall comply with all other applicable provisions of the Forest Practice Act and regulations, county general plans, zoning ordinances, and any implementing ordinances; copies of the state rules and regulations may be found on CAL FIRE's Web Page on the Internet at <http://www.fire.ca.gov>.
 - B. All timber operations shall be complete within one year from the date of acceptance by CAL FIRE.
 - C. All conversion activities shall be complete within two years from the date of acceptance by CAL FIRE unless under permit by local jurisdiction. Failure to complete the conversion requires compliance with stocking standards and stocking report requirements of the Forest Practice Act and Board of Forestry and Fire Protection regulations.
 - D. The timber operator shall remove or dispose of all slash or woody debris in accordance with 14 CCR § 1104.1(a)(2)(D)(1)-(9). The timberland owner may assume responsibility for the slash treatment, provided the landowner acknowledges in writing to CAL FIRE such responsibility at the time of submission of this notice. The specific requirements shall be included with the acknowledgement.
 - E. Timber operations may be conducted during the winter period. Tractor operations in the winter period are allowed under any of the conditions described in 14 CCR § 1104.1(a)(2)(E)1.-3.
 - F. No timber operations are allowed within a watercourse and lake protection zone unless specifically approved by local permit (e.g., county, city).
 - G. No timber operations shall be conducted until CAL FIRE's notice of acceptance is received and a valid copy of this notice and CAL FIRE's acceptance shall be kept on site during timber operations.
 - H. No sites of rare, threatened or endangered plants or animals or spaces of special concern shall be disturbed, threatened, or damaged.
 - I. No timber operations are allowed on significant historical or archeological sites.
 - J. Within one month of the completion of timber operations, including slash disposal, the timberland owner shall submit a work completion report to CAL FIRE.
 - K. A violation of the conversion exemption, including a conversion applied for in the name of someone other than the person or entity implementing the conversion in bona fide good faith, are violations of the Forest Practice Act and penalties may accrue up to ten thousand dollars (\$10,000) for each violation pursuant to Article 8 (commencing with Section 4601).

6. I, Michael Wheeler, declare as the authorized designee of the County Board of Supervisors that this conversion exemption is in conformance with all county regulatory requirements, including public notice. (If the county has authorized a designee this item MUST be completed. If it has not, see Item 7.)

SIGNATURE Michael Z. Wheeler Date 3-5-16

7. Registered Professional Forester preparing Notice: Name Brian Griesbach Number 2738
 Address 165 S Fortuna Blvd

City Fortuna State CA Zip 95540 Phone 707-725-1897

I have, or my supervised designee has, (1) prepared this Notice of Conversion Exemption Timber Operations; (2) visited the site and flagged the boundaries of the conversion exemption, applicable WLPZs and equipment limitation zones; (3) prepared a Neighborhood Notice of Conversion Exemption according to 14 CCR § 1104.1(a)(3) to be mailed by the landowner to adjacent landowners; and (4) posted and dated a copy of the Neighborhood Notice of Conversion Exemption on the ownership, visible to the public, at least 5 days prior to the postmark date of submission of the Notice of Conversion Exemption. I certify that if the County Board of Supervisors has not designated a representative authorized to sign in Item 6 that I, or my supervised designee, contacted the county and the Notice is in conformance with county regulations.

SIGNATURE of RPF Brian Griesbach Date 3/25/16

8. NOTICE SUBMITTER(S): Name Same as Item 1

Address _____

City _____ State _____ Zip _____ Phone _____

Submitter must be 1, 2, or 3 above, and must sign.

SIGNATURE [Signature] Date 3/25/16

FILE THIS NOTICE WITH THE CAL FIRE OFFICE BELOW FOR THE COUNTY IN WHICH THE OPERATION WILL OCCUR: DS

Forest Practice, CAL FIRE 135 Rldgway Avenue Santa Rosa, CA 95401	Forest Practice, CAL FIRE 6105 Airport Road Redding, CA 96002	Forest Practice, CAL FIRE 1234 East Shaw Avenue Fresno, CA 93710
Alameda, Colusa, Contra Costa, Del Norte, Humboldt, Lake, Marin, Mendocino, Napa, San Mateo, Santa Clara, Santa Cruz, Solano, Sonoma, western Trinity and Yolo Counties	Butte, Glenn, Lassen, Modoc, Nevada, Placer, Plumas, Shasta, Sierra, Siskiyou, Sutter, Tehama, eastern Trinity and Yuba Counties	Alpine, Amador, Calaveras, El Dorado, Fresno, Imperial, Inyo, Kern, Los Angeles, Madera, Mariposa, Merced, Mono, Monterey, Orange, Riverside, San Benito, San Bernardino, San Diego, San Luis Obispo, Stanislaus, Tuolumne, Tulare, and Ventura Counties

RECEIVED

APR 20 2016

COAST AREA OFFICE
RESOURCE MANAGEMENT

Project Description

Per the Humboldt County General Plan, the conversion exemption area is zoned Timber Production (TPZ). Humboldt County's Grading and Open Space Ordinance does not apply to this project because the conversion exemption area is zoned TPZ. However, the County has reviewed the conversion exemption as required and Item 6 is signed by the County's designee.

Addendum 14CCR 1104.1(a)(1)(E)(1-4)

The timberland owner has certified via his signature, under penalty of perjury, that this is a one-time conversion to residential home site and new road construction. The timberland owner understands that a "Bona Fide Intention or bona fide intent" is a present, sincere intention of the applicant to conform with and successfully execute the conversion plan, as determined by the Director in accordance with provisions of Sec. 1105.2 (Ref.: Sec. 4623, PRC). The timberland owner, acting as an individual, acting as a member of a partnership, or acting as an officer or employee of a corporation or other legal entity, has not obtained an exemption pursuant to this section in the last five years.

Addendum 14CCR 1104.1(a)(2)(F)

The conversion area is not located within a WLPZ or Class III ELZ.

Addendum 14CCR 1104.1(a)(6)

The extent of the vegetation removal and site preparation required for the conversion;

The proposed conversion consists of new seasonal road construction and construction of two building sites, which will be used for future residential development. The conversion area consists of merchantable second growth redwood, Douglas-fir and tanoak, which will require timber harvesting and extensive site preparation. Excavation and grading will be necessary to successfully convert the sites; however, no significant excavation is needed.

The suitability of soils, slope, aspect, and microclimate for the stated non-timber use;

The conversion exemption area's soils, slope, aspect, and microclimate are favorable for residential use.

RECEIVED

APR 20 2016

**COAST AREA OFFICE
RESOURCE MANAGEMENT**

Addendum 14CCR 1104.1(a)(2)(D) - Treatment of Logging Slash and Woody Debris.

1. Unless otherwise required, slash greater than one inch in diameter and greater than two feet long, and woody debris, except pine, shall receive full treatment no later than April 1 of the year following its creation, or within one year from the date of acceptance of the conversion exemption by the Director, whichever comes first.
2. All pine slash three inches and greater in diameter and longer than four feet must receive initial treatment if it is still on the parcel, within 7 days of its creation.
3. All pine woody debris longer than four feet must receive an initial treatment prior to full treatment.
4. Initial treatment shall include limbing woody debris and cutting slash and woody debris into lengths of less than four feet, and leaving the pieces exposed to solar radiation to aid in rapid drying.
5. Full treatment of all pine slash and woody debris must be completed by March 1 of the year following its creation, or within one year from the date of acceptance of the conversion exemption by the Director, whichever comes first.
6. Full slash and woody debris treatment may include any of the following:
 - a. Burying;
 - b. Chipping and spreading;
 - c. Piling and burning; or
 - d. Removing slash and woody debris from the site for treatment in compliance with (a)-(b). Slash and woody debris may not be burned by open outdoor fires except under permit from the appropriate fire protection agency, if required, the local air pollution control district or air quality management district. The burning must occur on the property where the slash and woody debris originated.
7. Slash and woody debris, except for pine, which is cut up for firewood shall be cut to lengths 24 inches or less and set aside for drying by April 1 of the year following its creation. Pine slash and woody debris which is cut up for firewood shall be cut to lengths 24 inches or less and set aside for drying within seven days of its creation.
8. Any treatment which involves burning of slash or woody debris shall comply with all state and local fire and air quality rules.

RECEIVED

APR 20 2016

**COAST AREA OFFICE
RESOURCE MANAGEMENT**

Additional Information

RECEIVED

APR 20 2016

COAST AREA OFFICE
RESOURCE MANAGEMENT

APN 095-201-005

Location Map

 Property Boundary

Map Scale 1" = 2,000'
Section 35, T1S, R2E, HB&M

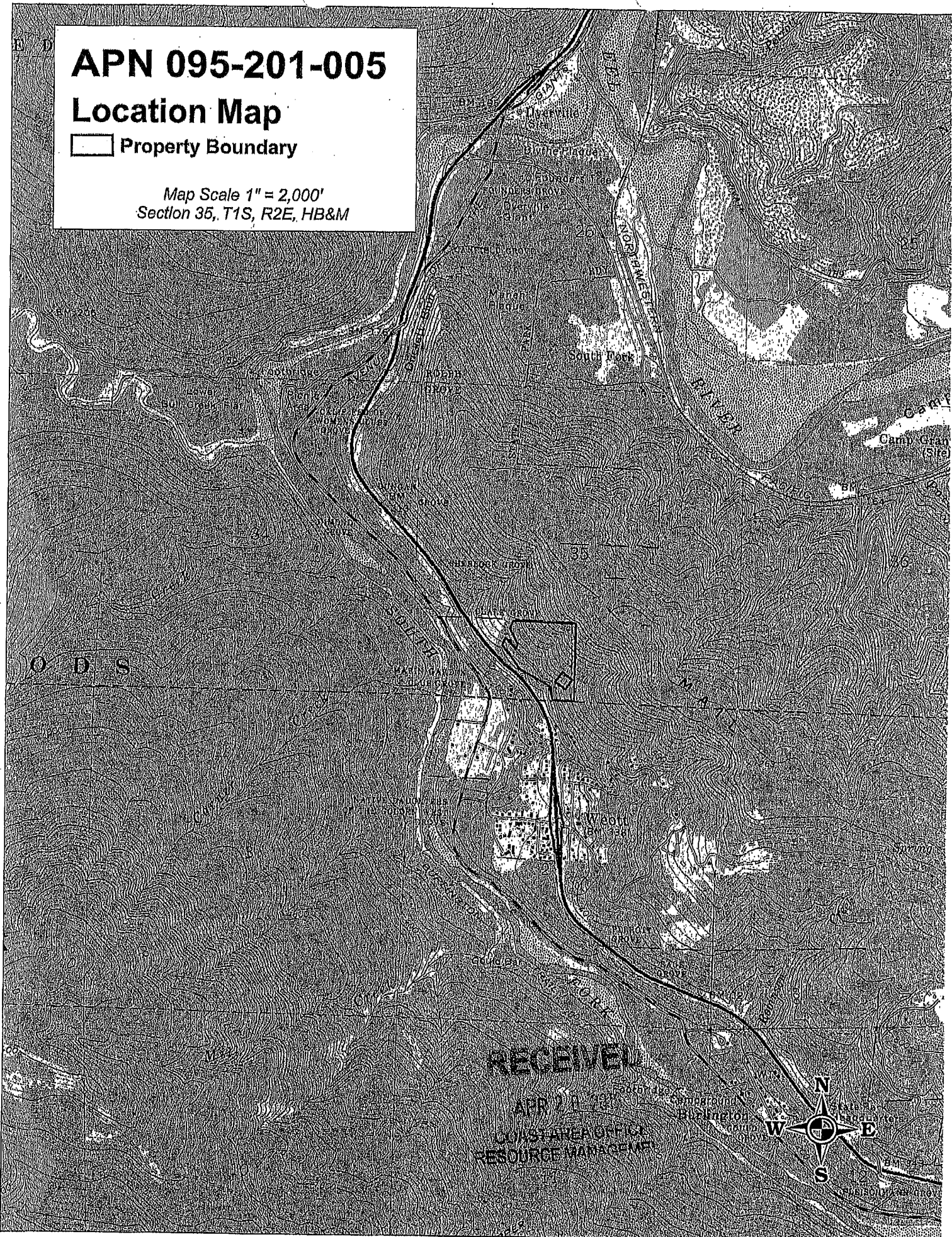

APN 095-201-005

NORTH

Conversion Map

Map Scale 1" = 250'
Contour Interval = 40 feet
Section 35, T1S, R2E, HB&M

 Property Boundary

 Conversion Boundary

 New Seasonal Road

 Existing Permanent Road

 Landing

 Class II Watercourse

 Class III Watercourse

 Domestic Water Supply

 Structure

LITTLE GROVE



RECEIVED
APR 21 2016
COUNTY OFFICE
SOUTH BAY CENTER

Less Than 3-acre Conversion Exemption NOTICE OF TIMBER OPERATIONS

Date of Posting of this Notice: 4-15-16

A Conversion exemption that may be of interest to you will be submitted to the California Department of Forestry & Fire Protection. The California Department of Forestry & Fire Protection will be reviewing the proposed timber operation for compliance with various laws and rules. The following briefly describes the proposed conversion exemption and where and how to get more information. Questions about the proposed conversion exemption or laws and rules governing timber operations should be directed to:

California Department of Forestry and Fire Protection
Forest Practice Program
135 Ridgeway Avenue
Santa Rosa, CA 95402
(707) 576-2959

Information about the Conversion Exemption is as follows:

1. TIMBER OWNER OF RECORD: Don Schoenhofer
Address: 3440 Newburg Road
City: Fortuna State: CA Zip: 95540 Phone: 707-498-8701
2. TIMBERLAND OWNER OF RECORD: Don Schoenhofer
Address: 3440 Newburg Road
City: Fortuna State: CA Zip: 95540 Phone: 707-498-8701
3. LICENSED TIMBER OPERATOR(S): Zerlang Construction License Number: A-10423
Address 3627 Tami Drive
City: Fortuna State: CA Zip: 95540 Phone: 707-725-1249
4. REGISTERED PROFESSIONAL FORESTER PREPARING NOTICE: Name Brian Griesbach RPF Number 2738
Address Timberland Resource Consultants, 165 South Fortuna Blvd, Suite 4
City Fortuna State CA Zip 95540 Phone (707) 725-1897
5. AGENCY OF HUMBOLDT COUNTY RESPONSIBLE FOR LAND USE CHANGES: Humboldt County Planning Department
6. PROJECT LOCATION: Located at 407 North Sunny Lane, CA 95571. APN 095-201-005. Legal description is SE ¼ of SW ¼ of Section 35, T1S, R2E, HB&M.
7. TYPE OF CONVERSION: This is a conversion from timberland to residential home site and new road construction and the maximum size of the conversion is less than 3 acres.

RECEIVED

APR 20 2016

COAST AREA OFFICE
RESOURCE MANAGEMENT



165 South Fortuna Boulevard, Fortuna, CA 95540
707-725-1897 • fax 707-725-0972
trc@timberlandresource.com

April 19, 2016

Jerry Stickney & Judy Thode
893 Nancy Court
Eureka, CA 95503

As the Registered Professional Forester preparing a Conversion Exemption per 14CCR 1104.1 for Don Schoenhofer, I am required by the California Forest Practice Rules to notify all adjacent landowners of this proposed operation with the following information:

15. TIMBER OWNER OF RECORD: Don Schoenhofer
Address: 3440 Newburg Road
City: Fortuna State: CA Zip: 95540 Phone: 707-498-8701
16. TIMBERLAND OWNER OF RECORD: Don Schoenhofer
Address: 3440 Newburg Road
City: Fortuna State: CA Zip: 95540 Phone: 707-498-8701
17. LICENSED TIMBER OPERATOR(S): Zerlang Construction License Number: A-10423
Address 3627 Taml Drive
City: Fortuna State: CA Zip: 95540 Phone: 707-725-1249
18. REGISTERED PROFESSIONAL FORESTER PREPARING NOTICE: Name Brian Griesbach RPF Number 2738
Address Timberland Resource Consultants, 165 South Fortuna Blvd, Suite 4
City Fortuna State CA Zip 95540 Phone (707) 725-1897
19. AGENCY OF HUMBOLDT COUNTY RESPONSIBLE FOR LAND USE CHANGES: Humboldt County Planning Department
20. PROJECT LOCATION: Located at 407 North Sunny Lane, CA 95571. APN 095-201-005. Legal description is SE ¼ of SW ¼ of Section 35, T1S, R2E, HB&M.
21. TYPE OF CONVERSION: This is a conversion from timberland to residential home site and new road construction and the maximum size of the conversion is less than 3 acres.

Sincerely,

A handwritten signature in black ink, appearing to read "Brian Griesbach", is written over a horizontal line.

Brian Griesbach, RPF #2738
Timberland Resource Consultants

RECEIVED

APR 20 2016
COAST AREA OFFICE
RESOURCE MANAGEMENT



Timberland Resource Consultants

165 South Fortuna Boulevard, Fortuna, CA 95540

707-725-1897 • fax 707-725-0972

trc@timberlandresource.com

April 18, 2016

Inez K. Gibbons
2960 Park Bl
Oakland, CA 94610

As the Registered Professional Forester preparing a Conversion Exemption per 14CCR 1104.1 for Don Schoenhofer, I am required by the California Forest Practice Rules to notify all adjacent landowners of this proposed operation with the following information:

1. TIMBER OWNER OF RECORD: Don Schoenhofer
Address: 3440 Newburg Road
City: Fortuna State: CA Zip: 95540 Phone: 707-498-8701
2. TIMBERLAND OWNER OF RECORD: Don Schoenhofer
Address: 3440 Newburg Road
City: Fortuna State: CA Zip: 95540 Phone: 707-498-8701
3. LICENSED TIMBER OPERATOR(S): Zerlang Construction License Number: A-10423
Address 3627 Tami Drive
City: Fortuna State: CA Zip: 95540 Phone: 707-725-1249
4. REGISTERED PROFESSIONAL FORESTER PREPARING NOTICE: Name Brian Griesbach RPF Number 2738
Address Timberland Resource Consultants, 165 South Fortuna Blvd, Suite 4
City Fortuna State CA Zip 95540 Phone (707) 725-1897
5. AGENCY OF HUMBOLDT COUNTY RESPONSIBLE FOR LAND USE CHANGES: Humboldt County Planning Department
6. PROJECT LOCATION: Located at 407 North Sunny Lane, CA 95571. APN 095-201-005. Legal description is SE ¼ of SW ¼ of Section 35, T1S, R2E, HB&M
7. TYPE OF CONVERSION: This is a conversion from timberland to residential home site and new road construction and the maximum size of the conversion is less than 3 acres.

Sincerely,

Brian Griesbach, RPF #2738
Timberland Resource Consultants

RECEIVED

APR 20 2016
COAST AREA OFFICE
RESOURCE MANAGEMENT



165 South Fortuna Boulevard, Fortuna, CA 95540
707-725-1897 • fax 707-725-0972
trc@timberlandresource.com

April 19, 2016

California State Parks
P.O. Box 2006
Eureka, CA 95502-2006

As the Registered Professional Forester preparing a Conversion Exemption per 14CCR 1104.1 for Don Schoenhofer, I am required by the California Forest Practice Rules to notify all adjacent landowners of this proposed operation with the following information:

8. TIMBER OWNER OF RECORD: Don Schoenhofer
Address: 3440 Newburg Road
City: Fortuna State: CA Zip: 95540 Phone: 707-498-8701
9. TIMBERLAND OWNER OF RECORD: Don Schoenhofer
Address: 3440 Newburg Road
City: Fortuna State: CA Zip: 95540 Phone: 707-498-8701
10. LICENSED TIMBER OPERATOR(S): Zerlang Construction License Number: A-10423
Address: 3627 Tami Drive
City: Fortuna State: CA Zip: 95540 Phone: 707-725-1249
11. REGISTERED PROFESSIONAL FORESTER PREPARING NOTICE: Name Brian Griesbach RPF Number 2738
Address: Timberland Resource Consultants, 165 South Fortuna Blvd, Suite 4
City Fortuna State CA Zip 95540 Phone (707) 725-1897
12. AGENCY OF HUMBOLDT COUNTY RESPONSIBLE FOR LAND USE CHANGES: Humboldt County Planning Department
13. PROJECT LOCATION: Located at 407 North Sunny Lane, CA 95571. APN 095-201-005. Legal description is SE ¼ of SW ¼ of Section 35, T1S, R2E, HB&M
14. TYPE OF CONVERSION: This is a conversion from timberland to residential home site and new road construction and the maximum size of the conversion is less than 3 acres.

Sincerely,



Brian Griesbach, RPF #2738
Timberland Resource Consultants

RECEIVED

APR 20 2016
COAST AREA OFFICE
RESOURCE MANAGEMENT



Timberland Resource Consultants

165 South Fortuna Boulevard, Fortuna, CA 95540

707-725-1897 • fax 707-725-0972

trc@timberlandresource.com

April 19, 2016

Native American Heritage Commission
1550 Harbor Blvd., Room 100
West Sacramento, CA 95691

Dear Native American Heritage Commission:

As the Registered Professional Forester preparing a Conversion Exemption per 14CCR 1104.1 for Don Schoenhofer, I am required by the California Forest Practice Rules to notify all Native Americans of this proposed operation with the following information:

1. TIMBER OWNER OF RECORD: Don Schoenhofer
Address: 3440 Newburg Road
City: Fortuna State: CA Zip: 95540 Phone: 707-498-8701
2. TIMBERLAND OWNER OF RECORD: Don Schoenhofer
Address: 3440 Newburg Road
City: Fortuna State: CA Zip: 95540 Phone: 707-498-8701
3. LICENSED TIMBER OPERATOR(S): Zerlang Construction License Number: A-10423
Address 3627 Tami Drive
City: Fortuna State: CA Zip: 95540 Phone: 707-725-1249
4. REGISTERED PROFESSIONAL FORESTER PREPARING NOTICE: Name Brian Griesbach RPF Number 2738
Address Timberland Resource Consultants, 165 South Fortuna Blvd, Suite 4
City Fortuna State CA Zip 95540 Phone (707) 725-1897
5. AGENCY OF HUMBOLDT COUNTY RESPONSIBLE FOR LAND USE CHANGES: Humboldt County Planning Department
6. PROJECT LOCATION: Located at 407 North Sunny Lane, CA 95571. APN 095-201-005. Legal description is SE ¼ of SW ¼ of Section 35, T1S, R2E, HB&M
7. TYPE OF CONVERSION: This is a conversion from timberland to residential home site and new road construction and the maximum size of the conversion is less than 3 acres.

Sincerely,

Brian Griesbach

Brian Griesbach, RPF #2738
Timberland Resource Consultants

RECEIVED
APR 20 2016
COAST AREA OFFICE
RESOURCE MANAGEMENT



Timberland Resource Consultants

165 South Fortina Boulevard, Fortuna, CA 95540
707-725-1897 • fax 707-725-0972
trc@timberlandresource.com

April 19, 2016

Bear River Band of Rohnerville Rancheria
266 Kiesner Road
Loleta, CA 95551

Dear Erica Cooper, Tribal Historic Preservation Officer:

As the Registered Professional Forester preparing a Conversion Exemption per 14CCR 1104.1 for Don Schoenhofer, I am required by the California Forest Practice Rules to notify all Native Americans of this proposed operation with the following information:

1. TIMBER OWNER OF RECORD: Don Schoenhofer
Address: 3440 Newburg Road
City: Fortuna State: CA Zip: 95540 Phone: 707-498-8701
2. TIMBERLAND OWNER OF RECORD: Don Schoenhofer
Address: 3440 Newburg Road
City: Fortuna State: CA Zip: 95540 Phone: 707-498-8701
3. LICENSED TIMBER OPERATOR(S): Zerlang Construction License Number: A-10423
Address 3627 Tami Drive
City: Fortuna State: CA Zip: 95540 Phone: 707-725-1249
4. REGISTERED PROFESSIONAL FORESTER PREPARING NOTICE: Name Brian Griesbach RPF Number 2738
Address Timberland Resource Consultants, 165 South Fortuna Blvd, Suite 4
City Fortuna State CA Zip 95540 Phone (707) 725-1897
5. AGENCY OF HUMBOLDT COUNTY RESPONSIBLE FOR LAND USE CHANGES: Humboldt County Planning Department
6. PROJECT LOCATION: Located at 407 North Sunny Lane, CA 95571. APN 095-201-005. Legal description is SE ¼ of SW ¼ of Section 35, T1S, R2E, HB&M
7. TYPE OF CONVERSION: This is a conversion from timberland to residential home site and new road construction and the maximum size of the conversion is less than 3 acres.

Sincerely,

Brian Griesbach

Brian Griesbach, RPF #2738
Timberland Resource Consultants

RECEIVED

APR 20 2016

COAST AREA OFFICE
RESOURCE MANAGEMENT



165 South Fortuna Boulevard, Fortuna, CA 95540
707-725-1897 • fax 707-725-0972
trc@timberlandresource.com

April 19, 2016

InterTribal Sinkyone Wilderness Council
P. O. Box 1523
Ukiah, CA 95482

Dear Hawk Rosales, Executive Director:

As the Registered Professional Forester preparing a Conversion Exemption per 14CCR 1104.1 for Don Schoenhofer, I am required by the California Forest Practice Rules to notify all Native Americans of this proposed operation with the following information:

1. TIMBER OWNER OF RECORD: Don Schoenhofer
Address: 3440 Newburg Road
City: Fortuna State: CA Zip: 95540 Phone: 707-498-8701
2. TIMBERLAND OWNER OF RECORD: Don Schoenhofer
Address: 3440 Newburg Road
City: Fortuna State: CA Zip: 95540 Phone: 707-498-8701
3. LICENSED TIMBER OPERATOR(S): Zerlang Construction License Number: A-10423
Address 3627 Tami Drive
City: Fortuna State: CA Zip: 95540 Phone: 707-725-1249
4. REGISTERED PROFESSIONAL FORESTER PREPARING NOTICE: Name Brian Griesbach RPF Number 2738
Address Timberland Resource Consultants, 165 South Fortuna Blvd, Suite 4
City Fortuna State CA Zip 95540 Phone (707) 725-1897
5. AGENCY OF HUMBOLDT COUNTY RESPONSIBLE FOR LAND USE CHANGES: Humboldt County Planning Department
6. PROJECT LOCATION: Located at 407 North Sunny Lane, CA 95571. APN 095-201-005. Legal description is SE ¼ of SW ¼ of Section 35, T1S, R2E, HB&M
7. TYPE OF CONVERSION: This is a conversion from timberland to residential home site and new road construction and the maximum size of the conversion is less than 3 acres.

Sincerely,

Brian Griesbach

Brian Griesbach, RPF #2738
Timberland Resource Consultants

RECEIVED

APR 20 2016

COAST AREA OFFICE
RESOURCE MANAGEMENT



165 South Fortuna Boulevard, Fortuna, CA 95540
707-725-1897 • fax 707-725-0972
trc@timberlandresource.com

April 19, 2016

Round Valley Indian Tribes of the Round Valley Reservation
77826 Covelo Road
Covelo, CA 95428

Dear Stephanie Britton, Natural Resources:

As the Registered Professional Forester preparing a Conversion Exemption per 14CCR 1104.1 for Don Schoenhofer, I am required by the California Forest Practice Rules to notify all Native Americans of this proposed operation with the following information:

1. TIMBER OWNER OF RECORD: Don Schoenhofer
Address: 3440 Newburg Road
City: Fortuna State: CA Zip: 95540 Phone: 707-498-8701
2. TIMBERLAND OWNER OF RECORD: Don Schoenhofer
Address: 3440 Newburg Road
City: Fortuna State: CA Zip: 95540 Phone: 707-498-8701
3. LICENSED TIMBER OPERATOR(S): Zerlang Construction License Number: A-10423
Address: 3627 Tami Drive
City: Fortuna State: CA Zip: 95540 Phone: 707-725-1249
4. REGISTERED PROFESSIONAL FORESTER PREPARING NOTICE: Name Brian Griesbach RPF Number 2738
Address: Timberland Resource Consultants, 165 South Fortuna Blvd, Suite 4
City Fortuna State CA Zip 95540 Phone (707) 725-1897
5. AGENCY OF HUMBOLDT COUNTY RESPONSIBLE FOR LAND USE CHANGES: Humboldt County Planning Department
6. PROJECT LOCATION: Located at 407 North Sunny Lane, CA 95571. APN 095-201-005. Legal description is SE ¼ of SW ¼ of Section 35, T1S, R2E, HB&M
7. TYPE OF CONVERSION: This is a conversion from timberland to residential home site and new road construction and the maximum size of the conversion is less than 3 acres.

Sincerely,

Brian Griesbach

Brian Griesbach, RPF #2738
Timberland Resource Consultants

RECEIVED

APR 20 2016

COAST AREA OFFICE
RESOURCE MANAGEMENT



165 South Fortuna Boulevard, Fortuna, CA 95540
707-725-1897 • fax 707-725-0972
trc@timberlandresource.com

April 19, 2016

Wallaki Tribe
P.O. Box 1284
Redway CA 95560

Dear Louis Hoaglin Sr., Chairperson:

As the Registered Professional Forester preparing a Conversion Exemption per 14CCR 1104.1 for Don Schoenhofer, I am required by the California Forest Practice Rules to notify all Native Americans of this proposed operation with the following information:

1. **TIMBER OWNER OF RECORD: Don Schoenhofer**
Address: 3440 Newburg Road
City: Fortuna State: CA Zip: 95540 Phone: 707-498-8701
2. **TIMBERLAND OWNER OF RECORD: Don Schoenhofer**
Address: 3440 Newburg Road
City: Fortuna State: CA Zip: 95540 Phone: 707-498-8701
3. **LICENSED TIMBER OPERATOR(S): Zerlang Construction** License Number: A-10423
Address 3627 Tami Drive
City: Fortuna State: CA Zip: 95540 Phone: 707-725-1249
4. **REGISTERED PROFESSIONAL FORESTER PREPARING NOTICE: Name Brian Griesbach RPF Number 2738**
Address Timberland Resource Consultants, 165 South Fortuna Blvd, Suite 4
City Fortuna State CA Zip 95540 Phone (707) 725-1897
5. **AGENCY OF HUMBOLDT COUNTY RESPONSIBLE FOR LAND USE CHANGES: Humboldt County Planning Department**
6. **PROJECT LOCATION: Located at 407 North Sunny Lane, CA 95571, APN 095-201-005. Legal description is SE ¼ of SW ¼ of Section 35, T1S, R2E, HB&M**
7. **TYPE OF CONVERSION: This is a conversion from timberland to residential home site and new road construction and the maximum size of the conversion is less than 3 acres.**

Sincerely,

A handwritten signature in cursive script that reads "Brian Griesbach".

Brian Griesbach, RPF #2738
Timberland Resource Consultants

RECEIVED

APR 20 2016
COAST AREA OFFICE
RESOURCE MANAGEMENT



165 South Fortuna Boulevard, Fortuna, CA 95540
707-725-1897 • fax 707-725-0972
trc@timberlandresource.com

April 19, 2016

Wiyot Tribe
1000 Wiyot Drive
Loleta, CA 95551

Dear Thomas Torma, Cultural Director/Tribal Historic Preservation Officer:

As the Registered Professional Forester preparing a Conversion Exemption per 14CCR 1104.1 for Don Schoenhofer, I am required by the California Forest Practice Rules to notify all Native Americans of this proposed operation with the following information:

1. TIMBER OWNER OF RECORD: Don Schoenhofer
Address: 3440 Newburg Road
City: Fortuna State: CA Zip: 95540 Phone: 707-498-8701
2. TIMBERLAND OWNER OF RECORD: Don Schoenhofer
Address: 3440 Newburg Road
City: Fortuna State: CA Zip: 95540 Phone: 707-498-8701
3. LICENSED TIMBER OPERATOR(S): Zerlang Construction License Number: A-10423
Address: 3627 Tami Drive
City: Fortuna State: CA Zip: 95540 Phone: 707-725-1249
4. REGISTERED PROFESSIONAL FORESTER PREPARING NOTICE: Name Brian Griesbach RPF Number 2738
Address: Timberland Resource Consultants, 165 South Fortuna Blvd, Suite 4
City: Fortuna State: CA Zip: 95540 Phone: (707) 725-1897
5. AGENCY OF HUMBOLDT COUNTY RESPONSIBLE FOR LAND USE CHANGES: Humboldt County Planning Department
6. PROJECT LOCATION: Located at 407 North Sunny Lane, CA 95571, APN 095-201-005. Legal description is SE 1/4 of SW 1/4 of Section 35, T1S, R2E, HB&M
7. TYPE OF CONVERSION: This is a conversion from timberland to residential home site and new road construction and the maximum size of the conversion is less than 3 acres.

Sincerely,

A handwritten signature in black ink that reads "Brian Griesbach".

Brian Griesbach, RPF #2738
Timberland Resource Consultants

RECEIVED

APR 20 2016

COAST AREA OFFICE
RESOURCE MANAGEMENT