

Date: Sep 29, 2023, 10:17am User ID: laco01g
File: T:\Cadfiles\10524\10524.00 Ashley Puhl Shelter Cove\XREF\10524.00_TOPO.dwg

RIM=293.18'
6" INV=287.17'



0 5' 10' 20' 30'
SCALE: 1"=10'



ROF
LOT 37
APN: 109-291-018

LANDS OF
ASHLEY PUHL
LOT 38
D.N: 2021-027617
APN: 109-291-019

MAESS
LOT 39
APN: 109-291-020

CONTROL TABLE

POINT	NORTHING	EASTING	ELEVATION (FT)	DESCRIPTION
CP#1	1904305.94	5980945.56	257.45	MAG NAIL & SHINER (SITE BENCHMARK)
CP#2	1904374.89	5980888.04	273.33	60D MAG NAIL
CP#3	1904404.59	5980977.74	251.72	60D MAG NAIL

LEGEND/ABBREVIATIONS:

---	BOUNDARY LINE	ALD	ALDER
- - -	ADJOINER BOUNDARY LINE	STP	STUMP
---	MAJOR CONTOUR	INV	INVERT ELEVATION
---	MINOR CONTOUR	D.N.	DOCUMENT NUMBER
---	OHW	APN	ASSESSORS' PARCEL NUMBER
---	SS		
---	EDGE OF ASPHALT CONCRETE		
---	ROAD CURB		
○ 15" FIR	TREE W/SIZE & TYPE		
PL 18" STUMP	STUMP W/SIZE		
○	UTILITY POLE		
⊙	SANITARY SEWER MANHOLE		
▲	SURVEY CONTROL POINT		
○	FOUND MONUMENT, 3/4" IRON PIPE W/NO TAG		

BASIS OF BEARINGS:

THE BEARINGS SHOWN HEREON ARE BASED UPON THE CALIFORNIA COORDINATE SYSTEM (NAD83), ZONE 1, EPOCH 2010 (REALIZATION 2011) IN ACCORDANCE WITH THE CALIFORNIA PUBLIC RESOURCES CODE SECTIONS 8801-8819. SAID BEARINGS ARE BASED LOCALLY UPON FIELD-OBSERVED TIES TO THE CALIFORNIA SPATIAL REFERENCE NETWORK.

NOTES:

BOUNDARY LINES SHOWN ON THIS MAP DERIVED FROM FOUND MONUMENTS AND RECORD DATA PER BOOK 17 MAPS PAGE 109 HUMBOLDT COUNTY RECORDS.

BASIS OF ELEVATIONS:
ELEVATIONS SHOWN HEREON ARE BASED ON THE NORTH AMERICAN VERTICAL DATUM OF 1988 (NAVD88), DERIVED FROM POST PROCESSING USING CORS STATIONS. THE BASIS OF ELEVATIONS FOR THIS SURVEY WAS ESTABLISHED FROM STATIC GPS OBSERVATIONS AT PROJECT CONTROL POINT #1 A SET MAG AND SHINER "LACO CONTROL", ELEVATION = 257.45 FEET (NAVD88).

CONTOUR INTERVAL IS ONE FOOT

(UNDERGROUND UTILITIES AND) SUBSURFACE CONDITIONS NOT SURVEYED.

FIELD SURVEY BY LACO ASSOCIATES ON AUGUST 21, 2023. ONLY CONDITIONS EXISTING AT THAT TIME ARE REFLECTED ON THIS MAP.

THE CONTENT OF THIS MAP WAS DEFINED BY CONTRACT AT THE REQUEST OF ASHLEY PUHL. LACO ASSOCIATES ACCEPTS NO LIABILITY FOR USE OF THIS MAP BY ANYONE OTHER THAN THE AUTHORIZED REPRESENTATIVE THEREOF.

AN ELECTRONIC FILE OF THIS MAP HAS BEEN PREPARED AND, IF TRANSMITTED FOR USE BY OTHERS, WAS DONE SO AS A COURTESY AND IS SUPPLEMENTARY TO THE SIGNED AND SEALED ELECTRONIC PDF. DUE TO THE SUSCEPTIBILITY OF ELECTRONIC FILES TO CORRUPTION BY OTHERS, THE SIGNED AND SEALED ELECTRONIC PDF, DELIVERED TO THE CLIENT, CONSTITUTES THE ONLY ACTUAL WORK PRODUCT OFFICIALLY PRODUCED IN ACCORDANCE WITH THE EXECUTED PROFESSIONAL SERVICES AGREEMENT.

SURVEYOR'S STATEMENT:

THIS SURVEY REPRESENTS A SURVEY MADE BY ME OR UNDER MY DIRECTION IN CONFORMANCE WITH THE REQUIREMENTS OF THE PROFESSIONAL SURVEYORS' ACT AT THE REQUEST OF ASHLEY PUHL, AUGUST 7, 2023.

Bradley A. Thomas
BRADLEY A. THOMAS, DATE: SEPTEMBER 29, 2023
P.L.S.: 5520

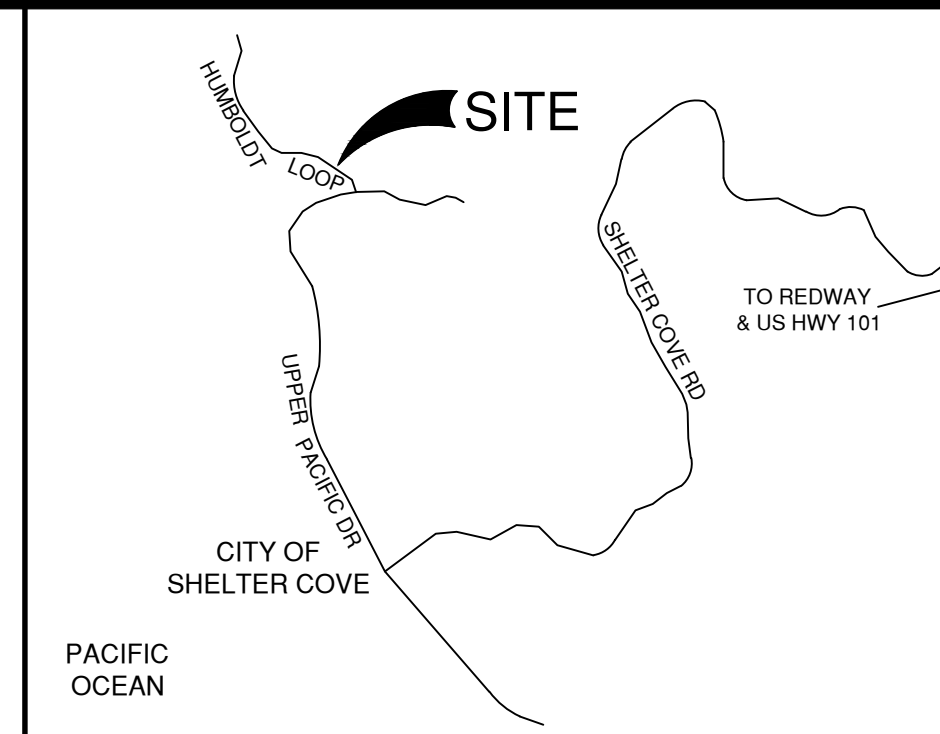
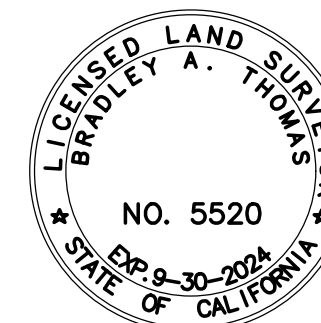

LOCATION MAP
NOT-TO-SCALE

DATE	
NO.	
REVISION	

LACO
SURVEYORS/ENGINEERS/PLANNERS/GEOLGISTS
lacoassociates.com

499 HUMBOLDT LOOP
SHELTER COVE, CALIFORNIA
TOPOGRAPHIC MAP

PLAT NO.	
JOB NO.	10524.00
DATE	9/29/2023
DESIGNER	DJC
CHECKED	DJC
DRAWN	ZH
SHEET	1 OF 1