

NOTES:

1. WATER SOURCE IS PRIVATE.
2. NO TREES TO BE REMOVED.
3. SMA SETBACKS SHALL BE ADHERED TO FOR STREAM(S), SPRING(S), OR WETLAND(S) IN PROPOSED VICINITY.
4. FLAT SHALL CONFORM TO SRA SETBACK.
5. TOTAL ENGINEERED GRADING = ±29,000 CY

DIRECTIONS:
 FROM GARBERVILLE, TRAVEL 8 MILES ON ALDERPOINT RD. TURN RIGHT ON TO BELL SPRINGS RD. AND TRAVEL 1.8 MILE TO PROPERTY ENTRANCE ON RIGHT.



LEGEND

	PROPERTY LINE
	SRA 30' SETBACK FLOW LINE
	GRADING SITE
	50' SMA
	EXISTING
	PROPOSED

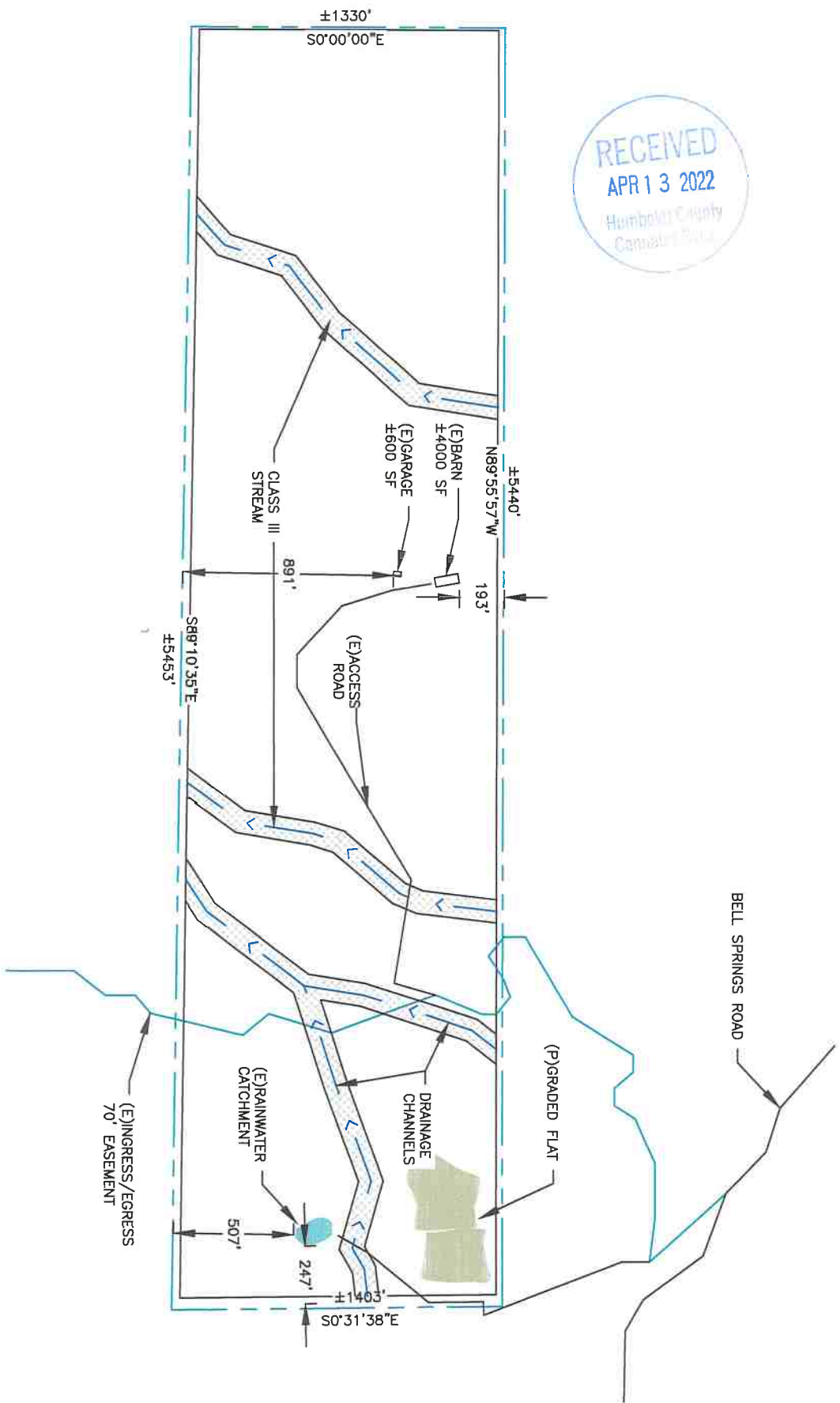

LEGAL	ADDRESS: LAT. 40.08581 LONG. -123.660359
	ASSESSOR'S PARCEL NUMBER: 216-082-006
	OWNER: KEVIN PEAK P.O. BOX 1951 REDWAY, CA 95560 PHONE: (707) 223-1422
	SETBACK: 30' PERMETER
	PROJECT: GRADED FLAT
	LOT SIZE: ±165 ACRES

DISCLAIMER:
 MAPPING INFORMATION PROVIDED IS FOR DESIGN PURPOSES ONLY.
 THIS SITE PLAN REFLECTS MANY MAPPING DETAILS THAT ARE USEFUL TO ASSURE THAT THE GRADING DESIGN IS LOCATED APPROPRIATE TO ITS SURROUNDINGS. HOWEVER, NONE OF THE INFORMATION SHOWN IS IMPLIED TO SUGGEST OR SUBSTITUTE FOR A CONTRACTED ACTUAL LAND SURVEY.
 A. M. BAIRD, ENGINEERING AND SURVEYING, INC. ASSUMES NO RESPONSIBILITY ARISING FROM THE USE OF INFORMATION PROVIDED, OTHER THAN WHAT HAS BEEN SPECIFICALLY INTENDED FOR THE GRADING DESIGN.



GRADING SITE PLAN

JOB # 20-4905
 SHEET # 1 OF 6

KEVIN PEAK
 APN 216-082-006
 HUMBOLDT CO. CA,
 GRADED FLAT
 SITE PLAN

SCALE: AS SHOWN
 DRAWN BY: MAIN
 CHECKED BY: A.M.B.
 DATE: 9/30/2021

A.M. Baird
 Engineering & Surveying, Inc.
 1257 Main Street., P.O.Box 396,
 Fortuna, CA 95540, (707) 725-5182

NO.	DATE	DESCRIPTION
REVISIONS		

NOTES:

1. SURFACE CONTOURS ARE 10' MAJOR AND 2' MINOR.
2. TOTAL EXCAVATION IS APPROXIMATELY 29,000 CY OF ENGINEERED GRADING.
3. FLAT ELEVATIONS AT ±2520' & 2550'.
4. CUT SLOPES SHALL NOT EXCEED 1.5:1 GENERALLY, WITH FILL SLOPES NOT TO EXCEED 1.5:1.
5. NO TREES TO BE REMOVED
6. KNOWN STREAM(S), SPRING(S), OR WETLAND(S) IN DEVELOPMENT AREA ARE SHOWN.
7. FILL MATERIAL SHALL NOT CONTAIN ANY IRREDUCIBLE ORGANIC MATERIAL DETRIMENTAL TO THE STRUCTURAL INTEGRITY OF THE FILL.
8. ALL GROUND RECEIVING FILL SHALL BE CLEARED, SCARIFIED, KEYED AND STEPPED IN ACCORDANCE WITH APPENDIX J OF THE 2019 CBC
9. RELATIVE COMPACTION OF 95% REQUIRED FOR RESIDENTIAL STRUCTURES WHERE 90% WILL SUFFICE FOR AGRICULTURAL.
10. THE FINISHED SURFACE SHALL SLOPE 0.5% MINIMUM AWAY FROM FILL PRISM FACES TOWARD DRAINAGE SWALES
11. BERM THE TOP OF THE CUT BANK TO DIVERT UPHILL SHEET FLOW AWAY FROM CUTFACE.
12. OWNERS &/OR CONTRACTOR ARE TO FOLLOW EROSION & SEDIMENT CONTROL MEASURES OUTLINED ON SHEET G5
13. REVEGETATE ALL DISTURBED AREAS W/ NATIVE GRASSES & COVER W/ STRAW MULCH. KEEP MOIST UNTIL VEGETATION HAS BECOME ESTABLISHED.
14. TEMPORARY FIBER ROLL SPACING SHALL BE NO GREATER THAN 8' ON CUTFACES AND ARE TO REMAIN IN PLACE UNTIL VEGETATION IS RE-ESTABLISHED. WHEN REMOVED, NETTING SHALL BE DISPOSED OF. IF NOT BIODEGRADABLE, AND FIBER ROLL CONTENT MAY BE BROADCAST ON-SITE.



LEGEND





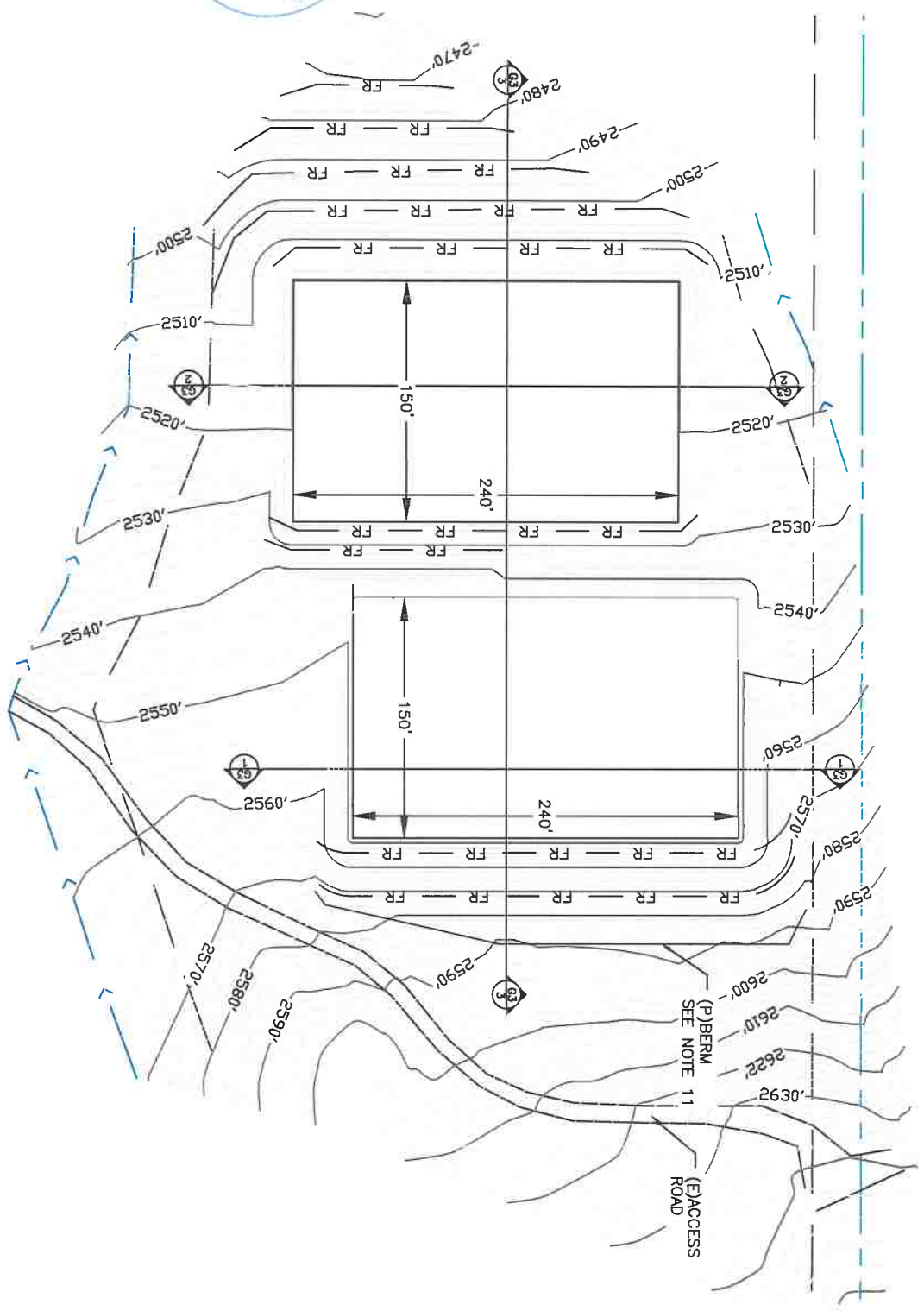
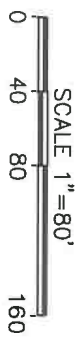

- PROPERTY LINE
- GRADING BOUNDARY
- SETBACKS
- FIBERROLL
- FLOW LINE
- CUT AREA
- FILL AREA

SHEET NUMBER
SECTION NUMBER



GRADING PLAN

JOB # 20-4905 SHEET # 2 of 6	KEVIN PEAK APN 216-082-006 HUMBOLDT CO. CA, GRADED FLAT GRADING PLAN	SCALE: AS SHOWN DRAWN BY: MAN CHECKED: A.M.B. DATE: 9/30/2021	 A.M. Baird Engineering & Surveying, Inc. 1257 Main Street., P.O.Box 396, Fortuna, CA 95540, (707) 725-5182	<table border="1" style="width: 100%; border-collapse: collapse;"> <thead> <tr> <th style="width: 10%;">NO.</th> <th style="width: 10%;">DATE</th> <th style="width: 80%;">DESCRIPTION</th> </tr> </thead> <tbody> <tr> <td> </td> <td> </td> <td> </td> </tr> <tr> <td> </td> <td> </td> <td> </td> </tr> </tbody> </table>	NO.	DATE	DESCRIPTION						
NO.	DATE	DESCRIPTION											

-  EXISTING GRADE
-  FINISH GRADE
-  CUT AREA
-  FILL AREA
-  SHEET NUMBER
-  SECTION NUMBER

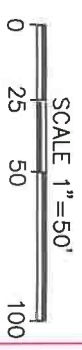
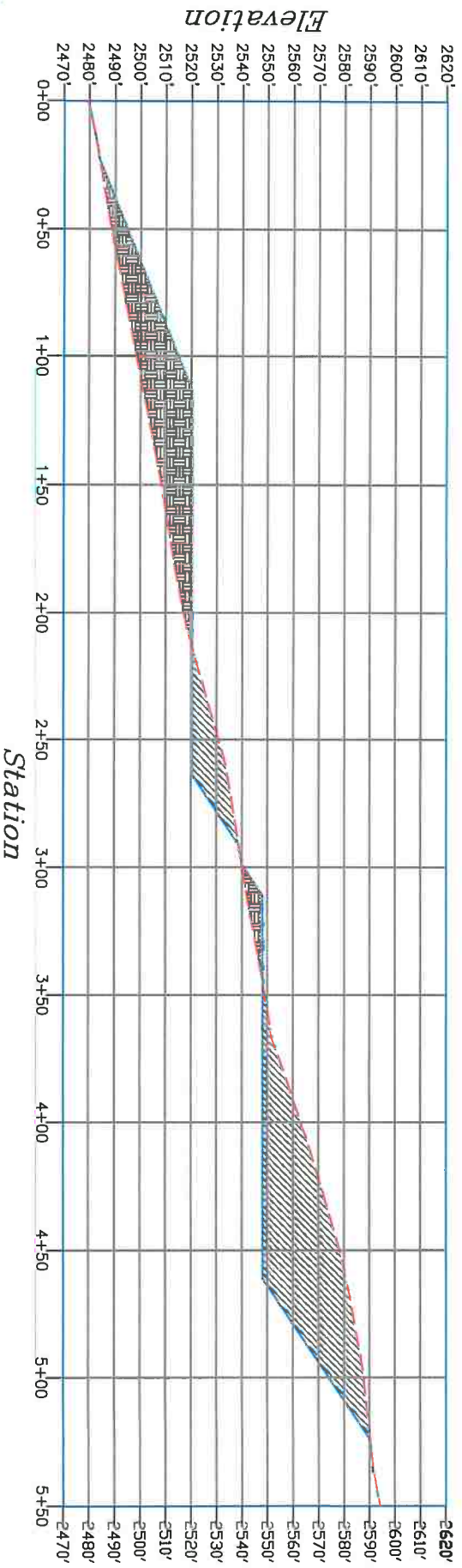
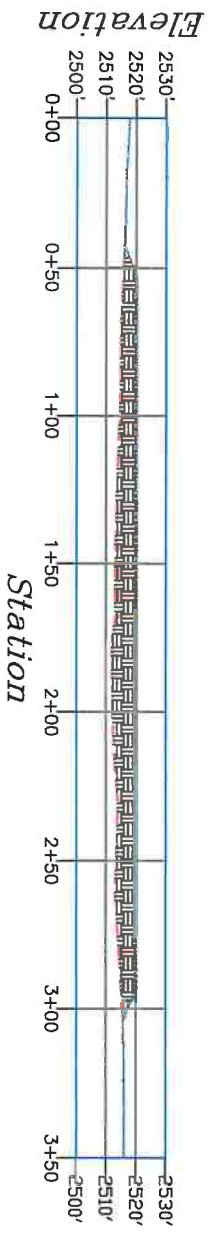
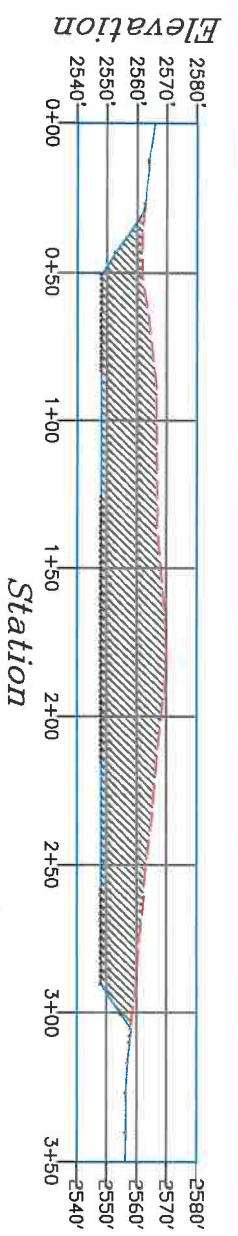

RECEIVED
APR 13 2022
Humboldt County
Cannabis Svcs.

GRADING X-SECTIONS

NO.	DATE	DESCRIPTION

A.M. Baird
Engineering & Surveying, Inc.
1257 Main Street, P.O. Box 396,
Fortuna, CA 95540, (707) 725-5182

SCALE: AS SHOWN
DRAWN BY: MAN
CHKD: A.M.B.
DATE: 9/30/2021

KEVIN PEAK
APN 216-082-006
HUMBOLDT CO. CA,
GRADED FLAT
GRADING X-SECTIONS

JOB #
20-4905
SHEET 7
6 OF 6

RECEIVED
 APR 3 2022
 Humboldt County
 Contract Svcs.

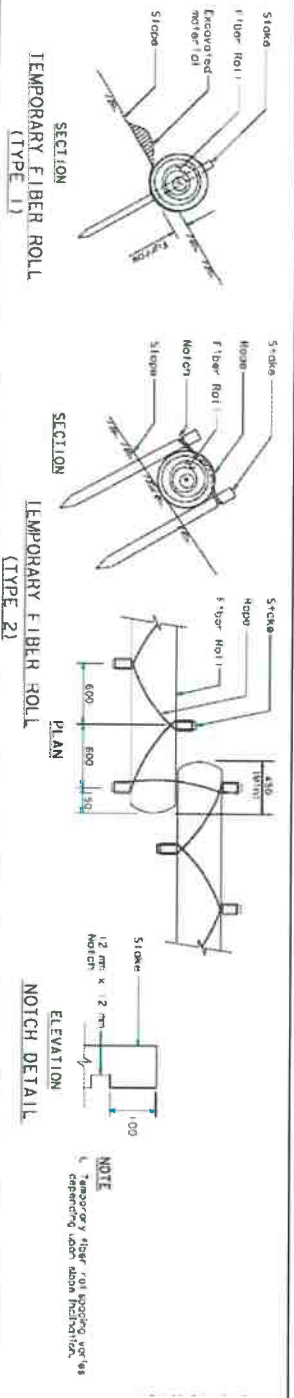
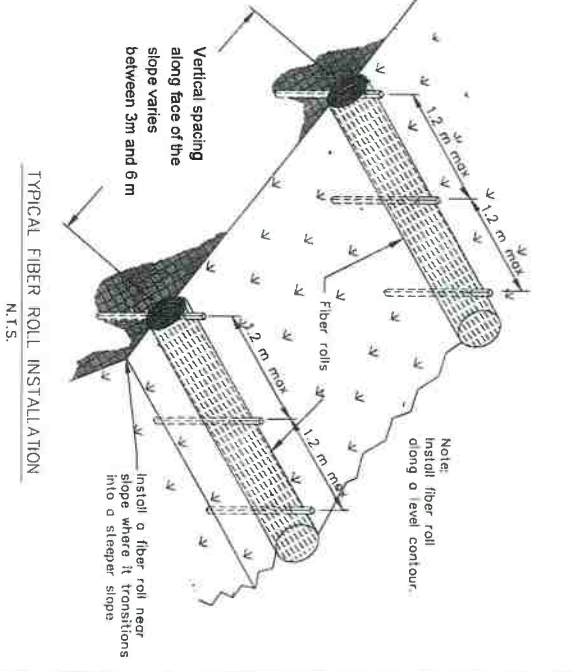
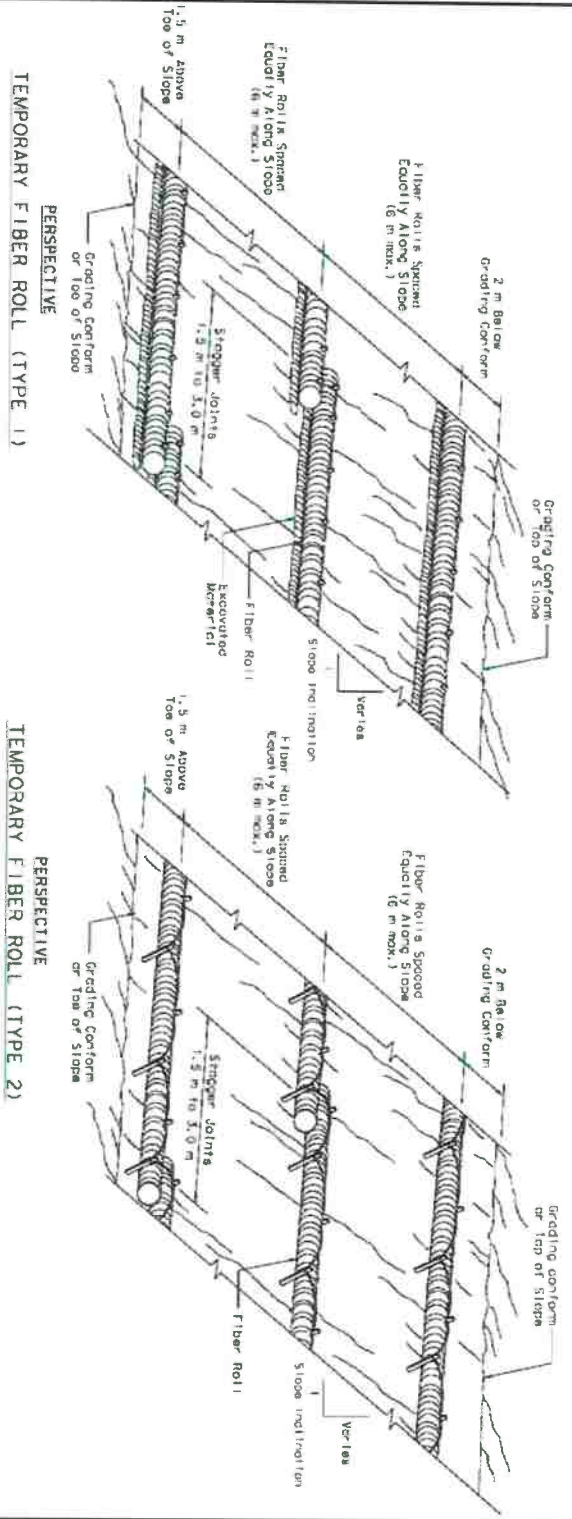
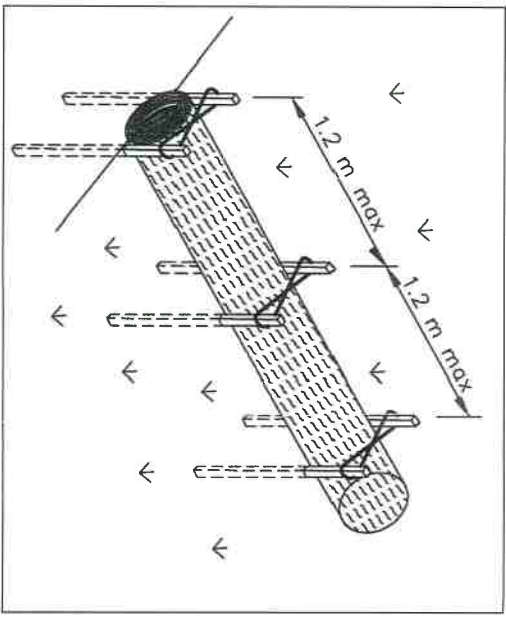
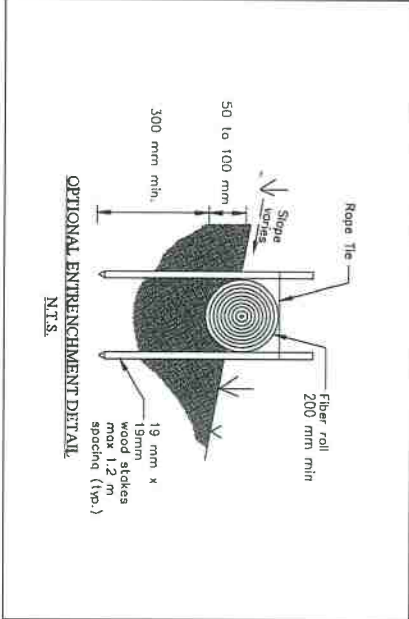
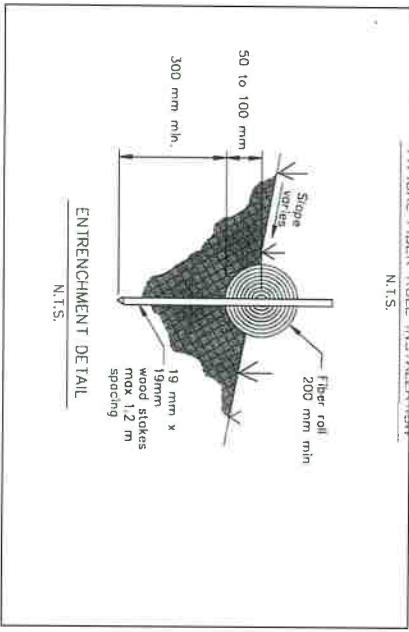

FIBER ROLLS DETAILS SCALE: N.T.S.

JOB # 20-4905 SHEET # 4 of 6	KEVIN PEAK APN 216-082-006 HUMBOLDT CO. CA, GRADED FLAT FIBER ROLL DETAILS	SCALE: N.T.S. DRAWN BY: MJB CHKD: A.M.B. DATE: 9/30/2021	A.M. Baird Engineering & Surveying, Inc. 1257 Main Street, P.O. Box 396, Fortuna, CA 95540, (707) 725-5182	NO. DATE	DESCRIPTION REVISIONS

EROSION AND SEDIMENT CONTROL PLAN—IMPLEMENTATION MEASURES

GENERAL:

OWNER(S): KEVIN PEAK
 ORGANIZERS: A.M. BAIRD ENGINEERING & SURVEYING, INC.
 PROJECT LOCATION: LAT. 40.08581 LONG. -123.680359, GARBERVILLE CA, 95542
 ACTIVITY : CONSTRUCTION OF GRADED FLAT
 ENGINEER'S DECLARATION:
 THIS EROSION & SEDIMENT CONTROL PLAN WAS PREPARED BY ME OR UNDER MY DIRECTION & IS BASED UPON THE CALTRANS CONSTRUCTION SITE BEST MANAGEMENT PRACTICES (BMP)'S MANUAL MARCH 2015.

ALLAN M. BAIRD R.C.E. 23,681

DATED _____

2. GRADING & EROSION CONTROL MEASURES TO BE TAKEN AT TIME OF PERMIT, & TO CONTINUE THROUGHOUT CONSTRUCTION PROCESS.
3. OWNERS) INTEND TO BEGIN CONSTRUCTION AS SOON AS PERMIT IS ISSUED.
4. IF CONSTRUCTION IS TO OCCUR BETWEEN OCTOBER 15 & APRIL 15, SITE INSPECTIONS WILL BE CONDUCTED BY THE CONTRACTOR &/OR OWNER(S): PRIOR TO A FORECASTED STORM, AFTER A RAIN EVENT, WEEKLY THROUGHOUT THE RAINY SEASON, AND EVERY TWO WEEKS THROUGHOUT CONSTRUCTION
5. SITE WILL BE MONITORED DAILY DURING WET WEATHER BY CONTRACTOR &/OR OWNER(S). CONTRACTOR &/OR OWNER(S) ARE RESPONSIBLE FOR REPORTING ANY HAZARDOUS SITUATIONS TO THE ENGINEER.
6. IN THE EVENT THAT ANY ASPECT OF THIS PLAN FAILS, THE OWNER(S) IS/ARE RESPONSIBLE FOR IMMEDIATELY CONTACTING THE ENGINEER FOR RECOMMENDATION(S) AND A PROFESSIONAL CONTRACTOR SHALL FOLLOW RECOMMENDATION(S)
7. IF A FOOTING REVIEW IS REQUIRED, SITE MUST BE EVALUATED BY AN ENGINEER, & IF NECESSARY, ADDITIONAL EROSION CONTROL MEASURES WILL BE TAKEN.
8. UPON COMPLETION OF THE PERMITTED ROUGH GRADING WORK & AT THE FINAL COMPLETION OF THE WORK FOR "ENGINEERED GRADING", OR WHEN PROFESSIONAL INSPECTION IS PERFORMED FOR REGULAR GRADING; A FINAL REPORT SHALL BE SUBMITTED BY THE ENGINEER, IF REQUIRED.
9. THE PERMIT APPLICANT/OWNER(S) SHALL NOTIFY THE BUILDING OFFICIAL WHEN THE GRADING OPERATION IS READY FOR FINAL INSPECTION, AS REQUIRED.
10. IF REQUIRED BY NOTE NINE (9.) ABOVE, A FINAL REPORT SHALL BE PREPARED BY THE ENGINEER AND SUBMITTED TO THE HUMBOLDT COUNTY BUILDING DEPARTMENT BEFORE THE FINAL INSPECTION TO ENSURE THE SITE IS IN ACCORDANCE WITH THIS EROSION CONTROL PLAN & HUMBOLDT COUNTY CODE 331-17.

SEDIMENT CONTROL, SLOPE CONSTRUCTION, & PROTECTION OF WATER COURSES:

11. DIRECT RUNOFF FROM SPOUTS WILL DISCHARGE TO SPLASH BLOCKS & FLOW AWAY FROM THE FOUNDATION &/OR FILL. CONTRACTOR TO PROVIDE POSITIVE DRAINAGE AWAY FROM STRUCTURE AS PER CURRENT BUILDING CODE.
12. ALL EXPOSED, DISTURBED GROUND SHALL BE TEMPORARILY COVERED W/ TWO INCHES OF STRAW MULCH IMMEDIATELY FOLLOWING GRADING.
13. IF APPLICABLE, CUT &/OR FILL AREAS SHALL BE COVERED W/ NATIVE GRASSES, COVERED W/ STRAW MULCH, & KEPT MOIST UNTIL GRASSES ESTABLISH.
14. DRIVEWAY SHALL BE PAVED OR COVERED BY 4-INCHES BASE ROCK TO PREVENT VEHICLE TRACKING OF MUD ONTO PUBLIC ROADWAYS DURING CONSTRUCTION.
15. FIBER ROLLS SHALL BE CONSTRUCTED ON CONTOURS DOWN SLOPE OF DISTURBED AREAS, DETAILS ON SHEET THREE 3.
16. FIBER ROLL LOCATION(S), OTHER EROSION, & SEDIMENT CONTROL MEASURES WERE SPECIFICALLY PLACED BASED ON TOPOGRAPHY OF ENCLOSED MAP. MINOR CHANGES TO THE PROPOSED DEVELOPMENT THAT WOULD CHANGE THE ASSUMED DIRECTION OF SURFACE FLOWS SHOULD APPROPRIATELY CHANGE THE LOCATION OF FIBER ROLLS STATED IN NOTE 15.

DISPOSAL OF EXCAVATED MATERIALS:

17. APPROXIMATELY 29,000 CU. YDS. OF MATERIAL WILL BE GRADED ON SITE. NO SOIL TO BE REMOVED FROM SITE, CUT= FILL.
18. CUT SLOPES ARE NOT TO EXCEED 1:1 & FILL SLOPES ARE NOT TO EXCEED 1.5:1 OR LESS AS PER PLANS; RUNOFF FROM ROOF/DRIVEWAY SHALL BE DIRECTED AWAY FORM CUT & FILL AREAS.
19. EROSION OF EXPOSED EXCAVATED MATERIALS WILL BE PREVENTED BY COMPACTING TO 85% BY TRACKING W/ HEAVY EQUIPMENT, 90% RC FOR AGRICULTURAL STRUCTURES AND 95% FOR FILL SUPPORTING RESIDENTIAL STRUCTURES IN EIGHT INCH LIFTS. MULCHING, & RE-SEEDING IMMEDIATELY FOLLOWING PLACEMENT, IF APPLICABLE.

REMOVAL OF VEGETATION & REVEGETATION:

20. EXISTING VEGETATION SHALL BE PROTECTED BY ESTABLISHING THE CONSTRUCTION BOUNDARY PRIOR TO COMMENCEMENT OF SOIL-DISTURBING ACTIVITIES.
21. EXISTING VEGETATION TO BE DISTURBED BY GRADING ACTIVITIES SHALL BE REPLACE W/ NATIVE GRASSES.
22. ALL EXPOSED CUT &/OR FILL SLOPES SHOULD BE RE-VEGETATED TO MATCH EXISTING VEGETATION IN SURROUNDING AREA.
23. CUT &/OR FILL SLOPES ARE LESS THAN NATURALLY OCCURRING SLOPES THAT SUPPORT PERMANENT VEGETATION.
24. SITE WILL BE MONITORED ON A DAILY BASIS DURING PERIODS OF HEAVY RAIN OR WIND. REAPPLICATION OF STRAW MULCH OR RE-SEEDING SHOULD BE COMPLETED AS NECESSARY.

NO.	DATE	DESCRIPTION

A.M. Baird
 Engineering & Surveying, Inc.
 1257 Main Street., P.O.Box 396,
 Fortuna, CA 95540, (707) 725-5182

SCALE: N/A
 DRAWN BY: AMB
 CHECKED: AMB
 DATE: 9/30/2021

KEVIN PEAK
 APN 216-082-006
 HUMBOLDT CO. CA,
 GRADED FLAT
GEC NOTES

JOB #
 20-4905
 SHEET # **05** OF 6



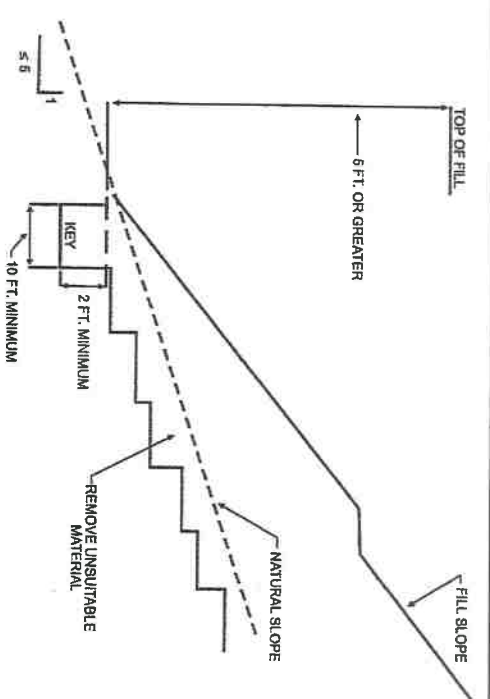

For SI: 1 foot = 304.8 mm.

FIGURE J107.3
BENCHING DETAILS

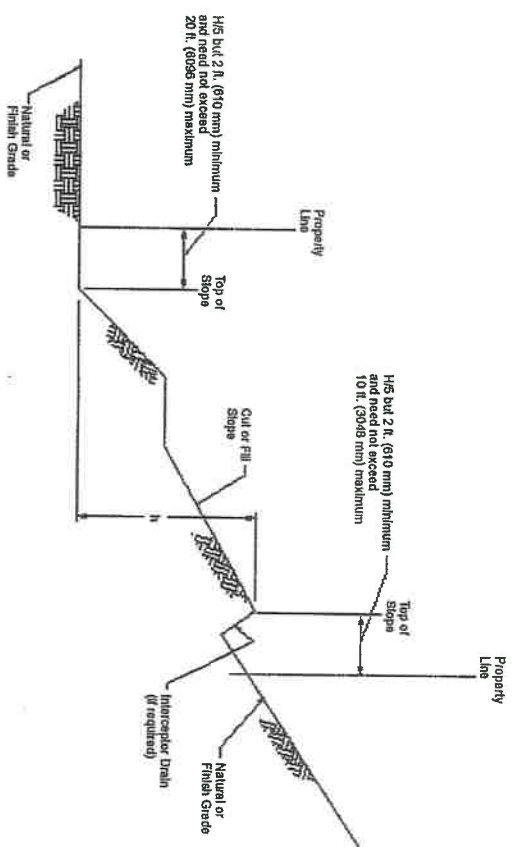

For SI: 1 foot = 304.8 mm.

EXCAVATION NOTES (CBC, 2019 SECTION J106):

1. **MAXIMUM SLOPE:** THE SLOPE OF CUT SURFACES SHALL BE NO STEEPER THAN IS SAFE FOR THE INTENDED USE, & SHALL BE NO STEEPER THAN ONE UNIT VERTICAL IN TWO UNITS HORIZONTAL (50%) SLOPE UNLESS THE OWNER(S) AUTHORIZED AGENT FURNISHES A GEOTECHNICAL REPORT JUSTIFYING A STEEPER SLOPE.
 - 1.1. **EXEMPTIONS:**
 - 1.1.1. A CUT SURFACE SHALL BE REMITTED TO BE AT A SLOPE OF ONE & A HALF UNITS HORIZONTAL TO ONE UNIT VERTICAL (67%) SLOPE PROVIDED THAT ALL OF THE FOLLOWING ARE MET:
 - 1.1.1.1. IT IS NOT INTENDED TO SUPPORT STRUCTURES OR SURCHARGES.
 - 1.1.1.2. IT IS ADEQUATELY PROTECTED AGAINST EROSION.
 - 1.1.1.3. IT IS NO MORE THAN EIGHT FEET (8') IN HEIGHT.
 - 1.1.1.4. IT IS APPROVED BY THE BUILDING CODE OFFICIAL.
 - 1.1.1.5. GROUND WATER IS NOT ENCOUNTERED.
 - 1.1.2. A CUT SURFACE IN BEDROCK SHALL BE PERMITTED TO BE AT A SLOPE OF ONE UNIT HORIZONTAL TO ONE UNIT VERTICAL (100%) SLOPE.

SETBACKS NOTES (CBC, 2019 SECTION J108):

1. **GENERAL:** CUT & FILL SLOPES SHALL BE SET BACK FROM THE PROPERTY LINES IN ACCORDANCE W/ THIS SECTION. SETBACK DIMENSIONS SHALL BE MEASURED PERPENDICULAR TO THE PROPERTY LINE & SHALL BE AS SHOWN IN FIGURE J108.1, UNLESS SUBSTANTIATING DATA IS SUBMITTED JUSTIFYING REDUCED SETBACKS.
2. **TOP OF SLOPE:** THE SETBACK AT THE TOP OF A CUT SLOPE SHALL BE NOT LESS THAN THAT SHOWN IN FIGURE J108.1, OR THAN IS REQUIRED TO ACCOMMODATE ANY REQUIRED INTERCEPTOR DRAINS, WHICHEVER IS GREATER.
3. **SLOPE PROTECTION:** WHERE REQUIRED TO PROTECT ADJACENT PROPERTIES AT THE TOE OF A SLOPE FROM ADVERSE EFFECTS OF THE GRADING, ADDITIONAL PROTECTION, APPROVED BY THE BUILDING OFFICIAL, SHALL BE INCLUDED. SUCH PROTECTION MAY INCLUDE BUT SHALL NOT BE LIMITED TO:
 - 3.1. SETBACKS GREATER THAN THOSE REQUIRED BY FIGURE J108.1.
 - 3.2. PROVISIONS FOR RETAINING WALLS OR SIMILAR CONSTRUCTION.
 - 3.3. EROSION PROTECTION OF THE FILL SLOPES.
 - 3.4. PROVISION FOR THE CONTROL OF SURFACE WATERS.

FILL NOTES (CBC, 2019 SECTION J107):

1. **GENERAL:** UNLESS OTHERWISE RECOMMENDED IN A GEOTECHNICAL REPORT, FILL SHALL COMPLY W/ PROVISIONS BELOW.
2. **SURFACE PREPARATION:** THE GROUND SURFACE SHALL BE PREPARED TO RECEIVE FILL BY REMOVING VEGETATION, TOPSOIL, & OTHER UNSUITABLE MATERIALS, & SCARPING THE GROUND TO PROVIDE A BOND W/ THE FILL MATERIAL.
3. **BENCHING:** WHERE EXISTING GRADE IS AT A SLOPE STEEPER THAN ONE UNIT VERTICAL IN FIVE UNITS HORIZONTAL (20%) SLOPE & THE DEPTH OF THE FILL EXCEEDS FIVE FEET; BENCHING SHALL BE PROVIDED IN ACCORDANCE WITH FIGURE J107.3. A KEY SHALL BE PROVIDED THAT IS AT LEAST TEN FEET IN WIDTH & TWO FEET IN DEPTH.
4. **FILL MATERIAL:** FILL MATERIAL SHALL NOT INCLUDE ORGANIC, FROZEN, OR OTHER DELETERIOUS MATERIALS. NO ROCKS OR SIMILAR IRREDUCIBLE MATERIAL GREATER THAN 12" IN ANY DIMENSION SHALL BE INCLUDED IN FILLS.
5. **COMPACTION:** ALL FILL MATERIAL SHALL BE COMPACTED BY METHODS THAT WILL ACHIEVE 90% OF MAXIMUM DENSITY. AT A MINIMUM, LIFTS NOT EXCEEDING 8" IN DEPTH, SHALL BE COMPACTED WITH HEAVY EQUIPMENT/SHEEPS FOOT OR EQUIVALENT MECHANICAL METHOD.
6. **MAXIMUM SLOPE:** THE SLOPE OF FILL SURFACES SHALL NOT BE STEEPER THAN IS SAFE FOR THE INTENDED USE. FILL SLOPES STEEPER THAN ONE UNIT VERTICAL IN TWO UNITS HORIZONTAL (50%) SLOPE SHALL BE JUSTIFIED BY A GEOTECHNICAL REPORT OR ENGINEERING DATA.

DRAINAGE & TERRACING NOTES (CBC, 2019 SECTION J109):

1. **GENERAL:** UNLESS OTHERWISE RECOMMENDED BY A REGISTERED DESIGN PROFESSIONAL, DRAINAGE FACILITIES & TERRACING SHALL BE PROVIDED IN ACCORDANCE W/ THE REQUIREMENTS OF THIS SECTION.

EXCEPTION: DRAINAGE FACILITIES & TERRACING NEED NOT BE PROVIDED WHERE THE GROUND SLOPE IS NOT STEEPER THAN ONE UNIT VERTICAL IN THREE UNITS HORIZONTAL (33%) SLOPE.
2. **TERRACES:** TERRACES AT LEAST SIX FEET (6') IN WIDTH SHALL BE ESTABLISHED AT NOT MORE THAN 30' VERTICAL UNIT INTERVALS ON ALL CUT OR FULL SLOPES TO CONTROL SURFACE DRAINAGE & DEBRIS. SUITABLE ACCESS SHALL BE PROVIDED TO ALLOW FOR CLEANING & MAINTENANCE. WHERE MORE THAN TWO TERRACES ARE REQUIRED, ONE TERRACE, LOCATED AT APPROXIMATELY MID-HEIGHT, SHALL BE AT LEAST 12' IN WIDTH.

SWALES OR DITCHES SHALL BE PROVIDED ON TERRACES. THEY SHALL HAVE A MINIMUM GRADIENT OF ONE UNIT VERTICAL IN 20 UNITS HORIZONTAL (5%) SLOPE & SHALL BE PAVED W/ CONCRETE NOT LESS THAN THREE INCHES (3") IN THICKNESS, OR W/ OTHER MATERIAL SUITABLE TO THE APPLICATION. THEY SHALL HAVE A DEPTH NOT LESS THAN 12 INCHES (12") & A WIDTH NOT LESS THAN FIVE FEET (5').

A SINGLE RUN OF SWALES OR DITCH SHALL NOT COLLECT RUNOFF FROM A TRIBUTARY AREA EXCEEDING 13,500 SQUARE FEET W/OUT DISCHARGING INTO A DOWN DRAIN.
3. **INTERCEPTOR DRAINS:** INTERCEPTOR DRAINS SHALL BE INSTALLED ALONG THE TOP OF CUT SLOPES RECEIVING DRAINAGE FROM A TRIBUTARY WIDTH GREATER THAN 40 FEET (40'), MEASURED HORIZONTALLY. THEY SHALL HAVE A MINIMUM DEPTH OF ONE FOOT & A MINIMUM WIDTH OF THREE FEET (3'). THE SLOPE SHALL BE APPROVED BY THE BUILDING OFFICIAL, BUT SHALL BE NOT LESS THAN ONE UNIT VERTICAL IN 50 UNITS HORIZONTAL (2%) SLOPE. THE DRAIN SHALL BE PAVED W/ CONCRETE NOT LESS THAN THREE INCHES (3") IN THICKNESS, OR BY OTHER MATERIALS SUITABLE TO THE APPLICATION. DISCHARGE FROM THE DRAIN SHALL BE ACCOMPLISHED IN A MANNER TO PREVENT EROSION & SHALL BE APPROVED BY THE BUILDING OFFICIAL.
4. **DRAINAGE ACROSS PROPERTY LINE:** DRAINAGE ACROSS PROPERTY LINES SHALL NOT EXCEED THAT WHICH EXISTED PRIOR TO GRADING. EXCESS OR CONCENTRATED DRAINAGE SHALL BE CONTAINED ON SITE OR DIRECTED TO AN APPROVED DRAINAGE FACILITY. EROSION OF THE GROUND IN THE AREA OF DISCHARGE SHALL BE PREVENTED BY INSTALLATION OF NON-EROSIVE DOWN DRAINS OR OTHER DEVICES.

NO.	DATE	DESCRIPTION

A.M. Baird
Engineering & Surveying, Inc.
1257 Main Street., P.O. Box 396,
Fortuna, CA 95540, (707) 725-5182

SCALE: NTS
DRAWN BY: MM
CHKD: A.M.B.
DATE: 9/30/2021

KEVIN PEAK
APN 216-082-006
HUMBOLDT CO. CA,
GRADED FLAT
CUT, FILL, & BENCHING

JOB #
20-4905
SHEET # **6** of 6

