



## DEPARTMENT OF FORESTRY AND FIRE PROTECTION

135 Ridgway Ave.  
 Santa Rosa, CA 95401  
 Website: [www.fire.ca.gov](http://www.fire.ca.gov)  
 (707) 576-2959



Date: February 21, 2014  
 Ref.: 1-14EX-048-HUM

CHRISTOPHER CARROLL  
 165 S FORTUNA BLVD STE 4  
 FORTUNA, CA 95540

Dear MR. CARROLL:

This is to acknowledge that your **Less Than 3 Acre Conversion Exemption** was accepted on **February 19, 2014**. It has been assigned the above listed Exemption number. All timber operations must be complete within one year. All conversion activities must be complete within two years, unless under permit by local jurisdiction.

**\*\*\*Please read the enclosed notice regarding Listed Anadromous Salmonids, Slash Clean-up, Sudden Oak Death, Pitch Canker, and Operations between October 15 – May 1.\*\*\***

In addition, please note the requirement for submittal of the Timber Operations Work Completion and/or Stocking Report (blue form) upon completion of the project.

Compliance with all provisions of the Forest Practice Act, rules pursuant to Section 1104.1(a)--Title 14 of the California Code of Regulations, will be determined by future inspection(s).

If you have any questions you may contact your local CAL FIRE Forest Practice Inspector or me at (707) 576-2959.

Sincerely,

Dominik Schwab  
 Forester II, Forest Practice  
 RPF #2823

## Enclosure

cc: Unit  
 Fish & Wildlife  
 Water Quality  
 County Planning  
 Board of Equalization  
 TO/TLO/PS – Sarah Garcia  
 LTO – McKnight Redimix  
 File

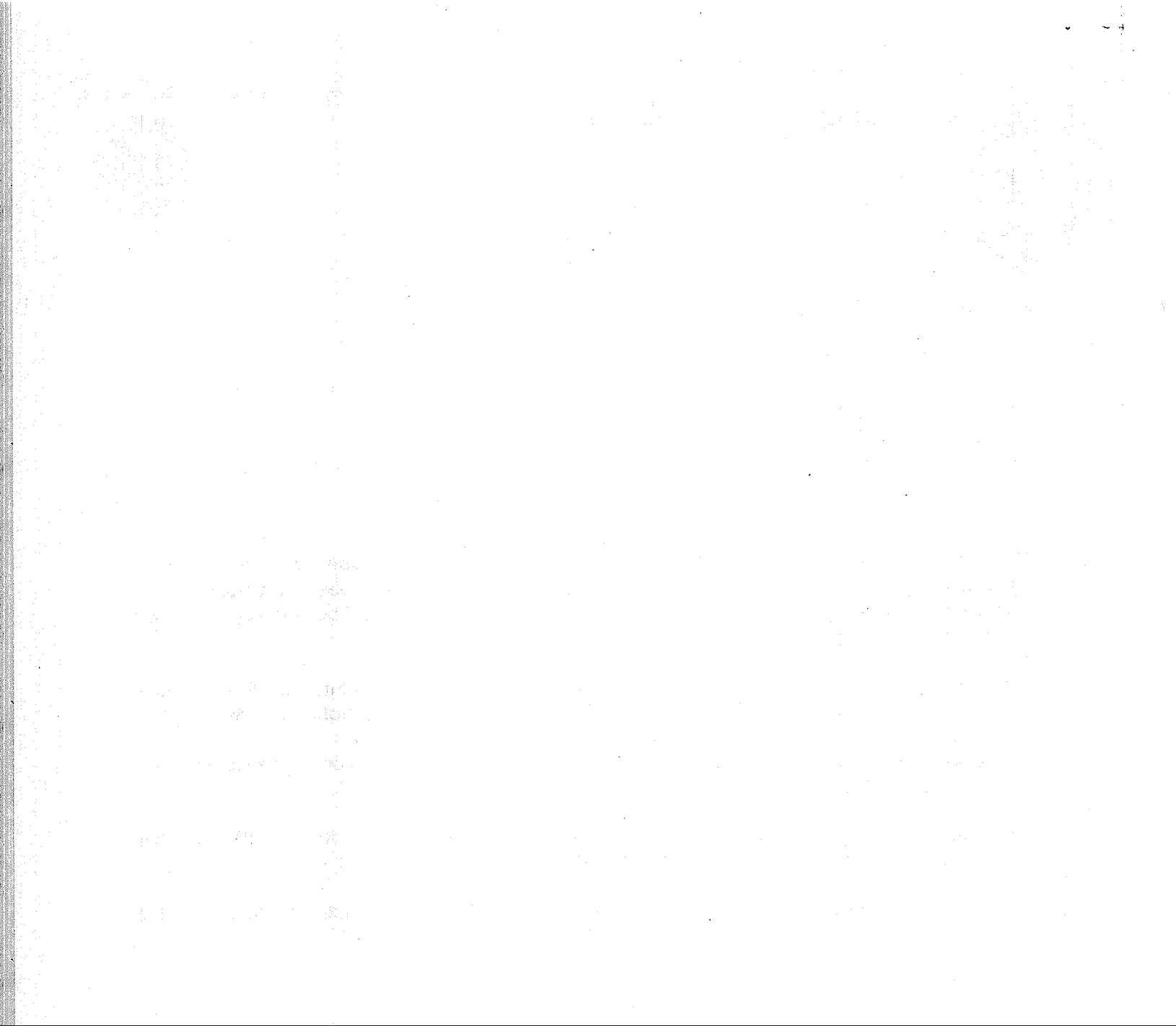

LESS THAN 3 ACRE CONVERSION EXEMPTION

STATE OF CALIFORNIA  
 DEPARTMENT OF FORESTRY AND FIRE PROTECTION  
 NOTICE OF TIMBER OPERATIONS THAT ARE EXEMPT FROM  
 CONVERSION AND TIMBER HARVESTING PLAN REQUIREMENTS  
 RM-73 (1104.1a) (11/12)

FOR ADMIN. USE ONLY **VDS**  
 Ex. # **1-14EX-048 HUM**  
 Date of Receipt **FEB 13 2014**  
 Date Accepted **FEB 19, 2014**  
 Date Expires **FEB 18 2015**

**VALID FOR ONE YEAR FROM DATE OF RECEIPT BY CAL FIRE  
 TIMBER OPERATIONS CANNOT START UNTIL VALID COPY  
 OF A NOTICE OF ACCEPTANCE IS RECEIVED FROM CAL FIRE**

The Director of the Department of Forestry and Fire Protection (CAL FIRE) is hereby notified of timber operations under the requirements of 14 CCR § 1104.1(a): Harvesting of trees that is a single conversion to a non-timber growing use of timberland of less than three acres. (See 14 CCR § 1104.1(a) for a description of the conditions on the conduct of this type of timber operation and additional information that is **required** to be submitted.) Complete Items 1 through 8 on both pages of this notice.

1. TIMBER OWNER(S) OF RECORD: **Sarah Garcia**

Address: **830 D Street, Apartment 1**

City: **Arcata** State: **CA** Zip: **95521** Phone: **707-834-3439**

TIMBER TAX EXEMPTION: Timber owners owe timber yield tax when they harvest trees unless the harvest is exempt (Revenue and Taxation Code sec. 38116). Some small or low value harvests may be exempt from timber yield tax: Timber removed from an operation whose value does not exceed \$3,000 within a quarter, according to BOE Harvest Value Schedules, Rule 1024. If you believe your harvest may qualify for this exemption, please complete Items A and B below. **For timber yield tax information or for further assistance with these questions call the State Board of Equalization, 1-800-400-7115, or write: Timber Tax Section, MIC: 60, State Board of Equalization, P.O. Box 942879, Sacramento, California 94279-0060; or contact the BOE Web Page on the Internet at <http://www.boe.ca.gov>.**

A. Circle the option that most closely estimates the total volume for this harvest, in thousands of board feet (mbf - Net Scribner short log):

Under 8 mbf      8-15 mbf      **16-25 mbf**      Over 25 mbf

B. Estimate the species composition of the timber that will be removed during this harvest (numbers should sum to 100%):

Redwood \_\_\_\_\_%; Ponderosa/Sugar pine \_\_\_\_\_%; **Douglas-fir 5%**; Fir \_\_\_\_\_%;  
 Port-Orford Cedar \_\_\_\_\_%; Cedar (IC, WRC) \_\_\_\_\_%; Other conifer \_\_\_\_\_%; **Other hardwood 95%**

2. TIMBERLAND OWNER(S) OF RECORD: **Sarah Garcia**

Address: **830 D Street, Apartment 1**

City: **Arcata** State: **CA** Zip: **95521** Phone: **707-834-3439**

**I certify, under penalty of perjury, that this is a one-time conversion to a non-timberland use and that there is a "bona fide intent" [14 CCR § 1100(b)] to convert to Agriculture and Homesite**

SIGNATURE *Sarah Garcia* Date 2/4/14

3. LICENSED TIMBER OPERATOR(S): **McKnight Redimix** Lic. No. **A-8896**

Address: **P.O. Box 38**

City: **Salyer** State: **CA** Zip: **95563** Phone: **530-629-2070**

SIGNATURE *Tom McKnight* Date 2-6-14

4. Designate the legal land description of the location of timberland conversion. A map showing the location of the timberland conversion MUST be attached. The map must show the ownership boundaries, the location of the timber operation, boundaries of the conversion, location and classification of all watercourses, and landing locations.

Section	Township	Range	Base & Meridian	County	Acreage to be Converted	Assessors Parcel Number
18	7N	4E	Humboldt	Humboldt	2.9	522-021-08

**RECEIVED**

**FEB 13 2014**

COAST AREA OFFICE  
 RESOURCE MANAGEMENT

5. The following are limitations or requirements for timber operations conducted under a Less Than Three Acre Conversion Exemption (Notice, Notice of Conversion Exemption, Conversion Exemption):
- A. Timber operations shall comply with all other applicable provisions of the Forest Practice Act and regulations, county general plans, zoning ordinances, and any implementing ordinances; copies of the state rules and regulations may be found on CAL FIRE's Web Page on the Internet at <http://www.fire.ca.gov>.
  - B. All timber operations shall be complete within one year from the date of acceptance by CAL FIRE.
  - C. All conversion activities shall be complete within two years from the date of acceptance by CAL FIRE unless under permit by local jurisdiction. Failure to complete the conversion requires compliance with stocking standards and stocking report requirements of the Forest Practice Act and Board of Forestry and Fire Protection regulations.
  - D. The timber operator shall remove or dispose of all slash or woody debris in accordance with 14 CCR § 1104.1(a)(2)(D)(1)-(9). The timberland owner may assume responsibility for the slash treatment, provided the landowner acknowledges in writing to CAL FIRE such responsibility at the time of submission of this notice. The specific requirements shall be included with the acknowledgement.
  - E. Timber operations may be conducted during the winter period. Tractor operations in the winter period are allowed under any of the conditions described in 14 CCR § 1104.1(a)(2)(E)1-3.
  - F. No timber operations are allowed within a watercourse and lake protection zone unless specifically approved by local permit (e.g., county, city).
  - G. No timber operations shall be conducted until CAL FIRE's notice of acceptance is received and a valid copy of this notice and CAL FIRE's acceptance shall be kept on site during timber operations.
  - H. No sites of rare, threatened or endangered plants or animals or species of special concern shall be disturbed, threatened, or damaged.
  - I. No timber operations are allowed on significant historical or archeological sites.
  - J. Within one month of the completion of timber operations, including slash disposal, the timberland owner shall submit a work completion report to CAL FIRE.
  - K. A violation of the conversion exemption, including a conversion applied for in the name of someone other than the person or entity implementing the conversion in bona fide good faith, are violations of the Forest Practice Act and penalties may accrue up to ten thousand dollars (\$10,000) for each violation pursuant to Article 8 (commencing with Section 4601).

6. I, \_\_\_\_\_, declare as the authorized designee of the County Board of Supervisors that this conversion exemption is in conformance with all county regulatory requirements, including public notice. (If the county has authorized a designee this item **MUST be completed. If it has not, see Item 7.**)

SIGNATURE \_\_\_\_\_ Date \_\_\_\_\_

7. Registered Professional Forester preparing Notice: **Chris Carroll** Number **2628**

Address **Timberland Resource Consultants, 165 South Fortuna Blvd, Suite 4**

City **Fortuna** State **CA** Zip **95540** Phone **707-725-1897**

I have, or my supervised designee has, (1) prepared this Notice of Conversion Exemption Timber Operations; (2) visited the site and flagged the boundaries of the conversion exemption, applicable WLPZs and equipment limitation zones; (3) prepared a Neighborhood Notice of Conversion Exemption according to 14 CCR § 1104.1(a)(3) to be mailed by the landowner to adjacent landowners; and (4) posted and dated a copy of the Neighborhood Notice of Conversion Exemption on the ownership, visible to the public, at least 5 days prior to the postmark date of submission of the Notice of Conversion Exemption. I certify that if the County Board of Supervisors has not designated a representative authorized to sign in Item 6 that I, or my supervised designee, contacted the county and the Notice is in conformance with county regulations.

SIGNATURE of RPF Chris Carroll Date 2-13-14

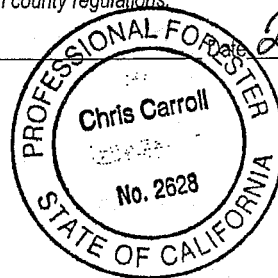

8. NOTICE SUBMITTER(S): **Sarah Garcia**

Address: **830 D Street, Apartment 1**

City: **Arcata** State: **CA** Zip: **95521** Phone: **707-834-3439**

Submitter must be 1, 2, or 3 above, and must sign.

SIGNATURE Sarah Garcia Date 2/9/14

FILE THIS NOTICE WITH THE CAL FIRE OFFICE BELOW FOR THE COUNTY IN WHICH THE OPERATION WILL OCCUR

Forest Practice, CAL FIRE 135 Ridgway Avenue Santa Rosa, CA 95401	Forest Practice, CAL FIRE 6105 Airport Road Redding, CA 96002	Forest Practice, CAL FIRE 1234 East Shaw Avenue Fresno, CA 93710
Alameda, Colusa, Contra Costa, Del Norte, Humboldt, Lake, Marin, Mendocino, Napa, San Mateo, Santa Clara, Santa Cruz, Solano, Sonoma, western Trinity and Yolo Counties	Butte, Glenn, Lassen, Modoc, Nevada, Placer, Plumas, Shasta, Sierra, Siskiyou, Sutter, Tehama, eastern Trinity and Yuba Counties	Alpine, Amador, Calaveras, El Dorado, Fresno, Imperial, Inyo, Kern, Los Angeles, Madera, Mariposa, Merced, Mono, Monterey, Orange, Riverside, San Benito, San Bernardino, San Diego, San Luis Obispo, Santa Barbara, Stanislaus, Tuolumne, Tulare, and Ventura Counties

RECEIVED

FEB 13 2014

COAST AREA OFFICE

# Garcia Conversion Exemption Operations Map

 Property Boundary

 Conversion Areas

 Jeep Road

 Existing Seasonal Truck Road

 Proposed Seasonal Road

 Landing Location

 Class III Watercourse

 Class II Wet Area

Map Scale 1" = 250'  
Section 18; T7N, R4E, HB&M

Ag Sites →

Home Site

RECEIVED

FEB 13 2014

COAST AREA OFFICE  
RESOURCE MANAGEMENT



# Garcia Conversion Exemption General Location Map



Property Boundary



Conversion Exemption Areas

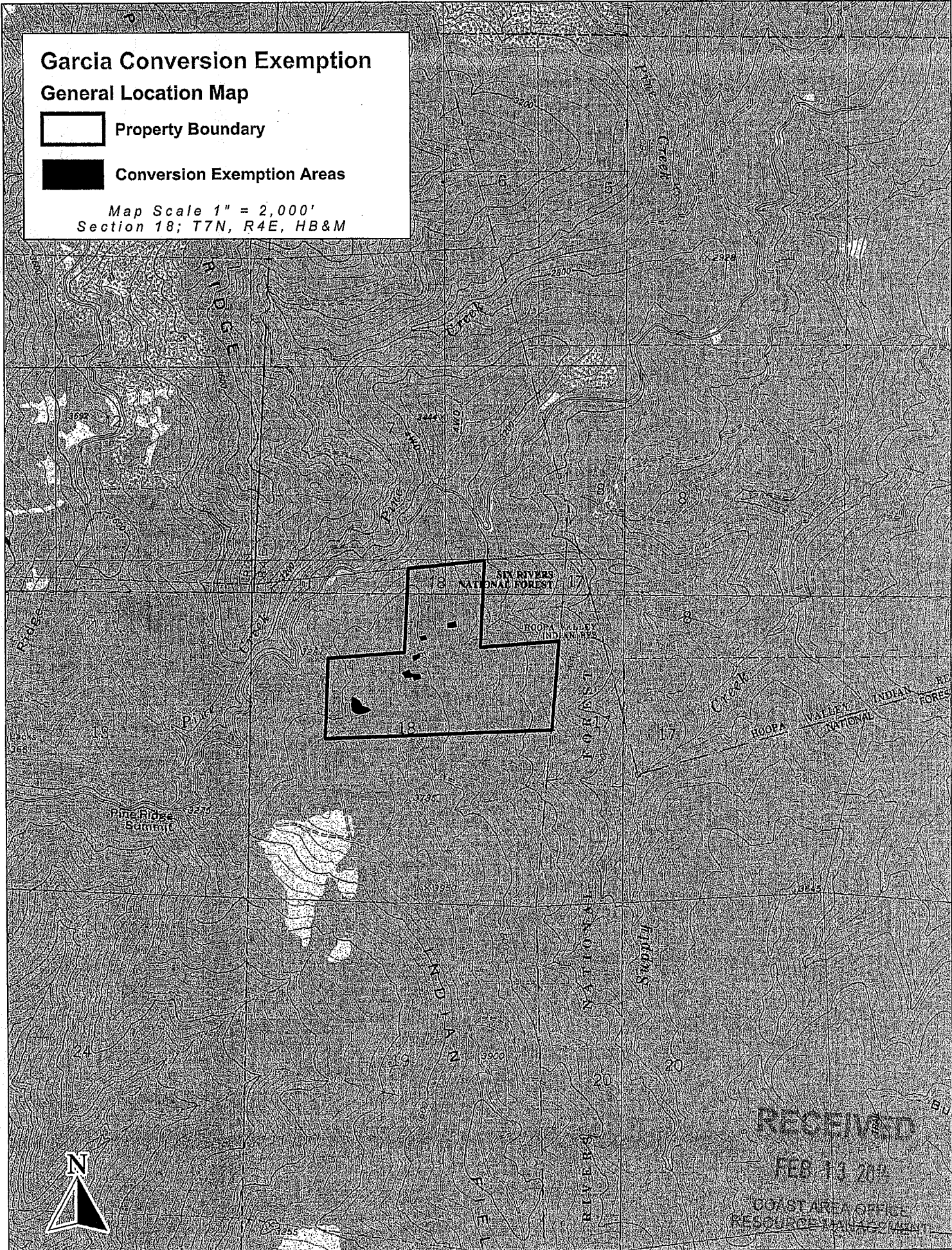

Map Scale 1" = 2,000'  
Section 18; T7N, R4E, HB&M

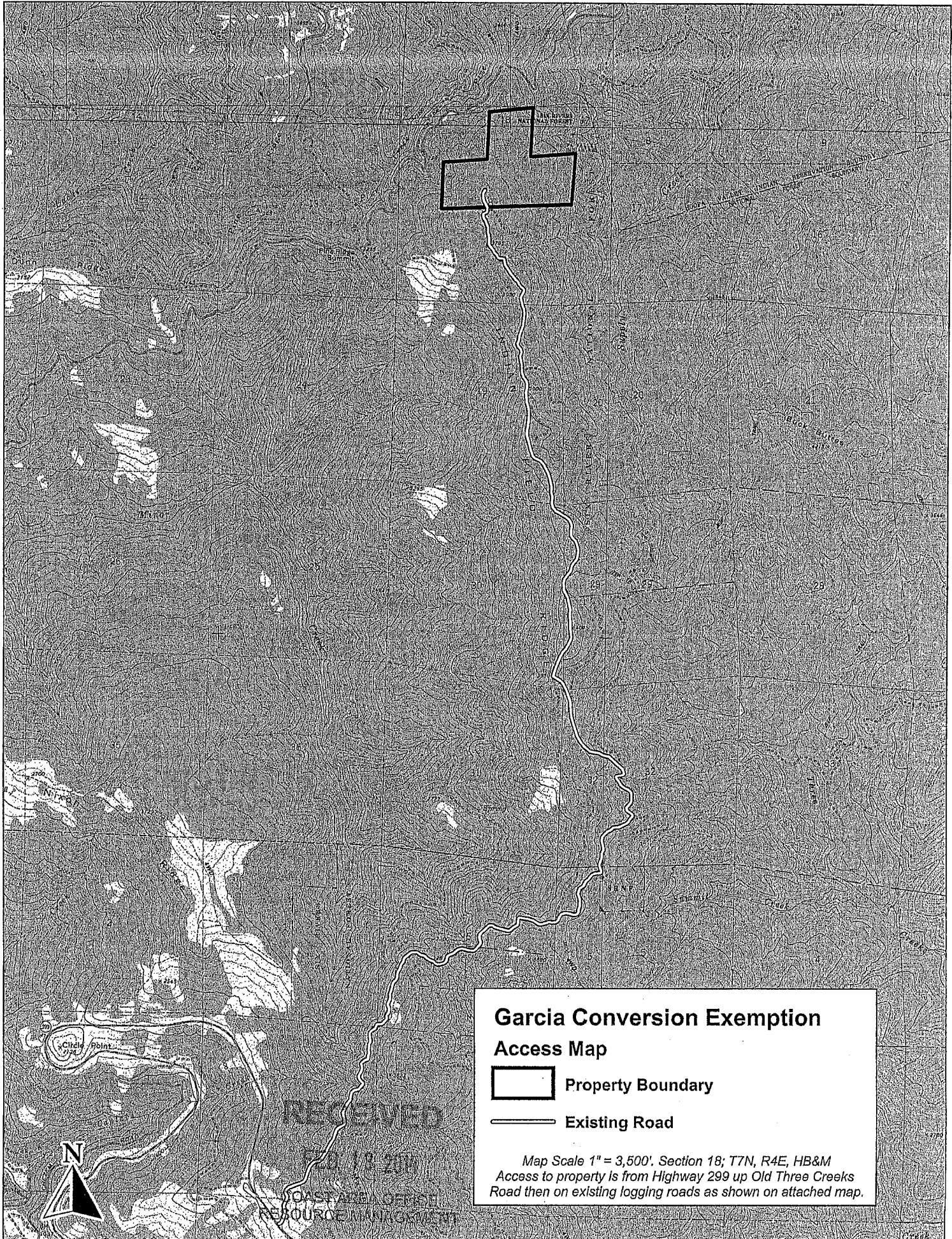

RECEIVED  
FEB 13 2014  
CONSTATE OFFICE  
RESOURCE MANAGEMENT



### Garcia Conversion Exemption Access Map

-  Property Boundary
-  Existing Road

Map Scale 1" = 3,500'. Section 18; T7N, R4E, HB&M  
Access to property is from Highway 299 up Old Three Creeks  
Road then on existing logging roads as shown on attached map.

RECEIVED

FEB 17 2014

COSTA AREA OFFICE  
RESOURCE MANAGEMENT



## **Project Description**

This conversion proposes to convert timberland into a home site and agriculture. Per the Humboldt County General Plan, the conversion exemption area is presently zoned Timber Production (TPZ). Humboldt County's Grading and Open Space Ordinance does not apply to this project because the conversion exemption area is zoned TPZ, and the property is greater than 3 acres in size. Consequently, Item 6 is not signed by the County's designee. The RPF has attached an e-mail from Humboldt County Planning, which states that no County review is required for Less Than 3-Acre Conversion Exemptions on TPZ lands. Agriculture is a principally permitted activity on TPZ lands

### **Addendum 14CCR 1104.1(a)(1)(E)(1-4)**

The timberland owner has certified via her signature, under penalty of perjury, that this is a one-time conversion to Agriculture & Home Site. The timberland owner understands that a "Bona Fide Intention or bona fide intent" is a present, sincere intention of the applicant to conform with and successfully execute the conversion plan, as determined by the Director in accordance with provisions of Sec. 1105.2 (Ref.: Sec. 4623, PRC). The timberland owner, acting as an individual, acting as a member of a partnership, or acting as an officer or employee of a corporation or other legal entity, has not obtained an exemption pursuant to this section in the last five years.

### **Addendum 14CCR 1104.1(a)(2)(F)**

There are no watercourses, ELZs, or WLPZs within the conversion exemption area. As shown on the Conversion Exemption Map, a Class II Wet Area is located near the western-most conversion site (home-site area). The harvest boundary was flagged a minimum distance of 50 feet from the transition line of the wet area.

### **Addendum 14CCR 1104.1(a)(6)**

#### **The extent of the vegetation removal and site preparation required for the conversion;**

The home site conversion area consists of merchantable tanoak, Chinquapin, madrone, and a minor component of Douglas-fir. The agricultural sites are located within the footprint of THP 1-05-188 HUM, which consists of +/- 7-year old ponderosa pine, Douglas-fir and tanoak regeneration. The majority of the site preparation will consist of removing stumps and old logging slash, which shall be treated per 14CCR 1104.1(a)(2)(D) as described on the following page. Grading and excavation shall be required but no significant earthwork is necessary to successfully convert the sites. Due to the gentle topography, no significant excavation will be necessary to make the site useable for their intended use.

#### **The suitability of soils, slope, aspect, and microclimate for the stated non-timber use;**

The conversion exemption area's slopes are nearly flat with all aspects represented and thus are favorable for agriculture and a home site. The soils are inadequate for agriculture but grow medium is imported and therefore not a limiting factor.

**RECEIVED**

**FEB 13 2014**

**COAST AREA OFFICE  
RESOURCE MANAGEMENT**



## **Addendum 14CCR 1104.1(a)(2)(D) - Treatment of Logging Slash and Woody Debris.**

1. Unless otherwise required, slash greater than one inch in diameter and greater than two feet long, and woody debris, except pine, shall receive full treatment no later than April 1 of the year following its creation, or within one year from the date of acceptance of the conversion exemption by the Director, whichever comes first.
2. All pine slash three inches and greater in diameter and longer than four feet must receive initial treatment if it is still on the parcel, within 7 days of its creation.
3. All pine woody debris longer than four feet must receive an initial treatment prior to full treatment.
4. Initial treatment shall include limbing woody debris and cutting slash and woody debris into lengths of less than four feet, and leaving the pieces exposed to solar radiation to aid in rapid drying.
5. Full treatment of all pine slash and woody debris must be completed by March 1 of the year following its creation, or within one year from the date of acceptance of the conversion exemption by the Director, whichever comes first.
6. Full slash and woody debris treatment may include any of the following:
  - a. Burying;
  - b. Chipping and spreading;
  - c. Piling and burning; or
  - d. Removing slash and woody debris from the site for treatment in compliance with (a)-(b). Slash and woody debris may not be burned by open outdoor fires except under permit from the appropriate fire protection agency, if required, the local air pollution control district or air quality management district. The burning must occur on the property where the slash and woody debris originated.
7. Slash and woody debris, except for pine, which is cut up for firewood shall be cut to lengths 24 inches or less and set aside for drying by April 1 of the year following its creation. Pine slash and woody debris which is cut up for firewood shall be cut to lengths 24 inches or less and set aside for drying within seven days of its creation.
8. Any treatment which involves burning of slash or woody debris shall comply with all state and local fire and air quality rules.

**RECEIVED**

**FEB 13 2014**

**COAST AREA OFFICE  
RESOURCE MANAGEMENT**

# WINTER OPERATING PLAN

1. The erosion hazard rating for the conversion exemption area is moderate.
2. Mechanical site preparation is proposed.
3. The yarding system for the conversion exemption is ground based.
4. This Winter Operating Plan is for all timber operations occurring from October 15 to May 1.
5. No watercourses occur the conversion exemption area.
6. Use of logging roads, tractor roads, or landings shall not take place at any location where "Saturated Soil Conditions" exist, where a "Stable Operating Surface" does not exist, or when visibly turbid water from the road, landing, or skid trail surface or inside ditch may reach a watercourse or lake.
7. No unstable areas occur within or nearby the conversion exemption area.
8. Winter Operations Restrictions:
  - a. Logging roads, landings or tractor roads shall not be used when visibly turbid water from the road, landing or tractor road (skid trail) or an inside ditch associated with the logging road, landing or tractor road may reach a watercourse or lake in amounts sufficient to cause a turbidity increase in Class I, II, III or IV waters.
  - b. Log hauling on logging roads and landings shall be limited to those which are hydrologically disconnected from watercourses to the extent feasible, and exhibit a stable operating surface.
  - c. Concurrent with use for log hauling, approaches to logging road watercourse crossings shall be treated for erosion control as needed to minimize soil erosion and sediment transport and to prevent the discharge of sediment into watercourses and lakes in quantities deleterious to the beneficial uses of water.
  - d. Concurrent with use for log hauling, all traveled surfaces of logging roads in a WLPZ or within any ELZ or EEZ designated for watercourse or lake protection shall be treated for erosion control as needed to minimize soil erosion and sediment transport and to prevent the discharge of sediment into watercourses and lakes in quantities deleterious to the beneficial uses of water.
  - e. Grading to obtain a drier running surface more than one time before reincorporation of any resulting berms back into the road surface is prohibited.
  - f. Unless the winter period operating plan proposes operations during an extended wet weather period with low antecedent soil wetness, no tractor roads shall be constructed, reconstructed, or used on slopes that are over 40 percent and within 200 feet of a Class I, II, or III watercourse, as measured from the watercourse or lake transition line during the extended wet weather period.
  - g. Logging roads, landings and tractor roads shall not be used when sediment from the logging road, landing or tractor road surface is transported to a watercourse or a drainage facility that discharges into a watercourse in amounts sufficient to cause a visible increase in turbidity in Class I, II, III, or IV waters.
  - h. Logging roads and landings shall not be used for log hauling when saturated soil conditions result in the visible increase in turbidity specified in Class I, II, III, or IV waters.

**RECEIVED**

FEB 13 2014

COAST AREA OFFICE  
RESOURCE MANAGEMENT

## WINTER OPERATING PLAN (CONT.)

- i. **SATURATED SOIL CONDITIONS:** means that soil and/or surface material pore spaces are filled with water to such an extent that runoff is likely to occur. Indicators of saturated soil conditions may include, but are not limited to: (1) areas of ponded water, (2) pumping of fines from the soil or road surfacing material during timber operations, (3) loss of bearing strength resulting in the deflection of soil or road surfaces under a load, such as the creation of wheel ruts, (4) spinning or churning of wheels or tracks that produces a wet slurry, or (5) inadequate traction without blading wet soil or surfacing materials.
- j. **STABLE OPERATING SURFACE:** means a road or landing surface that can support vehicular traffic and has a structurally sound road base appropriate for the type, intensity and timing of intended use.

**RECEIVED**

**FEB 13 2014**

**COAST AREA OFFICE  
RESOURCE MANAGEMENT**

# Additional Information

**RECEIVED**

**FEB 13 2014**

**COAST AREA OFFICE  
RESOURCE MANAGEMENT**

**From:** Estlow, Trevor [TEstlow@co.humboldt.ca.us]  
**Sent:** Thursday, July 09, 2009 10:18 AM  
**To:** distefano@timberlandresource.com  
**Subject:** Re: Less than 3-acre Conversion Exemptions  
Mark-

Anita asked me to follow up on an email you had sent her regarding Less Than 3-Acre Conversion Exemptions. For non-TPZ lands, the County requires a Building Inspector to verify that there are no Streamside Management Areas or other sensitive habitat in order to sign off the exemption. In residential areas, it may require a Special Permit from the Planning Division. On TPZ lands, no County review is required for Less Than 3-Acre Conversion Exemptions or 150-foot Fire Hazard Exemptions. Hope this answers your questions. Please contact me if you have any additional questions.

Sincerely,

**Trevor Estlow, Senior Planner**

County of Humboldt, Planning Division

3015 H Street

Eureka, CA 95501

Phone: (707) 268-3740

Fax: (707) 445-7446

Email: [testlow@co.humboldt.ca.us](mailto:testlow@co.humboldt.ca.us)

**RECEIVED**

**FEB 13 2014**

COAST AREA OFFICE  
RESOURCE MANAGEMENT

# Less Than 3-acre Conversion NOTICE OF TIMBER OPERATIONS

Date of Posting of this Notice: February 6, 2014

A Conversion exemption that may be of interest to you will be submitted to the California Department of Forestry & Fire Protection. The California Department of Forestry & Fire Protection will be reviewing the proposed timber operation for compliance with various laws and rules. The following briefly describes the proposed conversion exemption and where and how to get more information. Questions about the proposed conversion exemption or laws and rules governing timber operations should be directed to:

California Department of Forestry and Fire Protection  
Forest Practice Program  
135 Ridgeway Avenue  
Santa Rosa, CA 95402  
(707) 576-2959

## Information about the Conversion Exemption is as follows:

1. TIMBER OWNER OF RECORD: Sarah Garcia  
Address 830 D Street, Apartment 1  
City Arcata State CA Zip 95521 Phone 707-834-3439
2. TIMBERLAND OWNER OF RECORD: Sarah Garcia  
Address 830 D Street, Apartment 1  
City Arcata State CA Zip 95521 Phone 707-834-3439
3. LICENSED TIMBER OPERATOR: McKnight Redimix Lic. No. A-8896  
Address: P.O. Box 38  
City: Salyer State: CA Zip: 95563 Phone: 530-629-2070
4. REGISTERED PROFESSIONAL FORESTER PREPARING NOTICE: Chris Carroll Number 2628  
Address Timberland Resource Consultants, 165 South Fortuna Blvd, Suite 4  
City Fortuna State CA Zip 95540 .Phone (707) 725-1897
5. AGENCY OF HUMBOLDT COUNTY RESPONSIBLE FOR LAND USE CHANGES: Humboldt County Planning Department
6. PROJECT LOCATION: N½ of Section 18, Township 7 North, Range 4 East, Humboldt County, APN 522-021-008. Located approximately 5.5 miles west-southwest of Hoopa. Access is via Old Three Creeks Road.
7. TYPE OF CONVERSION: This is a conversion from timberland to agriculture and a home site, and the maximum size of the conversion is less than 3 acres.

RECEIVED

FEB 13 2014

COAST AREA OFFICE  
RESOURCE MANAGEMENT



165 South Fortuna Boulevard, Fortuna, CA 95540  
707-725-1897 • fax 707-725-0972  
trc@timberlandresource.com

February 6, 2014

SHARPE STEPHEN W & DEVERÉAUX DENISE & DI-TURO STEP  
4475 FAIRWAY DR  
SOQUEL, CA 95073

As the Registered Professional Forester preparing a Conversion Exemption per 14CCR 1104.1 for Sarah Garcia, I am required by the California Forest Practice Rules to notify all adjacent landowners of this proposed operation with the following information:

1. TIMBER OWNER OF RECORD: Sarah Garcia  
Address 830 D Street, Apartment 1  
City Arcata State CA Zip 95521 Phone 707-834-3439
2. TIMBERLAND OWNER OF RECORD: Sarah Garcia  
Address 830 D Street, Apartment 1  
City Arcata State CA Zip 95521 Phone 707-834-3439
3. LICENSED TIMBER OPERATOR: McKnight Redmix Lic. No. A-8896  
Address: P.O. Box 38  
City: Salyer State: CA Zip: 95563 Phone: 530-629-2070
4. REGISTERED PROFESSIONAL FORESTER PREPARING NOTICE: Chris Carroll Number 2628  
Address Timberland Resource Consultants, 165 South Fortuna Blvd, Suite 4  
City Fortuna State CA Zip 95540 Phone (707) 725-1897
5. AGENCY OF HUMBOLDT COUNTY RESPONSIBLE FOR LAND USE CHANGES: Humboldt County Planning Department
6. PROJECT LOCATION: N½ of Section 18, Township 7 North, Range 4 East, Humboldt County, APN 522-021-008. Located approximately 5.5 miles west-southwest of Hoopa. Access is via Old Three Creeks Road.
7. TYPE OF CONVERSION: This is a conversion from timberland to agriculture and a home site, and the maximum size of the conversion is less than three acres.

Sincerely,

  
Chris Carroll, RPF #2628  
Timberland Resource Consultants

RECEIVED

FEB 13 2014

COAST AREA OFFICE  
RESOURCE MANAGEMENT



165 South Fortuna Boulevard, Fortuna, CA 95540  
707-725-1897 • fax 707-725-0972  
trc@timberlandresource.com

February 6, 2014

BARNUM TIMBER COMPANY LP  
PO BX 1365  
EUREKA CA 95502-1365

As the Registered Professional Forester preparing a Conversion Exemption per 14CCR 1104.1 for Sarah Garcia, I am required by the California Forest Practice Rules to notify all adjacent landowners of this proposed operation with the following information:

1. TIMBER OWNER OF RECORD: Sarah Garcia  
Address 830 D Street, Apartment 1  
City Arcata State CA Zip 95521 Phone 707-834-3439
2. TIMBERLAND OWNER OF RECORD: Sarah Garcia  
Address 830 D Street, Apartment 1  
City Arcata State CA Zip 95521 Phone 707-834-3439
3. LICENSED TIMBER OPERATOR: McKnight Redimix Lic. No. A-8896  
Address: P.O. Box 38  
City: Salyer State: CA Zip: 95563 Phone: 530-629-2070
4. REGISTERED PROFESSIONAL FORESTER PREPARING NOTICE: Chris Carroll Number 2628  
Address Timberland Resource Consultants, 165 South Fortuna Blvd, Suite 4  
City Fortuna State CA Zip 95540 Phone (707) 725-1897
5. AGENCY OF HUMBOLDT COUNTY RESPONSIBLE FOR LAND USE CHANGES: Humboldt County Planning Department
6. PROJECT LOCATION: N½ of Section 18, Township 7 North, Range 4 East, Humboldt County, APN 522-021-008. Located approximately 5.5 miles west-southwest of Hoopa. Access is via Old Three Creeks Road.
7. TYPE OF CONVERSION: This is a conversion from timberland to agriculture and a home site, and the maximum size of the conversion is less than three acres.

Sincerely,

A handwritten signature in cursive script that reads "Chris Carroll".

Chris Carroll, RPF #2628  
Timberland Resource Consultants

RECEIVED

FEB 13 2014

COAST AREA OFFICE  
RESOURCE MANAGEMENT





165 South Fortuna Boulevard, Fortuna, CA 95540  
707-725-1897 • fax 707-725-0972  
trc@timberlandresource.com

February 6, 2014

Native American Heritage Commission  
1550 Harbor Blvd., Room 100  
West Sacramento, CA 95691

Dear Native American Heritage Commission:

As the Registered Professional Forester preparing a Conversion Exemption per 14CCR 1104.1 for Sarah Garcia, I am required by the California Forest Practice Rules to notify all Native Americans of this proposed operation with the following information:

1. TIMBER OWNER OF RECORD: Sarah Garcia  
Address: 830 D Street, Apartment 1  
City: Arcata State: CA Zip: 95521 Phone: 707-834-3439
2. TIMBERLAND OWNER OF RECORD: Sarah Garcia  
Address: 830 D Street, Apartment 1  
City: Arcata State: CA Zip: 95521 Phone: 707-834-3439
3. LICENSED TIMBER OPERATOR: McKnight Redimix Lic. No. A-8896  
Address: P.O. Box 38  
City: Salyer State: CA Zip: 95563 Phone: 530-629-2070
4. REGISTERED PROFESSIONAL FORESTER PREPARING NOTICE: Name Chris Carroll RPF Number 2628  
Address Timberland Resource Consultants, 165 South Fortuna Blvd, Suite 4  
City Fortuna State CA Zip 95540 Phone (707) 725-1897
5. AGENCY OF HUMBOLDT COUNTY RESPONSIBLE FOR LAND USE CHANGES: Humboldt County Planning Department
6. PROJECT LOCATION: N½ of Section 18, Township 7 North, Range 4 East, Humboldt County, APN 522-021-008. Located approximately 5.5 miles west-southwest of Hoopa. Access is via Old Three Creeks Road.
7. TYPE OF CONVERSION: This is a conversion from timberland to agriculture and a home site, and the maximum size of the conversion is less than three acres.

Sincerely,

A handwritten signature in black ink that reads "Chris Carroll".

Chris Carroll, RPF #2628  
Timberland Resource Consultants

RECEIVED

FEB 13 2014

COAST AREA OFFICE  
RESOURCE MANAGEMENT



165 South Fortuna Boulevard, Fortuna, CA 95540  
707-725-1897 • fax 707-725-0972  
trc@timberlandresource.com

February 6, 2014

Bear River Band of Rohnerville Rancheria  
266 Kiesner Road  
Loleta, CA 95551

Dear Erika Collins, Tribal Historic Preservation Officer:

As the Registered Professional Forester preparing a Conversion Exemption per 14CCR 1104.1 for Sarah Garcia, I am required by the California Forest Practice Rules to notify all Native Americans of this proposed operation with the following information:

1. TIMBER OWNER OF RECORD: Sarah Garcia  
Address 830 D Street, Apartment 1  
City Arcata State CA Zip 95521 Phone 707-834-3439
2. TIMBERLAND OWNER OF RECORD: Sarah Garcia  
Address 830 D Street, Apartment 1  
City Arcata State CA Zip 95521 Phone 707-834-3439
3. LICENSED TIMBER OPERATOR: Name: McKnight Redmix Lic. No A-8896  
Address: P.O. Box 38  
City: Salyer State: CA Zip: 95563 Phone: 530-629-2070
4. REGISTERED PROFESSIONAL FORESTER PREPARING NOTICE: Name Chris Carroll RPF Number 2628  
Address Timberland Resource Consultants, 165 South Fortuna Blvd, Suite 4  
City Fortuna State CA Zip 95540 Phone (707) 725-1897
5. AGENCY OF HUMBOLDT COUNTY RESPONSIBLE FOR LAND USE CHANGES: Humboldt County Planning Department
6. PROJECT LOCATION: N½ of Section 18, Township 7 North, Range 4 East, Humboldt County, APN 522-021-008. Located approximately 5.5 miles west-southwest of Hoopa. Access is via Old Three Creeks Road.
7. TYPE OF CONVERSION: This is a conversion from timberland to agriculture and a home site, and the maximum size of the conversion is less than three acres.

Sincerely,

A handwritten signature in black ink that reads "Chris Carroll". The signature is fluid and cursive.

Chris Carroll, RPF #2628  
Timberland Resource Consultants

**RECEIVED**

FEB 13 2014

COAST AREA OFFICE  
RESOURCE MANAGEMENT



165 South Fortuna Boulevard, Fortuna, CA 95540  
707-725-1897 • fax 707-725-0972  
trc@timberlandresource.com

February 6, 2014

Blue Lake Rancheria  
P.O. Box 428  
Blue Lake, CA 95525

Dear Janet Eidsness, Tribal Historic Preservation Officer:

As the Registered Professional Forester preparing a Conversion Exemption per 14CCR 1104.1 for Sarah Garcia, I am required by the California Forest Practice Rules to notify all Native Americans of this proposed operation with the following information:

1. TIMBER OWNER OF RECORD: Sarah Garcia  
Address 830 D Street, Apartment 1  
City Arcata State CA Zip 95521 Phone 707-834-3439
2. TIMBERLAND OWNER OF RECORD: Sarah Garcia  
Address 830 D Street, Apartment 1  
City Arcata State CA Zip 95521 Phone 707-834-3439
3. LICENSED TIMBER OPERATOR: Name: McKnight Redimix Lic. No A-8896  
Address: P.O. Box 38  
City: Salyer State: CA Zip: 95563 Phone: 530-629-2070
4. REGISTERED PROFESSIONAL FORESTER PREPARING NOTICE: Name Chris Carroll RPF Number 2628  
Address Timberland Resource Consultants, 165 South Fortuna Blvd, Suite 4  
City Fortuna State CA Zip 95540 Phone (707) 725-1897
5. AGENCY OF HUMBOLDT COUNTY RESPONSIBLE FOR LAND USE CHANGES: Humboldt County Planning Department
6. PROJECT LOCATION: N $\frac{1}{2}$  of Section 18, Township 7 North, Range 4 East, Humboldt County, APN 522-021-008. Located approximately 5.5 miles west-southwest of Hoopa. Access is via Old Three Creeks Road.
7. TYPE OF CONVERSION: This is a conversion from timberland to agriculture and a home site, and the maximum size of the conversion is less than three acres.

Sincerely,

A handwritten signature in black ink that reads "Chris Carroll". The signature is written in a cursive style with a large, prominent "C" at the beginning.

Chris Carroll, RPF #2628  
Timberland Resource Consultants

RECEIVED

FEB 13 2014

COAST AREA OFFICE  
RESOURCE MANAGEMENT



165 South Fortuna Boulevard, Fortuna, CA 95540  
707-725-1897 • fax 707-725-0972  
trc@timberlandresource.com

February 6, 2014

Wiyot Tribe  
1000 Wiyot Drive  
Loleta, CA 95551

Dear Thomas Torma, Tribal Historic Preservation Officer:

As the Registered Professional Forester preparing a Conversion Exemption per 14CCR 1104.1 for Sarah Garcia, I am required by the California Forest Practice Rules to notify all Native Americans of this proposed operation with the following information:

1. TIMBER OWNER OF RECORD: Sarah Garcia  
Address 830 D Street, Apartment 1  
City Arcata State CA Zip 95521 Phone 707-834-3439
2. TIMBERLAND OWNER OF RECORD: Sarah Garcia  
Address 830 D Street, Apartment 1  
City Arcata State CA Zip 95521 Phone 707-834-3439
3. LICENSED TIMBER OPERATOR: Name: McKnight Redlmix Lic. No A-8896  
Address: P.O. Box 38  
City: Salyer State: CA Zip: 95563 Phone: 530-629-2070
4. REGISTERED PROFESSIONAL FORESTER PREPARING NOTICE: Name Chris Carroll RPF Number 2628  
Address Timberland Resource Consultants, 165 South Fortuna Blvd, Suite 4  
City Fortuna State CA Zip 95540 Phone (707) 725-1897
5. AGENCY OF HUMBOLDT COUNTY RESPONSIBLE FOR LAND USE CHANGES: Humboldt County Planning Department
6. PROJECT LOCATION: N½ of Section 18, Township 7 North, Range 4 East, Humboldt County, APN 522-021-008. Located approximately 5.5 miles west-southwest of Hoopa. Access is via Old Three Creeks Road.
7. TYPE OF CONVERSION: This is a conversion from timberland to agriculture and a home site, and the maximum size of the conversion is less than three acres.

Sincerely,

  
Chris Carroll, RPF #2628  
Timberland Resource Consultants

RECEIVED

FEB 13 2014

COAST AREA OFFICE  
RESOURCE MANAGEMEN



# Timberland Resource Consultants

165 South Fortuna Boulevard, Fortuna, CA 95540  
707-725-1897 • fax 707-725-0972  
trc@timberlandresource.com

February 6, 2014

Yurok Tribe of California  
P.O. Box 1027  
Klamath, CA 95548

Dear Robert McConnell, Tribal Historic Preservation Officer:

As the Registered Professional Forester preparing a Conversion Exemption per 14CCR 1104.1 for Sarah Garcia, I am required by the California Forest Practice Rules to notify all Native Americans of this proposed operation with the following information:

1. TIMBER OWNER OF RECORD: Sarah Garcia  
Address 830 D Street, Apartment 1  
City Arcata State CA Zip 95521 Phone 707-834-3439
2. TIMBERLAND OWNER OF RECORD: Sarah Garcia  
Address 830 D Street, Apartment 1  
City Arcata State CA Zip 95521 Phone 707-834-3439
3. LICENSED TIMBER OPERATOR: Name: McKnight Redmix Lic. No A-8896  
Address: P.O. Box 38  
City: Salyer State: CA Zip: 95563 Phone: 530-629-2070
4. REGISTERED PROFESSIONAL FORESTER PREPARING NOTICE: Name Chris Carroll RPF Number 2628  
Address Timberland Resource Consultants, 165 South Fortuna Blvd, Suite 4  
City Fortuna State CA Zip 95540 Phone (707) 725-1897
5. AGENCY OF HUMBOLDT COUNTY RESPONSIBLE FOR LAND USE CHANGES: Humboldt County Planning Department
6. PROJECT LOCATION: N $\frac{1}{2}$  of Section 18, Township 7 North, Range 4 East, Humboldt County, APN 522-021-008. Located approximately 5.5 miles west-southwest of Hoopa. Access is via Old Three Creeks Road.
7. TYPE OF CONVERSION: This is a conversion from timberland to agriculture and a home site, and the maximum size of the conversion is less than three acres.

Sincerely,

Chris Carroll, RPF #2628  
Timberland Resource Consultants

RECEIVED

FEB 13 2014

COAST AREA OFFICE  
RESOURCE MANAGEMENT

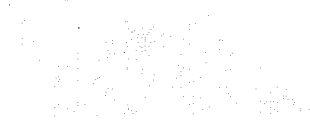

The first part of the document discusses the importance of maintaining accurate records of all transactions. It emphasizes that every entry should be supported by a valid receipt or invoice. This ensures that the financial statements are reliable and can be audited without issue.

In the second section, the author outlines the various methods used to collect and analyze data. This includes both primary and secondary research techniques. The primary research involves direct observation and interviews, while secondary research involves the use of existing data sources.

The third section details the results of the data analysis. It shows that there is a significant correlation between the variables being studied. This finding is supported by statistical tests and is consistent with previous research in the field.

Finally, the document concludes with a series of recommendations for future research. It suggests that further studies should be conducted to explore the underlying causes of the observed trends. Additionally, it recommends that practitioners should take these findings into account when making decisions.

The following table provides a summary of the key findings from the study. It shows that the majority of respondents are in favor of the proposed changes, with only a small percentage expressing concerns.

Category	Response	Percentage
Strongly Agree	Yes	65%
	No	5%
Disagree	Yes	15%
	No	10%
Strongly Disagree	Yes	5%
	No	5%

The data indicates that there is a clear majority in support of the proposed changes. This suggests that the changes are likely to be well-received and implemented successfully.