

**Recording Requested by:**

HUMBOLDT COUNTY  
BOARD OF SUPERVISORS  
Eureka, California

**Return To:**

Planning Department  
3015 H Street  
Eureka, CA 95501  
(Recorded without fee under GCS 27383)

**LAND CONSERVATION CONTRACT  
(Hansen Preserve)**

THIS CONTRACT is dated this 17<sup>th</sup> day of January, 23, by and between Darren Hansen and Karen Hansen, Nathan G. Hansen, Danielle M. Hansen, and Darren Ray Hansen and Karen Marie Hansen, referred to as OWNERS and the COUNTY OF HUMBOLDT, a political subdivision of the State of California, hereinafter referred to as COUNTY.

**WITNESSETH:**

WHEREAS, OWNER warrants that they own certain land particularly described hereinafter, which is presently devoted to agricultural and compatible uses; and

WHEREAS, said land is located in a Class C Agricultural Preserve heretofore established by COUNTY by Resolution No. \_\_\_\_\_; and

WHEREAS, OWNER and COUNTY by signing this Land Conservation Contract mutually agree to enter into this new contract pursuant to Section 51254 of the California Government Code and the County's Williamson Act Guidelines and to establish binding restrictions which will limit the use of said land to agricultural and incidental compatible uses;

NOW, THEREFORE, the parties agree as follows:

Section 1. This contract is made and entered into pursuant to the California Land Conservation Act of 1965 (Chapter 7 of Part 1 of Division 1 of Title 5 of the California Government

Code, commencing with Section 51200, hereafter referred to as the "Act"), and pursuant to the County's Resolution adopting Guidelines for Agricultural Preserves which implements the Act in Humboldt County (hereafter "local resolution") and the County's Resolution Establishing an Agricultural Preserve with Uniform Rules Including Compatible Uses (hereafter "authorizing resolution"), and is subject to all the provisions of the Act and County resolutions as they now exist, and as may be hereafter amended.

Section 2. The land to which all provisions of this contract shall apply is described in Exhibit "A" attached hereto. It is not intended to include in this contract any land zoned Timberland Production (TPZ) pursuant to Government Code Section 51100, et seq.

Section 3. During the term of this contract or any extension thereof, the land described herein shall be used only for agricultural uses, as defined by the Act or authorizing resolution, and those "compatible uses" as set forth in the Act or authorizing resolution, and shall not be used for any purpose other than said agricultural uses and compatible uses.

Section 4. This contract shall be effective on the date first written above, hereinafter the anniversary date, and shall remain in effect for an initial term of ten (10) years. On the first anniversary date and on each succeeding anniversary date, one year shall automatically be added to the unexpired term unless notice of non-renewal is given as provided by law.

Section 5. This contract shall run with the land described herein and shall be binding upon, and inure to the benefit of, all successors in interest of the OWNER. Neither the owner nor any successor in interest shall divide the land described herein, except that the County may approve a division of such land subject to the terms and conditions of the Act or local resolution if the proposed division meets all of the following conditions:

(a) Each preserve resulting from the division shall meet the minimum size requirements of the Act and local resolutions which are applicable to the land which is the subject of this contract, as provided in section 6 hereof; and

(b) Each parcel which is the subject of, or which results from the division shall meet the minimum size requirements of the Act and local resolutions which are applicable to the land which is the subject of this contract; and

(c) All successors in interest to owner shall enter into contracts at the time they assume title to any or all of the land described herein enforceably restricting said land pursuant to the statutory provisions referred to in Section 1 above.

Section 6. If the land subject to this contract is in a Class B Agricultural Preserve, it shall not be divided into preserves of less than 600 acres except that portions of the preserve may be rented or leased for agricultural and compatible uses. If the land subject to this contract is in a Class A or Class C Agricultural Preserve, it shall not be divided into preserves of less than 100 acres except that portions of the preserve may be rented or leased for agricultural and compatible uses. If the land subject to this contract is in a Class D Agricultural Preserve, it shall not be divided pursuant to the State Subdivision Map Act and must be sold, transferred or conveyed as a single unit of land.

Section 7. As used in this contract, the terms "divide" and "division" shall include any sale, transfer, encumbrance or any change in the manner in which title to all or any portion of the herein described land is held, whether immediate or future, but shall exclude "Immediate Family Transfers" approved by COUNTY pursuant to Government Code §51230.1. "Division" includes but is not limited to conveyance by deed, installment sales contract, contract of sale, contract for sale, deed of trust, gift or mortgage. Any purported division of the land described herein in violation of any provision of this contract shall be void.

Section 8. Any party signing this contract as a secured lender agrees to subordinate his security interest in the subject property to the rights, benefits and restrictions contained herein.

Section 9. Whenever notice must be given to COUNTY, it may be given by mailing it postage prepaid, addressed to the Board of Supervisors, County of Humboldt, County Courthouse, Eureka, California 95501; notice to OWNERS may be given by mailing it first class postage prepaid addressed to Darren & Karen Hansen Dairy, 530 Harbers Lane, Ferndale, CA 95536 or at such

other address OWNER may hereafter designate in writing. Delivery shall be deemed complete the day after the date of mailing.

Section 10. In the event of any conflict between the provisions of this contract, the local resolutions and the Act, those provisions which most restrict the right to divide the land subject to this contract or to use said land for non-agricultural purposes shall govern.

Section 11. In the event of Cancellation of this contract pursuant to the Act and local resolution, the OWNER shall pay to the COUNTY a cancellation fee equal to 12.5% of the cancellation valuation as calculated in accordance with Section 51283 of the California Government Code.

Section 12. OWNER agrees to permit COUNTY physical inspection of the subject real property and make available for examination such other information or records pursuant to Section 441(d) of the Revenue and Taxation Code as is reasonable and necessary for administration of this contract.

Section 13. This contract may be dated by COUNTY to correspond with the date its Chairman is authorized to execute this contract.

IN WITNESS WHEREOF, the parties hereto have executed the within contract.



Chair of the Board of Supervisors  
of the County of Humboldt, State of California.

(SEAL)

ATTEST:

KATHY HAYES  
Clerk of the Board of Supervisors  
of the County of Humboldt, State  
of California.

By   
Deputy

CERTIFICATE OF ACKNOWLEDGMENT

A notary public or other officer completing this certificate verifies only the identity of the individual who signed the document, to which this certificate is attached, and not the truthfulness, accuracy, or validity of that document.

STATE OF CALIFORNIA }  
COUNTY OF HUMBOLDT }

On this 17<sup>th</sup> day of January 20 23, before me, Suzanne Lippre

Notary Public, personally appeared Steve Madrone

who proved to me on the basis of satisfactory evidence to be the person(s) whose name(s) is/are subscribed to the within instrument and acknowledged to me that he/she/they executed the same in his/her/their authorized capacity(ies), and that by his/her/their signature(s) on the instrument the person(s), or the entity upon behalf of which the person(s) acted, executed the instrument.

I certify under PENALTY OF PERJURY under the laws of the State of California that the foregoing paragraph is true and correct.

Witness my hand and official seal.



Suzanne Lippre  
Notary Public Signature

(seal)

**Owners of Record**

By Dan Ray Hansen <sup>Darren Ray Hansen</sup>

By Karen Marie Hansen <sup>Karen Marie Hansen</sup>

By Danielle M. Hansen <sup>Danielle M. Hansen</sup>

By Nathan G. Hansen <sup>Nathan G. Hansen</sup>

**(Signature(s) to be Notarized)**

**Interest in Property**

Section 8B of the Humboldt County Williamson Act Guidelines states that "all parties having any interest in any real property included in the contract which could ripen into a fee interest or be exercised in a manner inconsistent with the purpose of the preserve, such as a security interest, shall be required to join in the execution of the proposed contract before such contract is executed by the Board of Supervisors".

The following parties have a security interest in the real property included in this contract which could ripen into a fee interest:

*TWO SIGNATURES ARE REQUIRED FOR CORPORATIONS:*

*(1) CHAIRPERSON OF THE BOARD, PRESIDENT OR VICEPRESIDENT; AND*

*(2) SECRETARY, ASSISTANT SECRETARY, CHIEF FINANCIAL OFFICER, OR TREASURER.*

By \_\_\_\_\_

By \_\_\_\_\_

Title \_\_\_\_\_

Title \_\_\_\_\_

Corporation Name: \_\_\_\_\_

Corporation Name: \_\_\_\_\_

**(Signature(s) to be Notarized)**

APPROVED AS TO FORM:

By \_\_\_\_\_  
County Counsel

**CALIFORNIA ACKNOWLEDGMENT**

CIVIL CODE § 1189

A notary public or other officer completing this certificate verifies only the identity of the individual who signed the document to which this certificate is attached, and not the truthfulness, accuracy, or validity of that document.

State of California }  
County of Humboldt

On Nov 18, 2022 before me, Kelli Townsend, Notary Public  
Date Here Insert Name and Title of the Officer

personally appeared Darren Ray Hansen and Karen Marie Hansen  
Name(s) of Signer(s)

who proved to me on the basis of satisfactory evidence to be the person(s) whose name(s) is/are subscribed to the within instrument and acknowledged to me that he/she/they executed the same in his/her/their authorized capacity(ies), and that by his/her/their signature(s) on the instrument the person(s), or the entity upon behalf of which the person(s) acted, executed the instrument.

I certify under PENALTY OF PERJURY under the laws of the State of California that the foregoing paragraph is true and correct.

WITNESS my hand and official seal.



Place Notary Seal and/or Stamp Above

Signature [Handwritten Signature]  
Signature of Notary Public

**OPTIONAL**

Completing this information can deter alteration of the document or fraudulent reattachment of this form to an unintended document.

**Description of Attached Document**

Title or Type of Document: Land Conservation Contract

Document Date: Nov 18, 2022 Number of Pages: \_\_\_\_\_

Signer(s) Other Than Named Above: Danielle M. Hansen & Nathan G. Hansen

**Capacity(ies) Claimed by Signer(s)**

Signer's Name: \_\_\_\_\_

Corporate Officer – Title(s): \_\_\_\_\_

Partner –  Limited  General

Individual  Attorney in Fact

Trustee  Guardian or Conservator

Other: \_\_\_\_\_

Signer is Representing: \_\_\_\_\_

Signer's Name: \_\_\_\_\_

Corporate Officer – Title(s): \_\_\_\_\_

Partner –  Limited  General

Individual  Attorney in Fact

Trustee  Guardian or Conservator

Other: \_\_\_\_\_

Signer is Representing: \_\_\_\_\_

**Owners of Record**

By Dan Hansen - Darren Hansen By Karen Hansen - Karen Hansen  
By Danielle M. Hansen - Danielle Hansen By Nathan G. Hansen - Nathan G. Hansen

**(Signature(s) to be Notarized)**

**Interest in Property**

Section 8B of the Humboldt County Williamson Act Guidelines states that "all parties having any interest in any real property included in the contract which could ripen into a fee interest or be exercised in a manner inconsistent with the purpose of the preserve, such as a security interest, shall be required to join in the execution of the proposed contract before such contract is executed by the Board of Supervisors".

The following parties have a security interest in the real property included in this contract which could ripen into a fee interest:

*TWO SIGNATURES ARE REQUIRED FOR CORPORATIONS:*

*(1) CHAIRPERSON OF THE BOARD, PRESIDENT OR VICEPRESIDENT; AND*

*(2) SECRETARY, ASSISTANT SECRETARY, CHIEF FINANCIAL OFFICER, OR TREASURER.*

By \_\_\_\_\_

By \_\_\_\_\_

Title \_\_\_\_\_

Title \_\_\_\_\_

Corporation Name: \_\_\_\_\_

Corporation Name: \_\_\_\_\_

**(Signature(s) to be Notarized)**

APPROVED AS TO FORM:

By \_\_\_\_\_  
County Counsel

**Owners of Record**

By \_\_\_\_\_

By \_\_\_\_\_



**CALIFORNIA ACKNOWLEDGMENT**

CIVIL CODE § 1189

A notary public or other officer completing this certificate verifies only the identity of the individual who signed the document to which this certificate is attached, and not the truthfulness, accuracy, or validity of that document.

State of California }  
County of Humboldt

On Nov 18, 2022 before me, Kelli Townsend, Notary Public  
Date Here Insert Name and Title of the Officer

personally appeared Darren Hansen and Karen Hansen  
Name(s) of Signer(s)

who proved to me on the basis of satisfactory evidence to be the person(s) whose name(s) is/are subscribed to the within instrument and acknowledged to me that he/she/they executed the same in his/her/their authorized capacity(ies), and that by his/her/their signature(s) on the instrument the person(s), or the entity upon behalf of which the person(s) acted, executed the instrument.

I certify under PENALTY OF PERJURY under the laws of the State of California that the foregoing paragraph is true and correct.

WITNESS my hand and official seal.



Place Notary Seal and/or Stamp Above

Signature Kelli Townsend  
Signature of Notary Public

**OPTIONAL**

Completing this information can deter alteration of the document or fraudulent reattachment of this form to an unintended document.

**Description of Attached Document**

Title or Type of Document: Land conservation contract

Document Date: Nov 18, 2022 Number of Pages: \_\_\_\_\_

Signer(s) Other Than Named Above: Danielle M. Hansen + Nathan G. Hansen

**Capacity(ies) Claimed by Signer(s)**

Signer's Name: _____	Signer's Name: _____
<input type="checkbox"/> Corporate Officer – Title(s): _____	<input type="checkbox"/> Corporate Officer – Title(s): _____
<input type="checkbox"/> Partner – <input type="checkbox"/> Limited <input type="checkbox"/> General	<input type="checkbox"/> Partner – <input type="checkbox"/> Limited <input type="checkbox"/> General
<input type="checkbox"/> Individual <input type="checkbox"/> Attorney in Fact	<input type="checkbox"/> Individual <input type="checkbox"/> Attorney in Fact
<input type="checkbox"/> Trustee <input type="checkbox"/> Guardian or Conservator	<input type="checkbox"/> Trustee <input type="checkbox"/> Guardian or Conservator
<input type="checkbox"/> Other: _____	<input type="checkbox"/> Other: _____
Signer is Representing: _____	Signer is Representing: _____

CALIFORNIA ACKNOWLEDGMENT

CIVIL CODE § 1189

A notary public or other officer completing this certificate verifies only the identity of the individual who signed the document to which this certificate is attached, and not the truthfulness, accuracy, or validity of that document.

State of California }
County of Humboldt }

On Nov 18, 2022 before me, Kelli Townsend, Notary Public
Date Here Insert Name and Title of the Officer

personally appeared Danielle M. Hansen
Name(s) of Signer(s)

who proved to me on the basis of satisfactory evidence to be the person(s) whose name(s) is/are subscribed to the within instrument and acknowledged to me that he/she/they executed the same in his/her/their authorized capacity(ies), and that by his/her/their signature(s) on the instrument the person(s), or the entity upon behalf of which the person(s) acted, executed the instrument.



I certify under PENALTY OF PERJURY under the laws of the State of California that the foregoing paragraph is true and correct.

WITNESS my hand and official seal.

Signature Kelli Townsend
Signature of Notary Public

Place Notary Seal and/or Stamp Above

OPTIONAL

Completing this information can deter alteration of the document or fraudulent reattachment of this form to an unintended document.

Description of Attached Document

Title or Type of Document: Land Conservation Agreement

Document Date: Nov 18, 2022 Number of Pages:

Signer(s) Other Than Named Above: Darren Hansen, Karen Hansen, Nathan G. Hansen

Capacity(ies) Claimed by Signer(s)

Signer's Name:
[ ] Corporate Officer - Title(s):
[ ] Partner - [ ] Limited [ ] General
[ ] Individual [ ] Attorney in Fact
[ ] Trustee [ ] Guardian or Conservator
[ ] Other:
Signer is Representing:

**CALIFORNIA ACKNOWLEDGMENT**

**CIVIL CODE § 1189**

A notary public or other officer completing this certificate verifies only the identity of the individual who signed the document to which this certificate is attached, and not the truthfulness, accuracy, or validity of that document.

State of California }  
County of Humboldt }

On Nov 18, 2022 before me, Kelli Townsend, Notary Public  
Date Here Insert Name and Title of the Officer

personally appeared Danielle M. Hansen  
Name(s) of Signer(s)

who proved to me on the basis of satisfactory evidence to be the person(s) whose name(s) is/are subscribed to the within instrument and acknowledged to me that he/she/they executed the same in his/her/their authorized capacity(ies), and that by his/her/their signature(s) on the instrument the person(s), or the entity upon behalf of which the person(s) acted, executed the instrument.

I certify under PENALTY OF PERJURY under the laws of the State of California that the foregoing paragraph is true and correct.

WITNESS my hand and official seal.



Signature Kelli Townsend  
Signature of Notary Public

Place Notary Seal and/or Stamp Above

**OPTIONAL**

Completing this information can deter alteration of the document or fraudulent reattachment of this form to an unintended document.

**Description of Attached Document**

Title or Type of Document: Land conservation Agreement

Document Date: NOV 18, 2022 Number of Pages: \_\_\_\_\_

Signer(s) Other Than Named Above: Darren Ray Hansen, Karen Marie Hansen, Nathan G. Hansen

**Capacity(ies) Claimed by Signer(s)**

Signer's Name: \_\_\_\_\_  
 Corporate Officer – Title(s): \_\_\_\_\_  
 Partner –  Limited  General  
 Individual  Attorney in Fact  
 Trustee  Guardian or Conservator  
 Other: \_\_\_\_\_  
Signer is Representing: \_\_\_\_\_

Signer's Name: \_\_\_\_\_  
 Corporate Officer – Title(s): \_\_\_\_\_  
 Partner –  Limited  General  
 Individual  Attorney in Fact  
 Trustee  Guardian or Conservator  
 Other: \_\_\_\_\_  
Signer is Representing: \_\_\_\_\_

**CALIFORNIA ACKNOWLEDGMENT**

**CIVIL CODE § 1189**

A notary public or other officer completing this certificate verifies only the identity of the individual who signed the document to which this certificate is attached, and not the truthfulness, accuracy, or validity of that document.

State of California }  
County of Humboldt }

On Nov 21, 2022 before me, Kelli Townsend, Notary Public  
Date Here Insert Name and Title of the Officer

personally appeared Nathan G. Hansen  
Name(s) of Signer(s)

who proved to me on the basis of satisfactory evidence to be the person(s) whose name(s) is/are subscribed to the within instrument and acknowledged to me that he/she/they executed the same in his/her/their authorized capacity(ies), and that by his/her/their signature(s) on the instrument the person(s), or the entity upon behalf of which the person(s) acted, executed the instrument.

I certify under PENALTY OF PERJURY under the laws of the State of California that the foregoing paragraph is true and correct.

WITNESS my hand and official seal.

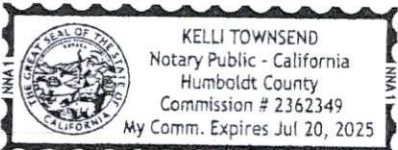

Place Notary Seal and/or Stamp Above

Signature [Handwritten Signature]  
Signature of Notary Public

**OPTIONAL**

Completing this information can deter alteration of the document or fraudulent reattachment of this form to an unintended document.

**Description of Attached Document**

Title or Type of Document: Land conservation contract  
Document Date: 11-21-2022 (Date Signed) Number of Pages: \_\_\_\_\_

Signer(s) Other Than Named Above: Karen Marie Hansen, Darren Ray Hansen, Danielle M. Hansen

**Capacity(ies) Claimed by Signer(s)**

Signer's Name: _____	Signer's Name: _____
<input type="checkbox"/> Corporate Officer – Title(s): _____	<input type="checkbox"/> Corporate Officer – Title(s): _____
<input type="checkbox"/> Partner – <input type="checkbox"/> Limited <input type="checkbox"/> General	<input type="checkbox"/> Partner – <input type="checkbox"/> Limited <input type="checkbox"/> General
<input type="checkbox"/> Individual <input type="checkbox"/> Attorney in Fact	<input type="checkbox"/> Individual <input type="checkbox"/> Attorney in Fact
<input type="checkbox"/> Trustee <input type="checkbox"/> Guardian or Conservator	<input type="checkbox"/> Trustee <input type="checkbox"/> Guardian or Conservator
<input type="checkbox"/> Other: _____	<input type="checkbox"/> Other: _____
Signer is Representing: _____	Signer is Representing: _____

**CALIFORNIA ACKNOWLEDGMENT**

**CIVIL CODE § 1189**

A notary public or other officer completing this certificate verifies only the identity of the individual who signed the document to which this certificate is attached, and not the truthfulness, accuracy, or validity of that document.

State of California }  
County of Humboldt }

On Nov 21, 2022 before me, Kelli Townsend, Notary Public  
Date Here Insert Name and Title of the Officer

personally appeared Nathan G. Hansen  
Name(s) of Signer(s)

who proved to me on the basis of satisfactory evidence to be the person(s) whose name(s) is/are subscribed to the within instrument and acknowledged to me that he/she/they executed the same in his/her/their authorized capacity(ies), and that by his/her/their signature(s) on the instrument the person(s), or the entity upon behalf of which the person(s) acted, executed the instrument.

I certify under PENALTY OF PERJURY under the laws of the State of California that the foregoing paragraph is true and correct.

WITNESS my hand and official seal.



Place Notary Seal and/or Stamp Above

Signature Kelli Townsend  
Signature of Notary Public

**OPTIONAL**

Completing this information can deter alteration of the document or fraudulent reattachment of this form to an unintended document.

**Description of Attached Document**

Title or Type of Document: Land conservation Contract

Document Date: 11-21-2022 (Date Signed) Number of Pages: \_\_\_\_\_

Signer(s) Other Than Named Above: Karen Hansen, Darren Hansen, Danielle M. Hansen

**Capacity(ies) Claimed by Signer(s)**

Signer's Name: \_\_\_\_\_

Corporate Officer – Title(s): \_\_\_\_\_

Partner –  Limited  General

Individual  Attorney in Fact

Trustee  Guardian or Conservator

Other: \_\_\_\_\_

Signer is Representing: \_\_\_\_\_

Signer's Name: \_\_\_\_\_

Corporate Officer – Title(s): \_\_\_\_\_

Partner –  Limited  General

Individual  Attorney in Fact

Trustee  Guardian or Conservator

Other: \_\_\_\_\_

Signer is Representing: \_\_\_\_\_

**EXHIBIT "A"**  
Legal Description

THE LAND REFERRED TO HEREIN BELOW IS SITUATED IN THE UNINCORPORATED AREA IN COUNTY OF HUMBOLDT, STATE OF CALIFORNIA AND IS DESCRIBED AS FOLLOWS:

**Tract A:**

That portion of the East Half of the Northwest Quarter and the East Half of the Southwest Quarter of Section 16 in

Township 2 North of Range 1 West, Humboldt Meridian, bounded and described as follows:

BEGINNING at a point 36 3/4 rods West and 1 rod South from the center of said Section 16; and running thence South

159 rods, more or less, to the South line of said Section 16;

thence Easterly along the section line to the Southeast corner of the Southwest Quarter of said Section 16;

thence Northerly along the quarter section line 1 mile to the Northeast corner of the Northwest Quarter of said Section 16;

thence West along the section line 38 1/2 rods, more or less, to a point 41 1/2 rods East of the Northwest corner of the

Northeast Quarter of the Northwest Quarter of said Section 16;

thence South 80 rods following East boundary of parcel described in Deed to Joseph A. Davenport from James Lawson,

dated March 31, 1883, and recorded in Book 8 of Deeds at Page 173, Humboldt County Records, to the Southeast corner

of said parcel;

thence West 40 1/2 rods, more or less on the South line of said parcel to point of intersection with a line running North

from a point 79 rods West of the center of said Section 16;

thence South 81 rods, more or less, to a point due West of the point of beginning; and

thence East 42 1/2 rods to the point of beginning.

**Tract B:**

**PARCEL ONE:**

BEGINNING at the Southeast corner of the Southwest quarter of the Northwest quarter of Section 16, Township 2 North,

Range 1 West, Humboldt Meridian; and running

thence North along the North and South subdivision line of the Northwest quarter of said Section 16, 904.20 feet;

thence West 946.11 feet;

thence South 904.20 feet to the East and West subdivision line of Section 16;

and thence East along said subdivision line 946.11 feet to the point of beginning.

**PARCEL TWO:**

The right to hold and use as a lane in common with Henry F. Harbers, his heirs and assigns, the following described parcel

of land:

BEGINNING on the North and South subdivision line of the Northwest quarter of Section 16, Township 2 North, Range 1

West, Humboldt Meridian, at a point situated 904.20 feet North of the Southeast corner of the Southwest quarter of the

Northwest quarter of said Section 16;

thence North 423.72 feet to the Northeast corner of said Southwest quarter of Northwest quarter;

thence West 33 feet;

thence South 423.72 feet;

and thence East 33 feet to the point of beginning as conveyed by Henry F. Harbers to John Harbers by deed recorded May 22, 1891, in [Book 38 of Deeds Page 256](#).

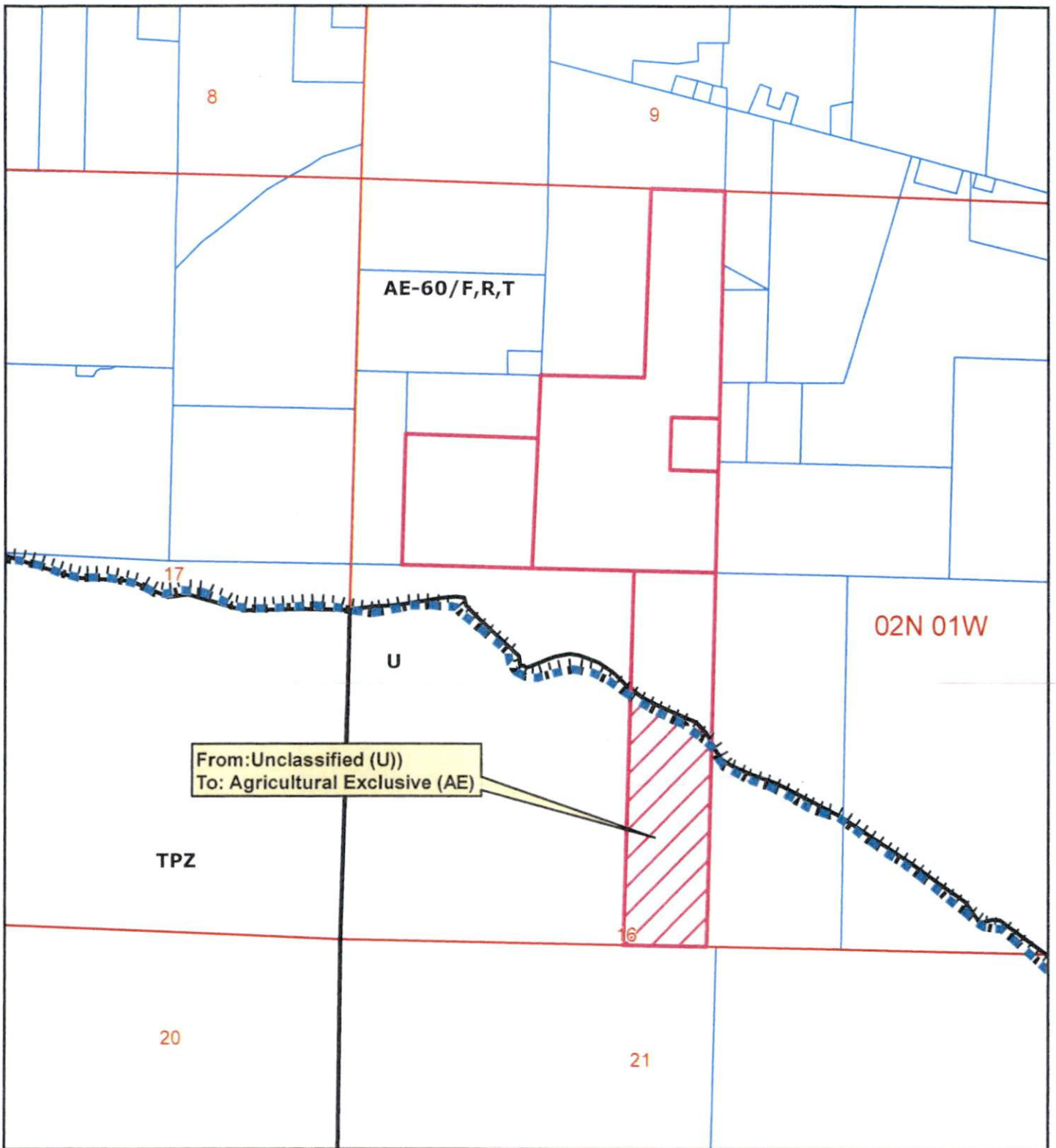

From: Unclassified (U)  
 To: Agricultural Exclusive (AE)

**ZONING MAP DETAIL**

**PROPOSED HANSEN  
 AGRICULTURAL PRESERVE &  
 ZONE RECLASSIFICATION  
 FERNDALE AREA**

**PLN-2022-17731**

**APN: 106-101-006 et al  
 T02N R01W S16 HB&M (Fortuna)**

Project Area = 

Rezone Area = 

Coastal Zone Boundary 

This map is intended for display purposes and should not be used for precise measurement or navigation. Data has not been completely checked for accuracy.

