

FUNDING SOURCES

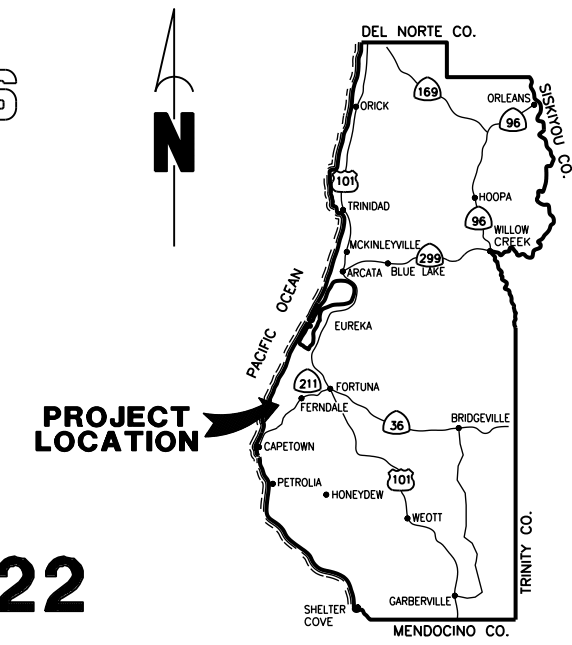

COUNTY OF HUMBOLDT
DEPARTMENT OF PUBLIC WORKS
PROJECT PLANS FOR CONSTRUCTION OF
STORM DAMAGE REPAIRS ON
POOLE ROAD (2G015)
at P.M. 2.00, 2.25 & 2.36
FEMA-4434-DR-CA PW-114
CONTRACT NO. 219320, 219321 & 219322

BAR IS ONE INCH ON ORIGINAL DRAWING IF NOT ONE INCH ON THIS SHEET, ADJUST SCALES ACCORDINGLY	ROAD NAME: POOLE ROAD	DESIGN SECTION: ENGINEERING	COUNTY OF HUMBOLDT DEPARTMENT OF PUBLIC WORKS POOLE ROAD PM 2.00, 2.25 & 2.36 SD REPAIR COVER SHEET, SHEET INDEX AND MAPS	SHEET 1 OF 9
	ROAD NO.: 2G015	MILE POST: 2.00, 2.25, 2.36		
	FEMA PROJECT NO.: FEMA-4434-DR-CA PW#114	DESIGNED BY: MMS		
	CONTRACT NO.: 219320, 219321, 219322	DRAWN BY: MMS		
	DRAWING FILE NAME: 219320-219322 SHEET 1	REVIEWED BY: JAB		
	PLOT DATE: 2/15/2024	APPROVED BY: TRS		



LOCATION MAP
SCALE: 1"=10± MILE

SITE	COUNTY PROJECT NUMBER
PM 2.00	219320
PM 2.25	219321
PM 2.36	219322

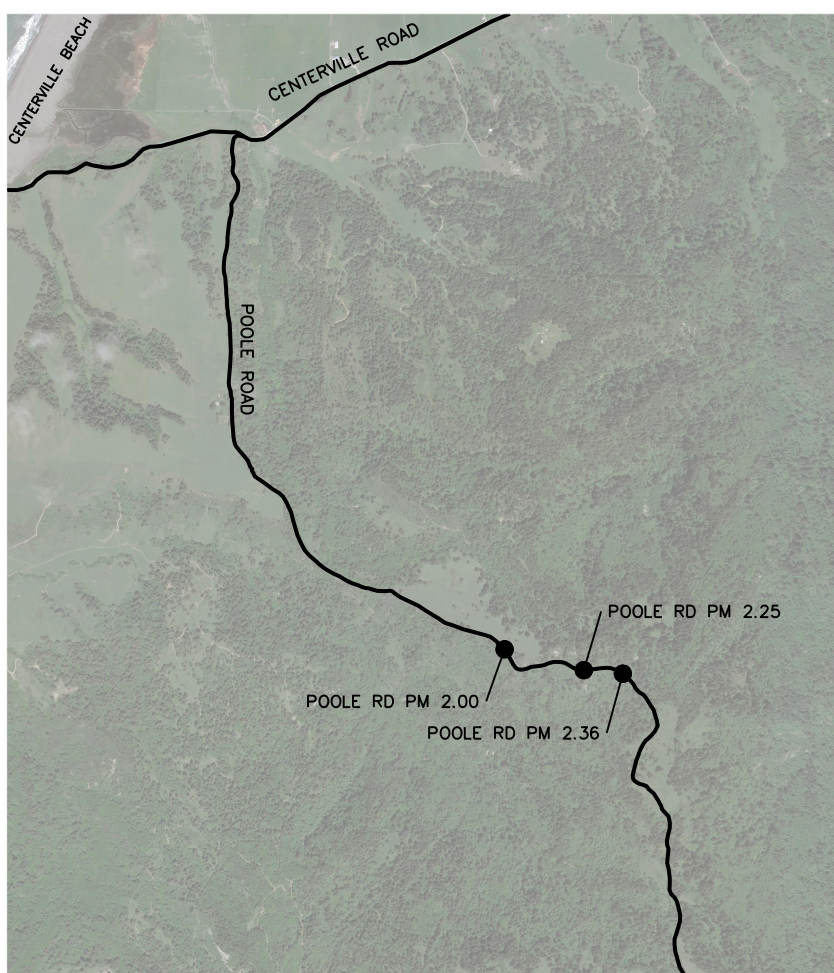

VICINITY MAP
N.T.S.



INDEX OF SHEETS

- 1 COVER SHEET, SHEET INDEX, AND MAPS
- 2 CONSTRUCTION AREA SIGNS & QUANTITIES
- 3 TYPICAL SECTION AND DETAILS
- 4 PM 2.00 PLAN AND PROFILE
- 5 PM 2.00 SECTION VIEWS
- 6 PM 2.25 PLAN AND PROFILE
- 7 PM 2.25 SECTION VIEWS
- 8 PM 2.36 PLAN AND PROFILE
- 9 PM 2.36 SECTION VIEWS

NOTES

THE CONTRACTOR SHALL HAVE A CLASS "A" LICENSE FOR THIS PROJECT.

PROJECT PLANS AND SPECIAL PROVISIONS TO BE SUPPLEMENTED BY THE STATE OF CALIFORNIA DEPARTMENT OF TRANSPORTATION STANDARD PLANS, STANDARD SPECIFICATIONS, AND THE LATEST REVISED 2023 STANDARD SPECIFICATIONS
(SEE APPLICABLE STAN PLAN LIST IN SPECIAL PROVISIONS)

RECOMMENDED

 _____ 3-21-2024
 JEFFREY A. BALL DATE
 RCE 70631 / EXP. 6/30/2025



APPROVED

 TONY R. SEGHELLI DATE
 RCE 63714, EXP. 9/30/2024



ORIGINAL LOW BID PRICE	CONSTRUCTED BY	RESIDENT ENGINEER
	PROJECT COMPLETED / /	CONSTRUCTION COST \$



BAR IS ONE INCH ON ORIGINAL DRAWING IF NOT ONE INCH ON THIS SHEET, ADJUST SCALES ACCORDINGLY	ROAD NAME: POOLE ROAD	DESIGN SECTION: ENGINEERING	COUNTY OF HUMBOLDT DEPARTMENT OF PUBLIC WORKS POOLE ROAD PM 2.00, 2.25 & 2.36 SD REPAIR SIGNS AND QUANTITIES	SHEET 2 OF 9
	ROAD NO.: 20015	MILE POST: 2.00, 2.25, 2.36		
	FEMA PROJECT NO.: FEMA-4434-DR-CA PW#114	DESIGNED BY: MMS		
	CONTRACT NO.: 219320, 219321, 219322	DRAWN BY: MMS		
	DRAWING FILE NAME: 219320-219322 SHEET 1	REVIEWED BY: JAB		
	PLOT DATE: 2/15/2024	APPROVED BY: TRS		

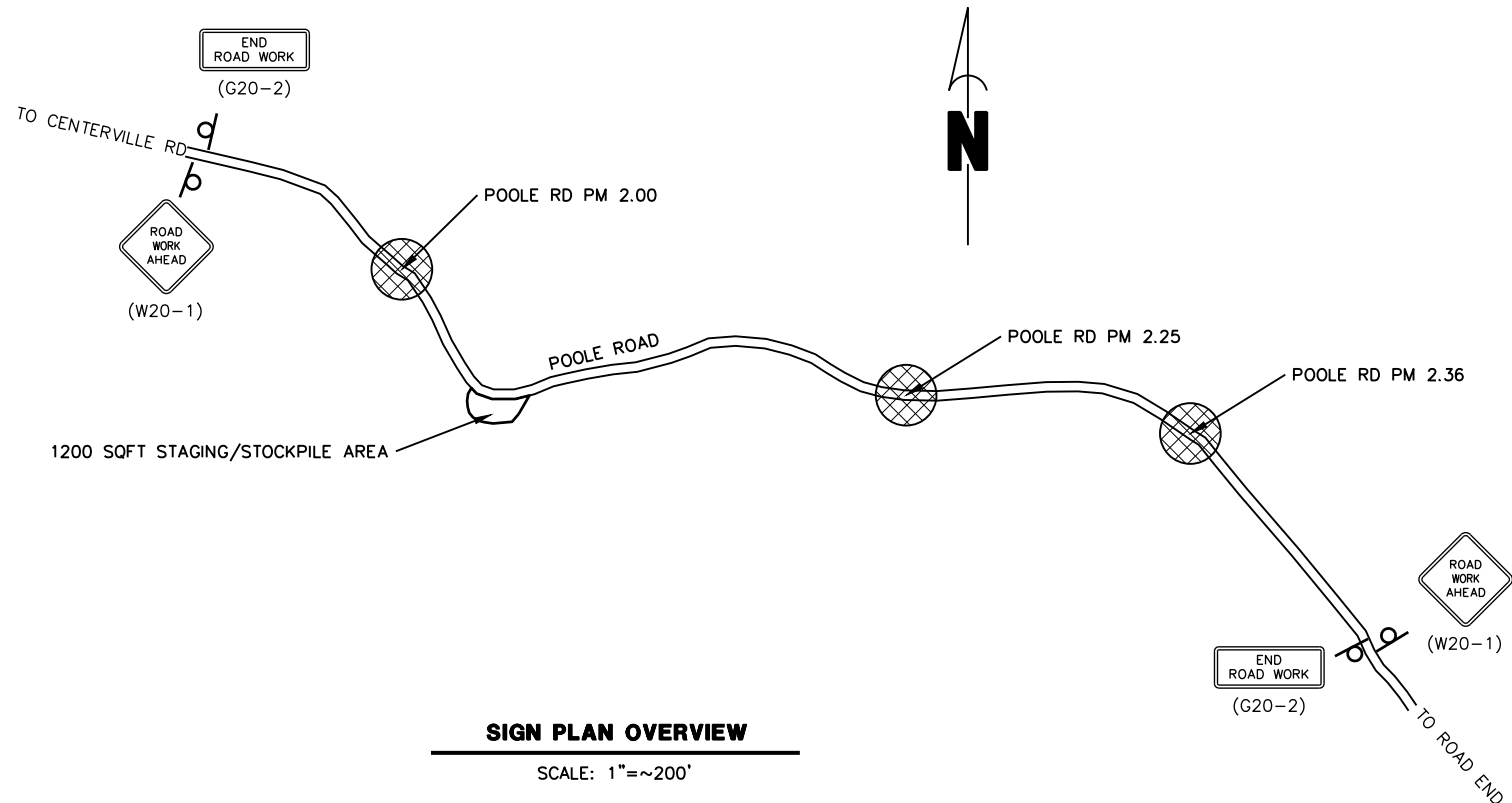

QUANTITIES

ITEM NO.	ITEM CODE	ITEM DESCRIPTION	UNIT	PM 2.00	PM 2.25	PM 2.36	Total
1	120090	Construction Area Signs	EA	2	0	2	4
2	120100	Traffic Control System	LS	0.50	0.25	0.25	1
3	130100	Job Site Management	LS	0.50	0.25	0.25	1
4	130201	Water Pollution Control Program	LS	0.50	0.25	0.25	1
5	170103	Clearing and Grubbing	LS	0.3	0.3	0.4	1
6	190101	F Roadway Excavation	CY	201	144	91	436
7	198050	Embankment	CY	27	20.0	17	64
8	210212	Dry Seed	SQFT	510	620	330	1,460
9	210280	Rolled Erosion Control Product (Blanket)	SQFT	310	390	160	860
10	210350	Fiber Rolls	LF	80	60	60	200
11	210420	Straw	SQFT	200	230	170	600
12	260400	Aggregate Base (1.5" Minus Crushed Rock)	CY	33	23	23	79
13	723030	Rock Slope Protection (1/2 T, Class VII, Method A)	CY	164	62	62	288
14	729011	Rock Slope Protection Fabric (Class 8)	SQYD	262	138	135	535
15	999990	Mobilization	LS	0.50	0.25	0.25	1

NOTES

- 1) SIGNS SHALL BE PLACED AS SHOWN ON PLAN OR AS DIRECTED BY THE ENGINEER.
- 2) FINAL PLACEMENT OF SIGNS SHALL BE APPROVED BY RESIDENT ENGINEER.
- 3) ADDITIONAL PORTABLE SIGNS SHALL BE USED AS REQUIRED FOR OTHER ROADSIDE WORK.
- 4) SEE STANDARD PLAN T13 FOR TRAFFIC CONTROL SYSTEM.
- 5) IN ADDITION TO CONSTRUCTION AREA SIGNS AND WHEN DIRECTED BY THE RESIDENT ENGINEER, THE CONTRACTOR SHALL UTILIZE FLAGMEN AS NECESSARY TO DIRECT TRAFFIC.
- 6) KEEP A MINIMUM OF 1 TRAFFIC LANE AT LEAST 10' WIDE OPEN FOR TRAFFIC, EXCEPT THE FULL WIDTH OF THE TRAVELED WAY MUST BE OPEN WHEN CONSTRUCTION OPERATIONS ARE NOT ACTIVE OR AN APPROVED TRAFFIC CONTROL PLAN IS IN PLACE

CONSTRUCTION AREA SIGN SUMMARY

SIGN TYPE	QTY	DESCRIPTION	SIZE	REMARKS	POST SIZE	NUMBER
W20-1	2	ROAD WORK AHEAD	30" x 30"	VISIBLE AT ALL TIMES	4" x 4"	1
G20-2	2	END ROAD WORK	36" x 18"	VISIBLE AT ALL TIMES	4 x 4	1

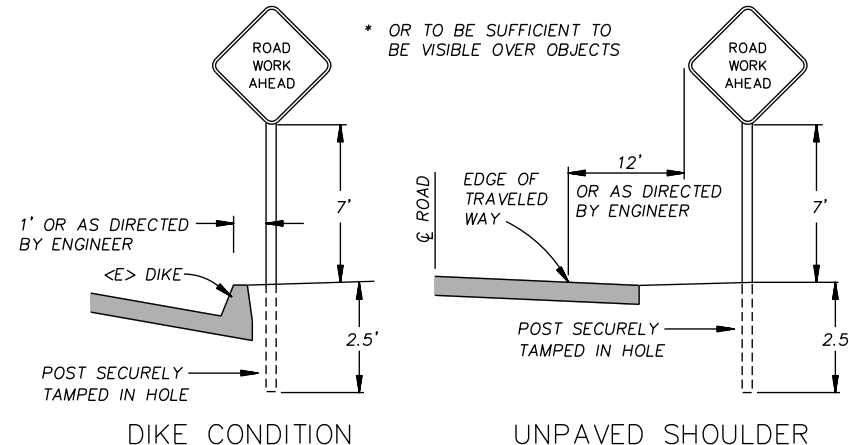

RURAL CONSTRUCTION AREA SIGN

- NOT TO SCALE -

STOCKPILE NOTES

- 1) MANAGE MATERIAL PER SECTION 13-4.03C OF THE 2023 CALTRANS STANDARD SPECIFICATIONS
- 2) IF STOCKPILE AREA IS IN A TURNOUT, THE TURNOUT SHALL BE REESTABLISHED TO PRE-CONSTRUCTION CONDITIONS
- 3) STOCKPILE LOCATIONS HAVE BEEN APPROVED BY PUBLIC WORKS AS DETAILED IN THE ENVIRONMENTAL REPORT.



BAR IS ONE INCH ON ORIGINAL DRAWING IF NOT ONE INCH ON THIS SHEET, ADJUST SCALES ACCORDINGLY	ROAD NAME: POOLE ROAD	DESIGN SECTION	COUNTY OF HUMBOLDT DEPARTMENT OF PUBLIC WORKS POOLE ROAD PM 2.00, 2.25 & 2.36 SD REPAIR TYPICAL SECTIONS	SHEET 3 OF 9	
	ROAD NO.: 20015	MILE POST: 2.00, 2.25, 2.36			ENGINEERING
	FEMA PROJECT NO.: FEMA-4434-DR-CA PW#114				DESIGNED BY: MMS
	CONTRACT NO.: 219320, 219321, 219322				DRAWN BY: MMS
	DRAWING FILE NAME: 219320-219322 SHEET 1	REVIEWED BY: JAB			
	PLOT DATE: 2/15/2024	APPROVED BY: TRS			

POOLE RD PM 2.00 RSP DIMENSIONS

STATION	RSP HEIGHT (FT)	TOE ELEV (FT)
(BEGIN) 0+50	13	4977.85
1+00	14	4979.42
1+10	15	4978.82
1+15	16	4978.01
(END) 1+30	16	4978.54

POOLE RD PM 2.25 RSP DIMENSIONS

STATION	RSP HEIGHT (FT)	TOE ELEV (FT)
(BEGIN) 10+60	7	4991.90
10+80	7	4992.22
11+00	7	4992.59
(END) 11+20	7	4993.34

POOLE RD PM 2.36 RSP DIMENSIONS

STATION	RSP HEIGHT (FT)	TOE ELEV (FT)
(BEGIN) 21+00	7	4989.15
21+20	7	4990.36
21+40	7	4991.48
(END) 21+60	7	4992.60

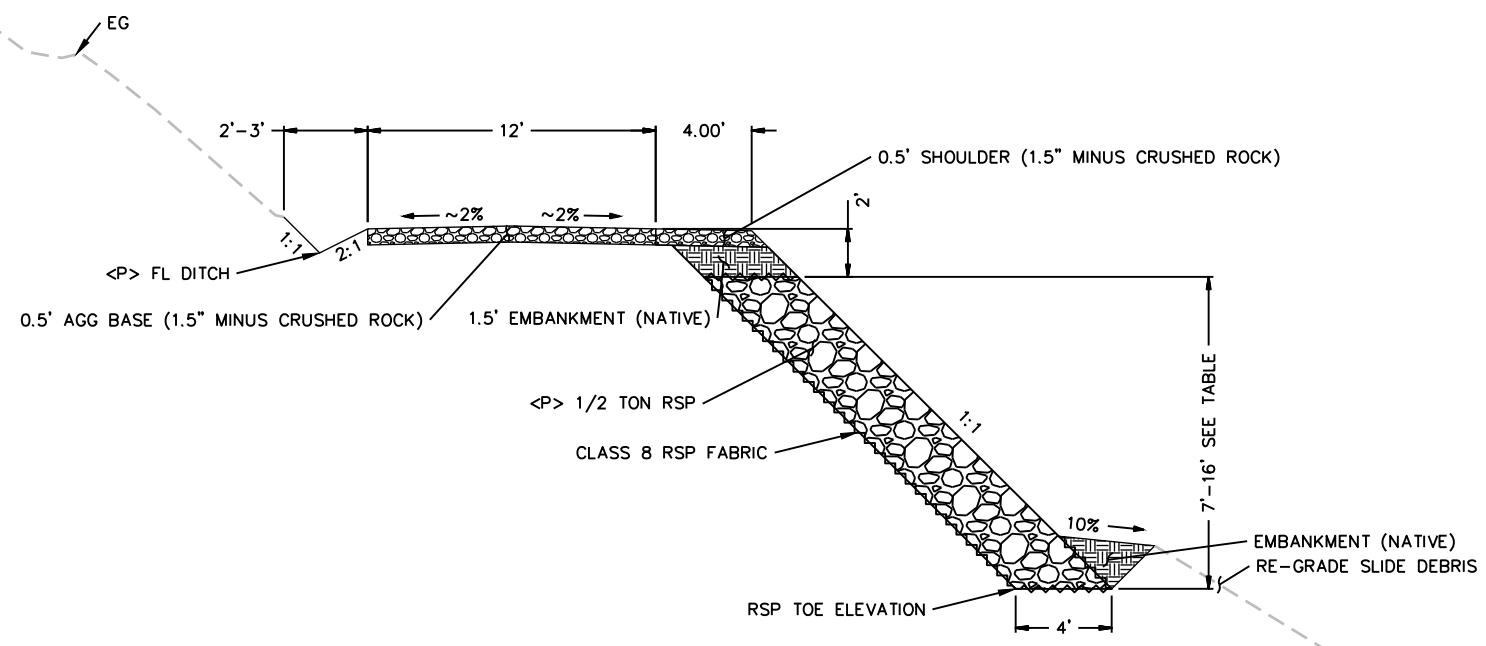

ROAD AND RSP TYPICAL SECTION
SCALE: 1"=4'

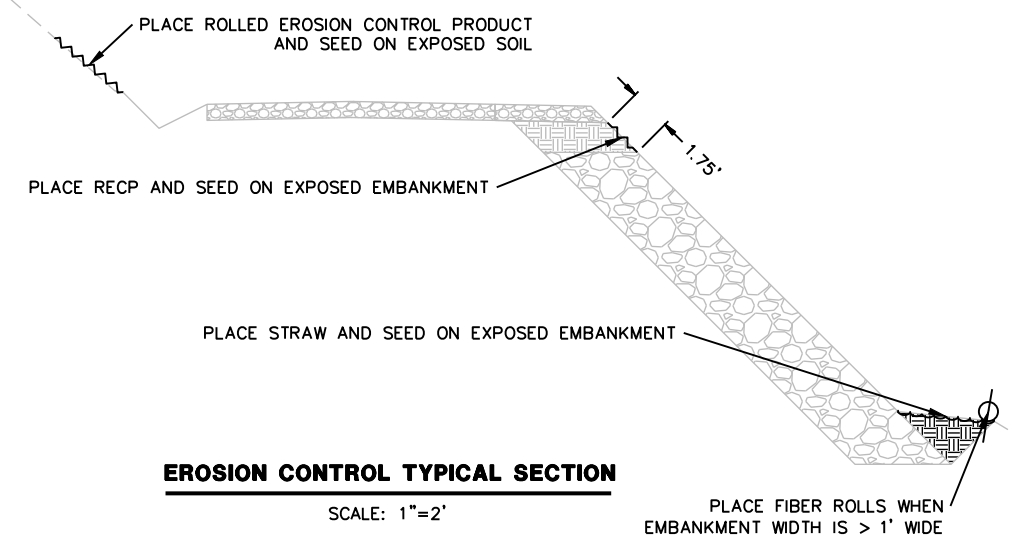

EROSION CONTROL TYPICAL SECTION
SCALE: 1"=2'

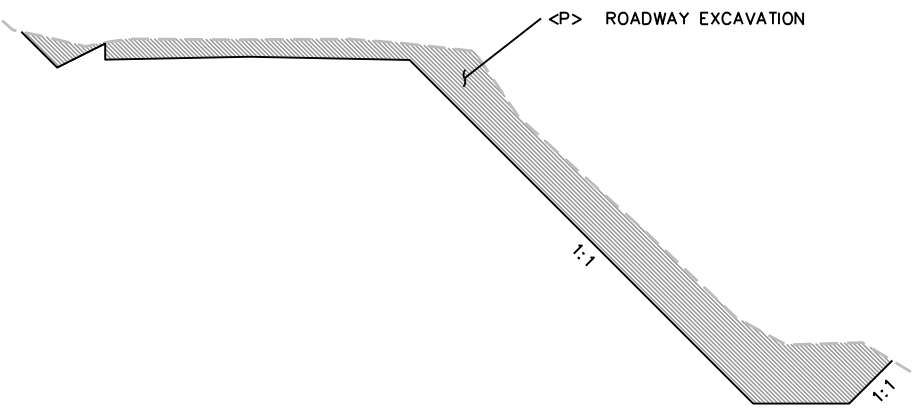

EXCAVATION TYPICAL SECTION
SCALE: 1"=4'



ROAD NAME: POOLE ROAD
 ROAD NO.: 2G015 MILE POST: 2.00
 DESIGN SECTION: ENGINEERING
 DESIGNED BY: MMS
 DRAWN BY: MMS
 REVIEWED BY: JAB
 APPROVED BY: TRS
 FEMA PROJECT NO.: FEMA-4434-DR-CA PW#114
 CONTRACT NO.: 219320
 DRAWING FILE NAME: 219320 Design
 PLOT DATE: 2/15/2024

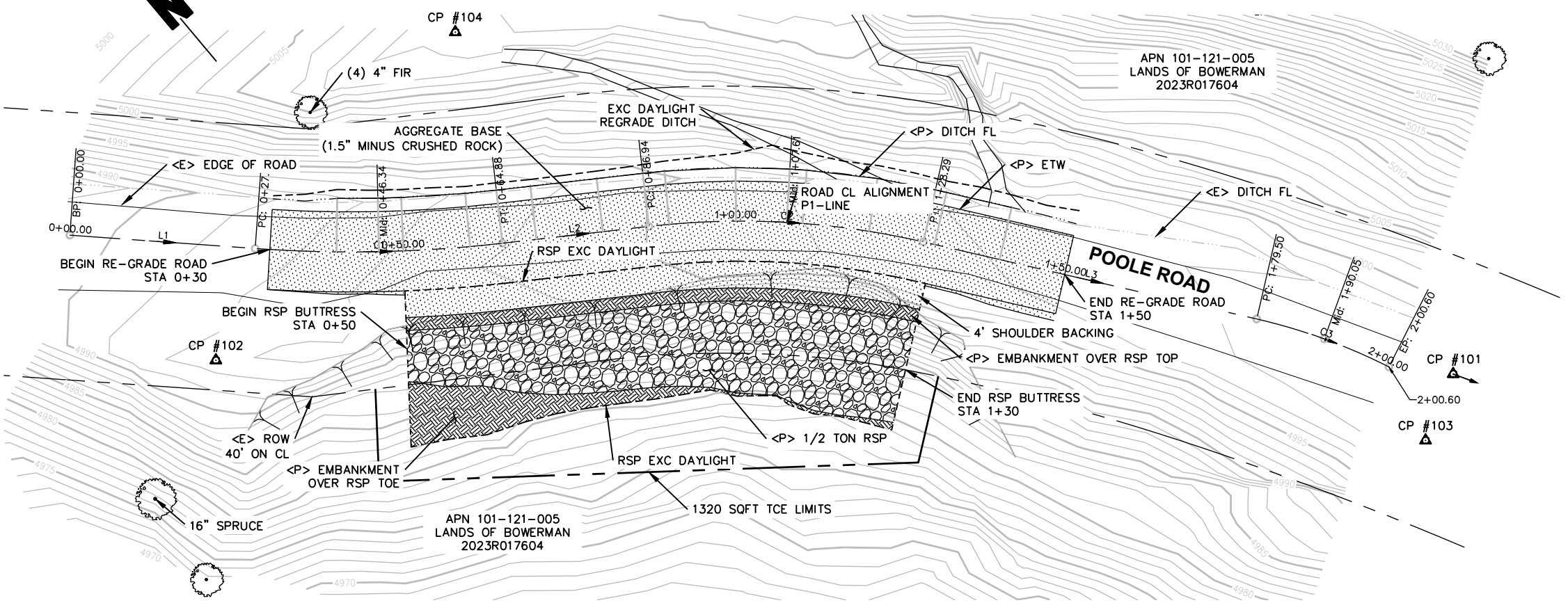

SEGMENT	LENGTH	BEARING/Delta	RADIUS	TANGENT	START	END
L1	27.81'	S45°53'07"E			STA: 0+00.00 N: 5364.41 E: 9732.86	STA: 0+27.81 N: 5345.05 E: 9752.83
C1	37.07'	010°40'21"	199.00'	18.59'	STA: 0+27.81 N: 5345.05 E: 9752.83	STA: 0+64.88 N: 5321.87 E: 9781.68
L2	22.06'	S56°33'28"E			STA: 0+64.88 N: 5321.87 E: 9781.68	STA: 0+86.94 N: 5309.71 E: 9800.09
C2	41.35'	019°34'47"	121.00'	20.88'	STA: 0+86.94 N: 5309.71 E: 9800.09	STA: 1+28.29 N: 5281.53 E: 9830.07
L3	51.22'	S36°58'41"E			STA: 1+28.29 N: 5281.53 E: 9830.07	STA: 1+79.50 N: 5240.61 E: 9860.88
C3	21.10'	013°50'29"	87.34'	10.60'	STA: 1+79.50 N: 5240.61 E: 9860.88	STA: 2+00.60 N: 5222.40 E: 9871.42

POINT #	DESCRIPTION	NORTHING	EASTING	ELEVATION
101	CP/80D&TAGHUMCOSURVEY	5000.000	10000.000	5000.00
102	CP/80D&TAGHUMCOSURVEY	5335.979	9737.505	4992.66
103	CP/80D&TAGHUMCOSURVEY	5210.395	9868.492	4998.72
104	CP/60D&TAGHUMCOSURVEY	5350.592	9796.548	5008.78

SURVEY NOTES

THE BEARINGS ARE BASED ON TIES BETWEEN THE CONTROL POINT #101 AND CONTROL POINT #102 WITH A COMPASS BEARING OF N38°00'00"W. COORDINATE SYSTEM IS ASSUMED WITH CONTROL POINT #101 BEING 5,000 NORTHING AND 10,000 EASTING.
 ELEVATIONS ARE BASED UPON THE ASSUMED ELEVATION OF CONTROL POINT #101 BEING 5000.00'.
 THE RIGHT OF WAY FOR THIS PROJECT IS 40', 20' EACH SIDE OF CENTERLINE, BASED UPON DEDICATIONS PER PARCEL MAP BOOK 34, PAGES 128-131.

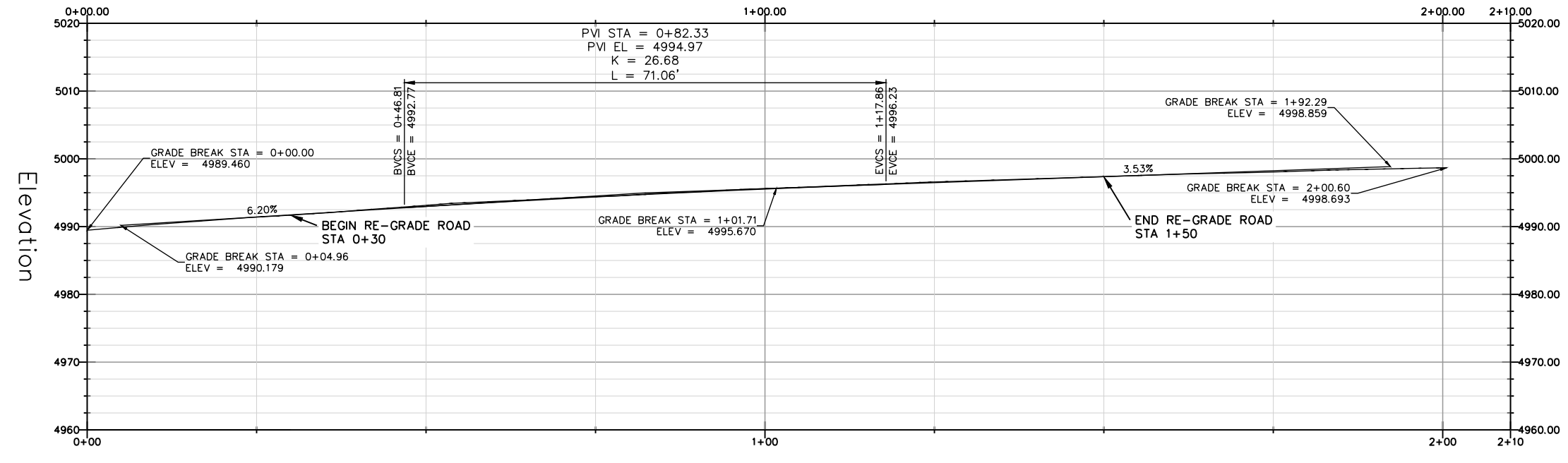

PROFILE VIEW

SCALE: 1"=10'



BAR IS ONE INCH ON ORIGINAL DRAWING IF NOT ONE INCH ON THIS SHEET, ADJUST SCALES ACCORDINGLY	ROAD NAME: POOLE ROAD	DESIGN SECTION
	ROAD NO.: 20015	ENGINEERING
	FEMA PROJECT NO.: FEMA-4434-DR-CA PW#114	DESIGNED BY: MMS
	CONTRACT NO.: 219320	DRAWN BY: MMS
	DRAWING FILE NAME: 219320 Design	REVIEWED BY: JAB
	PLOT DATE: 2/15/2024	APPROVED BY: TRS

COUNTY OF HUMBOLDT DEPARTMENT OF PUBLIC WORKS
POOLE ROAD PM 2.00 SD REPAIR
SECTION VIEWS (0+30 TO 1+50)

SHEET
5
OF
9

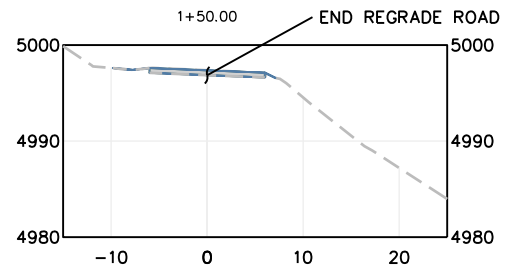
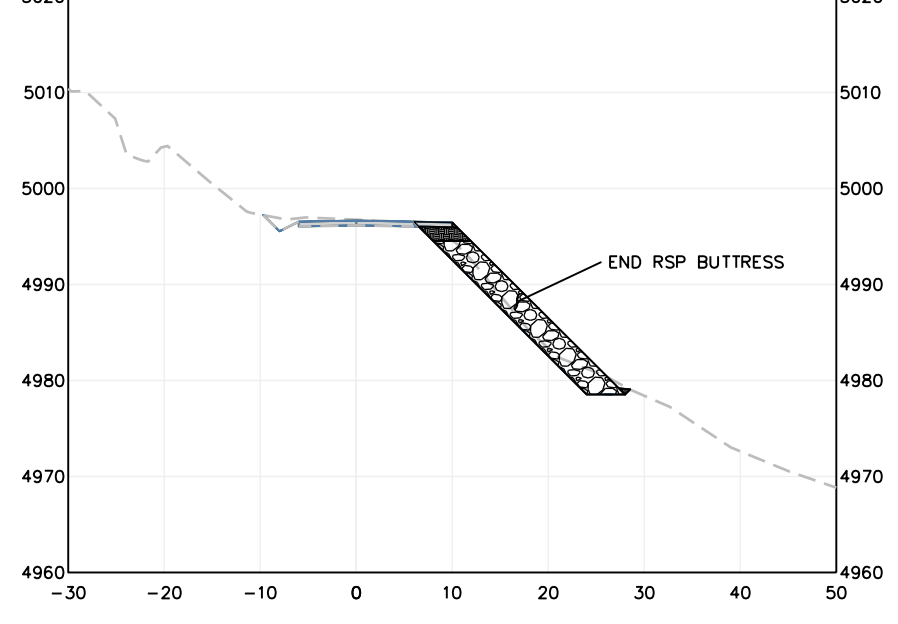
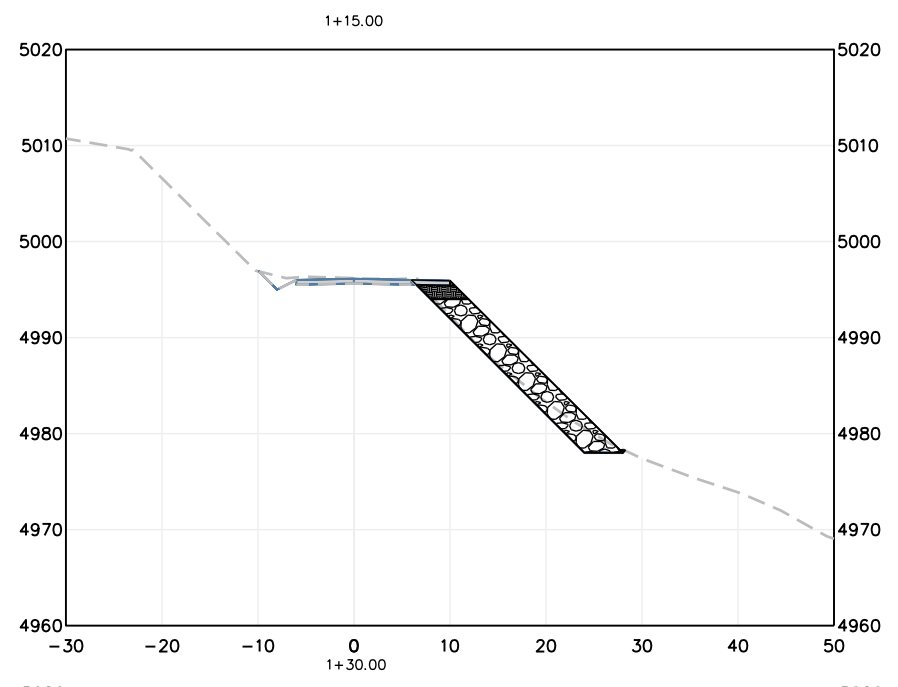
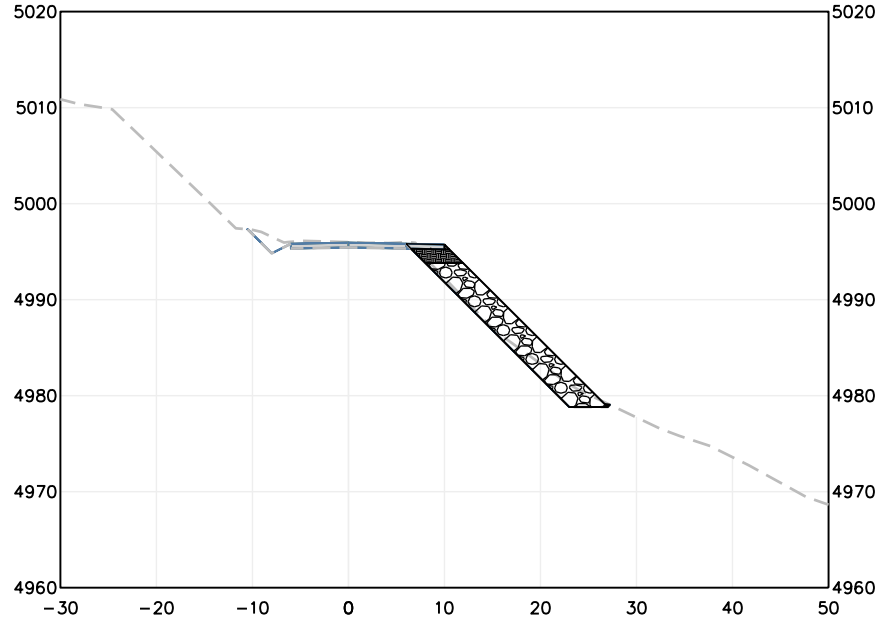
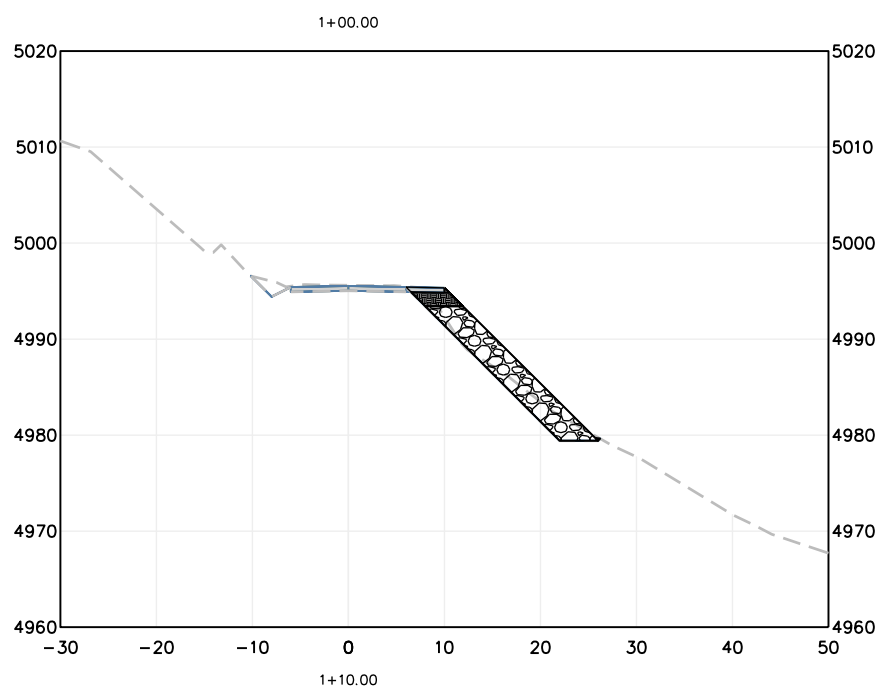
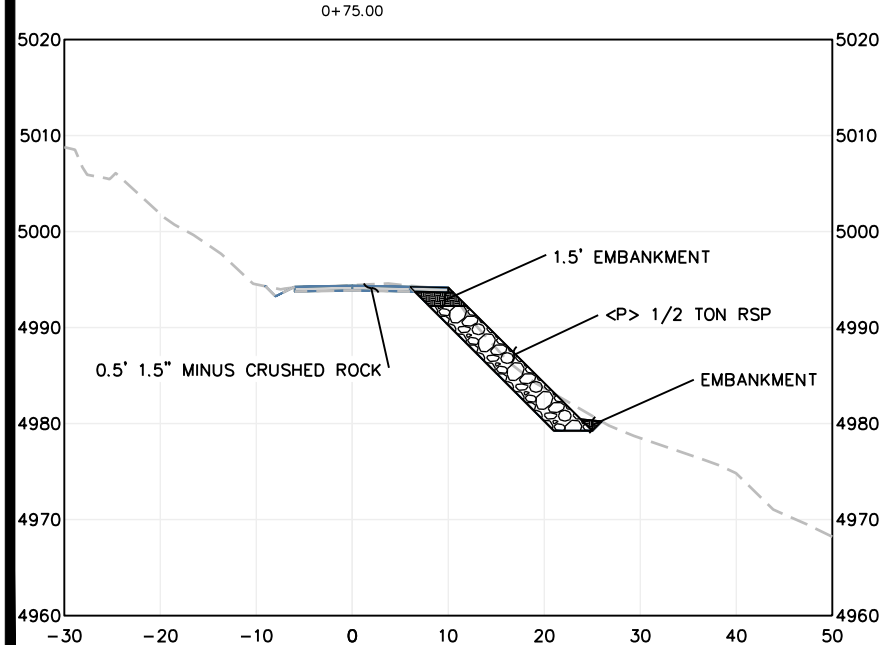
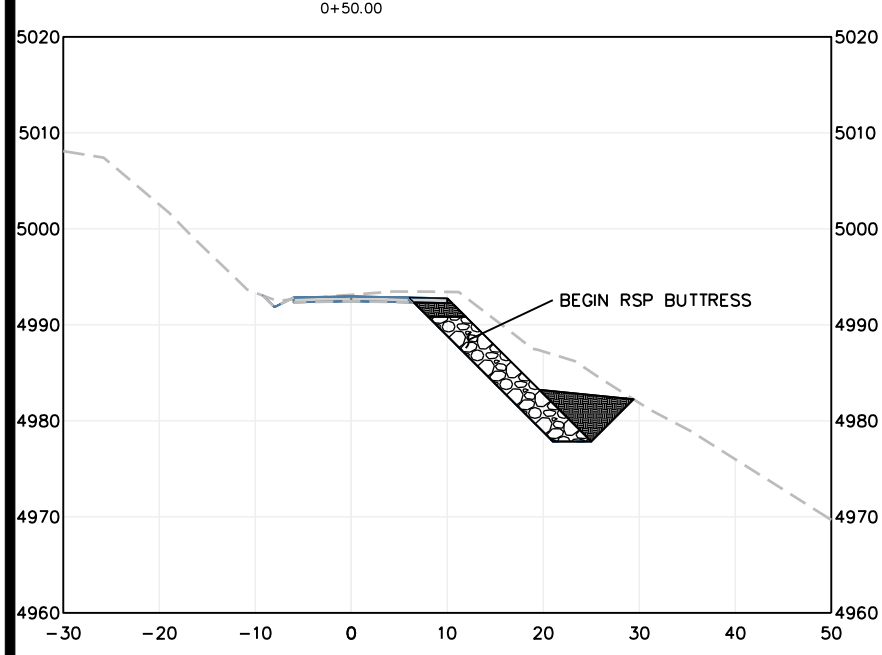
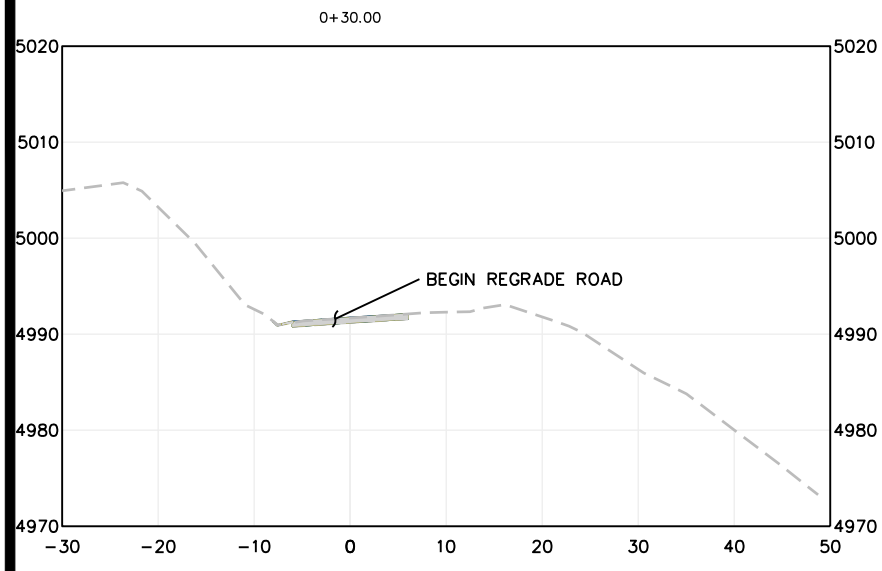

SECTION VIEWS
SCALE: 1"=10'



ROAD NAME: POOLE ROAD	DESIGN SECTION: ENGINEERING
ROAD NO.: 20015	MILE POST: 2.25
FEMA PROJECT NO.: FEMA-4434-DR-CA PW#114	DESIGNED BY: MMS
CONTRACT NO.: 219321	DRAWN BY: MMS
DRAWING FILE NAME: 219321_PooleRd2.25 Design	REVIEWED BY: JAB
PLOT DATE: 11/15/2023	APPROVED BY: TRS

COUNTY OF HUMBOLDT DEPARTMENT OF PUBLIC WORKS POOLE ROAD PM 2.25 SD REPAIR PLAN AND PROFILE	SHEET 6 OF 9
--	-------------------------------------

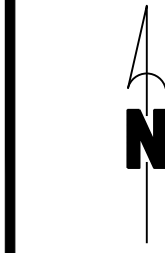

CP #104

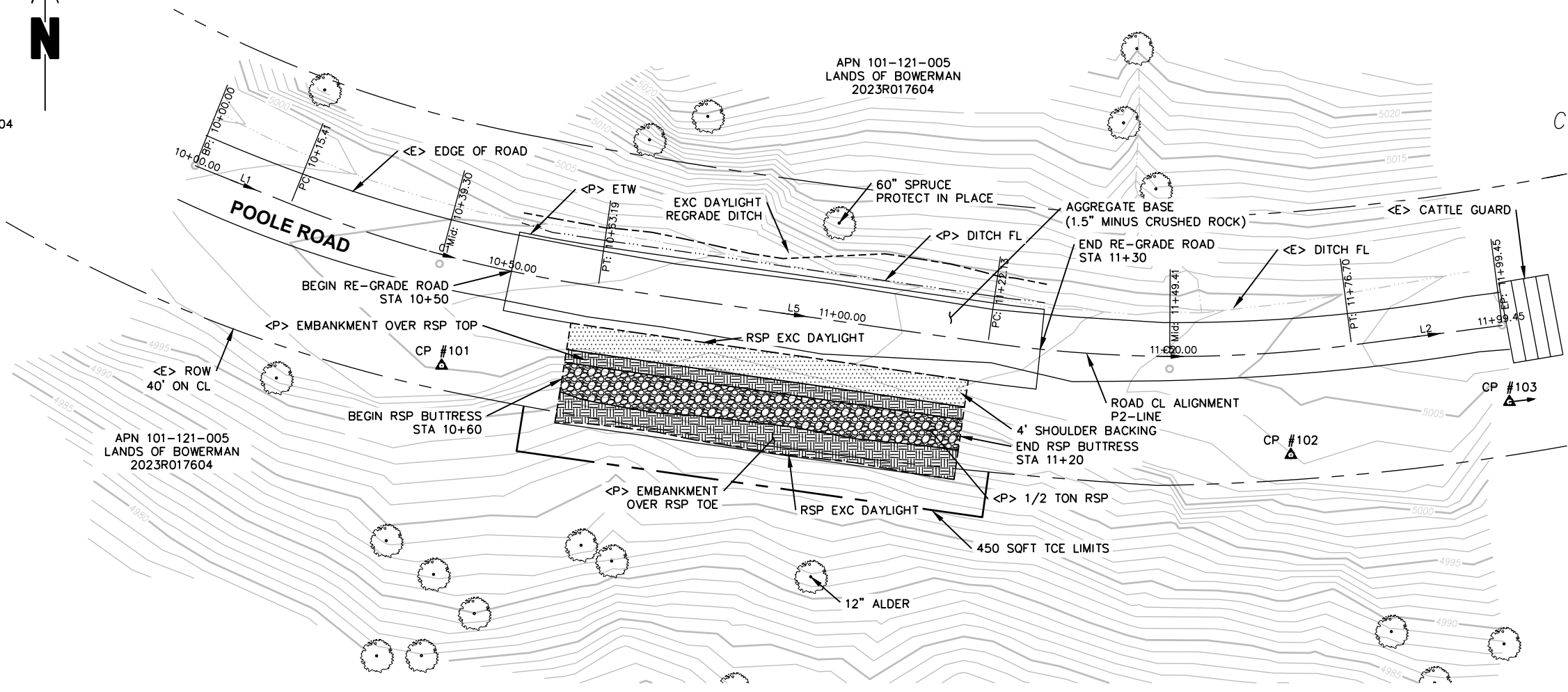

SEGMENT	LENGTH	BEARING/DELTA	RADIUS	TANGENT	START	END
L1	15.41'	S68°07'31\"E			STA: 10+00.00 N: 5029.93 E: 9963.10	STA: 10+15.41 N: 5024.19 E: 9977.40
C1	47.78'	013°41'19\"	200.00'	24.01'	STA: 10+15.41 N: 5024.19 E: 9977.40	STA: 10+63.19 N: 5011.83 E: 10023.44
L5	58.93'	S81°48'49\"E			STA: 10+63.19 N: 5011.83 E: 10023.44	STA: 11+22.13 N: 5003.43 E: 10081.77
C2	54.58'	015°38'08\"	200.00'	27.46'	STA: 11+22.13 N: 5003.43 E: 10081.77	STA: 11+76.70 N: 5003.08 E: 10136.18
L2	22.75'	N82°33'03\"E			STA: 11+76.70 N: 5003.08 E: 10136.18	STA: 11+99.45 N: 5006.03 E: 10158.73

POINT #	DESCRIPTION	NORTHING	EASTING	ELEVATION
101	CP/80D&TAGHUMCOSURVEY	5000.000	10000.000	5000.00
102	CP/80D&TAGHUMCOSURVEY	4986.640	10127.108	5004.06
103	CP/80D&TAGHUMCOSURVEY	5007.542	10266.601	5010.71
104	CP/80D&TAGHUMCOSURVEY	5033.937	9931.800	4997.38

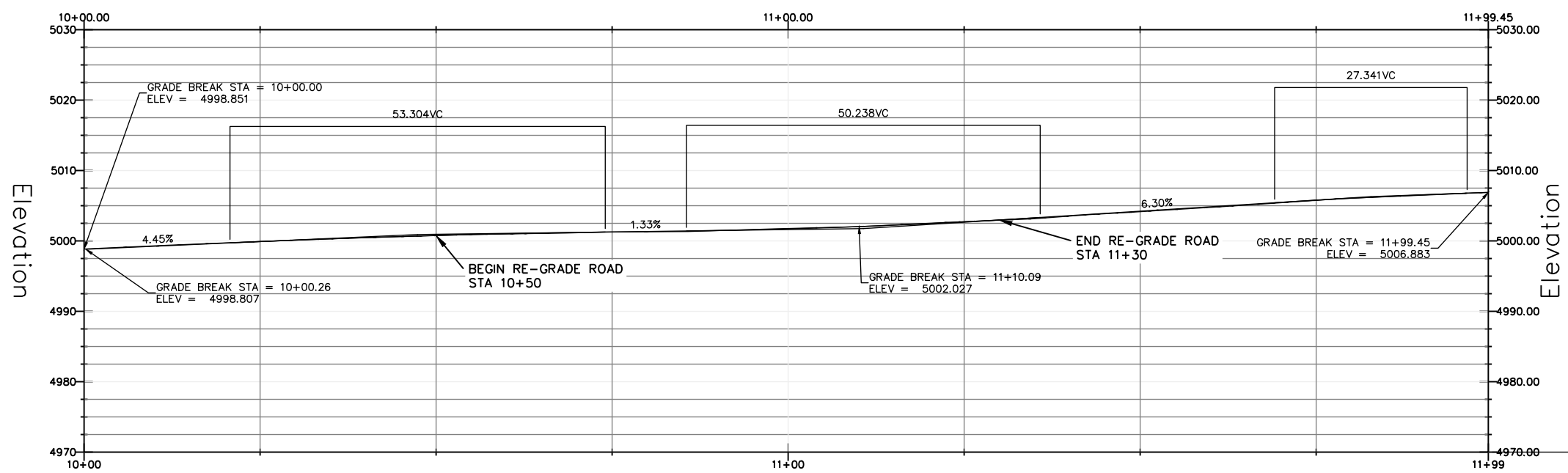

SURVEY NOTES

THE BEARINGS ARE BASED ON TIES BETWEEN THE CONTROL POINT #101 AND CONTROL POINT #102 WITH A COMPASS BEARING OF S84°00'00\"E. COORDINATE SYSTEM IS ASSUMED WITH CONTROL POINT #101 BEING 5,000 NORTHING AND 10,000 EASTING.

ELEVATIONS ARE BASED UPON THE ASSUMED ELEVATION OF CONTROL POINT #101 BEING 5000.00'.

THE RIGHT OF WAY FOR THIS PROJECT IS 40', 20' EACH SIDE OF CENTERLINE, BASED UPON DEDICATIONS PER PARCEL MAP BOOK 34, PAGES 128-131.



ROAD NAME: POOLE ROAD	DESIGN SECTION
ROAD NO.: 20015	ENGINEERING
MILE POST: 2.25	DESIGNED BY: MMS
FEMA PROJECT NO.: FEMA-4434-DR-CA PW#114	DRAWN BY: MMS
CONTRACT NO.: 219321	REVIEWED BY: JAB
DRAWING FILE NAME: 219321_PooleRd2.25 Design	APPROVED BY: TRS
PLOT DATE: 11/15/2023	

COUNTY OF HUMBOLDT DEPARTMENT OF PUBLIC WORKS	SHEET 7 OF 9
POOLE ROAD PM 2.25 SD REPAIR	
SECTION VIEWS (10+50 TO 11+30)	

BAR IS ONE INCH ON ORIGINAL DRAWING
IF NOT ONE INCH ON THIS SHEET, ADJUST SCALES ACCORDINGLY

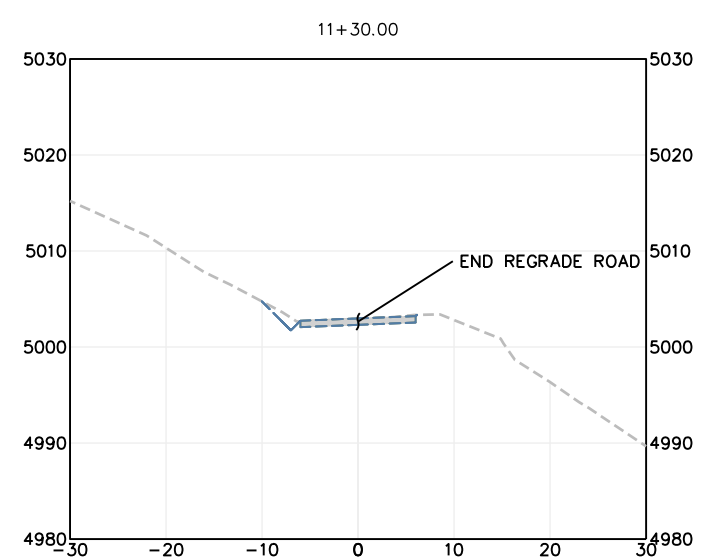
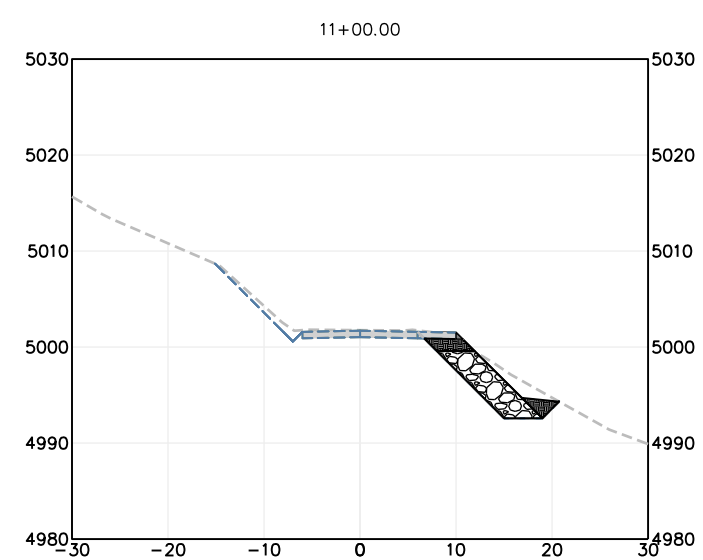
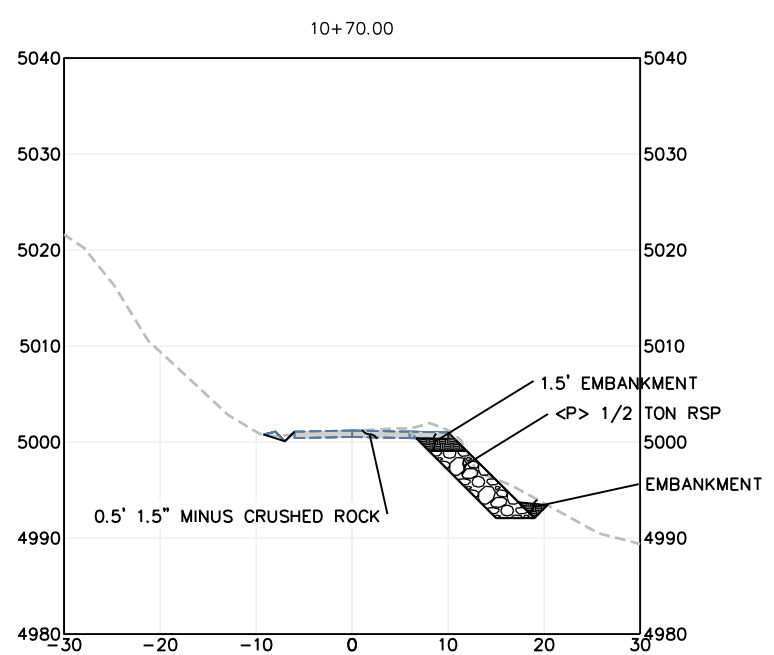
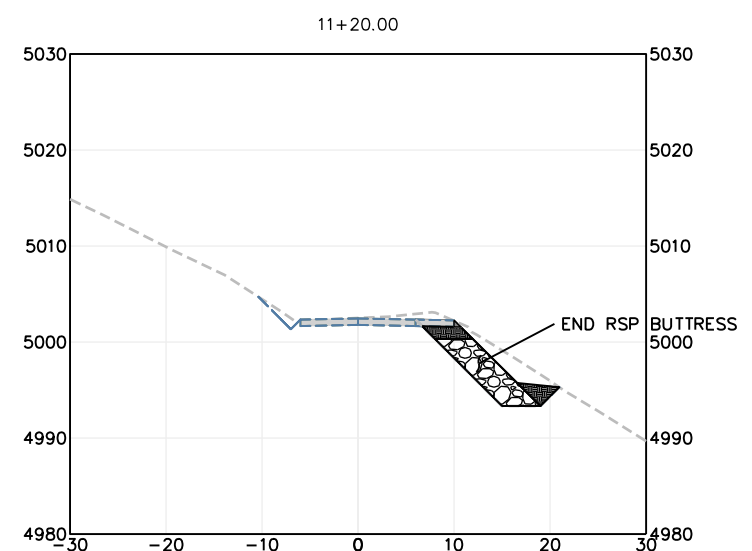
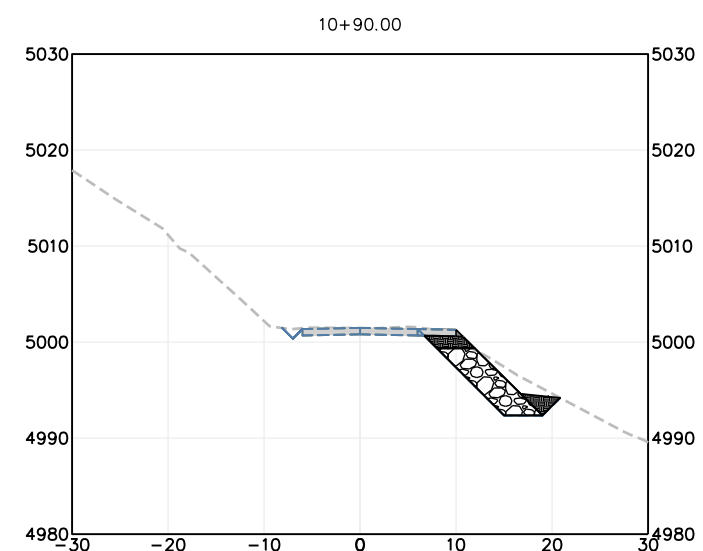
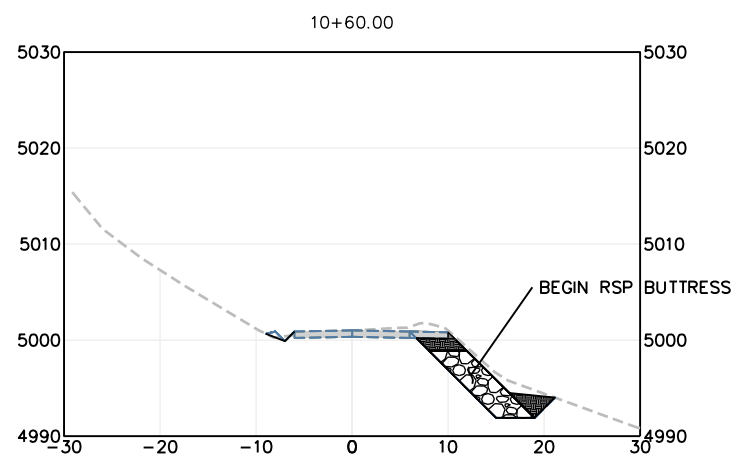
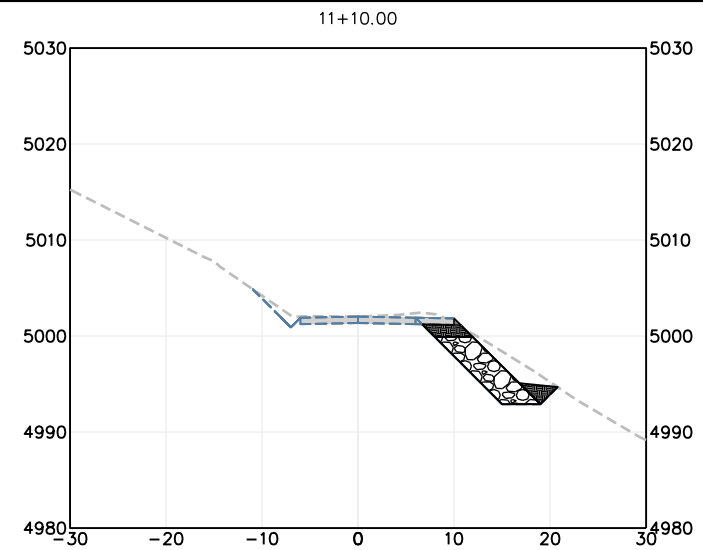
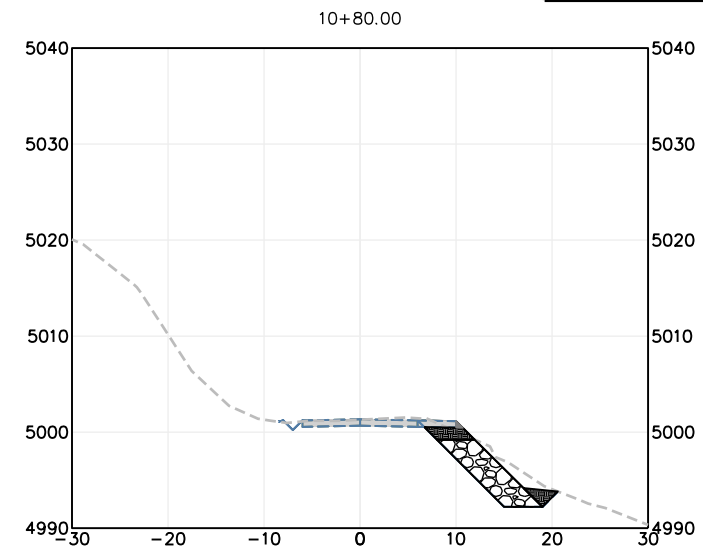
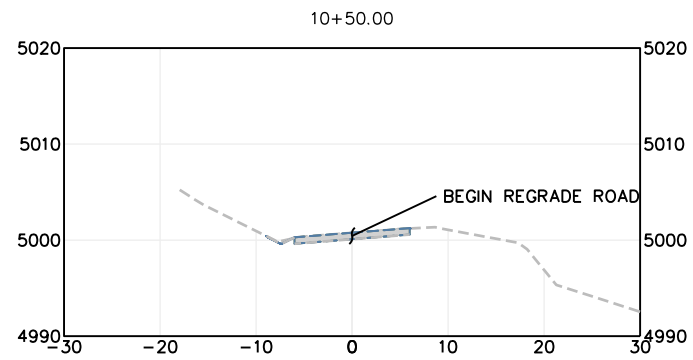

SECTION VIEWS

SCALE: 1"=10'



ROAD NAME: POOLE ROAD	MILE POST: 2.36
ROAD NO.: 20015	
FEMA PROJECT NO.: FEMA-4434-DR-CA PW#114	
CONTRACT NO.: 219322	
DRAWING FILE NAME: 219321_PooleRd2.36 Design	
PLOT DATE: 11/15/2023	

DESIGN SECTION	ENGINEERING
DESIGNED BY: MMS	
DRAWN BY: MMS	
REVIEWED BY: JAB	
APPROVED BY: TRS	

COUNTY OF HUMBOLDT
DEPARTMENT OF PUBLIC WORKS
POOLE ROAD PM 2.36 SD REPAIR
PLAN AND PROFILE

SHEET
8
OF
9

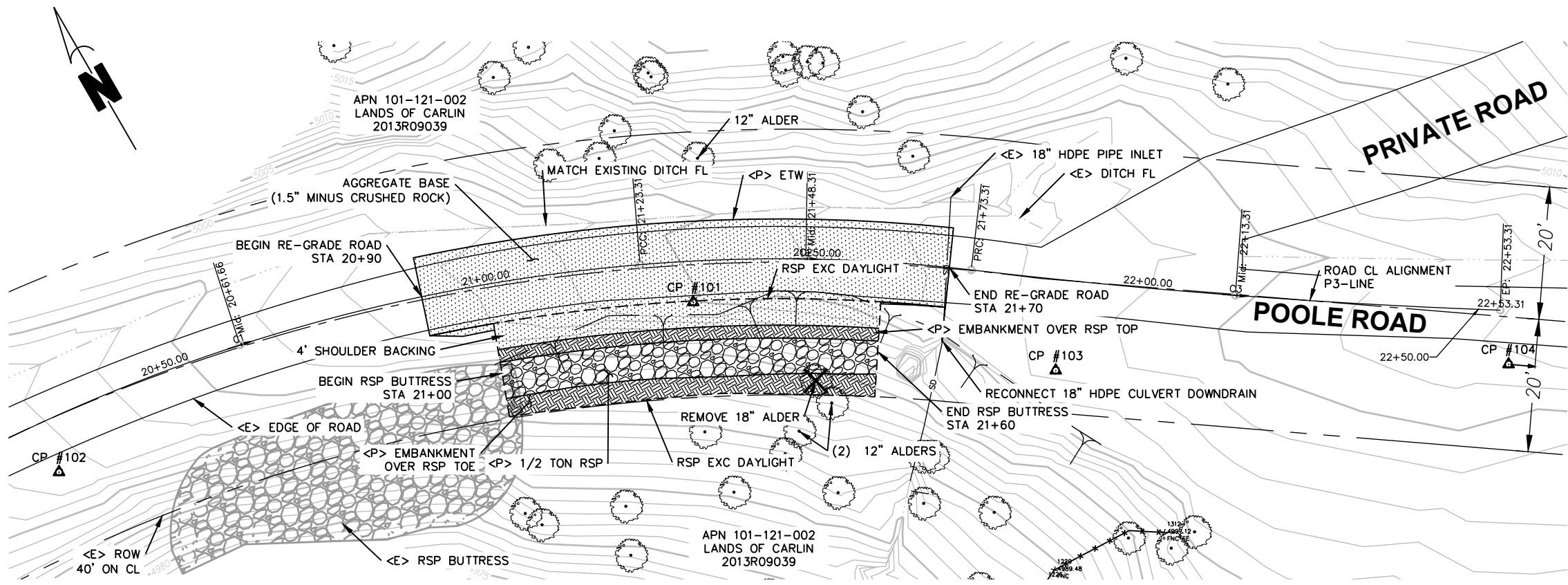

PLAN VIEW
SCALE: 1"=10'

SEGMENT	LENGTH	BEARING/Delta	RADIUS	TANGENT	START	END
C1	123.31'	026°10'03"	270.00'	62.75'	STA: 20+00.00 N: 50034.51 E: 59876.37	STA: 21+23.31 N: 50008.89 E: 59995.90
C2	50.00'	011°27'33"	250.00'	25.08'	STA: 21+23.31 N: 50008.89 E: 59995.90	STA: 21+73.31 N: 49983.25 E: 60038.72
C3	80.00'	004°35'01"	1000.00'	40.02'	STA: 21+73.31 N: 49983.25 E: 60038.72	STA: 22+53.31 N: 49938.12 E: 60104.75

POINT #	DESCRIPTION	NORTHING	EASTING	ELEVATION
101	CP /80D&TAGHUMCOSURVEY	50000.000	60000.000	5000.00
102	CP /80D&TAGHUMCOSURVEY	50025.613	59904.412	4992.54
103	CP /80D&TAGHUMCOSURVEY	49963.762	60042.185	5003.53
104	CP /80D&TAGHUMCOSURVEY	49906.989	60135.192	5008.55

SURVEY NOTES

THE BEARINGS ARE BASED ON TIES BETWEEN THE CONTROL POINT #101 AND CONTROL POINT #102 WITH A COMPASS BEARING OF N75°00'00"W. COORDINATE SYSTEM IS ASSUMED WITH CONTROL POINT #101 BEING 50,000 NORTHING AND 60,000 EASTING.

ELEVATIONS ARE BASED UPON THE ASSUMED ELEVATION OF CONTROL POINT #101 BEING 5000.00'.

THE RIGHT OF WAY FOR THIS PROJECT IS 40', 20' EACH SIDE OF CENTERLINE, BASED UPON DEDICATIONS PER PARCEL MAP BOOK 34, PAGES 128-131.

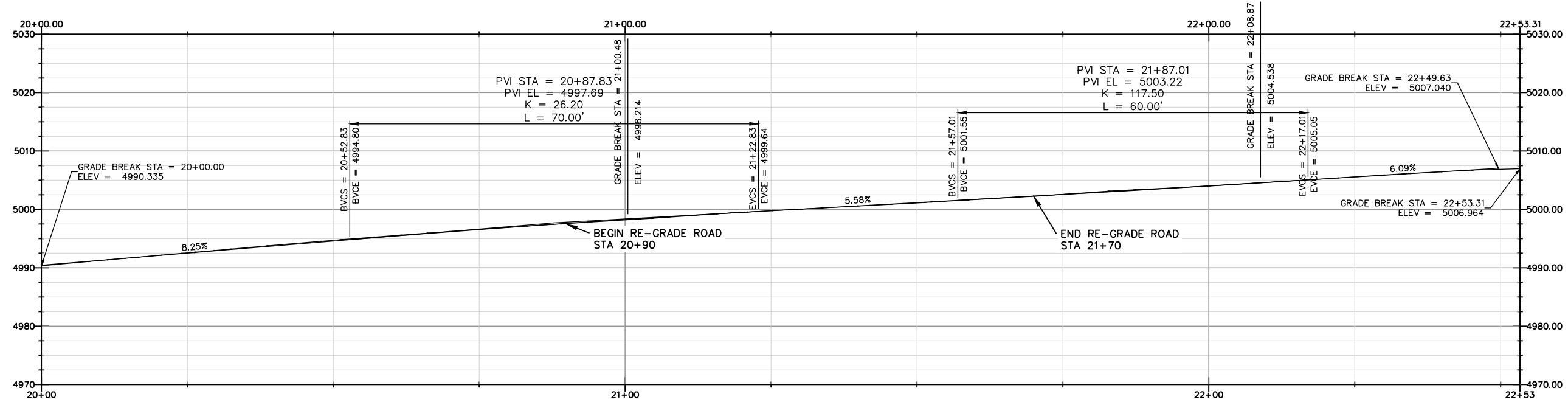

PROFILE VIEW
SCALE: 1"=10'



BAR IS ONE INCH ON ORIGINAL DRAWING IF NOT ONE INCH ON THIS SHEET, ADJUST SCALES ACCORDINGLY	ROAD NAME: POOLE ROAD	DESIGN SECTION
	ROAD NO.: 20015	ENGINEERING
	FEMA PROJECT NO.: FEMA-4434-DR-CA PW#114	DESIGNED BY: MMS
	CONTRACT NO.: 219322	DRAWN BY: MMS
	DRAWING FILE NAME: 219321_PooleRd2.36 Design	REVIEWED BY: JAB
	PLOT DATE: 11/15/2023	APPROVED BY: TRS

COUNTY OF HUMBOLDT DEPARTMENT OF PUBLIC WORKS	SECTION VIEWS (20+90 TO 21+70)	
		POOLE ROAD PM 2.36 SD REPAIR
		DESIGN SECTION

SHEET
9
OF
9

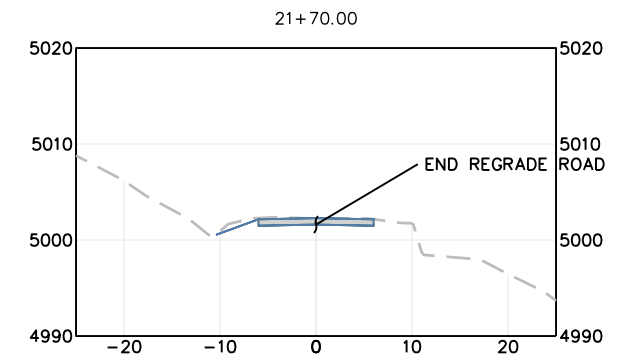
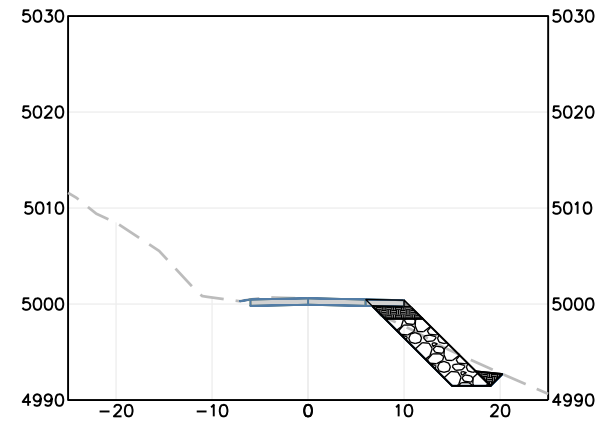
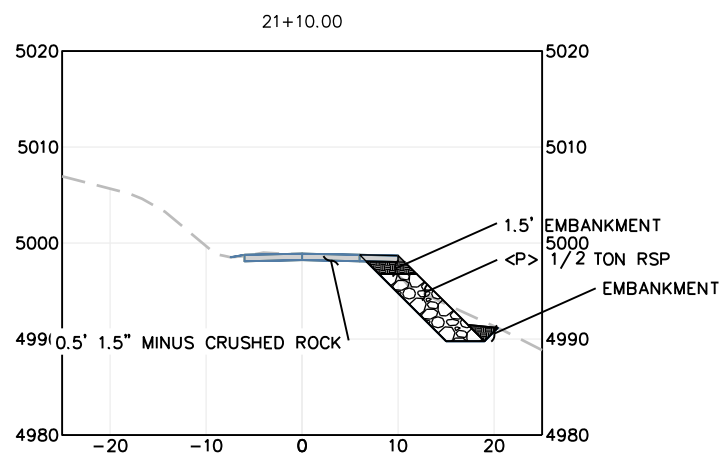
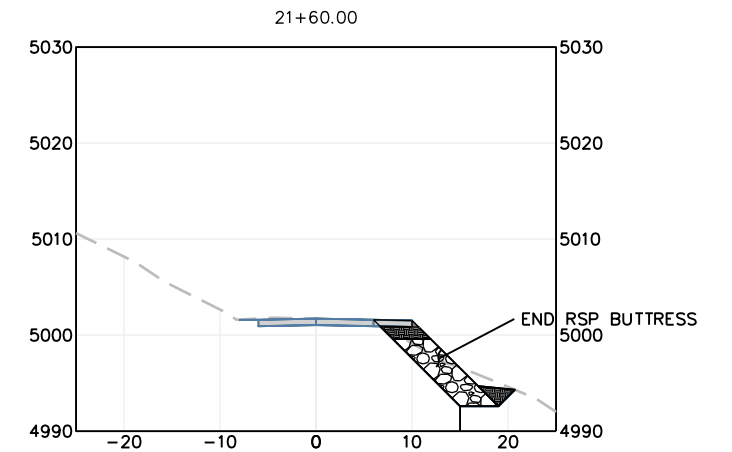
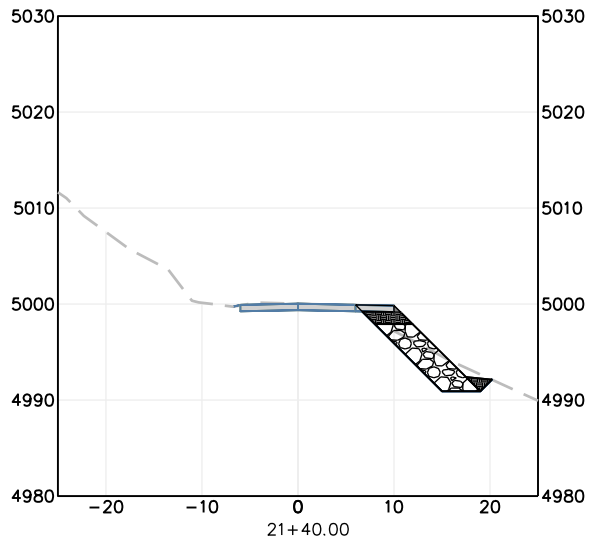
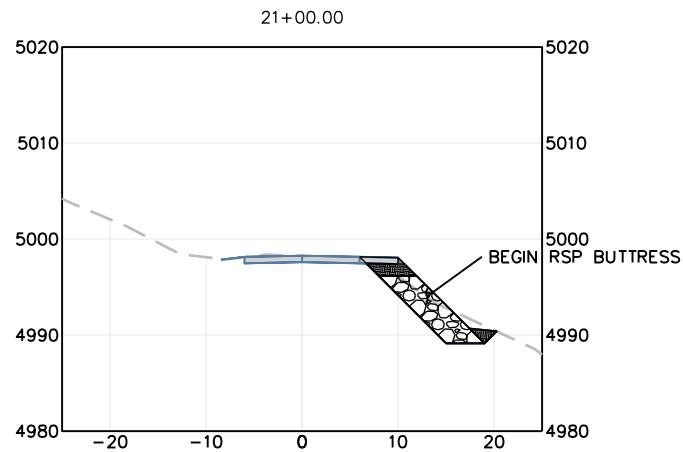
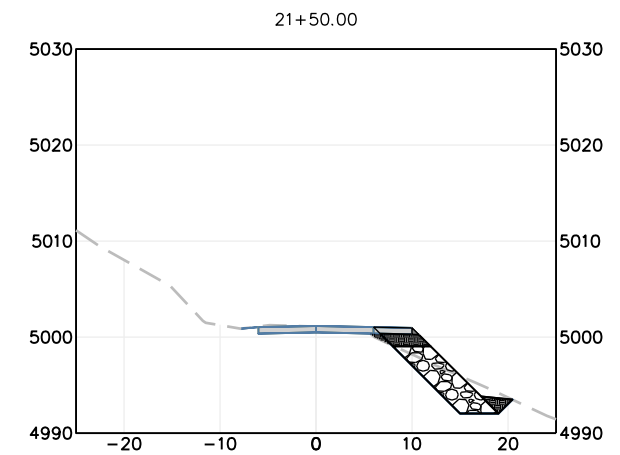
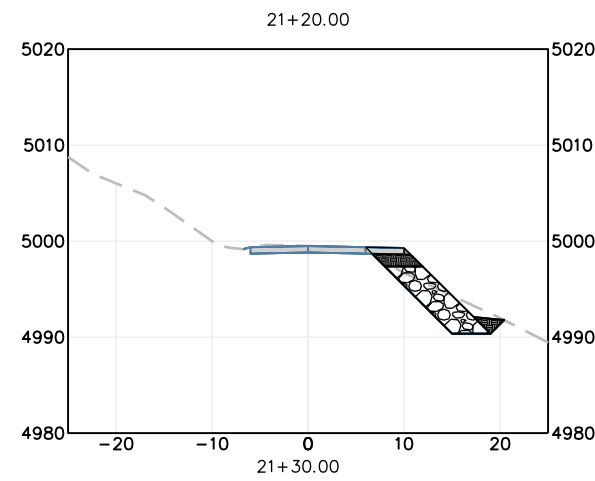
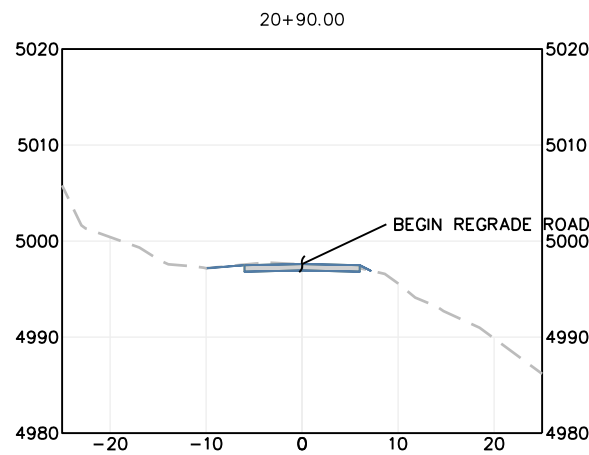

SECTION VIEWS

SCALE: 1"=10'