

SZS ENGINEERING ACCESS

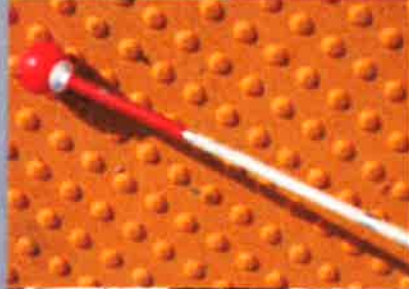

COUNTY OF HUMBOLDT, CALIFORNIA

SOCIAL SERVICES

ADA ACCESS COMPLIANCE ASSESSMENT

600 W CLARK STREET, EUREKA CA
(COUNTY LEASED FACILITY)

Sacramento Office
770 L Street, Suite 950
Sacramento, CA 95814
Email: Info@szs.engineering
Tel: 916.669.8750
Fax: 888.211.7441

Silicon Valley Office
2225 E. Bayshore Road, Suite 200
Palo Alto CA 94303
Tel: 866.694.7637
www.szs.engineering

September 26, 2018



Humboldt County Administrative Office
Management and Budget Team
825 Fifth Street, Room 112
Eureka, California 95501
Attention: Chris Shaver, Asst. CAO

Re: SOCIAL SERVICES – 600 W CLARK ST – ADA ACCESS COMPLIANCE ASSESSMENT

Dear Mr. Shaver,

We are pleased to submit this report as a first step in the process to identify barriers to access for the County of Humboldt. This process will allow the County to apply programmatic accessibility before resorting to physical barrier removal, in order to conserve funds while meeting the goal of improving access.

This has been an informative process. We look forward to creating an updated digital remediation program to facilitate implementation. Please review the report and provide input. We welcome collaboration in this process.

Contact me with any questions you may have.

Regards,

Syroun Z. Sanossian, Principal
SZS Engineering Access, Inc.



TABLE OF CONTENTS

1. EXECUTIVE SUMMARY	p. 1
A. Private Entities, Public Accommodations and the ADA	p. 3
B. Safe Harbor Provisions	p. 7
C. Barrier Severity Ratings and Remediation	p. 8
D. Official Responsible	p. 9
E. Recommended Barrier Removal Priorities	p. 9
F. Cost Estimates	p. 11
G. Exterior Spaces	p. 11
H. Facility Entrances	p. 12
I. Report Format Definitions	p. 13
2. EXTERIOR SPACES	p. 16
3. INTERIOR SPACES	p. 16
4. BARRIER DATA RECORDS	
A. Barrier Data Records	p. 18
B. Cost Estimate	p. 71
5. APPENDIX	
A. Reference Drawings	p. 72



1. EXECUTIVE SUMMARY

This ADA Access Compliance Assessment was compiled for the Social Services Building F facility at 600 West Clark Street in Eureka. This structure is leased by the County of Humboldt as a location where the County can provide county programs, services and activities. As a privately owned facility in which public activities take place, the facility is defined under the ADA as a public accommodation.

This report was developed to fulfill requirements under the consent decree entered into by the County of Humboldt with the US Department of Justice (DOJ). The United States alleged that Humboldt County has discriminated, and continues to discriminate, against individuals with disabilities by failing to make County facilities, programs, services, and activities accessible to and useable by individuals with disabilities in violation of the ADA.

The DOJ initiated a compliance review of Humboldt County under its Project Civic Access ("PCA") initiative, a wide-ranging effort to ensure that cities, counties, and other public entities throughout the country comply with the ADA by eliminating physical, communication, and other barriers that prevent people with disabilities from participating fully in community life. The DOJ's review of the County included a review of its programs and an accessibility survey of over 50 facilities, although the consent decree governs all facilities in which County programs, services or activities take place¹. As the result of its review, the Department found numerous violations of the ADA, notified the County of the violations and negotiated a settlement agreement in which the County committed to bring its facilities, programs, services and activities into compliance with the ADA.

SZS Engineering Access, Inc. is the Independent Licensed Architect ("ILA"), pre-approved by the DOJ, acting independently to certify whether any alterations, additions, or modifications made by the County during the term of this Consent Decree comply with the applicable standard pursuant to 28 C.F.R. § 35.151(c) and the Appendix to 28 C.F.R. § 35.151(c)².

In issuing certifications pursuant to this Consent Decree, the ILA will impartially prepare reports identifying each violation and demonstrating with photographs each violation that has been remediated. The ILA is considered a neutral inspector for purposes of issuing certifications of compliance.

Under the consent decree, the County agreed not to deny the benefits of its programs, services, and activities³ or discriminate against individuals with a disability, and will not, based on disability provide an unequal, different, or separate opportunity to participate in its programs, services, and activities⁴.

The intent of this assessment report is to identify physical barriers to access, so that design professionals can use the information to ensure that alterations to facilities that house County programs, services and activities result in facilities that are accessible to and usable by people with disabilities. This facility is owned by a private party. Where the owner leases the facility for use as a public accommodation, the facility must comply with requirements to provide access

¹ US v. County of Humboldt, US v. County of Humboldt, Civil Action No. 16-5139, Attachment - G, H, I, J

² 28 C.F.R. § 35.151(c) and the Appendix to 28 C.F.R. § 35.151(c)

³ 28 C.F.R. § 35.130(b)(1).

⁴ 28 C.F.R. § 35.130(b)(1), (3).



to a public accommodation. If the County were to vacate this facility, the requirements will remain in place for any other parties leasing the facility that provide public accommodations.

The field investigation began on October 20, 2017. Images of each physical element identified in this report were captured in HD digital photos while manual measurements were taken to establish as-built conditions for the process of cost estimating. Digital photographs are provided within this report for each barrier to access to facilitate the review of the data collected. Technical data can be interpreted more efficiently with a visual component; the photos provide a clear connection between the technical data described in each barrier data record and the physical barrier to access identified.

When taking measurements in exterior areas, visual markers are used to indicate the location or beginning and end of a barrier such as a cross slope. Red cups or the digital level used to take measurements will be used in photos as a visual marker to indicate the location of these exterior barriers within the context of the existing site conditions.

The Social Services Building F facility is a structure that was built since the enforcement of the Americans with Disabilities Act and is required to comply with new construction standards.

ADA Title III holds that no individual shall be discriminated against on the basis of disability in the full and equal enjoyment of the goods, services, facilities, privileges, advantages, or accommodations of any place of public accommodation by any private entity who owns, leases (or leases to), or operates a place of public accommodation. The findings presented are both narrative and technical in nature. Physical barriers to access identified during the field investigation process are documented in two ways:

1. Summary and Analysis: An analysis of findings is provided in a narrative form that describes particular barriers identified in the following records to help ensure that the findings for atypical situations can be further explained. The intent of this information is to provide a discussion on the functionality of physical elements. Background reasoning and research behind the identification of barriers is also provided where universal design principles may play a role. This analysis may be accompanied by digital photographs or diagrams, where applicable. Understanding building function and usage is essential when interpreting the findings held in this report. The narrative is intended to facilitate this process.
2. Barrier Data Records: Individual barriers to access are entered into the ADA/Access Compliance database so that technical information on each individual barrier can be provided a barrier data record. These barrier data records include detailed information including digital photographs of each barrier identified, code references that determine the barrier to access, as-built measurements, barrier severity ratings, budgetary cost estimates, recommended solutions for barrier removal and a priority for barrier removal will be assigned in the final report. The information is formatted with two barriers on each report page.

Each barrier identified in this report is designated as either required for removal or recommended for removal. State and federal model code provide the basis for most of the barrier identification contained in this report. There are other barriers to access that are dictated by case law precedent, vehicle code, health code, safety code and labor code. Most barriers identified in this report are based on those requirements but additional barriers exist



that are not based on these regulations or statutes. Barriers that are recommended for removal are based on pending regulations or good practices. The associated field provides two options for each barrier: Required or Recommended.

It is important to note that the barriers identified in this report reflect the most stringent requirements from the 2010 ADA Standards, California Code of Regulations/Title 24 and the California edition of the Manual on Uniform Traffic Control Devices (MUTCD). These model codes are not identical and contain conflicting requirements. To ensure ADA Access Compliance is achieved, this report is based on the most stringent requirements taken from these model codes.

In order to consolidate the barrier data, some of the more typical barriers found in multiple locations have been grouped within the barrier data records with a description of the locations in which they were found. For instance, this occurs where barriers were identified in stairways that have existing handrails that continue through multiple floors.

A. PRIVATE ENTITIES, PUBLIC ACCOMMODATIONS AND THE ADA

The landmark Americans with Disabilities Act (ADA), enacted on July 26, 1990 provides comprehensive civil rights protection to individuals with disabilities in the many areas including employment, telecommunications, facilities that offer public accommodations, and state and local governmental services. The ADA is comprised of five parts, or titles. Each title covers a specific area delineated by the ADA, in which the legislation is intended to enhance accessibility for persons with disabilities. The five titles are as follows:

Title I: Employment Practices by units of State and Local Governments

Title II: Programs, Services and Activities of State and Local Governments

Title III: Public Accommodations and Commercial Facilities (private businesses and non-profit service providers)

Title IV: Telecommunications

Title V: Miscellaneous Provisions

Title III of the Americans with Disabilities Act of 1990 (42 U.S.C. 12181) applies to this property. Title III prohibits discrimination on the basis of disability by public accommodations and requires places of public accommodation and commercial facilities to be designed, constructed, and altered in compliance with the construction-related accessibility standards established by Section 36.101 of the Act. The 2010 ADA Standards have updated the original ADA as of March 2012.

Furthermore, ADA Title III holds that no individual shall be discriminated against on the basis of disability in the full and equal enjoyment of the goods, services, facilities, privileges, advantages, or accommodations of any place of public accommodation by any private entity who owns, leases (or leases to), or operates a place of public accommodation. **Both the landlord who owns the site that houses a place of public accommodation and the tenant who owns or operates the place of public accommodation, are responsible to provide accessible public accommodations subject to the requirements of this Title. As between the parties, allocation of**



responsibility for complying with the obligations of this part may be determined by lease or other contract.⁵ The terms of the lease should define the responsibilities.

ACTIVITIES

Public accommodations also cannot deny participation to persons with disabilities, or provide for unequal or separate benefits for persons with disabilities. The basis of the ADA is the integration of persons with disabilities into society, not the expectation of preference or any type of special treatment.

A public accommodation shall afford goods, services, facilities, privileges, advantages, and accommodations to an individual with a disability in the most integrated setting appropriate to the needs of the individual. The maintenance of accessible features is essential. A public accommodation shall maintain in operable working condition those features of facilities and equipment that are required to be readily accessible to and usable by persons with disabilities by the Act, although this Act or section does not prohibit isolated or temporary interruptions in service or access due to maintenance or repairs.

ELIGIBILITY CRITERIA

A public accommodation shall not impose or apply eligibility criteria that screen out or tend to screen out an individual with a disability or any class of individuals with disabilities from fully and equally enjoying any goods, services, facilities, privileges, advantages, or accommodations, unless such criteria can be shown to be necessary for the provision of the goods, services, facilities, privileges, advantages, or accommodations being offered. But, a public accommodation may impose legitimate safety requirements that are necessary for safe operation. Safety requirements must be based on actual risks and not on mere speculation, stereotypes, or generalizations about individuals with disabilities. A public accommodation also may not impose a surcharge on a particular individual with a disability or any group of individuals with disabilities to cover the costs of measures, such as the provision of auxiliary aids, barrier removal, alternatives to barrier removal, and reasonable modifications in policies, practices, or procedures, that are required to provide that individual or group with the nondiscriminatory treatment required by the Act or this section.

MODIFICATIONS IN POLICIES, PRACTICES OR PROCEDURES

A public accommodation shall make reasonable modifications in policies, practices, or procedures, when the modifications are necessary to afford goods, services, facilities, privileges, advantages, or accommodations to individuals with disabilities, unless the public accommodation can demonstrate that making the modifications would fundamentally alter the nature of the goods, services, facilities, privileges, advantages, or accommodations. This is significant in terms of physical alterations made to improve accessibility for persons with disabilities. A public accommodation may refer an individual with a disability to another public accommodation, if that individual is seeking, or requires, treatment or services outside of the referring public accommodation's area of specialization, and if, in the normal

⁵ Department of Justice ADA Title III Regulations 28 CFR Part 36; Sec.36.105 -- 36.199 [Reserved] Subpart B -- General Requirements Sec.36.201 General. (b)



course of its operations, the referring public accommodation would make a similar referral for an individual without a disability who seeks or requires the same treatment or services.

AUXILIARY AIDS AND SERVICES

A public accommodation shall take steps that may be necessary to ensure that no individual with a disability is excluded, denied services, segregated or otherwise treated differently than other individuals because of the absence of auxiliary aids and services, unless the public accommodation can demonstrate that taking those steps would fundamentally alter the nature of the goods, services, facilities, privileges, advantages, or accommodations being offered or would result in an undue burden, i.e., significant difficulty or expense.

REMOVAL OF BARRIERS

A public accommodation shall remove architectural barriers in existing facilities, including communication barriers that are structural in nature, where design and construction for first occupancy started before January 26, 1993, **and such removal is readily achievable, i.e., easily accomplishable and able to be carried out without much difficulty or expense**⁶. Examples of steps to remove barriers include, but are not limited to, the following actions:

- 1) Installing ramps;
- 2) Making curb cuts in sidewalks and entrances;
- 3) Repositioning shelves;
- 4) Rearranging tables, chairs, vending machines, display racks, and other furniture;
- 5) Repositioning telephones;
- 6) Adding raised markings on elevator control buttons;
- 7) Installing flashing alarm lights;
- 8) Widening doors;
- 9) Installing offset hinges to widen doorways;
- 10) Eliminating a turnstile or providing an alternative accessible path;
- 11) Installing accessible door hardware;
- 12) Installing grab bars in toilet stalls;
- 13) Rearranging toilet partitions to increase maneuvering space;
- 14) Insulating lavatory pipes under sinks to prevent burns;
- 15) Installing a raised toilet seat;
- 16) Installing a full-length bathroom mirror;
- 17) Repositioning the paper towel dispenser in a bathroom;
- 18) Creating designated accessible parking spaces;

⁶ Department of Justice ADA Title III Regulations 28 CFR Part 36; Sec..36.105 -- 36.199 [Reserved] Subpart B -- General Requirements Sec.36.304 Removal of barriers.



- 19) Installing an accessible paper cup dispenser at an existing inaccessible water fountain;
- 20) Removing high pile, low density carpeting; or
- 21) Installing vehicle hand controls.

PRIORITIES

It is recommended that a public accommodation take measures to comply with the barrier removal requirements of this section in accordance with the following order of priorities:

(1) A public accommodation should take measures to provide access to a place of public accommodation from public sidewalks, parking, or public transportation. These measures include, for example, installing an entrance ramp, widening entrances, and providing accessible parking spaces.

(2) Second, a public accommodation should take measures to provide access to those areas of a place of public accommodation where goods and services are made available to the public. These measures include, for example, adjusting the layout of display racks, rearranging tables, providing Brailled and raised character signage, widening doors, providing visual alarms, and installing ramps.

(3) Third, a public accommodation should take measures to provide access to restroom facilities. These measures include, for example, removal of obstructing furniture or vending machines, widening of doors, installation of ramps, providing accessible signage, widening of toilet stalls, and installation of grab bars.

(4) Fourth, a public accommodation should take any other measures necessary to provide access to the goods, services, facilities, privileges, advantages, or accommodations of a place of public accommodation. This may include providing space in the seating area for wheelchair users to maneuver or wait, as able-bodied persons presently do.

No measure shall be taken; however, that poses a significant risk to the health or safety of individuals with disabilities or others. The provision of visual alarms is only required in sites where existing fire alarm systems are provided.

ALTERNATIVES TO BARRIER REMOVAL

Where a public accommodation cannot demonstrate that barrier removal is readily achievable, the public accommodation shall make its goods, services, facilities, privileges, advantages, or accommodations available through alternative methods, if those methods are readily achievable. Examples of alternatives to barrier removal include, but are not limited to, the following:

- (1) Providing curb service or home delivery;
- (2) Retrieving merchandise from inaccessible shelves or racks; and
- (3) Relocating activities to accessible locations.



Accessibility improvements for existing facilities must be viewed on a case-by-case basis; especially where space constraints or other extenuating circumstances may exist. Further, there may be instances where alterations that are otherwise necessary to provide fully compliant accessibility may be technically infeasible. In such cases, it is expected that alterations aimed at full compliance be made to the maximum extent feasible.

What does "maximum extent feasible" mean? In the context of ADA compliance, the "maximum extent feasible" refers to the greatest degree of alterations that can be made to existing sites and structures without adversely affecting:

- (1) the structural integrity of the site or structure;
- (2) the historical fabric of the site or structure; or
- (3) the naturally occurring geographic barriers surrounding the site or structure.

The fact that adding accessibility features during an alteration may increase costs does not, by itself, mean compliance is technically infeasible. Moreover, even if it is technically infeasible to comply with standards for individuals with certain disabilities (for instance, those who use wheelchairs), the alteration must still comply with standards for individuals with other impairments.⁷

ILLUSTRATION 1: A restaurant is undergoing a major renovation. Widening the entrance would affect the site structure because removal of an essential part of the structural frame would be required. In this case, it is "technically infeasible" to widen the entrance and the alteration is not required. However, all other CBC/ADA alterations requirements would apply to the renovation.

BUT: If the only problem with widening the entrance is that it would increase the cost of the renovation, the "technically infeasible" exception does not apply, and the entrance must be widened.

These issues have been taken into consideration while compiling this report. In cases where a facility was constructed since the enforcement of the ADA, full compliance is required.

B. SAFE HARBOR PROVISIONS

The County of Humboldt and private property owners can make use of the *safe harbor* provision contained in the 2010 ADA Standards. This federal rule applies to provisions in the ADA Standards and is applied on an element-by-element basis for elements that complied with the 1991 ADA Standards. The rule includes a general "safe harbor" under which physical elements in facilities used for County programs, activities and services, that were built or altered in compliance with the 1991 Standards, would not be required to be brought into compliance with the 2010 Standards until the elements were subject to a planned alteration. A similar safe harbor applies to elements associated with the "path of travel" to an altered area. The federal Access Board has provided a list of the new

⁷ Department of Justice: Americans with Disabilities Act ADA Title III Technical Assistance Manual Covering Public Accommodations and Commercial Facilities. III-6.1000 General.



requirements in the 2010 Standards that are not eligible for the safe harbor in § 35.150(b)(2)(ii)(A) through § 35.150(b)(2)(ii)(L) of the final rule⁸, which includes golf courses, recreation areas, play areas outdoor recreational areas and open spaces not originally covered by the 1990 Standards that are now included in the 2010 Standards.

The most common area where safe harbor applies in this particular facility is within the reach range requirements. Previous requirements under the 1990 ADA Standards allowed high reach range to extend to a maximum of 54 inches high, whereas the 2010 ADA Standards now allow a maximum reach of only 48 inches. Many controls and mechanisms can be granted safe harbor under this federal provision. Safe harbor does not apply to areas where an alteration to the permanent room or space has been performed since 1992, which required the element (e.g. light switch) to comply with the new construction standards in place at the time of the alteration.

C. BARRIER SEVERITY RATINGS AND REMEDIATION

SZS has developed proprietary barrier identification systems to standardize our process and ensure consistency while collecting data, creating reports and recommending implementation removal over time. Our proprietary barrier severity rating system was developed through many years of research and experience, and is integrated into our database, so that each barrier is assigned a rating that defines how severely each barrier affects a person's ability to use the element. We know from experience that without a systematic approach to barrier severity rating, deciding which barriers to remove, and when, can be reduced to guesswork.

There are five barrier severity ratings (BSR) that are assigned to individual barriers:

- 1 – Necessary
- 2 – Recommended
- 3 – Hindrance
- 4 – Low Severity
- 5 – Technically Infeasible

The affect that the barrier has on a person using the element is important, but the date of construction also plays a role in determining barrier severity ratings. Facilities that are defined under the ADA as new construction are required to be fully compliant and the barrier severity rating assigned to those barriers is 1 – Necessary to Remove. That is a legal requirement that governs our work regardless of how minor a barrier may be in terms of how it affects the user.

In existing facilities, which were constructed prior to the passage of the ADA, barrier removal is not required to achieve new construction standards. The standard for barrier removal is to bring a facility into compliance to the maximum extent feasible. This standard takes into consideration past building standards and practices which did not comply to the current ADA standards. Where barrier severity ratings are 4- Low Severity, these barriers may not require remediation. When barriers are rated as a 5 – Technically Infeasible, they

⁸ Americans with Disabilities Act Title II Regulations, Part 35 Nondiscrimination on the Basis of Disability in State and Local Government Services (as amended by the final rule published on September 15, 2010)
http://www.ada.gov/regs2010/titleII_2010/titleII_2010_regulations.htm



cannot be removed due to structural impracticability or other conditions that cannot be altered. Increasing the clear width of an interior stairway in an existing building, or reducing the roadway slope where it corresponds with steep terrain, is technically infeasible to remediate.

Sidewalks, which were constructed prior to 1992, were often constructed intentionally with a cross slope to encourage drainage that is now defined as a code violation. Research shows that the affect that the cross slope of a walking surface between 2.1% and 2.9% is minor, or of a low severity, and can be navigated by a person using a mobility assist device with some extra effort, whereas a cross slope of 5.0% or more is known to cause a wheelchair to tip over which may result in injury. Existing walkways and sidewalks that are identified with a cross slope in the 2.1% and 2.9% range are assigned a low severity BSR with remediation not generally recommended where the duration (linear footage) of the barrier is limited to less than 5 feet and the affect they have for people using mobility assist devices is minor in comparison to many other barriers identified. Other instances where barriers are identified in the report and no remediation is recommended will be provided with an explanation on a case-by-case basis.

Barriers with a low severity rating are often assigned a Proposed Solution of “No remediation recommended – low severity barrier”. The California Division of State Architect has approved this approach for projects throughout the state, since it is reasonable and allows for funds to be concentrated on barrier removals that have hindered or prevented use of an element by people with disabilities.

D. OFFICIAL RESPONSIBLE

The County of Humboldt is responsible to ensure access for people with disabilities to the programs, services or activities that they provide, whether they are provided in owned or leased facilities. The County is not necessarily the responsible party entrusted with removing barriers in leased facilities. The county will work with property owners, where feasible, to ensure compliance. Under the federal statute, discrimination includes a failure to design and construct facilities for first occupancy after January 26, 1993, that are readily accessible to and usable by individuals with disabilities⁹. California government code, civil code, health and safety code, vehicle code and labor code contain similar requirements.

The designated ADA Coordinator (ADA CO) is in charge of the barrier remediation plan pursuant to the Project Civic Access Consent Decree and ADA Transition Plan remediation during the time in which these reports have been compiled. The ADA CO and/or representative can be reached at (844) 365-0352 or ADA@co.humboldt.ca.us. It is likely that the person in this position will change over time through attrition, or retirement. At that time, another ADA CO will be assigned and assume these responsibilities to ensure continuity of services.

E. RECOMMENDED BARRIER REMOVAL PRIORITIES

The functions within the buildings were assigned a barrier removal priority that corresponds with the regulations discussed above. All construction and alterations to County buildings and facilities by the County or on its behalf [in leased facilities] will comply with the

⁹ Subpart D – New Construction and Alterations. § 36.401 New construction. (a) General. (a)



requirements of 28 C.F.R. § 35.151, including applicable architectural standards. All architectural changes by the County or on its behalf made on or after March 15, 2012, must comply with the 2010 ADA Standards. The term "2010 ADA Standards" refers to the 2010 ADA Standards for Accessible Design (28 C.F.R. § 35.104 (Title II) (defining the "2010 ADA Standards" as the requirements set forth in appendices B and D to 36 C.F.R. part 1191 and the requirements contained in 28 C.F.R. § 35.151.)). All citations are to the 2010 ADA Standards unless otherwise noted.

The parts of a County facility that do not comply with the 1991 ADA Standards (or the 2010 ADA Standards, as applicable), as listed in Attachments G, H, I, and J, of the consent decree, prevent people with disabilities from fully and equally enjoying the County's programs, services, or activities and constitute discrimination on the basis of disability within the meaning of 42 U.S.C. § 12132 and 28 C.F.R. §§ 35.149-35.151¹⁰.

Facilities that are privately owned will remain under this consent decree whether or not the County continues to lease the facility to house programs, services and activities. As long as public accommodations continue to be provided in the facility, the requirement to remove barriers to access will remain in effect.

In addition, barrier removal priorities should reflect the way in which people use the facilities. For instance, if barrier removal is not completed and a person cannot reach the facility because there is no pedestrian access route from the public transportation provided to serve the building, or no accessible parking is provided, an accessible toilet room inside the building is of little use to people with disabilities.

In order to prioritize barrier removal within facilities for implementation we have correlated the County programs, activities and services that take place within buildings that serve people with disabilities with the barriers to access that have been identified. Barriers to access identified in the exterior and interior spaces have been prioritized according to the following criteria:

- Priority 1:** Pedestrian route including access to the building from points of arrival and from the building site, including walkways and breezeways and potential hazards (see stairways below). Building entrances and lobby spaces
- Priority 2:** Primary building functions (classrooms, meeting rooms, auditoriums, corridors, play areas, etc.)
- Priority 3:** Restrooms, drinking fountains and benches or tables in public places
- Priority 4:** Interior and exterior stairways, signage and remaining barriers that affect people with disabilities as a low severity barrier

Finalized barrier priorities can be influenced by information on other factors provided by the County of Humboldt. These factors include:

¹⁰ US v. County of Humboldt, Civil Action No. 16-5139, Section II.M: New Construction, Alterations, and Physical Changes to Facilities.



- Number and type of programs, services and activities that take place in the facility
- Frequency of use by the general public
- Age of facility (pre-1992 existing or new construction post-1992)
- Type of use (public, staff or mixed use)
- Long-term Facility Planning Goals
 - Infrastructure improvement projects
 - Facility replacement as part of future CIP plans

F. COST ESTIMATES

This report contains budgetary cost estimates provided to facilitate the remediation of barriers. Cost estimates are provided for physical elements only while the cost of implementing a new policy or practice cannot be accurately assessed at this point in the process. The actual cost estimates are calculated using RS Means Construction Cost Estimating data and in some instances where a barrier location can have several different barriers to access, one or more of the barriers may have a cost estimate of \$0 dollars. This is an intentional reporting mechanism as it reflects the fact that the cost to remove that particular barrier is part of a cost of one or more barriers at that same location.

For instance, where a door equipped with a door closer is identified with a non-compliant opening force, sweep period and a lack of required maneuvering clearance on one or both sides of that door, the recommended barrier removal solution is often to install an automatic door opening device (ADOD), which at the time of this assessment is estimated to cost \$5,000. If each of those barriers to access had been reported with a cost estimate, the estimate could amount to 3 times that much, or \$15,000 if the correction to 2 of the 3 cost estimates was not performed. The end result is intended to produce a budgetary cost estimate that does not include amounts that could exponentially increase the overall cost of barrier removal implementation plans.

G. EXTERIOR SPACES

This assessment process included identification of barriers to access within the pedestrian access route (accessible route within the public rights-of-way or PROW) that serves this facility. Under state and federal regulations and statutes, the pedestrian access route from points of arrival at public transportation stops (where provided), continuing through sidewalks (where provided) and walkways leading to the facility entrance must be accessible to people with disabilities in order to ensure that they can reach the facility where programs, services and activities are provided. This information is not contained in this report, but has been compiled into a separate report provided to each jurisdictional authority that owns the PROW that connects bus stops and sidewalks to this facility.

Where these jurisdictions make use of federal funding for roadway work, etc. the entity is required under the federal Rehabilitation Act of 1973 to ensure that the pedestrian access route is usable by and accessible to people with disabilities. The 1990 ADA Standards



provided additional requirements intended to ensure that these paths of travel are made fully accessible “as expeditiously as possible, but, in any event, by January 26, 1995”.¹¹

At present, barriers were identified that appeared to be pre-ADA in some cases and these entities should be making progress on this work through a Rehabilitation Act Transition Plan since 1974 or ADA Transition Plan since 1992. If such plans are not in place, this information will be provided available to these entities, to allow them to make use of it when updating their existing remediation plans to comply with state and federal statutes and regulations.

This report contains barriers to access that are located within the facility site. There may be some overlap between site arrival points and a pedestrian connection to the facility entrance. In cases where the existing sidewalk is an essential part of the accessible route to the facility entrance, alterations must be made to the sidewalk to ensure that people with disabilities can make use of County programs, services and activities.

Owners of leased properties are likely to have responsibility for some of the sidewalk that borders their property.

As a public facility that was constructed since the passage of the ADA, the facility is required to have at least one accessible entrance and an accessible route provided within the building site that connects the existing sidewalk to the exterior and interior amenities provided, including a connection to public streets and sidewalks; and public transportation stops to the accessible building or facility entrance¹², as required by the 1990 and 2010 ADA Standards and California Code of Regulations Title 24.

H. FACILITY ENTRANCES

The public entrance to the facility was located in the front of the building adjacent to the accessible parking stall provided within the public parking lot on site. Additional entrances to medical records offices and meeting rooms are positioned along the side of the building past a gate that is on a path of travel connecting to the sidewalk. An accessible route was provided between the existing sidewalk along West Clark Street, near the existing accessible parking and building entrance.

¹¹ The Americans with Disabilities Act, Title II Technical Assistance Manual Covering State and Local Government Programs and Services, Section II-8.3000. See <https://www.ada.gov/taman2.html#II-8.3000>

¹² 2010 ADA Standards for Accessible Design, Section **206.2.1 Site Arrival Points**



I. REPORT FORMAT - DEFINITIONS

SZS CONSULTING

1 Field Date: 8/30/2016 2 Report Date: 9/13/2016 3 Barrier #: 1 4 

5 Facility: Jail (Adult Detention)

6 Location: Pedestrian Path to Building

7 Official Responsible:

8 Facility Function: Public Dwg: 1 of 2 9

10 Barrier Area: Walkways Remediation: Required 11

12 Barrier Type: Detectable Warnings - Hazardous Vehicular Way

13 Barrier Description: Detectable warning (truncated domes) or vertical curb not provided at hazardous vehicular area 18

14 Code References: CBC 11B-705.1.2.5 19

15 As Built Description: Pedestrian path along vehicular traffic lane has no detectable warnings installed where required 22

16 Proposed Solution: Provide truncated domes as detectable warning along pathway from Chestnut Avenue to building entry 20

17 As-Built Meas: 194 Quantity: LF Cost Estimate: \$67,900.00 BSR: 2 Recommended 23

21 X Coordinate: N/A Y Coordinate: N/A Z Coordinate: N/A 27

24 Implementation: Priority 1 Phase Date Status Open 26

28 Notes: 25

This is the Graphic User Interface (GUI) for the SZS database entry form. The name of each facility is located at the top of the form and the reports produced by the database have a similar format with identical fields although they are, in some instances, slightly different in size. A description for the data contained within each field is provided below:

- 1) **Field Date:** The date of the facility inspection.
- 2) **Report Date:** The date the report was compiled, revised or completed.
- 3) **Barrier #:** Individual number assigned to each barrier identified. The alphanumeric character assigned correlates with a room or space identified on the reference drawings provided with each report. This number allows the barrier to be pinpointed to a location within the facility.
- 4) **Image:** Digital photograph provided for each barrier as a visual representation of the issue and context.
- 5) **Facility:** Name of building, park or parking lot where the inspection was performed
- 6) **Location:** Area or space within the facility where a barrier is identified
- 7) **Official Responsible:** Person responsible for overseeing the policies and practices implemented through this process



- 8) **Facility Function (Public/Staff):** Designates barriers as located in either staff or public areas. Most barriers identified are designated for public use. Different requirements exist for public and staff use areas.
- 9) **Reference Drawing (Dwg):** Floor, site plans or aerial maps of the designated facility where the assessment was performed. Each reference drawing provides correlation between the barrier number listed in the report (see item 3 above) and the actual physical location where the barrier was identified.
- 10) **Barrier Area:** Provides a grouping of similar barriers identified in specific spaces (E.G.: Restrooms, Doors and Gates, Stairs, Ramps, Sidewalk, Walkways)
- 11) **Remediation:** Indicates whether a barrier is in direct violation of the federal and state codes and statutes and must be remediated or whether the remediation is recommended as a best practice. One of two options exist: (Required) or (Recommended).
- 12) **Barrier Type:** Identifies the type of physical element or area defined by California Building Code and the ADA Standards used to identify non-compliance. The categories of barriers contained in the database include:

Alarms
Assembly Areas
Blended Transitions
Bus Stops & Shelters
Classrooms
Clear Floor Space
Controls and Mechanisms
Corridors
Counters and Tables
Curb Ramps
Dining Facilities
Doors or Gates
Drinking Fountains
Elevators
Kitchens
Outdoor Areas Access Route
Parking
Passenger Loading Zones (Drop-Off)
Picnic Facilities
Play Areas
Public Phones
Ramps
Restrooms
Signage
Stairways
Street Furniture
Swimming Pools



Turning Space
Walkways

- 13) Requirement (Barrier Description):** Code language or performance standard that describes barrier identified.
- 14) Code References:** Applicable state and federal codes regulating the entities compliance. Each code reference is specific to each barrier and identifies the section of code which regulates compliance to that specific element (doors, parking stalls, sidewalks, etc.). Where a best practice is recommended, the term *Performance Standard* identifies the barrier to access documented in the barrier data record.
- 15) As Built Description (Desc):** Also known as the *findings*, information describes the barrier.
- 16) Proposed Solution:** Provides one suggested solution for the remediation of the barrier identified. Please note that other options may exist to bring items into compliance. Other solutions may exist and all solutions cannot be accounted for in this report. The suggested solution is generally the most common way of remediating this particular barrier.
- 17) As Built Measure:** Actual field measurement number for square footage (SF), linear footage (LF), or a single value (EACH or JOB) used to indicate physical dimension of barrier and calculate cost estimate.
- 18) Quantity:** Unit of measure for the remediation of each barrier (SF, LF, EACH or JOB).
- 19) Cost Estimate:** Budgetary Cost Estimate to remove the barrier described.
- 20) Barrier Severity Rating (BSR):** A systematic, research based rating that describes how severely each barrier affects usability for the particular element.
- 21) X Coordinate:** Geographic coordinate that provides the longitude (north-south) value
- 22) Y Coordinate:** Geographic coordinate that provides the latitude (east-west) value
- 23) Z Coordinate:** Geographic coordinate that provides the elevation value
- 24) Implementation Priority:** N/A
- 25) Implementation Phase:** N/A
- 26) Implementation Date:** Scheduled year or date as to when the remediation of the barrier will take place within the consent decree schedule. This field can be scheduled during phasing and changed to a specific date after the barrier is remediated and the record is closed.
- 27) Status (Open or Closed):** An implementation management tool that can flag barriers to indicate that they have been remediated or are remaining in the implementation phasing plan. Barrier data records have a "Closed" status when completed or have an "Open" status when they remain scheduled for remediation. This can be useful when remediation is



performed by both maintenance staff and design professionals within the construction process.

- 28) Notes:** Open field where additional explanation of the findings can be noted when encountering unusual situations in the field, or to note programmatic access solutions. The notes field can contain the image file name shown in the barrier data record, or additional information as needed such as an explanation of findings, or information on associated barriers in the same or similar locations.

EXTERIOR SPACES

The path of travel from the nearest bus stop was assessed as part of the scope of work. People with disabilities often travel using regional transit and must have an accessible route that allows them to reach the facility. Barriers to access were identified which may be the responsibility of another local jurisdiction to remediate. The jurisdiction should be contacted in order to ensure that these barriers are removed so that the County program, services and activities that take place in this location are accessible to people with disabilities.

The building provides several types of services to the public. An off-street parking lot is provided at the side of the building outside of a security gate. Van accessible and standard accessible stalls are provided in this location on a path of travel to the main entrance along Clark Street. Additional programs are located in other parts of the building and can be reached by the public by traveling past the secured gate along a walkway to each separate entrance door. This walkway has no separation (detectable warning) from the vehicular traffic lane and each of the door landings were identified with non-compliant slopes.

INTERIOR SPACES

The main entrance where the public receives SNAP benefits is located along the building frontage and adjacent to the off-street parking lot where public parking is provided. The entrance door at each of the locations where programs are provided lacked accessible signage, landings and hardware. Maneuvering clearance was also not compliant at many of the doors. Doors associated with spaces where programs, services or activities take place in this facility were identified with non-compliant operating force or sweep periods.

In instances where the door is not a fire rated door, or part of a fire rated assembly, the door closer may be removed to mitigate the barrier to access. If the door closer is to remain in place within a fire rated assembly, due to privacy concerns, etc., measures must be taken to ensure that the operating force and sweep period comply. If the existing door closer cannot be adjusted to comply for an extended period of time, the remaining options to ensure compliance are, first; to install new door closers that function at maximum 5 pounds of force and at least 5 seconds of sweep before reaching 12 degrees from the door frame (approx. 5 inches) consistently.

If the new door closer installed to comply is assessed and found not to function within these parameters, an automatic door opening device must be installed. An automatic door opening device has been identified by the California Building Standards Commission and the California Division of State Architect, as the only solution that meets both fire code requirements for fire



doors, and accessibility requirements contained in the ADA and California Building Code, Section 11B, as well as California Government Code, Civil Code and Health and Safety Code.

Public spaces in county health facilities are required to have accessible seating in the form of a space to accommodate a person using a wheelchair, service counters that are both accessible and do not create protruding hazards for others with vision impairments, and phones that are also usable for people with disabilities. Public and administrative areas, including waiting areas shall provide a seating area and space for wheelchairs and have public corridor access to, or provisions for, public toilet, drinking fountain and telephone per CBC section 1224.4.4.5, although the only toilets provided in the various service areas were identified as staff only. No public toilets are provided in this facility, although they are required.

The meeting room in the facility designated as public use was not identified with an accessible circulation path, table or maneuvering clearance. The offices and this meeting room were also identified as lacking required horn/strobe devices actuated by the fire alarm system.

The following barrier data records provide more detailed information on the barriers described above.

Field Date: 11/8/2017 Report Date: 9/19/2018 Barrier #: 1A
 Facility: Social Services - 600 W Clark St, Eureka
 Location: Exterior - Walkway to Building
 Official Responsible: Karen Clower, Interim ADA Coordinator
 Consent Decree: No Paragraph: M.51 Dwg: N/A
 Barrier Area: Accessible Route - Exterior Remediation: Required
 Barrier Type: Running Slope - Existing (5.0% - 8.2%)
 Barrier Description: Accessible route running slope exceeds 5.0% (5.0% - 8.2%)
 Code References: CBC 11B-403.3 and 2010 ADAS 403.3
 As Built Description: 5.4% running slope
 Proposed Solution: Provide handrails with wheelguide on both sides of ramp, and required landings. Where drop exceeds 30", provide guardrail.
 As-Built Meas: 5 Quantity: LF Cost Estimate: \$1,825.00 BSR: 1 Necessary
 X Coordinate: -124.17696 Y Coordinate: 40.7967 Z Coordinate: 0
 Implementation: Priority 1 Phase Date Status Open



LESSOR

Notes:

Field Date: 11/8/2017 Report Date: 9/19/2018 Barrier #: 1B
 Facility: Social Services - 600 W Clark St, Eureka
 Location: Exterior - Walkway to Building
 Official Responsible: Karen Clower, Interim ADA Coordinator
 Consent Decree: No Paragraph: M.51 Dwg: N/A
 Barrier Area: Accessible Route - Exterior Remediation: Required
 Barrier Type: Cross Slope - Existing (3.1% to 4.0%)
 Barrier Description: Cross slope exceeds 2.0% (3.1% to 4.0%)
 Code References: CBC 11B-403.3 and 2010 ADAS 403.3
 As Built Description: 3.9% cross slope
 Proposed Solution: Demolish existing and construct new route
 As-Built Meas: 9 Quantity: LF Cost Estimate: \$1,125.00 BSR: 3 Hindrance
 X Coordinate: -124.17696 Y Coordinate: 40.7967 Z Coordinate: 0
 Implementation: Priority 1 Phase Date Status Open



LESSOR

Notes:

Field Date: 11/8/2017 Report Date: 9/19/2018 Barrier #: 2

Facility: Social Services - 600 W Clark St, Eureka

Location: Exterior - Walkway to Building

Official Responsible: Karen Clower, Interim ADA Coordinator

Consent Decree: No Paragraph: M.51 Dwg: N/A

Barrier Area: Accessible Route - Exterior Remediation: Required

Barrier Type: Turning Space - T-Shaped (Level)

Barrier Description: T-shaped Turning space identified with a change in level of more than 1:48 (2.0%)

Code References: CBC 11B-304.2 and 2010 ADAS 304.2

As Built Description: 2.2% slope in landing at change of direction

Proposed Solution: Alter floor or ground surface to comply

As-Built Meas: 25 Quantity: SF Cost Estimate: \$3,125.00 BSR: 2 Recommended

X Coordinate: -124.17697 Y Coordinate: 40.79666 Z Coordinate: 129

Implementation: Priority 1 Phase Date Status Open

Notes:



LESSOR

Field Date: 11/8/2017 Report Date: 9/19/2018 Barrier #: 3

Facility: Social Services - 600 W Clark St, Eureka

Location: Exterior - Walkway to Building

Official Responsible: Karen Clower, Interim ADA Coordinator

Consent Decree: No Paragraph: M.51 Dwg: N/A

Barrier Area: Accessible Route - Exterior Remediation: Required

Barrier Type: Running Slope - Existing (8.3% or more)

Barrier Description: Accessible route running slope exceeds 5.0% (8.3% or more)

Code References: CBC 11B-403.3 and 2010 ADAS 403.3

As Built Description: 10.8% running slope

Proposed Solution: Demolish and construct new accessible ramp with handrails, wheelguide, and required landings. Where drop exceeds 30", provide guardrail.

As-Built Meas: 9 Quantity: LF Cost Estimate: \$3,510.00 BSR: 1 Necessary

X Coordinate: -124.17702 Y Coordinate: 40.79668 Z Coordinate: 5

Implementation: Priority 1 Phase Date Status Open

Notes:



Field Date: 11/8/2017 Report Date: 9/19/2018 Barrier #: 4
 Facility: Social Services - 600 W Clark St, Eureka
 Location: Exterior - Parking Lot
 Official Responsible: Karen Clower, Interim ADA Coordinator
 Consent Decree: No Paragraph: M.51 Dwg: N/A
 Barrier Area: Parking Remediation: Required
 Barrier Type: Tow-Away Sign - Contact Info
 Barrier Description: Tow-away sign lacks required contact info
 Code References: CBC 11B-502.8.2
 As Built Description: Sign does not comply
 Proposed Solution: Add contact information to existing sign
 As-Built Meas: 1 Quantity: EACH Cost Estimate: \$75.00 BSR: 3 Hindrance
 X Coordinate: -124.17686 Y Coordinate: 40.79666 Z Coordinate: 10
 Implementation: Priority 1 Phase Date Status Open



LESSOR

Notes:

Field Date: 11/8/2017 Report Date: 9/19/2018 Barrier #: 6A
 Facility: Social Services - 600 W Clark St, Eureka
 Location: Exterior - Parking Lot VA Stall
 Official Responsible: Karen Clower, Interim ADA Coordinator
 Consent Decree: No Paragraph: M.51 Dwg: N/A
 Barrier Area: Parking Remediation: Required
 Barrier Type: Stall Slope - Existing (5.0% or more)
 Barrier Description: Accessible stall & aisle not max. 2.0% in all directions (5.0% or more)
 Code References: CBC 11B-502.4 and 2010 ADAS 502.4
 As Built Description: Stall slope 8.0%. Aisle slope 2.2%
 Proposed Solution: Regrade stall to make level and restripe
 As-Built Meas: 1 Quantity: EACH Cost Estimate: \$12,600.00 BSR: 1 Necessary
 X Coordinate: -124.17689 Y Coordinate: 40.79668 Z Coordinate: 16
 Implementation: Priority 1 Phase Date Status Open



LESSOR

Notes: 10 parking stalls with 2 accessible stall including 1 van accessible stall provided in public parking lot

Field Date: 11/8/2017 Report Date: 9/19/2018 Barrier #: 6B
 Facility: Social Services - 600 W Clark St, Eureka
 Location: Exterior - Parking Lot VA Stall
 Official Responsible: Karen Clower, Interim ADA Coordinator
 Consent Decree: No Paragraph: M.51 Dwg: N/A
 Barrier Area: Parking Remediation: Required
 Barrier Type: Accessible Stall Sign - ISA Pavement Sign



LESSOR

Barrier Description: ISA 3' x 3' (white/blue) marking not within 6" of stall center and bottom edge not aligned with end of stall

Code References: CBC 11B-502.6.4.1

As Built Description: Existing pavement ISA sign is fading

Proposed Solution: Provide required sign

As-Built Meas: 1 Quantity: EACH Cost Estimate: \$150.00 BSR: 2 Recommended

X Coordinate: -124.17689 Y Coordinate: 40.79668 Z Coordinate: 16

Implementation: Priority 1 Phase Date Status Open

Notes:

Field Date: 11/8/2017 Report Date: 9/19/2018 Barrier #: 6C
 Facility: Social Services - 600 W Clark St, Eureka
 Location: Exterior - Parking Lot VA Stall
 Official Responsible: Karen Clower, Interim ADA Coordinator
 Consent Decree: No Paragraph: M.51 Dwg: N/A
 Barrier Area: Parking Remediation: Required
 Barrier Type: Accessible Stall Aisle - NO PARKING Lettering



LESSOR

Barrier Description: Access aisle lacks sign stating "NO PARKING" with min. 12" high letters contrasting with stall surface

Code References: CBC 11B-502.3.3

As Built Description: Access aisle lacks contrasting lettering min. 12" high stating "NO PARKING"

Proposed Solution: Provide required pavement sign at bottom of access aisle

As-Built Meas: 1 Quantity: EACH Cost Estimate: \$150.00 BSR: 3 Hindrance

X Coordinate: -124.17689 Y Coordinate: 40.79668 Z Coordinate: 16

Implementation: Priority 1 Phase Date Status Open

Notes:

Field Date: 11/8/2017 Report Date: 9/19/2018 Barrier #: 7A
 Facility: Social Services - 600 W Clark St, Eureka
 Location: Exterior - Parking Lot Standard Acc Stall
 Official Responsible: Karen Clower, Interim ADA Coordinator
 Consent Decree: No Paragraph: M.51 Dwg: N/A
 Barrier Area: Parking Remediation: Required
 Barrier Type: Accessible Stall Sign - Height in POT
 Barrier Description: Reflectorized ISA sign posted within path of travel is not posted at min. 80" high
 Code References: CBC 11B-502.6 Exception
 As Built Description: 72" high
 Proposed Solution: Remount sign at min. 80" high
 As-Built Meas: 1 Quantity: EACH Cost Estimate: \$100.00 BSR: 2 Recommended
 X Coordinate: -124.17684 Y Coordinate: 40.79673 Z Coordinate: 13
 Implementation: Priority 1 Phase Date Status Open



LESSOR

Notes:

Field Date: 11/8/2017 Report Date: 9/19/2018 Barrier #: 7B
 Facility: Social Services - 600 W Clark St, Eureka
 Location: Exterior - Parking Lot Standard Acc Stall
 Official Responsible: Karen Clower, Interim ADA Coordinator
 Consent Decree: No Paragraph: M.51 Dwg: N/A
 Barrier Area: Parking Remediation: Required
 Barrier Type: Stall Slope - Existing (2.1% to 3.0%)
 Barrier Description: Accessible stall & aisle not max. 2.0% in all directions (2.1% to 3.0%)
 Code References: CBC 11B-502.4 and 2010 ADAS 502.4
 As Built Description: 2.3% slope
 Proposed Solution: Regrade stall to make level and restripe
 As-Built Meas: 1 Quantity: EACH Cost Estimate: \$12,600.00 BSR: 4 Low Severity
 X Coordinate: -124.17684 Y Coordinate: 40.79673 Z Coordinate: 13
 Implementation: Priority 1 Phase Date Status Open



LESSOR

Notes:

Field Date: 11/8/2017 Report Date: 9/19/2018 Barrier #: 7C
 Facility: Social Services - 600 W Clark St, Eureka
 Location: Exterior - Parking Lot Standard Acc Stall
 Official Responsible: Karen Clower, Interim ADA Coordinator
 Consent Decree: No Paragraph: M.51 Dwg: N/A
 Barrier Area: Parking Remediation: Required
 Barrier Type: Accessible Stall Sign - ISA Pavement Sign



LESSOR

Barrier Description: ISA 3' x 3' (white/blue) marking not within 6" of stall center and bottom edge not aligned with end of stall

Code References: CBC 11B-502.6.4.1

As Built Description: Existing pavement ISA sign is fading

Proposed Solution: Provide required sign

As-Built Meas: 1 Quantity: EACH Cost Estimate: \$150.00 BSR: 2 Recommended

X Coordinate: -124.17684 Y Coordinate: 40.79673 Z Coordinate: 13

Implementation: Priority 1 Phase Date Status Open

Notes:

Field Date: 11/8/2017 Report Date: 9/19/2018 Barrier #: 8A
 Facility: Social Services - 600 W Clark St, Eureka
 Location: Exterior - Walkway to Building
 Official Responsible: Karen Clower, Interim ADA Coordinator
 Consent Decree: No Paragraph: M.51 Dwg: N/A
 Barrier Area: Accessible Route - Exterior Remediation: Required
 Barrier Type: Clear Width - Accessible Route



LESSOR

Barrier Description: Accessible route with no obstructions is not min. 48" wide, excluding the curb

Code References: CBC 11B-403.5.1 Exception 3 and Caltrans Highway Design Manual 105.2

As Built Description: 41" - 47" clear width

Proposed Solution: Alter existing accessible parking and construct min. 48" wide accessible route between parking and entrance

As-Built Meas: 11 Quantity: LF Cost Estimate: \$1,375.00 BSR: 1 Necessary

X Coordinate: -124.17664 Y Coordinate: 40.79665 Z Coordinate: 94

Implementation: Priority 1 Phase Date Status Open

Notes:

Field Date: 11/8/2017 Report Date: 9/19/2018 Barrier #: 8B

Facility: Social Services - 600 W Clark St, Eureka

Location: Exterior - Walkway to Building

Official Responsible: Karen Clower, Interim ADA Coordinator

Consent Decree: No Paragraph: M.51 Dwg: N/A

Barrier Area: Accessible Route - Exterior Remediation: Required

Barrier Type: Protruding Object - Wall Mounted Object

Barrier Description: Wall mounted object protrudes more than 4" into accessible route between 27" and 80" high

Code References: CBC 11B-307.2 and 2010 ADAS 307.2

As Built Description: Meter housing protrudes 5" at 45-1/2" high

Proposed Solution: Remove object or provide detectable warning

As-Built Meas: 1 Quantity: JOB Cost Estimate: \$550.00 BSR: 1 Necessary

X Coordinate: -124.17664 Y Coordinate: 40.79665 Z Coordinate: 94

Implementation: Priority 1 Phase Date Status Open

Notes:



LESSOR

Field Date: 11/8/2017 Report Date: 9/19/2018 Barrier #: 9

Facility: Social Services - 600 W Clark St, Eureka

Location: Exterior - Walkway to Public Entry along Clark St

Official Responsible: Karen Clower, Interim ADA Coordinator

Consent Decree: No Paragraph: M.51 Dwg: N/A

Barrier Area: Accessible Route - Exterior Remediation: Required

Barrier Type: Protruding Object - Foliage

Barrier Description: Trees, bushes or plants protrude more than 4" below 80" or reduce clear width to less than 48"

Code References: CBC 11B-307.2 and 2010 ADAS 307.2

As Built Description: Tree protrudes into path of travel between accessible parking stalls and entrance

Proposed Solution: Trim foliage to prevent encroachment into accessible route

As-Built Meas: 1 Quantity: JOB Cost Estimate: \$250.00 BSR: 2 Recommended

X Coordinate: -124.17697 Y Coordinate: 40.79666 Z Coordinate: 129

Implementation: Priority 1 Phase Date Status Open

Notes:



LESSOR

Field Date: 11/8/2017 Report Date: 9/19/2018 Barrier #: 10A
 Facility: Social Services - 600 W Clark St, Eureka
 Location: Service Lobby - Room 101
 Official Responsible: Karen Clower, Interim ADA Coordinator
 Consent Decree: No Paragraph: M.51 Dwg: 1 of 1
 Barrier Area: Signage Remediation: Required
 Barrier Type: Room ID Sign - No Tactile Information



COUNTY

Barrier Description: Room ID sign provided for sighted people lacks tactile info for the visually impaired

Code References: CBC 11B-216.2 and 2010 ADAS 216.2

As Built Description: No tactile information provided where visual sign exists

Proposed Solution: Provide room ID sign with tactile information at wall at latch side of door

As-Built Meas: 1 Quantity: EACH Cost Estimate: \$250.00 BSR: 1 Necessary

X Coordinate: N/A Y Coordinate: N/A Z Coordinate: N/A

Implementation: **Priority** 4 **Phase** **Date** **Status** Open

Notes:

Field Date: 11/8/2017 Report Date: 9/19/2018 Barrier #: 10B
 Facility: Social Services - 600 W Clark St, Eureka
 Location: Service Lobby - Room 101
 Official Responsible: Karen Clower, Interim ADA Coordinator
 Consent Decree: No Paragraph: M.51 Dwg: 1 of 1
 Barrier Area: Signage Remediation: Required
 Barrier Type: ISA - Accessible Entry



COUNTY

Barrier Description: No sign identifying door as accessible

Code References: CBC 11B-216.6 and 2010 ADAS 216.6

As Built Description: Accessible entrance has no ISA sign

Proposed Solution: Provide ISA at accessible entrance door

As-Built Meas: 1 Quantity: EACH Cost Estimate: \$250.00 BSR: 1 Necessary

X Coordinate: N/A Y Coordinate: N/A Z Coordinate: N/A

Implementation: **Priority** 4 **Phase** **Date** **Status** Open

Notes:

Field Date: 11/8/2017 Report Date: 9/19/2018 Barrier #: 10C

Facility: Social Services - 600 W Clark St, Eureka

Location: Service Lobby - Room 101

Official Responsible: Karen Clower, Interim ADA Coordinator

Consent Decree: No Paragraph: M.51 Dwg: 1 of 1

Barrier Area: Doors or Gates Remediation: Required

Barrier Type: Door Closer - Exterior Adjustment

Barrier Description: Door opening force exceeds 5 lbf

Code References: CBC 11B-404.2.9

As Built Description: 13 lbf

Proposed Solution: Replace or adjust existing closer

As-Built Meas: 1 Quantity: EACH Cost Estimate: \$450.00 BSR: 1 Necessary

X Coordinate: N/A Y Coordinate: N/A Z Coordinate: N/A

Implementation: Priority 1 Phase Date Status Open

Notes:



LESSOR

Field Date: 11/8/2017 Report Date: 9/19/2018 Barrier #: 10D

Facility: Social Services - 600 W Clark St, Eureka

Location: Service Lobby - Room 101

Official Responsible: Karen Clower, Interim ADA Coordinator

Consent Decree: No Paragraph: M.51 Dwg: 1 of 1

Barrier Area: Doors or Gates Remediation: Required

Barrier Type: Door Closer - Exterior Sweep

Barrier Description: Door closer lacks min. 5 second sweep period/back check

Code References: CBC 11B-404.2.8.1 and 2010 ADAS 404.2.8.1

As Built Description: 1 second sweep

Proposed Solution: Replace or adjust existing closer

As-Built Meas: 0 Quantity: EACH Cost Estimate: \$0.00 BSR: 2 Recommended

X Coordinate: N/A Y Coordinate: N/A Z Coordinate: N/A

Implementation: Priority 1 Phase Date Status Open

Notes:



LESSOR

Field Date: 11/8/2017 Report Date: 9/19/2018 Barrier #: 10E

Facility: Social Services - 600 W Clark St, Eureka

Location: Service Lobby - Room 101

Official Responsible: Karen Clower, Interim ADA Coordinator

Consent Decree: No Paragraph: M.51 Dwg: 1 of 1

Barrier Area: Doors or Gates Remediation: Required

Barrier Type: Door/Gate Height - Existing

Barrier Description: Door/Gate clearance not min. 80" high

Code References: CBC 11B-404.2.3 & 11B-307.2 and 2010 ADAS 404.2.3 & 307.2

As Built Description: 78-3/4" high

Proposed Solution: Replace door or gate

As-Built Meas: 1 Quantity: EACH Cost Estimate: \$2,250.00 BSR: 3 Hindrance

X Coordinate: N/A Y Coordinate: N/A Z Coordinate: N/A

Implementation: Priority 1 Phase Date Status Open

Notes:



LESSOR

Field Date: 11/8/2017 Report Date: 9/19/2018 Barrier #: 10F

Facility: Social Services - 600 W Clark St, Eureka

Location: Service Lobby - Room 101

Official Responsible: Karen Clower, Interim ADA Coordinator

Consent Decree: No Paragraph: M.51 Dwg: 1 of 1

Barrier Area: Doors or Gates Remediation: Required

Barrier Type: Vision Lights - Existing

Barrier Description: Doors, gates, and side lights adjacent to opening not max. 43" above floor/ground

Code References: CBC 11B-404.2.11 and 2010 ADAS 404.2.11

As Built Description: 43-1/2" high

Proposed Solution: Replace door or vision panel in door

As-Built Meas: 0 Quantity: EACH Cost Estimate: \$0.00 BSR: 3 Hindrance

X Coordinate: N/A Y Coordinate: N/A Z Coordinate: N/A

Implementation: Priority 1 Phase Date Status Open

Notes:



LESSOR

BARRIER DATA RECORDS

Field Date: 11/8/2017 Report Date: 9/19/2018 Barrier #: 10G
 Facility: Social Services - 600 W Clark St, Eureka
 Location: Service Lobby - Room 101
 Official Responsible: Karen Clower, Interim ADA Coordinator
 Consent Decree: No Paragraph: M.51 Dwg: 1 of 1
 Barrier Area: Signage Remediation: Required
 Barrier Type: Tactile Exit Sign - Exit



COUNTY

Barrier Description: Ground floor doors that exit to exterior not provided with signs stating "EXIT"
 Code References: CBC 11B-216.4.1 & 11B-703 and 2010 ADAS 216.4.1
 As Built Description: No tactile sign provided where required
 Proposed Solution: Provide compliant sign at exit side of door
 As-Built Meas: 1 Quantity: EACH Cost Estimate: \$250.00 BSR: 1 Necessary
 X Coordinate: N/A Y Coordinate: N/A Z Coordinate: N/A
 Implementation: Priority 4 Phase Date Status Open

Notes:

Field Date: 11/8/2017 Report Date: 9/19/2018 Barrier #: 10H
 Facility: Social Services - 600 W Clark St, Eureka
 Location: Service Lobby - Room 101
 Official Responsible: Karen Clower, Interim ADA Coordinator
 Consent Decree: No Paragraph: M.51 Dwg: 1 of 1
 Barrier Area: Controls and Mechanisms Remediation: Required
 Barrier Type: Electrical Outlets - Side Reach Low Unobstructed



COUNTY

Barrier Description: Electrical outlet control box not min. 15" high measured to the bottom of the outlet box
 Code References: CBC 11B-308.1.2, 11B-308.3.1 and 2010 ADAS 308.3
 As Built Description: 10" high
 Proposed Solution: Relocate outlet to area with min. 15" low reach or max. 48" high reach
 As-Built Meas: 1 Quantity: EACH Cost Estimate: \$750.00 BSR: 3 Hindrance
 X Coordinate: N/A Y Coordinate: N/A Z Coordinate: N/A
 Implementation: Priority 2 Phase Date Status Open

Notes:

Field Date: 11/8/2017 Report Date: 9/19/2018 Barrier #: 101
 Facility: Social Services - 600 W Clark St, Eureka
 Location: Service Lobby - Room 101
 Official Responsible: Karen Clower, Interim ADA Coordinator
 Consent Decree: No Paragraph: M.51 Dwg: 1 of 1
 Barrier Area: Signage Remediation: Required
 Barrier Type: Room ID Sign - No Tactile Information



COUNTY

Barrier Description: Room ID sign provided for sighted people lacks tactile info for the visually impaired

Code References: CBC 11B-216.2 and 2010 ADAS 216.2

As Built Description: No tactile information provided where visual sign exists at employee room and closet in circulation path

Proposed Solution: Provide room ID sign with tactile information at wall at latch side of door

As-Built Meas: 2 Quantity: EACH Cost Estimate: \$500.00 BSR: 1 Necessary

X Coordinate: N/A Y Coordinate: N/A Z Coordinate: N/A

Implementation: Priority 4 Phase Date Status Open

Notes:

Field Date: 11/8/2017 Report Date: 9/19/2018 Barrier #: 101
 Facility: Social Services - 600 W Clark St, Eureka
 Location: Service Lobby - Room 101
 Official Responsible: Karen Clower, Interim ADA Coordinator
 Consent Decree: No Paragraph: M.51 Dwg: 1 of 1
 Barrier Area: Counters and Tables Remediation: Required
 Barrier Type: Counter - Surface Height



COUNTY

Barrier Description: No section at least 3 feet long between 28" and 34" provided at existing counter

Code References: CBC 11B-902.3 & 11B-904.4 and 2010 ADAS 902.3 & 904.4

As Built Description: Low counter 36-1/4" high

Proposed Solution: Provide min. 3 ft long section of counter at max. 34" high

As-Built Meas: 1 Quantity: EACH Cost Estimate: \$875.00 BSR: 3 Hindrance

X Coordinate: N/A Y Coordinate: N/A Z Coordinate: N/A

Implementation: Priority 2 Phase Date Status Open

Notes:

Field Date: 11/8/2017 Report Date: 9/19/2018 Barrier #: 10K
 Facility: Social Services - 600 W Clark St, Eureka
 Location: Service Lobby - Room 101
 Official Responsible: Karen Clower, Interim ADA Coordinator
 Consent Decree: No Paragraph: M.51 Dwg: 1 of 1
 Barrier Area: Counters and Tables Remediation: Required
 Barrier Type: Counter - Protruding Object



COUNTY

Barrier Description: Counter or table in route of travel protrudes more than 4" above 27" high
 Code References: CBC 11B-307 and 2010 ADAS 307
 As Built Description: 3 counters protrude 11-1/2" at 40-3/4" high and 34-3/8" high
 Proposed Solution: Provide cane-detectable warning that reaches below 27" high for the visually impaired
 As-Built Meas: 3 Quantity: EACH Cost Estimate: \$1,650.00 BSR: 1 Necessary
 X Coordinate: N/A Y Coordinate: N/A Z Coordinate: N/A
 Implementation: Priority 2 Phase Date Status Open

Notes:

Field Date: 11/8/2017 Report Date: 9/19/2018 Barrier #: 10L
 Facility: Social Services - 600 W Clark St, Eureka
 Location: Service Lobby - Room 101
 Official Responsible: Karen Clower, Interim ADA Coordinator
 Consent Decree: No Paragraph: M.51 Dwg: 1 of 1
 Barrier Area: Controls and Mechanisms Remediation: Required
 Barrier Type: Operable Part - Side Reach High Unobstructed



COUNTY

Barrier Description: Operable part not at min. 15" or max. 48" high
 Code References: CBC 11B-308.3.1 and 2010 ADAS 308.3.1
 As Built Description: Telephone handsets 56" high OC
 Proposed Solution: Relocate control or mechanism to min. 15" or max. 48" high
 As-Built Meas: 1 Quantity: EACH Cost Estimate: \$750.00 BSR: 3 Hindrance
 X Coordinate: N/A Y Coordinate: N/A Z Coordinate: N/A
 Implementation: Priority 2 Phase Date Status Open

Notes:

Field Date: 11/8/2017 Report Date: 9/19/2018 Barrier #: 10M
 Facility: Social Services - 600 W Clark St, Eureka
 Location: Service Lobby - Room 101
 Official Responsible: Karen Clower, Interim ADA Coordinator
 Consent Decree: No Paragraph: M.51 Dwg: 1 of 1
 Barrier Area: Accessible Route - Interior Remediation: Required
 Barrier Type: Protruding Object - Wall Mounted Object



COUNTY

Barrier Description: Wall mounted object protrudes more than 4" into accessible route between 27" and 80" high

Code References: CBC 11B-307.2 and 2010 ADAS 307.2

As Built Description: Telephones protrude 8-3/8" at 47" high

Proposed Solution: Remove object or provide detectable warning (wing walls)

As-Built Meas: 2 Quantity: EACH Cost Estimate: \$1,100.00 BSR: 1 Necessary

X Coordinate: N/A Y Coordinate: N/A Z Coordinate: N/A

Implementation: Priority 2 Phase Date Status Open

Notes:

Field Date: 11/8/2017 Report Date: 9/19/2018 Barrier #: 10N
 Facility: Social Services - 600 W Clark St, Eureka
 Location: Service Lobby - Room 101
 Official Responsible: Karen Clower, Interim ADA Coordinator
 Consent Decree: No Paragraph: M.51 Dwg: 1 of 1
 Barrier Area: Clear Floor Space Remediation: Required
 Barrier Type: Clear Floor Space - Wheelchair Use (Stored Items)



COUNTY

Barrier Description: Clear floor space of min. 30" by 48" not provided at element required to be accessible

Code References: CBC 11B-305 and 2010 ADAS 305

As Built Description: No wheelchair seating provided where fixed seats are provided in waiting area

Proposed Solution: Rearrange furniture to provide wheelchair seating space in waiting area

As-Built Meas: 1 Quantity: JOB Cost Estimate: \$0.00 BSR: 1 Necessary

X Coordinate: N/A Y Coordinate: N/A Z Coordinate: N/A

Implementation: Priority 2 Phase Date Status Open

Notes:

Field Date: 11/8/2017 Report Date: 9/19/2018 Barrier #: 100

Facility: Social Services - 600 W Clark St, Eureka

Location: Service Lobby - Room 101

Official Responsible: Karen Clower, Interim ADA Coordinator

Consent Decree: No Paragraph: M.51 Dwg: 1 of 1

Barrier Area: Alarms Remediation: Required

Barrier Type: Horn/Strobe - Common Use Area

Barrier Description: No horn/strobes in common use areas

Code References: CBC 11B-702.1 and 2010 ADAS 702.1

As Built Description: Device not provided

Proposed Solution: Provide strobes in common use area

As-Built Meas: 1 Quantity: EACH Cost Estimate: \$5,500.00 BSR: 1 Necessary

X Coordinate: N/A Y Coordinate: N/A Z Coordinate: N/A

Implementation: Priority 2 Phase Date Status Open

Notes:



COUNTY

Field Date: 11/8/2017 Report Date: 9/19/2018 Barrier #: 11A

Facility: Social Services - 600 W Clark St, Eureka

Location: Exterior - Walkway to Rear Entrances

Official Responsible: Karen Clower, Interim ADA Coordinator

Consent Decree: No Paragraph: M.51 Dwg: N/A

Barrier Area: Doors or Gates Remediation: Required

Barrier Type: Smooth Surface at Bottom - Kickplate

Barrier Description: Door/Gate lacks min. 10" smooth uninterrupted bottom surface

Code References: CBC 11B-404.2.10 and 2010 ADAS 404.2.10

As Built Description: Bottom 10" of door or gate not smooth and uninterrupted

Proposed Solution: Provide min. 10" high kickplate at push side of door

As-Built Meas: 1 Quantity: EACH Cost Estimate: \$225.00 BSR: 1 Necessary

X Coordinate: -124.17679 Y Coordinate: 40.79677 Z Coordinate: 21

Implementation: Priority 1 Phase Date Status Open

Notes:



Field Date: 11/8/2017 Report Date: 9/19/2018 Barrier #: 11B

Facility: Social Services - 600 W Clark St, Eureka

Location: Exterior - Walkway to Rear Entrances

Official Responsible: Karen Clower, Interim ADA Coordinator

Consent Decree: No Paragraph: M.51 Dwg: N/A

Barrier Area: Doors or Gates Remediation: Required

Barrier Type: Maneuvering Cl - Ext Front App/Pull 24"

Barrier Description: Door/Gate at pull side of exterior door lacks min. 24" beyond latch side of door

Code References: CBC Figure 11B-404.2.4.1 and 2010 ADAS 404.2.4.1

As Built Description: No maneuvering clearance at pull side of door where vertical curb exists in door landing

Proposed Solution: Relocate door or gate or alter area to provide required maneuvering clearance

As-Built Meas: 1 Quantity: EACH Cost Estimate: \$2,250.00 BSR: 1 Necessary

X Coordinate: -124.17679 Y Coordinate: 40.79677 Z Coordinate: 21

Implementation: Priority 1 Phase Date Status Open

Notes:



Field Date: 11/8/2017 Report Date: 9/19/2018 Barrier #: 11C

Facility: Social Services - 600 W Clark St, Eureka

Location: Exterior - Walkway to Rear Entrances

Official Responsible: Karen Clower, Interim ADA Coordinator

Consent Decree: No Paragraph: M.51 Dwg: N/A

Barrier Area: Doors or Gates Remediation: Required

Barrier Type: Door/Gate Landing - Slope > 5.0%

Barrier Description: Door/Gate landing is not level on both sides of door (> 5.0%)

Code References: CBC 11B-404.2.4.4 and 2010 ADAS 404.2.4.4

As Built Description: 5.2% slope

Proposed Solution: Demolish and reconstruct level landing

As-Built Meas: 25 Quantity: SF Cost Estimate: \$3,125.00 BSR: 1 Necessary

X Coordinate: -124.17679 Y Coordinate: 40.79677 Z Coordinate: 21

Implementation: Priority 1 Phase Date Status Open

Notes:



Field Date: 11/8/2017 Report Date: 9/19/2018 Barrier #: 11D
 Facility: Social Services - 600 W Clark St, Eureka
 Location: Exterior - Walkway to Rear Entrances
 Official Responsible: Karen Clower, Interim ADA Coordinator
 Consent Decree: No Paragraph: M.51 Dwg: N/A
 Barrier Area: Accessible Route - Exterior Remediation: Required
 Barrier Type: Cross Slope - Existing (5.0% or more)
 Barrier Description: Cross slope exceeds 2.0% (5.0% or more)
 Code References: CBC 11B-403.3 and 2010 ADAS 403.3
 As Built Description: 9.9% cross slope in path of travel to building entrance behind gate
 Proposed Solution: Demolish existing and construct new route
 As-Built Meas: 65 Quantity: LF Cost Estimate: \$8,125.00 BSR: 1 Necessary
 X Coordinate: -124.17679 Y Coordinate: 40.79677 Z Coordinate: 21
 Implementation: Priority 1 Phase Date Status Open



Field Date: 11/8/2017 Report Date: 9/19/2018 Barrier #: 12
 Facility: Social Services - 600 W Clark St, Eureka
 Location: Exterior - Walkway to Building
 Official Responsible: Karen Clower, Interim ADA Coordinator
 Consent Decree: No Paragraph: M.51 Dwg: N/A
 Barrier Area: Accessible Route - Exterior Remediation: Required
 Barrier Type: Detectable Warnings - Hazardous Vehicular Way
 Barrier Description: Detectable warning (truncated domes) or vertical curb not provided at hazardous vehicular area
 Code References: CBC 11B-705.1.2.5
 As Built Description: Detectable warning not provided between path of travel and hazardous vehicular way
 Proposed Solution: Provide compliant truncated domes, vertical curb min. 6" high or guardrail
 As-Built Meas: 143 Quantity: LF Cost Estimate: \$50,050.00 BSR: 2 Recommended
 X Coordinate: -124.17676 Y Coordinate: 40.79679 Z Coordinate: 22
 Implementation: Priority 1 Phase Date Status Open



Field Date: 11/8/2017 Report Date: 9/19/2018 Barrier #: 13A

Facility: Social Services - 600 W Clark St, Eureka

Location: Exterior - Walkway to Building

Official Responsible: Karen Clower, Interim ADA Coordinator

Consent Decree: No Paragraph: M.51 Dwg: N/A

Barrier Area: Signage Remediation: Required

Barrier Type: Room ID Sign - No Tactile Information

Barrier Description: Room ID sign provided for sighted people lacks tactile info for the visually impaired

Code References: CBC 11B-216.2 and 2010 ADAS 216.2

As Built Description: No tactile information provided where visual sign exists at entrances to A3, A4, G1, G2, R9, R8, R7

Proposed Solution: Provide room ID sign with tactile information at wall at latch side of door

As-Built Meas: 7 Quantity: EACH Cost Estimate: \$1,750.00 BSR: 1 Necessary

X Coordinate: -124.17694 Y Coordinate: 40.79692 Z Coordinate: -45

Implementation: Priority 4 Phase Date Status Open

Notes:



Field Date: 11/8/2017 Report Date: 9/19/2018 Barrier #: 13B

Facility: Social Services - 600 W Clark St, Eureka

Location: Exterior - Walkway to Building

Official Responsible: Karen Clower, Interim ADA Coordinator

Consent Decree: No Paragraph: M.51 Dwg: N/A

Barrier Area: Accessible Route - Exterior Remediation: Required

Barrier Type: Surface Condition - Firm and Stable

Barrier Description: Accessible route surface is not firm and stable (cracked, broken or loose soil, etc.)

Code References: CBC 11B-403.2 and 2010 ADAS 403.2

As Built Description: Surface cracked and damaged

Proposed Solution: Repair surface to make firm and stable

As-Built Meas: 2 Quantity: LF Cost Estimate: \$250.00 BSR: 1 Necessary

X Coordinate: -124.17694 Y Coordinate: 40.79692 Z Coordinate: -45

Implementation: Priority 1 Phase Date Status Open

Notes:



Field Date: 11/8/2017 Report Date: 9/19/2018 Barrier #: 14A
 Facility: Social Services - 600 W Clark St, Eureka
 Location: Exterior - Walkway to Building
 Official Responsible: Karen Clower, Interim ADA Coordinator
 Consent Decree: No Paragraph: M.51 Dwg: N/A
 Barrier Area: Accessible Route - Exterior Remediation: Recommended
 Barrier Type: Bench - Seat Height/Depth/Back Support
 Barrier Description: Bench seat not 20" to 24" deep and height not 17" to 19" above ground. Back support not compliant
 Code References: Performance Standard, CBC 11B-903.3 & 903.5 and 2010 ADAS 903.3 & 903.5
 As Built Description: 16-1/2" bench seat height and 15" seat depth and 16" backrest height
 Proposed Solution: Ensure that min. 1 seating element in area is accessible or 5% overall
 As-Built Meas: 1 Quantity: EACH Cost Estimate: \$1,100.00 BSR: 3 Hindrance
 X Coordinate: -124.17692 Y Coordinate: 40.79692 Z Coordinate: -21
 Implementation: Priority 3 Phase Date Status Open



Field Date: 11/8/2017 Report Date: 9/19/2018 Barrier #: 14B
 Facility: Social Services - 600 W Clark St, Eureka
 Location: Exterior - Walkway to Building
 Official Responsible: Karen Clower, Interim ADA Coordinator
 Consent Decree: No Paragraph: M.51 Dwg: N/A
 Barrier Area: Accessible Route - Exterior Remediation: Required
 Barrier Type: Bench - Level Landing
 Barrier Description: No level landing provided adjacent to bench
 Code References: CBC 11B-903.2 and 2010 ADAS 903.2
 As Built Description: 2.2% slope
 Proposed Solution: Provide level landing adjacent to min. 1 bench or 5% of group of benches
 As-Built Meas: 12 Quantity: SF Cost Estimate: \$1,500.00 BSR: 3 Hindrance
 X Coordinate: -124.17692 Y Coordinate: 40.79692 Z Coordinate: -21
 Implementation: Priority 3 Phase Date Status Open



Field Date: 11/8/2017 Report Date: 9/19/2018 Barrier #: 15
 Facility: Social Services - 600 W Clark St, Eureka
 Location: Exterior - Walkway to Building
 Official Responsible: Karen Clower, Interim ADA Coordinator
 Consent Decree: No Paragraph: M.51 Dwg: N/A
 Barrier Area: Accessible Route - Exterior Remediation: Required
 Barrier Type: Cross Slope - Existing (5.0% or more)
 Barrier Description: Cross slope exceeds 2.0% (5.0% or more)
 Code References: CBC 11B-403.3 and 2010 ADAS 403.3
 As Built Description: 7.8% cross slope
 Proposed Solution: Demolish existing and construct new route
 As-Built Meas: 86 Quantity: LF Cost Estimate: \$10,750.00 BSR: 1 Necessary
 X Coordinate: -124.17679 Y Coordinate: 40.7971 Z Coordinate: 5
 Implementation: Priority 1 Phase Date Status Open
 Notes:



Field Date: 11/8/2017 Report Date: 9/19/2018 Barrier #: 16A
 Facility: Social Services - 600 W Clark St, Eureka
 Location: Exterior - Walkway to Building
 Official Responsible: Karen Clower, Interim ADA Coordinator
 Consent Decree: No Paragraph: M.51 Dwg: N/A
 Barrier Area: Controls and Mechanisms Remediation: Required
 Barrier Type: Operable Part - Landing
 Barrier Description: Landing not provided at operable part
 Code References: CBC 11B-305.2 and 2010 ADAS 305.2
 As Built Description: Aiphone and mailbox 5.0% slope
 Proposed Solution: Remodel to provide level clear floor space at controls/mechanisms
 As-Built Meas: 12 Quantity: SF Cost Estimate: \$6,900.00 BSR: 2 Necessary
 X Coordinate: -124.17677 Y Coordinate: 40.79702 Z Coordinate: 10
 Implementation: Priority 2 Phase Date Status Open
 Notes:



Field Date: 11/8/2017 Report Date: 9/19/2018 Barrier #: 16B
 Facility: Social Services - 600 W Clark St, Eureka
 Location: Exterior - Walkway to Building
 Official Responsible: Karen Clower, Interim ADA Coordinator
 Consent Decree: No Paragraph: M.51 Dwg: N/A
 Barrier Area: Controls and Mechanisms Remediation: Required
 Barrier Type: Operable Part - Side Reach High (Safe Harbor)
 Barrier Description: Operable part at max. 54" high
 Code References: ADA Title II, Subpart D, § 35.150 Existing facilities § 35.150(b)(2)(i)
 As Built Description: Aiphone call button 50-1/2" high. Mail box 58" high
 Proposed Solution: Relocate operating control within accessible reach range
 As-Built Meas: 2 Quantity: EACH Cost Estimate: \$1,500.00 BSR: 3 Hindrance
 X Coordinate: -124.17677 Y Coordinate: 40.79702 Z Coordinate: 10
 Implementation: Priority 2 Phase Date Status Open
 Notes:



Field Date: 11/8/2017 Report Date: 9/19/2018 Barrier #: 16C
 Facility: Social Services - 600 W Clark St, Eureka
 Location: Exterior - Walkway to Building
 Official Responsible: Karen Clower, Interim ADA Coordinator
 Consent Decree: No Paragraph: M.51 Dwg: N/A
 Barrier Area: Accessible Route - Exterior Remediation: Required
 Barrier Type: Protruding Object - Wall Mounted Object
 Barrier Description: Wall mounted object protrudes more than 4" into accessible route between 27" and 80" high
 Code References: CBC 11B-307.2 and 2010 ADAS 307.2
 As Built Description: Mailbox protrudes 7-5/8" at 48" high
 Proposed Solution: Remove object or provide detectable warning
 As-Built Meas: 1 Quantity: JOB Cost Estimate: \$550.00 BSR: 1 Necessary
 X Coordinate: -124.17677 Y Coordinate: 40.79702 Z Coordinate: 10
 Implementation: Priority 1 Phase Date Status Open
 Notes:



Field Date: 11/8/2017 Report Date: 9/19/2018 Barrier #: 17

Facility: Social Services - 600 W Clark St, Eureka

Location: Exterior - Walkway to Building

Official Responsible: Karen Clower, Interim ADA Coordinator

Consent Decree: No Paragraph: M.51 Dwg: N/A

Barrier Area: Accessible Route - Exterior Remediation: Required

Barrier Type: Change in Level - 1/2" or Higher

Barrier Description: Change in level greater than 1/2" in accessible route

Code References: CBC 11B-403.4 and 2010 ADAS 403.4

As Built Description: 1-1/2" lip in walkway surface

Proposed Solution: Grind or repair to remove trip hazard

As-Built Meas: 1 Quantity: LF Cost Estimate: \$250.00 BSR: 1 Necessary

X Coordinate: -124.17678 Y Coordinate: 40.79714 Z Coordinate: 8

Implementation: Priority 1 Phase Date Status Open

Notes:



Field Date: 11/8/2017 Report Date: 9/19/2018 Barrier #: 18A

Facility: Social Services - 600 W Clark St, Eureka

Location: Entrance - Room 103

Official Responsible: Karen Clower, Interim ADA Coordinator

Consent Decree: No Paragraph: M.51 Dwg: 1 of 1

Barrier Area: Signage Remediation: Required

Barrier Type: Room ID Sign - No Tactile Information

Barrier Description: Room ID sign provided for sighted people lacks tactile info for the visually impaired

Code References: CBC 11B-216.2 and 2010 ADAS 216.2

As Built Description: No tactile information provided where visual sign exists

Proposed Solution: Provide room ID sign with tactile information at wall at latch side of door

As-Built Meas: 1 Quantity: EACH Cost Estimate: \$250.00 BSR: 1 Necessary

X Coordinate: N/A Y Coordinate: N/A Z Coordinate: N/A

Implementation: Priority 4 Phase Date Status Open

Notes:



Field Date: 11/8/2017 Report Date: 9/19/2018 Barrier #: 18B

Facility: Social Services - 600 W Clark St, Eureka

Location: Entrance - Room 103

Official Responsible: Karen Clower, Interim ADA Coordinator

Consent Decree: No Paragraph: M.51 Dwg: 1 of 1

Barrier Area: Signage Remediation: Required

Barrier Type: ISA - Accessible Entry

Barrier Description: No sign identifying door as accessible

Code References: CBC 11B-216.6 and 2010 ADAS 216.6

As Built Description: Accessible entrance has no ISA sign

Proposed Solution: Provide ISA at accessible entrance door

As-Built Meas: 1 Quantity: EACH Cost Estimate: \$250.00 BSR: 1 Necessary

X Coordinate: N/A Y Coordinate: N/A Z Coordinate: N/A

Implementation: Priority 4 Phase Date Status Open

Notes:



Field Date: 11/8/2017 Report Date: 9/19/2018 Barrier #: 18C

Facility: Social Services - 600 W Clark St, Eureka

Location: Entrance - Room 103

Official Responsible: Karen Clower, Interim ADA Coordinator

Consent Decree: No Paragraph: M.51 Dwg: 1 of 1

Barrier Area: Doors or Gates Remediation: Required

Barrier Type: Door Closer - Exterior Adjustment

Barrier Description: Door opening force exceeds 5 lbf

Code References: CBC 11B-404.2.9

As Built Description: 7 lbf

Proposed Solution: Replace or adjust existing closer

As-Built Meas: 1 Quantity: EACH Cost Estimate: \$450.00 BSR: 1 Necessary

X Coordinate: N/A Y Coordinate: N/A Z Coordinate: N/A

Implementation: Priority 1 Phase Date Status Open

Notes:



Field Date: 11/8/2017 Report Date: 9/19/2018 Barrier #: 18D
 Facility: Social Services - 600 W Clark St, Eureka
 Location: Entrance - Room 103
 Official Responsible: Karen Clower, Interim ADA Coordinator
 Consent Decree: No Paragraph: M.51 Dwg: 1 of 1
 Barrier Area: Doors or Gates Remediation: Required
 Barrier Type: Door/Gate Height - Existing
 Barrier Description: Door/Gate clearance not min. 80" high
 Code References: CBC 11B-404.2.3 & 11B-307.2 and 2010 ADAS 404.2.3 & 307.2
 As Built Description: 78-1/2" high
 Proposed Solution: Replace door or gate
 As-Built Meas: 1 Quantity: EACH Cost Estimate: \$2,250.00 BSR: 3 Hindrance
 X Coordinate: N/A Y Coordinate: N/A Z Coordinate: N/A
 Implementation: Priority 1 Phase Date Status Open
 Notes: 42-3/4" vision lights



Field Date: 11/8/2017 Report Date: 9/19/2018 Barrier #: 18E
 Facility: Social Services - 600 W Clark St, Eureka
 Location: Entrance - Room 103
 Official Responsible: Karen Clower, Interim ADA Coordinator
 Consent Decree: No Paragraph: M.51 Dwg: 1 of 1
 Barrier Area: Doors or Gates Remediation: Required
 Barrier Type: Threshold (replacement)
 Barrier Description: Door/Gate threshold height exceeds 1/2" with a bevel
 Code References: CBC 11B-404.2.5 and 2010 ADAS 404.2.5
 As Built Description: 2" high threshold
 Proposed Solution: Provide new door threshold
 As-Built Meas: 1 Quantity: EACH Cost Estimate: \$275.00 BSR: 1 Necessary
 X Coordinate: N/A Y Coordinate: N/A Z Coordinate: N/A
 Implementation: Priority 1 Phase Date Status Open
 Notes:



Field Date: 11/8/2017 Report Date: 9/19/2018 Barrier #: 18F

Facility: Social Services - 600 W Clark St, Eureka

Location: Entrance - Room 103

Official Responsible: Karen Clower, Interim ADA Coordinator

Consent Decree: No Paragraph: M.51 Dwg: 1 of 1

Barrier Area: Doors or Gates Remediation: Required

Barrier Type: Door/Gate Landing - Slope > 5.0%

Barrier Description: Door/Gate landing is not level on both sides of door (> 5.0%)

Code References: CBC 11B-404.2.4.4 and 2010 ADAS 404.2.4.4

As Built Description: 6.8% slope

Proposed Solution: Demolish and reconstruct level landing

As-Built Meas: 20 Quantity: SF Cost Estimate: \$2,500.00 BSR: 1 Necessary

X Coordinate: N/A Y Coordinate: N/A Z Coordinate: N/A

Implementation: Priority 1 Phase Date Status Open

Notes:



Field Date: 11/8/2017 Report Date: 9/19/2018 Barrier #: 18G

Facility: Social Services - 600 W Clark St, Eureka

Location: Entrance - Room 103

Official Responsible: Karen Clower, Interim ADA Coordinator

Consent Decree: No Paragraph: M.51 Dwg: 1 of 1

Barrier Area: Doors or Gates Remediation: Required

Barrier Type: Maneuvering Cl - Stored Items

Barrier Description: Door/Gate lacks required maneuvering clearance

Code References: CBC Figure 11B-404.2.4.1 and 2010 ADAS 404.2.4.1

As Built Description: Chair blocks maneuvering clearance at pull side of door

Proposed Solution: Remove stored items to provide access

As-Built Meas: 0 Quantity: EACH Cost Estimate: \$0.00 BSR: 1 Necessary

X Coordinate: N/A Y Coordinate: N/A Z Coordinate: N/A

Implementation: Priority 1 Phase Date Status Open

Notes:



Field Date: 11/8/2017 Report Date: 9/19/2018 Barrier #: 18H

Facility: Social Services - 600 W Clark St, Eureka

Location: Entrance - Room 103

Official Responsible: Karen Clower, Interim ADA Coordinator

Consent Decree: No Paragraph: M.51 Dwg: 1 of 1

Barrier Area: Signage Remediation: Required

Barrier Type: Tactile Exit Sign - Exit

Barrier Description: Ground floor doors that exit to exterior not provided with signs stating "EXIT"

Code References: CBC 11B-216.4.1 & 11B-703 and 2010 ADAS 216.4.1

As Built Description: No tactile sign provided where required

Proposed Solution: Provide compliant sign at exit side of door

As-Built Meas: 1 Quantity: EACH Cost Estimate: \$250.00 BSR: 1 Necessary

X Coordinate: N/A Y Coordinate: N/A Z Coordinate: N/A

Implementation: Priority 4 Phase Date Status Open

Notes:



Field Date: 11/8/2017 Report Date: 9/19/2018 Barrier #: 19A

Facility: Social Services - 600 W Clark St, Eureka

Location: Room 103

Official Responsible: Karen Clower, Interim ADA Coordinator

Consent Decree: No Paragraph: M.51 Dwg: 1 of 1

Barrier Area: Controls and Mechanisms Remediation: Required

Barrier Type: Electrical Switches - Side Reach High (Safe Harbor)

Barrier Description: Light switch control box top edge at max. 54" high measured to top of box

Code References: ADA Title II, Subpart D, § 35.150 Existing facilities § 35.150(b)(2)(i)

As Built Description: 48-1/4" high

Proposed Solution: No remediation required. Control or mechanism complied with prior code and is granted safe harbor

As-Built Meas: 1 Quantity: EACH Cost Estimate: \$0.00 BSR: 4 Low Severity

X Coordinate: N/A Y Coordinate: N/A Z Coordinate: N/A

Implementation: Priority 2 Phase Date Status Closed

Notes:



Field Date: 11/8/2017 Report Date: 9/19/2018 Barrier #: 19B
 Facility: Social Services - 600 W Clark St, Eureka
 Location: Room 103
 Official Responsible: Karen Clower, Interim ADA Coordinator
 Consent Decree: No Paragraph: M.51 Dwg: 1 of 1
 Barrier Area: Controls and Mechanisms Remediation: Required
 Barrier Type: Electrical Outlets - Side Reach Low Unobstructed
 Barrier Description: Electrical outlet control box not min. 15" high measured to the bottom of the outlet box
 Code References: CBC 11B-308.1.2, 11B-308.3.1 and 2010 ADAS 308.3
 As Built Description: 10" high
 Proposed Solution: Relocate outlet to area with min. 15" low reach or max. 48" high reach
 As-Built Meas: 1 Quantity: EACH Cost Estimate: \$750.00 BSR: 3 Hindrance
 X Coordinate: N/A Y Coordinate: N/A Z Coordinate: N/A
 Implementation: Priority 2 Phase Date Status Open
 Notes:



Field Date: 11/8/2017 Report Date: 9/19/2018 Barrier #: 19C
 Facility: Social Services - 600 W Clark St, Eureka
 Location: Room 103
 Official Responsible: Karen Clower, Interim ADA Coordinator
 Consent Decree: No Paragraph: M.51 Dwg: 1 of 1
 Barrier Area: Counters and Tables Remediation: Required
 Barrier Type: Counter - Surface Height
 Barrier Description: No section at least 3 feet long between 28" and 34" provided at existing counter
 Code References: CBC 11B-902.3 & 11B-904.4 and 2010 ADAS 902.3 & 904.4
 As Built Description: 36" high
 Proposed Solution: Provide min. 3 ft long section of counter at max. 34" high
 As-Built Meas: 1 Quantity: EACH Cost Estimate: \$875.00 BSR: 3 Hindrance
 X Coordinate: N/A Y Coordinate: N/A Z Coordinate: N/A
 Implementation: Priority 2 Phase Date Status Open
 Notes:



Field Date: 11/8/2017 Report Date: 9/19/2018 Barrier #: 19D
 Facility: Social Services - 600 W Clark St, Eureka
 Location: Room 103
 Official Responsible: Karen Clower, Interim ADA Coordinator
 Consent Decree: No Paragraph: M.51 Dwg: 1 of 1
 Barrier Area: Clear Floor Space Remediation: Required
 Barrier Type: Clear Floor Space - Wheelchair Use (Stored Items)
 Barrier Description: Clear floor space of min. 30" by 48" not provided at element required to be accessible
 Code References: CBC 11B-305 and 2010 ADAS 305
 As Built Description: No wheelchair seating area provided in lobby/waiting area
 Proposed Solution: Move stored items at control or mechanism
 As-Built Meas: 1 Quantity: JOB Cost Estimate: \$0.00 BSR: 1 Necessary
 X Coordinate: N/A Y Coordinate: N/A Z Coordinate: N/A
 Implementation: Priority 2 Phase Date Status Open
 Notes:



Field Date: 11/8/2017 Report Date: 9/19/2018 Barrier #: 19E
 Facility: Social Services - 600 W Clark St, Eureka
 Location: Room 103
 Official Responsible: Karen Clower, Interim ADA Coordinator
 Consent Decree: No Paragraph: M.51 Dwg: 1 of 1
 Barrier Area: Signage Remediation: Required
 Barrier Type: Braille on Door
 Barrier Description: Braille signage posted on door where door swing could cause injury
 Code References: CBC 11B-703.4.2 and 2010 ADAS 703.4.2
 As Built Description: Sign with tactile information located on door
 Proposed Solution: Remove sign from door
 As-Built Meas: 1 Quantity: EACH Cost Estimate: \$0.00 BSR: 1 Necessary
 X Coordinate: N/A Y Coordinate: N/A Z Coordinate: N/A
 Implementation: Priority 4 Phase Date Status Open
 Notes:



Field Date: 11/8/2017 Report Date: 9/19/2018 Barrier #: 19F

Facility: Social Services - 600 W Clark St, Eureka

Location: Room 103

Official Responsible: Karen Clower, Interim ADA Coordinator

Consent Decree: No Paragraph: M.51 Dwg: 1 of 1

Barrier Area: Signage Remediation: Required

Barrier Type: Location - 48" to 60"

Barrier Description: Braille/Tactile information on sign not located between 48" and 60" high on wall at latch side of door

Code References: CBC 11B-703.4.1 and 2010 ADAS 703.4.1

As Built Description: Tactile information on sign measured at 65-1/2"

Proposed Solution: Provide new sign

As-Built Meas: 1 Quantity: EACH Cost Estimate: \$250.00 BSR: 2 Recommended

X Coordinate: N/A Y Coordinate: N/A Z Coordinate: N/A

Implementation: Priority 4 Phase Date Status Open

Notes:



Field Date: 11/8/2017 Report Date: 9/19/2018 Barrier #: 19G

Facility: Social Services - 600 W Clark St, Eureka

Location: Room 103

Official Responsible: Karen Clower, Interim ADA Coordinator

Consent Decree: No Paragraph: M.51 Dwg: 1 of 1

Barrier Area: Restrooms Remediation: Required

Barrier Type: Sign - 12" Circle/Triangle at Unisex Restroom

Barrier Description: No 12" triangle superimposed on 12" circle provided on door or doorway to unisex toilet room

Code References: CBC 11B-703.7.2.6.3

As Built Description: Required sign not provided on door or doorway

Proposed Solution: Provide 12" circle/triangle sign on door

As-Built Meas: 1 Quantity: EACH Cost Estimate: \$250.00 BSR: 1 Necessary

X Coordinate: N/A Y Coordinate: N/A Z Coordinate: N/A

Implementation: Priority 4 Phase Date Status Open

Notes:



Field Date: 11/8/2017 Report Date: 9/19/2018 Barrier #: 20A

Facility: Social Services - 600 W Clark St, Eureka

Location: Room 107

Official Responsible: Karen Clower, Interim ADA Coordinator

Consent Decree: No Paragraph: M.51 Dwg: 1 of 1

Barrier Area: Signage Remediation: Required

Barrier Type: Room ID Sign - No Tactile Information

Barrier Description: Room ID sign provided for sighted people lacks tactile info for the visually impaired

Code References: CBC 11B-216.2 and 2010 ADAS 216.2

As Built Description: No tactile information provided where visual sign exists

Proposed Solution: Provide room ID sign with tactile information at wall at latch side of door

As-Built Meas: 1 Quantity: EACH Cost Estimate: \$250.00 BSR: 1 Necessary

X Coordinate: N/A Y Coordinate: N/A Z Coordinate: N/A

Implementation: Priority 4 Phase Date Status Open

Notes:



Field Date: 11/8/2017 Report Date: 9/19/2018 Barrier #: 20B

Facility: Social Services - 600 W Clark St, Eureka

Location: Room 107

Official Responsible: Karen Clower, Interim ADA Coordinator

Consent Decree: No Paragraph: M.51 Dwg: 1 of 1

Barrier Area: Doors or Gates Remediation: Required

Barrier Type: Door/Gate Height - Existing

Barrier Description: Door/Gate clearance not min. 80" high

Code References: CBC 11B-404.2.3 & 11B-307.2 and 2010 ADAS 404.2.3 & 307.2

As Built Description: 77-1/2" high

Proposed Solution: Replace door or gate

As-Built Meas: 1 Quantity: EACH Cost Estimate: \$2,250.00 BSR: 3 Hindrance

X Coordinate: N/A Y Coordinate: N/A Z Coordinate: N/A

Implementation: Priority 2 Phase Date Status Open

Notes:



Field Date: 11/8/2017 Report Date: 9/19/2018 Barrier #: 20C

Facility: Social Services - 600 W Clark St, Eureka

Location: Room 107

Official Responsible: Karen Clower, Interim ADA Coordinator

Consent Decree: No Paragraph: M.51 Dwg: 1 of 1

Barrier Area: Doors or Gates Remediation: Required

Barrier Type: Maneuvering CI - Stored Items

Barrier Description: Door/Gate lacks required maneuvering clearance

Code References: CBC Figure 11B-404.2.4.1 and 2010 ADAS 404.2.4.1

As Built Description: Tables blocks maneuvering clearance at pull side of door

Proposed Solution: Rearrange stored items to provide access

As-Built Meas: 0 Quantity: EACH Cost Estimate: \$0.00 BSR: 1 Necessary

X Coordinate: N/A Y Coordinate: N/A Z Coordinate: N/A

Implementation: Priority 2 Phase Date Status Open

Notes:



Field Date: 11/8/2017 Report Date: 9/19/2018 Barrier #: 20D

Facility: Social Services - 600 W Clark St, Eureka

Location: Room 107

Official Responsible: Karen Clower, Interim ADA Coordinator

Consent Decree: No Paragraph: M.51 Dwg: 1 of 1

Barrier Area: Accessible Route - Interior Remediation: Required

Barrier Type: Clear Width - 36" Wide (Stored Items)

Barrier Description: Accessible route clear width is not min. 36" wide

Code References: CBC 11B-403.5.1 and 2010 ADAS 403.5.1

As Built Description: Furniture or stored items block circulation route and prevent passage through space

Proposed Solution: Rearrange furniture to provide min. 36" wide passage space through room

As-Built Meas: 1 Quantity: JOB Cost Estimate: \$0.00 BSR: 2 Recommended

X Coordinate: N/A Y Coordinate: N/A Z Coordinate: N/A

Implementation: Priority 2 Phase Date Status Open

Notes: 24" wide



Field Date: 11/8/2017 Report Date: 9/19/2018 Barrier #: 20E
 Facility: Social Services - 600 W Clark St, Eureka
 Location: Room 107
 Official Responsible: Karen Clower, Interim ADA Coordinator
 Consent Decree: No Paragraph: M.51 Dwg: 1 of 1
 Barrier Area: Controls and Mechanisms Remediation: Required
 Barrier Type: Electrical Outlets - High/Low Reach
 Barrier Description: Electrical outlet measured from bottom of box not min. 15" high or max. 48" high measured to top of box
 Code References: CBC 11B-308.1.2, 11B-308.2.1 & 2010 ADAS 308.2.2
 As Built Description: 9" high
 Proposed Solution: Relocate outlet to area with min. 15" low reach or max. 48" high reach
 As-Built Meas: 1 Quantity: EACH Cost Estimate: \$750.00 BSR: 3 Hindrance
 X Coordinate: N/A Y Coordinate: N/A Z Coordinate: N/A
 Implementation: Priority 2 Phase Date Status Open



Field Date: 11/8/2017 Report Date: 9/19/2018 Barrier #: 20F
 Facility: Social Services - 600 W Clark St, Eureka
 Location: Room 107
 Official Responsible: Karen Clower, Interim ADA Coordinator
 Consent Decree: No Paragraph: M.51 Dwg: 1 of 1
 Barrier Area: Counters and Tables Remediation: Required
 Barrier Type: Table - Knee Clearance
 Barrier Description: Knee clearance not min. 27" high, 19" deep or 30" wide
 Code References: CBC 11B-306.3 and 2010 ADAS 306.3
 As Built Description: 26-1/4" high and 11" deep knee clearance
 Proposed Solution: Provide min. 1 accessible table and 5% overall. Avoid pedestal base tables.
 As-Built Meas: 1 Quantity: EACH Cost Estimate: \$450.00 BSR: 3 Hindrance
 X Coordinate: N/A Y Coordinate: N/A Z Coordinate: N/A
 Implementation: Priority 2 Phase Date Status Open



Field Date: 11/8/2017 Report Date: 9/19/2018 Barrier #: 20G
 Facility: Social Services - 600 W Clark St, Eureka
 Location: Room 107
 Official Responsible: Karen Clower, Interim ADA Coordinator
 Consent Decree: No Paragraph: M.51 Dwg: 1 of 1
 Barrier Area: Alarms Remediation: Required
 Barrier Type: Fire Pull - Accessible Route
 Barrier Description: Fire pull not on accessible route
 Code References: CBC 11B-305.5 and 2010 ADAS 305.5
 As Built Description: Desk blocks fire pull clear floor space
 Proposed Solution: Move stored items to provide access to fire alarm actuator
 As-Built Meas: 0 Quantity: JOB Cost Estimate: \$0.00 BSR: 1 Necessary
 X Coordinate: N/A Y Coordinate: N/A Z Coordinate: N/A
 Implementation: Priority 2 Phase Date Status Open
 Notes:



Field Date: 11/8/2017 Report Date: 9/19/2018 Barrier #: 20H
 Facility: Social Services - 600 W Clark St, Eureka
 Location: Room 107
 Official Responsible: Karen Clower, Interim ADA Coordinator
 Consent Decree: No Paragraph: M.51 Dwg: 1 of 1
 Barrier Area: Signage Remediation: Required
 Barrier Type: Tactile Exit Sign - Exit
 Barrier Description: Ground floor doors that exit to exterior not provided with signs stating "EXIT"
 Code References: CBC 11B-216.4.1 & 11B-703 and 2010 ADAS 216.4.1
 As Built Description: No tactile sign provided where required
 Proposed Solution: Provide compliant sign at exit side of door
 As-Built Meas: 1 Quantity: EACH Cost Estimate: \$250.00 BSR: 1 Necessary
 X Coordinate: N/A Y Coordinate: N/A Z Coordinate: N/A
 Implementation: Priority 4 Phase Date Status Open
 Notes:



Field Date: 11/8/2017 Report Date: 9/19/2018 Barrier #: 201
 Facility: Social Services - 600 W Clark St, Eureka
 Location: Room 107
 Official Responsible: Karen Clower, Interim ADA Coordinator
 Consent Decree: No Paragraph: M.51 Dwg: 1 of 1
 Barrier Area: Alarms Remediation: Required
 Barrier Type: Horn/Strobe - Staff Area
 Barrier Description: No horn/strobe in staff areas
 Code References: CBC 11B-702.1 and 2010 ADAS 702.1
 As Built Description: Device not provided
 Proposed Solution: Provide horn/strobe in area where programs, services and activities take place
 As-Built Meas: 1 Quantity: EACH Cost Estimate: \$5,500.00 BSR: 3 Hindrance
 X Coordinate: N/A Y Coordinate: N/A Z Coordinate: N/A
 Implementation: Priority 2 Phase Date Status Open
 Notes:



Field Date: 11/8/2017 Report Date: 9/19/2018 Barrier #: 21A
 Facility: Social Services - 600 W Clark St, Eureka
 Location: Room 108
 Official Responsible: Karen Clower, Interim ADA Coordinator
 Consent Decree: No Paragraph: M.51 Dwg: 1 of 1
 Barrier Area: Signage Remediation: Required
 Barrier Type: Room ID Sign - No Tactile Information
 Barrier Description: Room ID sign provided for sighted people lacks tactile info for the visually impaired
 Code References: CBC 11B-216.2 and 2010 ADAS 216.2
 As Built Description: No tactile information provided where visual sign exists
 Proposed Solution: Provide room ID sign with tactile information at wall at latch side of door
 As-Built Meas: 1 Quantity: EACH Cost Estimate: \$250.00 BSR: 1 Necessary
 X Coordinate: N/A Y Coordinate: N/A Z Coordinate: N/A
 Implementation: Priority 4 Phase Date Status Open
 Notes:



Field Date: 11/8/2017 Report Date: 9/19/2018 Barrier #: 21B
 Facility: Social Services - 600 W Clark St, Eureka
 Location: Room 108
 Official Responsible: Karen Clower, Interim ADA Coordinator
 Consent Decree: No Paragraph: M.51 Dwg: 1 of 1
 Barrier Area: Doors or Gates Remediation: Required
 Barrier Type: Door Closer - Interior Adjustment
 Barrier Description: Door opening force exceeds 5 lbf
 Code References: CBC 11B-404.2.9 and 2010 ADAS 404.2.9
 As Built Description: 9 lbf at non-fire rated door
 Proposed Solution: Per US DOJ, door closer can be removed to comply. If closer remains, adjust or replace to provide max. 5 lbf
 As-Built Meas: 0 Quantity: EACH Cost Estimate: \$0.00 BSR: 1 Necessary
 X Coordinate: N/A Y Coordinate: N/A Z Coordinate: N/A
 Implementation: Priority 2 Phase Date Status Open
 Notes:



Field Date: 11/8/2017 Report Date: 9/19/2018 Barrier #: 21C
 Facility: Social Services - 600 W Clark St, Eureka
 Location: Room 108
 Official Responsible: Karen Clower, Interim ADA Coordinator
 Consent Decree: No Paragraph: M.51 Dwg: 1 of 1
 Barrier Area: Doors or Gates Remediation: Required
 Barrier Type: Maneuvering Cl - Front App/Push 12"
 Barrier Description: Door/Gate with latch/closer at push side lacks min. 12" beyond latch side of door
 Code References: CBC Figure 11B-404.2.4.1 and 2010 ADAS 404.2.4.1
 As Built Description: 6" maneuvering clearance at push side of door
 Proposed Solution: Relocate door or gate or alter area to provide required maneuvering clearance
 As-Built Meas: 1 Quantity: EACH Cost Estimate: \$2,250.00 BSR: 1 Necessary
 X Coordinate: N/A Y Coordinate: N/A Z Coordinate: N/A
 Implementation: Priority 2 Phase Date Status Open
 Notes:



Field Date: 11/8/2017 Report Date: 9/19/2018 Barrier #: 22A
 Facility: Social Services - 600 W Clark St, Eureka
 Location: Room 109
 Official Responsible: Karen Clower, Interim ADA Coordinator
 Consent Decree: No Paragraph: M.51 Dwg: 1 of 1
 Barrier Area: Signage Remediation: Required
 Barrier Type: Room ID Sign - No Tactile Information
 Barrier Description: Room ID sign provided for sighted people lacks tactile info for the visually impaired
 Code References: CBC 11B-216.2 and 2010 ADAS 216.2
 As Built Description: No tactile information provided where visual sign exists
 Proposed Solution: Provide room ID sign with tactile information at wall at latch side of door
 As-Built Meas: 1 Quantity: EACH Cost Estimate: \$250.00 BSR: 1 Necessary
 X Coordinate: N/A Y Coordinate: N/A Z Coordinate: N/A
 Implementation: Priority 4 Phase Date Status Open
 Notes:



Field Date: 11/8/2017 Report Date: 9/19/2018 Barrier #: 22B
 Facility: Social Services - 600 W Clark St, Eureka
 Location: Room 109
 Official Responsible: Karen Clower, Interim ADA Coordinator
 Consent Decree: No Paragraph: M.51 Dwg: 1 of 1
 Barrier Area: Controls and Mechanisms Remediation: Required
 Barrier Type: Electrical Outlets - Side Reach Low Unobstructed
 Barrier Description: Electrical outlet control box not min. 15" high measured to the bottom of the outlet box
 Code References: CBC 11B-308.1.2, 11B-308.3.1 and 2010 ADAS 308.3
 As Built Description: 11-1/2" high
 Proposed Solution: Relocate outlet to area with min. 15" low reach or max. 48" high reach
 As-Built Meas: 1 Quantity: EACH Cost Estimate: \$750.00 BSR: 3 Hindrance
 X Coordinate: N/A Y Coordinate: N/A Z Coordinate: N/A
 Implementation: Priority 2 Phase Date Status Open
 Notes:



Field Date: 11/8/2017 Report Date: 9/19/2018 Barrier #: 22C
 Facility: Social Services - 600 W Clark St, Eureka
 Location: Room 109
 Official Responsible: Karen Clower, Interim ADA Coordinator
 Consent Decree: No Paragraph: M.51 Dwg: 1 of 1
 Barrier Area: Counters and Tables Remediation: Required
 Barrier Type: Table - Clear Floor Space (Stored Items)
 Barrier Description: Clear floor space 30" x 48" not provided at table
 Code References: CBC 11B-305.3 and 2010 ADAS 305.3
 As Built Description: Adequate clear floor space not provided at table
 Proposed Solution: Relocate desk if used by the public when receiving services
 As-Built Meas: 1 Quantity: EACH Cost Estimate: \$0.00 BSR: 3 Hindrance
 X Coordinate: N/A Y Coordinate: N/A Z Coordinate: N/A
 Implementation: Priority 2 Phase Date Status Open
 Notes:



Field Date: 11/8/2017 Report Date: 9/19/2018 Barrier #: 22D
 Facility: Social Services - 600 W Clark St, Eureka
 Location: Room 109
 Official Responsible: Karen Clower, Interim ADA Coordinator
 Consent Decree: No Paragraph: M.51 Dwg: 1 of 1
 Barrier Area: Counters and Tables Remediation: Required
 Barrier Type: Table - Knee Clearance
 Barrier Description: Knee clearance of at least 27" high, 30" wide and 19" deep not provided
 Code References: CBC 11B-306.3 and 2010 ADAS 306.3
 As Built Description: 24-1/2" high, 27" wide, and 14" deep knee clearance
 Proposed Solution: Provide min. 1 accessible table and 5% overall. Avoid pedestal base tables.
 As-Built Meas: 1 Quantity: EACH Cost Estimate: \$450.00 BSR: 3 Hindrance
 X Coordinate: N/A Y Coordinate: N/A Z Coordinate: N/A
 Implementation: Priority 2 Phase Date Status Open
 Notes:



Field Date: 11/8/2017 Report Date: 9/19/2018 Barrier #: 22E
 Facility: Social Services - 600 W Clark St, Eureka
 Location: Room 109
 Official Responsible: Karen Clower, Interim ADA Coordinator
 Consent Decree: No Paragraph: M.51 Dwg: 1 of 1
 Barrier Area: Controls and Mechanisms Remediation: Required
 Barrier Type: Electrical Switches - Side Reach High (Safe Harbor)
 Barrier Description: Light switch control box top edge at max. 54" high measured to top of box
 Code References: ADA Title II, Subpart D, § 35.150 Existing facilities § 35.150(b)(2)(i)
 As Built Description: 50" high
 Proposed Solution: No remediation required. Control or mechanism complied with prior code and is granted safe harbor
 As-Built Meas: 1 Quantity: EACH Cost Estimate: \$0.00 BSR: 4 Low Severity
 X Coordinate: N/A Y Coordinate: N/A Z Coordinate: N/A
 Implementation: Priority 2 Phase Date Status Closed
 Notes:



Field Date: 11/8/2017 Report Date: 9/19/2018 Barrier #: 22F
 Facility: Social Services - 600 W Clark St, Eureka
 Location: Room 109
 Official Responsible: Karen Clower, Interim ADA Coordinator
 Consent Decree: No Paragraph: M.51 Dwg: 1 of 1
 Barrier Area: Signage Remediation: Required
 Barrier Type: Room ID Sign - No Tactile Information
 Barrier Description: Room ID sign provided for sighted people lacks tactile info for the visually impaired
 Code References: CBC 11B-216.2 and 2010 ADAS 216.2
 As Built Description: No tactile information provided where visual sign exists in circulation path
 Proposed Solution: Provide room ID sign with tactile information at wall at latch side of door
 As-Built Meas: 2 Quantity: EACH Cost Estimate: \$500.00 BSR: 1 Necessary
 X Coordinate: N/A Y Coordinate: N/A Z Coordinate: N/A
 Implementation: Priority 4 Phase Date Status Open
 Notes:



Field Date: 11/8/2017 Report Date: 9/19/2018 Barrier #: 22G

Facility: Social Services - 600 W Clark St, Eureka

Location: Room 109

Official Responsible: Karen Clower, Interim ADA Coordinator

Consent Decree: No Paragraph: M.51 Dwg: 1 of 1

Barrier Area: Alarms Remediation: Required

Barrier Type: Horn/Strobe - Meeting Room

Barrier Description: No horn/strobes in meeting room

Code References: CBC 11B-702.1 and 2010 ADAS 702.1

As Built Description: Device not provided

Proposed Solution: Provide strobes in common use area

As-Built Meas: 1 Quantity: EACH Cost Estimate: \$5,500.00 BSR: 1 Necessary

X Coordinate: N/A Y Coordinate: N/A Z Coordinate: N/A

Implementation: Priority 2 Phase Date Status Open

Notes:



Field Date: 11/8/2017 Report Date: 9/19/2018 Barrier #: 23A

Facility: Social Services - 600 W Clark St, Eureka

Location: Entrance - Room 120

Official Responsible: Karen Clower, Interim ADA Coordinator

Consent Decree: No Paragraph: M.51 Dwg: 1 of 1

Barrier Area: Controls and Mechanisms Remediation: Required

Barrier Type: Operable Part - Landing

Barrier Description: Landing not provided at operable part

Code References: CBC 11B-305.2 and 2010 ADAS 305.2

As Built Description: Aiphone call button 10.8% slope

Proposed Solution: Remodel to provide level clear floor space at controls/mechanisms

As-Built Meas: 12 Quantity: SF Cost Estimate: \$6,900.00 BSR: 2 Necessary

X Coordinate: N/A Y Coordinate: N/A Z Coordinate: N/A

Implementation: Priority 2 Phase Date Status Open

Notes:



Field Date: 11/8/2017 Report Date: 9/19/2018 Barrier #: 23B
 Facility: Social Services - 600 W Clark St, Eureka
 Location: Entrance - Room 120
 Official Responsible: Karen Clower, Interim ADA Coordinator
 Consent Decree: No Paragraph: M.51 Dwg: 1 of 1
 Barrier Area: Controls and Mechanisms Remediation: Required
 Barrier Type: Operable Part - Side Reach High Unobstructed
 Barrier Description: Operable part not at min. 15" or max. 48" high
 Code References: CBC 11B-308.3.1 and 2010 ADAS 308.3.1
 As Built Description: Aiphone call button 57-1/2" high
 Proposed Solution: Relocate control or mechanism to min. 15" or max. 48" high
 As-Built Meas: 1 Quantity: EACH Cost Estimate: \$750.00 BSR: 3 Hindrance
 X Coordinate: N/A Y Coordinate: N/A Z Coordinate: N/A
 Implementation: Priority 2 Phase Date Status Open
 Notes:



Field Date: 11/8/2017 Report Date: 9/19/2018 Barrier #: 23C
 Facility: Social Services - 600 W Clark St, Eureka
 Location: Entrance - Room 120
 Official Responsible: Karen Clower, Interim ADA Coordinator
 Consent Decree: No Paragraph: M.51 Dwg: 1 of 1
 Barrier Area: Signage Remediation: Required
 Barrier Type: Room ID Sign - No Tactile Information
 Barrier Description: Room ID sign provided for sighted people lacks tactile info for the visually impaired
 Code References: CBC 11B-216.2 and 2010 ADAS 216.2
 As Built Description: No tactile information provided where visual sign exists
 Proposed Solution: Provide room ID sign with tactile information at wall at latch side of door
 As-Built Meas: 1 Quantity: EACH Cost Estimate: \$250.00 BSR: 1 Necessary
 X Coordinate: N/A Y Coordinate: N/A Z Coordinate: N/A
 Implementation: Priority 4 Phase Date Status Open
 Notes:



Field Date: 11/8/2017 Report Date: 9/19/2018 Barrier #: 23D

Facility: Social Services - 600 W Clark St, Eureka

Location: Entrance - Room 120

Official Responsible: Karen Clower, Interim ADA Coordinator

Consent Decree: No Paragraph: M.51 Dwg: 1 of 1

Barrier Area: Signage Remediation: Required

Barrier Type: ISA - Accessible Entry

Barrier Description: No sign identifying door as accessible

Code References: CBC 11B-216.6 and 2010 ADAS 216.6

As Built Description: Accessible entrance has no ISA sign

Proposed Solution: Provide ISA at accessible entrance door

As-Built Meas: 1 Quantity: EACH Cost Estimate: \$250.00 BSR: 1 Necessary

X Coordinate: N/A Y Coordinate: N/A Z Coordinate: N/A

Implementation: Priority 4 Phase Date Status Open

Notes:



Field Date: 11/8/2017 Report Date: 9/19/2018 Barrier #: 23E

Facility: Social Services - 600 W Clark St, Eureka

Location: Entrance - Room 120

Official Responsible: Karen Clower, Interim ADA Coordinator

Consent Decree: No Paragraph: M.51 Dwg: 1 of 1

Barrier Area: Doors or Gates Remediation: Required

Barrier Type: Door Closer - Exterior Sweep

Barrier Description: Door closer lacks min. 5 second sweep period/back check

Code References: CBC 11B-404.2.8.1 and 2010 ADAS 404.2.8.1

As Built Description: 3 seconds sweep

Proposed Solution: Replace or adjust existing closer

As-Built Meas: 1 Quantity: EACH Cost Estimate: \$250.00 BSR: 2 Recommended

X Coordinate: N/A Y Coordinate: N/A Z Coordinate: N/A

Implementation: Priority 1 Phase Date Status Open

Notes:



Field Date: 11/8/2017 Report Date: 9/19/2018 Barrier #: 23F
 Facility: Social Services - 600 W Clark St, Eureka
 Location: Entrance - Room 120
 Official Responsible: Karen Clower, Interim ADA Coordinator
 Consent Decree: No Paragraph: M.51 Dwg: 1 of 1
 Barrier Area: Doors or Gates Remediation: Required
 Barrier Type: Door/Gate Height - Existing
 Barrier Description: Door/Gate clearance not min. 80" high
 Code References: CBC 11B-404.2.3 & 11B-307.2 and 2010 ADAS 404.2.3 & 307.2
 As Built Description: 79-7/8" high
 Proposed Solution: Replace door or gate
 As-Built Meas: 1 Quantity: EACH Cost Estimate: \$2,250.00 BSR: 3 Hindrance
 X Coordinate: N/A Y Coordinate: N/A Z Coordinate: N/A
 Implementation: Priority 1 Phase Date Status Open



Field Date: 11/8/2017 Report Date: 9/19/2018 Barrier #: 23G
 Facility: Social Services - 600 W Clark St, Eureka
 Location: Entrance - Room 120
 Official Responsible: Karen Clower, Interim ADA Coordinator
 Consent Decree: No Paragraph: M.51 Dwg: 1 of 1
 Barrier Area: Doors or Gates Remediation: Required
 Barrier Type: Threshold (replacement)
 Barrier Description: Door/Gate threshold height exceeds 1/2" with a bevel
 Code References: CBC 11B-404.2.5 and 2010 ADAS 404.2.5
 As Built Description: 1-1/4" high threshold
 Proposed Solution: Provide new door threshold
 As-Built Meas: 1 Quantity: EACH Cost Estimate: \$275.00 BSR: 1 Necessary
 X Coordinate: N/A Y Coordinate: N/A Z Coordinate: N/A
 Implementation: Priority 1 Phase Date Status Open



Field Date: 11/8/2017 Report Date: 9/19/2018 Barrier #: 23H
 Facility: Social Services - 600 W Clark St, Eureka
 Location: Entrance - Room 120
 Official Responsible: Karen Clower, Interim ADA Coordinator
 Consent Decree: No Paragraph: M.51 Dwg: 1 of 1
 Barrier Area: Doors or Gates Remediation: Required
 Barrier Type: Door/Gate Landing - Slope > 5.0%
 Barrier Description: Door/Gate landing is not level on both sides of door (> 5.0%)
 Code References: CBC 11B-404.2.4.4 and 2010 ADAS 404.2.4.4
 As Built Description: 10.8% slope
 Proposed Solution: Demolish and reconstruct level landing
 As-Built Meas: 20 Quantity: SF Cost Estimate: \$2,500.00 BSR: 1 Necessary
 X Coordinate: N/A Y Coordinate: N/A Z Coordinate: N/A
 Implementation: Priority 1 Phase Date Status Open



Field Date: 11/8/2017 Report Date: 9/19/2018 Barrier #: 23I
 Facility: Social Services - 600 W Clark St, Eureka
 Location: Entrance - Room 120
 Official Responsible: Karen Clower, Interim ADA Coordinator
 Consent Decree: No Paragraph: M.51 Dwg: 1 of 1
 Barrier Area: Doors or Gates Remediation: Required
 Barrier Type: Maneuvering Cl - Ext Front App/Pull 24"
 Barrier Description: Door/Gate at pull side of exterior door lacks min. 24" beyond latch side of door
 Code References: CBC Figure 11B-404.2.4.1 and 2010 ADAS 404.2.4.1
 As Built Description: 4" maneuvering clearance at pull side of door
 Proposed Solution: Relocate door or gate or alter area to provide required maneuvering clearance
 As-Built Meas: 1 Quantity: EACH Cost Estimate: \$2,250.00 BSR: 1 Necessary
 X Coordinate: N/A Y Coordinate: N/A Z Coordinate: N/A
 Implementation: Priority 1 Phase Date Status Open



Field Date: 11/8/2017 Report Date: 9/19/2018 Barrier #: 23J
 Facility: Social Services - 600 W Clark St, Eureka
 Location: Entrance - Room 120
 Official Responsible: Karen Clower, Interim ADA Coordinator
 Consent Decree: No Paragraph: M.51 Dwg: 1 of 1
 Barrier Area: Doors or Gates Remediation: Required
 Barrier Type: Maneuvering CI - Front App/Pull 60"
 Barrier Description: Door/Gate at pull side lacks min. 60" perpendicular to door
 Code References: CBC Figure 11B-404.2.4.1 and 2010 ADAS 404.2.4.1
 As Built Description: 48" maneuvering clearance at pull side of door due to vehicle
 Proposed Solution: Relocate door or gate or alter area to provide required maneuvering clearance
 As-Built Meas: 0 Quantity: EACH Cost Estimate: \$0.00 BSR: 1 Necessary
 X Coordinate: N/A Y Coordinate: N/A Z Coordinate: N/A
 Implementation: Priority 1 Phase Date Status Open



Field Date: 11/8/2017 Report Date: 9/19/2018 Barrier #: 23K
 Facility: Social Services - 600 W Clark St, Eureka
 Location: Entrance - Room 120
 Official Responsible: Karen Clower, Interim ADA Coordinator
 Consent Decree: No Paragraph: M.51 Dwg: 1 of 1
 Barrier Area: Doors or Gates Remediation: Required
 Barrier Type: Maneuvering CI - Front App/Push 12"
 Barrier Description: Door/Gate with latch/closer at push side lacks min. 12" beyond latch side of door
 Code References: CBC Figure 11B-404.2.4.1 and 2010 ADAS 404.2.4.1
 As Built Description: 7-1/4" maneuvering clearance at push side of door
 Proposed Solution: Alter area to provide required maneuvering clearance
 As-Built Meas: 0 Quantity: EACH Cost Estimate: \$0.00 BSR: 1 Necessary
 X Coordinate: N/A Y Coordinate: N/A Z Coordinate: N/A
 Implementation: Priority 1 Phase Date Status Open



Field Date: 11/8/2017 Report Date: 9/19/2018 Barrier #: 23L
 Facility: Social Services - 600 W Clark St, Eureka
 Location: Entrance - Room 120
 Official Responsible: Karen Clower, Interim ADA Coordinator
 Consent Decree: No Paragraph: M.51 Dwg: 1 of 1
 Barrier Area: Signage Remediation: Required
 Barrier Type: Tactile Exit Sign - Exit
 Barrier Description: Ground floor doors that exit to exterior not provided with signs stating "EXIT"
 Code References: CBC 11B-216.4.1 & 11B-703 and 2010 ADAS 216.4.1
 As Built Description: No tactile sign provided where required
 Proposed Solution: Provide compliant sign at exit side of door
 As-Built Meas: 1 Quantity: EACH Cost Estimate: \$250.00 BSR: 1 Necessary
 X Coordinate: N/A Y Coordinate: N/A Z Coordinate: N/A
 Implementation: Priority 4 Phase Date Status Open
 Notes:



Field Date: 11/8/2017 Report Date: 9/19/2018 Barrier #: 24A
 Facility: Social Services - 600 W Clark St, Eureka
 Location: Room 120 Vestibule
 Official Responsible: Karen Clower, Interim ADA Coordinator
 Consent Decree: No Paragraph: M.51 Dwg: 1 of 1
 Barrier Area: Controls and Mechanisms Remediation: Required
 Barrier Type: Electrical Switches - Side Reach High (Safe Harbor)
 Barrier Description: Light switch control box top edge at max. 54" high measured to top of box
 Code References: ADA Title II, Subpart D, § 35.150 Existing facilities § 35.150(b)(2)(i)
 As Built Description: 48-1/2" high
 Proposed Solution: No remediation required. Control or mechanism complied with prior code and is granted safe harbor
 As-Built Meas: 1 Quantity: EACH Cost Estimate: \$0.00 BSR: 4 Low Severity
 X Coordinate: N/A Y Coordinate: N/A Z Coordinate: N/A
 Implementation: Priority 2 Phase Date Status Closed
 Notes:



Field Date: 11/8/2017 Report Date: 9/19/2018 Barrier #: 24B
 Facility: Social Services - 600 W Clark St, Eureka
 Location: Room 120 Vestibule
 Official Responsible: Karen Clower, Interim ADA Coordinator
 Consent Decree: No Paragraph: M.51 Dwg: 1 of 1
 Barrier Area: Signage Remediation: Required
 Barrier Type: Room ID Sign - No Tactile Information
 Barrier Description: Room ID sign provided for sighted people lacks tactile info for the visually impaired
 Code References: CBC 11B-216.2 and 2010 ADAS 216.2
 As Built Description: No tactile information provided where visual sign exists at room 109
 Proposed Solution: Provide room ID sign with tactile information at wall at latch side of door
 As-Built Meas: 1 Quantity: EACH Cost Estimate: \$250.00 BSR: 1 Necessary
 X Coordinate: N/A Y Coordinate: N/A Z Coordinate: N/A
 Implementation: Priority 4 Phase Date Status Open



Notes:

Field Date: 11/8/2017 Report Date: 9/19/2018 Barrier #: 24C
 Facility: Social Services - 600 W Clark St, Eureka
 Location: Room 120 Vestibule
 Official Responsible: Karen Clower, Interim ADA Coordinator
 Consent Decree: No Paragraph: M.51 Dwg: 1 of 1
 Barrier Area: Signage Remediation: Required
 Barrier Type: Braille on Door
 Barrier Description: Braille signage posted on door where door swing could cause injury
 Code References: CBC 11B-703.4.2 and 2010 ADAS 703.4.2
 As Built Description: Sign with tactile information located on door
 Proposed Solution: Remove sign from door
 As-Built Meas: 1 Quantity: EACH Cost Estimate: \$0.00 BSR: 1 Necessary
 X Coordinate: N/A Y Coordinate: N/A Z Coordinate: N/A
 Implementation: Priority 4 Phase Date Status Open



Notes:

Field Date: 11/8/2017 Report Date: 9/19/2018 Barrier #: 24D
 Facility: Social Services - 600 W Clark St, Eureka
 Location: Room 120 Vestibule
 Official Responsible: Karen Clower, Interim ADA Coordinator
 Consent Decree: No Paragraph: M.51 Dwg: 1 of 1
 Barrier Area: Signage Remediation: Required
 Barrier Type: Location - 48" to 60"
 Barrier Description: Braille/Tactile information on sign not located between 48" and 60" high on wall at latch side of door
 Code References: CBC 11B-703.4.1 and 2010 ADAS 703.4.1
 As Built Description: 67-1/2" high
 Proposed Solution: Reposition sign or provide new sign
 As-Built Meas: 1 Quantity: EACH Cost Estimate: \$250.00 BSR: 2 Recommended
 X Coordinate: N/A Y Coordinate: N/A Z Coordinate: N/A
 Implementation: Priority 4 Phase Date Status Open
 Notes:



Field Date: 11/8/2017 Report Date: 9/19/2018 Barrier #: 24E
 Facility: Social Services - 600 W Clark St, Eureka
 Location: Room 120 Vestibule
 Official Responsible: Karen Clower, Interim ADA Coordinator
 Consent Decree: No Paragraph: M.51 Dwg: 1 of 1
 Barrier Area: Alarms Remediation: Required
 Barrier Type: Horn/Strobe - Corridor
 Barrier Description: No horn/strobes in corridor
 Code References: CBC 11B-702.1 and 2010 ADAS 702.1
 As Built Description: Device not provided
 Proposed Solution: Provide strobes in common use area
 As-Built Meas: 1 Quantity: EACH Cost Estimate: \$5,500.00 BSR: 1 Necessary
 X Coordinate: N/A Y Coordinate: N/A Z Coordinate: N/A
 Implementation: Priority 2 Phase Date Status Open
 Notes:



Field Date: 11/8/2017 Report Date: 9/19/2018 Barrier #: 25A
 Facility: Social Services - 600 W Clark St, Eureka
 Location: Room 120
 Official Responsible: Karen Clower, Interim ADA Coordinator
 Consent Decree: No Paragraph: M.51 Dwg: 1 of 1
 Barrier Area: Signage Remediation: Required
 Barrier Type: Room ID Sign - No Tactile Information
 Barrier Description: Room ID sign provided for sighted people lacks tactile info for the visually impaired
 Code References: CBC 11B-216.2 and 2010 ADAS 216.2
 As Built Description: No tactile information provided where visual sign exists
 Proposed Solution: Provide room ID sign with tactile information at wall at latch side of door
 As-Built Meas: 1 Quantity: EACH Cost Estimate: \$250.00 BSR: 1 Necessary
 X Coordinate: N/A Y Coordinate: N/A Z Coordinate: N/A
 Implementation: Priority 4 Phase Date Status Open
 Notes:



Field Date: 11/8/2017 Report Date: 9/19/2018 Barrier #: 25B
 Facility: Social Services - 600 W Clark St, Eureka
 Location: Room 120
 Official Responsible: Karen Clower, Interim ADA Coordinator
 Consent Decree: No Paragraph: M.51 Dwg: 1 of 1
 Barrier Area: Doors or Gates Remediation: Required
 Barrier Type: Maneuvering Cl - Stored Items
 Barrier Description: Door/Gate lacks required maneuvering clearance
 Code References: CBC Figure 11B-404.2.4.1 and 2010 ADAS 404.2.4.1
 As Built Description: Chairs block maneuvering clearance at pull side of door
 Proposed Solution: Remove stored items to provide access
 As-Built Meas: 1 Quantity: EACH Cost Estimate: \$125.00 BSR: 1 Necessary
 X Coordinate: N/A Y Coordinate: N/A Z Coordinate: N/A
 Implementation: Priority 2 Phase Date Status Open
 Notes:



Field Date: 11/8/2017 Report Date: 9/19/2018 Barrier #: 25C
 Facility: Social Services - 600 W Clark St, Eureka
 Location: Room 120
 Official Responsible: Karen Clower, Interim ADA Coordinator
 Consent Decree: No Paragraph: M.51 Dwg: 1 of 1
 Barrier Area: Accessible Route - Interior Remediation: Required
 Barrier Type: Clear Width - 36" Wide (Stored Items)
 Barrier Description: Accessible route clear width is not min. 36" wide
 Code References: CBC 11B-403.5.1 and 2010 ADAS 403.5.1
 As Built Description: Furniture or stored items block circulation route and prevent passage through space
 Proposed Solution: Rearrange furniture to provide min. 36" wide passage space through room
 As-Built Meas: 1 Quantity: JOB Cost Estimate: \$0.00 BSR: 2 Recommended
 X Coordinate: N/A Y Coordinate: N/A Z Coordinate: N/A
 Implementation: Priority 2 Phase Date Status Open



Field Date: 11/8/2017 Report Date: 9/19/2018 Barrier #: 25D
 Facility: Social Services - 600 W Clark St, Eureka
 Location: Room 120
 Official Responsible: Karen Clower, Interim ADA Coordinator
 Consent Decree: No Paragraph: M.51 Dwg: 1 of 1
 Barrier Area: Clear Floor Space Remediation: Required
 Barrier Type: Clear Floor Space - Wheelchair Use (Stored Items)
 Barrier Description: Clear floor space of min. 30" by 48" not provided at element required to be accessible
 Code References: CBC 11B-305 and 2010 ADAS 305
 As Built Description: Stored items block whiteboard clear floor space
 Proposed Solution: Move stored items at element required to be accessible
 As-Built Meas: 1 Quantity: JOB Cost Estimate: \$0.00 BSR: 1 Necessary
 X Coordinate: N/A Y Coordinate: N/A Z Coordinate: N/A
 Implementation: Priority 2 Phase Date Status Open



Field Date: 11/8/2017 Report Date: 9/19/2018 Barrier #: 25E
 Facility: Social Services - 600 W Clark St, Eureka
 Location: Room 120
 Official Responsible: Karen Clower, Interim ADA Coordinator
 Consent Decree: No Paragraph: M.51 Dwg: 1 of 1
 Barrier Area: Controls and Mechanisms Remediation: Required
 Barrier Type: Electrical Outlets - Side Reach Low Unobstructed
 Barrier Description: Electrical outlet control box not min. 15" high measured to the bottom of the outlet box
 Code References: CBC 11B-308.1.2, 11B-308.3.1 and 2010 ADAS 308.3
 As Built Description: 11-3/4" high
 Proposed Solution: Relocate outlet to area with min. 15" low reach or max. 48" high reach
 As-Built Meas: 1 Quantity: EACH Cost Estimate: \$750.00 BSR: 3 Hindrance
 X Coordinate: N/A Y Coordinate: N/A Z Coordinate: N/A
 Implementation: Priority 2 Phase Date Status Open



Notes:

Field Date: 11/8/2017 Report Date: 9/19/2018 Barrier #: 25F
 Facility: Social Services - 600 W Clark St, Eureka
 Location: Room 120
 Official Responsible: Karen Clower, Interim ADA Coordinator
 Consent Decree: No Paragraph: M.51 Dwg: 1 of 1
 Barrier Area: Controls and Mechanisms Remediation: Required
 Barrier Type: Clothing Hook or Rod - Height
 Barrier Description: Clothing hooks not max. 48" high AFF
 Code References: CBC 11B-308.2.1 and 2010 ADAS 308.2.1
 As Built Description: 79-1/4" high
 Proposed Solution: Provide additional hook in accessible location
 As-Built Meas: 1 Quantity: EACH Cost Estimate: \$125.00 BSR: 2 Recommended
 X Coordinate: N/A Y Coordinate: N/A Z Coordinate: N/A
 Implementation: Priority 2 Phase Date Status Open



Notes:

Field Date: 11/8/2017 Report Date: 9/19/2018 Barrier #: 25G
 Facility: Social Services - 600 W Clark St, Eureka
 Location: Room 120
 Official Responsible: Karen Clower, Interim ADA Coordinator
 Consent Decree: No Paragraph: M.51 Dwg: 1 of 1
 Barrier Area: Accessible Route - Interior Remediation: Required
 Barrier Type: Protruding Object - Wall Mounted Object
 Barrier Description: Wall mounted object protrudes more than 4" into accessible route between 27" and 80" high
 Code References: CBC 11B-307.2 and 2010 ADAS 307.2
 As Built Description: Coat hook protrudes 12" at 78" high
 Proposed Solution: Remove object or provide detectable warning (wing walls)
 As-Built Meas: 1 Quantity: EACH Cost Estimate: \$550.00 BSR: 1 Necessary
 X Coordinate: N/A Y Coordinate: N/A Z Coordinate: N/A
 Implementation: Priority 2 Phase Date Status Open



Notes:

Field Date: 11/8/2017 Report Date: 9/19/2018 Barrier #: 25H
 Facility: Social Services - 600 W Clark St, Eureka
 Location: Room 120
 Official Responsible: Karen Clower, Interim ADA Coordinator
 Consent Decree: No Paragraph: M.51 Dwg: 1 of 1
 Barrier Area: Signage Remediation: Required
 Barrier Type: Room ID Sign - No Sign
 Barrier Description: No room ID sign provided at permanent room or space
 Code References: CBC 11B-216.2 and 2010 ADAS 216.2
 As Built Description: No room sign provided at door within circulation path
 Proposed Solution: Provide room ID sign with tactile information at wall at latch side of door
 As-Built Meas: 1 Quantity: EACH Cost Estimate: \$250.00 BSR: 1 Necessary
 X Coordinate: N/A Y Coordinate: N/A Z Coordinate: N/A
 Implementation: Priority 4 Phase Date Status Open



Notes:

Field Date: 11/8/2017 Report Date: 9/19/2018 Barrier #: 25I
 Facility: Social Services - 600 W Clark St, Eureka
 Location: Room 120
 Official Responsible: Karen Clower, Interim ADA Coordinator
 Consent Decree: No Paragraph: M.51 Dwg: 1 of 1
 Barrier Area: Counters and Tables Remediation: Required
 Barrier Type: Table - Knee Clearance
 Barrier Description: Knee clearance of at least 27" high, 30" wide and 19" deep not provided
 Code References: CBC 11B-306.3 and 2010 ADAS 306.3
 As Built Description: 26-1/2" high and 15" deep knee clearance
 Proposed Solution: Provide min. 1 accessible table and 5% overall. Avoid pedestal base tables.
 As-Built Meas: 1 Quantity: EACH Cost Estimate: \$450.00 BSR: 3 Hindrance
 X Coordinate: N/A Y Coordinate: N/A Z Coordinate: N/A
 Implementation: Priority 2 Phase Date Status Open
 Notes:



Field Date: 11/8/2017 Report Date: 9/19/2018 Barrier #: 25J
 Facility: Social Services - 600 W Clark St, Eureka
 Location: Room 120
 Official Responsible: Karen Clower, Interim ADA Coordinator
 Consent Decree: No Paragraph: M.51 Dwg: 1 of 1
 Barrier Area: Counters and Tables Remediation: Required
 Barrier Type: Table - Clear Floor Space
 Barrier Description: Clear floor space 30" x 48" not provided at table
 Code References: CBC 11B-305.3 and 2010 ADAS 305.3
 As Built Description: 40-1/2" deep from table to wall
 Proposed Solution: Move stored objects
 As-Built Meas: 1 Quantity: EACH Cost Estimate: \$0.00 BSR: 3 Hindrance
 X Coordinate: N/A Y Coordinate: N/A Z Coordinate: N/A
 Implementation: Priority 2 Phase Date Status Open
 Notes:



Field Date: 11/8/2017 Report Date: 9/19/2018 Barrier #: 25K

Facility: Social Services - 600 W Clark St, Eureka

Location: Room 120

Official Responsible: Karen Clower, Interim ADA Coordinator

Consent Decree: No Paragraph: M.51 Dwg: 1 of 1

Barrier Area: Accessible Route - Interior Remediation: Required

Barrier Type: Protruding Object - Wall Mounted Object

Barrier Description: Wall mounted object protrudes more than 4" into accessible route between 27" and 80" high

Code References: CBC 11B-307.2 and 2010 ADAS 307.2

As Built Description: Monitors protrude 9" at 50" high

Proposed Solution: Remove object or provide detectable warning (wing walls)

As-Built Meas: 2 Quantity: EACH Cost Estimate: \$1,100.00 BSR: 1 Necessary

X Coordinate: N/A Y Coordinate: N/A Z Coordinate: N/A

Implementation: Priority 2 Phase Date Status Open

Notes:



Field Date: 11/8/2017 Report Date: 9/19/2018 Barrier #: 25L

Facility: Social Services - 600 W Clark St, Eureka

Location: Room 120

Official Responsible: Karen Clower, Interim ADA Coordinator

Consent Decree: No Paragraph: M.51 Dwg: 1 of 1

Barrier Area: Alarms Remediation: Required

Barrier Type: Horn/Strobe - Common Use Area

Barrier Description: No horn/strobes in common use areas

Code References: CBC 11B-702.1 and 2010 ADAS 702.1

As Built Description: Device not provided

Proposed Solution: Provide strobes in common use area

As-Built Meas: 1 Quantity: EACH Cost Estimate: \$5,500.00 BSR: 1 Necessary

X Coordinate: N/A Y Coordinate: N/A Z Coordinate: N/A

Implementation: Priority 2 Phase Date Status Open

Notes:



COST ESTIMATES

Cost Estimate Total	\$199,260.00		
Cost Estimate - Priority 1:	\$128,860.00	% of Total Cost Estimate:	64.67%
Cost Estimate - Priority 2:	\$60,300.00	% of Total Cost Estimate:	30.26%
Cost Estimate - Priority 3:	\$2,600.00	% of Total Cost Estimate:	1.30%
Cost Estimate - Priority 4:	\$7,500.00	% of Total Cost Estimate:	3.76%

APPENDIX – REFERENCE DRAWINGS

SZS
ENGINEERING

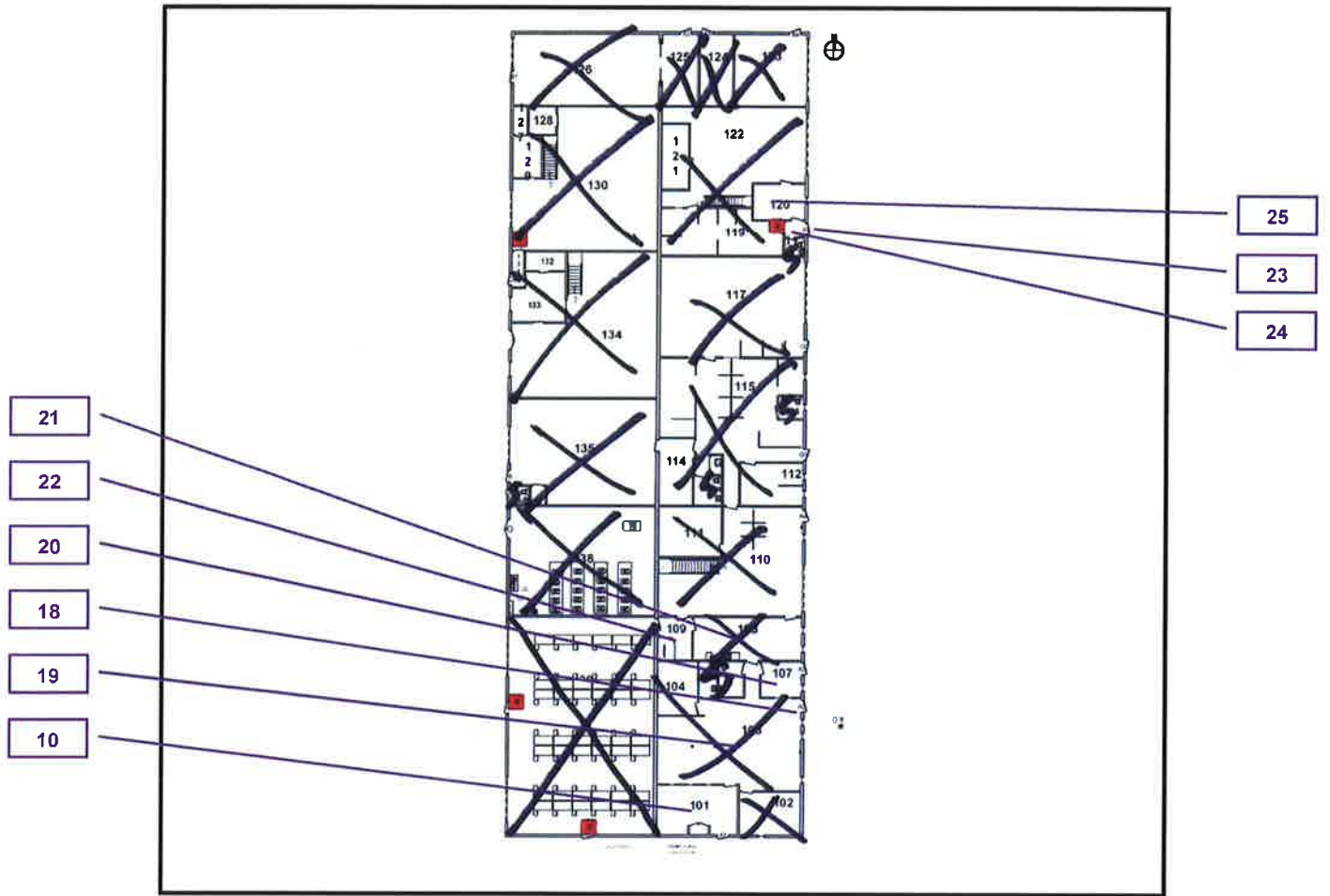

AREA MAP

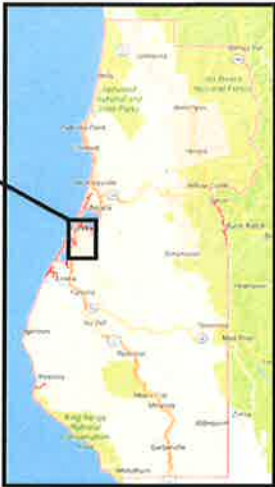

 = LEASED PREMISES



Exhibit B – Floor Plan

Humboldt County
 Department of Health &
 Human Services
 600 W. Clark Street
 Eureka, CA 95501
 Building S000600

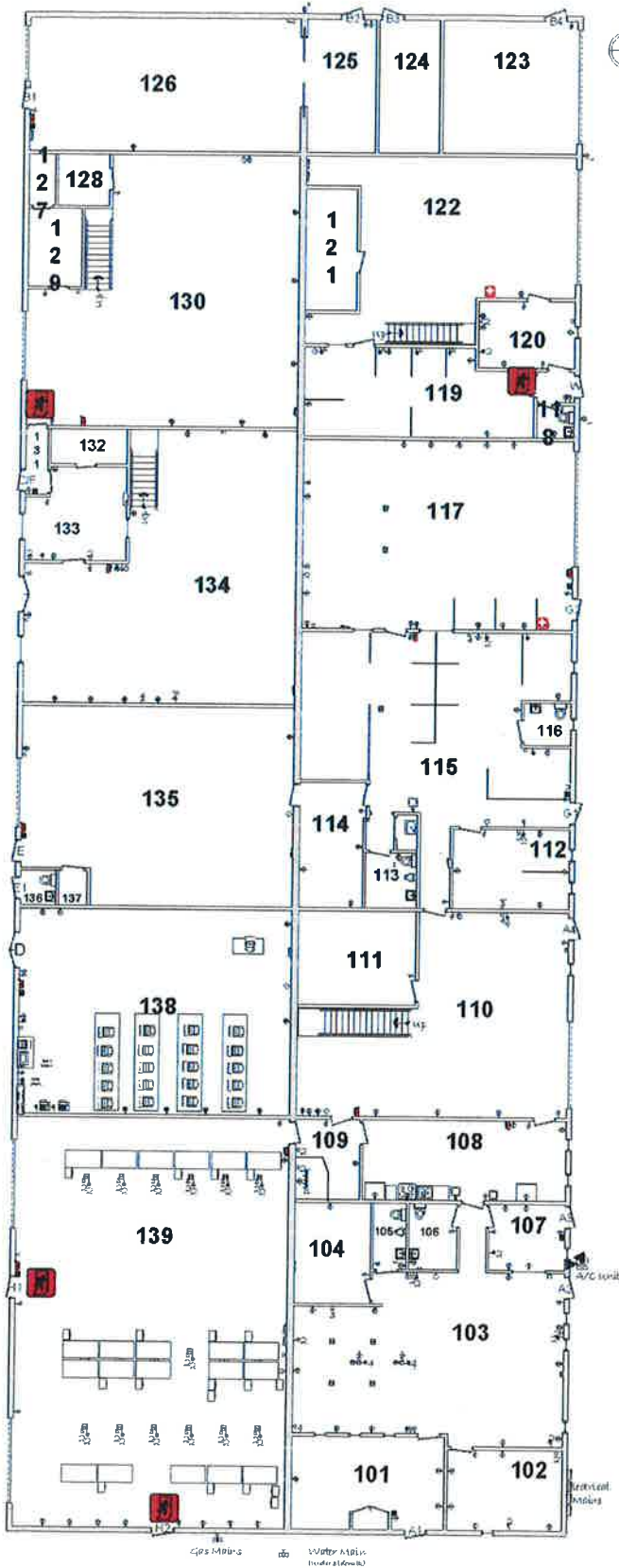

Key

Note: The placement of the below symbols are approximated

☐ TELEPHONE NODE

— NETWORK NODE

⊕ QUAD OUTLET 110V/120V

⊖ OUTLET 110V/120V

⊕ SWITCH

⊕ WATER METER

Total: 16,679 sq. ft.

0 ft. 6 ft. 10 ft. 20 ft.

Architectural Scale

0.05 in. = 1 foot*

Page = 170 ft. x 280 ft.

*Note: Room dimensions of this draft are approximated within a 6" tolerance.

PARKING

PARKING

CLARK STREET