



DC EDEN, INC IS APPLYING FOR A CANNABIS DISTRIBUTION LICENSE IN ACCORDANCE WITH THE DEPARTMENT OF CANNABIS CONTROL (DCC). THE OPERATION IS LOCATED AT 3525 REDWOOD DR, REDWAY CA. THE DISTRIBUTION PREMISES IS LOCATED ON THE FIRST FLOOR AND SECOND FLOOR IS APPROXIMATELY 2,240 SQUARE FEET. THE PROPERTY ALSO INCLUDES A PREMISES FOR ONE (1) PROPOSED CANNABIS RETAIL LICENSE ON THE FIRST FLOOR AND ONE (1) PREMISES FOR AN EXISTING RESIDENCE ON THE SECOND FLOOR.

APPLICANT:
DC EDEN, INC
RACHEL AND CLARK WORSWICK
7260 BENBOW DRIVE
GARBERVILLE, CA 95542

PROPERTY OWNER:
WEST RIVER LANE, LLC
P.O.BOX 1020
GARBERVILLE, CA 95542

SITE ADDRESS:
APN: 077-331-032-000
3525 REDWOOD DR, SUITE B
REDWAY, CA 95560

PROPERTY SIZE = ±0.31 ACRES

GENERAL PLAN DESIGNATION =COMMERCIAL SERVICES

1. DRAWING SCALE AS NOTED. WRITTEN DIMENSIONS SHALL TAKE PRECEDENCE OVER SCALED DIMENSIONS.
2. THIS IS NOT A BOUNDARY SURVEY. BOUNDARY INFORMATION DEPICTED HAS BEEN OBTAINED FROM HUMBOLDT COUNTY 2015 GIS DATA. NORTHPOINT CONSULTING GROUP, INC. HAS NOT VERIFIED THIS PROPERTY BOUNDARY.
3. ALL AREAS OUTSIDE OF THE CANNABIS ACTIVITIES ARE USED IN ACCORDANCE TO THE HUMBOLDT COUNTY LAND USE DESIGNATION.

22x34 SHEET: 1"=10'
11x17 SHEET: 1"=20'

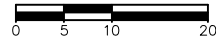

C0 - PREMISES DIAGRAM, VICINITY MAP,
& PROJECT NOTES
C1 - DETAILED FLOOR PLANS

APN: 077-331-032-000

SEE SHEET C1 FOR FLOOR PLAN
AND DETAIL OF PREMISES

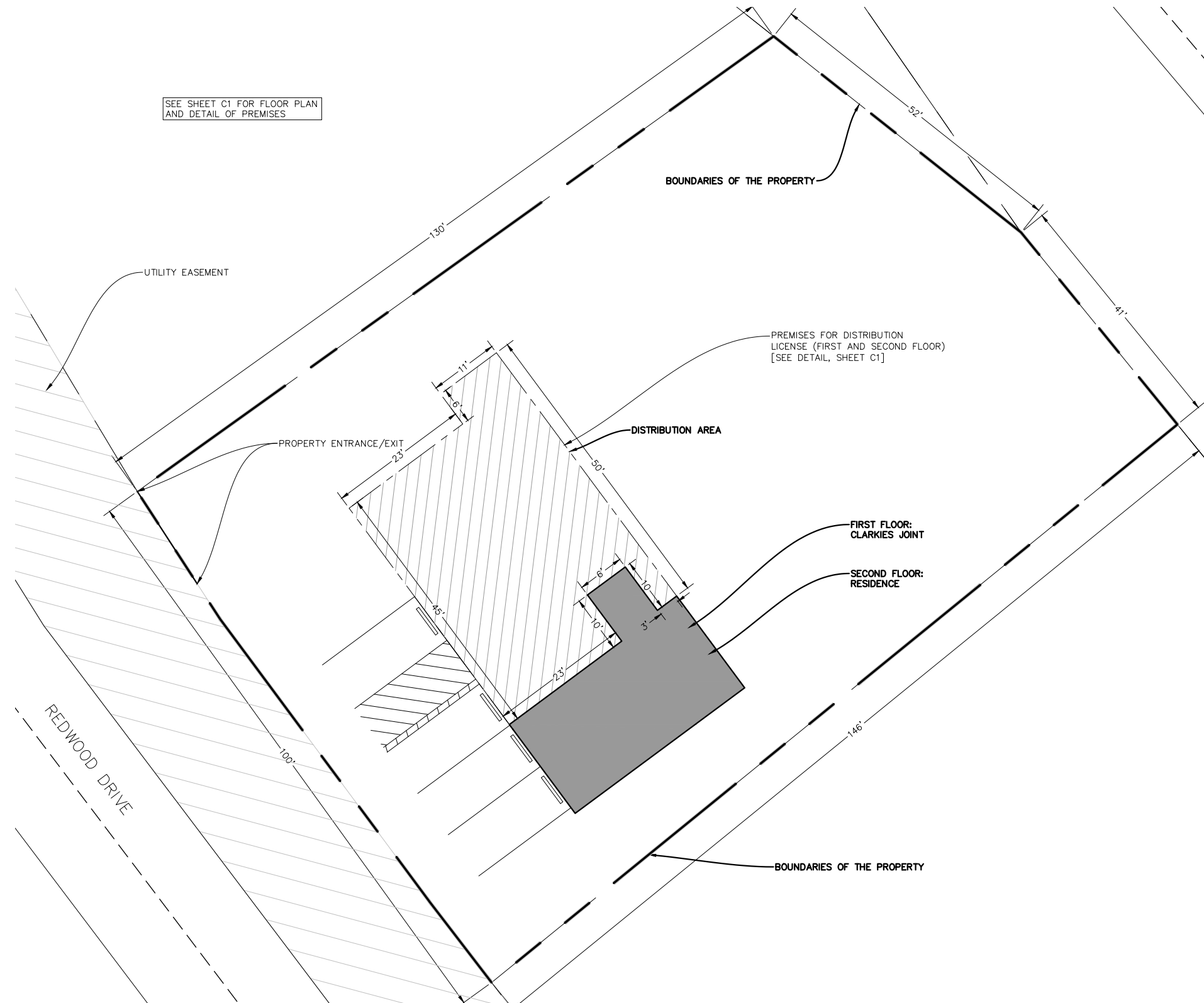
[illegible]

NORTHPOINT
CONSULTING GROUP, INC.
1117 Samoa Blvd., Arcata, CA 95521

DC EDEN, INC
REDWAY, CA
PROPERTY DIAGRAM

PROJ. MGR.: PBS
DRAWN BY: PRH
DATE: 06/07/2024
SCALE: AS SHOWN

SHEET
C0
18-119

APN: 077-331-032-000

PREMISES FOR DC EDEN, INC-
DISTRIBUTION LICENSE
(FIRST FLOOR)
(LIMITED ACCESS AREA)

FIRST FLOOR:-
THE COUNTRY CLUB, LLC
BCC RETAIL LICENSE NO.
C10-0000182-LIC

THERE ARE NO PROPOSED
COMMON OR SHARED AREAS
BETWEEN PREMISES AND LICENSES

ENTRANCE/EXIT FOR RESIDENCE.



22x34 SHEET: 1"=5'
11x17 SHEET: 1"=10'



A horizontal graphic scale bar with a black and white alternating pattern. It is marked with '0' at the left end, '5' at the midpoint, and '10' at the right end.

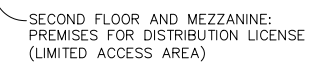

SECOND FLOOR SECURITY PLAN

22x34 SHEET: 1"=5'
11x17 SHEET: 1"=10'



A horizontal graphic scale bar with a black outline. It is divided into two main sections: the left section is white with a black border, and the right section is solid black. The total length of the bar is marked with the number '10' at the right end. A tick mark in the middle of the bar is labeled with the number '5'.

[illegible]

NORTHPOINT
CONSULTING GROUP, INC.
1117 Samoa Blvd., Arcata, CA 95521

GRASS ROOTS DISTRIBUTION, LLC
REDWAY, CA
DETAILED FLOOR PLAN

PROJ. MGR.: PBS
DRAWN BY: PRH
DATE: 06/07/2024
SCALE: AS SHOWN

SHEET
C1

18-119

###