

SHEET		1		OF		19	
COUNTY OF HUMBOLDT DEPARTMENT OF PUBLIC WORKS				DESIGN SECTION			
RED CAP ROAD SHOULDER WIDENING - PHASE 2				ROBERT L. BARNETT			
COVER SHEET				DESIGNED BY JAC/CP			
SHEET INDEX AND DETAILS				DRAWN BY JAC/CP			
CHECKED BY: RLD				APPROVED BY: CP			
DATE: 4/28/2015				FILE NO. 156			
PROJECT NAME: RED CAP ROAD				FILE NO. 156			
CONTRACT NO. DTFH69-15-H-00051				CONTRACT NO. DTFH69-15-H-00051			
DRAWING FILE NAME: C:\PROJECTS\HUMBOLDT\Red Cap Rd\7\Plan\00051.dwg				DRAWING FILE NAME: C:\PROJECTS\HUMBOLDT\Red Cap Rd\7\Plan\00051.dwg			
PLOT DATE: 4/28/2015				PLOT DATE: 4/28/2015			

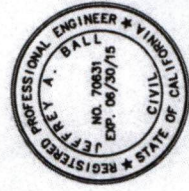

COUNTY OF HUMBOLDT
DEPARTMENT OF PUBLIC WORKS
AND THE KARUK TRIBE
PROJECT PLANS FOR CONSTRUCTION OF
RED CAP ROAD [8Q100] SHOULDER WIDENING
PHASE 2 - P.M. 0.30 TO 1.56
AGREEMENT NO. DTFH69-15-H-00051
CONTRACT NO. 321606A



RECOMMENDED

Jeffrey A. Ball 4/28/2015
DATE



APPROVED

Christopher J. Whitworth 4/28/2015
DATE

- INDEX OF SHEETS**
- 1 COVER SHEET
 - 2 CONSTRUCTION AREA SIGNS, QUANTITIES, AND DETAILS
 - 3-6 QUANTITIES, TYPICAL SECTIONS, AND DETAILS
 - 7-11 PLAN AND PROFILE
 - 12-13 WIRE WALL PLAN, PROFILE, AND SECTION
 - 14-19 CROSS SECTIONS

NOTES

THE CONTRACTOR SHALL HAVE A CLASS "A" LICENSE FOR THIS PROJECT

REFERENCE TO CALTRANS STANDARD PLANS DATED 2010

DESIGN DESIGNATION

TRAFFIC VOLUME ADT (PRESENT - '06) - 268

DESIGN SPEED 70-35 MPH & 45 MPH (POSTED SPEED LIMITS)

ORIGINAL LOW BID PRICE	CONSTRUCTED BY	RESIDENT ENGINEER	CONSTRUCTION COST

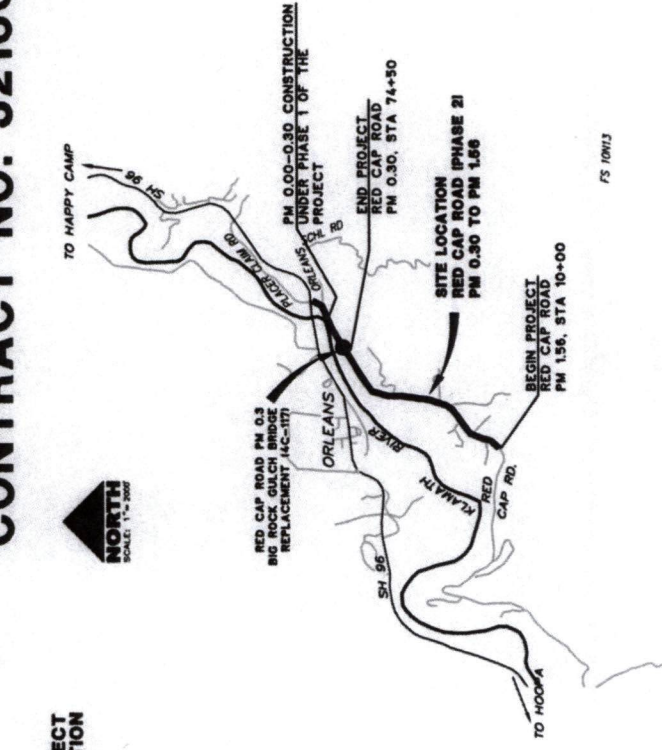

SITE MAP
SCALE 1" = 2000'

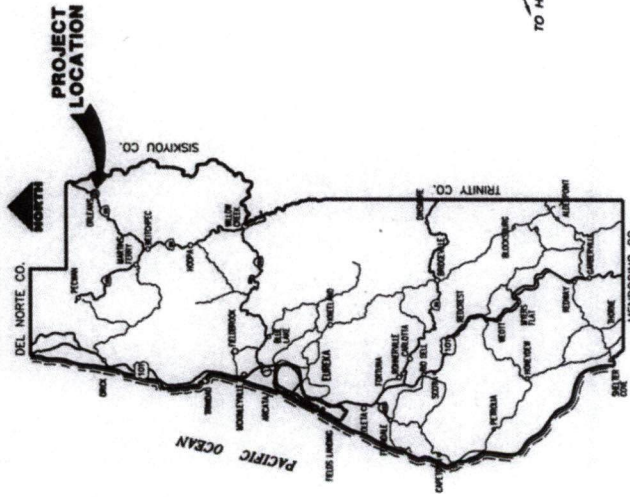

LOCATION MAP
NOT TO SCALE

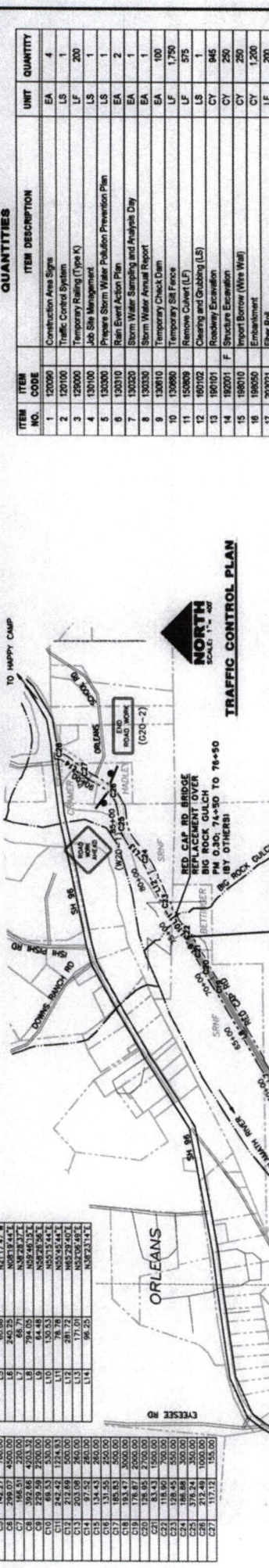

CURVE TABLE		LINE TABLE	
CURVE	LENGTH (FEET)	LINE	BEARING
C1	200.00	1	N 89° 51' 13" E
C2	200.00	2	N 89° 51' 13" E
C3	200.00	3	N 89° 51' 13" E
C4	200.00	4	N 89° 51' 13" E
C5	200.00	5	N 89° 51' 13" E
C6	200.00	6	N 89° 51' 13" E
C7	200.00	7	N 89° 51' 13" E
C8	200.00	8	N 89° 51' 13" E
C9	200.00	9	N 89° 51' 13" E
C10	200.00	10	N 89° 51' 13" E
C11	200.00	11	N 89° 51' 13" E
C12	200.00	12	N 89° 51' 13" E
C13	200.00	13	N 89° 51' 13" E
C14	200.00	14	N 89° 51' 13" E
C15	200.00	15	N 89° 51' 13" E
C16	200.00	16	N 89° 51' 13" E
C17	200.00	17	N 89° 51' 13" E
C18	200.00	18	N 89° 51' 13" E
C19	200.00	19	N 89° 51' 13" E
C20	200.00	20	N 89° 51' 13" E
C21	200.00	21	N 89° 51' 13" E
C22	200.00	22	N 89° 51' 13" E
C23	200.00	23	N 89° 51' 13" E
C24	200.00	24	N 89° 51' 13" E
C25	200.00	25	N 89° 51' 13" E
C26	200.00	26	N 89° 51' 13" E
C27	200.00	27	N 89° 51' 13" E
C28	200.00	28	N 89° 51' 13" E
C29	200.00	29	N 89° 51' 13" E
C30	200.00	30	N 89° 51' 13" E
C31	200.00	31	N 89° 51' 13" E
C32	200.00	32	N 89° 51' 13" E
C33	200.00	33	N 89° 51' 13" E
C34	200.00	34	N 89° 51' 13" E
C35	200.00	35	N 89° 51' 13" E
C36	200.00	36	N 89° 51' 13" E
C37	200.00	37	N 89° 51' 13" E
C38	200.00	38	N 89° 51' 13" E
C39	200.00	39	N 89° 51' 13" E
C40	200.00	40	N 89° 51' 13" E
C41	200.00	41	N 89° 51' 13" E
C42	200.00	42	N 89° 51' 13" E
C43	200.00	43	N 89° 51' 13" E
C44	200.00	44	N 89° 51' 13" E
C45	200.00	45	N 89° 51' 13" E
C46	200.00	46	N 89° 51' 13" E
C47	200.00	47	N 89° 51' 13" E
C48	200.00	48	N 89° 51' 13" E
C49	200.00	49	N 89° 51' 13" E
C50	200.00	50	N 89° 51' 13" E
C51	200.00	51	N 89° 51' 13" E
C52	200.00	52	N 89° 51' 13" E
C53	200.00	53	N 89° 51' 13" E
C54	200.00	54	N 89° 51' 13" E
C55	200.00	55	N 89° 51' 13" E
C56	200.00	56	N 89° 51' 13" E
C57	200.00	57	N 89° 51' 13" E
C58	200.00	58	N 89° 51' 13" E
C59	200.00	59	N 89° 51' 13" E
C60	200.00	60	N 89° 51' 13" E
C61	200.00	61	N 89° 51' 13" E
C62	200.00	62	N 89° 51' 13" E
C63	200.00	63	N 89° 51' 13" E
C64	200.00	64	N 89° 51' 13" E
C65	200.00	65	N 89° 51' 13" E
C66	200.00	66	N 89° 51' 13" E
C67	200.00	67	N 89° 51' 13" E
C68	200.00	68	N 89° 51' 13" E
C69	200.00	69	N 89° 51' 13" E
C70	200.00	70	N 89° 51' 13" E
C71	200.00	71	N 89° 51' 13" E
C72	200.00	72	N 89° 51' 13" E
C73	200.00	73	N 89° 51' 13" E
C74	200.00	74	N 89° 51' 13" E
C75	200.00	75	N 89° 51' 13" E
C76	200.00	76	N 89° 51' 13" E
C77	200.00	77	N 89° 51' 13" E
C78	200.00	78	N 89° 51' 13" E
C79	200.00	79	N 89° 51' 13" E
C80	200.00	80	N 89° 51' 13" E
C81	200.00	81	N 89° 51' 13" E
C82	200.00	82	N 89° 51' 13" E
C83	200.00	83	N 89° 51' 13" E
C84	200.00	84	N 89° 51' 13" E
C85	200.00	85	N 89° 51' 13" E
C86	200.00	86	N 89° 51' 13" E
C87	200.00	87	N 89° 51' 13" E
C88	200.00	88	N 89° 51' 13" E
C89	200.00	89	N 89° 51' 13" E
C90	200.00	90	N 89° 51' 13" E
C91	200.00	91	N 89° 51' 13" E
C92	200.00	92	N 89° 51' 13" E
C93	200.00	93	N 89° 51' 13" E
C94	200.00	94	N 89° 51' 13" E
C95	200.00	95	N 89° 51' 13" E
C96	200.00	96	N 89° 51' 13" E
C97	200.00	97	N 89° 51' 13" E
C98	200.00	98	N 89° 51' 13" E
C99	200.00	99	N 89° 51' 13" E
C100	200.00	100	N 89° 51' 13" E

TRAFFIC CONTROL PLAN	
TO HOOPA	TO HAPPY CAMP

CONSTRUCTION AREA SIGN SUMMARY	
SIGN TYPE	QTY
W20-1	2
G20-2	2

CONSTRUCTION AREA SIGN SUMMARY				
SIGN TYPE	QTY	DESCRIPTION	SIZE	REMARKS
W20-1	2	ROAD WORK AHEAD	36" x 36"	VISIBLE AT ALL TIMES
G20-2	2	END ROAD WORK	36" x 18"	VISIBLE AT ALL TIMES

24	5105023	F	Minor Concrete (Minor Structures)	CY	8
25	5800111		Roadside Sign - One Post	EA	4
26	665017		18" Corrugated Steel Pipe (0.018" Thick)	LF	402
27	665023		24" Corrugated Steel Pipe (0.018" Thick)	LF	52
28	665036		36" Corrugated Steel Pipe (0.018" Thick)	LF	46
29	665022		8" Perforated Plastic Pipe (Underdrain)	LF	70
30	665023		8" Non-Perforated Plastic Pipe	LF	20
31	662022		Class 1 Permeable Material (Base/bed)	CY	20
32	660117		18" Corrugated Steel Pipe (Underdrain (0.018" Thick)	LF	60

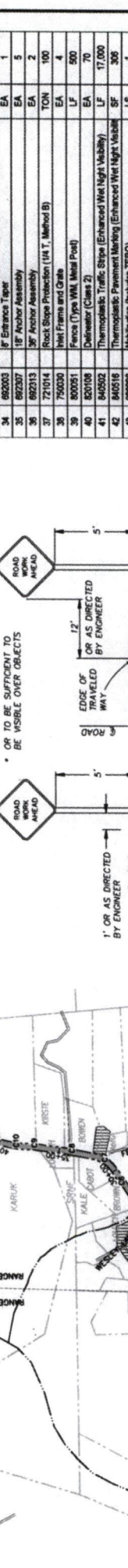

NOTES

- 1) SIGNS SHALL BE PLACED AS SHOWN ON PLAN OR AS DIRECTED BY THE ENGINEER.
- 2) FINAL PLACEMENT OF SIGNS SHALL BE APPROVED BY RESIDENT ENGINEER.
- 3) ADDITIONAL PORTABLE SIGNS SHALL BE USED AS REQUIRED FOR OTHER ROADSIDE WORK.
- 4) SEE STANDARD PLAN T13 FOR TRAFFIC CONTROL SYSTEM.
- 5) IN ADDITION TO CONSTRUCTION AREA SIGNS AND WHEN DIRECTED BY THE RESIDENT ENGINEER, THE CONTRACTOR SHALL UTILIZE FLAGMEN AS NECESSARY TO DIRECT TRAFFIC.
- 6) DISTANCE TO W20-1 AND G20-2 MAY BE EXTENDED TO ENCOMPASS SITES WITHIN ONE MILE OF EACH OTHER.

ENVIRONMENTALLY APPROVED AREAS WHICH MAY BE USED FOR SITE ACTIVITIES SHALL BE IDENTIFIED AND PROTECTED PRIOR TO USAGE.

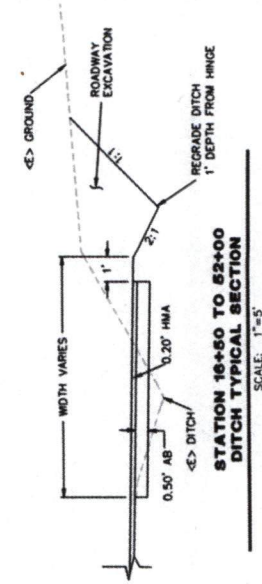
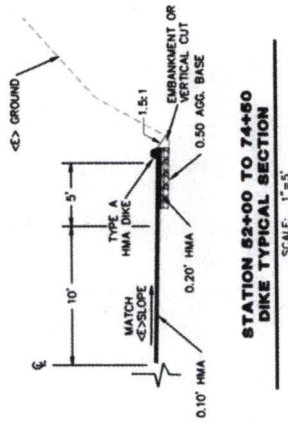
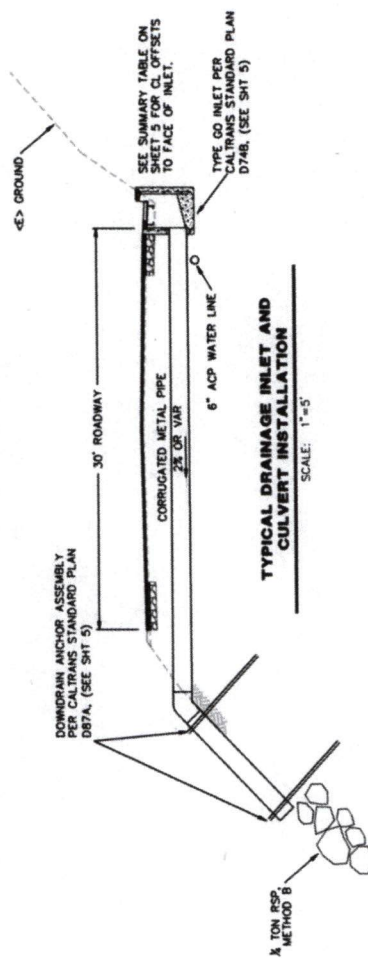
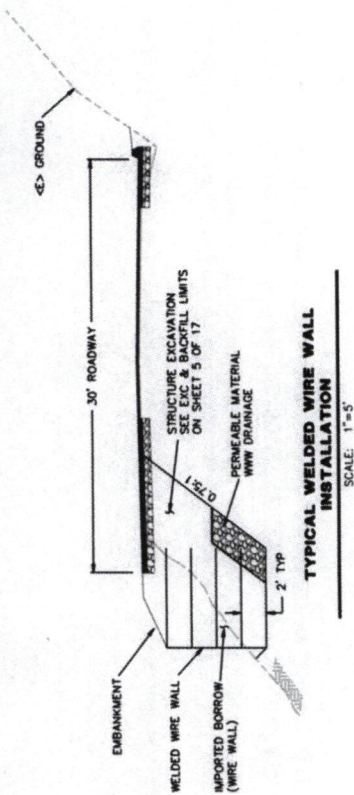
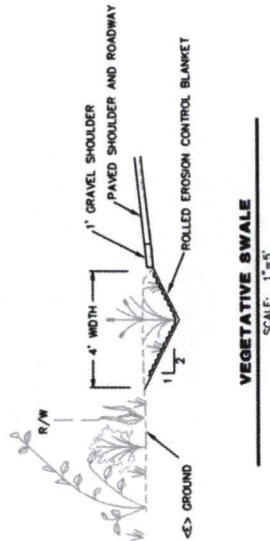
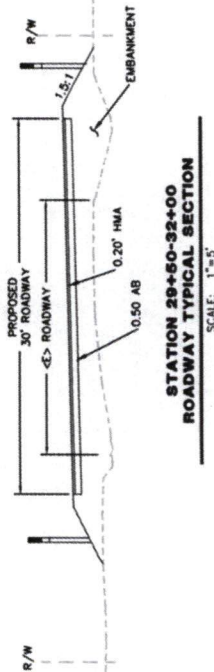
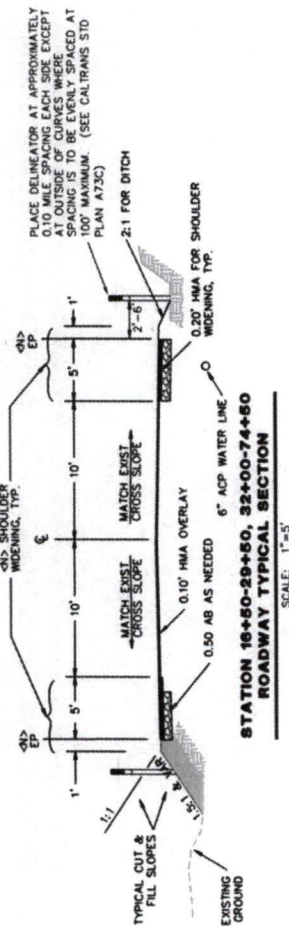
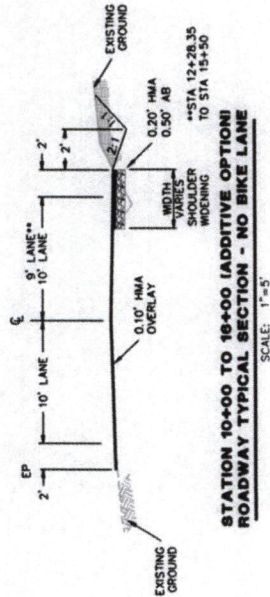

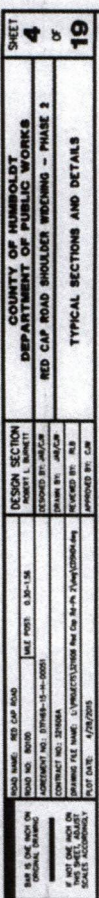

SET 1 OF TWO PROJECT NUMBER: 00000000	ROAD NAME: RED CAP ROAD	DATE PLOT: 03-30-18	DESIGN SECTION ADRIEN L. BARNETT	COUNTY OF MINNEAPOLIS DEPARTMENT OF PUBLIC WORKS RED CAP ROAD SHOULDER WIDENING - PHASE 2 TYPICAL SECTIONS AND DETAILS	SHEET 4 OF 19
	AGREEMENT NO. 137849-13-0000 CONTRACT NO. 23000A	DRAWING FILE NAME: L:\PROJECTS\23000A\RED CAP Rd\4-24\23000A.dwg PLOT DATE: 4/28/2018	DESIGNED BY: JAC/GR CHECKED BY: JLB APPROVED BY: GR		

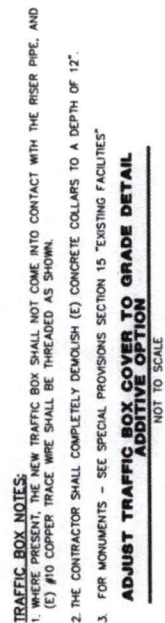
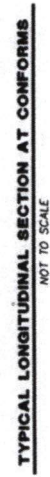
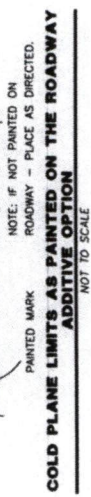

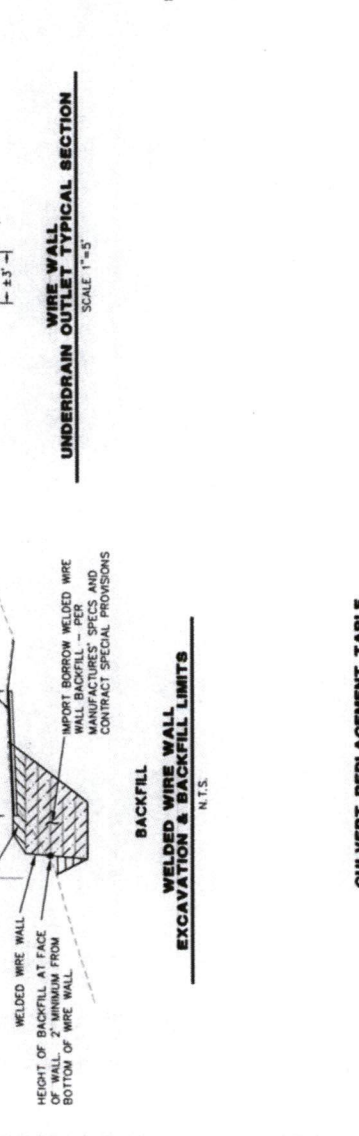

AY SURFACE
AGG. BASE

STRUCTURE
EXCAVATION

2x48\"/>

TYPE BACKFILL

BASE BID TOTAL	18'	402'	60'
TOTAL	24"	--	52'
TOTAL	36"	46'	20'

CULVERT TRENCH DETAIL 1
NOT TO SCALE

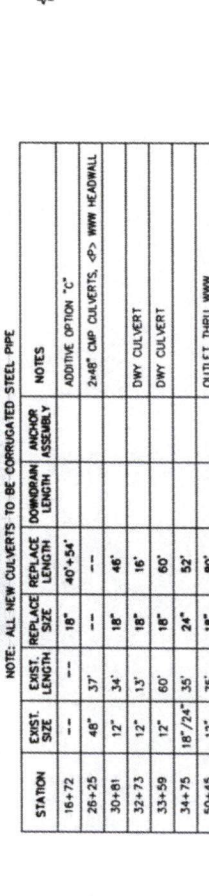

51+44	12"	36"	18"	40"	<P> GO DI OUTLET THRU WWW

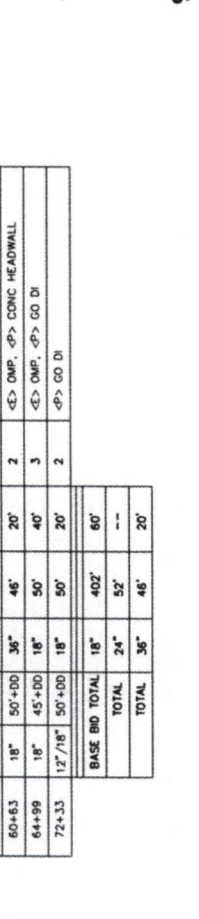

1

1

114

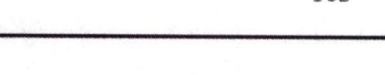

FROM STATION 61+60+ TO STATION 86+30+ OVER LANDS OF USA, RIGHT-OF-WAY IS 66' WIDE. 33' EACH SIDE OF CENTERLINE PER USE PERMIT WITH US FOREST SERVICE, OTHER THAN THE AREA NEAR BIG GULCH BRIDGE, APPROX. STATION 75+75. AREA NEAR BIG GULCH BRIDGE IS IMPLIED COMMON LAW DEDICATION FOR AN IRREGULARLY SHAPED AREA

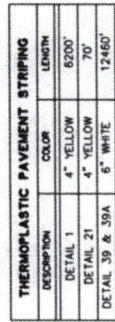
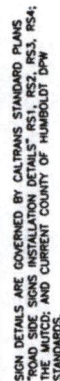

(INCLUDES ADDITIVE OPTION "C")

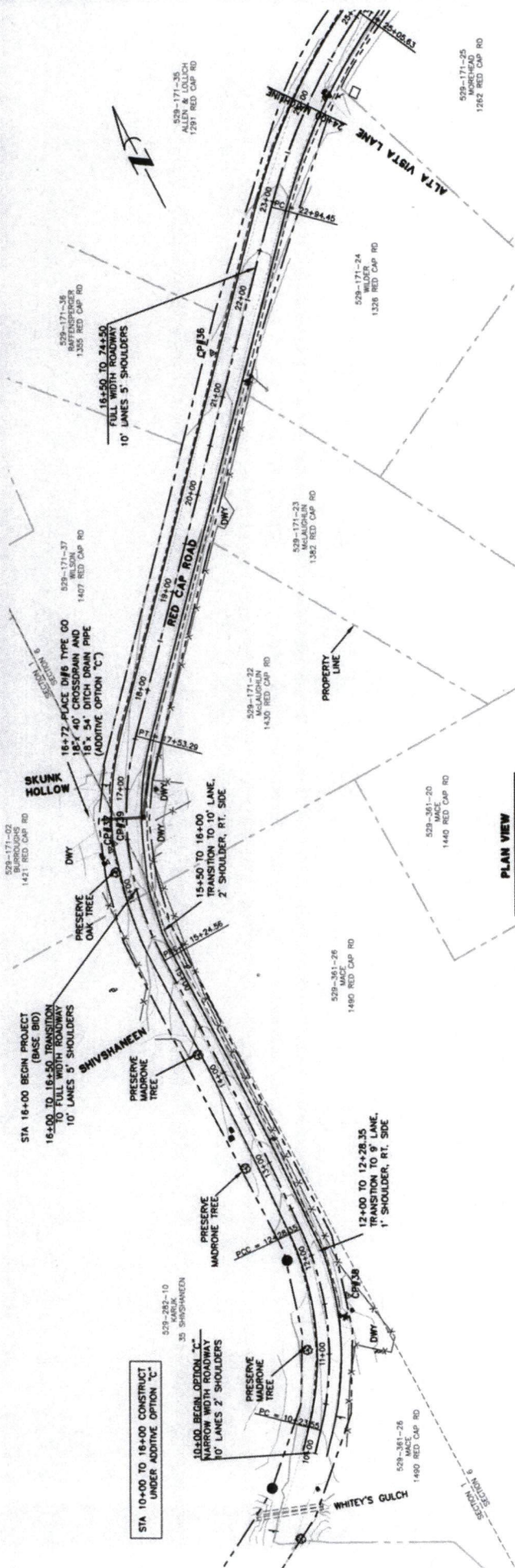

PLAN VIEW
 SCALE: 1"=50'

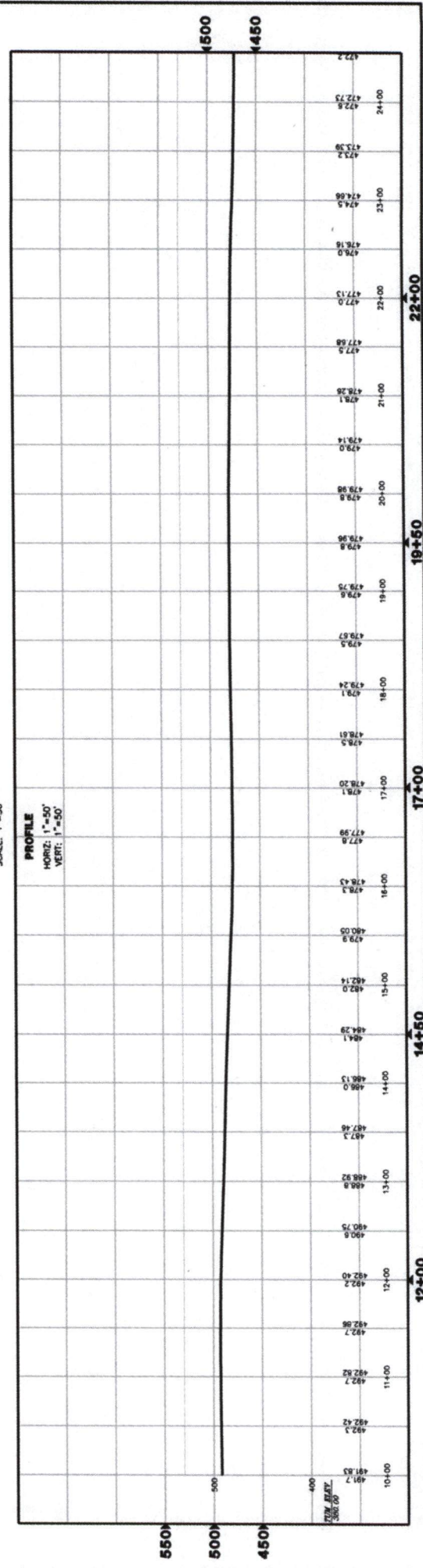



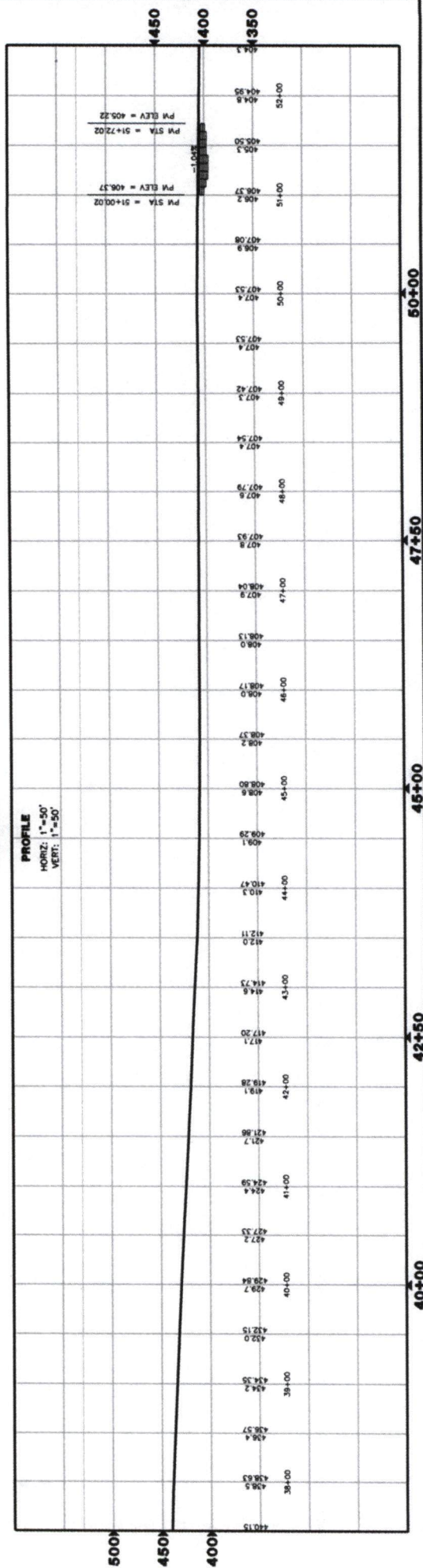

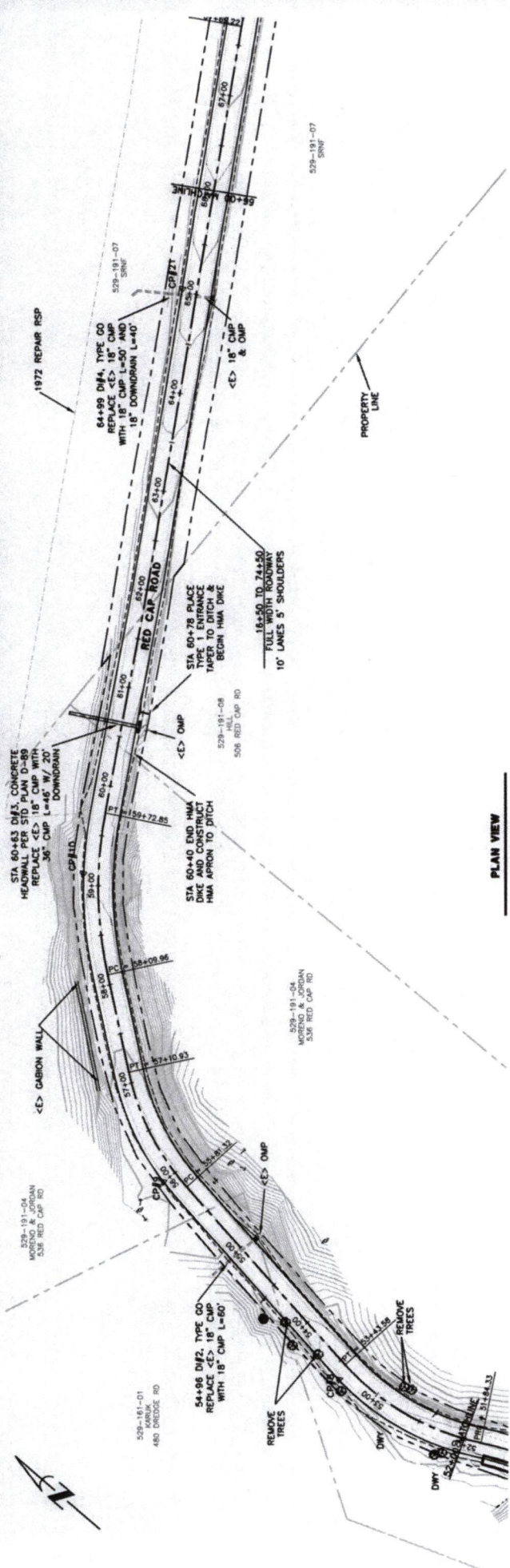

PLAN VIEW

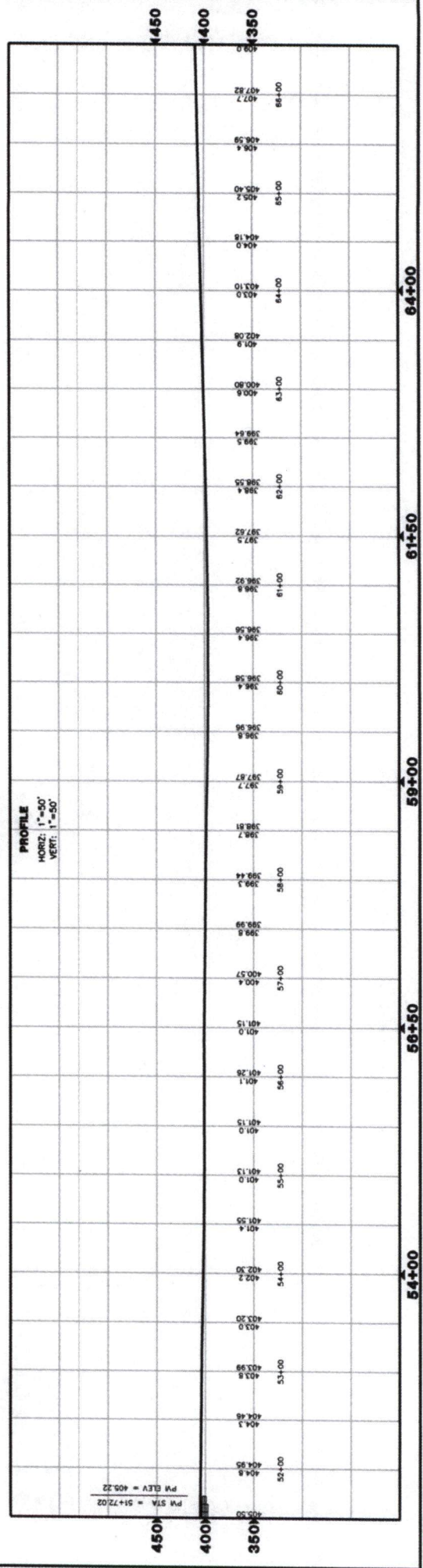

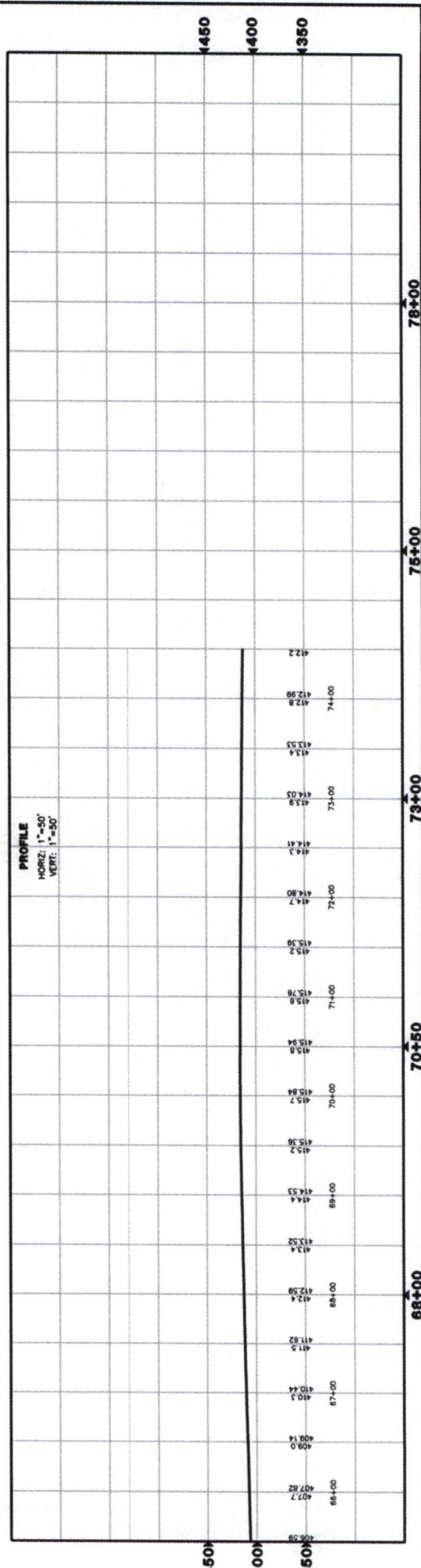
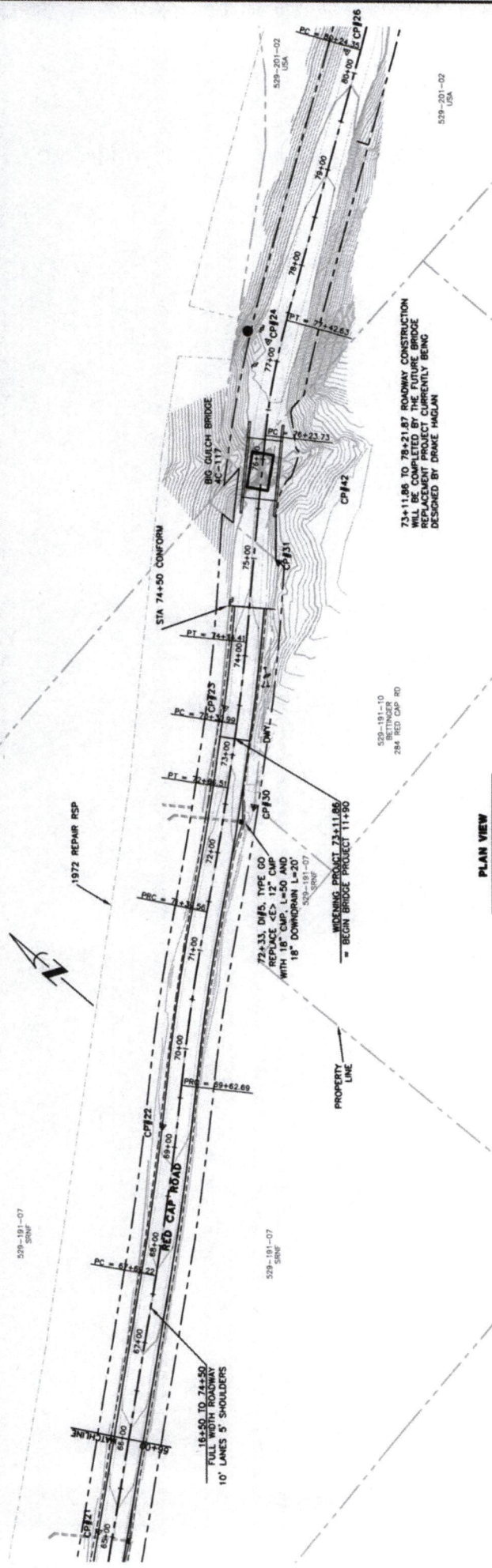



THIS DRAWING IS THE PROPERTY OF THE COUNTY OF HUMBOLDT. IT IS TO BE USED ONLY FOR THE PROJECT AND LOCATION SPECIFICALLY IDENTIFIED HEREON. IT IS NOT TO BE REPRODUCED, COPIED, OR TRANSMITTED IN ANY FORM OR BY ANY MEANS, ELECTRONIC OR MECHANICAL, INCLUDING PHOTOCOPYING, RECORDING, OR BY ANY INFORMATION STORAGE AND RETRIEVAL SYSTEM, WITHOUT THE WRITTEN PERMISSION OF THE COUNTY OF HUMBOLDT.

DESIGN SECTION
 DESIGNED BY: JAC/CM
 CHECKED BY: JAC/CM
 DATE: 4/29/2005
 APPROVED BY: CM

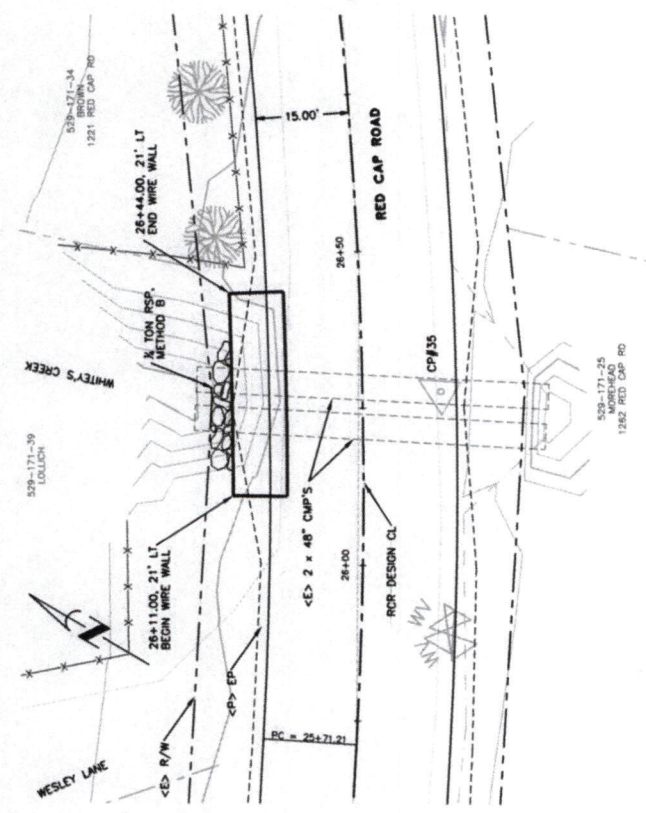

WIRE WALL NO. 1 - PLAN VIEW
 SCALE: 1"=10'

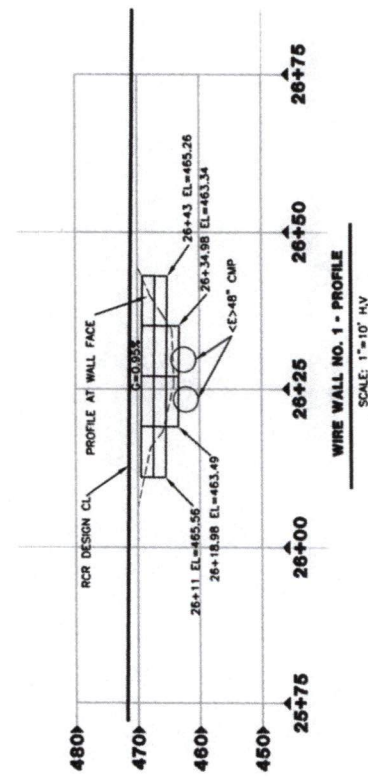

WIRE WALL NO. 1 - PROFILE
 SCALE: 1"=10' H.V.

WIRE WALL NO. 1 SECTION
 SCALE: 1"=5'



THIS DRAWING IS THE PROPERTY OF THE COUNTY OF HUMBOLDT. IT IS TO BE USED ONLY FOR THE PROJECT AND LOCATION SPECIFICALLY IDENTIFIED HEREON. IT IS NOT TO BE REPRODUCED, COPIED, OR TRANSMITTED IN ANY FORM OR BY ANY MEANS, ELECTRONIC OR MECHANICAL, WITHOUT THE WRITTEN PERMISSION OF THE COUNTY OF HUMBOLDT.

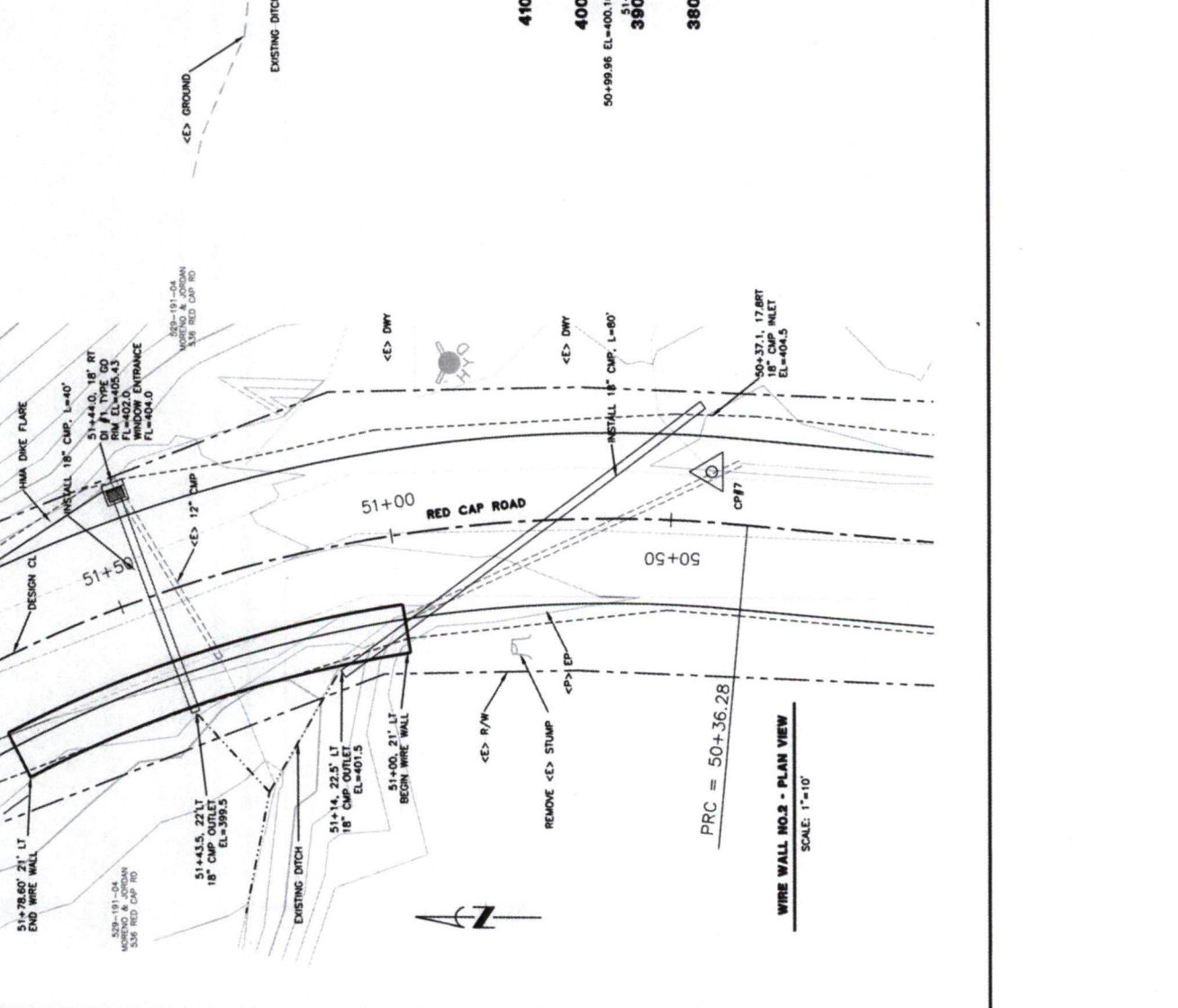
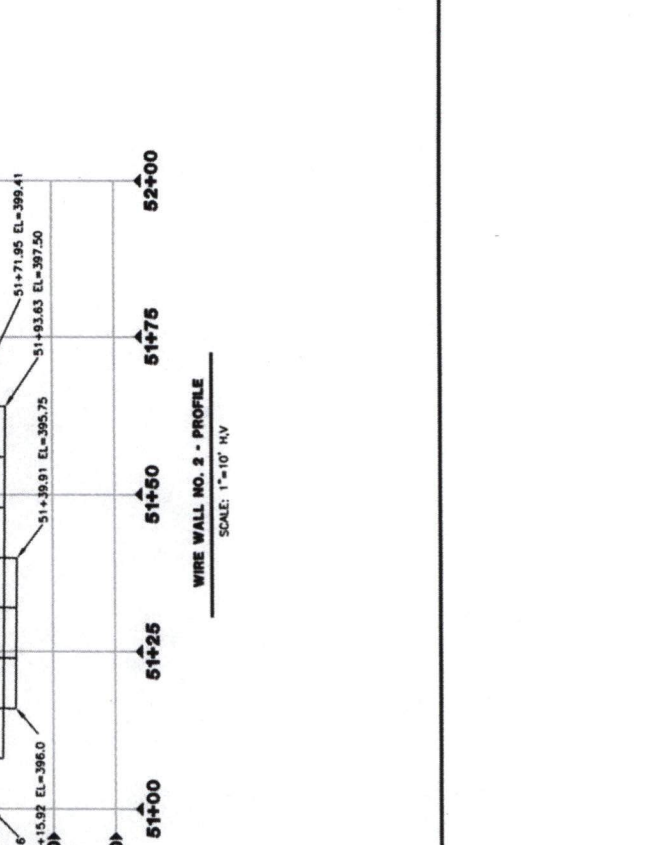
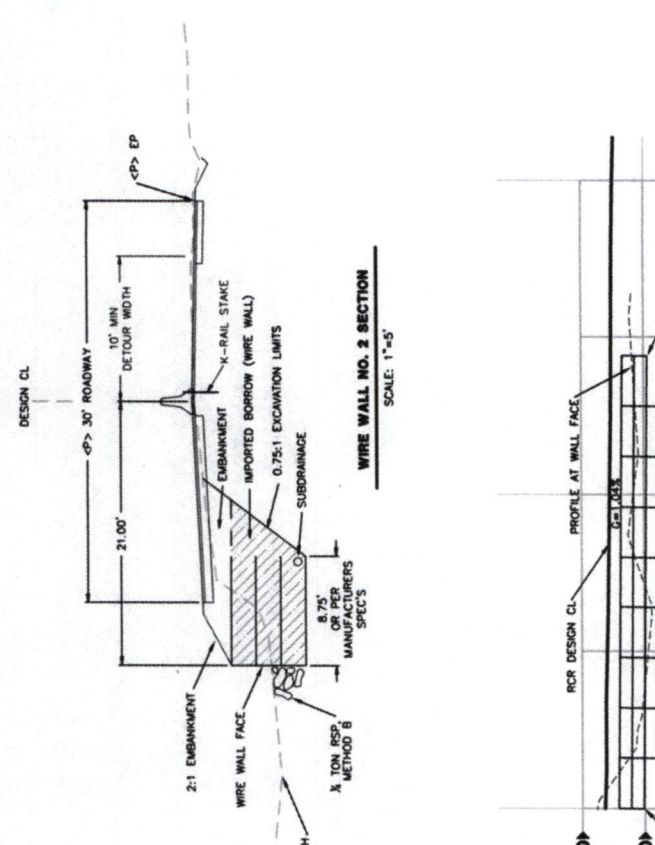



CROSS SECTIONS

SCALE: 1"=10'

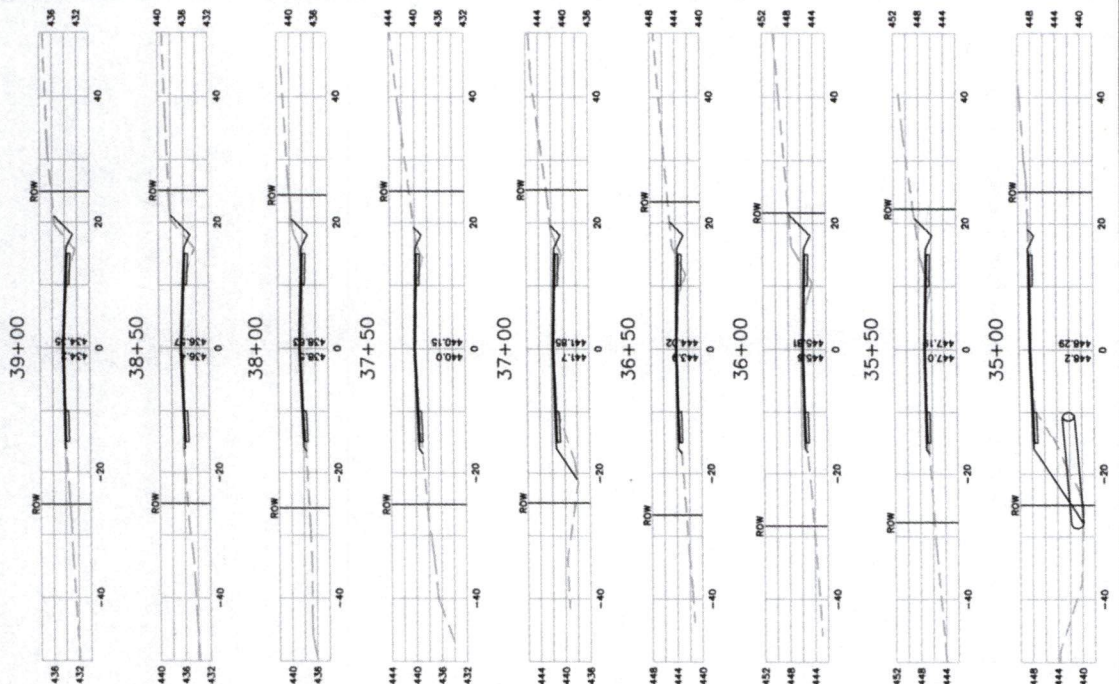
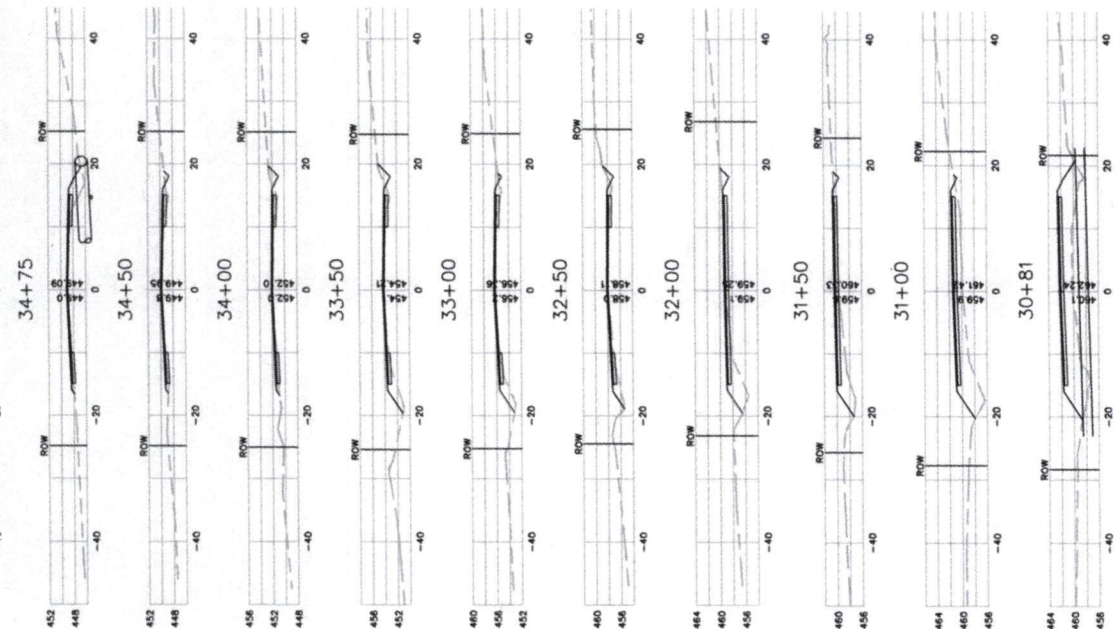
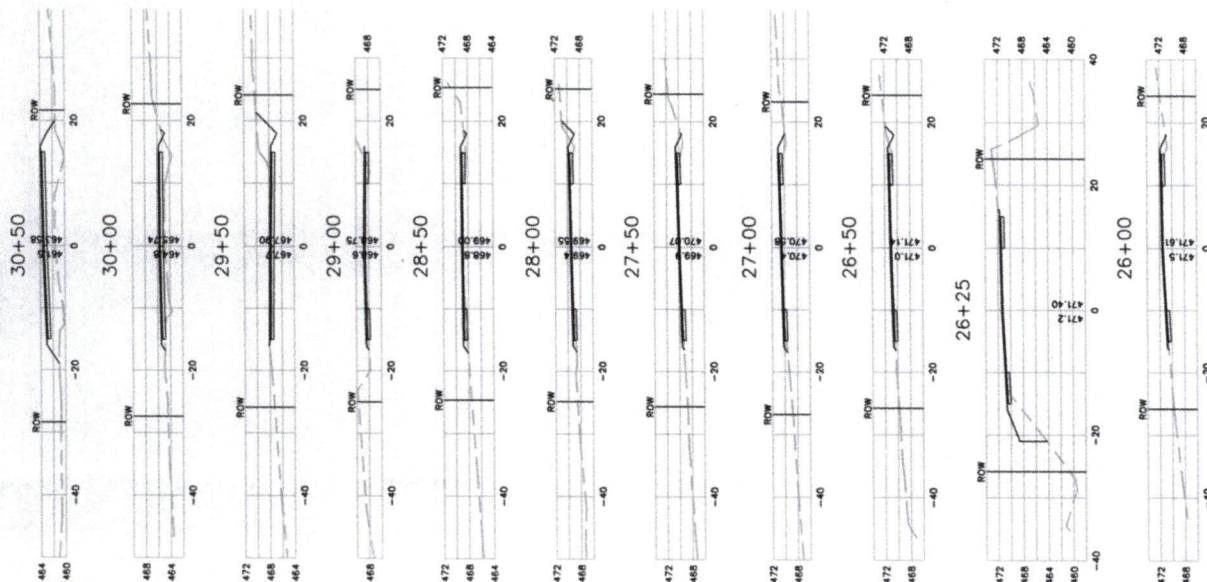

COUNTY OF HUMBOLDT
DEPARTMENT OF PUBLIC WORKS
ROAD SHOULDER WIDENING - PHASE 1

DESIGN SECTION
ROBERT L. BURDET
DESIGNED BY: JLB/CJM
DRAWN BY: JLB/CJM
REVIEWED BY: RLB
APPROVED BY: CJM

TABLE POST: 0.30-1.56
Final Cap Ref: 0.30-1.56

ROAD NAME: RED CAP ROAD
ROAD NO: 80100
APPOINTMENT NO: DTH88-15-W
CONTRACT NO: 37-600A
SHIPPING FILE NAME: L:\PROJECTS
LOT DATE: 4/28/2015



CROSS SECTIONS

SCALE: 1"=10'

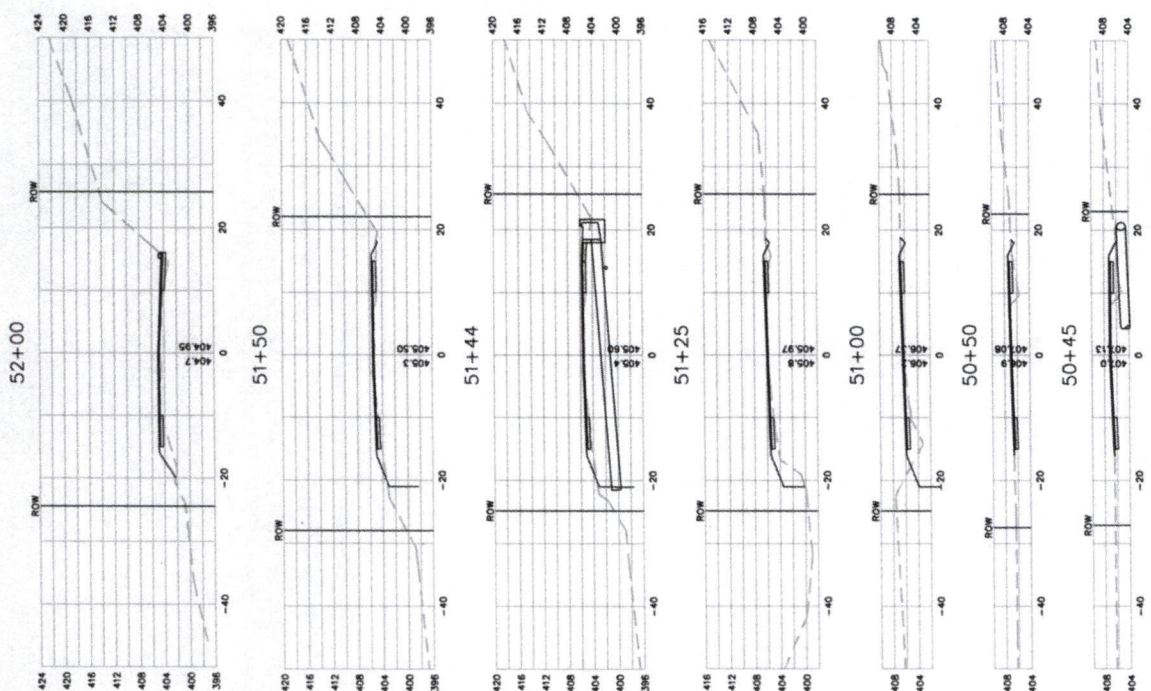
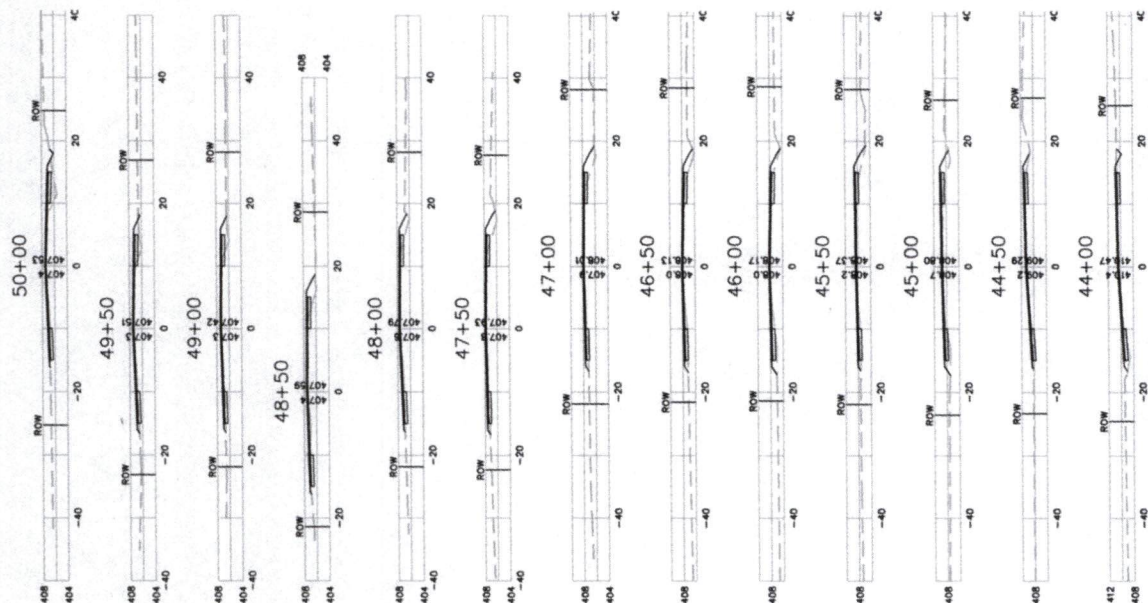
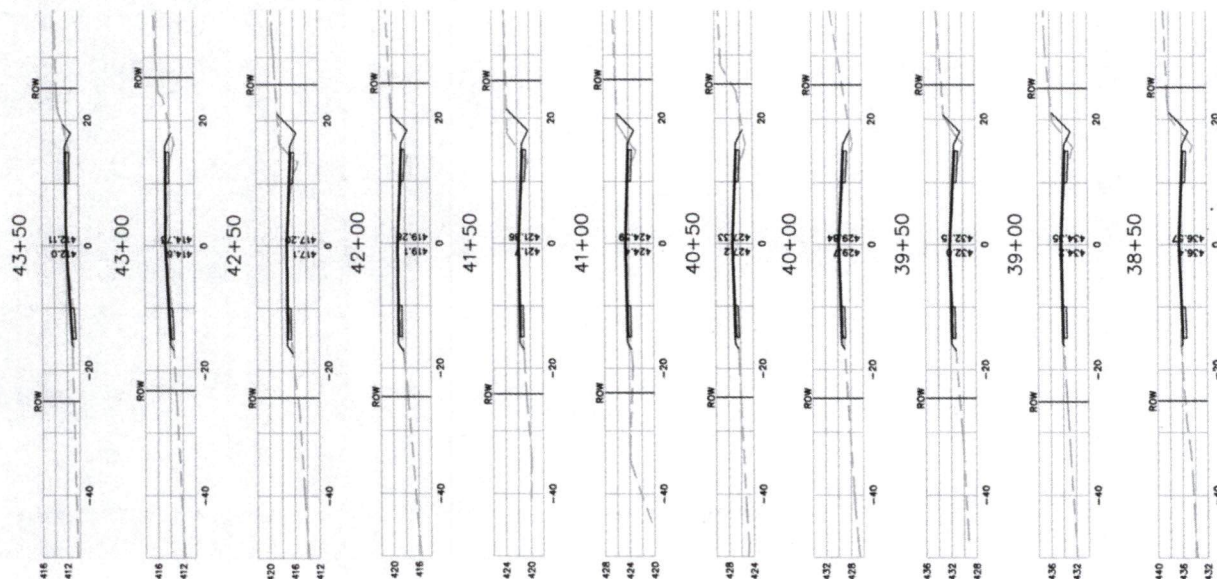



CROSS SECTIONS
 SCALE: 1"=10'

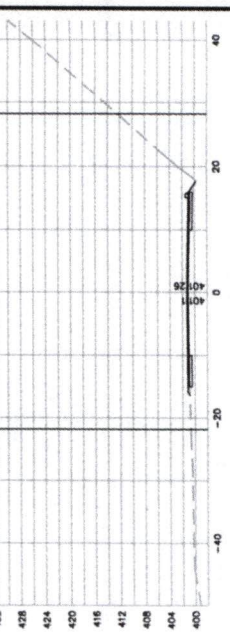
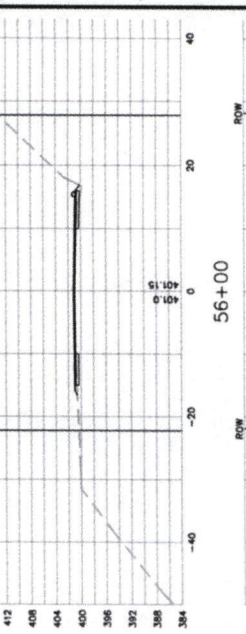
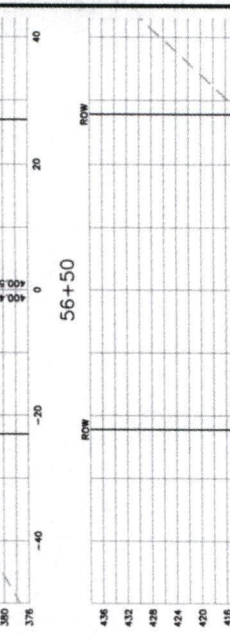
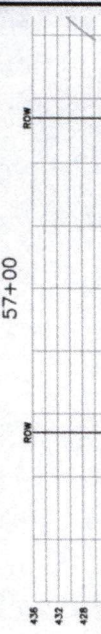
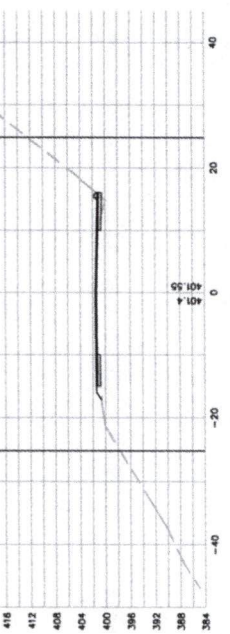
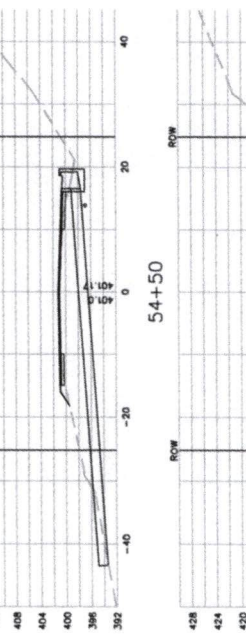
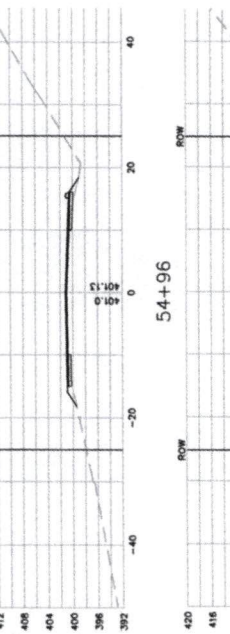
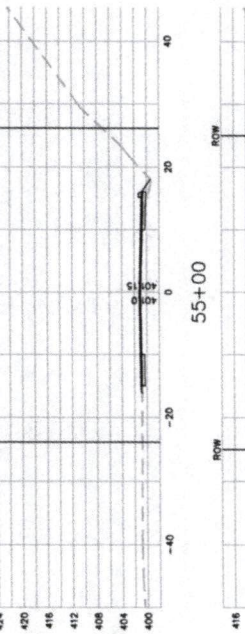
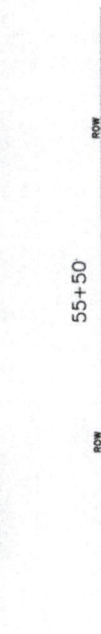
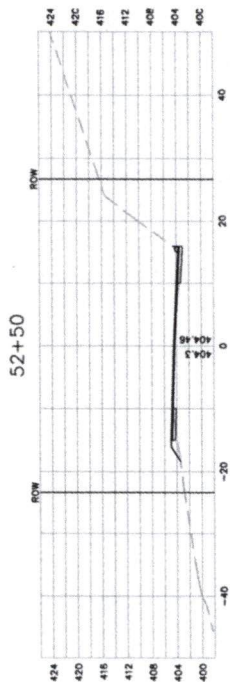
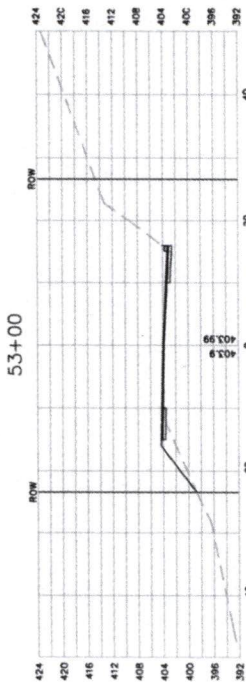
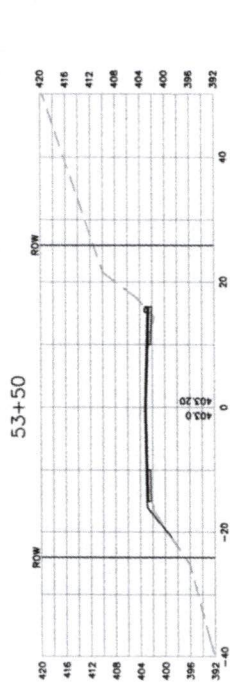
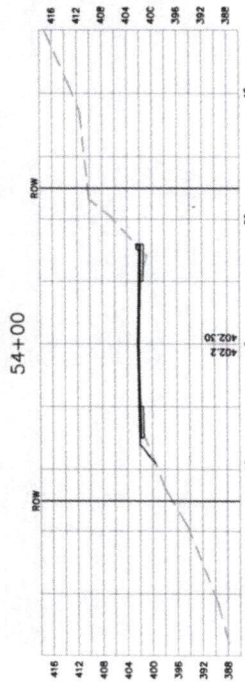
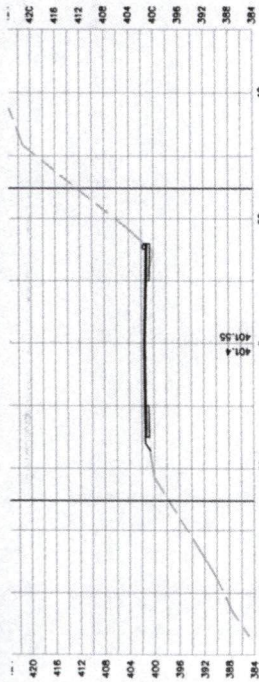



CROSS SECTIONS
SCALE: 1"=10'

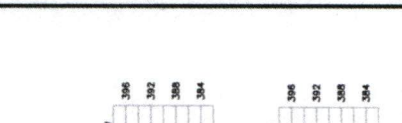
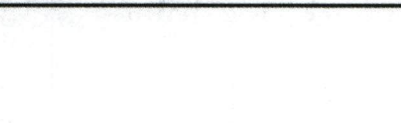
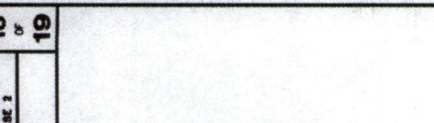
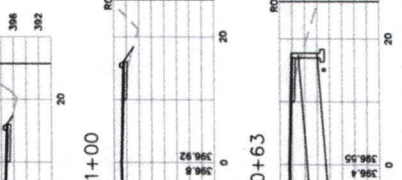
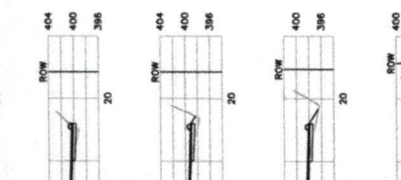
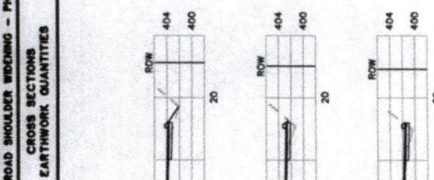
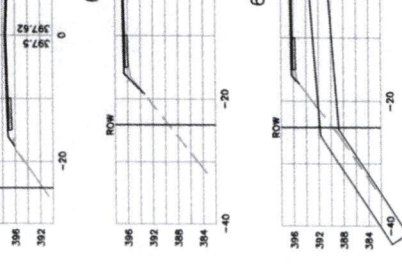
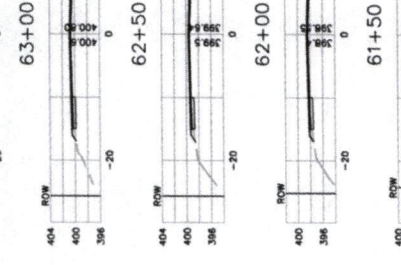
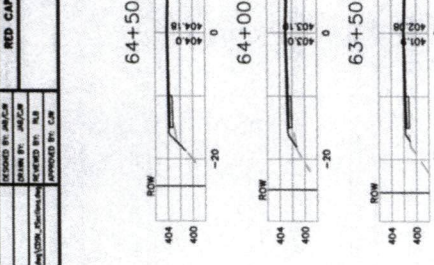
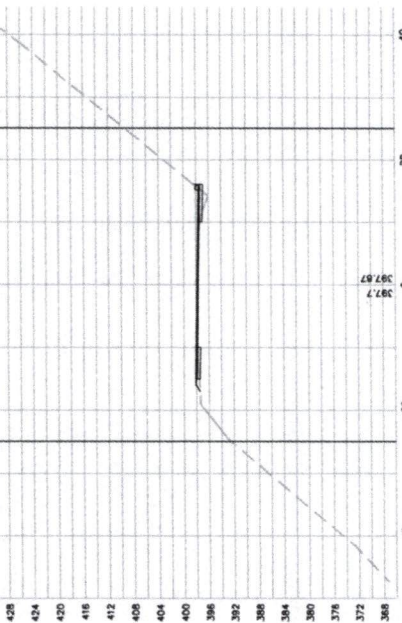
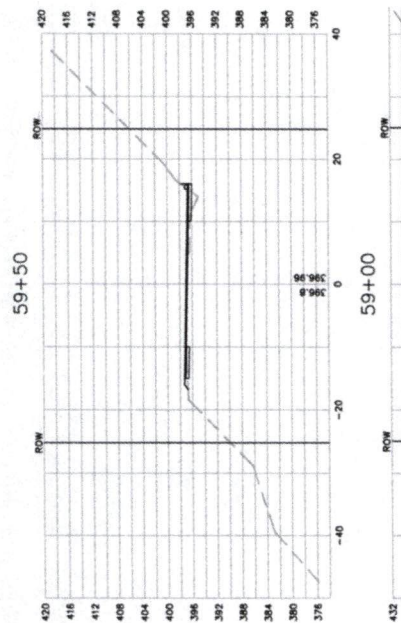
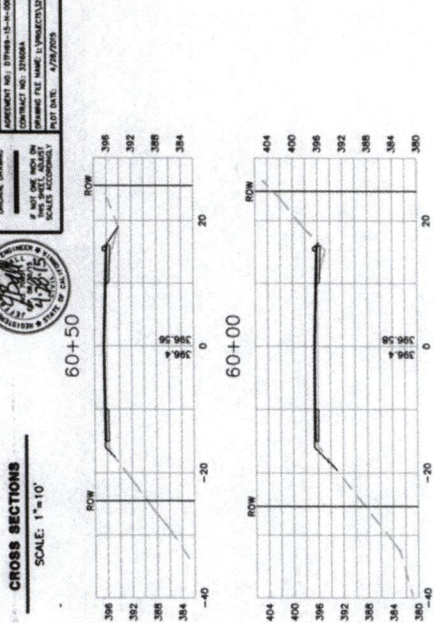
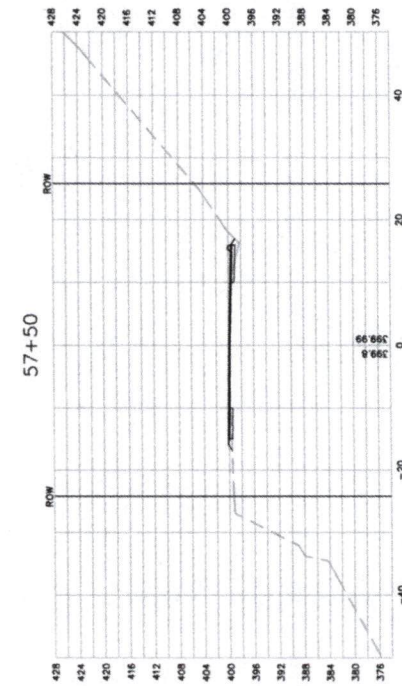
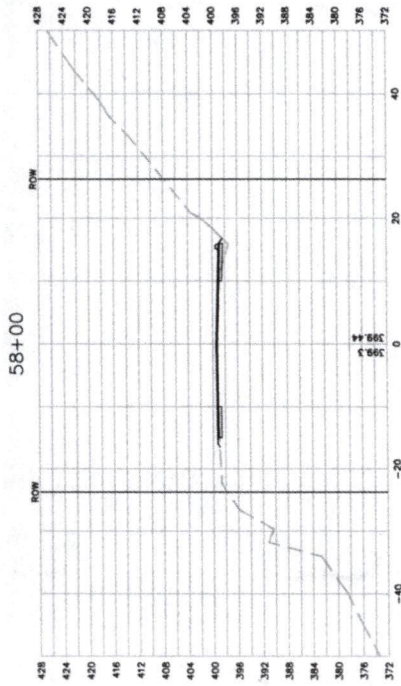
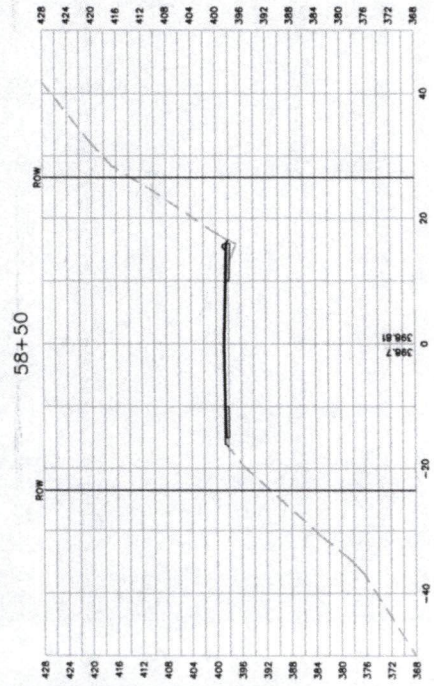

ROAD NAME: RED CAP ROAD
ROAD NO: 80000
MILE POST: 0.35-1.16
DESIGNED BY: JBL/CP
CHECKED BY: JBL/CP
CONTRACT NO: 200604
DRAWING FILE NAME: L:\PROJECTS\HUMBOLDT\80000\80000.DWG
DATE: 4/28/2005
SCALE: AS SHOWN



CROSS SECTIONS
SCALE: 1"=10'

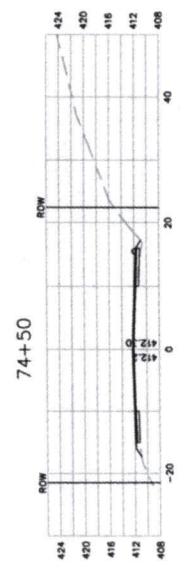
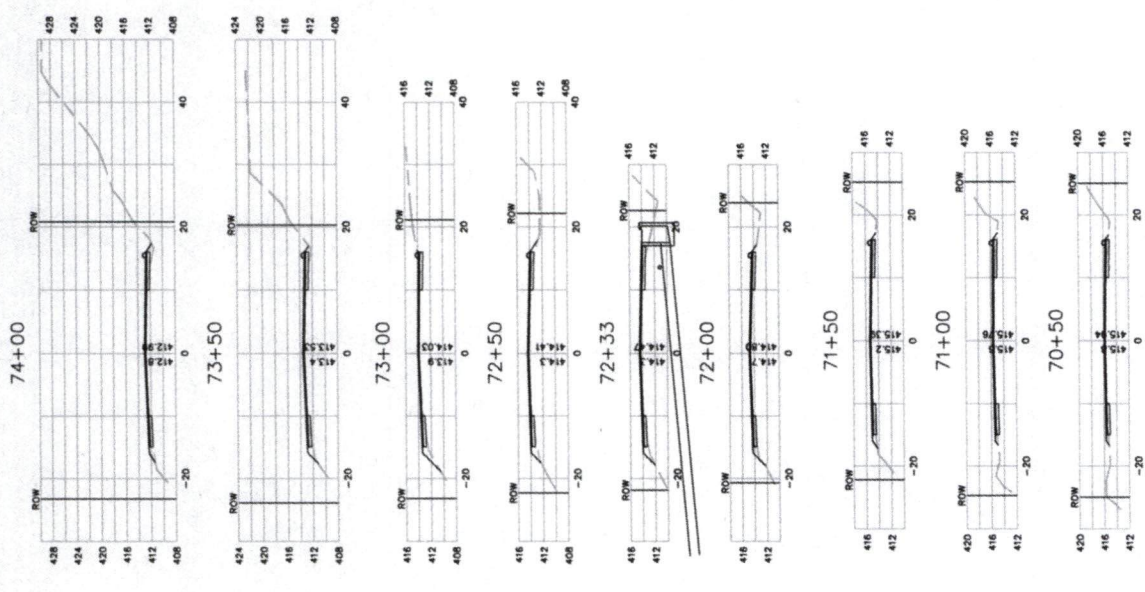
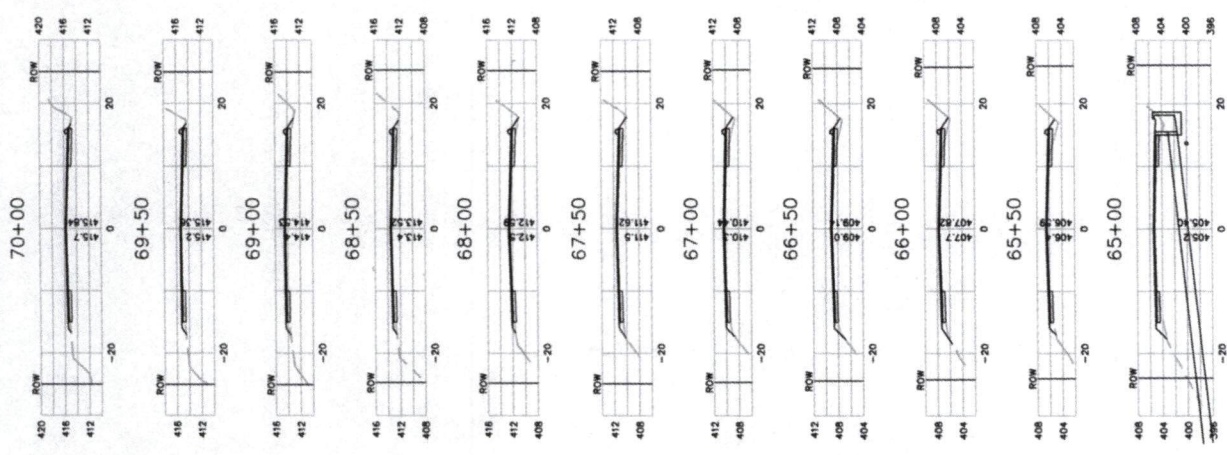

**MEMORANDUM OF AGREEMENT
BY AND BETWEEN
THE KARUK TRIBE
AND
COUNTY OF HUMBOLDT**

This Memorandum of Agreement (MOA), entered into this _____ day of _____, 2015 identifies and sets forth the joint and individual responsibilities of the Karuk Tribe, hereinafter referred to as "TRIBE," and the County of Humboldt, hereinafter referred to as "COUNTY," in the improvements to that approximately 1.3 mile section of Red Cap Road (8Q100), which is located within the town of Orleans in Humboldt County, California.

WITNESSETH:

WHEREAS, the parties hereto mutually desire to implement improvements to that approximately 1.3 mile section of Red Cap Road (8Q100) that is located within the town of Orleans; and

WHEREAS, TRIBE has secured the necessary funding through the Federal Highway Administration Tribal Transportation Program (FHWA TTP) and other programs to undertake the actions outlined herein; and

WHEREAS, the parties mutually agree to undertake the actions outlined herein; and

NOW, THEREFORE, in consideration of the foregoing and of the mutual covenants contained herein, it is hereby understood and agreed by and between the parties hereto as follows:

1. **PERFORMANCE:**

- A. TRIBE will obtain approval for all funding for the project from the Federal Highway Administration (FHWA).
- B. The parties hereto have jointly prepared the necessary National Environmental Policy Act, California Environmental Quality Act, and National Historic Preservation Act documents and submitted these documents and received approval.
- C. The parties hereto have jointly surveyed, designed, and prepared the construction plans, specifications, and estimates for the proposed road improvements.
- D. COUNTY will prepare the construction bid package for review by TRIBE; and advertise and bid the project for construction. COUNTY will submit the qualified, responsive, low bid for approval by TRIBE, prior to award of the construction contract.
- E. COUNTY will administer the project in accordance with all applicable requirements of the FHWA TTP and all other terms and conditions of this MOA.
- F. TRIBE will provide resident engineering and cultural monitoring services for the duration of the project.
- G. TRIBE shall reimburse COUNTY for the construction contract and contract administration expenses.

- H. If requested by TRIBE, COUNTY will provide construction surveying services.
- I. COUNTY will be responsible for managing the relocation of any utilities out of the construction areas within the existing right of way prior to construction of the road.
- J. Reimbursements by TRIBE to COUNTY shall not exceed the availability of funding as identified in Amendment Number 2 to the Referenced Funding Agreement dated January 8, 2015 (Agreement No. DTFH69-15-H-00051) between TRIBE and the Department of Transportation, executed on April 7, 2015, which is attached hereto as Exhibit A and incorporated herein by reference.

2. ADDITIONS NOT LIMITED:

Nothing in this MOA precludes TRIBE, FHWA or COUNTY from bringing additional resources to implement the project as outlined herein or in subsequent construction documents.

3. OWNERSHIP AND MAINTENANCE:

- A. This MOA does not change any aspect of COUNTY's ownership or continuing maintenance responsibilities of that approximately 1.3 mile section of Red Cap Road located within the Karuk Tribe's ancestral territory.
- B. This MOA does not add any ownership or continuing maintenance responsibilities to TRIBE of that approximately 1.3 mile section of Red Cap Road located within the Karuk ancestral territory.

4. INDEPENDENT CAPACITY:

- A. It is understood that this MOA is not intended to, and shall not be construed to, create the relationship of agent, servant, employee, partnership, joint venture or any other similar association.
- B. TRIBE assumes exclusively the responsibility for acts of TRIBE's employees, agents and subcontractors, other than COUNTY, as they relate to the services to be provided during the course and scope of this MOA.
- C. COUNTY assumes exclusively the responsibility for COUNTY's employees, agents and subcontractors as they relate to services to be provided during the course and scope of this MOA.

5. REVIEW BY LICENSED PERSONNEL:

Work performed by employees of TRIBE that are determined to be mutually cooperative, such as surveying or engineering work, shall be reviewed and subject to change by COUNTY employees who are appropriately licensed by the State of California in the subject fields, if such licensing is required.

6. TERM:

This MOA shall begin upon execution by both parties and shall remain in full force and effect, unless sooner terminated as provided herein, until September 30, 2018, or until completion of the work subject to this MOA, whichever is sooner.

7. NUCLEAR FREE HUMBOLDT COUNTY ORDINANCE COMPLIANCE:

The Karuk Tribal Council certifies by its signature below that TRIBE is not a Nuclear Weapons Contractor, in that TRIBE is not knowingly or intentionally engaged in the research, development, production or testing of nuclear warheads, nuclear weapons system or nuclear weapons components as defined by the Nuclear Free Humboldt County Ordinance. TRIBE agrees to notify COUNTY immediately if it becomes a nuclear weapons contractor, as defined above. COUNTY may immediately terminate this MOA if it determines that the foregoing certification is false or if TRIBE becomes a nuclear weapons contractor.

8. AMENDMENTS:

No amendments to, or alteration of, the terms of this MOA shall be valid unless made in writing by means of a written amendment signed by all parties.

9. LIMITED WAIVER OF TRIBAL SOVEREIGN IMMUNITY:

TRIBE does not waive its sovereign immunity or consent to suit in any court except as expressly stated in this section and subject to the limitations and considerations stated in this section.

A. Limited Waiver and Consent to Suit. TRIBE waives its sovereign immunity and consents to suit as to "Covered Claims" as defined in Section (B)(1) below. TRIBE's governing body has executed a formal Resolution of Limited Waiver of Sovereign Immunity, which is attached hereto as Exhibit B and incorporated herein by reference.

B. Conditions and Limitations. This waiver and consent is subject to the following conditions and limitations:

1. Covered Claims. This waiver and consent only applies to claims by COUNTY that TRIBE has violated any provision of this MOA or that seeks to resolve a dispute concerning the interpretation, implementation or enforcement of this MOA. It does not include tort claims, claims for exemplary or punitive damages, lost profits, emotional damages, or any other claims not sounding in contract.
2. Covered Claimants. This waiver and consent only applies to COUNTY, and not to any other person, entity, including any commercial or governmental entity or group, and not to any successor or assign of COUNTY.
3. Covered Courts. This consent to suit only applies to the California State Courts in Humboldt County, and appropriate state appellate courts. TRIBE does not consent to suit in any other court.
4. Remedies. This waiver and consent is specifically limited to an award of foreseeable monetary damages constituting a reimbursement of funds for obligations not performed

by TRIBE under the terms of this MOA, not to exceed to the total project cost contemplated under this MOA, and/or specific performance to compel enforcement of this MOA. This waiver of immunity expressly does not allow for recovery of attorneys fees or other costs associated with litigation of Covered Claims, or post-judgment interest. Any judgment awarded COUNTY pursuant to this section may only be satisfied from allocated FHWA TTP project funds and not from any other property or assets of TRIBE.

5. Duration. Notwithstanding any applicable statute of limitations or other law, this limited waiver shall be enforceable only for such period as this MOA remains in effect, and only as to claims arising during the effective period of this MOA, except that this limited waiver of sovereign immunity shall remain effective for any proceeding then pending and all appeals therefrom until the underlying legal claim or claims have been finally determined.

10. DISPUTES:

If a dispute arises involving the interpretation, implementation or enforcement of this MOA, the parties shall meet, in person and in good faith, to make every reasonable attempt to resolve the problem within thirty (30) days of discovering a material dispute. The parties agree that informal dispute resolution, including mediation should an in-person meeting prove unsuccessful, shall be attempted prior to seeking recourse from the courts. .

11. TERMINATION:

- A. Either party may terminate this MOA by providing the other party with thirty (30) days advanced written notice. Receipt of such notice by either party shall begin the thirty (30) day period required for termination.
- B. In the event of any termination of this MOA, COUNTY shall be entitled to compensation for uncompensated services rendered hereunder through and including the effective date of such termination, provided such services were rendered satisfactorily.

12. NOTICES:

Any and all notices required to be given pursuant to the terms of this MOA shall be in writing and served personally, or sent by certified mail, return receipt requested, to the respective addresses set forth below. Notice shall be effective upon actual receipt or refusal as shown on the receipt obtained pursuant to the foregoing.

COUNTY: Humboldt County Department of Public Works
Attention: Thomas K. Mattson, Director of Public Works
1106 Second Street
Eureka, CA 95501

TRIBE: Karuk Tribe Department of Transportation
Attention: Sandi Tripp, Director
PO Box 1016
Happy Camp, CA 96039

13. RECORD RETENTION AND INSPECTION:

- A. Maintenance and Preservation of Records. TRIBE agrees to timely prepare accurate and complete financial and performance records, and to maintain and preserve said records for at least three (3) years from the date of final payment under this MOA, except that if any litigation, claim, negotiation, audit or other action is pending, the records shall be retained until completion and resolution of all issues arising there from.
- B. Inspection of Records. All records referenced by this section shall be made available during normal business hours to inspection, audit and reproduction by any duly authorized agents of the State of California, the Federal Government or COUNTY upon adequate notice and a showing that such inspection, audit or reproduction is necessary or required.

14. SEVERABILITY:

If any provision of this MOA, or any portion thereof, is found by any court of competent jurisdiction to be unenforceable or invalid for any reason, such provision shall be severable and shall not in any way impair the enforceability of any other provision of this MOA.

15. WAIVER OF DEFAULT:

The waiver by either party of any breach or violation of any requirement of this MOA shall not be deemed to be a waiver of any such breach in the future, or of the breach of any other requirement of this MOA.

16. JURISDICTION AND VENUE:

This MOA shall be construed in accordance with the laws of the State of California. Any dispute arising hereunder or relating to this MOA shall be litigated in the State of California and venue shall lie in the County of Humboldt.

17. INTERPRETATION:

This MOA, as well as its individual provisions, shall be deemed to have been prepared equally by both of the parties hereto, and shall not be construed or interpreted more favorably for one party on the basis that the other party prepared it.

18. INDEPENDENT CONSTRUCTION:

The titles of the sections, subsections, and paragraphs set forth in this MOA are inserted for convenience of reference only, and shall be disregarded in construing or interpreting any of the provisions of this MOA.

19. FORCE MAJEURE:

Neither party hereto shall be liable or responsible for delays or failures in performance resulting from events beyond the reasonable control of such party and without fault or negligence of such party. Such events shall include, but not be limited to, acts of God, strikes, lockouts, riots, acts of war, epidemics, acts of government, fire, power failures, nuclear accidents, earthquakes, unusually severe weather, acts of terrorism or other disasters, whether or not similar to the foregoing.

20. ENTIRE AGREEMENT:

This MOA contains all of the terms and conditions agreed upon by the parties hereto and no other agreements between the parties, oral or otherwise, regarding the subject matter of this MOA shall be deemed to exist or to bind either of the parties hereto. In addition, this MOA shall supersede in its entirety any and all prior agreements of the parties.

21. AUTHORITY TO EXECUTE:

Each person executing this MOA represents and warrants that he or she is duly authorized and has legal authority to execute and deliver this MOA. Each party represents and warrants to the other that the execution and delivery of this MOA and the performance of such party's obligations hereunder have been duly authorized.

KARUK TRIBE:

By: _____
Russell Attebery
Chairman, Karuk Tribal Council

Date: _____

COUNTY OF HUMBOLDT:

By: _____
Estelle Fennell
Chair, Humboldt County Board of Supervisors

Date: _____