



**STATE OF CALIFORNIA
CALIFORNIA ENVIRONMENTAL PROTECTION AGENCY
STATE WATER RESOURCES CONTROL BOARD**

DIVISION OF WATER RIGHTS

RIGHT TO DIVERT AND USE WATER

REGISTRATION H500602

CERTIFICATE H100103

Right Holder: *Eric Wegmet
PO Box 7148
Eureka, CA 95501*

The State Water Resources Control Board (State Water Board) authorizes the diversion and use of water by the right holder in accordance with the limitations and conditions herein SUBJECT TO PRIOR RIGHTS. The priority of this right dates from 03/31/2018. This right is issued in accordance with the State Water Board delegation of authority to the Deputy Director for Water Rights (Resolution 2012-0029) and the Deputy Director for Water Rights redelegation of authority dated October 19, 2017.

The Deputy Director for Water Rights finds that this registration meets the requirements for registration of small irrigation use appropriation. (Wat. Code, § 1228 et seq.)

Right holder is hereby granted a right to divert and use water as follows:

1. Location of point(s) of diversion (**Coordinates in WGS 84**)

Name of Diversion	Source	Tributary To:	Thence	Latitude	Longitude	County	Assessor's Parcel Numbers (APN)
Class II POD	Unnamed Stream	Mad River	Mad River	40.5126	-123.5612	Humboldt	208-241-017

2. Purpose of Use and 3. Place of Use

2. Purpose of Use	3. Place of Use		
	County	Assessor's Parcel Numbers (APN)	Acres
Irrigation	Humboldt	208-241-017	0.3902663

Note: Assessor's Parcel Numbers provided are based on the user's entries in this portal on 06/21/2018.

The place of use is shown on the map filed on 06/21/2018 with the State Water Board.

4. Quantity and Season:

The water appropriated shall be limited to the quantity which can be beneficially used and shall not exceed **0.20 acre-feet per year** to be collected from 11/01 to 05/31 and as permitted in the diversion season specified in the current version of the State Water Board's Cannabis Policy, whichever is more restrictive. The total storage capacity shall not exceed 0.23783881 acre-feet. The rate of diversion to storage shall not exceed **42,000 gallons per day (gpd) or the diversion rate specified in the current version of the State Water Board's Cannabis Policy, whichever is more restrictive.**

5. No water shall be diverted or used under this right unless the water right holder is in compliance with all applicable conditions, including the numeric and narrative instream flow requirements, of the current version of the State Water Board's Cannabis Policy, except as follows:

16. All rights are issued subject to available flows. Inasmuch as the source contains treated wastewater, imported water from another stream system, or return flow from other projects, there is no guarantee that such supply will continue.
17. If storage or diversion of water under this right is by means of a dam, right holder shall allow sufficient water at all times to pass through a fishway or, in the absence of a fishway, allow sufficient water to pass over, around, or through the dam to keep in good condition any fish that may be planted or exist below the dam; provided that, during a period of low flow in the stream, upon approval of the California Department of Fish and Wildlife, this requirement will be satisfied if sufficient water is passed through a culvert, waste gate, or over or around the dam to keep in good condition any fish that may be planted or exist below the dam if it is impracticable or detrimental to pass the water through a fishway. In the case of a reservoir, this provision shall not require the passage or release of water at a greater rate than the unimpaired natural inflow into the reservoir. (Fish & G. Code, § 5937.)
18. The facilities for diversion under this right shall include satisfactory means of measuring and bypassing sufficient water to satisfy downstream prior rights and any requirements of the California Department of Fish and Wildlife and the State Water Board's Cannabis Policy.
19. This right does not authorize any act which results in the taking of a threatened, endangered, or candidate species or any act which is now prohibited, or becomes prohibited in the future, under either the California Endangered Species Act (Fish and Game Code section 2050 et seq.) or the federal Endangered Species Act (16 U.S.C.A. section 1531 et seq.). If a "take" will result from any act authorized under this water right, the right holder shall obtain authorization for an incidental take prior to construction or operation of the project. Right holder shall be responsible for meeting all requirements of the state and Federal Endangered Species Acts for the project authorized under this right.
20. This right is subject to the submittal of an annual report of water use and satisfactory renewal, on forms to be furnished by the State Water Board, including payment of the then-current annual renewal fees. (Wat. Code, § 1228.5.)
21. This right shall be totally or partially forfeited for nonuse if the diversion is abandoned or if all or any part of the diversion is not beneficially used for a continuous period of five years.
22. This right is subject to enforcement, including but not limited to revocation, by the State Water Board if 1) the State Water Board finds that the right holder knowingly made any false statement, or knowingly concealed any material fact, in the right; 2) the right is not renewed as required by the conditions of this certificate; or 3) the State Water Board finds that the right holder is in violation of the conditions of this right. (Wat. Code, § 1228.4 et seq.)
23. The State Water Board intends to develop and implement a basin-wide program for real-time electronic monitoring and reporting of diversions, withdrawals, releases, and streamflow in a standardized format if and when resources become available. Such real-time reporting will be required upon a showing by the State Water Board that the program and the infrastructure are in place to accept real-time electronic reports. Implementation of the reporting requirements shall not necessitate amendment to this right.

STATE WATER RESOURCES CONTROL BOARD
DIVISION OF WATER RIGHTS

This certificate was issued automatically as a result of the registrant self-certifying submittal of a water right registration filing in substantial compliance with Water Code §1228.3.

Dated: 06/21/2018 12:29:52

State Water Resources Control Board
DIVISION OF WATER RIGHTS
INITIAL STATEMENT OF WATER DIVERSION AND USE
 A STATEMENT SHALL NOT ESTABLISH OR CONSTITUTE EVIDENCE OF A WATER RIGHT
 READ THE ATTACHED INFORMATION AND INSTRUCTION SHEET BEFORE COMPLETING THIS FORM
 FURTHER INFORMATION CAN BE FOUND IN WATER CODE, SECTIONS 5100-5107

Page 1 of 3: INITIAL STATEMENT OF WATER DIVERSION AND USE DIVERTER NAME ERIC WEGMET
 SOURCE/TRIBUTARY Unnamed Class II watercourse DIVERSION WORKS NAME Class II Watercourse

A. Diverter Information			
Diverter Name(s) ERIC WEGMET			
Mailing Address PO BOX 7148		City EUREKA	State CA
Phone Number 707-601-6207		Zip 95501	
Person Filing Statement (if Different From Diverter) Timberland Resource Consultants			
Mailing Address 165 S. Fortuna Blvd.		City Fortuna	State CA
Phone Number 707-725-1897		Zip 95540	
Land Owner Name Same as diverter			
Mailing Address		City	State
Zip			
Mail Receiver <input type="radio"/> Diverter <input checked="" type="radio"/> Person Filing			
B. Signature and Important Information			
DATE: <u>3-12-16</u>			
SIGNATURE: <u>Chris Carrell</u>			
PRINTED NAME: <u>Chris</u> <u>V.</u> <u>Carrell</u>			
(first name)		(middle name)	
(last name)			
I declare that the information in this report is true to the best of my knowledge and belief.			
Submit Form Electronically			
THE STATE WATER RESOURCES CONTROL BOARD MAY RELY ON THE NAMES AND ADDRESSES ON THIS DOCUMENT FOR MAILING NOTICES REGARDING PROCEEDINGS BEFORE THE BOARD. (Wat. Code, § 5106, subd. (b)(1).)			
SUPPLEMENTAL STATEMENTS OF WATER DIVERSION AND USE MUST BE FILED AT THREE-YEAR INTERVALS OR IF THERE IS A CHANGE IN THE NAME OR ADDRESS OF THE DIVERTER. (Wat. Code, § 5104.)			
THE MAKING OF A WILLFUL MISSTATEMENT ON A STATEMENT OF WATER DIVERSION AND USE IS A MISDEMEANOR PUNISHABLE BY A FINE NOT EXCEEDING \$1,000 OR BY IMPRISONMENT IN THE COUNTY JAIL FOR UP TO SIX MONTHS, OR BOTH. THE BOARD MAY IMPOSE CIVIL LIABILITY UPON A PERSON WHO KNOWINGLY MAKES A MATERIAL MISSTATEMENT ON THIS FORM. (Wat. Code, § 5107.)			

UPON COMPLETION OF THIS STATEMENT, ATTACH ALL SUPPORTING DOCUMENTATION AND MAPS AND MAIL TO:

State Water Resources Control Board
 Division of Water Rights
 PO Box 2000
 Sacramento, CA 95812-2000

Additional copies of this form, instructions on how to complete this form and water right information can be obtained at http://www.waterboards.ca.gov/waterrights/water_issues/programs/diversion_use/. Revised January 2014.

S025421

State Water Resources Control Board
DIVISION OF WATER RIGHTS
INITIAL STATEMENT OF WATER DIVERSION AND USE
 A STATEMENT SHALL NOT ESTABLISH OR CONSTITUTE EVIDENCE OF A WATER RIGHT
 READ THE ATTACHED INFORMATION AND INSTRUCTION SHEET BEFORE COMPLETING THIS FORM
 FURTHER INFORMATION CAN BE FOUND IN WATER CODE, SECTIONS 5100-5107

PAGE 2 OF 3: INITIAL STATEMENT OF WATER DIVERSION AND USE

DIVERTER NAME ERIC WEGMET

SOURCE/TRIBUTARY Unnamed Class II watercourse

DIVERSION WORKS NAME Class II Watercourse

1. Type of Claim													
Check the box(s) which describe the type of claim(s) under which you are diverting water.													
<input checked="" type="checkbox"/> Riparian	<input type="checkbox"/> Pre-1914	<input type="checkbox"/> Court Decree	<input type="checkbox"/> Pending Appropriative Application	<input type="checkbox"/> Pueblo	<input checked="" type="checkbox"/> Other: <u>SDUR to be submitted</u>								
If you checked yes for Court Decree, Pending Appropriative Application or other, list the decree number, application ID or explanation:													
2. Water Course Description													
Water Course Name at the point of diversion <u>Unnamed Class II watercourse</u>						Water Course is tributary to <u>Mad River</u>							
3. Legal Land Description													
Provide the location of the Point of Diversion using one of the following methods (check one box and enter coordinates, if applicable)													
<input type="checkbox"/> Latitude/Longitude Measurements: _____													
<input checked="" type="checkbox"/> California Coordinate System (NAD 1983): <u>452,451.30m; 4,484,789.27m</u>													
<input checked="" type="checkbox"/> USGS Topographic Map with point of diversion labeled on map (if checked yes, please attach map)													
Assessor's Parcel Number(s), if assigned: <u>208-241-17</u>						County <u>Humboldt</u>							
Provide Public Land Description to nearest 40 acres (if assigned)													
<u>SE 1/4 of the NW 1/4 of Section 36, Township 2N, Range 5E, B&M Humboldt</u>													
4. Place of Use Description													
Provide a general description of the area in which the water was used <u>40 acre parcel consisting of homestead with agricultural gardens.</u>													
Identify the location of the place of use on a specific United States Geological Survey (USGS) topographic map and on any other maps with identifiable landmarks. If assigned, provide the public land description to the nearest 40-acre subdivision and the assessor's parcel number. (check box indicating each map attached)													
<input checked="" type="checkbox"/> USGS Topographic Map													
<input type="checkbox"/> County Assessor's parcel map													
5. Purpose of Use Description (Please select all that apply below)													
<input checked="" type="checkbox"/> Irrigation Number of Acres: <u>0.18</u>			<input checked="" type="checkbox"/> Domestic Persons Served: <u>4</u>			<input type="checkbox"/> Stock watering Number of stock and type: _____			<input type="checkbox"/> Other Please Explain: _____				
6. Diversion Works Description													
Name of Diversion Works, if named <u>Class II Watercourse</u>						Year in which diversion commenced (or specify nearest known year) <u>2007</u>							
List any related existing water rights, if applicable (for example, an appropriative right using the same diversion works)													
7. Type of Diversion Facility (select one)													
<input type="checkbox"/> Gravity													
<input checked="" type="checkbox"/> Water Course Pump													
<input type="checkbox"/> Well Pump													
<input type="checkbox"/> Other (please specify) _____													
Do you directly divert water? <input checked="" type="checkbox"/> Yes <input type="checkbox"/> No													
Capacity of Direct Diversion Works (specify unit and amount) <u>2</u>						Do you divert water to storage?							
<input checked="" type="checkbox"/> Cubic feet per second						<input type="checkbox"/> On-stream storage (Complete Section B)							
<input checked="" type="checkbox"/> Gallons per minute						<input checked="" type="checkbox"/> Off-stream storage (Complete Sections A & B)							
<input type="checkbox"/> Gallons per day						<input type="checkbox"/> Acre-feet							
A. Capacity of Storage Diversion Works (specify unit and amount) <u>2</u>						B. Capacity of Storage Tank or Reservoir (specify unit and amount) <u>77500</u>							
<input type="checkbox"/> Cubic feet per second						<input checked="" type="checkbox"/> Gallons							
<input checked="" type="checkbox"/> Gallons per minute						<input type="checkbox"/> Acre-feet							
<input type="checkbox"/> Gallons per day													
Quantity of Water Diverted: Note: Measurements must be made using best available technologies and best professional practices as listed in Section 60 unless documentation is provided to the State Water Resources Control Board that the implementation of those practices is not locally cost-effective.													
Provide the quantity of water diverted each month in the table below as a measured in (check one box) <input checked="" type="checkbox"/> Gallons <input type="checkbox"/> Acre-feet													
Year	Jan	Feb	Mar	Apr	May	Jun	Jul	Aug	Sep	Oct	Nov	Dec	Total
2015	0	77500	0	0	0	0	0	0	0	0	0	0	77500

CONTINUE TO PAGE 2

S025421

DIVERTER NAME ERIC WEGMET

SOURCE/TRIBUTARY Unnamed Class II watercourse

DIVERSION WORKS NAME Class II Watercourse

8. Measurement Device Description
 Method used to measure water diverted (select one)

Water directly diverted and/or diverted to storage was measured with a measuring device.
 (If checked, proceed to section 8a and skip section 8b)

Direct measurement using a device listed in Section 8a is not locally cost effective for water directly diverted and/or diverted to storage.
 (If checked, skip section 8a and proceed to section 8b).

8a. Measuring Device
 Indicate the types of measuring devices used (check all that apply):

Propeller Meter Sluice/Slide Gate Acoustic Meter Weir
 Staff gage and storage capacity curve Staff gage and floodable acreage
 Pressure transducer and storage capacity curve Other: _____

Indicate any additional technology used (check all that apply and explain below):
 Flow totalizer Data Logger Telemetry Other: _____

Indicate who installed your measuring device(s) (check all that apply):

Representative using manufacturer's recommendations Licensed Civil or Agricultural Engineer
 Representative who is American Water Works Association (AWWA)-certified Hydrographer
 Representative using United States Geological Survey (USGS) techniques Other/Unknown: _____

List the make, model number, and last calibration date of your measuring device(s), if available: _____

8b. Explanation of why use of a measuring device is not locally cost effective
 Indicate why you concluded that direct measurement using a device listed in Section 8a is not locally cost effective (check all that apply)

Diversion is small or minimal in size Diversions are infrequent Ungauged Siphon
 No power at diversion point Other: _____

Indicate method(s) used as an alternative to direct measurement in order to complete this report (check all that apply)

Electricity records dedicated to the pump Total facility electricity records minus estimated non-pump electricity
 Engine fuel use or hour meter records Crop duty estimates/consumptive use estimates
 Power generation estimates Other water duty estimates other than for crops
 Modeled/estimated flows Remote satellite imaging
 Pipe/trajectory method Bucket and stopwatch
 Float and stopwatch Other: _____

Explain your measurement alternatives:
The diverter shall install a water meter in 2016

9. Maximum Rate of Diversion (if available)
 Provide the maximum rate of diversion achieved in each month as measured in (check one box)

Year	Jan	Feb	Mar	Apr	May	Jun	Jul	Aug	Sep	Oct	Nov	Dec
2015	0	2	0	0	0	0	0	0	0	0	0	0

cfs gpm gpd

10. Recent Water Use
 Provide the annual water use in recent years:

Maximum	77,500	<input checked="" type="checkbox"/> Gallons <input type="checkbox"/> Acre Feet
Minimum	77,500	<input checked="" type="checkbox"/> Gallons <input type="checkbox"/> Acre Feet

11. Water Conservation Efforts (answer only sections applicable to your diversion)
Water Conservation: Are you currently employing any methods of water conservation?
 If yes, describe any water conservation efforts in use: **mulching, morning watering, mist sprayers** Yes No

Water Quality and Wastewater Reclamation: Are you now or have you been using reclaimed water from a wastewater treatment facility, desalination facility or water polluted by waste to a degree that unreasonably affects such water for other beneficial uses? Yes No

Conjunctive use of surface water and groundwater: Are you using groundwater in lieu of surface water? Yes No

END OF INITIAL STATEMENT FORM

Sign and Submit Form

Save Form (submit later)

S025421

APN 208-241-17

ISWDU Map

 Property Boundary

 Point of Diversion

Map Scale 1" = 1,000'
Section 36, T2N, R5E, HB&M

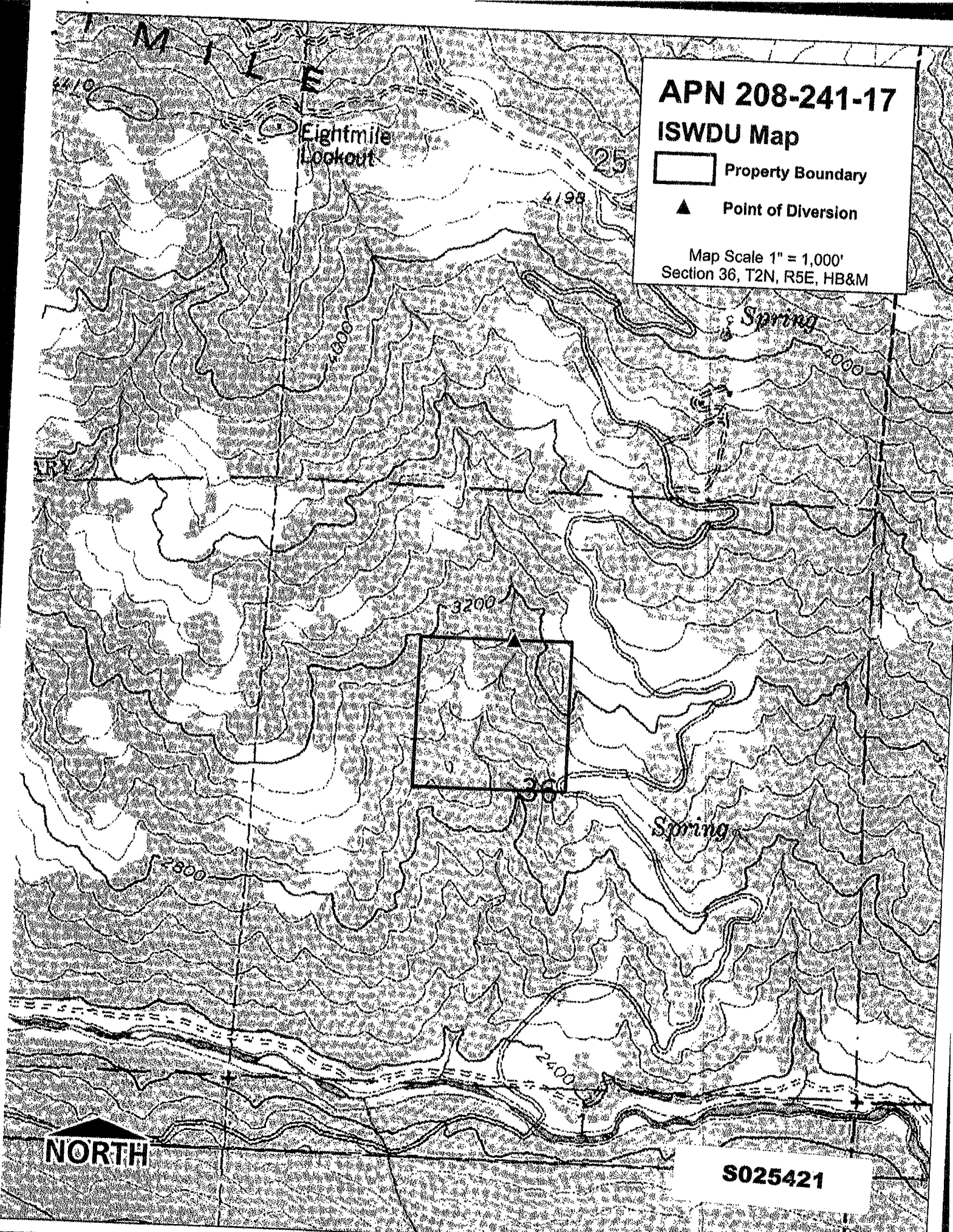

NORTH

S025421



GAVIN NEWSOM
GOVERNOR



JARED BLUMENFELD
SECRETARY FOR
ENVIRONMENTAL PROTECTION



State Water Resources Control Board

Page 1 of 1

January 22, 2020

MARKO TEOVSKI
PO BOX 3
MEYERS FLAT, CA 95554

In Reply Refer to:
AW: S025421 et al

Dear Marko Teovski:

NEW PRIMARY OWNER INFORMATION FOR WATER RIGHTS:

S025421, S025422, AND H500602

Owner of Record Information

The Division of Water Rights (Division) received notification on December 9, 2019 that Marko Teovski is now the primary owner of the property served by the water rights listed above. A copy of these water rights can be obtained by searching for your water right number from the Division's website at: <http://ciwqs.waterboards.ca.gov/ciwqs/ewrims/EWPublicTerms.jsp>

You are herein advised that unless the Division is informed in writing to the contrary within 30 days of the date of this letter, the Division records will show ownership as follows:

Primary Owner:	Marko Teovski
-----------------------	---------------

If you have any questions regarding your water right(s) please contact the Fee and Data Management Unit at (916) 341-5431 or send an email to eloise.berryman@waterboards.ca.gov.

Sincerely,

Eloise Berryman, Manager
Reporting and Data Management Unit
Division of Water Rights

Enclosure (s):

- Statement July 1 Password Letter
- Water Right April 1 Password Letter
- Registration SIUR for Cannabis Water Right Fact Sheet
- Statements Fact Sheet

cc: ERIC WEGMET
PO BOX 7148
EUREKA, CA 95501

TIMBERLAND RESOURCE CONSULTANTS
165 S FORTUNA BLVD
FORTUNA, CA 95540

E. JOAQUIN ESQUIVEL, CHAIR | EILEEN SOBEC, EXECUTIVE DIRECTOR





GAVIN NEWSOM
GOVERNOR



JARED BLUMENFELD
SECRETARY FOR
ENVIRONMENTAL PROTECTION

State Water Resources Control Board

Page 1 of 1

January 22, 2020

MARKO TEOVSKI
PO BOX 3
MEYERS FLAT, CA 95554

In Reply Refer to:
AW: S025421 et al

Dear Marko Teovski:

NEW PRIMARY OWNER INFORMATION FOR WATER RIGHTS:

S025421, S025422, AND H500602

Owner of Record Information

The Division of Water Rights (Division) received notification on December 9, 2019 that Marko Teovski is now the primary owner of the property served by the water rights listed above. A copy of these water rights can be obtained by searching for your water right number from the Division's website at: <http://ciwqs.waterboards.ca.gov/ciwqs/ewrims/EWPublicTerms.jsp>

You are herein advised that unless the Division is informed in writing to the contrary within 30 days of the date of this letter, the Division records will show ownership as follows:

Primary Owner:	Marko Teovski
-----------------------	---------------

If you have any questions regarding your water right(s) please contact the Fee and Data Management Unit at (916) 341-5431 or send an email to eloise.berryman@waterboards.ca.gov.

Sincerely,

Eloise Berryman, Manager
Reporting and Data Management Unit
Division of Water Rights

Enclosure (s):
Statement July 1 Password Letter
Water Right April 1 Password Letter
Registration SIUR for Cannabis Water Right Fact Sheet
Statements Fact Sheet

cc: ERIC WEGMET PO BOX 7148 EUREKA, CA 95501	TIMBERLAND RESOURCE CONSULTANTS 165 S FORTUNA BLVD FORTUNA, CA 95540
--	--

E. JOAQUIN ESQUIVEL, CHAIR | EILEEN SOBECK, EXECUTIVE DIRECTOR

1001 I Street, Sacramento, CA 95814 | Mailing Address: P.O. Box 100, Sacramento, CA 95812-0100 | www.waterboards.ca.gov

