

# EXHIBIT B

SECTION 6, TOWNSHIP 4 NORTH, RANGE 1 WEST  
SECTIONS 15, 16, 20, 21, 29, 31, 32 TOWNSHIP 5 NORTH, RANGE 1 WEST  
COUNTY OF HUMBOLDT, STATE OF CALIFORNIA



PREPARED BY OR UNDER SUPERVISION OF:

*R. W. Bronkall* 12/17/2021

ROBERT W. BRONKALL, PLS 7645  
HUMBOLDT COUNTY SURVEYOR

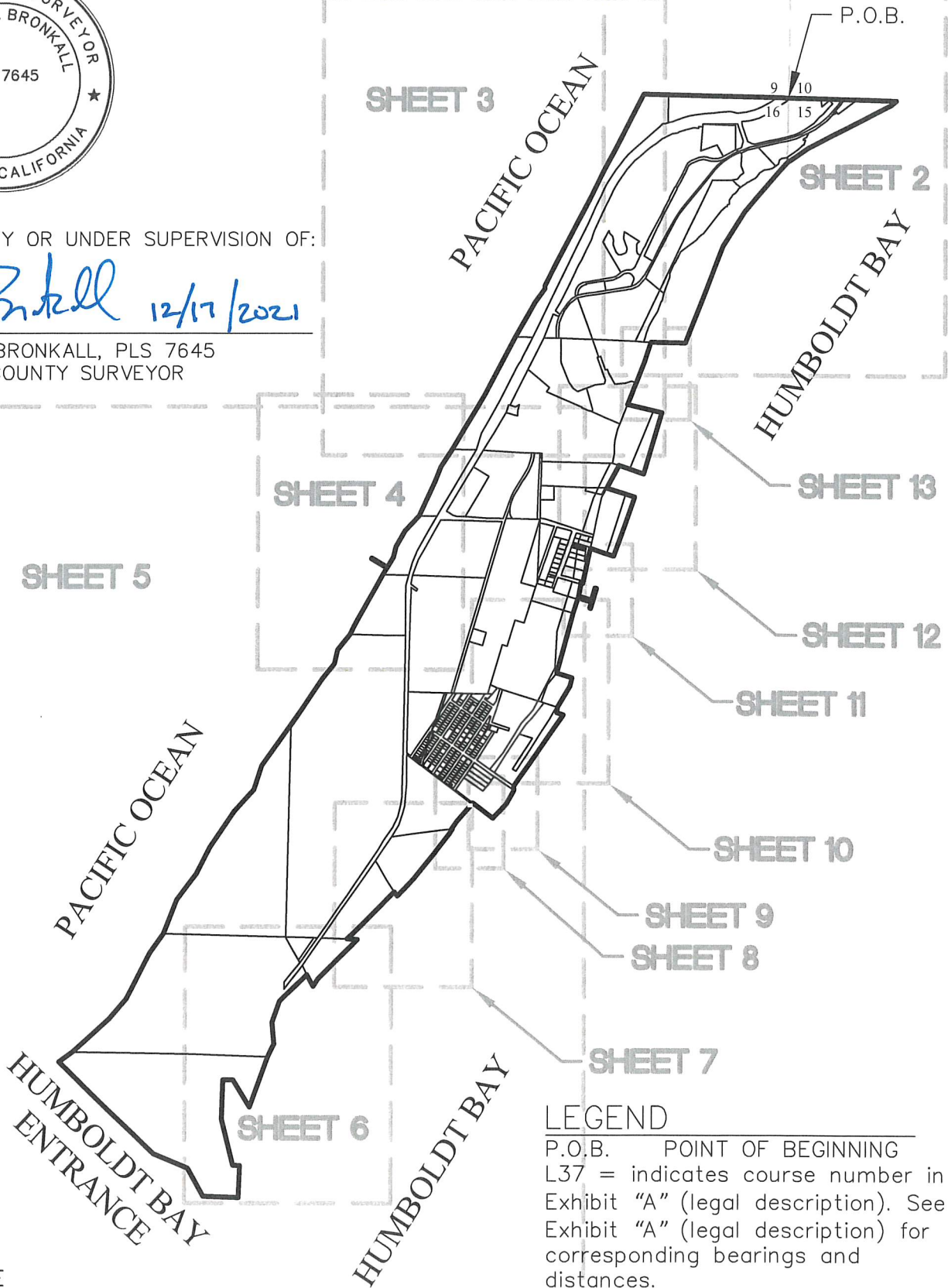

## LEGEND

P.O.B. POINT OF BEGINNING  
L37 = indicates course number in Exhibit "A" (legal description). See Exhibit "A" (legal description) for corresponding bearings and distances.

NOT TO SCALE

PACIFIC OCEAN

NORTH LINE  
SECTION 16

P.O.B. NORTHEAST  
CORNER SECTION 16

NORTH LINE  
SECTION 15

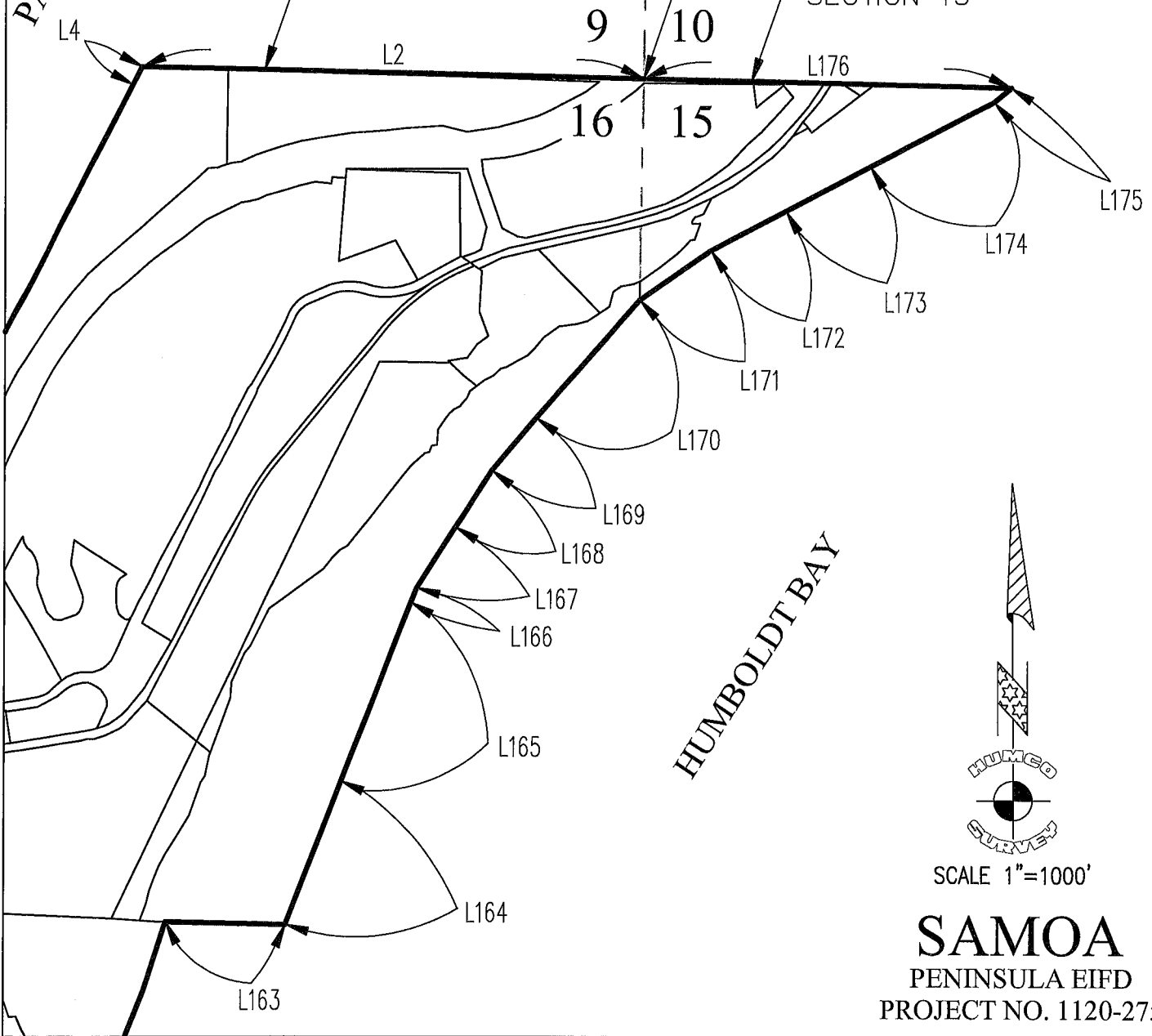

HUMBOLDT BAY

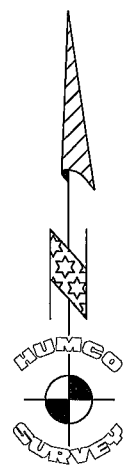

SCALE 1"=1000'

**SAMOA**  
PENINSULA EIFD  
PROJECT NO. 1120-275

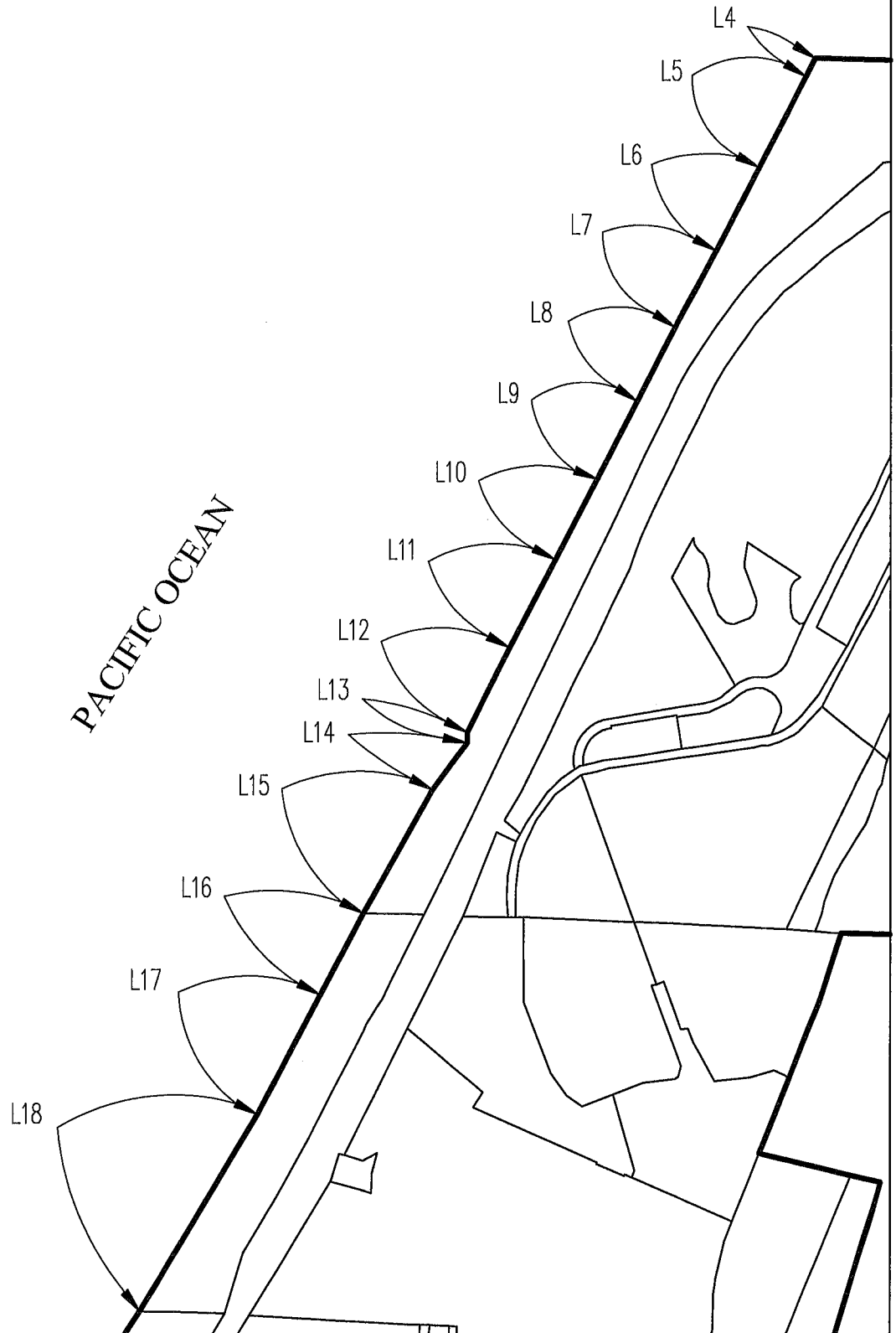
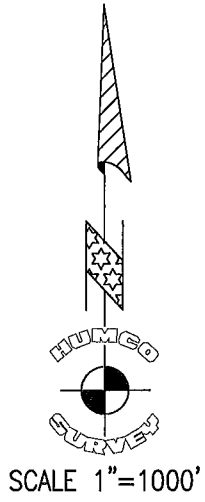

**SAMOA**  
PENINSULA EIFD  
PROJECT NO. 1120-275

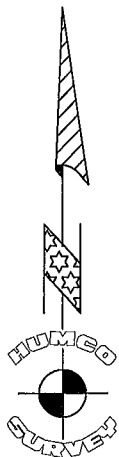

SCALE 1"=600'

PACIFIC OCEAN

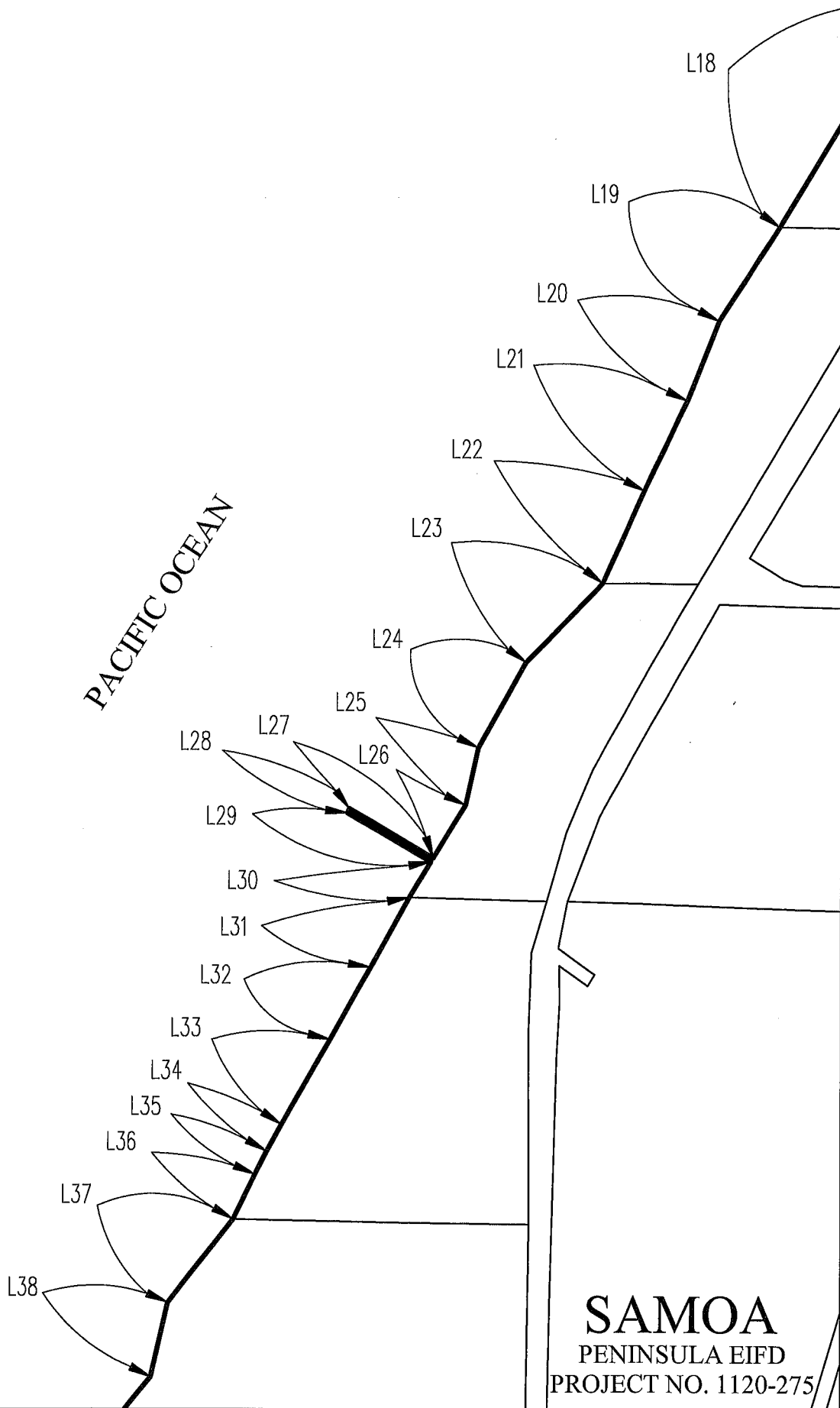

**SAMOA**  
PENINSULA EIFD  
PROJECT NO. 1120-275

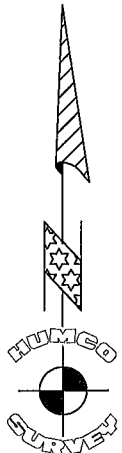

SCALE 1"=2000'

PACIFIC OCEAN

HUMBOLDT BAY ENTRANCE

HUMBOLDT BAY

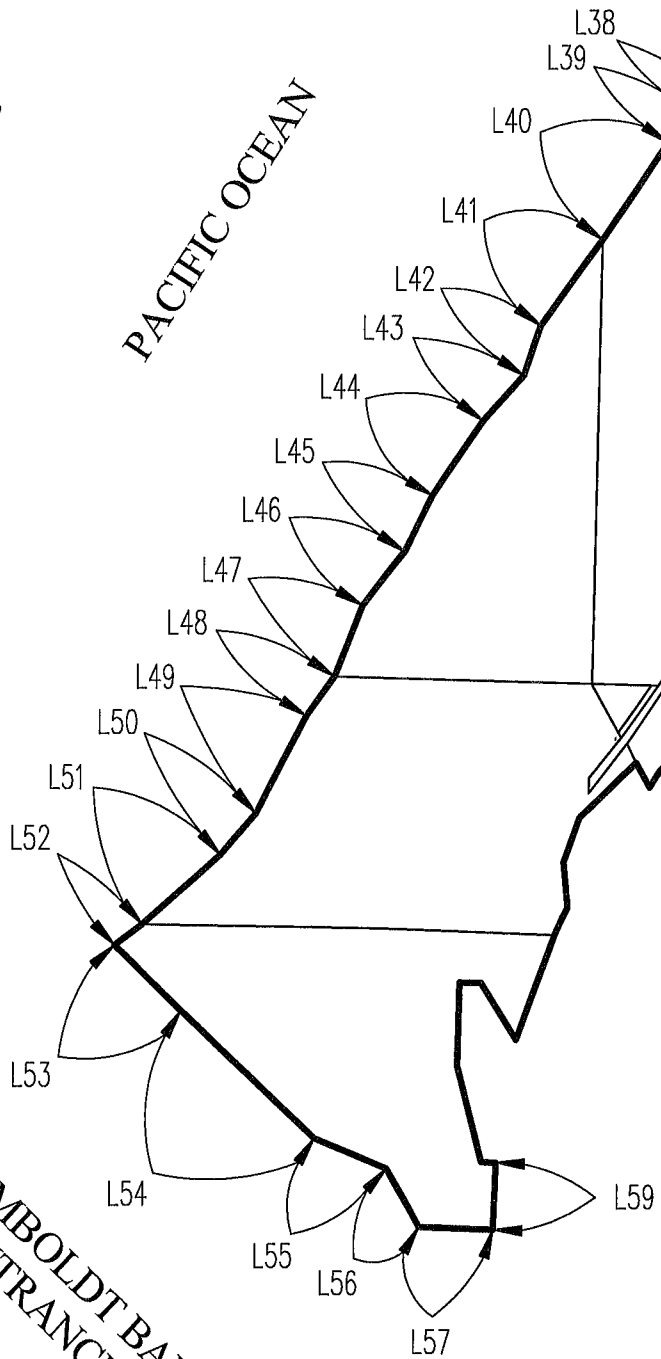

**SAMOA**  
PENINSULA EIFD  
PROJECT NO. 1120-275

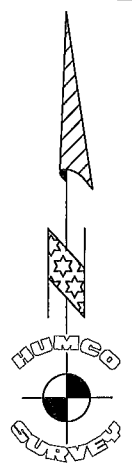

SCALE 1"=600'

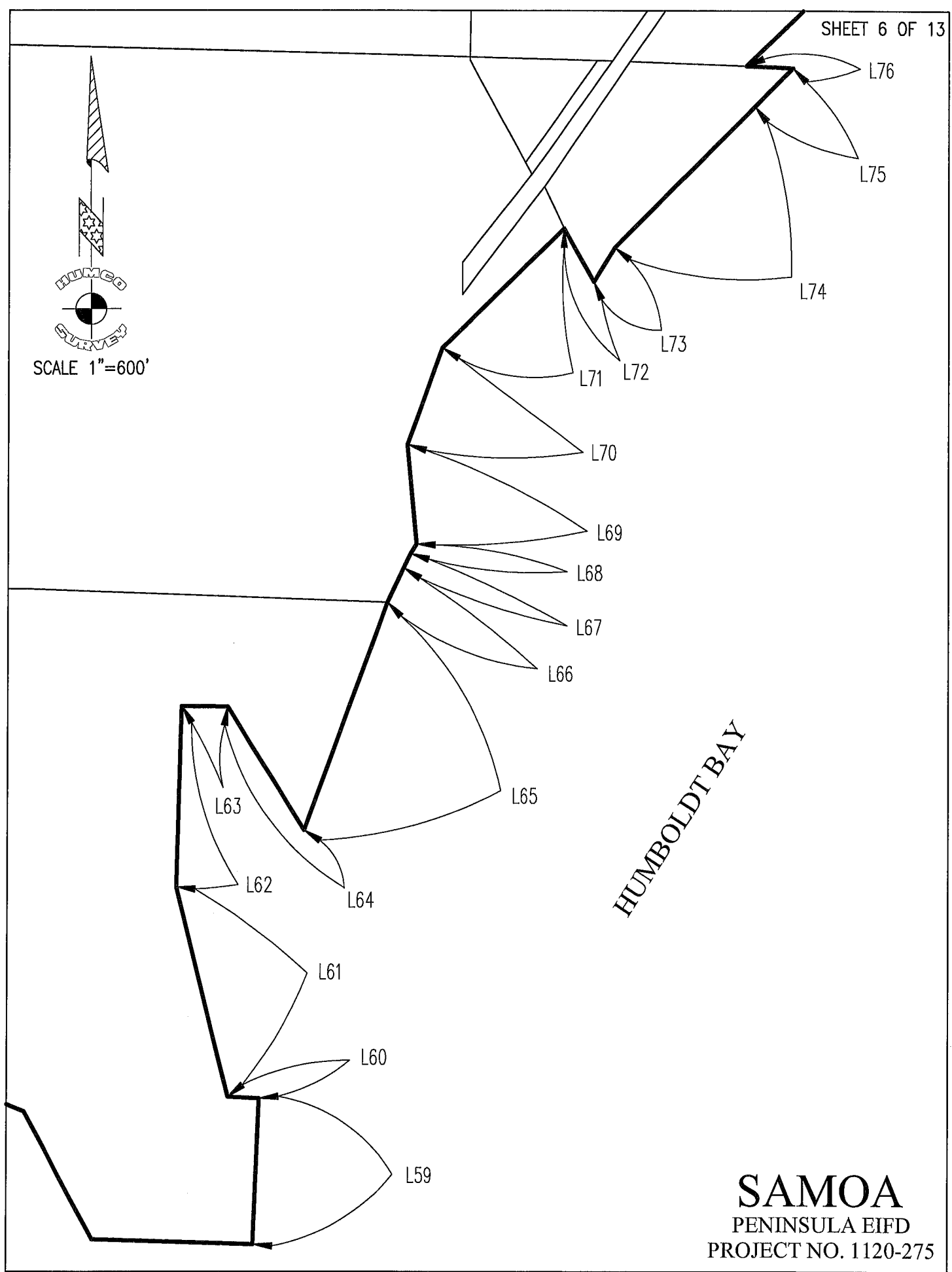

HUMBOLDT BAY

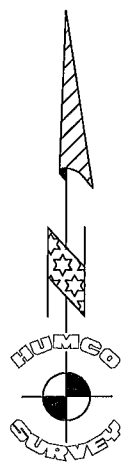

SCALE 1"=400'

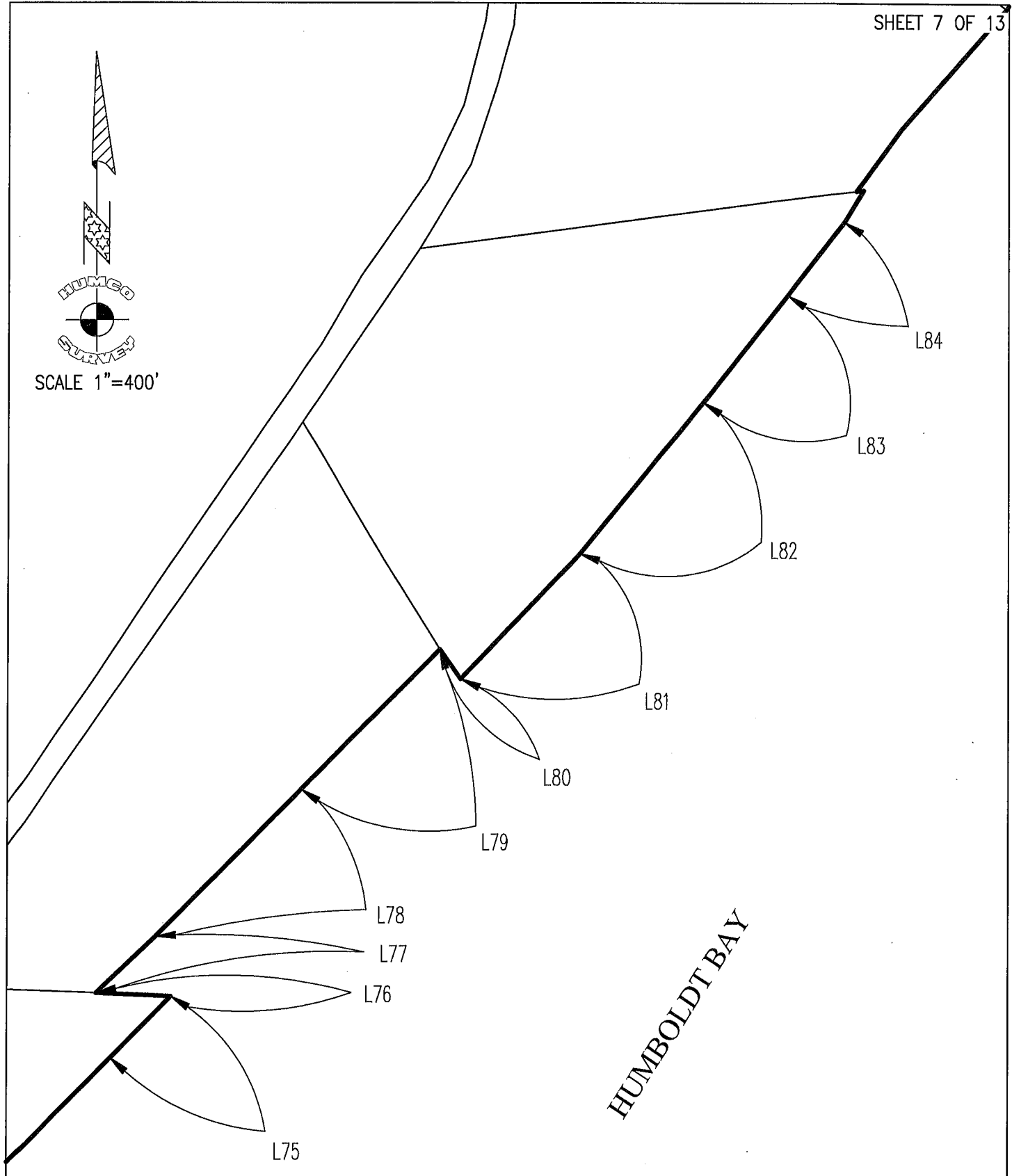

HUMBOLDT BAY

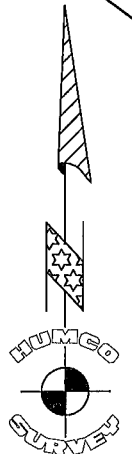

SCALE 1"=200'

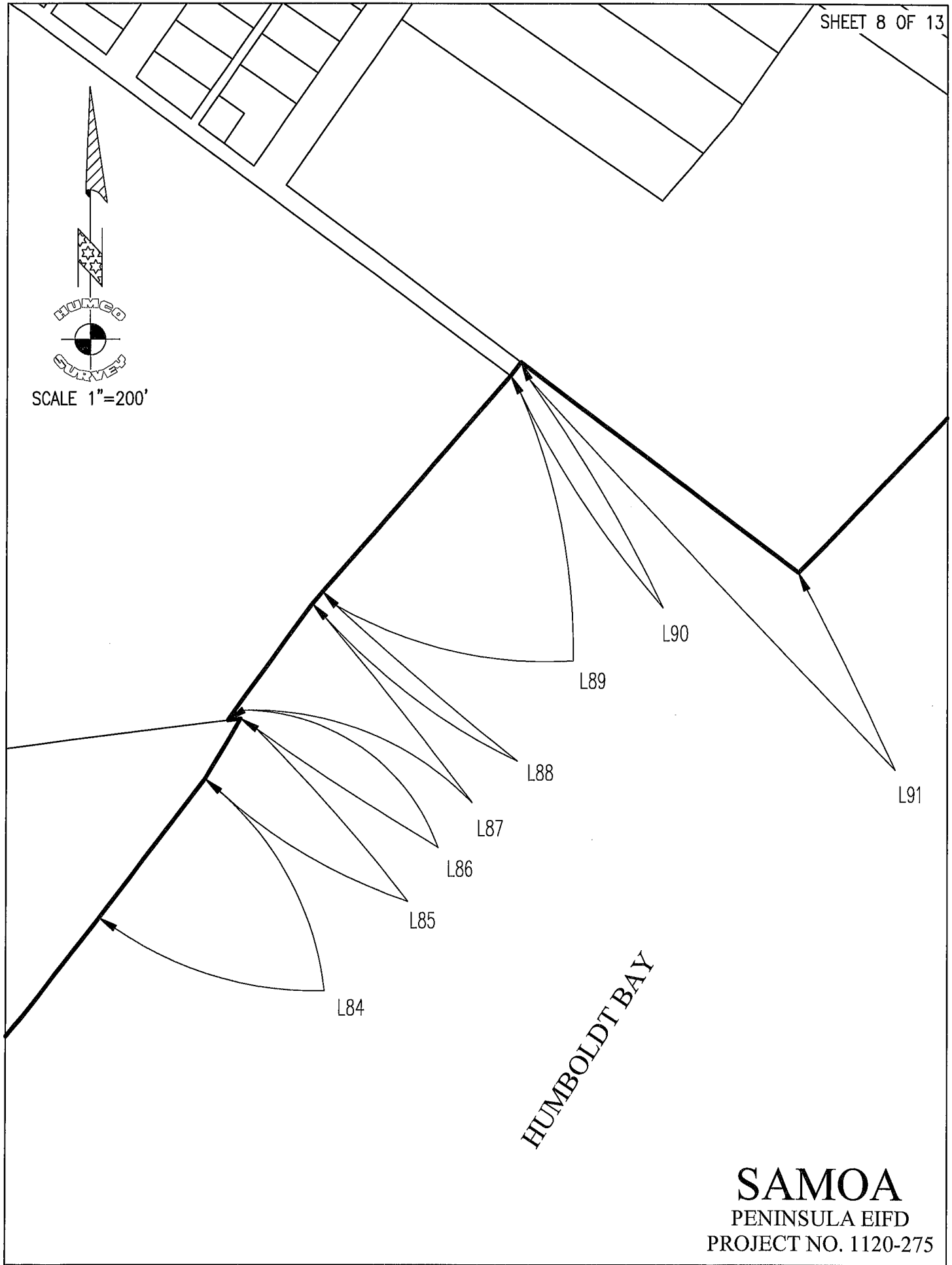

**SAMOA**  
PENINSULA EIFD  
PROJECT NO. 1120-275



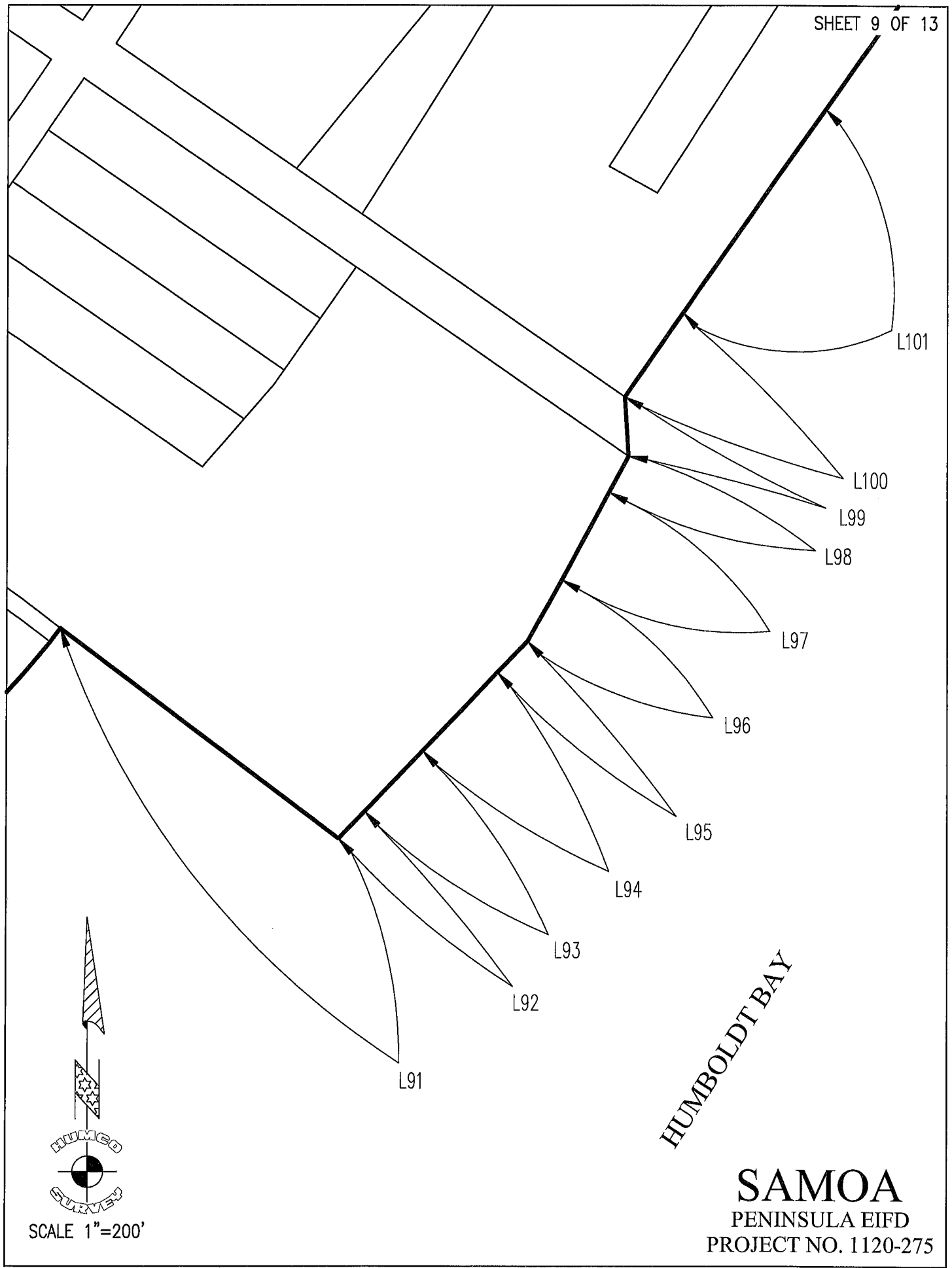

HUMBOLDT BAY

**SAMOA**

PENINSULA EIFD  
PROJECT NO. 1120-275

SCALE 1"=200'



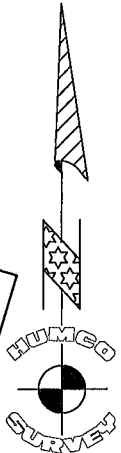

SCALE 1"=400'

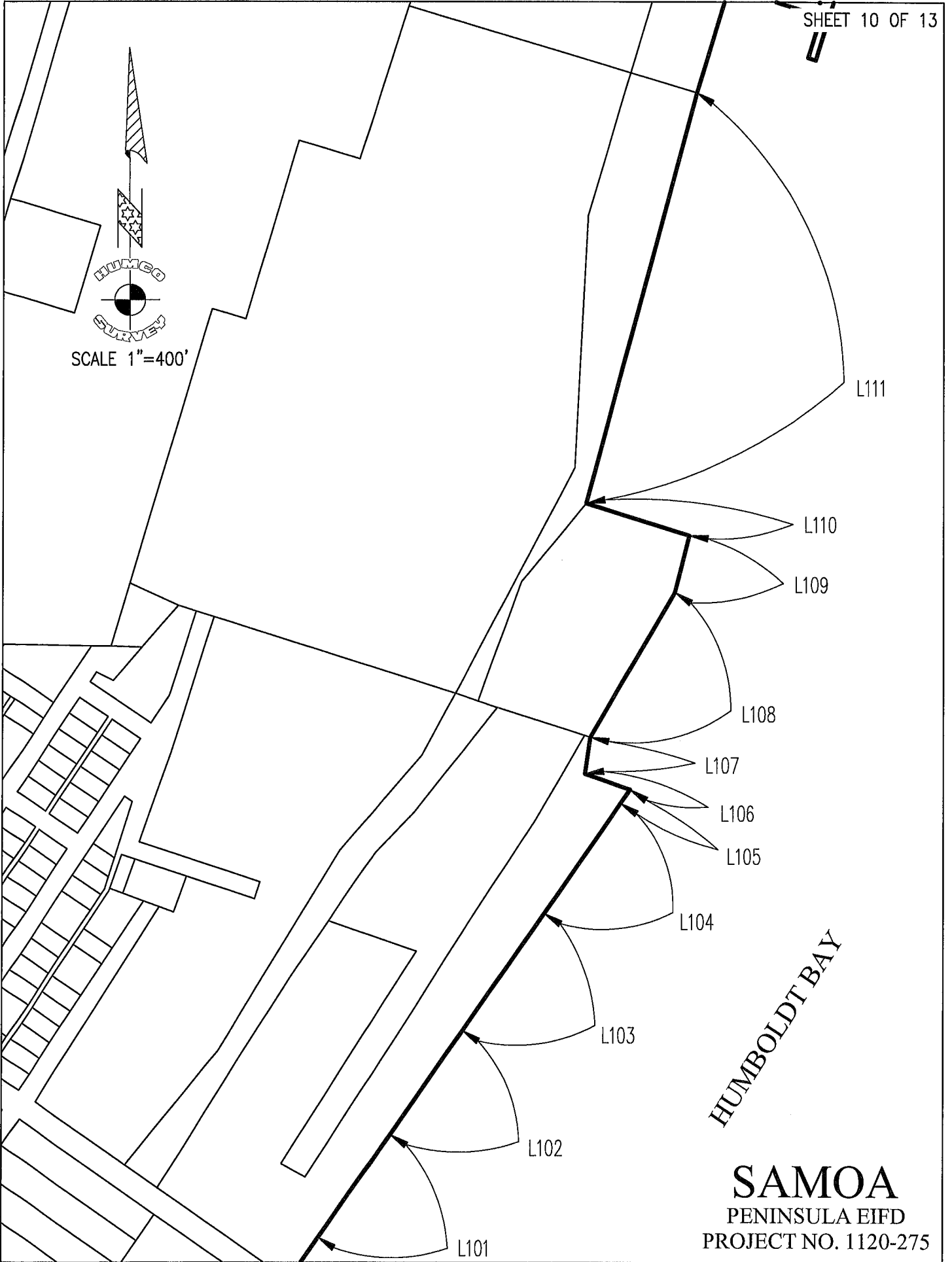

HUMBOLDT BAY

**SAMOA**  
PENINSULA EIFD  
PROJECT NO. 1120-275

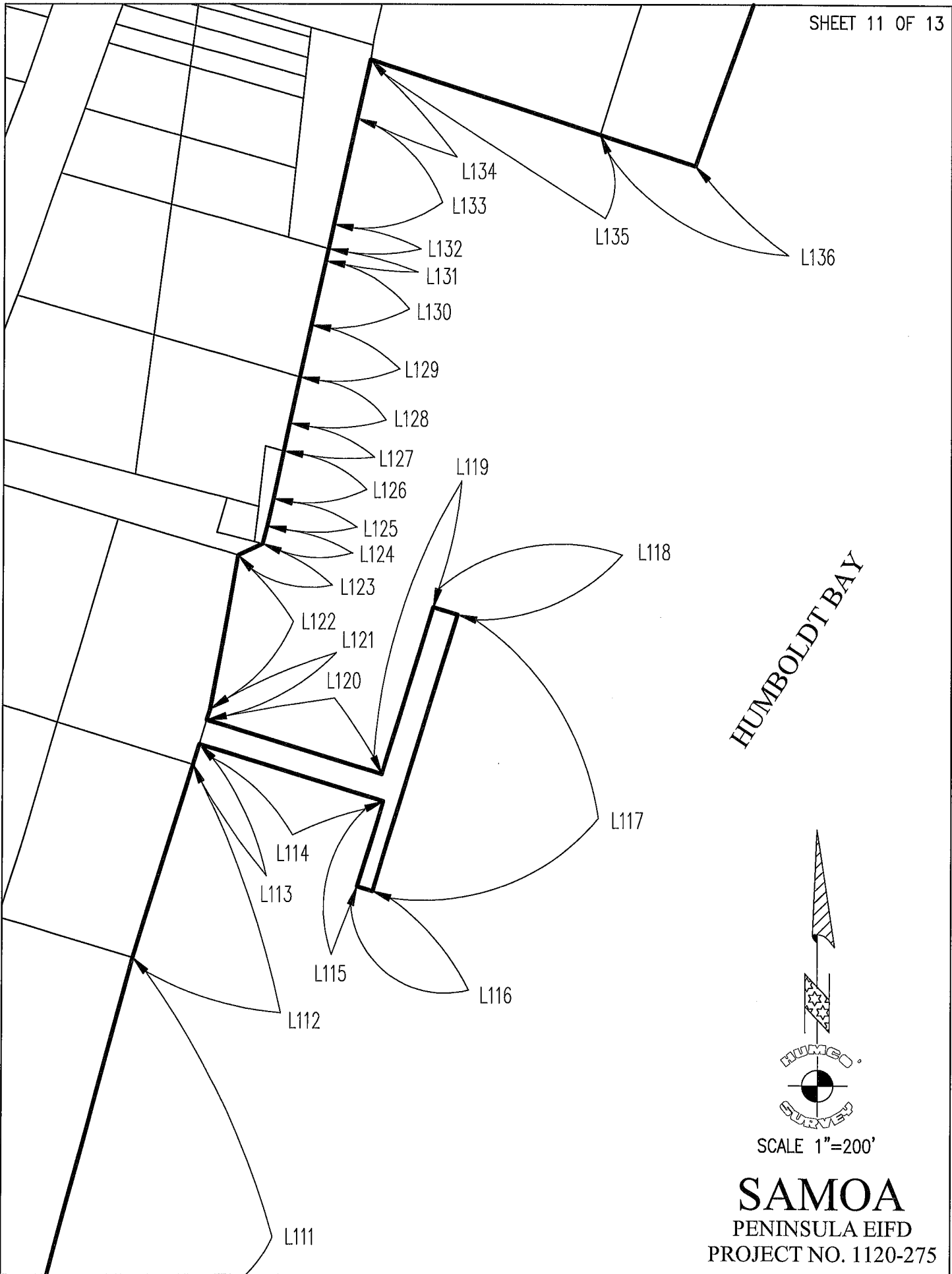

HUMBOLDT BAY

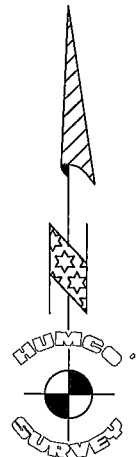

SCALE 1"=200'

**SAMOA**  
PENINSULA EIFD  
PROJECT NO. 1120-275

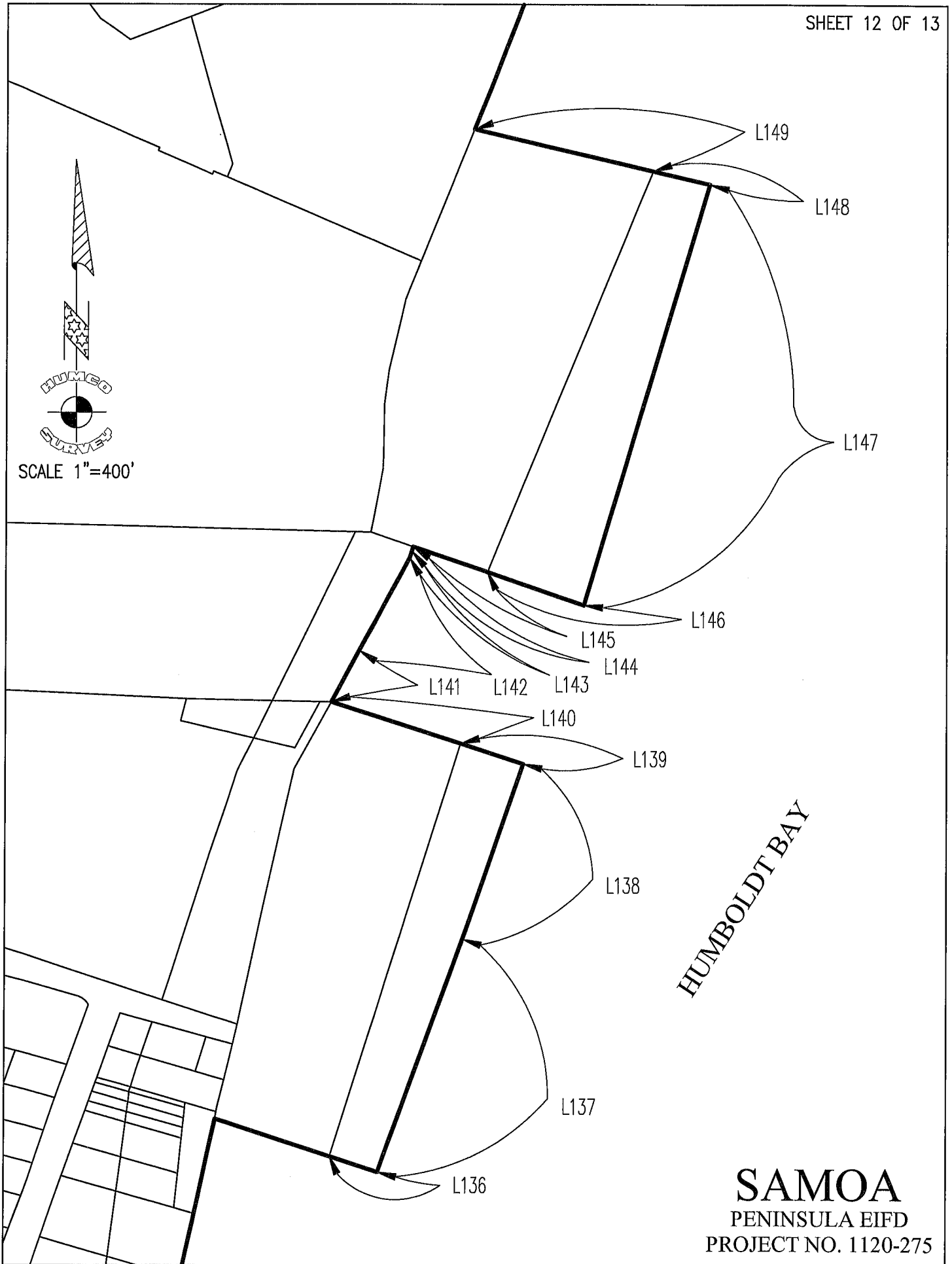

SCALE 1"=400'

HUMBOLDT BAY

**SAMOA**  
PENINSULA EIFD  
PROJECT NO. 1120-275

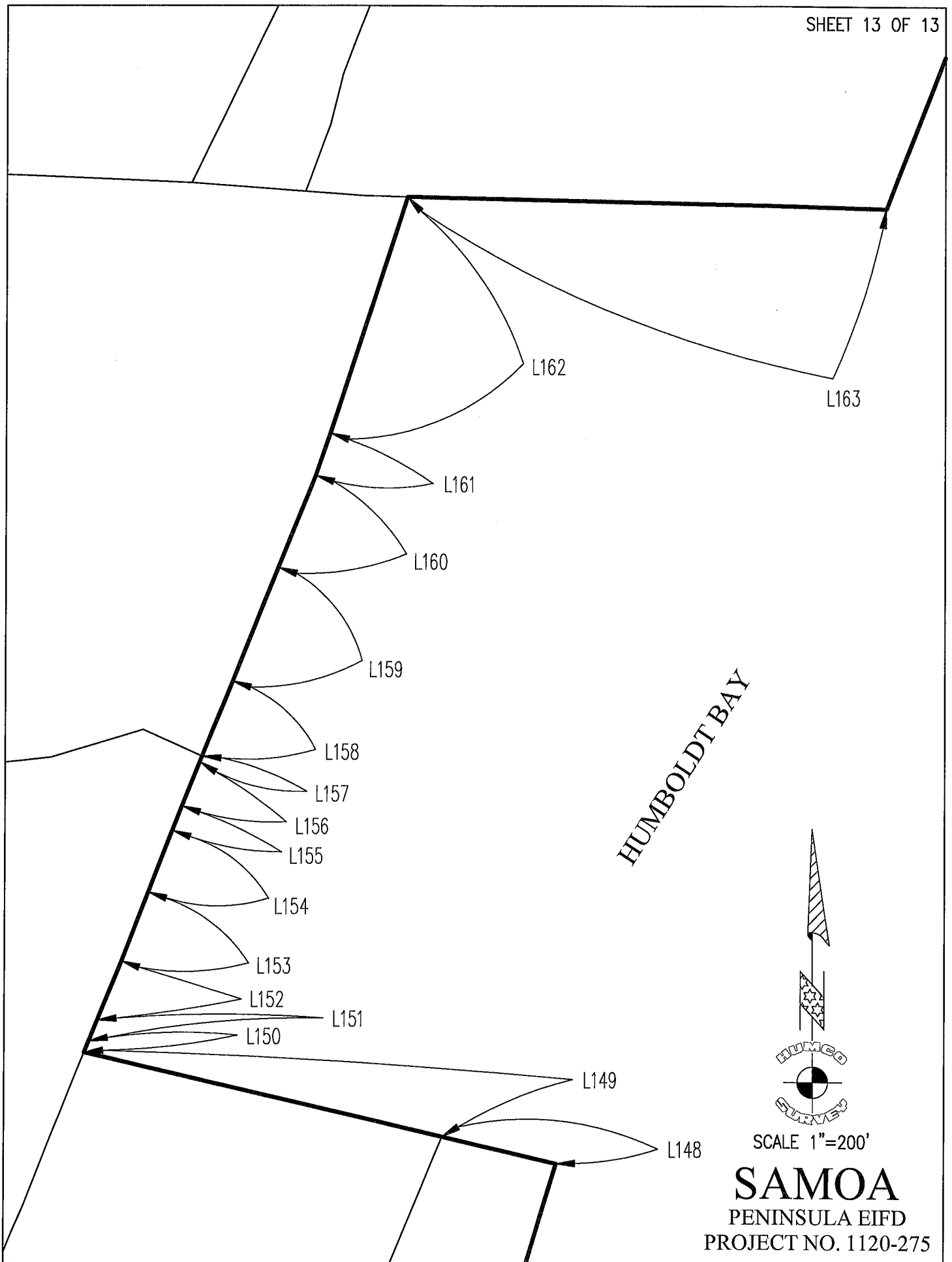

HUMBOLDT BAY

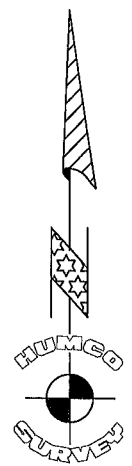

SCALE 1"=200'

**SAMOA**  
PENINSULA EIFD  
PROJECT NO. 1120-275