

**LOCATION MAP**

**PROPOSED J & J FAMILY LLC  
 LOT LINE ADJUSTMENT,  
 ZONE BOUNDARY ADJUSTMENT &  
 CONDITIONAL USE PERMIT**

**EUREKA AREA  
 PLN-2020-16400**

**APN: 015-111-006, -012, -013  
 T5N R1W S25 HB&M (Eureka)**

Project Area = 

This map is intended for display purposes and should not be used for precise measurement or navigation. Data has not been completely checked for accuracy.





**AERIAL MAP**

**PROPOSED J & J FAMILY LLC  
 LOT LINE ADJUSTMENT,  
 ZONE BOUNDARY ADJUSTMENT &  
 CONDITIONAL USE PERMIT**

**EUREKA AREA  
 PLN-2020-16400**

**APN: 015-111-006, -012, -013  
 T5N R1W S25 HB&M (Eureka)**

**Project Area =** 

This map is intended for display purposes and should not be used for precise measurement or navigation. Data has not been completely checked for accuracy.

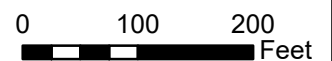



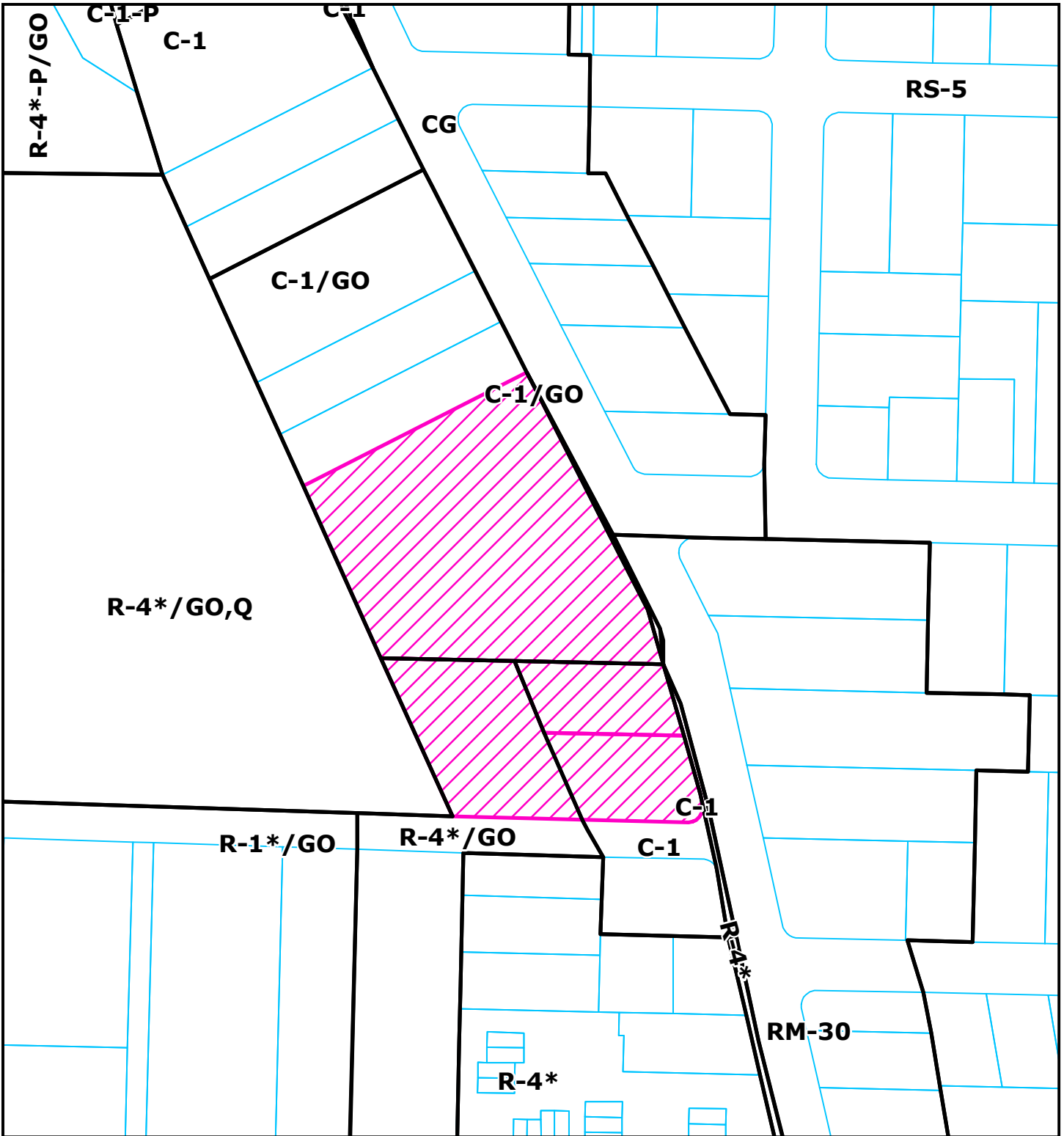

**ZONING MAP**

**PROPOSED J & J FAMILY LLC  
 LOT LINE ADJUSTMENT,  
 ZONE BOUNDARY ADJUSTMENT &  
 CONDITIONAL USE PERMIT**

**EUREKA AREA  
 PLN-2020-16400**

**APN: 015-111-006, -012, -013  
 T5N R1W S25 HB&M (Eureka)**

**Project Area =** 

This map is intended for display purposes and should not be used for precise measurement or navigation. Data has not been completely checked for accuracy.



0 100  
 Feet

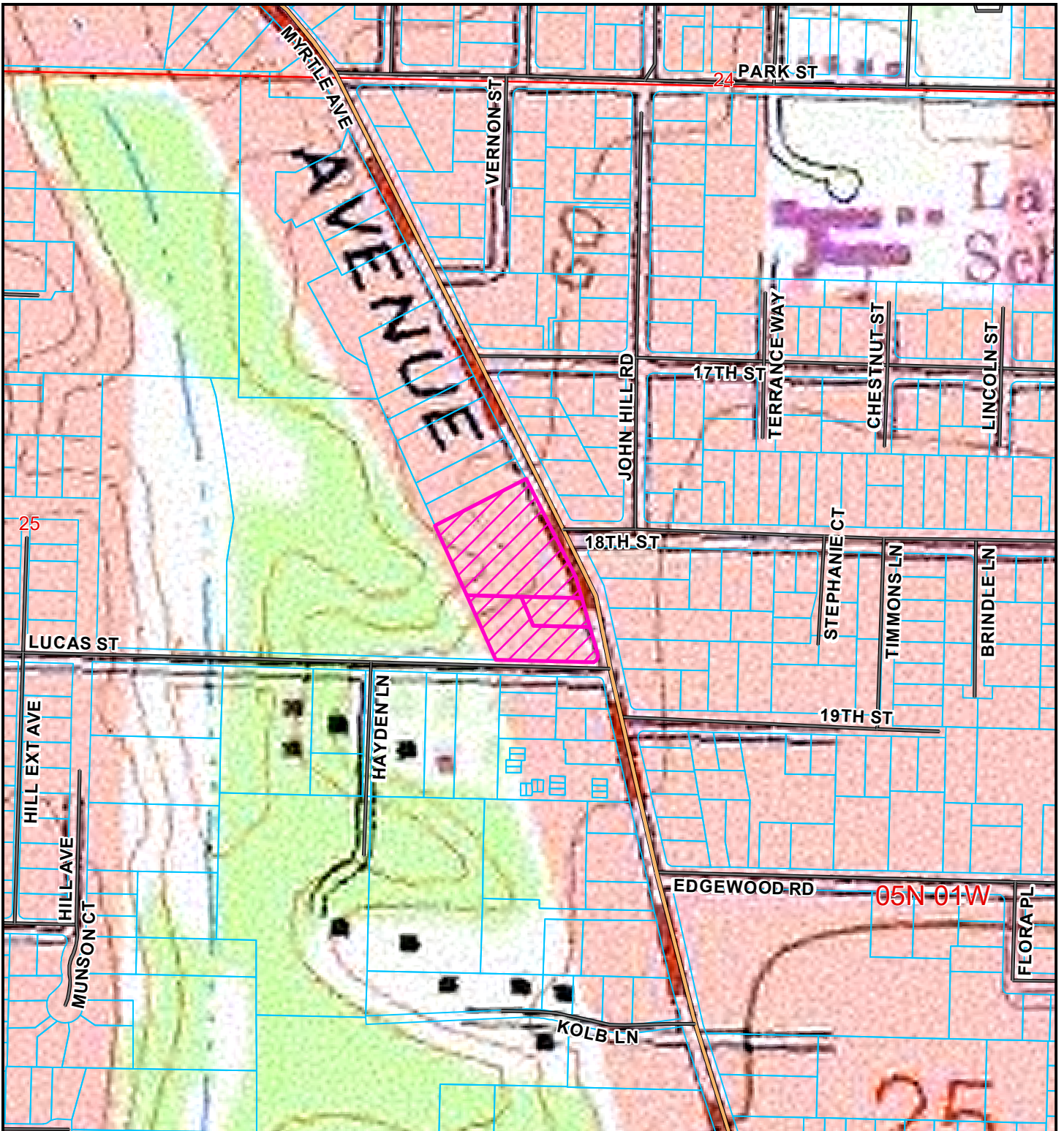

**TOPO MAP**

**PROPOSED J & J FAMILY LLC  
LOT LINE ADJUSTMENT,  
ZONE BOUNDARY ADJUSTMENT &  
CONDITIONAL USE PERMIT**

**EUREKA AREA  
PLN-2020-16400**

**APN: 015-111-006, -012, -013  
T5N R1W S25 HB&M (Eureka)**

Project Area = 

This map is intended for display purposes and should not be used for precise measurement or navigation. Data has not been completely checked for accuracy.

