

BAR IS ONE INCH ON ORIGINAL DRAWING  IF NOT ONE INCH ON THIS SHEET, ADJUST SCALES ACCORDINGLY	ROAD NAME: CENTRAL AVENUE	DESIGN SECTION: ENGINEERING	<b>COUNTY OF HUMBOLDT</b> <b>DEPARTMENT OF PUBLIC WORKS</b> <b>CENTRAL AVENUE PM 0.00-0.30 SHOULDER WIDENING</b> <b>COVER SHEET, SHEET INDEX AND MAPS</b>	SHEET <b>1</b> OF <b>12</b>
	ROAD NO.: 4L800	MILE POST: 0.00-0.30		
	AGREEMENT NO.: RPL-5904(177)	DESIGNED BY: MMS/RLB		
	CONTRACT NO.: 321617	DRAWN BY: MMS/RLB		
	DRAWING FILE NAME: 321617_Design Final 2-15-2022	REVIEWED BY: JAB		
	PLOT DATE: 2/28/2022	APPROVED BY: TRS		

**FUNDING SOURCE**

THIS PROJECT IS FUNDED THROUGH THE STATE TRANSPORTATION REGIONAL IMPROVEMENT PROGRAM

**COUNTY OF HUMBOLDT**  
**DEPARTMENT OF PUBLIC WORKS**  
**PROJECT PLANS FOR CONSTRUCTION OF**  
**CENTRAL AVENUE (4L800)**  
**at P.M. 0.00-0.30**  
**SHOULDER WIDENING**  
**PROJECT NO. RPL-5904(177)**  
**CONTRACT NO. 321617**

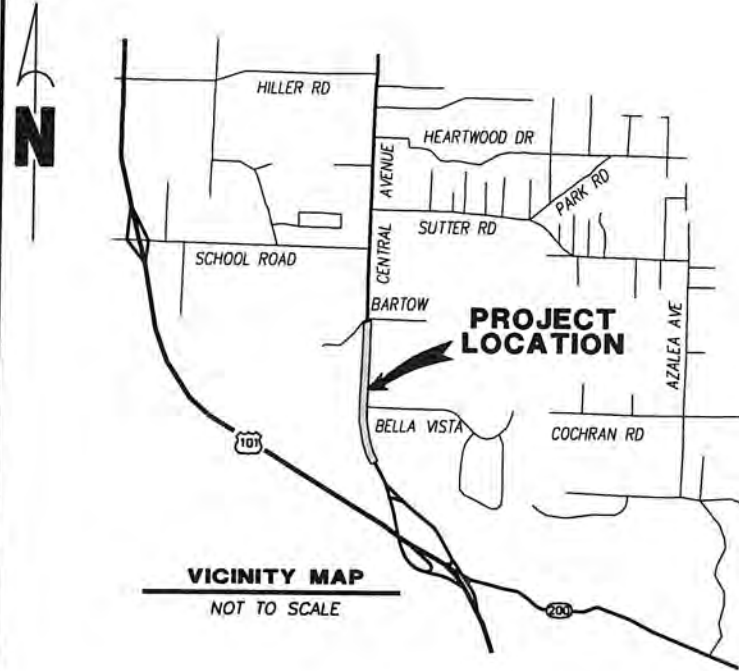
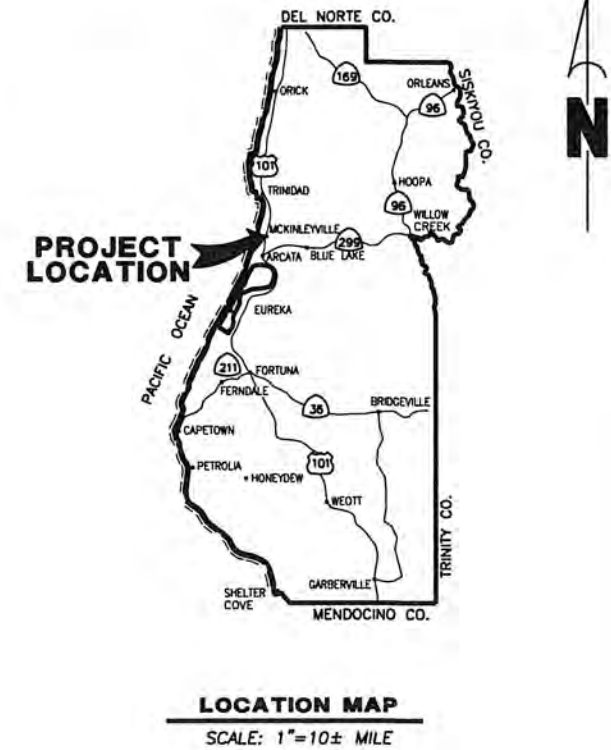

**INDEX OF SHEETS**

- 1 COVER SHEET, SHEET INDEX, AND MAPS
- 2 CONSTRUCTION AREA SIGNS & QUANTITIES
- 3 SURVEY CONTROL
- 4 TYPICAL SECTIONS
- 5 STRIPING AND UTILITIES
- 6 PLAN AND PROFILE
- 7 DRAINAGE PLAN AND PROFILE
- 8 EROSION CONTROL
- 9-12 SECTION VIEWS

**NOTES**

THE CONTRACTOR SHALL HAVE A CLASS "A" LICENSE FOR THIS PROJECT.  
 PROJECT PLANS AND SPECIAL PROVISIONS TO BE SUPPLEMENTED BY THE STATE OF CALIFORNIA DEPARTMENT OF TRANSPORTATION STANDARD PLANS, STANDARD SPECIFICATIONS, AND THE LATEST REVISED 2018 STANDARD SPECIFICATIONS  
 (SEE APPLICABLE STAN PLAN LIST IN SPECIAL PROVISIONS)

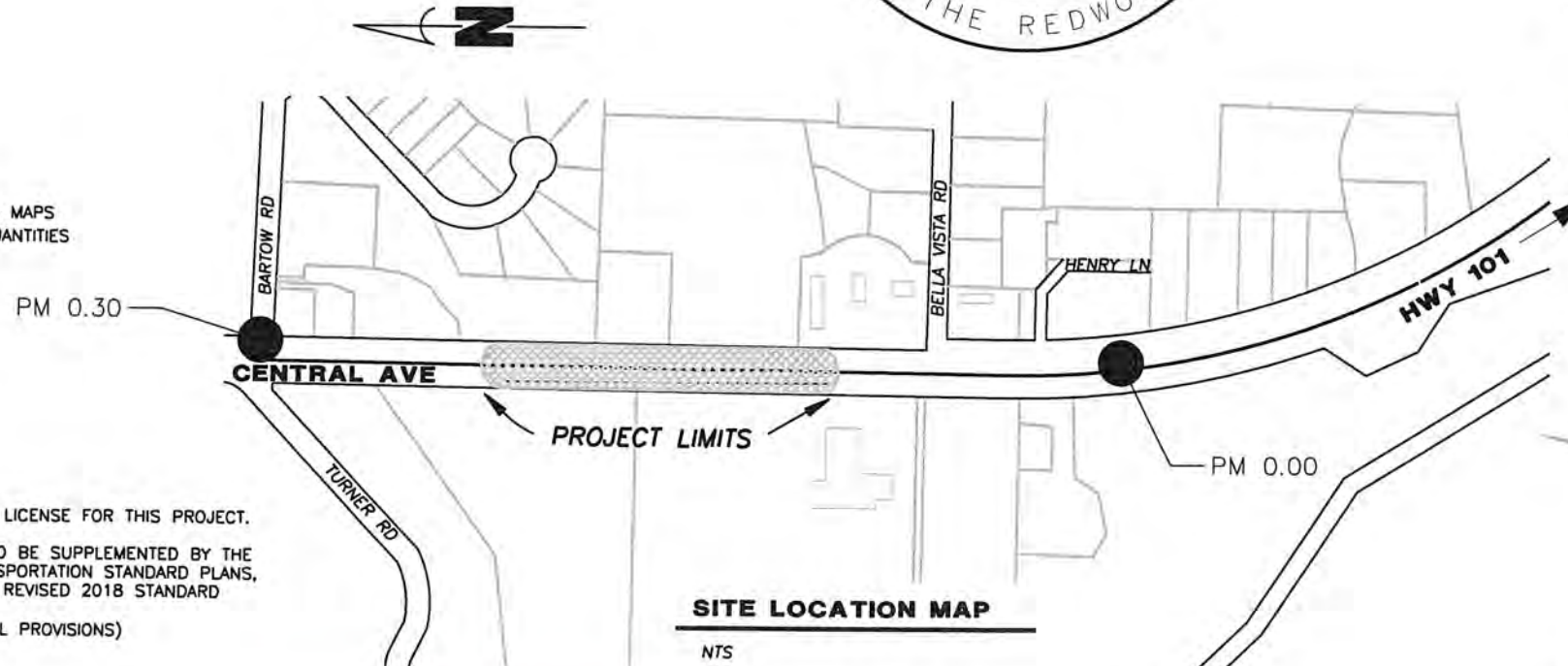

**RECOMMENDED**

*Jeffrey A. Ball* 2/28/2022  
 JEFFREY A. BALL DATE  
 RCE 70631, EXP. 6/30/2023



**APPROVED**

*Tony R. Seghetti* 2/28/22  
 TONY R. SEGHETTI DATE  
 RCE 63714, EXP. 9/30/2022



ORIGINAL LOW BID PRICE	CONSTRUCTED BY	RESIDENT ENGINEER
	PROJECT COMPLETED	CONSTRUCTION COST \$



ROAD NAME: CENTRAL AVENUE	DESIGN SECTION: ENGINEERING
ROAD NO.: 4L800	MILE POST: 0.00-0.30
AGREEMENT NO.: RPL-5904(177)	DESIGNED BY: MMS/RLB
CONTRACT NO.: 321617	DRAWN BY: MMS/RLB
DRAWING FILE NAME: 321617_Design Final 2-15-2022	REVIEWED BY: JAB
PLOT DATE: 2/28/2022	APPROVED BY: TRS

<b>COUNTY OF HUMBOLDT</b> <b>DEPARTMENT OF PUBLIC WORKS</b>	SHEET <b>2</b> OF <b>12</b>
<b>CENTRAL AVENUE PM 0.00-0.30 SHOULDER WIDENING</b>	
<b>CONSTRUCTION AREA SIGNS AND QUANTITIES</b>	

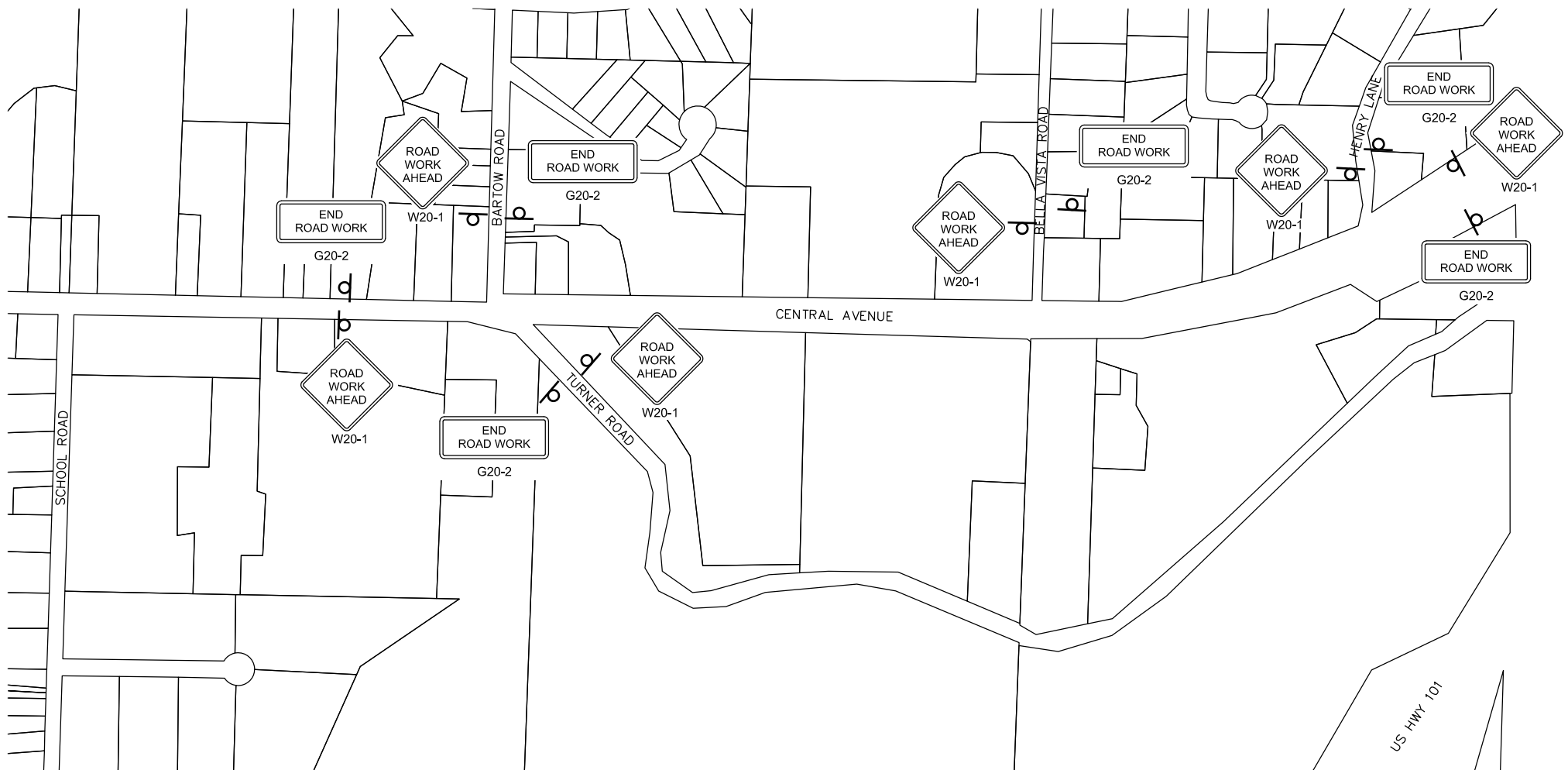

**CONSTRUCTION AREA SIGNS**  
SCALE: 1"=100'

QUANTITIES				
ITEM NO.	ITEM CODE	ITEM DESCRIPTION	UNIT	TOTAL
1	120090	Construction Area Signs	EA	12
2	120100	Traffic Control System	LS	1
3	130100	Job Site Management	LS	1
4	130200	Prepare Water Pollution Control Program	LS	1
5	170103	Clearing and Grubbing (LS)	LS	1
6	190101	F Roadway Excavation	CY	550
7	198050	Embankment	CY	61
8	210212	Dry Seed (SQFT)	SQFT	2,400
9	210280	Rolled Erosion Control Product (Blanket)	SQFT	1,870
10	210350	Fiber Rolls	LF	375
11	210420	Straw	SQFT	530
12	260203	F Class 2 Aggregate Base (CY)	CY	210
13	390132	Hot Mix Asphalt (Type A)	TON	179
14	394073	Place Hot Mix Asphalt Dike (Type A)	LF	1,174
15	398100	Remove Asphalt Concrete Dike	LF	94
16	510094A	F Minor Concrete, Drainage Inlet (Type G0)	EA	1
17	641107	18" Plastic Pipe	LF	115
18	722020	F Gabion (3'x3'x6')	CY	100
19	750500A	F Miscellaneous Metal (24-12X Bike-Safe Inlet Grate) (Galvanized)	LB	239
20	820610	Relocate Roadside Sign	EA	4
21	840501	Thermoplastic Traffic Stripe	LF	1,208
22	999990	Mobilization	LS	1

**NOTES**

- 1) SIGNS SHALL BE PLACED AS SHOWN ON PLAN OR AS DIRECTED BY THE ENGINEER.
- 2) FINAL PLACEMENT OF SIGNS SHALL BE APPROVED BY RESIDENT ENGINEER.
- 3) ADDITIONAL PORTABLE SIGNS SHALL BE USED AS REQUIRED FOR OTHER ROADSIDE WORK.
- 4) SEE STANDARD PLAN T13 FOR TRAFFIC CONTROL SYSTEM.
- 5) IN ADDITION TO CONSTRUCTION AREA SIGNS AND WHEN DIRECTED BY THE RESIDENT ENGINEER, THE CONTRACTOR SHALL UTILIZE FLAGMEN AS NECESSARY TO DIRECT TRAFFIC.
- 6) DISTANCE TO W20-1 AND G20-2 MAY BE EXTENDED TO ENCOMPASS SITES WITHIN ONE MILE OF EACH OTHER.
- 7) KEEP A MINIMUM OF 1 TRAFFIC LANE AT LEAST 10' WIDE OPEN FOR TRAFFIC, EXCEPT THE FULL WIDTH OF THE TRAVELED WAY MUST BE OPEN WHEN CONSTRUCTION OPERATIONS ARE NOT ACTIVE OR AN APPROVED TRAFFIC CONTROL PLAN IS IN PLACE

**CONSTRUCTION AREA SIGN SUMMARY**

SIGN TYPE	QTY	DESCRIPTION	SIZE	REMARKS	POST SIZE	NUMBER
W20-1	6	ROAD WORK AHEAD	48" x 48"	VISIBLE AT ALL TIMES	4" x 4"	1
G20-2	6	END ROAD WORK	36" x 18"	VISIBLE AT ALL TIMES	4 x 4	1

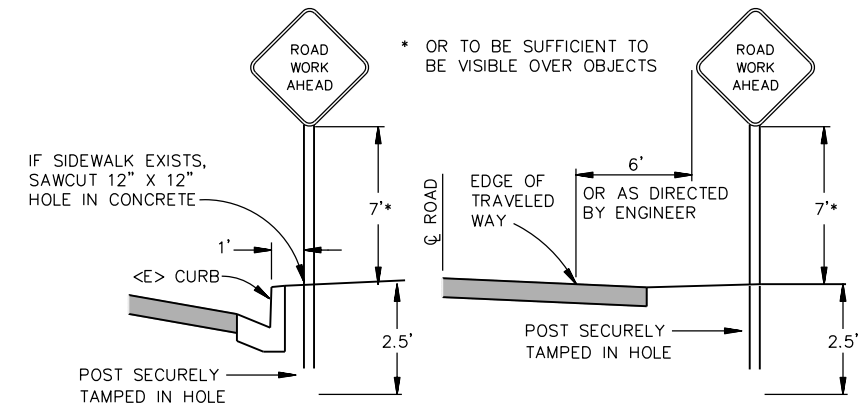

**URBAN CONSTRUCTION AREA SIGN**  
- NOT TO SCALE -



BAR IS ONE INCH ON ORIGINAL DRAWING  IF NOT ONE INCH ON THIS SHEET, ADJUST SCALES ACCORDINGLY	ROAD NAME: CENTRAL AVENUE	DESIGN SECTION	<b>COUNTY OF HUMBOLDT</b> <b>DEPARTMENT OF PUBLIC WORKS</b> <b>CENTRAL AVENUE PM 0.00-0.30 SHOULDER WIDENING</b> <b>SURVEY CONTROL</b>	SHEET <b>3</b> OF <b>12</b>	
	ROAD NO.: 4L800	MILE POST: 0.00-0.30			ENGINEERING
	AGREEMENT NO.: RPL-5904(177)				DESIGNED BY: MMS/RLB
	CONTRACT NO.: 321617				DRAWN BY: MMS/RLB
	DRAWING FILE NAME: 321617_Design Final 2-15-2022	REVIEWED BY: JAB			
	PLOT DATE: 2/28/2022	APPROVED BY: TRS			

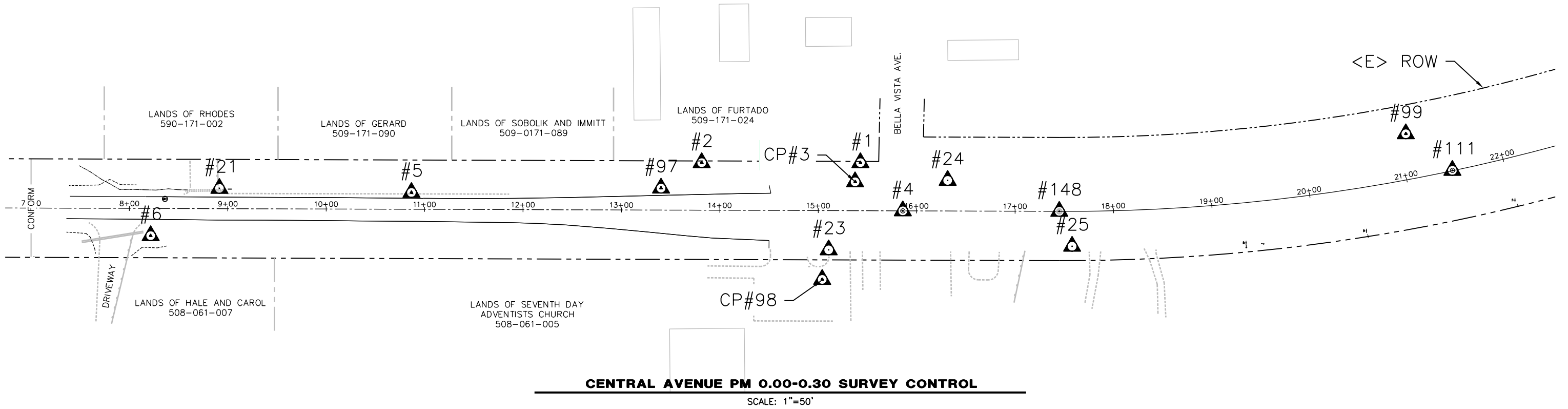

**CENTRAL AVENUE PM 0.00-0.30 SURVEY CONTROL**  
SCALE: 1"=50'

**SURVEY CONTROL & MONUMENT COORDINATES**

Point	Northing	Easting	Elev.	Description
1	20554.2093	29970.6674	184.97	CP1 60DNAIL
2	20715.5108	29970.6674	186.25	CP2 60DNAIL
3	20559.5999	29951.2494	184.71	FDMAGNAIL
4	20511.0975	29921.7829	185.90	CLMONLID
5	21010.4222	29940.4177	161.80	SET60DNAIL
6	21275.3947	29896.5779	145.02	SET80DNAIL
21	21205.5980	29944.5030	150.13	CP/MAG&TAGHUMCOSURVEY
22	20853.7450	29939.6200	171.13	CP/MAGS
23	20586.4460	29882.1840	183.16	CP/MAG&TAGHUMCOSURVEY
24	20465.5760	29952.6320	185.17	CP/MAG&TAGHUMCOSURVEY
25	20339.0810	29885.7880	185.50	CP/MAG&TAGHUMCOSURVEY
97	20756.7952	29944.8168	176.27	CPCN&S
98	20593.0463	29852.1370	182.40	CPCN&S
99	20000.00	30000.00	183.12	CP60DNAIL
111	19952.6578	29962.8512	172.91	CLMONLID
148	20352.0227	29921.3847	185.90	CLMONLID
151	21978.0350	29926.4405	123.44	CLMONLID

SURVEY NOTES:  
 POINTS FROM FIELD SURVEYS PERFORMED 1/27/2010, 5/16/2012, 1/2/2013, AND 2/2/2021.  
 DATUM AND BASIS OF BEARING ASSUMED.  
 RIGHT OF WAY: MINIMUM WIDTH IS 50' EITHER SIDE OF CENTERLINE.  
 APN PROPERTY LINES ARE NOT A PRODUCT OF SURVEY

**MONUMENT PRESERVATION NOTES**

- CONTRACTOR TO USE EXTREME CAUTION WHILE WORKING IN THE VICINITY OF MONUMENTS.
- IMMEDIATELY CONTACT THE HUMBOLDT COUNTY SURVEY DIVISION (707)445-7205, IF MONUMENTS ARE DISTURBED OR WILL BE IMPACTED BY CONSTRUCTION WORK.
- HISTORICAL MONUMENTS ARE POINT #'S 4, 111, 148, AND 151

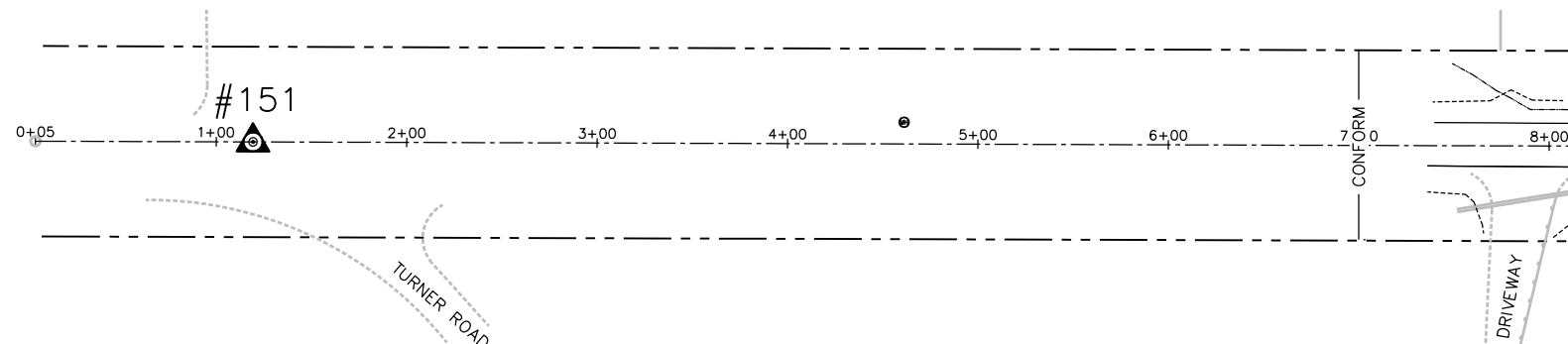

**CENTRAL AVENUE PM 0.00-0.30 NORTH SURVEY CONTROL**  
SCALE: 1"=50'



BAR IS ONE INCH ON ORIGINAL DRAWING  IF NOT ONE INCH ON THIS SHEET, ADJUST SCALES ACCORDINGLY	ROAD NAME: CENTRAL AVENUE	DESIGN SECTION	
	ROAD NO: 4L800	MILE POST: 0.00-0.30	ENGINEERING
	AGREEMENT NO.: RPL-5904(177)	DESIGNED BY: MMS/RLB	
	CONTRACT NO.: 321617	DRAWN BY: MMS/RLB	
	DRAWING FILE NAME: 321617_Design Final 2-15-2022	REVIEWED BY: JAB	
	PLOT DATE: 2/28/2022	APPROVED BY: TRS	

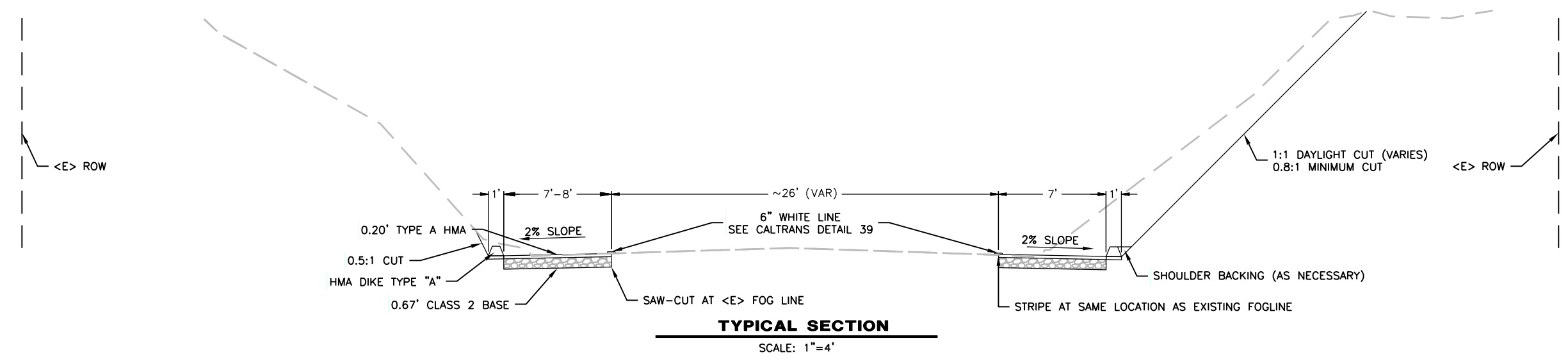
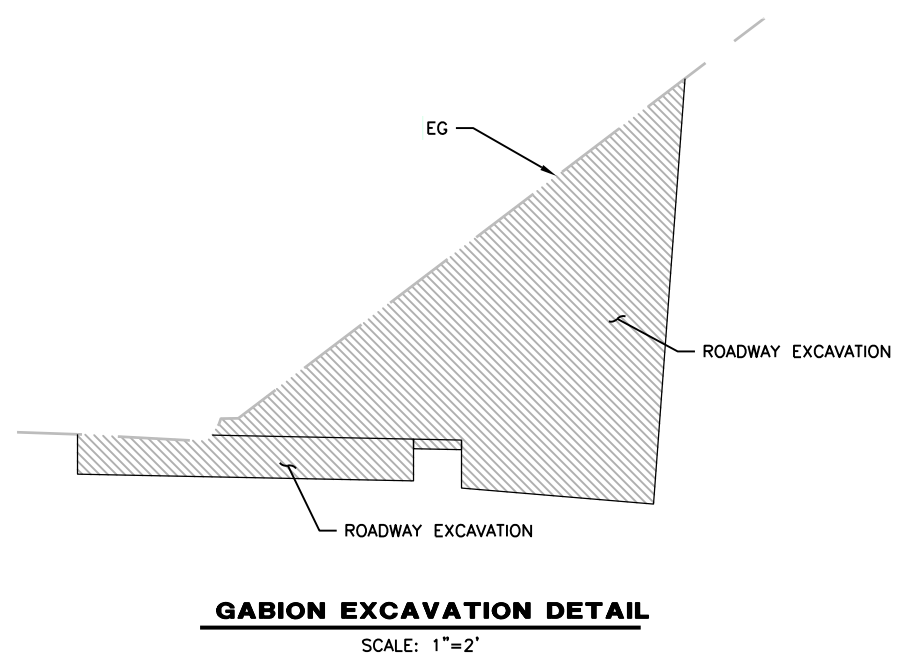
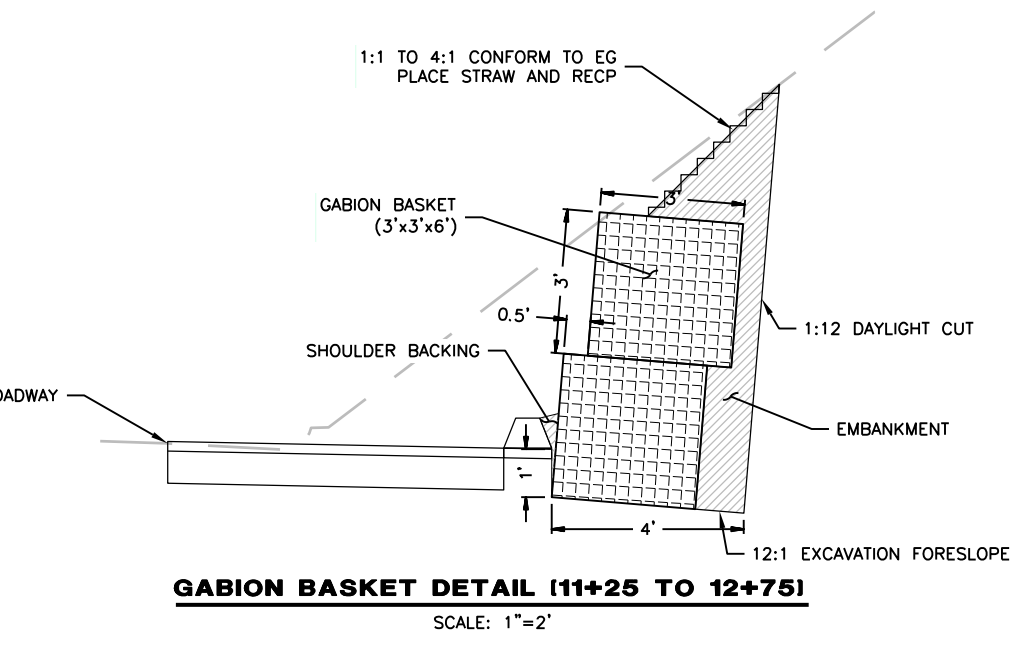
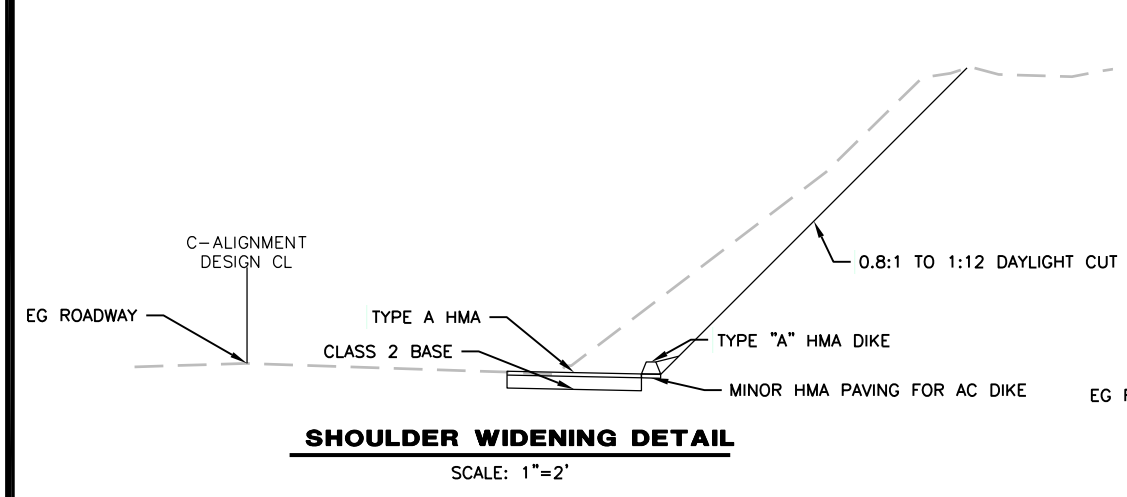
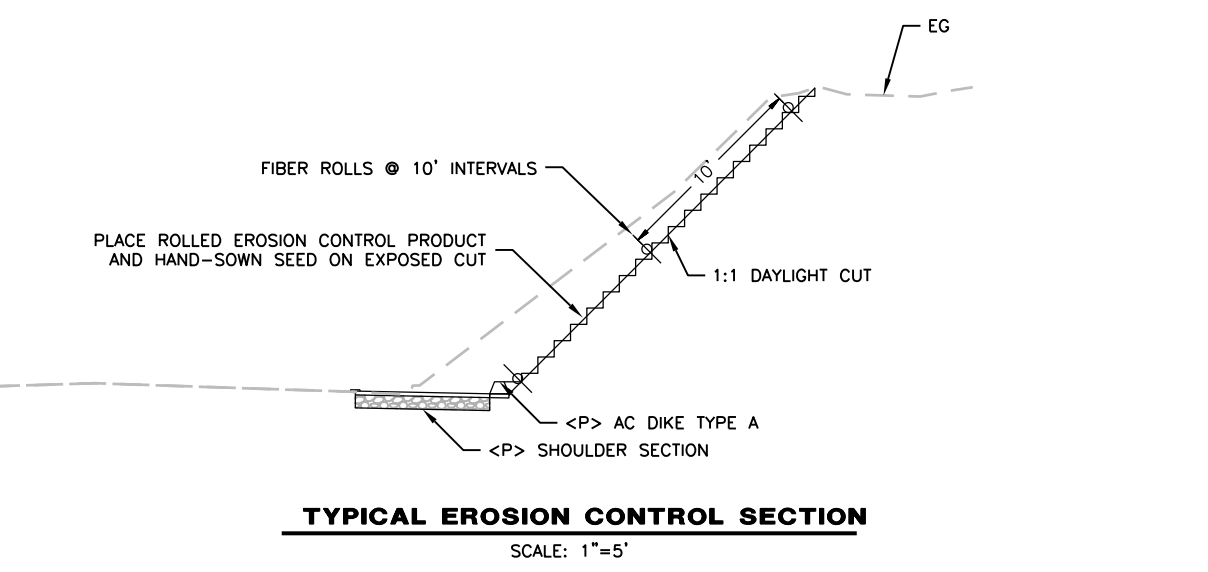
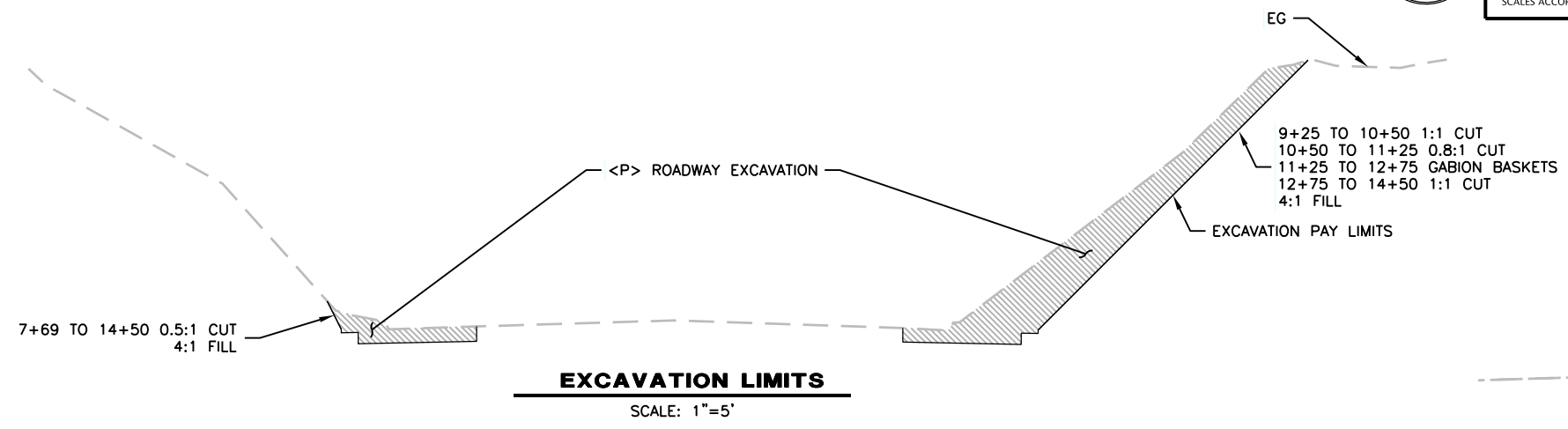



BAR IS ONE INCH ON ORIGINAL DRAWING  IF NOT ONE INCH ON THIS SHEET, ADJUST SCALES ACCORDINGLY	ROAD NAME: CENTRAL AVENUE	DESIGN SECTION
	ROAD NO: 4L800	ENGINEERING
	AGREEMENT NO.: RPL-5904(177)	DESIGNED BY: MMS/RLB
	CONTRACT NO.: 321617	DRAWN BY: MMS/RLB
	DRAWING FILE NAME: 321617_Design Final 2-15-2022	REVIEWED BY: JAB
	PLOT DATE: 2/28/2022	APPROVED BY: TRS

COUNTY OF HUMBOLDT DEPARTMENT OF PUBLIC WORKS CENTRAL AVENUE PM 0.00-0.30 SHOULDER WIDENING STRIPING AND UTILITIES
---

SHEET  
**5**  
OF  
**12**

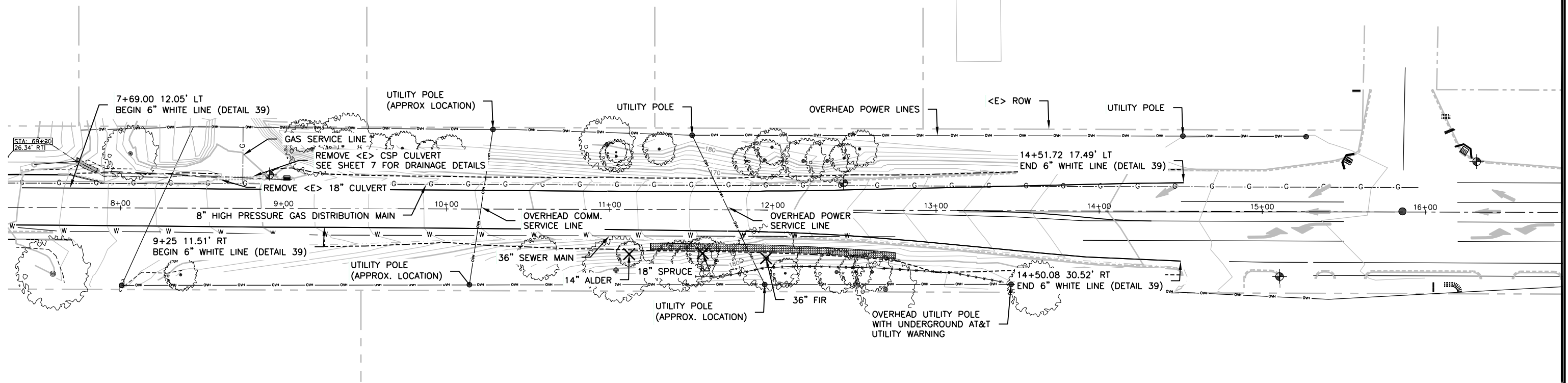

**STRIPING AND UTILITIES**  
SCALE: 1"=20'

Central Avenue Shoulder Widening Project			
Tree Removal Summary			
Central Avenue West Side (Station 9+25 to 14+50)			
Tree Type	<12" DBH	12-24" DBH	25-36" DBH
Pine (Monterey/Shore)	±4	0	0
Douglas Fir	±5	0	1
Alder	±2	1	0
Spruce	0	1	0
	<12" DBH	12-24" DBH	24-36" DBH
<b>Total Tree Removal</b>	<b>±11</b>	<b>2</b>	<b>1</b>

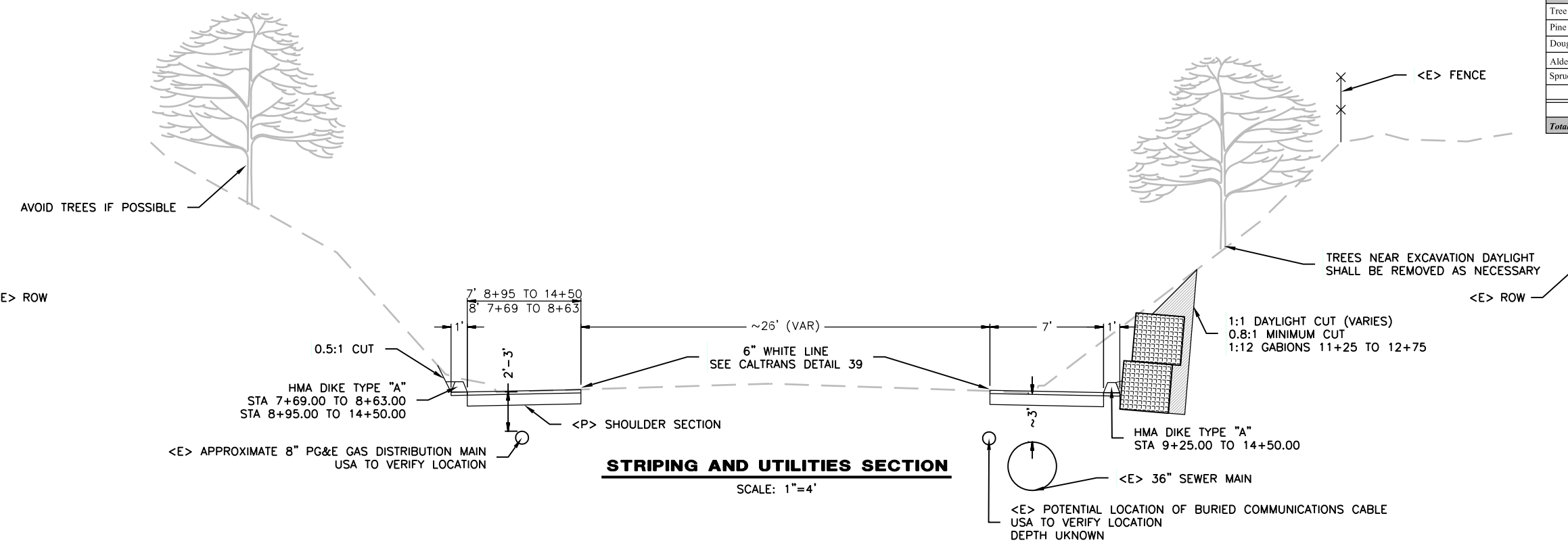



ROAD NAME: CENTRAL AVENUE	DESIGN SECTION
ROAD NO.: 4L800	ENGINEERING
MILE POST: 0.00-0.30	DESIGNED BY: MMS/RLB
AGREEMENT NO.: RPL-5904(177)	DRAWN BY: MMS/RLB
CONTRACT NO.: 321617	REVIEWED BY: JAB
DRAWING FILE NAME: 321617_Design Final 2-15-2022	APPROVED BY: TRS
PLOT DATE: 2/28/2022	

COUNTY OF HUMBOLDT DEPARTMENT OF PUBLIC WORKS	SHEET <b>6</b> OF <b>12</b>
CENTRAL AVENUE PM 0.00-0.30 SHOULDER WIDENING	
PLAN AND PROFILE VIEW	

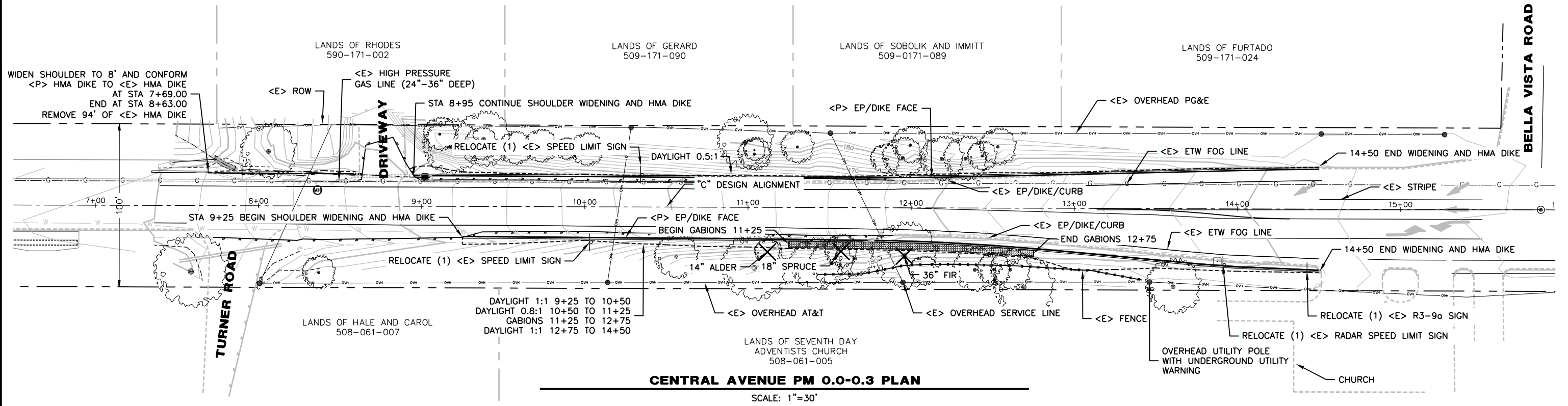

**ALIGNMENT GEOMETRY**

No.	Type	Length	Start Station	End Station	Delta angle	Radius
1	Line	1739.90'	0+05.00'	17+44.90'		
2	Curve	1749.26'	17+44.90'	34+94.15'	52°45'00"	1900.00'

PVI STA = 16+57.08  
PVI EL = 197.77  
K = 75.05  
L = 850.00'

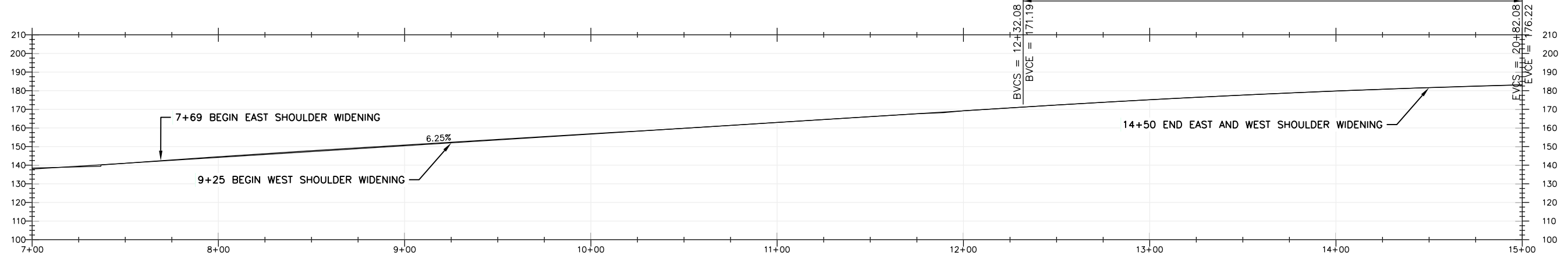



ROAD NAME: CENTRAL AVENUE	DESIGN SECTION
ROAD NO.: 4L800	ENGINEERING
MILE POST: 0.00-0.30	DESIGNED BY: MMS/RLB
AGREEMENT NO.: RPL-5904(177)	DRAWN BY: MMS/RLB
CONTRACT NO.: 321617	REVIEWED BY: JAB
DRAWING FILE NAME: 321617_Design Final 2-15-2022	APPROVED BY: TRS
PLOT DATE: 2/28/2022	

COUNTY OF HUMBOLDT DEPARTMENT OF PUBLIC WORKS	SHEET
CENTRAL AVENUE PM 0.00-0.30 SHOULDER WIDENING	7
DRAINAGE PLAN AND PROFILE	OF
	12

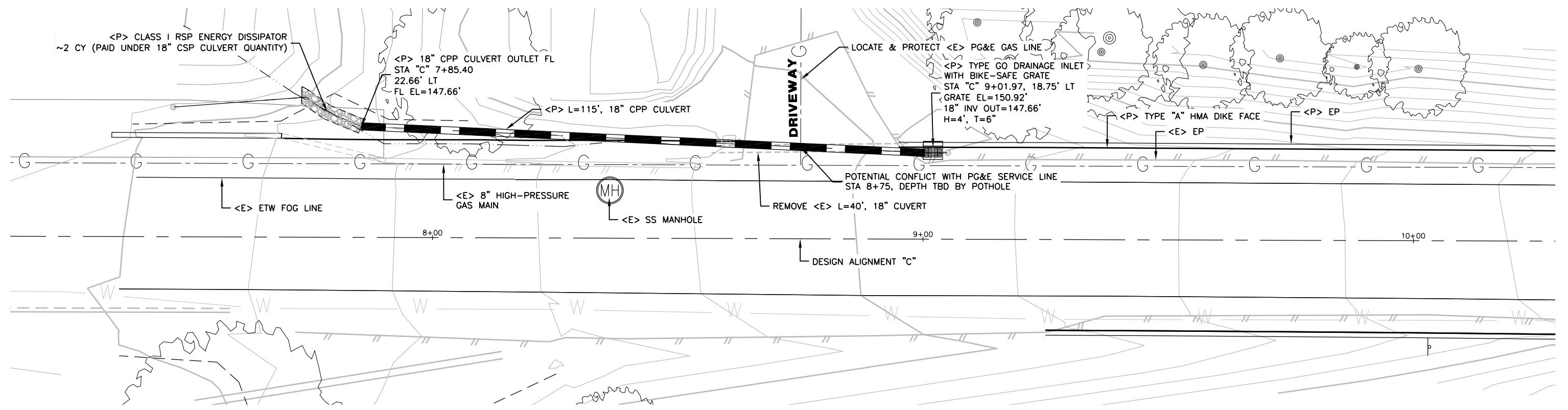

**CENTRAL AVENUE PM 0.0-0.3 DRAINAGE PLAN**

SCALE: 1"=10'

**NOTES**

- IF THE CONTRACTOR AND COUNTY DETERMINE THAT THE CULVERT ALIGNMENT AS SHOWN WILL CONFLICT WITH THE EXISTING PG&E SERVICE LINE, THE CULVERT DEPTH, SLOPE, AND OUTFALL LOCATION CAN BE ADJUSTED AS NECESSARY, AS LONG AS 18" OF COVER OVER THE NEW PIPE CAN BE MAINTAINED, AS WELL AS MAINTAINING A SAFE DISTANCE FROM THE EXISTING GAS LINE PER PG&E'S STANDARDS (CONTRACTOR IS TO COORDINATE WITH PG&E IF THIS BECOMES NECESSARY)

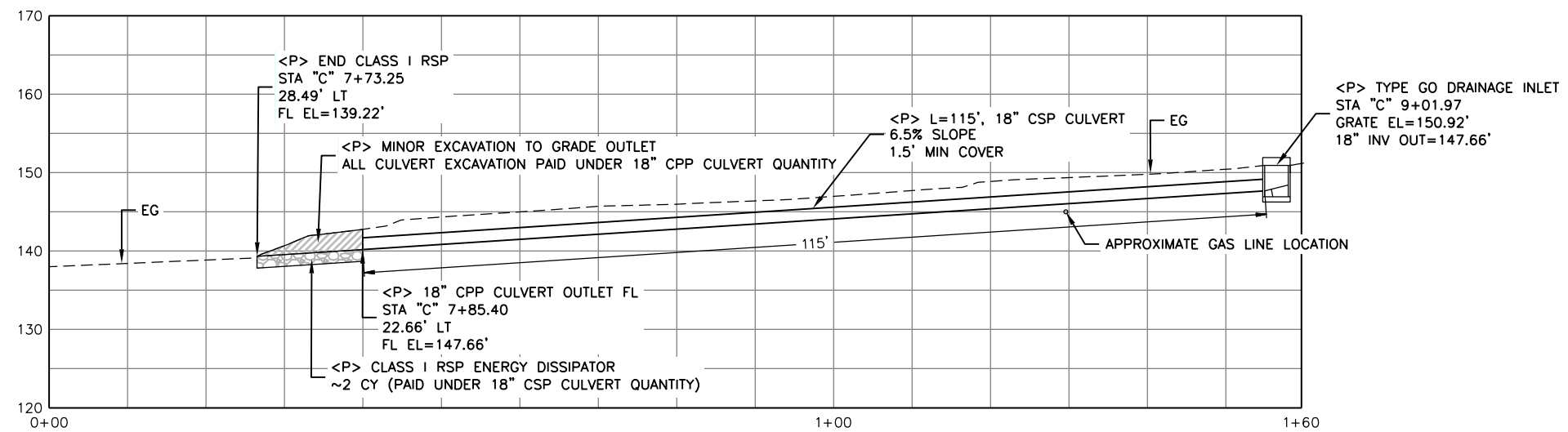

**CENTRAL AVENUE PM 0.0-0.3 DRAINAGE PROFILE VIEW**

SCALE: 1"=10'



BAR IS ONE INCH ON ORIGINAL DRAWING  IF NOT ONE INCH ON THIS SHEET, ADJUST SCALES ACCORDINGLY	ROAD NAME: CENTRAL AVENUE	DESIGN SECTION
	ROAD NO.: 4L800	ENGINEERING
	AGREEMENT NO.: RPL-5904(177)	DESIGNED BY: MMS/RLB
	CONTRACT NO.: 321617	DRAWN BY: MMS/RLB
	DRAWING FILE NAME: 321617_Design Final 2-15-2022	REVIEWED BY: JAB
	PLOT DATE: 2/28/2022	APPROVED BY: TRS

COUNTY OF HUMBOLDT DEPARTMENT OF PUBLIC WORKS
CENTRAL AVENUE PM 0.00-0.30 SHOULDER WIDENING
EROSION CONTROL

SHEET  
**8**  
OF  
**12**

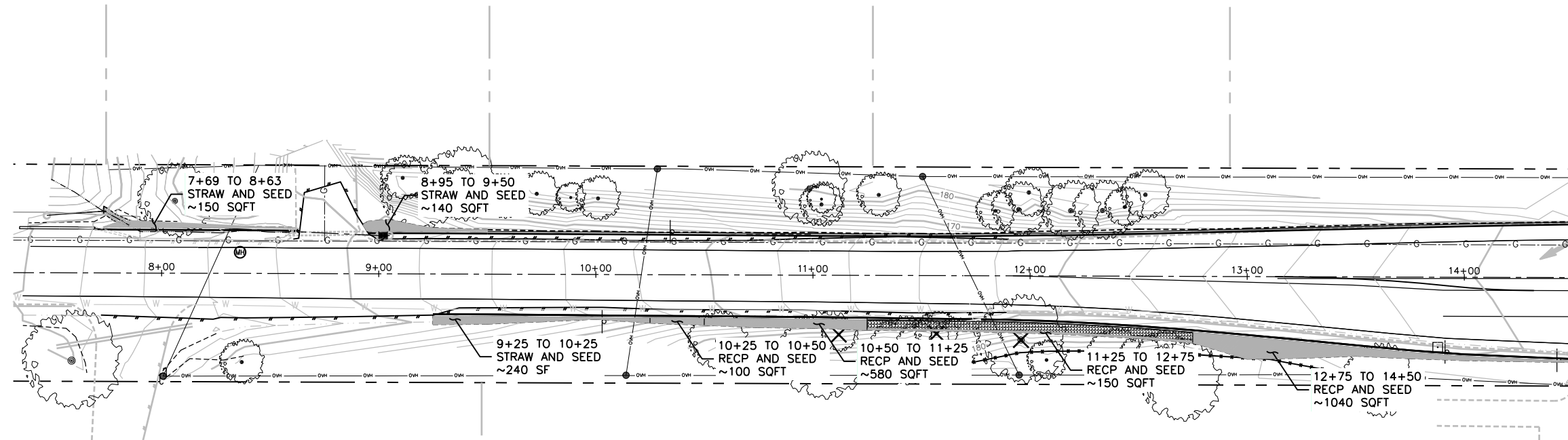

**CENTRAL AVENUE PM 0.00-0.30 EROSION CONTROL PLAN 1 OF 21**  
SCALE: 1"=30'

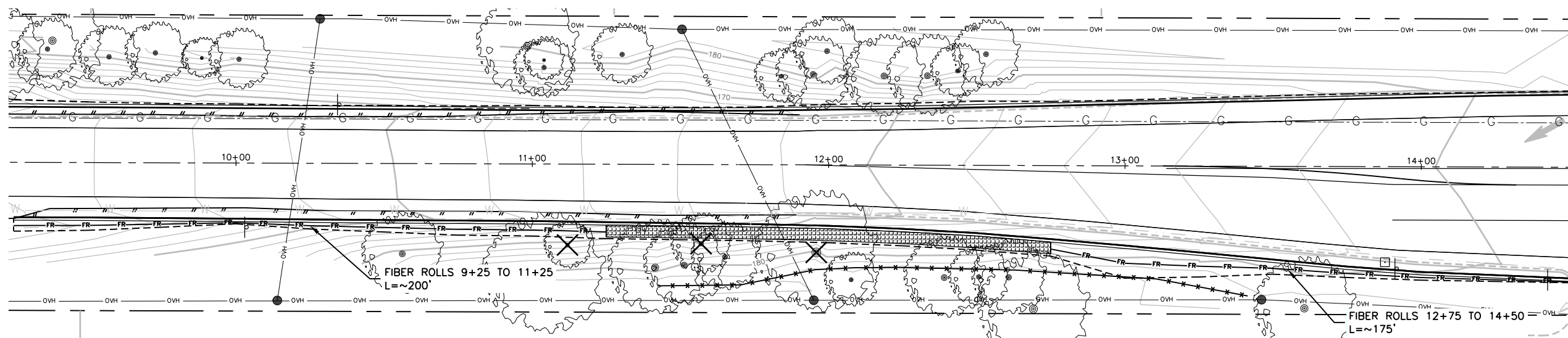

**CENTRAL AVENUE PM 0.00-0.30 EROSION CONTROL PLAN 2 OF 21**  
SCALE: 1"=20'





BAR IS ONE INCH ON ORIGINAL DRAWING  IF NOT ONE INCH ON THIS SHEET, ADJUST SCALES ACCORDINGLY	ROAD NAME: CENTRAL AVENUE	DESIGN SECTION
	ROAD NO.: 4L800	ENGINEERING
	AGREEMENT NO.: RPL-5904(177)	DESIGNED BY: MMS/RLB
	CONTRACT NO.: 321617	DRAWN BY: MMS/RLB
	DRAWING FILE NAME: 321617_Design Final 2-15-2022	REVIEWED BY: JAB
	PLOT DATE: 2/28/2022	APPROVED BY: TRS

COUNTY OF HUMBOLDT DEPARTMENT OF PUBLIC WORKS CENTRAL AVENUE PM 0.00-0.30 SHOULDER WIDENING SECTIONS 7+75 TO 10+50
---

SHEET  
**9**  
OF  
**12**

**SECTIONS 7+75 TO 10+50**  
SCALE: 1"=10'

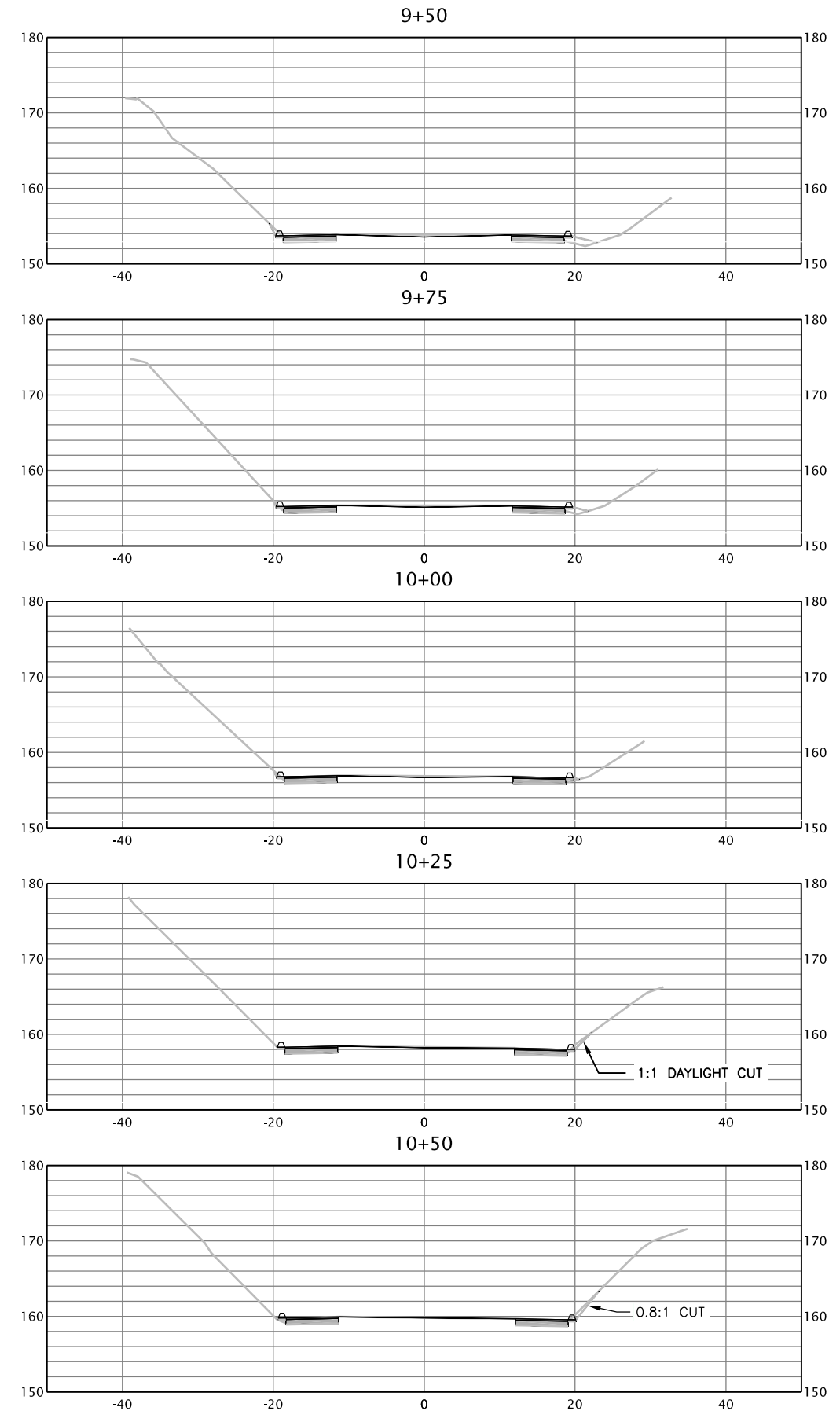
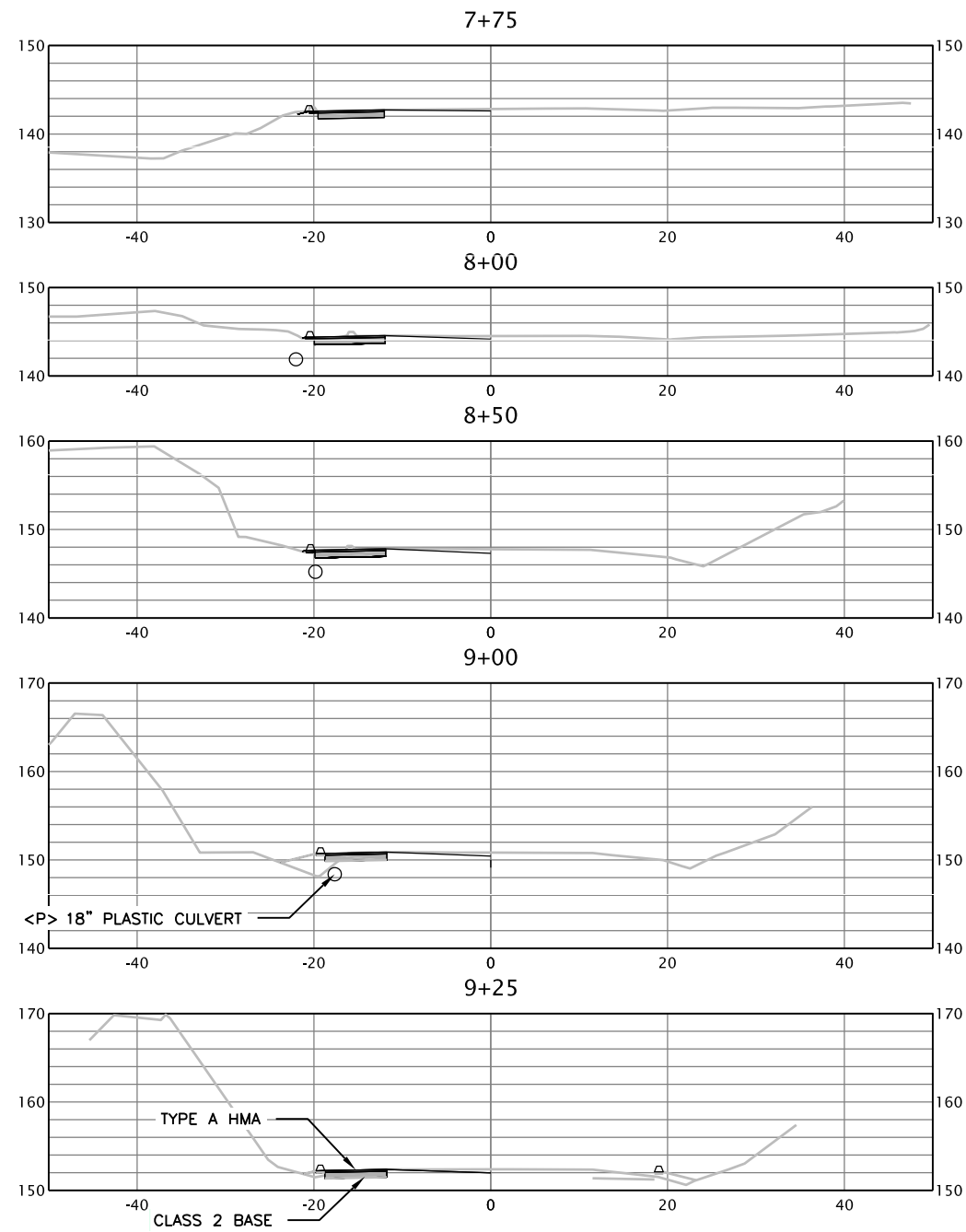



BAR IS ONE INCH ON ORIGINAL DRAWING  IF NOT ONE INCH ON THIS SHEET, ADJUST SCALES ACCORDINGLY	ROAD NAME: CENTRAL AVENUE	DESIGN SECTION	COUNTY OF HUMBOLDT DEPARTMENT OF PUBLIC WORKS <b>CENTRAL AVENUE PM 0.00-0.30 SHOULDER WIDENING</b> <b>SECTIONS 10+75 TO 12+00</b>	SHEET <b>10</b> OF <b>12</b>	
	ROAD NO: 4L800	MILE POST: 0.00-0.30			ENGINEERING
	AGREEMENT NO.: RPL-5904(177)	DESIGNED BY: MMS/RLB			
	CONTRACT NO.: 321617	DRAWN BY: MMS/RLB			
	DRAWING FILE NAME: 321617_Design Final 2-15-2022	REVIEWED BY: JAB			
	PLOT DATE: 2/28/2022	APPROVED BY: TRS			

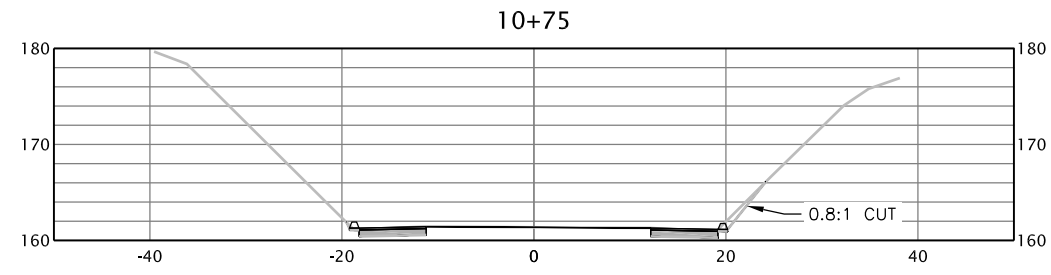

**SECTIONS 10+75 TO 12+00**  
SCALE: 1"=10'

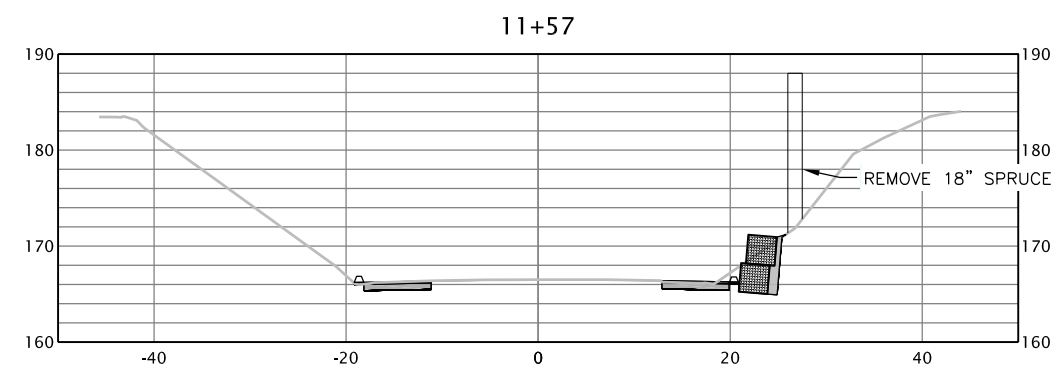
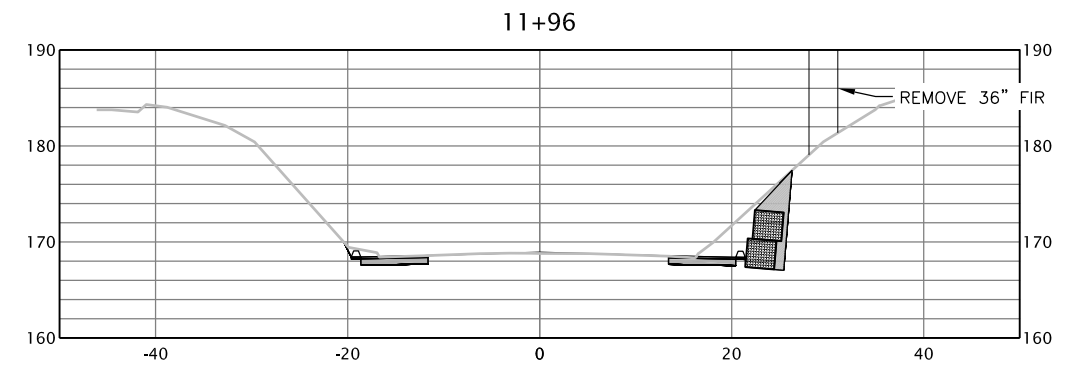
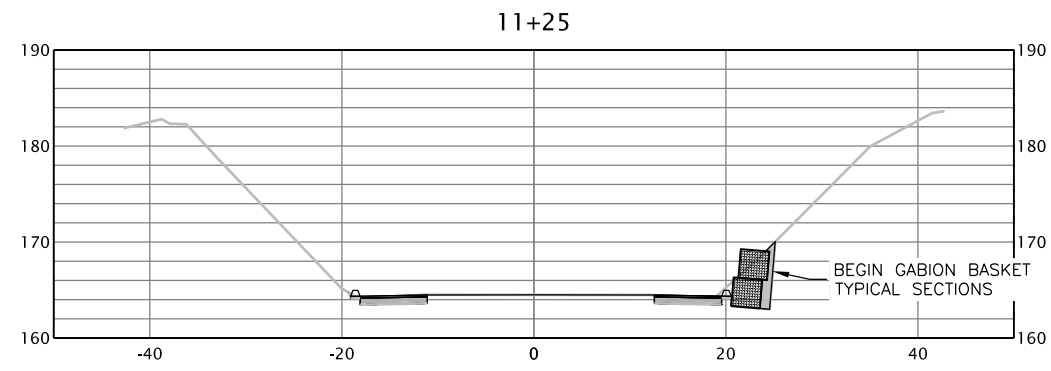
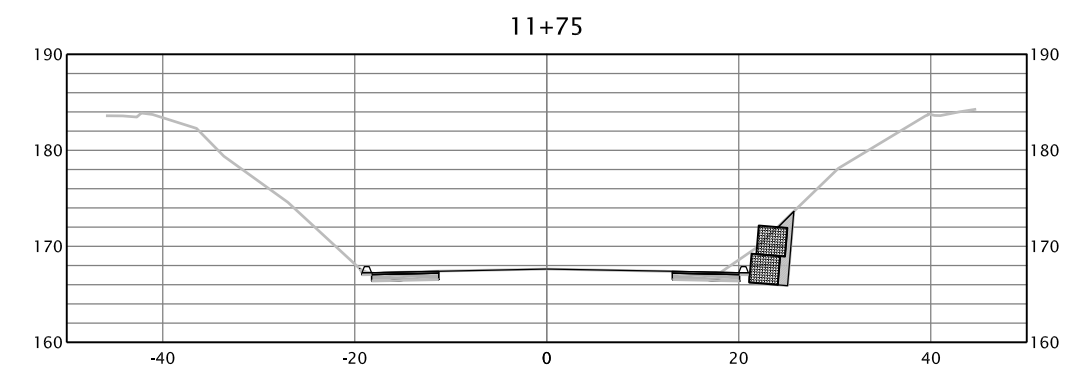
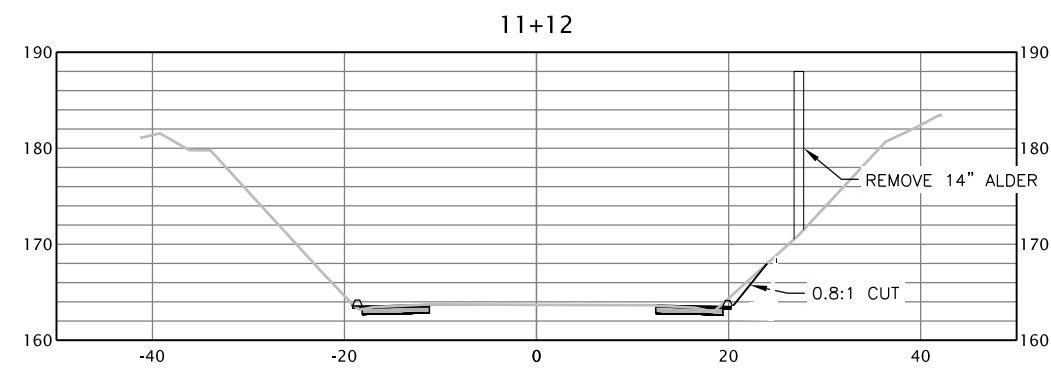



BAR IS ONE INCH ON ORIGINAL DRAWING  IF NOT ONE INCH ON THIS SHEET, ADJUST SCALES ACCORDINGLY	ROAD NAME: CENTRAL AVENUE		DESIGN SECTION	COUNTY OF HUMBOLDT DEPARTMENT OF PUBLIC WORKS <b>CENTRAL AVENUE PM 0.00-0.30 SHOULDER WIDENING</b> <b>SECTIONS 12+25 TO 13+50</b>	SHEET <b>11</b> OF <b>12</b>
	ROAD NO.: 4L800	MILE POST: 0.00-0.30	ENGINEERING		
	AGREEMENT NO.: RPL-5904(177)		DESIGNED BY: MMS/RLB		
	CONTRACT NO.: 321617		DRAWN BY: MMS/RLB		
	DRAWING FILE NAME: 321617_Design Final 2-15-2022		REVIEWED BY: JAB		
	PLOT DATE: 2/28/2022		APPROVED BY: TRS		

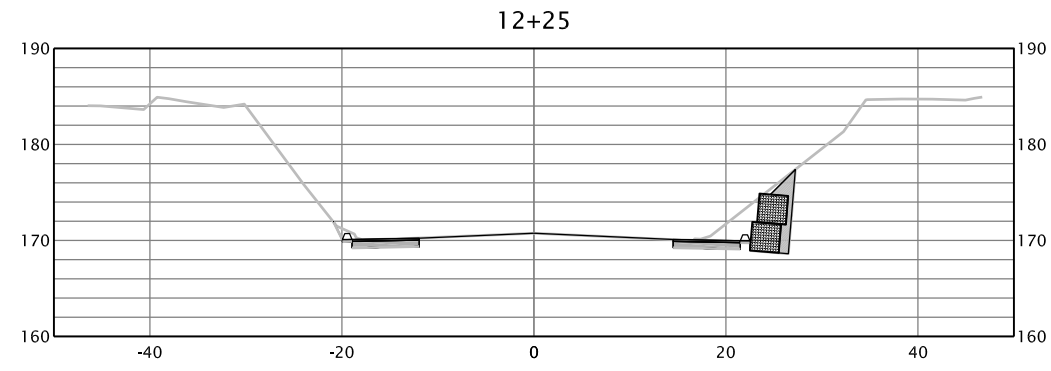

**SECTIONS 12+25 TO 13+50**  
SCALE: 1"=10'

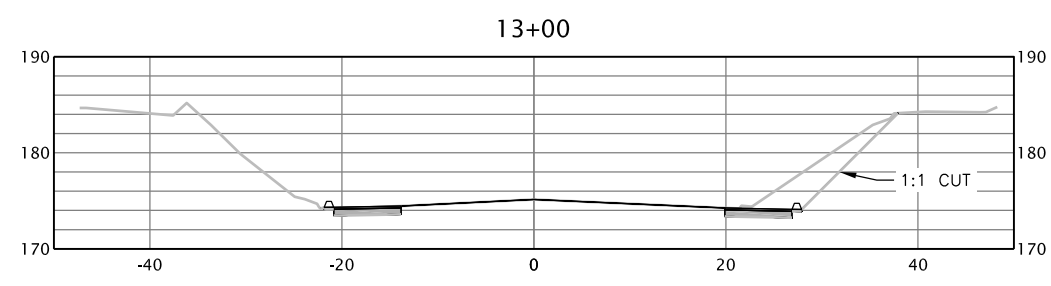
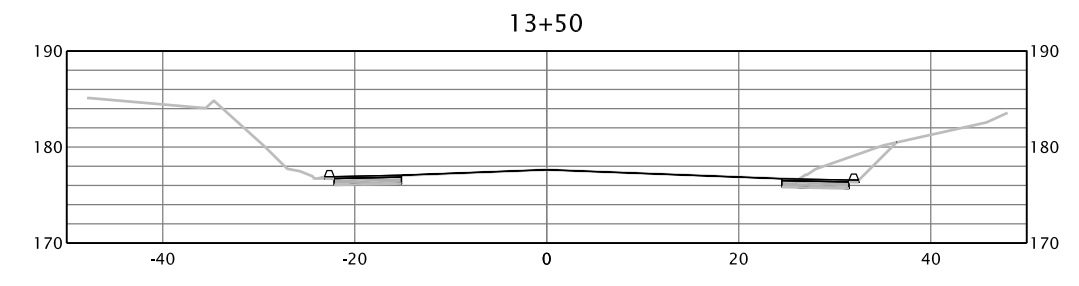
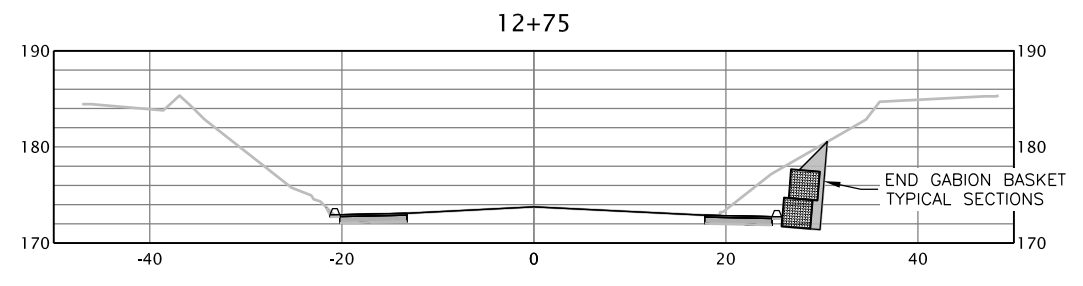
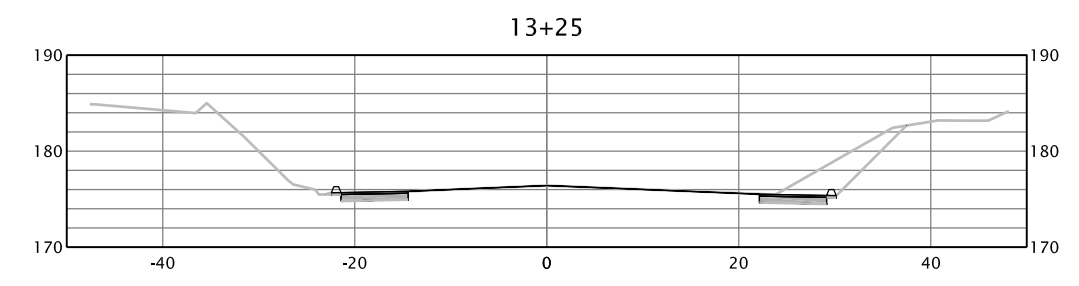
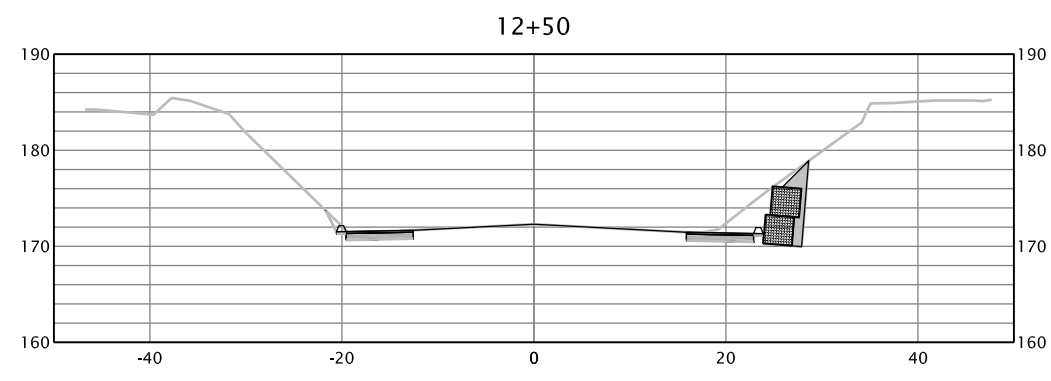



BAR IS ONE INCH ON ORIGINAL DRAWING  IF NOT ONE INCH ON THIS SHEET, ADJUST SCALES ACCORDINGLY	ROAD NAME: CENTRAL AVENUE	DESIGN SECTION	COUNTY OF HUMBOLDT DEPARTMENT OF PUBLIC WORKS	SHEET <b>12</b> OF <b>12</b>
	ROAD NO.: 4L800	ENGINEERING		
	AGREEMENT NO.: RPL-5904(177)	DESIGNED BY: MMS/RLB		
	CONTRACT NO.: 321617	DRAWN BY: MMS/RLB		
	DRAWING FILE NAME: 321617_Design Final 2-15-2022	REVIEWED BY: JAB	CENTRAL AVENUE PM 0.00-0.30 SHOULDER WIDENING	SECTIONS 13+75 TO 14+50
	PLOT DATE: 2/28/2022	APPROVED BY: TRS		

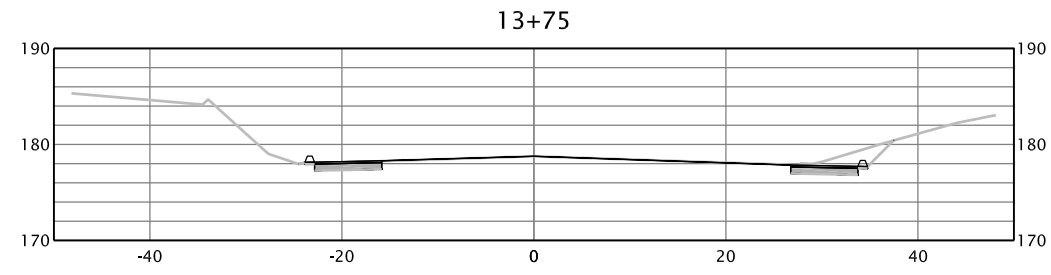

**SECTIONS 13+75 TO 14+50**  
SCALE: 1"=10'

