



DEPARTMENT OF FORESTRY AND FIRE PROTECTION

135 Ridgway Ave.
Santa Rosa, CA 95401
Website: www.fire.ca.gov
(707) 576-2959



Date: May 09, 2014
Ref.: 1-14EX-129-HUM

AISHA MORTON
232 RIVERVIEW LN
MCKINLEYVILLE, CA 95519

Dear MS. MORTON:

This is to acknowledge that your **Less Than 3 Acre Conversion Exemption** was accepted on **May 6, 2014**. It has been assigned the above listed Exemption number. All timber operations must be complete within one year. All conversion activities must be complete within two years, unless under permit by local jurisdiction.

*****Please read the enclosed notice regarding Listed Anadromous Salmonids, Slash Clean-up, Sudden Oak Death, Pitch Canker, and Operations between October 15 – May 1.*****

In addition, please note the requirement for submittal of the Timber Operations Work Completion and/or Stocking Report (blue form) upon completion of the project.

Compliance with all provisions of the Forest Practice Act, rules pursuant to Section 1104.1(a)--Title 14 of the California Code of Regulations, will be determined by future inspection(s).

If you have any questions you may contact your local CAL FIRE Forest Practice Inspector or me at (707) 576-2959.

Sincerely,

Daniel Sooy
Staff Forester
RPF #2793

Enclosure

- cc: Unit
- Fish & Wildlife
- Water Quality
- County Planning
- Board of Equalization
- RPF – Chris Carroll
- LTO – Rice Equipment
- File

LESS THAN 3 ACRE CONVERSION EXEMPTION

STATE OF CALIFORNIA
DEPARTMENT OF FORESTRY AND FIRE PROTECTION
NOTICE OF TIMBER OPERATIONS THAT ARE EXEMPT FROM
CONVERSION AND TIMBER HARVESTING PLAN REQUIREMENTS
RM-73 (1/19/14) (1/1/12)

FOR ADMIN. USE ONLY ✓ *0.5004*
Ex. # 1-14EX-129HUM
Date of Receipt APR 30 2014
Date Accepted 5/6/14
Date Expires 5/5/15

VALID FOR ONE YEAR FROM DATE OF RECEIPT BY CAL FIRE
TIMBER OPERATIONS CANNOT START UNTIL VALID COPY
OF A NOTICE OF ACCEPTANCE IS RECEIVED FROM CAL FIRE

The Director of the Department of Forestry and Fire Protection (CAL FIRE) is hereby notified of timber operations under the requirements of 14 CCR § 1104.1(a). Harvesting of trees that is a single conversion to a non-timber growing use of timberland of less than three acres. (See 14 CCR § 1104.1(a) for a description of the conditions on the conduct of this type of timber operation and additional information that is required to be submitted). Complete items 1 through 6 on both pages of this notice.

1. TIMBER OWNER(S) OF RECORD: Aleha Candrian Norton

Address: 232 Riverview Lane

City: McKinleville State: CA Zip: 95519 Phone: 707-498-5493

TIMBER TAX EXEMPTION: Timber owners owe timber yield tax when they harvest trees unless the harvest is exempt (Revenue and Taxation Code sec. 38116). Some small or low value harvests may be exempt from timber yield tax. Timber removed from an operation whose value does not exceed \$3,000 within a quarter, according to BOE Harvest Value Schedules, Rule 1024. If you believe your harvest may qualify for this exemption, please complete items A and B below. For timber yield tax information or for further assistance with these questions call the State Board of Equalization, 1-800-400-7415, or write: Timber Tax Section, MIC-80, State Board of Equalization, P.O. Box 942879, Sacramento, California 94279-0060, or contact the BOE Web Page on the internet at <http://www.boe.ca.gov>.

A. Circle the option that most closely estimates the total volume for this harvest. In thousands of board feet (mbf = Net Scribner, short log):

Under 8 mbf 8-16 mbf 16-25 mbf Over 25 mbf

B. Estimate the species composition of the timber that will be removed during this harvest (numbers should sum to 100%):

Redwood _____ %; Ponderosa/Sugar pine _____ %; Douglas fir 85%; Fir _____ %;
Port-Oxford Cedar _____ %; Cedar (IC, WRC) _____ %; Other conifer _____ %; Other hardwood 15%

2. TIMBERLAND OWNER(S) OF RECORD: Aleha Candrian Norton

Address: 232 Riverview Lane

City: McKinleville State: CA Zip: 95519 Phone: 707-498-5493

I hereby, under penalty of perjury, that this is a one-time conversion to a non-timberland use and that there is a "bona fide intent" (14 CCR § 1100(b)) to convert to Agriculture.

SIGNATURE _____

Date: 4/27/14

3. LICENSED TIMBER OPERATOR(S): Rice Equipment

Lic. No.: A-10930

Address: P.O. Box 66

City: Burnt Ranch State: CA Zip: 95527 Phone: 530-829-1620

SIGNATURE Bob Rice

Date: 4-26-14

4. Designate the legal land description of the location of timberland conversion. A map showing the location of the timberland conversion MUST be attached. The map must show the ownership boundaries, the location of the timber operation, boundaries of the conversion, location and classification of all watercourses, and landing locations.

Section 35 Township 3N Range 4E Base & Meridian Humboldt County Humboldt Acreage to be Converted 2.9 Assessor's Parcel Number 317-182-20

Page 1 NOTE: This form has two pages. Continue on and complete page 2. Read the instructions before attempting to complete.

RECEIVED

APR 30 2014

COAST AREA OFFICE
RESOURCE MANAGEMEN

LESS THAN THREE ACRE CONVERSION EXEMPTION Page 2.

5. The following are limitations or requirements for timber operations conducted under a Less Than Three Acre Conversion Exemption (Notice, Notice of Conversion Exemption, Conversion Exemption):
- A. Timber operations shall comply with all other applicable provisions of the Forest Practice Act and regulations, county general plans, zoning ordinances, and any implementing ordinances; copies of the state rules and regulations may be found on CAL FIRE's Web Page on the Internet at <http://www.fire.ca.gov>.
 - B. All timber operations shall be complete within one year from the date of acceptance by CAL FIRE.
 - C. All conversion activities shall be complete within two years from the date of acceptance by CAL FIRE, unless under permit by local jurisdiction. Failure to complete the conversion requires compliance with stocking standards and stocking report requirements of the Forest Practice Act and Board of Forestry and Fire Protection regulations.
 - D. The timber operator shall remove or dispose of all slash or woody debris in accordance with 14 CCR § 1104.1(a)(2)(D)(1)-(9). The timberland owner may assume responsibility for the slash treatment, provided the landowner acknowledges in writing to CAL FIRE such responsibility at the time of submission of this notice. The specific requirements shall be included with the acknowledgement.
 - E. Timber operations may be conducted during the winter period. Tractor operations in the winter period are allowed under any of the conditions described in 14 CCR § 1104.1(a)(2)(E)1-3.
 - F. No timber operations are allowed within a watercourse and lake protection zone unless specifically approved by local permit (e.g., county, city).
 - G. No timber operations shall be conducted until CAL FIRE's notice of acceptance is received and a valid copy of this notice and CAL FIRE's acceptance shall be kept on site during timber operations.
 - H. No slash of rare, threatened or endangered plants or animals or species of special concern shall be disturbed, threatened or damaged.
 - I. No timber operations are allowed on significant historical or archeological sites.
 - J. Within one month of the completion of timber operations, including slash disposal, the timberland owner shall submit a work completion report to CAL FIRE.
 - K. A violation of the conversion exemption, including a conversion applied for in the name of someone other than the person or entity implementing the conversion in bona fide good faith, are violations of the Forest Practice Act and penalties may accrue up to ten thousand dollars (\$10,000) for each violation pursuant to Article 6 (commencing with Section 4501).

6. I, _____, declare as the authorized designee of the County Board of Supervisors that this conversion exemption is in conformance with all county regulatory requirements, including public notice. (If the county has authorized a designee this item MUST be completed. If it has not, see item 7.)

SIGNATURE _____ Date _____

7. Registered Professional Forester preparing Notice: Chris Carroll Number 2628

Address Timberland Resource Consultants, 165 South Fortuna Blvd, Suite A

Gly Fortuna State CA Zip 95540 Phone 707-725-4897

I have, or my supervised designee has, (1) prepared this Notice of Conversion Exemption Timber Operations; (2) visited the site and flagged the boundaries of the conversion exemption, applicable MLPZs and equipment limitation zones; (3) prepared a Neighborhood Notice of Conversion Exemption according to 14 CCR § 1104.1(a)(3) to be mailed by the landowner to adjacent landowners; and (4) posted and defied a copy of the Neighborhood Notice of Conversion Exemption on the ownership, visible to the public, at least 5 days prior to the postmark date of submission of the Notice of Conversion Exemption. I certify that if the County Board of Supervisors has not designated a representative authorized to sign in item 6 that I, or my supervised designee, contacted the county and the Notice is in conformance with county regulations.

SIGNATURE OF RPF Chris Carroll Date 4-30-14

8. NOTICE SUBMITTER(S): Aisha Candace Morton

Address: 232 Riverview Lane

City: McKinleyville State: CA Zip: 95519 Phone: 707-498-5493

Submitter must be 1, 2, or 3 above, and must sign.

SIGNATURE _____ Date 4/27/14

FILE THIS NOTICE WITH THE CAL FIRE OFFICE BELOW FOR THE COUNTY IN WHICH THE OPERATION WILL OCCUR

Forest Practice, CAL FIRE 135 Ridgway Avenue Santa Rosa, CA 95401	Forest Practice, CAL FIRE 6105 Airport Road Redding, CA 96002	Forest Practice, CAL FIRE 1234 East Shaw Avenue Fresno, CA 93740
Alameda, Colusa, Contra Costa, Del Norte, Humboldt, Lake, Marin, Mendocino, Napa, San Mateo, Santa Clara, Santa Cruz, Solano, Sonoma, western Trinity and Yolo Counties	Butte, Glenn, Lassen, Modoc, Nevada, Placer, Plumas, Shasta, Sierra, Siskiyou, Sutter, Tehama, eastern Trinity and Yuba Counties	Alpine, Amador, Calaveras, El Dorado, Fresno, Imperial, Inyo, Kern, Los Angeles, Madera, Mariposa, Merced, Mono, Monterey, Orange, Riverside, San Benito, San Bernardino, San Diego, San Luis Obispo, Santa Barbara, Stanislaus, Tuolumne, Tulare, and Ventura Counties

RECEIVED

APR 30 2014

COAST AREA OFFICE
RESOURCE MANAGEMENT

Project Description

This conversion proposes to convert timberland into two agricultural sites. Per the Humboldt County General Plan, the conversion exemption area is presently zoned Timber Production (TPZ). Humboldt County's Grading and Open Space Ordinance does not apply to this project because the conversion exemption area is zoned TPZ, and the property is greater than 3 acres in size. Consequently, Item 6 is not signed by the County's designee. The RPF has attached an e-mail from Humboldt County Planning, which states that no County review is required for Less Than 3-Acre Conversion Exemptions on TPZ lands. Agriculture is a principally permitted activity on TPZ lands

Addendum 14CCR 1104.1(a)(1)(E)(1-4)

The timberland owner has certified via her signature, under penalty of perjury, that this is a one-time conversion to Agriculture. The timberland owner understands that a "Bona Fide Intention or bona fide intent" is a present, sincere intention of the applicant to conform with and successfully execute the conversion plan, as determined by the Director in accordance with provisions of Sec. 1105.2 (Ref.: Sec. 4623, PRC). The timberland owner, acting as an individual, acting as a member of a partnership, or acting as an officer or employee of a corporation or other legal entity, has not obtained an exemption pursuant to this section in the last five years.

Addendum 14CCR 1104.1(a)(2)(F)

There are no watercourses, ELZs, or WLPZs within the conversion exemption area.

Addendum 14CCR 1104.1(a)(6)

The extent of the vegetation removal and site preparation required for the conversion;

The conversion area consists of merchantable Douglas-fir with a minor component of tanoak and madrone. This conversion will require timber harvesting and treatment of logging slash. Grading and excavation shall be required but no significant earthwork appears necessary to successfully convert the sites.

The suitability of soils, slope, aspect, and microclimate for the stated non-timber use;

The conversion exemption area's slopes are gentle to moderately sloping with aspects represented that are favorable for agriculture. The soils are inadequate for agriculture but grow medium is imported and therefore not a limiting factor.

RECEIVED

APR 30 2014

**COAST AREA OFFICE
RESOURCE MANAGEMENT**

Addendum 14CCR 1104.1(a)(2)(D) - Treatment of Logging Slash and Woody Debris.

1. Unless otherwise required, slash greater than one inch in diameter and greater than two feet long, and woody debris, except pine, shall receive full treatment no later than April 1 of the year following its creation, or within one year from the date of acceptance of the conversion exemption by the Director, whichever comes first.
2. All pine slash three inches and greater in diameter and longer than four feet must receive initial treatment if it is still on the parcel, within 7 days of its creation.
3. All pine woody debris longer than four feet must receive an initial treatment prior to full treatment.
4. Initial treatment shall include limbing woody debris and cutting slash and woody debris into lengths of less than four feet, and leaving the pieces exposed to solar radiation to aid in rapid drying.
5. Full treatment of all pine slash and woody debris must be completed by March 1 of the year following its creation, or within one year from the date of acceptance of the conversion exemption by the Director, whichever comes first.
6. Full slash and woody debris treatment may include any of the following:
 - a. Burying;
 - b. Chipping and spreading;
 - c. Piling and burning; or
 - d. Removing slash and woody debris from the site for treatment in compliance with (a)-(b). Slash and woody debris may not be burned by open outdoor fires except under permit from the appropriate fire protection agency, if required, the local air pollution control district or air quality management district. The burning must occur on the property where the slash and woody debris originated.
7. Slash and woody debris, except for pine, which is cut up for firewood shall be cut to lengths 24 inches or less and set aside for drying by April 1 of the year following its creation. Pine slash and woody debris which is cut up for firewood shall be cut to lengths 24 inches or less and set aside for drying within seven days of its creation.
8. Any treatment which involves burning of slash or woody debris shall comply with all state and local fire and air quality rules.

RECEIVED

APR 30 2014

**COAST AREA OFFICE
RESOURCE MANAGEMENT**

Aisha Morton Conversion General Location Map



Property Boundary



Conversion Exemption

Scale 1" = 2,000'
Section 26, T3N, R4E, HB&M.

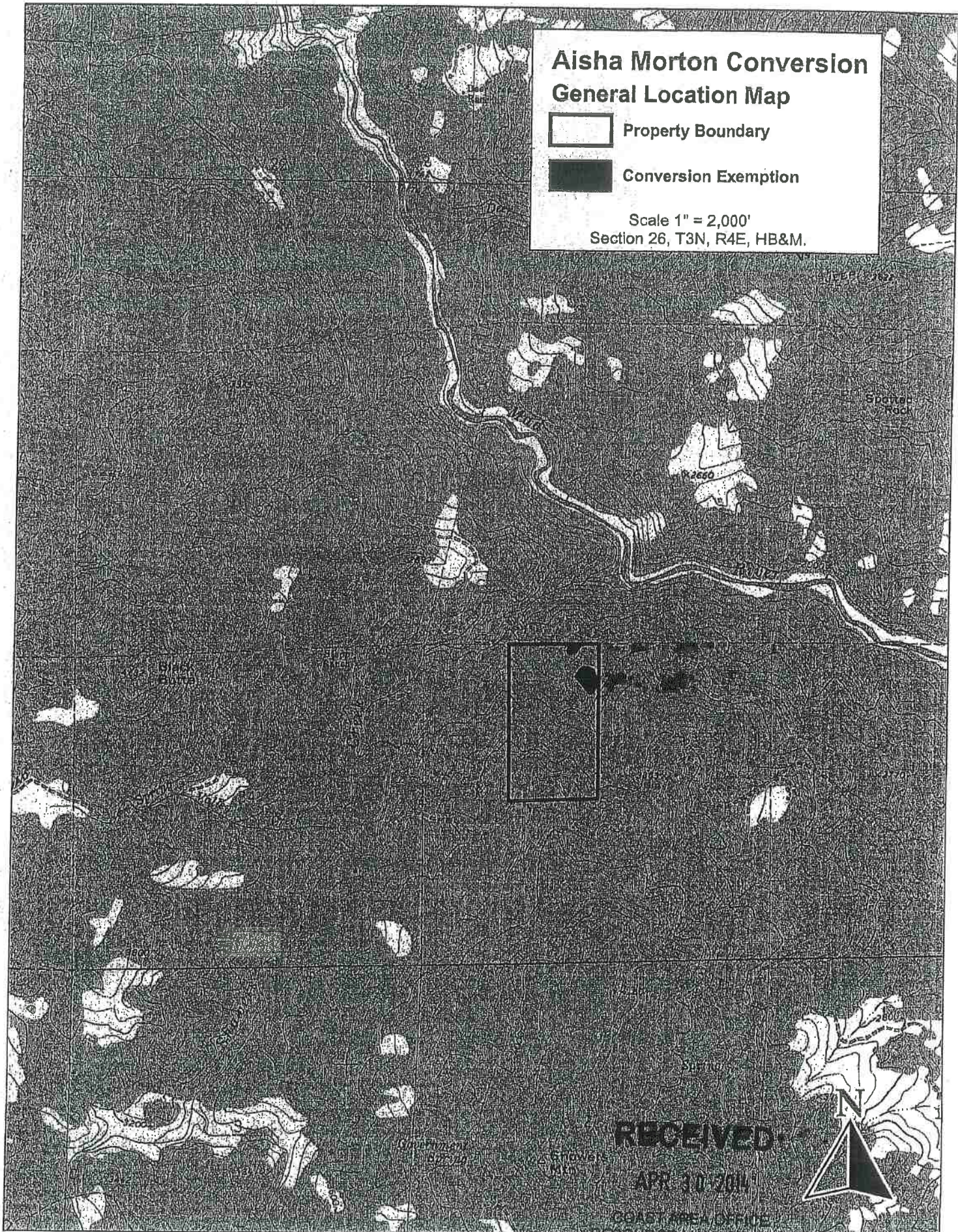





RECEIVED

APR 30 2011

COAST AREA OFFICE
RESOURCE MANAGEMENT



Aisha Morton Conversion Haul Route Map

-  Property Boundary
-  Conversion Exemption
-  Stapp County Road
-  Existing Seasonal Road

Scale 1" = 2,000'
Section 35, T3N, R4E, HB&M.

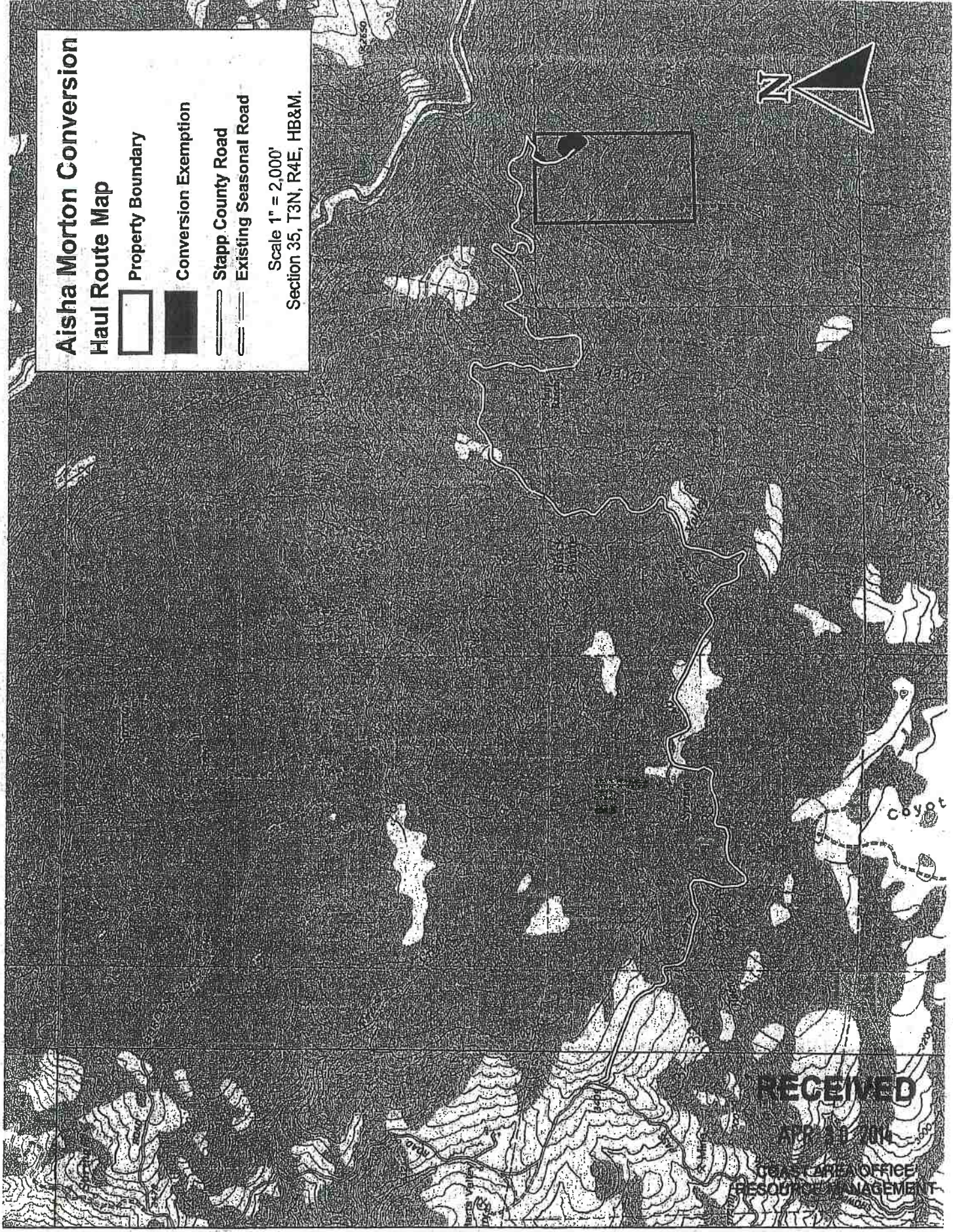

RECEIVED
APR 21 2011
TOPEKA AREA OFFICE
RESOURCE MANAGEMENT

Aisha Morton Conversion Operations Map

 Property Boundary

 Conversion Area

 Existing Seasonal Road

 Swale Feature

 Landing Location

 Grassland

Scale 1" = 150'
Section 35, T3N, R4E, HB&M.

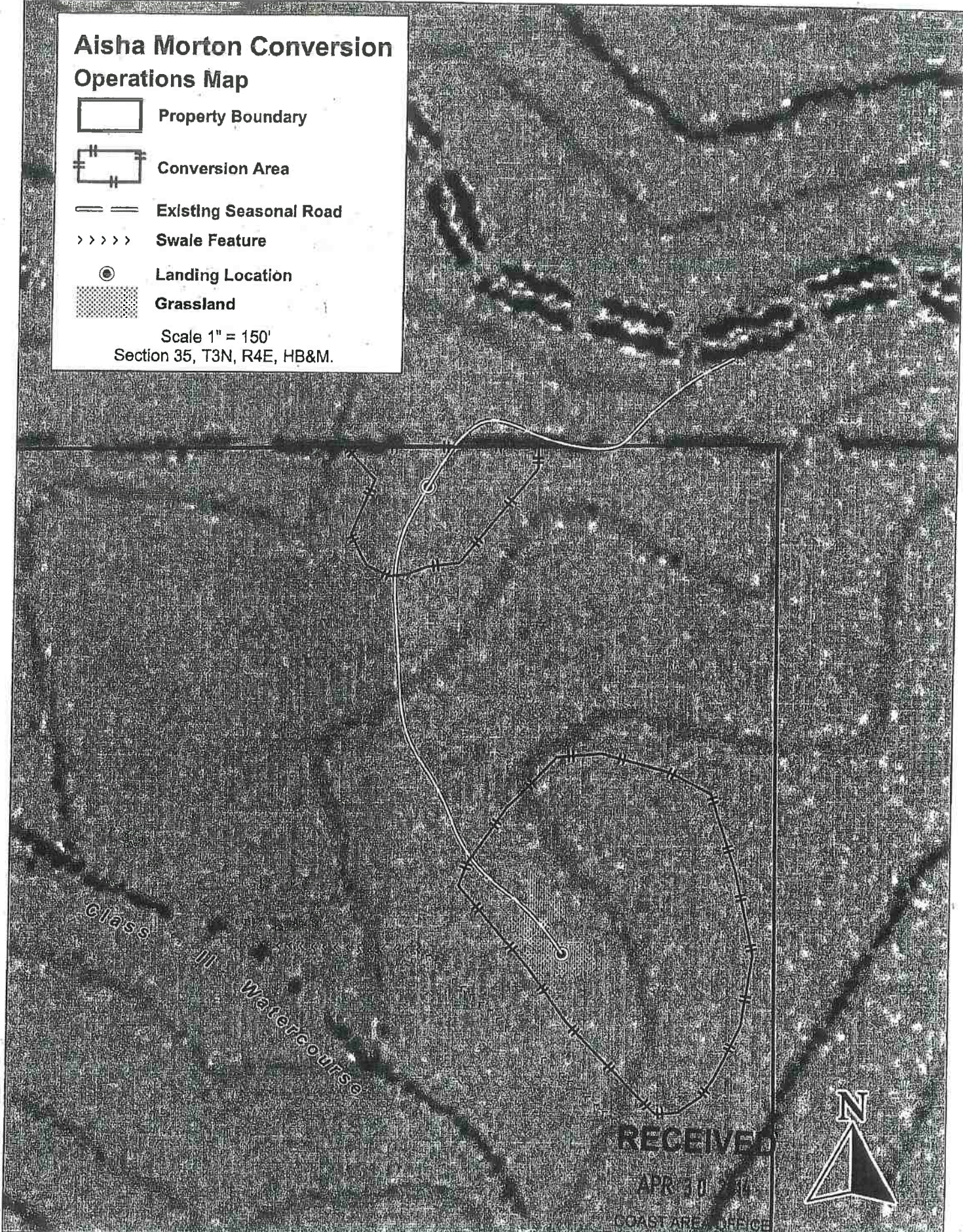

RECEIVED

APR 20 2010

COAST AREA OFFICE
RESOURCE MANAGEMENT

Message

Page 1 of 1

From: Estlow, Trevor [TEstlow@co.humboldt.ca.us]
Sent: Thursday, July 09, 2009 10:18 AM
To: distefano@timberlandresource.com
Subject: Re: Less than 3-acre Conversion Exemptions
Mark-

Anita asked me to follow up on an email you had sent her regarding Less Than 3-Acre Conversion Exemptions. For non-TPZ lands, the County requires a Building Inspector to verify that there are no Streamside Management Areas or other sensitive habitat in order to sign off the exemption. In residential areas, it may require a Special Permit from the Planning Division. On TPZ lands, no County review is required for Less Than 3-Acre Conversion Exemptions or 150-foot Fire Hazard Exemptions. Hope this answers your questions. Please contact me if you have any additional questions.

Sincerely,

Trevor Estlow, Senior Planner

County of Humboldt, Planning Division

3015 H Street

Eureka, CA 95501

Phone: (707) 268-3740

Fax: (707) 445-7446

Email: estlow@co.humboldt.ca.us

RECEIVED

APR 30 2014

**COAST AREA OFFICE
RESOURCE MANAGEMENT**



DEPARTMENT OF FORESTRY AND FIRE PROTECTION

[Humboldt-Del Norte Unit0]
[118 S. Fortuna Blvd]
[707-777-1720]
[Fortuna, CA 95540]
Website: www.fire.ca.gov



February 26, 2015

Chris Carroll
165 Soth Fortuna BLVD, STE 4
Fortuna, CA 95540

NOTICE OF INSPECTION

Section 4604 of the Public Resources Code (PRC) requires the department to inspect timber operations for compliance with the Forest Practice Act and rules of the Board of Forestry and Fire Protection.

Harvest Document: 1-14EX-129-HUM
Inspection Date: February 24, 2015
Inspection Type: Final Completion
Inspection Number: 2
Person Contacted: Bob Rice

FINAL COMPLETION

Timber operations are complete. Stocking is not required. You have one year to complete all conversion activities. **Erosion control maintenance will be required for a period of One year, ending December 17 2015.**

If you have any question about this matter, please contact Lucas Titus at 707-777-1720.

Hugh Scanlon
Unit Chief

by: Lucas Titus RPF # 2870
Staff Forester

CC: Region, Unit, LTO, LO, RPF

FC

LT

ORIGINAL + C.G. TO UNIT
DATE 2/30 INITIALS r

State of California
Department of Forestry
and Fire Protection
Completion/Stocking Report
RM-71 (Rev. 12/08)
Page One of Three

Admin. Use Only

Area: _____
Date Received: DEC 29 2014
Date Approved: _____
Date Sent to B.O.E.: _____

GNR-orig, BOE, WQ, DFW
TO/TLO, LTO, RPF, Unit on _____

TIMBER OPERATIONS WORK COMPLETION AND/OR STOCKING REPORT
(As per Div. 4, Chap. 8, Sections 4585 and 4587 PRC, and Title 14 CCR Sections 1070-1075)

Certification By Timber Owner or Agent: I certify that the declarations herein are true and correct to the best of my knowledge and belief. I am notifying the Department of Forestry and Fire Protection of the status of compliance with the completion and stocking requirements of the Forest Practice Act and rules of the Board of Forestry and Fire Protection for:

Harvest Document Number: 1-14EX-129 HUM

Harvest document includes a Timber Harvesting Plan (THP), a Nonindustrial Timber Management Plan's Notice of Timber Operations (NTO), a Less Than Three Acre Conversion Exemption (EX), or an Emergency Notice (EM). For Timberland Conversion Permits (TCP), include the THP Number above, as well as the Conversion Permit No.: _____

Completion Report

- Final Completion Report** On (date): _____ all work on the operation was completed, and no further harvesting shall be conducted.
- Partial Completion Report.** On (date): _____ all work on a part of the plan as shown on the attached map was completed. Additional harvesting is anticipated on the remaining portion of the logging area. **Only one partial completion report may be accepted by the CAL FIRE during any calendar year.**
- NTMP-NTO Completion Report.** On (date): _____ all work on this NTO was completed for this calendar year. Additional harvesting is anticipated in following years.
- EX Completion Report.** On **December 17, 2014** all work on this **Less Than Three Acre Conversion Exemption** was completed. No stocking report is required.
- TCP Completion Report.** On (date): _____ all work on this **Timberland Conversion Permit** was completed. No stocking report is required.

Stocking Report: The area declared as complete in this report or a previously approved completion report meets all of the stocking requirements of the Forest Practice Act and rules of the Board of Forestry and Fire Protection. The stocking status after completion of timber operations was determined by:

- One of the sampling procedures adopted by the Board of Forestry and Fire Protection. The identification of the person sampling, plot data, and a map of the area sampled are attached.
- Physical examination of the area by the timber owner or the agent thereof after completion of timber operations determined that the area's stocking obviously meet the requirements of the Forest Practice Rules and a waiver of stocking sampling is requested.
- As stated in the harvest document, the area was **substantially damaged** as per 14 CCR § 1080.1, and only dead, down, or dying trees were salvaged, or the Site Class is IV or V, hence no restocking is required.

RECEIVED

RECEIVED

JAN 05 2015

DEC 29 2014

HUMBOLDT-DEL NORTE R.U.
RESOURCE MANAGEMENT

COAST AREA OFFICE
RESOURCE MANAGEMENT

This is a stocking report for the:

- Entire operating area covered by the harvest document.
- Entire operating area covered by this completion report or the completion report previously submitted on (date): _____
- Part of the operating area for which this completion report is submitted.

A map indicating the area completed (if the actual area harvested is less than approved) and/or stocked must be submitted with this report. Additional information can be found in the instruction pages of this form.



Signature

12-17-14
Date

Bob Rice
Print Name

P.O. Box 66
Address

Burnt Ranch
City

CA
State

95527
Zip Code

530-629-1929
Telephone Number (with Area Code)

DIRECTOR'S CERTIFICATION

Report In Conformance

- The Director has determined that all of the requirements of the Forest Practice Act and rules of the Board of Forestry and Fire Protection have been completed **except** stocking for the area described in this report. Erosion control maintenance is required for at least one year following the submission of this report, or until stocking is met, whichever is later, and it may be extended to three years.
- The area described by this report has been found to meet all of the requirements of the Forest Practice Act and forest practice rules **including** stocking as shown on the attached map. Erosion control maintenance is required for at least one year following the submission of this report or until stocking is met for the entire area of the harvest document, whichever is later, and it may be extended to three years.
- The area described by this report has been found to meet all of the requirements of the Forest Practice Act and Forest Practice Rules including stocking for the entire area as shown on the THP (or other harvest document) map. Erosion control maintenance is required for at least one year following the submission of this report, and it may be extended to three years.

Maintenance Period

The prescribed maintenance period for erosion control shall be:

- One Year.** Ending date: 12/17/2015
- Three Years.** Ending date: _____
- Other.** Specify length: _____ years and ending date: _____

RECEIVED

DEC 29 2014

COAST AREA OFFICE
RESOURCE MANAGEMENT

Report Not In Conformance

- The area described by this report has been found **not to be in compliance** with the Forest Practice Act and Forest Practice Rules. See attached documents for further information. **A new completion and/or stocking report must be submitted** upon completion of the work required in the documents attached.
- The Director has determined that the **stocking** requirements of the Forest Practice Act and forest practice rules **have not been met**. See attached documents for further information. **A new completion and/or stocking report must be submitted** upon completion of the work required in the documents attached.

Other Reports

- Conversion Permit.** The Completion Report is necessary, but a stocking report is not required.
- Less Than Three Acre Conversion Exemption.** The Completion Report is necessary, but a stocking report is not required.
- Emergency Notice or a THP with Substantially Damaged Timberland** as per 14 CCR § 1080.1, where a stocking report is not required.

For the selection from **Other Reports** above, the Director has determined that all of the requirements of the Forest Practice Act and Forest Practice Rules:

- Have been completed.**
- Have not been completed** and are not in compliance with the regulations and/or the rules. See attached documents for further information. **A new completion report must be submitted** upon completion of the work required in the documents attached.

Director, California Department of Forestry and Fire Protection

By: _____
Signature *Lucas Titus* Print Name *Lucas Titus*

_____ RPF # *2870* Date *2/26/15*
Title *Forestry I*

RECEIVED

DEC 29 2014

COAST AREA OFFICE
RESOURCE MANAGEMENT

**Aisha Morton Conversion
General Location Map**

 Property Boundary

 Conversion Exemption

Scale 1" = 2,000'
Section 26, T3N, R4E, HB&M.

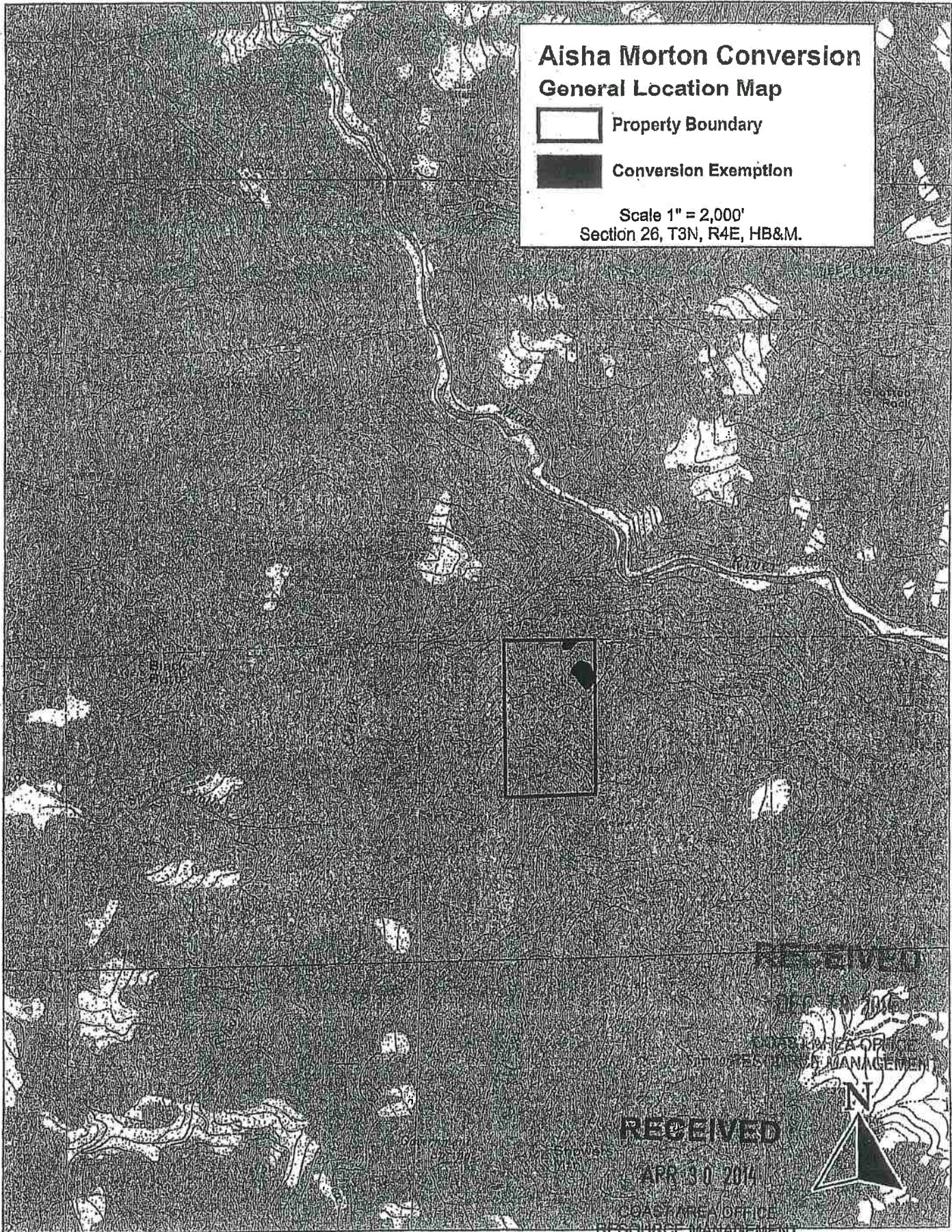

RECEIVED

APR 30 2014

COAST GUARD OFFICE
RESOURCE MANAGEMENT

