

Pld Style: 11 x 17 construction.ctb
Last Saved By: jim.smith 2025/05/23
Drawing Name: C:\pw_working\lochner-pw-01\20250326\24146 TITLE.dwg May 23, 2025 - 9:03am

GARBERVILLE AIRPORT (O16)

COUNTY OF HUMBOLDT , CALIFORNIA

FOR BIDDING PURPOSES ONLY
NOT FOR CONSTRUCTION

AIP No. 3-06-0092-0XX-2025

GENERAL DESCRIPTION OF PROJECT:
RUNWAY SAFETY AREA IMPROVEMENTS;
REPLACE CULVERT

INDEX OF SHEETS

SHEET NUMBER	SHEET TITLE
1.1	TITLE SHEET
1.2	AIRPORT LAYOUT, LEGEND, NOTES, SURVEY CONTROL
2.1	REMOVALS PLAN
3.1	GRADING PLAN
4.1	STORM DRAIN DETAILS
ATTACHED	CONSTRUCTION SAFETY & PHASING PLAN

VICINITY MAP

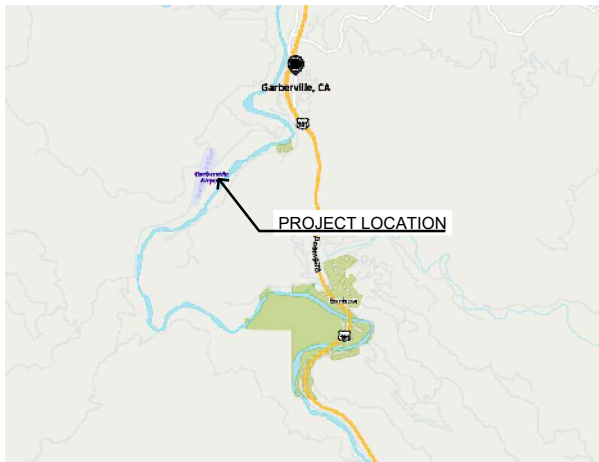

NO SCALE



JUNE 2025



GARBERVILLE AIRPORT (O16)

GARBERVILLE, CALIFORNIA

AIP No. 3-06-0092-0XX-2025

PROJECT NO.	24146
DRAWN BY	MAC / JOS
CHECKED BY	EFR / NPD
DESIGNED BY	ACT / DWK
REVISIONS	

TITLE SHEET

1.1

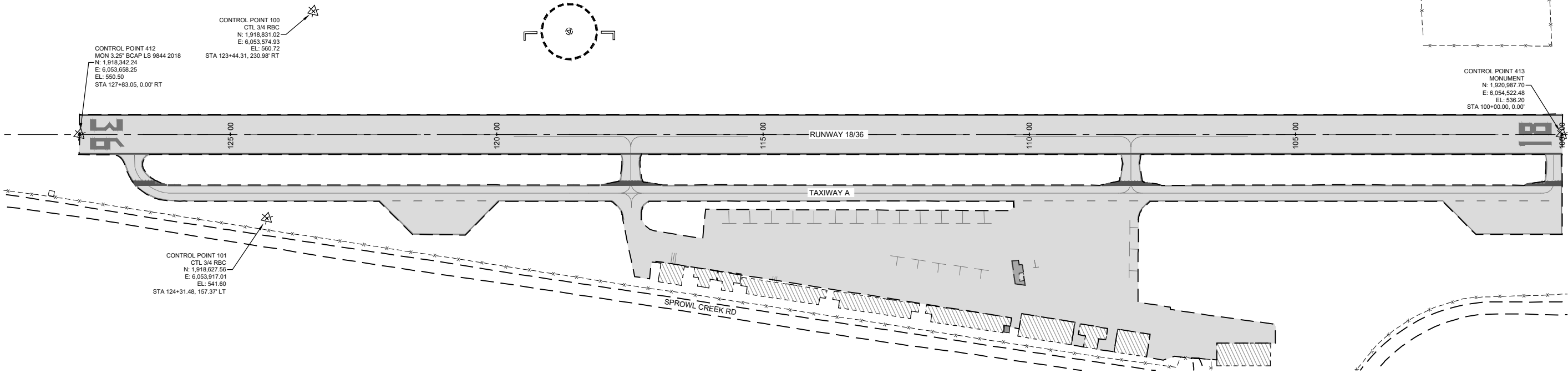

LEGEND

X 0.00		X 99.99	
---	EXISTING SPOT ELEVATION	---	PROPOSED FINISHED GRADE ELEVATION
---	EXISTING GROUND CONTOUR (5' INTERVAL)	---	PROPOSED GROUND CONTOUR (1' INTERVAL)
---	EXISTING RUNWAY EDGE LIGHT	---	PROPOSED RUNWAY EDGE LIGHT
---	EXISTING TAXIWAY EDGE LIGHT	---	PROPOSED TAXIWAY EDGE LIGHT
---	EXISTING RETROREFLECTIVE MARKER	---	PROPOSED TAXIWAY RETROREFLECTIVE MARKER
---	EXISTING SPLICE BASE / PULL BOX	---	PROPOSED SPLICE BASE / PULL BOX
---	EXISTING AIRFIELD SIGN	---	PROPOSED AIRFIELD SIGN
---	EXISTING BEACON	---	PROPOSED BEACON AND TOWER
---	EXISTING WIND CONE	---	PROPOSED LIGHTED WIND CONE
---	EXISTING SEGMENTED CIRCLE	---	PROPOSED SUPPLEMENTAL WIND CONE
---	EXISTING PAPI / VASI	---	PROPOSED SEGMENTED CIRCLE
---	EXISTING REIL	---	PROPOSED PAPI
---	EXISTING AWOS/ASOS/UNICOM	---	PROPOSED REIL
---	EXISTING TIEDOWN ANCHOR	---	PROPOSED AWOS
---	EXISTING UTILITY POLE	---	PROPOSED TIEDOWN ANCHOR
---	EXISTING AREA LIGHT	---	PROPOSED UTILITY POLE
---	EXISTING GUY	---	PROPOSED AREA LIGHT (S)
---	EXISTING PAD MOUNTED TRANSFORMER	---	PROPOSED ELECTRIC TRANSFORMER
---	EXISTING UTILITY PEDESTAL	---	PROPOSED MANHOLE
---	EXISTING UTILITY METER	---	PROPOSED SANITARY SEWER CLEAN-OUT
---	EXISTING MANHOLE / CLEAN-OUT	---	PROPOSED STORM DRAIN INLET
---	EXISTING AREA INLET / CATCH BASIN	---	PROPOSED FIRE HYDRANT
---	EXISTING FIRE HYDRANT	---	PROPOSED WATER VALVE
---	EXISTING WATER VALVE	---	PROPOSED SURVEY MONUMENT
---	EXISTING TREE	---	PROPOSED AIRFIELD POWER CABLE(S)
---	EXISTING ROAD SIGN(S)	---	PROPOSED COUNTERPOISE CABLE
---	EXISTING SECTION CORNER	---	PROPOSED CONCRETE ENCASED DUCT BANK
---	EXISTING SURVEY CONTROL MONUMENT	---	PROPOSED CULVERT w/END SECTIONS
---	EXISTING PROPERTY CORNER PIN/CAP	---	PROPOSED SWALE DIRECTION
---	EXISTING AIRFIELD POWER CABLE(S)	---	PROPOSED BARBED WIRE FENCE
---	EXISTING CONCRETE DUCT BANK	---	PROPOSED CHAIN LINK FENCE
---	EXISTING CULVERT	---	PROPOSED WILDLIFE FENCE
---	EXISTING SWALE DIRECTION	---	PROPOSED SANITARY SEWER LINE
---	EXISTING BARB WIRE FENCE	---	PROPOSED STORM DRAIN LINE
---	EXISTING CHAIN LINK FENCE	---	PROPOSED WATERLINE
---	EXISTING WILDLIFE FENCE	---	PROPOSED GAS LINE
---	EXISTING SANITARY SEWER LINE	---	PROPOSED UNDERGROUND POWER/TELE
---	EXISTING STORM DRAIN LINE	---	PROPOSED PERFORATED UNDERDRAIN W/ CLEAN-OUT
---	EXISTING WATER LINE	---	PROPOSED NON-PERFORATED UNDERDRAIN
---	EXISTING GAS LINE	---	PROPOSED SEDIMENT LOG
---	EXISTING UNDERGROUND POWER OR TELE. LINE	---	PROPOSED SILT FENCE
---	EXISTING OVERHEAD POWER CABLE	---	PROPOSED CONCRETE PAVEMENT
---	EXISTING UNDERGROUND COMMUNICATION LINE	---	PROPOSED ASPHALT PAVEMENT
---	EXISTING FIBER OPTIC CABLE	---	PROPOSED ASPHALT/CONCRETE REMOVAL
---	EXISTING UNDERDRAIN W/ CLEAN-OUT	---	PROPOSED GRAVEL
---	EXISTING CONCRETE PAVEMENT	---	PROPOSED ROCK RIPRAP
---	EXISTING ASPHALT PAVEMENT	---	PROPOSED BUILDING
---	EXISTING GRAVEL	---	PROPOSED SEEDING AREA
---	EXISTING BUILDING	---	PROPOSED GRADING AREA
---	EXISTING WETLANDS	---	

NOTE: LEGEND APPLIES TO ALL SHEETS IN THIS PLAN SET, IS GENERIC, AND NOT ALL SYMBOLS MAY BE IN PLAN SHEETS.

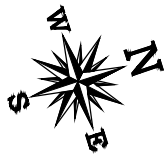

AIRPORT LAYOUT & SURVEY CONTROL



SCALE IN FEET

GENERAL NOTES

- ESTIMATED QUANTITIES ARE CONSIDERED APPROXIMATE ONLY EXCEPT WHERE PLAN QUANTITIES ARE SPECIFIED FOR PAYMENT. ACTUAL QUANTITIES SHALL BE DETERMINED BY FIELD MEASUREMENT OR SPECIFICATIONS.
- THE CONTRACTOR SHALL PROVIDE MATERIAL SUBMITTALS FOR THE ENGINEER'S APPROVAL PRIOR TO ORDERING.
- THE CONTRACTOR IS REQUIRED TO OBTAIN ALL NECESSARY CONSTRUCTION PERMITS AS NECESSARY FOR THE PROJECT.
- THE CONTRACTOR SHALL BE REQUIRED TO SUBMIT A WORK SCHEDULE AND PROPOSED CONSTRUCTION METHODS AT THE PRE-CONSTRUCTION CONFERENCE.
- THE CONTRACTOR SHALL OBTAIN APPROVAL FROM AIRPORT MANAGEMENT AND THE ENGINEER PRIOR TO ESTABLISHING CONSTRUCTION ACCESS OR HAUL ROADS. EXISTING PAVEMENT SURFACES OTHER THAN AIRFIELD PAVEMENTS SHALL BE USED TO THE MAXIMUM EXTENT POSSIBLE.
- THE CONTRACTOR SHALL MINIMIZE DISTURBANCE INCLUDING RUTS PRODUCED BY VEHICLES AND EQUIPMENT IN NON-PAVEMENT AREAS WITHIN ALL CONSTRUCTION AREAS. ALL DISTURBED AREAS IN THESE LOCATIONS SHALL BE RECLAIMED AT NO ADDITIONAL COST TO THE SPONSOR. DAMAGE CAUSED TO EXISTING AIRFIELD PAVEMENTS, AIRFIELD CABLE CIRCUITS OR FACILITIES DURING CONSTRUCTION SHALL BE REPAIRED BY THE CONTRACTOR AT NO ADDITIONAL COST TO THE SPONSOR.
- CONTRACTOR SHALL COORDINATE ALL ON-SITE WASTE MATERIAL DISPOSAL WITH ENGINEER AND AIRPORT.

NOTES TO SURVEYOR:

- THE PROJECT CONTROL IS A MODIFIED STATE PLANE COORDINATE SYSTEM.
- ALL DISTANCE UNITS ARE IN FEET AT GROUND.
- A BASE LINE WITH STATIONS AND OFFSETS HAS BEEN SET AT THE RUNWAY CENTERLINE FOR PROJECT CONTROL. ALL INFORMATION FOR THIS PROJECT WILL BE BASED ON THIS BASE LINE.
- BEFORE ANY CONSTRUCTION OPERATIONS BEGIN, CONSTRUCTION SURVEYOR TO RUN A TRAVERSE, LEVEL LOOP, AND VERIFY CONTROL. ANY DISCREPANCIES SHALL BE RESOLVED WITH PROJECT ENGINEER.
- FOR QUALITY CONTROL AND VERIFICATION PURPOSES, ANY WRITTEN SURVEY INFORMATION SUPPLIED TO LOCHNER SHALL BE IN STATION, OFFSET, ELEVATION FORMAT.

CAUTION - NOTICE TO CONTRACTOR

THE CONTRACTOR IS SPECIFICALLY CAUTIONED THAT THE LOCATION AND/OR ELEVATION OF EXISTING UTILITIES AS SHOWN ON THESE PLANS IS BASED ON RECORDS OF THE VARIOUS UTILITY COMPANIES AND WHERE POSSIBLE, MEASUREMENTS IN THE FIELD. THE INFORMATION IS PROVIDED FOR THE CONVENIENCE OF THE CONTRACTOR AND IS NOT TO BE RELIED UPON AS BEING EXACT OR COMPLETE. THE CONTRACTOR MUST CALL CALIFORNIA 811 (1-800-824-2444) AT LEAST 48 HOURS BEFORE ANY EXCAVATION / EMBANKMENT TO REQUEST FIELD LOCATION OF UTILITIES.



GARBerville AIRPORT (O16)

GARBerville, CALIFORNIA

AIP No. 3-06-0092-0XX-2025

PROJECT NO.	24146	DATE
DRAWN BY	MAC / JOS	06/2025
CHECKED BY	EFR / NPD	06/2025
DESIGNED BY	ACT / DWK	06/2025
REVISIONS		DATE

AIRPORT LAYOUT,
LEGEND, NOTES,
SURVEY CONTROL

1.2

Plot Style: 11 x 17 construction.ctb

Last Saved By: jim.smith 2025/05/22

Drawing Name: C:\Users\jim-1\SMI\AppData\Local\Temp\AcPublish_17812\24146-DEMO.dwg May 22, 2025 - 4:04pm

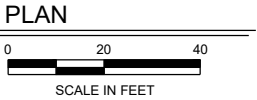
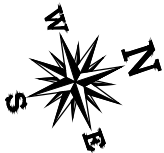
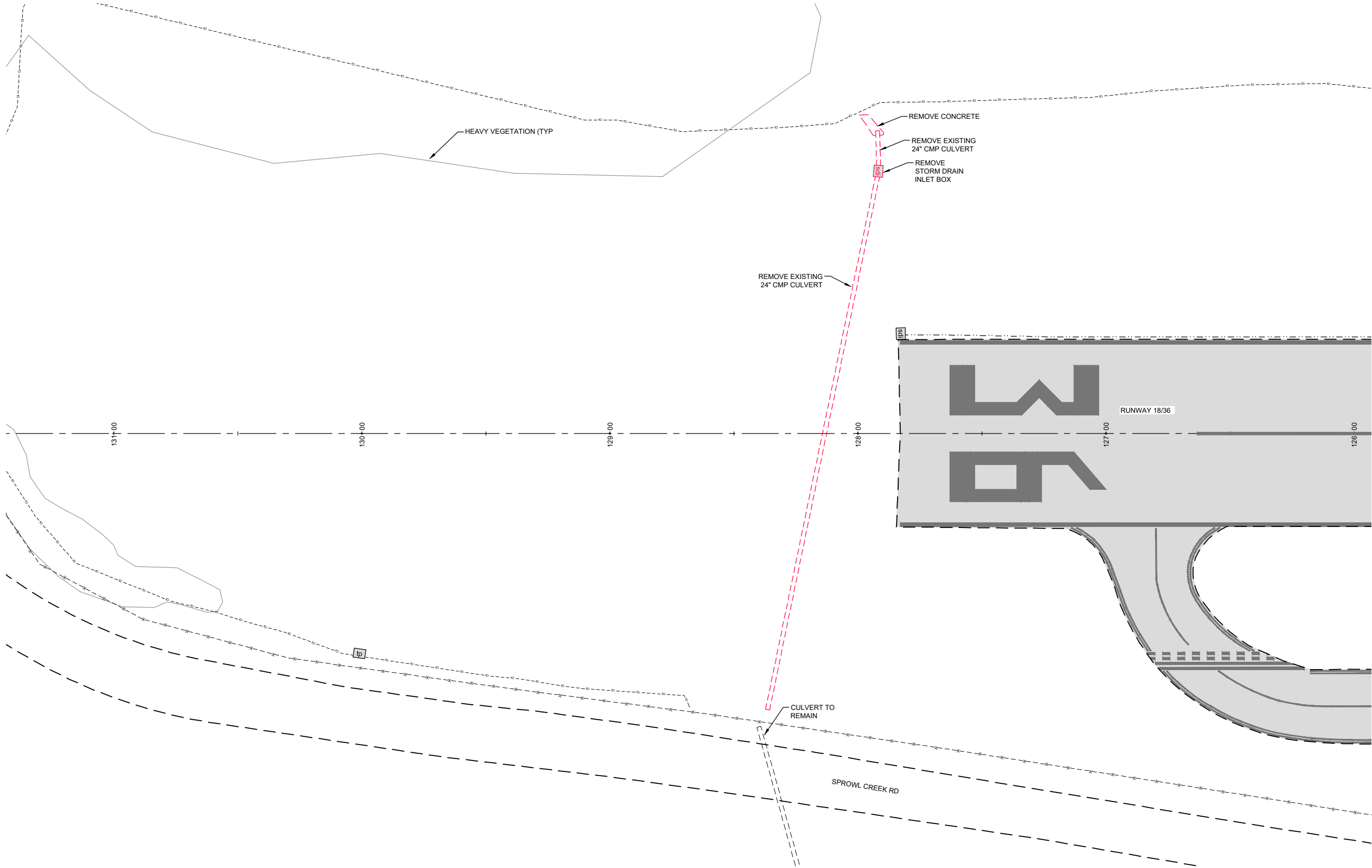

NOTE: ALL EXISTING FEATURES, UTILITIES, ETC., ABOVE AND BELOW GROUND, ARE CONSIDERED "PROTECT IN PLACE" UNLESS NOTE OTHERWISE.

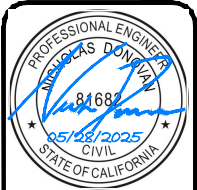

GARBERVILLE AIRPORT (O16)

GARBERVILLE, CALIFORNIA

AIP No. 3-06-0092-0XX-2025

PROJECT NO.	24146	DATE
DRAWN BY	MAC / JOS	06/2025
CHECKED BY	EFR / NPD	06/2025
DESIGNED BY	ACT / DWK	06/2025
REVISIONS		DATE

REMOVALS PLAN

2.1

Pld Style: 11 x 17 construction.ctb
Last Saved By: jlm.smith 2025/04/14
Drawing Name: C:\Users\jim-1\MyAppData\Local\Temp\AcPublish_17812\24146-GRABE.dwg May 22, 2025 - 4:14pm

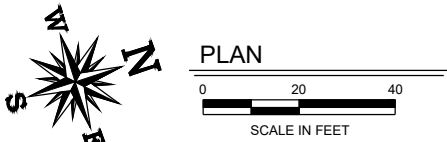
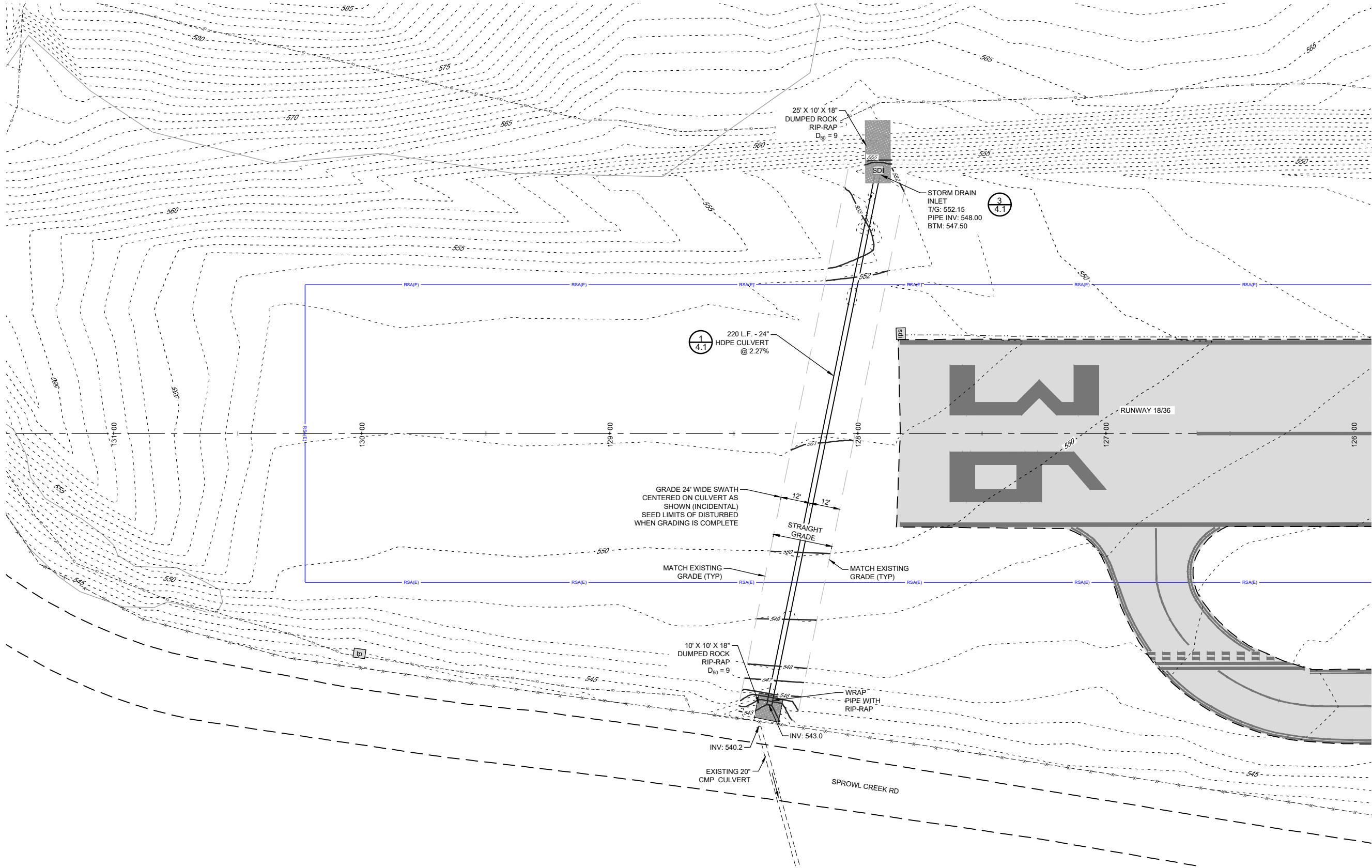

GARBERVILLE AIRPORT (O16)

GARBERVILLE, CALIFORNIA

AIP No. 3-06-0092-0XX-2025

PROJECT NO.	24146	DATE
DRAWN BY	MAC / JOS	06/2025
CHECKED BY	EFR / NPD	06/2025
DESIGNED BY	ACT / DWK	06/2025
REVISIONS		DATE

GRADING
PLAN

3.1



GARBERVILLE AIRPORT (O16)

GARBERVILLE, CALIFORNIA

AIP No. 3-06-0092-0XX-2025

PROJECT NO. 24146	
DRAWN BY MAC / JOS	DATE 06/2025
CHECKED BY EFR / NPD	DATE 06/2025
DESIGNED BY ACT / DWK	DATE 06/2025
REVISIONS	DATE

STORM DRAIN DETAILS

4.1

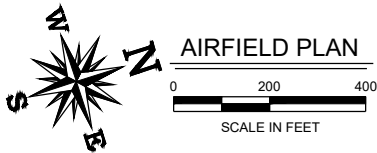
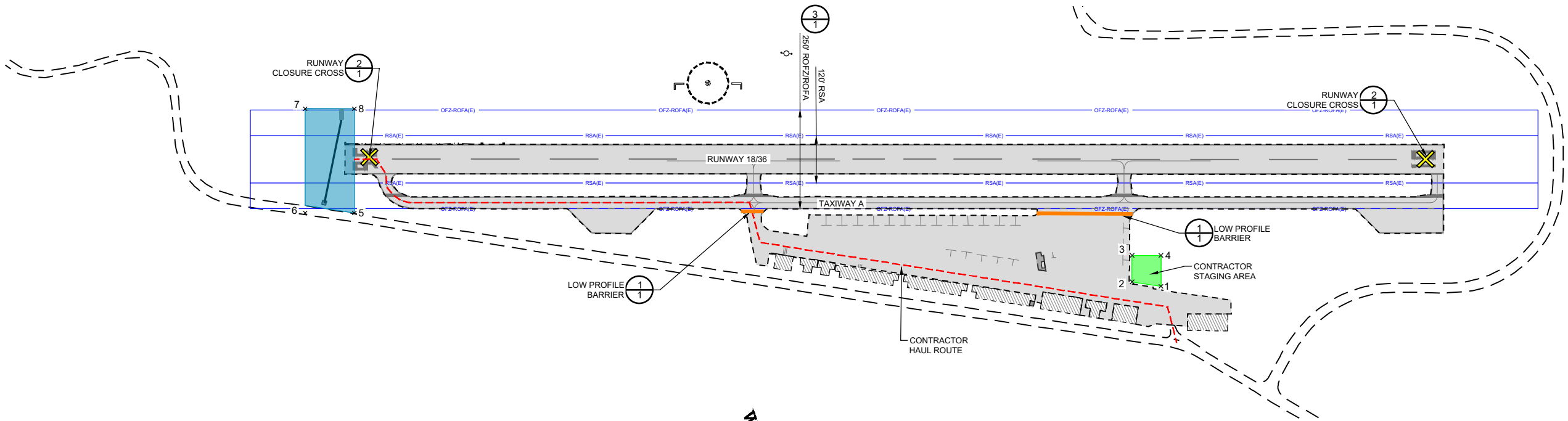

AIRFIELD PLAN

SCALE IN FEET

WORK AREA COORDINATES

POINT #	ELEVATION	LATITUDE	LONGITUDE
1	533'	N040°05'13.05"	W123°48'44.44"
2	533'	N040°05'12.39"	W123°48'44.86"
3	533'	N040°05'12.58"	W123°48'45.68"
4	533'	N040°05'13.27"	W123°48'45.41"
5	549'	N040°04'54.26"	W123°48'54.37"
6	547'	N040°04'53.08"	W123°48'54.84"
7	563'	N040°04'53.84"	W123°48'58.08"
8	563'	N040°04'55.01"	W123°48'57.62"

LATITUDE AND LONGITUDES (LAT/LONG) DELINEATION OF THE CONSTRUCTION AREA AND CONTRACTOR STAGING AREA LIMITS ELEVATIONS WERE OBTAINED FROM GOOGLE EARTH

LEGEND

- PHASE I WORK AREA
- CONTRACTOR STAGING AREA
- LOW PROFILE BARRIER
- CONTRACTOR HAUL ROUTE
- DETAIL #
- SHEET #
- ROFA = RUNWAY OBJECT FREE AREA
- ROFZ = RUNWAY OBSTACLE FREE ZONE
- RSA = RUNWAY SAFETY AREA

NOTES:

- CONTRACTOR SHALL BE RESPONSIBLE FOR ANY DAMAGE CAUSED BY CONSTRUCTION ACTIVITIES TO HAUL ROUTES. ANY DAMAGE SHALL BE REPAIRED BY THE CONTRACTOR AT NO EXPENSE TO THE SPONSOR.

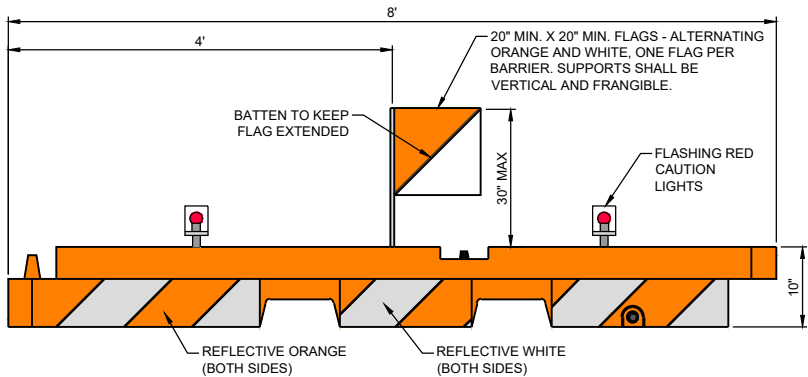

NOTES:

- BARRIER SHALL BE SHERWIN INDUSTRIES, 10" x 96" LOW PROFILE AIRPORT BARRIER, AS SHOWN, OR APPROVED EQUAL.
- THE ENTIRE AREA OF ORANGE AND WHITE STRIPES SHALL BE REFLECTORIZED WITH SMOOTH SURFACE TYPE REFLECTIVE SHEETING.
- LIGHTS MUST BE MOUNTED ON BARRIERS AND SPACED AT NO MORE THAN 10 FT.
- THE BARRIERS SHALL BE WEIGHTED AGAINST PROWASH AND CAPABLE OF WITHSTANDING UP TO 100 M.P.H. WIND FORCES.
- FLASHING RED CAUTION LIGHTS SHALL BE BATTERY OPERATED AND SHALL MAINTAIN SUCH INTENSITY SO AS TO BE READILY IDENTIFIED FROM DISTANCES OF AT LEAST 200 FEET DURING DARKNESS.
- THE CONTRACTOR SHALL CHECK ALL BARRIERS AND LIGHTS EACH DAY BEFORE LEAVING THE AIRPORT TO ENSURE LIGHTS ARE WORKING PROPERLY AND MAY NOT LEAVE WITHOUT ALL BARRIERS AND LIGHTS BEING IN PROPER WORKING ORDER.

1 LOW PROFILE SAFETY BARRIER
NOT TO SCALE

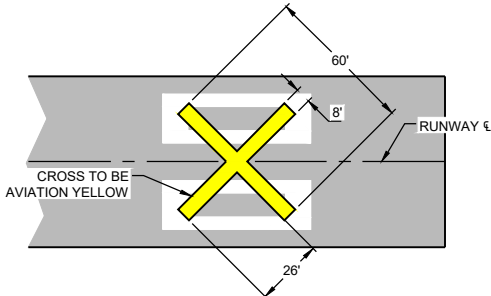

2 RUNWAY CLOSURE CROSS
NOT TO SCALE

NOTE:

2 EACH REQUIRED PER CLOSED RUNWAY- INCIDENTAL. TO BE APPLIED OVER RUNWAY NUMERALS ON RUNWAY OR AT RUNWAY ENDS PRIOR TO RUNWAY CLOSURE. CROSSES TO BE CONSTRUCTED OF PLYWOOD OR OTHER FLAT MATERIALS WHICH SHALL BE SECURELY FASTENED TO PAVEMENT AND/OR ADEQUATELY WEIGHTED WITH SAND BAGS.

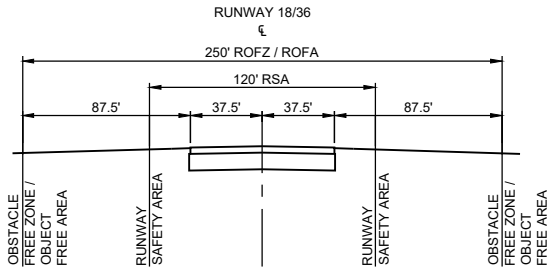

ALL CONSTRUCTION EQUIPMENT, STOCKPILES, AND TRAFFIC MUST REMAIN CLEAR OF ANY OPEN RUNWAY OBSTACLE FREE ZONE / OBJECT FREE AREA.

3 SAFETY AREAS
NOT TO SCALE

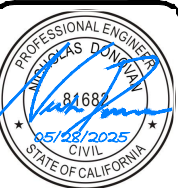

Lochner

GARBERVILLE AIRPORT (O16)

GARBERVILLE, CALIFORNIA

AIP No. 3-06-0092-0XX-2025

PROJECT NO.	24146
DRAWN BY	MAC / JOS
CHECKED BY	EFR / NPD
DESIGNED BY	ACT / DWK
REVISIONS	

CONSTRUCTION SAFETY
&
PHASING PLAN

1 of 1