

C:\My Drive\MotherEarthEngineering\Project Files\2019\19040 - North Bay Nevada Cannabis APN 208-241-018\11-10-2019

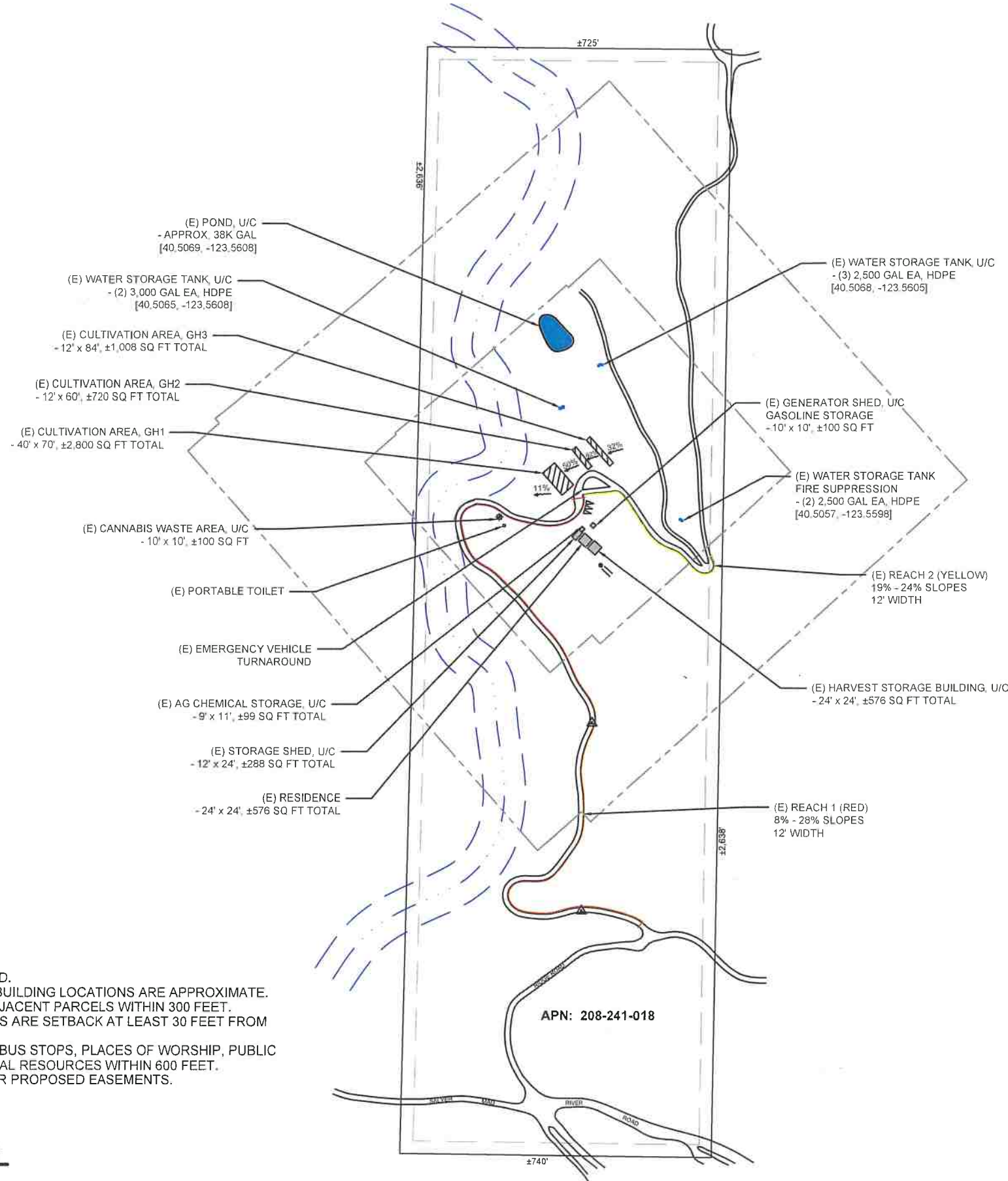

- NOTE:**
1. NO GRADING PROPOSED.
 2. PROPERTY LINES AND BUILDING LOCATIONS ARE APPROXIMATE.
 3. NO RESIDENCES ON ADJACENT PARCELS WITHIN 300 FEET.
 4. ALL CULTIVATION AREAS ARE SETBACK AT LEAST 30 FEET FROM PROPERTY LINES.
 5. NO SCHOOLS, SCHOOL BUS STOPS, PLACES OF WORSHIP, PUBLIC PARKS, TRIBAL CULTURAL RESOURCES WITHIN 600 FEET.
 6. NO KNOWN EXISTING OR PROPOSED EASEMENTS.

PLOT PLAN
SCALE: 1"=300'

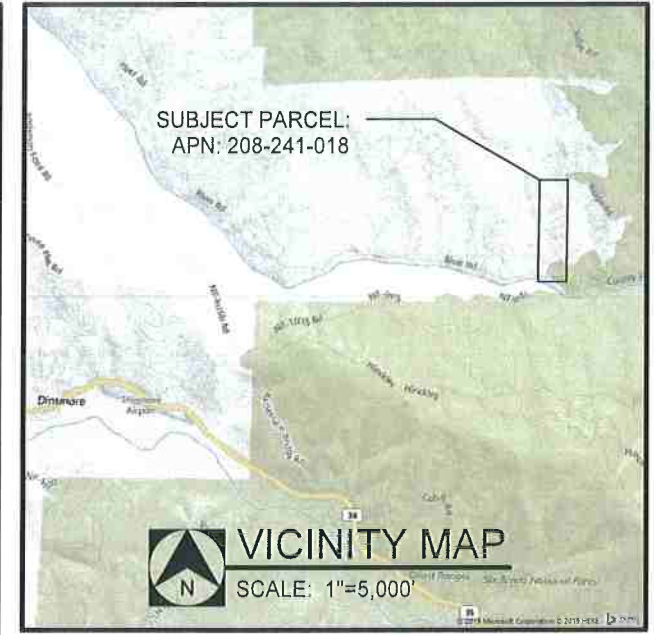

DIRECTIONS TO SITE

FROM FORTUNA, CA:

HEAD EAST ON CA HWY 36, 52.4 MILES.

TURN LEFT ONTO COUNTY LINE CREEK RD, 4.2 MILES.

CONTINUE ONTO SALYER MAD RIVER RD, 1.0 MILES.

TURN RIGHT ONTO RIDGE RD, 1.2 MILES.

PROPERTY IS ON THE LEFT.

LEGEND

- PROPERTY LINE
- 30' SETBACK FROM PROPERTY LINE
- 300' SETBACK FROM CULTIVATION AREAS
- 600' SETBACK FROM CULTIVATION AREAS
- CLASS III WATERCOURSE WITH 50 FT STREAM SIDE MANAGEMENT AREA BUFFER
- WATER LINE FOR CULTIVATION ACTIVITIES
- PUBLIC ROAD
- ACCESS ROAD
- STRUCTURE
- OUTDOOR CULTIVATION AREA
- SEPTIC SYSTEM
- DITCH RELIEF CULVERT
- PARKING SPACE, 9'X18'
- EXISTING
- PROPOSED
- NOT USED FOR CULTIVATION
- USED FOR CULTIVATION
- % SLOPE AND DIRECTION

MOTHER EARTH ENGINEERING

661 G STREET
ARCATA, CA 95521, 707-633-8321

MEE JOB NO: 019040

REVISION SCHEDULE			
#	DATE	BY	DESCRIPTION
0	11/18/19	JL	DRAFTED
1			
2			
3			
4			
5			

RECEIVED
DEC 31 2019
Humboldt County
Cannabis Svcs.

1.0 CULTIVATION PERMIT
APPLICANT: NORTH BAY NECTAR
MAILING ADDRESS: PO BOX 274, MAD RIVER, CA 95552

PLOT PLAN
APN: 208-241-018
SITE ADDRESS:

SHEET NO:
1