

HUMBOLDT COUNTY DEPARTMENT OF PUBLIC WORKS
ROAD EVALUATION REPORT

12848
RECEIVED

AUG 07 2020

Humboldt County
Cannabis Svcs.

PART A: *Part A may be completed by the applicant*

Applicant Name: Drew Cowan

APN: 522-033-010

Planning & Building Department Case/File No.: 12848

Road Name: Old 3 Creeks Road (complete a separate form for each road)

From Road (Cross street): State Route 299

To Road (Cross street): Unnamed Access Road

Length of road segment: 5.5 miles Date Inspected: 5/14/20

Road is maintained by: ☐ County ☒ Other Road Association
(State, Forest Service, National Park, State Park, BLM, Private, Tribal, etc)

Check one of the following:

Box 1 ☐ The entire road segment is developed to Category 4 road standards (20 feet wide) or better. If checked, then the road is adequate for the proposed use without further review by the applicant.

Box 2 ☒ The entire road segment is developed to the equivalent of a road category 4 standard. If checked, then the road is adequate for the proposed use without further review by the applicant.

An equivalent road category 4 standard is defined as a roadway that is generally 20 feet in width, but has pinch points which narrow the road. Pinch points include, but are not limited to, one-lane bridges, trees, large rock outcroppings, culverts, etc. Pinch points must provide visibility where a driver can see oncoming vehicles through the pinch point which allows the oncoming vehicle to stop and wait in a 20 foot wide section of the road for the other vehicle to pass.

Box 3 ☐ The entire road segment is not developed to the equivalent of road category 4 or better. The road may or may not be able to accommodate the proposed use and further evaluation is necessary. Part B is to be completed by a Civil Engineer licensed by the State of California.

The statements in PART A are true and correct and have been made by me after personally inspecting and measuring the road. A map showing the location and limits of the road being evaluated in PART A is attached.

Drew Cowan
Signature

7-31-20
Date

Drew Cowan
Name Printed

Important: Read the instructions before using this form. If you have questions, please call the Dept. of Public Works Land Use Division at 707.445.7205.

**HUMBOLDT COUNTY DEPARTMENT OF PUBLIC WORKS
ROAD EVALUATION REPORT**

PART A: *Part A may be completed by the applicant*

Applicant Name: Drew Cowan

APN: 522-033-010

Planning & Building Department Case/File No.: 12848

Road Name: Unnamed Access Road *(complete a separate form for each road)*

From Road (Cross street): Old 3 Creeks Road

To Road (Cross street): Arrive at property

Length of road segment: 1 miles Date Inspected: 5/14/20

Road is maintained by: ☐ County ☒ Other Road Association
(State, Forest Service, National Park, State Park, BLM, Private, Tribal, etc)

Check one of the following:

Box 1 ☐ The entire road segment is developed to Category 4 road standards (20 feet wide) or better. If checked, then the road is adequate for the proposed use without further review by the applicant.

Box 2 ☒ The entire road segment is developed to the equivalent of a road category 4 standard. If checked, then the road is adequate for the proposed use without further review by the applicant.

An equivalent road category 4 standard is defined as a roadway that is generally 20 feet in width, but has pinch points which narrow the road. Pinch points include, but are not limited to, one-lane bridges, trees, large rock outcroppings, culverts, etc. Pinch points must provide visibility where a driver can see oncoming vehicles through the pinch point which allows the oncoming vehicle to stop and wait in a 20 foot wide section of the road for the other vehicle to pass.

Box 3 ☐ The entire road segment is not developed to the equivalent of road category 4 or better. The road may or may not be able to accommodate the proposed use and further evaluation is necessary. Part B is to be completed by a Civil Engineer licensed by the State of California.

The statements in PART A are true and correct and have been made by me after personally inspecting and measuring the road. A map showing the location and limits of the road being evaluated in PART A is attached.

Drew Cowan
Signature

7-31-20
Date

Drew Cowan
Name Printed

Important: Read the instructions before using this form. If you have questions, please call the Dept. of Public Works Land Use Division at 707.445.7205.

Road Evaluation Overview Map

4 Ponds LLC - 12848
APN 522-033-010

Legend

- APN 522-033-010
- Old 3 Creeks Road Segment
- Road Segment
- Unnamed Access Road Segment
- Willow Creek

APN 522-033-010

Unnamed Access Road Segment

Old 3 Creeks Road Segment

Google Earth

© 2020 Google



3 mi

Photo Log Map 1

4 Ponds LLC - 12848
APN 522-033-010

Legend

- APN 522-033-010
- Old 3 Creeks Road Segment
- Photo Location
- Unnamed Access Road Segment

APN 522-033-010

1

2

3

4

5

Google Earth

© 2020 Google



3000 ft

Photo Log Map 2

4 Ponds LLC - 12848
APN 522-033-010

APN 522-033-010

Legend

- APN 522-033-010
- Old 3 Creeks Road Segment
- Photo Location
- Unnamed Access Road Segment

Google Earth

© 2020 Google



2 mi

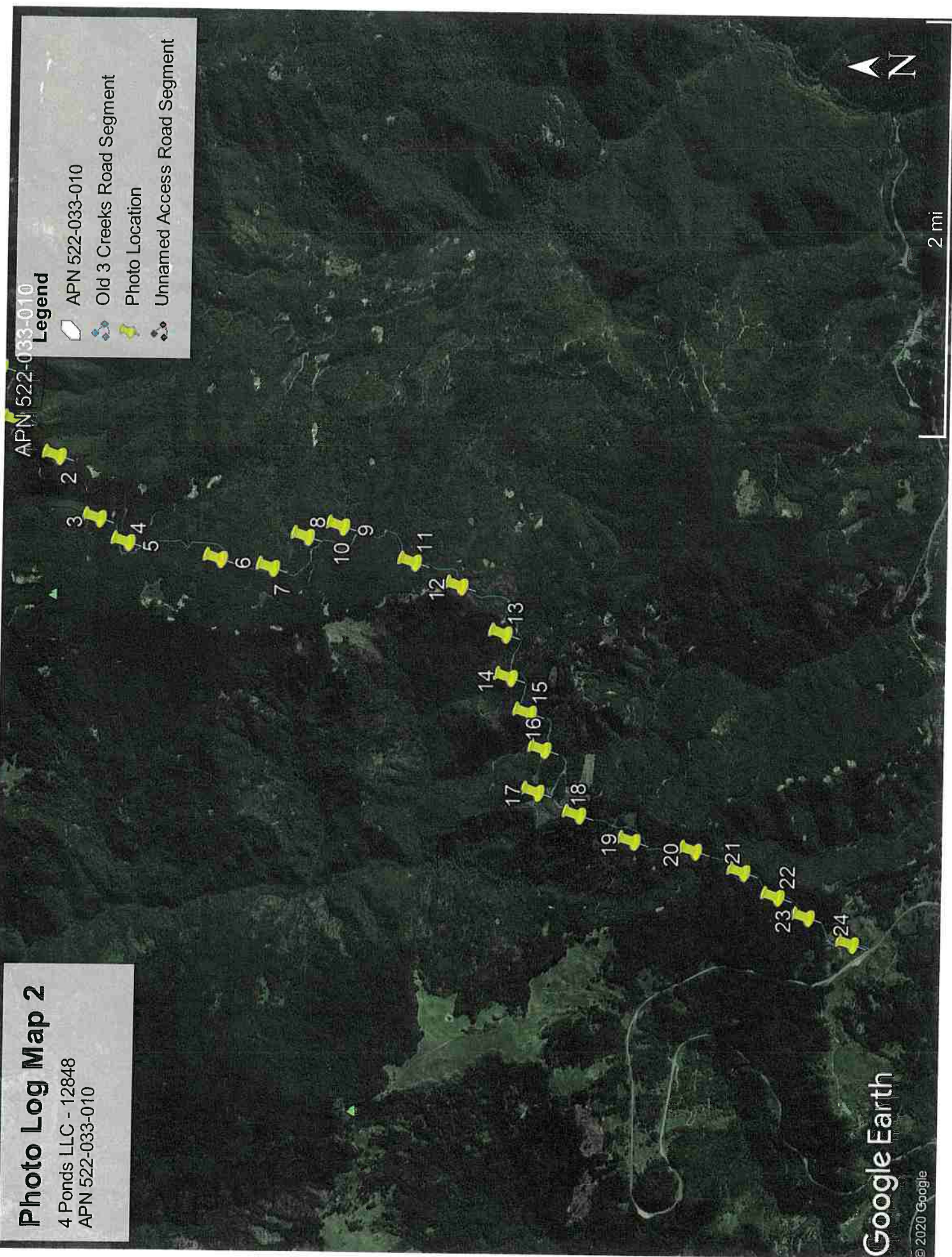

Road Evaluation Photo Log

4 Ponds, LLC

Drew Cowan

APN: 522-033-010

Date Prepared: 5/19/2020

Prepared by: Jackson Ingram, EIT, Belle Ciotti

All Photos Taken by: Phil Zerkel, Trillian Schroeder

Photo 1

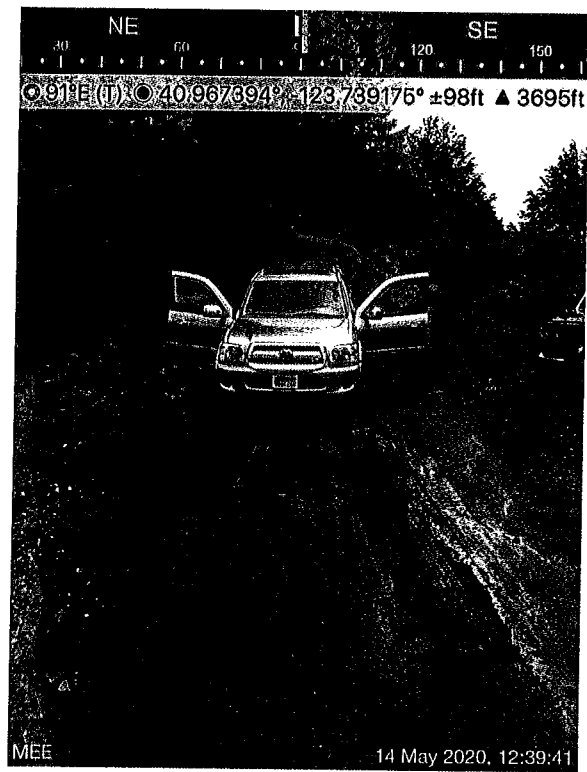

Photo 2

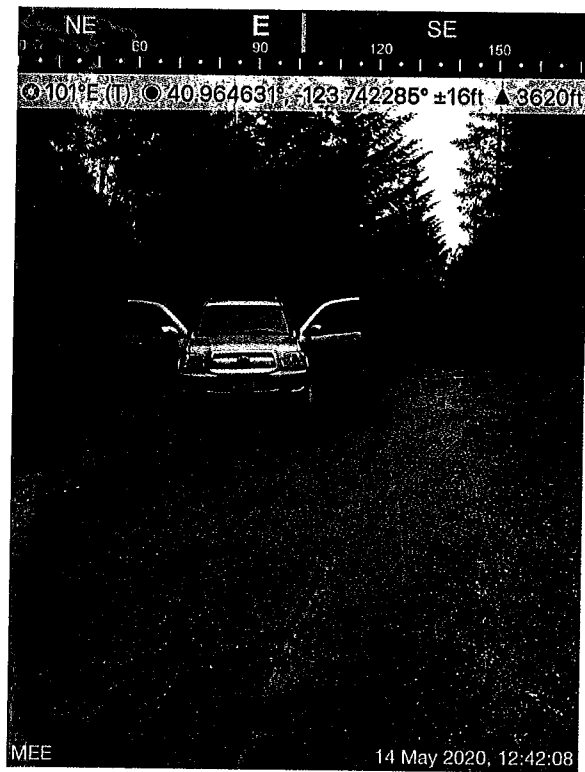

Photo 3

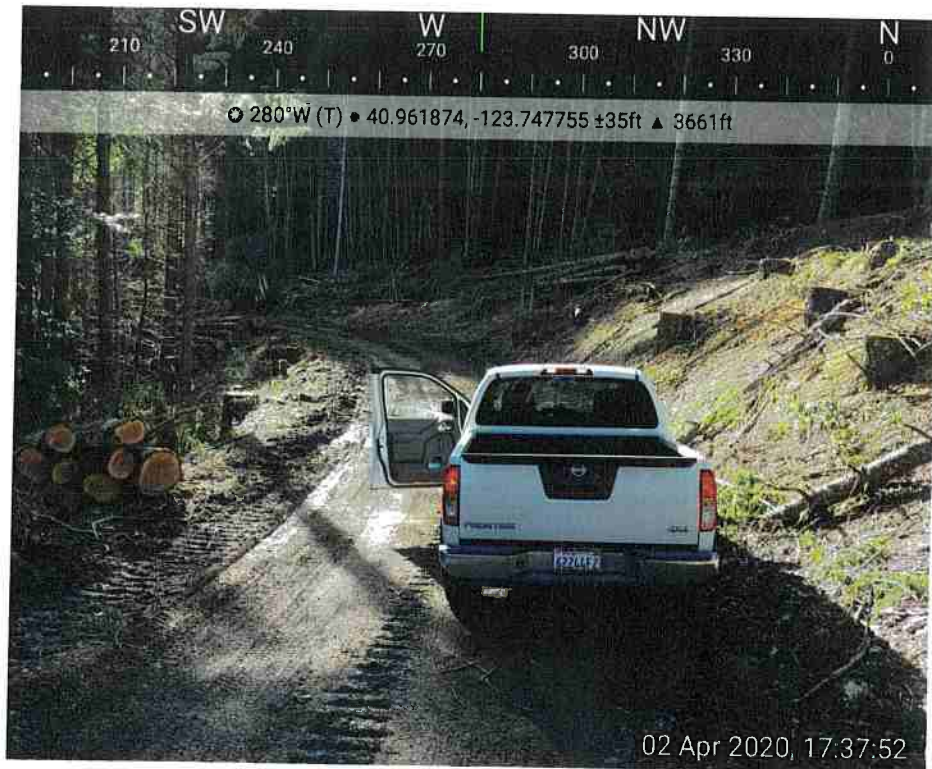

Photo 4

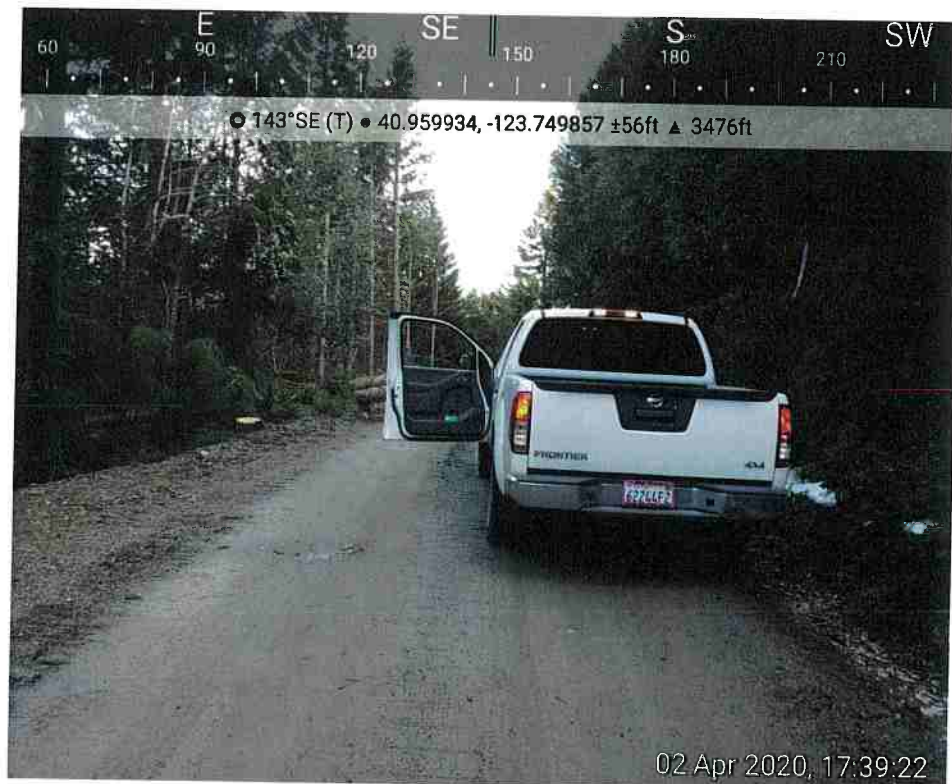

Photo 5



Photo 6



Photo 7

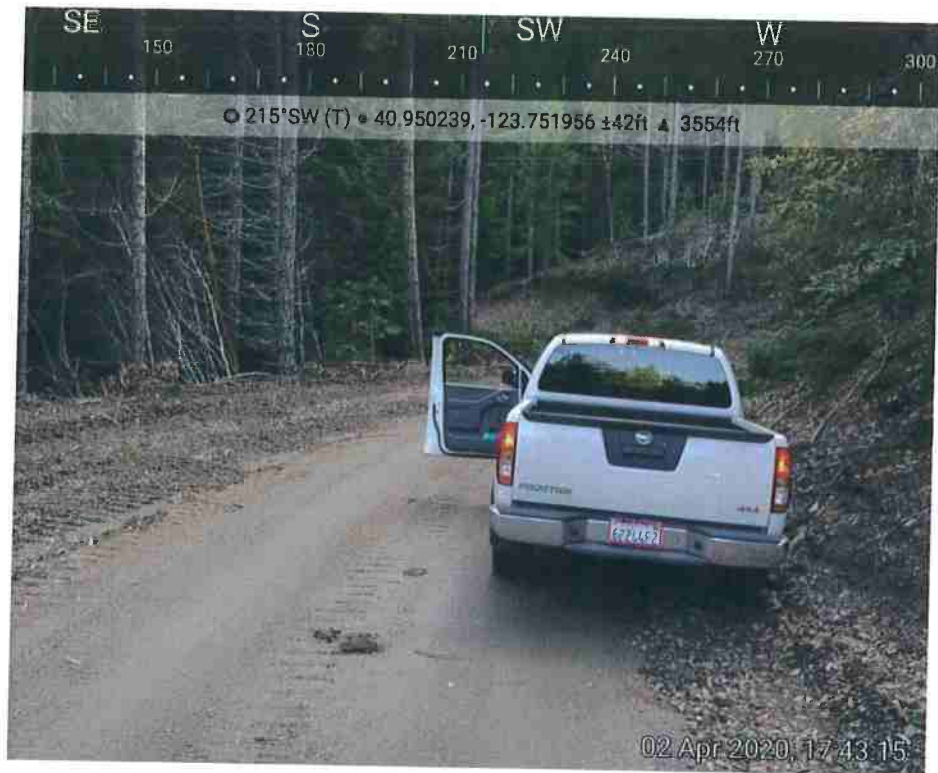

Photo 8

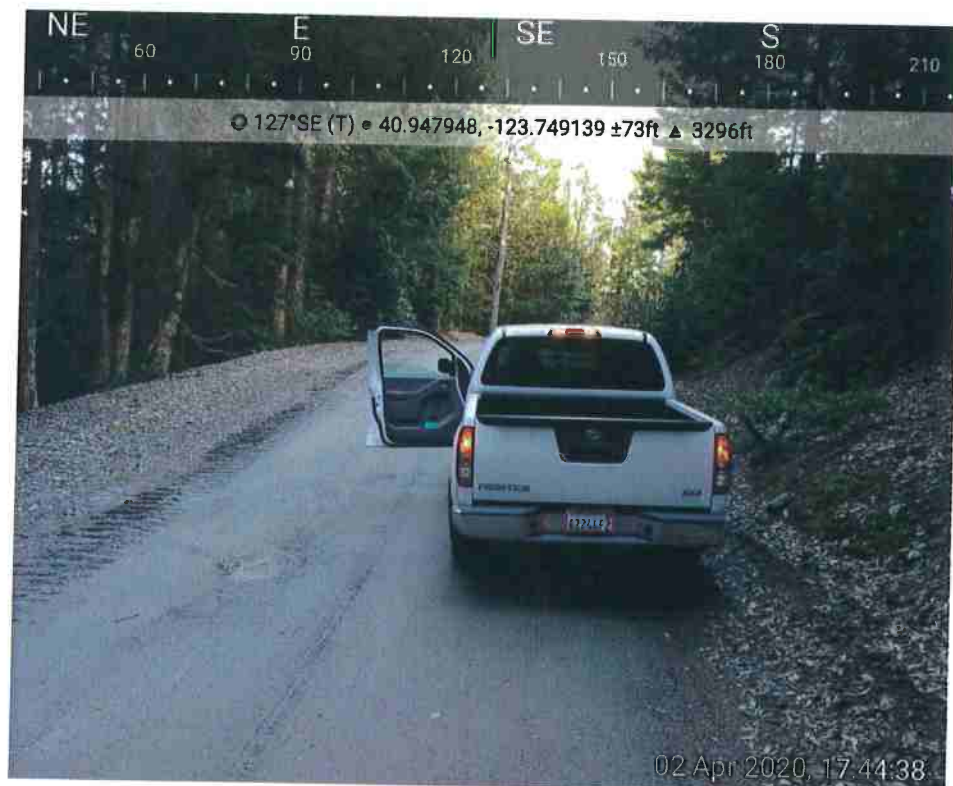

Photo 9



Photo 10



Photo 11



Photo 12

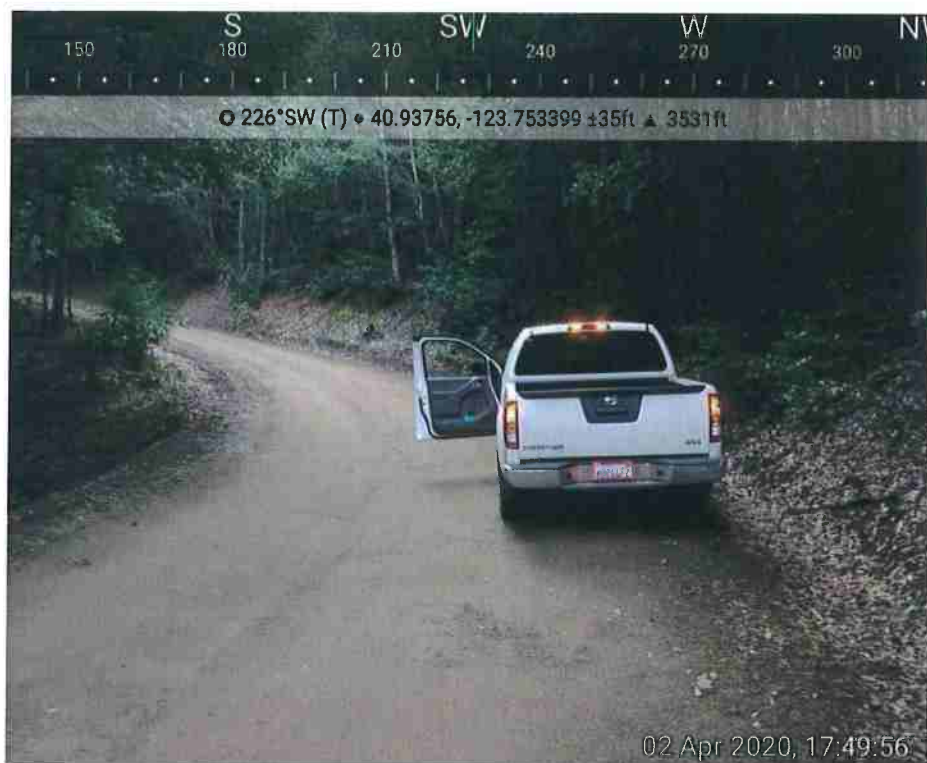

Photo 13

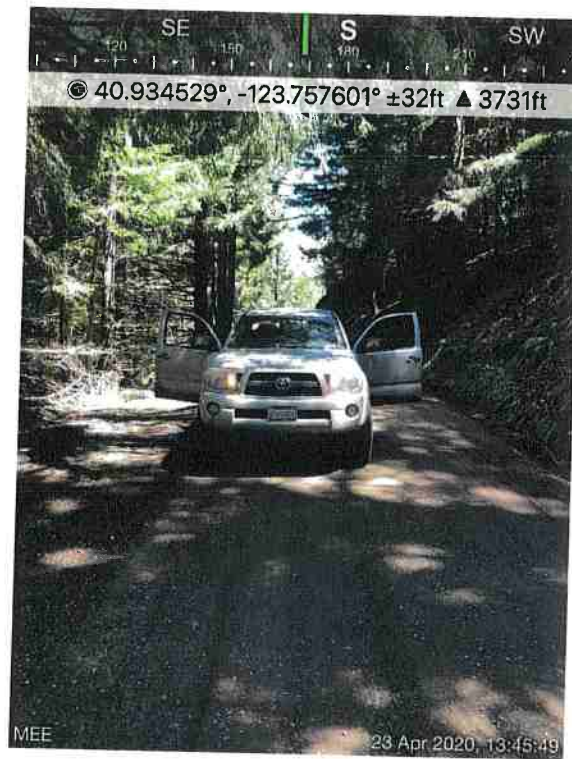

Photo 14

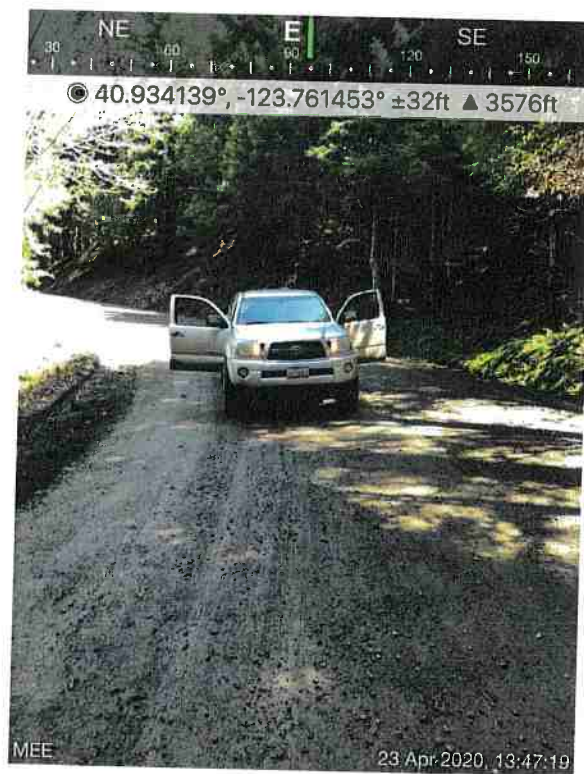

Photo 15

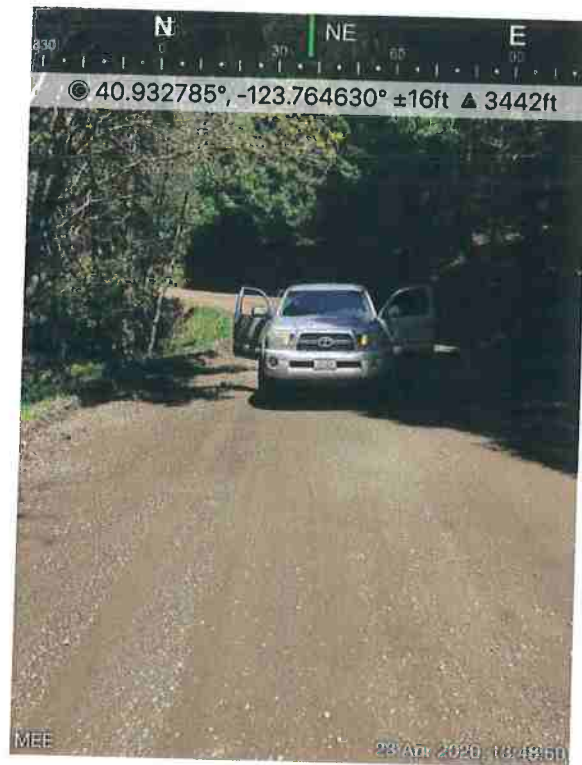

Photo 16

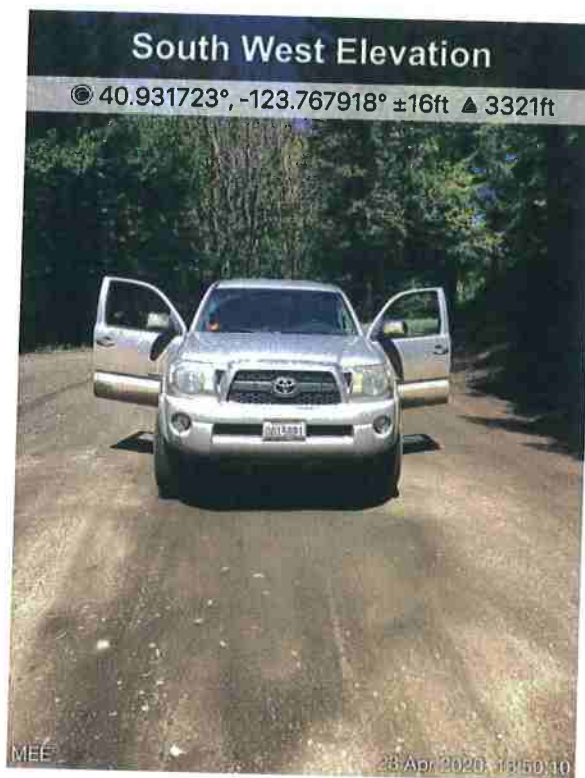

Photo 17

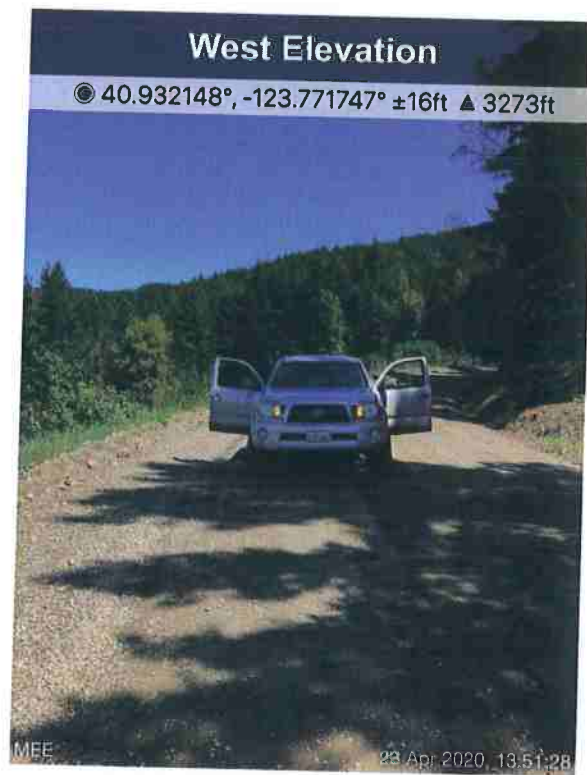

Photo 18

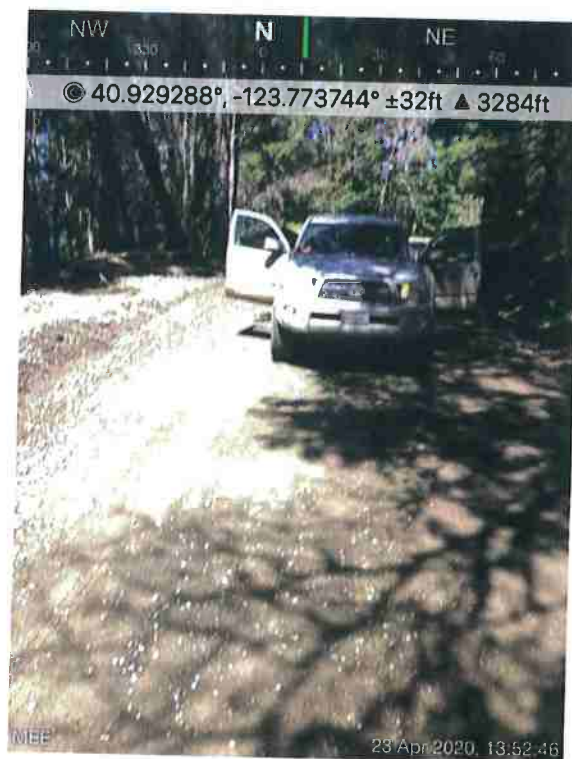

Photo 19

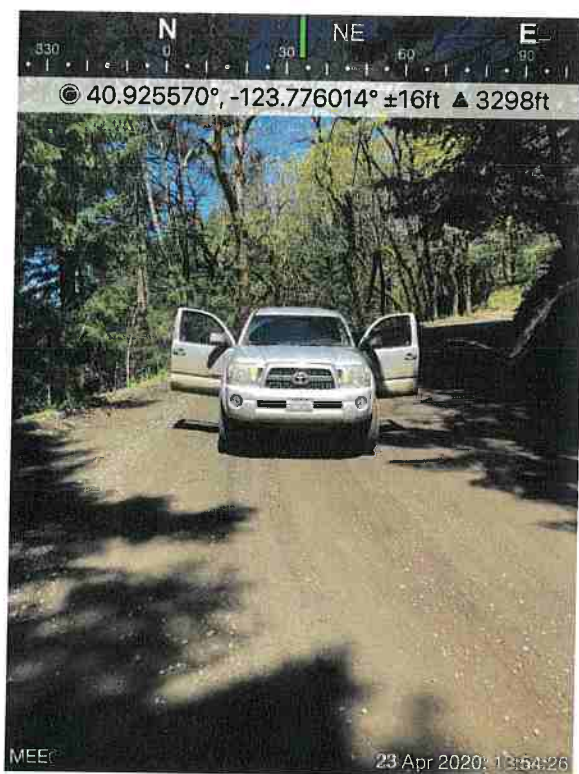

Photo 20

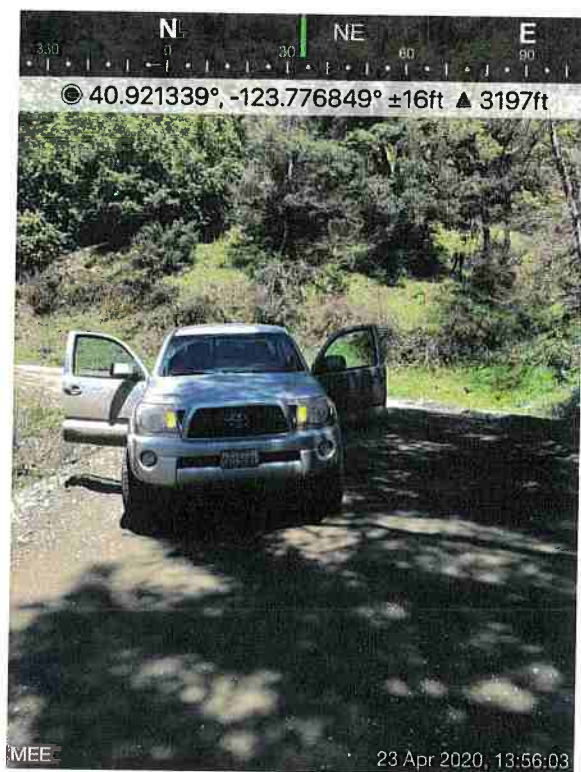

Photo 21

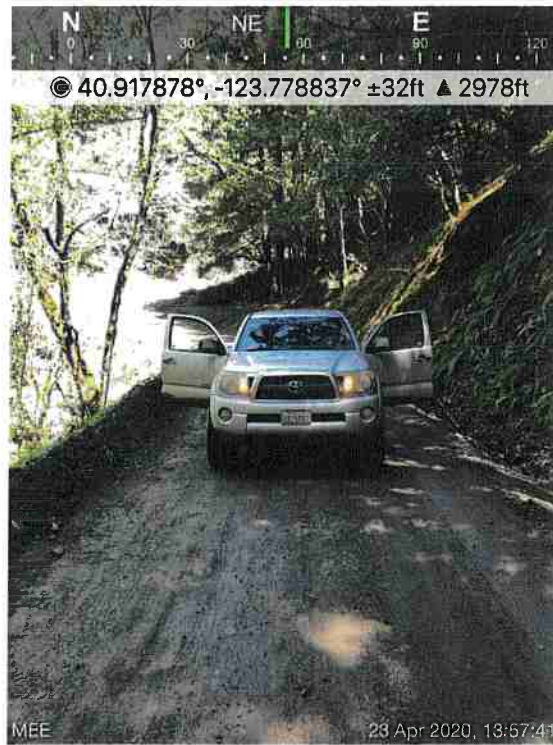

Photo 22

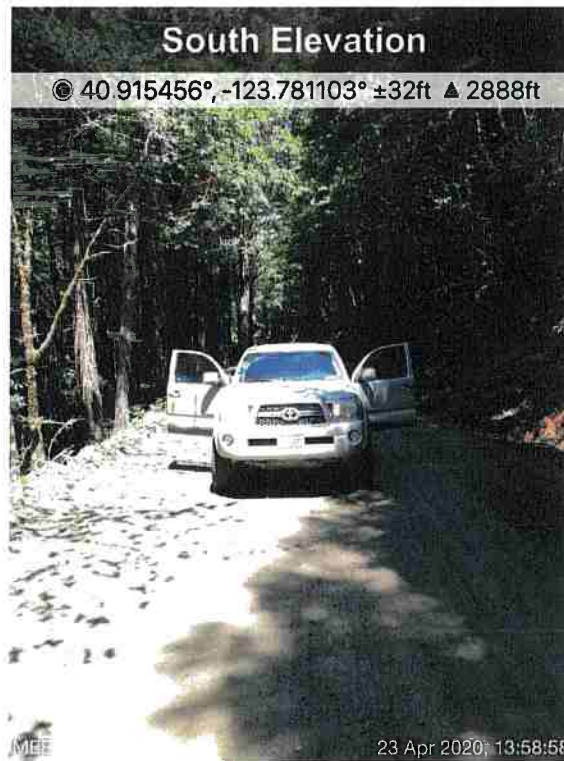

Photo 23



Photo 24

