

# Exhibit C – Site Plan

Humboldt County  
 Department of Health &  
 Human Services  
 600 W. Clark Street  
 Eureka, CA 95501  
 Building S000600

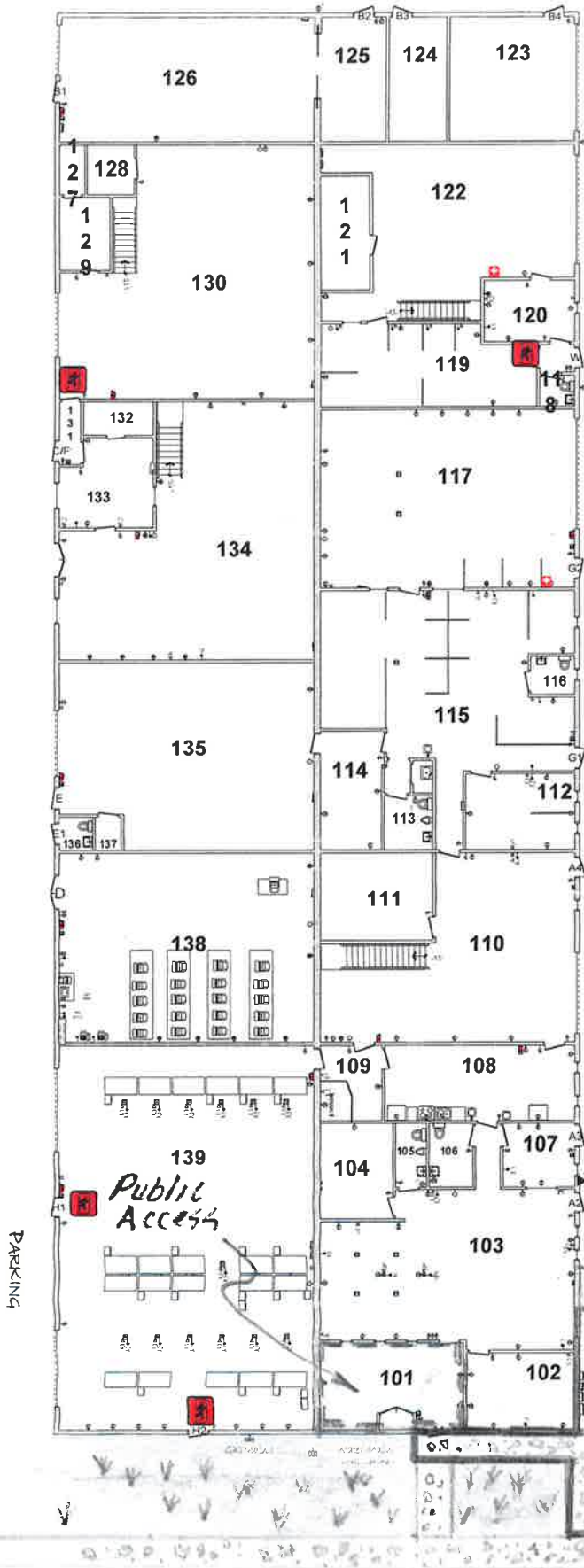

- Key**
- ⊕ (with '1' or '2') - Note: See statement of the owner regarding the barrier removals
  - ⊕ - TELEPHONE NODE
  - ⊕ - NETWORK NODE
  - ⊕ - GROUND OUTLET 110/120V
  - ⊕ - OUTLET 110/120
  - ⊕ - SWITCH
  - ⊕ - WATER HEATER

*Note:*  
 Room 101 Public Access.  
 All other Rooms non-Public Access.

*Barrier removals within this area to be performed by Lessor*

Total: 16,679 sq. ft.

0 ft. 6 ft. 10 ft. 20 ft.  
 Architectural Scale

*Note:*  
 Room dimensions on this draft are approximate within a 6" tolerance.

*West Clark Street*