



**VICINITY MAP**  
NOT TO SCALE

**DIRECTIONS TO SITE:**

- FROM EUREKA, CA
- HEAD EAST ON CA-299
- TURN RIGHT AT MARTIN DRIVE
- CONTINUE UP SLOPE TO COUNTY RTE 8L100
- TURN RIGHT ONTO STATON LANE
- CONTINUE STRAIGHT FOR 0.4 MILES

**PROJECT DESCRIPTION:**

NEW EARTH FARMS, LLC IS PROPOSING TO PERMIT NEW CANNABIS CULTIVATION ACTIVITIES IN ACCORDANCE WITH THE COUNTY OF HUMBOLDT'S (COUNTY) COMMERCIAL CANNABIS LAND USE ORDINANCE (CCLUO), ORDINANCE NO. 2554. THE EXISTING OPERATION INCLUDES APPROXIMATELY 10,000 SQUARE FEET (SF) OF APPROVED MIXED-LIGHT CULTIVATIONS AREA (APP. NO. 12260). THE APPLICANT IS PROPOSING THE ADDITION OF 32,500 SF OF MIXED-LIGHT CULTIVATION FOR A TOTAL OF 42,500 SF OF MIXED-LIGHT CULTIVATION AREA.

**GENERAL NOTES:**

1. DRAWING SCALE AS NOTED. WRITTEN DIMENSIONS SHALL TAKE PRECEDENCE OVER SCALED DIMENSIONS.
2. THIS IS NOT A BOUNDARY SURVEY. BOUNDARY INFORMATION DEPICTED HAS BEEN OBTAINED FROM HUMBOLDT COUNTY 2015 GIS DATA. NORTHPOINT CONSULTING GROUP, INC. HAS NOT VERIFIED THIS PROPERTY BOUNDARY.
3. THERE ARE NO NEARBY SCHOOLS, SCHOOL BUS STOPS, PLACES OF WORSHIP, PUBLIC PARKS OR TRIBAL RESOURCES WITHIN 600 FEET OF THE PROPOSED CULTIVATION AREA.

**PLOT PLAN**

22x34 SHEET: 1"=100'  
11x17 SHEET: 1"=200'

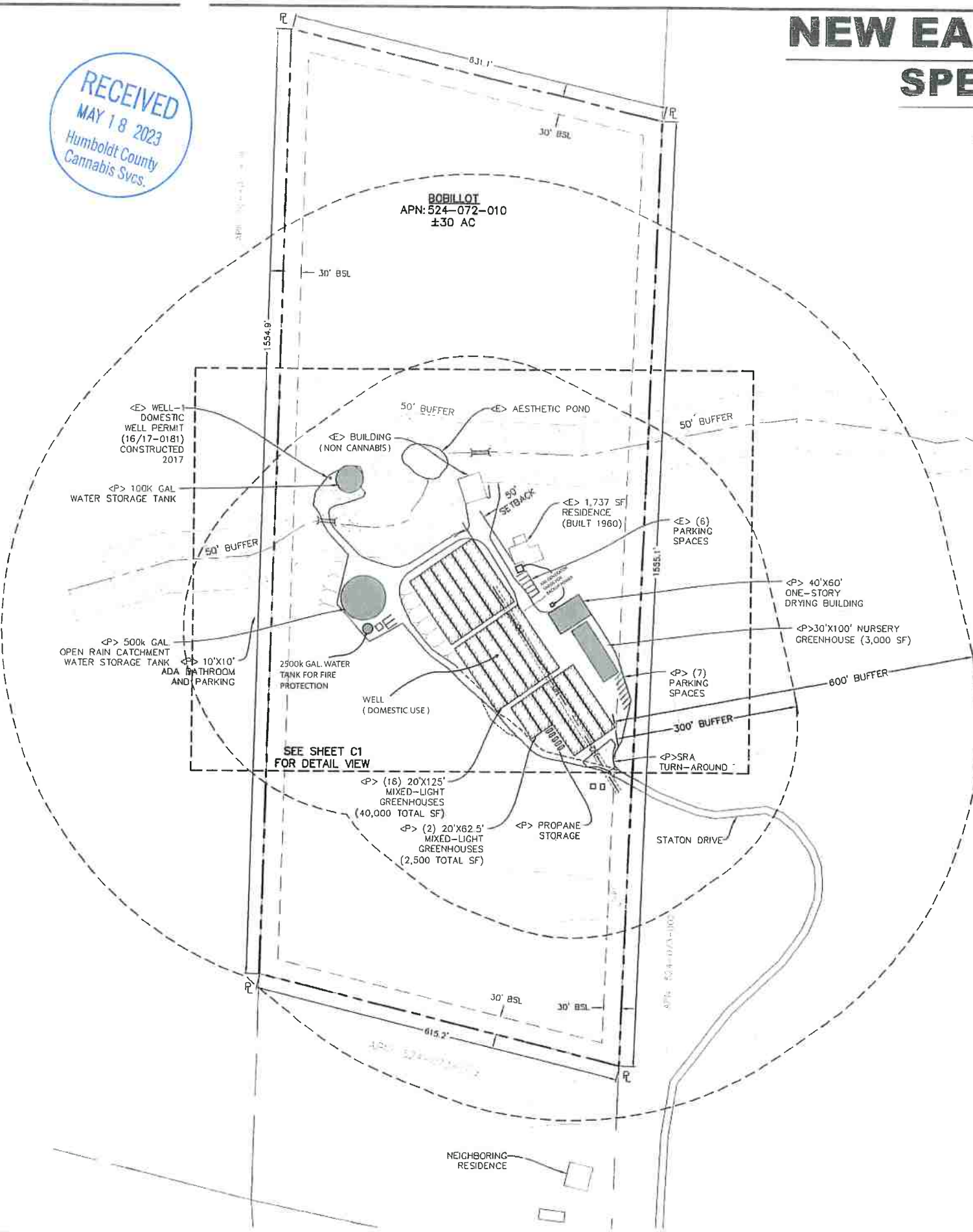

# NEW EARTH FARMS, LLC SPECIAL PERMIT

APN: 524-072-010

**PROJECT INFORMATION:**

**APPLICANT:**  
NEW EARTH FARMS, LLC  
P.O. BOX 153  
WILLOW CREEK, CA 95573

**PROPERTY OWNER:**  
SECOND 707 REALTY, LLC  
P.O. BOX 153  
WILLOW CREEK, CA 95573

**APPLICANTS AGENT:**  
NORTHPOINT CONSULTING GROUP, INC  
1117 SAMOA BLVD.  
ARCATA, CA 95521  
(707) 798-6438

**SITE ADDRESS:**  
APN: 524-072-010  
600 STATON LANE  
WILLOW CREEK, CA 95573

EXISTING MIXED LIGHT CULTIVATION AREA = 10,000 SF  
PROPOSED MIXED LIGHT CULTIVATION AREA = 42,500 SF

EARTH WORK QUANTITIES = TBD

WATER = PRIVATE  
SEWER = PRIVATE

PROPERTY SIZE (WEBGIS) = ±21.74 ACRES  
PROPERTY SIZE (ASSESSED) = ±30 ACRES  
ZONING = U (UNCLASSIFIED)  
GENERAL PLAN DESIGNATION = RA40

**BUILDING SETBACK**

	U	SRA
FRONT	20'	30'
SIDE	5'	30'
REAR	10'	30'

SRA AREA = YES  
IN COASTAL ZONE = NO  
IN 100 YR FLOOD ZONE = NO



**SHEET INDEX:**

- C0 - SPECIAL PERMIT SITE PLAN, VICINITY MAP, & PROJECT NOTES
- C1 - SITE PLAN DETAIL

NEW EARTH FARMS, LLC - SPECIAL PERMIT  
600 STATON LN. WILLOW CREEK, CA 95537 / APN: 524-072-010  
SPECIAL PERMIT - SITE PLAN

DATE	
REVISION	

PROJECT NO: PS  
DRAWN BY: CJC  
DATE: 08/18/22  
SCALE: AS SHOWN

SHEET  
**C0**

18-124

# NEW EARTH FARMS, LLC SPECIAL PERMIT

APN: 524-072-010

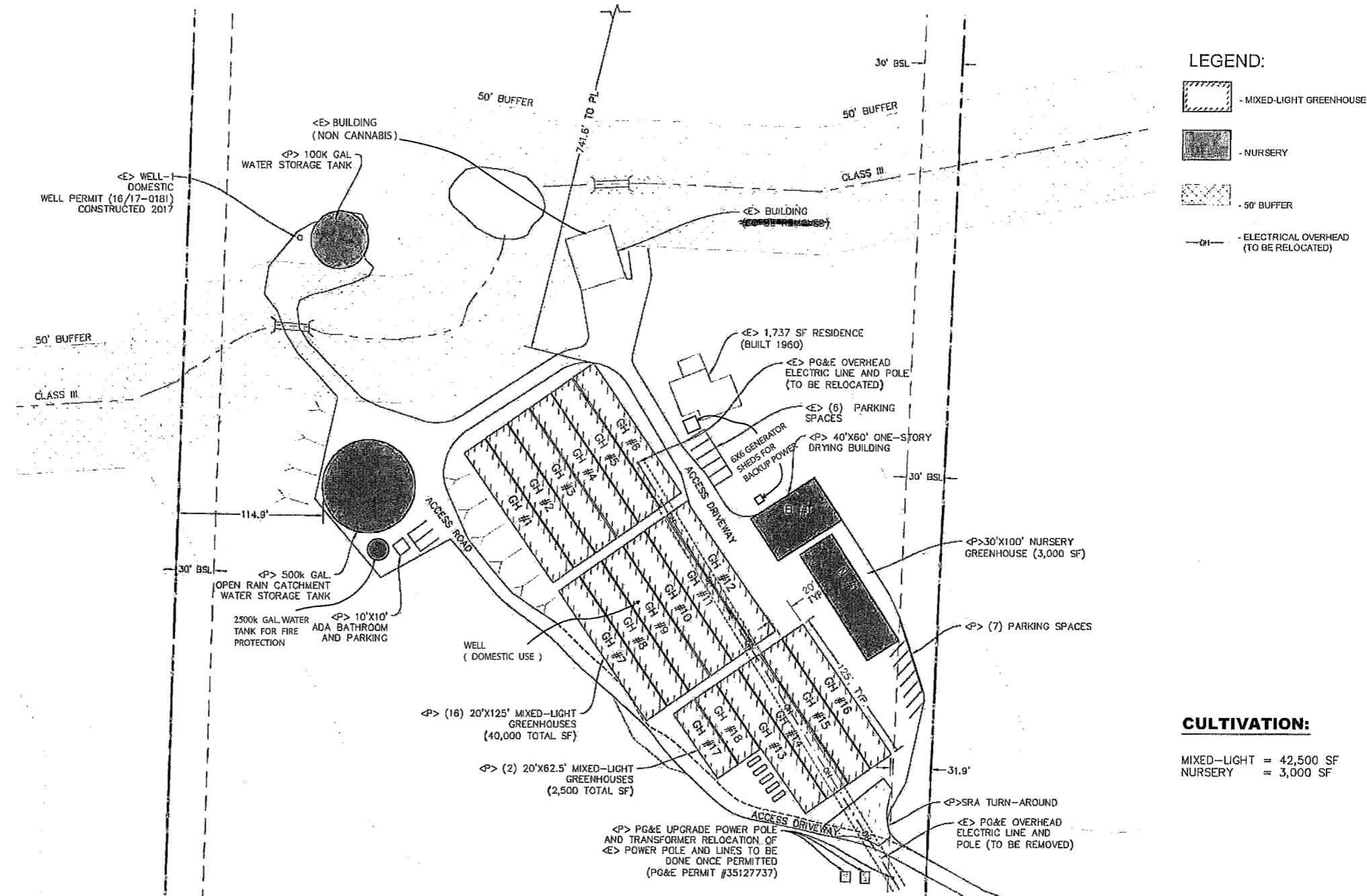

### LEGEND:

- MIXED-LIGHT GREENHOUSE
- NURSERY
- 50' BUFFER
- ELECTRICAL OVERHEAD (TO BE RELOCATED)

### CULTIVATION:

MIXED-LIGHT = 42,500 SF  
NURSERY = 3,000 SF

### SITE PLAN DETAIL

22x34 SHEET: 1"=50'  
11x17 SHEET: 1"=100'

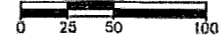

NEW EARTH FARMS, LLC - SPECIAL PERMIT  
600 STATON LN. WILLOW CREEK, CA 95537 / APN: 524-072-010  
SPECIAL PERMIT - SITE PLAN DETAIL (OPTION 1)

PROJECT NO:	PS
DESIGNED BY:	CJS
DATE:	08/18/23
SCALE:	AS SHOWN
SHEET	
<b>C1</b>	
18-124	