

GARBERVILLE AIRPORT

GARBERVILLE, CALIFORNIA

FOR BIDDING PURPOSES ONLY, NOT FOR CONSTRUCTION

AIP No. TBD
ACI No. 22798

PREPARED BY:
ARMSTRONG CONSULTANTS, INC.
APRIL 2024

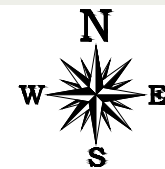
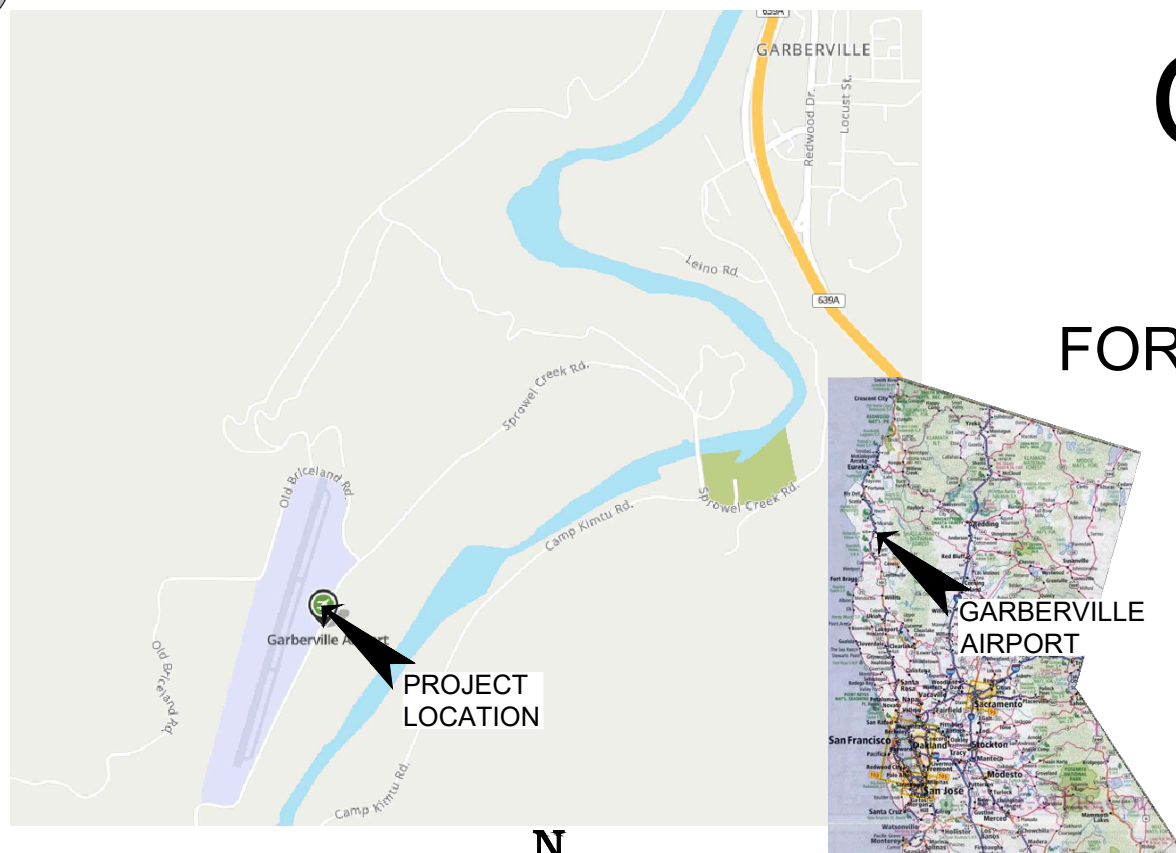

VICINITY MAP
NOT TO SCALE

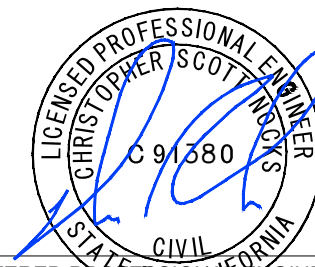

04/04/2024

DESIGNED BY: _____ DATE _____

REGISTERED PROFESSIONAL ENGINEER DATE
REVIEWED BY AND PREPARED UNDER MY DIRECT SUPERVISION

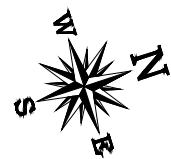
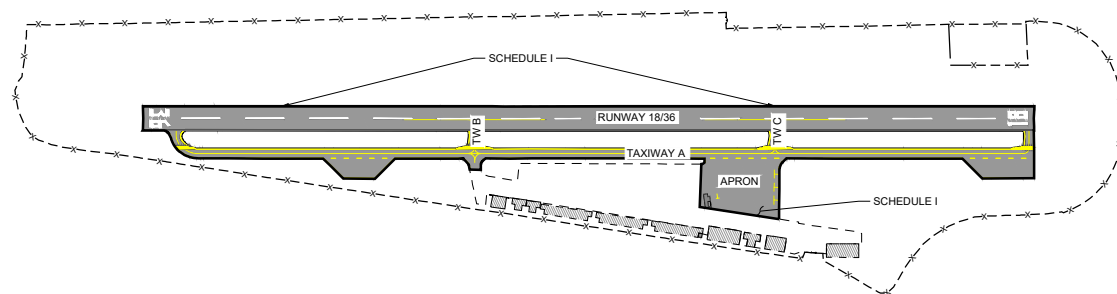

KEY MAP
NOT TO SCALE

SCHEDULE I

REHABILITATE RUNWAY 18/36,
TAXIWAYS A, B, AND C, AND
APRON

INDEX TO SHEETS

COVER SHEET	1.1
GENERAL NOTES, LEGEND & SURVEY CONTROL	1.2
MARKING REMOVAL PLAN	2.1-2.2
RUNWAY 18/36 MARKING LAYOUT PLAN	3.1-3.2
TAXIWAY A MARKING LAYOUT PLAN	3.3-3.5
MARKING DETAILS	3.6-3.7
CONSTRUCTION SAFETY & PHASING PLAN	ATTACHED

SHEET 1.1



S:\California\Garberville\Projects\Active\Projects\22798\Garberville-Rehab_RW_TW_Apron\CAD\dwg\22798101.dwg 3/29/2024 8:10:29 AM MCOATS

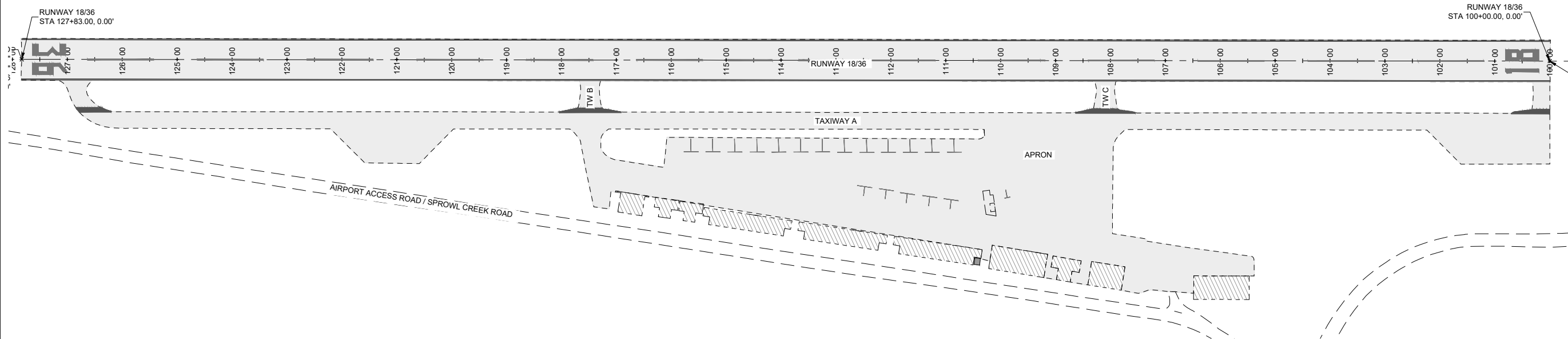

LEGEND

	EXISTING SPOT ELEVATION		PROPOSED FINISHED GRADE ELEVATION
	EXISTING GROUND CONTOUR (5' INTERVAL)		PROPOSED GROUND CONTOUR (1' INTERVAL)
	EXISTING RUNWAY EDGE LIGHT		PROPOSED RUNWAY EDGE LIGHT
	EXISTING TAXIWAY EDGE LIGHT		PROPOSED TAXIWAY EDGE LIGHT
	EXISTING RETROREFLECTIVE MARKER		PROPOSED RETROREFLECTIVE MARKER
	EXISTING SPLICE BASE / PULL BOX		PROPOSED SPLICE BASE / PULL BOX
	EXISTING AIRFIELD SIGN		PROPOSED AIRFIELD SIGN
	EXISTING BEACON		PROPOSED BEACON AND TOWER
	EXISTING WIND CONE		PROPOSED LIGHTED WIND CONE
	EXISTING SEGMENTED CIRCLE		PROPOSED SUPPLEMENTAL WIND CONE
	EXISTING PAPI / VASI		PROPOSED SEGMENTED CIRCLE
	EXISTING REIL		PROPOSED PAPI
	EXISTING AWOS/ASOS/UNICOM		PROPOSED REIL
	EXISTING TIEDOWN ANCHOR		PROPOSED AWOS
	EXISTING UTILITY POLE		PROPOSED TIEDOWN ANCHOR
	EXISTING AREA LIGHT		PROPOSED UTILITY POLE
	EXISTING GUY		PROPOSED AREA LIGHT (S)
	EXISTING PAD MOUNTED TRANSFORMER		PROPOSED AREA LIGHT (S)
	EXISTING UTILITY PEDESTAL		PROPOSED ELECTRIC TRANSFORMER
	EXISTING UTILITY METER		PROPOSED MANHOLE
	EXISTING MANHOLE / CLEAN-OUT		PROPOSED SANITARY SEWER CLEAN-OUT
	EXISTING AREA INLET / CATCH BASIN		PROPOSED STORM DRAIN INLET
	EXISTING FIRE HYDRANT		PROPOSED FIRE HYDRANT
	EXISTING WATER VALVE		PROPOSED WATER VALVE
	EXISTING TREE		PROPOSED SURVEY MONUMENT
	EXISTING ROAD SIGN(S)		PROPOSED AIRFIELD POWER CABLE(S)
	EXISTING SECTION CORNER		PROPOSED COUNTERPOISE CABLE
	EXISTING SURVEY CONTROL MONUMENT		PROPOSED CONCRETE ENCASED DUCT BANK
	EXISTING PROPERTY CORNER PIN/CAP		PROPOSED CULVERT W/END SECTIONS
	EXISTING AIRFIELD POWER CABLE(S)		PROPOSED SWALE DIRECTION
	EXISTING CONCRETE DUCT BANK		PROPOSED BARBED WIRE FENCE
	EXISTING CULVERT		PROPOSED CHAIN LINK FENCE
	EXISTING SWALE DIRECTION		PROPOSED WILDLIFE FENCE
	EXISTING BARB WIRE FENCE		PROPOSED SANITARY SEWER LINE
	EXISTING CHAIN LINK FENCE		PROPOSED STORM DRAIN LINE
	EXISTING WILDLIFE FENCE		PROPOSED WATERLINE
	EXISTING SANITARY SEWER LINE		PROPOSED GAS LINE
	EXISTING STORM DRAIN LINE		PROPOSED UNDERGROUND POWER/TELE
	EXISTING WATER LINE		PROPOSED PERFORATED UNDERDRAIN W/ CLEAN-OUT
	EXISTING GAS LINE		PROPOSED NON-PERFORATED UNDERDRAIN
	EXISTING UNDERGROUND POWER OR TELE. LINE		PROPOSED SEDIMENT LOG
	EXISTING OVERHEAD POWER CABLE		PROPOSED SILT FENCE
	EXISTING UNDERGROUND COMMUNICATION LINE		PROPOSED CONCRETE PAVEMENT
	EXISTING FIBER OPTIC CABLE		PROPOSED ASPHALT PAVEMENT
	EXISTING UNDERDRAIN W/ CLEAN-OUT		PROPOSED ASPHALT/CONCRETE REMOVAL
	EXISTING CONCRETE PAVEMENT		PROPOSED GRAVEL
	EXISTING ASPHALT PAVEMENT		PROPOSED ROCK RIPRAP
	EXISTING GRAVEL		PROPOSED BUILDING
	EXISTING BUILDING		PROPOSED SEEDING AREA
	EXISTING WETLANDS		PROPOSED GRADING AREA

NOTE: LEGEND APPLIES TO ALL SHEETS IN THIS PLAN SET, IS GENERIC, AND NOT ALL SYMBOLS MAY BE IN PLAN SHEETS.

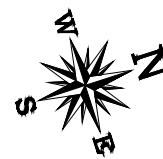

AIRPORT LAYOUT & SURVEY CONTROL

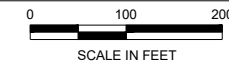

GENERAL NOTES

- ESTIMATED QUANTITIES ARE CONSIDERED APPROXIMATE ONLY EXCEPT WHERE PLAN QUANTITIES ARE SPECIFIED FOR PAYMENT. ACTUAL QUANTITIES SHALL BE DETERMINED BY FIELD MEASUREMENT OR SPECIFICATIONS.
- THE CONTRACTOR SHALL PROVIDE MATERIAL SUBMITTALS FOR THE ENGINEER'S APPROVAL PRIOR TO ORDERING.
- THE CONTRACTOR IS REQUIRED TO OBTAIN ALL NECESSARY CONSTRUCTION PERMITS AS NECESSARY FOR THE PROJECT.
- THE CONTRACTOR SHALL BE REQUIRED TO SUBMIT A WORK SCHEDULE AND PROPOSED CONSTRUCTION METHODS AT THE PRE-CONSTRUCTION CONFERENCE.
- THE CONTRACTOR SHALL OBTAIN APPROVAL FROM AIRPORT MANAGEMENT AND THE ENGINEER PRIOR TO ESTABLISHING CONSTRUCTION ACCESS OR HAUL ROADS. EXISTING PAVEMENT SURFACES OTHER THAN AIRFIELD PAVEMENTS SHALL BE USED TO THE MAXIMUM EXTENT POSSIBLE.
- THE CONTRACTOR SHALL MINIMIZE DISTURBANCE INCLUDING RUTS PRODUCED BY VEHICLES AND EQUIPMENT IN NON-PAVEMENT AREAS WITHIN ALL CONSTRUCTION AREAS. ALL DISTURBED AREAS IN THESE LOCATIONS SHALL BE RECLAIMED AT NO ADDITIONAL COST TO THE SPONSOR. DAMAGE CAUSED TO EXISTING AIRFIELD PAVEMENTS, AIRFIELD CABLE CIRCUITS OR FACILITIES DURING CONSTRUCTION SHALL BE REPAIRED BY THE CONTRACTOR AT NO ADDITIONAL COST TO THE SPONSOR.
- CONTRACTOR SHALL COORDINATE ALL ON-SITE WASTE MATERIAL DISPOSAL WITH ENGINEER AND AIRPORT.

NOTES TO SURVEYOR:

- THE PROJECT CONTROL IS A MODIFIED STATE PLANE COORDINATE SYSTEM.
- ALL DISTANCE UNITS ARE IN FEET AT GROUND.
- A BASE LINE WITH STATIONS AND OFFSETS HAS BEEN SET AT THE RUNWAY CENTERLINE FOR PROJECT CONTROL. ALL INFORMATION FOR THIS PROJECT WILL BE BASED ON THIS BASE LINE.
- BEFORE ANY CONSTRUCTION OPERATIONS BEGIN, CONSTRUCTION SURVEYOR TO RUN A TRAVERSE, LEVEL LOOP, AND VERIFY CONTROL. ANY DISCREPANCIES SHALL BE RESOLVED WITH PROJECT ENGINEER.
- FOR QUALITY CONTROL AND VERIFICATION PURPOSES, ANY WRITTEN SURVEY INFORMATION SUPPLIED TO ACI SHALL BE IN STATION, OFFSET, ELEVATION FORMAT.



CAUTION - NOTICE TO CONTRACTOR

THE CONTRACTOR IS SPECIFICALLY CAUTIONED THAT THE LOCATION AND/OR ELEVATION OF EXISTING UTILITIES AS SHOWN ON THESE PLANS IS BASED ON RECORDS OF THE VARIOUS UTILITY COMPANIES AND WHERE POSSIBLE, MEASUREMENTS IN THE FIELD. THE INFORMATION IS PROVIDED FOR THE CONVENIENCE OF THE CONTRACTOR AND IS NOT TO BE RELIED UPON AS BEING EXACT OR COMPLETE. THE CONTRACTOR MUST CALL CALIFORNIA 811 (1-800-624-2444) AT LEAST 48 HOURS BEFORE ANY EXCAVATION / EMBANKMENT TO REQUEST FIELD LOCATION OF UTILITIES.



GARBERVILLE AIRPORT
GARBERVILLE, CALIFORNIA
PAVEMENT MAINTENANCE
AIP No.

No.	Revision	Date	By

ACI No. 227981
Date: APRIL 2024
File Name: 22798101

Drawn: MAC
Checked: EFR
Approved: CSN

GENERAL NOTES, LEGEND & SURVEY CONTROL

S:\California\Garberville\Project Files\Active Projects\22798_GARBERVILLE-Rehab_RW_TW_Apron\CAD.dwg, 22798102.dwg 3/29/2024 9:45:52 AM MCOATS

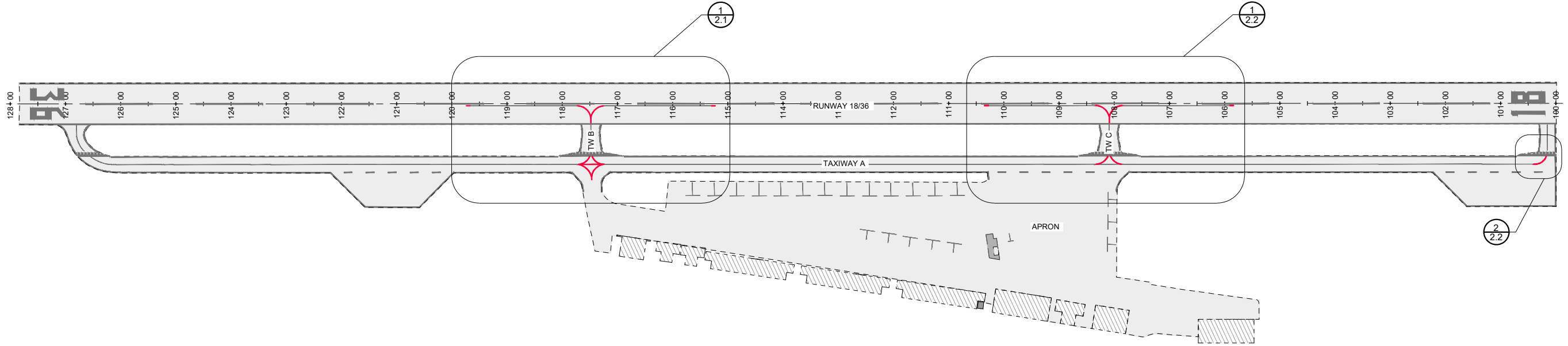

AIRPORT LAYOUT

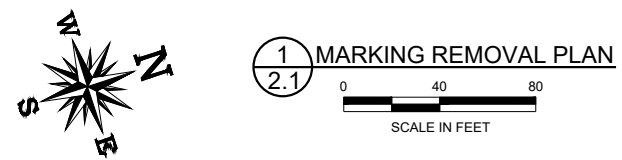
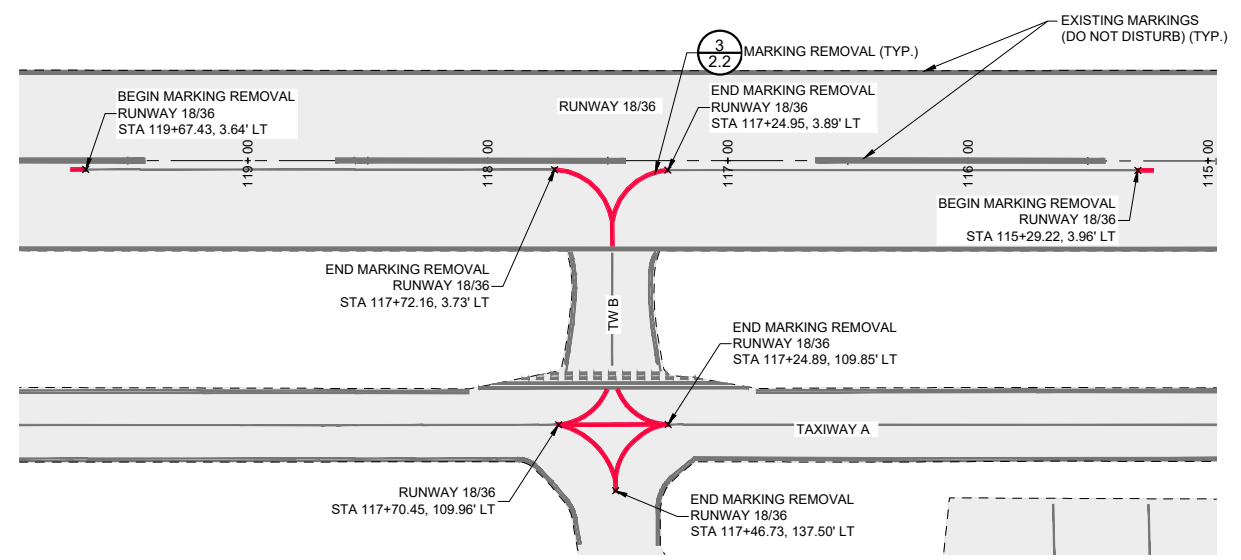

1.2.1 MARKING REMOVAL PLAN



GARBERVILLE AIRPORT
GARBERVILLE, CALIFORNIA
PAVEMENT MAINTENANCE
AIP No.

No.	Revision	Date	By

ACI No. 227981
Date: APRIL 2024
File Name: 22798102

Drawn: MAC
Checked: EFR
Approved: CSN

MARKING
REMOVAL
PLAN

Sheet: 2.1

S:_California\Garberville\Project Files\Active Projects\22798_GARBERVILLE-Rehab_RW_TW_Apron\CAD\dwg\22798102.dwg 3/29/2024 9:45:52 AM MCOATS

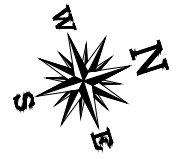
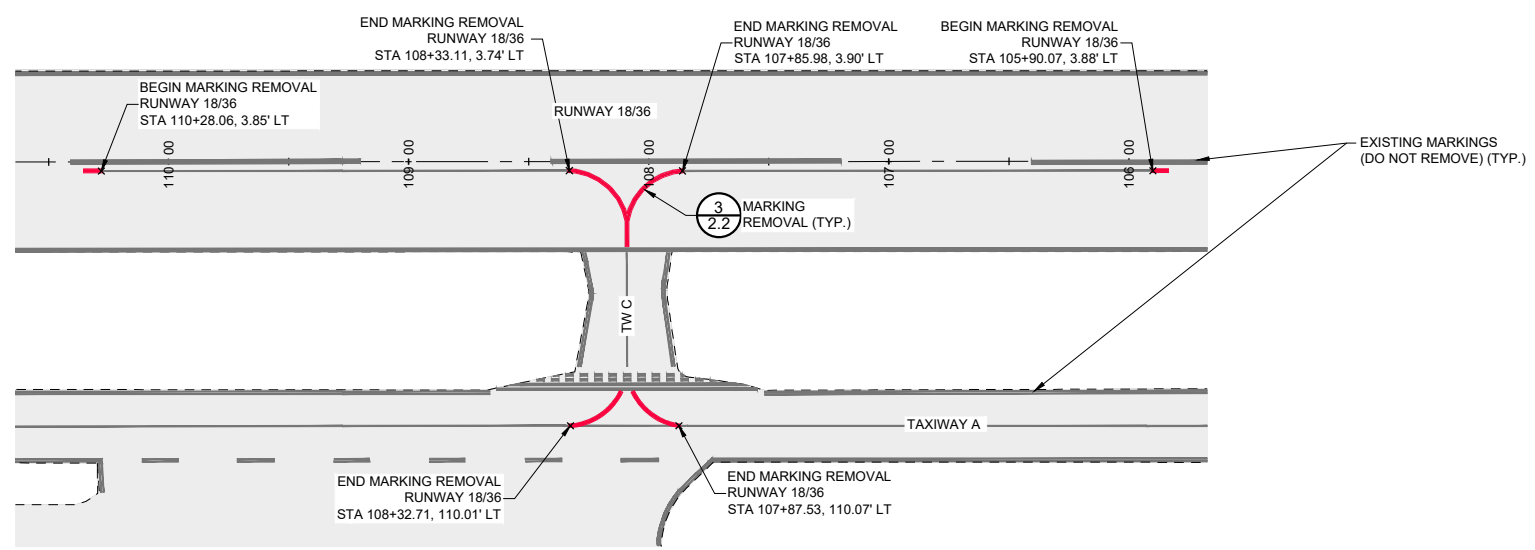

1
2.2 MARKING REMOVAL PLAN
SCALE IN FEET

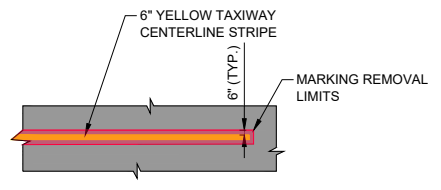

TAXIWAY CENTERLINE MARKING

3
2.2 MARKING REMOVAL PLAN
NOT TO SCALE

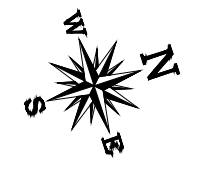
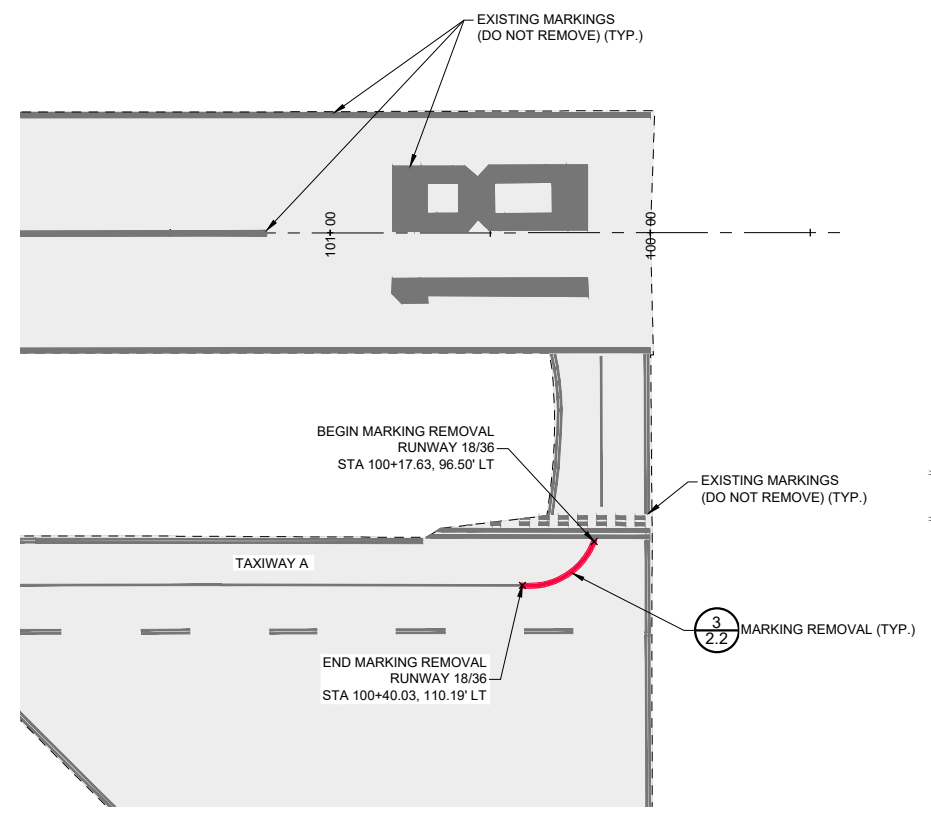

2
2.2 MARKING REMOVAL PLAN
SCALE IN FEET



No.	Revision	Date	By

ACI No. 227981
Date: APRIL 2024
File Name: 22798102

Drawn: MAC
Checked: EFR
Approved: CSN

**MARKING
REMOVAL
PLAN**

S:\California\Garberville\Project Files\Active Projects\22798 GARBERVILLE-Rehab_RW_TW_Apron\CAD.dwg, 2/27/2024 9:45:43 AM MCOATS

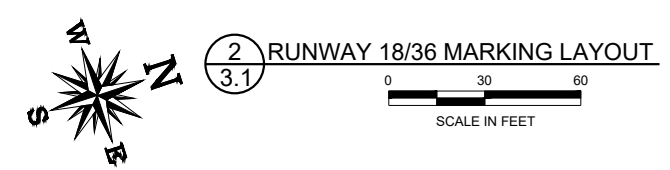
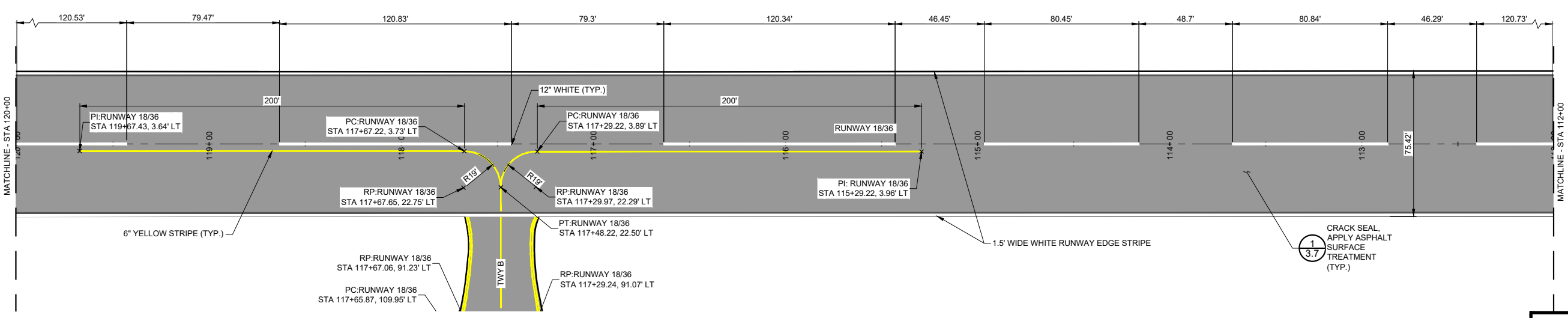
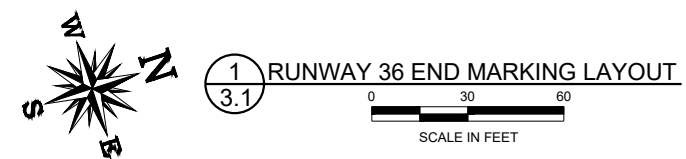
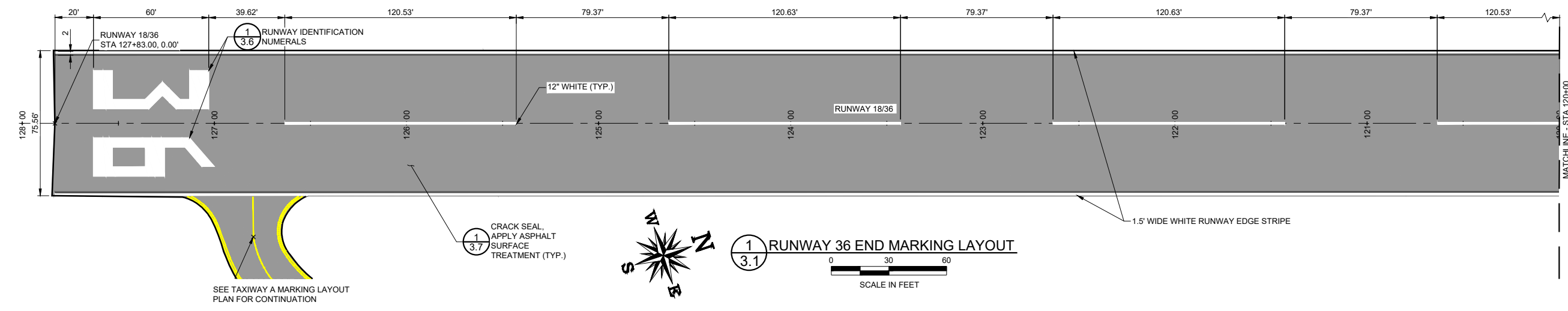
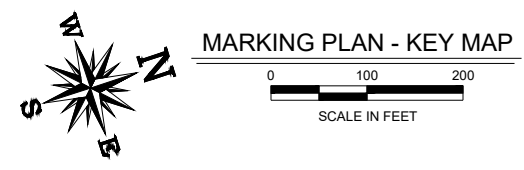
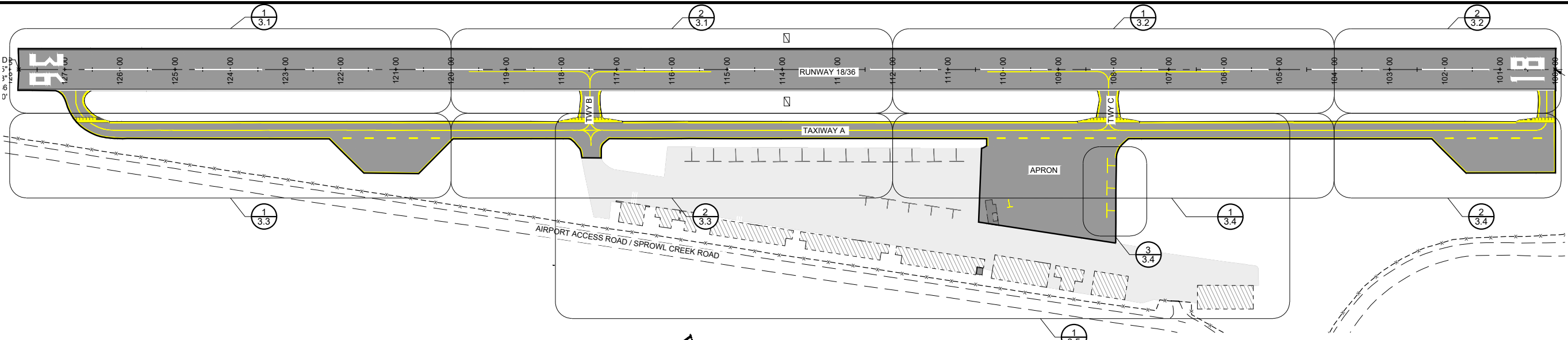

GARBERVILLE AIRPORT
GARBERVILLE, CALIFORNIA
PAVEMENT MAINTENANCE
AIP No.

No.	Revision	Date	By

ACI No. 227981
Date: APRIL 2024
File Name: 22798103

Drawn: MAC
Checked: EFR
Approved: CSN

RUNWAY 18/36
MARKING
LAYOUT PLAN

Sheet: 3.1

S:\California\Garberville\Project Files\Active Projects\22798_GARBERVILLE-Rehab_RW_TW_Apron\CAD\dwg\22798103.dwg 3/29/2024 9:45:43 AM MCOATS

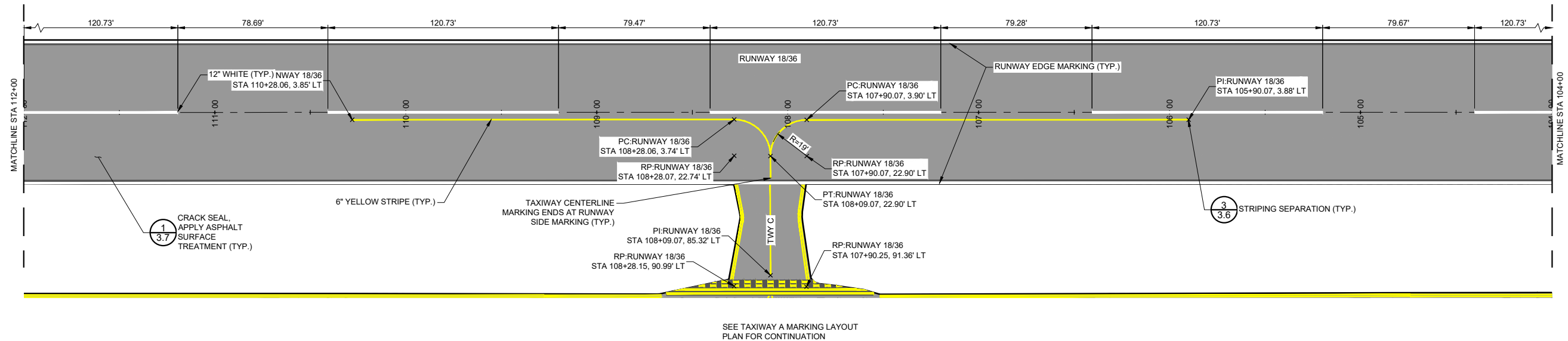

SEE TAXIWAY A MARKING LAYOUT PLAN FOR CONTINUATION

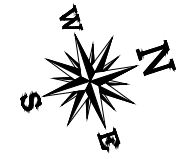

3.2 RUNWAY 18/36 MARKING LAYOUT
SCALE IN FEET

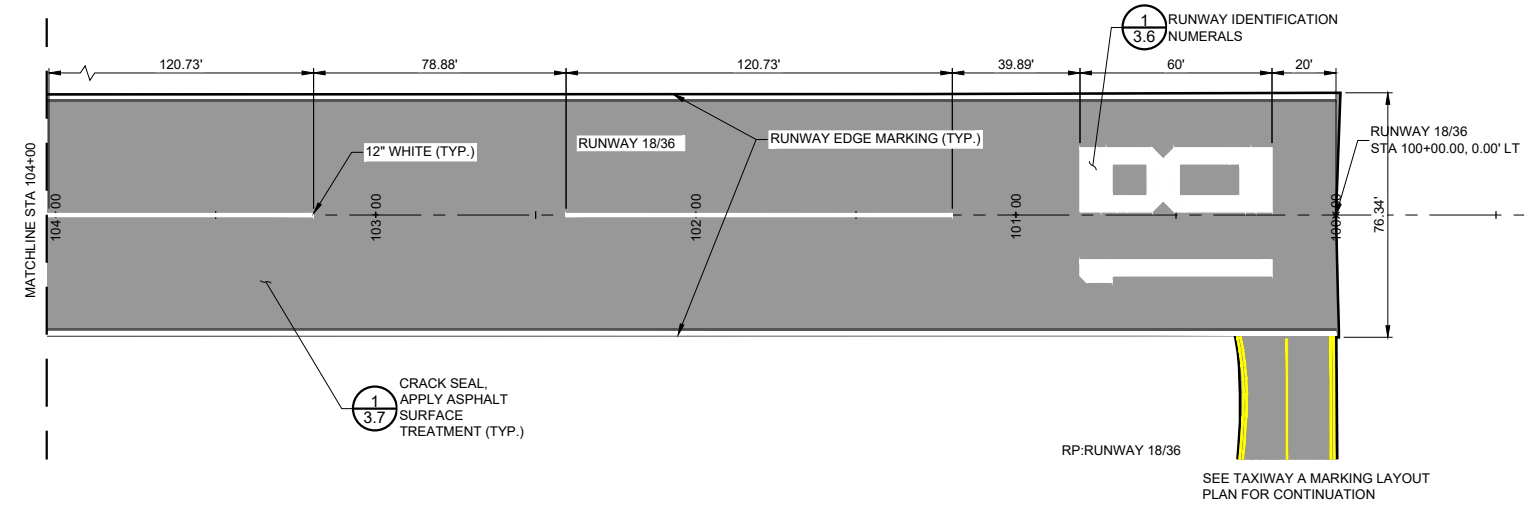

SEE TAXIWAY A MARKING LAYOUT PLAN FOR CONTINUATION

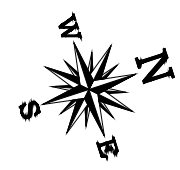

3.2 RUNWAY 18 END MARKING LAYOUT
SCALE IN FEET



GARBERVILLE AIRPORT
GARBERVILLE, CALIFORNIA
PAVEMENT MAINTENANCE
AIP No.

No.	Revision	Date	By

ACI No. 227981
Date: APRIL 2024
File Name: 22798103

Drawn: MAC
Checked: EFR
Approved: CSN

RUNWAY 18/36
MARKING
LAYOUT PLAN

Sheet: 3.2

S:\California\Garberville\Project Files\Active Projects\22798_GARBERVILLE-Rehab_RW_TW_Apron\CAD\dwg\22798103.dwg 3/29/2024 9:45:43 AM MCOATS

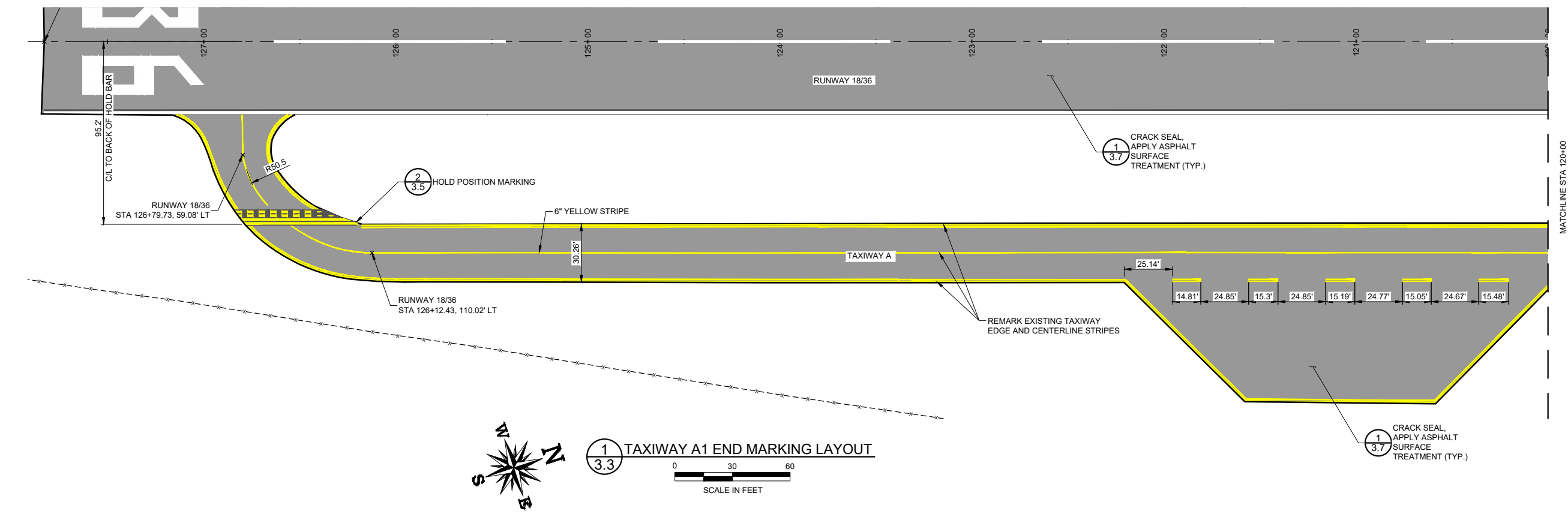

1 TAXIWAY A1 END MARKING LAYOUT
3.3

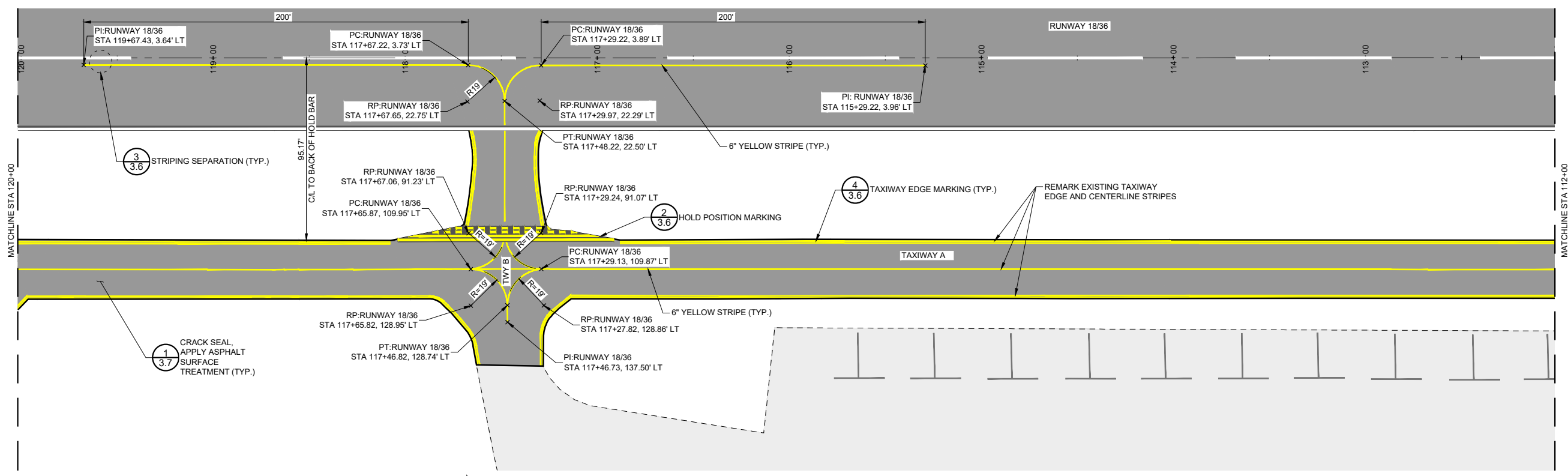

2 TAXIWAY A2 MARKING LAYOUT
3.3



No.	Revision	Date	By

ACI No. 227981
Date: APRIL 2024
File Name: 22798103

Drawn: MAC
Checked: EFR
Approved: CSN

TAXIWAY A
MARKING
LAYOUT PLAN

S:_California\Garberville\Project Files\Active Projects\22798 GARBERVILLE-Rehab_RW_TW_Apron\CAD\dwg\22798103.dwg 3/29/2024 9:45:43 AM MCOATS

No.	Revision	Date	By

ACI No. 227981
Date: APRIL 2024
File Name: 22798103

Drawn: MAC
Checked: EFR
Approved: CSN

TAXIWAY A MARKING LAYOUT PLAN

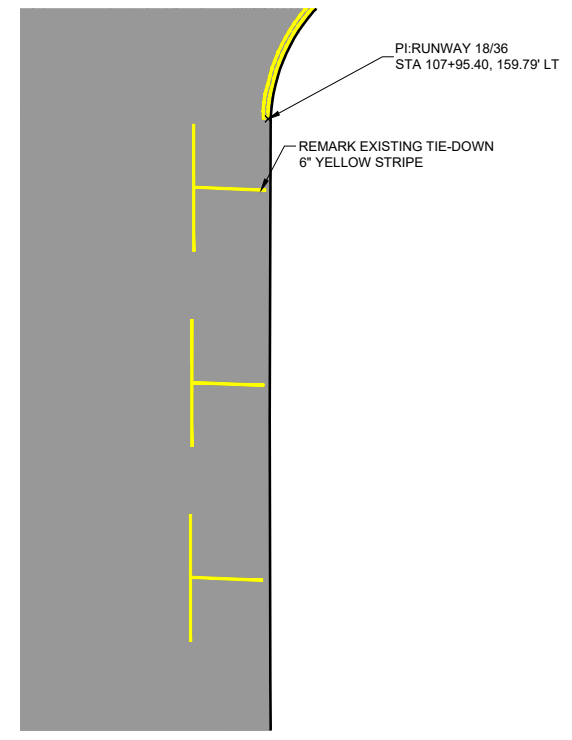
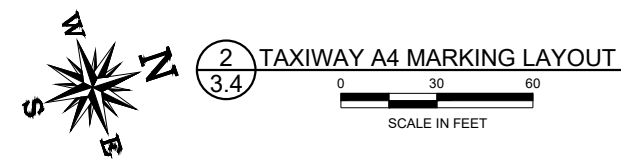
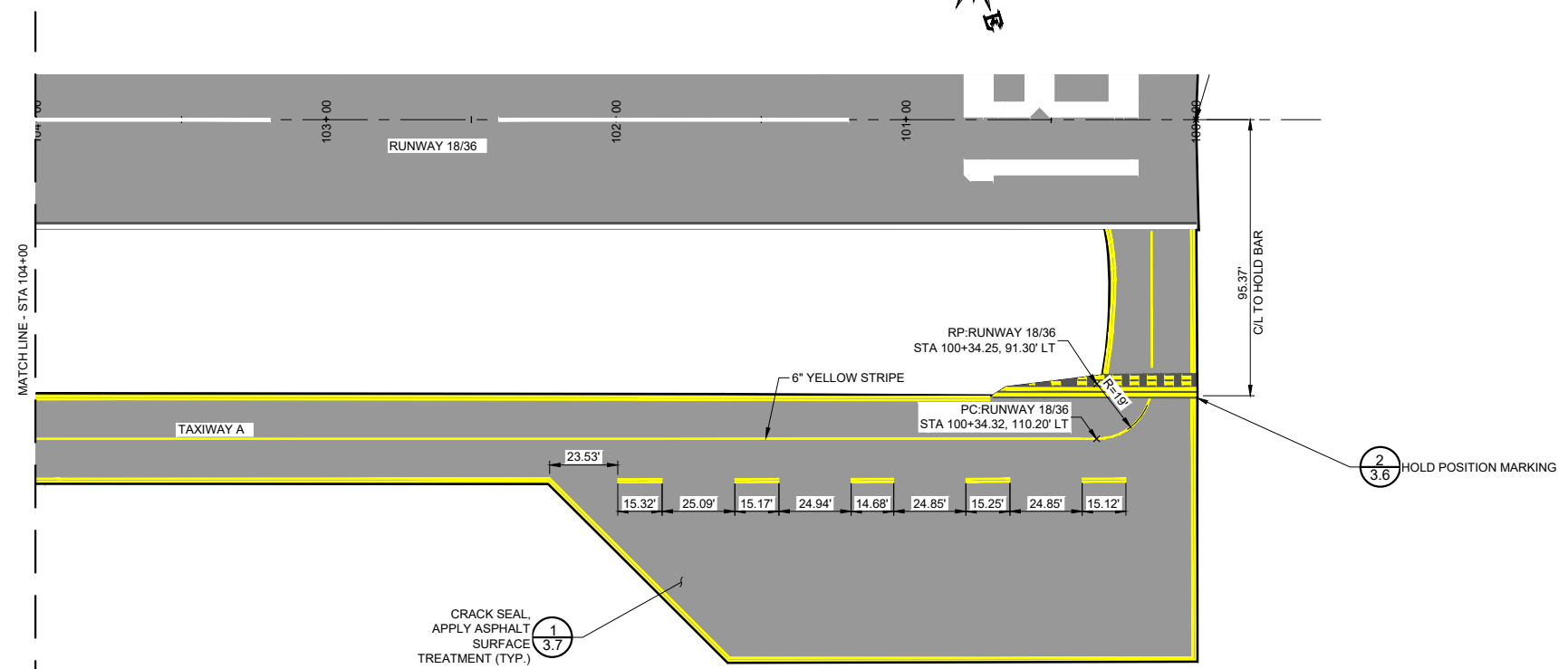
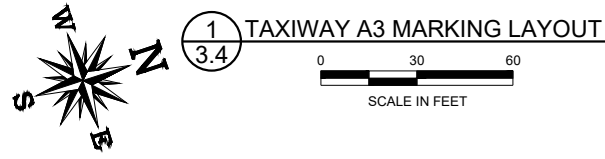
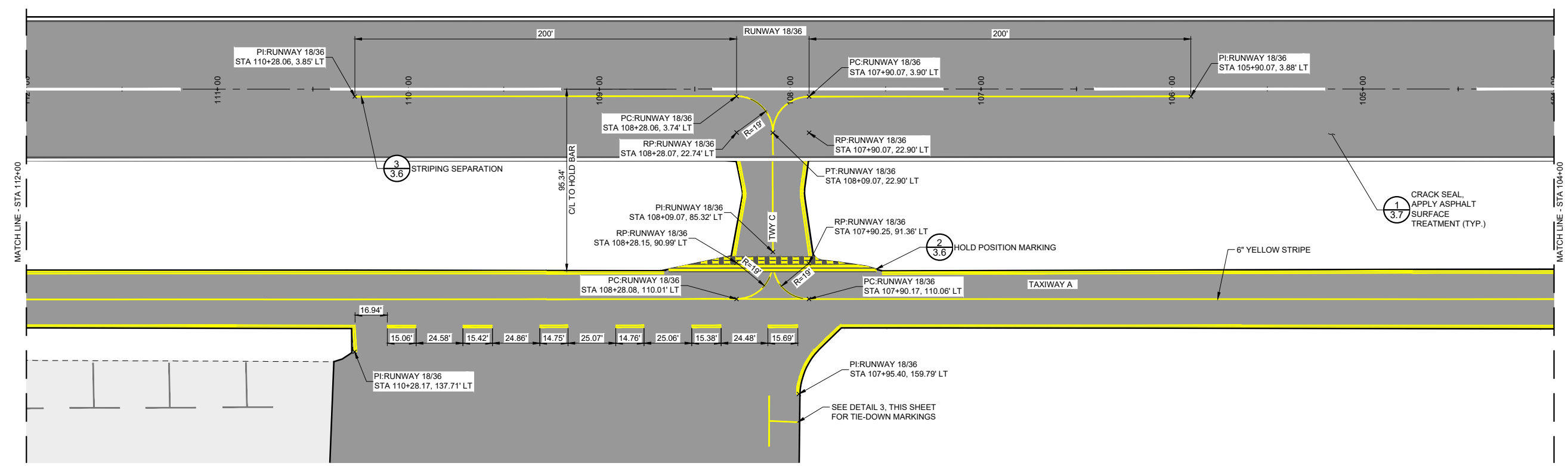

S:_California\Garberville\Project Files\Active Projects\22798 Garberville-Rehab_RW_TW_Apron\CAD\dwg\22798103.dwg 3/29/2024 9:45:43 AM MCOATS

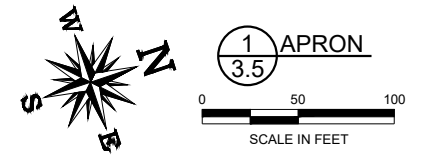
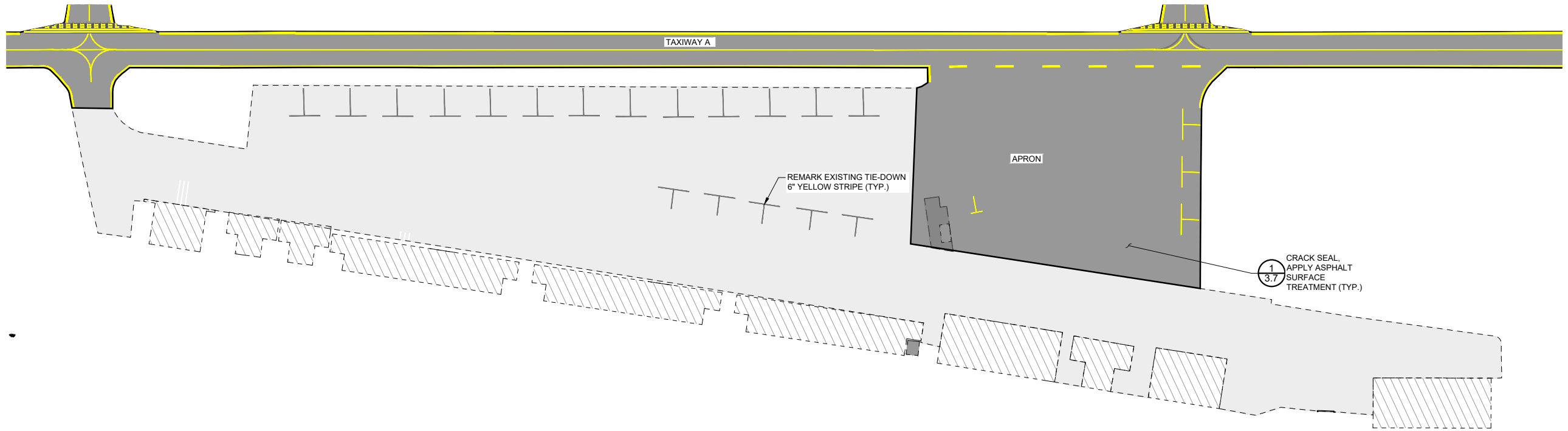

1
3.7
CRACK SEAL,
APPLY ASPHALT
SURFACE
TREATMENT (TYP.)



GARBERVILLE AIRPORT
GARBERVILLE, CALIFORNIA
PAVEMENT MAINTENANCE
AIP No.

No.	Revision	Date	By

ACI No. 227981
Date: APRIL 2024
File Name: 22798103

Drawn: MAC
Checked: EFR
Approved: CSN



MARKING
LAYOUT PLAN

Sheet: 3.5

S:_California\Garberville\Project Files\Active Projects\22798 GARBERVILLE-Rehab_RW_TW_Apron\CAD\dwg\22798103.dwg 3/29/2024 9:45:43 AM MCOATS

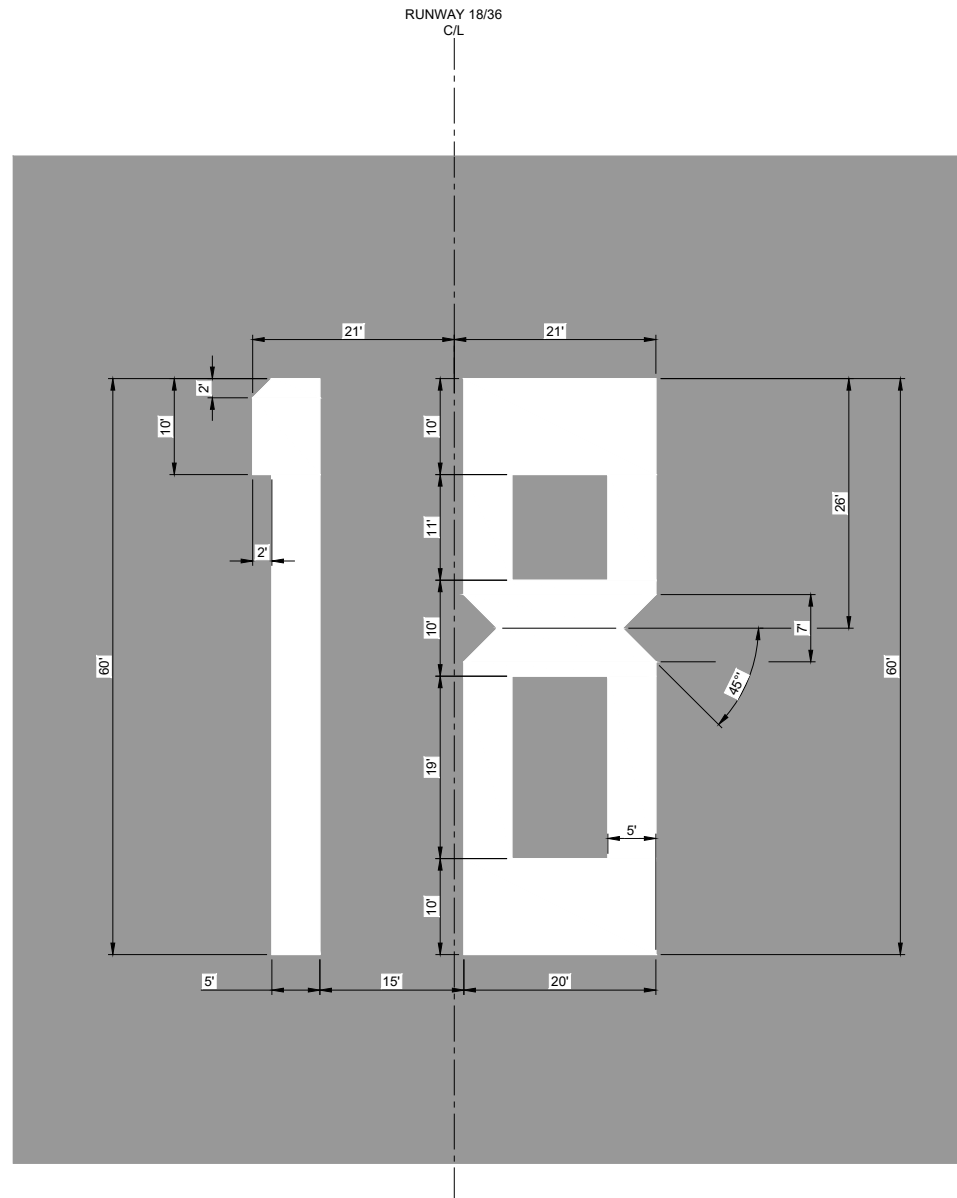
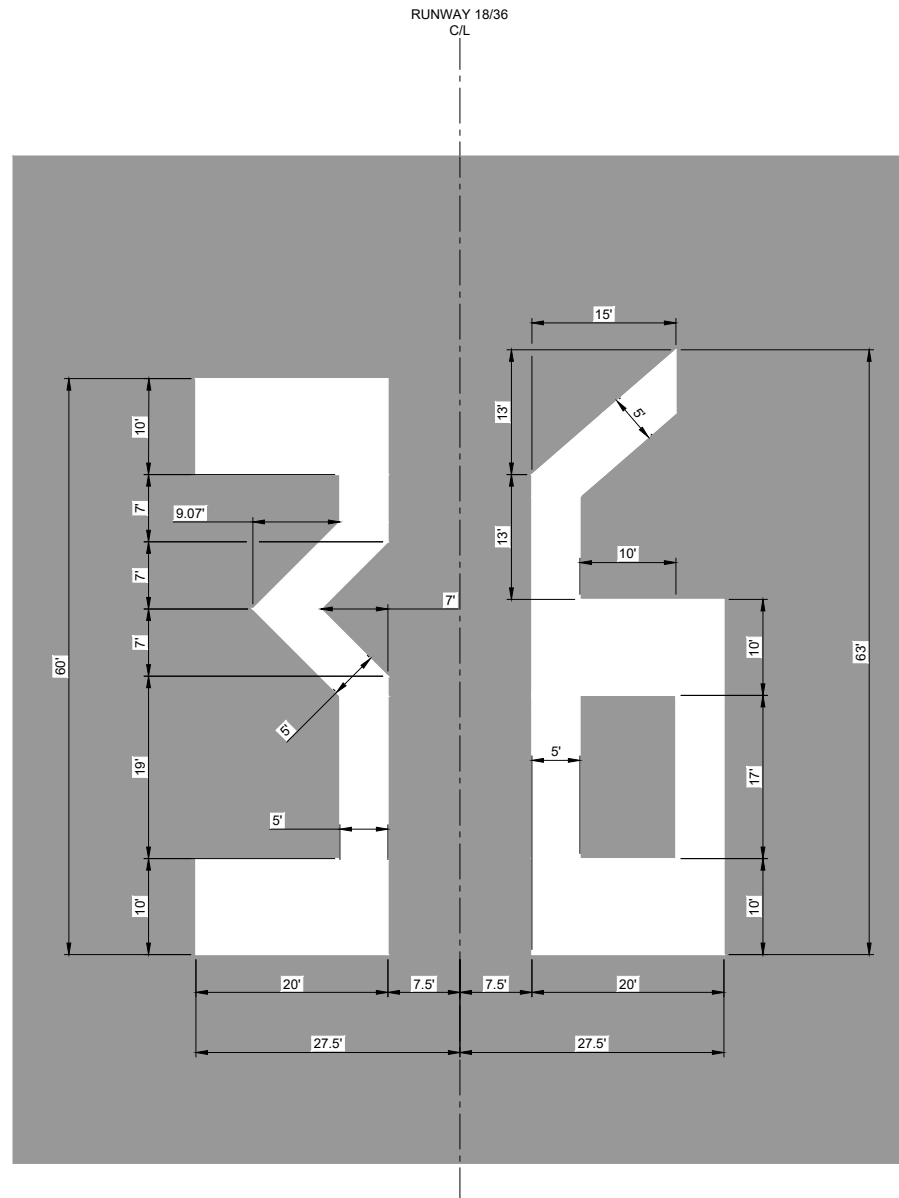

NOTE: ALL RUNWAY NUMERALS ARE WHITE
1 **3.6** **RUNWAY IDENTIFICATION NUMERALS**
 NOT TO SCALE

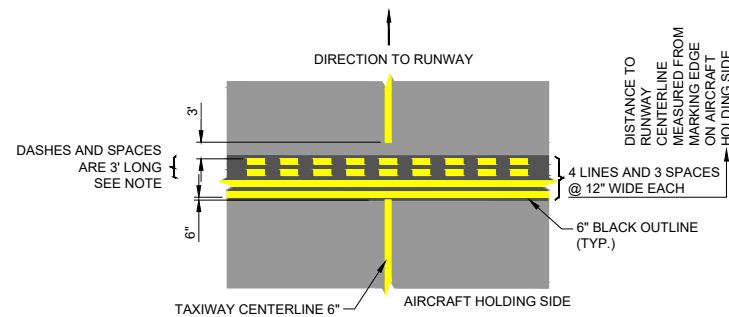

2 **3.6** **RUNWAY HOLDING POSITION MARKING - PATTERN A**
 NOT TO SCALE

NOTES:
 UNLESS OTHERWISE NOTED ALL LINES ARE YELLOW.
 BLACK BACKGROUND TO BE CONTINUOUS BETWEEN LINES & STRIPES.

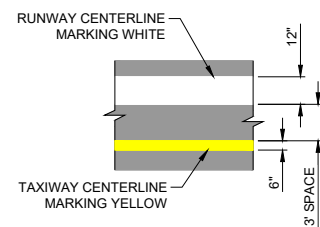

3 **3.6** **STRIPING SEPARATION**
 NOT TO SCALE

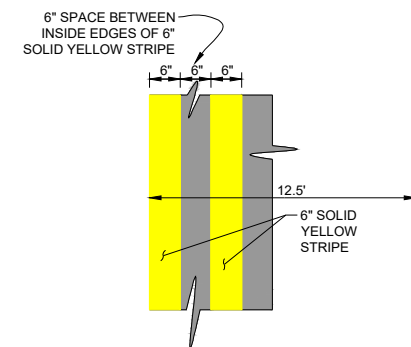

4 **3.6** **TAXIWAY EDGE MARKING**
 NOT TO SCALE

NOTES:
 BLACK OUTLINE MARKING REQUIRED ONLY ON CONCRETE AREAS.

No.	Revision	Date	By

ACI No. 227981
 Date: APRIL 2024
 File Name: 22798103

Drawn: MAC
 Checked: EFR
 Approved: CSN

MARKING DETAILS



S:_California\Garberville\Project Files\Active Projects\22798_GARBERVILLE-Rehab_RW_TW_Apron\CAD\dwg\22798103.dwg 3/29/2024 9:45:43 AM MCOATS

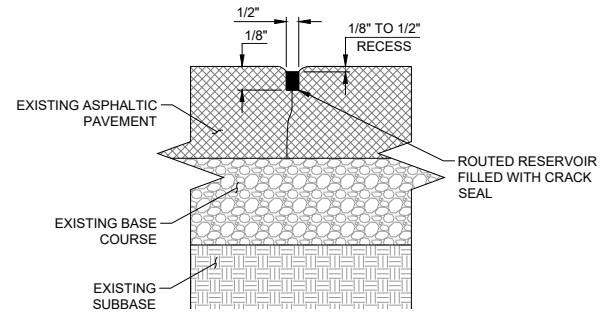

CRACKS 1/8" - 1/2" TREATMENT

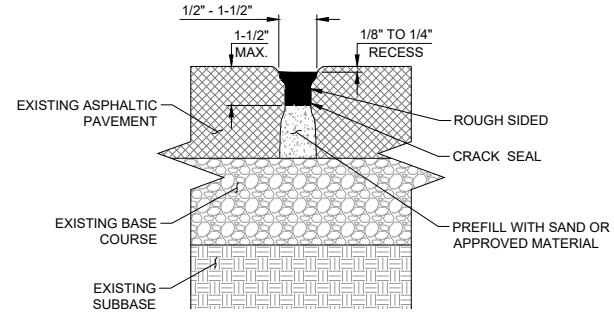

CRACKS 1/2" - 1-1/2" TREATMENT

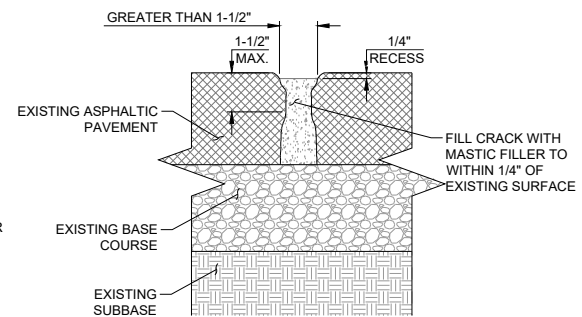

CRACKS LARGER THAN 1-1/2" TREATMENT

1 P-101 CRACK SEALING
3.7 NOT TO SCALE

GARBERVILLE AIRPORT
GARBERVILLE, CALIFORNIA
PAVEMENT MAINTENANCE
AIP No.

No.	Revision	Date	By

ACI No. 227981
Date: APRIL 2024
File Name: 22798103

Drawn: MAC
Checked: EFR
Approved: CSN



MARKING DETAILS

S:\California\Garberville\Project Files\Active Projects\22798 Garberville-Rehab_RW_TW_Apron\CAD\dwg\22798150.dwg 3/29/2024 9:34:27 AM MCOATS

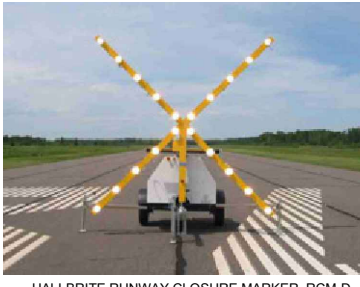
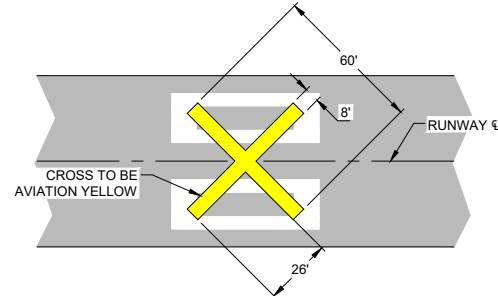
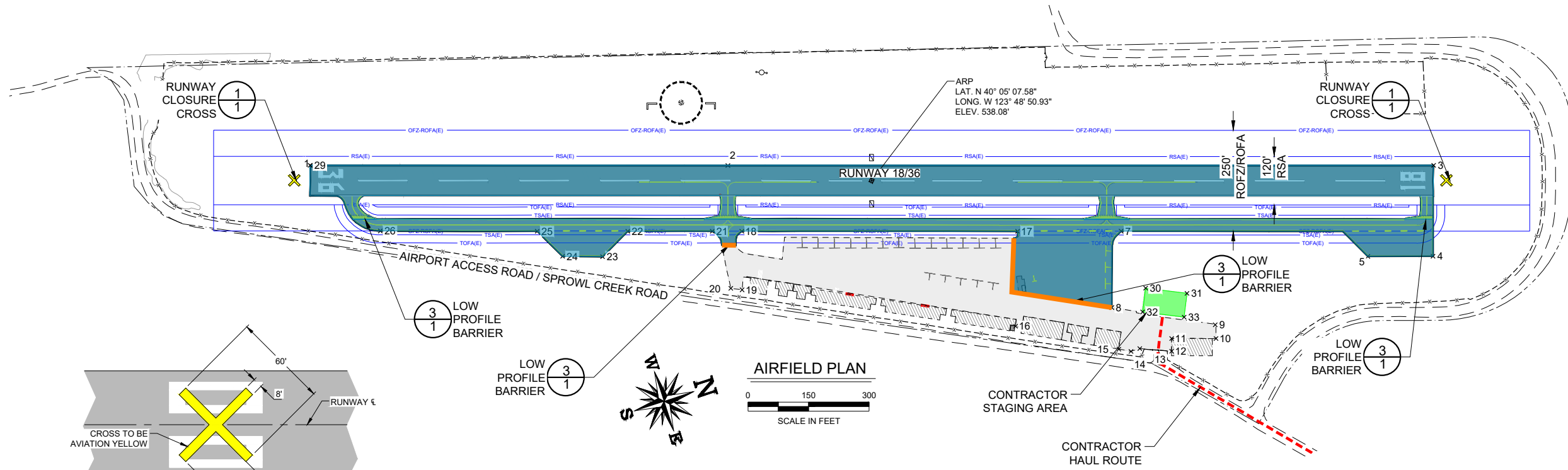

HAL-BRITE RUNWAY CLOSURE MARKER, RCM-D

1 RUNWAY CLOSURE CROSS
NOT TO SCALE

NOTES:
2 EACH REQUIRED PER CLOSED RUNWAY- INCIDENTAL. TO BE APPLIED OVER RUNWAY NUMERALS ON RUNWAY OR AT RUNWAY ENDS PRIOR TO RUNWAY CLOSURE. CROSSES TO BE CONSTRUCTED OF PLYWOOD OR OTHER FLAT MATERIALS WHICH SHALL BE SECURELY FASTENED TO PAVEMENT AND/OR ADEQUATELY WEIGHTED WITH SAND BAGS.
A LIGHTED CLOSURE CROSS SHALL BE REQUIRED AT NIGHT FOR DURATION OF PROJECT. HAL-BRITE RUNWAY CLOSURE MARKER RCM-D, AS SHOWN, REQUIRED, OR APPROVED EQUAL.

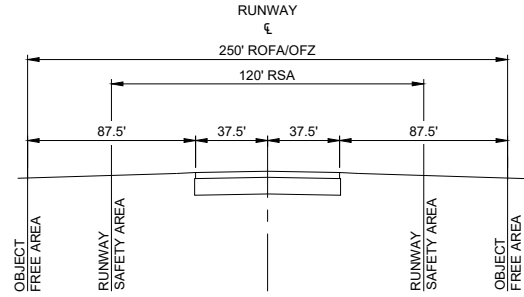

ALL STATIONARY CONSTRUCTION EQUIPMENT AND STOCKPILES MUST REMAIN CLEAR OF ANY OPEN RUNWAY OBJECT FREE AREA. ALL CONSTRUCTION EQUIPMENT AND TRAFFIC MUST REMAIN CLEAR OF ANY OPEN RUNWAY OBSTACLE FREE ZONE.

2 SAFETY AREAS
NOT TO SCALE

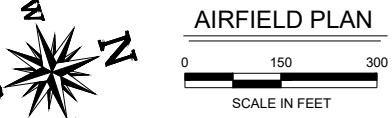

LEGEND

- PHASE I WORK AREA
- CONTRACTOR STAGING AREA
- LOW PROFILE BARRIER
- CONTRACTOR HAUL ROUTE
- DETAIL #
- 1 SHEET #
- ROFA = RUNWAY OBJECT FREE AREA
- ROFZ = RUNWAY OBSTACLE FREE ZONE
- RSA = RUNWAY SAFETY AREA
- TOFA = TAXIWAY OBJECT FREE AREA
- TSA = TAXIWAY SAFETY AREA

NOTES:
1. CONTRACTOR SHALL BE RESPONSIBLE FOR ANY DAMAGE CAUSED BY CONSTRUCTION ACTIVITIES TO HAUL ROUTES. ANY DAMAGE SHALL BE REPAIRED BY THE CONTRACTOR AT NO EXPENSE TO THE SPONSOR.

WORK AREA COORDINATES			
POINT #	ELEVATION	LATITUDE	LONGITUDE
1	550'	N040°04'54.53"	W123°48'56.60"
2	543'	N040°05'04.32"	W123°48'52.73"
3	535'	N040°05'20.86"	W123°48'46.19"
4	533'	N040°05'20.20"	W123°48'43.42"
5	533'	N040°05'18.67"	W123°48'44.02"
7	534'	N040°05'13.07"	W123°48'47.08"
8	533'	N040°05'12.31"	W123°48'44.83"
9	532'	N040°05'14.61"	W123°48'43.35"
10	531'	N040°05'14.53"	W123°48'42.92"
11	532'	N040°05'13.49"	W123°48'43.33"
12	533'	N040°05'13.40"	W123°48'42.94"
13	534'	N040°05'12.67"	W123°48'43.32"
14	535'	N040°05'12.45"	W123°48'43.31"
15	535'	N040°05'12.18"	W123°48'43.50"
16	535'	N040°05'09.92"	W123°48'45.15"
17	534'	N040°05'10.64"	W123°48'48.03"
18	537'	N040°05'04.18"	W123°48'50.59"
19	535'	N040°05'03.77"	W123°48'48.80"
20	535'	N040°05'03.51"	W123°48'48.95"
21	539'	N040°05'03.48"	W123°48'50.86"

WORK AREA COORDINATES			
POINT #	ELEVATION	LATITUDE	LONGITUDE
22	541'	N040°05'01.50"	W123°48'51.65"
23	538'	N040°05'00.73"	W123°48'51.10"
24	540'	N040°04'59.80"	W123°48'51.49"
25	543'	N040°04'59.38"	W123°48'52.49"
26	545'	N040°04'55.70"	W123°48'53.95"
29	550'	N040°04'54.53"	W123°48'56.60"
30	533'	N040°05'13.24"	W123°48'45.11"
31	533'	N040°05'14.17"	W123°48'44.57"
32	532'	N040°05'13.00"	W123°48'44.41"
33	531'	N040°05'13.93"	W123°48'43.87"
41	538'	N040°05'07.58"	W123°48'50.93"

LATITUDE AND LONGITUDES (LAT/LONG) DELINEATION OF THE CONSTRUCTION AREA AND CONTRACTOR STAGING AREA LIMITS ELEVATIONS WERE OBTAINED FROM GOOGLE EARTH

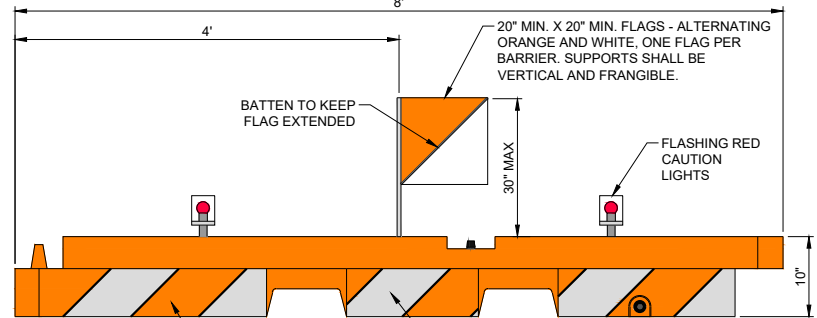

3 LOW PROFILE SAFETY BARRIER
NOT TO SCALE

NOTES:
1. BARRIER SHALL BE SHERWIN INDUSTRIES, 10" x 96" LOW PROFILE AIRPORT BARRIER, AS SHOWN, OR APPROVED EQUAL.
2. THE ENTIRE AREA OF ORANGE AND WHITE STRIPES SHALL BE REFLECTORIZED WITH SMOOTH SURFACE TYPE REFLECTIVE SHEETING.
3. LIGHTS MUST BE MOUNTED ON BARRIERS AND SPACED AT NO MORE THAN 10 FT.
4. THE BARRIERS SHALL BE WEIGHTED AGAINST PROPWASH AND CAPABLE OF WITHSTANDING UP TO 100 M.P.H. WIND FORCES.
5. FLASHING RED CAUTION LIGHTS SHALL BE BATTERY OPERATED AND SHALL MAINTAIN SUCH INTENSITY SO AS TO BE READILY IDENTIFIED FROM DISTANCES OF AT LEAST 200 FEET DURING DARKNESS.
6. THE CONTRACTOR SHALL CHECK ALL BARRIERS AND LIGHTS EACH DAY BEFORE LEAVING THE AIRPORT TO ENSURE LIGHTS ARE WORKING PROPERLY AND MAY NOT LEAVE WITHOUT ALL BARRIERS AND LIGHTS BEING IN PROPER WORKING ORDER.



No.	Revision	Date	By

ACI No. 227981
Date: APRIL 2024
File Name: 22798150

Drawn: MAC
Checked: EFR
Approved: CSN

CONSTRUCTION SAFETY & PHASING PLAN