Botanical Survey Results

HOLMES THP

HUMBOLDT COUNTY, CA

Prepared by:

Kyle Wear
Botanical Consultant
kyle_wear@suddenlink.net

Prepared for:

Holmgren Forestry
P.O. Box 247
Fortuna, CA 95540

Date:

July 2019

SUMMARY

Survey Date(s): May 20, & July 16, 2019

Field Personnel: Kyle Wear

Survey Area: 32 acres

Survey Hours: 5

USGS Quadrangle(s): Redcrest

Results: No special status plants or natural communities were encountered on the THP

RECEIVED

JUL 23 2019

COAST AREA
RESOURCE MANAGEMENT

1. INTRODUCTION

This report presents the results of a botanical survey conducted on the Holmes THP in Holmes. The purpose of the survey was to identify special status plants and plant communities that could be impacted by timber harvesting operations.

2. DEFINITIONS

Special Status Plants

Special status plants include taxa that are listed under the Endangered Species Act (ESA) and/or the California Endangered Species Act (CESA), in addition to plants that meet the definition of rare or endangered under the California Environmental Quality Act (CEQA). This includes plants with California Rare Plant Ranks (CRPR) of 1A, 1B, 2A, or 2B or other species that warrant consideration based on local or biological significance.

Special Status Plant Communities

Special status plant communities are communities with limited distribution that may be vulnerable to environmental impacts. Natural Communities recognized as sensitive are provided on the CDFW Sensitive *Natural Communities List* (CDFW 2018). The list is based on the vegetation classification in *A Manual of California Vegetation, 2nd Edition* (Sawyer et al. 2009). Natural communities with G or S ranks of 3 or lower are considered sensitive. However, they may not warrant protection under CEQA unless they are considered high quality. Human disturbance, invasive species, logging, and grazing are common factors considered when judging whether the stand is high quality and warrants protection.

3. ENVIRONMENTAL SETTING

Project Location

The 32-acre THP is located on the Redcrest USGS quadrangle (Section 3, T1S, R2E & Section 34, T1N, R2E) along Holmes Flat Road.

Soil, Topography, and Hydrology

The soil types mapped on the THP are derived siltstone and alluvium from mixed sedimentary sources (USDA, NRCS 2019). The THP includes a flat river terrace and a generally north and facing approximately 50% slope. The elevation ranges from approximately 160 to 440 feet above sea level. The THP includes several small tributaries of the Eel River. There are ponds and wetlands on the lower terrace.

4. METHODS

Scoping

A list of special status plants that could potentially occur on the THP was generated by consulting the *California Natural Diversity Database* (CDFW 2019) and the *CNPS Inventory of Rare and Endangered Plants* (CNPS 2019). The scoping list includes special status plants with

documented occurrences on the Redcrest USGS quadrangle or adjacent quadrangles; the list may include other taxa known to occur in habitat similar to the project area in Humboldt County (Table 1).

Survey

The botanical survey was conducted by Kyle Wear, M.A. Mr. Wear has over 20 years of experience conducting floristic surveys and other botanical work in northern California.

The survey was floristic in nature and followed methods outlined in *Protocols for Surveying and Evaluating Impacts to Special Status Native Plant Populations and Natural Communities* (CDFW 2018). The amendment was surveyed on May 20 and July 16, 2019. Approximately 5 hours were spent on the survey. A survey coverage map is provided in Figure 1. Plant taxonomy generally follows *The Jepson Manual Vascular Plants of California, Second Edition* (Baldwin et al. 2012), however the plant list may include more recent name changes. Plant communities were classified according to *A Manual of California Vegetation, 2nd Edition* (Sawyer et al. 2009).

5. RESULTS AND DISCUSSION

Special Status Plants

No special status plants were encountered on the survey. A list of all plants observed on the THP is provided in Table 2.

Special Status Plant Communities

No special status plant communities occur on the THP. The vegetation is consistent with young Redwood forest (*Sequoia sempervirens* Forest Alliance). The forest canopy is dominated by redwood. The understory is often dominated by huckleberry (*Vaccinium ovatum*) and sword fern (*Polystichum munitum*).

The wetland habitat on the lower terrace at the base of the slope includes a canopy of redwood and Oregon ash (*Fraxinus latifolia*). Common understory plants include slough sedge (*Carex obnupta*), rushes (*Juncus patens* & *J. effusus*), pennyroyal (*Mentha pelugium*), small flowered bulrush (*Scirpus microcarpus*), and water plantain (*Alisma lanceolata*). There are two ponds with cattail (*Typha latifolia*) and duckweed (*Lemna* sp.)

Plants associated with the stream include lady fern (*Athyrium filix-femina*), slough sedge, and five finger-fern (*Adiantum aleuticum*)

The appurtenant access roads from Holmes Flat Road pass through mowed grassland/residential lawn, agricultural fields, and a developed/ruderal area. The vegetation is predominately non-native grasses and other non-native herbaceous vegetation.

6. REFERENCES

Baldwin, B. C., D. H. Goldman, D. J. Keil, R. Patterson, and T.J. Roasatti. Eds. 2012. *The Jepson Manual, Vascular Plants of California, Second Edition*. University of California Press. Berkeley, CA.

California Department of Fish and Wildlife (CDFW). 2019. *California Natural Diversity Database (CNDDB)*. <https://www.wildlife.ca.gov/Data/CNDDB>

CDFW. 2018. *California Sensitive Natural Communities List*.
<https://www.wildlife.ca.gov/Data/VegCAMP/Natural-Communities>

CDFW. 2018. *Protocols for Surveying and Evaluating Impacts to Special Status Native Plant Populations and Natural Communities*.
<https://www.wildlife.ca.gov/Conservation/Survey-Protocols#377281280-plants>

California Native Plant Society (CNPS). 2019. *Inventory of Rare and Endangered Plants*.
<http://www.rareplants.cnps.org>

Sawyer, J.O., T. Keeler-Wolf and J.M Evans. 2009. *A Manual of California Vegetation, 2nd Edition*. California Native Plant Society. Sacramento, CA.

United States Department of Agriculture, Natural Resource Conservation Service (USDA, NRCS). 2019. *Web Soil Survey*. <https://websoilsurvey.sc.egov.usda.gov>

Table 1. Special Status Plant Scoping List.

Scientific Name	Common Name	Listing Status	Blooming Period	Habitat	Potential to Occur on THP
<i>Astragalus agnicidus</i>	Humboldt County milk-vetch	1B.1, CE	Apr-Sep	Broadleaved upland forest, North Coast coniferous forest, openings, disturbed areas, sometimes roadsides	Moderate. Potential along roads and disturbed areas.
<i>Carex arcta</i>	northern clustered sedge	2B.2	Jun-Sep	Bogs and fens, North Coast coniferous forest (mesic)	High. Potential wetlands.
<i>Downingia willamettensis</i>	Cascade downingia	2B.2	Jun-Jul(Sep)	Cismontane woodland lake margins, Valley and foothill grassland lake margins, Vernal pools	Moderate. Some potential in wetlands and ponds.
<i>Erythronium oregonum</i>	giant fawn lily	2B.2	Mar-Jun(Jul)	Cismontane woodland, Meadows and seeps, sometimes serpentinite, rocky, openings	Moderate-Unlikely. THP lacks much typical mesic rock habitat. Class II stream near domestic water supply appears suitable habitat.
<i>Erythronium revolutum</i>	coast fawn lily	2B.2	Mar-Jul(Aug)	Bogs and fens, Broadleaved upland forest, North Coast coniferous forest, Mesic, streambanks	Moderate-Unlikely. THP lacks much typical mesic rock habitat. Class II stream near domestic water supply appears suitable habitat.
<i>Gilia capitata</i> ssp. <i>pacifica</i>	Pacific gilia	1B.2	Apr-Aug	Coastal bluff scrub, Chaparral (openings), Coastal prairie, Valley and foothill grassland	Unlikely. THP lacks natural grasslands.
<i>Montia howellii</i>	Howell's montia	2B.2	(Jan-Feb)Mar-May	Meadows and seeps, North Coast coniferous forest, Vernal pools, vernal mesic, sometimes roadsides	High. Potential on roads.
<i>Peckera bolanderi</i> var. <i>bolanderi</i>	seacoast ragwort	2B.2	(Jan-Apr)May-Jul(Aug)	Coastal scrub, North Coast coniferous forest, Sometimes roadsides	Moderate-Unlikely. Some potential on roadcuts and open areas.
<i>Piperia candida</i>	white-flowered rein orchid	1B.2	(Mar)May-Sep	Broadleaved upland forest, Lower montane coniferous forest, North Coast coniferous forest, sometimes serpentinite	Moderate-High. Potential along roads old skid trails and forest understory.
<i>Sidalcea malviflora</i> ssp. <i>patula</i>	Siskiyou checkerbloom	1B.2	(Apr)May-Aug	Coastal bluff scrub, Coastal prairie, North Coast coniferous forest, often roadcuts	Moderate-Unlikely. Some potential along roads and open areas.

RECEIVED

JUL 23 2019

COAST AREA
RESOURCE MANAGEMENT

Table 1 (Cont.). Special Status Plant Scoping List.

SPECIAL STATUS PLANT LISTING STATUS

Endangered Species Act (ESA)

FE: Federally Endangered

FT: Federally Threatened

FR: Federally Rare

California Endangered Species Act (CESA)

CE: California Endangered

CT: California Threatened

CR: California Rare

California Rare Plant Ranks

1A: Plants Presumed Extirpated in California and Either Rare or Extinct Elsewhere

1B: Plants Rare, Threatened, or Endangered in California and Elsewhere

2A: Plants Presumed Extirpated in California, But Common Elsewhere

2B: California Rare Plant Rank 2B: Plants Rare, Threatened, or Endangered in California, But More Common Elsewhere

Threat Ranks

0.1-Seriously threatened in California (over 80% of occurrences threatened / high degree and immediacy of threat)

0.2-Moderately threatened in California (20-80% occurrences threatened / moderate degree and immediacy of threat)

0.3-Not very threatened in California (less than 20% of occurrences threatened / low degree and immediacy of threat or no current threats known)

RECEIVED

JUL 23 2019

COAST AREA
RESOURCE MANAGEMENT

Figure 1. Survey Coverage Map.

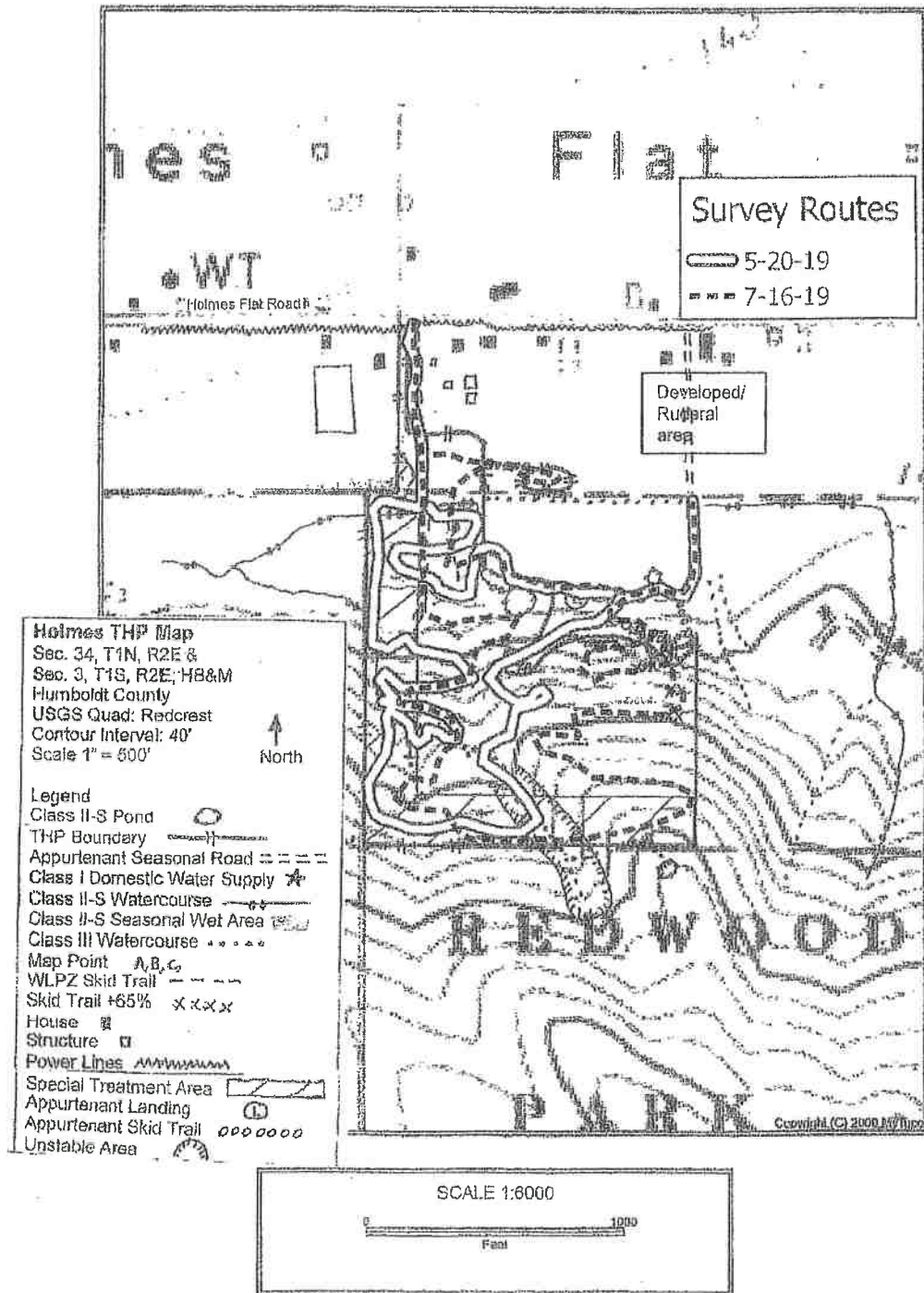

Table 2. List of Plants Encountered on the THP.

Scientific Name	Common Name
<i>Acer macrophyllum</i>	bigleaf maple
<i>Adiantum aleuticum</i>	five-fingered fern
<i>Agrostis</i> sp.	bent grass
<i>Alisma lanceolata</i>	lanceleaf water plantain
<i>Alnus rubra</i>	red alder
<i>Anaphalis margaritacea</i>	pearly everlasting
<i>Anthoxanthum occidentale</i>	California sweet grass
<i>Anthoxanthum odoratum</i>	sweet vernal grass
<i>Arbutus menziesii</i>	Pacific madrone
<i>Athyrium filix-femina</i>	lady fern
<i>Baccharis pilularis</i>	coyote brush
<i>Bellis perennis</i>	English daisy
<i>Callitriche</i> sp.	water starwort
<i>Cardamine californica</i>	milk maids
<i>Carex gynodynamis</i>	Olney's hairy sedge
<i>Carex hartfordii</i>	Hartford's sedge
<i>Carex hendersonii</i>	Henderson's sedge
<i>Carex leptopoda</i>	short scale sedge
<i>Carex obnupta</i>	slough sedge
<i>Ceanothus thyrsiflorus</i>	blue blossom
<i>Cirsium vulgare</i>	bull thistle
<i>Claytonia perfoliata</i>	miner's lettuce
<i>Clintonia andrewsiana</i>	bead lily
<i>Convolvulus arvensis</i>	field bindweed
<i>Cortaderia jubata</i>	pampas grass
<i>Corylus cornuta</i> ssp. <i>californica</i>	California hazelnut
<i>Crataegus monogyna</i>	hawthorn
<i>Cynodon dactylon</i>	bermuda grass
<i>Cynosurus echinatus</i>	dogtail grass
<i>Cyperus eragrostis</i>	nut-grass
<i>Dactylis glomerata</i>	orchard grass
<i>Daucus carota</i>	Queen Anne's lace
<i>Dipsacus fullonum</i>	wild teasel
<i>Eleocharis macrostachya</i>	creeping spike-rush
<i>Elymus glaucus</i> ssp. <i>glaucus</i>	blue wildrye
<i>Epilobium ciliatum</i>	northern willow herb
<i>Equisetum telmateia</i> ssp. <i>braunii</i>	giant horsetail
<i>Erigeron canadensis</i>	horseweed

Table 2 (Cont.). List of Plants Encountered on the THP.

Scientific Name	Common Name
<i>Festuca arundinacea</i>	tall fescue
<i>Festuca myuros</i>	rattail sixweeks grass
<i>Festuca perennis</i>	rye grass
<i>Fragaria vesca</i>	wood strawberry
<i>Fraxinus latifolia</i>	Oregon ash
<i>Galium aparine</i>	goose grass
<i>Galium</i> sp.	bedstraw
<i>Gastridium phleoides</i>	nit grass
<i>Gaultheria shallon</i>	salal
<i>Geranium dissectum</i>	cut-leaved geranium
<i>Helminthotheca echoides</i>	bristly ox-tongue
<i>Hieracium albiflorum</i>	white hawkweed
<i>Holcus lanatus</i>	common velvet grass
<i>Holodiscus discolor</i>	oceanspray
<i>Hypericum perforatum</i>	St. John's-wort
<i>Hypochaeris radicata</i>	hairy cat's-ear
<i>Iris douglasiana</i>	Douglas iris
<i>Juncus balticus</i>	wire rush
<i>Juncus effusus</i>	common rush
<i>Juncus patens</i>	spreading rush
<i>Lactuca</i> sp.	wild lettuce
<i>Lathyrus vestitus</i>	wood pea
<i>Lemna</i> sp.	duckweed
<i>Leucanthemum vulgare</i>	ox-eye daisy
<i>Luzula</i> sp.	wood rush
<i>Lysimachia latifolia</i>	Pacific star flower
<i>Maianthemum racemosa</i>	feathery false lily of the valley
<i>Malva nicaeensis</i>	bull mallow
<i>Melica</i> sp.	oniongrass
<i>Mentha pulegium</i>	pennyroyal
<i>Mimulus guttatus</i>	seep-spring monkey flower
<i>Mimulus moschatus</i>	musk monkey flower
<i>Notholithocarpus densiflorus</i> var. <i>densiflorus</i>	tanoak
<i>Oenanthe sarmentosa</i>	Pacific water-parsley
<i>Oxalis oregana</i>	redwood sorrel
<i>Parentucellia viscosa</i>	yellow parentucellia
<i>Petasites frigidus</i> var. <i>palmatus</i>	western coltsfoot

Table 2 (Cont.). List of Plants Encountered on the THP.

Scientific Name	Common Name
<i>Poa annua</i>	annual bluegrass
<i>Poa pratensis</i>	Kentucky bluegrass
<i>Poa trivialis</i>	rough bluegrass
<i>Polygonum aviculare</i>	prostrate knotweed
<i>Polypodium glycyrrhiza</i>	licorice fern
<i>Polystichum munitum</i>	sword fern
<i>Prosartes hookeri</i>	Hooker's fairy bells
<i>Prunella vulgaris</i>	self-heal
<i>Pseudotsuga menziesii</i>	Douglas-fir
<i>Pteridium aquilinum</i> var. <i>pubescens</i>	bracken fern
<i>Ranunculus repens</i>	creeping buttercup
<i>Ribes sanguineum</i> var. <i>glutinosum</i>	pink-flowering currant
<i>Rosa</i> sp.	rose
<i>Rubus leucodermis</i>	white-stemmed raspberry
<i>Rubus parviflorus</i>	thimbleberry
<i>Rubus spectabilis</i>	salmonberry
<i>Rubus ursinus</i>	California blackberry
<i>Rumex crispus</i>	curly dock
<i>Salix lasiandra</i> ssp. <i>lasiandra</i>	Pacific willow
<i>Salix lasiolepis</i>	arroyo willow
<i>Sambucus racemosa</i> var. <i>racemosa</i>	red elderberry
<i>Sanicula crassicaulis</i>	Pacific snakeroot
<i>Scolopus bigelovii</i>	slink-pod
<i>Senecio minimus</i>	coast fireweed
<i>Sequoia sempervirens</i>	coast redwood
<i>Spergularia rubra</i>	purple sand spurry
<i>Stachys ajugoides</i>	hedge nettle
<i>Struthiopteris spicant</i>	deer fern
<i>Taraxacum officinale</i>	dandelion
<i>Tellima grandiflora</i>	fringe cups
<i>Toxicodendron diversilobum</i>	poison-oak
<i>Trifolium dubium</i>	little hop clover
<i>Trifolium repens</i>	white clover
<i>Trillium ovatum</i>	western trillium
<i>Trisetum cernuum</i>	nodding trisetum
<i>Typha latifolia</i>	broadleaf cattail
<i>Umbellularia californica</i>	California-bay

RECEIVED

JUL 23 2019

COAST AREA
RESOURCE MANAGEMENT

Table 2 (Cont.). List of Plants Encountered on the THP.

Scientific Name	Common Name
<i>Urtica dioica</i>	stinging nettle
<i>Vaccinium ovatum</i>	evergreen huckleberry
<i>Vaccinium parvifolium</i>	red huckleberry
<i>Vancouveria</i> sp.	inside-out flower
<i>Veronica americana</i>	American brooklime
<i>Veronica scutellata</i>	marsh speedwell
<i>Vicia sativa</i>	vetch
<i>Viola glabella</i>	stream violet
<i>Viola sempervirens</i>	evergreen violet
<i>Whipplea modesta</i>	modesty
<i>Zeltnera muhlenbergii</i>	Monterey centaury

RECEIVED

JUL 23 2019

COASTAL RESOURCES
RESOURCE MANAGEMENT

From: Cameron Holmgren <holmgrenforestry@hotmail.com>
Sent: Tuesday, July 23, 2019 2:46 PM
To: Santa Rosa Review Team@CALFIRE; Hayashi, Bianca@Wildlife
Subject: Holmes THP 1-18-0163-HUM, Minor Amendment #4, Botanical Survey Results
Attachments: scan0791.pdf

Warning: this message is from an external user and should be treated with caution.

There were no special status plants or natural communities encountered on the THP

Cameron Holmgren, RPF #2929
Holmgren Forestry
PO Box 247
Fortuna, CA 95540
(707) 599-6416 Cell

RECEIVED

JUL 23 2019

COAST AREA
RESOURCE MANAGEMENT

AMENDMENT NO 3 (Minor)



Holmgren Forestry
PO Box 247
Fortuna, CA 95540
(707) 599-6416
holmgrenforestry@hotmail.com

June 6, 2019

CAL FIRE Review Team
135 Ridgeway Avenue
Santa Rosa, CA 95401

This amendment conforms to the rules and
the regulations of the Board of Forestry and
the Forest Practice Act. NTMS

Reviewed by ma/ccc date routed 7 Jun 2019
cc: Unit (2), BOE, SUB, RPF

NSO

Valid Until: 2/1/2020

Re: Holmes THP 1-18-163HUM Minor Amendment #3, Request for NSO Compliance Review

Dear CAL FIRE Representative,

On behalf of the landowners, I request compliance review from CAL FIRE regarding Northern spotted owls (NSO) for the Holmes THP 1-18-163HUM.

There is one NSO Activity Center HUM1106 within 0.7 air miles of the plan area. All NSO surveys followed Take Avoidance USFWS Scenario 4 using "Attachment A". All surveys were called with a digital caller. NSO survey stations are placed to cover as much of the THP 0.7 mile buffer as possible, however some locations are not possible to survey due to private property constraints.

2019 was the second year of protocol surveys for the Holmes THP area. In 2019 the nearby Childs NTMP landowners are not willing to share NSO data, so two new overlapping calling stations 6 & 7 were added. In 2019 six complete visits were called from stations 1-7. There were no NSO or Barred owl detections.

In 2018 six complete visits were called from stations 1-5. There were no NSO or Barred owl detections.

The THP is one unit totaling 16.7 acres. The THP is located in Section 34, T1N, R2E & Section 3, T1S, R2E; HB&M, Humboldt County. The silviculture is group selection/selection. The primary timber types are redwood, Douglas-fir, tanoak and madrone with a small component of alder, maple and pepperwood. Canopy cover ranges from 20% to 100% and is typed as 16 acres of Nesting/Roosting habitat and 0.7 acres of non-habitat. After timber operations are complete 11 acres of Nesting/Roosting habitat will be reduced to Foraging habitat. NSO suitable habitat will not be reduced. (See Habitat Maps with acres).

Please see attachments as follows:

- NSO Calling Station Map
- 2019 NSO Surveys (6)

Thank you,

Cameron Holmgren, RPF #2929

RECEIVED
JUN - 6 2019
COAST AREA OFFICE
RESOURCE MANAGEMENT

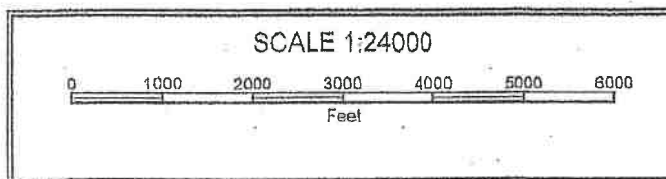
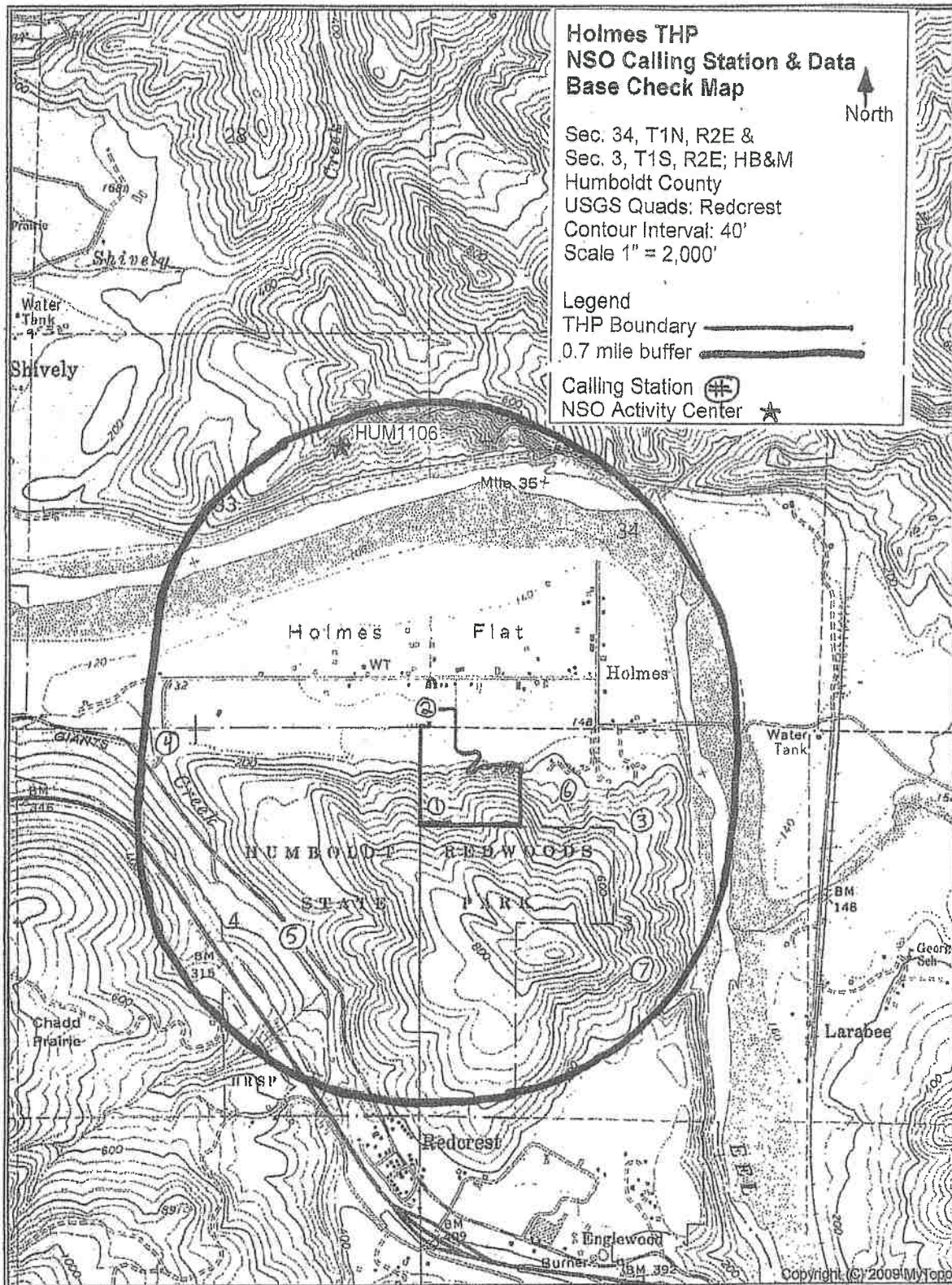

RECEIVED
 JUN - 6 2011
 COAST GUARD OFFICE
 RESOURCE MANAGEMENT

Northern Spotted Owl Survey Form

Visit # 1

Project Holmes THP		
Observer Justin Tallman	Date 3/12/19	Weather, Wind, Temp. PC, 1-2 45

[illegible]

4 List all stations and note if skipped.

Weather codes;

CL	Clear
FG	Fog
PC	Partly Cloudy
OC	Overcast
DR	Drizzle

Wind Codes:

0	Calm
1	Light Air
2	Light Breeze
3	Gentle Breeze
4	Moderate Breeze
5	Fresh Breeze
6	Strong Breeze

Sex Codes:

M	Male
F	Female
U	Unknown
PR	Pair

Data Logged _____

Data Entered

RECEIVED
JUN - 6 2019
COAST AREA OFFICE
RESOURCE MANAGEMENT

Northern Spotted Owl Survey Form

Visit # 2

Project <u>Holmes THP</u>		
Observer <u>Justin Tallman</u>	Date <u>3/23/19</u>	Weather, Wind, Temp. <u>OC 1-2 50</u>

[illegible]

*List all stations and note if skipped.

Weather codes:

CL	Clear
FG	Fog
PC	Partly Cloudy
OC	Overcast
DR	Drizzle

Wind Codes:

0	Calm
1	Light Air
2	Light Breeze
3	Gentle Breeze
4	Moderate Breeze
5	Fresh Breeze
6	Strong Breeze

Sex Codes:

M	Male
F	Female
U	Unknown
PR	Pair

Data Logged _____

Data Entered

RECEIVED

JUN - 6 2019

COAST AREA OFFICE
RESOURCE MANAGEMENT

Visit # 3

Visit # 3

[illegible]

Data Entered _____

RECEIVED
JUN - 6 2019
COAST AREA OFFICE
RESOURCE MANAGEMENT

Northern Spotted Owl Survey Form

Visit # 4

Project Holmes +HP		
Observer Justin Tallman	Date 4/27/19	Weather, Wind, Temp. 6C/42 45

[illegible]

*List all stations and note if skipped.

Weather codes:

CL	Clear
FG	Fog
PC	Partly Cloudy
OC	Overcast
DR	Drizzle

Wind Codes:

0	Calm
1	Light Air
2	Light Breeze
3	Gentle Breeze
4	Moderate Breeze
5	Fresh Breeze
6	Strong Breeze

Sex Codes:

M	Male
F	Female
U	Unknown
PR	Pelt

Date Logged

Data Entered

RECEIVED

JUN - 6 2019

COAST AREA OFFICE
RESOURCE MANAGEMENT

Northern Spotted Owl Survey Form

Visit # 5

Project Holmes THP		
Observer Justin Tallman	Date 5/6/19	Weather, Wind, Temp. PC 1-2 50-55

[illegible]

*List all stations and note if skipped.

Weather codes:

CL	Clear
FG	Fog
PC	Partly Cloudy
OC	Overcast
DR	Drizzle

Wind Codes:

0	Calm
1	Light Air
2	Light Breeze
3	Gentle Breeze
4	Moderate Breeze
5	Fresh Breeze
6	Strong Breeze

Sex Codes:

M	Male
F	Female
U	Unknown
PR	Pair

Date Logged _____

Data Entered _____

RECEIVED

JUN - 6 2019

COAST AREA OFFICE
RESOURCE MANAGEMENT

Northern Spotted Owl Survey Form

Visit # 6

Project <u>Holmes flat</u>		
Observer <u>Justin Tallman</u>	Date <u>5/30/19</u>	Weather, Wind, Temp. <u>FG 1-50</u>

[illegible]

*List all stations and note if skipped.

Weather codes:

CL	Clear
FG	Fog
PC	Partly Cloudy
OC	Overcast
DR	Drizzle

Wind Codes:

0	Calm
1	Light Air
2	Light Breeze
3	Gentle Breeze
4	Moderate Breeze
5	Fresh Breeze
6	Strong Breeze

Sex Codes:

M	Male
F	Female
U	Unknown
PR	Pair

Data Logged

Data Entered

RECEIVED

JUN - 6 2019

COAST AREA OFFICE
RESOURCE MANAGEMENT

From: Cameron Holmgren <holmgrenforestry@hotmail.com>
Sent: Thursday, June 6, 2019 12:39 PM
To: Santa Rosa Review Team@CALFIRE
Subject: Holmes THP 1-18-163HUM Minor Amendment #3, Request for NSO Compliance Review
Attachments: scan0730.pdf

Warning: this message is from an external user and should be treated with caution.

Cameron Holmgren, RPF #2929
Holmgren Forestry
PO Box 247
Fortuna, CA 95540
(707) 599-6416 Cell

RECEIVED
JUN - 6 2019
COAST AREA OFFICE
RESOURCE MANAGEMENT

Curtis, Chris@CALFIRE

From: Baker, Michael@CALFIRE
Sent: Thursday, June 6, 2019 4:29 PM
To: Santa Rosa Review Team@CALFIRE; Curtis, Chris@CALFIRE; Flamik, Glenn@CALFIRE; Headley, Shawn@CALFIRE; Montgomery, Timothy@CALFIRE; Schwab, Dominik@CALFIRE; Stanish, Anastasia@CALFIRE
Cc: Solinsky, Bill@CALFIRE
Subject: RE: Holmes THP 1-18-00163HUM Minor Amendment #3, Request for NSO Compliance Review

Santa Rosa Review Team,

I have reviewed the survey summary, calling stations map, and field data sheets submitted as an amendment request to THP # 1-18-00163 HUM, dated June 6, 2019.

The 2019 USFWS Protocol Surveys, as conducted, meet the requirements of the USFWS 2012 NSO Survey Protocol guidance and zero NSO were detected.

Therefore, no changes to the NSO Protection Measures in the approved plan, as informed by the USFWS guidance, are warranted.

I recommend that this amendment request be accepted and applicable until February 1, 2020.

Michael Baker

Michael D. Baker, Ph.D.
Forest Practice Biologist
Sr. Environmental Scientist



Email preferred over voicemail
Cell: 916-616-0021

Every Californian should conserve water **and keep trees alive.**

Find out how at: saveourwater.com/trees · Drought.CA.gov

From: Santa Rosa Review Team@CALFIRE
Sent: Thursday, June 6, 2019 1:56 PM
To: Baker, Michael@CALFIRE <Michael.Baker@fire.ca.gov>; Curtis, Chris@CALFIRE <Chris.Curtis@fire.ca.gov>; Flamik, Glenn@CALFIRE <Glenn.Flamik@fire.ca.gov>; Headley, Shawn@CALFIRE <Shawn.Headley@fire.ca.gov>; Montgomery, Timothy@CALFIRE <timothy.montgomery@fire.ca.gov>; Schwab, Dominik@CALFIRE <Dominik.Schwab@fire.ca.gov>; Stanish, Anastasia@CALFIRE <Anastasia.Stanish@fire.ca.gov>
Subject: FW: Holmes THP 1-18-00163HUM Minor Amendment #3, Request for NSO Compliance Review

From: Cameron Holmgren [<mailto:holmgrenforestry@hotmail.com>]
Sent: Thursday, June 6, 2019 12:39 PM
To: Santa Rosa Review Team@CALFIRE <SantaRosaReviewTeam@fire.ca.gov>
Subject: Holmes THP 1-18-163HUM Minor Amendment #3, Request for NSO Compliance Review

Warning: this message is from an external user and should be treated with caution.

Cameron Holmgren, RPF #2929
Holmgren Forestry
PO Box 247
Fortuna, CA 95540
(707) 599-6416 Cell