

Humboldt County Site Plan
Humboldt Headless Chicken Ranch
APN: 218-151-005
Site address:
1530 D Road
Garberville, Ca 95542
Mailing Address:
69 Nob Hill Road
Whitethorn, Ca 95589
Rev. 10/08/2023

Abbreviations:
 WT - Water Tank(s)
 DPL - Distance to Property Line
 GH - Greenhouse/Mixed light
 OD - Outdoor
 CUB - Cannabis use building

Map Legend
 Grow Area
 Property line (Humboldt County GIS)
 Road
 Seasonal ATV Road
 Stream
 Approximate County SMA(see SMA Report for Mapping)
 Cannabis use building
 Non cannabis use building
 Water storage tanks
 Spring box
 Well
 Other point of interest

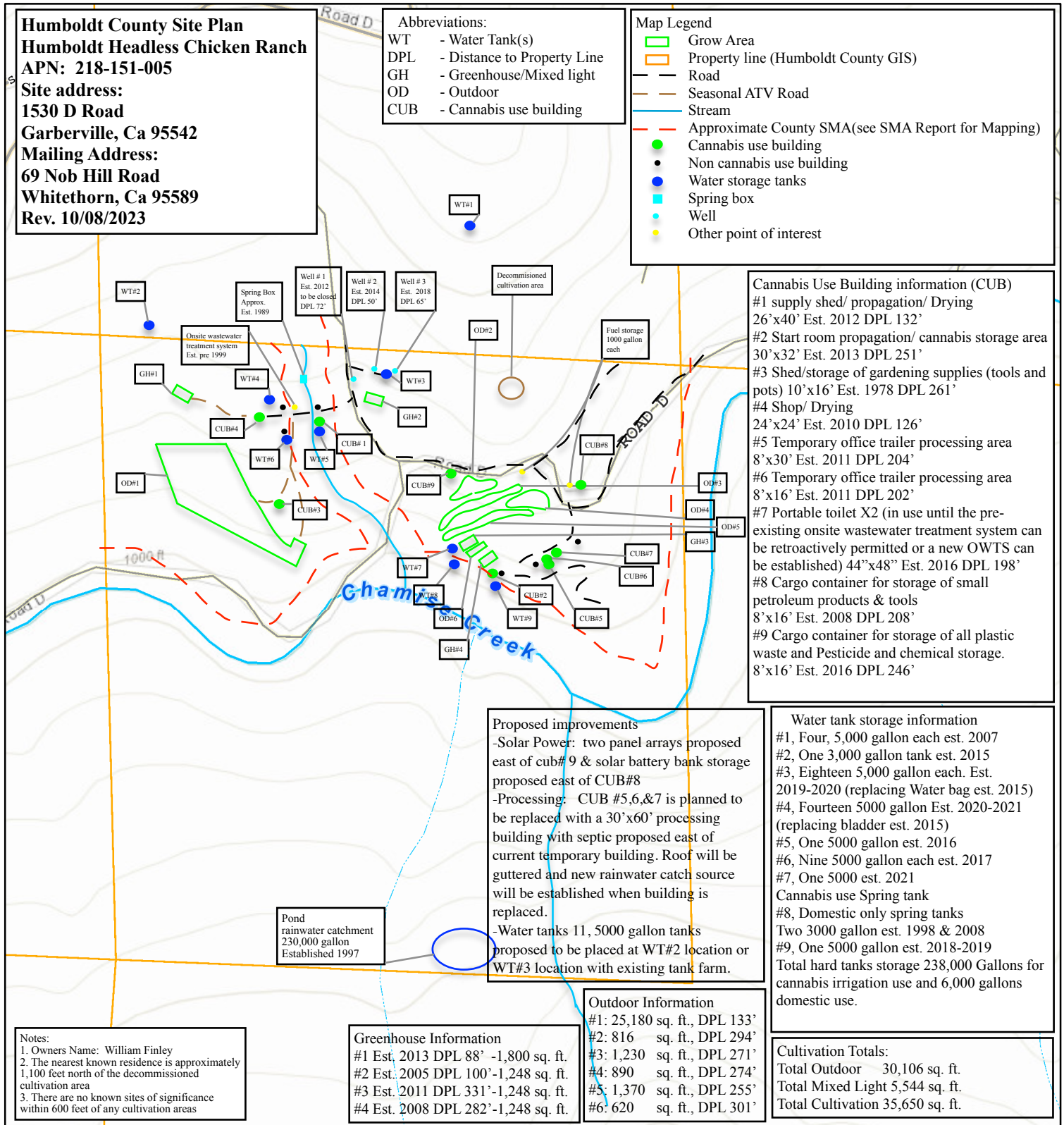

Cannabis Use Building information (CUB)
 #1 supply shed/ propagation/ Drying 26'x40' Est. 2012 DPL 132'
 #2 Start room propagation/ cannabis storage area 30'x32' Est. 2013 DPL 251'
 #3 Shed/storage of gardening supplies (tools and pots) 10'x16' Est. 1978 DPL 261'
 #4 Shop/ Drying 24'x24' Est. 2010 DPL 126'
 #5 Temporary office trailer processing area 8'x30' Est. 2011 DPL 204'
 #6 Temporary office trailer processing area 8'x16' Est. 2011 DPL 202'
 #7 Portable toilet X2 (in use until the pre-existing onsite wastewater treatment system can be retroactively permitted or a new OWTS can be established) 44'x48" Est. 2016 DPL 198'
 #8 Cargo container for storage of small petroleum products & tools 8'x16' Est. 2008 DPL 208'
 #9 Cargo container for storage of all plastic waste and Pesticide and chemical storage. 8'x16' Est. 2016 DPL 246'

Proposed improvements
 -Solar Power: two panel arrays proposed east of cub# 9 & solar battery bank storage proposed east of CUB#8
 -Processing: CUB #5,6,&7 is planned to be replaced with a 30'x60' processing building with septic proposed east of current temporary building. Roof will be guttered and new rainwater catch source will be established when building is replaced.
 -Water tanks 11, 5000 gallon tanks proposed to be placed at WT#2 location or WT#3 location with existing tank farm.

Water tank storage information
 #1, Four, 5,000 gallon each est. 2007
 #2, One 3,000 gallon tank est. 2015
 #3, Eighteen 5,000 gallon each. Est. 2019-2020 (replacing Water bag est. 2015)
 #4, Fourteen 5000 gallon Est. 2020-2021 (replacing bladder est. 2015)
 #5, One 5000 gallon est. 2016
 #6, Nine 5000 gallon each est. 2017
 #7, One 5000 est. 2021
 Cannabis use Spring tank
 #8, Domestic only spring tanks Two 3000 gallon est. 1998 & 2008
 #9, One 5000 gallon est. 2018-2019
 Total hard tanks storage 238,000 Gallons for cannabis irrigation use and 6,000 gallons domestic use.

Outdoor Information
 #1: 25,180 sq. ft., DPL 133'
 #2: 816 sq. ft., DPL 294'
 #3: 1,230 sq. ft., DPL 271'
 #4: 890 sq. ft., DPL 274'
 #5: 1,370 sq. ft., DPL 255'
 #6: 620 sq. ft., DPL 301'

Greenhouse Information
 #1 Est. 2013 DPL 88' -1,800 sq. ft.
 #2 Est. 2005 DPL 100'-1,248 sq. ft.
 #3 Est. 2011 DPL 331'-1,248 sq. ft.
 #4 Est. 2008 DPL 282'-1,248 sq. ft.

Notes:
 1. Owners Name: William Finley
 2. The nearest known residence is approximately 1,100 feet north of the decommissioned cultivation area
 3. There are no known sites of significance within 600 feet of any cultivation areas

Pond
 rainwater catchment
 230,000 gallon
 Established 1997



ArcGIS Web Map

Humboldt County Planning and Building Department

0 180 360 720 Feet
 0 0.0325 0.065 0.13 Miles
 RF = 1:4,514 1 in = 376 ft



Printed: December 21, 2020

Web AppBuilder 2.0 for ArcGIS

Map Disclaimer:

While every effort has been made to assure the accuracy of this information, it should be understood that it does not have the force & effect of law, rule, or regulation. Should any difference or error occur, the law will take precedence.

Source: Humboldt County GIS, Sources: Esri, HERE, Garmin, Intermap, increment P Corp., GEBCO, USGS, FAO, NPS, NRCAN, GeoBase, IGN, Kadaster NL, Ordnance Survey, Esri Japan, METI, Esri China (Hong Kong), (c) OpenStreetMap contributors, and the GIS User Community

Received 10/17/2023 HCPBD