

**FUNDING SOURCE**  
 THIS PROJECT IS FUNDED BY THE US DEPARTMENT OF TRANSPORTATION, FEDERAL HIGHWAY ADMINISTRATION EMERGENCY RELIEF PROGRAM



**PROJECT PLANS OF STORM DAMAGE REPAIRS ON**

**MURRAY ROAD (C3M0201)**

at P.M. 5.57

**PROJECT NO. ER-32L013261**

**CONTRACT NO. 217438**

BAR IS ONE INCH ON ORIGINAL DRAWING	ROAD NAME: MURRAY ROAD	DATE POST: PM 5.57	DESIGN SECTION: JEFFREY A. BALL	COUNTY OF HUMBOLDT DEPARTMENT OF PUBLIC WORKS	SHEET 1 OF 8
F NOT ONE INCH ON THIS SHEET, ADJUST SCALES ACCORDINGLY	ROAD NO: C3M0201	EA NO:	DESIGNED BY: JAB	MURRAY ROAD PM 5.57	
	PROJECT NO: ER-32L013261	PRNO:	DRAWN BY: JAB	COVER SHEET, INDEX AND DETAILS	
	CONTRACT NO: 217438	DRAWING FILE NAME: I:\PROJECTS\2017\20171438\PM5.57\CONSUL.dwg	REVIEWED BY: JAB		
	PROJECT DATE: 9/6/19	REVISION DATE:	APPROVED BY: JAB		

COUNTY OF HUMBOLDT

DEPARTMENT OF PUBLIC WORKS

- INDEX OF SHEETS**
- 1 COVER SHEET
  - 2 CONSTRUCTION AREA SIGNS, QUANTITIES, AND DETAILS
  - 3 TYPICAL SECTIONS AND DETAILS
  - 4 PLAN AND PROFILE
  - 5-6 CROSS SECTIONS - "C"-LINE
  - 7-8 CROSS SECTIONS - "I"-LINE

**APPLICABLE STANDARD PLANS**  
 REFERENCE TO CALTRANS STANDARD PLANS DATED 2018.  
 (SEE APPLICABLE STD PLAN LIST IN SPECIAL PROVISIONS)

**NOTES**  
 THE CONTRACTOR SHALL HAVE A CLASS "A" LICENSE FOR THIS PROJECT.

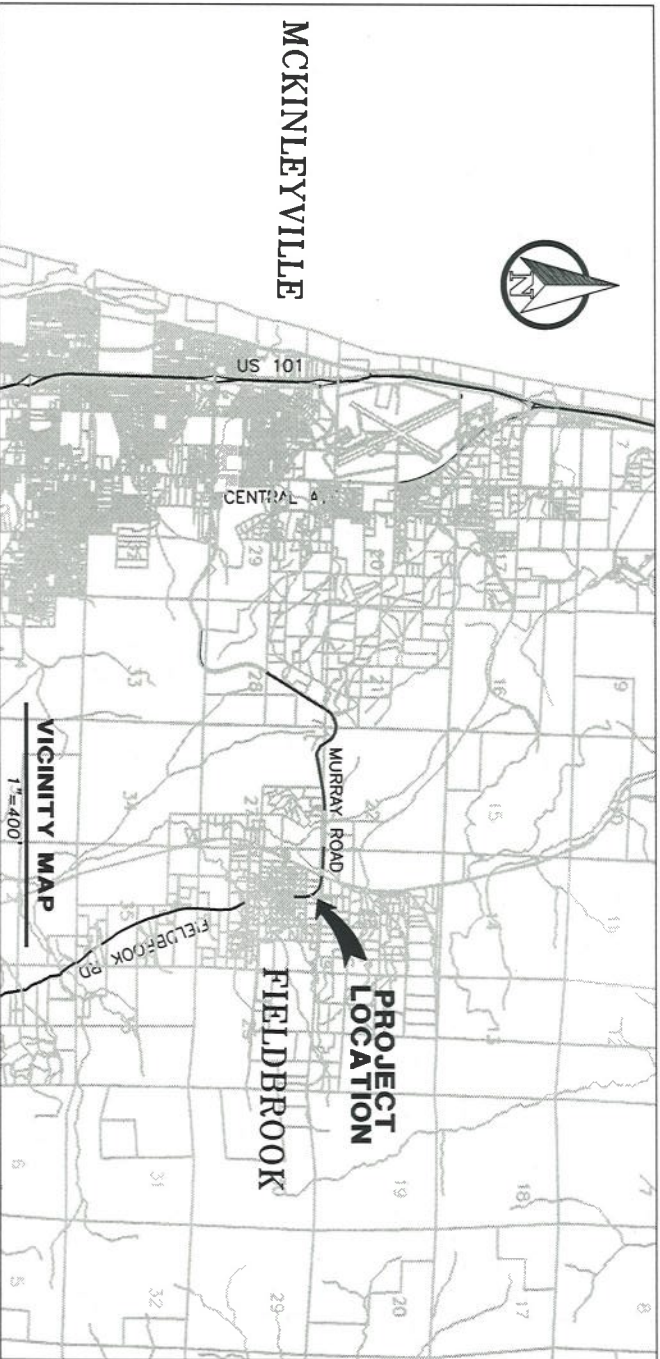
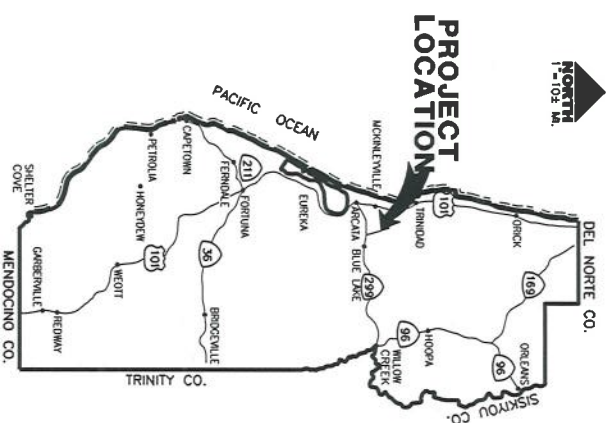

**RECOMMENDED**

*Michael D. Layton*  
 MICHAEL D. LAYTON  
 RCE 90546, EXP. 12/31/2019  
 DATE 9-6-19



**APPROVED**

*Tony R. Seghetti*  
 TONY R. SEGHETTI  
 RCE 63714, EXP. 9/30/2020  
 DATE 9-6-19



ORIGINAL LOW BID PRICE

CONSTRUCTED BY

PROJECT COMPLETED

RESIDENT ENGINEER

CONSTRUCTION COST \$

**QUANTITIES**

ITEM NO.	ITEM CODE	ITEM DESCRIPTION	UNIT	TOTAL QUANTITY
1	100100	Develop Water Supply	LS	1
2	120089	Construct Detour (Railroad Flatcar Bridge)	LS	1
3	120100	Traffic Control System	LS	1
4	120900	Construction Area Signs	EA	12
5	128601	Temporary Signal System	LS	1
6	129000	Temporary Railing (Type K)	LF	160
7	130100	Job Site Management	LS	1
8	130200	Prepare Water Pollution Control Plan	LS	1
9	130680	Temporary Silt Fence	LF	150
10	131201	Temporary Creek Diversion System	LS	1
11	146002	Contractor-Supplied Biologist (LS)	LS	1
12	150604	Remove Fence	LF	100
13	151531	Reconstruct Fence	LF	100
14	150805	Remove Culvert	EA	1
15	160101	Clearing and Grubbing (LS)	LS	1
16	170103A	Remove Tree	EA	3
17	190101	Roadway Excavation	CY	90
18	190151	Channel Excavation	CY	15
19	192001	Structure Excavation (Culvert)	CY	730
20	193001	Structure Backfill	CY	110
21	198050	Embankment	CY	570
22	200001	Plant Trees	EA	6
23	210350	Fiber Rolls	LF	500
24	210430	Hydroseed	SQFT	1,500
25	260301	Class 2 Aggregate Base	CY	60
26	390130	Hot Mix Asphalt (Type A, 1/2")	TON	40
27	650034	48" Reinforced Concrete Pipe (5" Thick) Class III	LF	104
28	721006	Rock Slope Protection (1/2 TON, Method A)	TON	22
29	840501	Thermoplastic Traffic Stripe	LF	255
30	999990	Mobilization	LS	1

**CONSTRUCTION AREA SIGN SUMMARY**

SIGN TYPE	QTY	DESCRIPTION	SIZE	REMARKS	POST SIZE	NUMBER
W20-1	2	ROAD WORK AHEAD	36" x 36"	VISIBLE AT ALL TIMES	4" x 4"	1
W20-4	2	ONE LANE ROAD AHEAD	36" x 36"	VISIBLE AT ALL TIMES	4" x 4"	1
W3-3	2	SIGNAL AHEAD	36" x 18"	VISIBLE AT ALL TIMES	4" x 4"	1
W16-2P	2	500 FEET	36" x 18"	VISIBLE AT ALL TIMES	4" x 4"	1
R10-6	2	STOP HERE ON RED	36" x 18"	VISIBLE AT ALL TIMES	4" x 4"	1
G20-2	2	END ROAD WORK	36" x 18"	VISIBLE AT ALL TIMES	4" x 4"	1

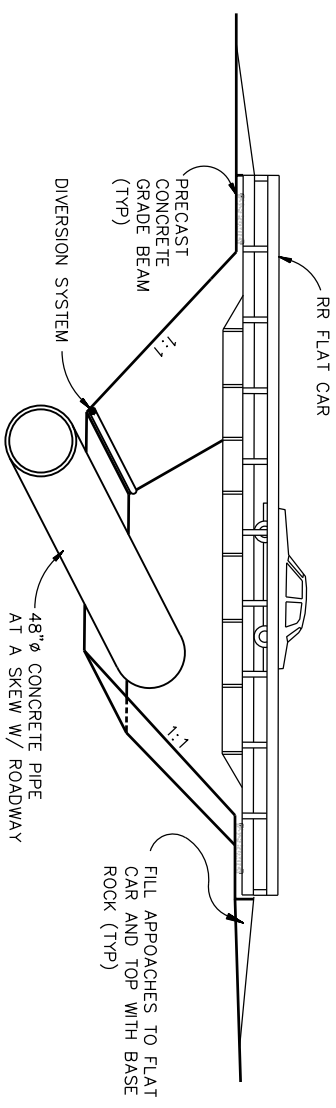

**FLATCAR DETOUR ELEVATION VIEW**  
NOT TO SCALE

**NOTES**

- 1) SIGNS SHALL BE PLACED AS SHOWN ON PLAN OR AS DIRECTED BY THE ENGINEER.
- 2) FINAL PLACEMENT OF SIGNS SHALL BE APPROVED BY RESIDENT ENGINEER.
- 3) ADDITIONAL PORTABLE SIGNS SHALL BE USED AS REQUIRED FOR OTHER ROADSIDE WORK.
- 4) SEE STANDARD PLAN T13 FOR TRAFFIC CONTROL SYSTEM.
- 5) IN ADDITION TO CONSTRUCTION AREA SIGNS AND WHEN DIRECTED BY THE RESIDENT ENGINEER, THE CONTRACTOR SHALL UTILIZE FLAGMEN AS NECESSARY TO DIRECT TRAFFIC.
- 6) DISTANCE TO W20-1 AND G20-2 MAY BE EXTENDED TO ENCOMPASS SITES WITHIN ONE MILE OF EACH OTHER.

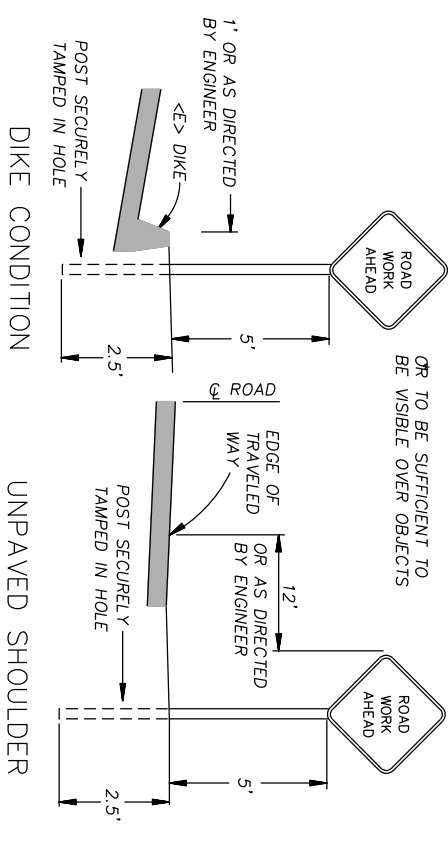

**RURAL CONSTRUCTION AREA SIGN**  
- NOT TO SCALE -

**SURVEY CONTROL & MONUMENT COORDINATES**

Pnt.#	Northing	Eastng	Elev.	Description
1	5211.6056	5003.7133	4999.08	SET80D&SHINER
2	5049.9539	5000.7032	4998.17	SETMAGNAIL&HUMCODPW.TAG
3	4960.4256	5039.5316	5000.00	SET80D&SHINER
4	4626.0679	5039.6623	5001.75	SETMAGNAIL&HUMCODPW.TAG
5	5000.0000	5000.0000	0.00	FD.1 1/2"ALCAP.LS3945
6	4999.7835	5050.3657	4995.14	FD.3/4"1"P.W/PLUG.LS2820
7	4850.0010	4999.9900	5000.09	FD.5/8"REBAR.NOI.D.

VERTICAL DATUM: ASSUMED ELEVATION 5000.00 ON CONTROL POINT CP#3  
 HORIZONTAL DATUM: NORTH BASED ON A TIE BETWEEN CP#5 & CP#7  
 RIGHT OF WAY: 25' EITHER SIDE OF TRAVERSED CENTERLINE SOUTH OF SITE  
 80' EITHER SIDE OF TRAVERSED CENTERLINE NORTH OF SITE

**APN REFERENCE TABLE**

ID	APN #	OWNER NAME
A	512-073-002-000	JOSEPH J. JR. & TERESA I. MELLO
B	512-101-071-000	SAMUAL F. & MARISSA MINOTON
C	512-101-073-000	PAUL W. SR. & MARVINE R. RAY
D	512-072-003-000	ROBERT S. & JUNE C. REDNER
E	512-091-006-000	ROBERT S. & JUNE C. REDNER
F	512-091-007-000	PAUL R. & MARY F. MEYER
G	512-091-043-000	KEVIN HALE
H	512-091-049-000	PAUL R. & MARY F. MEYER

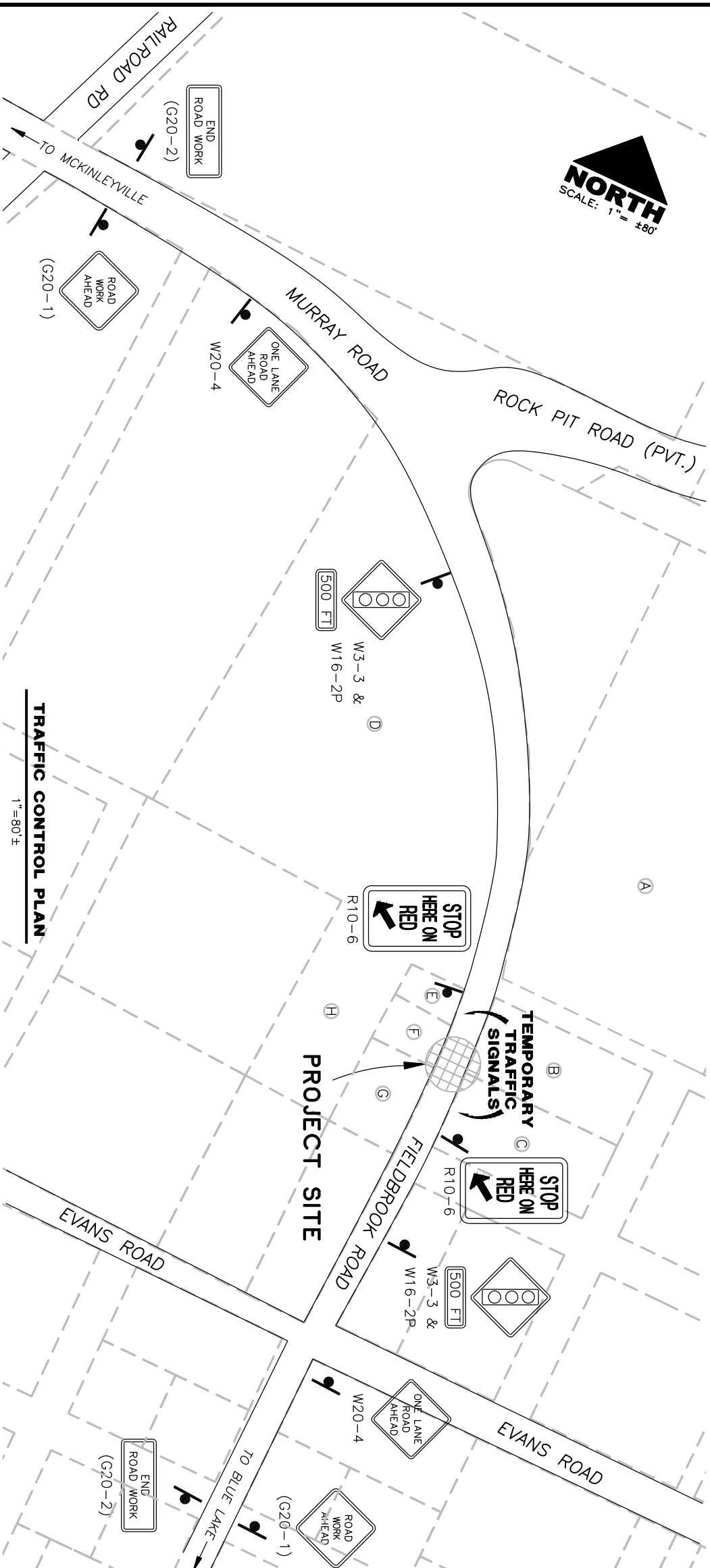

**TRAFFIC CONTROL PLAN**  
1"=80'±

ROAD NAME: MURRAY ROAD ROAD NO: G2020 PROJECT NO: EB-2010129	MILE POST: PM 5.57 EA NO: PRNO:	DESIGN SECTION JEFFREY A. BALL	COUNTY OF HUMBOLDT DEPARTMENT OF PUBLIC WORKS MURRAY ROAD PM 5.57
CONTRACT NO: 217438 DRAWING FILE NAME: L:\PROJECTS\201750\217438\dwg\CONSO2.dwg PLOT DATE: 6/6/19	REVISION DATE:	DESIGNED BY: MDL DRAWN BY: WDL REVIEWED BY: JAB APPROVED BY: ARS	CONSTRUCTION AREA SIGNS, QUANTITIES, SURVEY CONTROL AND DETAILS
			SHEET <b>2</b> OF <b>8</b>



ROAD NAME: MURRAY ROAD	DESIGN SECTION	COUNTY OF HUMBOLDT DEPARTMENT OF PUBLIC WORKS	SHEET 3
BAR IS ONE INCH ON ORIGINAL DRAWING	JEFFREY A. BALL		
PROJECT NO.: CM2020	MILE POST: PM 5.57	MURRAY ROAD PM 5.57	OF 8
CONTRACT NO.: 217438	EA NO.:		
DRAWING FILE NAME: L:\PROJECTS\2017SD\217438\DWG\COSM03.dwg	DESIGNED BY: MDL	TYPICAL SECTIONS and DETAILS	
REVISION DATE: 8/6/19	REVIEWED BY: JAB		
APPROVED BY: ASB	APPROVED BY: ASB		

**TEMPORARY CREEK DIVERSION PLAN**

SCALE: 1"=10'

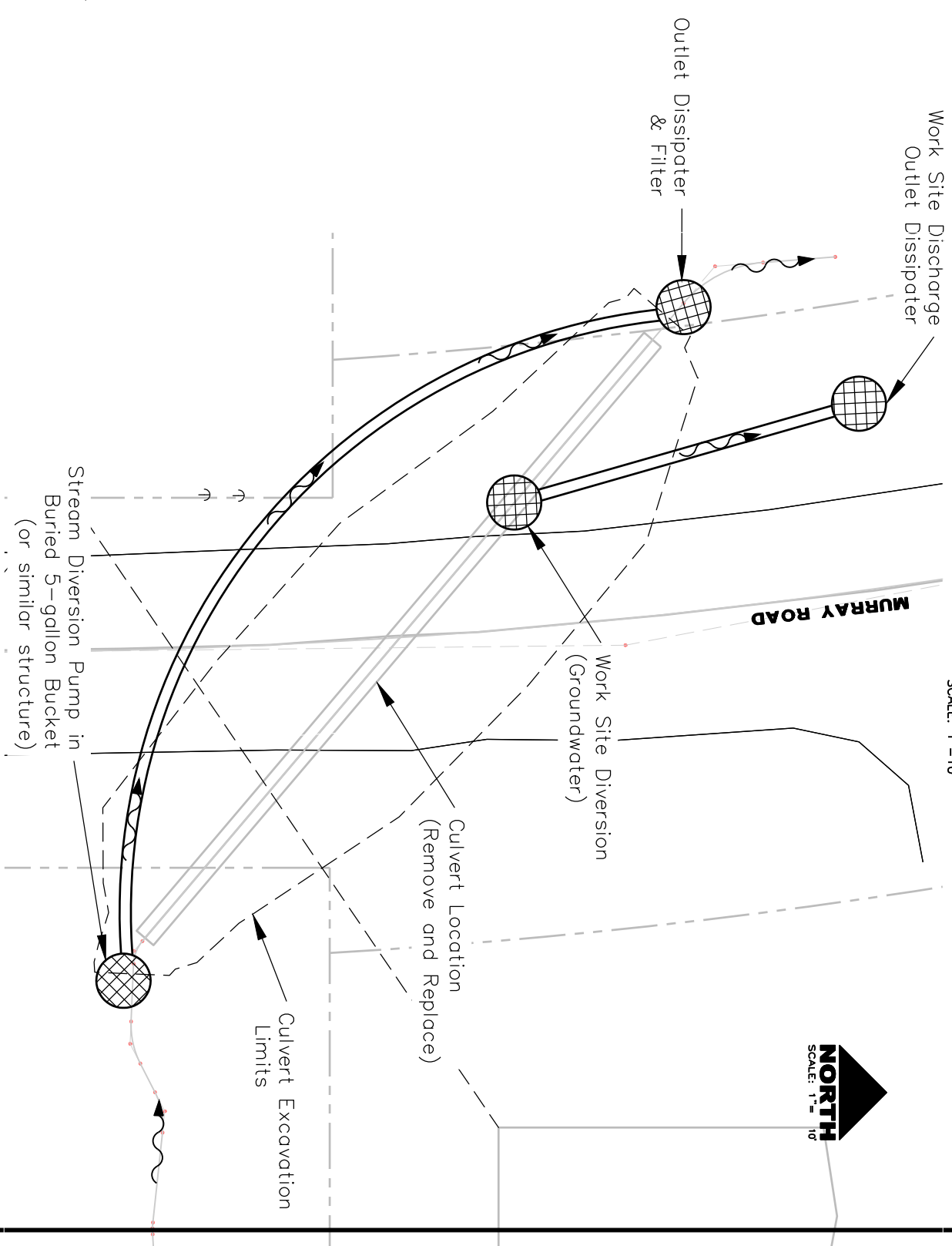

**NOTES:**

1. The pump will run 24/7 as needed to divert stream flow through the site using a gas generator or similar device.
2. Place generator in a containment structure and have secondary containment structure for fueling.
3. Place stream inlet pump in a 5-gallon bucket (or similar structure) with holes to capture stream flow. This will divert surface and subsurface flow. A sand-bog coffer dam will be built around stream inlet pump to insure all water is adequately pumped from active work site.
4. Discharge the stream diversion outlet downstream of excavation limits into a dissipation/filter system that minimizes erosion or scour.
5. The work site diversion must discharge accumulated groundwater over the heavily vegetated embankment.

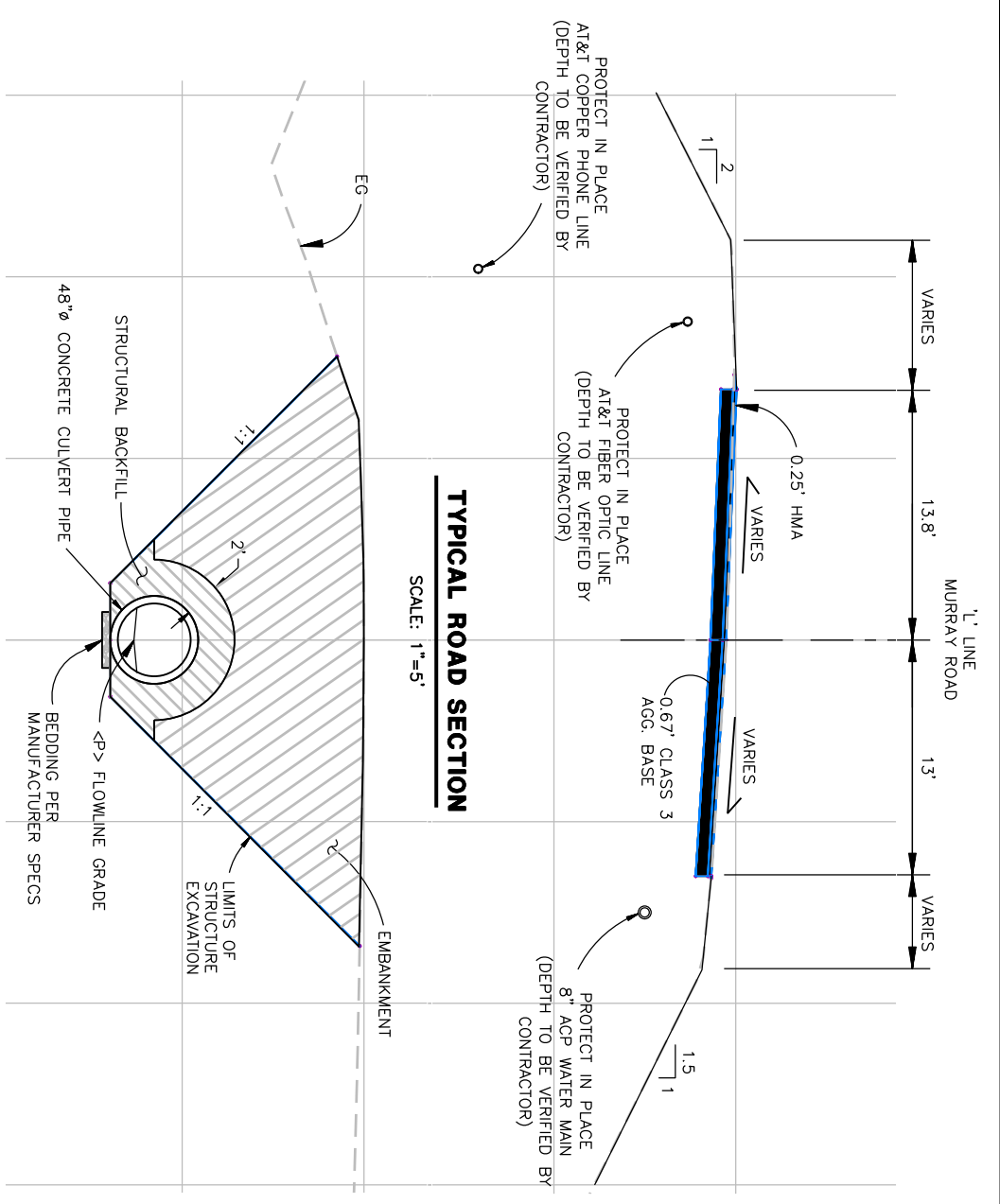

**TYPICAL CLASS III CULVERT SECTION**

SCALE: 1"=5'

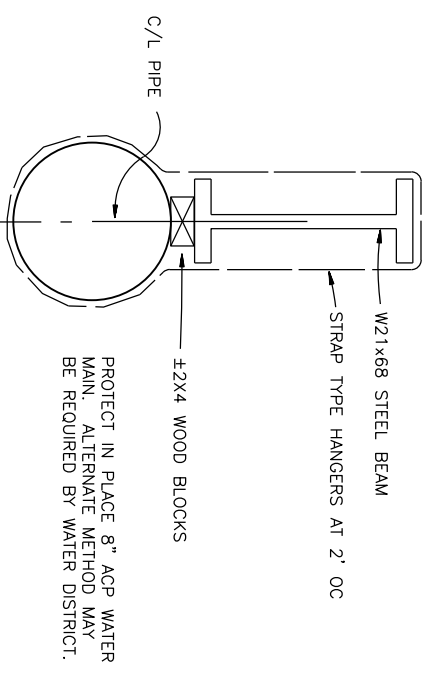

**WATER MAIN SUPPORT DETAIL**

NOT TO SCALE

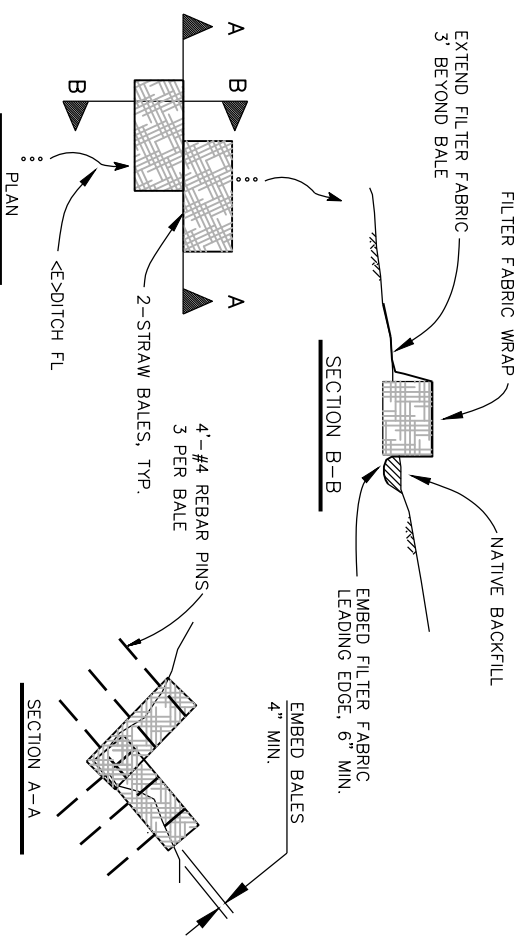

**SILT DAM DETAIL**

NOT TO SCALE

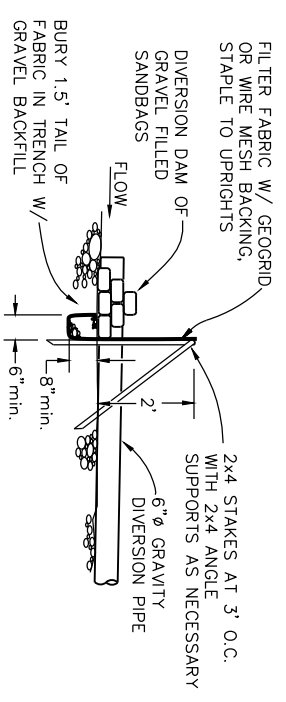

**DETAIL**

NOT TO SCALE

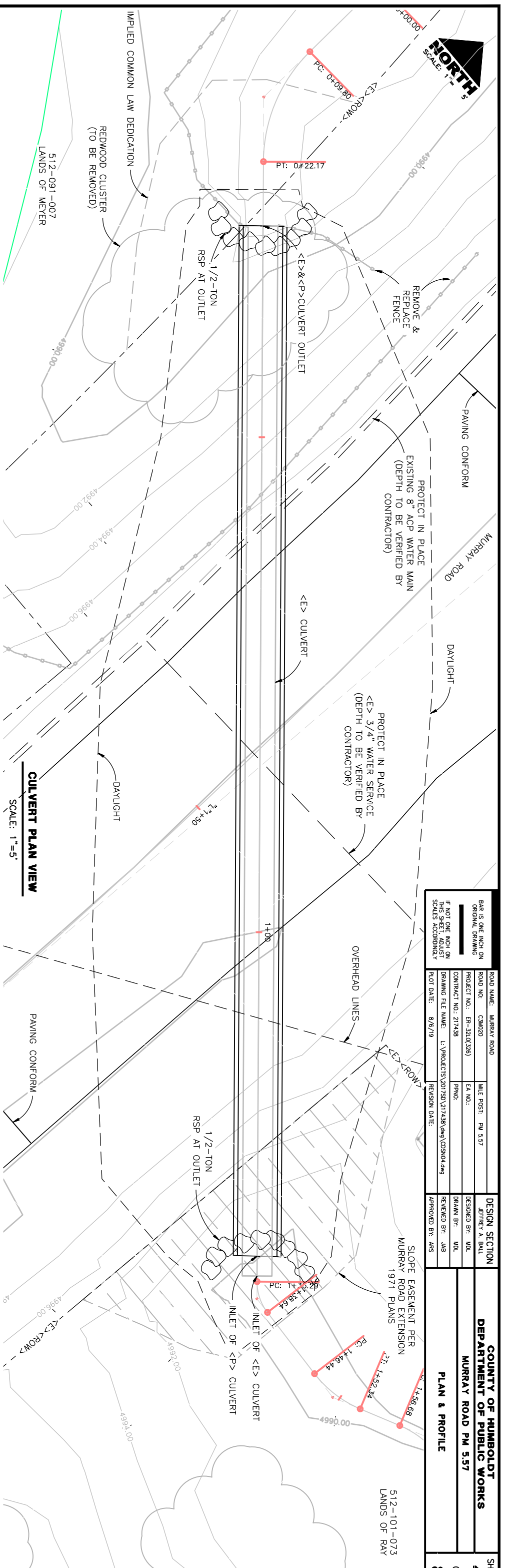

ROAD NAME: MURRAY ROAD		MILE POST: PM 5.57	
ROAD NO.: C3M020		EA NO.:	
PROJECT NO.: EP-230(029)		DESIGNED BY: MBL	
CONTRACT NO.: 217438		DRAWN BY: MBL	
DRAWING FILE NAME: L:\PROJECTS\201750\217438\dwg\CONSO4.dwg		REVIEWED BY: JAB	
PLOT DATE: 8/6/19		APPROVED BY: ABS	

DESIGN SECTION		COUNTY OF HUMBOLDT	
JEFFREY A. BALL		DEPARTMENT OF PUBLIC WORKS	
MURRAY ROAD PM 5.57		SHEET 4	
PLAN & PROFILE		OF 8	

**CULVERT PROFILE**  
 HORIZ: 1"=5'  
 VERT: 1"=5'

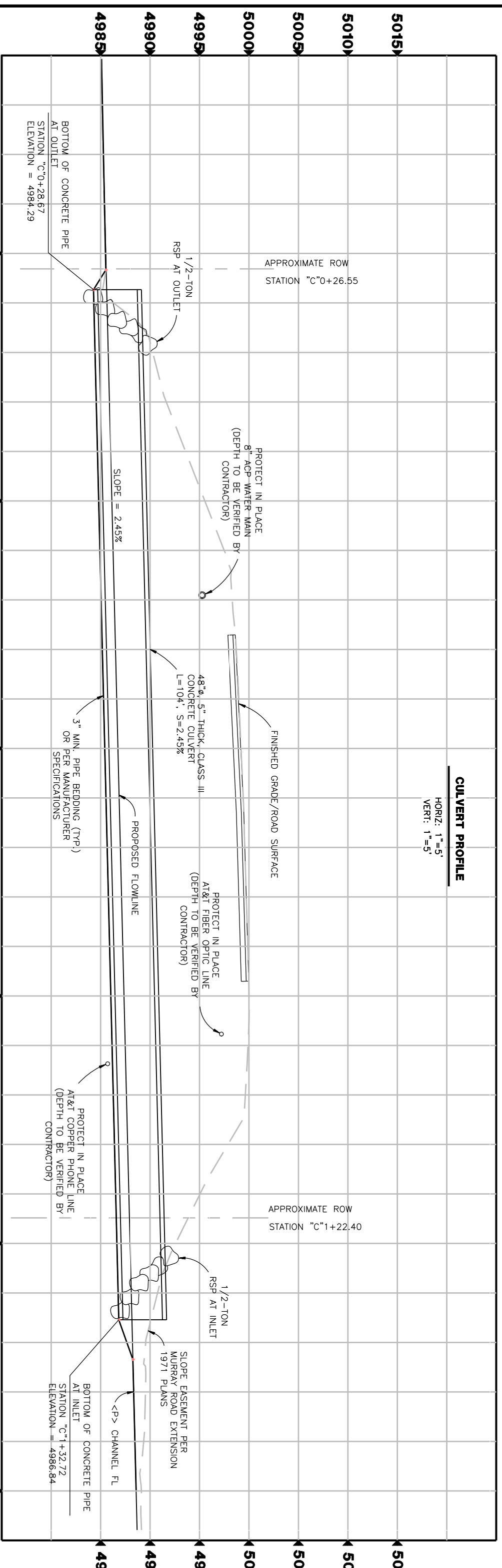

Stationing labels: 4985, 4990, 4995, 5000, 5005, 5010, 5015, 4985, 4990, 4995, 5000, 5005, 5010, 5015

BAR IS ONE INCH ON ORIGINAL DRAWING IF NOT ONE INCH ON THIS SHEET, ADJUST SCALES ACCORDINGLY		ROAD NAME: MURRAY ROAD ROAD NO.: CM020 PROJECT NO.: ER-32.0(39) CONTRACT NO.: 217438 DRAWING FILE NAME: L:\PROJECTS\201750\217438\DWG\DS0505.dwg PLOT DATE: 8/6/19		MILE POST: PM 5.57 EA NO.: PNO.: REVISION DATE:		<b>DESIGN SECTION</b> EFFREY A. BALL DESIGNED BY: MDL DRAWN BY: MDL REVIEWED BY: JAB APPROVED BY: AAS		<b>COUNTY OF HUMBOLDT</b> <b>DEPARTMENT OF PUBLIC WORKS</b> <b>MURRAY ROAD PM 5.57</b> <b>CROSS SECTIONS - 'C'-LINE</b>		SHEET <b>5</b> OF <b>8</b>
---	--	---	--	--	--	--	--	--	--	-------------------------------------

**SCALE**  
1"=10'

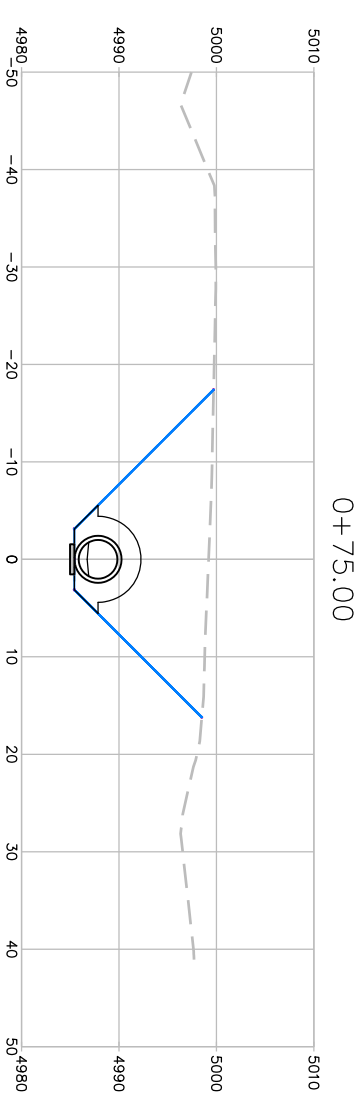
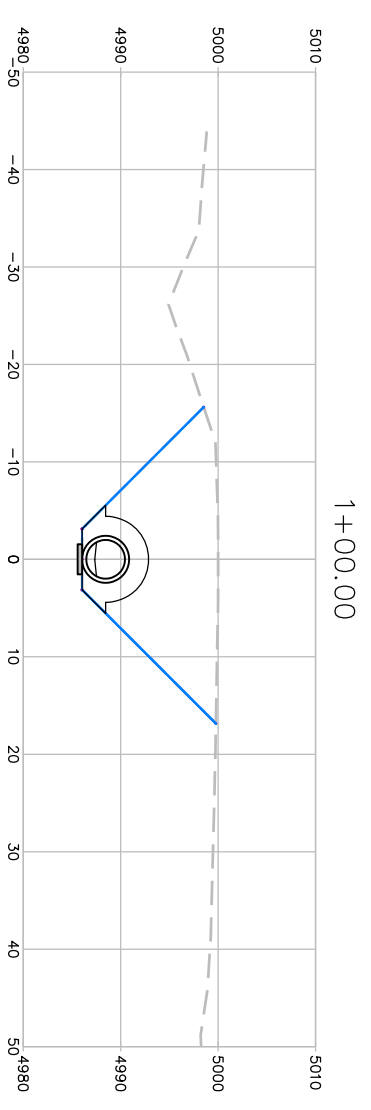
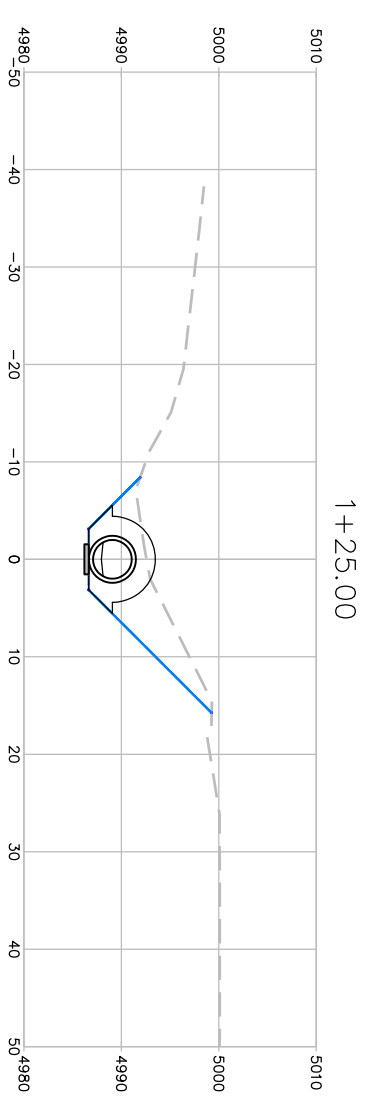
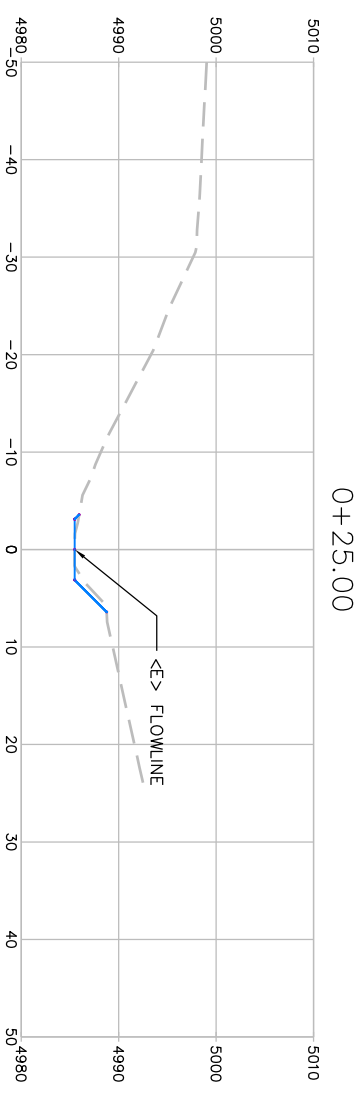
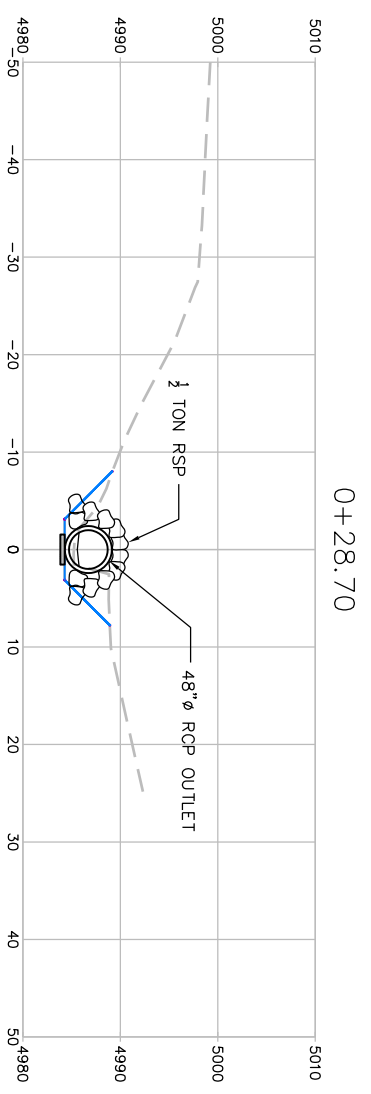
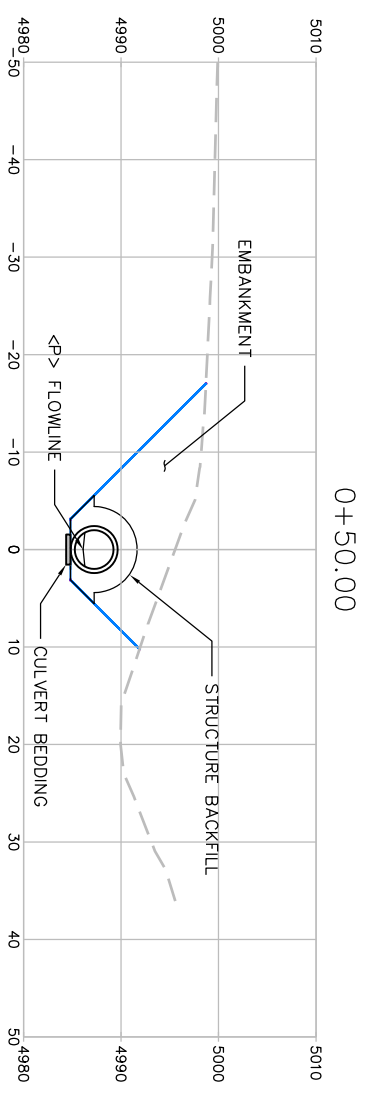



BAR IS ONE INCH ON ORIGINAL DRAWING IF NOT ONE INCH ON THIS SHEET, ADJUST SCALES ACCORDINGLY		ROAD NAME: MURRAY ROAD ROAD NO.: C&M020 PROJECT NO.: EP-230(0290) CONTRACT NO.: 217438 DRAWING FILE NAME: L:\PROJECTS\201750\217438\dwg\CSM07.dwg PLOT DATE: 8/6/19		MILE POST: PM 5.57 EA NO.: PRNO: REVISION DATE:		DESIGN SECTION DESIGNED BY: MJL DRAWN BY: MJL REVIEWED BY: JAB APPROVED BY: ABS		<b>COUNTY OF HUMBOLDT</b> <b>DEPARTMENT OF PUBLIC WORKS</b> <b>MURRAY ROAD PM 5.57</b> <b>CROSS SECTIONS - 1'-LINE</b>		SHEET <b>7</b> OF <b>8</b>
---	--	--	--	--	--	---	--	---	--	-------------------------------------

**SCALE**  
1"=10'

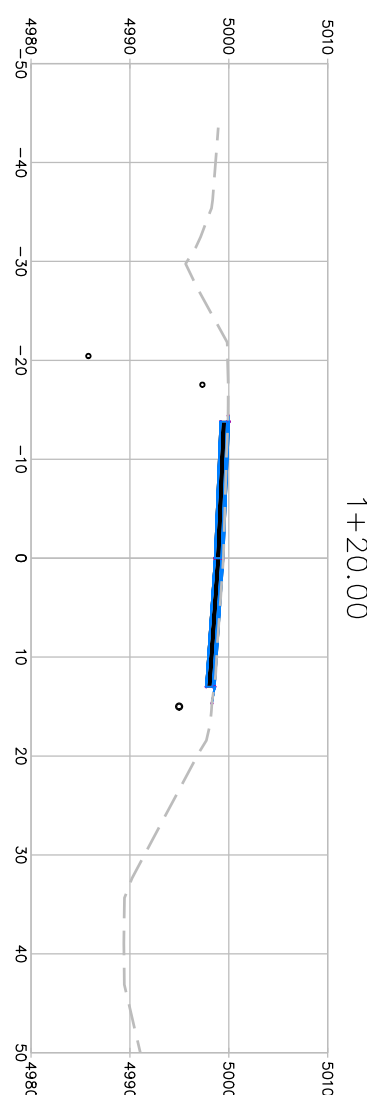
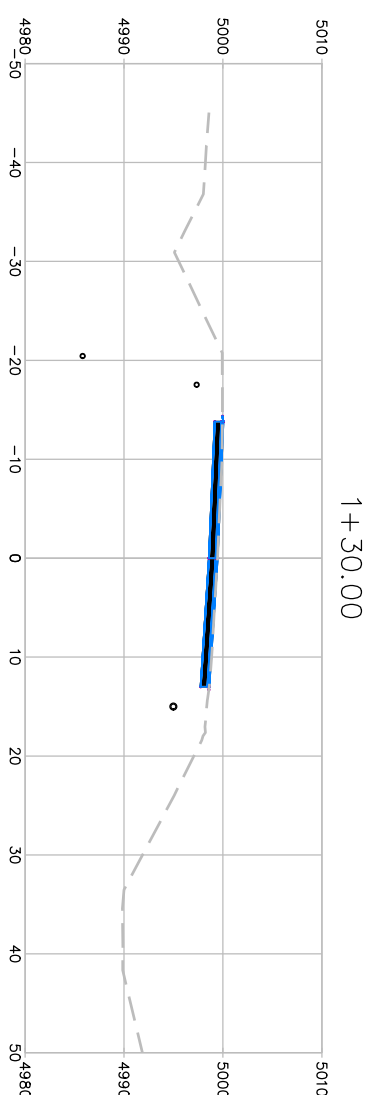
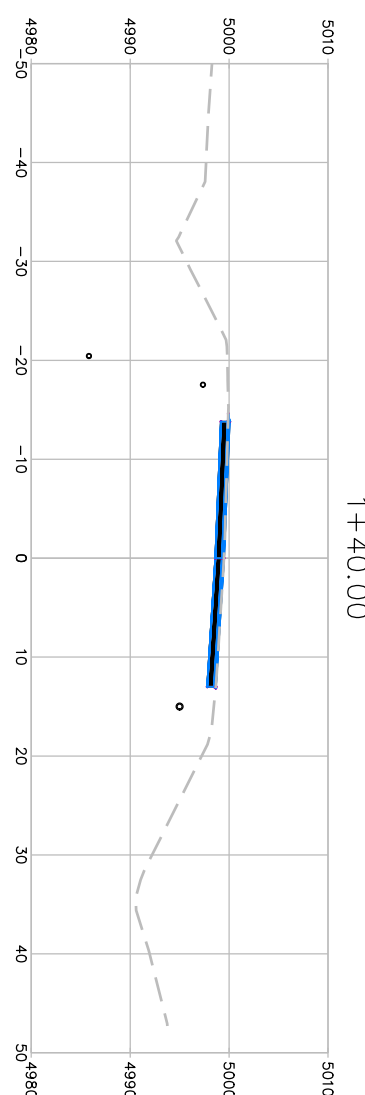
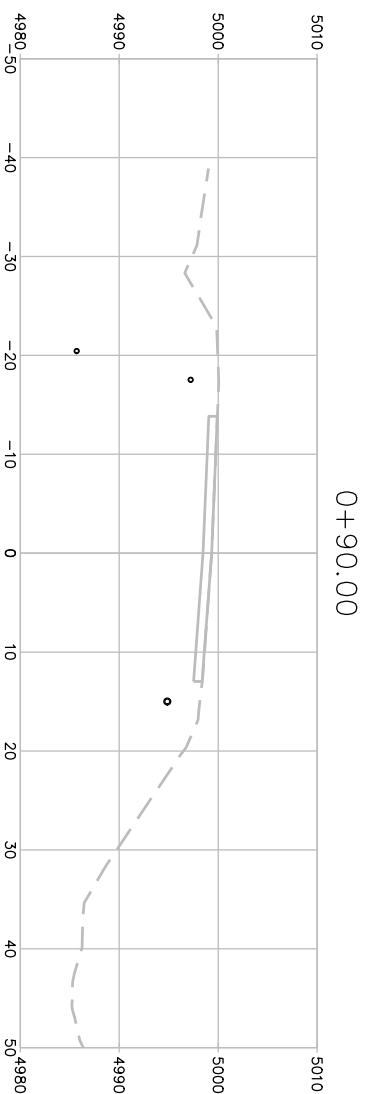
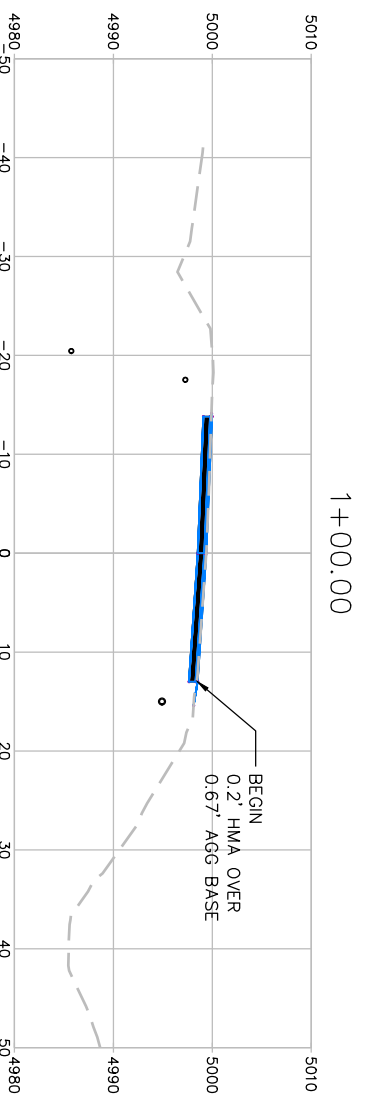
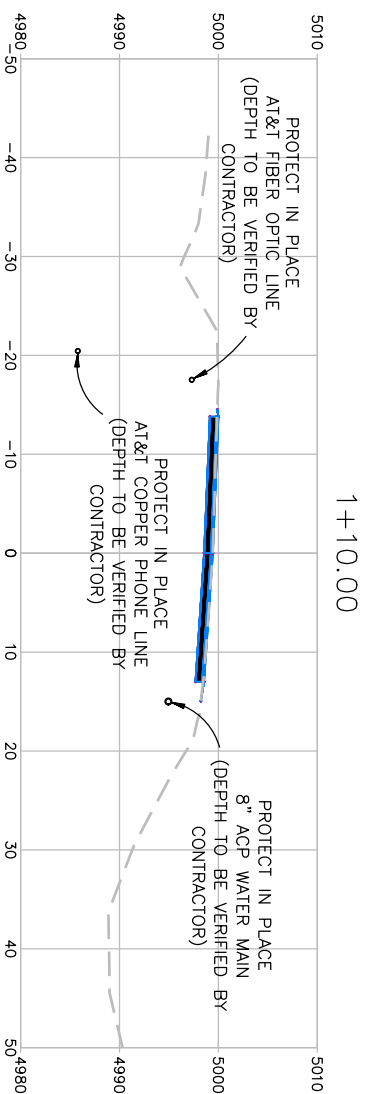

BAR IS ONE INCH ON ORIGINAL DRAWING IF NOT ONE INCH ON THIS SHEET, ADJUST SCALES ACCORDINGLY		ROAD NAME: MURRAY ROAD ROAD NO.: CAW020 PROJECT NO.: EP-230(0290) CONTRACT NO.: 217438 DRAWING FILE NAME: L:\PROJECTS\201750\217438\dwg\CD5808.dwg PLOT DATE: 8/6/19	MILE POST: PM 5.57 EA NO.: PRNO: REVISION DATE:	DESIGN SECTION DESIGNED BY: MJL DRAWN BY: MJL REVIEWED BY: JAB APPROVED BY: ARS	<b>COUNTY OF HUMBOLDT</b> <b>DEPARTMENT OF PUBLIC WORKS</b> <b>MURRAY ROAD PM 5.57</b> <b>CROSS SECTIONS - 1'-LINE</b>	SHEET <b>8</b> OF <b>8</b>
---	--	---	--	---	---	-------------------------------------

**SCALE**  
1"=10'

