

ROAD NAME: BriceLand Thorne Road	DESIGN SECTION: N. L. BURNETT	COUNTY OF HUMBOLDT DEPARTMENT OF PUBLIC WORKS DINNER CREEK CULVERT REPLACEMENT COVER SHEET, LOCATION MAP, AND VICINITY MAP	SHEET 1 OF 11
ROAD NO. F5A010	MILE POST: 3.27 and 3.74		
AGREEMENT NO. P1610515	DESIGNED BY: JCT/AMK		
CONTRACT NO. 211304	DRAWN BY: JCT/AMK		
DRAWING FILE NAME: L:\PROJECTS\211304 DINNER\21130401.DWG	REVIEWED BY: JAO		
PLOT DATE: 2/28/2018	APPROVED BY: AMS		

FUNDING SOURCE
 THIS PROJECT IS FUNDED BY THE CALIFORNIA DEPARTMENT OF FISH AND WILDLIFE & PACIFIC MARINE FISHERIES COMMISSION



COUNTY OF HUMBOLDT DEPARTMENT OF PUBLIC WORKS PROJECT PLANS FOR CONSTRUCTION OF DINNER CREEK CULVERT REPLACEMENT BRICELAND THORNE ROAD F5A010 PM 3.27 & 3.74 AGREEMENT NO. P1610515 CONTRACT NO. 211304



INDEX OF SHEETS

- 1 COVER SHEET, LOCATION MAP AND VICINITY MAP
- 2 CONSTRUCTION AREA SIGNS, QUANTITIES, AND SURVEY CONTROL
- 3 TYPICAL SECTIONS AND DETAILS
- 4 "D" LINE - DETOUR & EROSION CONTROL AND WATER MANAGEMENT PLAN
- 5 "C" LINE - PLAN & PROFILE DINNER CREEK SITE 1
- 6 "L" LINE - PLAN & PROFILE BRICELAND THORNE ROAD SITE 1
- 7 SITE 1 CULVERT & CREEK EXCAVATION CROSS SECTIONS
- 8 SITE 1 ROADWAY CROSS SECTIONS
- 9 "C" LINE - PLAN & PROFILE DINNER CREEK SITE 2
- 10 SITE 2 CULVERT & STREAM BANK RESTORATION CROSS SECTIONS
- 11 SITE 2 CULVERT & STREAM BANK RESTORATION CROSS SECTIONS

APPLICABLE STANDARD PLANS
 REFERENCE TO CALTRANS STANDARD PLANS DATED 2015
 (SEE APPLICABLE STANDARD PLAN LIST IN SPECIAL PROVISIONS)

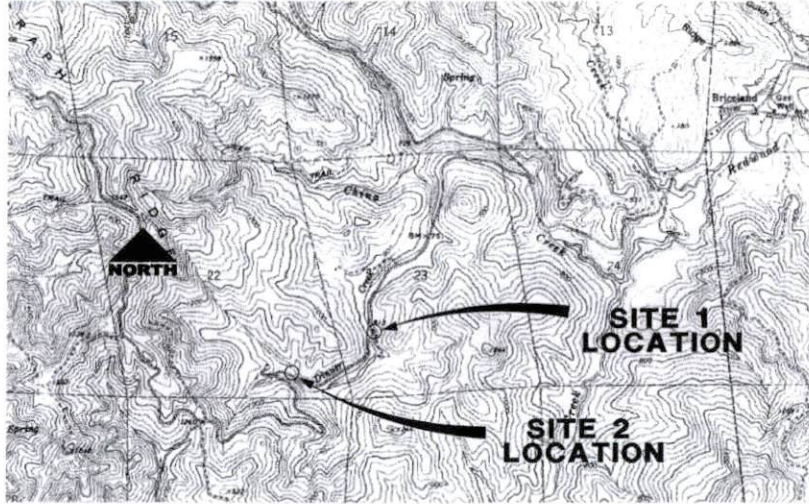

VICINITY MAP
 NOT TO SCALE

RECOMMENDED

Jeffrey A. Ball
 JEFFREY A. BALL
 RCE 70631, EXP. 06/30/2019
 2-28-2018 DATE



APPROVED

Tony R. Seghetti
 TONY R. SEGHETTI
 RCE 63714, EXP. 9/30/2018
 2/28/18 DATE



ORIGINAL LOW BID PRICE	CONSTRUCTED BY	RESIDENT ENGINEER
	PROJECT COMPLETED / /	CONSTRUCTION COST \$

QUANTITIES

ITEM NO.	ITEM CODE	ITEM DESCRIPTION	UNIT	BID QUANTITY
1	120089	Construct Detour (Railroad Flatcar Bridge)	LS	1
2	120090	Construction Area Signs	EA	12
3	120100	Traffic Control System	LS	1
4	128601	Temporary Signal System	LS	1
5	129000	Temporary Railing (Type K)	EA	4
6	130100	Job Site Management	LS	1
7	130200	Prepare Water Pollution Control Program	LS	1
8	130640	Temporary Fiber Roll (Type 1)	LF	600
9	130680	Temporary Silt Fence	LF	400
10	130900	Temporary Concrete Washout	EA	1
11	146004	Fish Protection (Water Bypass System)	EA	2
12	146100	Fish Habitat Structure	LS	1
13	150808	Remove Culvert (EA)	EA	2
14	150808	S Remove Concrete Weir	LS	1
15	160102	Clearing and Grubbing	LS	1
16	190151	F Channel Excavation (Dinner Creek)	CY	260
17	192025	F Structure Excavation (Culvert)	CY	2,690
18	193004	F Structure Backfill (Culvert)	CY	860
19	198020	Imported River Gravel	CY	260
20	198050	Embankment	CY	1,030
21	210430	S Hydroseed	LS	1
22	260301	Class 2 Aggregate Base	CY	130
23	390102	Hot Mix Asphalt (Type A, 1/2" mix)	Ton	100
24	510103	S-F Class A Concrete (Arch Culvert)	CY	68
25	520101	S-F Bar Reinforcing Steel	Lbs	6,270
26	671101	120" Structural Steel Plate Pipe (0.109" Thick)	LF	30
27	674960	S 18"x9" Structural Steel Arch Culvert (0.168in-8g.)	LF	100
28	720111	Clean River Run Rock (6" to 8" Cobble)	CY	20
29	720122	Rock Slope Protection (1/2 to 1-ton, Method A)	TON	150
30	721008	Rock Slope Protection (Light, Method B)	TON	50
31	999990	Mobilization	LS	1

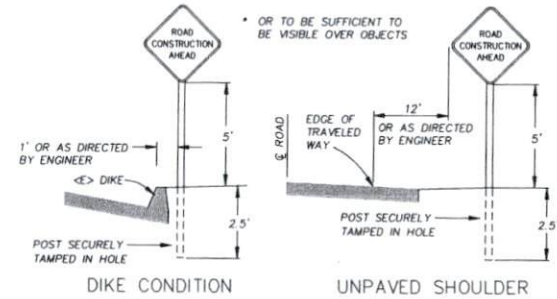

RURAL CONSTRUCTION AREA SIGN

- NOT TO SCALE -

NOTES

- 1) SIGNS SHALL BE PLACED AS SHOWN ON PLAN OR AS DIRECTED BY THE RESIDENT ENGINEER.
- 2) FINAL PLACEMENT OF SIGNS SHALL BE APPROVED BY RESIDENT ENGINEER.
- 3) ADDITIONAL PORTABLE SIGNS SHALL BE USED AS REQUIRED FOR OTHER ROADSIDE WORK.
- 4) SEE STANDARD PLAN 113 FOR TRAFFIC CONTROL SYSTEM.
- 5) IN ADDITION TO CONSTRUCTION AREA SIGNS AND WHEN DIRECTED BY THE RESIDENT ENGINEER, THE CONTRACTOR SHALL UTILIZE FLAGMEN AS NECESSARY TO DIRECT TRAFFIC.
- 6) DISTANCE TO C18/C23 AND C13/C14 MAY BE EXTENDED TO ENCOMPASS SITES WITHIN ONE MILE OF EACH OTHER.



ROAD NAME: Briceland Thorne Road
 ROAD NO: FS4210
 AGREEMENT NO: P1810515
 CONTRACT NO: 213304
 DRAWING FILE NAME: L:\PROJECTS\213304 DINNER\DWG\239602.DWG
 PLOT DATE: 2/28/2018

DESIGN SECTION & L. BURNETT
 DESIGNED BY: JCT/ADR
 DRAWN BY: JCT/ADR
 REVIEWED BY: JAB
 APPROVED BY: ARS

COUNTY OF HUMBOLDT
 DEPARTMENT OF PUBLIC WORKS
 DINNER CREEK CULVERT REPLACEMENT
 CONSTRUCTION AREA SIGNS, QUANTITIES,
 SURVEY CONTROL AND DETAILS

SHEET 2 OF 11

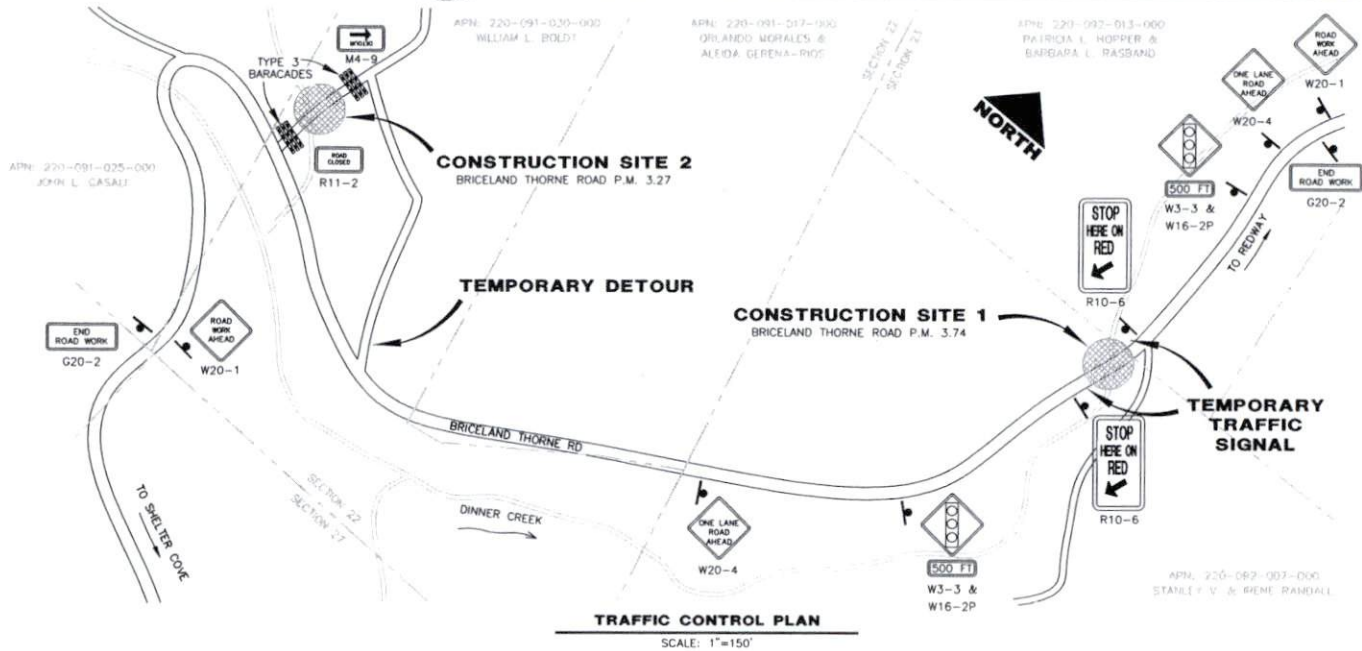

SURVEY CONTROL COORDINATES

PNT. #	NORTHING	EASTING	ELEV.	DESCRIPTION
1	10827.4390	9815.8810	855.78	fd1/2gipnoid=old600
2	10599.4450	10152.9480	857.87	fd60dshnr=old502
4	10796.4740	9866.1501	855.75	set180dspikepinkflag
5	10909.6556	9759.2614	860.87	set180dspikepinkflag
7	10655.0145	9845.4266	846.31	set180dspikepinkflag

'L-LINE' SURVEY COORDINATES

PNT. #	NORTHING	EASTING	ELEV.	DESCRIPTION
5000	10868.2381	9670.7491	0.00	L0+00
5016	10684.5082	10025.1280	0.00	L4+00
5018	10843.1473	9735.7388	0.00	PC
5019	10247.8151	9505.8968	0.00	CC
5020	10825.1022	9782.4789	0.00	CPI
5021	10799.9839	9825.8302	0.00	PT

CONSTRUCTION AREA SIGN SUMMARY

SIGN TYPE	QTY	DESCRIPTION	SIZE	REMARKS	POST SIZE	NUMBER
W20-1	2	ROAD WORK AHEAD	48" x 48"	VISIBLE AT ALL TIMES	4" x 4"	1
W20-4	2	ONE LANE ROAD AHEAD	48" x 48"	VISIBLE AT ALL TIMES	4" x 4"	1
W3-3 & W16-2P	2	SIGNAL AHEAD 500 FT	48" x 48" 24" x 18"	VISIBLE AT ALL TIMES	4" x 4"	1
R10-6	2	STOP HERE ON RED	48" x 48"	VISIBLE AT ALL TIMES	4" x 4"	1
G20-2	2	END ROAD WORK	36" x 18"	VISIBLE AT ALL TIMES	4" x 4"	1
M4-9	1	DETOUR	30" x 24"	VISIBLE AT ALL TIMES	4" x 4"	1
R11-2	1	ROAD CLOSED	48" x 30"	VISIBLE AT ALL TIMES	4" x 4"	1



ROAD NAME: Briceland Thorne Road
 ROAD NO.: FSAD10
 MILE POST: 3.27 and 3.74
 AGREEMENT NO.: P1810515
 CONTRACT NO.: 211304
 DRAWING FILE NAME: L:\PROJECTS\211304 DINNER\DWG\220903.DWG
 PLOT DATE: 2/28/2018

DESIGN SECTION
 R. L. BURNETT
 DESIGNED BY: JST/ANL
 DRAWN BY: JST/ANL
 REVIEWED BY: JMB
 APPROVED BY: ARS

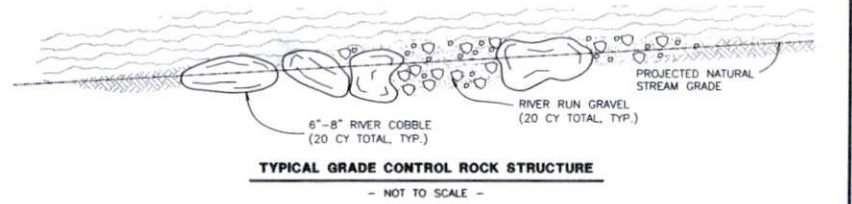
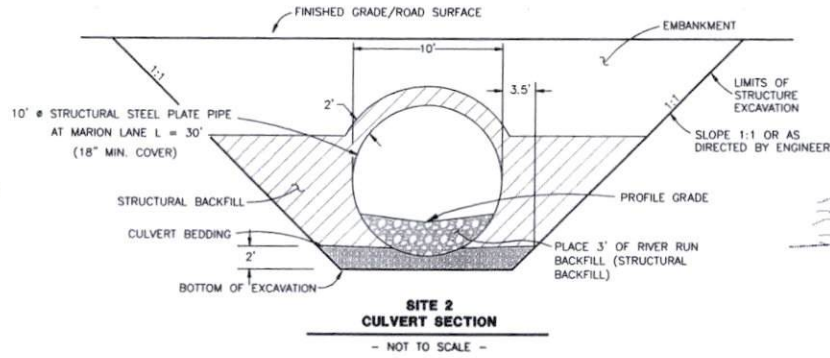
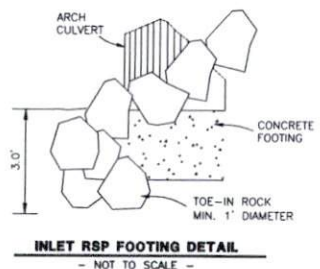
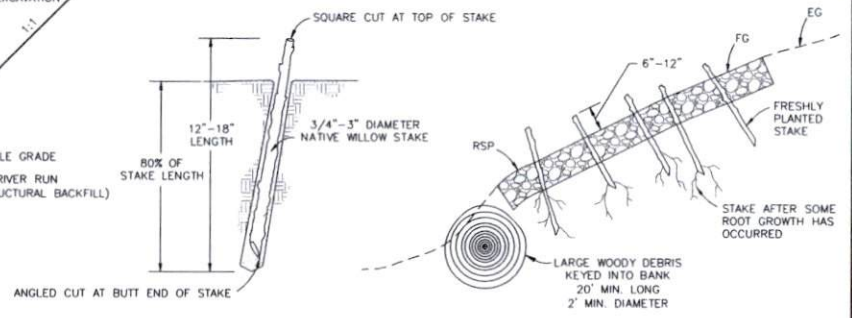
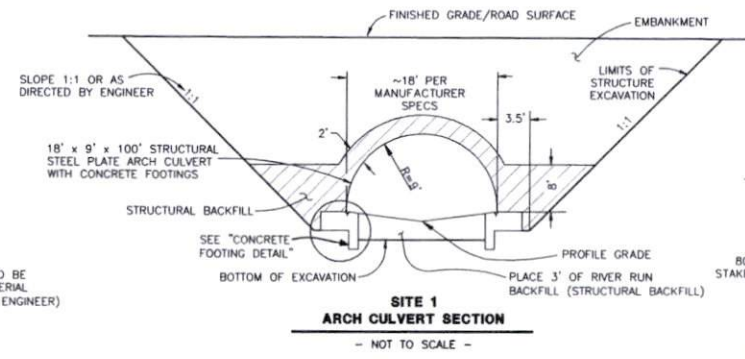
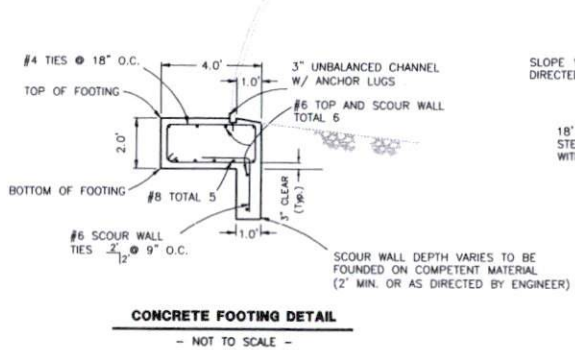
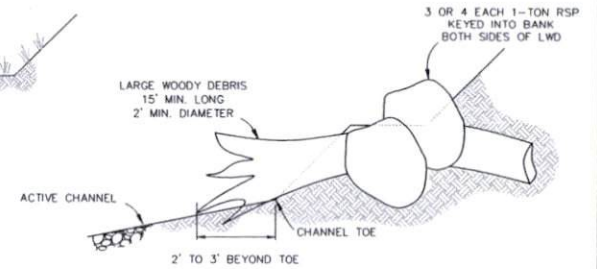
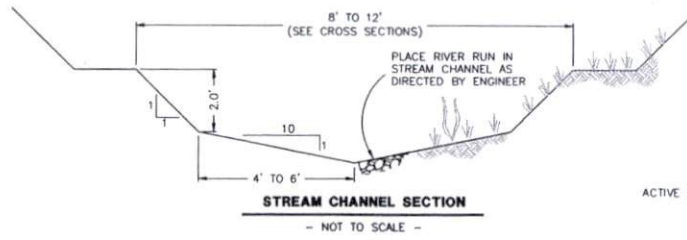
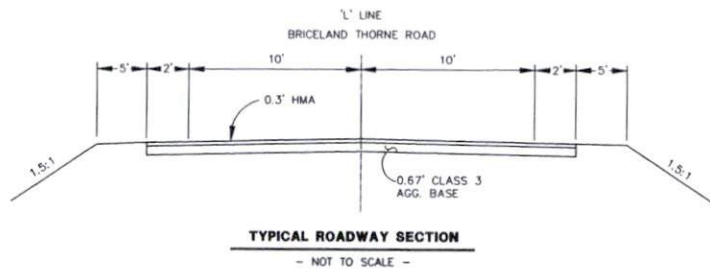



ROAD NAME: Briceland Thorne Road
 ROAD NO: F54010
 AGREEMENT NO: P1810015
 CONTRACT NO: 211304
 DRAWING FILE NAME: L:\PROJECTS\211304 DINNER\UNM\22874.DWG
 PLOT DATE: 2/28/2018

DESIGN SECTION
 R. L. BURNETT
 DESIGNED BY: JGT/ANL
 DRAWN BY: JGT/ANL
 REVIEWED BY: JAB
 APPROVED BY: ARS

COUNTY OF HUMBOLDT
 DEPARTMENT OF PUBLIC WORKS
 DINNER CREEK CULVERT REPLACEMENT
 'D' LINE - DETOUR, EROSION CONTROL
 AND WATER MANAGEMENT PLAN

SHEET
4
 OF
11

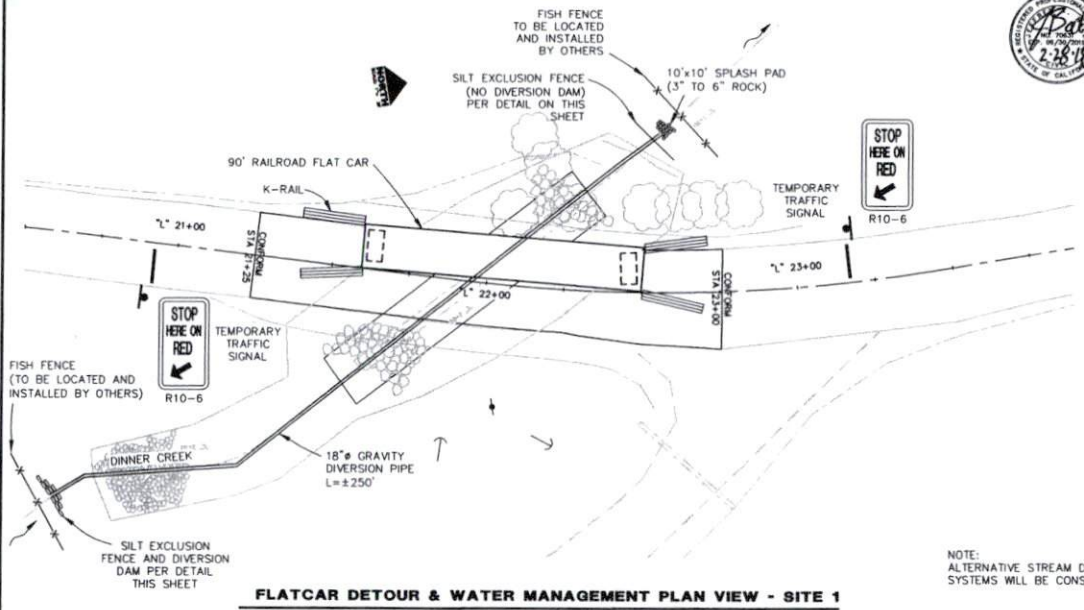

FLATCAR DETOUR & WATER MANAGEMENT PLAN VIEW - SITE 1
 SCALE: 1"=20'

NOTE:
 ALTERNATIVE STREAM DIVERSION
 SYSTEMS WILL BE CONSIDERED

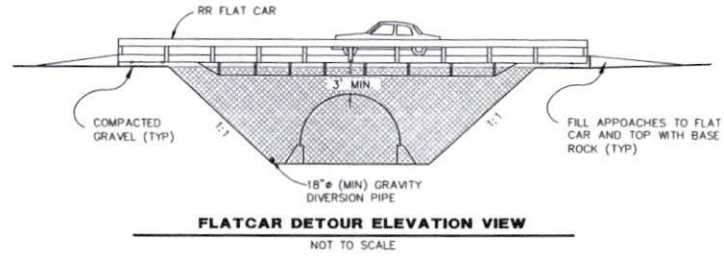

FLATCAR DETOUR ELEVATION VIEW
 NOT TO SCALE

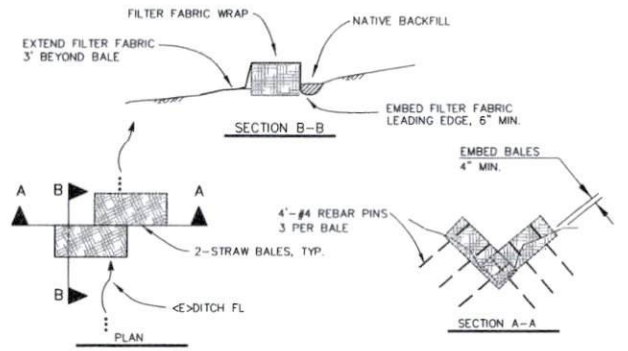

SILT DAM DETAIL
 NOT TO SCALE

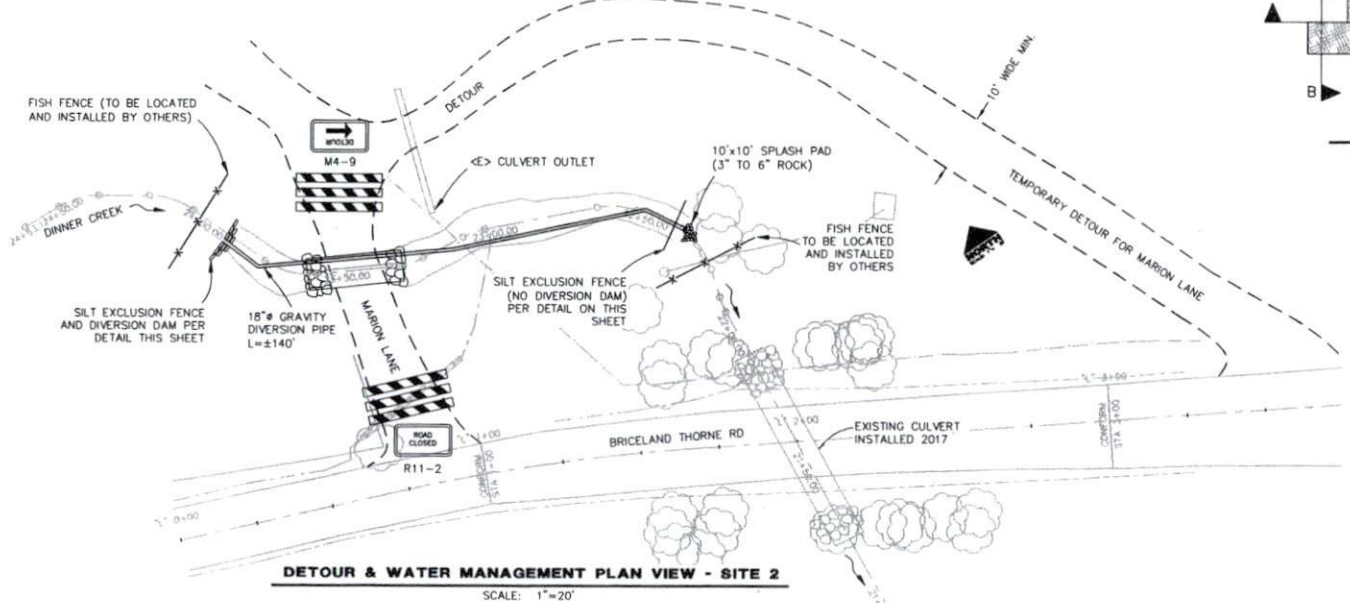

DETOUR & WATER MANAGEMENT PLAN VIEW - SITE 2
 SCALE: 1"=20'

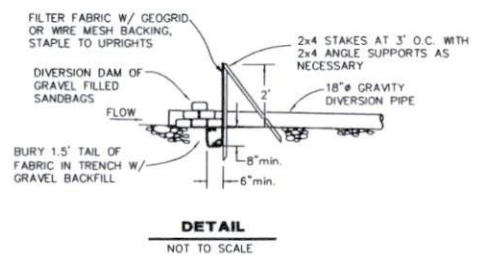

DETAIL
 NOT TO SCALE

APH: 220-082-013-000
 PATRICIA L. HOPPER &
 BARBARA L. HASBAND



ROAD NAME: Brickett Thorne Road
 ROAD NO.: FSAD00 WILE POST: 3.27 and 3.74
 AGREEMENT NO.: P1810015
 CONTRACT NO.: 211304
 DRAWING FILE NAME: L:\PROJECTS\211304 DINNER\DWG\220082.DWG
 PLOT DATE: 2/28/2018

DESIGN SECTION
 R. L. BARNETT
 DESIGNED BY: JST/ADL
 DRAWN BY: JST/ADL
 REVIEWED BY: JAB
 APPROVED BY: ARS

COUNTY OF HUMBOLDT
 DEPARTMENT OF PUBLIC WORKS
 DINNER CREEK CULVERT REPLACEMENT
 DINNER CREEK SITE 1
 "C" LINE PLAN & PROFILE

SHEET
 5
 OF
 11

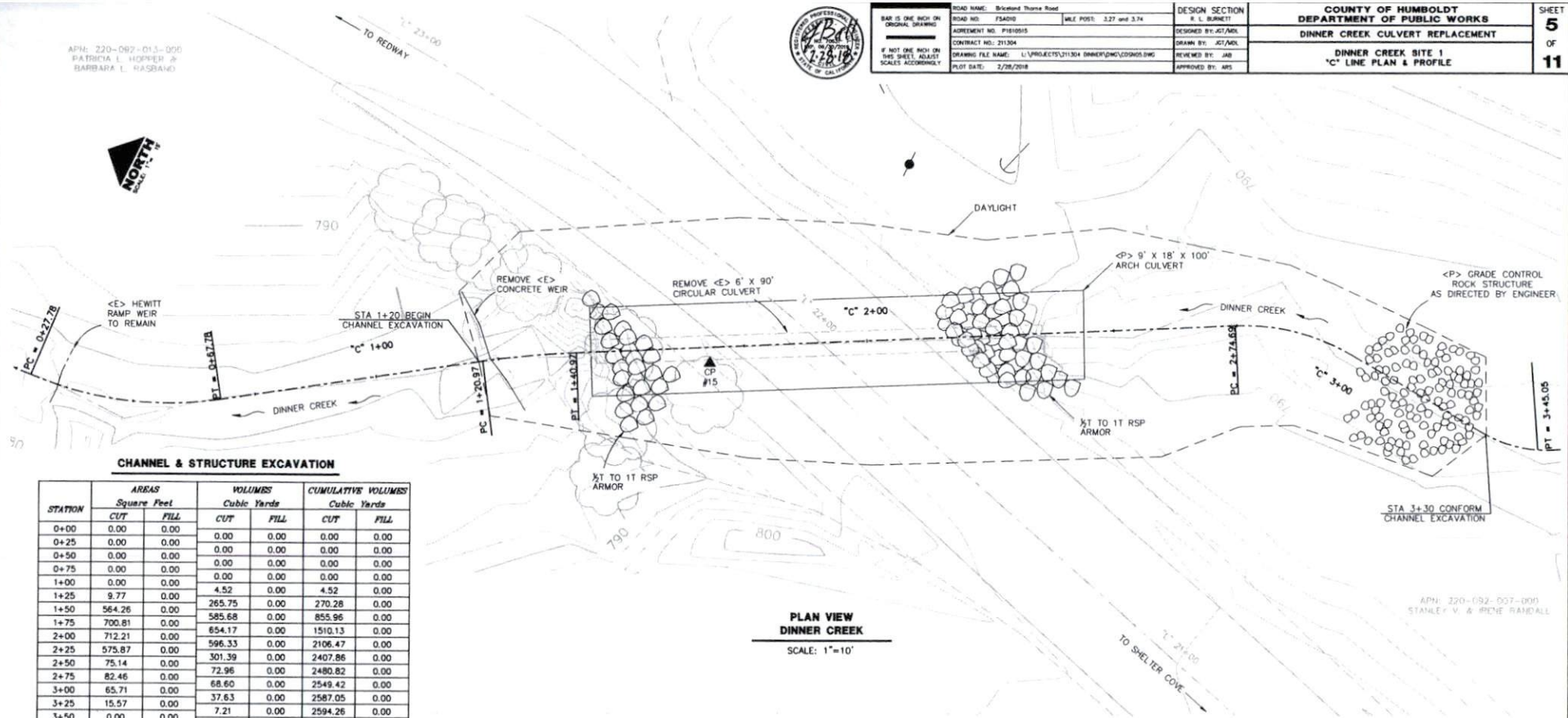

CHANNEL & STRUCTURE EXCAVATION

STATION	AREAS Square Feet		VOLUMES Cubic Yards		CUMULATIVE VOLUMES Cubic Yards	
	CUT	FILL	CUT	FILL	CUT	FILL
0+00	0.00	0.00	0.00	0.00	0.00	0.00
0+25	0.00	0.00	0.00	0.00	0.00	0.00
0+50	0.00	0.00	0.00	0.00	0.00	0.00
0+75	0.00	0.00	0.00	0.00	0.00	0.00
1+00	0.00	0.00	4.52	0.00	4.52	0.00
1+25	9.77	0.00	265.75	0.00	270.28	0.00
1+50	564.26	0.00	585.68	0.00	855.96	0.00
1+75	700.81	0.00	654.17	0.00	1510.13	0.00
2+00	712.21	0.00	596.33	0.00	2106.47	0.00
2+25	575.87	0.00	301.39	0.00	2407.86	0.00
2+50	75.14	0.00	72.96	0.00	2480.82	0.00
2+75	82.46	0.00	68.60	0.00	2549.42	0.00
3+00	65.71	0.00	37.63	0.00	2587.05	0.00
3+25	15.57	0.00	7.21	0.00	2594.26	0.00
3+50	0.00	0.00	0.00	0.00	2594.26	0.00
3+75	0.00	0.00	0.00	0.00	2594.26	0.00

PLAN VIEW
 DINNER CREEK
 SCALE: 1"=10'

'C' LINE PROFILE
 DINNER CREEK
 HORIZ: 1"=10'
 VERT: 1"=10'

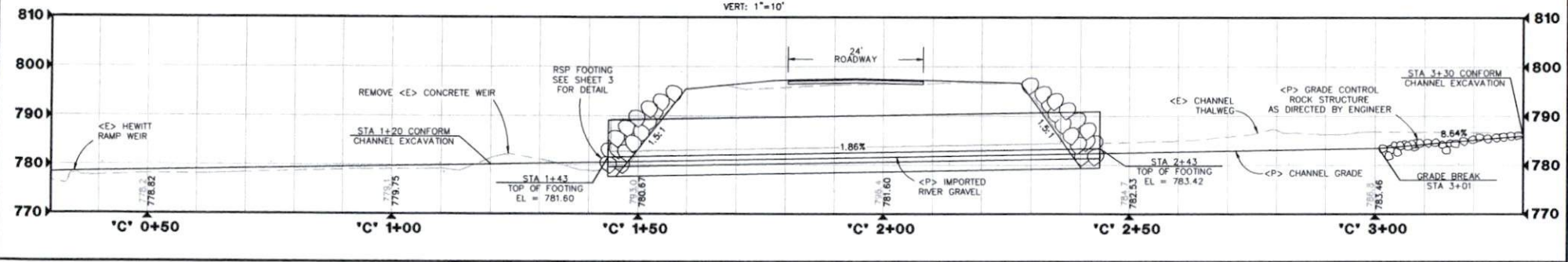

APH: 220-082-007-000
 STANLEY V. & RENE RANDALL

SPN 220-092-013-000
 DRAWN BY: L. HOFFER &
 BARBARA L. RASBAND



ROAD NAME: Briceland Thorne Road
 ROAD NO: FS4010 MILE POST: 3.27 and 3.74
 AGREEMENT NO: P180045
 CONTRACT NO: 211304
 DRAWING FILE NAME: L:\PROJECTS\111304 DINNER\DWG\CONFORM.DWG
 PLOT DATE: 2/28/2018

DESIGN SECTION
 E. L. BURNETT
 DESIGNED BY: JST/MDL
 DRAWN BY: JST/MDL
 REVIEWED BY: JAB
 APPROVED BY: ARS

COUNTY OF HUMBOLDT
 DEPARTMENT OF PUBLIC WORKS
 DINNER CREEK CULVERT REPLACEMENT
 DINNER CREEK SITE 1
 'L' LINE - PLAN & PROFILE

SHEET
6
 OF
11

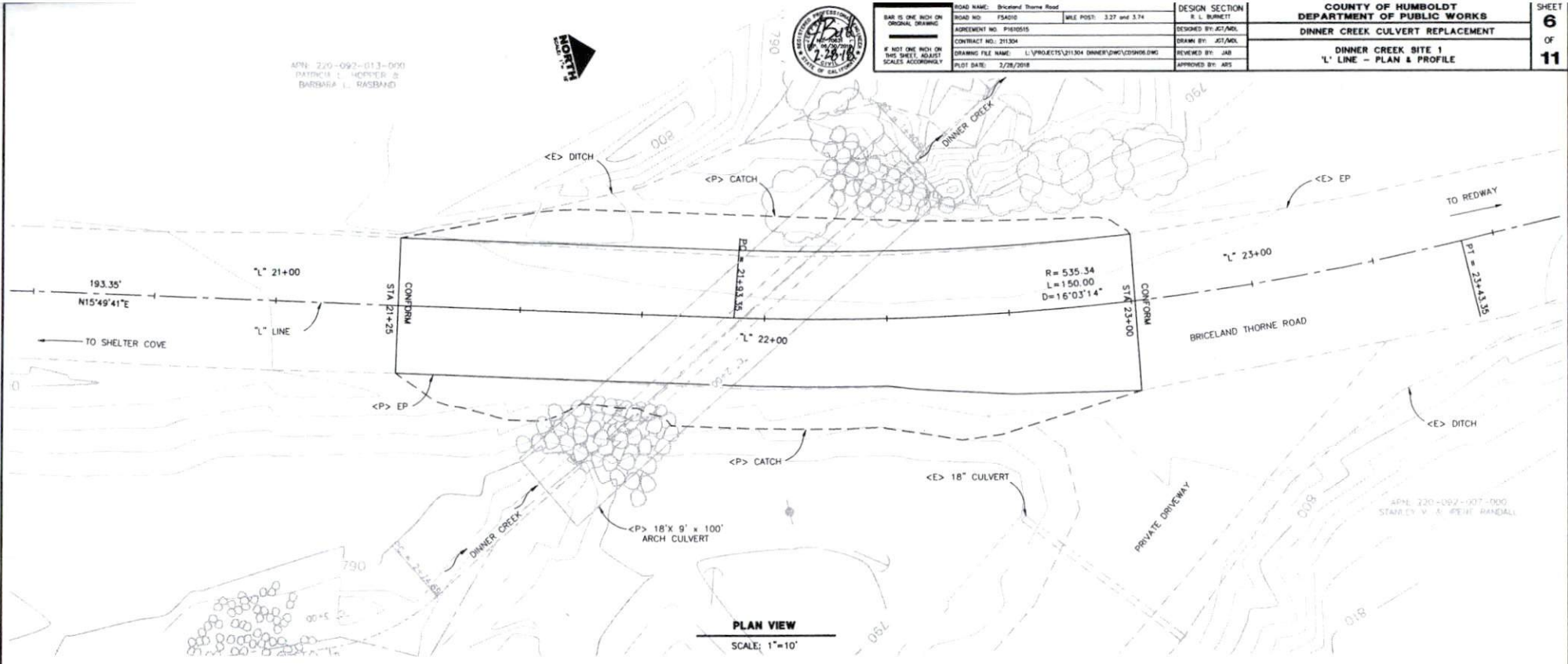

PLAN VIEW
 SCALE: 1"=10'

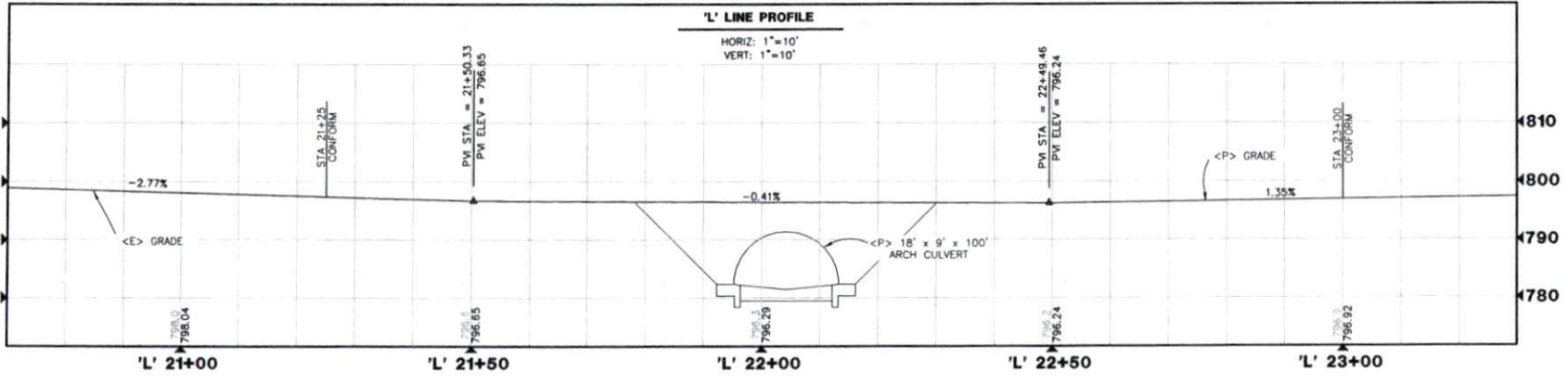

'L' LINE PROFILE
 HORIZ: 1"=10'
 VERT: 1"=10'



ROAD NAME: Gravelly Thorne Road
 ROAD NO.: F54202
 MILE POST: 3.27 and 3.74
 AGREEMENT NO.: P1610515
 CONTRACT NO.: 211304
 DRAWING FILE NAME: L:\PROJECTS\211304 DINNER\DWG\CD09407.DWG
 PLOT DATE: 2/26/2018

DESIGN SECTION
 R. L. BURNETT
 DESIGNED BY: JCT/ADK
 DRAWN BY: JCT/ADK
 REVIEWED BY: JAB
 APPROVED BY: ARE

COUNTY OF HUMBOLDT
 DEPARTMENT OF PUBLIC WORKS
 DINNER CREEK CULVERT REPLACEMENT
 DINNER CREEK SITE 1
 "C" LINE CROSS SECTIONS

SHEET
7
 OF
11

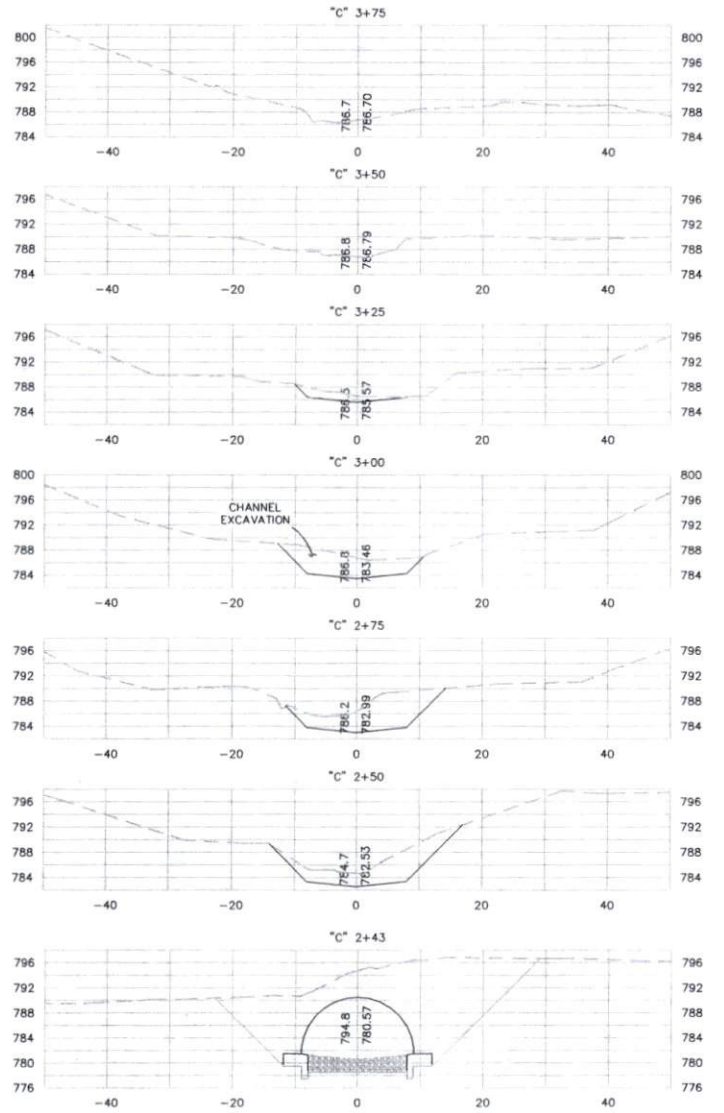
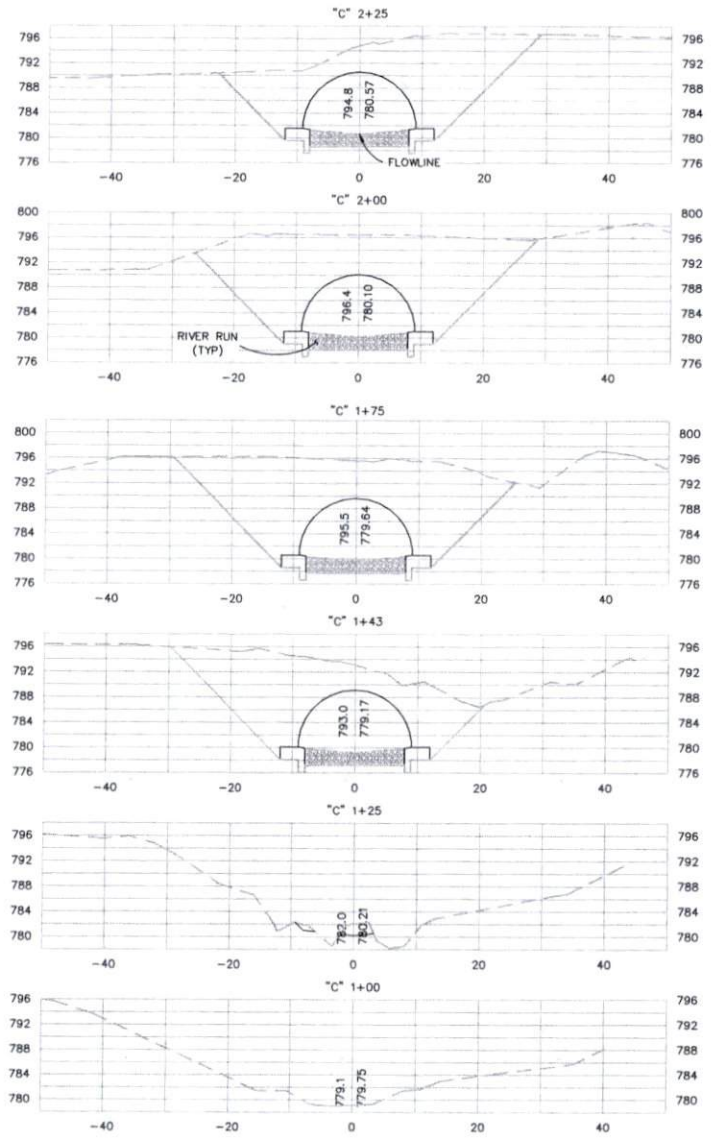

SECTIONS
 SCALE: 1"=10'



ROAD NAME: Bickford Thorne Road	DESIGN SECTION
ROAD NO: FS4010	R. L. BURNETT
WILE POST: 3.27 and 3.74	DESIGNED BY: JCT/ADL
AGREEMENT NO: P1810115	DRAWN BY: JCT/ADL
CONTRACT NO: 211304	REVIEWED BY: JAB
DRAWING FILE NAME: L:\PROJECTS\211304 DINNER\DWG\CROSSSECTIONS	APPROVED BY: ARS
PLOT DATE: 2/28/2018	

COUNTY OF HUMBOLDT
DEPARTMENT OF PUBLIC WORKS
DINNER CREEK CULVERT REPLACEMENT
DINNER CREEK SITE 1
"L" LINE CROSS SECTIONS

SHEET
8
OF
11

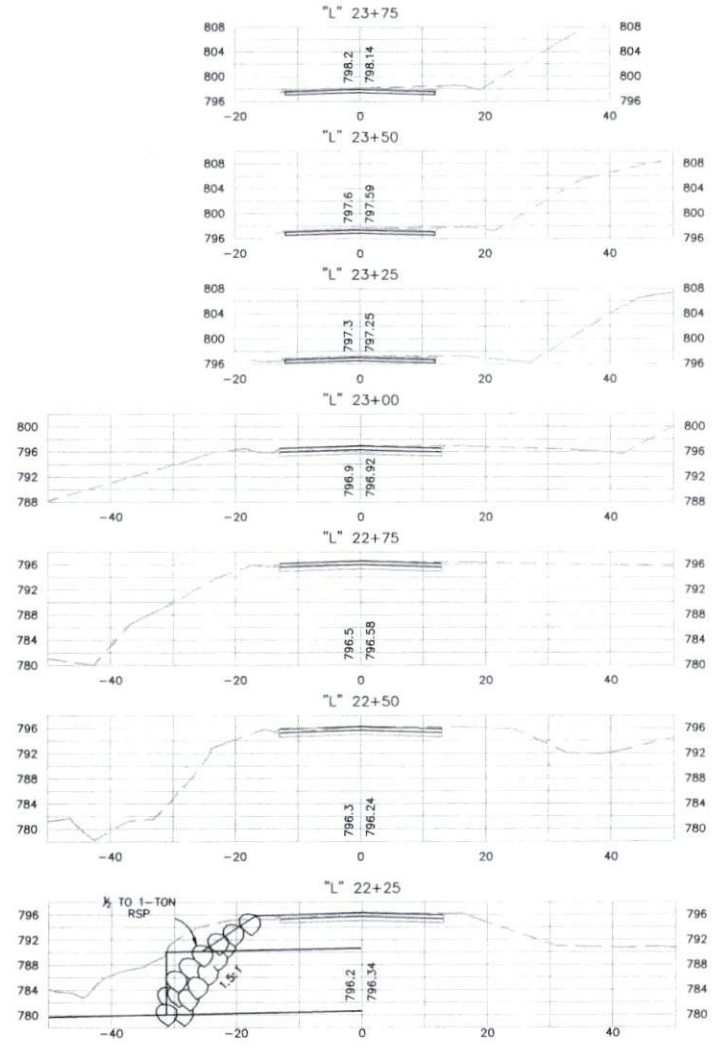
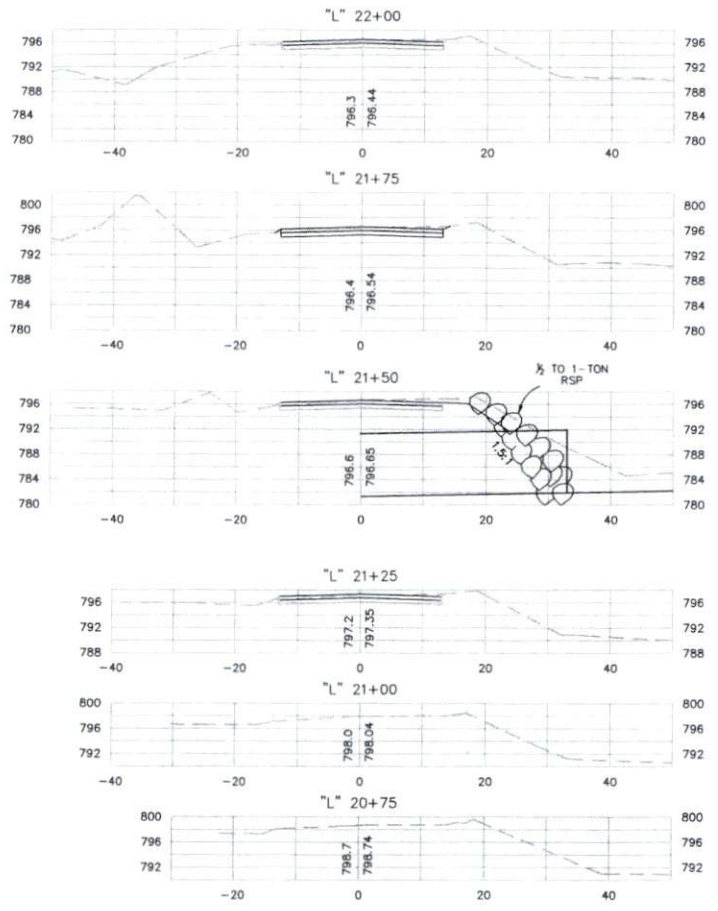

SECTIONS
SCALE: 1"=10'



ROAD NAME: Breceland Thorne Road
 ROAD NO: F34203 MILE POST: 3.27 and 3.74
 AGREEMENT NO: P1810515
 CONTRACT NO: 211304
 DRAWING FILE NAME: L:\PROJECTS\211304 DINNER\DWG\CD0409.DWG
 PLOT DATE: 2/28/2018

DESIGN SECTION: R. L. BURNETT
 DESIGNED BY: JST/MDL
 DRAWN BY: JST/MDL
 REVIEWED BY: JMB
 APPROVED BY: AMS

COUNTY OF HUMBOLDT
 DEPARTMENT OF PUBLIC WORKS
 DINNER CREEK CULVERT REPLACEMENT
 DINNER CREEK SITE 2
 'C' LINE - PLAN & PROFILE

SHEET 9 OF 11

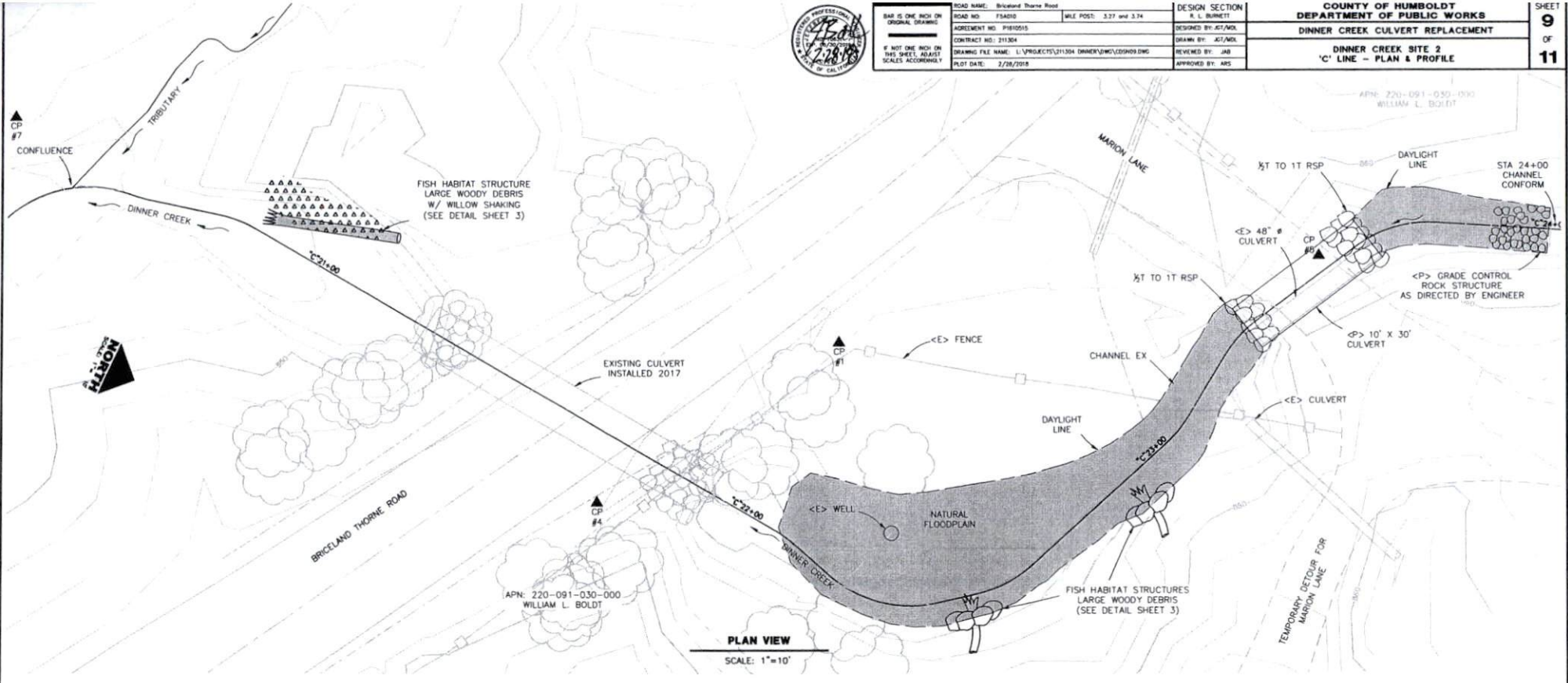

PLAN VIEW
 SCALE: 1"=10'

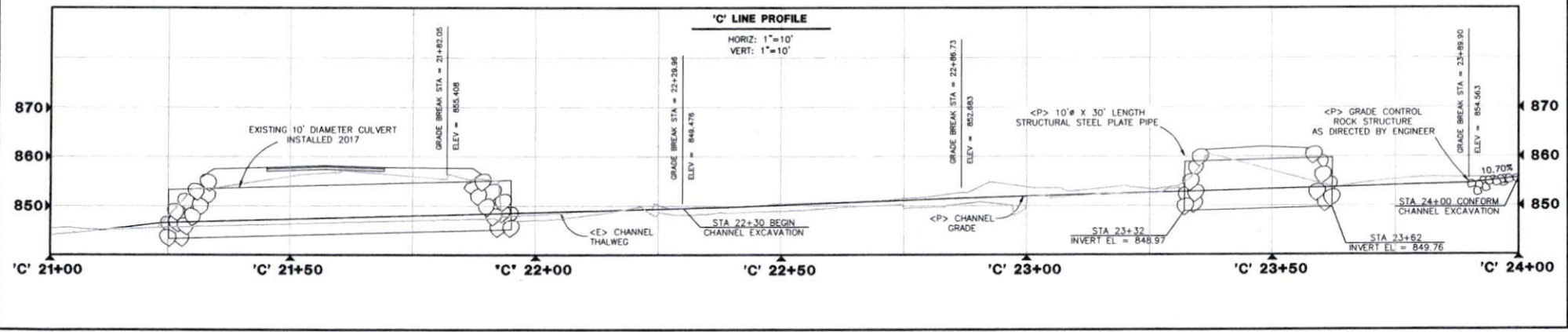



ROAD NAME: Brickett/Thorne Road
ROAD NO: FS4210 MILE POST: 3.27 and 3.74
DESIGN SECTION: R. L. BURNETT
DESIGNED BY: JST/MDL
DRAWN BY: JST/MDL
REVIEWED BY: JMB
APPROVED BY: ARS

AGREEMENT NO. P1610015
CONTRACT NO. 211304
DRAWING FILE NAME: L:\PROJECTS\211304 DINNER CREEK\DWG\211304.DWG
PLOT DATE: 2/28/2018

COUNTY OF HUMBOLDT
DEPARTMENT OF PUBLIC WORKS
DINNER CREEK CULVERT REPLACEMENT
SITE 2 'C' LINE CROSS SECTIONS
CULVERT & STREAM BANK RESTORATION

SHEET 10 OF 11

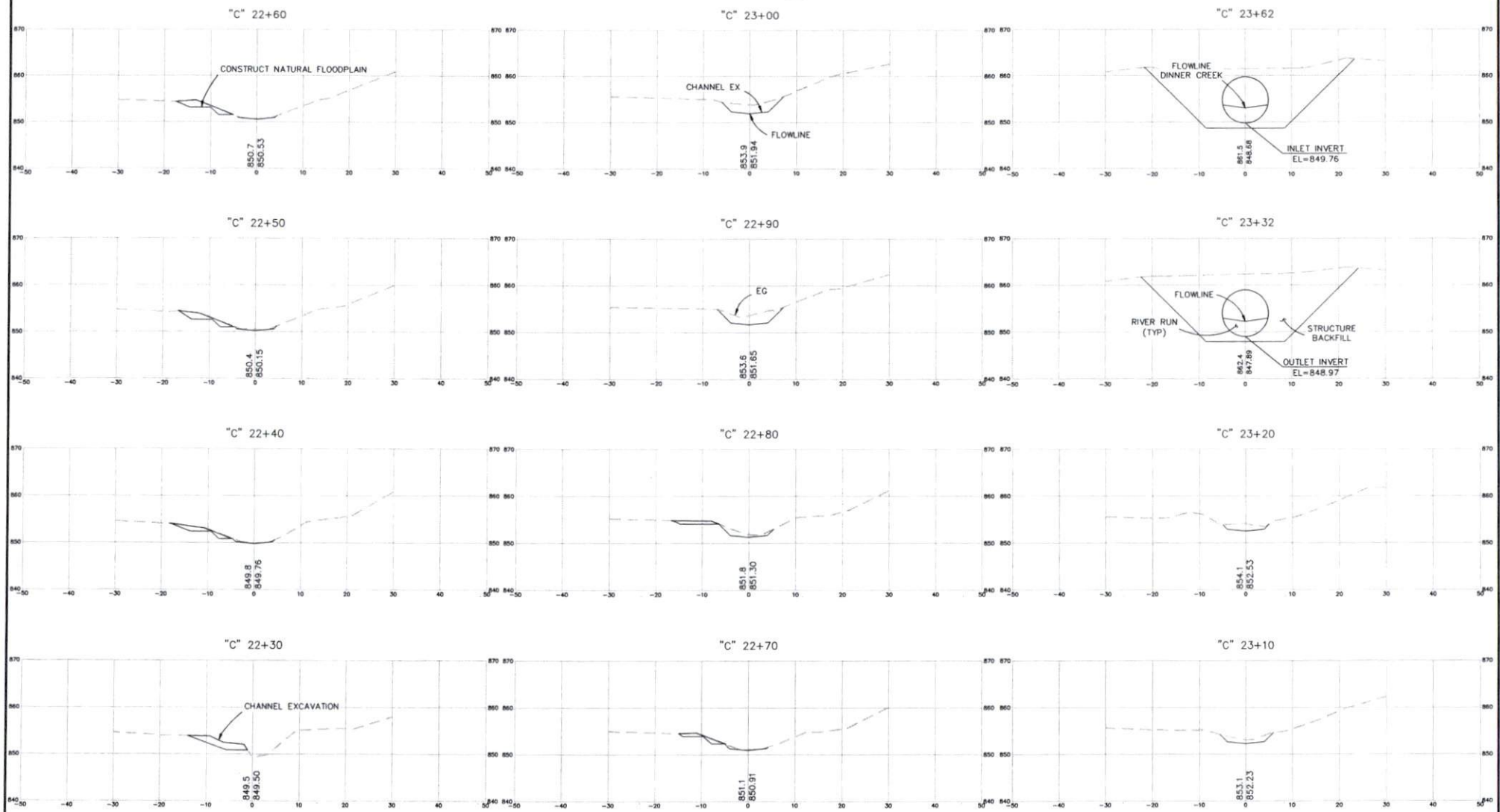

SECTIONS
SCALE: 1"=10'



ROAD NAME: Briceland Thorne Road
ROAD NO: F34810 MILE POST: 3.27 and 3.74
DESIGN SECTION: R. L. BURNETT
DESIGNED BY: JKT/MKL
AGREEMENT NO: F1810515
CONTRACT NO: 211304
DRAWING FILE NAME: L:\PROJECTS\211304 DINNER CREEK\CD\SH11.DWG
REVIEWED BY: JAB
PLOT DATE: 2/28/2008
APPROVED BY: ARS

COUNTY OF HUMBOLDT
DEPARTMENT OF PUBLIC WORKS
DINNER CREEK CULVERT REPLACEMENT
SITE 2 "C" LINE CROSS SECTIONS
CULVERT & STREAM BANK
RESTORATION

SHEET
11
OF
11

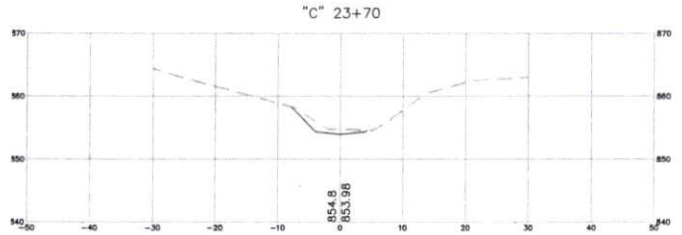
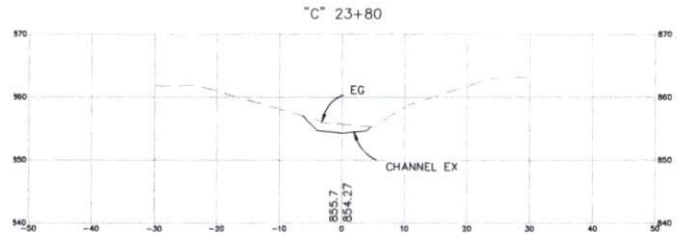
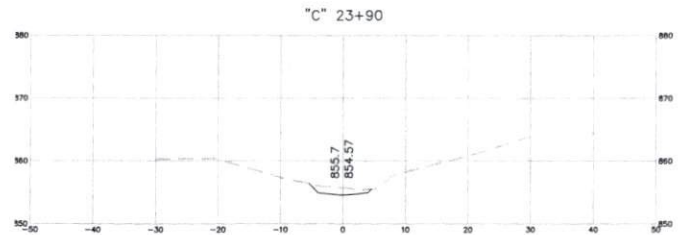
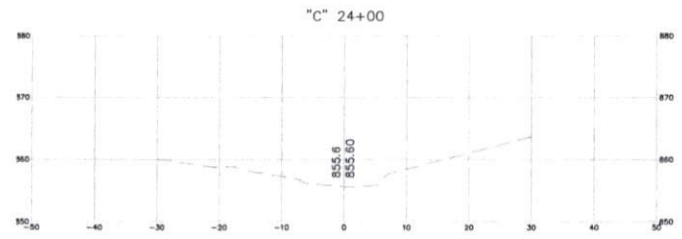

SECTIONS
SCALE: 1"=10'