

HUMBOLDT COUNTY DEPARTMENT OF PUBLIC WORKS GARBERVILLE VETERANS HALL DEMOLITION HUMBOLDT COUNTY PROJECT NUMBER: 162765 AUGUST 2022

AREA MAP

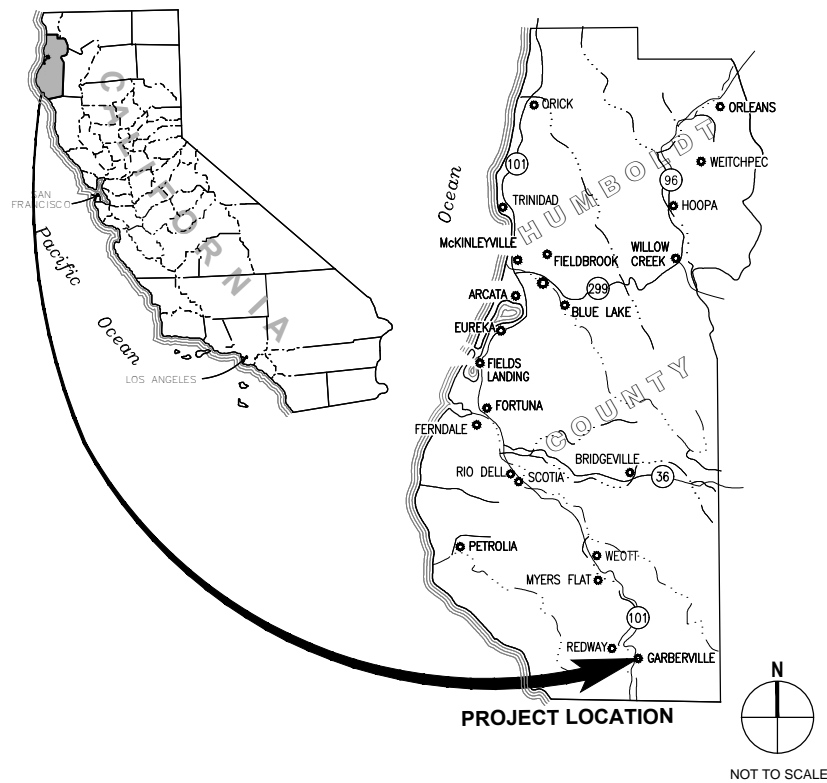

LOCATION MAP



APPROVALS

HUMBOLDT COUNTY DIRECTOR OF PUBLIC WORKS

THOMAS K. MATTSOON _____ SIGNED

GARBERVILLE VETERANS REPRESENTATIVES

REPRESENTATIVE #1: _____ SIGNED

REPRESENTATIVE #2: _____ SIGNED

ENGINEER: GHD Inc.
JOSH WOLF _____ SIGNED

SHEET INDEX

SHEET NO.	DRAWING GENERAL	DESCRIPTION
1	G-001	COVER SHEET
2	G-002	CIVIL NOTES
	CIVIL	
3	C-101	EXISTING CONDITIONS
4	CD101	DEMOLITION
5	C-102	EROSION AND SEDIMENT CONTROL PLAN

No.	Issue	Checked	Approved	Date	
Author	N BLACK	Drafting Check	N SANGER	Project Manager	JOSH WOLF
Designer	N BLACK	Design Check	N SANGER	Project Director	JOSH WOLF



Bar is one inch on original size sheet
0 1"



GHD
GHD Inc.
4080 Plaza Goldorado Circle Suite B
Cameron Park, California 95682 USA
T 1 530 677 5515
www.ghd.com

Conditions of Use
This document and the ideas and designs incorporated herein, as an instrument of professional service, is the property of GHD. This document may only be used by GHD's client (and any other person who GHD has agreed can use this document) for the purpose for which it was prepared and must not be used by any other person or for any other purpose.



Client **HUMBOLDT COUNTY DEPARTMENT OF PUBLIC WORKS**
Project **GARBERVILLE VETERANS HALL DEMOLITION**

Title **COVER SHEET**

Project No. **1258003** Date **2022-08-11** Scale **NTS**

Size **ANSI D**
Status Code
Sheet No. **G-001** Sheet **1 of 5**

GENERAL SITE NOTES

- CONTRACTOR SHALL FIELD VERIFY ALL EXISTING SITE CONDITIONS AND REVIEW ALL AVAILABLE REFERENCE DRAWINGS PRIOR TO THE COMMENCEMENT OF WORK AND REPORT ANY DISCREPANCIES TO THE OWNER'S REPRESENTATIVE. CONTRACTOR IS RESPONSIBLE FOR VISITING THE SITE AND BECOMING FAMILIAR WITH THE SITE CONDITIONS PRIOR TO BIDDING.
- IT IS EXPECTED THAT THE ACTUAL LOCATION OF EXISTING UTILITIES MAY VARY FROM THAT SHOWN ON THE PLANS. CONTRACTOR SHALL NOTIFY UNDERGROUND SERVICE ALERT PRIOR TO COMMENCING WORK AND SHALL POthOLE TO LOCATE ANY UTILITIES WHICH MAY CONFLICT WITH PLANNED WORK.
- UPON COMPLETION OF THE CONSTRUCTION PROJECT, THE CONTRACTOR SHALL LEAVE THE PROJECT AREA FREE OF DEBRIS AND UNUSED MATERIAL. ALL DAMAGE CAUSED BY THE CONTRACTOR SHALL BE RESTORED TO AN "AS GOOD OR BETTER" CONDITION.
- CONTRACTOR TO MAINTAIN TRAFFIC (VEHICULAR AND PEDESTRIAN) ACCESS TO SURROUNDING AREA AT ALL TIMES. CONTRACTOR TO COORDINATE ANY PROPOSED SHUT DOWNS WITH THE COUNTY.
- DUST CONTROL SHALL BE PROVIDED AT ALL TIMES, AT THE CONTRACTOR'S EXPENSE, TO MINIMIZE ANY DUST NUISANCE AND SHALL BE IN ACCORDANCE WITH CALTRANS STANDARD SPECIFICATIONS, CURRENT EDITION. CONTRACTOR SHALL OBTAIN A PERMIT FROM THE HUMBOLDT COUNTY PUBLIC WORKS DEPARTMENT FOR USE OF WATER FROM FIRE HYDRANTS FOR CONSTRUCTION PURPOSES.
- ALLOWABLE WORK TIMES: 9AM - 5PM, MONDAY - FRIDAY.

HAZARDOUS MATERIALS GENERAL NOTES

- AN ASBESTOS SURVEY AND LEAD PAINT SAMPLING AND LEAD WASTE CHARACTERIZATION REPORT HAS BEEN COMPLETED FOR THIS SITE BY BRUNELLE & CLARK CONSULTING, LLC (JANUARY 8, 2021). THE CONTRACTOR SHALL PERFORM ASBESTOS AND LEAD ABATEMENT SERVICES FOR THIS DEMOLITION PROJECT IN CONFORMANCE WITH THE RECOMMENDATIONS IN THE BRUNELLE & CLARK REPORT.
- ALL REQUIRED HAZARDOUS MATERIALS WORK SUBMITTALS MUST BE APPROVED IN WRITING BY HUMBOLDT COUNTY DEPARTMENT OF PUBLIC WORKS PRIOR TO THE START OF ANY HAZARDOUS MATERIAL WORK INCLUDING WORK AREA PREPARATION.
- THE CONTRACTOR SHALL WORK SO AS TO AVOID CREATING AIRBORNE DUST.
- THE CONTRACTOR SHALL TAKE ALL NECESSARY MEASURES TO PROTECT THEIR PERSONNEL, AS WELL AS PERSONNEL IN ADJACENT AREAS, INCLUDING APPROPRIATE USE OF PERSONAL PROTECTIVE EQUIPMENT AND REGULATED AREA DEMARCATION.
- THE CONTRACTOR SHALL PROVIDE SUFFICIENT SAFETY TRAINING TO ALL PERSONNEL RELATED TO THE FOLLOWING HAZARDS AT MINIMUM:
ASBESTOS, LEAD, NOISE, HEAT STRESS, CONFINED SPACE, ELECTRICAL HAZARDS (GFCI USE, WATER USAGE AROUND ELECTRICAL SYSTEMS, LOCK-OUT AND TAG OUT), ANY WORK AT HEIGHTS, AND OTHER ANTICIPATED HAZARDS.
- THE CONTRACTOR SHALL CONSTRUCT AND MAINTAIN ALL HAZARDOUS MATERIAL CONTAINMENT SYSTEMS AND CRITICAL BARRIERS IN A GOOD CONDITION AND SHALL MAINTAIN CONSTANT SURVEILLANCE FOR SIGNS OF CONTAINMENT SYSTEM DETERIORATION OR FAILURE. CORRECTIVE ACTION NECESSARY TO PREVENT OR ADDRESS CONTAINMENT FAILURE SHALL BE TAKEN IMMEDIATELY.

SURVEY NOTES

- TOPOGRAPHIC SURVEY PERFORMED BY HUMBOLDT COUNTY DEPARTMENT OF PUBLIC WORKS ON FEBRUARY 14, 2022.
- TOPOGRAPHIC SURVEYS DO NOT NECESSARILY REPRESENT THE CURRENT SITE CONDITIONS. CONTRACTOR TO VERIFY SITE CONDITIONS.
- HORIZONTAL CONTROL IS ON NAD83(2011) EPOCH 2010.00 BASIS, CALIFORNIA STATE PLANE COORDINATES, ZONE 1. VERTICAL CONTROL IS ON NAVD88 BASIS.
- CONTRACTOR MUST COMPLY WITH BUSINESS AND PROFESSIONS CODE SECTION 8771(B) REGARDING REFERENCING, PRESERVING AND RECONSTRUCTING SURVEY MONUMENTS, WHETHER OR NOT SURVEY MONUMENTS ARE SHOWN.
- IF SURVEY MONUMENT IS DAMAGED BY CONTRACTORS OPERATIONS, CONTRACTOR SHALL REPLACE SURVEY MONUMENT AT CONTRACTORS EXPENSE.

UTILITY NOTES

- LOCATIONS OF EXISTING UNDERGROUND UTILITIES ARE PLOTTED FROM RECORD DRAWINGS AND INTERPOLATION OF PHYSICAL EVIDENCE ON THE SITE AND ARE SUBJECT TO FIELD VERIFICATION BY THE CONTRACTOR. SEE GENERAL SITE NOTES 1 AND 2. SEE UTILITY LOCATING AND MAPPING SPECIFICATIONS.
- ALL LOCATIONS FOR WORK SHALL BE CHECKED AND COORDINATED WITH EXISTING CONDITIONS IN THE FIELD BEFORE BEGINNING CONSTRUCTION UNDER THIS SECTION OR ANY OTHER SECTION.
- CONTRACTOR SHALL COORDINATE USA UTILITY LOCATE AT LEAST TWO WORKING DAYS PRIOR TO BEGINNING DEMOLITION. CONTRACTOR SHALL COORDINATE THE UTILITY LOCATE WITH THE OWNER FOR ALL UTILITY WORK. INFORM OWNER IMMEDIATELY IF LOCATE INDICATES THAT EXISTING UTILITIES ARE DIFFERENT THAN SHOWN ON DRAWINGS.
- CONTRACTOR IS RESPONSIBLE FOR ANY DAMAGE TO UTILITIES, FEATURES, AND STRUCTURES LOCATED ON THE SITE. LOCATE, PROTECT, AND AVOID DISRUPTION OF ALL ABOVE AND BELOW GRADE UTILITIES DURING CONSTRUCTION.
- APPROXIMATE BUILDING UTILITY CONNECTIONS ARE SHOWN ON DRAWINGS WHERE FOUND. COMPLETENESS OF BUILDING CONNECTIVITY IS NOT GUARANTEED.
- CONTRACTOR TO VERIFY CONNECTIVITY OF UTILITY NETWORK PRIOR TO DEMOLITION OF EXISTING UTILITY.
- ALL EXISTING UTILITIES AND TIE-IN POINTS SHOULD BE CONSIDERED ACTIVE UTILITIES UNLESS OTHERWISE INDICATED.
- CONFIRM ALL UTILITY VALVE VAULTS, VALVES, METERS, BACKFLOW PREVENTION ASSEMBLIES, AND OTHER UTILITY APPURTENANCES WITH THE COUNTY.
- UTILITY LOCATIONS ARE APPROXIMATE. ANY UTILITY VERIFICATION IS TO BE LIMITED TO HAND TOOLS AND MUST BE COORDINATED WITH UTILITY PROVIDER PRIOR TO ANY EXCAVATION. ANY ADJUSTMENT AND / OR CORRECTION TO ANY UTILITY WORK SHOWN ON THESE PLANS THAT AFFECTS A UTILITY MUST BE COORDINATED WITH UTILITY PROVIDER. SEE GENERAL SITE NOTES 1 & 2.

EROSION AND SEDIMENTATION CONTROL NOTES

THESE MINIMUM EROSION AND SEDIMENTATION CONTROL STANDARDS SHALL APPLY TO ALL PROJECTS REQUIRING BUILDING, GRADING, AND DEVELOPMENT PERMITS, AND COUNTY OF HUMBOLDT PUBLIC WORKS ACTIVITIES, TO PREVENT SEDIMENTATION OF ONSITE AND OFF-SITE PROPERTY.

GENERAL GUIDELINES

- MINIMIZE SOIL EXPOSURE DURING THE OCT 15 / APR 15 BY PROPER TIMING OF GRADING AND CONSTRUCTION.
- RETAIN TREES AND NATURAL VEGETATION TO STABILIZE HILLSIDES, RETAIN MOISTURE, REDUCE EROSION, MINIMIZE SILTATION AND NUTRIENT RUNOFF AND PRESERVE SCENIC QUALITIES.
- VEGETATE AND MULCH DENUDED AREAS TO PROTECT THEM FROM WINTER RAINS.
- DIVERT RUNOFF AWAY FROM SLEEP, DENUDED SLOPES OR OTHER CRITICAL AREAS WITH BARRIERS, BERMS, DITCHES OR OTHER FACILITIES.
- DESIGN GRADING TO BE COMPATIBLE WITH ADJACENT AREAS AND RESULT IN MINIMAL DISTURBANCE OF THE TERRAIN AND NATURAL LAND FEATURES.
- LIMIT THE CLEARING OF VEGETATION AND DISTURBANCE OF THE SOIL TO AREAS OF PROVEN STABILITY. MITIGATE GEOLOGIC HAZARDS AND ADVERSE SOIL CONDITIONS WHEN THEY ARE ENCOUNTERED.
- REDUCE SEDIMENT TRANSPORT OFF SITE TO THE MAXIMUM EXTENT FEASIBLE THROUGH THE USE OF THE BEST MANAGEMENT PRACTICES (BMPs).
- PROPOSE A NEW OR MODIFIED EROSION AND SEDIMENT CONTROL TECHNIQUE IF THE TECHNIQUE IS PREFERRED AND MEETS THE INTENT OR THESE REGULATIONS. OBTAIN APPROVAL FROM THE COUNTY PRIOR TO IMPLEMENTATION.
- CONDUCT FREQUENT SITE INSPECTION TO ENSURE THAT CONTROL MEASURES ARE WORKING PROPERLY AND TO CORRECT PROBLEMS AS NEEDED.
- EMPLOY OTHER MEANS OF EROSION AND SEDIMENT CONTROL AS REQUIRED BY THE CHIEF BUILDING OFFICIAL OR THE COUNTY REPRESENTATIVE AS APPLICABLE.

SEDIMENT CONTROL

- USE SEDIMENT BASINS, SILT TRAPS, OR SIMILAR MEASURE TO RETAIN SEDIMENT TRANSPORTED BY RUNOFF WATER ONSITE.
- COLLECT AND DIRECT SURFACE RUNOFF AT NON-EROSIVE VELOCITIES TO THE COMMON NATURAL WATERCOURSE OF THE DRAINAGE AREA.
- AVOID CONCENTRATING SURFACE WATER ANYWHERE EXCEPT SWALES OR WATERCOURSES.
- PREVENT MUD FROM BEING TRACKED ONTO THE PUBLIC ROADWAY BY TRAVELING OVER A TEMPORARY GRAVEL CONSTRUCTION ENTRANCE OR WASHING OFF VEHICLE TIRES BEFORE ENTERING A PUBLIC OR PRIVATE DRIVEWAY.

PROTECTION OF WATERCOURSES AND DRAINAGE INLETS

- PREPARE DRAINAGE WAYS TO HANDLE CONCENTRATED OR INCREASED RUNOFF FROM DISTURBED AREAS BY USING APPROPRIATE LINING MATERIALS OR ENERGY ABSORBING DEVICES TO REDUCE THE VELOCITY OF RUNOFF WATER.
- TRAP SEDIMENT-LADEN RUNOFF IN BASINS TO ALLOW SOIL PARTICLES TO SETTLE OUT BEFORE FLOWS ARE RELEASED TO RECEIVING WATER, STORM DRAIN, STREET OR ADJACENT PROPERTY. THIS STANDARD IS NOT MANDATORY FOR GRADING CONDUCTED BETWEEN APRIL 15 AND OCTOBER 15 WHEN THE SITE IS FULLY WINTERIZED AND STABILIZED PRIOR TO OCTOBER 15. REMOVE TRAPPED SEDIMENT TO A SUITABLE LOCATION ON-SITE OR AT A DISPOSAL SITE APPROVED BY THE COUNTY.
- DO NOT GRADE OR DRIVE EQUIPMENT IN A STREAMSIDE MANAGEMENT OR OTHER WET AREAS EXCEPT AS ALLOWED THROUGH THE COUNTY STREAMSIDE MANAGEMENT AREA.
- DEPOSIT OR STORE EXCAVATED MATERIALS AWAY FROM WATERCOURSES.
- PROTECT ALL STORM DRAINAGE STRUCTURES FROM SEDIMENT CLOGGING.
- USE STRAW BALES, FILTER FABRIC WRAPS AND DRAINAGE INLET PROTECTIONS IN A MANNER THAT DOES NOT CAUSE EROSION OR FLOODING OF A ROADWAY.

DISPOSAL OF EXCAVATED MATERIALS

- STOCKPILE TOPSOIL ON THE SITE FOR USE ON AREAS TO BE RE-VEGETATED.
- PLACE STOCKPILED SOIL IN LOCATIONS, SO THAT IF EROSION OCCURS, IT WILL NOT CONTRIBUTE TO OFF-SITE SEDIMENT DISCHARGE.
- PROTECT STOCKPILED SOIL PROMPTLY THROUGH THE USE OF APPROPRIATE BMPs TO REDUCE THE RISK OF EROSION AND SEDIMENT TRANSPORT. APPLY MULCH OR OTHER PROTECTIVE COVERINGS ON STOCKPILED MATERIAL THAT WILL BE EXPOSED THROUGH THE WINTER SEASON.
- DISPOSE OF EXCAVATED MATERIAL NOT USED AT THE SITE AT A LOCATION APPROVED BY THE COUNTY.

DUST CONTROL

- ALL PROJECT AREA SHALL BE TREATED AND MAINTAINED AS NECESSARY TO MINIMIZE THE EMISSION OF DUST. MAINTENANCE SHALL BE CONDUCTED AS NECESSARY TO PREVENT A NUISANCE TO OFF-SITE PROPERTIES.
- ALL PROJECT SITES, SHALL BE MAINTAINED AS NECESSARY TO MINIMIZE THE EMISSION OF DUST AND PREVENT THE CREATION OF A NUISANCE TO ADJACENT PROPERTIES.

REVEGETATION

- APPLY TEMPORARY SEEDING AND MULCHING TO DENUDED AREAS PRIOR TO OCTOBER 15 UNLESS THE PROJECT IS CONDITIONED OTHERWISE.
- ESTABLISH A PERMANENT VEGETATIVE COVER ON DENUDED AREAS NOT OTHERWISE STABILIZED.
- PERMANENT VEGETATION GROUND COVER MUST CONTROL SOIL EROSION SATISFACTORILY AND SURVIVE SEVERE WEATHER CONDITIONS.
- RETAIN A VEGETATIVE BARRIER WHENEVER POSSIBLE AROUND PROPERTY BOUNDARIES.

PLAN SYMBOLS

— OH —	OVERHEAD WIRES		GAS METER
— OHE —	OVERHEAD ELECTRIC WIRES		GAS VALVE
— OHT —	OVERHEAD TELEPHONE WIRES		HOSE BIBB
— E —	ELECTRIC LINE		WATER METER
— G —	GAS LINE		WATER VALVE
— SS —	SANITARY SEWER LINE		ELECTRICAL MANHOLE
— SSFM —	SANITARY SEWER FORCE MAIN		SANITARY SEWER CLEANOUT
— SD —	STORM DRAIN LINE		SEWER MANHOLE
— W —	WATER LINE		STORM DRAIN MANHOLE
— x —	CHAINLINK FENCE		CATCH BASIN
— — —	RIGHT OF WAY		TELEPHONE MANHOLE
x 95.94 95.94	SPOT ELEVATION		POWER POLE
	LIMITS OF DEMOLITION		GUY WIRE & ANCHOR
	TREE		STREET LIGHT
			JOINT USE UTILITY POLE
			PROPERTY LINE
			SIGN (AS NOTED)

GENERAL SHEET SYMBOLS

	KEYNOTE
--	---------

No.	Issue	Checked	Approved	Date	
Author	N BLACK	Drafting Check	N SANGER	Project Manager	JOSH WOLF
Designer	N BLACK	Design Check	N SANGER	Project Director	JOSH WOLF

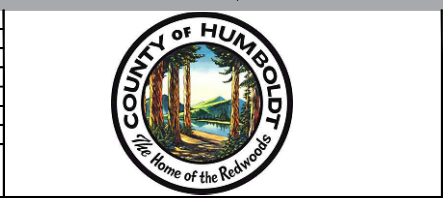

Bar is one inch on original size sheet
0 ————— 1"

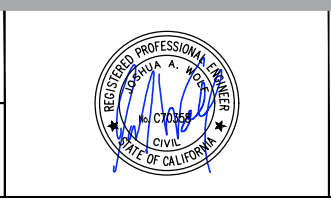

GHD Inc.
4080 Plaza Goldorado Circle Suite B
Cameron Park, California 95682 USA
T 1 530 677 5515
www.ghd.com

Conditions of Use
This document and the ideas and designs incorporated herein, as an instrument of professional service, is the property of GHD. This document may only be used by GHD's client (and any other person who GHD has agreed can use this document) for the purpose for which it was prepared and must not be used by any other person or for any other purpose.

Client **HUMBOLDT COUNTY DEPARTMENT OF PUBLIC WORKS**
Project **GARBERVILLE VETERANS HALL DEMOLITION**

Project No. **1258003**
Date **2022-08-11**
Scale **1" = 10'**

Title **CIVIL NOTES**

Sheet No. **G-002**
Sheet **2 of 5**

SHEET GENERAL NOTES

1. LOCATION OF (E) UTILITIES AND STRUCTURES ARE FROM INFORMATION AVAILABLE AT THE TIME OF DESIGN. EXACT LOCATION AND COMPLETENESS ARE NOT GUARANTEED. CONTRACTOR SHALL NOTIFY THE OWNER AND UNDERGROUND SERVICES ALERT (800-642-2444) A MINIMUM OF TWO BUSINESS DAYS PRIOR TO ANY EXCAVATION AND SHALL POTHOLE FOR EXACT LOCATION. CONTRACTOR IS RESPONSIBLE FOR LOCATING EXISTING UTILITIES.
2. ALL FACILITIES SHOWN ON THIS PAGE ARE EXISTING.
3. ALL DIMENSIONS SHOWN ARE APPROXIMATE.

LINE & HATCH LEGEND

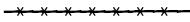
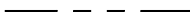
-  CONCRETE SLAB/PAVING
-  PROPERTY BOUNDARY FENCE LINE
-  RIGHT OF WAY

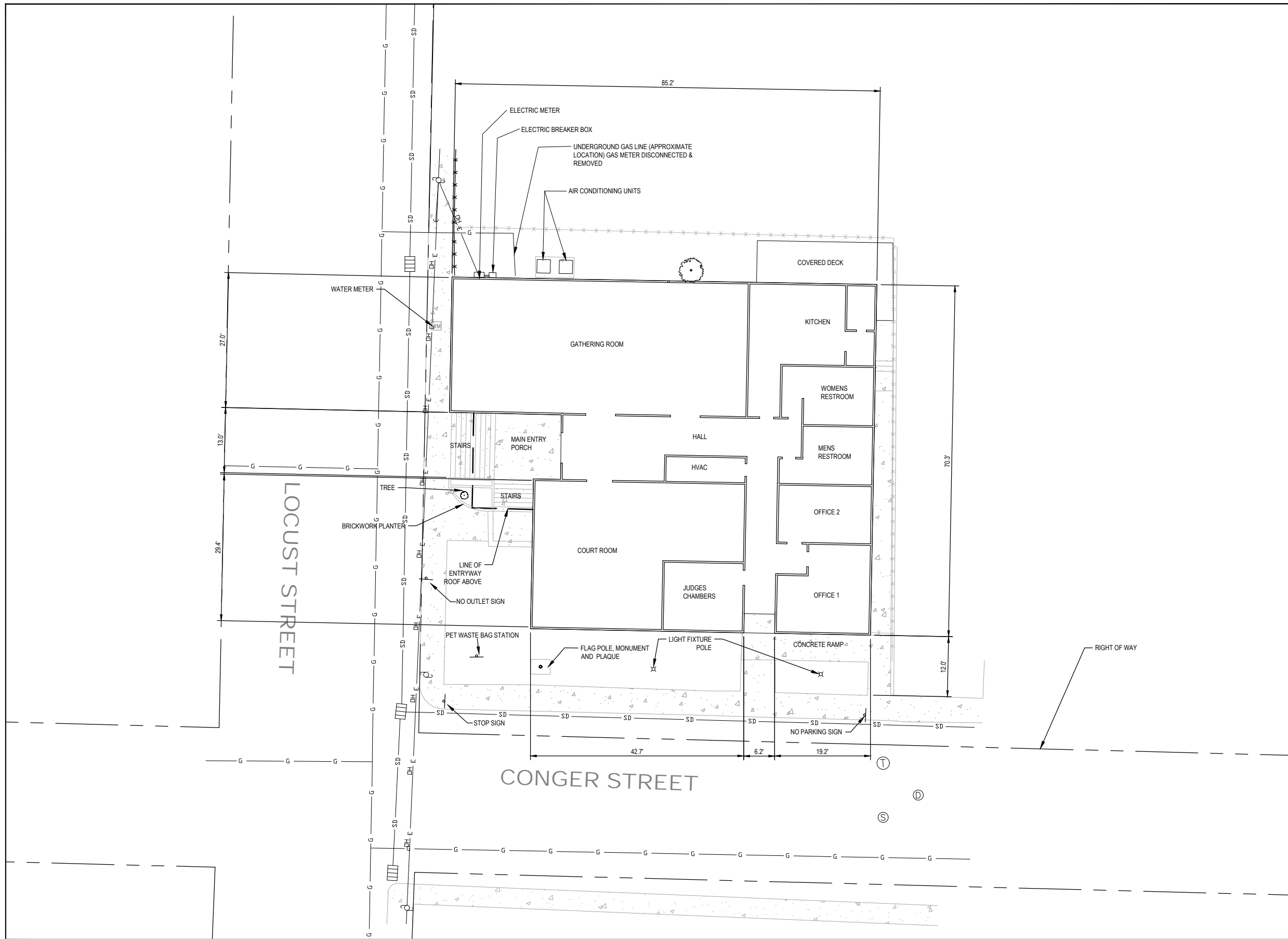

No.	Issue	Checked	Approved	Date	
Author	N BLACK	Drafting Check	N SANGER	Project Manager	JOSH WOLF
Designer	N BLACK	Design Check	N SANGER	Project Director	JOSH WOLF



Bar is one inch on original size sheet
0 1"



GHD Inc.
4080 Plaza Goldorado Circle Suite B
Cameron Park, California 95682 USA
T 1 530 677 5515



Client **HUMBOLDT COUNTY DEPARTMENT OF PUBLIC WORKS**
Project **GARBERVILLE VETERANS HALL DEMOLITION**

Title **EXISTING CONDITIONS**

Size **ANSI D**

Status Code

Project No. **1258003** Date **2022-08-11** Scale **1" = 10'**

Sheet No. **C-101** Sheet **3 of 5**

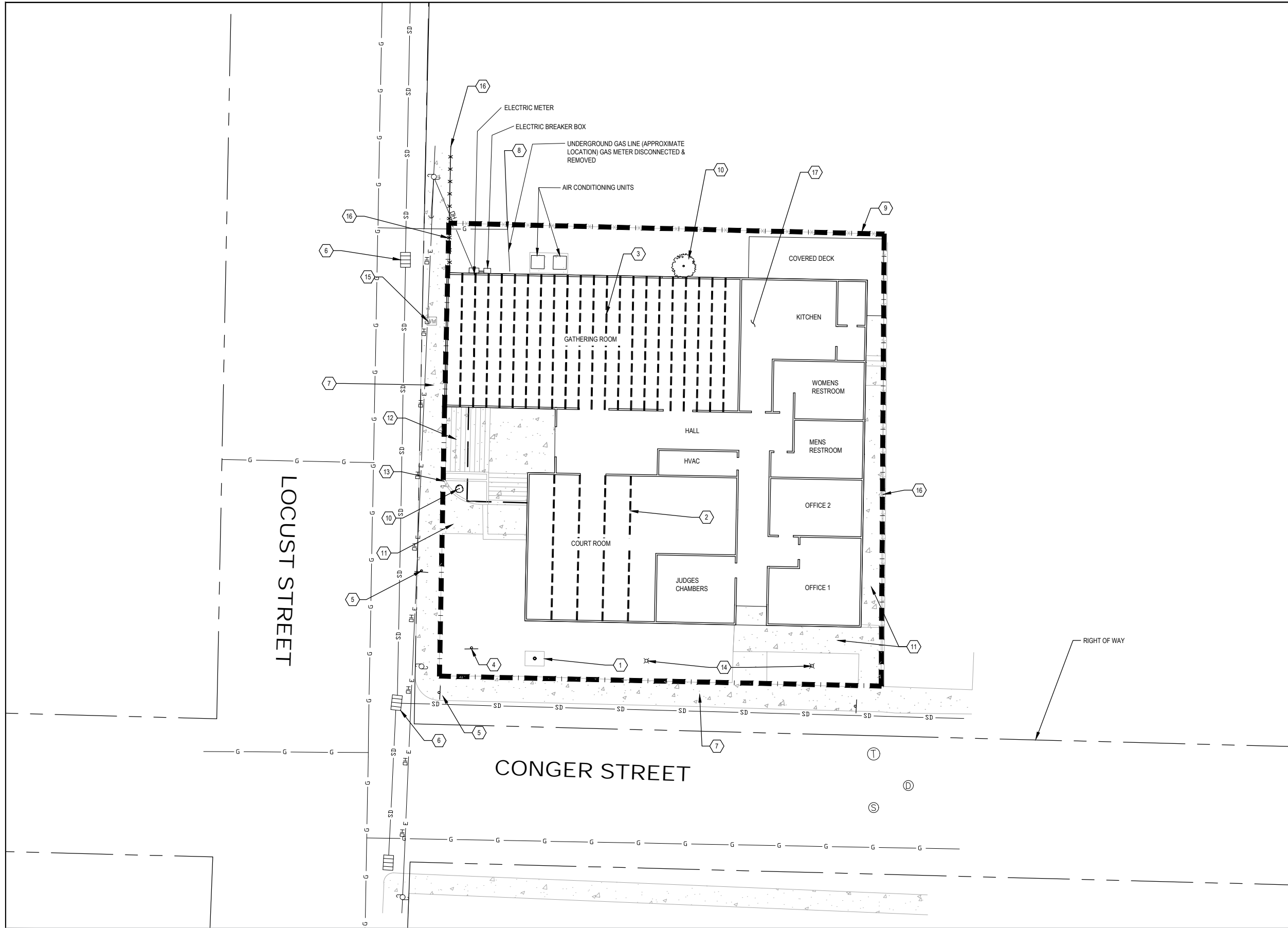

SHEET GENERAL NOTES

1. LOCATION OF (E) UTILITIES AND STRUCTURES ARE FROM INFORMATION AVAILABLE AT THE TIME OF DESIGN. EXACT LOCATION AND COMPLETENESS ARE NOT GUARANTEED. CONTRACTOR SHALL NOTIFY THE OWNER AND UNDERGROUND SERVICES ALERT (800)642-2444 A MINIMUM OF TWO BUSINESS DAYS PRIOR TO ANY EXCAVATION AND SHALL POthOLE FOR EXACT LOCATION. CONTRACTOR IS RESPONSIBLE FOR LOCATING EXISTING UTILITIES.
2. UNLESS NOTED OTHERWISE, CONTRACTOR TO DEMOLISH AND REMOVE ALL SITEWORK, BUILDINGS, FOOTINGS, WALKWAYS, STAIRS, RETAINING WALLS, UTILITIES, AIR CONDITIONING UNITS, ETC. CONTRACTOR TO HYDROSEED, APPLY STRAW MULCH, AND INSTALL FIBER ROLLS AND OTHER BMP'S AS PRESENTED IN THE EROSION AND SEDIMENT CONTROL NOTES AFTER DEMOLITION IS COMPLETE.
3. CONTRACTOR RESPONSIBLE FOR PROPER DISPOSAL OF ALL DEMOLISHED MATERIALS, WASTE PRODUCTS, AND OTHER DEBRIS ENCOUNTERED DURING CONSTRUCTION.
4. ALL FACILITIES SHOWN ON THIS PAGE ARE EXISTING.
5. ALL SALVAGED ITEMS ARE TO BE DELIVERED TO THE HUMBOLDT COUNTY BUILDING MAINTENANCE YARD LOCATED AT 901 2ND ST, EUREKA, CALIFORNIA, UNLESS OTHERWISE DIRECTED. CONTRACTOR TO COORDINATE DELIVERY DETAILS WITH COUNTY REPRESENTATIVES.

SHEET KEYNOTES

1. (E) FLAGPOLE, FLAGPOLE BASE AND MEMORIAL PLAQUE TO BE SALVAGED.
2. (E) 4"x20" REDWOOD DENSE STRUCTURAL CEILING BEAMS TO BE SALVAGED. (4 TOTAL, EACH APPROX. 29' IN LENGTH)
3. (E) 4"x16" REDWOOD DENSE STRUCTURAL CEILING BEAMS TO BE SALVAGED. (21 TOTAL, EACH APPROX. 26' IN LENGTH)
4. (E) PET WASTE STATION TO BE DEMOLISHED & REMOVED.
5. (E) ROADWAY SIGN TO REMAIN & BE PROTECTED. TYP.
6. (E) STORM DRAIN TO REMAIN & BE PROTECTED. TYP.
7. (E) PUBLIC SIDEWALK TO REMAIN AND BE PROTECTED.
8. CONTRACTOR TO COORDINATE WITH LOCAL PROPANE COMPANY TO ABANDON (E) GAS LINE.
9. EXTENTS OF DEMOLITION ACTIVITIES.
10. (E) TREE TO BE REMOVED.
11. (E) CONCRETE RAMP AND SIDEWALK/WALKWAY TO BE DEMOLISHED AND REMOVED.
12. (E) CONCRETE STAIRS TO BE DEMOLISHED AND REMOVED.
13. (E) BRICKWORK TO BE DEMOLISHED AND REMOVED.
14. (E) LIGHT FIXTURES TO BE DEMOLISHED AND REMOVED
15. (E) WATER METER TO REMAIN AND BE PROTECTED
16. (E) FENCE TO REMAIN AND BE PROTECTED. TYP.
17. DEMOLISH AND REMOVE (E) BUILDING.

LINE & HATCH LEGEND

- (E) CONCRETE SLAB/PAVING
- LIMITS OF DEMOLITION
- DENSE STRUCTURAL REDWOOD BEAMS, TO BE SALVAGED
- RIGHT OF WAY
- PROPERTY BOUNDARY FENCE LINE



No.	Issue	Checked	Approved	Date
Author	N BLACK	Drafting Check	N SANGER	Project Manager
Designer	N BLACK	Design Check	M SANGER	Project Director
			JOSH WOLF	



Bar is one inch on original size sheet
0 1"



GHD Inc.
4080 Plaza Goldorado Circle Suite B
Cameron Park, California 95682 USA
T 1 530 677 5515

Conditions of Use
This document and the ideas and designs incorporated herein, as an instrument of professional service, is the property of GHD. This document may only be used by GHD's client (and any other person who GHD has agreed can use this document) for the purpose for which it was prepared and must not be used by any other person or for any other purpose.



Client **HUMBOLDT COUNTY DEPARTMENT OF PUBLIC WORKS**
Project **GARBERVILLE VETERANS HALL DEMOLITION**

Title **DEMOLITION PLAN**

Project No. **1258003** Date **2022-08-11** Scale **1" = 10'**

Size **ANSI D**
Status Code
Sheet No. **CD101** Sheet **4 of 5**

