

Humboldt County Board of Supervisors Presentation

April 4th, 2023



Hannah Ozanian

Homeless Services Consultant with DHHS

Former Director of Friendship Park at Loaves & Fishes, a day center for adults experiencing homelessness in Sacramento

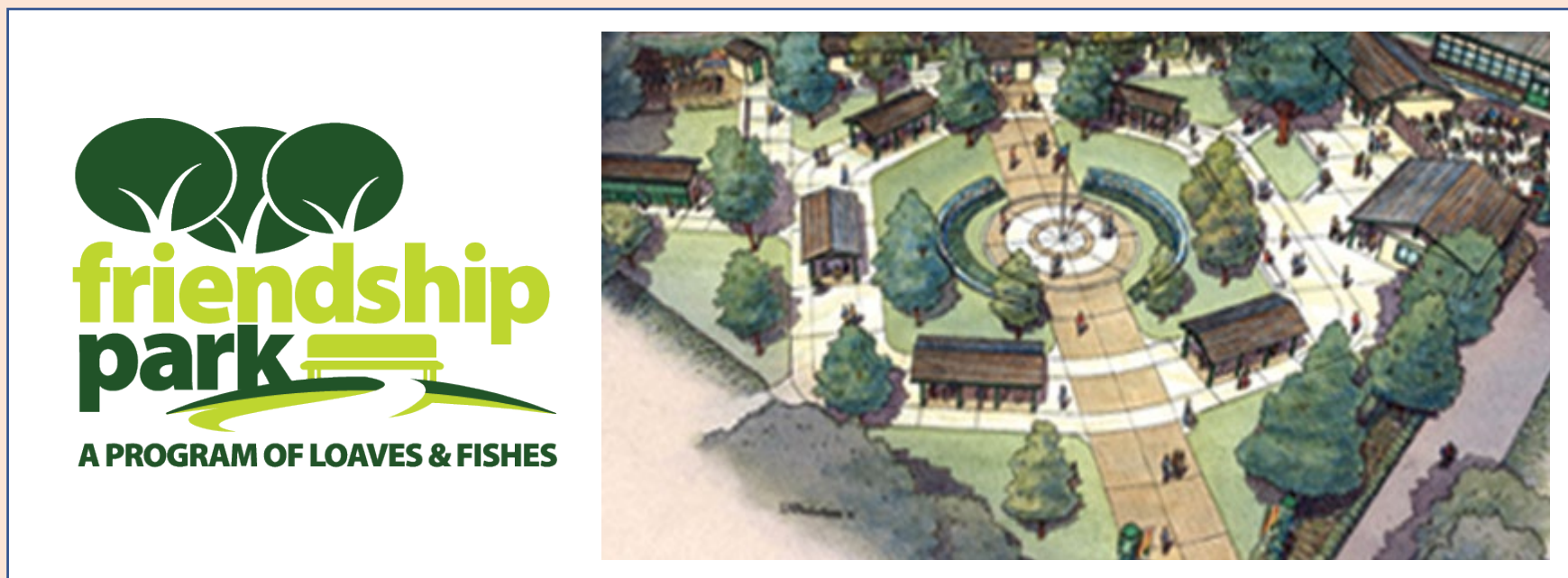



Loaves & Fishes Friendship Park





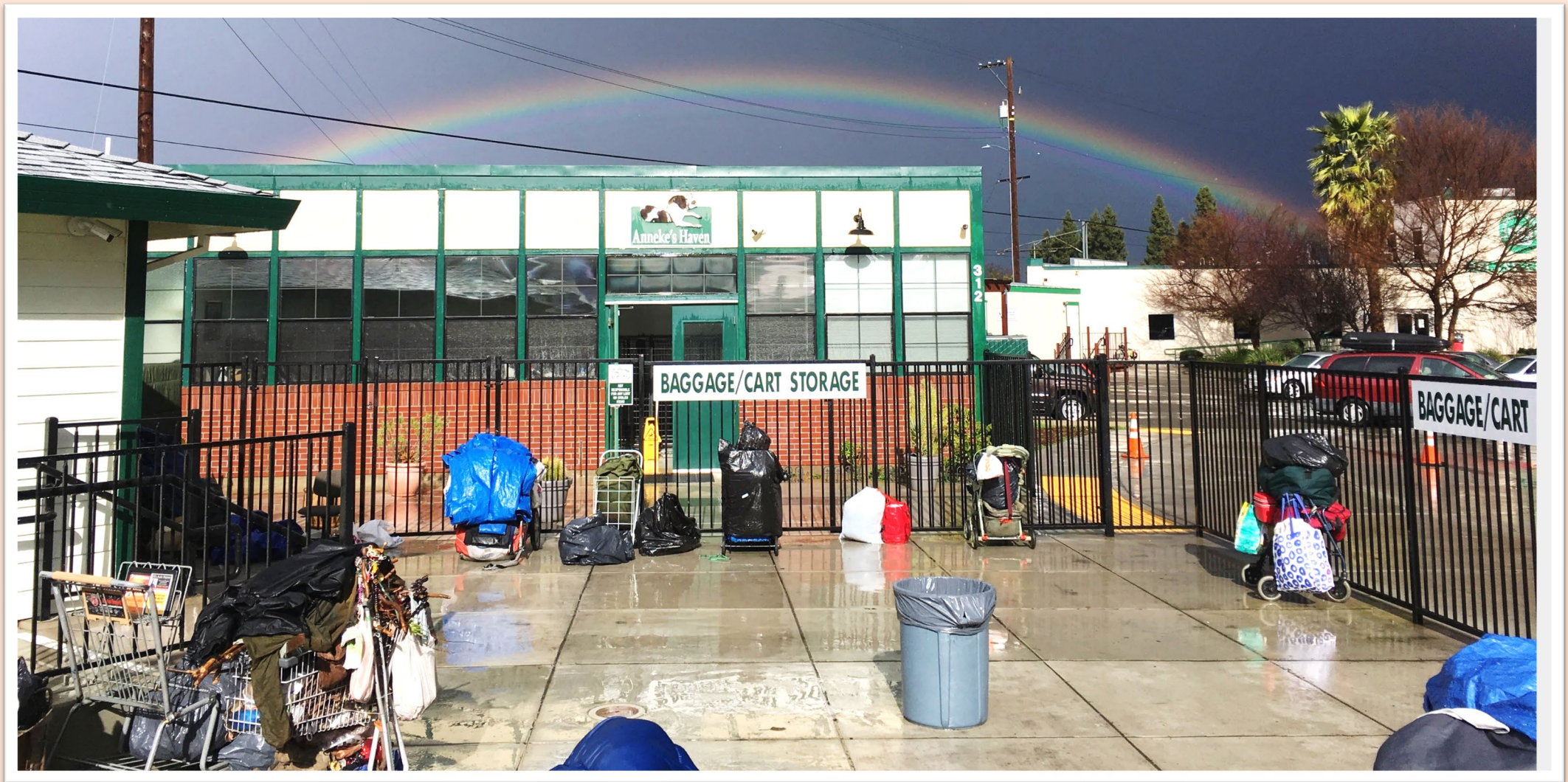

Anneke's Haven

BAGGAGE/CART STORAGE

BAGGAGE/CART

312

Humboldt Navigation Center Objectives

- To develop a central location for people experiencing homelessness, social service agencies and community groups/volunteers to work together on the local challenges of homelessness
- To engage with and offer assistance to individuals experiencing homelessness by connecting them to available resources and to provide clear pathways to connect people to permanent housing options
- To provide a place respite for individuals to be during the day including basic survival services

Services to include

- Assessment for service need
- Access to social workers, mental health clinicians, SUD counselors, and community/outreach organizations
- Hygiene services such as restrooms, showers, a clothing closet and laundry assistance
- Community classrooms and computer lab
- Storage lockers, bike kitchen, pet kennel and care
- A safe place to be during the day

What we envision for the shelter

A shelter where individuals live temporarily as they work towards obtaining permanent housing.

- Non-congregate shelter
- Accommodation of the Ps: Partners, Pets, and Possessions
- Dedicated case management to assist in the transition to permanent housing

Location

80 W. 3rd Street, Eureka

Site is an undeveloped lot owned by Mercer-Fraser

Located across the street from St. Vincent de Paul Dining Facility, where a lunchtime meal is provided to an average of 100 individuals per day









Commercial St.



Sign Dimensions:
 300' x 200' x 1500'
 Stall width 5.5m
 Stall length 18.0m
 Stall angle 90deg
 No. Stalls 9

W. 3rd Street



Pavilion



Bike and Cart Lockers



Lockers



Kennels

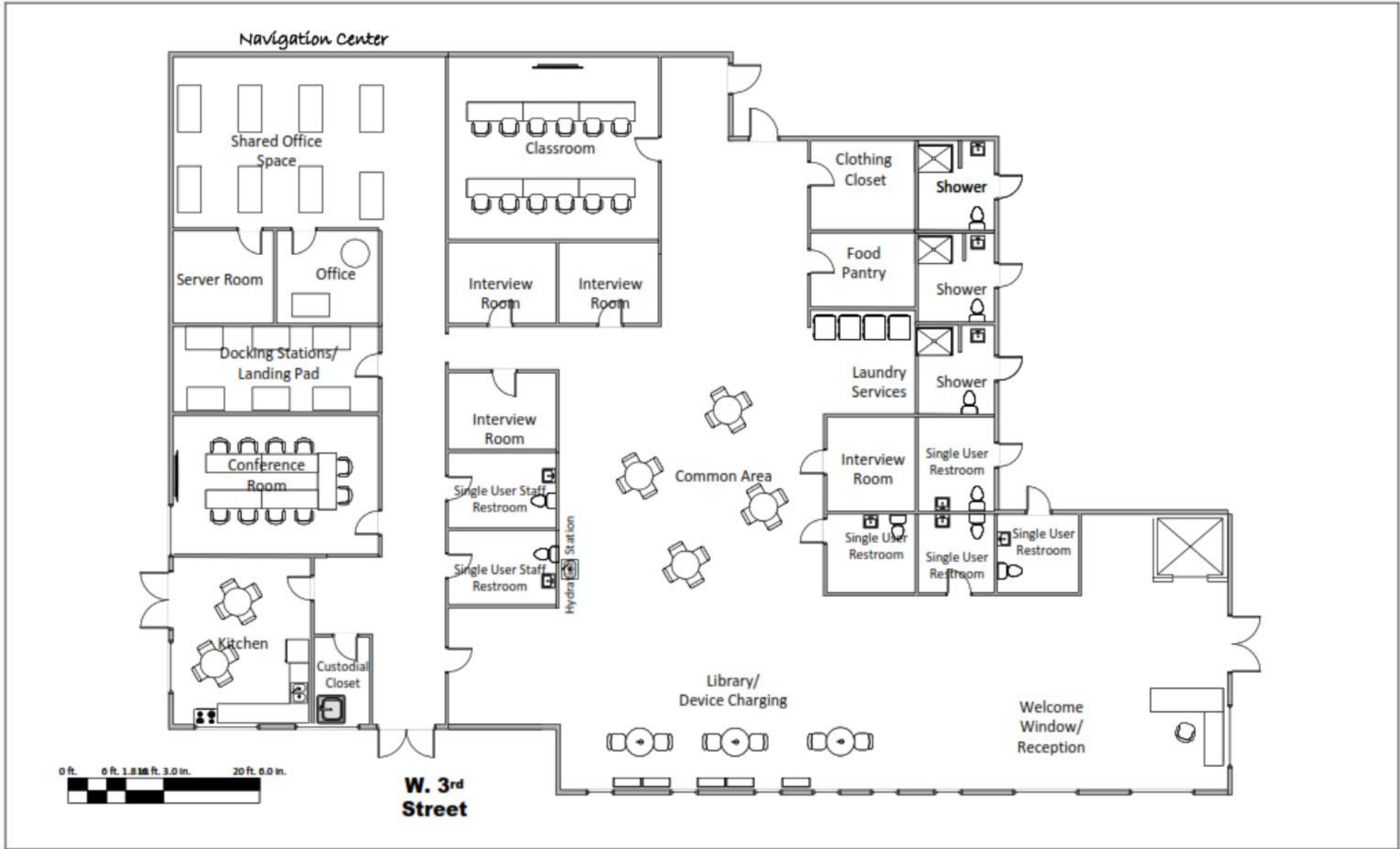

Navigation Center



Safety and Security

- 24-hour security will be provided
- Staff will be trained in de-escalation techniques
- EPD's Community Safety Engagement Team will play an active role in outreach and community engagement



Questions?